

OFF ISLAND PEAKS
28/2267

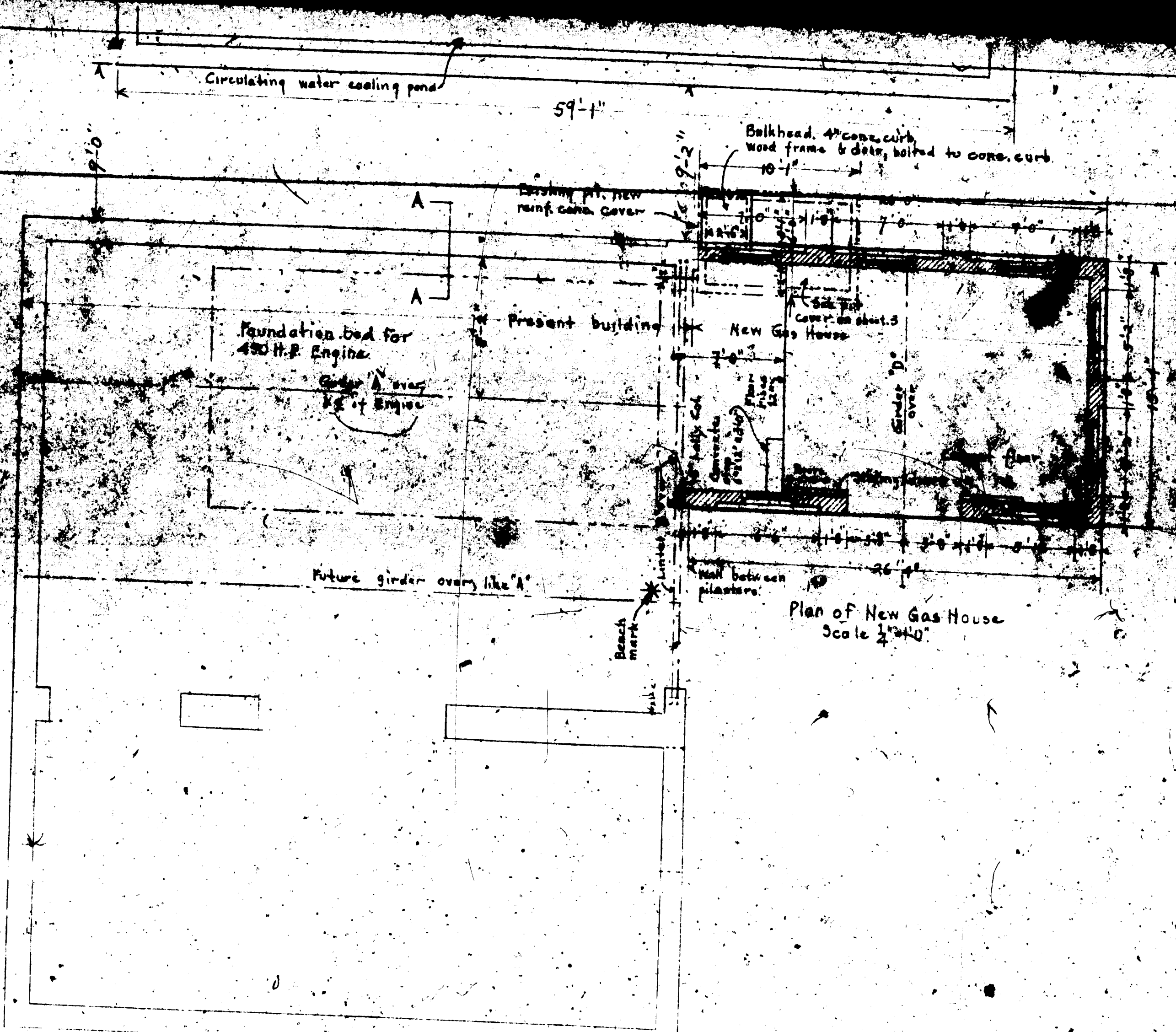

Run in necessary foundation wall of old building to depth of new engine bed.

Section A-A.

See Section of wall of new Gas House, on Section Sheets.

Plan of New Gas House
Scale 1/4" = 1'-0"

THE OFFICE OF
JOHN F. THOMAS, ARCHITECT
PORTLAND, ME

NEW GAS HOUSE & ALTERATIONS
CASCADIA BAY LIGHT & POWER CO.
PEAK ISLAND PORTLAND, ME

FLOOR
PLAN
Scale 1/4" = 1'-0"

