

Maine Cement Products

Thompson's Point



**APPLICATION FOR PERMIT**  
 DEPARTMENT OF BUILDING INSPECTIONS SERVICES  
 ELECTRICAL INSTALLATIONS

Date June 12, 1975, 19\_\_  
 Receipt and Permit number A2901

To the CHIEF ELECTRICAL INSPECTOR, Portland, Maine:  
 The undersigned hereby applies for a permit to make electrical installations in accordance with the laws of Maine, the Portland Electrical Ordinance, the National Electrical Code and the following specifications.

LOCATION OF WORK: Thompsons Point  
 OWNER'S NAME: Maine Cement Products ADDRESS: same

OUTLETS (number of) \_\_\_\_\_ FEES \_\_\_\_\_  
 Lights \_\_\_\_\_  
 Receptacles \_\_\_\_\_  
 Switches \_\_\_\_\_  
 Plugmold \_\_\_\_\_ (number of feet) \_\_\_\_\_  
 TOTAL \_\_\_\_\_

FIXTURES (number of) \_\_\_\_\_  
 Incandescent \_\_\_\_\_  
 Fluorescent \_\_\_\_\_ (Do not include strip fluorescent)  
 TOTAL \_\_\_\_\_  
 Strip Fluorescent, in feet \_\_\_\_\_

SERVICES:  
 Permanent, total amperes 800 \_\_\_\_\_  
 Temporary \_\_\_\_\_ 6.00

METERS: (number of) 1 \_\_\_\_\_ .50

MOTORS: (number of)  
 Fractional \_\_\_\_\_  
 1 HP or over \_\_\_\_\_

RESIDENTIAL HEATING:  
 Oil or Gas (number of units) \_\_\_\_\_  
 Electric (number of rooms) \_\_\_\_\_

COMMERCIAL OR INDUSTRIAL HEATING:  
 Oil or Gas (by a main boiler) \_\_\_\_\_  
 Oil or Gas (by separate units) \_\_\_\_\_  
 Electric (total number of kws) \_\_\_\_\_

APPLIANCES. (number of)  
 Ranges \_\_\_\_\_  
 Cook Tops \_\_\_\_\_  
 Wall Ovens \_\_\_\_\_  
 Dryers \_\_\_\_\_  
 Fans \_\_\_\_\_  
 Water Heaters \_\_\_\_\_  
 Disposals \_\_\_\_\_  
 Dishwashers \_\_\_\_\_  
 Compactors \_\_\_\_\_  
 Others (denote) \_\_\_\_\_  
 TOTAL \_\_\_\_\_

MISCELLANEOUS: (number of)  
 Branch Panels \_\_\_\_\_  
 Transformers \_\_\_\_\_  
 Air Conditioners \_\_\_\_\_  
 Signs \_\_\_\_\_  
 Fire/Burglar Alarms \_\_\_\_\_  
 Circus, Fairs, etc. \_\_\_\_\_  
 Alterations to wires \_\_\_\_\_  
 Repairs after fire \_\_\_\_\_  
 Heavy Duty, 220v outlets \_\_\_\_\_  
 Emergency Lights, battery \_\_\_\_\_  
 Emergency Generator \_\_\_\_\_

FOR ADDITIONAL WORK NOT ON ORIGINAL PERMIT . . . . . INSTALLATION FEE DUE: 6.50  
 FOR REMOVAL OF A "STOP ORDER" (304-16 b) . . . . . DOUBLE FEE DUE: \_\_\_\_\_  
 FOR PERFORMING WORK WITHOUT A PERMIT (304-9) . . . . . \_\_\_\_\_  
 TOTAL AMOUNT DUE: 6.50

INSPECTION:  
 Will be ready on \_\_\_\_\_, 19\_\_; or Will Call

CONTRACTOR'S NAME: I&L Electric  
 ADDRESS: RED 2, GORHAM  
 TEL.: 892-6217

MASTER LICENSE NO.: 3567  
 LIMITED LICENSE NO.: \_\_\_\_\_

SIGNATURE OF CONTRACTOR:  
John H. Tobrueger

INSPECTOR'S COPY

ELECTRICAL INSTALLATIONS—

Permit Number A 2901

Location Thompsons Point

Owner Maine Cement Products

Date of Permit 6-12-75

Final Inspection 7-9-75

By Inspector Libby

Permit Application Register Page No. 17

INSPECTIONS: Service ✓ by Libby  
Service called in 7-9-75  
Closing-in \_\_\_\_\_ by \_\_\_\_\_

PROGRESS INSPECTIONS: 7-8-75 AM / \_\_\_\_\_  
\_\_\_\_\_ / \_\_\_\_\_  
\_\_\_\_\_ / \_\_\_\_\_  
\_\_\_\_\_ / \_\_\_\_\_  
\_\_\_\_\_ / \_\_\_\_\_

DATE:	REMARKS:
7-8-75 AM	Other wires in with entrance wires. Must be changed before hook-up.
	Another permit needed for other work? No.
	Work done by resident electrician.
7-9-75 AM	Not Done
7-9-75 PM	OK called in

**CITY OF PORTLAND, MAINE**  
**Application for Permit to Install Wires**

Permit No. **54308**  
 Issued **9/21** .., 19 **20**

Portland, Maine

To the City Electrician, Portland, Maine:

The undersigned hereby applies for a permit to install wires for the purpose of conducting electric current, in accordance with the laws of Maine, the Electrical Ordinance of the City of Portland, and the following specifications:

(This form must be completely filled out - Minimum Fee \$1.00) -

Owner's Name and Address **MAINE CEMENT Thompson, Portland**  
 Contractor's Name and Address **TURNER ELECT Co. Tel. 7750504**

Location Use of Building **STORAGE**  
 Number of Families Apartments Stores Number of Stories **2**  
 Description of Wiring: New Work Additions Alterations **✓**

**Changed services from single phase to 3 phase**  
 Pipe Cable Metal Molding BX Cable Plug Molding (No. of feet)  
 No. Light Outlets Plugs Light Circuits Plug Circuits

FIXTURES: No. Fluor. or Strip Lighting (No feet)  
 SERVICE: Pipe  Cable Underground  No. of Wires **4** Size **42 CU 400**  
 METERS: Relocated Added Total Meters

MOTORS: Number Phase H. P. Amps Starter  
 HEATING UNITS: Domestic (Oil) No. Motors H.P.  
 Commercial (Oil) No. Motors H.P.  
 Electric Heat (No. of Rooms)

APPLIANCES: No. Ranges Watts Brand Feeds (Size and No.)  
 Elec. Heaters Watts  
 Miscellaneous Watts Extra Cabinets or Panels

Transformers Air Conditioners (No. Units) Signs (No. Units)  
 Will commence **9/17** 19 **20** Ready to cover in 19 **20** Inspection **9/21** 19 **20**

Amount of Fee \$ **4.00**  
 Signed **Jeffrey F. Hurman**

DO NOT WRITE BELOW THIS LINE

SERVICE	METER			GROUND		
VISITS: 1	2	3	4	5	6	
7	8	9	10	11	12	

REMARKS:  
 INSPECTED BY **JW [Signature]**  
 (OVER)

*Maine Cement*

LOCATION *Thompson's Point*  
 INSPECTION DATE *9/21/70*  
 WORK COMPLETED *9/21/70*  
 TOTAL NO INSPECTIONS  
 REMARKS:

**FEES FOR WIRING PERMITS EFFECTIVE JULY 31, 1968**

<b>WIRING</b>	
1 to 30 Outlets	\$ 2.00
31 to 60 Outlets	3.00
Over 60 Outlets, each Outlet	.05
(Each twelve feet or fraction thereof of fluorescent lighting or any type of plug molding will be classed as one outlet)	
<b>SERVICES</b>	
Single Phase	2.50
Three Phase	1.00
<b>MOTORS</b>	
Not exceeding 50 H.P.	3.00
Over 50 H.P.	1.00
<b>HEATING UNITS</b>	
Domestic (Oil)	2.00
Commercial (Oil)	4.00
Electric Heat (Each Room)	.75
<b>APPLIANCES</b>	
Ranges, Cooking Tops, Ovens, Water Heaters, Disposals, Built-in Dishwashers, Dryers, and any permanent built-in appliance — each unit	1.50
<b>MISCELLANEOUS</b>	
Temporary Service, Single Phase	1.00
Temporary Service, Three Phase	2.00
Circuses, Carnivals, Fairs, etc	10.00
Meters, relocate	1.00
Distribution Cabinet or Panel, per unit	1.00
Transformers, per unit	2.00

2.45

I-2 INDUSTRIAL ZONE



### APPLICATION FOR PERMIT

Class of Building or Type of Structure Tank Removal  
September 25, 1968  
Portland, Maine,

RECEIVED FOR  
CITY OF PORTLAND  
SEP 30 1968

To the INSPECTOR OF BUILDINGS, PORTLAND, MAINE

The undersigned hereby applies for a permit to erect alter repair demolish install the following building structure equipment in accordance with the Laws of the State of Maine, the Building Code and Zoning Ordinance of the City of Portland, plans and specifications, if any, submitted herewith and the following specifications:

Location Thompson's Point Within Fire Limits? \_\_\_\_\_ Dist. No. \_\_\_\_\_  
Owner's name and address Maine Cement Products, Inc. Thompson's Point Telephone \_\_\_\_\_  
Lessee's name and address \_\_\_\_\_ Telephone \_\_\_\_\_  
Contractor's name and address Portland Pump Company, 321 Lincoln St. Portland Telephone 772-6336  
Architect \_\_\_\_\_ Specifications \_\_\_\_\_ Plans no No. of sheets \_\_\_\_\_  
Proposed use of building \_\_\_\_\_ No. families \_\_\_\_\_  
Last use \_\_\_\_\_ No. families \_\_\_\_\_  
Material \_\_\_\_\_ No. stories \_\_\_\_\_ Heat \_\_\_\_\_ Style of roof \_\_\_\_\_ Roofing \_\_\_\_\_  
Other buildings on same lot \_\_\_\_\_  
Estimated cost \$ \_\_\_\_\_ Fee \$ 2.00

#### General Description of New Work

To remove (1)-1000 gallon gasoline storage tank, outside underground.  
(discontinued)

9/25/68  
Sent to Fire Dept. 9/30/68  
Rec'd from Fire Dept. 9/30/68

It is understood that this permit does not include installation of heating apparatus which is to be taken out separately by and in the name of the heating contractor. **PERMIT TO BE ISSUED TO** contractor

#### Details of New Work

Is any plumbing involved in this work? \_\_\_\_\_ Is any electrical work involved in this work? \_\_\_\_\_  
Is connection to be made to public sewer? \_\_\_\_\_ If not, what is proposed for sewage? \_\_\_\_\_  
Has septic tank notice been sent? \_\_\_\_\_ Form notice sent? \_\_\_\_\_  
Height average grade to top of plate \_\_\_\_\_ Height average grade to highest point of roof \_\_\_\_\_  
Size, front \_\_\_\_\_ depth \_\_\_\_\_ No. stories \_\_\_\_\_ solid or filled land? \_\_\_\_\_ earth or rock? \_\_\_\_\_  
Material of foundation \_\_\_\_\_ Thickness, top \_\_\_\_\_ bottom \_\_\_\_\_ cellar \_\_\_\_\_  
Kind of roof \_\_\_\_\_ Rise per foot \_\_\_\_\_ Roof covering \_\_\_\_\_  
No. of chimneys \_\_\_\_\_ Material of chimneys \_\_\_\_\_ of lining \_\_\_\_\_ Kind of heat \_\_\_\_\_ fuel \_\_\_\_\_  
Framing Lumber—Kind \_\_\_\_\_ ; Dressed or full size? \_\_\_\_\_ Corner posts \_\_\_\_\_ Sills \_\_\_\_\_  
Size Girder \_\_\_\_\_ Columns under girders \_\_\_\_\_ Size \_\_\_\_\_ Max. on centers \_\_\_\_\_  
Studs (outside walls and carrying partitions) 2x4-16" O. C. Bridging in every floor and flat roof span over 8 feet.  
Joists and rafters: 1st floor \_\_\_\_\_, 2nd \_\_\_\_\_, 3rd \_\_\_\_\_, roof \_\_\_\_\_  
On centers: 1st floor \_\_\_\_\_, 2nd \_\_\_\_\_, 3rd \_\_\_\_\_, roof \_\_\_\_\_  
Maximum span: 1st floor \_\_\_\_\_, 2nd \_\_\_\_\_, 3rd \_\_\_\_\_, roof \_\_\_\_\_  
If one story building with masonry walls, thickness of walls? \_\_\_\_\_ height? \_\_\_\_\_

#### If a Garage

No. cars now accommodated on same lot \_\_\_\_\_ to be accommodated \_\_\_\_\_ number commercial cars to be accommodated \_\_\_\_\_  
Will automobile repairing be done other than minor repairs to cars habitually stored in the proposed building? \_\_\_\_\_

APPROVED:  
9/27/68 J.P. Demeris  
9/30/68 [Signature]

#### Miscellaneous

Will work require disturbing of any tree on a public street? no  
Will there be in charge of the above work a person competent to see that the State and City requirements pertaining thereto are observed? yes  
Portland Pump Company

CS 301

INSPECTION COPY

Signature of owner by: [Signature]

[Handwritten initials]

Permit No. 68/1014

Location *Wagoner's Farm*

Owner *Wagoner's Products Inc*

Date of permit 9/30/68

Notif. closing-in

Inspn. closing-in

Final Notif.

Final Inspn.

Cert. of Occupancy issued

Sealing Out Notice

Form Check Notice

NOTES

A series of horizontal lines for notes, with a large handwritten 'X' drawn across the first few lines.



APPLICATION FOR PERMIT

Class of Building or Type of Structure Second Class

Portland, Maine, February 25, 1966

PERMIT ISSUED

00122  
MAR 3 1966

CITY of PORTLAND

To the INSPECTOR OF BUILDINGS, PORTLAND, MAINE

The undersigned hereby applies for a permit to erect alter repair demolish install the following building structure equipment in accordance with the Laws of the State of Maine, the Building Code and Zoning Ordinance of the City of Portland, plans and specifications, if any, submitted herewith and the following specifications:

Location Thompson's Point (end of Sewall St.) Within Fire Limits? \_\_\_\_\_ Dist. No. \_\_\_\_\_  
Owner's name and address Mecaw Industries, Thompson's Point Telephone \_\_\_\_\_  
Lessee's name and address Maine Cement Products, Precast Bldg., Thompson's Pt. Telephone \_\_\_\_\_  
Contractor's name and address \_\_\_\_\_ " " \_\_\_\_\_ " " Telephone 775-2351  
Architect \_\_\_\_\_ Specifications \_\_\_\_\_ Plans YES No. of sheets 1  
Proposed use of building Precast Concrete blk. Bldg. No. families \_\_\_\_\_  
Last use \_\_\_\_\_ " " \_\_\_\_\_ No. families \_\_\_\_\_  
Material 2nd ci. No. stories 1 Heat \_\_\_\_\_ Style of roof \_\_\_\_\_ Roofing \_\_\_\_\_  
Other buildings on same lot \_\_\_\_\_  
Estimated cost \$ 3000.00 Fee \$ 7.00

General Description of New Work

To construct 17' x 25'1 concrete block addition on side of building as per plan.  
wide long

It is understood that this permit does not include installation of heating apparatus which is to be taken out separately by and in the name of the heating contractor. PERMIT TO BE ISSUED TO Cement Products  
Maine

Details of New Work

Is any plumbing involved in this work? \_\_\_\_\_ Is any electrical work involved in this work? \_\_\_\_\_  
Is connection to be made to public sewer? \_\_\_\_\_ If not, what is proposed for sewage? \_\_\_\_\_  
Has septic tank notice been sent? \_\_\_\_\_ Form notice sent? \_\_\_\_\_  
Height average grade to top of plate \_\_\_\_\_ Height average grade to highest point of roof \_\_\_\_\_  
Size, front \_\_\_\_\_ depth \_\_\_\_\_ No. stories \_\_\_\_\_ solid or filled land? \_\_\_\_\_ earth or rock? \_\_\_\_\_  
Material of foundation concrete at least 4" below grade Thickness, top \_\_\_\_\_ bottom \_\_\_\_\_ cellar \_\_\_\_\_  
Kind of roof \_\_\_\_\_ Rise per foot \_\_\_\_\_ Roof covering \_\_\_\_\_  
No. of chimneys \_\_\_\_\_ Material of chimneys \_\_\_\_\_ of lining \_\_\_\_\_ Kind of heat \_\_\_\_\_ fuel \_\_\_\_\_  
Framing Lumber—Kind \_\_\_\_\_ Dressed or full size? \_\_\_\_\_ Corner posts \_\_\_\_\_ Sills \_\_\_\_\_  
Size Girder \_\_\_\_\_ Columns under girders \_\_\_\_\_ Size \_\_\_\_\_ Max. on centers \_\_\_\_\_  
Studs (outside walls and carrying partitions) 2x4-16" C. C. Bridging in every floor and flat roof space over 8 feet.  
Joists and rafters: 1st floor \_\_\_\_\_, 2nd \_\_\_\_\_, 3rd \_\_\_\_\_, roof \_\_\_\_\_  
On centers: 1st floor \_\_\_\_\_, 2nd \_\_\_\_\_, 3rd \_\_\_\_\_, roof \_\_\_\_\_  
Maximum span: 1st floor \_\_\_\_\_, 2nd \_\_\_\_\_, 3rd \_\_\_\_\_, roof \_\_\_\_\_  
If one story building with masonry walls, thickness of walls? \_\_\_\_\_ height? \_\_\_\_\_

If a Garage

No. cars now accommodated on same lot \_\_\_\_\_, to be accommodated \_\_\_\_\_ number commercial cars to be accommodated \_\_\_\_\_  
Will automobile repairing be done other than minor repairs to cars habitually stored in the proposed building? \_\_\_\_\_

APPROVED:

J. E. M.

Miscellaneous

Will work require disturbing of any tree on a public street? no  
Will there be in charge of the above work a person competent to see that the State and City requirements pertaining thereto are observed? yes

Maine Cement Products Co.

CS 301

INSPECTION COPY

Signature of owner MAINE CEMENT PRODUCTS CO.

David B. Jones



NOTES

3-8-66 Footings OK  
 to pour- *JK*

3-9-66 Blocks starting *JK*

3-18-66 Walls up  
 steel in OK *JK*

3-31-66 Completed *JK*

X

Permit No. 66/122  
 Location *Langston's Ford (Langston Rd)*  
 Owner *Walter Grant Padgett Co.*  
 Date of permit 3/3/66  
 Notif. closing-in  
 Inspn. closing-in  
 Final Notif.  
 Final Inspn.  
 Cert. of Occupancy issued  
 Sinking Out Notice  
 Form Check Notice

AP - Thompson's Point

December 22, 1961

Maine Cement Products Co.  
Thompson's Point

Gentlemen:

Permit to enlarge existing door into side of concrete precast block building from 12'4" x 7'6" to 12'6" x 11'10" and to decrease the size of the door in the end of the building from approximately 25' in width to 12'6" in width is being issued with the understanding that the exterior walls used to decrease the door in the end of the building ~~is~~ to be of 12" concrete block instead of wood framing as shown on the plan.

Very truly yours,

Gerald E. Kayberry  
Deputy Director of  
Building Inspection

GEK/h



1-2 INDUSTRIAL ZONE

# APPLICATION FOR PERMIT

Class of Building or Type of Structure \_\_\_\_\_

Portland, Maine, November 23, 1961

01649  
DEC 22  
CITY OF PORTLAND

To the INSPECTOR OF BUILDINGS, PORTLAND, MAINE

The undersigned hereby applies for a permit to erect alter repair demolish install the following building structure equipment in accordance with the Laws of the State of Maine, the Building Code and Zoning Ordinance of the City of Portland, plans and specifications, if any, submitted herewith and the following specifications:

Location Thompson's Point Within Fire Limits? \_\_\_\_\_ Dist. No. \_\_\_\_\_  
 Owner's name and address Maine Cement Products Co., Thompson's Point Telephone \_\_\_\_\_  
 Lessee's name and address \_\_\_\_\_ Telephone \_\_\_\_\_  
 Contractor's name and address not lat Telephone \_\_\_\_\_  
 Architect \_\_\_\_\_ Specifications \_\_\_\_\_ Plans yes No. of sheets 2  
 Proposed use of building Precast cement products No. families \_\_\_\_\_  
 Last use \_\_\_\_\_ " \_\_\_\_\_ No. families \_\_\_\_\_  
 Material, con. bl. No. stories 1 Heat \_\_\_\_\_ Style of roof flat Roofing \_\_\_\_\_  
 Other buildings on same lot \_\_\_\_\_  
 Estimated cost \$ 2000. Fee \$ 6.00

### General Description of New Work

~~To-out-in-new-opening-~~  
 To enlarge existing door opening as per plan

Permit issued with Memo

It is understood that this permit does not include installation of heating apparatus which is to be taken out separately by and in the name of the heating contractor. **PERMIT TO BE ISSUED TO OWNERS**

### Details of New Work

Is any plumbing involved in this work? \_\_\_\_\_ Is any electrical work involved in this work? \_\_\_\_\_  
 Is connection to be made to public sewer? \_\_\_\_\_ If not, what is proposed for sewage? \_\_\_\_\_  
 Has septic tank notice been sent? \_\_\_\_\_ Form notice sent? \_\_\_\_\_  
 Height average grade to top of plate \_\_\_\_\_ Height average grade to highest point of roof \_\_\_\_\_  
 Size, front \_\_\_\_\_ depth \_\_\_\_\_ No. stories \_\_\_\_\_ solid or filled land? \_\_\_\_\_ earth or rock? \_\_\_\_\_  
 Material of foundation \_\_\_\_\_ Thickness, top \_\_\_\_\_ bottom \_\_\_\_\_ cellar \_\_\_\_\_  
 Kind of roof \_\_\_\_\_ Rise per foot \_\_\_\_\_ Roof covering \_\_\_\_\_  
 No. of chimneys \_\_\_\_\_ Material of chimneys \_\_\_\_\_ of lining \_\_\_\_\_ Kind of heat \_\_\_\_\_ fuel \_\_\_\_\_  
 Framing Lumber—Kind \_\_\_\_\_ Dressed or full size? \_\_\_\_\_ Corner posts \_\_\_\_\_ Sills \_\_\_\_\_  
 Size Girder \_\_\_\_\_ Columns under girders \_\_\_\_\_ Size \_\_\_\_\_ Max. on centers \_\_\_\_\_  
 Studs (outside walls and carrying partitions) 2x4-16" O. C. Bridging in every floor and flat roof span over 8 feet.  
 Joists and rafters: 1st floor \_\_\_\_\_, 2nd \_\_\_\_\_, 3rd \_\_\_\_\_, roof \_\_\_\_\_  
 On centers: 1st floor \_\_\_\_\_, 2nd \_\_\_\_\_, 3rd \_\_\_\_\_, roof \_\_\_\_\_  
 Maximum span: 1st floor \_\_\_\_\_, 2nd \_\_\_\_\_, 3rd \_\_\_\_\_, roof \_\_\_\_\_  
 If one story building with masonry walls, thickness of walls? \_\_\_\_\_ height? \_\_\_\_\_

### If a Garage

No. cars now accommodated on same lot \_\_\_\_\_, to be accommodated \_\_\_\_\_ number commercial cars to be accommodated \_\_\_\_\_  
 Will automobile repairing be done other than minor repairs to cars habitually stored in the proposed building? \_\_\_\_\_

APPROVED:  
*J. E. M. W. memo*

### Miscellaneous

Will work require disturbing of any tree on a public street? no  
 Will there be in charge of the above work a person competent to see that the State and City requirements pertaining thereto are observed? yes

Maine Cement Products

*Maine Cement Products Co*  
*H. Brown*

CS 301

INSPECTION COPY

Signature of owner By: \_\_\_\_\_

P.A.





APPLICATION FOR AMENDMENT TO PERMIT

Amendment No. Amend. #1

Portland, Maine, June 26, 1964

PERMIT ISSUED

JUN 26 1964

CITY OF PORTLAND

To the INSPECTOR OF BUILDINGS, PORTLAND, MAINE

The undersigned hereby applies for amendment to Permit No. 64/498 pertaining to the building or structure comprised the original application in accordance with the Laws of the State of Maine, the Building Code and Zoning Ordinance of the City of Portland, plans and specifications, if any, submitted herewith, and the following specifications:

Location .. Thompson's Point..... Within Fire Limits? .. Dist. No. ....
Owner's name and address .. Maine Cement Products, Thompson's Point... Telephone .....
Licensee's name and address .. Telephone ....
Contractor's name and address .. Maynard & Aurel Gagne, 141 State St. .... Telephone . ....
Architect .. Plans filed ... Yes No. of sheets . 1
Proposed use of building .. Mfg. cement blocks..... No. families . ....
Past use .. No. families ..
Increased cost of work . 500.. Additional fee .. 1,00.

Description of Proposed Work

To enlarge door opening to 26' wide as per plan

Details of New Work Maine Cement Products

Is any plumbing involved in this work? .. Is any electrical work involved in this work? ..
Height average grade to top of plate .. Height average grade to highest point of roof ..
Size, front .. depth .. No. stories .. solid or tiled land? .. earth or rock? ..
Material of foundation .. Thickness, top .. bottom .. cellar ..
Material of underpinning .. Height .. Thickness ..
Kind of roof .. Rise per foot .. Roof covering ..
No. of chimneys .. Material of chimneys .. of lining ..
Framing lumber—Kind .. Dressed or full size? ..
Corner posts .. Sills .. Girt or ledger board? .. Size ..
Girders .. Size .. Columns under girders .. Size .. Max. on centers ..
Studs (outside walls and carrying partitions) 2x4-16" O. C. Bridging in every floor and flat roof span over 8 feet.
Joists and rafters: 1st floor .. 2nd .. 3rd .. roof ..
On centers: 1st floor .. 2nd .. 3rd .. roof ..
Maximum span: 1st floor.. 2nd .. 3rd .. roof ..

Approved:

Maine Cement Products

Signature of Owner By: [Handwritten Signature]

[Handwritten Signature]

Approved: .. Inspector of Buildings

A.P. - Thompson's Point  
(End of Sewall St. )

May 12, 1964

Mr. Rudolph L. Violette, Vice President  
Hecaw Industries  
Thompson's Point

Dear Mr. Violette:

Building permit to make alterations to the interior of the Maine Cement Products Company manufacturing plant is being issued subject to compliance with the following:

It is understood that the 12-inch WF 50 pound steel lintel supporting 6 feet of 12-inch concrete block wall and roof load over the present cubing area will be fireproofed as per Underwriters' Design, Number 29 with a minimum of 1 1/2-inches of gypsum plaster over 24 gauge metal lath to provide an approved fire-resistance rating of 4 hours in compliance with Section 303-d-2 of the Building Code.

It is understood that there will be at least 16 inches of brickwork under the bearing plates of the 12 WF 50 beam mentioned above and that the cut half blocks will be removed and replaced with solid half block.

Very truly yours,

Gerald E. Mayberry  
Deputy Building Inspector

GEN:m

I-2 INDUSTRIAL ZONE

APPLICATION FOR PERMIT



Class of Building or Type of Structure \_\_\_\_\_

Portland, Maine, May 1, 1964

PERMIT ISSUED

MAY 12 1964

CITY of PORTLAND

To the INSPECTOR OF BUILDINGS, PORTLAND, MAINE

The undersigned hereby applies for a permit to erect alter repair demolish install the following building structure equipment in accordance with the Laws of the State of Maine, the Building Code and Zoning Ordinance of the City of Portland, plans and specifications, if any, submitted herewith and the following specifications:

Location Thompson's Point Within Fire Limits? \_\_\_\_\_ Dist. No. \_\_\_\_\_
Owner's name and address Maine Cement Products Co., Thompson's Point Telephone \_\_\_\_\_
Lessee's name and address \_\_\_\_\_ Telephone \_\_\_\_\_
Contractor's name and address not let Telephone \_\_\_\_\_
Architect \_\_\_\_\_ Specifications \_\_\_\_\_ Plans yes \_\_\_\_\_ No. of sheets 1
Proposed use of building Mfg. cement blocks No. families \_\_\_\_\_
Last use " " No. families \_\_\_\_\_
Material conl No. stories 1-2 Heat \_\_\_\_\_ Style of roof \_\_\_\_\_ Roofing \_\_\_\_\_
Other buildings on same lot \_\_\_\_\_
Estimated cost \$ 4,000. Fee \$ 8.00

General Description of New Work

To make alterations to interior of building as per plan

Permit Issued with Letter

It is understood that this permit does not include installation of heating apparatus which is to be taken out separately by and in the name of the heating contractor. PERMIT TO BE ISSUED TO Maine Cement Products

Details of New Work

Is any plumbing involved in this work? \_\_\_\_\_ Is any electrical work involved in this work? \_\_\_\_\_
Is connection to be made to public sewer? \_\_\_\_\_ If not, what is proposed for sewage? \_\_\_\_\_
Has septic tank notice been sent? \_\_\_\_\_ Form notice sent? \_\_\_\_\_
Height average grade to top of plate \_\_\_\_\_ Height average grade to highest point of roof \_\_\_\_\_
Size, front \_\_\_\_\_ depth \_\_\_\_\_ No. stories \_\_\_\_\_ solid or filled land? \_\_\_\_\_ earth or rock? \_\_\_\_\_
Material of foundation \_\_\_\_\_ Thickness, top \_\_\_\_\_ bottom \_\_\_\_\_ cellar \_\_\_\_\_
Kind of roof \_\_\_\_\_ Rise per foot \_\_\_\_\_ Roof covering \_\_\_\_\_
No. of chimneys \_\_\_\_\_ Material of chimneys \_\_\_\_\_ of lining \_\_\_\_\_ Kind of heat \_\_\_\_\_ fuel \_\_\_\_\_
Framing Lumber-Kind \_\_\_\_\_ Dressed or full size? \_\_\_\_\_ Corner posts \_\_\_\_\_ Sills \_\_\_\_\_
Size Girder \_\_\_\_\_ Columns under girders \_\_\_\_\_ Size \_\_\_\_\_ Max. on centers \_\_\_\_\_
Studs (outside walls and carrying partitions) 2x4-16" O. C. Bridging in every floor and flat roof span over 8 feet.
Joists and rafters: 1st floor \_\_\_\_\_, 2nd \_\_\_\_\_, 3rd \_\_\_\_\_, roof \_\_\_\_\_
On centers: 1st floor \_\_\_\_\_, 2nd \_\_\_\_\_, 3rd \_\_\_\_\_, roof \_\_\_\_\_
Maximum span: 1st floor \_\_\_\_\_, 2nd \_\_\_\_\_, 3rd \_\_\_\_\_, roof \_\_\_\_\_
If one story building with masonry walls, thickness of walls? \_\_\_\_\_ height? \_\_\_\_\_

If a Garage

No. cars now accommodated on same lot \_\_\_\_\_, to be accommodated \_\_\_\_\_ number commercial cars to be accommodated \_\_\_\_\_
Will automobile repairing be done other than minor repairs to cars habitually stored in the proposed building? \_\_\_\_\_

APPROVED:

M. E. W. w/letter

Miscellaneous

Will work require disturbing of any tree on a public street? no
Will there be in charge of the above work a person competent to see that the State and City requirements pertaining thereto are observed? yes

Maine Cement Products

CS 301

INSPECTION COPY

Signature of owner By:

NOTES

5-24-64 Steel beam  
in & fire stopped OK *HW*

6-10-64 Completed *HW*

6-26-64 Soc Amend.  
8-18-64 Steel beam  
in place *HW*

*X*

Permit No. 641/498 B-31

Location *Maplewood Point*

Owner *Marine Cement Products*

Date of permit *5/12/64*

Notif. closing-in

Inspn. closing-in

Final Notif.

Final Inspn.

Cert. of Occupancy issued

Staking Out Notice

Form Check Notice





# APPLICATION FOR PERMIT

1-2 INDUSTRIAL ZONE

Class of Building or Type of Structure \_\_\_\_\_

Portland, Maine, November 1, 1962

PERMIT ISSUED  
01465

NOV 2 1962

CITY of PORTLAND

To the INSPECTOR OF BUILDINGS, PORTLAND, MAINE

The undersigned hereby applies for a permit to erect alter repair demolish install the following building structure equipment in accordance with the Laws of the State of Maine, the Building Code and Zoning Ordinance of the City of Portland, plans and specifications, if any, submitted herewith and the following specifications:

Location Thompson's Point Within Fire Limits? \_\_\_\_\_ Dist. No. \_\_\_\_\_  
 Owner's name and address Maine Cement Products, Thompson's Point Telephone \_\_\_\_\_  
 Lessee's name and address \_\_\_\_\_ Telephone \_\_\_\_\_  
 Contractor's name and address owners Telephone \_\_\_\_\_  
 Architect \_\_\_\_\_ Specifications \_\_\_\_\_ Plans yes No. of sheets 1  
 Proposed use of building \_\_\_\_\_ Storage No. families \_\_\_\_\_  
 Last use \_\_\_\_\_ " \_\_\_\_\_ No. families \_\_\_\_\_  
 Material \_\_\_\_\_ No. stories \_\_\_\_\_ Heat \_\_\_\_\_ Style of roof \_\_\_\_\_ Roofing \_\_\_\_\_  
 Other buildings on same lot \_\_\_\_\_  
 Estimated cost \$ 4,000 Fee \$ 8.00

## General Description of New Work

To sheath gable ends with metal as per plan

It is understood that this permit does not include installation of heating apparatus which is to be taken out separately by and in the name of the heating contractor. PERMIT TO BE ISSUED TO owners

## Details of New Work

Is any plumbing involved in this work? \_\_\_\_\_ Is any electrical work involved in this work? \_\_\_\_\_  
 Is connection to be made to public sewer? \_\_\_\_\_ If not, what is proposed for sewage? \_\_\_\_\_  
 Has septic tank notice been sent? \_\_\_\_\_ Form notice sent? \_\_\_\_\_  
 Height average grade to top of plate \_\_\_\_\_ Height average grade to highest point of roof \_\_\_\_\_  
 Size, front \_\_\_\_\_ depth \_\_\_\_\_ No. stories \_\_\_\_\_ solid or filled land? \_\_\_\_\_ earth or rock? \_\_\_\_\_  
 Material of foundation \_\_\_\_\_ Thickness, top \_\_\_\_\_ bottom \_\_\_\_\_ cellar \_\_\_\_\_  
 Kind of roof \_\_\_\_\_ Rise per foot \_\_\_\_\_ Roof covering \_\_\_\_\_  
 No. of chimneys \_\_\_\_\_ Material of chimneys \_\_\_\_\_ of lining \_\_\_\_\_ Kind of heat \_\_\_\_\_ fuel \_\_\_\_\_  
 Framing Lumber--Kind \_\_\_\_\_ Dressed or full size? \_\_\_\_\_ Corner posts \_\_\_\_\_ Sills \_\_\_\_\_  
 Size Girder \_\_\_\_\_ Columns under girders \_\_\_\_\_ Size \_\_\_\_\_ Max. on centers \_\_\_\_\_  
 Studs (outside walls and carrying partitions) 2x4-16" O. C. Bridging in every floor and flat roof span over 8 feet.  
 Joists and rafters: 1st floor \_\_\_\_\_, 2nd \_\_\_\_\_, 3rd \_\_\_\_\_, roof \_\_\_\_\_  
 On centers: 1st floor \_\_\_\_\_, 2nd \_\_\_\_\_, 3rd \_\_\_\_\_, roof \_\_\_\_\_  
 Maximum span: 1st floor \_\_\_\_\_, 2nd \_\_\_\_\_, 3rd \_\_\_\_\_, roof \_\_\_\_\_  
 If one story building with masonry walls, thickness of walls? \_\_\_\_\_ height? \_\_\_\_\_

## If a Garage

No. cars now accommodated on same lot \_\_\_\_\_, to be accommodated \_\_\_\_\_ number commercial cars to be accommodated \_\_\_\_\_  
 Will automobile repairing be done other than minor repairs to cars habitually stored in the proposed building? \_\_\_\_\_

APPROVED:

*C.N. - 11/2/62 - agj*

## Miscellaneous

Will work require disturbing of any tree on a public street? no  
 Will there be in charge of the above work a person competent to see that the State and City requirements pertaining thereto are observed? yes - Maine Cement Products

CS 321

INSPECTION COPY

Signature of owner

By:

*Rudolph L. Violette*

*P.H.*





# APPLICATION FOR AMENDMENT TO PERMIT

Amendment No. #1  
October 24, 1961  
Portland, Maine.

PERMIT ISSUED

OCT 24 1961

CITY of PORTLAND

To the INSPECTOR OF BUILDINGS, PORTLAND, MAINE

The undersigned hereby applies for amendment to Permit No. 61/1176 pertaining to the building or structure comprised in the original application in accordance with the Laws of the State of Maine, the Building Code and Zoning Ordinance of the City of Portland, plans and specifications, if any, submitted hereunder, and the following specifications:

Location: Thompson's Point Within Fire Limits? Dist. No.  
Owner's name and address: Maine Cement Products Co., Inc. Thompson's Point Telephone  
Lessee's name and address Telephone  
Contractor's name and address Telephone 2-5485  
Architect Plans filed Yes No. of sheets  
Proposed use of building: Open Storage Shed for Cement Blocks No. families  
Last use No. families  
Increased cost of work 7024.00 Additional fee .50

### Description of Proposed Work

To substitute 20 gage steel sheets for wood roof decking, 5/8 inch steel rods welded to panel points on top chord to be added as wind bracing at end bays.

### Details of New Work permit to owners.

Is any plumbing involved in this work? Is any electrical work involved in this work?  
Height average grade to top of plate Height average grade to highest point of roof  
Size, front depth No. stories solid or filled land? earth or rock?  
Material of foundation Thickness, top bottom cellar  
Material of underpinning Height Thickness  
Kind of roof Rise per foot Roof covering of trim  
No. of chimneys Material of chimneys of trim  
Framing lumber—Kind Girt or ledger load? Size  
Corner posts Sills Column under girders Size Max. on centers  
Girders Size Column under girders Size Max. on centers  
Studs (outside walls and carrying partitions) 2x4-10" O. C. Bridging in every floor and flat roof span over 8 feet.  
Joists and rafters: 1st floor, 2nd, 3rd, roof  
On centers: 1st floor, 2nd, 3rd, roof  
Maximum span: 1st floor, 2nd, 3rd, roof

Approved: M. E. M.

Maine Cement Products Co., Inc.  
Signature of Owner by: Rudy Violette

Approved: Albert J. Searo  
Inspector of Buildings

Sept. 13, 1961

Mr. William P. Flynn, Inc.  
Consulting Engineer, Poland, Maine  
Mr. Rudolph L. Violette, Vice Pres.  
Nesco Industries  
Thompson's Point, Portland, Maine

Gentlemen:

Permit to erect a 1-story (open shed) steel frame structure 95'x153' as per plans received Sept. 12, 1961 is being issued subject to compliance with the following:

1. In a discussion with Mr. Violette we understand that he plans to use 2-inch nominal size wooden planking for roof deck.
2. The roof covering will need to be a Class C material as approved by a recognized testing authority.

5 cc  
A wood  
steel roof

Very truly yours,

Gerald E. Kayberry  
Deputy Inspector of Buildings

GEM:m

P. S.

Permit is issued on the basis that this is to be and is to be kept an open structure without enclosing walls of any kind. Otherwise the area would be excessive.



1-2 INDUSTRIAL ZONE

# APPLICATION FOR PERMIT

Class of Building or Type of Structure \_\_\_\_\_

Portland, Maine, \_\_\_\_\_

Sept. 12, 1961

PERMIT ISSUED  
SEP 15 1961  
CITY OF PORTLAND

To the INSPECTOR OF BUILDINGS, PORTLAND, MAINE

The undersigned hereby applies for a permit to erect alter repair demolish install the following building structure equipment in accordance with the Laws of the State of Maine, the Building Code and Zoning Ordinance of the City of Portland, plans and specifications, if any, submitted herewith and the following specifications:

Location Thompson's Point Within Fire Limits? \_\_\_\_\_ Dist. No. \_\_\_\_\_

Owner's name and address Maine Cement Products Co. Inc. Thompson's Point Telephone \_\_\_\_\_

Lessee's name and address \_\_\_\_\_ Telephone \_\_\_\_\_

Contractor's name and address not let Telephone \_\_\_\_\_

Architect \_\_\_\_\_ Specifications \_\_\_\_\_ Plans yes No. of sheets 4

Proposed use of building Open Storage Shed for Cement Blocks No. families \_\_\_\_\_

Last use Open Shed No. families \_\_\_\_\_

Material \_\_\_\_\_ No. stories 1 Heat \_\_\_\_\_ Style of roof \_\_\_\_\_ Roofing \_\_\_\_\_

Other buildings on same lot several bldgs. on plans.

Estimated cost \$ 10,000 Fee \$ 20.00

### General Description of New Work

To erect 1-story (open shed) steel and frame structure as per plans. 96' x 152'.

*Since there are to be no enclosing walls, there are no area restrictions in the Building Code to apply.*

$$\begin{array}{r}
 152 \\
 96 \\
 \hline
 248 \\
 96 \\
 \hline
 344 \\
 136 \\
 \hline
 480
 \end{array}$$

It is understood that this permit does not include installation of heating apparatus which is to be taken out separately by and in the name of the heating contractor. **PERMIT TO BE ISSUED TO** OWNER

### Details of New Work

Is any plumbing involved in this work? \_\_\_\_\_ Is any electrical work involved in this work? \_\_\_\_\_

Is connection to be made to public sewer? \_\_\_\_\_ If not, what is proposed for sewage? \_\_\_\_\_

Has septic tank notice been sent? \_\_\_\_\_ Form notice sent? yes

Height average grade to top of plate \_\_\_\_\_ Height average grade to highest point of roof \_\_\_\_\_

Size, front \_\_\_\_\_ depth \_\_\_\_\_ No. stories \_\_\_\_\_ solid or filled land? \_\_\_\_\_ earth or rock? \_\_\_\_\_

Material of foundation \_\_\_\_\_ Thickness, top \_\_\_\_\_ bottom \_\_\_\_\_ cellar \_\_\_\_\_

Kind of roof \_\_\_\_\_ Rise per foot \_\_\_\_\_ Roof covering \_\_\_\_\_

No. of chimneys \_\_\_\_\_ Material of chimneys \_\_\_\_\_ of lining \_\_\_\_\_ Kind of heat \_\_\_\_\_ fuel \_\_\_\_\_

Framing Lumber—Kind \_\_\_\_\_ Dressed or full size? \_\_\_\_\_ Corner posts \_\_\_\_\_ Sills \_\_\_\_\_

Size Girder \_\_\_\_\_ Columns under girders \_\_\_\_\_ Size \_\_\_\_\_ Max. on centers \_\_\_\_\_

Studs (outside walls and carrying partitions) 2x4-16" O. C. Bridging in every floor and flat roof span over 8 feet.

Joists and rafters: 1st floor \_\_\_\_\_, 2nd \_\_\_\_\_, 3rd \_\_\_\_\_, roof \_\_\_\_\_

On centers: 1st floor \_\_\_\_\_, 2nd \_\_\_\_\_, 3rd \_\_\_\_\_, roof \_\_\_\_\_

Maximum span: 1st floor \_\_\_\_\_, 2nd \_\_\_\_\_, 3rd \_\_\_\_\_, roof \_\_\_\_\_

If one story building with masonry walls, thickness of walls? \_\_\_\_\_ height? \_\_\_\_\_

### If a Garage

No. cars now accommodated on same lot \_\_\_\_\_, to be accommodated \_\_\_\_\_ number commercial cars to be accommodated \_\_\_\_\_

Will automobile repairing be done other than minor repairs to cars habitually stored in the proposed building? \_\_\_\_\_

APPROVED:

J. E. Pa. w/ letter

### Miscellaneous

Will work require disturbing of any tree on a public street? no

Will there be in charge of the above work a person competent to see that the State and City requirements pertaining thereto are observed? yes

Maine Cement Products Co. Inc.

CS 301

INSPECTION COPY

Signature of owner by:

William J. Felt

*F.M.*

NOTES

10-17-61 looked over  
 base plates of use  
 no lms moved in  
 from their station  
 from sheet. Some  
 rust & scale but  
 should be adequate  
 with serrate washers  
 or strapping bolts and  
 two bolts. Footings  
 all poured. Ready  
 to erect steel. *CP*

12-1-61 Steel frame  
 & roof purlins ready  
 for a roof roofing *CP*

1-25-62 Completed *CP*

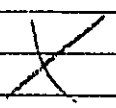

Permit No. 61/1196  
 Location *Hampton Field*  
 Owner *Marine General Products Co. Inc.*  
 Date of permit 9/15/61  
 Notif. closing-in  
 Inspn. closing-in  
 Final Notif.  
 Final Inspn.  
 Cert. of Occupancy issued  
 Staking Out Notice  
 Form Check Notice

9-26-61  
 10-19-60-20



APPLICATION FOR PERMIT

Class of Building or Type of Structure \_\_\_\_\_ Installation \_\_\_\_\_

Portland, Maine, April 14, 1961

PERMIT ISSUED

00354

APR 18 1961

CITY OF PORTLAND

To the INSPECTOR OF BUILDINGS, PORTLAND, MAINE

The undersigned hereby applies for a permit to erect alter repair demolish install the following building structure equipment in accordance with the Laws of the State of Maine, the Building Code and Zoning Ordinance of the City of Portland, plans and specifications, if any, submitted herewith and the following specifications:

Location Thompson's Point Within Fire Limits? \_\_\_\_\_ Dist. No. \_\_\_\_\_
Owner's name and address Maine Cement Products, Thompson's Point Telephone \_\_\_\_\_
Lessee's name and address \_\_\_\_\_ Telephone \_\_\_\_\_
Contractor's name and address Portland Pump Co., 321 Lincoln St., So. Port. Telephone 2-6336
Architect \_\_\_\_\_ Specifications \_\_\_\_\_ Plans \_\_\_\_\_ fire dept. No. of sheets \_\_\_\_\_
Proposed use of building \_\_\_\_\_ No. families \_\_\_\_\_
Last use \_\_\_\_\_ No. families \_\_\_\_\_
Material \_\_\_\_\_ No. stories \_\_\_\_\_ Heat \_\_\_\_\_ Style of roof \_\_\_\_\_ Roofing \_\_\_\_\_
Other buildings on same lot \_\_\_\_\_
Estimated cost \$ \_\_\_\_\_ Fee \$ 1.00

General Description of New Work

To install 1-1000 gallon gasoline tank, additional storage, for private use.

x Tank to be buried 3' below grade; coated with asphaltum; bears Und. Lab.

Permit Issued with Letter

Sent to Fire Dept 4-14-61
Rec'd from Fire Dept 4-18-61

It is under load that this permit does not include installation of heating apparatus which is to be taken out separately by and in the name of the heating contractor. PERMIT TO BE ISSUED TO Portland Pump Co.

Details of New Work

Is any plumbing involved in this work? \_\_\_\_\_ Is any electrical work involved in this work? \_\_\_\_\_
Is connection to be made to public sewer? \_\_\_\_\_ If not, what is proposed for sewage? \_\_\_\_\_
Has septic tank notice been sent? \_\_\_\_\_ Form notice sent? \_\_\_\_\_
Height average grade to top of plate \_\_\_\_\_ Height average grade to highest point of roof \_\_\_\_\_
Size, front \_\_\_\_\_ depth \_\_\_\_\_ No. stories \_\_\_\_\_ solid or filled land? \_\_\_\_\_ earth or rock? \_\_\_\_\_
Material of foundation \_\_\_\_\_ Thickness, top \_\_\_\_\_ bottom \_\_\_\_\_ cellar \_\_\_\_\_
Kind of roof \_\_\_\_\_ Rise per foot \_\_\_\_\_ Roof covering \_\_\_\_\_
No. of chimneys \_\_\_\_\_ Material of chimneys \_\_\_\_\_ of lining \_\_\_\_\_ Kind of heat \_\_\_\_\_ fuel \_\_\_\_\_
Framing Lumber-Kind \_\_\_\_\_ Dressed or full size? \_\_\_\_\_ Corner posts \_\_\_\_\_ Sills \_\_\_\_\_
Size Girder \_\_\_\_\_ Columns under girders \_\_\_\_\_ Size \_\_\_\_\_ Max. on centers \_\_\_\_\_
Studs (outside walls and car-ving partitions) 2x4-16" O. C. Bridging in every floor and flat roof span over 8 feet.
Joists and rafters: 1st floor \_\_\_\_\_, 2nd \_\_\_\_\_, 3rd \_\_\_\_\_, roof \_\_\_\_\_
On centers: 1st floor \_\_\_\_\_, 2nd \_\_\_\_\_, 3rd \_\_\_\_\_, roof \_\_\_\_\_
Maximum span: 1st floor \_\_\_\_\_, 2nd \_\_\_\_\_, 3rd \_\_\_\_\_, roof \_\_\_\_\_
If one story building with masonry walls, thickness of walls? \_\_\_\_\_ height? \_\_\_\_\_

If a Garage

No. cars now accommodated on same lot \_\_\_\_\_, to be accommodated \_\_\_\_\_ number commercial cars to be accommodated \_\_\_\_\_
Will automobile repairing be done other than minor repairs to cars habitually stored in the proposed building? \_\_\_\_\_

Miscellaneous

Will work require disturbing of any tree on a public street? \_\_\_\_\_ NO.
Will there be in charge of the above work a person competent to see that the State and City requirements pertaining thereto are observed? \_\_\_\_\_ YES
Portland Pump Co.

APPROVED:
Carl P. Johnson
Chief of Fire Dept.

CS 301

INSPECTION COPY

Signature of owner

By:

J. W. Lindvall

NOTES ON PERMIT

5-24-61 slab & cables  
down & checked by  
Capt. Flaherty

Large vertical form area with multiple lines for handwritten notes and a large signature in the upper middle section.

Vertical form section containing the following fields:  
Permit No. 671 BSH P  
Location  
Owner  
Date of permit  
Notif. closing-in  
Inspr. closing-in  
Final Notif.  
Final Inspr.  
Cert. of Occupancy Issued  
Staking Out Notice  
Form Check Notice

Large vertical form area on the right side of the page, containing multiple horizontal lines for handwritten notes and a signature at the bottom.



NOTES FOR PERMIT SECTIONS

5-4-61 slab & cables  
down & checked by  
Capt Flaherty

*[Handwritten signature]*

No. of permits  
No. of permits

Form Check Notice

Staking Out Notice

Cert. of Occupancy Issued

Final Inspn.

Final Inspn.

Final Inspn.

Final Inspn.

Final Inspn.

Final Inspn.

Final Inspn.

Final Inspn.

Final Inspn.

Final Inspn.

Final Inspn.

Final Inspn.

Final Inspn.

Final Inspn.

Final Inspn.

Final Inspn.

Final Inspn.

Final Inspn.

Permit No.	64/854
Location	Down Blvd / Front
Owner	Mc... / ...
Date of permit	5/1/61
Notif. closing-in	
Inspn. closing-in	
Final Notif.	
Final Inspn.	
Cert. of Occupancy Issued	
Staking Out Notice	
Form Check Notice	

Final Inspn.

Final Inspn.

Final Inspn.

Final Inspn.

Final Inspn.

Final Inspn.

Final Inspn.

Final Inspn.

Final Inspn.

Final Inspn.

Final Inspn.

Final Inspn.

Final Inspn.

Final Inspn.

Final Inspn.

Final Inspn.

Final Inspn.

Final Inspn.

Final Inspn.

Final Inspn.

Final Inspn.

6-15

MEMORANDUM FROM DEPARTMENT OF BUILDING INSPECTION, PORTLAND, MAINE

April 14, 1961

Location: Thompson's Point

Before tank and piping is covered from view, installer is required to notify the ~~Fire Dept. Headquarters~~ of readiness for inspection and to refrain from covering up until approved by the ~~Fire Dept. Headquarters~~

This tank of <sup>(1)</sup>1000 gallons capacity is required to be of steel or wrought iron no less in thickness than #10 gauge; and before installation is required to be protected against corrosion, even though galvanized, by two coats of tar, asphaltum, or other suitable rust-resisting paint, and special protection wherein corrosive soil such as cinders or the like.

Pipe lines connected to underground tanks, other than tubing and except fill lines and test wells, must be provided with double swing joints arranged to permit the tank to settle without impairing the efficiency of the pipe connections.

Owner and installer will have to bear the responsibility for the structural capacity of the tank to support loads from above such as heavy motor trucks.

If tank will be so located as to be subjected to the action of tide water or "ground" water, adequate anchorage or weighting must be provided to prevent "floating" when tank is empty or nearly so.

AP - Thompson's Point

April 18, 1961

Portland Pump Co.,  
321 Lincoln St.,  
So. Portland, Maine

cc to Maine Cement Products Co.  
Thompson's Point

Gentlemen:

Permit for installation of 1000 gallon underground tank for the storage of gasoline at the above named location is issued herewith. Permit has been approved by the Fire Department subject to the condition that the tank shall be anchored in position and that plans as to how it is anchored are to be sent to that Department. Capt. Flaherty of the Fire Department should be consulted as to requirements in this regard.

Very truly yours,

Albert J. Sears  
Director of Building Inspection

AJS/R

RECEIVED  
APR 14 1961  
DEPT OF BLD'G. INSP.  
CITY OF PORTLAND

PROPOSED 1000 GAL TANK  
BACKGROUND FOR GASOLINE

EXIST 500 GAL TANK

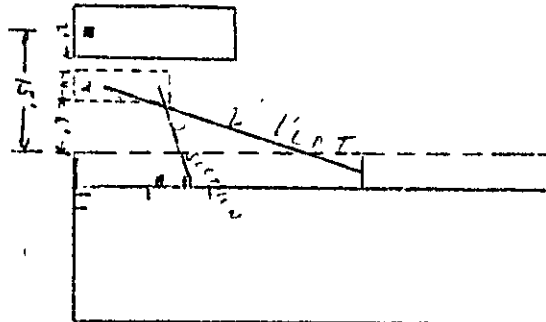

OWNER: MAINE CEMENT WORKS  
THOMPSON'S POINT

P.R. ESSO STANDARD  
LINCOLN STREET

CITY OF  
PORTLAND PUMP CO.  
321 LINCOLN STREET  
SOUTH PORTLAND, MAINE



APPLICATION FOR PERMIT

Class of Building or Type of Structure Installation
Portland, Maine, October 24, 1960

PERMIT ISSUED 01626 OCT 25 1960 CITY of PORTLAND

To the INSPECTOR OF BUILDINGS, PORTLAND, MAINE.

The undersigned hereby applies for a permit to erect/alter/repair/demolish/install the following building structure equipment in accordance with the Laws of the State of Maine, the Building Code and Zoning Ordinance of the City of Portland, plans and specifications, if any, submitted herewith and the following specifications:

Location Thompson's Point, Within Fire Limits? Dist. No.
Owner's name and address Thompson's Point Realty, P.O. Box 1059 Telephone
Lessee's name and address Maine Cement Products Co. Thompson's Point. Telephone
Contractor's name and address Grinnell Co. 501 Fore St. Telephone 3-3879
Architect Specifications Plans yes No. of sheets 1
Proposed use of building warehouse No. families
Last use No. families
Material No. stories Heat Style of roof Roofing
Other buildings on same lot
Estimated cost \$ Fee \$ 2.00

General Description of New Work

To install dry sprinkler system in new building as per plan.

It is understood that this permit does not include installation of heating apparatus which is to be taken out separately by and in the name of the heating contractor. PERMIT TO BE ISSUED TO contractor

Details of New Work

Is any plumbing involved in this work? Is any electrical work involved in this work?
Is connection to be made to public sewer? If not, what is proposed for sewage?
Has septic tank notice been sent? Form notice sent?
Height average grade to top of plate Height average grade to highest point of roof
Size, front depth No. stories solid or filled land? earth or rock?
Material of foundation Thickness, top bottom cellar
Kind of roof Rise per foot Roof covering
No. of chimneys Material of chimneys of lining Kind of heat fuel
Framing Lumber-Kind Dressed or full size? Corner posts Sills
Size Girder Columns under girders Size Max. on centers
Studs (outside walls and carrying partitions) 2x4-16" O. C. Bridging in every floor and flat roof spr over 8 feet.
Joists and rafters: 1st floor, 2nd, 3rd, roof
On centers: 1st floor, 2nd, 3rd, roof
Maximum span: 1st floor, 2nd, 3rd, roof
If one story building with masonry walls, thickness of walls? height?

If a Garage

No. cars now accommodated on same lot, to be accommodated number commercial cars to be accommodated.
Will automobile repairing be done other than minor repairs to cars habitually stored in the proposed building?

APPROVED: OK - 10/25/60 - [Signature]

Miscellaneous

Will work require disturbing of any tree on a public street? no
Will there be in charge of the above work a person competent to see that the State and City requirements pertaining thereto are observed? yes
Grinnell Company

CS 301

INSPECTION COPY

Signature of owner by: [Signature]

F.1





1-2 INDUSTRIAL ZONE

# APPLICATION FOR PERMIT

Class of Building or Type of Structure Second Class

Portland, Maine, April 26, 1960

**PERMIT ISSUED**  
00537  
MAY 17 1960  
CITY OF PORTLAND

To the INSPECTOR OF BUILDINGS, PORTLAND, MAINE:

The undersigned hereby applies for a permit to erect alter repair demolish install the following building structure equipment in accordance with the Laws of the State of Maine, the Building Code and Zoning Ordinance of the City of Portland, plans and specifications, if any, submitted herewith and the following specifications:

Location Thompson's Point Within Fire Limits? \_\_\_\_\_ Dist. No. \_\_\_\_\_  
 Owner's name and address Thompson's Point Realty, P.O. Box 1059 Telephone \_\_\_\_\_  
 Lessee's name and address Maine Cement Products Co., Thompson's Point Telephone \_\_\_\_\_  
 Contractor's name and address Fusco & Ricchio, 210 Sherwood St. Telephone \_\_\_\_\_  
 Architect \_\_\_\_\_ Specifications yes Plans yes No. of sheets 3  
 Proposed use of building Warehouse No. families \_\_\_\_\_  
 Last use \_\_\_\_\_ " \_\_\_\_\_ No. families \_\_\_\_\_  
 Material brick No. stories 1 Heat \_\_\_\_\_ Style of roof \_\_\_\_\_ Roofing \_\_\_\_\_  
 Other buildings on same lot \_\_\_\_\_  
 Estimated cost \$ 17,000. Fee \$ 17.00

### General Description of New Work

To construct 1-story concrete block addition 100' x 74' as per plans

*Ellis Paperboard Co.*

Permit Issued with Letter

It is understood that this permit does not include installation of heating apparatus which is to be taken out separately by and in the name of the heating contractor. **PERMIT TO BE ISSUED TO** Maine Cement Products Co.

### Details of New Work

Is any plumbing involved in this work? \_\_\_\_\_ Is any electrical work involved in this work? \_\_\_\_\_  
 Is connection to be made to public sewer? \_\_\_\_\_ If not, what is proposed for sewage? \_\_\_\_\_  
 Has septic tank notice been sent? \_\_\_\_\_ Form notice sent? \_\_\_\_\_  
 Height average grade to top of plate \_\_\_\_\_ Height average grade to highest point of roof? \_\_\_\_\_  
 Size, front \_\_\_\_\_ depth \_\_\_\_\_ No. stories \_\_\_\_\_ solid or filled land? \_\_\_\_\_ earth or rock? \_\_\_\_\_  
 Material of foundation \_\_\_\_\_ Thickness, top \_\_\_\_\_ bottom \_\_\_\_\_ cellar \_\_\_\_\_  
 Material of underpinning \_\_\_\_\_ Height \_\_\_\_\_ Thickness \_\_\_\_\_  
 Kind of roof \_\_\_\_\_ Rise per foot \_\_\_\_\_ Roof covering \_\_\_\_\_  
 No. of chimneys \_\_\_\_\_ Material of chimneys \_\_\_\_\_ of lining \_\_\_\_\_ Kind of heat None fuel \_\_\_\_\_  
 Framing Lumber—Kind \_\_\_\_\_ Dressed or full size? \_\_\_\_\_ Corner posts \_\_\_\_\_ Sills \_\_\_\_\_  
 Size Girder \_\_\_\_\_ Columns under girders \_\_\_\_\_ Size \_\_\_\_\_ Max. on centers \_\_\_\_\_  
 Kind and thickness of outside sheathing of exterior walls? \_\_\_\_\_  
 Studs (outside walls and carrying partitions) 2x4-16" O. C. Bridging in every floor and flat roof span over 8 feet.  
 Joists and rafters: 1st floor \_\_\_\_\_, 2nd \_\_\_\_\_, 3rd \_\_\_\_\_, roof \_\_\_\_\_  
 On centers: 1st floor \_\_\_\_\_, 2nd \_\_\_\_\_, 3rd \_\_\_\_\_, roof \_\_\_\_\_  
 Maximum span: 1st floor \_\_\_\_\_, 2nd \_\_\_\_\_, 3rd \_\_\_\_\_, roof \_\_\_\_\_  
 If one story building with masonry walls, thickness of walls? \_\_\_\_\_ height? \_\_\_\_\_

### If a Garage

No. cars now accommodated on same lot \_\_\_\_\_, to be accommodated \_\_\_\_\_ number commercial cars to be accommodated \_\_\_\_\_  
 Will automobile repairing be done other than minor repairs to cars habitually stored in the proposed building? \_\_\_\_\_

APPROVED:

*5/5/60 J. E. G. Jr.*  
*with letter by A. J. S.*

### Miscellaneous

Will work require disturbing of any tree on a public street? no  
 Will there be in charge of the above work a person competent to see that the State and City requirements pertaining thereto are observed? yes Thompson's Point Realty  
 Maine Cement Products

INSPECTION COPY

Signature of owner By: *Benjamin L. Viollette*

*PH*

NOTES

8-24-60 Heat started  
 8-1-60 Forms ready  
 to pour outside walls  
 8-9-60 All outside  
 walls pouring  
 8-17-60 Backfill  
 8-30-60 Steel framing  
 8-31-60  
 9-14-60 Walls half  
 10-13-60 Roof gence  
 on  
 11-15-60 Completed

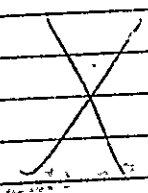

Permit No.	601537
Location	Thompson's Field
Owner	Paul J. Thompson
Date of permit	8/17/60
Notif. closing-in	
Inspn. closing-in	
Final Notif.	
Final Inspn.	
Cert. of Occupancy issued	11/16/60
Staking Out Notice	
Form Check Notice	

Section 2B-2  
 Thompson pt.





APPLICATION FOR AMENDMENT TO PERMIT

Amendment No. #

Portland, Maine, October 20, 1960

PERMIT AWARDED

OCT 25 1960

CITY of PORTLAND

To the INSPECTOR OF BUILDINGS, PORTLAND, MAINE

The undersigned hereby applies for amendment to Permit No. 60/537, pertaining to the building or structure comprised in the original application in accordance with the Laws of the State of Maine, the Building Code and Zoning Ordinance of the City of Portland, plans and specifications, if any, submitted herewith, and the following specifications:

Location Thompson's Point ... With Fire Limits? ... Dist. No. ...
Owner's name and address Thompson's Point Realty, P.O. Box 1059 ... Telephone ...
Lessee's name and address Maine Cements, Products Co. Thompson's Point ... Telephone ...
Contractor's name and address ... Telephone ...
Architect ... Plans filed yes No. of sheets ...
Proposed use of building Warehouse ... No. families ...
Last use ... No. families ...
Increased cost of work \$400.00 ... Additional fee ... 1.00

Description of Proposed Work

To cut holes in web steel trusses to allow sprinkler pipes to pass thru.

Details of New Work Permit to Cement Products Co.

Is any plumbing involved in this work? ... Is any electrical work involved in this work? ...
Height average grade to top of plate ... Height average grade to highest point of roof ...
Size, front ... depth ... No. stories ... solid or filled land? ... earth or rock? ...
Material of foundation ... Thickness, top ... bottom ... cellar ...
Material of underpinning ... Height ... Thickness ...
Kind of roof ... Rise per foot ... Roof covering ... of lining ...
No. of chimneys ... Material of chimneys ... Dressed or full size? ... Size ...
Framing lumber—Kind ... Girt or ledger board? ... Size ...
Corner posts ... Sills ... Columns under girders ... Size ... Max. on centers ...
Girders ... Size ... Columns under girders ... Size ... Max. on centers ...
Studs (outside walls and carrying partitions) 2x4-16" O. C. Bridging in every floor and flat roof span over 8 feet.
Joists and rafters: 1st floor ... 2nd ... 3rd ... roof ...
On centers: 1st floor ... 2nd ... 3rd ... roof ...
Maximum span: 1st floor ... 2nd ... 3rd ... roof ...

Approved:

Thompson's Point Realty
Maine Cement Products Co.

Signature of Owner by: Pauline Viollette

Approved: Albert J. Sears
Inspector of Buildings

INSPECTION COPY

CS. 105

(COPY)



Copy to: CITY OF PORTLAND, MAINE  
Ellis Paperboard Company Department of Building Inspection  
Thompson's Point  
Portland Maine

# Certificate of Occupancy

LOCATION Thompson's Point

Issued to Maine Cement Products Company Date of Issue November 16, 1960  
Thompson's Point

This is to certify that the building, premises, or part thereof, at the above location, built—altered—changed as to use under Building Permit No. 50/537, has had final inspection, has been found to conform substantially to requirements of Zoning Ordinance and Building Code of the City, and is hereby approved for occupancy or use, limited or otherwise, as indicated below.

PORTION OF BUILDING OR PREMISES

APPROVED OCCUPANCY

New Addition  
(section 2B-2)

Warehouse

Limiting Conditions:

This certificate supersedes  
certificate issued

Approved:

(Date)

Wesley F. Cartwright

Inspector

Albert J. Sears

Inspector of Buildings

AP-Thompson's Point

May 17, 1960

cc to: Thompson's Point Realty  
P.O. Box 1059  
Portland, Maine

Maine Cement Products Co.  
Thompson's Point

cc to: Fusco & Richio  
240 Sherwood Street

Gentlemen:

Building permit for construction of a one story concrete block addition 74 feet by 100 feet to existing manufacturing building at the above named location to be used for warehouse purposes is issued herewith based on specifications, plans bearing revision dates of May 9, 11 & 12, 1960, and plans of the Stran-Steel Corporation covering the rigid frames and wall roof construction supported thereon. Permit is issued on the understanding that the automatic sprinkler system in the existing building is to be extended to cover the addition. A separate permit issuable only to the actual installer is required for this installation.

Very truly yours,

Albert J. Sears  
Inspector of Buildings

AJS/jg

ELLIS PAPERS  
THOMPSON BAY  
MAY 31 1900  
DEPT. OF BLDG. INSP.  
CITY OF BOSTON

THIS BUILDING IS ONE  
STORY HIGH WITH-OUT  
BASEMENT

Existing  
Office

Existing  
Manufacturing

Existing  
Warehouse

Proposed  
Warehouse  
Addition

240'

100'



# APPLICATION FOR PERMIT

1-2 INDUSTRIAL

FEB 17 1959

Class of Building or Type of Structure \_\_\_\_\_

Portland, Maine, February 16, 1959

CITY of PORTLAND

To the INSPECTOR OF BUILDINGS, PORTLAND, MAINE

The undersigned hereby applies for a permit to erect alter repair demolish install the following building structure equipment in accordance with the Laws of the State of Maine, the Building Code and Zoning Ordinance of the City of Portland, plans and specifications, if any, submitted herewith and the following specifications:

Location Thompson's Point Portland Maine Within Fire Limits? no Dist. No. \_\_\_\_\_

Owner's name and address Maine Cement Products Inc. Div. of Mecaw Industries Telephone 2-5485  
Thompson's Point

Lessee's name and address \_\_\_\_\_ Telephone \_\_\_\_\_

Contractor's name and address owners & Bancroft Martin Rolling Mills Co. Telephone \_\_\_\_\_

Architect \_\_\_\_\_ Specifications \_\_\_\_\_ Plans yes No. of sheets 3

Proposed use of building Storage Bins No. families \_\_\_\_\_

Last use \_\_\_\_\_ " " \_\_\_\_\_ No. families \_\_\_\_\_

Material \_\_\_\_\_ No. stories \_\_\_\_\_ Heat \_\_\_\_\_ Style of roof \_\_\_\_\_ Roofing \_\_\_\_\_

Other buildings on same lot \_\_\_\_\_

Estimated cost \$ 2500.00 Fee \$ 5.00

### General Description of New Work

To construct enclosure over existing bins as per plans.

It is understood that this permit does not include installation of heating apparatus which is to be taken out separately by and in the name of the heating contractor. PERMIT TO BE ISSUED TO OWNERS

### Details of New Work

Is any plumbing involved in this work? \_\_\_\_\_ Is any electrical work involved in this work? \_\_\_\_\_

Is connection to be made to public sewer? \_\_\_\_\_ If not, what is proposed for sewage? \_\_\_\_\_

Has septic tank notice been sent? \_\_\_\_\_ Form notice sent? \_\_\_\_\_

Height average grade to top of plate \_\_\_\_\_ Height average grade to highest point of roof \_\_\_\_\_

Size, front \_\_\_\_\_ depth \_\_\_\_\_ No. stories \_\_\_\_\_ solid or filled land? \_\_\_\_\_ earth or rock? \_\_\_\_\_

Material of foundation \_\_\_\_\_ Thickness, top \_\_\_\_\_ bottom \_\_\_\_\_ cellar \_\_\_\_\_

Material of underpinning \_\_\_\_\_ Height \_\_\_\_\_ Thickness \_\_\_\_\_

Kind of roof \_\_\_\_\_ Rise per foot \_\_\_\_\_ Roof covering \_\_\_\_\_

No. of chimneys \_\_\_\_\_ Material of chimneys \_\_\_\_\_ of lining \_\_\_\_\_ Kind of heat \_\_\_\_\_ fuel \_\_\_\_\_

Framing Lumber—Kind \_\_\_\_\_ Dressed or full size? \_\_\_\_\_ Corner posts \_\_\_\_\_ Sills \_\_\_\_\_

Size Girder \_\_\_\_\_ Columns under girders \_\_\_\_\_ Size \_\_\_\_\_ Max. on centers \_\_\_\_\_

Kind and thickness of outside sheathing of exterior walls? \_\_\_\_\_

Studs (outside walls and carrying partitions) 2x4-16" O. C. Bridging in every floor and flat roof span over 8 feet.

Joists and rafters: 1st floor \_\_\_\_\_, 2nd \_\_\_\_\_, 3rd \_\_\_\_\_, roof \_\_\_\_\_

On centers: 1st floor \_\_\_\_\_, 2nd \_\_\_\_\_, 3rd \_\_\_\_\_, roof \_\_\_\_\_

Maximum span: 1st floor \_\_\_\_\_, 2nd \_\_\_\_\_, 3rd \_\_\_\_\_, roof \_\_\_\_\_

If one stor. building with masonry walls, thickness of walls? \_\_\_\_\_ height? \_\_\_\_\_

### If a Garage

No. cars now accommodated on same lot \_\_\_\_\_, to be accommodated \_\_\_\_\_ number commercial cars to be accommodated \_\_\_\_\_

Will automobile repairing be done other than minor repairs to cars habitually stored in the proposed building? \_\_\_\_\_

APPROVED:

\_\_\_\_\_  
 \_\_\_\_\_  
 \_\_\_\_\_

### Miscellaneous

Will work require disturbing of any tree on a public street? no

Will there be in charge of the above work a person competent to see that the State and City requirements pertaining thereto are observed? yes  
Maine Cement Products Co. Inc.

INSPECTION COPY

Signature of owner by: Joseph Thomas

F.M.

2-27-59 steel erected  
 in place  
 3-17-59 same waiting  
 for gut covering  
 4-7-59 sheet metal  
 siding  
 4-29-59 Completed

Permit No.	59-116
Location	1111 1/2 St. N. S.W.
Owner	W. C. ...
Date of permit	2/27/59
Notif. closing-in	3/17/59
Inspn. closing-in	3/17/59
Final Notif.	4/7/59
Final Inspn.	4/7/59
Cert. of Occupancy issued	4/29/59
Staking Out Notice	
Form Check Notice	

Inspection of foundation  
 Inspection of underground  
 Kind of roof  
 Rise over foot  
 Framing of upper floor  
 Columns under girders  
 Kind and thickness of outside sheathing of exterior wal  
 Studs (outside walls and cutting partitions) 2x10 (11)  
 Header and partition  
 Partitions in  
 If one story building with masonry walls thickness of wal  
 No. of stories  
 Framing of upper floor  
 Rise over foot  
 Kind of underground  
 Inspection of foundation

INSPECTION COPY

May 2, 1957

Thompson's Point--Belated permit for oil burning equipment at the plant  
of Maine Cement Products Co., Inc.

Marshall Engineering Co.,  
398 Fore St.  
Mr. Rudolph Violette, Engineer  
Maine Cement Products Co., Inc.  
P. O. Box 1059  
Thompson's Point

Gentlemen:

At long last building permit for the above installation is belatedly issued to Marshall Engineering, though the burner assembly does not carry upon it the Underwriters' label, on the basis of my letter of March 7-- Mr. Violette having given us the assurances as regards previous good record of the burner and Mr. Marshall having certified to the safeties in his letter of March 12.

In checking over the job some time ago our field inspector found everything in order except that he could not locate the required remote control switch. Upon phoning Mr. Marshall about this, he said that the remote control switch is located either in another building or another part of the building at some distance away from the burner assembly.

We are closing out the job from our records and will make no further inspections. In order that there may be no misunderstanding about the remote control switch, however, the regulations require either a control switch or a manually operated shut off valve in the oil supply line at a sufficient distance from the burner assembly or in such a location that, should some emergency take place at the burner, the appliance can be completely and quickly shut down by operating the remote control switch or remote control valve.

No doubt it is as Mr. Marshall says, but it seems to me that this switch or valve should be appropriately marked so that in time of need there will be no doubt what to do, and also so that some person will not shut down the burner unnecessarily unaware of the purpose of the switch or that it involves the oil burning equipment at all.

Very truly yours,

Warren McDonald  
Inspector of Buildings

WMCD/B

Enclosure to Marshall Engineering: Copy of application and permit card. 2B



FILL IN AND SIGN WITH INK

APPLICATION FOR PERMIT FOR HEATING, COOKING OR POWER EQUIPMENT

Portland, Maine, July 25, 1956

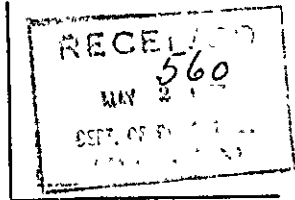

To the INSPECTOR OF BUILDINGS, PORTLAND, ME.

The undersigned hereby applies for a permit to install the following heating, cooking or power equipment in accordance with the Laws of Maine, the Building Code of the City of Portland, and the following specifications:

Location Thompson's Point Use of Building Mfg. concrete block No. Stories New Building Existing "
Name and address of owner of appliance Maine Cement Products, Thompson's Point
Installer's name and address Marshall Engineering Co., 116 Middle St. Telephone 31524

General Description of Work

To install oil burning equipment in connection with existing steam heat

IF HEATER, OR POWER BOILER

Location of appliance boiler room Any burnable material in floor surface or beneath?
If so, how protected? Kind of fuel? oil
Minimum distance to burnable material, from top of appliance or casing top of furnace Over 15"
From top of smoke pipe Over 15". From front of appliance no wood From sides or back of appliance no wood
Size of chimney flue new stack Other connections to same flue none
If gas fired, how vented? Rated maximum demand per hour
Will sufficient fresh air be supplied to the appliance to insure proper and safe combustion? yes

IF OIL BURNER

Name and type of burner Ray (Rotary type) 3 1/2 gal. Labeled by underwriters' laboratories? yes
Will operator be always in attendance? Does oil supply line feed from top or bottom of tank? top
Type of floor beneath burner concrete Size of vent pipe 2"
Location of oil storage above ground Number and capacity of tanks 1-1000 gal.
Low water shut off yes Make McDonnell-Killer No. #51
Will all tanks be more than five feet from any flame? yes How many tanks enclosed?
Total capacity of any existing storage tanks for furnace burners none

Permit Issued with Letter IF COOKING APPLIANCE

Location of appliance Any burnable material in floor surface or beneath?
If so, how protected? Height of Legs, if any
Skirting at bottom of appliance? Distance to combustible material from top of appliance?
From front of appliance From sides and back From top of smoke pipe
Size of chimney flue Other connections to same flue
Is hood to be provided? If so, how vented? Forced or gravity?
If gas fired, how vented? Rated maximum demand per hour

MISCELLANEOUS EQUIPMENT OR SPECIAL INFORMATION

The above ground tank will not be in place more than four months. On that basis we will not require foundations below frost but the tank should be supported on non-combustible material with only wood cushion allowed under the tank.

Boiler to be used for drying of concrete blocks
Amount of fee enclosed? \$2.00 (\$2.00 for one heater, etc., 50 cents additional for each additional heater, etc., in same building at same time.)

APPROVED:

Handwritten signature of the Chief of the Dept.

Will there be in charge of the above work a person competent to see that the State and City requirements pertaining thereto are observed? yes

Marshall Engineering Co.

CITY OF MAINE PRINTING CO.

INSPECTION COPY

Signature of Installer By: Marshall



NOTES

- 16 Low Water Switch
- 15 Injection Card
- 14 Oil Gauge
- 13 Tank Heaters
- 12 Tank Heating
- 11 Capacity of Tank
- 10 Valves in Supply Line
- 9 Pump Support & Protection
- 8 Heater Control
- 7 High Limit Control
- 6 Stack to roof
- 5 Main Label
- 4 Burner to tank
- 3
- 2
- 1

Permit No. 56 / 570  
 Location Howland Point  
 Owner Marine Supply Products  
 Date of permit 5/2/57  
 Approved \_\_\_\_\_

8-1-56 Found oil burner all installed with temp. oil tank. No label on used Ray Burner. Phone Marshall Engineering Co. Stack ?

9-18-56 Stack closed in about roof. Temporary tank cut out - using #2 oil with 2" line from new tank. No cut off at bldg entrance.

9-25-56 Cut off on suction line installed at bldg wall. No label cut off.

11-3-57 Can not locate amero. in cut off sw at outside.



FILL IN AND SIGN WITH INK

APPLICATION FOR PERMIT FOR HEATING, COOKING OR POWER EQUIPMENT

Portland, Maine, Aug. 15, 1956

PERMIT ISSUED

01304  
AUG 16 1956

CITY OF PORTLAND

To the INSPECTOR OF BUILDINGS, PORTLAND, ME.

The undersigned hereby applies for a permit to install the following heating, cooking or power equipment in accordance with the Laws of Maine, the Building Code of the City of Portland, and the following specifications:

Location Thompson's Point Use of Building Mfg concrete blocks No Stories ~~New~~ Building Existing "
Name and address of owner of appliance ... Maine Cement Products, Thompson's Point
Installer's name and address ... owner. Telephone

General Description of Work

To install low pressure steam boiler and stack

IF HEATER, OR POWER BOILER

Location of appliance boiler room Any burnable material in floor surface or beneath? no
If so, how protected? Kind of fuel? oil
Minimum distance to burnable material, from top of appliance or casing top of furnace over 15"
From top of smoke pipe over 15" From front of appliance over 4' From sides or back of appliance over 3'
Size of chimney flue stack as per plan Other connections to same flue
If gas fired, how vented? Rated maximum demand per hour
Will sufficient fresh air be supplied to the appliance to insure proper and safe combustion? ~~no~~ yes

IF OIL BURNER

Name and type of burner Labelled by underwriters' laboratories?
Will operator be always in attendance? Does oil supply line feed from top or bottom of tank?
Type of floor beneath burner Size of vent pipe
Location of oil storage Number and capacity of tanks
Low water shut off Make No.
Will all tanks be more than five feet from any flame? How many tanks enclosed?
Total capacity of any existing storage tanks for furnace burners

IF COOKING APPLIANCE

Location of appliance Any burnable material in floor surface or beneath?
If so, how protected? Height of Legs, if any
Skirting at bottom of appliance? Distance to combustible material from top of appliance?
From front of appliance From sides and back From top of smokepipe
Size of chimney flue Other connections to same flue
Is hood to be provided? If so, how vented? Forced or gravity?
If gas fired, how vented? Rate maximum demand per hour

MISCELLANEOUS EQUIPMENT OR SPECIAL INFORMATION

Boiler to be used for drying of concrete blocks

Amount of fee enclosed? \$2.00 (\$2.00 for one heater, etc., 50 cents additional for each additional heater, etc., in same building at same time.)

APPROVED:
[Signature area]

Will there be in charge of the above work a person competent to see that the State and City requirements pertaining thereto are observed? yes

Maine Cement Products

Signature of Installer by: Rudolph Virolle Eng.

CITY OF PORTLAND PRINTING CO.

INSPECTION COPY

NOTES

9-4-56 Stack only in roof  
of wing ~~CP~~

10-10-56 Completed ~~CP~~

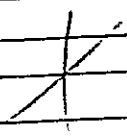

Permit No. 56/1304

Location Plum Springs Road

Owner Plum Springs Products

Date of permit 8/16/56

Approved

Large empty lined area for notes, divided into two columns by a vertical line.

Thompson's Point--Installation of fuel oil tank for and by Maine Cement Products.

8/16/56

Before tank and piping is covered from view, installer is required to notify Fire Department Headquarters of readiness for inspection and to refrain from covering up until approved by the Fire Department.

This tank of 6800 gallons capacity is required to be of steel or wrought iron no less in thickness than  $\frac{1}{4}$  inch; and before installation is required to be protected against corrosion, even though galvanized, by two coats of tar, asphaltum, or other suitable rust-resisting paint, and special protection wherein corrosive soil such as cinders or the like.

Pipe lines connected to underground tanks, other than tubing and except fill lines and test wells, must be provided with double swing joints arranged to permit the tank to settle without impairing the efficiency of the pipe connections.

Owner and installer will have to bear the responsibility for the structural capacity of the tank to support loads from above such as heavy motor trucks.

If tank will be so located as to be subjected to the action of tide water or "ground" water, adequate anchorages or weighting must be provided to prevent "floating" when tank is empty or nearly so.

D

CC: Harry W. Marr, Chief  
of the Fire Department



(D) INDUSTRIAL ZONE

# APPLICATION FOR PERMIT

Class of Building or Type of Structure Installation  
Portland, Maine, Aug. 15, 1956

PERMIT ISSUED

01366

AUG 16 1956

CITY OF PORTLAND

To the INSPECTOR OF BUILDINGS, PORTLAND, MAINE

The undersigned hereby applies for a permit to ~~erect above ground~~ install the following ~~building~~ equipment in accordance with the Laws of the State of Maine, the Building Code and Zoning Ordinance of the City of Portland, plans and specifications, if any, submitted herewith and the following specifications:

Location Thompson's Point Within Fire Limits? no Dist. No. \_\_\_\_\_  
 Owner's name and address Maine Cement Products, Inc., Thompson's Point Telephone \_\_\_\_\_  
 Lessee's name and address \_\_\_\_\_ Telephone \_\_\_\_\_  
 Contractor's name and address owner Telephone \_\_\_\_\_  
 Architect \_\_\_\_\_ Specifications \_\_\_\_\_ Plans yes No. of sheets 1  
 Proposed use of building \_\_\_\_\_ No. families \_\_\_\_\_  
 Last use \_\_\_\_\_ No. families \_\_\_\_\_  
 Material \_\_\_\_\_ No. stories \_\_\_\_\_ Heat \_\_\_\_\_ Style of roof \_\_\_\_\_ Roofing \_\_\_\_\_  
 Other buildings on same lot \_\_\_\_\_  
 Estimated cost \$ \_\_\_\_\_ Fee \$1.00

### General Description of New Work

To install 1-6800 fuel oil storage tank. Top of tank will be 3' beneath new fill. Tank bears Underwriters label and painted with asphaltum. 2" vent pipe.

BEFORE covering Tank and any Equipment, REMOVAL OF FIRE DEPT Required.

Permit issued with Memo

8/14/56  
8/16/56

It is understood that this permit does not include installation of heating apparatus which is to be taken out separately by and in the name of the heating contractor. PERMIT TO BE ISSUED TO owner

### Details of New Work

Is any plumbing involved in this work? \_\_\_\_\_ Is any electrical work involved in this work? \_\_\_\_\_  
 Is connection to be made to public sewer? \_\_\_\_\_ If not, what is proposed for sewage? \_\_\_\_\_  
 Has septic tank notice been sent? \_\_\_\_\_ Form notice sent? \_\_\_\_\_  
 Height average grade to top of plate \_\_\_\_\_ Height average grade to highest point of roof \_\_\_\_\_  
 Size, front \_\_\_\_\_ depth \_\_\_\_\_ No. stories \_\_\_\_\_ solid or filled land? \_\_\_\_\_ earth or rock? \_\_\_\_\_  
 Material of foundation \_\_\_\_\_ Thickness, top \_\_\_\_\_ bottom \_\_\_\_\_ cellar \_\_\_\_\_  
 Material of underpinning \_\_\_\_\_ Height \_\_\_\_\_ Thickness \_\_\_\_\_  
 Kind of roof \_\_\_\_\_ Rise per foot \_\_\_\_\_ Roof covering \_\_\_\_\_  
 No. of chimneys \_\_\_\_\_ Material of chimneys \_\_\_\_\_ of lining \_\_\_\_\_ Kind of heat \_\_\_\_\_ fuel \_\_\_\_\_  
 Framing lumber—Kind \_\_\_\_\_ Dressed or full size? \_\_\_\_\_  
 Corner posts \_\_\_\_\_ Sills \_\_\_\_\_ Girt or ledger board? \_\_\_\_\_ Size \_\_\_\_\_  
 Girders \_\_\_\_\_ Size \_\_\_\_\_ Columns under girders \_\_\_\_\_ Size \_\_\_\_\_ Max. on centers \_\_\_\_\_  
 Studs (out side walls and carrying partitions) 2x4-16" O. C. Bridging in every floor and flat roof span over 8 feet.  
 Joists and rafters: 1st floor \_\_\_\_\_, 2nd \_\_\_\_\_, 3rd \_\_\_\_\_, roof \_\_\_\_\_  
 On centers 1st floor \_\_\_\_\_, 2nd \_\_\_\_\_, 3rd \_\_\_\_\_, roof \_\_\_\_\_  
 Maximum span: 1st floor \_\_\_\_\_, 2nd \_\_\_\_\_, 3rd \_\_\_\_\_, roof \_\_\_\_\_  
 If one story building with masonry walls, thickness of walls? \_\_\_\_\_ height? \_\_\_\_\_

### If a Garage

No. cars now accommodated on same lot \_\_\_\_\_, to be accommodated \_\_\_\_\_ number commercial cars to be accommodated \_\_\_\_\_  
Will automobile repairing be done other than minor repairs to cars habitually stored in the proposed building? \_\_\_\_\_

APPROVED:

*[Signature]*  
CHIEF OF FIRE DEPT.

### Miscellaneous

Will work require disturbing of any tree on a public street? no  
Will there be in charge of the above work a person competent to see that the State and City requirements pertaining thereto are observed? yes

Maine Cement Products, Inc.

Signature of owner by: *[Signature]*

INSPECTION COPY

Permit No. 561306

Location *Plumb Line Point*

Owner *Marine General Products*

Date of permit *8/16/56*

Notif. closing-in

Inspn. closing-in

Final Notif.

Final Inspn.

Cert. of Occupancy issued

Staking Out Notice

Form Check Notice

NOTES

*9-4-56 Tank in place on conc slab*

Large ruled area for handwritten notes, containing a large handwritten 'X' and some faint text.



FILL IN AND SIGN WITH INK

APPLICATION FOR PERMIT FOR HEATING, COOKING OR POWER EQUIPMENT

Portland, Maine, October 19, 1955

PERMIT ISSUED 01984

OCT 20 1955

CITY of PORTLAND

N-NFC

To the INSPECTOR OF BUILDINGS, PORTLAND, ME.

Complete 10/24/55

The undersigned hereby applies for a permit to install the following heating, cooking or power equipment in accordance with the Laws of Maine, the Building Laws of the City of Portland, and the following specifications:

Office building

Location Thompson's Point Use of Building Mfg. No. Stories 1 New Building Existing Name and address of owner of appliance Maine Cement Products, Thompson's Point Installer's name and address Maurice Colton, 71 Wellington Rd. Telephone 4-2766

General Description of Work

To install hot water heating system and oil burning equipment

IF HEATER, OR POWER BOILER

Location of appliance boiler room Any burnable material in floor surface or beneath? no If so, how protected? Kind of fuel? oil Minimum distance to burnable material, from top of appliance or casing top of furnace Over 15" From top of smoke pipe Over 15" From front of appliance Over 4' From sides or back of appliance Over 3' Size of chimney flue 8x8 Other connections to same flue none If gas fired, how vented? Rated maximum demand per hour Will sufficient fresh air be supplied to the appliance to insure proper and safe combustion? yes

IF OIL BURNER

Name and type of burner Gilbert Barker Labelled by underwriters' laboratories? yes Will operator be always in attendance? Does oil supply line feed from top or bottom of tank? bottom Type of floor beneath burner concrete Size of vent pipe 1 1/2" Location of oil storage outside above ground Number and capacity of tanks 1-275 gal. Low water shut off Make No. Will all tanks be more than five feet from any flame? yes How many tanks enclosed? Total capacity of any existing storage tanks for furnace burners none

IF COOKING APPLIANCE

Location of appliance Any burnable material in floor surface or beneath? If so, how protected? Height of Legs, if any Skirting at bottom of appliance? Distance to combustible material from top of appliance? From front of appliance From sides and back From top of smokepipe Size of chimney flue Other connections to same flue Is hood to be provided? If so, how vented? Forred or gravity? If gas fired, how vented? Rated maximum demand per hour

MISCELLANEOUS EQUIPMENT OR SPECIAL INFORMATION

Tank will set on concrete slab

Permit Issued with Letter

Amount of fee enclosed? 2.00 (\$2.00 for one heater, etc., 50 cents additional for each additional heater, etc., in same building at same time.)

APPROVED: [Signature] CHIEF OF FIRE DEPT.

Will there be in charge of the above work a person competent to see that the State and City requirements pertaining thereto are observed? yes

Maine Cement Products

Signature of Installer By: Maurice Colton

INSPECTION COPY

C17-254-1M MARKS





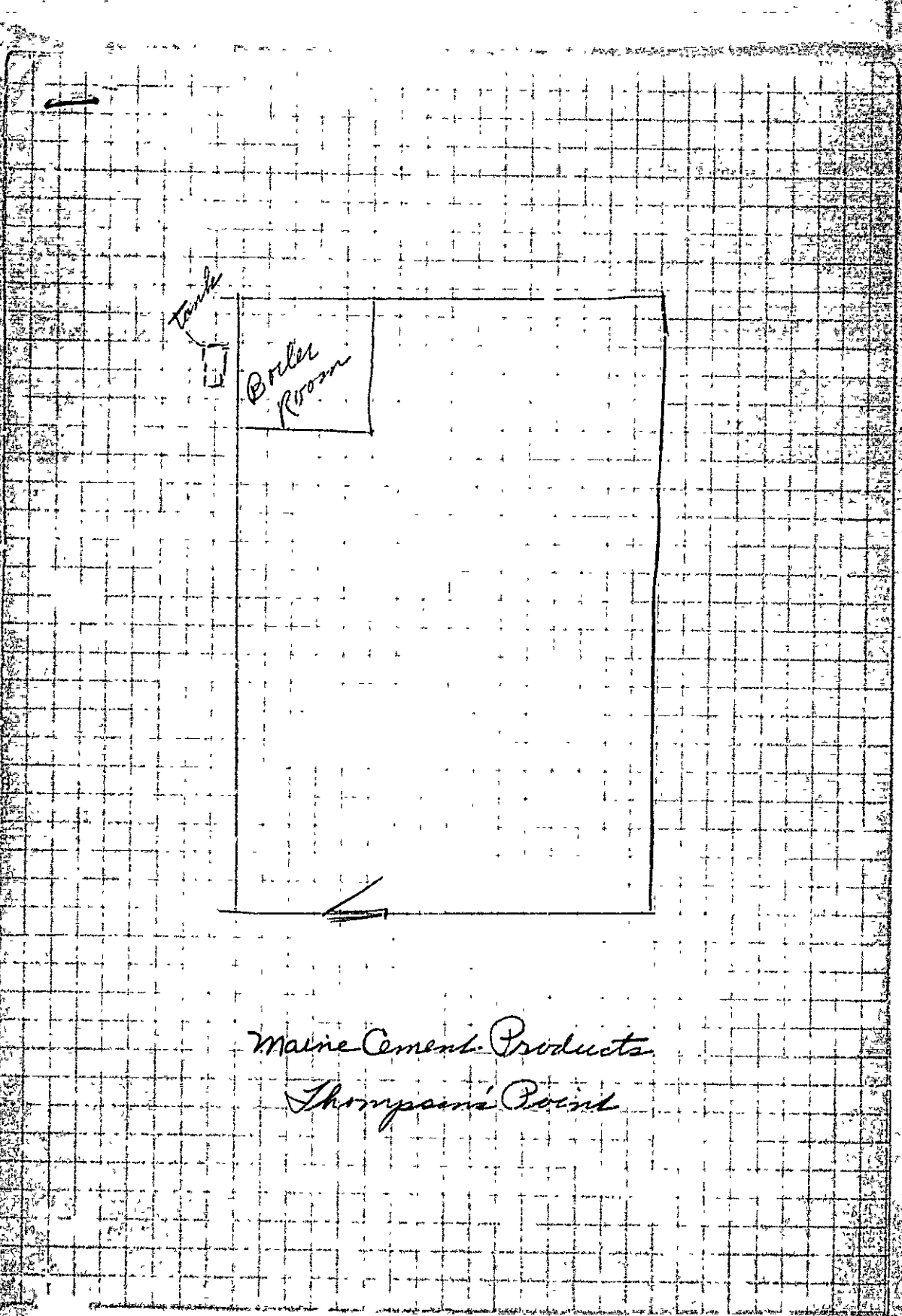

Maine Cement Products  
Thompson's Point

October 26, 1955

AP Thompson's Point--Installation of heating boiler and oil burning equipment for  
Maine Cement Products

Mr. Maurice Colton  
71 Wellington Road

Copy to Maine Cement Products  
Thompson's Point

Dear Mr. Colton:

Building permit for the above installation is issued to you, herewith, subject to the following conditions.

Your application says merely that the oil storage tank is to be outside above ground setting on a concrete slab. This slab is required to be of suitably reinforced concrete at least four inches thick, the top of the slab is to be somewhat higher than the grade of the ground around the slab and the oil supply pipe from tank to burner is required to be of copper tubing or other approved flexible material.

The Chief of the Fire Department has given his required approval on the proposition on that basis.

Very truly yours,

WMcD/B

Warren McDonald  
Inspector of Buildings

7B



# APPLICATION FOR AMENDMENT TO PERMIT

Amendment No. 1

Portland, Maine, Sept. 26, 1955

PERMIT ISSUED

SEP 28 1955

CITY of PORTLAND

To the INSPECTOR OF BUILDINGS, PORTLAND, ME.

The undersigned hereby applies for an amendment to Permit No. 55/1187 pertaining to the building or structure comprised in the original application in accordance with the Laws of the State of Maine, the Building Code and Zoning Ordinance of the City of Portland, plans and specifications, if any, submitted herewith, and the following specifications:

Location Thompson's Point Within Fire Limits? no Dist. No. \_\_\_\_\_  
 Owner's name and address Maine Cement Products, Thompson's Point Telephone \_\_\_\_\_  
 Lessee's name and address \_\_\_\_\_ Telephone \_\_\_\_\_  
 Contractor's name and address Portland Pump, 321 Lincoln St., So. Portland Telephone 2-6336  
 Architect \_\_\_\_\_ Plans filed no No. of sheets \_\_\_\_\_  
 Proposed use of building \_\_\_\_\_ No. families \_\_\_\_\_  
 Increased cost of work \_\_\_\_\_ Additional fee 50

### Description of Proposed Work

To install 5000 gallon tank instead of 4,000 gallon tank.

### Amendment to be issued to Portland Pump Co. Details of New Work

9/26/55  
9/28/55

Is any plumbing work involved in this work? \_\_\_\_\_ Is any electrical work involved in this work? \_\_\_\_\_  
 Height average grade to top of plate \_\_\_\_\_ Height average grade to highest point of roof \_\_\_\_\_  
 Size, front \_\_\_\_\_ depth \_\_\_\_\_ No. stories \_\_\_\_\_ solid or filled land? \_\_\_\_\_ earth or rock? \_\_\_\_\_  
 Material of foundation \_\_\_\_\_ Thickness, top \_\_\_\_\_ bottom \_\_\_\_\_ cellar \_\_\_\_\_  
 Material of underpinning \_\_\_\_\_ Height \_\_\_\_\_ Thickness \_\_\_\_\_  
 Kind of roof \_\_\_\_\_ Rise per foot \_\_\_\_\_ Roof covering \_\_\_\_\_  
 No. of chimneys \_\_\_\_\_ Material of chimneys \_\_\_\_\_ of lining \_\_\_\_\_  
 Framing lumber—Kind \_\_\_\_\_ Dressed or full size? \_\_\_\_\_  
 Corner posts \_\_\_\_\_ Sills \_\_\_\_\_ Girt or ledger board? \_\_\_\_\_ Size \_\_\_\_\_  
 Girders \_\_\_\_\_ Size \_\_\_\_\_ Columns under girders \_\_\_\_\_ Size \_\_\_\_\_ Max. on centers \_\_\_\_\_  
 Studs (outside walls and carrying partitions) 2x4-16" O. C. Bridging in every floor and flat roof span over 8 feet.  
 Joists and rafters: 1st floor \_\_\_\_\_, 2nd \_\_\_\_\_, 3rd \_\_\_\_\_, roof \_\_\_\_\_  
 On centers: 1st floor \_\_\_\_\_, 2nd \_\_\_\_\_, 3rd \_\_\_\_\_, roof \_\_\_\_\_  
 Maximum span: 1st floor \_\_\_\_\_, 2nd \_\_\_\_\_, 3rd \_\_\_\_\_, roof \_\_\_\_\_

Maine Cement Products  
Portland Pump Co.

Approved:

*[Signature]*

INSPECTION COPY

CHIEF OF FIRE DEPT.

Signature of Owner by:

*[Signature]*

Approved:

9/26/55 - *[Signature]*  
Inspector of Buildings.

HOMPSON'S POINT

ROAD WAY

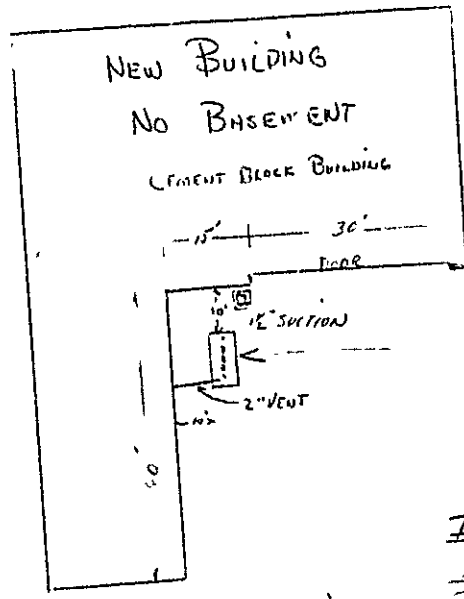

~~4000 GAL TANK~~  
~~48" DIA. X 10' LAM.~~  
 5000 GAL TANK  
 7'-2" DIA X 15' LAM.

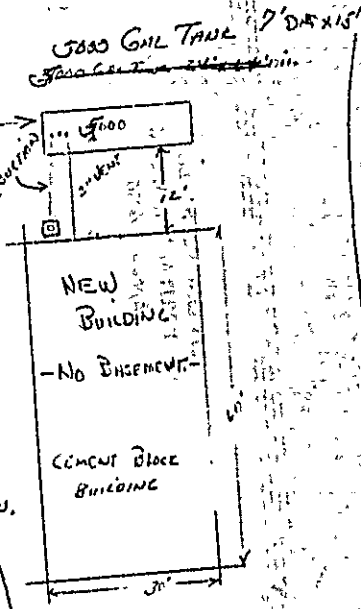

1000 GAL TANK  
 48" DIA. X 10' LAM.

INSTALLATION of 1-1000 GAL + 1-~~4000~~ 5000 GAL TANKS.  
 AT MAINE CEMENT PRODUCTS CO., THOMPSON  
 POINT, PORTLAND, MAINE.

GASOLINE TANK INSTALLATION

WATER

Memorandum from Department of Building Inspection, Portland, Maine  
Thompson's Point--Installation of gasoline storage tanks for Maine  
Cement Products by Portland Pump Co., installers

Before tanks and piping are covered from view, installer is required to notify Fire Department Headquarters of readiness for inspection and to refrain from covering up until approved by the Fire Department.

The tank of 1000 gallons capacity is required to be of steel or wrought iron no less in thickness than No. 10 gauge and the 4000 gallon tank no less than No. 7 gauge; and before installation is required to be protected against corrosion, even though galvanized, by two coats of tar, asphaltum, or other suitable rust-retarding paint, and special protection wherein corrosive soil such as cinders or the like.

Pipe lines connected to underground tanks, other than tubing and except fill lines and test wells, must be provided with double swing joints arranged to permit the tank to settle without impairing the efficiency of the pipe connections.

Owner and installer will have to bear the responsibility for the structural capacity of the tank to support loads from above such as heavy motor trucks.

If tanks will be so located as to be subjected to the action of tide water or "ground" water, adequate anchorage or weighting must be provided to prevent "floating" when tank is empty or nearly so.

3

CC: Maine Cement Products  
Thompson's Point

Harry W. Marr, Chief  
of the Fire Department

(Signed) Warren McDonald  
Inspector of Buildings



# INDUSTRIAL ZONE APPLICATION FOR PERMIT

Class of Building or Type of Structure .. Installation ..

Portland, Maine, .. August 30, 1955

PERMIT ISSUED

501487

CITY of PORTLAND

To the INSPECTOR OF BUILDINGS, PORTLAND, MAINE

The undersigned hereby applies for a permit to ~~construct~~ install the following building structure equipment in accordance with the Laws of the State of Maine, the Building Code and Zoning Ordinance of the City of Portland, plans and specifications, if any, submitted herewith and the following specifications:

Location: Thompson's Point ..... Within Fire Limits? .. Dist. No. ....

Owner's name and address .. Maine Cement Products, Thompson's Point .. Telephone ..

Lessee's name and address .. Telephone ..

Contractor's name and address .. Portland Pump, 321 Lincoln St. So. Portland .. Telephone 2-6336

Architect .. Specifications .. Plans .. No. of sheets

Proposed use of building .. No. families

Last use .. No. families ..

Material .. No. stories .. Heat .. Style of roof .. Roofing ..

Other building on same lot .. Fee \$ 1.00

Estimated cost \$ ..

### General Description of New Work

To install 1-1000 and 1-4000 gallon for gasoline storage to be for private use. Tanks will be 3' underground and painted with asphaltum. Tanks bear Underwriters' Label. No other tanks.

Two electric pumps 1 1/2" piping. 2" vent pipe

**BEFORE** Covering Tank and any Piping **APPROVAL** of FIRE DEPT. Required.

8/30/55  
9/1/55

It is understood that this permit does not include installation of heating apparatus which is to be taken out separately by and in the name of the heating contractor. **PERMIT TO BE ISSUED TO** Portland Pump

### Details of New Work

Is any plumbing involved in this work? .. Is any electrical work involved in this work? ..

Is connection to be made to public sewer? .. If not, what is proposed for sewage? ..

Has septic tank notice been sent? .. Form notice sent? ..

Height average grade to top of plate .. Height average grade to highest point of roof ..

Size, front .. depth .. No. stories .. solid or filled land? .. earth or rock? ..

Material of foundation .. Thickness, top .. bottom .. cellar ..

Material of underpinning .. Height .. Thickness ..

Kind of roof .. Rise per foot .. Roof covering ..

No. of chimneys .. Material of chimneys .. of lining .. Kind of heat .. fuel ..

Framing lumber—Kind .. Dressed or full size? ..

Corner posts .. Sills .. Girt or ledger board? .. Size ..

Girders .. Size .. Columns under girders .. Size .. Max. on centers ..

Studs (outside walls and carrying partitions) 2x4-16" O. C. Bridging in every floor and flat roof span over 8 feet. ..

Joists and rafters: 1st floor .. 2nd .. 3rd .. roof ..

On centers: 1st floor .. 2nd .. 3rd .. roof ..

Maximum span: 1st floor .. 2nd .. 3rd .. roof .. height? ..

If one story building with masonry walls, thickness of walls? ..

### If a Garage

No. cars to be accommodated on same lot .. to be accommodated .. number commercial cars to be accommodated ..

Will automobile repairing be done other than minor repairs to cars habitually stored in the proposed building? ..

### Miscellaneous

Will work require disturbing of any tree on a public street? .. no ..

Will there be in charge of the above work a person competent to see that the State and City requirements pertaining thereto are observed? .. yes ..

APPROVED

*[Signature]*  
CHIEF OF FIRE DEPT.  
O.R. - 9/2/55 - C.P.S.

Maine Cement Products  
Portland Pump

Signature of owner By: *[Signature]*

C16-354-1M-Mark

INSPECTION COPY

Permit No. 55/1487

Location *Manassas Park*

Owner *Manassas Company Products*

Date of permit 9/2/55

Notif. closing-in

Inspn. closing-in

Final Notif.

Final Inspn.

Cert. of Occupancy Issued

Staking Out Notice

Form Check Notice

NOTES

11-29-55 (1) *10/1/55*

Large ruled area for notes, mostly blank with a large handwritten 'X' across the top portion.



# APPLICATION FOR AMENDMENT TO PERMIT

Amendment No. #1

Portland, Maine, June 6, 1955

**PERMIT ISSUED**

**JUN 19 1955**

**CITY OF PORTLAND**

To the INSPECTOR OF BUILDINGS, PORTLAND, ME.

The undersigned hereby applies for an amendment to Permit No. 55/556 pertaining to the building or structure comprised in the original application in accordance with the Laws of the State of Maine, the Building Code and Zoning Ordinance of the City of Portland, plans and specifications, if any, submitted hereunder, and the following specifications:

Location Thompson's Point Within Fire Limits? no Dist. No. \_\_\_\_\_  
 Owner's name and address Veazie Realty Inc., State St., Bangor Telephone \_\_\_\_\_  
 Lessee's name and address Kaire Cement Products Co. Telephone \_\_\_\_\_  
 Contractor's name and address Fusco & Ricchio, 240 Sherwood St. Telephone \_\_\_\_\_  
 Architect \_\_\_\_\_ Plans filed yes No. of sheets 5  
 Proposed use of building Manufacture of cement products No. families \_\_\_\_\_  
 Increased cost of work \_\_\_\_\_ Additional fee .50

### Description of Proposed Work

To construct steel and concrete aggregate bin addition as per plans.

Details of New Work Veazie Realty Co., Inc.  
Box 1059, Portland

Is any plumbing work involved in this work? \_\_\_\_\_ Is any electrical work involved in this work? \_\_\_\_\_  
 Height average grade to top of plate \_\_\_\_\_ Height average grade to highest point of roof \_\_\_\_\_  
 Size, front \_\_\_\_\_ depth \_\_\_\_\_ No. stories \_\_\_\_\_ solid or filled land? \_\_\_\_\_ earth or rock? \_\_\_\_\_  
 Material of foundation \_\_\_\_\_ Thickness, top \_\_\_\_\_ bottom \_\_\_\_\_ cellar \_\_\_\_\_  
 Material of underpinning \_\_\_\_\_ Height \_\_\_\_\_ Thickness \_\_\_\_\_  
 Kind of roof \_\_\_\_\_ Rise per foot \_\_\_\_\_ Roof covering \_\_\_\_\_  
 No. of chimneys \_\_\_\_\_ Material of chimneys \_\_\_\_\_ of lining \_\_\_\_\_  
 Framing lumber—Kind \_\_\_\_\_ Dressed or full size? \_\_\_\_\_  
 Corner posts \_\_\_\_\_ Sills \_\_\_\_\_ Girt or ledger board? \_\_\_\_\_ Size \_\_\_\_\_  
 Girders \_\_\_\_\_ Size \_\_\_\_\_ Columns under girders \_\_\_\_\_ Size \_\_\_\_\_ Max. on centers \_\_\_\_\_  
 Studs (outside walls and carrying partitions) 2x4-16" O. C. Bridging in every floor and flat roof span over 8 feet.  
 Joists and rafters: 1st floor \_\_\_\_\_, 2nd \_\_\_\_\_, 3rd \_\_\_\_\_, roof \_\_\_\_\_  
 On centers: 1st floor \_\_\_\_\_, 2nd \_\_\_\_\_, 3rd \_\_\_\_\_, roof \_\_\_\_\_  
 Maximum span: 1st floor \_\_\_\_\_, 2nd \_\_\_\_\_, 3rd \_\_\_\_\_, roof \_\_\_\_\_

Approved:

O.K. 7/19/55 - agf

Signature of Owner By: [Signature]  
7/19/55 [Signature]

Approved: \_\_\_\_\_ Inspector of Buildings.



AP - Thompson's Point

April 27, 1955

<sup>O</sup>  
Owner - Vennie Realty Inc.  
State Street  
Bangor, Maine

<sup>C</sup>  
Lessee - Maine Cement Products  
Bangor, Maine

<sup>C</sup>  
Contractor - Fusco & Nicchio  
240 Sherwood St.

Building permit for construction of a one story masonry building at the above location is issued herewith based on revised plans filed April 22, 1955 but subject to the following conditions:

1. Construction of aggregate bin addition is excluded from work covered by this permit since no details of its construction have as yet been furnished. When necessary information is available, such work can be covered by an amendment to the permit now being issued.
2. Division of the building into fire areas as indicated keeps the largest area within the 10,000 square foot maximum allowable for Non-combustible construction. However, if the area of the aggregate bin addition were to exceed the approximately 800 square feet indicated, the maximum allowable area within fire walls would be exceeded.
3. Unless the fabrication of the long span steel joists is to be done by welders certified for such work in the City of Portland, certification in writing by the manufacturer of the joists to the effect that all welding has been designed and all shop welding has been performed according to the procedure and by properly qualified welders as set forth in the Code and qualification procedure established by the American Welding Society is required to be on file at this office before work of erection of the joists is started.
4. A certificate of occupancy is required from this department before the building is put into use.
5. Voids in concrete block walls are required to be filled with concrete at all points where concentrated loads from roof beams are carried on walls.

Very truly yours,

Warren McDonald  
Inspector of Buildings

AJS/H



# APPLICATION FOR PERMIT

Class of Building or Type of Structure \_\_\_\_\_

Portland, Maine, April 8, 1955

To the INSPECTOR OF BUILDINGS, PORTLAND, ME.

The undersigned hereby applies for a permit to erect ~~abandoned~~ at the following building ~~located~~ in accordance with the Laws of the State of Maine, the Building Code and Zoning Ordinance of the City of Portland, plans and specifications, if any, submitted herewith and the following specifications:

Location Thompson's Point Within Fire Limits? no Dist No. \_\_\_\_\_

Owner's name and address Veazie Realty Inc., State St. Veazie, Bangor Telephone \_\_\_\_\_

Lessee's name and address Maine Cement Products Co. Telephone 2-5485

Contractor's name and address Fusco & Ricchio, 240 Sherwood St. Telephone \_\_\_\_\_

Architect Rudolph L. Viallette, Maine Cement Products, Bangor Telephone \_\_\_\_\_

Proposed use of building Manufacture of cement products Plans yes No. of sheets 6

Last use \_\_\_\_\_ No. families \_\_\_\_\_

Material \_\_\_\_\_ No. stories \_\_\_\_\_ Heat \_\_\_\_\_ Style of roof \_\_\_\_\_ Roofing \_\_\_\_\_

Other buildings on same lot \_\_\_\_\_

Estimated cost \$ 50,000. Fee \$ 50.00

## General Description of New Work

To construct 1-story masonry building approximately 150' x 190' as per plans.

Permit Issued with Letter

It is understood that this permit does not include installation of heating apparatus which is to be taken out separately by and in the name of the heating contractor.  
Permit to be issued to Box 1050, Maine Cement Products Co.

## Details of New Work

Is any plumbing work involved in this work? \_\_\_\_\_ Is any electrical work involved in this work? \_\_\_\_\_

Height average grade to top of plate \_\_\_\_\_ Height average grade to highest point of roof \_\_\_\_\_

Size, front \_\_\_\_\_ depth \_\_\_\_\_ No. stories \_\_\_\_\_ solid or filled land? solid earth or rock? earth

Material of foundation \_\_\_\_\_ Thickness, top \_\_\_\_\_ bottom \_\_\_\_\_ cellar \_\_\_\_\_

Material of underpinning \_\_\_\_\_ Height \_\_\_\_\_ Thickness \_\_\_\_\_

Kind of roof \_\_\_\_\_ Rise per foot \_\_\_\_\_ Roof covering \_\_\_\_\_ From central heating at \_\_\_\_\_

No. of chimneys \_\_\_\_\_ Material of chimneys \_\_\_\_\_ of lining \_\_\_\_\_ Kind of heat steam fuel oil

Framing lumber—Kind \_\_\_\_\_ Dressed or full size? \_\_\_\_\_ Thompson's Point

Corner posts \_\_\_\_\_ Sills \_\_\_\_\_ Girt or ledger board? \_\_\_\_\_ Size \_\_\_\_\_

Girders \_\_\_\_\_ Size \_\_\_\_\_ Columns under girders \_\_\_\_\_ Size \_\_\_\_\_ Max. on centers \_\_\_\_\_

Studs (outside walls and carrying partitions) 2x1-16" O. C. Bridging in every floor and flat roof span over 8 feet.

Joists and rafters: 1st floor \_\_\_\_\_, 2nd \_\_\_\_\_, 3rd \_\_\_\_\_, roof \_\_\_\_\_

On centers: 1st floor \_\_\_\_\_, 2nd \_\_\_\_\_, 3rd \_\_\_\_\_, roof \_\_\_\_\_

Maximum span: 1st floor \_\_\_\_\_, 2nd \_\_\_\_\_, 3rd \_\_\_\_\_, roof \_\_\_\_\_

If one story building with masonry walls, thickness of walls? 8" & 12" height? 16'

## If a Garage

No. cars now accommodated on same lot \_\_\_\_\_ to be accommodated \_\_\_\_\_ number commercial cars to be accommodated \_\_\_\_\_

Will automobile repairing be done other than minor repairs to cars habitually stored in the proposed building? \_\_\_\_\_

APPROVED:

*with letter by AGJ*

## Miscellaneous

Will work require disturbing of any tree on a public street? no

Will there be in charge of the above work a person competent to see that the State and City requirements pertaining thereto observed? yes

Veazie Realty Inc.

Signature of owner by *James Tracy Treasurer*

INSPECTION COPY





APPLICATION FOR PERMIT

PERMIT ISSUED

JUL 19 1955

Class of Building or Type of Structure \_\_\_\_\_

Portland, Maine, July 8, 1955

To the INSPECTOR OF BUILDINGS, PORTLAND, ME.

CITY OF PORTLAND

The undersigned hereby applies for a permit to erect ~~the following building~~ in accordance with the Laws of the State of Maine, the Building Code and Zoning Ordinance of the City of Portland, plans and specifications, if any, submitted herewith and the following specifications:

Location Thompson's Point Within Fire Limits? n Dist. No.
Owner's name and address Veazie Realty Inc., Veazie Road, Bangor, Maine Telephone
Lessor's name and address Telephone
Contractor's name and address Fusco & Richio, 240 Sherwood St. Telephone
Architect Specifications Plans yes No. of sheets 2
Proposed use of building office No. families
Last use No. families
Material No. stories Heat Style of roof Roofing
Other buildings on same lot
Estimated cost \$ 23,000 Fee \$ 5.00

General Description of New Work

To construct 1-story concrete and steel office building 56' x 32' as per plans.

Permit Issued with Letter

It is understood that this permit does not include installation of heating apparatus which is to be taken out separately by and in the name of the heating contractor. Permit to be mailed to Maine Cement Products Co., Box 1059

Details of New Work

Is any plumbing work involved in this work? Is any electrical work involved in this work?
Height average grade to top of plate Height average grade to highest point of roof
Size, front depth No. stories solid or filled land? earth or rock?
Material of foundation Thickness, top bottom cellar
Material of underpinning Height Thickness
Kind of roof Rise per foot Roof covering
No. of chimneys Material of chimneys of lining Kind of heat hot water oil
Framing lumber-Kind Dressed or full size?
Corner posts Sills Girt or ledger board? Size
Girders Size Columns under girders Size Max. on center
Studs (outside walls and carrying partitions) 2x4-16" O. C. Bridging in every floor and flat roof span over 8 feet.
Joists and rafters: 1st floor, 2nd, 3rd, roof
On centers: 1st floor, 2nd, 3rd, roof
Maximum span: 1st floor, 2nd, 3rd, roof
If one story building with masonry walls, thickness of walls? height?

If a Garage

No. cars now accommodated on same lot to be accommodated number commercial cars to be accommodated
Will automobile repairing be done other than minor repairs to cars habitually stored in the proposed building?

APPROVED: with letter by J.P.

Miscellaneous

Will work require disturbing of any tree on a public street? no
Will there be in charge of the above work a person competent to see that the State and City requirements pertaining thereto are observed? yes

Veazie Realty Inc.

Signature of owner by: [Signature]