





(A) APARTMENT HOUSE ZONE  
APPLICATION FOR PERMIT

Class of Building or Type of Structure Third Class  
Portland, Maine, July 12, 1948

PERMIT ISSUED  
JUL 22 1948  
CITY of PORTLAND

To the INSPECTOR OF BUILDINGS, PORTLAND, MAINE

The undersigned hereby applies for a permit to ~~erect~~ alter ~~repair~~ ~~demolish~~ ~~construct~~ all the following building structure equipment in accordance with the Laws of the State of Maine, the Building Code and Zoning Ordinance of the City of Portland, plans and specifications, if any, submitted herewith and the following specifications:

Location Eastern Ave., Long Island Within Fire Limits? no Dist. No. \_\_\_\_\_  
Cleaves Ldg.  
Owner's name and address Raymond R. Sharkey, Long Island Telephone \_\_\_\_\_  
Lessee's name and address \_\_\_\_\_ Telephone \_\_\_\_\_  
Contractor's name and address owners Telephone \_\_\_\_\_  
Architect \_\_\_\_\_ Specifications \_\_\_\_\_ Plans no No. of sheets \_\_\_\_\_  
Proposed use of building Cottage No. families \_\_\_\_\_  
Last use \_\_\_\_\_ No. families \_\_\_\_\_  
Material frame No. stories 1 Height \_\_\_\_\_ Style of roof pitch Roofing \_\_\_\_\_  
Other buildings on same lot outside of lot  
Estimated cost \$ 100. 125. Fee \$ 50 1.00

General Description of New Work

To construct 5'x20' roof over existing platform street end of building - screen in piazza.

To construct 4'x4' addition to existing out building for tool shed, screens, etc.  
concrete block on top of ground; 4x6 sill; 2x6 floor joists, 16" O.C., 4' span;  
2-2x4 corner posts; 2x4 rafters, 16" O.C.; 5' to plate and 7' to highest point.

NOTIFICATION BEFORE LATHING  
OR CLOSING-IN IS WAIVED

3-2x4 plate - 4' span

Permit Issued with Letter

It is understood that this permit does not include installation of heating apparatus which is to be taken out separately by and in the name of the heating contractor. PERMIT TO BE ISSUED TO owners

CERTIFICATE OF OCCUPANCY  
REQUIREMENT IS WAIVED

Details of New Work

Is any plumbing involved in this work? \_\_\_\_\_ Is any electrical work involved in this work? \_\_\_\_\_  
Height average grade to top of plate 6' Height average grade to highest point of roof 7'  
Size, front \_\_\_\_\_ depth \_\_\_\_\_ No. stories 1 solid or filled land? solid earth or rock? earth  
Material of foundation concr. posts Thickness, top \_\_\_\_\_ bottom \_\_\_\_\_ cellar \_\_\_\_\_  
Material of underpinning existing Height \_\_\_\_\_ Thickness \_\_\_\_\_  
Kind of roof shed Rise per foot 2" Roof covering asphalt roofing Class C Unc. Lab.  
No. of chimneys \_\_\_\_\_ Material of chimneys \_\_\_\_\_ of lining \_\_\_\_\_ Kind of heat \_\_\_\_\_ fuel \_\_\_\_\_  
Framing lumber—Kind hemlock Dressed or full size? dressed  
Corner posts 3 4x4 Sills \_\_\_\_\_ Girt or ledger board? \_\_\_\_\_ Size \_\_\_\_\_  
Girders \_\_\_\_\_ Size \_\_\_\_\_ Columns under girders \_\_\_\_\_ Size \_\_\_\_\_ Max. on centers \_\_\_\_\_  
Studs (outside walls and carrying partitions) 2x4-16" O. C. Bridging in every floor and flat roof span over 8 feet.  
Joists and rafters: 1st floor \_\_\_\_\_, 2nd \_\_\_\_\_, 3rd \_\_\_\_\_, roof 2x6  
On centers: 1st floor \_\_\_\_\_, 2nd \_\_\_\_\_, 3rd \_\_\_\_\_, roof 16"  
Maximum span: 1st floor \_\_\_\_\_, 2nd \_\_\_\_\_, 3rd \_\_\_\_\_, roof 5'  
If one story building with masonry walls, thickness of walls? \_\_\_\_\_ height? \_\_\_\_\_

If a Garage

No. cars now accommodated on same lot \_\_\_\_\_, to be accommodated \_\_\_\_\_ number commercial cars to be accommodated \_\_\_\_\_  
Will automobile repairing be done other than minor repairs to cars habitually stored in the proposed building? \_\_\_\_\_

APPROVED:

OK with letter - AJS

Miscellaneous

Will work require disturbing of any tree on a public street? no  
Will there be in charge of the above work a person competent to see that the State and City requirements pertaining thereto are observed? yes

INSPECTION COPY

Signature of owner

Raymond S. Sharkey

NOTES

71546 Permitted Under the Code  
did not show him location of  
not home & P

6-2-49 Work not done  
Left  
(entire job)

City of Occupancy Issued  
ATKINS LEGAL SERVICE  
STATE WASH

Final Inspn.

Inspn. closing-in

Final Notif.

Notif. closing-in

Date of permit 7/22/48

Owner R. J. ...

Location ...

Permit No. 48/1220

Multiple lines of faint, mostly illegible text, likely bleed-through from the reverse side of the page.

EASTERN AVENUE

10'

78'

5'

RIGHT OF WAY  
115'

RIGHT OF WAY  
113'

PROPOSED ADDITION

EXISTING SHED

PUT ROOF OVER EXISTING  
PLATFORM + CORRELIN

20'

10'

EXISTING OPEN PLAZA

WATER

Vertical text on the left margin, possibly a scale or reference note.

104-D-46-3000<sup>B</sup>'

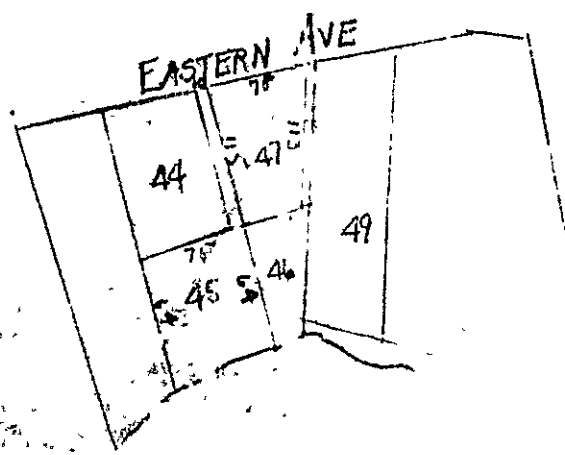

7/17/48

Mr. Shuck will not be  
here until a week or so.  
Bat (Gajon) has got a  
pair of birds nesting in  
about 5 x 10' with 4 birds.  
Right side (near inlet of  
bay) with very little.

ES

Water

Eastern Ave. Long Rd  
104-1-46

1/2" pipe, or painted  
cut by the shading  
at least 10'

5'

1/2" pipe  
shading said  
2' to 2 1/2' from edge

RECEIVED  
JUL 10 1948  
DEPT. OF BLD'G. INSP.  
CITY OF PORTLAND

214 N. 21st St

100 Eastern Ave., Long  
Island-1

July 21, 1948

Mr. Raymond R. Sharkey  
Long Island, Maine

Subject: Permit for construction  
of roof over existing platform  
on rear of cottage and addition  
to out-house off Eastern Avenue,  
Long Island

Dear Sir:

The permit for the above work is issued herewith subject  
to the following:

1. All parts of the existing platform are to be repaired  
and replaced where necessary before roof is provided over it.
2. The double 2x4 plate for supporting outer ends of  
rafters of new roof should be framed with the 2x4's placed with  
the 4" dimension upright. The rafters may be made 2x4, 24" on  
centers instead of the 2x6, 13" on centers as given in applica-  
tion, if desired

Very truly yours,

Inspector of Buildings

AJS/S





PERMIT ISSUED

# APPLICATION FOR PERMIT TO REPAIR BUILDING

Third Class Building

JUN 17 1939

Portland, Maine, June 17, 1939

To the INSPECTOR OF BUILDINGS, PORTLAND, ME.

The undersigned hereby applies for a permit to repair the following described building in accordance with the Laws of Maine, the Building Code of the City of Portland, and the following specifications:

Location Western Avenue, Long Island Ward 1st Within fire limits? no Dist. No. \_\_\_\_\_

Owner's name and address L. W. Rockwell, Topfield, Mass Telephone \_\_\_\_\_

Contractor's name and address Thomas Wood, Long Island Telephone \_\_\_\_\_

Use of building Cottage

No. stories 1 Height \_\_\_\_\_ ft., Gross area \_\_\_\_\_ sq ft., Style of roof pitch

Type of present roof covering wood

### General Description of New Work

To cover entire roof

### If Roof Covering is to be Repaired or Renewed

When last repaired? \_\_\_\_\_, Area then repaired \_\_\_\_\_ sq. ft.

Are repairs or renewal due to damage by fire? no If so what areas damaged? \_\_\_\_\_ sq. ft.

Area of roof to be repaired now: entire sq.

Type of roofing to be used Asphalt roofing No. plies \_\_\_\_\_

Trade name and grade of roof covering to be used Class C Euc. Ltd.

Estimated cost \$ \_\_\_\_\_ L. W. Rockwell Fee \$ .50

Signature of owner

by

*L. W. Rockwell*

INSPECTION COPY

104-1-116

Ward 2d / Permit No. 39/834

Location Eastern Ave., Long Isl.

Owner L. W. Rockwell

Date of permit: 6/17/39

Notif. closing-in

Inspn. closing-in

Final Notif.

Final Inspn.

Cert. of Occupancy issued

NOTES

[Large area of horizontal lines for notes, with a large handwritten 'X' drawn across the middle section.]



APARTMENT HOUSE ZONE  
APPLICATION FOR PERMIT

PERMIT ISSUED

Class of Building or Type of Structure Third Class

Portland, Maine, July 27, 1925

To the INSPECTOR OF BUILDINGS, PORTLAND, ME.

The undersigned hereby applies for a permit to erect alter or install the following building structure equipment in accordance with the Laws of the State of Maine, the Building Code of the City of Portland, plans and specifications, if any, submitted herewith and the following specifications:

Location Off Eastern Ave, Long Island Ward 1st Within Fire Limits? Yes

Owner's name and address L. A. Rowwell, Long Island Telephone 204-23

Contractor's name and address J. M. Gray, Long Island Telephone 204-23

Architect's name and address \_\_\_\_\_

Proposed use of building Cottage No. families \_\_\_\_\_

Other Buildings on same lot \_\_\_\_\_

Plans filed as part of this application no No. of sheets \_\_\_\_\_

Estimated cost \$ 75 For \$ 50

Description of Present Building to be Altered

Material wood No. stories 1 Style of roof \_\_\_\_\_ Roofing \_\_\_\_\_

Last use Co. No. families \_\_\_\_\_

General Description of New Work

To put roof over existing side platform 28' x 6'

5' to right of way  
NOTIFICATION BEFORE LATITUDE  
OR CLOSING IN IS WAIVED

CERTIFICATE OF OCCUPANCY  
REQUIREMENT FULFILLED IN THE NAME OF

It is understood that this permit does not include installation of heating apparatus which to be taken out separately by and in the name of the heating contractor

Details of New Work

Size, front \_\_\_\_\_ depth \_\_\_\_\_ No. stories \_\_\_\_\_ Height average grade to top of plate \_\_\_\_\_

To be erected on solid or filled land? \_\_\_\_\_ Height average grade to highest point of roof \_\_\_\_\_

Material of foundation existing cedar posts earth or rock? \_\_\_\_\_

Material of underpinning \_\_\_\_\_ Thickness, top \_\_\_\_\_ bottom \_\_\_\_\_

Material of underpinning \_\_\_\_\_ Height \_\_\_\_\_ Thickness \_\_\_\_\_

Kind of Roof flat Rise per foot 2" Roof covering asphalt roofing, Class D Ins., Lat.

No. of chimneys \_\_\_\_\_ Material of chimneys \_\_\_\_\_ of lining \_\_\_\_\_

Kind of heat \_\_\_\_\_ Type of fuel \_\_\_\_\_ Is gas fitting involved? \_\_\_\_\_

Corner posts \_\_\_\_\_ Sills \_\_\_\_\_ Girt or ledger board? \_\_\_\_\_ Size \_\_\_\_\_

Material columns under girders \_\_\_\_\_ Size \_\_\_\_\_ Max. on center \_\_\_\_\_

Studs (outside walls and carrying partitions) 2x4-10" O. C. Girders 6x8 or larger. Bridging \_\_\_\_\_

Joists and rafters: 1st floor \_\_\_\_\_, 2nd \_\_\_\_\_, 3rd \_\_\_\_\_

On centers: 1st floor \_\_\_\_\_, 2nd \_\_\_\_\_, 3rd \_\_\_\_\_

Maximum span: 1st floor \_\_\_\_\_, 2nd \_\_\_\_\_, 3rd \_\_\_\_\_ roof 5'

If one story building with masonry walls, thickness of walls? \_\_\_\_\_ height \_\_\_\_\_

If a Garage

No. cars now accommodated on same lot \_\_\_\_\_, to be accommodated \_\_\_\_\_

Total number commercial cars to be accommodated \_\_\_\_\_

Will automobile repairing be done other than minor repairs to cars habitually stored in the proposed building? \_\_\_\_\_

Miscellaneous

Will above work require removal or disturbing of any shade tree on a public street? no

Will there be in charge of the above work a person competent to see that the State and City requirements pertaining are observed? yes

INSPECTION COPY

Signature of owner L. A. Rowwell

War. Dept. Permit No. 35/1034

Location (City) Eastern Ave. Long Isl.

Owner: G. G. Gockwell

Permit 7/17/35

Disp. by

Disp. by

Final No.:

Final Invt. 7/2/36 C.D.

Cert. of Occupancy issued None

NOTES

Gate "Walden" 104

I

4-6-35

