

EASTERN AVE. (YWCA) LONG ISLAND
104-C-1

SHAW-WALKER



STUDS 2X4
 COVER POST 4X4
 RAFTERS 2X6
 MATCHED LINE
 ROOFERS 1X7
 FELT ROOFING PAPER
 MINERIAL ROOFING

VALUE - 400.00

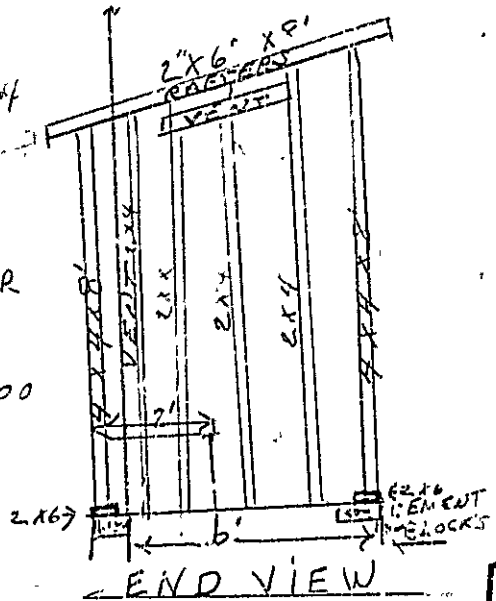

RECEIVED
 MAY 15 1974
 DEPT. OF BLDG. INSP.
 CITY OF PORTLAND

104-6-1 Custom Ave, Long Mel.

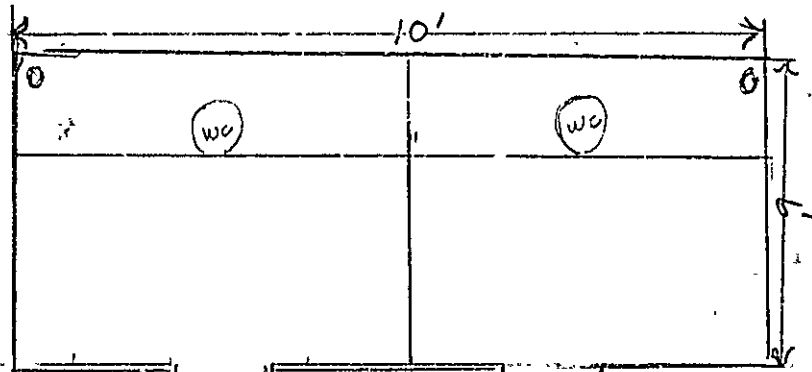

FLOOR PLAN



APPLICATION FOR PERMIT

PERMIT ISSUED

MAY 16 1974

B.O.C.A. USE GROUP

00433

B.O.C.A. TYPE OF CONSTRUCTION

ZONING LOCATION _____ PORTLAND, MAINE, May 15, 1974...

CITY of PORTLAND

To the DIRECTOR OF BUILDING & INSPECTION SERVICES, PORTLAND, MAINE

The undersigned hereby applies for a permit to erect, alter, repair, demolish, move or install the following building, structure, equipment or change use in accordance with the Laws of the State of Maine, the Portland B.O.C.A. Building Code and Zoning Ordinance of the City of Portland with plans and specifications, if any, submitted herewith and the following specifications:

LOCATION: 104-G-1 Eastern Ave Long Island Fire District #1 #2

1. Owner's name and address: YWCA, Portland Me. Telephone

2. Lessee's name and address:

3. Contractor's name and address: J. E. O'Leary, 20 Goudy St., So Portland Telephone 799-6704

4. Architect:

Proposed use of building: PRIVY Specifications Plans No. of sheets

Last use:

Material: frame No. stories: 1 Heat

Other buildings on same lot:

Estimated contractual cost: \$ 400.00 No. families:

Roofing:

Fee \$: 3.00

FIELD INSPECTOR—Mr. Nelson Garbrielt GENERAL DESCRIPTION

This application is for: @ 775-5451

Dwelling Ext. 234

Garage

Masonry Bldg.

Metal Bldg.

Alterations

Demolitions

Change of Use

Other

To construct an 10'x6' foot privy per plan, set on 16"x8" inch-conc blocks, 2x6 sills, 4x4 corner posts with 2x4 studs. 2" rafters slant roof covered with rolled asphalt paper. Stamp of Special Conditions.

NOTE TO APPLICANT: Separate permits are required by the installers and subcontractors of heating, plumbing, electrical and mechanicals.

PERMIT IS TO BE ISSUED TO 1 2 3 4

Other:

DETAILS OF NEW WORK

Is any plumbing involved in this work? no Is any electrical work involved in this work? no

Is connection to be made to public sewer? If not, what is proposed for sewage?

Has septic tank notice been sent? Form notice sent?

Height average grade to top of plate 7.15' average grade to highest point of roof

Size, front depth No. stories solid or filled land? earth or rock?

Material of foundation Thickness, top bottom cellar

Kind of roof Rise per foot Roof covering

No. of chimney Material of chimneys of lining Kind of heat fuel

Framing Lumber—Kind Dressed or full size Corner posts Sills

Size Girder Columns under girders Size Max. on centers

Studs (outside walls and carrying partitions) 2x4-16" G. C. Bridging in every floor and flat roof span over 8 feet.

Joists and rafters: 1st floor 2nd 3rd roof

On centers: 1st floor 2nd 3rd roof

Maximum span: 1st floor 2nd 3rd roof

If one story building with masonry walls, thickness of walls? height?

IF A GARAGE

No. cars now accommodated on same lot, to be accommodated ... number commercial cars to be accommodated ...

Will automobile repairing be done other than minor repairs to cars habitually stored in the proposed building?

APPROVALS BY: DATE

BUILDING INSPECTION—PLAN EXAMINER

ZONING:

BUILDING CODE:

Fire Dept.:

Health Dept.:

Others: *Wm. O. O'Leary*

MISCELLANEOUS

Will work require disturbing of any tree on a public street?

Will there be in charge of the above work a person competent to see that the State and City requirements pertaining thereto are observed?

Wm. O. O'Leary Signature of Applicant Phone # 799-6704

Type Name of above

FIELD INSPECTOR'S COPY

Other and Address

PERMIT ISSUED

000000

NOTES

Permit No. 74/433
 Location 104-G-1
 Owner KWCT
 Date of permit 5/16/74
 Approved _____

*Customs
 Tony Wilson*

ml...

6-21-74 Completed

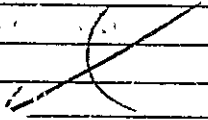

Below the permit information and notes, there are two large rectangular sections, each containing multiple horizontal lines for additional notes or specifications. The bottom portion of these sections is heavily obscured by a dark, grainy stamp or shadow.

104-G-1 Eastern Ave., Long Island

June 14, 1973

cc to: YMCA, 87 Spring Street

James E. O'Leary
20 Gandy Street
So. Portland

Dear Mr. O'Leary:

Building permit to construct a one story frame building 20' x 30' replacing existing building that was at this location is being issued with the understanding that, the existing sewage system may be used for this building.

Very truly yours,

A. Allan Soule
Assistant Director

AAS:R



APPLICATION FOR AMENDMENT TO PERMIT

Amendment No.
Portland, Maine, July 30, 1973

PERMIT ISSUED

JUL 30 1973

CITY of PORTLAND

To the INSPECTOR OF BUILDINGS, PORTLAND, MAINE

The undersigned hereby applies for amendment to Permit No. 73/631 pertaining to the building or structure comprised in the original application in accordance with the Laws of the State of Maine, the Building Code and Zoning Ordinance of the City of Portland, plans and specifications, if any, submitted herewith, and the following specifications:

Location Eastern Ave., Long Island Within Fire Limits? Dist. No.
 Owner's name and address YWCA, 87 Spring St Telephone
 Lessee's name and address Telephone
 Contractor's name and address James E. O'Leary, 20 Goudy St., So Portland Telephone 799-6704
 Architect Plans filed No. of sheets
 Proposed use of building YWCA. Rec room No. families
 Last use No. families
 Increased cost of work Additional fee 3.00

Description of Proposed Work

construct a 16x8 toilet room, wood frame on existing foundation, to ventilate with fan or operable windows as per plan.

Details of New Work

Is any plumbing involved in this work? Is any electrical work involved in this work?
 Height average grade to top of plate Height average grade to highest point of roof
 Size, front depth No. stories solid or filled land? earth or rock?
 Material of foundation Thickness, top bottom cellar
 Material of underpinning Height Thickness
 Kind of roof Rise per foot Roof covering
 No. of chimneys Material of chimneys of lining
 Framing lumber - Kind Dressed or full size?
 Corner posts Sills Girt or ledger board? Size
 Girders Size Columns under girders Size Max. on centers
 Studs (outside walls and carrying partitions) 2x4-16" O. C. Bridging in every floor and flat roof span over 8 feet.
 Joists and rafters: 1st floor 2nd 3rd roof
 On centers: 1st floor 2nd 3rd roof
 Maximum spacing: 1st floor 2nd 3rd roof

Approved: *W.F.C.*

Signature of Owner *J.E. O'Leary - YWCA*

Inspector of Buildings

104

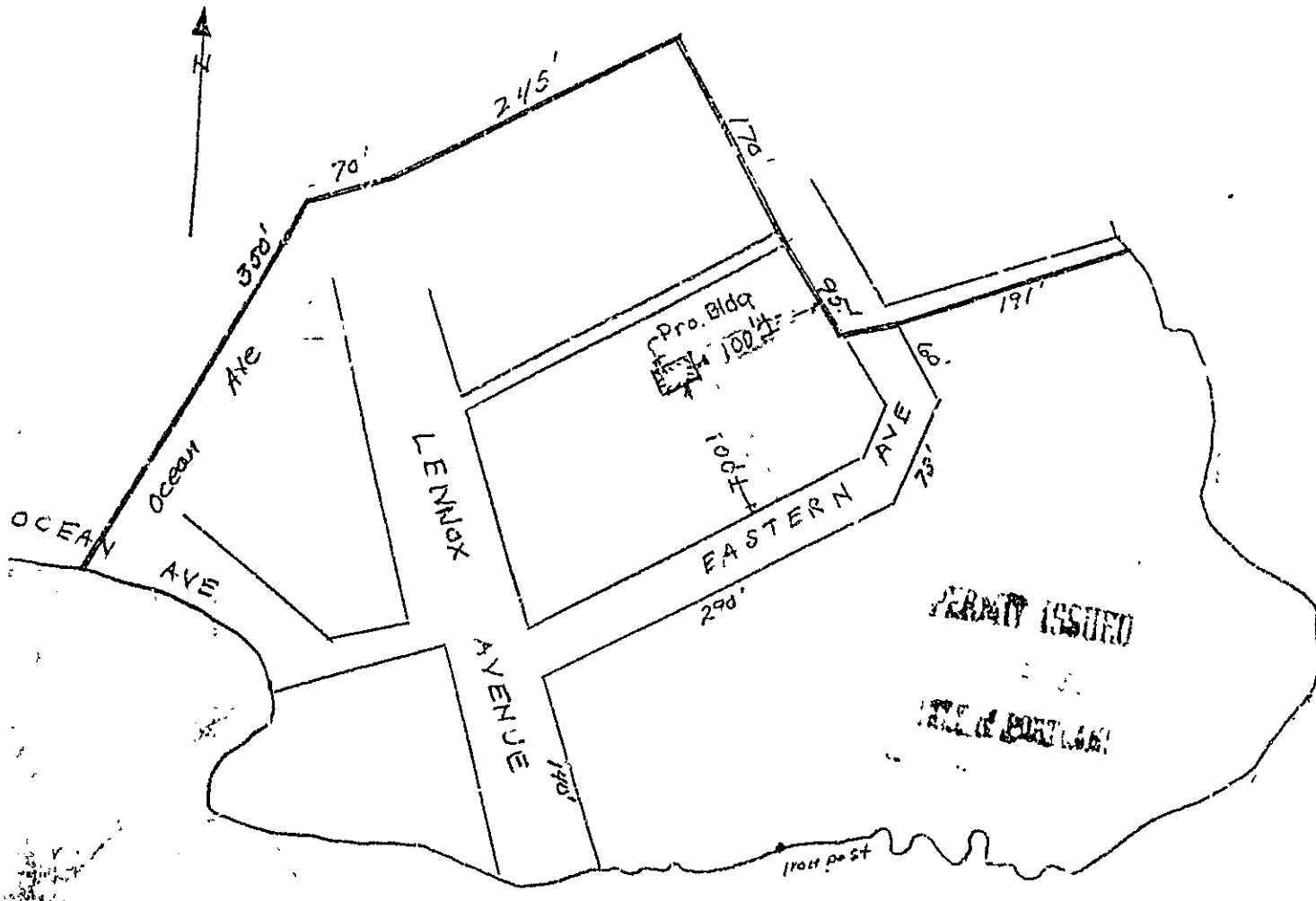

PROPOSED BUILDING - LONG ISLAND ME.
20' X 30'



B3 RESIDENCE ZONE

APPLICATION FOR PERMIT

Class of Building or Type of Structure _____

Portland, Maine, June 12, 1973

PERMIT ISSUED

JUN 14 1973

00631 CITY OF PORTLAND

To the INSPECTOR OF BUILDINGS, PORTLAND, MAINE

The undersigned hereby applies for a permit to erect alter repair demolish install the following building structure equipment in accordance with the Laws of the State of Maine, the Building Code and Zoning Ordinance of the City of Portland, plans and specifications, if any, submitted herewith and the following specifications:

10A- Education Eastern Ave. Long Island Within Fire Limits? Dist. No. Owner's name and address Y.W.C.A., 87 Spring St. Telephone Lessee's name and address Contractor's name and address James E. O'Leary, 20 Goudy St. So. Portland Telephone 799-6704 Architect Specifications Plans yes No. of sheets 4-5 Proposed use of building YWCA Rec. room No. families Last use No. families Material No. stories Heat Style of roof Roofing Other buildings on same lot Estimated cost \$ 2500. Fee \$ 9.00

General Description of New Work

To construct one story frame building, 20' x 30' , using existing concrete slab

PERMIT ISSUED WITH LETTER

It is understood that this permit does not include installation of heating apparatus which is to be taken out separately by and in the name of the heating contractor. PERMIT TO BE ISSUED TO contractor

Details of New Work

Is any plumbing involved in this work? yes Is any electrical work involved in this work? yes Is connection to be made to public sewer? septic tank If not, what is proposed for sewage? Has septic tank notice been sent? Form notice sent? Height average grade to top of plate 8' Height average grade to highest point of roof 13' Size, front 20' depth 30' No. stories 1 solid or filled land? earth or rock? Material of foundation concrete slab existing Thickness, top bottom cellar Kind of roof pitch Rise per foot 5" Roof covering asphalt No. of chimneys exist. (1) Material of chimneys of lining Kind of heat fuel Framing Lumber-Kind spruce Dressed or full size? Corner posts 6x6 Sills 2x6 Size Girder Columns under girders Size Max. on centers Studs (outside walls and carrying partitions) 2x4-16" O. C. Bridging in every floor and flat roof span over 8 feet. Joists and rafters: 1st floor, 2nd, 3rd, roof trussed-lik. Soule On centers: 1st floor, 2nd, 3rd, roof Maximum span: 1st floor, 2nd, 3rd, roof If one story building with masonry walls, thickness of walls? height?

If a Garage

No. cars now accommodated on same lot, to be accommodated number commercial cars to be accommodated Will automobile repairing be done other than minor repairs to cars habitually stored in the proposed building?

APPROVED:

016-4114173- 016- 01/11/73

PERMIT ISSUED WITH LETTER

Miscellaneous

Will work require disturbing of any tree on a public street? Will there be in charge of the above work a person competent to see that the State and City requirements pertaining thereto are observed? yes Y.W.C.A.

CS 301

INSPECTION COPY

Signature of owner

By:

James E O'Leary

NOTES

6/13/73 - This bldg replaces
existing bldg that they had
used in the last year - Alder

7-20-73 Framed
out

Ready for toilets
PA

8-24-73 Framing
of toilets started
PA

9-14-73 Completed
no windows in
toilet rooms PA

6-21-74 No
plumbing - see
later permit
for latrine
AP

X

NE!

Permit No. 73/1631

Location: Eastman Ave - S.S.

Owner: V.W.C.A.

Date of permit: 6/14/73

Notif. closing-in

Inspn. closing-in

Final Notif.

Final Inspn.

Cert. of Occupancy issued

Staking Out Notice

Form Check Notice

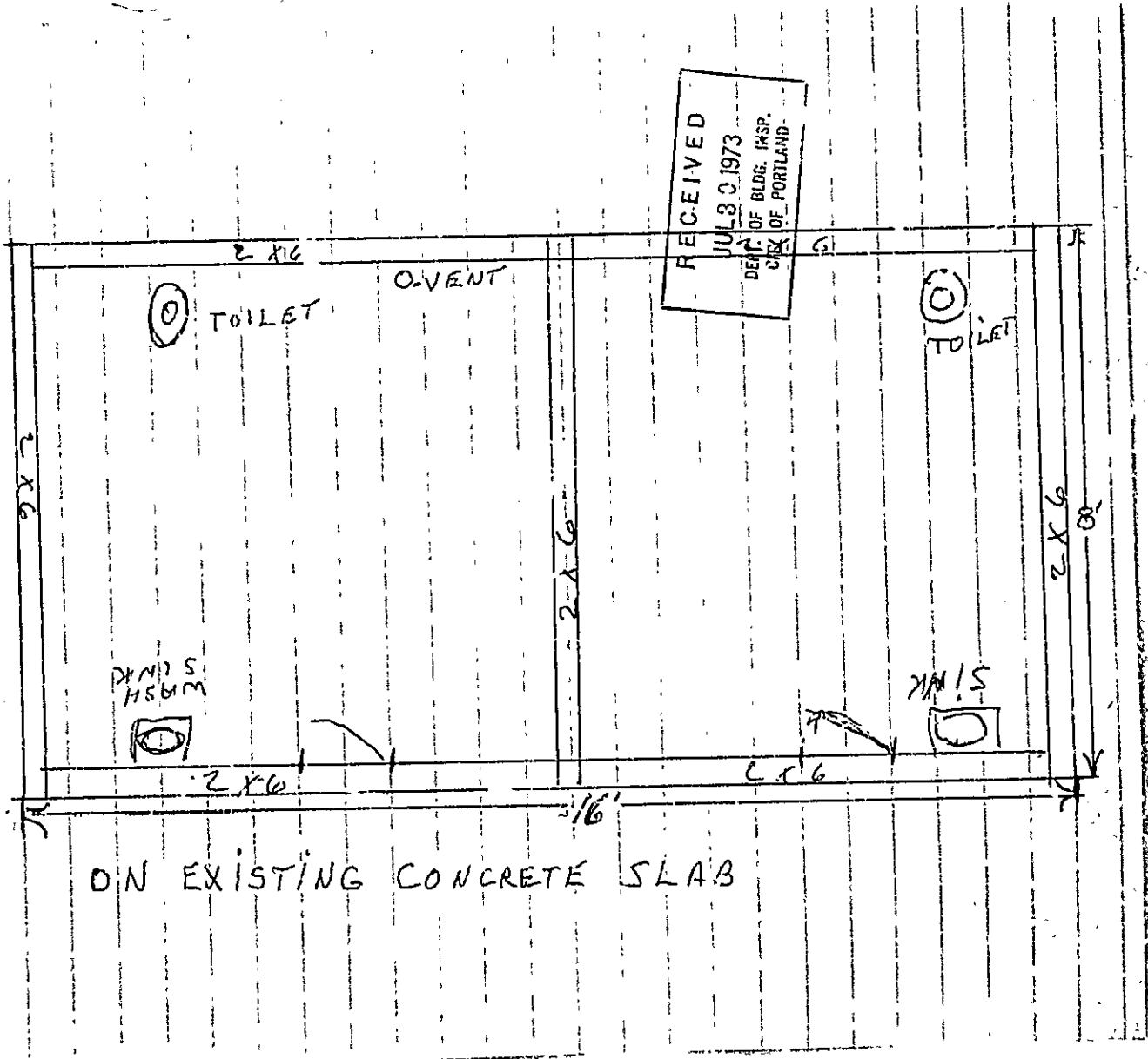

RECEIVED
JUL 30 1973
DEPT. OF BLDG. INSP.
CITY OF PORTLAND

ON EXISTING CONCRETE SLAB

LIST OF MATERIALS

CORNER POST

2" X 4"

STUDS - FRAMING LUMBER - SPRUCE

2" X 4"

SILLS

2" X 6"

DOORS

2 -

STD

SLATING

SHY

STD

ROOF - MATCHED - TONGUED & GROVED

ROOF COVER - ASPHALT SHINGLES -

ROOF - FLAT - SHED TYPE 2" X 4" TWO FOOT ON CENTER

RECEIVED

MAR 23 1973

OFFICE OF THE

CLERK

LOCATION: EASTERN AVE, LONG ISLAND, MAINE

OWNER'S NAME: YWCA - 87 SPRING ST. PORTLAND, ME.

PROPOSED USE OF BUILDING - TOILETS - (TWO)

ESTIMATED COST: \$1750.00

TO CONSTRUCT ONE STORY FRAME BUILDING
16' X 8' USING EXISTING CONCRETE SLAB &
SEPTIC TANK

CONTRACTOR'S NAME: JAMES E. O'LEARY
2 GOUDY ST. SO. PORTLAND, ME.

RECEIVED

JUL 30 1973

DEPT. OF BLDG. INSP.
CITY OF PORTLAND

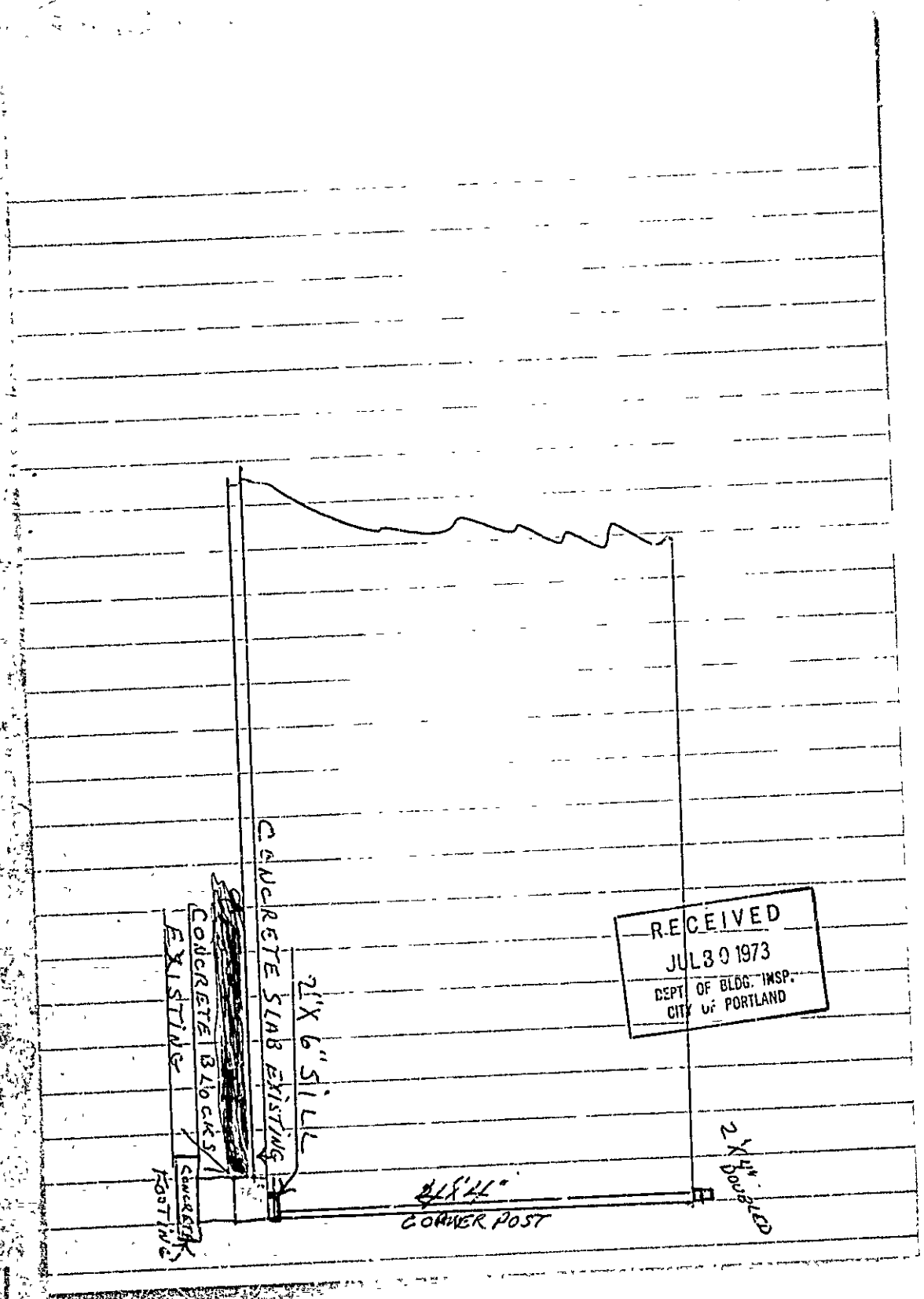

RECEIVED
JUL 30 1973
DEPT. OF BLDG. INSP.
CITY OF PORTLAND

CONCRETE SLAB EXISTING
2" X 6" SILL
CONCRETE 3 1/2" CHAS.
EXISTING
CONCRETE
POSTING

2 1/2" X 4"
CORNER POST

2" X 4" POSTING

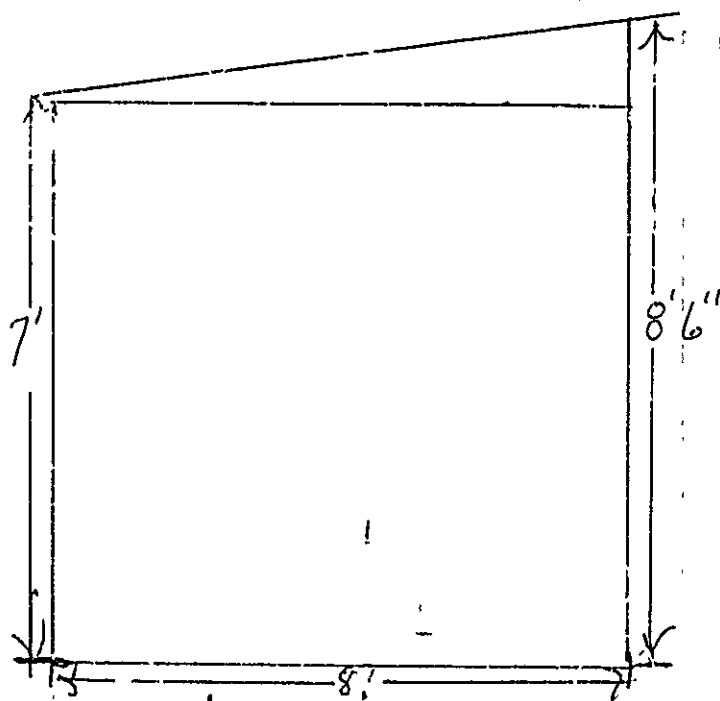

SIDE VIEW
SHED ROOF

RECEIVED.
JUL 30 1973
DEPT OF BLDG. INSP.
CITY OF PORTLAND

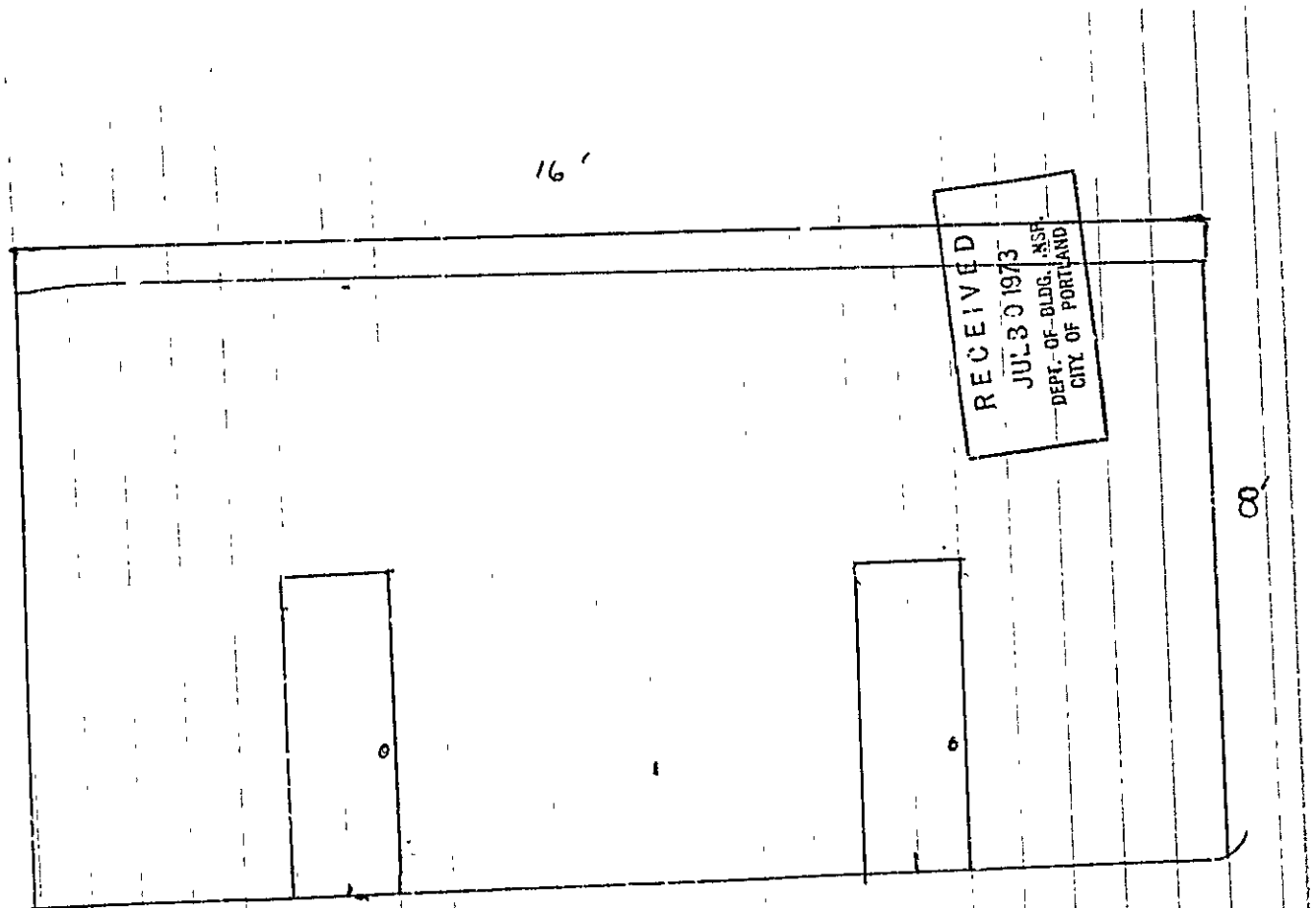

FRONT VIEW ON EXISTING SLAB

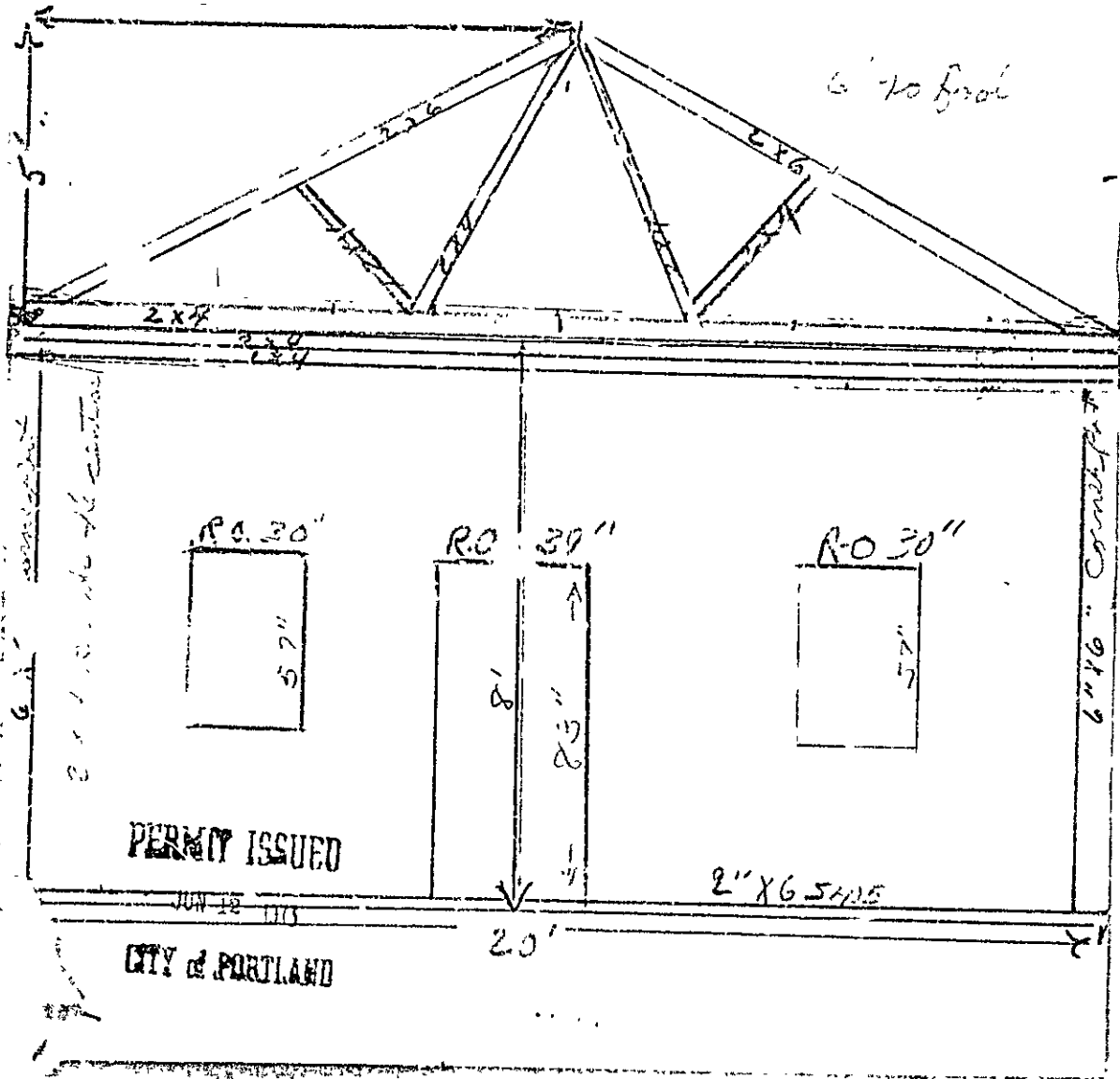

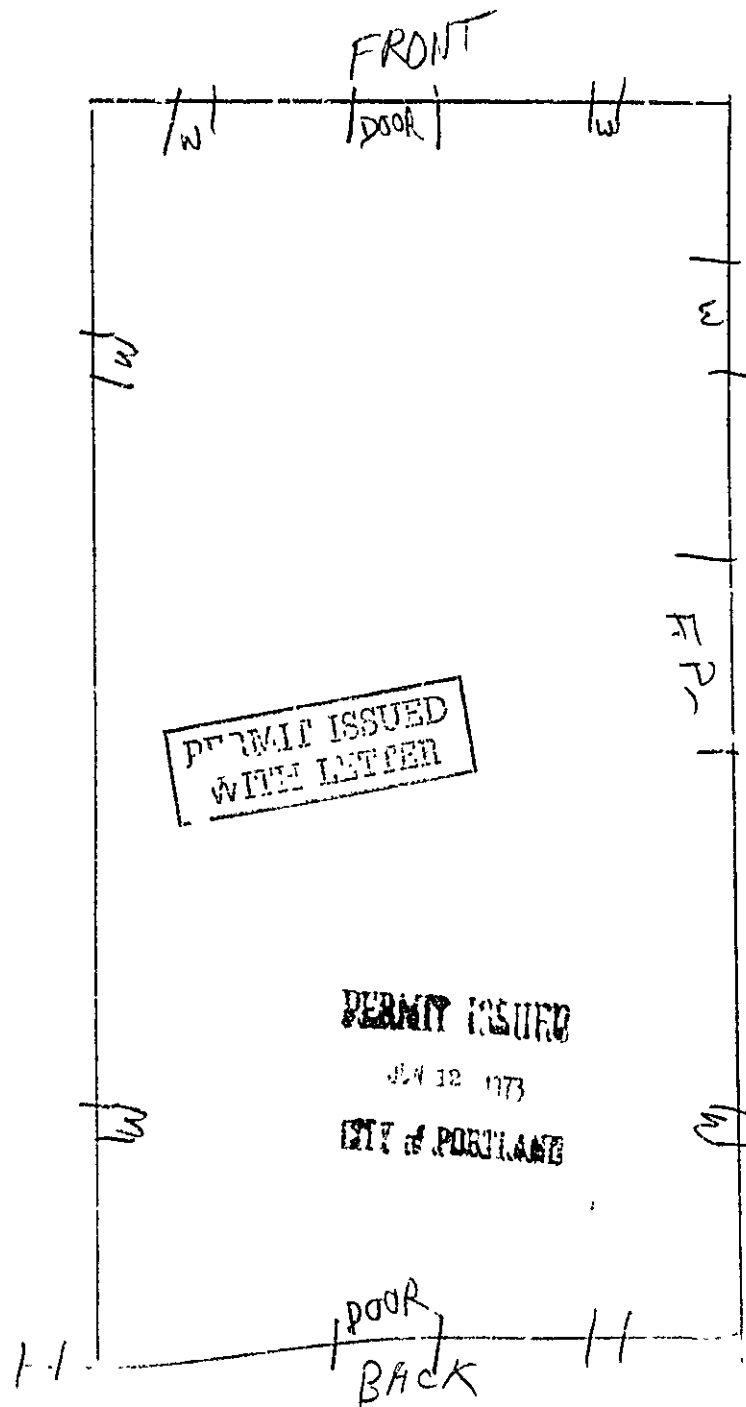

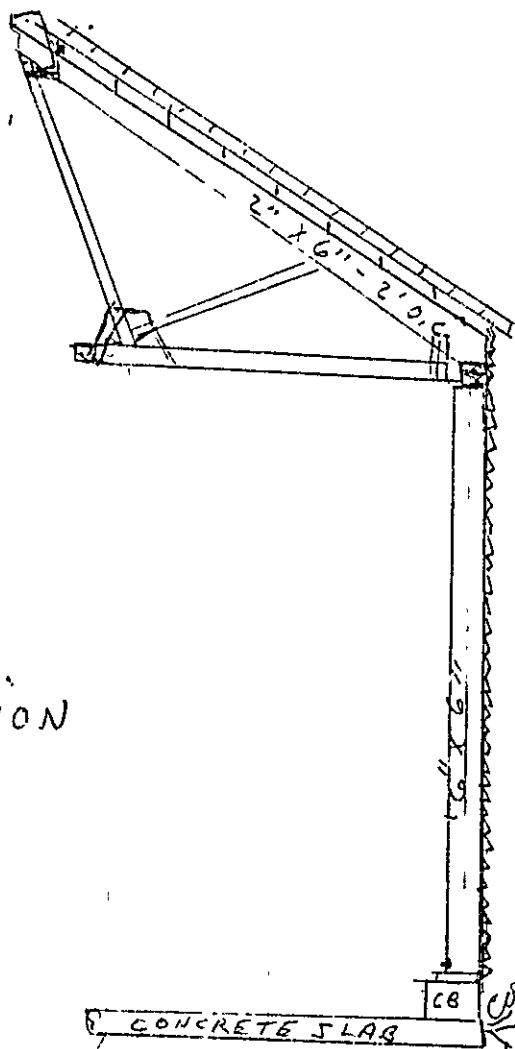

CROSS SECTION

PERMIT ISSUED

JUN 12 1973

CITY of PORTLAND

CONCRETE
BLOCK
EXISTING

LIST OF MATERIALS

CORNER POST		1 - 6" X 6" - 8'
STUDS		2" X 4" X 8'
JACKS	16" ON CENTER	2" X 4"
HEADERS		2" X 4" DOUBLED
SHOE		2" X 6"
PLATES		2" X 4" DOUBLED
RAFTERS	2' ON CENTER	2" X 6"
ROOFING SHINGLES - CLASS "C"		1056.12
FELT PAPER		3 ROLLS
NOVELTY SIDING		2000 BOARD FEET
WINDOWS		8
DOORS		2
ROOFING BOARDS		1500 FEET

CONCRETE SLAB 100' X 20' - 2" X 6" BOLTED
TO PREVIOUSLY INSTALLED FOOTING

PERMIT ISSUED

JUN 12 1973

CITY OF PORTLAND