

CRESCENT AVE. LONG ISLAND  
103-D-7

*Smead*  
No. 153C  
HARTING, MN  
LOS ANGELES, CHICAGO, LOGAN, OH  
MCGREGOR, TX. LOCUST GROVE, GA  
U.S.A.

# EMEIC

40 SCHOOL STREET - SUNCOOK, NEW HAMPSHIRE 03275  
TEL. 603/485-4410

April 2, 1981

Malcomb Ward  
Building Inspection Dept  
City Hall  
Portland, Maine 04101

Dear Sir:

I enclosed find check for \$550 for a building permit for a shed on my property on Long Island. The plot plan and shed construction details were sent earlier this week.

Thank you in advance for your assistance in this matter.

Sincerely

Royal A. Ferguson

EMEIC

P.O. BOX 71 - SUNCOOK, NEW HAMPSHIRE 03275  
TEL. 603/485-4410

March 31, 1981

Mr. Malcomb Ward  
Portland City Hall  
389 Congress St.  
Portland, ME 04101

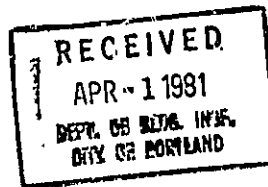

Dear Mr. Ward:

I was told to submit to you a sketch (for approval) of a shed I would like to build on L.I. this summer.

Enclosed is a copy of the proposed shed construction as well as a rough plot plan.

Would you please look this over and please send a building permit for said shed.

Thank you in advance.

Sincerely  
Roy A. Ferguson

SHED - 14' x 24'  
ROY FERGUSON  
LONG ISLAND  
MAINE 04050

3/25/81

Roofing to be  
Corrugated  
sheet metal

Slope of roof  
To be approx.  
2' in 14' width

2x10's 16' long  
13 ea req'd,  
Spaced on  
2' centers

Writer - Address  
40 School St  
Sancook, NH 05275

1x3  
STRAPPING  
#2' TYP

2x6's  
Typical

2x4 angle  
braces typical on  
all vertical poles

4x4's 8 ea req'd

ground  
level

RECEIVED  
APR - 1 1981  
DEPT. OF BLDG. INSP  
CITY OF PORTLAND

4x4's buried to strike ledge  
or buried 4'. Treated poles  
to be used to resist rot  
8 ea req'd

sheathing to  
be Vertical  
Barn Board with  
seams battened

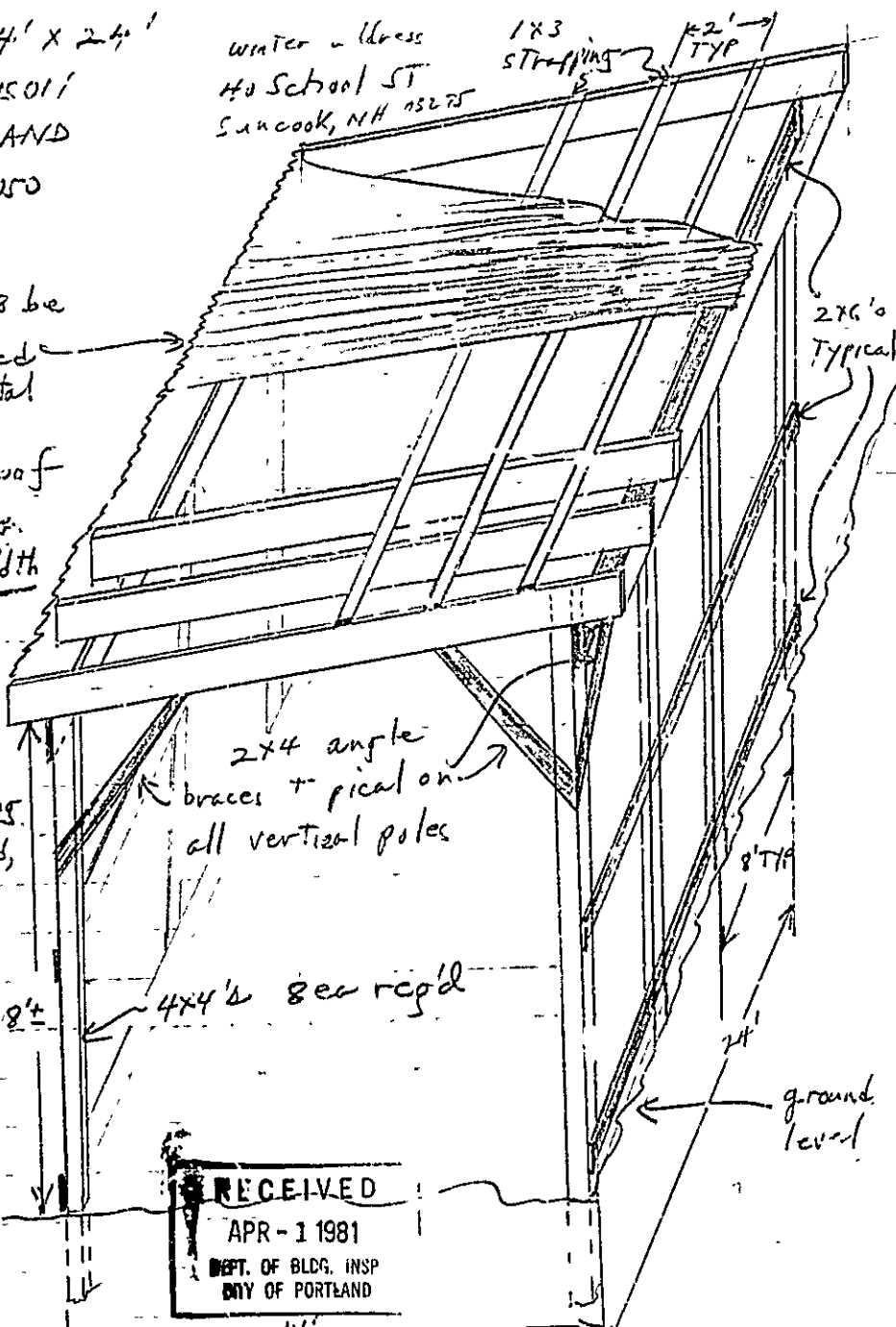

ROY FERGUSON  
LONG ISLAND

3/25/81  
103-D-7 Crescent Avenue

PLOT Plan

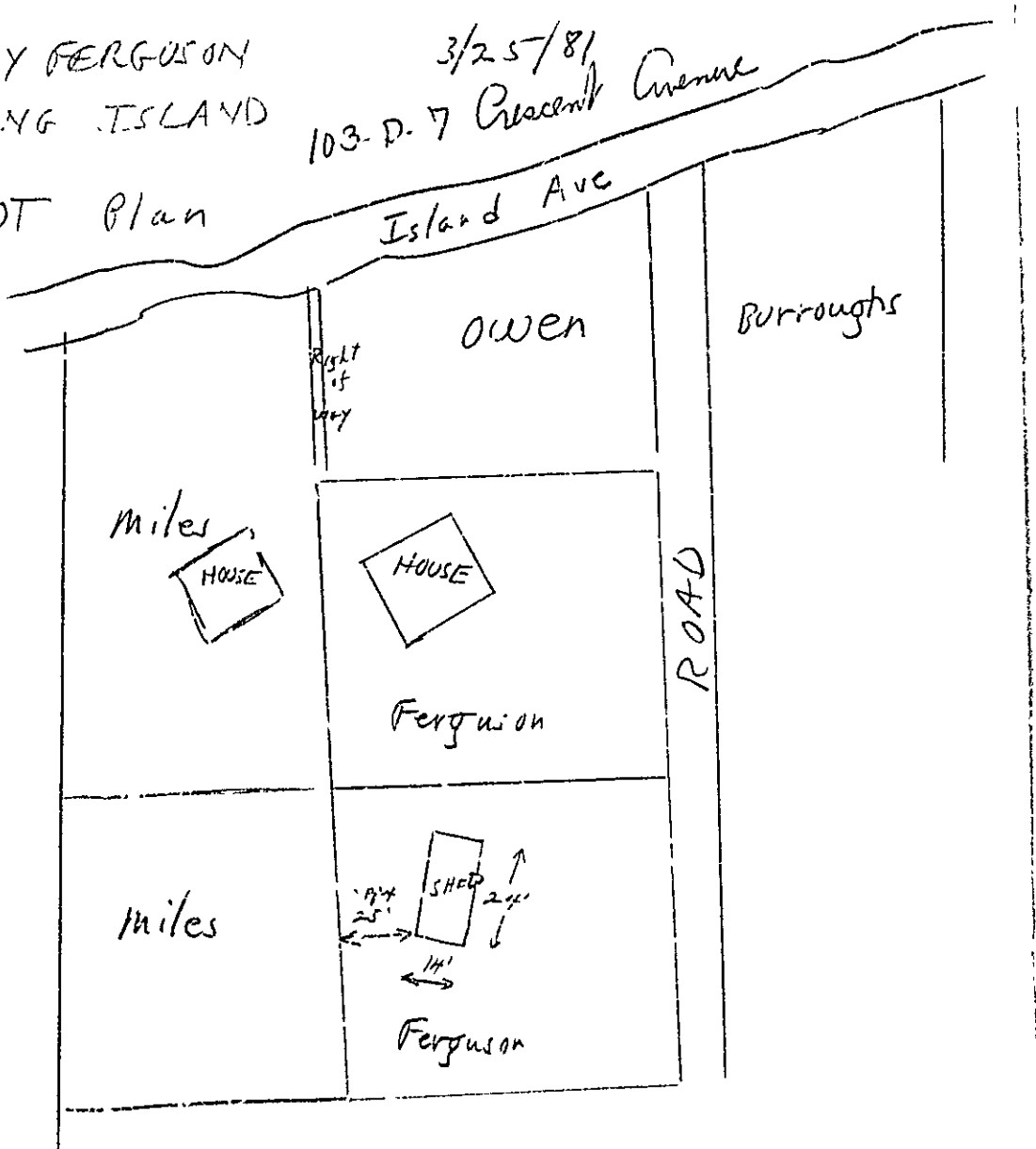

RECEIVED  
APR - 1 1981  
DEPT. OF BLDG. INSP  
CITY OF PORTLAND



# APPLICATION FOR PERMIT

PERMIT ISSUED

APR 7 1981

B.O.C.A. USE GROUP .....  
 B.O.C.A. TYPE OF CONSTRUCTION ..... 254  
 ZONING LOCATION R-3 PORTLAND, MAINE, April 1, 1981

CITY of PORTLAND

To the DIRECTOR OF BUILDING & INSPECTION SERVICES, PORTLAND, MAINE  
 The undersigned hereby applies for a permit to erect, alter, repair, demolish, move or ins.all the following building, structure, equipment or change use in accordance with the Laws of the State of Maine, the Portland B.O.C.A. Building Code and Zoning Ordinance of the City of Portland with plans and specifications, if any, submitted herewith and the following specifications.

LOCATION 103-D-7 Crescent Ave. Long Island Fire District #1  #2   
 1. Owner's name and address Roy. Ferguson- P.O. Box 71 Suncook, N.H. Telephone 603-485-4410  
 2. Lessee's name and address ..... Telephone .....  
 3. Contractor's name and address Owner ..... Telephone .....  
 4. Architect ..... Specifications ..... Plans ..... No. of sheets .....  
 Proposed use of building storage shed ..... No. families .....  
 Last use ..... No. families .....  
 Material ..... No. stories ..... Heat ..... Style of roof ..... Roofing .....  
 Other buildings on same lot ..... Fee \$ 5.50  
 Estimated contractual cost \$ 500.00

### FIELD INSPECTOR - Mr. \_\_\_\_\_ GENERAL DESCRIPTION

This application is for:  
 Dwelling ..... @ 775-5451  
 Garage ..... Ext. 234  
 Masonry Bldg. ....  
 Metal Bldg. ....  
 Alterations .....  
 Demolitions .....  
 Change of Use .....  
 Other .....

To construct 14' x 24' storage shed  
 as per plans. 2 sheets of plans.

of Special Conditions

NO FEE TO APPLICANT. Separate permits are required by the installers and subcontractors of heating, plumbing, electrical and mechanical.

PERMIT IS TO BE ISSUED TO 1  2  3  4   
 Other: .....

### DETAILS OF NEW WORK

Is any plumbing involved in this work? ..... Is any electrical work involved in this work? .....  
 Is connection to be made to public sewer? ..... 1. Not what is proposer for sewer? .....  
 Has septic tank notice been sent? ..... Form notice sent? .....  
 Height average grade to top of plate ..... Height average grade to highest point of roof .....  
 Size, front ..... depth ..... No. stories ..... solid or filled land? ..... earth or rock? .....  
 Material of foundation ..... Thickness, top ..... bottom ..... cellar .....  
 Kind of roof ..... Rise per foot ..... Roof covering ..... Kind of heat ..... fuel .....  
 No. of chimneys ..... Material of chimneys ..... of lining .....  
 Framing Lumber—Kind ..... Dressed or full size? ..... Cornet posts ..... Sills .....  
 Size Girder ..... Columns under girders ..... Size ..... Max. on centers .....  
 Studs (outside walls and carrying partitions) 2x4-16" O. C. Bridging in every floor and flat roof span over 8 feet.  
 Joists and rafters: 1st floor ..... 2nd ..... 3rd ..... roof .....  
 On centers: 1st floor ..... 2nd ..... 3rd ..... roof .....  
 Maximum span: 1st floor ..... 2nd ..... 3rd ..... roof ..... height? .....

If one story building with masonry walls, thickness of walls? ..... height? .....  
 IF A GARAGE  
 No. cars now accommodated on same lot ..... to be accommodated ..... number commercial cars to be accommodated .....  
 Will automobile repairing be done other than minor repairs to cars habitually stored in the proposed building? .....

APPROVALS BY:  
 BUILDING INSPECTION - PLAN EXAMINER .....  
 ZONING: D. H. McNeil .....  
 BUILDING CODE: .....  
 Fire Dept.: .....  
 Health Dept.: .....  
 Others: .....

MISCELLANEOUS  
 Will work require disturbing of any tree on a public street? .....  
 Will there be in charge of the above work a person competent to see that the State and City requirements pertaining thereto are observed? .....

Signature of Applicant ..... Phone # same  
 Type Name of above Roy. Ferguson 1  2  3  4   
 sent in by mail Other .....  
 and Address .....

FIELD INSPECTOR'S COPY

7

NOTES

5-26-81 - Exhaust work begun AA  
10-14-81 - Scrap. Put add on  
cess into kitchen. Hook into  
in line with furnace Dr. AA  
6-15-82 - Complets AA

Approved V-S-81

Date of permit 9-1-81

Owner W. H. Magnusson

Permit No. 81854  
Location 103-27 Lynden Ave Brook Park