

BEACH AVENUE
Long Island

97-II-32

Long Island Me
June 17, 1931.

Dear Sir

Received your letter of the
15th. as you say that I will
have to use 2 x 6 for Roof, 2 in
& 18 in a foot. That will be
as you say I will do it

Yours Truly

Philip MacNamee
Long Island Me

Rec'd
Long Island Me
June 17, 1931

673-A-I

June 15, 1931

Mr. Philip MacVane
Long Island
Portland, Maine

Dear Sir:

Referring to your application for a building permit to cover construction of a one story shed 10' x 14' for the storage of coal and wood at the corner of Leach Avenue and Woodbury Street, Long Island, the rafters as given on your application are 2x4, fifteen inches from center to center on a ten foot span. If these rafters are to be on a ten foot span, they should be at least 2x6 and may be spaced eighteen inches from center to center. It will be necessary for you to notify this office of your intention to use this size rafters, or equivalent construction, in the roof before the permit is issued to cover the work.

In the meantime, it is unlawful for you to proceed with any of the work until the permit card is actually in your possession and posted upon the premises.

Your location plan shows that the shed is to be at least five feet from either property line. Please see to it that these distances are not less than five feet in any event.

Very truly yours,

Inspector of Buildings.

WJ:HO

STATEMENT ACCOMPANYING APPLICATION FOR BUILDING PERMIT

for shed for storage of wood and coal
at Cor. Beach Ave. & Woodbury St.
Long Island

Date 6/13/31

1. In whose name is the title of the property now recorded? *Philip A. MacLean*
2. Are the boundaries of the property in the vicinity of the proposed work shown clearly on the ground, and how? *By - Post*
3. Is the outline of the proposed work now staked out upon the ground? *Yes* If not, will you notify the Inspection Office when the work is staked out and before any of the work is commenced? *Yes*
4. What is to be maximum projection or overhang of eaves or drip? *4"*
5. Do you assume full responsibility for the correctness of the location plan or statement of location filed with this application, and does it show the complete outline of the proposed work on the ground, including bay windows, porches and other projections? *Yes*
6. Do you assume full responsibility for the correctness of all statements in the application concerning the sizes, design and use of the proposed building? *Yes*
7. Do you understand that in case changes are proposed in the location of the work or in any of the details specified in the application that a revised plan and application must be submitted to this office before the changes are made? *Yes*

Philip A. MacLean

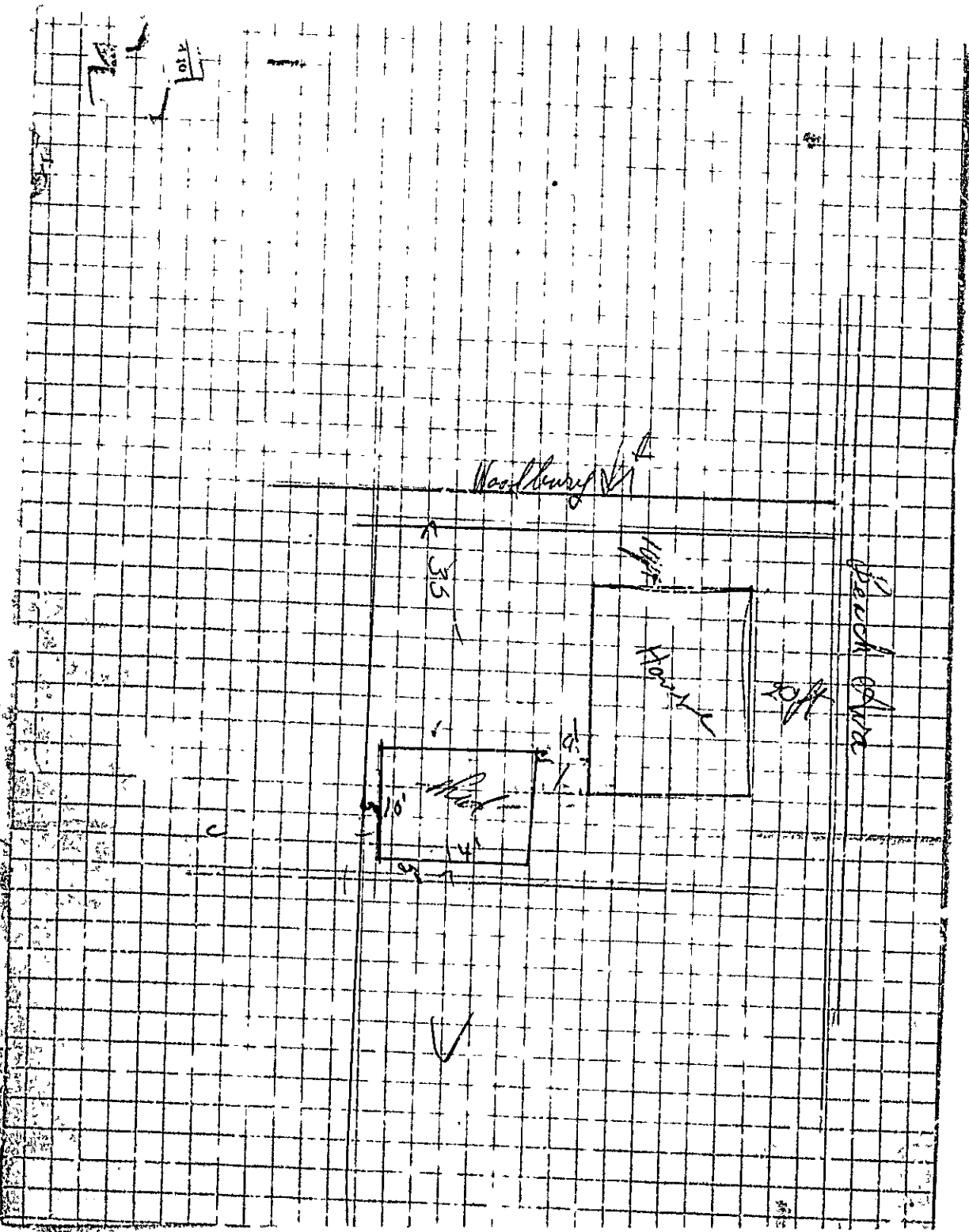

(A) APARTMENT HOUSE ZONE



APPLICATION FOR PERMIT

Permit No. 1060

JUN 18 1931

Class of Building or Type of Structure: Third Class

Portland, Maine, June 15, 1931

To the INSPECTOR OF BUILDINGS, PORTLAND, ME.

The undersigned hereby applies for a permit to erect after install the following building structure equipment in accordance with the Laws of the State of Maine, the Building Code of the City of Portland, plans and specifications, if any, submitted herewith and the following specifications:

Location Cor. Beach Ave & Longbury St., Long Island Within Fire Limits? no Dist. No. 12
Owner's or Lessee's name and address: Philip MacVane, Long Island Telephone no
Contractor's name and address: Orner Telephone _____
Architect's name and address _____
Proposed use of building: Storage of coal and wood No. families _____
Other buildings on same lot: Cottage
Plans filed as part of this application? yes No. of sheets 1
Estimated cost \$ 25. Fee \$.25

Description of Present Building to be Altered

Material _____ No. stories _____ Heat _____ Style of roof _____ Roofing _____
La c use _____

General Description of New Work

To erect one story frame shed 10' x 14'

NO. VERIFICATION BEFORE FINISHING OR CLOSING-IN IS WAIVED. CERTIFICATE OF OCCUPANCY REQUIREMENT IS WAIVED.

It is understood that this permit does not include installation of heating apparatus which is to be taken out separately by and in the name of the heating contractor.

Details of New Work

Height average grade to top of plate _____
Size, front 14' depth 10' No. stories 1 Height average grade to highest point of roof 0'
To be erected on solid or filled land? solid earth or rock? earth
Material of foundation concrete Thickness, top _____ bottom _____
Material of underpinning _____ Height _____ Thickness _____
Kind of Roof shed Rise per foot 2" Roof covering Asphalt roofing Class C Unc. Lab
No. of chimneys no Material of chimneys _____ of lining _____
Kind of heat no Type of fuel _____ Is gas fitting involved? _____
Corner posts 4x4 Sills 6x4 Girt or ledger board? _____ Size _____
Material columns wide girders _____ Size _____ Max. on centers _____
Studs (outside walls and carrying partitions) 2x4-16" O. C. Girders 6x8 or larger. Bridging in every floor and flat roof span over 8 feet. Sills and corner posts all one piece in cross section.
Joists and rafters: 1st floor 2x6, 2nd _____, 3rd _____, roof 2x6 2x6
On centers: 1st floor 18", 2nd _____, 3rd _____, roof 18" 18"
Maximum span: 1st floor 10', 2nd _____, 3rd _____, roof 10'

If one story building with masonry walls, thickness of walls? _____ height? _____

If a Garage

No. cars now accommodated on same lot _____, to be accommodated _____
Total number commercial cars to be accommodated _____
Will automobile repairing be done other than minor repairs to cars habitually stored in the proposed building? _____

Miscellaneous

Will above work require removal or disturbing of any shade tree on a public street? no
Will there be in charge of the above work a person competent to see that the State and City requirements pertaining thereto are observed? yes

Signature of owner Philip A MacVane

INSPECTION COPY

5073A

Ward Permit No. 3/1066

Location: Radial + Widdling St

Owner: Philip MacLane

Permit: 1/13/31

Notif. closing-in

Ins-pn. closing-in

Final Ins-pn.

Final Ins-pn. 2/23/32 OK

Cert. of Occupancy issued Same

7/29/31. NOTES

From James took 9-
 me to this job - 32
 and spoke of it as being
 recently built.
 This is only 6 x 7' instead
 of 10' x 14' as per application.
 Back was 2-24 studs
 flat on in the corner
 and in the center, the
 rest of framing appears
 to be small studs 20-3
 in dia. - these are 18"
 in dia. - was used
 on the roof.
 6-6" high in
 one in. OK

1/13/31

one in. OK

8/26/31. Look this over once in a while to see how it stands up. OK

11/4/31. Appears O.K. at this time. OK

12/30/31. Same, etc.
5/23/32. This seems to stand up O.K. OK