

GARFIELD AVENUE LONG ISLAND  
97-B-57-35

SMITHSONIAN INSTITUTION  
WASHINGTON, D.C.

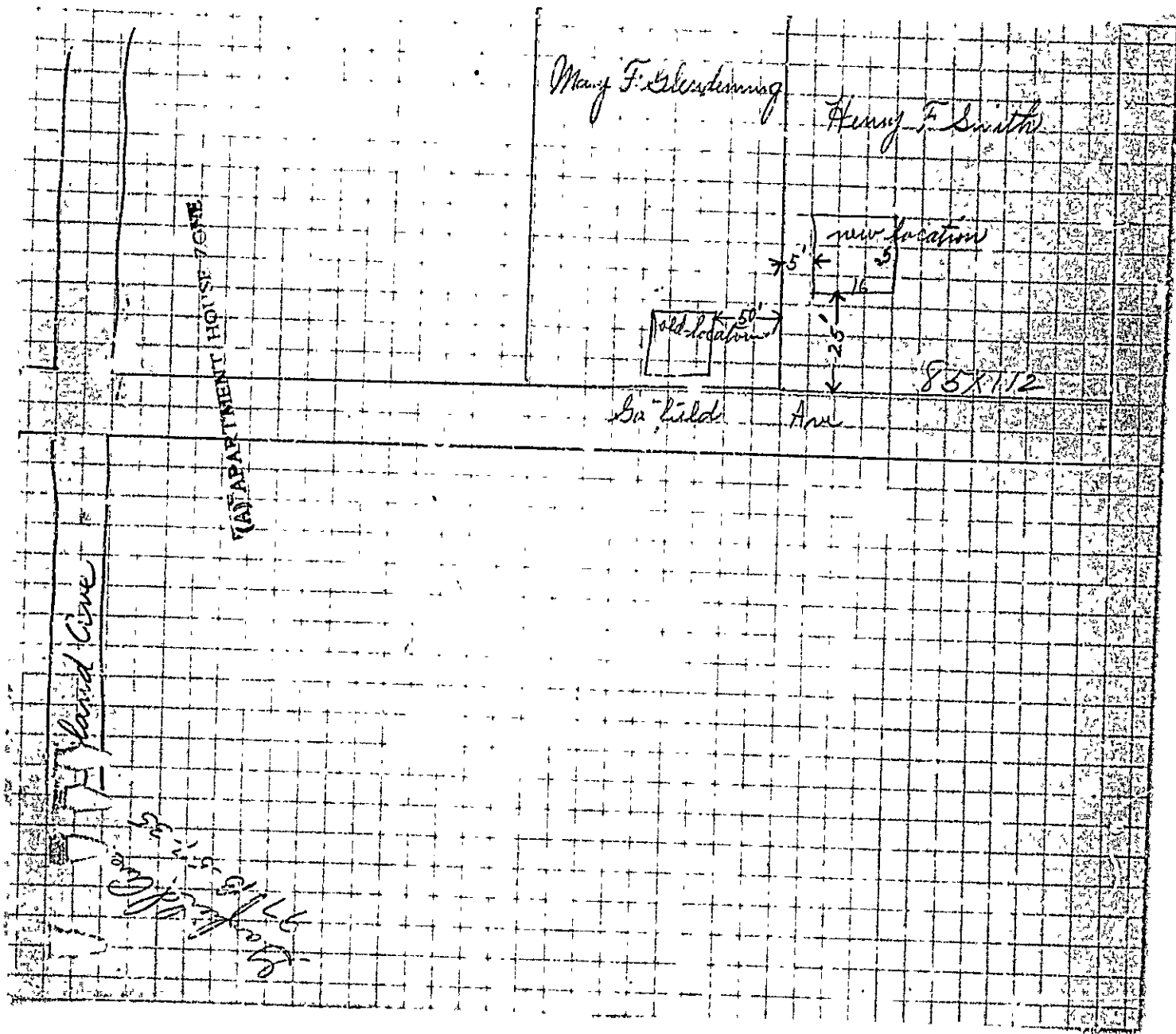



APARTMENT HOUSE 7041V  
APPLICATION FOR PERMIT

PERMIT ISSUED  
Permit No. \_\_\_\_\_

JUN 5 1929

Class of Building or Type of Structure Third Class  
Portland, Maine, June 5, 1929

To the INSPECTOR OF BUILDINGS, PORTLAND, ME.

The undersigned hereby applies for a permit to erect alter ~~with~~ the following building structure equipment in accordance with the Laws of the State of Maine, the Building Code of the City of Portland, plans and specifications, if any, submitted herewith and the following specifications:

Location Garfield Avenue, Long Island Ward 1 Within Fire Limits? EO Dist. No. \_\_\_\_\_  
Owner's or Lessee's name and address Bonora's Landing, Long Island Telephone \_\_\_\_\_  
Contractor's name and address Jacob Gray, Long Island Telephone \_\_\_\_\_  
Architect's name and address \_\_\_\_\_ No. families \_\_\_\_\_  
Proposed use of building Gar  
Other buildings on same lot none

Description of Present Building to be Altered  
Material Wood No. stories 1 1/2 Heat \_\_\_\_\_ Style of roof Pipe  
Last use store

General Description of New Work:  
To move building about 75' to adjoining lot  
To put 4x4 beam across center of building supported by 2x4 joists  
To recover one side of roof  
To cut in two new windows

Details of New Work:  
Size, front \_\_\_\_\_ depth \_\_\_\_\_ No. stories \_\_\_\_\_  
To be erected on solid or filled land? land earth or rock? \_\_\_\_\_  
Material of foundation Bank place Thickness, top \_\_\_\_\_ bottom \_\_\_\_\_  
Material of underpinning \_\_\_\_\_ Height \_\_\_\_\_ Thickness \_\_\_\_\_  
Kind of roof pitch Roof covering Asphalt roofing Glass? U.S.A.  
No. of chimneys \_\_\_\_\_ Material of chimneys \_\_\_\_\_ of lining \_\_\_\_\_  
Kind of heat \_\_\_\_\_ Type of fuel \_\_\_\_\_ Distance, heater to chimney \_\_\_\_\_  
If oil burner, name and model \_\_\_\_\_  
Capacity and location of oil tanks \_\_\_\_\_  
Is gas fitting involved? \_\_\_\_\_ Size of service \_\_\_\_\_  
Corner posts \_\_\_\_\_ Sills \_\_\_\_\_ Girt or ledger board? \_\_\_\_\_ Size \_\_\_\_\_  
Material columns under girders \_\_\_\_\_ Size \_\_\_\_\_ Max. on centers \_\_\_\_\_  
Studs (outside walls and carrying partitions) 2x4-16" O.C. Girders 6x8 or larger. Bridging b every floor and flat roof span over 8 feet. Sills and corner posts all one piece in cross section.  
Joists and rafters: 1st floor \_\_\_\_\_, 2nd \_\_\_\_\_, 3rd \_\_\_\_\_, roof \_\_\_\_\_  
On centers: 1st floor \_\_\_\_\_, 2nd \_\_\_\_\_, 3rd \_\_\_\_\_, roof \_\_\_\_\_  
Maximum span: 1st floor \_\_\_\_\_, 2nd \_\_\_\_\_, 3rd \_\_\_\_\_, roof \_\_\_\_\_  
If one story building with masonry walls, thickness of walls? \_\_\_\_\_ height? \_\_\_\_\_

If a Garage  
No. cars now accommodated on same lot \_\_\_\_\_, to be accommodated \_\_\_\_\_  
Total number commercial cars to be accommodated \_\_\_\_\_  
If automobile repairing be done other than minor repairs to cars habitually stored in the proposed building? \_\_\_\_\_

Miscellaneous  
All above work require removal or disturbing of any shade tree on a public street? no  
Plans filed as part of this application? yes No. sheets 1 Fee \$ 1.00  
Estimated cost \$100.

Will there be in charge of the above work a person competent to see that the State and City requirements pertaining thereto are observed? Yes  
Signature of owner Mary J. Glanville

INSPECTION COPY

PERMIT ISSUED  
NO. OF OCCUPANCY  
IN OCCUPANCY IS WAIVED  
NO. OF OCCUPANCY  
IN OCCUPANCY IS WAIVED  
EXCLUDE THE  
STREETS OF THE CITY  
of Portland  
June 5, 1929

6668

War - 1 Permit No. 28/1047  
*since 1919*

Location Garfield & Ave. Long

Owner Mrs. F. G. Anderson

Date of permit 6/10/28

N            sing-in

           sing-in

Final Notif.           

Final Inspn.           

Cert. of Occupancy issued           

NOTES

*see plan - 1047*

~~137/11/29  
PT F~~