

93-F-45 ISLAND AVENUE - LONG ISL.



APPLICATION FOR PERMIT
DEPARTMENT OF BUILDING INSPECTIONS SERVICES
ELECTRICAL INSTALLATIONS

Date 10-23, 19 78
 Receipt and Permit number A13066

To the CHIEF ELECTRICAL INSPECTOR, Portland, Maine.

The undersigned hereby applies for a permit to make electrical installations in accordance with the laws of
 Maine, the Portland Electrical Ordinance, the National Electrical Code and the following specifications:

LOCATION OF WORK: 93-F-45 Island Avenue, Long Island, Me.
 OWNER'S NAME: Michael Kilgore ADDRESS: same FEES

OUTLETS: Receptacles _____ Switches _____ Plugmold _____ ft. TOTAL _____

FIXTURES: (number of)
 Incandescent _____ Fluorescent _____ (not strip) TOTAL _____
 Strip Fluorescent _____ ft. _____

SERVICES: Overhead x Underground _____ Temporary _____ TOTAL amperes 100 3.00
.50

METERS: (number of) 1

MOTORS: (number of)
 Fractional _____
 1 HP or over _____

RESIDENTIAL HEATING:
 Oil or Gas (number of units) _____
 Electric (number of rooms) _____

COMMERCIAL OR INDUSTRIAL HEATING:
 Oil or Gas (by a main boiler) _____
 Oil or Gas (by separate units) _____
 Electric Under 20 kws _____ Over 20 kws _____

APPLIANCES: (number of)
 Ranges _____ Water Heaters _____
 Cook Tops _____ Disposals _____
 Wall Ovens _____ Dishwashers _____
 Dryers _____ Compactors _____
 Fans _____ Others (denote) _____
 TOTAL _____

MISCELLANEOUS: (number of)
 Branch Panels _____
 Transformers _____
 Air Conditioners Central Unit _____
 Separate Units (windows) _____
 Signs 20 sq. ft. and under _____
 Over 20 sq. ft. _____
 Swimming Pools Above Ground _____
 In Ground _____
 Fire/Burglar Alarms Residential _____
 Commercial _____
 Heavy Duty Outlets, 220 Volt (such as welders) 30 amps and under _____
 over 30 amps _____
 Circus, Fairs, etc. _____
 Alterations to wires _____
 Repairs after fire _____
 Emergency Lights, battery _____
 Emergency Generators _____

FOR ADDITIONAL WORK NOT ON ORIGINAL PERMIT INSTALLATION FEE DUE:
 FOR REMOVAL OF A "STOP ORDER" (304-16.b) DOUBLE FEE DUE:
 TOTAL AMOUNT DUE: 3.50

INSPECTION:
 Will be ready on 10-23, 1978; or Will Call _____
 CONTRACTOR'S NAME: Harry G. Papkee
 ADDRESS: Long Island, Me.
 TEL: 766-3372
 MASTER LICENSE NO.: 105 SIGNATURE OF CONTRACTOR: Harry G. Papkee
 LIMITED LICENSE NO.: _____

INSPECTOR'S COPY — WHITE
 OFFICE COPY — CANARY
 CONTRACTOR'S COPY — GREEN

APPLICATION FOR PERMIT

PERMIT ISSUED

B.O.C.A. SF GROUP

AUG 12 1986

B.O.C.A. TYPE OF CONSTRUCTION 01042

ZONING LOCATION IR-2 ... PORTLAND, MAINE July 31, 1986

City Of Portland

To the CHIEF OF BUILDING & INSPECTION SERVICES, PORTLAND, MAINE

The undersigned hereby applies for a permit to erect, alter, repair, demolish, move or install the following building, structure, equipment or change use in accordance with the Laws of the State of Maine, the Portland B.O.C.A. Building Code and Zoning Ordinance of the City of Portland with plans and specifications, if any, submitted herewith and the following specifications:

LOCATION Map # 93 Lot F-2 Island Ave, Long Island Fire District #1 #2

1 Owner's name and address Mervin R. Kilgore Telephone 729-1226

2 Lessee's name and address Telephone

3 Contractor's name and address Owner Telephone

No. of sheets

Proposed use of building Shed No. families

Last use No. families

Material No. stories Heat Style of roof Roofing

Other buildings on same lot

Estimated contractual cost \$ 8,750.00

FIELD INSPECTOR—Mr Appeal Fees \$

@ 775-5431 Base Fee

Late Fee

TOTAL \$ 25.00

To construct a 14'x16' workshed as per plans.

One sheet of plans. Take down existing shed

Stamp of Special Conditions

Send permit to: Mervin Kilgore, 16 Nancy Drive, Brunswick 04011

NOTE TO APPLICANT: Separate permits are required by the installers and subcontractors of heating, plumbing, electrical and mechanicals

DETAILS OF NEW WORK

Is any plumbing involved in this work? No Is any electrical work involved in this work? No

Is a connection to be made to public sewer? If not, what is proposed for sewage?

Has septic tank notice been sent? Form notice sent?

Height average grade to top of plate Height average grade to highest point of roof

Size, front depth No stories solid or filled land? earth or rock?

Material of foundation Thickness, top bottom center

Kind of roof Rise per foot Roof covering

No. of chimneys Material of chimneys of lining Kind of heat fuel

Framing Lumber—Kind Dressed or full size? Corner posts Sills

Size Girder Columns under girders Size Max on centers

Studs (outside walls and carrying partitions) 2x4-16" O. C. Bridging in every floor and flat roof span over 8 feet.

Joists and rafters 1st floor 2nd 3rd roof

On centers: 1st floor 2nd 3rd roof

Maximum span. 1st floor 2nd 3rd roof

If one story building with masonry walls, thickness of walls? height?

IF A GARAGE

No. cars now accommodated on same lot, to be accommodated number of commercial cars to be accommodated

Will automobile repairing be done other than minor repairs to cars habitually stored in the proposed building?

APPROVALS BY:

DATE

MISCELLANEOUS

BUILDING INSPECTION—PLAN EXAMINER Will work require disturbing of any tree on a public street?

ZONING: OK M.R.K. Aug 5, 1986 Will there be in charge of the above work a person competent

BUILDING CODE: to see that the State and City requirements pertaining thereto

Fire Dept.: are observed?

Health Dept.:

Others:

Signature of Applicant Mervin R. Kilgore Phone # 729-1226

Type Name of above Mervin R. Kilgore 1 2 3 4

Other

and Address

FIELD INSPECTOR'S COPY

APPLICANT'S COPY

OFFICE FILE COPY

M.R. Haddato

Q3F45

Permit No. 86/1042
 Location 93F 2nd Street Okla Del.
 Owner M. J. ...
 Date of permit 7-31-86
 Approved 8-12-86
 Dwelling single
 Garage _____
 Alteration _____

NOTES

11-5-86 - Completed
OK.

(The main body of the form is crossed out with a large diagonal line.)



Plot PLAN

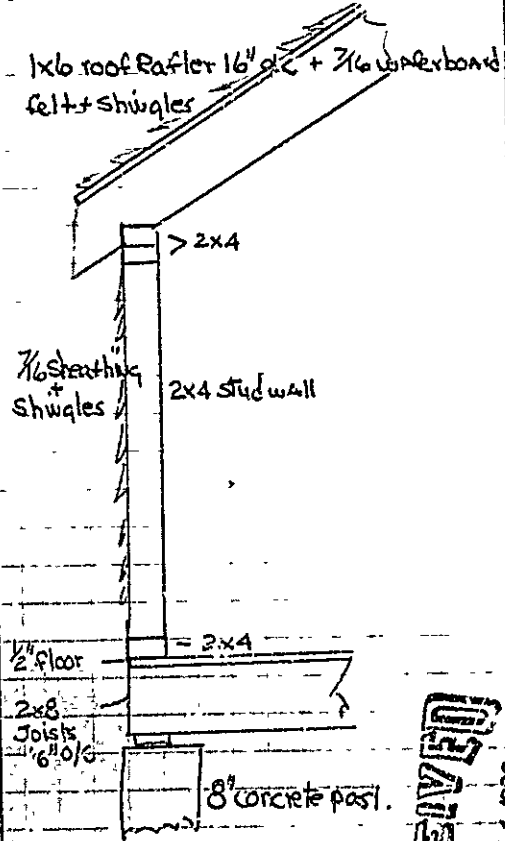
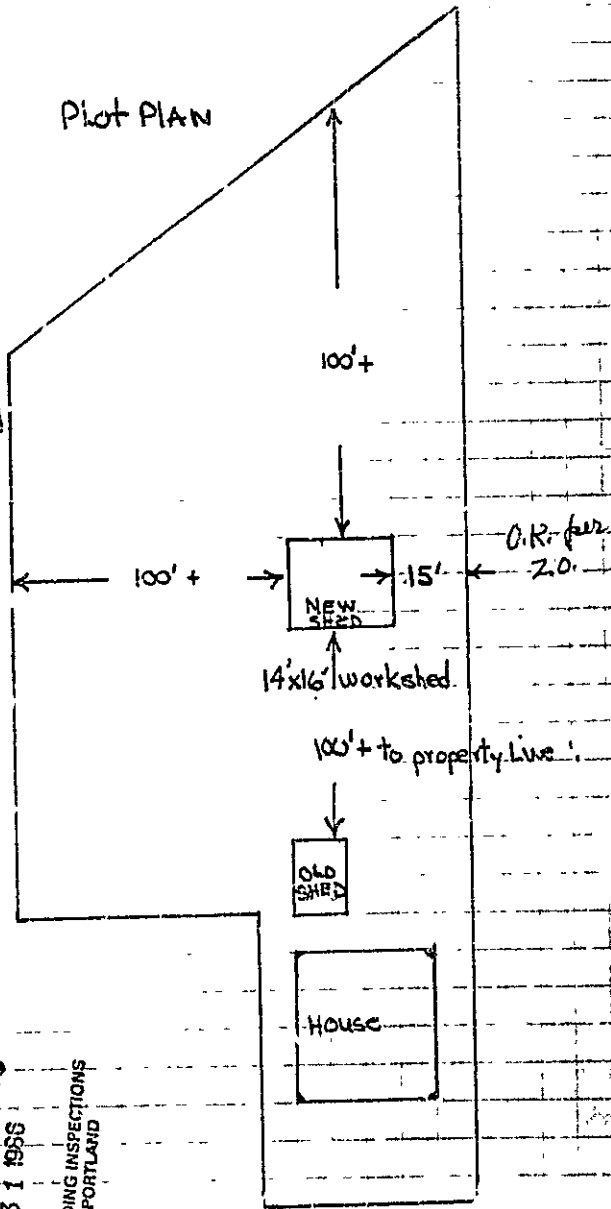

Cross Sectional View

RECEIVED

JUL 3 1 1986

DEPT. OF BUILDING INSPECTIONS
CITY OF PORTLAND

Mervin R. Kilgore
Long Island Casco Bay
Maine - Island Ave

14x16' workshed
Cost \$875
Contractor: SELF

lot # 2
Island Ave

Applicant: *Murwyn R. Kilgore, Jr* Date: *Aug 5, 1986*
Address: *Island Ave, Long Island*
Assessors No.: *93-F-45*

CHECK LIST AGAINST ZONING ORDINANCE

Date -
Zone Location -
Interior or corner lot -
Use - *Construct a shed*
Sewage Disposal -
Rear Yards -
Side Yards -
Front Yards -
Projections -
Height -
Lot Area - *5,000 #*
Building Area -
Area per Family -
Width of Lot -
Lot Frontage -
Off-street Parking -
Loading Bays -

Site Plan -
Shoreland Zoning -
Flood Plains -