

ISLAND AVENUE  
93-E-20-21

LONG ISLAND



**(1) APARTMENT HOUSE ZONE PERMIT ISSUED**  
**APPLICATION FOR PERMIT** Permit No. 0952

Class of Building or Type of Structure Third Grade JUN. 27 1938

Portland, Maine, June 27, 1938

To the INSPECTOR OF BUILDINGS, PORTLAND, ME.

The undersigned hereby applies for a permit to erect and install the following building structure equipment in accordance with the Laws of the State of Maine, the Building Code of the City of Portland, plans and specifications, if any, submitted herewith and the following specifications:

Location Island Avenue  
West End Long Island Within Fire Limits? no Dist. No. \_\_\_\_\_  
 Owner's or Lessee's name and address James Kilday, Wilton St., Walden, Mass. Telephone \_\_\_\_\_  
 Contractor's name and address Frank L. Fifield, 189 Tremont St., Walden, Mass. Telephone \_\_\_\_\_  
 Architect \_\_\_\_\_ Plans filed no No. of sheets \_\_\_\_\_  
 Proposed use of building Cottage No. families \_\_\_\_\_  
 Other buildings on same lot \_\_\_\_\_  
 Estimated cost \$ 50 Fee \$ .50

**Description of Present Building to be Altered**

Material wood No. stories 1 1/2 Heat \_\_\_\_\_ Style of roof \_\_\_\_\_ Roofing \_\_\_\_\_  
 Last use Cottage No. families \_\_\_\_\_

**General Description of New Work**

To glass in existing front and side piazza of cottage  
 Piazza existing with roof over same prior to Dec. 3, 1938

It is understood that this permit does not include installation of heating apparatus which is to be taken out separately by and in the name of the heating contractor.

**Details of New Work**

Size, front \_\_\_\_\_ depth \_\_\_\_\_ No. stories \_\_\_\_\_ Height average grade to top of \_\_\_\_\_  
 \_\_\_\_\_ Height average grade to highest point of roof \_\_\_\_\_  
 To be erected on solid or filled land? \_\_\_\_\_ earth or rock? \_\_\_\_\_  
 Material of foundation \_\_\_\_\_ Thickness, top \_\_\_\_\_ bottom \_\_\_\_\_ cellar \_\_\_\_\_  
 Material of underpinning \_\_\_\_\_ Height \_\_\_\_\_ Thickness \_\_\_\_\_  
 Kind of Roof \_\_\_\_\_ Rise per foot \_\_\_\_\_ Roof covering \_\_\_\_\_  
 No. of chimneys \_\_\_\_\_ Material of chimneys \_\_\_\_\_ of lining \_\_\_\_\_  
 Kind of heat \_\_\_\_\_ Type of fuel \_\_\_\_\_ Is gas fitting involved? \_\_\_\_\_  
 Framing Lumber Kind \_\_\_\_\_ Dressed or Full Size? \_\_\_\_\_  
 Corner posts \_\_\_\_\_ Sills \_\_\_\_\_ Girt or ledger board? \_\_\_\_\_ Size \_\_\_\_\_  
 Material columns under girders \_\_\_\_\_ Size \_\_\_\_\_ Max. on centers \_\_\_\_\_  
 Studs (outside walls and carrying partitions)  $\frac{1}{2}$  4-16" O. C. Girders 6x8 or larger. Bridging in every floor and flat roof span over 8 feet. Sills and corner posts all one piece in cross section.  
 Joists and rafters: 1st floor \_\_\_\_\_, 2nd \_\_\_\_\_, 3rd \_\_\_\_\_, roof \_\_\_\_\_  
 On centers: 1st floor \_\_\_\_\_, 2nd \_\_\_\_\_, 3rd \_\_\_\_\_, roof \_\_\_\_\_  
 Maximum span: 1st floor \_\_\_\_\_, 2nd \_\_\_\_\_, 3rd \_\_\_\_\_, roof \_\_\_\_\_  
 If one story building with masonry walls, thickness of walls? \_\_\_\_\_ height? \_\_\_\_\_

**Is a Garage**

No. cars now accommodated on same lot \_\_\_\_\_ to be accommodated \_\_\_\_\_  
 Total number commercial cars to be accommodated \_\_\_\_\_  
 Will automobile repairing be done other than minor repairs to cars habitually stored in the proposed building? \_\_\_\_\_

**Miscellaneous**

Will above work require removal or disturbing of any shade tree on a public street? no  
 Will there be in charge of the above work a person competent to see that the State and City requirements pertaining thereto are observed? yes  
 Signature of owner James Kilday

INSPECTION COPY

Signature of owner

By

Frank L. Fifield



10

APPLICATION FOR PERMIT

1220

PERMIT ISSUED

OCT 3 1954

CITY of PORTLAND

B.O.C.A. USE GROUP .....

B.O.C.A. TYPE OF CONSTRUCTION .....

ZONING LOCATION ..... PORTLAND, MAINE Sept. 28, 1954

To the CHIEF OF BUILDING & INSPECTION SERVICES, PORTLAND, MAINE

The undersigned hereby applies for a permit to erect, alter, repair, demolish, move or install the following building, structure, equipment or change use in accordance with the Laws of the State of Maine, the Portland B.O.C.A. Building Code and Zoning Ordinance of the City of Portland with plans and specifications, if any, submitted herewith and the following specifications:

LOCATION .... 93-B-24-21 Island Ave. Long Isl. Fire District #1  #2

1. Owner's name and address Stephen T Honey - 26 Orland St. Telephone .....

2. Lessee's name and address .....

3. Contractor's name and address Alan A. Foster - RFD # 2, Box 411E Hollis Ctr. Me Telephone 264-5650

Proposed use of building summer cottage No. of sheets 1

Last use same No. families .....

Material ..... No stories ..... Heat ..... Style of roof ..... Roofing .....

Other buildings on same lot .....

Estimated contractual cost \$ 3,900.00 Appeal Fees \$ .....

FIELD INSPECTOR—Mr. @ 775-5451 Base Fee 30.00

Late Fee .....

TOTAL \$ 30.00

To remove existing 8' x 24' sun deck and to construct 10' x 24' as per plans. 1 sheet of plans.

Stamp of Special Conditions

send permit to HOLD, WILL PICK UP PERMIT

NOTE TO APPLICANT: Separate permits are required by the installers and subcontractors of heating, plumbing, electrical and mechanicals.

DETAILS OF NEW WORK

Is any plumbing involved in this work? no Is any electrical work involved in this work? no
Is connection to be made to public sewer? If not, what is proposed for sewage?
Has septic tank notice been sent? Form notice sent?
Height average grade to top of plate Height average grade to higher point of roof
Size, front depth No. stories solid or filled land? earth or rock?
Material of foundation Thickness, top bottom cellar
Kind of roof Rise per foot Roof covering
No. of chimneys Material of chimneys of lining Kind of heat fuel
Framing Lumber—Kind Dressed or full size? Corner posts Sills
Size Girder Columns under girders Size Max. on centers
Joists (outside walls and carrying partitions) 2x4-16" O. C. Bridging in every floor and flat roof span over 8 feet.
Joists and rafters: 1st floor 2nd 3rd roof
On centers: 1st floor 2nd 3rd roof
Maximum span: 1st floor 2nd 3rd roof
1 story building with masonry walls, thickness of walls? height?

IF A GARAGE

now accommodated on same lot, to be accommodated number commercial cars to be accommodated
mobile repairing be done other than minor repairs to cars habitually stored in the proposed building?

SIGNED BY: DATE

INSPECTION—PLAN EXAMINER

MISCELLANEOUS no Will work require disturbing of any tree on a public street?

CODE

Will there be in charge of the above work a person competent to see that the State and City requirements pertaining thereto are observed? yes

Signature of Applicant Alan A Foster for Phone #

Type Name of above Honey I  2  3  4

Other and Address

FIELD INSPECTOR'S COPY

APPLICANT'S COPY

OFFICE FILE COPY



**APPLICATION FOR PERMIT**  
**DEPARTMENT OF BUILDING INSPECTIONS SERVICES**  
**ELECTRICAL INSTALLATIONS**

Date July 10, 1984  
 Receipt and Permit number 21875

To the CHIEF ELECTRICAL INSPECTOR, Portland, Maine:

The undersigned hereby applies for a permit to make electrical installations in accordance with the Maine, the Portland Electrical Ordinance, the National Electrical Code and the following specifications:

LOCATION OF WORK: 93-E-20-21 Isl. Ave. Long Isl.  
 OWNER'S NAME: Timothy & Irene Honey ADDRESS: same

COMPLETED  
 3.00

**OUTLETS:**

Receptacles \_\_\_\_\_ Switches \_\_\_\_\_ Plugmold \_\_\_\_\_ ft. TOTAL 1-30

**FIXTURES: (number of)**

Incandescent \_\_\_\_\_ Fluorescent \_\_\_\_\_ (not strip) TOTAL \_\_\_\_\_

Strip Fluorescent \_\_\_\_\_ ft. \_\_\_\_\_

**SERVICES:**

Overhead \_\_\_\_\_ Underground \_\_\_\_\_ Temporary \_\_\_\_\_ TOTAL amperes \_\_\_\_\_

**METERS: (number of)** \_\_\_\_\_

**MOTORS: (number of)**

Fractional \_\_\_\_\_

1 HP or over \_\_\_\_\_

**RESIDENTIAL HEATING:**

Oil or Gas (number of units) \_\_\_\_\_

Electric (number of rooms) \_\_\_\_\_

**COMMERCIAL OR INDUSTRIAL HEATING:**

Oil or Gas (by a main boiler) \_\_\_\_\_

Oil or Gas (by separate units) \_\_\_\_\_

Electric Under 20 kws \_\_\_\_\_ Over 20 kws \_\_\_\_\_

**APPLIANCES: (number of)**

Ranges \_\_\_\_\_

Cook Tops \_\_\_\_\_

Wall Ovens \_\_\_\_\_

Dryers \_\_\_\_\_

Fans \_\_\_\_\_

Water Heaters \_\_\_\_\_

Disposals \_\_\_\_\_

Dishwashers \_\_\_\_\_

Compactors \_\_\_\_\_

Others (denote) \_\_\_\_\_

TOTAL \_\_\_\_\_

**MISCELLANEOUS: (number of)**

Branch Panels \_\_\_\_\_

Transformers \_\_\_\_\_

Air Conditioners Central Unit \_\_\_\_\_

Separate Units (windows) \_\_\_\_\_

Signs 20 sq. ft. and under \_\_\_\_\_

Over 20 sq. ft. \_\_\_\_\_

Swimming Pools Above Ground \_\_\_\_\_

In Ground \_\_\_\_\_

Fire/Burglar Alarms Residential \_\_\_\_\_

Commercial \_\_\_\_\_

Heavy Duty Outlets, 220 Volt (such as welders) 30 amps and under \_\_\_\_\_

over 30 amps \_\_\_\_\_

Circus, Fairs, etc. \_\_\_\_\_

Alterations to wires \_\_\_\_\_

Repairs after fire \_\_\_\_\_

Emergency Lights, battery \_\_\_\_\_

Emergency Generators \_\_\_\_\_

INSTALLATION FEE DUE: \_\_\_\_\_

FOR ADDITIONAL WORK NOT ON ORIGINAL PERMIT ..... DOUBLE FEE DUE: \_\_\_\_\_

FOR REMOVAL OF A "STOP ORDER" (304-16.5) \_\_\_\_\_

TOTAL AMOUNT DUE: \_\_\_\_\_

min

3.00

5.00

**INSPECTION:**

Will be ready on \_\_\_\_\_, 19\_\_; or Will Call

CONTRACTOR'S NAME: Seacast Elec

ADDRESS: Long Isl., Me

TEL: \_\_\_\_\_

MASTER LICENSE NO.: 3088

LIMITED LICENSE NO.: \_\_\_\_\_

SIGNATURE OF CONTRACTOR:

*Hay C. Payne*

INSPECTOR'S COPY — WHITE

OFFICE COPY — CANARY

CONTRACTOR'S COPY — GREEN





S. T. Honey  
93-E- Summer Residence  
20-21 Long Island  
ISL. AVE

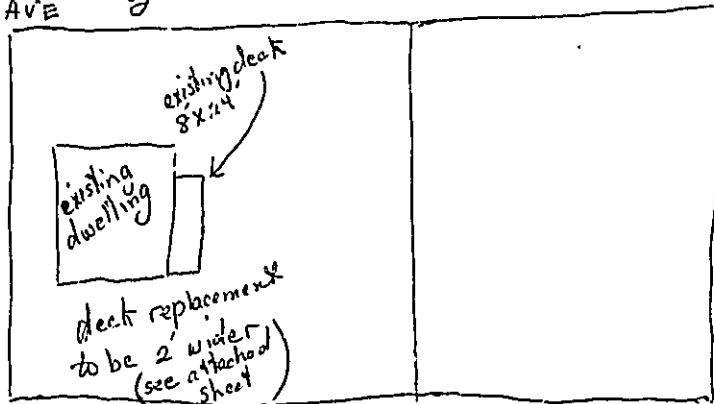

dedeal double lot  
| approx 75' to lot line | SIDE

Contractor:  
Alan A. Foster  
RFD #2, Box 401E  
Hollis Center, Me

RECEIVED  
SEP 28 1984  
DEPT. OF BLDG. INSP.  
CITY OF PORTLAND

Summer House

Kitchen  
Area

Boat  
Landing

Top View

Diagonal  
5/4 x 6 Southern  
Yellow Pine  
Pressure Treated

2x8 Steel  
Bracing

2x8 P.T.S.Y. Joists  
and  
Band Joists  
16" O.C.

RECEIVED

SEP 28 1984

DE BLOG WSP  
CITY OF PORTLAND

Roofing section Detail of Deck

Posts and cap rails  
duplicate original

Top and Bottom Rails  
duplicate of originals.

Ballusters exact 5/4 O.C.  
duplicate of originals.

Steps  
1/2" x 12"

Side View

Lattice Strips  
1/2" x 1 3/4"  
2" square hole

Concrete Filled  
post holes  
1/4" deep x 12" dia.  
16" O.C.

Pressure Treated Pine  
Posts 1 1/2"

Hinged  
and lockable  
collar across posts.  
Lattice covered.



APPLICATION FOR PERMIT

PERMIT ISSUED

B.O.C.A. USE GROUP

B.O.C.A. TYPE OF CONSTRUCTION 012-0

OCT 3 1984

ZONING LOCATION R-3 PORTLAND, MAINE SEPT. 28, 1984

CITY OF PORTLAND

To: the CHIEF OF BUILDING & INSPECTION SERVICES, PORTLAND, MAINE

The undersigned hereby applies for a permit to erect, alter, repair, demolish, move or install the following building, structure, equipment or change use in accordance with the Laws of the State of Maine, the Portland B.O.C.A. Building Code and Zoning Ordinance of the City of Portland with plans and specifications, if any, submitted herewith and the following specifications:

LOCATION 93-E-20-21 Island Ave., Long Isl. Fire District #1, #2

1. Owner's name and address Stephen T. Honey - 26 Orland St. Telephone

2. Lessee's name and address Telephone

3. Contractor's name and address Alan A. Foster - RFD # 2, Box 401E Hollis Ctr., Me. No. of sheets 284-650

Proposed use in building summer cottage No. of families 1

Last use site No. of families

Material No. stories Heat Style of roof Roofing

Other buildings on same lot

Estimated contractual cost \$ 3,900

FIELD INSPECTOR - Mr. Appeal Fees \$

@ 775-5451

Base Fee 30.00

Late Fee

TOTAL \$ 30.00

To remove existing 8' x 24' sun deck and to construct 10' x 24' as per plans. 1 sheet of plans.

Stamp of Special Conditions

send permit to HOLD, WILL PICK UP PERMIT

NOTE TO APPLICANT: Separate permits are required by the installers and subcontractors of heating, plumbing, electrical and mechanicals.

DETAILS OF NEW WORK

Is any plumbing involved in this work? no Is any electrical work involved in this work? no
Is connection to be made to public sewer? If not, what is proposed for sewage?
Has septic tank notice been sent? Form notice sent?
Height average grade to top of plate Height average grade to highest point of roof
Size, front depth No. stories solid or filled land? earth or rock?
Material of foundation Thickness, top bottom cellar
Kind of roof Rise per foot Roof covering
No. of chimneys Material of chimneys of lining Kind of heat fuel
Framing Lumber - Kind Dressed or full size? Corner posts Sills
Size Girder Columns under girders Size Max. on centers
Studs (outside walls and carrying partitions) 2x4-16" O. C. Bridging in every floor and flat roof span over 8 feet.
Joists and rafters: 1st floor, 2nd, 3rd, roof
On centers: 1st floor, 2nd, 3rd, roof
Maximum span: 1st floor, 2nd, 3rd, roof
Is one story building with masonry walls, thickness of walls? height?

IF A GARAGE

No. cars now accommodated on same lot to be accommodated number commercial cars to be accommodated
Will automobile repairing be done other than minor repairs to cars habitually stored in the proposed building?

APPROVALS BY:

DATE

MISCELLANEOUS

BUILDING INSPECTION - PLAN EXAMINER

Will work require disturbing of any tree on a public street? no

ZONING: Alan A. Foster

BUILDING CODE: Alan A. Foster

Will there be in charge of the above work a person competent to see that the State and City requirements pertaining thereto are observed? yes

Fire Dept.:

Health Dept.:

Others:

Signature of Applicant Alan A. Foster Phone # 775-5451

Type: Name of above Alan A. Foster for S. T. Honey 1 2 3 4

Other and Address

