

ISLAND AVE., LONG ISLAND

93-1-1



APPLICATION FOR PERMIT
DEPARTMENT OF BUILDING INSPECTIONS SERVICES
ELECTRICAL INSTALLATIONS

Date May 13, 1976, 19__

Receipt and Permit number A1814

To the CHIEF ELECTRICAL INSPECTOR, Portland, Maine.

The undersigned hereby applies for a permit to make electrical installations in accordance with the laws of Maine, the Portland Electrical Ordinance, the National Electrical Code and the following specifications:

LOCATION OF WORK: 93-E-1 Island Ave. Long Island

OWNER'S NAME: Capt. Norman Hutchinson ADDRESS: same

OUTLETS: (number of)

Lights	_____	
Receptacles	_____	FEES
Switches	_____	
Plugmold	_____ (number of feet)	
TOTAL	_____	_____

FIXTURES: (number of)

Incandescent	_____	
Fluorescent	_____ (Do not include strip fluorescent)	
TOTAL	_____	_____
Strip Fluorescent, in feet	_____	_____

SERVICES:

Permanent, total amperes	<u>200</u>	_____	<u>3.00</u>
Temporary	_____	_____	_____

METERS: (number of) 150

MOTORS: (number of)

Fractional	_____	_____
1 HP or over	_____	_____

RESIDENTIAL HEATING:

Oil or Gas (number of units)	_____	_____
Electric (number of rooms)	_____	_____

COMMERCIAL OR INDUSTRIAL HEATING:

Oil or Gas (by a main boiler)	_____	_____
Oil or Gas (by separate units)	_____	_____
Electric (total number of kws)	_____	_____

APPLIANCES: (number of)

Ranges	_____	Water Heaters	_____
Cook Tops	_____	Disposals	_____
Wall Ovens	_____	Dishwashers	_____
Dryers	_____	Compactors	_____
Fans	_____	Others (denote)	_____
TOTAL	_____		_____

MISCELLANEOUS: (number of)

Branch Panels	_____	_____
Transformers	_____	_____
Air Conditioners	_____	_____
Signs	_____	_____
Fire/Burglar Alarms	_____	_____
Circus, Fairs, etc.	_____	_____
Alteratis. to wires	_____	_____
Repairs & fire	_____	_____
Heavy Duty, 220v outlets	_____	_____
Emergency Lights, battery	_____	_____
Emergency Generators	_____	_____

INSTALLATION FEE DUE: 3.50

FOR ADDITIONAL WORK NOT ON ORIGINAL PERMIT DOUBLE FEE DUE: _____

FOR REMOVAL OF A "STOP ORDER" (304-16.b) _____

FOR PERFORMING WORK WITHOUT A PERMIT (304-9) _____

TOTAL AMOUNT DUE: 3.50

INSPECTION:

Will be ready on _____, 19__; or Will Call X _____

CONTRACTOR'S NAME: Raymond Mitchell, Jr.

ADDRESS: 237 Preble St. South Portland

TEL.: 799-8284

MASTER LICENSE NO.: 3515

SIGNATURE OF CONTRACTOR: _____

LIMITED LICENSE NO.: _____

Raymond Mitchell Jr

INSPECTOR'S COPY

93 1/2

Island and

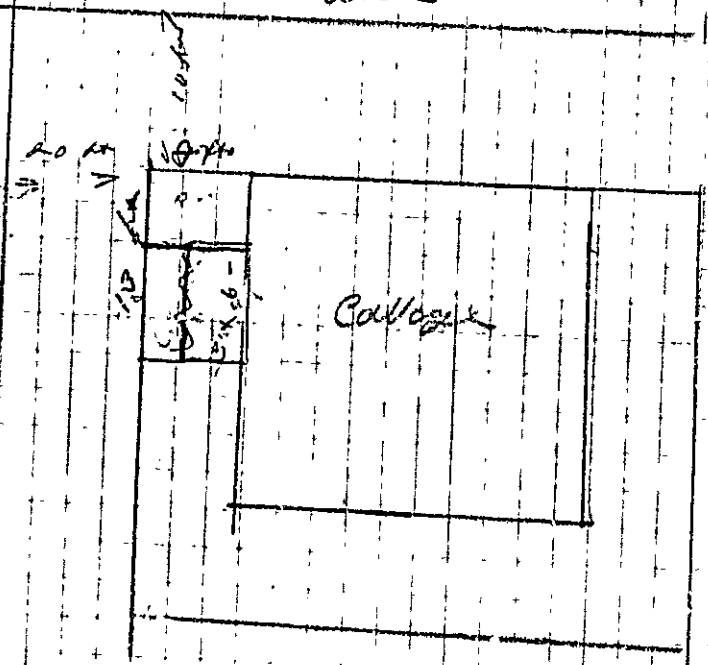

RECEIVED
 NOV 4 1940
 DEPT. OF ELDGE. ENG.
 CITY OF PORTLAND



APARTMENT HOUSE ZONE
APPLICATION FOR PERMIT

Permit No. 1784
NOV 4 1946

Class of Building or Type of Structure _____

Portland, Maine, _____

To the INSPECTOR OF BUILDINGS, PORTLAND, ME.

The undersigned hereby applies for a permit to erect alter or repair the following building structure or equipment in accordance with the Laws of the State of Maine, the Building Code of the City of Portland, plans and specifications, if any, submitted herewith and the following specifications:

Location Inland Avenue Long Island Within Fire Limits? no Dist. No. _____
Owner's or lessee's name and address James L. Connor, 34 Capra St. Bedford, Mass. Telephone _____
Contractor's name and address Thomas Wood, Leavitt St., Long Island Telephone NO
Architect _____ Plans filed yes No. of sheets 1
Proposed use of building Cottage No. families _____
Other buildings on same lot _____
Estimated cost \$ 75. Fee \$.50

Description of Present Building to be Altered

Material wood No. stories 2 Heat _____ Style of roof _____ Roofing _____
Last use Cottage No. families _____

General Description of New Work

To enlarge existing toilet room enclosure on piazza, and also provide new pantry by enclosing portion 8' x 13' on existing side piazza of cottage, as shown on plan window at least three square feet in area for ventilation of toilet room.
To change window to door to lead into new pantry.

It is understood that this permit does not include installation of heating apparatus which is to be taken out separately by and in the name of the heating contractor.

Details of New Work

CERTIFICATE OF COMPLIANCE
REQUIREMENTS WAIVED

Is any plumbing work involved in this work? _____
Is any electrical work involved in this work? _____ Height average grade to top of plate _____
Size, front _____ depth _____ No. stories _____ Height average grade to highest point of roof _____
To be erected on solid or filled land? _____ earth or rock? _____
Material of foundation existing cedar Thickness, top _____ bottom _____ cellar _____
Material of underpinning posts Height _____ Thickness _____
Kind of roof _____ Rise per foot _____ Roof covering _____
No. of chimneys _____ Material of chimneys _____ of lining _____
Kind of heat _____ Type of fuel _____ Is gas fitting involved? _____
Framing lumber - Kind _____ Dressed or full size? _____
Corner posts _____ Sills _____ Girt or ledger board? _____ Size _____
Material columns under girders _____ Size _____ Max. on centers _____
Studs (outside wall; and carrying partitions) 2x4-16" O.C. Girders 6x8 or larger. Bridging in every floor and flat roof span over 8 feet. Sills and corner posts all one piece in cross section.
Joists and rafters: 1st floor _____, 2nd _____, 3rd _____, roof _____
On centers: 1st floor _____, 2nd _____, 3rd _____, roof _____
Maximum span: 1st floor _____, 2nd _____, 3rd _____, roof _____
If one story building with masonry walls, thickness of walls? _____ height? _____

If a Garage

No. cars now accommodated on same lot _____ to be accommodated _____
Total number commercial cars to be accommodated _____
Will automobile repairing be done other than minor repairs to cars habitually stored in the proposed building? _____

Miscellaneous

Will above work require removal or disturbing of any shade tree on a public street? no
Will there be in charge of the above work a person competent to see that the State and City requirements pertaining thereto are observed? yes

Signature of owner

Samuel L. Connor
By Thomas J. Wood

INSPECTION COPY

Permit No. 40/1784
Location: Island Cove Long Isl
Owner: Samuel C. Gordon
Date of perm't 11/4/40.
Notif. closing-in
Inspn. closing-in
Final Notif.
Final Inspn
Cert. of Occupancy issued

NOTES

11/2/40. Work done 93
could not get in E
to back of JB 1

RECEIVED
NOV 11 1940

DESIGNED BY