

ISLAND AVE., LONG ISLAND

93-D-8

CITY OF PORTLAND, MAINE
Application for Permit to Install Wires

Permit No. 57125
 Issued 8/26/68
 Portland, Maine Aug 26, 1968

To the City Electrician, Portland, Maine:

The undersigned hereby applies for a permit to install wires for the purpose of conducting electric current, in accordance with the laws of Maine, the Electrical Ordinance of the City of Portland, and the following specifications:

(This form must be completely filled out — Minimum Fee, \$1.00)

93.0-8

Owner's Name and Address Mrs. Cleo West Tel. _____
 Contractor's Name and Address Paul Beaume Tel. 43678
 Location Island Ave. Long Island Use of Building Summer Cottage
 Number of Families 1 Apartments _____ Stores _____ Number of Stories 1 1/2
 Description of Wiring: New Work _____ Additions Alterations _____
60 Amp to 100amp service.
 Pipe Cable Metal Molding _____ BX Cable _____ Plug Molding (No. of feet) _____
 No. Light Outlets _____ Plugs _____ Light Circuits _____ Plug Circuits _____
 FIXTURES: No. _____ Fluor. or Strip Lighting (No. feet) _____
 SERVICE: Pipe _____ Cable Underground _____ No. of Wires 3 Size 2-2-14
 METERS: Relocated outside Added _____ Total No. Meters _____
 MOTORS: Number _____ Phase _____ H. P. _____ Amps _____ Volts _____ Starter _____
 HEATING UNITS: Domestic (Oil) _____ No. Motors _____ Phase _____ H.P. _____
 Commercial (Oil) _____ No. Motors _____ Phase _____ H.P. _____
 Electric Heat (No. of Rooms) _____
 APPLIANCES: No. Ranges _____ Watts _____ Brand Feets (Size and No) _____
 Elec. Heaters _____ Watts _____
 Miscellaneous _____ Watts _____ Extra Cabinets or Panels _____
 Transformers _____ Air Conditioners (No. Units) _____ Signs (No. Units) _____
 Will commence Aug 27 1968 Ready to cover in _____ 19 _____ Inspection Aug 27 1968
 Amount of Fee \$ 2.00

Signed Paul Beaume
2-5-33

DO NOT WRITE BELOW THIS LINE

SERVICE	<input checked="" type="checkbox"/>	METER		GROUND	<input checked="" type="checkbox"/>
VISITS: 1	2	3	4	5	6
	7	8	9	10	11
REMARKS:					12

INSPECTED BY F. W. Fletcher
 (OVER)

Long Island
LOCATION *Island Av.*
INSPECTION DATE *8/27/68*
WORK COMPLETED *8/27/68*
TOTAL NO. INSPECTIONS *1*
REMARKS:

FEEES FOR WIRING PERMITS EFFECTIVE JULY 31, 1963

WIRING

1 to 30 Outlets \$ 2.00
31 to 60 Outlets 3.00
Over 60 Outlets, each Outlet .05
(Each twelve feet or fraction thereof of fluorescent lighting or
any type of plug molding will be classed as one outlet).

SERVICES

Single Phase 2.00
Three Phase 4.00

MOTORS

Not exceeding 50 H.P. 3.00
Over 50 H.P. 4.00

HEATING UNITS

Domestic (Oil) 2.00
Commercial (Oil) 4.00
Electric Heat (Each Room) .75

APPLIANCES

Range, Cooking Tops, Ovens, Water Heaters, Disposals, Built-in
Dishwashers, Dryers, and any permanent built-in appliance — each
unit 1.50

MISCELLANEOUS

Temporary Service, Single Phase

1.00
2.00

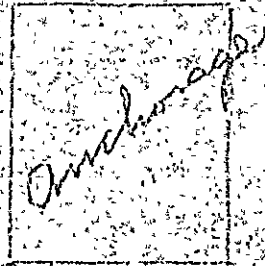
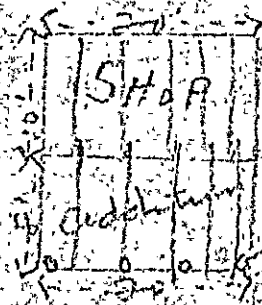

4 Cedar Posts
Buildings 8x20x6 ft
Flat pitched
roof covered
with Paper
Roofing

6717117170.0
332
1012
21
2106.5
708.4
7.2
6717117170.0
11
41
671
671

Shore



(A) APARTMENT HOUSE ZONE
APPLICATION FOR PERMIT **PERMIT ISSUED**

Class of Building or Type of Structure Third Class JUL 13 1934

Portland, Maine, July 12, 1934

To the INSPECTOR OF BUILDINGS, PORTLAND, ME.

The undersigned hereby applies for a permit to ~~erect~~ alter ~~install~~ the following building structure equipment in accordance with the Laws of the State of Maine, the Building Code of the City of Portland, plans and specifications, if any, submitted herewith and the following specifications:

Location Off Inland Avenue, Long Island Ward 1st Within Fire Limits? no Dist. No. _____

Owner's or Lessee's name and address Phone Leasing A. Wade Hooker, 56 Sheridan St., Baverhill, Mass. Telephone _____

Contractor's name and address Geney Telephone _____

Architect's name and address _____

Proposed use of building Private tool and workshop No. families _____

Other buildings on same lot Cottage

Plans filed as part of this application? yes No. of sheets 1

Estimated cost \$ 50 Fee \$ 50

Description of Present Building to be Altered

Material wood No. stories 1 Heat _____ Style of roof pitch Roofing asphalt

Last use Private tool and workshop No. families _____

General Description of New Work

To construct one story addition 8' x 20' to existing one story building which is now 10' x 20'. The addition is more than 10' from either side lot line and more than 25' from the shore line. The studs in the outside walls will be 2x4 no more than 24" from center to center. Unless the rafters rest directly over the studs a double 2x4 plate will be used at the top end of the studs.

INSPECTION NOT COMPLETED

It is understood that this permit does not include installation of heating apparatus which is to be taken out separately and in the presence of the heating contractor.

NOTIFICATION BEFORE LATHING
OR CLOSING IN IS WAIVED
CERTIFICATE OF OCCUPANCY
REQUIREMENT IS WAIVED

Detail of New Work

Height average grade to top of plate _____

Size, front _____ depth _____ No. stories _____ Height average grade to highest point of roof _____

To be erected on solid or filled land? solid earth or rock? earth

Material of foundation concrete Thickness, top _____ bottom _____

Material of underpinning _____ Height _____ Thickness _____

Kind of roof shed Rise per foot 5" Roof covering asphalt roofing Class O Und. Lab.

No. of chimneys no Material of chimneys _____ of lining _____

Kind of heat no Type of fuel _____ Is gas fitting involved? _____

Corner posts 4x4 Sills 4x4 Girt or ledger board? _____ Size _____

Material columns under girders _____ Size _____ Max. on centers _____

Studs (outside walls and carrying partitions) 2x4-16" O. C. Girders 6x8 or larger. Bridging in every floor and flat roof span over 8 feet. Sills and corner posts all one piece in cross section.

Joists and rafters: 1st floor 2x6, 2nd _____, 3rd _____, roof 2x4 or 2x6

On centers: 1st floor 18", 2nd _____, 3rd _____, roof 18" to 24"

Maximum span: 1st floor 8', 2nd _____, 3rd _____, roof 8' to 9'

If one story building with masonry walls, thickness of walls? _____ height? _____

If a Garage:

No. cars now accommodated on same lot _____, to be accommodated _____

Total number commercial cars to be accommodated _____

Will automobile repairing be done other than minor repairs to cars habitually stored in the proposed building? _____

Miscellaneous

Will above work require removal or disturbing of any shade tree on a public street? no

Will there be in charge of the above work a person competent to see that the State and City requirements pertaining thereto are observed? _____

A. Wade Hooker

Signature of owner

INSPECTION COPY

By Priscilla L. Poole

72338

Ward 2nd / Permit No 34/937

Loc Off Island Ave. front

Owner A. Manda Hooker

Date of permit 7/12/34

Notif. closing-in

Inspn. closing-in

Final Notif.

Final Inspn.

Cert. of Occupancy issued

8/20/34 NOTES
This work well etc. An opening about 6'0" is to be cut between old land new work, will have a 4x6 wooden plate making a 4x8 and will have a opening at both ends.

7/26/35. A 14'0" opening has been cut and a 4x8 used as a header. This 2 course is quite overlaid. It talked with Floyd who helped Mr. Hooker do the work. He said he would put a post in to cut down the spars. Also smoke pipe which extends through main door of outside wall

to be removed. 9/26/35. The one chimney also

8/27/36. Mr. Hooker not here, etc. does not look as though anything has been done to strengthen the opening between the existing building and addition covered by this permit. The stone and the metal smoke pipe, through the outside wall, had not been removed.

4x14x45 = 22 22
4x14x30 = 21 00
46 00

8/13/37. In storage it is difficult to see how the rapids in weather bearing when in roof shows this. Mr. Hooker argued that due to the construction this 4x8 with 2x4 floor joists was plenty strong. Although the stone is removed at this time the smoke pipe outside is still in place and Mr.

Hooker served notice that he is going to put the stone up when it gets chilly and is needed. etc.





(A) APARTMENT HOUSE ZONE PERMIT ISSUED
APPLICATION FOR PERMIT

Permit No. 0537

Class of Building or Type of Structure: Third Class

MAY 29 1934

To the INSPECTOR OF BUILDINGS, PORTLAND, ME.

Portland, Maine, May 22, 1934

The undersigned hereby applies for a permit to erect alter install the following building structure equipment in accordance with the Laws of the State of Maine, the Building Code of the City of Portland, plans and specifications, if any, submitted herewith and the following specifications:

Location: Off Island Avenue, Long Island Ward Inl. 1 Within Fire Limits? no Dist. No. _____

Owner's or Lessee's name and address: Mrs. A. Maude Hooker, 55 Sheridan St. Telephone _____

Contractor's name and address: J. M. Gray, Long Island, Haverhill, Mass. Telephone _____

Architect's name and address _____ Telephone _____

Proposed use of building: Cottages No. families _____

Other buildings on same lot _____

Plans filed as part of this application? no No. of sheets _____

Estimated cost: \$90.00 Fee \$ 50

Description of Present Building to be Altered

Material: wood No. stories: 1 1/2 Heat _____ Style of roof _____ Roofing _____

Last use: Cottage No. families _____

General Description of New Work

To replace existing cedar post foundation under a portion of the cottage with concrete foundation wall 10" thick at the top and 12" thick at the bottom and extending to ledge, this section of new wall to be about thirty lineal feet.

NOTIFICATION BEFORE LATHING OR CLOSING-IN IS WAIVED.

CERTIFICATE OF OCCUPANCY REQUIREMENT IS WAIVED.

It is understood that this permit does not include installation of heating apparatus which is to be taken out separately by and in the name of the heating contractor.

Details of New Work

Size, front _____ depth _____ No. stories _____ Height average grade to top of plate _____

To be erected on solid or filled land? _____ Height average grade to highest point of roof _____
earth or rock? _____

Material of foundation: concrete trench wall thickness, top: 10" bottom: 12"

Material of underpinning _____ Height _____ Thickness _____

Kind of Roof: _____ Rise per foot _____ Roof covering _____

No. of chimneys _____ Material of chimneys _____ of lining _____

Kind of heat _____ Type of fuel _____ Is gas fitting involved? _____

Corner posts _____ Sills _____ Girt or ledger board? _____ Size _____

Material columns under girders _____ Size _____ Max. on centers _____

Studs (outside walls and carrying partitions) 2x4-16" O. C. Girders 6x8 or larger. Bridging in every floor and flat roof span over 8 feet. Sills and corner posts all one piece in cross section.

Joists and rafters: 1st floor _____, 2nd _____, 3rd _____, roof _____

On centers: 1st floor _____, 2nd _____, 3rd _____, roof _____

Maximum span: 1st floor _____, 2nd _____, 3rd _____, roof _____

If one story building with masonry walls, thickness of walls? _____ height? _____

If a Garage

No. cars now accommodated on same lot _____ to be accommodated _____

Total number commercial cars to be accommodated _____

Will automobile repairing be done other than minor repairs to cars habitually stored in the proposed building? _____

Miscellaneous

Will above work require removal or disturbing of any shade tree on a public street? no

Will there be in charge of the above work a person competent to see that the State and City requirements pertaining thereto are observed? YES

Mrs. A. Maude Hooker

Signature of owner

By

INSPECTION COPY

Ward 34 / Permit No. 34/637

Location Off Island Ave. Long Is.

Owner A. Maude Hobbes

Date of permit 5/23/34

Notif. closing-in

Inspn. closing-in

Final Notif.

Final Inspn.

Cert. of Occupancy issued None

NOTES 93

6/29/34
This work is pretty
well about half closed
in list appears O.K.
Q.B.

TRIPER CO

93-D-8

Mrs. West.

P.L. get
lot number of this
100... property.

and

9/17/30.

A. Mande Hooker

"Anchorage"

93-D-8

C-30-184

35 Lincoln St.
Haverhill, Mass.



HARRY A. BRINAGHOFF
CITY MANAGER

City of Portland, Maine

EXECUTIVE DEPARTMENT

August 26, 1930.

Mr. Warren McDonald,
Building Inspector,
BUILDING.

Dear Sir:

Attached hereto is copy of a letter from Mr. Patrick J. Quinn which mentions a building permit matter which comes under your jurisdiction.

Yours truly,

J. B. Quinn
City Manager.

JEB:EGC

*E. J. Hanigan F7432 came
97 Exchange
today. I agreed to meet him
and notify him*

*run
9/1/30*

COPY.

83 Jun Avenue,
West Newton, Mass.

Mr. Barlow,
City Manager.

Dear Sir:

I am writing to ask if you will take up the matter for me with the proper departments and see if you can help us out.

I have a summer cottage at the west end of Long Island and my family are there for the summer.

A dog at the cottage bit my little girl, 5 years old, last Tuesday, and the next day M. J. Quinn complained to Mr. Dresser, the man on duty at the island.

She asked that the dog be restrained and explained what happened.

I was there over the week end and the dog is very vicious to the little ones on the point. He jumped up on my little girl and caught her on the right cheek bone close to her eye. I was in the time and what can you do to remedy this situation?

One thing more will you tell me if the Board of Health given to Mr. Hooper to remodel a small house into a home and has the Board of Health given permission to keep a home?

I call this to your attention as my place is just above the beach land and I think it should be attended to and the point of view was intended, a strictly residential section.

I am not able to call on you at Fortland but hoped this morning. I hope you will be able to see me at the office in the city at 11:00 AM.

Very truly yours,
Ed. Quinn

Complaint No. C-50-104CITY OF PORTLAND, MAINE
DEPARTMENT OF BUILDING INSPECTION

COMPLAINT

Location Island Avenue
West End, Long Island 92-D-P-2 Ward 1Owner's name and address A. Maude Becker 35 Heriden St. Haverhill, Mass. Telephone _____

Tenant's name and address _____ Telephone _____

Use of building _____

General Description

Letter attached to inspection copy of complaint

Complainant's name and address Patrick J. Quinn Telephone _____

Date of examination and conditions found _____

Action taken _____

INSPECTION COPY

93-D-8

since

War 1 Complaint No. C-30-124

Location West End Long Is.

Date Received August 1930

Disposed of 10/30/31 See

note below

NOTES

~~10/30/31~~

In fall of 1930, the
matter was up and
Mr. Hoche was about
to move the pony up
to the country.
Early in summer of 1931
Mr. Hoche called
in about it and was
told that he must
make proper disposal
of manure. Talked
with him about the
report that infantile
paralysis had been
traced in some
case to horse manure.
Mr. Hoche left to
investigate the
affair and I have
not heard from him.

Cedar Posts not more than 6 ft apart
Sills 4x6 with 6" side vertices
4x4 corner posts
Rafters 2x4 24" centers
Studing 2x4

93. P. 5

(A) APARTMENT HOUSE ZONE

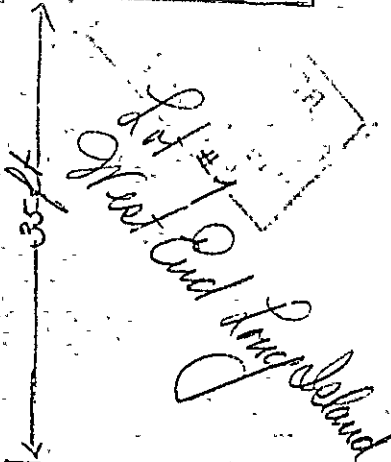
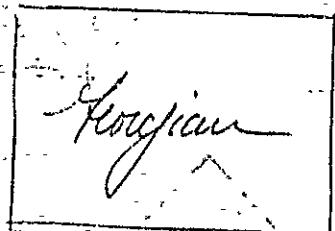

35 ft

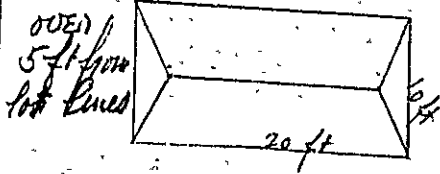



(A) APARTMENT HOUSE EONE

PERMIT ISSUED

Permit No. 1239

APPLICATION FOR PERMIT

JUN 28 1928

Class of Building or Type of Structure Third Class

Portland, Maine, June 26, 1928.

To the INSPECTOR OF BUILDINGS, PORTLAND, ME.

The undersigned hereby applies for a permit to erect ~~the following~~ the following building structure ~~equipment~~ in accordance with the Laws of the State of Maine, the Building Code of the City of Portland, plans and specifications, if any, submitted herewith and the following specifications:

Location Long Island Ward 1 Within Fire Limits? no Dist. No.
Owner's name and address Carl E. Craven, 6/27/28, E. C. Long Island Telephone
Contractor's name and address Carl P. Hooker, Long Island Telephone
Architect's name and address No. families

Proposed use of building tool shed
Other buildings on same lot 1 family cottage

Description of Present Building to be Altered

Material No. stories Heat Style of roof Roofing
Last use No. families

General Description of New Work

To erect tool-shed 20' x 10'.

NOTIFICATION BY ONE LAWFUL OR CLOSING IS WAIVED.
CERTIFICATE OF OCCUPANCY REQUIREMENT IS WAIVED.

Details of New Work

Size, front 20' depth 10' No. stories 1 Height average grade to highest point of roof 12'

To be erected on solid or filled land? solid earth or rock? earth

Material of foundation cedar posts Thickness, top bottom

Material of underpinning Height Thickness

Kind of roof hip Roof covering asphalt shingles Class C.

No. of chimneys no Material of chimneys of lining

Kind of heat no Type of fuel Distance, heater to chimney

If oil burner, name and model

Capacity and location of oil tanks

Is gas fitting involved? no Size of service

Corner posts 4x4 Sills 4x6 Girt or ledger board? Size Max. on centers

Material columns under girders Size

Studs (outside walls and carrying partitions) 2x4-16" O.C. Girders 6x8 or larger. Bridging in every floor and flat roof span over 8 feet. Sills and corner posts all one piece in cross section.

Joists and rafters: 1st floor 2x8, 2nd , 3rd , roof 2x4

On centers: 1st floor 24", 2nd , 3rd , roof 24"

Maximum span: 1st floor 10', 2nd , 3rd , roof

If one story building with masonry walls, thickness of walls? height?

If a Garage

No. cars now accommodated on same lot , to be accommodated

Total number commercial cars to be accommodated

Will automobile repairing be done other than minor repairs to cars habitually stored in the proposed building?

Miscellaneous

Will above work require removal or disturbing of any shade tree on a public street? no

Plans filed as part of this application? yes No. sheets 1

Estimated cost \$ 400. Fee \$.70

Will there be in charge of the above work a person competent to see that the State and City requirements pertaining thereon are observed? yes

Signature of owner Doris E. Craven
John B. Craven

INSPECTION COPY

6856P

Ward 1 Permit No. 287239
 Prince Ldg.
 Location West End Ferry Island
 Insp. Carl E. Kooker
Doris E. Warren
 Date of permit 6/26/28
 Notif. closing-in _____
 Insp. closing-in _____
 Final Notif. 93-D-8
 Final Inspn. _____
 Cert. of Occupancy issued _____

NOTES
 P.I.F.
 3/11/29

~~ATTENTION JOB BEING
 ABANDONED
 3/11/29~~

RECEIVED BY INSPECTOR

2000

[Faint, mostly illegible text and markings in the right margin, possibly including a date like 'MAY 29 1929']