

ISLAND AVE., LONG ISLAND

93-C-8

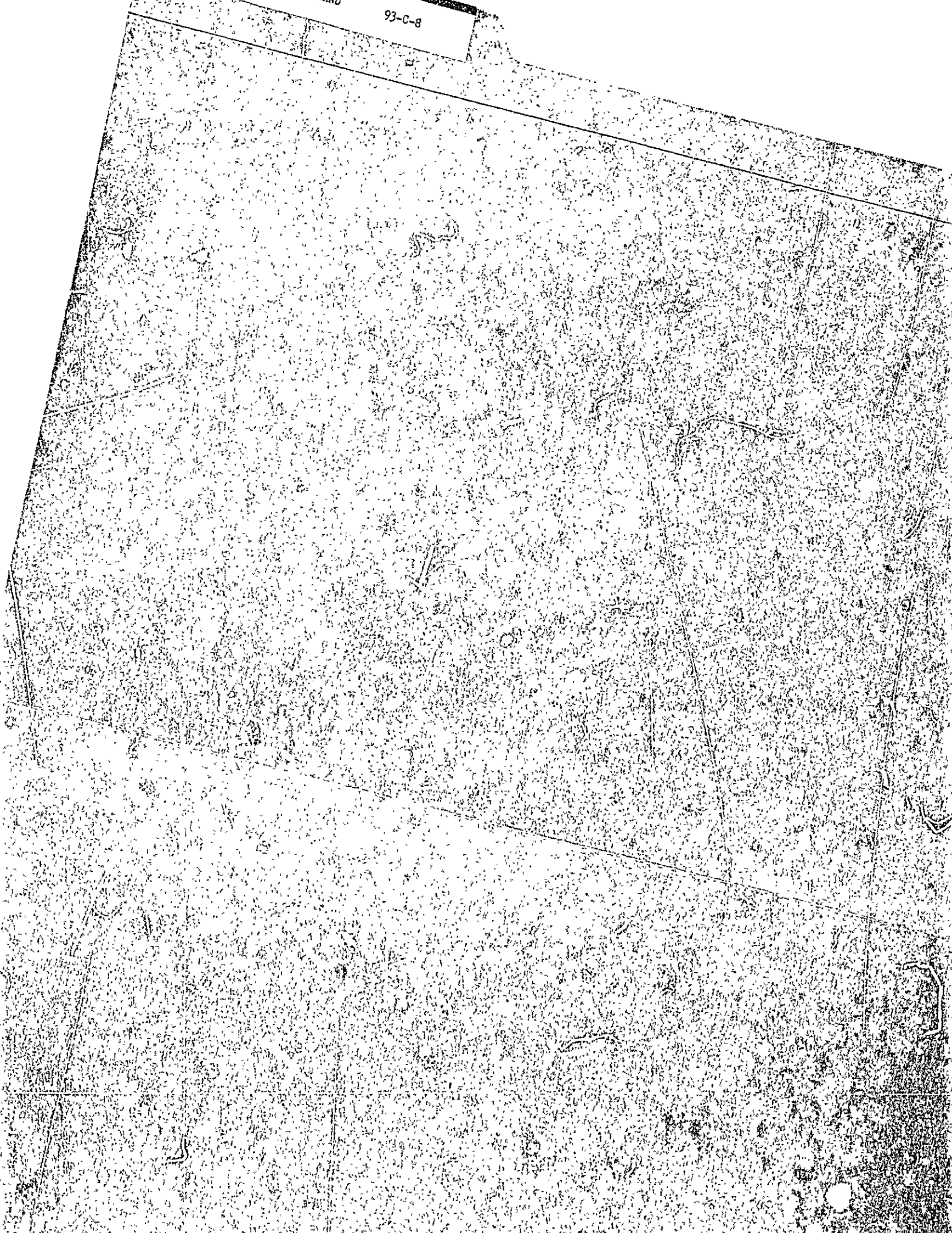



APPLICATION FOR PERMIT
DEPARTMENT OF BUILDING INSPECTIONS SERVICES
ELECTRICAL INSTALLATIONS

Date July 22, 1980
 Receipt and Permit number A 51521

To the CHIEF ELECTRICAL INSPECTOR, Portland, Maine:

The undersigned hereby applies for a permit to make electrical installations in accordance with the laws of Maine, the Portland Electrical Ordinance, the National Electrical Code and the following specifications:

LOCATION OF WORK: 93-C-8 Island Ave. Long Island
 OWNER'S NAME: xxx Joseph Donovan ADDRESS: same

		FEES	
OUTLETS:	Receptacles _____	Switches _____	Plugmold _____
	ft. TOTAL _____		
FIXTURES: (number of)	Inandescent _____	Flourescent _____	(not strip) TOTAL _____
	Strip Flourescent _____ ft. _____		
SERVICES:	Overhead <input checked="" type="checkbox"/> _____	Underground _____	Temporary _____
	TOTAL amperes <u>200</u>		<u>3.00</u>
METERS: (number of)	<u>1</u>		<u>.50</u>
MOTORS: (number of)	Fractional _____		
	1 HP or over _____		
RESIDENTIAL HEATING:	Oil or Gas (number of units) _____		
	Electric (number of rooms) _____		
COMMERCIAL OR INDUSTRIAL HEATING:	Oil or Gas (by a main boiler) _____		
	Oil or Gas (by separate units) _____		
	Electric Under 20 kws _____	Over 20 kws _____	
APPLIANCES: (number of)	Ranges _____	Water Heaters _____	
	Cook Tops _____	Disposals _____	
	Wall Ovens _____	Dishwashers _____	
	Dryers _____	Compactors _____	
	Fans _____	Others (denote) _____	
	TOTAL _____		
MISCELLANEOUS: (number of)	Branch Panels _____		
	Transformers _____		
	Air Conditioners Central Unit _____		
	Separate Units (windows) _____		
	Signs 20 sq. ft. and under _____		
	Over 20 sq. ft. _____		
	Swimming Pools Above Ground _____		
	In Ground _____		
	Fire/Burglar Alarms Residential _____		
	Commercial _____		
	Heavy Duty Outlets, 220 Volt (such as welders) 30 amps and under _____		
	over 30 amps _____		
	Circus, Fairs, etc. _____		
	Alterations to wires _____		
	Repairs after fire _____		
	Emergency Lights, battery _____		
	Emergency Generators _____		
	INSTALLATION FEE DUE: _____		
	DOUBLE FEE DUE: _____		
	FOR REMOVAL OF A "STOP ORDER" (304-16.b) _____		
	TOTAL AMOUNT DUE:		<u>3.50</u>

INSPECTION:
 Will be ready on _____, 19__; or Will Call
CONTRACTOR'S NAME: Harry Papkee
ADDRESS: Long Island, Maine
TEL.: _____
MASTER LICENSE NO.: 3088 **SIGNATURE OF CONTRACTOR:**
LIMITED LICENSE NO.: _____ Harry C. Papkee

INSPECTOR'S COPY — WHITE
 OFFICE COPY — CANARY
 CONTRACTOR'S COPY — GREEN

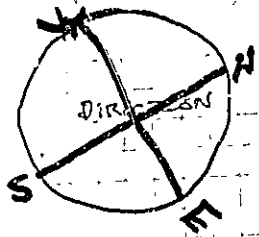

TO WATER
160'

TO WATER
160'

TO PROPERTY
LINE

TO PROPERTY
LINE

TO ROAD
LINE

TO PROPERTY
LINE

PORCH

All headers to consist
of Double 3x10 (Douglas Fir)
2 windows
1 sliding door

SLIDING
GLASS 6x6
DOOR

LIVING ROOM

10'
TO ROAD
LINE

12'
WINDOW
EXTEND
KITCHEN

Kitchen

Bed Room

TO ROAD
LINE

TO PROPERTY
LINE

RECEIVED
APR 18 1980
DEPT. OF BLDG. INSP.
CITY OF PORTLAND

ONE STORY

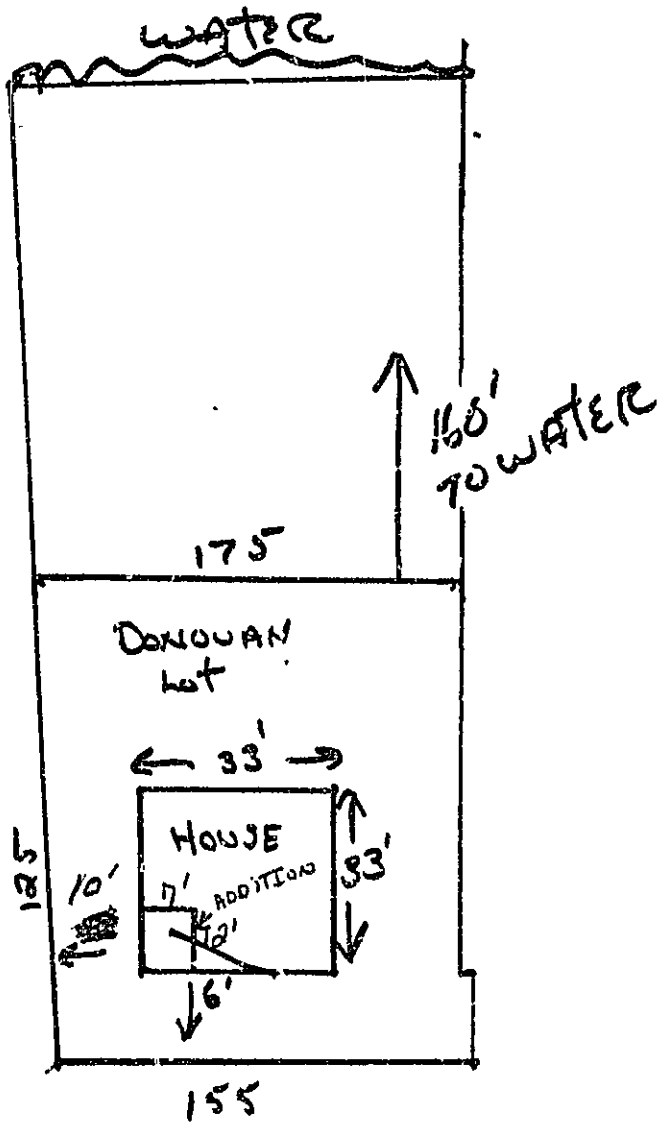

RECEIVED
 APR 18 1980
 DEPT. OF BLDG. INSP.
 CITY OF PORTLAND



APPLICATION FOR PERMIT

PERMIT ISSUED

B.O.C.A. USE GROUP

B.O.C.A. TYPE OF CONSTRUCTION

ZONING LOCATION R-3 PORTLAND, MAINE, April 18, 1980

APR 22 1980
00 204
CITY OF PORTLAND

To the DIRECTOR OF BUILDING & INSPECTION SERVICES, PORTLAND, MAINE

The undersigned hereby applies for a permit to erect, alter, repair, demolish, move or install the following building, structure, equipment or change use in accordance with the Laws of the State of Maine, the Portland B.O.C.A. Building Code and Zoning Ordinance of the City of Portland with plans and specifications, if any, submitted herewith and the following specifications:

LOCATION 93 C-8 Island Ave., Long Island Fire District #1 #2

1. Owner's name and address J. Dickert, Donovan Telephone 766-5563

2. Lessee's name and address Telephone

3. Contractor's name and address Owner Telephone

4. Architect Specifications Plans No. of sheets

Proposed use of building dwelling No. families

Last use No. families

Material No. stories Heat Style of roof Roofing

Other buildings on same lot Fee \$ 5.50

Estimated contractual cost \$ 900.00

FIELD INSPECTOR—Mr.

GENERAL DESCRIPTION

This application is for:

@ 775-5451
Ext. 234

To construct 7'x12' addition to kitchen
as per plan

Dwelling

Garage

Masonry Bldg.

Metal Bldg.

Alterations

Demolitions

Change of Use

Other

To install sliding glass door in living room
Stamp of Special Conditions

NOTE TO APPLICANT. Separate permits are required by the installers and subcontractors of heating, plumbing, electrical and mechanical.

PERMIT IS TO BE ISSUED TO 1 2 3 4

Other:

DETAILS OF NEW WORK

Is any plumbing involved in this work? Is any electrical work involved in this work?

Is connection to be made to public sewer? If not, what is proposed for sewage?

Has septic tank notice been sent? Form notice sent?

Height average grade top of pipe Height average grade to highest point of roof

Size, front depth No. stories solid or filled land? earth or rock?

Material of foundation. Manholes Thickness, top 10" bottom cellar

Kind of roof Patch Rise per foot Roof covering asphalt shingles

No. of chimneys Material of chimneys of lining Kind of hearth fuel

Framing Lumber—Kind Dressed or full size? Corner posts Sills

Size Girder Columns under girders Size Max. on centers

Studs (outside walls and carrying partitions) 2x4-16" O. C. Bridging in every floor and flat roof span over 8 feet.

Joists and rafters: 1st floor 2nd 3rd roof

On centers: 1st floor 2nd 3rd roof

Maximum span: 1st floor 2nd 3rd roof

If one story building with masonry walls, thickness of walls? height?

IF A GARAGE

No. cars now accommodated on same lot to be accommodated number commercial cars to be accommodated

Will automobile repairing be done other than minor repairs to cars habitually stored in the proposed building?

APPROVALS BY:

DATE

MISCELLANEOUS

BUILDING INSPECTION—PLAN EXAMINER

ZONING: O.K. M.A.W. 4/18/80

BUILDING CODE:

Fire Dept.:

Health Dept.:

Others:

Will work require disturbing of any tree on a public street? NO

Will there be in charge of the above work a person competent to see that the State and City requirements pertaining thereto are observed? YES

Signature of Applicant

John J. Donovan

Phone # 766-5563

Type Name of above: J. D. Donovan

Other and Address

FIELD INSPECTOR'S COPY

NOTES

Aug 25, 1980

Started the addition, no foundation started; It appears as if the contractor is going to use treated wood sills at grade level; No one present at this time 11 am; Will contact owner to use concrete foundation down 4' or to the depth that appears to be the most pronounced in this area 6" above grade;

Sliding glass door installed; Header OK;

5-26-81 - All work okay. released step order on patio. Ad

10-14-81 Final Insp. Complete OK Ad

Approved

Date of permit 4-22-80

Owner

J. D. Rowman

Location 93 C-8 Seland Ave.

89

Permit No 80/204



(A) APARTMENT HOUSE ZONE

Permit No.

APPLICATION FOR PERMIT

0507
APR 8 1950

Class of Building or Type of Structure Third Class

Portland, Maine, April 1, 1950

To the INSPECTOR OF BUILDINGS, PORTLAND, ME.

The undersigned hereby applies for a permit to ~~erect~~ alter in ~~the~~ following building structure ~~erected~~ in accordance with the Laws of the State of Maine, the Building Code of the City of Portland, plans and specifications, if any, submitted herewith and the following specifications:

Location 127 Island Avenue, Long Island Ward 1 Within Fire Limits? no Dist. No. _____

Owner's name and address Miss Irene M. Ferry 77 Washington Ave. Telephone P 685

Contractor's name and address _____ Telephone _____

Architect's name and address _____

Proposed use of building summer cottage No. families _____

Other buildings on same lot _____

Description of Present Building to be Altered

Material wood No. stories 2 Heat _____ Style of roof _____ Roofing _____

Last use summer cottage No. families _____

General Description of New Work

To build one story addition on rear of cottage 12' x 13'

Details of New Work

Size, front 12' depth 13' No. stories 1 Height average grade to highest point of roof 12'

To be erected on solid or filled land? solid earth or rock? earth

Material of foundation concrete piers Thickness, top _____ bottom _____

Material of underpinning _____ Height _____ thickness _____

Kind of roof flat 4" to foot Roof covering asphalt roofing Class C Und Lab.

No. of chimneys no Material of chimneys _____ of lining _____

Kind of heat no Type of fuel _____ Distance, heater to chimney _____

If oil burner, name and model _____

Capacity and location of oil tanks _____

Is gas fitting involved? _____ Size of service _____

Corner posts 4x4 Sills 4x4 Girt or ledger board? _____ Size _____

Material columns under girders _____ Max. on centers _____

Studs (outside walls and carrying partitions) 2x4-16" O. C. Girders 6x3 or larger. Bridging in every floor and flat roof span over 8 feet. Sills and corner posts all one piece in cross section.

Joists and rafters: 1st floor 2x8, 2nd _____, 3rd _____, roof 2x8

On centers: 1st floor 16", 2nd _____, 3rd _____, roof 16"

Maximum span: 1st floor 12', 2nd _____, 3rd _____, roof 12'

If one story building with masonry walls, thickness of walls? _____ height? _____

If a Garage

No. cars now accommodated on same lot _____, to be accommodated _____

Total number commercial cars to be accommodated _____

Will automobile repairing be done other than minor repairs to cars habitually stored in the proposed building? _____

Miscellaneous

Will above work require removal or disturbing of any shade tree on a public street? no

Plans filed as part of this application? yes No. sheets 1

Estimated cost \$ 90 Fee \$ 50

Will there be in charge of the above work a person competent to see that the State and City requirements pertaining thereto are observed? yes

Signature of owner Miss Irene M. Ferry *W. E. ...*

INSPECTION COPY

200 to 14 ...

364-7

Ward 1 Permit No. 30/507

Location: Off Island Ave Long Is

Miss Jean M. Lewis

Date of permit 4/8/30

Notif. closing-in

Inspn. closing-in

Final Notif.

pn

Cert. of Occupancy issued

NOTES

Sheet # 73
Lot # 8
C

9/12/30 - no
budgeting in floor
Pass it up

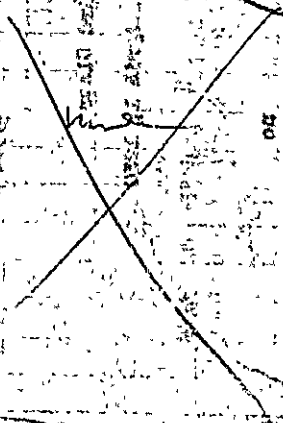

City of New York
Department of Public Works

Permit No. 30/507



APPLICATION FOR PERMIT
DEPARTMENT OF BUILDING INSPECTIONS SERVICES
ELECTRICAL INSTALLATIONS

Date 9/17/91, 19
 Receipt and Permit number 3088

To the CHIEF ELECTRICAL INSPECTOR, Portland, Maine:

The undersigned hereby applies for a permit to make electrical installations in accordance with the laws of Maine, the Portland Electrical Ordinance, the National Electrical Code and the following specifications:

LOCATION OF WORK: Island Ave - Long Island

OWNER'S NAME: Barron Estate - ADDRESS: c/o Joseph Donovan 93-C-8

	FEES	
OUTLETS:		
Receptacles <input checked="" type="checkbox"/> Switches <input checked="" type="checkbox"/> Plugmold _____ ft. TOTAL <u>50</u>	10.00	
FIXTURES: (number of)		
Incandescent <u>12</u> Fluorescent _____ (not strip) TOTAL <u>12</u>	2.40	
Strip Fluorescent _____ ft.		
SERVICES:		
Overhead <input checked="" type="checkbox"/> Underground _____ Temporary _____ TOTAL amperes <u>100</u>	15.00	
METERS: (number of) <u>1</u>	1.00	
MOTORS: (number of)		
Fractional _____		
HP or over _____		
RESIDENTIAL HEATING:		
Oil or Gas (number of units) _____		
Electric (number of rooms) _____		
COMMERCIAL OR INDUSTRIAL HEATING:		
Oil or Gas (by a main boiler) _____		
Oil or Gas (by separate units) _____		
Electric Under 20 kws _____ Over 20 kws _____		
APPLIANCES: (number of)		
Ranges <u>1</u> Water Heaters <u>1</u>		
Cook Tops _____ Disposals _____		
Wall Ovens _____ Dishwashers _____		
Dryers _____ Compactors _____		
Fans _____ Others (denote) _____		
TOTAL <u>2</u>	4.00	
MISCELLANEOUS: (number of)		
Branch Panels _____		
Transformers _____		
Air Conditioners Control Unit _____		
Separate Units (windows) _____		
Signs 20 sq. ft. and under _____		
Over 20 sq. ft. _____		
Swimming Pools Above Ground _____		
In Ground _____		
Fire/Burglar Alarms Residential _____		
Commercial _____		
Heavy Duty Outlets, 220 Volt (such as welders) 30 amps and under _____		
over 30 amps _____		
Circus, Fairs, etc. _____		
Alterations to wires _____		
Repairs after fire _____		
Emergency Lights, battery _____		
Emergency Generators _____		
	INSTALLATION FEE DUE:	
FOR ADDITIONAL WORK NOT ON ORIGINAL PERMIT DOUBLE FEE DUE:		
FOR REMOVAL OF A "STOP ORDER" (304-16.b)		
TOTAL AMOUNT DUE:	<u>32.40</u>	

INSPECTION:
 Will be ready on _____, 19____; or Will Call
 CONTRACTOR'S NAME: Seacoast Electric
 ADDRESS: 58 Fore St - Portland
 TEL: 774-5179
 PER LICENSE NO.: Papke #03088 SIGNATURE OF CONTRACTOR: Harry C. Papke
 EXPIRED LICENSE NO.: _____

INSPECTOR'S COPY — WHITE
 OFFICE COPY — CANARY
 CONTRACTOR'S COPY — GREEN:

