



APPLICATION FOR PERMIT
DEPARTMENT OF BUILDING INSPECTIONS SERVICES
ELECTRICAL INSTALLATIONS

Date July 31, 19 81
 Receipt and Permit number A 72997

To the CHIEF ELECTRICAL INSPECTOR, Portland, Maine:

The undersigned hereby applies for a permit to make electrical installations in accordance with the laws of Maine, the Portland Electrical Ordinance, the National Electrical Code and the following specifications:

LOCATION OF WORK: 93-B-14 Rear Isl. Ave. Long Island

OWNER'S NAME: Frank Duley ADDRESS: lives there

	FEES
OUTLETS:	
Receptacles _____ Switches _____ Plugmold _____ ft. TOTAL _____	
FIXTURES: (number of)	
Incandescent _____ Fluorescent _____ (not strip) TOTAL _____	
Strip Fluorescent _____ ft. _____	
SERVICES:	
Overhead _____ Underground _____ Temporary _____ TOTAL amperes _____	
METERS: (number of) _____	
MOTORS: (number of)	
Fractional _____	
1 HP or over _____	
RESIDENTIAL HEATING:	
Oil or Gas (number of units) _____	
Electric (number of rooms) <u>4</u> _____	4.00
COMMERCIAL OR INDUSTRIAL HEATING:	
Oil or Gas (by a main boiler) _____	
Oil or Gas (by separate units) _____	
Electric Under 20 kws _____ Over 20 kws _____	
APPLIANCES: (number of)	
Ranges _____ Water Heaters _____	
Cook Tops _____ Disposals _____	
Wall Ovens _____ Dishwashers _____	
Dryers _____ Compactors _____	
Fans _____ Others (denote) _____	
TOTAL _____	
MISCELLANEOUS: (number of)	
Branch Panels _____	
Transformers _____	
Air Conditioners Central Unit _____	
Separate Units (windows) _____	
Signs 20 sq. ft. and under _____	
Over 20 sq. ft. _____	
Swimming Pools Above Ground _____	
In Ground _____	
Fire/Burglar Alarms Residential _____	
Commercial _____	
Heavy Duty Outlets, 220 Volt (such as welders) 30 amps and under _____	
over 30 amps _____	
Circus, Fairs, etc. _____	
Alterations to wires _____	
Repairs after fire _____	
Emergency Lights, battery _____	
Emergency Generators _____	
INSTALLATION FEE DUE: _____	
FOR ADDITIONAL WORK NOT ON ORIGINAL PERMIT ... DOUBLE FEE DUE: _____	
FOR REMOVAL OF A "STOP ORDER" (304-16.b) ... _____	
TOTAL AMOUNT DUE: _____	4.00

INSPECTION:

Will be ready on ready, 19 81; or Will Call _____

CONTRACTOR'S NAME: Harry Papkoe

ADDRESS: Long Island, Me.

TEL: _____

MASTER LICENSE NO.: 03088 SIGNATURE OF CONTRACTOR: _____

LIMITED LICENSE NO.: _____ Harry Papkoe

INSPECTOR'S COPY — WHITE

OFFICE COPY — CANARY

CONTRACTOR'S COPY — GREEN

ELECTRICAL INSTALLATIONS—

Permit Number 72997
Location 93 B-14 Rear Island
Owner F. Dudley
Date of Permit 7-31-81
Final Inspection 10-14-81
By Inspector W. Kelly
Permit Application Register Page No 94

INSPECTIONS: Service _____ by _____
Service called in _____
Closing-in _____ by _____
PROGRESS INSPECTIONS: 10-14-81 / _____ / _____
/ _____ / _____ / _____
/ _____ / _____ / _____

CODE
COMPLIANCE
COMPLETED
DATE 10-14-81

DATE:	REMARKS:

Long Island
Long Island

34-8-14
St. Andrew Ave

RECEIVED
SEP 28 1940
DEPT. OF CLERK. INSP.
CITY OF PORTLAND

80 ft. to
O'Malley

120 ft

to be cleared

10 ft

50 ft to
St. Andrew

Parish

Cottage

own parish



APARTMENT HOUSE ZONE
APPLICATION FOR PERMIT

PERMIT ISSUED

Class of Building or Type of Structure Third Class

SEP 28 1940
Portland, Maine, September 28, 1940

To the INSPECTOR OF BUILDINGS, PORTLAND, ME.

The undersigned hereby applies for a permit to erect alter install the following building structure equipment in accordance with the Laws of the State of Maine, the Building Code of the City of Portland, plans and specifications, if any, submitted herewith and the following specifications:

Location Off Island Avenue, Ponca Landing Within Fire Limits? NO Dist. No. _____

Owner's or Lessee's name and address Edith Daley, Long Island, Senechunkport Telephone _____

Contractor's name and address Thomas F. Wood, Long Island Telephone BY

Architect _____ Plans filed YES No. of sheets 1

Proposed use of building Cottage The Deaf No. families _____

Other buildings on same lot _____

Estimated cost \$ 75 Fee \$.50

Description of Present Building to be Altered

Material wood No. stories 1 1/2 Heat _____ Style of roof _____ Roofing _____

Last use Cottage (Kalam) No. families _____

General Description of New Work

To close in portion 9' x 20' of existing one story piazza
More than half of the area of the vertical enclosing walls will consist of window sash or glass area of doors

It is understood that this permit does not include installation of heating apparatus which is to be taken out separately by and in the name of the heating contractor.

Details of New Work

Is any plumbing work involved in this work? _____

Is any elect. work involved in this work? _____ Height average grade to top of plate _____

Size, front _____ depth _____ No. stories _____ Height average grade to highest point of _____

To be erected on solid or filled land? _____ earth or rock? _____

Material of foundation _____ Thickness, top _____ bottom _____ cellar _____

Material of underpinning _____ Height _____ Thickness _____

Kind of Roof _____ Rise per foot _____ Roof covering _____

No. of chimneys _____ Material of chimneys _____ of lining _____

Kind of heat _____ Type of fuel _____ Is gas fitting involved? _____

Framing Lumber—Kind _____ Dressed or Full Size? _____

Corner posts _____ Sills _____ Girt or ledger board? _____ Size _____

Material columns under girders _____ Size _____ Max. on centers _____

Studs (outside walls and carrying partitions) 2x4-16" O. C. Girders 6x8 or larger. Bridging in every floor and flat roof span over 8 feet. Sills and corner posts all one piece in cross section.

Joists and rafters: 1st floor _____, 2nd _____, 3rd _____, roof _____

On centers: 1st floor _____, 2nd _____, 3rd _____, roof _____

Maximum span: 1st floor _____, 2nd _____, 3rd _____, roof _____

If one story building with masonry walls, thickness of walls? _____ height? _____

If a Garage

No. cars now accommodated on same lot _____, to be accommodated _____

Total number commercial cars to be accommodated _____

Will automobile repairing be done other than minor repairs to cars habitually stored in the proposed building? _____

Miscellaneous

Will above work require removal or disturbing of any shade tree on a public street? _____

Will there be in charge of the above work a person competent to see that the State and City requirements pertaining thereto are observed? yes

Edith Daley

Signature of owner

Thomas F. Wood

INSTRUCTION COPY

CERTIFICATE OF EXAMINATION
BY THE INSPECTOR OF BUILDINGS
ON SEP 28 1940
CERTIFICATION BEFORE EXAMINATION IS WARRANT

Permit No. 40/1462

Location Off Island Area Logg

Owner Edith Duley

Date of permit 9/28/40

Notif. closing-in

Inspn. closing-in

Final Notif.

Final Inspn. 10/3/40. O.C.

Cert. of Occupancy issued: Mark

NOTES

10/3/40. Mark completed
unable to check inside
do

No.	Dist.	Area	Permit	Inspected	Remarks
1					
2					
3					
4					
5					
6					
7					
8					
9					
10					
11					
12					
13					
14					
15					
16					
17					
18					
19					
20					
21					
22					
23					
24					
25					
26					
27					
28					
29					
30					
31					
32					
33					
34					
35					
36					
37					
38					
39					
40					
41					
42					
43					
44					
45					
46					
47					
48					
49					
50					
51					
52					
53					
54					
55					
56					
57					
58					
59					
60					
61					
62					
63					
64					
65					
66					
67					
68					
69					
70					
71					
72					
73					
74					
75					
76					
77					
78					
79					
80					
81					
82					
83					
84					
85					
86					
87					
88					
89					
90					
91					
92					
93					
94					
95					
96					
97					
98					
99					
100					



(A) APARTMENT HOUSE ZONE

PERMIT NO. 5508

APPLICATION FOR PERMIT

1929
JUL 15 1929

Class of Building or Type of Structure Third Class
Portland, Maine, July 15, 1929

To the INSPECTOR OF BUILDINGS, PORTLAND, ME.

The undersigned hereby applies for a permit to erect alter install the following building structure equipment in accordance with the Laws of the State of Maine, the Building Code of the City of Portland, plans and specifications, if any, submitted herewith and the following specifications:

Location West End Long Island Ward 1 Within Fire Limits? No Dist. No. _____
Owner's or Lessee's name and address Mary G. Kaler, 192 York St. Telephone _____
Contractor's name and address Bird Shollenbarger, 478 Washington Ave. Telephone F 6307 Wk
Architect's name and address _____ No. families _____
Proposed use of building Cottage
Other buildings on same lot _____

Description of Present Building to be Altered
Material wood No. stories 2 Heat _____ Style of roof _____ Roofing _____
Last use cottage No. families _____

General Description of New Work
To enclose portion of existing piazza with glass
Piazza existing with roof over same prior to Dec. 6, 1925

CERTIFICATE OF U.S. DEPT. OF COMMERCE
NOTIFICATION BEFORE LAYING
OR CLOSING IS WANTED

Details of New Work
Size, front _____ depth _____ No. stories _____ Height average grade to highest point of roof _____
To be erected on solid or filled land? _____ earth or rock? _____
Material of foundation _____ Thickness, top _____ bottom _____
Material of underpinning _____ Height _____ Thickness _____
Kind of roof _____ Roof covering _____
No. of chimneys _____ Material of chimneys _____ of lining _____
Kind of heat _____ Type of fuel _____ Distance, heater to chimney _____
If oil burner, name and model _____
Capacity and location of oil tanks _____
Is gas fitting involved? _____ Size of service _____
Corner posts _____ Sills _____ Cirt or ledger board? _____ Size _____
Material columns under girders _____ Max. on centers _____
Studs (outside walls and carrying partitions) 2x4-16" O.C. Girders 6x8 or larger. Bridging in every floor and flat roof span over 8 feet. Sills and corner posts all one piece in cross section.
Joists and rafters: 1st floor _____, 2nd _____, 3rd _____, roof _____
On centers: 1st floor _____, 2nd _____, 3rd _____, roof _____
Maximum span: 1st floor _____, 2nd _____, 3rd _____, roof _____
If one story building with masonry walls, thickness of walls? _____ height? _____

If a Garage
No. cars now accommodated on same lot _____ to be accommodated _____
Total number commercial cars to be accommodated _____
Will automobile repairing be done other than minor repairs to cars habitually stored in the proposed building? _____

Miscellaneous
Will above work require removal or disturbing of any shade tree on a public street? No
Plans filed as part of this application? No No. sheets _____ Fee \$.50
Estimated cost \$ 100.
Will there be in charge of the above work a person competent to see that the State and City requirements pertaining thereto are observed? Yes
Signature of owner Mary Kaler
Bird Shollenbarger

INSPECTION COPY

17556

Ward 1 Permit No. 29/1320
Location West End King Island
Owner Mary G. Kales
Date of permit 7/18/29
Notif. closing-in _____
Inspn. closing-in _____
Final Notif. 11/13/29
Final Inspn. _____
Cert. of Occupancy issued _____

NOTES

93
B
14

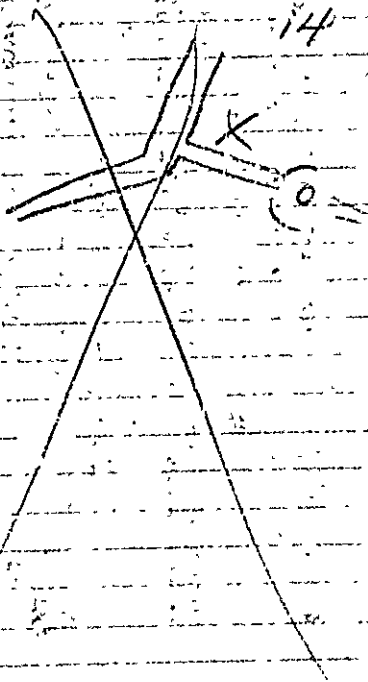
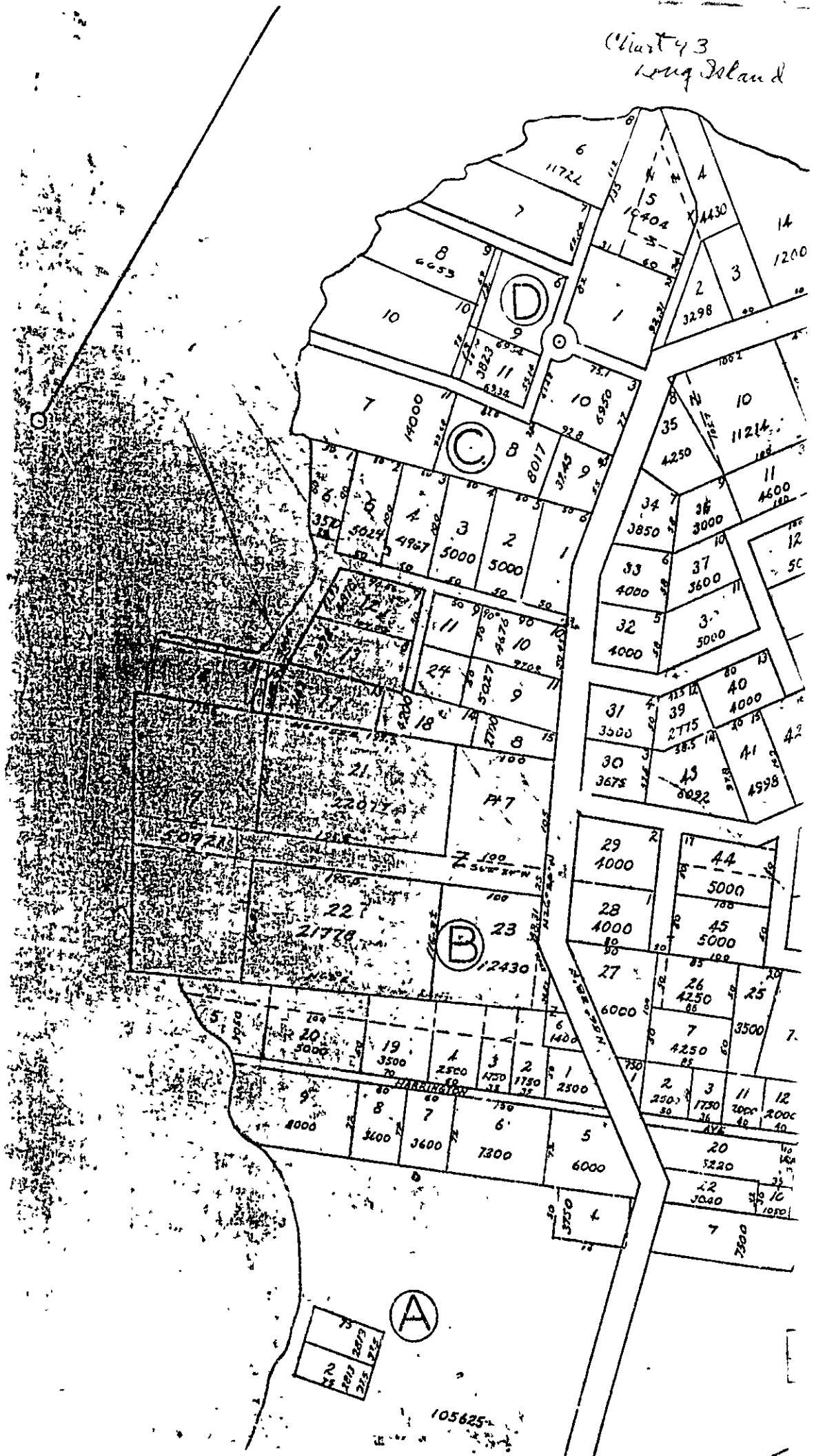

Chart 43
Long Island



Jackson & Casey Corporation

GENERAL CONTRACTING - PLUMBING & HEATING
ISLAND AVENUE
PEAKS ISLAND, MAINE 04108

RECEIVED

JAN 30 1984
DEPT. OF BLDG. INSP
CITY OF PORTLAND

EDWARD L. CASEY, PRESIDENT
764-2817 - 766-5537

CATHERINE B. CASEY, VICE PRESIDENT
766-2817 - 766-5537

January 25, 1984

Mr. Arthur Addato, Insp.
Building Inspection
City of Portland
389 Congress St.
Portland, Maine 04101

Dear Arthur:

Per your request this letter lists what we are doing to the Jane Wray Larocque property on Long Island, L#93-B-16 & 17, Permit #0055:

We are replacing the windows and doors with better quality units, reshingling the roof, reshingling the porch roof, replacing the clapboards with Atlantic White Cedar, replacing rotten boards and sills and repairing the interior walls as needed.

The plumbing and electrical details are included in separate applications for permits.

If we can be of further service please call.

Yours truly,

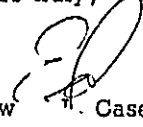
Edw. Casey, President

ELC:dm

RECEIVED

JAN 30 1984

DEPT. OF BLDG. INSP
CITY OF PORTLAND



CITY OF PORTLAND

JOSEPH E. GRAY, JR.
DIRECTOR OF PLANNING & URBAN DEVELOPMENT

January 20, 1984

Jackson & Casey Corp.
Island Avenue
Peaks Island, Maine 04108

Dear Sir,

Your application to make alterations to existing cottage at 93-B-16 & 17 Rear Island Avenue. Long Island issued for the alteration only not to convert into a year round dwelling. Also you must submit to this office a set of plans showing the proposed alterations before work begins.

If you have any questions on these requirements, please call this office.

Sincerely,

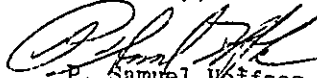
P. Samuel Hoffes
Chief of Inspections

/dmm

APPLICATION FOR PERMIT

PERMIT ISSUED

B.O.C.A. USE GROUP

B.O.C.A. TYPE OF CONSTRUCTION

0055

JAN 20 1984

ZONING LOCATION R-3 PORTLAND, MAINE Jan 13, 1984

To the CHIEF OF BUILDING & INSPECTION SERVICES, PORTLAND, MAINE

CITY OF PORTLAND

The undersigned hereby applies for a permit to erect, alter, repair, demolish, move or install the following building, structure, equipment or change use in accordance with the Laws of the State of Maine, the Portland B.O.C.A. Building Code and Zoning Ordinance of the City of Portland with plans and specifications, if any, submitted herewith and the following specifications:

LOCATION ... 93-B-16 & 17 Rear Isl. Ave. Long Island ... Fire District #1 #2

1. Owner's name and address Jane Wray Larocque - same Telephone 766-4333

2. Lessee's name and address Telephone

3. Contractor's name and address Jackson & Casey Corp. - Isl. Ave. Pks. Isl. Telephone 766-2817

Proposed use of building seasonal year-round dwelling (summer water only) No. of sheets

Last use No. families 1

Material No. stories Heat Style of roof Roofing

Other buildings on same lot

Estimated contractual cost \$ 20,000

FIELD INSPECTOR - Mr. @ 775-5451

Appeal Fees \$
Base Fee 110.00
Late Fee
TOTAL \$ 110.00

To make alterations to existing summer cottage to convert it into year-round dwelling, alterations no structural changes

Status of Special Conditions

PERMIT ISSUED WITH LETTER

send permit to 3 04103

NOTE TO APPLICANT: Separate permits are required by the installers and subcontractors of heating, plumbing, electrical and mechanicals.

DETAILS OF NEW WORK

Is any plumbing involved in this work? yes Is any electrical work involved in this work? yes

connection to be made to public sewer? cesspool If not, what is proposed for sewage?

Has sump tank notice been sent? existing Form notice sent?

Height average grade to top of plat? Height average grade to highest point of roof?

Size, front depth No. stories soil or filled land? earth or rock?

Material of foundation Thickness, top bottom cellar

Kind of roof Rise per foot Roof covering

No. of chimneys Material of chimneys of lining Kind of heat fuel

Framing Lumber - Kind Dressed or full size? Corner posts Sills

Size Girders Columns under girders Size Max. on centers

Studs (on side walls and carrying partitions) 2x4-16" O.C. Bridging in every floor and flat roof span over 8 feet.

Joists and rafters 1st floor 2nd 3rd roof

On centers 1st floor 2nd 3rd roof

Maximum span 1st floor 2nd 3rd roof

If one story building with masonry walls, thickness of walls? height?

IF A GARAGE

No. cars now accommodated on same lot to be accommodated number commercial to be accommodated

Will automobile repairing be done other than minor repairs to cars habitually stored in proposed building?

APPROVALS BY DATE MANEUS

BUILDING INSPECTION - PLAN EXAMINER Will work require cutting of any tree on a public street? no

ZONING: O.K. H.D.T.

BUILDING CODE Will there be in charge of the above work a person competent

Fire Dept. to see that the State and City requirements pertaining thereto

Health Dept. are observed? yes

Others

Signature of Applicant Edward Casey for Jackson & Casey Phone # same

Type Name of above Edward Casey for Jackson & Casey

Other and Address

PERMIT ISSUED WITH FIELD INSPECTOR'S COPY

APPLICANT'S COPY OFFICE FILE COPY

Handwritten signature/initials

NOTES

1-25-84 - OK to close in.
Go for LPI - ELECT. - BLDG. *CC*
2-3-84 - Complete OK. *CC*

Permit No. 84/055

Location 933 7th St. S.W. 211

Own *Paul Jones*

Date of Permit 1-13-84

Approved 1-21-84

Dwelling

Garage

Alteration *for storage*

~~Large rectangular area of the page is crossed out with a large 'X'.~~

PLUMBING APPLICATION

Department of Human Services
Division of Health Engineering
(207) 286-3825

PROPERTY ADDRESS

Town or Plantation: Portland

Street: 13-B-11-17-D

Subdivision Lot #: 13-B-11-17-D

PROPERTY OWNERS NAME

Last: Wagner First: Jane

Applicant Name: Jane Wagner

Mailing Address of Owner/Applicant (if different): 111 Pine St

0260 PORTLAND *** 05170 ***

Janet Wagner Local Plumbing Inspector Signature

FEE On Double Charged

L.P.I. # 123

Owner/Applicant Statement

I certify that the information submitted is correct to the best of my knowledge and understand that any falsification is reason for the Local Plumbing Inspector to deny a Permit.

Janet Wagner Date: 11/13/84

Signature of Owner/Applicant

Caution: Inspection Required

I have inspected the installation authorized above and find it in compliance with the Maine Plumbing Rules.

Janet Wagner Local Plumbing Inspector Signature

APPROVED 11/22/84

PERMIT INFORMATION

This Application is for

1. NEW PLUMBING

2. RELOCATED PLUMBING

Type Of Structure To Be Served:

1. SINGLE FAMILY DWELLING

2. MODULAR OR MOBILE HOME

3. MULTIPLE FAMILY DWELLING

4. OTHER - SPECIFY: _____

Plumbing To Be Installed By:

1. MASTER PLUMBER

2. OIL BURNERMAN

3. MFG'D. HOUSING DEALER/MECHANIC

4. PUBLIC UTILITY EMPLOYEE

5. PROPERTY OWNER

LICENSE # 11774

Number	Hook-Ups And Piping Relocation	Number	Column 2 Type of Fixture	Number	Column 1 Type of Fixture
	HOOK-UP: to public sewer in those cases where the connection is not regulated and inspected by the local Sanitary District.		Hosebibbs / Sillcock		Bathtub (and Shower)
			Floor Drain		Shower (Separate)
			Urinal		Sink
	HOOK-UP: to an existing subsurface wastewater disposal system.		Drinking Fountain		Wash Basin
			Indirect Waste		Water Closet (Toilet)
			Water Treatment Softener, Filter, etc.		Clothes Washer
	PIPING RELOCATION of sanitary lines, drains, and piping without new fixtures.		Grease/Oil Separator		Dish Washer
			Dental Cuspidor		Garbage Disposal
			Bidet		Laundry Tub
	Hook-Ups (Subtotal)		Other: _____		Water Heater
\$	Hook-Up Fee		Fixtures (Subtotal) Column 2		Fixtures (Subtotal) Column 1
					Fixtures (Subtotal) Column 2
					Total Fixtures
				\$ 18	Fixture Fee
				\$	Hook-Up Fee
				\$ 18	Total Fee

SEE PERMIT FEE SCHEDULE FOR CALCULATING FEE

TOWN COPY



APPLICATION FOR PERMIT
DEPARTMENT OF BUILDING INSPECTIONS SERVICES
ELECTRICAL INSTALLATIONS

Date Feb-7, 1984
Receipt and Permit number 19851

To the CHIEF ELECTRICAL INSPECTOR, Portland, Maine:

The undersigned hereby applies for a permit to make electrical installations in accordance with the laws of Maine, the Portland Electrical Ordinance, the National Electrical Code and the following specifications:

LOCATION OF WORK: Lot 93 B 16-17 Bear Island Ave Long Island
OWNER'S NAME: JANE WRAY LAROCHE ADDRESS: SAMY

3000
GTTJ
FEE'S

OUTLETS: Receptacles 30 Switches _____ Plugmold _____ ft. TOTAL 30 3.00

FIXTURES: (number of) Incandescent 5 Fluorescent _____ (not strip) TOTAL 5 3.00
Strip Fluorescent _____ ft.

SERVICES: Overhead 1 Underground _____ Temporary _____ TOTAL amperes 200 3.00

METERS: (number of) .5050

MOTORS (number of) _____

.....

.....

COMMERCIAL OR INDUSTRIAL HEATING: (number of rooms) 6 6.00

Oil or Gas (by a main boiler) _____

Oil or Gas (by separate units) _____

Electric Under 20 kws _____ Over 20 kws _____

APPLIANCES: (number of)

Ranges _____ Water Heaters _____

Cook Tops _____ Disposals _____

Wall Ovens _____ Dishwashers _____

Dryers _____ Compactors _____

Fans _____ Others (denote) _____

TOTAL _____

MISCELLANEOUS: (number of)

Branch Panels _____

Transformers _____

Air Conditioners Central Unit _____

Separate Units (windows) _____

Signs 20 sq. ft. and under _____

Over 20 sq. ft. _____

Swimming Pools Above Ground _____

In Ground _____

Fire/Burglar Alarms Residential _____

Commercial _____

Heavy Duty Outlets, 220 Volt (such as welders) 30 amps and under _____

over 30 amps _____

Circus, Fairs, etc. _____

Alterations to wires _____

Repairs after fire _____

Emergency Lights, battery _____

Emergency Generators _____

INSTALLATION FEE DUE: _____
FOR ADDITIONAL WORK NOT ON ORIGINAL PERMIT DOUBLE FEE DUE: _____
FOR REMOVAL OF A "STOP ORDER" (304-16.b)
TOTAL AMOUNT DUE: 15.50

INSPECTION: Will be ready on IS Ready now, 19 _____; or Will Call _____

CONTRACTOR'S NAME: Charles Mastro Lucia

ADDRESS: 168 Voranda St, PTD

TEL: 725-2760

MASTER LICENSE NO.: 2387 SIGNATURE OF CONTRACTOR: _____

LIMITED LICENSE NO.: _____

INSPECTOR'S COPY — WHITE
OFFICE COPY — CANARY
CONTRACTOR'S COPY — GREEN

ELECTRICAL INSTALLATIONS

Permit Number

1988/1

Location

1-93-B-16-17

Owner

Restorac

Date of Permit

2-7-84

Final Inspection

10-11-84

By Inspector

Libby 10-11-84

Permit Application Register Page No. 3

INSPECTIONS: Service by Libby
Service called in 2-9-84
Closing-in 2-9-84 by Libby

PROGRESS INSPECTIONS: 10-11-84

CODE COMPLIANCE COMPLETED

DATE 11-84

Handwritten notes: *Handwritten notes, possibly 'No work done' and 'No work done'.*

REMARKS: 2

DATE	REMARKS
11-84	2

Handwritten signature: *Long Island*

12.20

Handwritten notes: *Is Board now... Operator... 100... 200... 300...*