

BEAN POT CIRCLE

1 Bean Pot Circle

4

Oxford
STOCK No. 753 1/2



APPLICATION FOR PERMIT

PERMIT ISSUED

B.O.C.A. USE GROUP 839
B.O.C.A. TYPE OF CONSTRUCTION

AUG 19 1981

ZONING LOCATION PORTLAND, MAINE, Aug. 18, 1981

CITY OF PORTLAND

To the DIRECTOR OF BUILDING & INSPECTION SERVICES, PORTLAND, MAINE

The undersigned hereby applies for a permit to erect, alter, repair, demolish, move or install the following building, structure, equipment or change use in accordance with the Laws of the State of Maine, the Portland B.O.C.A. Building Code and Zoning Ordinance of the City of Portland with plans and specifications, if any, submitted herewith and the following specifications:

1 Bean pot Circle
LOCATION: 1. Owner's name and address Burnham & Morrill same Fire District #1 [] #2 []
2. Lessee's name and address same Telephone
3. Contractor's name and address Cousins Construction Co. 348 Medford Telephone
4. Architect Specifications Charlestown, Ma. No. of sheets
Proposed use of building factory (Wharf bldg. & Main Bldg.) No. families
Last use No. families
Material No. stories Heat Style of roof Roofing
Other buildings on same lot
Estimated contractual cost \$ 3000. Fee \$ 25.

FIELD INSPECTOR-Mr. GENERAL DESCRIPTION
This application is for: @ 775-5451 To do repair work in two bldgs. as per plans
Dwelling Ext. 234
Garage
Masonry Bldg Stamp of Special Conditions
Metal Bldg
Alterations
Demolitions
Change of Use
Other

NOTE TO APPLICANT: Separate permits are required by the installers and subcontractors of heating, plumbing, electrical and mechanicals. Philip Snow Assoc. 597 Main St. So. Portland

PERMIT IS TO BE ISSUED TO 1 [] 2 [] 3 [] 4 []
Other:

DETAILS OF NEW WORK

Is any plumbing involved in this work? Is any electrical work involved in this work?
Is connection to be made to public sewer? If not, what is proposed for sewage?
Has septic tank notice been sent? Form notice sent?
Height average grade to top of plate Height average grade to highest point of roof
Size, front depth No. stories solid or filled land? earth or rock?
Material of foundation Thickness, top bottom cellar
Kind of roof Rise per foot Roof covering
No. of chimneys Material of chimneys of lining Kind of heat fuel
Framing Lumber--Kind Dressed or full size? Corner posts Sills
Size Girder Columns under girders Size Max. on centers
Studs (outside walls and carrying partitions) 2x4-16" O. C. Bridging in every floor and flat roof span over 8 feet.
Joists and rafters: 1st floor 2nd 3rd roof
On centers: 1st floor 2nd 3rd roof
Maximum span: 1st floor 2nd 3rd roof
If one story building with masonry walls, thickness of walls? height?

IF A GARAGE

No. cars now accommodated on same lot to be accommodated number commercial cars to be accommodated
Will automobile repairing be done other than minor repairs to cars habitually stored in the proposed building?

APPROVALS BY: DATE MISCELLANEOUS
BUILDING INSPECTION--PLAN EXAMINER Will work require disturbing of any tree on a public street?
ZONING:
BUILDING CODE: Will there be in charge of the above work a person competent to see that the State and City requirements pertaining thereto are observed? yes
Fire Dept.:
Health Dept.:
Others:

Signature of Applicant Philip Snow Phone #
Type Name of above Philip Snow 1 [] 2 [] 3 [] 4 []
Other and Address

FIELD INSPECTOR'S COPY

1A



APPLICATION FOR PERMIT
 DEPARTMENT OF BUILDING INSPECTIONS SERVICES
 ELECTRICAL INSTALLATIONS

To the CHIEF ELECTRICAL INSPECTOR, Portland, Maine: Date July 11, 19 79
 The undersigned hereby applies for a permit to make electrical installations in accordance with the laws of
 Maine, the Portland Electrical Ordinance, the National Electrical Code and the following specifications: Receipt and Permit number A 28835

LOCATION OF WORK: Burnham Morrill - Turnaround Pole # 4
 OWNER'S NAME: State of Maine ADDRESS: Augusta, Me.

OUTLETS:	Receptacles _____	Switches _____	Plugmold _____	ft. TOTAL _____	FEES _____
FIXTURES: (number of)	Incandescent _____	Flourescent _____	(not strip) TOTAL _____		
	Strip Flourescent _____	ft. _____	TOTAL _____		
SERVICES:	Overhead <input checked="" type="checkbox"/> _____	Underground _____	Temporary _____	TOTAL amperes <u>100</u>	<u>3.00</u>
METERS: (number of)	<u>1</u>				<u>.50</u>
MOTORS: (number of)	Fractional _____				
	1 HP or over _____				
RESIDENTIAL HEATING:	Oil or Gas (number of units) _____				
	Electric (number of rooms) _____				
COMMERCIAL OR INDUSTRIAL HEATING:	Oil or Gas (by a main boiler) _____				
	Oil or Gas (by separate units) _____				
	Electric Under 20 kws _____	Over 20 kws _____			
APPLIANCES: (number of)	Ranges _____	Water Heaters _____			
	Cook Tops _____	Disposals _____			
	Wall Ovens _____	Dishwashers _____			
	Dryers _____	Compactors _____			
	Fans _____	Others (denote) _____			
	TOTAL _____				
MISCELLANEOUS: (number of)	Branch Panels _____				
	Transformers _____				
	Air Conditioners Central Unit _____				
	Separate Units (windows) _____				
	Signs 20 sq. ft. and under _____				
	Over 20 sq. ft. _____				
	Swimming Pools Above Ground _____				
	In Ground _____				
	Fire/Burglar Alarms Residential _____				
	Commercial _____				
	Heavy Duty Outlets, 220 Volt (such as welders) 30 amps and under _____				
	over 30 amps _____				
	Circus, Fairs, etc. _____				
	Alterations to wires _____				
	Repairs after fire _____				
	Emergency Lights, battery _____				
	Emergency Generators _____				
FOR ADDITIONAL WORK NOT ON ORIGINAL PERMIT	INSTALLATION FEE DUE: _____				
FOR REMOVAL OF A "STOP ORDER" (304-16.b)	DOUBLE FEE DUE: _____				
	TOTAL AMOUNT DUE: _____				<u>3.50</u>

INSPECTION: Will be ready on xx, 19 79; or Will Call _____
 CONTRACTOR'S NAME: A. D. Electric
 ADDRESS: 64 Grove St. Lewiston
 TEL: 784-4377
 MASTER LICENSE NO.: _____
 LIMITED LICENSE NO.: 2384 SIGNATURE OF CONTRACTOR: [Signature]

INSPECTOR'S COPY — WHITE
 OFFICE COPY — CANARY
 CONTRACTOR'S COPY — GREEN



APPLICATION FOR PERMIT

B.O.C.A. USE GROUP
 B.O.C.A. TYPE OF CONSTRUCTION
 ZONING LOCATION PORTLAND, MAINE Oct. 7, 1976

PERMIT ISSUED
 OCT 7 1976
CITY OF PORTLAND

To the DIRECTOR OF BUILDING & INSPECTION SERVICES, PORTLAND, MAINE
 The undersigned hereby applies for a permit to erect, alter, repair, demolish, move or install the following building, structure, equipment or change use in accordance with the Laws of the State of Maine, the Portland B.O.C.A. Building Code and Zoning Ordinance of the City of Portland with plans and specifications, if any, submitted herewith and the following specifications:

LOCATION 1. Bean Pot Circle
 1. Owner's name and address Burnham & Morrill Co. Same Fire District #1 #2
 2. Lessee's name and address Eastern Securities 112 Middle St. Telephone 772-8341
 3. Contractor's name and address Eastern Securities 112 Middle St. Telephone 774-5819
 4. Architect Specifications Plans No. of sheets
 Proposed use of building Heat No. families No. families
 Last use Style of roof Roofing Fee \$ 5.00
 Material No. stories Estimated contractual cost \$ 1,000

FIELD INSPECTOR—Mr. Truman
 This application is for:
 Dwelling
 Garage
 Masonry Bldg.
 Metal Bldg.
 Alterations
 De. olitions
 Change of Use
 Other

GENERAL DESCRIPTION

Permit to replace control and detection devices on fire alarm system.

Stamp of Special Conditions

NOTE TO APPLICANT: Separate permits are required by the installers and subcontractors of heating, plumbing, electrical and mechanicals.

PERMIT IS TO BE ISSUED TO 1 2 3 4
 Other:

DETAILS OF NEW WORK

Is any plumbing involved in this work?
 Is connection to be made to public sewer?
 Has septic tank notice been sent?
 Height average grade to top of plate
 Size, front depth
 Material of foundation No. stories
 Kind of roof Thickness, top
 No. of chimneys Rise per foot
 Framing Lumber—Kind Material of chimneys
 Size Girder Dresse or full size?
 Studs (outside walls and carrying partitions) 2x4-16" O. C. Bridging in every floor and flat roof span over 8 feet.
 Joists and rafters: 1st floor 2nd 3rd
 On centers: 1st floor 2nd 3rd
 Maximum span: 1st floor 2nd 3rd
 If one story build- with masonry walls, thickness of walls? height?

IF A GARAGE

No. cars now accommodated on same lot to be accommodated number commercial cars to be accommodated
 Will automobile repairing be done other than minor repairs to cars habitually stored in the proposed building?

MISCELLANEOUS

Will work require disturbing of any tree on a public street? ..
 Will there be in charge of the above work a person competent to see that the State and City requirements pertaining thereto are observed? Yes

APPROVALS BY:
 BUILDING INSPECTION—PLAN EXAMINER
 ZONING:
 BUILDING CODE:
 Fire Dept.:
 Health Dept.:
 Others:

Signature of Applicant Ralph Bryant Phone # same
 Type Name of above Ralph Bryant Other 1 2 3 4
 and Address

FIELD INSPECTOR'S COPY

CITY OF PORTLAND, MAINE
Application for Permit to Install Wires

429 A-41, 42
 430-D-1-2

Permit No. 2279
 Issued 10/1/74
 Portland, Maine Oct. 8, 1974

To the City Electrician, Portland, Maine:

The undersigned hereby applies for a permit to install wires for the purpose of conducting electric current, in accordance with the laws of Maine, the Electrical Ordinance of the City of Portland, and the following specifications:

(This form must be completely filled out — Minimum Fee, \$1.00)

No G!

Owner's Name and Address Burham & Merrill Co. Tel. _____
 Contractor's Name and Address Bailey & Picknell, Inc. Tel. 797-8633
 Location Portland 1 Bean St. Circle Use of Building Factory
 Number of Families _____ Apartments _____ Stores _____ Number of Stories _____
 Description of Wiring: New Work Additions _____ Alterations _____
 Pipe _____ Cable _____ Metal Molding _____ BX Cable _____ Plug Molding (No. of feet) _____
 No. Light Outlets _____ Plugs 5 Light Circuits _____ Plug Circuits 5
 FIXTURES: No. _____ Fluor. or Strip Lighting (No. feet) _____
 SERVICE: Pipe _____ Cable Underground _____ No. of Wires 3 Size 2-1/8 + 1-3/8 SEA.
 METERS: Relocated _____ Added 1 Total No. Meters 1
 MOTORS: Number _____ Phase _____ H. P. _____ Amps _____ Volts _____ Starter _____
 HEATING UNITS: Domestic (Oil) _____ No. Motors _____ Phase _____ H.P. _____
 Commercial (Oil) _____ No. Motors _____ Phase _____ H.P. _____
 Electric Heat (No. of Rooms) _____
 APPLIANCES: No. Ranges _____ Watts _____ Brand Feeds (Size and No.) _____
 Elec. Heaters _____ Watts _____
 Miscellaneous _____ Watts _____ Extra Cabinets or Panels _____
 Transformers _____ Air Conditioners (No. Units) _____ Signs (No. Units) _____
 Will commence _____ 19____ Ready to cover in _____ 19____ Inspection _____
 Amount of Fee \$ 4.00

Signed Ralph E. Bailey, Jr.

DO NOT WRITE BELOW THIS LINE

SERVICE METER _____ GROUND _____
 VISITS: 1 10-8-74 2 _____ 3 _____ 4 _____ 5 _____ 6 _____
 7 _____ 8 _____ 9 _____ 10 _____ 11 _____ 12 _____

REMARKS:

Service ok called in

INSPECTED BY Dilby (OVER)

APPLICATION FOR PERMIT

PERMIT ISSUED

B.O.C.A. USE GROUP

B.O.C.A. TYPE OF CONSTRUCTION 392

APR 25 1984

ZONING LOCATION PORTLAND, MAINE April 24, 1984

CITY of PORTLAND

To the CHIEF OF BUILDING & INSPECTION SERVICES, PORTLAND, MAINE

The undersigned hereby applies for a permit to erect, alter, repair, demolish, move or install the following building, structure, equipment or change use in accordance with the Laws of the State of Maine, the Portland B.O.C.A. Building Code and Zoning Ordinance of the City of Portland with plans and specifications, if any, submitted herewith and the following specifications:

LOCATION ... 1. Beanyet Circle ... Fire District #1 [] #2 []
1. Owner's name and address Burnham & Morrill - same P.O. Box 1871 - 04104 Telephone 772-8341
2. Lessee's name and address Attn: Peter Redfern Telephone
3. Contractor's name and address N. G. Bailey - Harbouth Road, Gray, Maine Telephone 657-3200
Proposed use of building Commercial No. of sheets A
Last use none No. families
Material No. stories Heat Style of roof Roofing
Other buildings on same lot
Estimated contractual cost \$ 67,000.00

FIELD INSPECTOR - Mr @ 775-5451
Appeal Fees \$
Base Fee
Late Fee
TOTAL \$ 325.00

To construct foundations (2). New foundation 14' x 28' and restore existing coal pocket, as per plans. New foundation for 2 silos.

Stamp of Special Conditions

ISSUE PERMIT TO #1

NOTE TO APPLICANT: Separate permits are required by the installers and subcontractors of heating, plumbing, electrical and mechanicals.

DETAILS OF NEW WORK

Is any plumbing involved in this work? Is any electrical work involved in this work?
Is connection to be made to public sewer? If not, what is proposed for sewage?
Has septic tank notice been sent? Form notice sent?
Height average grade to top of plate Height average grade to highest point of roof
Size, front depth No. stories solid or filled land? earth or rock?
Material of foundation Thickness, top bottom cellar
Kind of roof Rise per foot Roof covering
No. of chimneys Material of chimneys of lining Kind of heat fuel
Framing Lumber - Kind Dressed or full size? Corner posts Sills
Size Girder Columns under girders Size Max. on centers
Studs (outside walls and carrying partitions) 2x4-16" O. C. Bridging in every floor and flat roof span over 8 feet.
Joists and rafters 1st floor 2nd 3rd roof
On centers: 1st floor 2nd 3rd roof
Maximum span: 1st floor 2nd 3rd roof
If one story building with masonry walls, thickness of walls? height?

IF A GARAGE

No. cars now accommodated on same lot to be accommodated number commercial cars to be accommodated
Will automobile repairing be done other than minor repairs to cars habitually stored in the proposed building?

APPROVALS BY: DATE
BUILDING INSPECTION - PLAN EXAMINER
ZONING
BUILDING CODE
Fire Dept.
Health Dept.
Others:

MISCELLANEOUS
Will work require disturbing of any tree on a public street?
Will there be in charge of the above work a person competent to see that the State and City requirements pertaining thereto are observed? yes

Signature of Applicant Phone #
Type Name of above Peter Redfern for B. & M. 1 EX 2 [] 3 [] 4 []
Other and Address

FIELD INSPECTOR'S COPY

APPLICANT'S COPY

OFFICE FILE COPY

NOTES

11/15/84 checked concrete
part of roof of porch

8/16/84 checked sides
& foundation

Check sides have been
installed by contractor
reinforced off

MM

Permit No. 841 676
 Location 10000 1st Ave
 Owner Pauline
 Date of permit 2-15-84
 App. used 6-14-84
 Dwelling 2 stories
 Garage
 Allegation

APPLICATION FOR PERMIT

B.O.C.A. USE GROUP 392

B.O.C.A. TYPE OF CONSTRUCTION

ZONING LOCATION PORTLAND, MAINE April 24, 1984

PERMIT ISSUED

APR 25 1984

To the CHIEF OF BUILDING & INSPECTION SERVICES PORTLAND, MAINE

The undersigned hereby applies for a permit to erect, alter, repair, demolish, move or install the following building, structure, equipment or change use in accordance with the Laws of the State of Maine, the Portland B.O.C.A. Building Code and Zoning Ordinance of the City of Portland with plans and specifications, if any, submitted herewith and the following specifications:

LOCATION 1 Beanpot Circle Fire District #1 , #2
1. Owner's name and address Burnham & Morrill - same P.O. Box 1871 - 04104 Telephone 772-3411...
2. Lessee's name and address Attn: Peter Redfern Telephone
3. Contractor's name and address N.G. Bailey - Yarmouth Road, Gray, Maine Telephone 657-3200....

Proposed use of building ... Commercial No. of sheets ... 4
Last use ... same No. families
Material No. stories Heat Style of roof Roofing
Other buildings on same lot
Estimated contractual cost \$ 63,000.00.

FIELD INSPECTOR- Mr. M. B. G. @775-5451
Appeal Fees \$
Base Fee
Late Fee
TOTAL \$ 325.00....

To construct foundations (2). New foundation 14' x 28' and restore existing coal pocket, as per plans. New foundation for 2 silos.

Stamp of Special Conditions

ISSUE PERMIT TO #1

NOTE TO APPLICANT: Separate permits are required by the installers and subcontractors of heating, plumbing, electrical and mechanicals.

DETAILS OF NEW WORK

Is any plumbing involved in this work? Is any electrical work involved in this work?
Is connection to be made to public sewer? If not, what is proposed for sewage?
Has septic tank notice been sent? Form notice sent?
Height average grade to top of plate Height average grade to highest point of roof
Size, front depth No. stories solid or filled land? earth or rock?
Material of foundation Thickness, top bottom cellar
Kind of roof Rise per foot Roof covering
No. of chimneys Material of chimneys of lining Kind of heat fuel
Framing Lumber—Kind Dressed or full size? Corner posts Sills
Size Girder Columns under girders Size Max. on centers
Studs (outside walls and carrying partitions) 2x4-16" O. C. Bridging in every floor and flat roof span over 8 feet.
Joists and rafters: 1st floor 2nd 3rd roof
On centers: 1st floor 2nd 3rd roof
Maximum span: 1st floor 2nd 3rd roof
If one story building with masonry walls, thickness of walls? height?

IF A GARAGE

No. cars now accommodated on same lot to be accommodated number commercial cars to be accommodated
Will automobile repairing be done other than minor repairs to cars habitually stored in the proposed building?

APPROVALS BY: DATE MISCELLANEOUS
BUILDING INSPECTION—PLAN EXAMINER Will work require disturbing of any tree on a public street? .. NO
ZONING:
BUILDING CODE: Will there be in charge of the above work a person competent to see that the State and City requirements pertaining thereto are observed? .. yes ...
Fire Dept.:
Health Dept.:
Others:

Signature of Applicant [Signature] Phone #
Type Name of above Peter Redfern for B & M 1 2 3 4
Other
and Address

FIELD INSPECTOR'S COPY APPLICANT'S COPY OFFICE FILE COPY

[Handwritten signature and initials]

NOTES

Permit No. 841892
 Location: [unclear] Pad Circle
 Owner: [unclear] & Merrill
 Date of issue: 4-29-54
 Expires: 4-25-59
 Issued by: [unclear]
 Garage: [unclear]
 Attention: [unclear]

5/10/54 Re. contacted
 Peter [unclear] Pad farm
 checked for footing
 pour he will
 call when ready
 for next pour
 checked ground where
 silos will go. [unclear]

5/27/54 disp. for pour
 checked walls & footings
 OK ready to back fill.

7/6/54 checked [unclear]
 OK

8/10/54 checked silos
 OK
 [unclear]

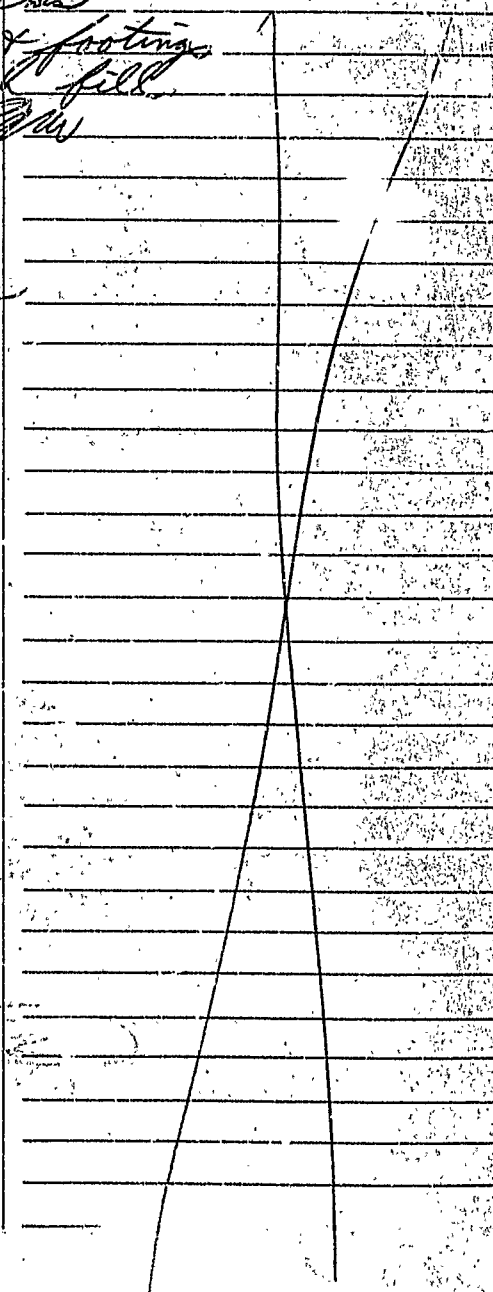

APPLICATION FOR PERMIT

PERMIT ISSUED

B.O.C.A. USE GROUP

B.O.C.A. TYPE OF CONSTRUCTION 676

ZONING LOCATION PORTLAND, MAINE Feb. 15, 1984

JUN 14 1984

CITY OF PORTLAND

To the CHIEF OF BUILDING & INSPECTION SERVICES, PORTLAND, MAINE

The undersigned hereby applies for a permit to erect, alter, repair, demolish, move or install the following building, structure, equipment or change use in accordance with the Laws of the State of Maine, the Portland B.O.C.A. Building Code and Zoning Ordinance of the City of Portland with plans and specifications, if any, submitted herewith and the following specifications:

LOCATION ... 1. Bean Pot Circle - Burnham Morrill File District #1 , #2

1. Owner's name and address Pet Inc. - St. Louis, Missouri Telephone

2. Lessee's name and address Div of L. C. Industries Telephone

3. Contractor's name and address Telephone

Proposed use of building No. of sheets

Last use No. families

Material No. stories Heat Style of roof Roofing

Other buildings on same lot

Estimated contractual cost \$ 260,000 Appeal Fees \$ 50.00

FIELD INSPECTOR--Mr. @ 775-5451 Base Fee 1,310.00

Late Fee

TOTAL \$ 1,310.00

To construct 2 silos - 12' x 55' in height to be used for storage of beans

Appeal sustained 2-29-84 Stamp of Special Conditions

This application is deemed to settle the question of zoning appeal. In the event the appeal is sustained the applicant will furnish complete information, estimated cost and pay appeal fee.

NOTE TO APPLICANT: Separate permits are required by the installers and subcontractors of heating, plumbing, electrical and mechanicals.

DETAILS OF NEW WORK

Is any plumbing involved in this work? Is any electrical work involved in this work?

Is connection to be made to public sewer? If not, what is proposed for sewage?

Has septic tank notice been sent? Form notice sent?

Height average grade to top of plate Height average grade to highest point of roof

Size, front depth No. stories Solid or filled land? earth or rock?

Material of foundation Thickness, top bottom cellular

Kind of roof Rise per foot Roof covering

No. of chimneys Material of chimneys of lining Kind of heat fuel

Finishing Lumber--Kind Dressed or full size? Corner posts Sills

Size Girder Columns under girders Size Max. on centers

Studs (outside walls and carrying partitions) 2x4-16" O. C. Bridging in every floor and flat roof span over 8 feet.

Joints and rafters: 1st floor 2nd 3rd roof

On centers: 1st floor 2nd 3rd roof

Maximum span: 1st floor 2nd 3rd roof

If one story building with masonry walls, thickness of walls? height?

IF A GARAGE

No. cars now accommodated on same lot to be accommodated number commercial cars to be accommodated

Will automobile repairing be done other than minor repairs to cars habitually stored in the proposed building?

APPROVALS BY: DATE

MISCELLANEOUS

BUILDING INSPECTION--PLAN EXAMINER

Will work require disturbing of any tree on a public street?

ZONING: O. R. M. Dept.

BUILDING CODE:

Will there be in charge of the above work a person competent to see that the State and City requirements pertaining thereto are observed?

Fire Dept.:

Health Dept.:

Other:

Signature of Applicant: Peter Redfern, Inc. Phone # 772-8341

Type Name of above: Peter Redfern, Inc. 1 2 3 4

Burnham Morrill Other and Address

FIELD INSPECTOR'S COPY

APPLICANT'S COPY

OFFICE FILE COPY

Handwritten signature and initials at the bottom left of the page.

B

APPLICATION FOR PERMIT

PERMIT ISSUED

B.O.C.A. USE GROUP 676
B.O.C.A. TYPE OF CONSTRUCTION

JUN 14 1984

ZONING LOCATION PORTLAND, MAINE Feb. 15, 1984

CITY OF PORTLAND

To the CHIEF OF BUILDING & INSPECTION SERV. PORTLAND, MAINE
The undersigned hereby applies for a permit to erect, alter, demolish, move or install the following building, structure, equipment or change use in accordance with the Laws of the State of Maine, the Portland B.O.C.A. Building Code and Zoning Ordinance of the City of Portland with plans and specifications, if any, submitted herewith and the following specifications:

LOCATION ... I. Bear Pot. Circle ... Burnham Morrill ... Fire District #1 #2
1. Owner's name and address Pat. Inc. ... St. Louis, Missouri Telephone
2. Lessee's name and address Div of I. C. Industries Telephone
3. Contractor's name and address Telephone
Proposed use of building No. of sheets
Last use No. families
Material No. stories Heat Style of roof Roofing
Other buildings on same lot
Estimated contractual cost \$ 260,000
FIELD INSPECTOR—Mr
@ 775-5451

Appeal Fees \$ 50.00
Base Fee
Late Fee \$ 110.00
TOTAL \$ 1,110.00

To construct 2 silos - 12' x 55' in height
to be used for storage of beams

Stamp of Special Conditions

Appeal sustained

NOTE TO APPLICANT: Separate permits are required by the installers and subcontractors of heating, plumbing, electrical and mechanicals.

DETAILS OF NEW WORK

Is any plumbing involved in this work? Is any electrical work involved in this work?
Is connection to be made to public sewer? If not, what is proposed for sewage?
Has septic tank notice been sent? Form notice sent?
Height average grade to top of plate Height average grade to highest point of roof
Size, front depth No. stories solid or filled land? earth or rock?
Material of foundation Thickness, top bottom cell
Kind of roof Rise per foot Roof covering
No. of chimneys Material of chimneys c/lining Kind of heat
Framing Lumber—Kind Dressed or full size? Corner posts Sills
Size Girder Columns under girders Size Max. on centers
Studs (outside walls and carrying partitions) 2x4-16" O. C. Bridging in every floor and flat roof span over 8 feet.
Joists and rafters: 1st floor 2nd 3rd roof
On centers: 1st floor 2nd 3rd roof
Maximum span: 1st floor 2nd 3rd roof
If one story building with masonry walls, thickness of walls? height?

IF A GARAGE

No. cars now accommodated on same lot to be accommodated number commercial cars to be accommodated
Will automobile repairing be done other than minor repairs to cars habitually stored in the proposed building?

APPROVALS BY: DATE
BUILDING INSPECTION—PLAN EXAMINER
ZONING
BUILDING CODE:
Fire Dept.:
Health Dept.:
Others:

MISCELLANEOUS

Will work require disturbing of any tree on a public street?
Will there be in charge of the above work a person competent to see that the State and City requirements pertaining thereto are observed?

Signature of Applicant Phone # 772-8341
Type Name of above Peter Redfern for 1 2 3 4
Burnham Morrill Other
and Address

FIELD INSPECTOR'S COPY

APPLICANT'S COPY

OFFICE FILE COPY

W

APPLICATION FOR PERMIT

PERMIT ISSUED
MAY 8 1985
CITY OF PORTLAND

B.O.C.A. USE GROUP
B.O.C.A. TYPE OF CONSTRUCTION 0422
ZONING LOCATION PORTLAND, MAINE ~~March 1, 1985~~ May 1, 1985

To the CHIEF OF BUILDING & INSPECTION SERVICES, PORTLAND, MAINE

The undersigned hereby applies for a permit to erect, alter, repair, demolish, move or install the following building, structure, equipment or change use in accordance with the Laws of the State of Maine, the Portland B.O.C.A. Building Code and Zoning Ordinance of the City of Portland with plans and specifications, if any, submitted herewith and the following specifications:

LOCATION ... 1 Bean Pot Circle ... Fire District #1 #2
1. Owner's name and address ... Burnham & Morrill Co. - same ... Telephone 772-8341
2. Lessee's name and address ...
3. Contractor's name and address ... Suburban Propane - Thompsons Point ... Telephone
Proposed use of building 1000 gal. propane gas tank ... No. of sheets
Last use none ... No. families
Material ... No. stories ... Heat ... Style of roof ... Roofing
Other buildings on same lot
Estimated contractual cost \$ 500
FIELD INSPECTOR—Mr. @ 775-5451
Appeal Fees \$
Base Fee 15.00
Late Fee none tank 10.00
TOTAL \$ 25.00

To construct 6' x 20' concrete pad to be used to set 1000 gal. propane gas tank on being moved from one area of lot to another area ~~and to~~
~~substantially~~

Stamp of Special Conditions

NOTE TO APPLICANT: Separate permits are required by the installers and subcontractors of heating, plumbing, electrical and mechanicals.

DETAILS OF NEW WORK

Is any plumbing involved in this work? ... Is any electrical work involved in this work?
Is connection to be made to public sewer? ... If not, what is proposed for sewage?
Has septic tank notice been sent? ... Form notice sent?
Height average grade to top of plate ... Height average grade to highest point of roof
Size, front ... depth ... No. stories ... solid or filled land? ... earth or rock?
Material of foundation ... Thickness, top ... bottom ... cellar
Kind of roof ... Rise per foot ... Roof covering
No. of chimneys ... Material of chimneys ... of lining ... Kind of heat ... fuel
Framing lumber—Kind ... Dressed or full size? ... Corner posts ... Sills
Size Girder ... Columns under girders ... Size ... Max. on centers
Studs (outside walls and carrying partitions) 2x4-16" O. C. Bridging in every floor and flat roof span over 8 feet.
Joists and rafters: 1st floor ... 2nd ... 3rd ... roof
On centers: 1st floor ... 2nd ... 3rd ... roof
Maximum span: 1st floor ... 2nd ... 3rd ... roof
If one story building with masonry walls, thickness of walls? ... height?

IF A GARAGE

No. cars now accommodated on same lot ... to be accommodated ... number commercial cars to be accommodated
Will automobile repairing be done other than minor repairs to cars habitually stored in the proposed building?

APPROVALS BY: DATE MISCELLANEOUS
BUILDING INSPECTION—PLAN EXAMINER ... Will work require disturbing of any tree on a public street?
ZONING ...
BUILDING CODE ... Will there be in charge of the above work a person competent
Fire Dept. ... to see that the State and City requirements pertaining thereto
Health Dept. ... are observed?
Others: ...
Signature of Applicant John Totman Plan Engineer Phone # same
Type for Burnham & Morrill 1 2 3 4
Other ...
and Address

FIELD INSPECTOR'S COPY APPLICANT'S COPY OFFICE FILE COPY

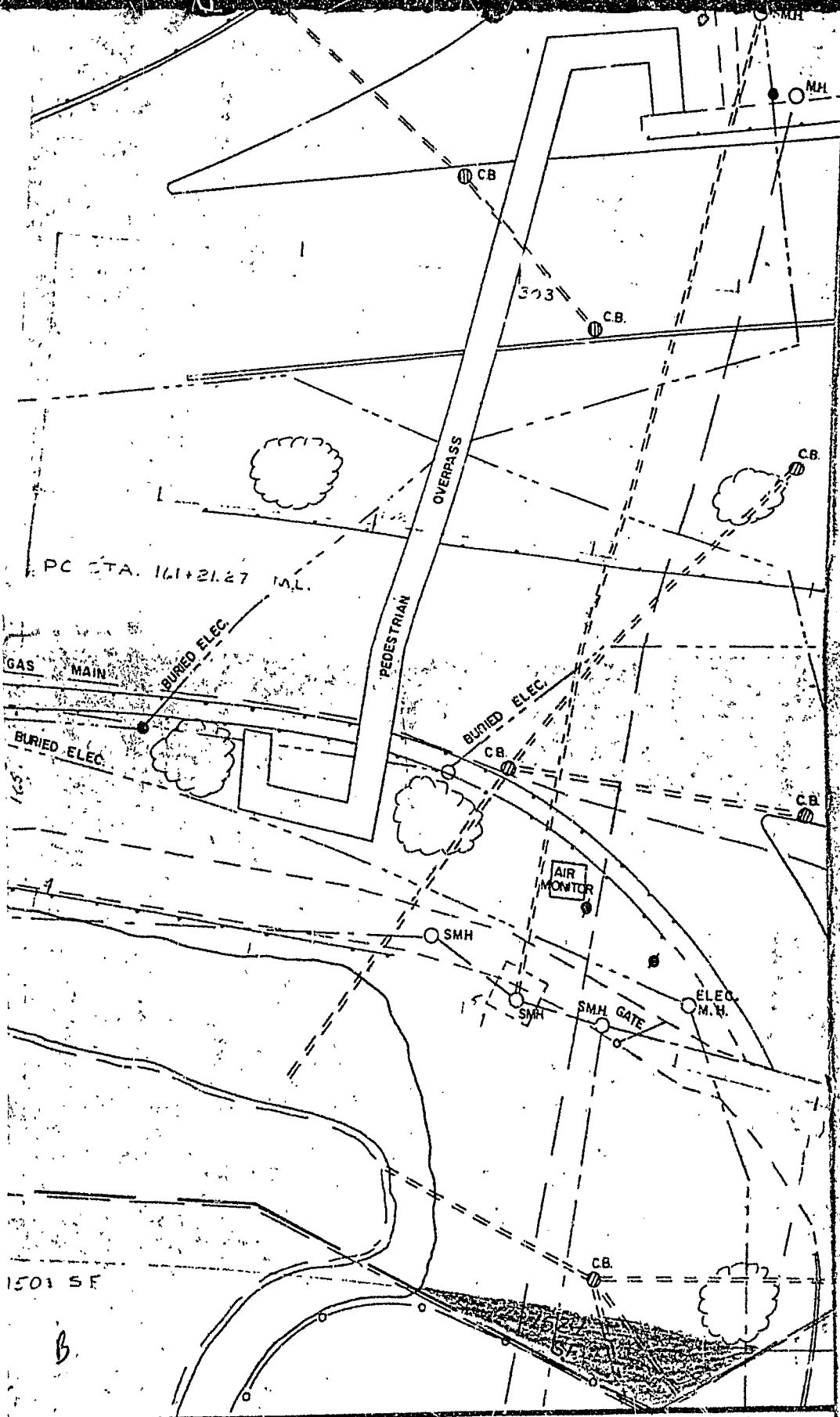

STATE OF MAINE
DEPARTMENT OF TRANSPORTATION

RIGHT OF WAY MAP
STATE HIGHWAY "295"

PORTLAND FEDERAL AID PROJECT NO. CUMBERLAND COUNTY

DATE: *April* 1985 APPROVED:

SCALE: 1 INCH = 25 FEET

SHEET NO. OF SHEETS

J.O.T. FILE NO.

RECEIVED MAY 21 1985 DEPT. OF BLDG. INSP. CITY OF PORTLAND RICHARD A. COLEMAN	COMMISSIONER CHIEF ENGINEER
---	--------------------------------

F.H.W.A. REG. NO.	STATE	PROJECT NUMBER	NO.	SHEET

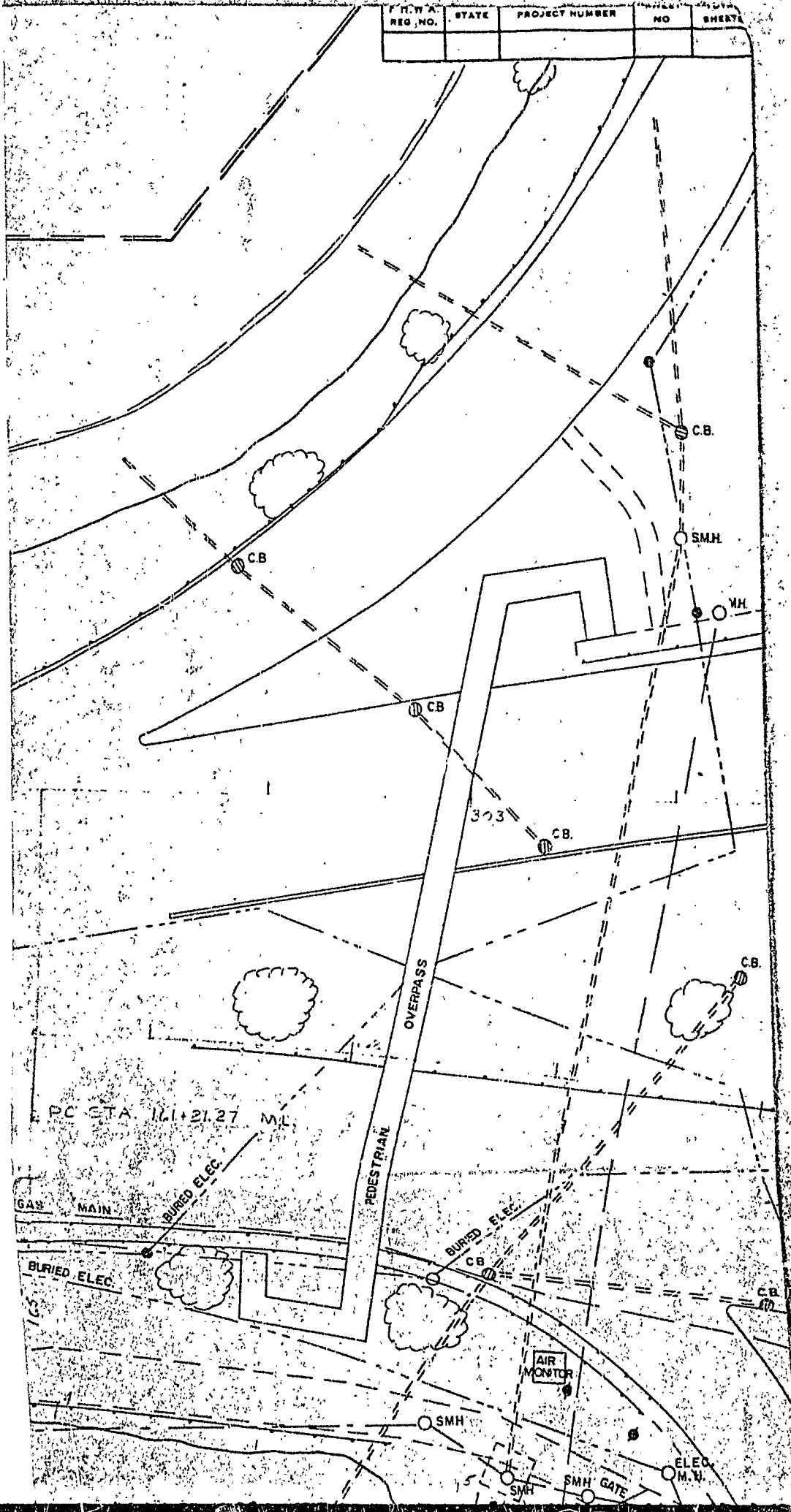

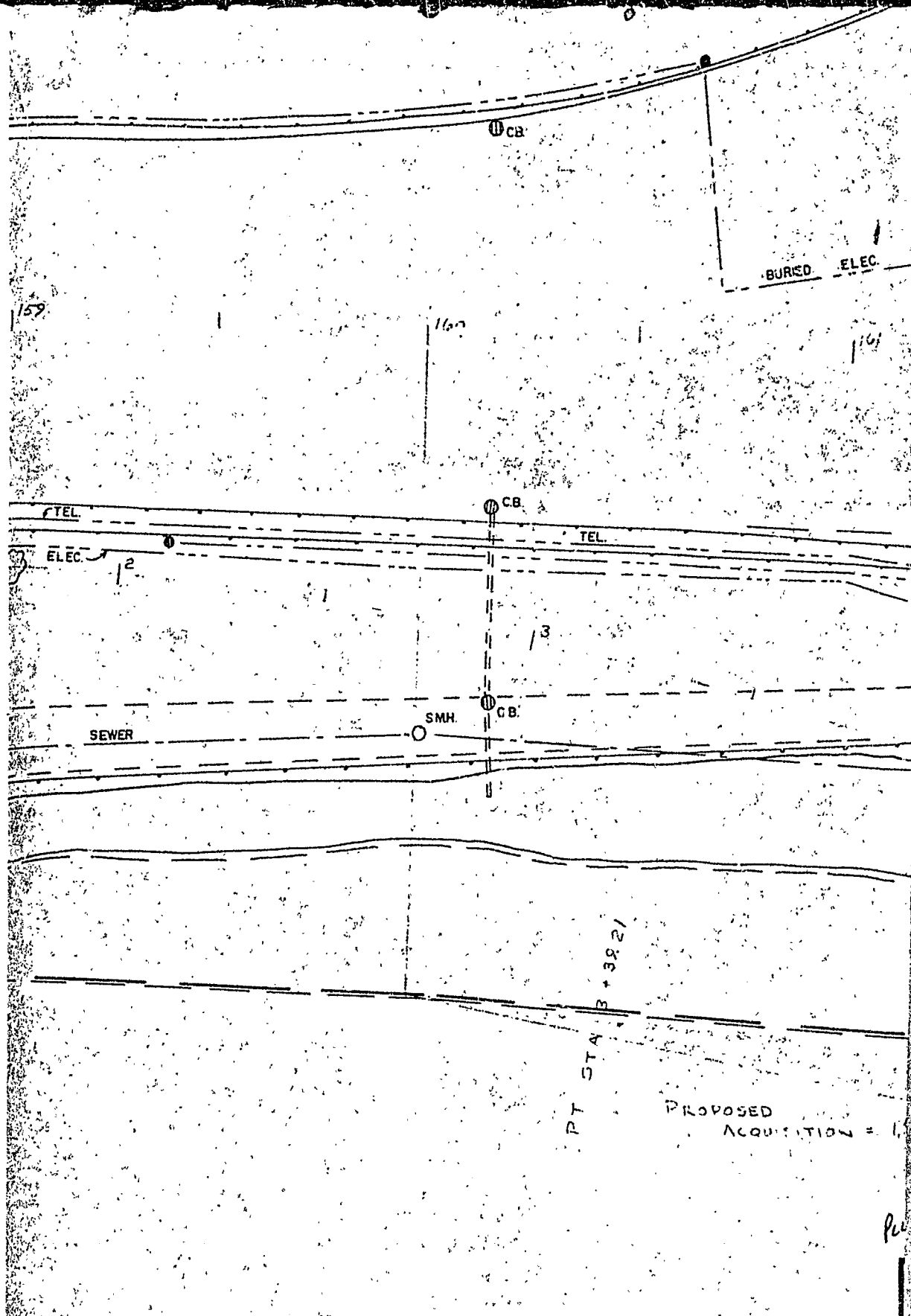

● - RAILROAD SPIKE ▲ - CONTROL MONUMENTS

CONTROLLED ACCESS LIMIT

CONTROLLED ACCESS LIMIT LINE
ALONG R/W LINE

R/W LINE

CONTROLLED ACCESS LIMIT LINE NOT
ON R/W LINE

VEHICLES WILL BE PERMITTED TO
CROSS STATE HIGHWAY "295" AND
ADJACENT PROPERTIES WITHIN
BOUNDARIES DEFINED BY
CONTROLLED ACCESS LIMIT LINES

MAINE DEPARTMENT OF TRANSPORTATION-CENTERLINE CONTROL					
MAINE STATE COORDINATE SYSTEM — ZONE					
CONTROL MONUMENTS			TRAV. CONTROL POINTS		
STATION	NORTH	EAST	NUMBER	NORTH	EAST

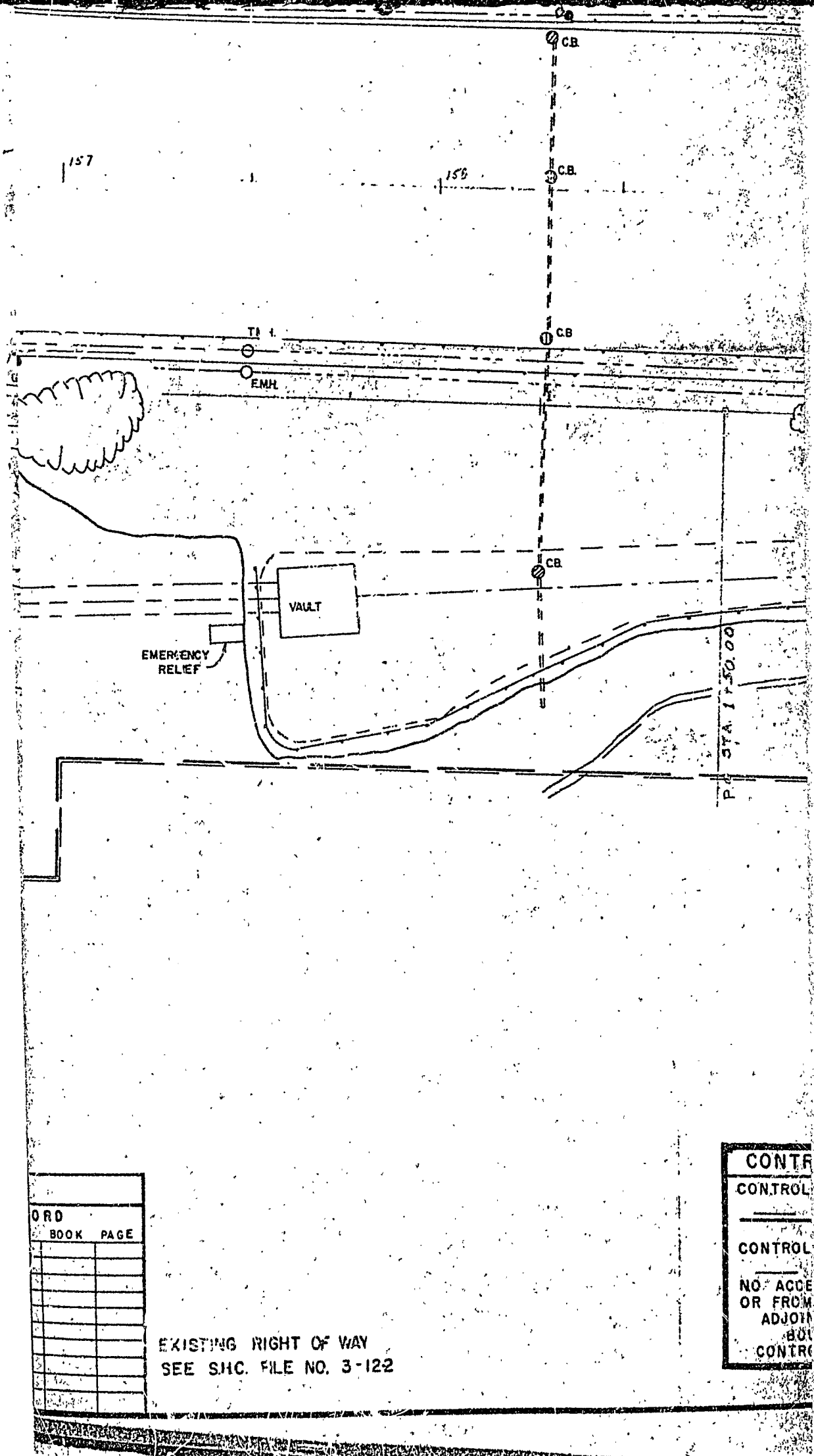

ORD	BOOK	PAGE

EXISTING RIGHT OF WAY
SEE SHC. FILE NO. 3-122

CONTR
CONTROL
CONTROL
NO ACCE
OR FROM
ADJOM
BOU
CONTR

CHECKED	REVISIONS			
	NO.	DATE	DESCRIPTION	BY

BACK

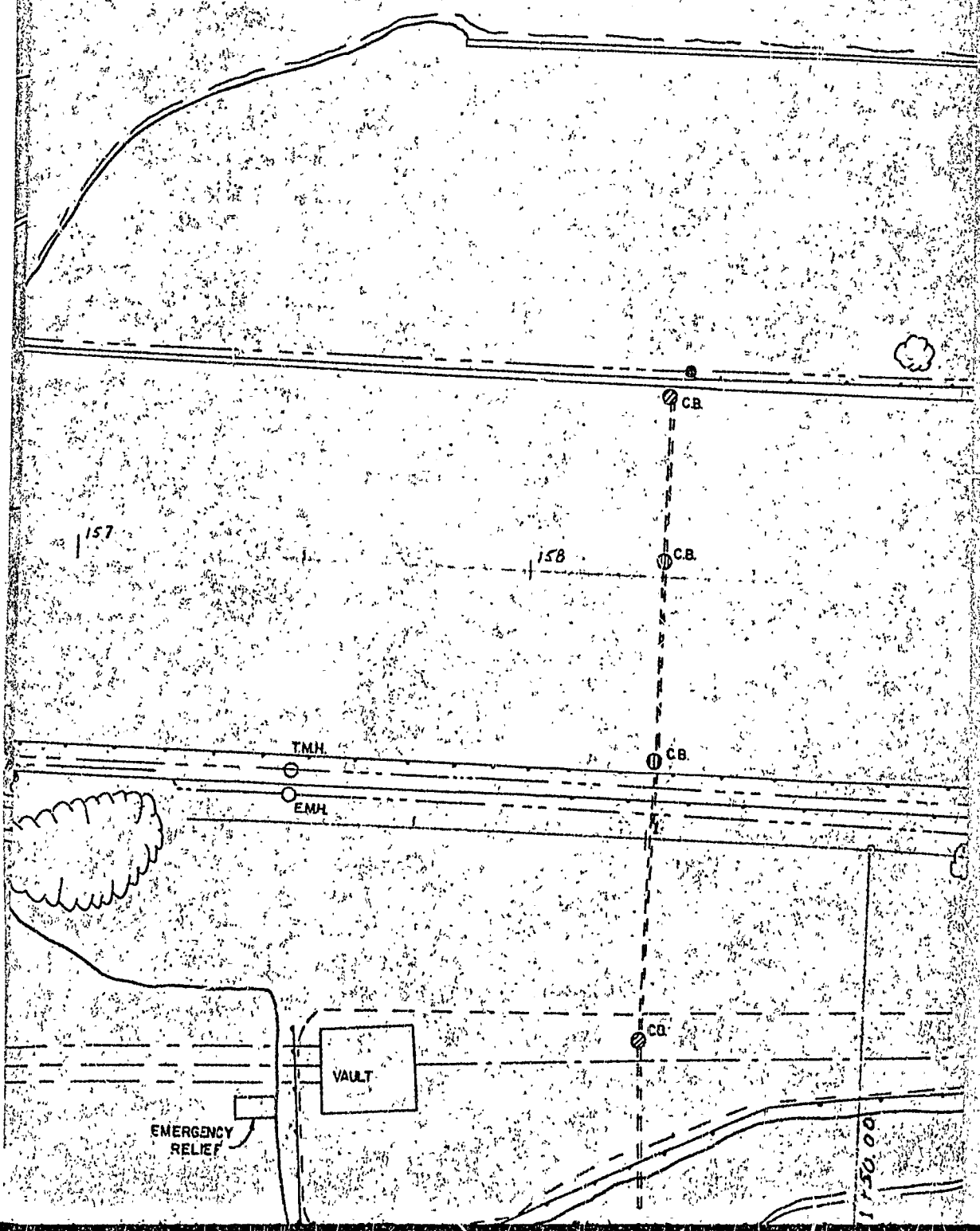

1750.00

SYMBOLS

- I.P. (IRON PIPE or PIN)
- S.T. (SEPTIC TANK) □ C.P. (CESSPOOL)
- WELL ○ SPRING
- W.L. _____
- WATER LINE or MAIN
- BL _____
- SEWER LINE
- C.D. _____
- CELLAR DRAIN
- _____
- UNDERGROUND WIRE or CABLE
- CONST. LIMB. LINE
- ○ ○ ○ ○
- LIMITS of HWY. SLOPE EASEMENT
- GRADING LIMITS
- LIMITS of GRADING RIGHTS
- PL _____
- PROPERTY LINE
- _____
- EXISTING RIGHT OF WAY
- NEW R/W
- NEW R/W WITHIN EXISTING R/W

ITEM	FIGURED	PLOTTED	CHE
BASE LINE			
TOPOGRAPHY			
R/W LINES			
AREAS			
EXIST. R/W			

ELEC.

156

TUKEY BRIDGE

SYMBOLS	
●	LP (IRON PIPE or PIN)
□	SEPTIC TANK
□	ACCESS POOL
○	WELL
○	SPRING
---	W.L.
---	WATER LINE or MAIN
---	S.L.
---	SEWER LINE
---	C.D.
---	CELLAR DRAIN
---	UNDERGROUND WIRE or CABLE
---	CONST. LIMIT LINE
---	LIMITS of HWY. SLOPE EASEMENT
---	GRADING LIMITS
---	LIMITS of GRADING RIGHTS
---	PL.
---	PROPERTY LINE
---	EXISTING RIGHT OF WAY
---	NEW R/W
---	NEW R/W WITHIN EXISTING R/W

ITEM	FINURED	PLOTTED	CHECKED
BASE LINE			
TOPOGRAPHY			
R/W LINES			
AREAS			
EXIST. R/W			

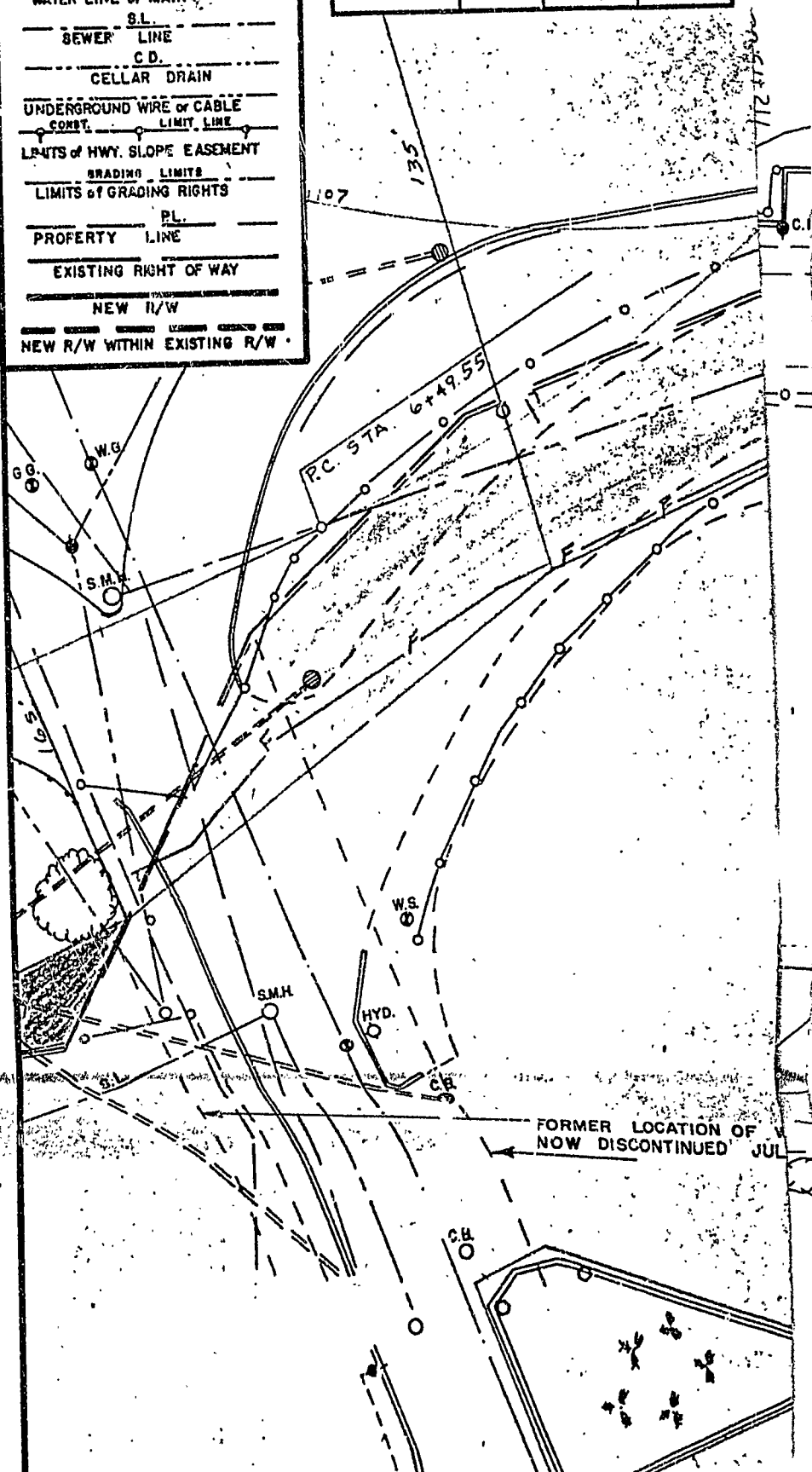

REVISIONS			
NO.	DATE	DESCRIPTION	BY



B & M PARKING LOT

Page A

6, 1959

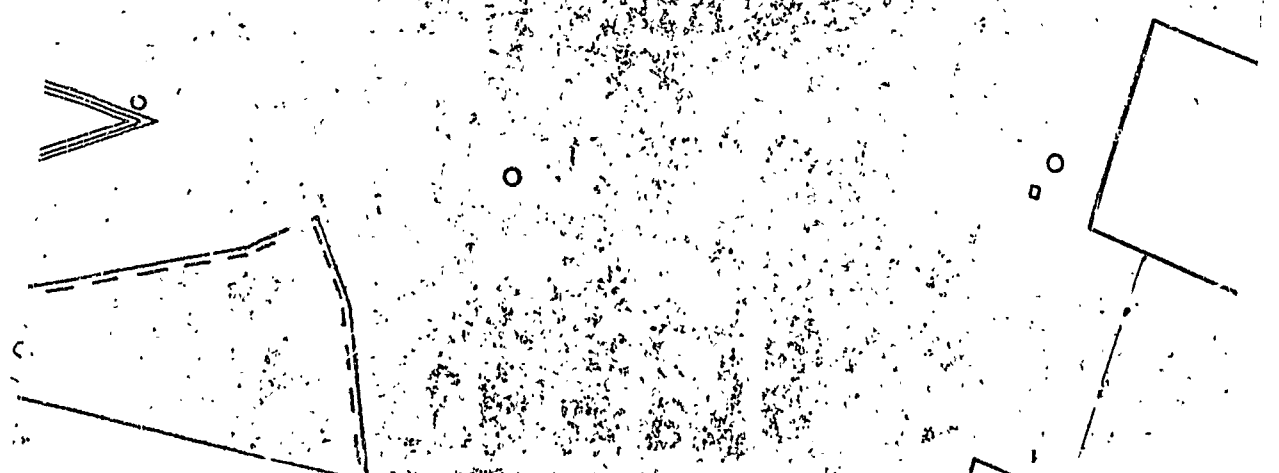

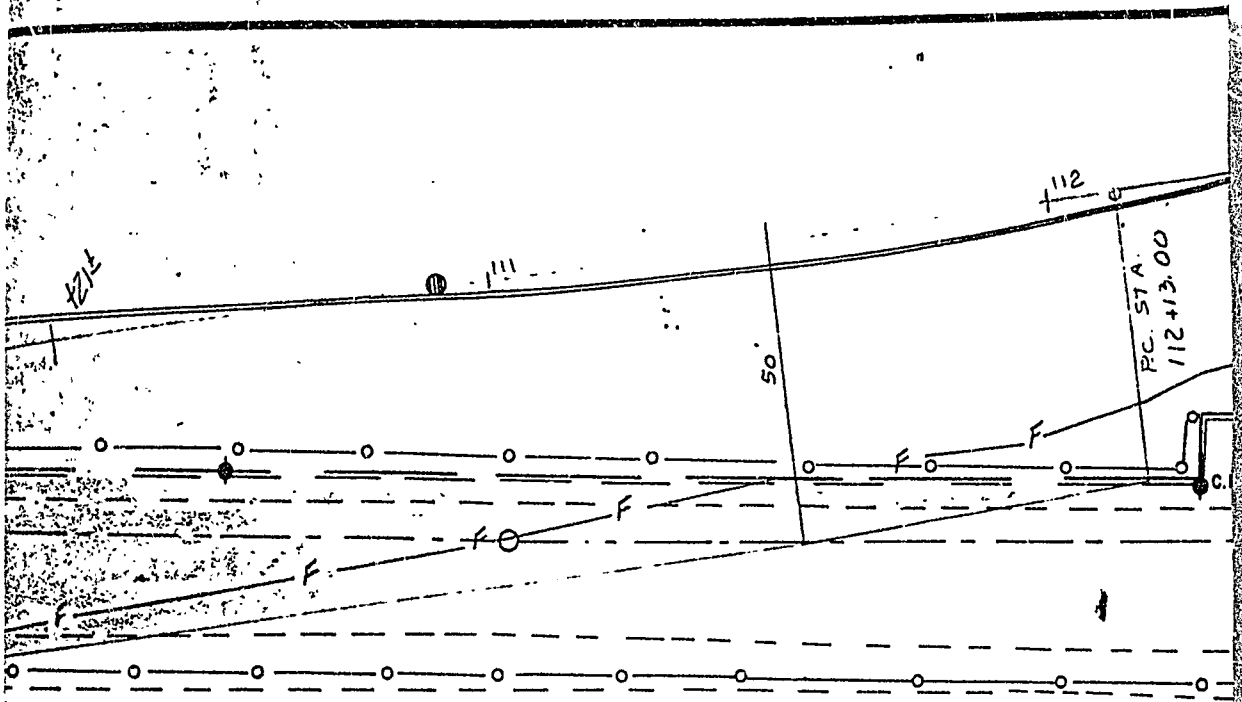

ION = 14,960 ± SQ. FT.

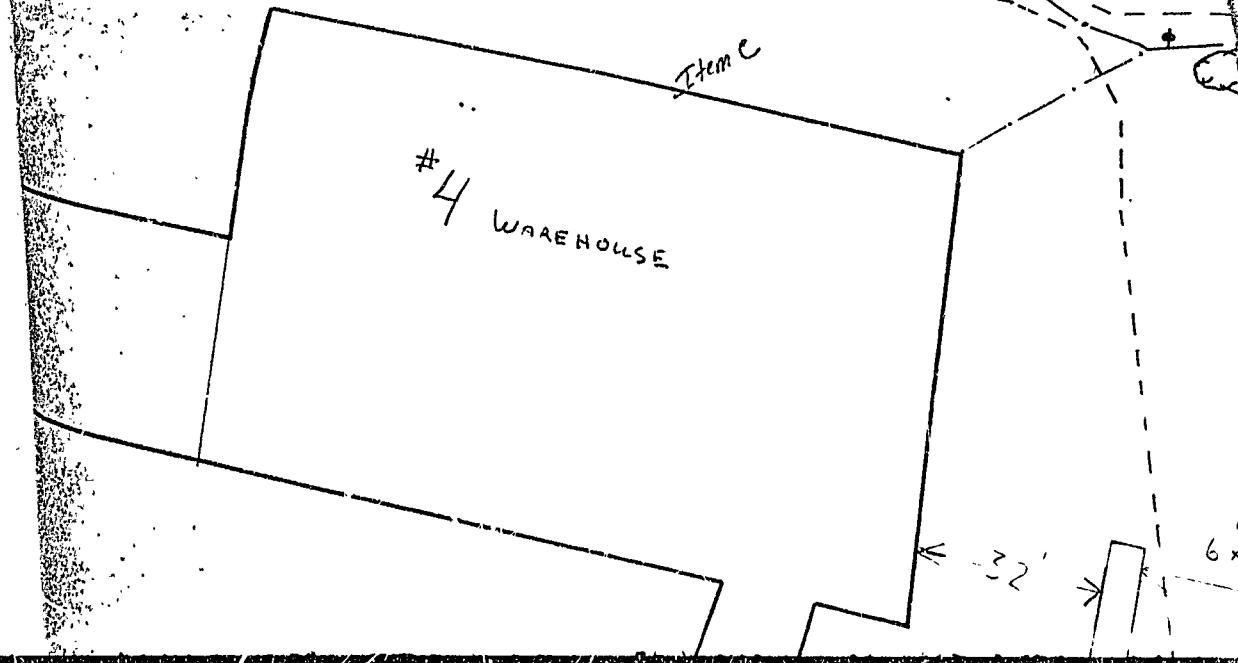
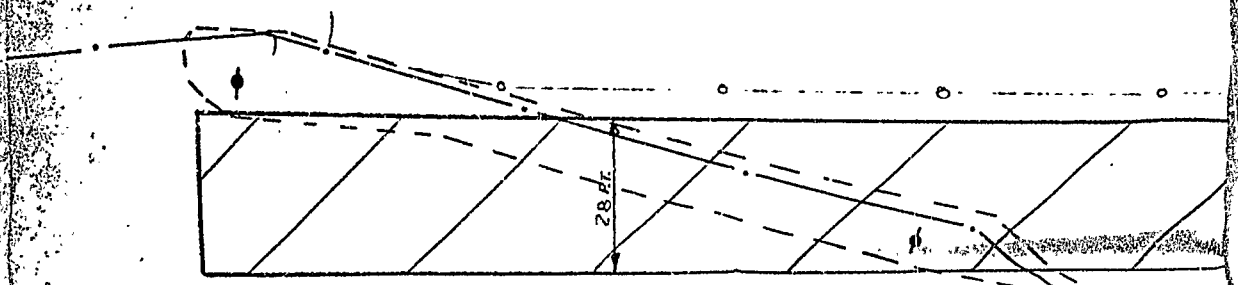

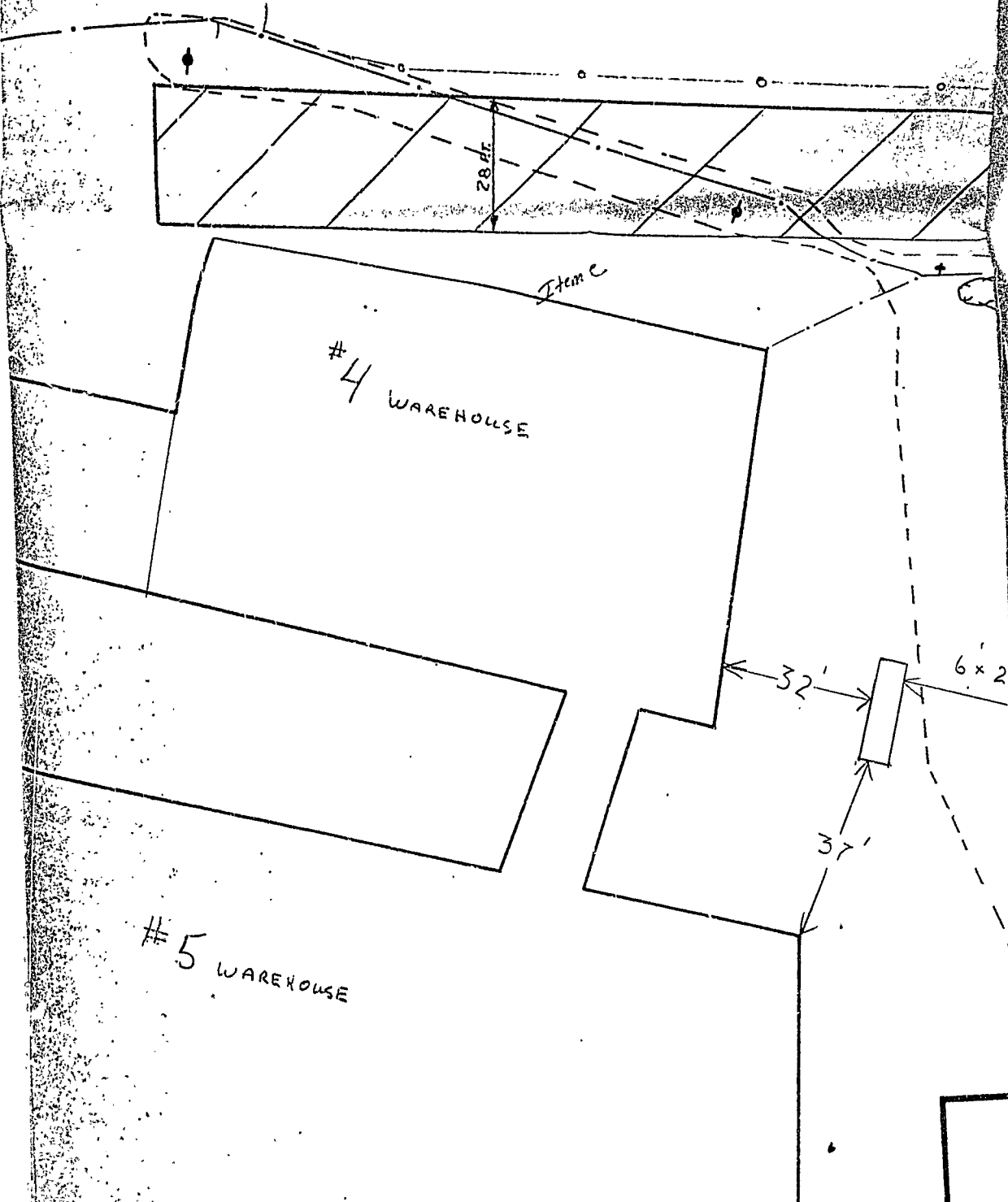

● - RAILROAD SPIKE ▲ - CONTROL MONUMENTS

MAINE DEPARTMENT OF TRANSPORTATION-CENTERLINE CONTROL					
MAINE STATE COORDINATE SYSTEM —					ZONE
CONTROL MONUMENTS			TRAV. CONTROL POINTS		
STATION	NORTH	EAST	NUMBER	NORTH	EAST

DA
SC
SHE
D.O

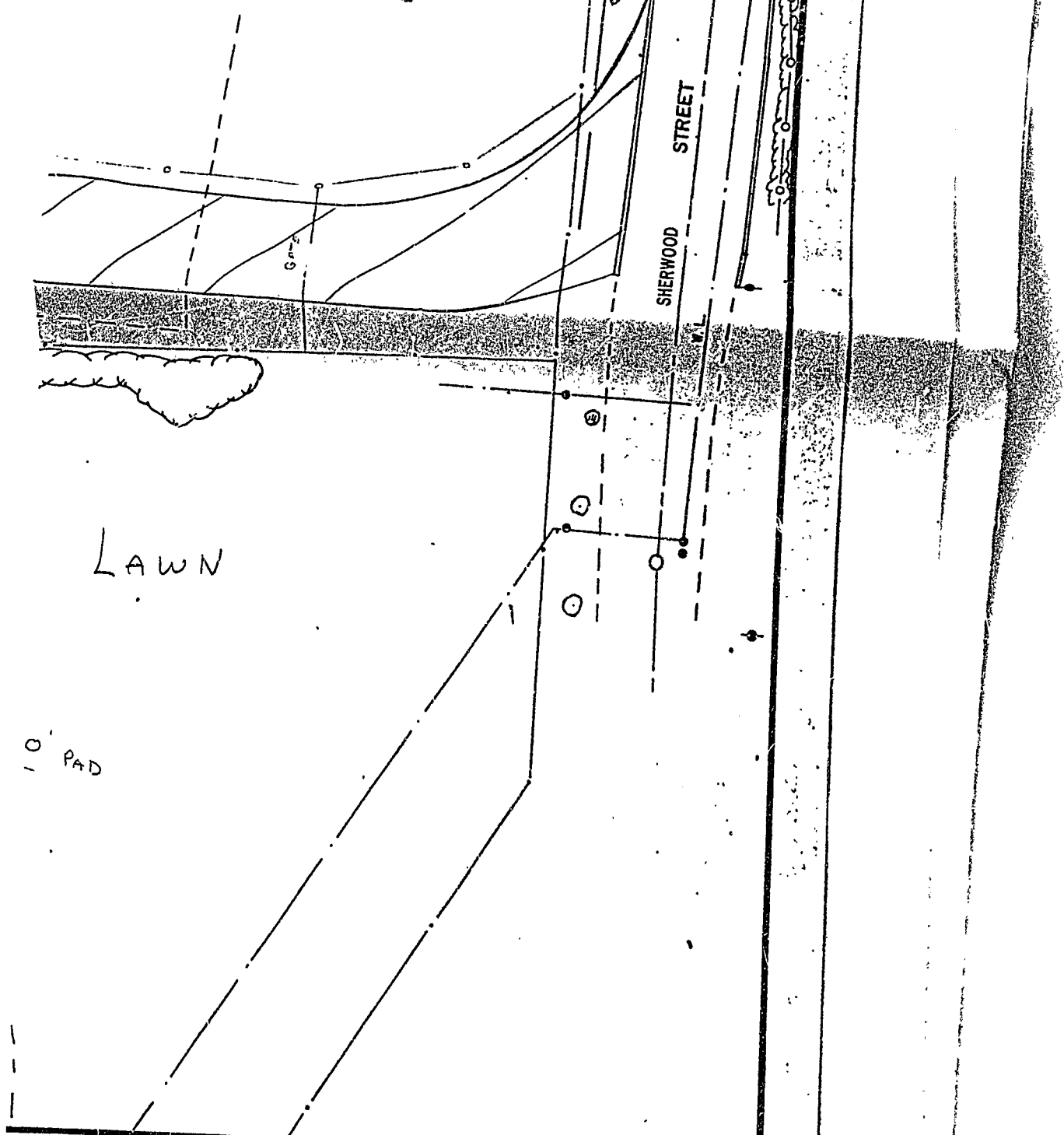

STATE OF MAINE
DEPARTMENT OF TRANSPORTATION

RIGHT OF WAY MAP

BURNHAM & MORRILL Co
1 BEAN POT CIRCLE

DATE: *April*, 1985 APPROVED:

SCALE: 1 INCH = 25 FEET

SHEET NO. OF SHEETS
P.L. FILE NO.

RECEIVED
MAY 21 1985
DEPT. OF BLDG. INSP.
CITY OF PORTLAND

COMMISSIONER

CHIEF ENGINEER

F.H.W.A. REG. NO.	STATE	PROJECT NUMBER	SHEET NO.	TOTAL SHEETS

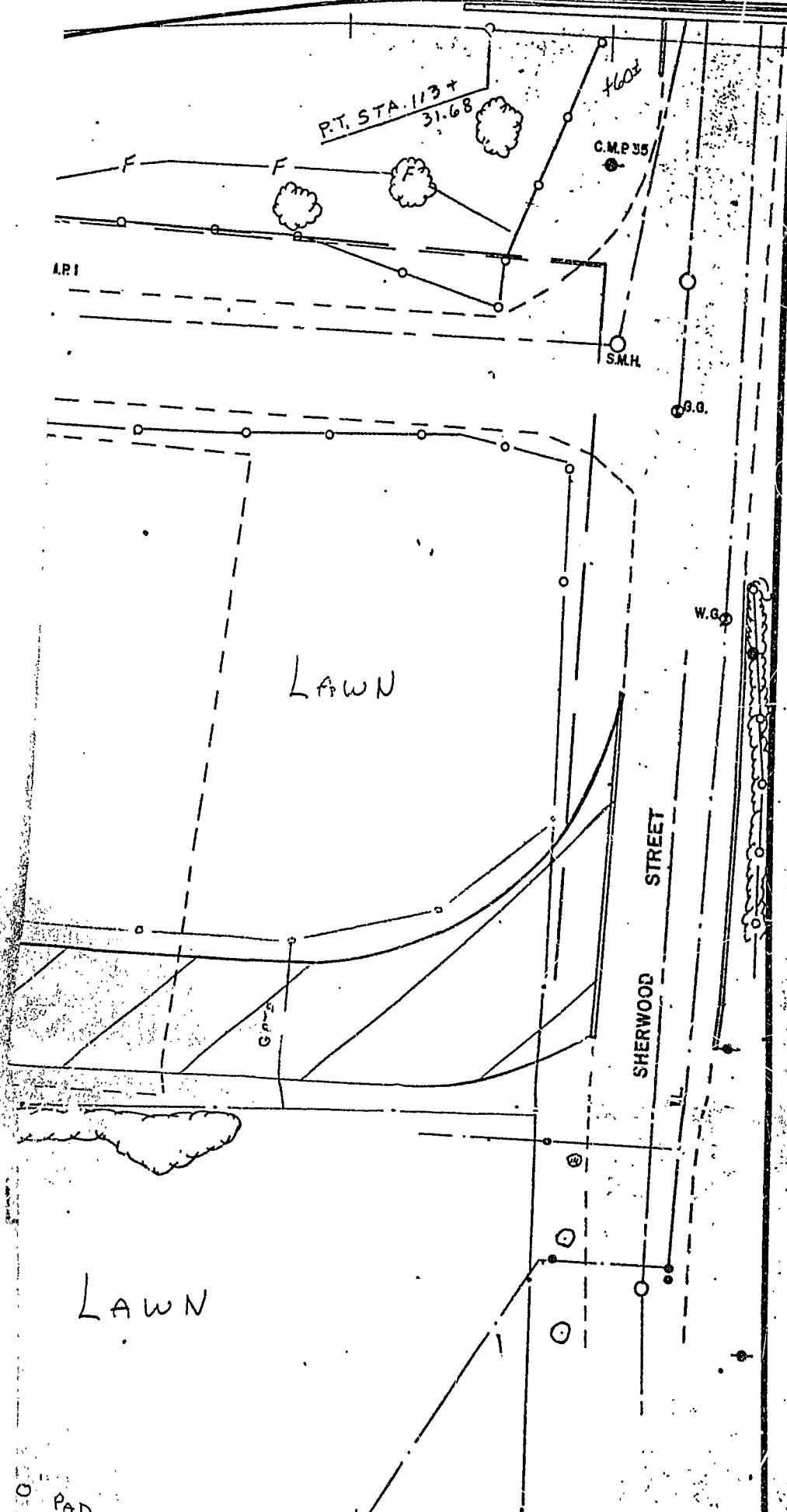

PAD

APPLICATION FOR PERMIT

PERMIT ISSUED

B.O.C.A. USE GROUP

B.O.C.A. TYPE OF CONSTRUCTION 0-422

MAY 3 1985

ZONING LOCATION PORTLAND, MAINE

CITY OF PORTLAND

To the CHIEF OF BUILDING & INSPECTION SERVICES, PORTLAND, MAINE

The undersigned hereby applies for a permit to erect, alter, repair, demolish, move or install the following building, structure, equipment or change use in accordance with the Laws of the State of Maine, the Portland B.O.C.A. Building Code and Zoning Ordinance of the City of Portland with plans and specifications, if any, submitted herewith and the following specifications:

LOCATION ... 1 Bean Pot Circle ... Fire District #1 , #2

1. Owner's name and address ... Burnham & Morrill Co. - same ... Telephone 772-8341

2. Lessee's name and address ... Telephone

3. Contractor's name and address ... Suburban Propane - Thompsons Point ... Telephone

..... No. of sheets

Proposed use of building 1000 gal. propane gas tank ... No. families

Last use ... same ... No. families

Material ... No. stories ... Heat ... Style of roof ... Roofing

Other buildings on same lot

Estimated contractual cost \$ 500

FIELD INSPECTOR—Mr. ... Appeal Fees \$

@ 775-5451 ... Base Fee .15.00

move tank 10.00

Late Fee ... TOTAL \$.25.00

To construct 6' x 20' concrete pad to be used to set 1000 gal. propane gas tank on being moved from one area of lot to another area ~~suburban~~

Stamp of Special Conditions

NOTE TO APPLICANT: Separate permits are required by the installers and subcontractors of heating, plumbing, electrical and mechanicals.

DETAILS OF NEW WORK

Is any plumbing involved in this work? ... Is any electrical work involved in this work?

Is connection to be made to public sewer? ... If not, what is proposed for sewage?

Has septic tank notice been sent? ... Form notice sent?

Height average grade to top of plate ... Height average grade to highest point of roof

Size, front ... depth ... No. stories ... solid or filled land? ... earth or rock?

Material of foundation ... Thickness, top ... bottom ... cellar

Kind of roof ... Rise per foot ... Roof covering

No. of chimneys ... Material of chimneys ... of lining ... Kind of heat ... fuel

Framing Lumber—Kind ... Dressed or full size? ... Corner posts ... Sills

Size Girder ... Columns under girders ... Size ... Max. on centers

Studs (outside walls and carrying partitions) 2x4-16" O. C. Bridging in every floor and flat roof span over 8 feet.

Joists and rafters: 1st floor ... 2nd ... 3rd ... roof

On centers: 1st floor ... 2nd ... 3rd ... roof

Maximum span: 1st floor ... 2nd ... 3rd ... roof

If one story building with masonry walls, thickness of walls? ... height?

IF A GARAGE

No. cars now accommodated on same lot ... to be accommodated ... number commercial cars to be accommodated

Will automobile repairing be done other than minor repairs to cars habitually stored in the proposed building?

APPROVALS BY: ... DATE

MISCELLANEOUS

BUILDING INSPECTION PLAN EXAMINER

Will work require disturbing of any tree on a public street?

ZONING

Will there be in charge of the above work a person competent to see that the State and City requirements pertaining thereto are observed?

BUILDING CODE

Fire Dept.

Health Dept.

Others

Signature of Applicant ... Phone # same

Type Name of above John Totman Plan Engineer ... 1 2 3 4

for Burnham & Morrill ... Other ... and Address

FIELD INSPECTOR'S COPY

APPLICANT'S COPY

OFFICE FILE COPY

MA 2009

NOTES

6/20/85 Checked out 6" pad ground for propane tank & barriers already installed. Must

7/2/85 Tank installed OK

Permit No. 85-1922
Location: 18189 21st Ave
Owner: S. J. C. & M. J. C.
Date of permit: 5-1-85
Approved: J. B. 85
Dwelling:
Garage:
Alteration: none done

85-1922
Permit # 85-1922
7/2/85

APPLICATION FOR PERMIT

00353 PERMIT ISSUED

B.O.C.A. USE GROUP

B.O.C.A. TYPE OF CONSTRUCTION

ZONING LOCATION PORTLAND, MAINE April 1, 1986

CITY OF PORTLAND

To the CHIEF OF BUILDING & INSPECTION SERVICES, PORTLAND, MAINE

The undersigned hereby applies for a permit to erect, alter, repair, demolish, move or install the following building, structure, equipment or change use in accordance with the Laws of the State of Maine, the Portland B.O.C.A. Building Code and Zoning Ordinance of the City of Portland with plans and specifications, if any, submitted herewith and the following specifications:

LOCATION 1 Bean Pot Circle Fire District #1 [], #2 []
1. Owner's name and address Burnham & Morrill Div of Pet Inc. - same Telephone 772-8341
2. Lessee's name and address Telephone
3. Contractor's name and address Owner Telephone

Proposed use of building food processing plant No. of sheets
Last use same No. families
Material No. stories Heat Style of roof Roofing

Other buildings on same lot
Estimated contractual cost \$ 75,000 Appeal Fees \$
Base Fee 395.00

FIELD INSPECTOR--Mr. @ 775-5451 Late Fee
TOTAL \$

To expand canned receiving area by enclosing can receiving yard as per plans.

Stamp of Special Conditions

NOTE TO APPLICANT: Separate permits are required by the installers and subcontractors of heating, plumbing, electrical and mechanicals.

DETAILS OF NEW WORK

Is any plumbing involved in this work? NO Is any electrical work involved in this work? YES
Is connection to be made to public sewer? If not, what is proposed for sewage?
Has septic tank notice been sent? Form notice sent?
Height average grade to top of plate Height average grade to highest point of roof
Size, front depth No. stories solid or filled land? earth or rock?
Material of foundation Thickness, top bottom cellar
Kind of roof Rise per foot Roof covering
No. of chimneys Material of chimneys of lining Kind of heat fuel
Framing Lumber--Kind Dressed or full size? Corner posts Sills
Size Girder Columns under girders Size Max. on centers
Studs (outside walls and carrying partitions) 2x4-16" O. C. Bridging in every floor and flat roof span over 8 feet.
Joists and ratters: 1st floor 2nd 3rd roof
On centers: 1st floor 2nd 3rd roof
Maximum span: 1st floor 2nd 3rd roof
If one story building with masonry walls, thickness of walls? height?

IF A GARAGE

No. cars now accommodated on same lot, to be accommodated number commercial cars to be accommodated
Will automobile repairing be done other than minor repairs to cars habitually stored in the proposed building?

APPROVALS BY: DATE MISCELLANEOUS
BUILDING INSPECTION PLAN EXAMINER Will work require disturbing of any tree on a public street? NO
ZONING: Building Code: Will there be in charge of the above work a person competent to see that the State and City requirements pertaining thereto are observed? Yes
Fire Dept.: Health Dept.: Others: Ext 269

Signature of Applicant Phone # same
Type Name of above John Totman for Ext 269
Burnham & Morrill Other and Address

FIELD INSPECTOR'S COPY

APPLICANT'S COPY

OFFICE FILE COPY

Handwritten signature and date: JMA 10/1/86



APPLICATION FOR PERMIT
DEPARTMENT OF BUILDING INSPECTIONS SERVICES
ELECTRICAL INSTALLATIONS

12/1/86 ER

Date November 25, 1986
 Receipt and Permit number D 09723

To the CHIEF ELECTRICAL INSPECTOR, Portland, Maine:

The undersigned hereby applies for a permit to make electrical installations in accordance with the laws of Maine, the Portland Electrical Ordinance, the National Electrical Code and the following specifications:

LOCATION OF WORK: 295 Northbound (B&M Plant) *Beaumont Circle*
 OWNER'S NAME: Yankee Construction ADDRESS: 193 Middle Street

FEES

OUTLETS:	Receptacles _____	Switches _____	Plugmold _____	TOTAL _____	
FIXTURES: (number of)	Incandescent _____	Flourescent _____	(not strip) TOTAL _____		
	Strip Flourescent _____	ft. _____			
SERVICES:	Overhead <u>XX</u>	Underground _____	Temporary <u>60</u>	TOTAL amperes <u>60</u>	<u>3.00</u>
METERS: (number of)	_____				
MOTORS: (number of)	_____				
	Fractional _____	_____			
	1 HP or over _____	_____			
RESIDENTIAL HEATING:	_____				
	Oil or Gas (number of units) _____	_____			
	Electric (number of rooms) _____	_____			
COMMERCIAL OR INDUSTRIAL HEATING:	_____				
	Oil or Gas (by a main boiler) _____	_____			
	Oil or Gas (by separate units) _____	_____			
	Electric Under 20 kws _____	Over 20 kws _____	_____		
APPLIANCES: (number of)	_____				
	Ranges _____	Water Heaters _____	_____		
	Cook Tops _____	Disposals _____	_____		
	Wall Ovens _____	Dishwashers _____	_____		
	Dryers _____	Compactors _____	_____		
	Fans _____	Others (denote) _____	_____		
	TOTAL _____	_____			
MISCELLANEOUS: (number of)	_____				
	Branch Panels _____	_____			
	Transformers _____	_____			
	Air Conditioners Central Unit _____	_____			
	Separate Units (windows) _____	_____			
	Signs 20 sq. ft. and under _____	_____			
	Over 20 sq. ft. _____	_____			
	Swimming Pools Above Ground _____	_____			
	In Ground _____	_____			
	Fire/Burglar Alarms Residential _____	_____			
	Commercial _____	_____			
	Heavy Duty Outlets, 220 Volt (such as welders) 30 amps and under _____	_____			
	over 30 amps _____	_____			
	Circus, Fairs, etc. _____	_____			
	Alterations to wires _____	_____			
	Repairs after fire _____	_____			
	Emergency Lights, battery _____	_____			
	Emergency Generators _____	_____			
	INSTALLATION FEE DUE: _____	_____			
	FOR ADDITIONAL WORK NOT ON ORIGINAL PERMIT ... DOUBLE FEE DUE: _____	_____			
	FOR REMOVAL OF A "STOP ORDER" (304-16.b) ...	_____			<u>5.00 min</u>
	TOTAL AMOUNT DUE: _____	_____			

INSPECTION:

Will be ready on 11/26 a.m., 1986; or Will Call _____
 CONTRACTOR'S NAME: AD Electric
 ADDRESS: Rural Rt. 1 Box 3180 Sabattus
 TEL.: 375-6616
 MASTER LICENSE NO.: 2801 SIGNATURE OF CONTRACTOR: *Donald B. Castonguay*
 LIMITED LICENSE NO.: _____

INSPECTOR'S COPY — WHITE
 OFFICE COPY — CANARY
 CONTRACTOR'S COPY — GREEN

Permit # _____ City of Portland BUILDING PERMIT APPLICATION Fee \$32.60 Zone _____ Map # _____ Lot# _____
 Please fill out any part which applies to job. Proper plans must accompany form.

Owner: PET (B & M Beans) Phone # 772-8341
 Address: 1 Bean Pot Circle, Portland, ME 04104
 LOCATION OF CONSTRUCTION 1 Bean Pot Circle
 Contractor: Bailey Sign Co. Sub: _____
 Address: 9 Thomas Dr., West., ME 04092 Phone # 774-2843
 Est. Construction Cost: _____ Proposed Use: Comm. - Bean Plant
 Past Use: same
 # of Existing Res. Units _____ # of New Res. Units _____
 Building Dimensions L _____ W _____ Total Sq. Ft. _____
 # Stories: _____ # Bedrooms _____ Lot Size: _____
 Is Proposed Use: Seasonal _____ Condominium _____ Conversion _____
 Explain Conversion Erect 38 sq. ft. free standing sign, one sheet of plans.

For Official Use Only

Date Dec. 21, 1989 Subdivision: _____ Name _____
 Inside Fire Limits _____ Lot _____
 Bldg Code _____ Ownership: _____ Public _____ Private _____
 Time Limit _____
 Estimated Cost _____
 Zoning: I-2
 Street Frontage Provided: _____ Back _____ Side _____
 Provided Setbacks: Front _____
 Review Required:
 Zoning Board Approval: Yes _____ No _____ Date: _____
 Planning Board Approval: Yes _____ No _____ Date: _____
 Conditional Use: _____ Variance _____ Site Plan _____ Subdivision _____
 Shoreland Zoning Yes _____ No _____ Floodplain Yes _____ No _____
 Special Exception _____
 Other (Explain) OK W.D. HAS 12-22-89

Foundation:
 1. Type of Soil: _____
 2. Set Backs - Front _____ Rear _____ Side(s) _____
 3. Footings Size: _____
 4. Foundation Size: _____
 5. Other _____

Floor:
 1. Sills Size: _____ Sills must be anchored
 2. Girder Size: _____ Size: _____
 3. Lally Column Spacing: _____ Spacing 16" O.C.
 4. Joists Size: _____ Size: _____
 5. Bridging Type: _____ Size: _____
 6. Floor Sheathing Type: _____
 7. Other Material: _____

Exterior Walls:
 1. Studding Size _____ Spacing _____
 2. No. windows _____
 3. No. Doors _____
 4. Header Sizes _____ Span(s) _____
 5. Bracing: Yes _____ No _____
 6. Corner Posts Size _____ Size _____
 7. Insulation Type _____ Size _____
 8. Sheathing Type _____ Weather Exposure _____
 9. Siding Type _____
 10. Masonry Materials _____
 11. Metal Materials _____

Interior Walls:
 1. Studding Size _____ Spacing _____
 2. Header Sizes _____ Spacing _____
 3. Wall Covering Type _____
 4. Fire Wall if required _____
 5. Other Materials _____

Ceiling:
 1. Ceiling Joists Size: _____ Spacing _____
 2. Ceiling Strapping Size _____
 3. Type Ceilings: _____ Size _____
 4. Insulation Type _____
 5. Ceiling Height: _____
Roof:
 1. Truss or Rafter Size _____
 2. Sheathing Type _____
 3. Roof Covering Type _____

Chimneys: Type: _____ Number of Fire Places _____
Heating: Type of Heat: _____
Electrical: Service Entrance Size: _____ Smoke Detector Required Yes _____ No _____

Plumbing: Yes _____ No _____
 1. Approval of soil test if required _____
 2. No. of Tubs or Showers _____
 3. No. of Flushes _____
 4. No. of Lavatories _____
 5. No. of Other Fixtures _____

Swimming Pools:
 1. Type: _____ x _____ Square Footage _____
 2. Pool Size: _____
 3. Must conform to National Electrical Code and State Law.

Permit Received By Joyce M. Rinaldi
 Signature of Applicant Rodney L. Bean Date 12/21/89
 Signature of CEO _____ Date _____

Inspection Dates _____
 White Tag - CEO _____
 © Copyright GPCOG 1988

White-Tax Assesor Yellow-GPCOG

PERMIT ISSUED
 DEC 26 1989
 City of Portland

PLOT PLAN

N



FEES (Breakdown From Front)

Base Fee \$ 32.60 _____
Subdivision Fee \$ _____
Site Plan Review Fee \$ _____
Other Fees \$ _____
(Explain) _____
Late Fee \$ _____

Inspection Record

Type	Date
FINAL	1/3/90
_____	_____
_____	_____
_____	_____
_____	_____

COMMENTS

~~_____~~
~~_____~~
~~_____~~
~~_____~~
~~_____~~
~~_____~~
~~_____~~
~~_____~~
~~_____~~
~~_____~~

Signature of Applicant Radney L. Benn
as agent of owner

Date 12/21/89

002957
 Permit # _____ City of Portland BUILDING PERMIT APPLICATION Fee \$32.60 Zone _____ Map # _____ Lot# _____
 Please fill out any part which applies to job. Proper plans must accompany form.

Applicant: PBT (B & M Beans) Phone # 772-8341
 Address: 1 Bean Pot Circle, Portland, ME 04104
 Nature of Construction: 1 Bean Pot Circle
 Contractor: Bailey Sign Co. Sub: _____
 Address: 9 Thomas Dr., West., ME 04092 Phone # 774-2843
 Construction Cost: _____ Proposed Use: Comm. - Bean Plant
 Past Use: same
 Existing Res. Units _____ # of New Res. Units _____
 Building Dimensions: L _____ W _____ Total Sq. Ft. _____
 Rooms: _____ # Bedrooms _____ Lot Size: _____
 Proposed Use: Seasonal _____ Condominium _____ Conversion _____
 In Conversion: Erect 38 sq. ft. free standing sign, one sheet of plans.

For Official Use Only

Date: Dec. 21, 1989
 Inside Fire Limits: _____
 Bldg Code: _____
 Time Limit: _____
 Estimated Cost: _____

Subdivision: _____
 Name: _____
 Lot: _____
 Ownership: _____ Public _____ Private _____

Zoning: I-2
 Street Frontage Provided: _____
 Provided Setbacks: Front _____ Back _____ Side _____

Review Required:
 Zoning Board Approval: Yes _____ No _____ Date: _____
 Planning Board Approval: Yes _____ No _____ Date: _____
 Conditional Use: _____ Variance _____ Site Plan _____ Subdivision _____
 Shoreland Zoning: Yes _____ No _____ Floodplain: Yes _____ No _____
 Special Exception _____
 Other: (Explain) OK W.D. H.S. 12-22-89

Foundation: Erected on own property, non lighted.

1. Type of Soil: _____
 2. Set Backs - Front _____ Rear _____ Side(s) _____
 3. Footings Size: _____
 4. Foundation Size: _____
 5. Other: _____

1. Sills Size: _____ Sills must be anchored.
 2. Girder Size: _____
 3. Lally Column Spacing: _____ Size: _____
 4. Joists Size: _____ Spacing 16" O.C.
 5. Bridging Type: _____ Size: _____
 6. Floor Sheathing Type: _____ Size: _____
 7. Other Material: _____

Interior Walls:
 1. Studding Size _____ Spacing _____
 2. No. windows _____
 3. No. Doors _____
 4. Header Sizes _____ Span(s) _____
 5. Bracing: Yes _____ No _____
 6. Corner Posts Size _____
 7. Insulation Type _____ Size _____
 8. Sheathing Type _____ Size _____
 9. Siding Type _____ Weather Exposure _____
 10. Metal Materials _____
 11. Metal Materials _____

Exterior Walls:
 1. Studding Size _____ Spacing _____
 2. Header Sizes _____ Span(s) _____
 3. Wall Covering Type _____
 4. Fire Wall if required _____
 5. Other Materials _____

Ceiling:
 1. Ceiling Joists Size: _____ Spacing _____
 2. Ceiling Strapping Size _____
 3. Type Ceilings: _____
 4. Insulation Type _____
 5. Ceiling Height: _____

Roof:
 1. Truss or Rafter Size _____ Span DEC 26 1989
 2. Sheathing Type _____ Size _____
 3. Roof Covering Type _____ City of Portland

Chimneys:
 Type: _____ Number of Fire Places _____

Heating:
 Type of Heat: _____

Electrical:
 Service Entrance Size: _____ Smoke Detector Required Yes _____ No _____

Plumbing:
 1. Approval of soil test if required Yes _____ No _____
 2. No. of Tubs or Showers _____
 3. No. of Flushes _____
 4. No. of Lavatories _____
 5. No. of Other Fixtures _____

Swimming Pools:
 1. Type: _____
 2. Pool Size: _____ x _____ Square Footage _____
 3. Must conform to National Electrical Code and State Law.

Permit Received By: Joyce M. Rinaldi
 Signature of Applicant: _____ Date: 12/21/89
 Signature of CEO: _____ as agent of owner _____ Date _____
 Inspection Dates: _____

White-Tax Assesor Yellow-GPCOG White Tag-CEO
 MR. MACISAAC © Copyright GPCOG 1988



APPLICATION FOR PERMIT
DEPARTMENT OF BUILDING INSPECTIONS SERVICES
ELECTRICAL INSTALLATIONS

Date February 16, 1989
 Receipt and Permit number _____

To the CHIEF ELECTRICAL INSPECTOR, Portland, Maine:

The undersigned hereby applies for a permit to make electrical installations in accordance with the laws of Maine, the Portland Electrical Ordinance, the National Electrical Code and the following specifications:

LOCATION OF WORK: Burnham and Merrill RR Drive
 OWNER'S NAME: The Dept. of Environmental Protection ADDRESS: Bureau of Air Quality
State House Station #17, Augusta, Me

OUTLETS: Receptacles 2 Switches 1 Plugmold _____ ft. TOTAL _____ 3.00

FIXTURES: (number of) Incandescent _____ Fluorescent _____ (not strip) TOTAL _____
 Strip Fluorescent _____ ft. _____

SERVICES: Overhead _____ Underground _____ Temporary _____ TOTAL amperes _____

METERS: (number of) Fractional _____
 1 HP or over _____

RESIDENTIAL HEATING: Oil or Gas (number of units) _____
 Electric (number of rooms) _____

COMMERCIAL OR INDUSTRIAL HEATING: Oil or Gas (by a main boiler) _____
 Oil or Gas (by separate units) _____
 Electric Under 20 kws _____ Over 20 kws _____

APPLIANCES: (number of) Ranges _____ Water Heaters _____
 Cook Tops _____ Disposals _____
 Wall Ovens _____ Dishwashers _____
 Dryers _____ Compactors _____
 Fans _____ Others (denote) _____

TOTAL _____

MISCELLANEOUS: (number of) Branch Panels 1 _____ 1.00
 Transformers _____
 Air Conditioners Central Unit _____
 Separate Units (windows) _____
 Signs 20 sq. ft. and under _____
 Over 20 sq. ft. _____
 Swimming Pools Above Ground _____
 In Ground _____
 Fire/Burglar Alarms Residential _____
 Commercial _____
 Heavy Duty Outlets, 220 Volt (such as welders) 30 amps and under _____
 over 30 amps _____
 Circus, Fairs, etc. _____
 Alterations to wires _____
 Repairs after fire _____
 Emergency Lights, battery _____
 Emergency Generators _____

FOR ADDITIONAL WORK NOT ON ORIGINAL PERMIT INSTALLATION FEE DUE: _____
 FOR REMOVAL OF A "STOP ORDER" (304-16.b) DOUBLE FEE DUE: _____
 TOTAL AMOUNT DUE: 5.00 min

INSPECTION: Will be ready on _____, 19__; or Will Call x
 CONTRACTOR'S NAME: John Letfey
 ADDRESS: 45 Hillside Rd., Portland
 TEL.: 797-5553
 MASTER LICENSE NO.: 08675 SIGNATURE OF CONTRACTOR: _____
 LIMITED LICENSE NO.: _____

INSPECTOR'S COPY — WHITE
 OFFICE COPY — CANARY
 CONTRACTOR'S COPY — GREEN

Permit # **930499** City of Portland BUILDING PERMIT APPLICATION Fee 165.00 Zone _____ Map # _____ Lot# _____
 Please fill out any part which applies to job. Proper plans must accompany form.

PERMIT ISSUED
JAN 14 1993
CITY OF PORTLAND

Owner: Pet Inc/B&M Baked Beans Phone # _____
 Address: 1 Beanpot Circle Ptd, ME
 LOCATION OF CONSTRUCTION 1 Beanpot Circle
 Contractor: Bailey Sign Sub: _____
 Address: 9 Thomas Drive Westbrook, ME 04092 Phone # 774-2843
 Est. Construction Cost: _____ Proposed Use: Factory w/sign
 UL#: AV047060 Past Use: Factory
 # of Existing Res. Units _____ # of New Res. Units _____
 Building Dimensions L _____ W _____ Total Sq. Ft. _____
 # Stories: _____ # Bedrooms _____ Lot Size: _____
 Is Proposed Use: Seasonal _____ Condominium _____ Conversion _____
 Explain Conversion: Erect Lighted Sign 10'x70' as per plans

For Official Use Only
 Date June 1, 1993
 Inside Fire Limits _____
 Bldg Code _____
 Time Limit _____
 Estimated Cost _____

Zoning: T2
 Street Frontage Provided: _____
 Provided Setbacks: Front _____ Back _____ Side _____
 Review Required:
 Zoning Board Approval: Yes _____ No _____ Date: _____
 Planning Board Approval: Yes _____ No _____ Date: _____
 Conditional Use: _____ Variance _____ Site Plan _____
 Shoreland Zoning Yes _____ No _____ Floodplain Yes _____ No _____
 Special Exception _____
 Other (Explain) 6-14-93

Foundation:
 1. Type of Soil: _____
 2. Set Backs - Front _____ Rear _____ Side(s) _____
 3. Footings Size: _____
 4. Foundation Size: _____
 5. Other _____

Floor:
 1. Sills Size: _____ Sills must be anchored.
 2. Girder Size: _____ Size: _____
 3. Lally Column Spacing: _____ Spacing 16" O.C.
 4. Joists Size: _____ Size: _____
 5. Bridging Type: _____ Size: _____
 6. Floor Sheathing Type: _____
 7. Other Material: _____

Exterior Walls:
 1. Studding Size _____ Spacing _____
 2. No. windows _____
 3. No. Doors _____ Span(s) _____
 4. Header Sizes _____
 5. Bracing: Yes _____ No _____
 6. Corner Posts Size _____ Size _____
 7. Insulation Type _____ Size _____
 8. Sheathing Type _____
 9. Siding Type _____
 10. Masonry Materials _____
 11. Metal Materials _____

Interior Walls:
 1. Studding Size _____ Spacing _____
 2. Header Sizes _____ Span(s) _____
 3. Wall Covering Type _____
 4. Fire Wall if required _____
 5. Other Materials _____

Ceiling:
 1. Ceiling Joists Size: _____ Spacing _____
 2. Ceiling Strapping Size _____
 3. Type Ceilings: _____ Size _____
 4. Insulation Type _____
 5. Ceiling Height: _____

Roof:
 1. Truss or Rafter Size _____ Span Action: _____
 2. Sheathing Type _____ Size _____
 3. Roof Covering Type _____

Chimneys:
 Type: _____ Number of Fire Places _____

Heating:
 Type of Heat: _____
 Electrical: Service Entrance Size: _____ Smoke Detector Required Yes _____ No _____

Plumbing:
 1. Approval of soil test if required _____
 2. No. of Tubs or Showers _____
 3. No. of Flushes _____
 4. No. of Lavatories _____
 5. No. of Other Fixtures _____

Swimming Pools:
 1. Type: _____ Square Footage _____
 2. Pool Size: _____
 3. Must conform to National Electrical Code and State Law.

Permit Received By Mary Gresik
 Signature of Applicant Andrea Noyes Date June 1, 1993
 Signature of CEO _____ Date _____

Inspection Dates _____

White-Tax Assessor _____ Yellow-GPCOG _____ White Tag -CEO _____

HISTORIC PRESERVATION

Not in District or Landmark
 Does not require review
 Requires Review

Approved
 Approved with Conditions

Date: 6/14/93

Copyright GPCOG 1988

930499

Permit # 930499 City of Portland BUILDING PERMIT APPLICATION Fee 405.00 Zone Map # Lot#

Please fill out any part which applies to job. Proper plans must accompany form.

Owner: Pat Inc/B&M Baked Beans Phone # _____
 Address: 1 Beanpot Circle Pti, ME
 LOCATION OF CONSTRUCTION 1 Beanpot Circle
 Contractor: Hailey Sign Sub: _____
9 Thomas Drive Westbrook, ME 04092 Phone # 774-2843
 Address: _____
 Est. Construction Cost: _____ Proposed Use: FACTORY w/sign
 JLF#: AU047050 Past Use: Factory
 # of Existing Res. Units _____ # of New Res. Units _____
 Building Dimensions L _____ W _____ Total Sq. Ft. _____
 # Stories: _____ # Bedrooms _____ Lot Size: _____
 Is Proposed Use: Seasonal _____ Condominium _____ Conversion _____
 Explain Conversion Erec Lighted Sign 10'x70' as per plans

For Official Use Only

Date June 1, 1993 Subdivision: _____
 Inside Fire Limits _____ Name: JUN 14 1993
 Eisdg Code _____ Lot: _____
 Time Limit _____ Ownership: CITY OF PORTLAND
 Estimated Cost _____

Zoning: _____
 Street Frontage Provided: _____
 Provided Setbacks: Front _____ Back _____ Side _____ Side _____

Review Required:
 Zoning Board Approval: Yes _____ No _____ Date: _____
 Planning Board Approval: Yes _____ No _____ Date: _____
 Conditional Use: _____ Variance _____ Site Plan _____ Subdivision _____
 Shoreland Zoning Yes _____ No _____ Floodplain Yes _____ No _____
 Special Exception _____
 Other (Explain) 6-14-93

Foundation:
 1. Type of Soil: _____
 2. Set Backs - Front _____ Rear _____ Side(s) _____
 3. Footings Size: _____
 4. Foundation Size: _____
 5. Other _____

Floor:
 1. Sills Size: _____ Sills must be anchored.
 2. Girder Size: _____
 3. Lally Column Spacing: _____ Size: _____
 4. Joists Size: _____ Spacing 16" O.C.
 5. Bridging Type: _____ Size: _____
 6. Floor Sheathing Type: _____ Size: _____
 7. Other Material: _____

Exterior Walls:
 1. Studding Size _____ Spacing _____
 2. No. windows _____
 3. No. Doors _____
 4. Header Sizes _____ Span(s) _____
 5. Bracing: Yes _____ No _____
 6. Corner Posts Size _____
 7. Insulation Type _____ Size _____
 8. Sheathing Type _____ Size _____
 9. Siding Type _____ Weather Exposure _____
 10. Masonry Materials _____
 11. Metal Materials _____

Interior Walls:
 1. Studding Size _____ Spacing _____
 2. Header Sizes _____ Span(s) _____
 3. Wall Covering Type _____
 4. Fire Wall if required _____
 5. Other Materials _____

HISTORIC PRESERVATION

Ceiling:
 1. Ceiling Joists Size: _____ Spacing _____ Historic District or Landmark _____
 2. Ceiling Strapping Size _____ Does not require review _____
 3. Type Ceilings: _____ Size _____ Requires Review _____
 4. Insulation Type _____
 5. Ceiling Height: _____

Roof:
 1. Truss or Rafter Size _____ Span _____ Action: Approved
 2. Sheathing Type _____ Size _____ Approved with Conditions
 3. Roof Covering Type _____ Date: 7/1/93
Denial

Chimneys:
 Type: _____ Number of Fire Places _____
 Date: 7/1/93
Denial

Heating:
 Type of Heat: _____

Electrical:
 Service Entrance Size: _____ Smoke Detector Required Yes _____ No _____

Plumbing:
 1. Approval of soil test if required Yes _____ No _____
 2. No. of Tubs or Showers _____
 3. No. of Flushes _____
 4. No. of Lavatories _____
 5. No. of Other Fixtures _____

Swimming Pools:
 1. Type: _____
 2. Pool Size: _____ x _____ Square Footage _____
 3. Must conform to National Electrical Code and State Law.

Permit Received By Mary Gressik
 Signature of Applicant: Andrea Noyes Date June 1, 1993
 Signature of CEO _____ Date _____

Inspection Dates _____
 White-Tax Assesor Yellow-GPCOG White Tag -CEO 6/17/93 Copyright GPCOG 1988

PLOT PLAN



FEES (Breakdown From Front)	Type	Inspection Record	Date
Base Fee \$ _____	_____	_____	____/____/____
Subdivision Fee \$ _____	_____	_____	____/____/____
Site Plan Review Fee \$ _____	_____	_____	____/____/____
Other Fees \$ _____	_____	_____	____/____/____
(Explain) _____	_____	_____	____/____/____
Late Fee \$ _____	_____	_____	____/____/____

COMMENTS

8/31/93 Done. A Rowe

Signature of Applicant

Andrea B. Dwyer

Date

6-1-93

WRITTEN CONSENT AND AGREEMENT RELATING TO A CERTAIN SIGN PROPOSED TO BE
ERECTED ON A BUILDING AT 1 Bearpot Circle
IN PORTLAND, MAINE John Tupper being the owner of the premises
at 1 Bearpot Circle in Portland, Maine hereby gives consent to the
erection of a certain sign owned by Pet Inc. over the
public sidewalk or on the building from said premises as described in
application to the Division of Inspection Services of Portland, Maine for a
permit to cover erection of said sign:

And in consideration of the issuance of said permit John Tupper
owner of said premises, in event said sign shall cease to serve the purpose
for which it was erected or shall become dangerous and in event the owner of
said sign shall fail to remove said sign or make it permanently safe in case
the sign still serves the purpose for which it was erected, hereby agrees
for himself or itself, for his heirs, its successors, and his or its
assigns, to completely remove said sign within ten days of notice from said
Inspector of Buildings that said sign is in such condition and of order from
him to remove it.

In Witness whereof, the owner of said premises has signed this consent and
agreement this 12 day of May 1993.

John Tupper
OWNER

03/05/88

05/26/93 08:37 207 772 7043

B&M DIV PET INC. --- BAILEY SIGN

003

MAY 25 '93 14:23

FROM PET INC RISK MGT

TO PORTLAND

PAGE. 003

THIS ENDORSEMENT CHANGES THE POLICY. PLEASE READ IT CAREFULLY.

ENDORSEMENT #1

This endorsement, effective 12:01 A.M. October 1, 1992 forms a part of
policy No. RMGL 326 52 26 issued to PET INCORPORATED
by National Union Fire Insurance Company of Pittsburgh, PA

This endorsement modifies insurance provided under the following:
COMMERCIAL GENERAL LIABILITY COVERAGE PART

NAMED INSURED

IT IS AGREED THAT ITEM 1 OF THE POLICY DECLARATIONS "NAMED INSUREDS" IS
COMPLETED TO READ AS FOLLOWS:

PET INCORPORATED AND ITS SUBSIDIARIES AS NOW EXIST OR MAY HEREAFTER BE
CONSTITUTED, WHICH ARE MORE THAN 50% OWNED, 100% MANAGED, OR FINANCIALLY
CONTROLLED BY THE NAMED INSURED, AND/OR JOINT VENTURES OR PARTNERSHIPS IN
WHICH THE NAMED INSUREDS PARTICIPATES BUT ONLY FOR THE NAMED INSUREDS
LIABILITY ARISING OUT OF SUCH JOINT VENTURES OR PARTNERSHIPS, INCLUDING THE
FOLLOWING ENTITIES:

HAIN PURE FOOD CO., INC.
HELVETIA REDEVELOPMENT CORPORATION
LA SIERRA BRANDS, INC.
OLD EL PASO FOODS COMPANY*
ORVAL KENT FOOD COMPANY, INC.
ORVAL KENT FOOD COMPANY, S.A. DE C.V.
ORVAL KENT FOOD COMPANY OF LINARES, INC.
ORVAL KENT FOOD COMPANY DE LINARES, S.A. DE C.V.
ORVAL KENT FOOD COMPANY OF RIO BRAVO, INC.
PET INCORPORATED
PET INCORPORATED COMMUNITY SUPPORT FOUNDATION
PET INTERNATIONAL, INC.**
PRIMO FOOD LIMITED
PROGRESSO FOODS COMPANY
RAMIREZ & FERAUD CHILI COMPANY, INC.
ST. LOUIS LITHOGRAPHING COMPANY
WILLIAM UNDERWOOD COMPANY - B&M Div.

U 13310

AUTHORIZED REPRESENTATIVE

AIGRAM124
SD/m
11/25/92

05/26/93 08:36 207 772 7043 B&M DIV PET INC. →→→ BAILEY SIGN 002
 MAY 25 '93 14:23 FROM PET INC RISK MGT TO PORTLAND PAGE 002
 1. NATIONAL UNION FIRE INSURANCE COMPANY OF PITTSBURGH A STOCK COMPANY
 2. AMERICAN HOME ASSURANCE COMPANY A STOCK COMPANY
 3. THE INSURANCE COMPANY OF STATE OF PENNSYLVANIA A STOCK COMPANY
 Member Companies of American International Group
 EXECUTIVE OFFICES
 70 FINE STREET, NEW YORK, N.Y. 10270
 COVERAGE IS PROVIDED IN THE COMPANY DESIGNATED BY NUMBER (HEREIN CALLED THE COMPANY).

COMMERCIAL GENERAL LIABILITY DECLARATIONS

POLICY NO. RM GL 326-52-26

NAMED INSURED PET INCORPORATED
 MAILING ADDRESS 400 S FOURTH ST (HEADQUARTERS)
 ST LOUIS MO 63102-0000

POLICY PERIOD: From 10/01/92 to 10/01/93 at

12:01 A.M. Standard Time at your mailing address shown above

IN RETURN FOR THE PAYMENT OF THE PREMIUM, AND SUBJECT TO ALL TERMS OF THIS POLICY,
 WE AGREE WITH YOU TO PROVIDE THE INSURANCE AS STATED IN THIS POLICY.

LIMITS OF INSURANCE
 GENERAL AGGREGATE LIMIT (Other Than Prod-Comp Operations) \$ See Endorsement #15
 PRODUCTS-COMPLETED OPERATIONS AGGREGATE LIMIT \$ 2,000,000
 PERSONAL & ADVERTISING INJURY LIMIT \$ 2,000,000
 EACH OCCURRENCE LIMIT \$ 2,000,000
 FIRE DAMAGE LIMIT \$ 1,000,000 Any One Ft
 MEDICAL EXPENSE LIMIT \$ 5,000 Any One Ps

Forms Of Business: Individual Partnership Joint Venture Organization
 (Other than Partnership or Joint Venture)

Business Description: FOOD MFG

Location Of All Premises You Own, Rent or Occupy: SEE ATTACHED SCHEDULE

CLASSIFICATION	CODE NO.	PREMIUM BASIS	RATE	ADVANCE PREMIUM	
				PR/CO	ALL OTHER
SEE ATTACHED SCHEDULE					

TOTAL: \$ 1,992,033

Premium shown is payable: \$

ENDORSEMENTS ATTACHED TO THIS POLICY: SEE ATTACHED SCHEDULE

COUNTERSIGNED: _____ BY _____
 (Date) (Authorized Representative)