

ZONING LOCATION R-3 PORTLAND, MAINE May 2, 1986 City Of Portland

To the CHIEF OF BUILDING & INSPECTION SERVICES, PORTLAND, MAINE

The undersigned hereby applies for a permit to erect, alter, repair, demolish, move or install the following building, structure, equipment or change use in accordance with the Laws of the State of Maine, the Portland B.O.C.A. Building Code and Zoning Ordinance of the City of Portland with plans and specifications, if any, submitted herewith and the following specifications:

LOCATION 56 Bernard Road Portland, Maine Fire District #1 , #2 
1. Owner's name and address ... Anthony Napolitano 56 Bernard Rd ... Telephone 797-7542
2. Lessee's name and address ... Telephone ...
3. Contractor's name and address National Pool & Spa, Inc. Telephone 657-4440
P.O. Box 11-29 Portland Rd Gray, Maine No. of sheets ...
Proposed use of building 1 family No. families ...
Last use 1 family No. families ...
Material No. stories Heat Style of roof Roofing
Other buildings on same lot
Estimated contractual cost \$ 12,000

FIELD INSPECTOR—Mr. @ 775-5451 Appeal Fees \$
Base Fee
Late Fee
TOTAL \$ 80.00

To construct 18X 36 Inground Pool
14X18 Pressure treated Deck
8X12 Wood Shed on Concrete Blocks
As per plan

Stamp of Special Conditions

Permit #1

NOTE TO APPLICANT: Separate permits are required by the installers and subcontractors of heating, plumbing, electrical and mechanicals.

DETAILS OF NEW WORK

Is any plumbing involved in this work? NO Is any electrical work involved in this work? yes
Is connection to be made to public sewer? If not, what is proposed for sewage?
Has septic tank notice been sent? Form notice sent?
Height average grade to top of plate Height average grade to highest point of roof
Size, front depth No. stories solid or filled land? earth or rock?
Material of foundation deck somotubes Thickness, top bottom cellar
Kind of roof Rise per foot Roof covering
No. of chimneys Material of chimneys of lining Kind of heat fuel
Framing Lumber—Kind Dressed or full size? Corner posts Sills
Size Girder Columns under girders Size Max. on centers
Studs (outside walls and carrying partitions) 2x4-16" O. C. Bridging in every floor and flat roof span over 8 feet.
Joists and rafters: 1st floor 2nd 3rd roof
On centers: 1st floor 2nd 3rd roof
Maximum span: 1st floor 2nd 3rd roof
If one story building with masonry walls, thickness of walls? height?

IF A GARAGE

No. cars now accommodated on same lot to be accommodated number commercial cars to be accommodated
Will automobile repairing be done other than minor repairs to cars habitually stored in the proposed building?

APPROVALS BY: DATE
BUILDING INSPECTION—PLAN EXAMINER
ZONING: O. R. M. J. T. S. A. D. E.
BUILDING CODE:
Fire Dept.:
Health Dept.:
Others:

MISCELLANEOUS
Will work require disturbing of any tree on a public street? No
Will there be in charge of the above work a person competent to see that the State and City requirements pertaining thereto are observed? Yes

Signature of Applicant Anthony J. Napolitano Phone # 797-7542
Type Name of above Anthony Napolitano 1  2  3  4 
Other and Address

FIELD INSPECTOR'S COPY APPLICANT'S COPY OFFICE FILE COPY

MA MILLER

5/2/86 sent copy of  
Swimming pool Regs. with  
Permit ~~1/8~~

OK ~~2/8~~

~~[Large section of the page is crossed out with a large diagonal line.]~~

Permit No. 866/513  
Location 2611 Grand Road  
Owner ~~William J. [unclear]~~  
Permit 5-2-86  
Approved [unclear]  
Selling [unclear]  
Page [unclear]  
Creation [unclear]

8X12 wood shed  
on blocks (1)

14X18 pressure treated deck  
2x8 joice 8" saw tubes  
5/4" decking (2)

18X36 Inground pool  
National Pool's & SPA  
Gray, Me. (3)

RECEIVED

MAY - 2 1986

DEPT. OF BUILDING INSPECTIONS  
CITY OF PORTLAND

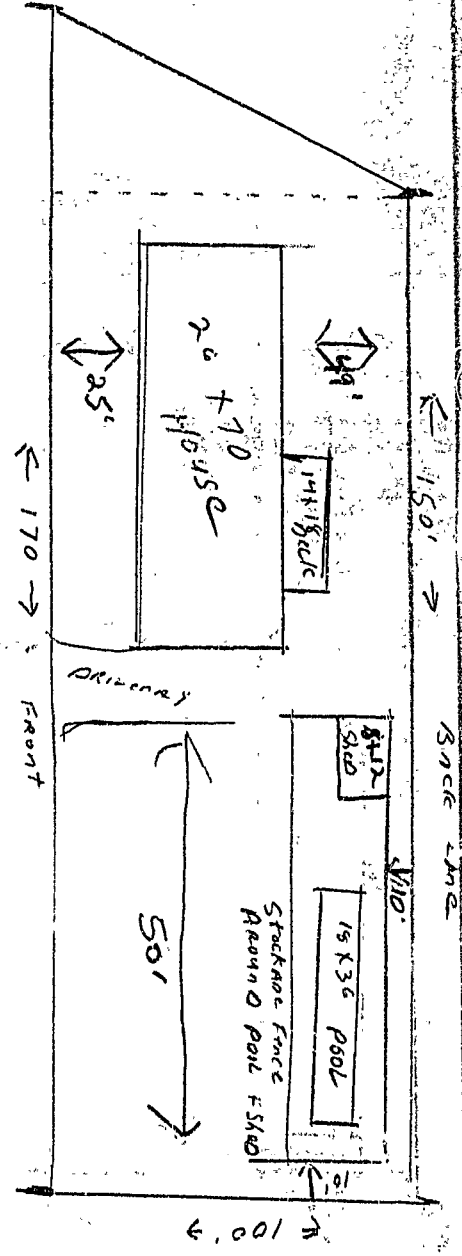

ANTHONY J NAPOLITANO  
56 BERKHO RD  
797-7542

RECEIVED

MAY - 2 1986

DEPT. OF BUILDING INSPECTIONS

## Accessories ... now or later

A diving board, a slide and solar or ordinary pool water heater are great "fun-accessories" that will expand your pool activities to the fullest. Consideration should be given to these items before your new pool's construction begins. Installing the mounting devices for the diving board during pool construction will be easier and less expensive than having it done a year or two later. If a heater is part of a future plan, have your dealer install the plumbing, concrete pad, etc., while he's got all his equipment at the site.

Another good idea is to have your dealer install the attachment for a *Star-Sweep* automatic pool cleaner. After a season or two of hand cleaning, you may want one of these units that travels around your pool and cleans it automatically — without your help. Talk it over with your dealer now. *Star-Sweep* will save you time, expense and avoid possible disruption of your activities later.

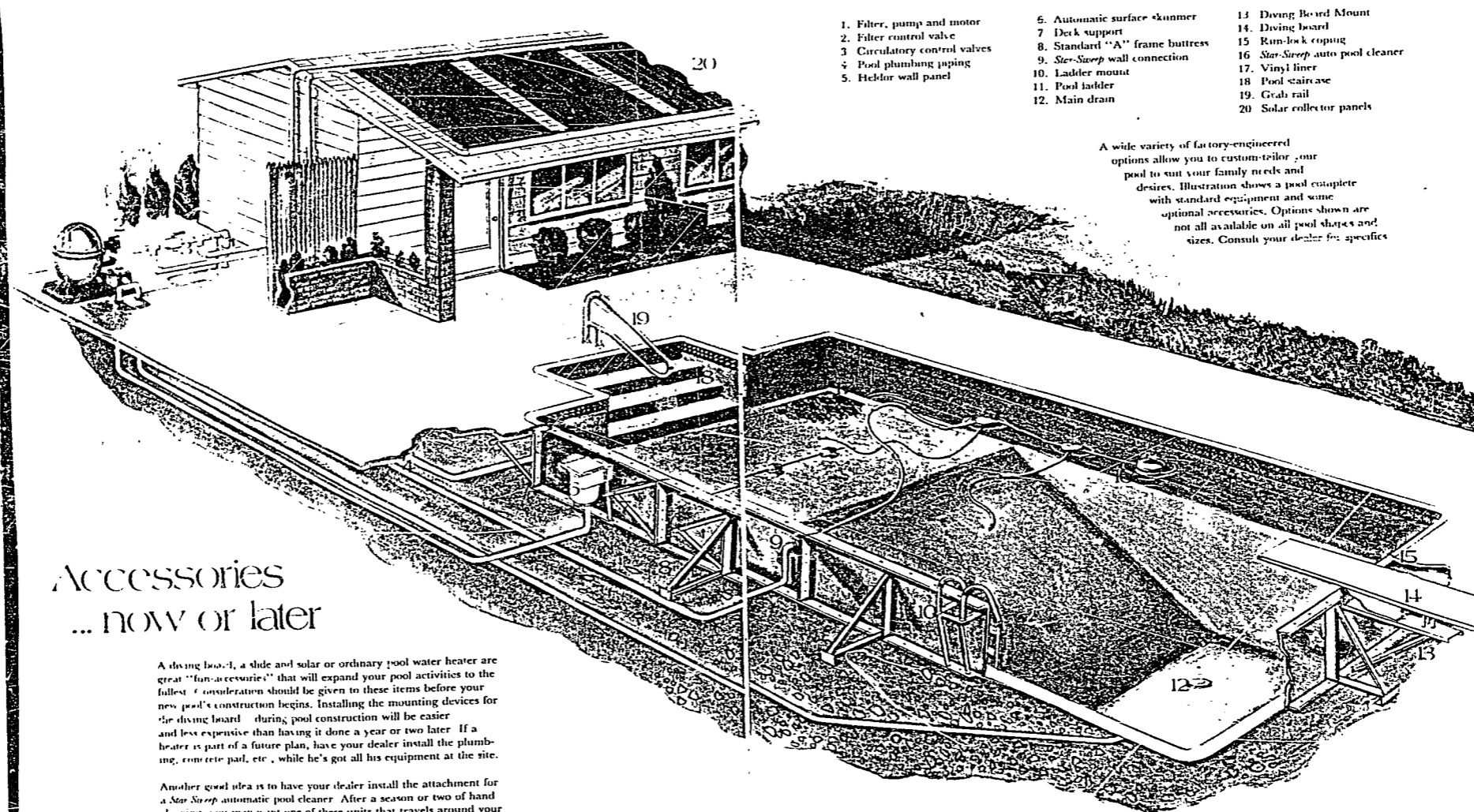

1. Filter, pump and motor
2. Filter control valve
3. Circulatory control valves
4. Pool plumbing piping
5. Heilor wall panel

6. Automatic surface skimmer
7. Deck support
8. Standard "A" frame buttress
9. *Star-Sweep* wall connection
10. Ladder mount
11. Pool ladder
12. Main drain

13. Diving Board Mount
14. Diving board
15. Run-lock coping
16. *Star-Sweep* auto pool cleaner
17. Vinyl liner
18. Pool staircase
19. Grab rail
20. Solar collector panels

A wide variety of factory-engineered options allow you to custom-tailor your pool to suit your family needs and desires. Illustration shows a pool complete with standard equipment and some optional accessories. Options shown are not all available on all pool shapes and sizes. Consult your dealer for specifics.

PERMIT # 325 CITY OF Portland BUILDING PERMIT APPLICATION

Please fill out any items which applies to job. Proper plans must accompany forms.

Owner: Anthony Napolitano  
 Address: 56 Bernard Rd Portland 791-742  
 LOCATION OF CONSTRUCTION 56 Bernard Rd  
 CONTRACTOR: Owner \_\_\_\_\_ SUBCONTRACTORS: \_\_\_\_\_  
 ADDRESS: \_\_\_\_\_

Est. Construction Cost 15,000 Type of Use: Two Car Garage  
 Past Use: \_\_\_\_\_  
 Building Dimensions L      W      Sq Ft      # Stories      Lot Size       
 Is Proposed Use: Seasonal \_\_\_\_\_ Condominium \_\_\_\_\_ Apartment \_\_\_\_\_  
 Conversion - Explain Construct two car garage, 22' x 28', attached

COMPLETE ONLY IF THE NUMBER OF UNITS WILL CHANGE EXISTING DWELLING  
 Residential Buildings Only:  
 # Of Existing Units \_\_\_\_\_ # Of New Dwelling Units \_\_\_\_\_

Foundation:  
 1. Type of Soil \_\_\_\_\_  
 2. Set Backs - Front \_\_\_\_\_ Rear \_\_\_\_\_ Side(s) \_\_\_\_\_  
 3. Footing Size \_\_\_\_\_  
 4. Foundation Size \_\_\_\_\_  
 5. Other \_\_\_\_\_

Roof:  
 1. Sill Size \_\_\_\_\_  
 2. Girder Size \_\_\_\_\_  
 3. Fully Column Spacing \_\_\_\_\_  
 4. Joist Size \_\_\_\_\_  
 5. Bracing Type \_\_\_\_\_  
 6. Floor Sheathing Type \_\_\_\_\_  
 7. Other Material \_\_\_\_\_

Exterior Walls:  
 1. Studding Size \_\_\_\_\_ Spacing \_\_\_\_\_  
 2. No. window \_\_\_\_\_  
 3. No. Doors \_\_\_\_\_  
 4. Header Sizes \_\_\_\_\_  
 5. Bracing: Yes \_\_\_\_\_ Spacing \_\_\_\_\_  
 6. Corner Posts Size \_\_\_\_\_  
 7. Insulation \_\_\_\_\_  
 8. Sheathing \_\_\_\_\_ Size \_\_\_\_\_  
 9. Siding Type \_\_\_\_\_  
 10. Masonry Material \_\_\_\_\_  
 11. Metal Material \_\_\_\_\_

Interior Walls:  
 1. Studding Size \_\_\_\_\_ Spacing \_\_\_\_\_  
 2. Header Sizes \_\_\_\_\_ Spacing \_\_\_\_\_  
 3. Wall Covering Type \_\_\_\_\_  
 4. Fire Wall if required \_\_\_\_\_  
 5. Other Materials \_\_\_\_\_

**For Official Use Only**

Date: APRIL 4, 1988 Subdivision: Yes  No   
 Inspector: Lynn Name: \_\_\_\_\_  
 Block Code: \_\_\_\_\_ Lot: \_\_\_\_\_  
 Title: \_\_\_\_\_ Block: \_\_\_\_\_  
 Estimated Cost: 15,000 Permit Expiration: \_\_\_\_\_  
 Value Structure: \_\_\_\_\_ Owner: \_\_\_\_\_  
 Year: 03

Ceiling:  
 1. Ceiling Joist Size \_\_\_\_\_  
 2. Ceiling Strapping Size \_\_\_\_\_  
 3. Type Ceiling: \_\_\_\_\_  
 4. Insulation Type \_\_\_\_\_  
 5. Ceiling Height \_\_\_\_\_

Roof:  
 1. Truss or Rafter Size \_\_\_\_\_  
 2. Slope \_\_\_\_\_  
 3. Roof Covering Type \_\_\_\_\_  
 4. Other \_\_\_\_\_

Chimneys:  
 1. \_\_\_\_\_ Number of \_\_\_\_\_

Heating:  
 1. Type of Heat: \_\_\_\_\_

Electrical:  
 1. Service Entrance Size \_\_\_\_\_  
 2. Smallest Conductor Required: Yes  No

Plumbing:  
 1. Approval of soil test if required: Yes  No   
 2. No. of Toilets or Sinks \_\_\_\_\_  
 3. No. of Flushes \_\_\_\_\_  
 4. No. of Lavatories \_\_\_\_\_  
 5. No. of Other Fixtures \_\_\_\_\_

Swimming Pools:  
 1. Type: \_\_\_\_\_  
 2. Pool Size: \_\_\_\_\_ Square Footage \_\_\_\_\_  
 3. Must conform to National Electrical Code and State Law

Zoning:  
 1. District: \_\_\_\_\_  
 2. Street Frontage: \_\_\_\_\_ Provided \_\_\_\_\_  
 3. Required Setbacks: Front \_\_\_\_\_ Side \_\_\_\_\_

Review:  
 1. Zoning Board Approval: Yes \_\_\_\_\_ No \_\_\_\_\_ Date: \_\_\_\_\_  
 2. Planning Board approval: Yes \_\_\_\_\_ No \_\_\_\_\_ Date: \_\_\_\_\_  
 3. Additional Uses: \_\_\_\_\_  
 4. Erosion and Floodplain Mgmt: \_\_\_\_\_  
 5. Other (Explain): \_\_\_\_\_  
 Date Approved: \_\_\_\_\_

Permit Received By: Lynne Bennett

Signature of Applicant: Anthony Napolitano Date: 4/4/88

Signature of CEO: Anthony Napolitano Date: \_\_\_\_\_

Inspection Dates: \_\_\_\_\_

White Tag Assessor

Yellow-CPGOG

White Tag -CEO

© Copyright GPCOG 1987

930237

\$25.00 Change of Use

Permit # 930237 City of Portland BUILDING PERMIT APPLICATION Fee \$50.00 Zone \_\_\_\_\_ Map # \_\_\_\_\_ Lot# \_\_\_\_\_

Please fill out any part which applies to job. Proper plans must accompany form.

Owner: Darlene Napolitano Phone # 797-7542

Address: 56 Bernard Rd. Portland, Maine 04103

LOCATION OF CONSTRUCTION 56 Bernard Rd.

Contractor: \_\_\_\_\_ Sub: \_\_\_\_\_

Address: \_\_\_\_\_ Phone # \_\_\_\_\_

Est. Construction Cost: \_\_\_\_\_ Proposed Use: Single family-day care Zoning: \_\_\_\_\_

\_\_\_\_\_ single fam. day care 8 12 children Past Use: \_\_\_\_\_

# of Existing Units \_\_\_\_\_ # of New Res. Units \_\_\_\_\_

Build'g Dimensions L \_\_\_\_\_ W \_\_\_\_\_ Total Sq. Ft. \_\_\_\_\_

# Stories: \_\_\_\_\_ # Bedrooms \_\_\_\_\_ Lot Size: \_\_\_\_\_

Is Proposed Use: Seasonal \_\_\_\_\_ Condominium \_\_\_\_\_ Conversion \_\_\_\_\_

Explain Conversion Change of Use Conditional Use Appeal \_\_\_\_\_

For Official Use Only	
Date: <u>February 16, 1993</u>	Subdivision: _____
Inside Fire Limits: <u>4-5-93</u>	Name: <u>APR-6-1993</u>
Bldg Code: _____	Lot: _____
Time Limit: _____	Ownership: _____
Estimated Cost: _____	Public _____
	Private _____

Street Frontage Provided: \_\_\_\_\_  
 Provided Setbacks: Front \_\_\_\_\_ Back \_\_\_\_\_ Side \_\_\_\_\_  
 Review Required:  
 Zoning Board Approval: Yes \_\_\_\_\_ No \_\_\_\_\_ Date: \_\_\_\_\_  
 Planning Board Approval: Yes \_\_\_\_\_ No \_\_\_\_\_ Date: \_\_\_\_\_  
 Conditional Use: \_\_\_\_\_ Variance \_\_\_\_\_ Site Plan \_\_\_\_\_ Subdivision \_\_\_\_\_  
 Shoreland Zoning Yes \_\_\_\_\_ No \_\_\_\_\_ Floodplain Yes \_\_\_\_\_ No \_\_\_\_\_  
 Special Exception \_\_\_\_\_  
 Other: WDA (Explain) 4-6-93

Foundation:  
 1. Type of Soil: \_\_\_\_\_  
 2. Set Backs - Front \_\_\_\_\_ Rear \_\_\_\_\_ Side(s) \_\_\_\_\_  
 3. Footings Size: \_\_\_\_\_  
 4. Foundation Size: \_\_\_\_\_  
 5. Other \_\_\_\_\_

Floor:  
 1. Sills Size: \_\_\_\_\_ Sills must be anchored.  
 2. Girder Size: \_\_\_\_\_  
 3. Lally Column Spacing: \_\_\_\_\_ Size: \_\_\_\_\_  
 4. Joists Size: \_\_\_\_\_ Spacing 16" O.C.  
 5. Bridging Type: \_\_\_\_\_ Size: \_\_\_\_\_  
 6. Floor Sheathing Type: \_\_\_\_\_ Size: \_\_\_\_\_  
 7. Other Material: \_\_\_\_\_

Exterior Walls:  
 1. Studding Size \_\_\_\_\_ Spacing \_\_\_\_\_  
 2. No. windows \_\_\_\_\_  
 3. No. Doors \_\_\_\_\_  
 4. Header Sizes \_\_\_\_\_ Span(s) \_\_\_\_\_  
 5. Bracing: Yes \_\_\_\_\_ No \_\_\_\_\_  
 6. Corner Posts Size \_\_\_\_\_  
 7. Insulation Type \_\_\_\_\_ Size \_\_\_\_\_  
 8. Sheathing Type \_\_\_\_\_ Size \_\_\_\_\_  
 9. Siding Type \_\_\_\_\_  
 10. Masonry Materials \_\_\_\_\_  
 11. Metal Materials \_\_\_\_\_

Interior Walls:  
 1. Studding Size \_\_\_\_\_ Spacing \_\_\_\_\_  
 2. Header Sizes \_\_\_\_\_ Span(s) \_\_\_\_\_  
 3. Wall Covering Type \_\_\_\_\_  
 4. Fire Wall if required \_\_\_\_\_  
 5. Other Materials \_\_\_\_\_

Ceiling:  
 1. Ceiling Joists Size: \_\_\_\_\_  
 2. Ceiling Strapping Size \_\_\_\_\_ Spacing \_\_\_\_\_  
 3. Type Ceilings: \_\_\_\_\_  
 4. Insulation Type \_\_\_\_\_ Size \_\_\_\_\_  
 5. Ceiling Height: \_\_\_\_\_

Roof:  
 1. Truss or Rafter Size \_\_\_\_\_ Span \_\_\_\_\_ Action: Approved  
 2. Sheathing Type \_\_\_\_\_ Size \_\_\_\_\_  
 3. Roof Covering Type \_\_\_\_\_  
 Approved with conditions

Chimneys:  
 Type: \_\_\_\_\_ Number of Fire Places \_\_\_\_\_ Date: 4/5/93

Heating:  
 Type of Heat: \_\_\_\_\_

Electrical:  
 Service Entrance Size: \_\_\_\_\_ Smoke Detector Required Yes \_\_\_\_\_ No \_\_\_\_\_

Plumbing:  
 1. Approval of soil test if required Yes \_\_\_\_\_ No \_\_\_\_\_  
 2. No. of Tubs or Showers \_\_\_\_\_  
 3. No. of Flushes \_\_\_\_\_  
 4. No. of Lavatories \_\_\_\_\_  
 5. No. of Other Fixtures \_\_\_\_\_

Swimming Pools:  
 1. Type: \_\_\_\_\_  
 2. Pool Size: \_\_\_\_\_ x \_\_\_\_\_ Square Footage \_\_\_\_\_  
 3. Must conform to National Electrical Code and State Law.

Permit Received By Latini

Signature of Applicant Darlene Napolitano Date 2/16/93

CEO's District Antoine Napolitano

CONTINUED TO REVERSE SIDE

White - Tax Assessor

Ivory Tag - CEO

MA CARROLL

APPROVAL AUTHORITY 3-26-93  
**PERMIT ISSUED WITH REQUIREMENTS**

**HISTORIC PRESERVATION**

**PERMIT ISSUED WITH REQUIREMENTS**

930237

\$25.00 Change of Use

Permit # \_\_\_\_\_ City of Portland BUILDING PERMIT APPLICATION Fee 50.00 Zone \_\_\_\_\_ Map # \_\_\_\_\_ Lot# \_\_\_\_\_

Please fill out any part which applies to job. Proper plans must accompany form.

Owner: Darlone Napoleano Phone # 797-7542

Address: 56 Bernard Rd. Portland, Maine 06403

LOCATION OF CONSTRUCTION 56 Bernard Rd

Contractor: \_\_\_\_\_ Sub: \_\_\_\_\_

Address: \_\_\_\_\_ Phone # \_\_\_\_\_

Est. Construction Cost: \_\_\_\_\_ Proposed Use: Single fam. day care / 12 children Zoning: \_\_\_\_\_

# of Existing Res. Units \_\_\_\_\_ # of New Res. Units \_\_\_\_\_

Building Dimensions L \_\_\_\_\_ W \_\_\_\_\_ Total Sq. Ft. \_\_\_\_\_

# Stories: \_\_\_\_\_ # Bedrooms \_\_\_\_\_ Lot Size: \_\_\_\_\_

Is Proposed Use: Seasonal \_\_\_\_\_ Condominium \_\_\_\_\_ Conversion \_\_\_\_\_

Explain Conversion Change of Use Conditional Use Anepal

**For Official Use Only**

Date: February 16, 1993 Subdivision: \_\_\_\_\_  
 Inside Fire Limits: \_\_\_\_\_ Name: APR-6-1993  
 Bldg Code: \_\_\_\_\_ Lot: \_\_\_\_\_  
 Time Limit: \_\_\_\_\_ Other: \_\_\_\_\_  
 Estimated Cost: \_\_\_\_\_

Street Frontage Provided: \_\_\_\_\_  
 Provided Setbacks: Front \_\_\_\_\_ Back \_\_\_\_\_ Side \_\_\_\_\_ Side \_\_\_\_\_

Review Required:  
 Zoning Board Approval: Yes \_\_\_\_\_ No \_\_\_\_\_ Date: \_\_\_\_\_  
 Planning Board Approval: Yes \_\_\_\_\_ No \_\_\_\_\_ Date: \_\_\_\_\_  
 Conditional Use: \_\_\_\_\_ Variance \_\_\_\_\_ Site Plan \_\_\_\_\_ Subdivision \_\_\_\_\_  
 Shoreland Zoning Yes \_\_\_\_\_ No \_\_\_\_\_ Floodplain: Yes \_\_\_\_\_ No \_\_\_\_\_  
 Special Exception \_\_\_\_\_  
 Other: WHA-4-6-93 (Explain)

**Foundation:**

- Type of Soil: \_\_\_\_\_
- Set Backs - Front \_\_\_\_\_ Rear \_\_\_\_\_ Side(s) \_\_\_\_\_
- Footings Size: \_\_\_\_\_
- Foundation Size: \_\_\_\_\_
- Other: \_\_\_\_\_

**Floor:**

- Sills Size: \_\_\_\_\_ Sills must be anchored.
- Girder Size: \_\_\_\_\_
- Lally Column Spacing: \_\_\_\_\_ Size: \_\_\_\_\_
- Joists Size: \_\_\_\_\_ Spacing 16" O.C.
- Bridging Type: \_\_\_\_\_ Size: \_\_\_\_\_
- Floor Sheathing Type: \_\_\_\_\_ Size: \_\_\_\_\_
- Other Material: \_\_\_\_\_

**Exterior Walls:**

- Studding Size \_\_\_\_\_ Spacing \_\_\_\_\_
- No. windows \_\_\_\_\_
- No. Doors \_\_\_\_\_
- Header Sizes \_\_\_\_\_ Span(s) \_\_\_\_\_
- Bracing: Yes \_\_\_\_\_
- Corner Posts Size \_\_\_\_\_
- Insulation Type \_\_\_\_\_ Size \_\_\_\_\_
- Sheathing Type \_\_\_\_\_ Size \_\_\_\_\_
- Siding Type \_\_\_\_\_ Weather Exposure \_\_\_\_\_
- Masonry Materials \_\_\_\_\_
- Metal Materials \_\_\_\_\_

**Interior Walls:**

- Studding Size \_\_\_\_\_ Spacing \_\_\_\_\_
- Header Sizes \_\_\_\_\_ Span(s) \_\_\_\_\_
- Wall Covering type \_\_\_\_\_
- Fire Wall if required \_\_\_\_\_
- Other Materials \_\_\_\_\_

**Ceiling:**

- Ceiling Joists Size: \_\_\_\_\_
- Ceiling Strapping Size \_\_\_\_\_ Spacing \_\_\_\_\_ Not in District nor Landmark
- Type Ceilings: \_\_\_\_\_ Does not require review
- Insulation Type: \_\_\_\_\_ Size \_\_\_\_\_ Requires review
- Ceiling Height: \_\_\_\_\_

**Roof:**

- Truss or Rafter Size: \_\_\_\_\_ Span Action: Approved
- Sheathing Type: \_\_\_\_\_ Size: \_\_\_\_\_ Approved with Conditions
- Roof Covering Type: \_\_\_\_\_ Date: 4-15-93

**Chimneys:** Type: \_\_\_\_\_ Number of Fire Places \_\_\_\_\_

**Heating:** Type of Heat: \_\_\_\_\_

**Electrical:** Service Entrance Size: \_\_\_\_\_ Smoke Detector Required: Yes \_\_\_\_\_ No \_\_\_\_\_

**Plumbing:**

- Approval of soil test if required: Yes \_\_\_\_\_ No \_\_\_\_\_
- No. of Tubs or Showers: \_\_\_\_\_
- No. of Flushes: \_\_\_\_\_
- No. of Lavatories: \_\_\_\_\_
- No. of Other Fixtures: \_\_\_\_\_

**Swimming Pools:**

- Type: \_\_\_\_\_
- Pool Size: \_\_\_\_\_ PERMIT ISSUED WITH REQUIREMENTS Square Footage \_\_\_\_\_
- Must conform with \_\_\_\_\_ Set / Law \_\_\_\_\_

Permit Received By Latini

Signature of Applicant Darlone Napoleano Date 2/16/93

CEO's District 4 Anthony Napoleano

CONTINUED TO REVERSE SIDE

Ivory Tag - CEO [Signature]

White - Tax Assessor

**PERMIT ISSUED WITH REQUIREMENTS**

**HISTORIC PRESERVATION**

