

437-C-59 Bernard Rd.

APPLICATION FOR PERMIT

PERMIT ISSUED

B.O.C.A. USE GROUP .....
B.O.C.A. TYPE OF CONSTRUCTION ..... 00769
ZONING LOCATION ..... PORTLAND, MAINE July 25, 1983

JUL 24 1983

CITY OF PORTLAND

To the CHIEF OF BUILDING & INSPECTION SERVICES, PORTLAND, MAINE

The undersigned hereby applies for a permit to erect, alter, repair, demolish, move or install the following building, structure, equipment or change use in accordance with the Laws of the State of Maine, the Portland B.O.C.A. Building Code and Zoning Ordinance of the City of Portland with plans and specifications, if any, submitted herewith and the following specifications:

LOCATION 437-C-59 Burnard Road Fire District #1 #2
1. Owner's name and address Anthony J. Napolitano - 6 Samuel Rd., Portland Telephone 797-3633
2. Lessee's name and address 04103 Telephone
3. Contractor's name and address owner Telephone
Proposed use of building No. of sheets
Last use No. families
Material No. stories Heat Style of roof Roofing
Other buildings on same lot
Estimated contractual cost \$ 45,000.00

FIELD INSPECTOR—Mr. 15,000 @ 775-5451
Appeal Fees \$
Base Fee
Late Fee
TOTAL \$ 235.00
75.00

To construct single family home (Colonial), 26' x 70', no garage, as per plans.

Stamp of Special Conditions

NOTE TO APPLICANT: Separate permits are required by the installers and subcontractors of heating, plumbing, electrical and mechanicals

DETAILS OF NEW WORK

Is any plumbing involved in this work? yes Is any electrical work involved in this work? yes
Is connection to be made to public sewer? yes If not, what is proposed for sewage?
Has septic tank notice been sent? Form notice sent?
Height average grade to top of plate. Height average grade to highest point of roof
Size, front depth No. stories solid or filled land? earth or rock?
Material of foundation Thickness, top bottom cellar
Kind of roof Rise per foot Roof covering
No. of chimneys Material of chimneys of lining Kind of heat fuel
Framing Lumber—Kind Dressed or full size? Corner posts Sills
Size Girder Columns under girders Size Max. on centers
Studs (outside walls and carrying partitions) 2x4-16" O. C. Bridging in every floor and flat roof span over 8 feet.
Joists and rafters: 1st floor 2nd 3rd roof
On centers: 1st floor 2nd 3rd roof
Maximum span: 1st floor 2nd 3rd roof
If one story building with masonry walls, thickness of walls? height?

IF A GARAGE

No. cars now accommodated on same lot, to be accommodated number commercial cars to be accommodated
Will automobile repairing be done other than minor repairs to cars habitually stored in the proposed building?

APPROVALS BY: DATE MISCELLANEOUS
BUILDING INSPECTION—PLAN EXAMINER Will work require disturbing of any tree on a public street?
ZONING:
BUILDING CODE: Will there be in charge of the above work a person competent to see that the State and City requirements pertaining thereto are observed?
Fire Dept.:
Health Dept.:
Others:

Signature of Applicant Anthony J. Napolitano Phone # same
Type Name of above Anthony J. Napolitano 1 2 3 4

9

FIELD INSPECTOR'S COPY APPLICANT'S COPY OFFICE FILE COPY

**PLUMBING APPLICATION**

Department of Human Services  
Division of Health Engineering  
(207) 289-3826

**PROPERTY ADDRESS**  
Town/City/Plantation: Portland  
Street: 437-C-59 Bernard Rd.  
Subdivision Lot # 437-C-59 Bernard Rd.

**PROPERTY OWNERS NAME**  
Last: Nassolton First: Anthony

Applicant Name: John D'Brion

Mailing Address of Owner/Applicant (if Different): Hearns Rd. Scarborough, Me. 04072

0176 PORTLAND \*\*\* 05170 \*\*\*

Date Permit Issued: 10/11/83 \$ 42 FEE  Double Charged

L.P.I. # 123

Local Plumbing Inspector Signature: \_\_\_\_\_

**Owner/Applicant Statement**  
I certify that the information submitted is correct to the best of my knowledge and understand that any falsification is reason for the Local Plumbing Inspector to deny a permit.  
[Signature] / Signature of Owner/Applicant Date: 10/11/83

**Caution: Inspection Required**  
I have inspected the installation authorized above and found it to be in compliance with the Maine Plumbing Rules.  
[Signature] / Local Plumbing Inspector Signature Date Approved: NOV 27 1983

**PERMIT INFORMATION**

<b>This Application is for</b> 1. <input checked="" type="checkbox"/> NEW PLUMBING 2. <input type="checkbox"/> RELOCATED PLUMBING OCT 17 1983 DEC 8 - 1983	<b>Type Of Structure To Be Served:</b> 1. <input checked="" type="checkbox"/> SINGLE FAMILY DWELLING 2. <input type="checkbox"/> MODULAR OR MOBILE HOME 3. <input type="checkbox"/> MULTIPLE FAMILY DWELLING 4. <input type="checkbox"/> OTHER - SPECIFY: _____	<b>Plumbing To Be Installed By:</b> 1. <input checked="" type="checkbox"/> MASTER PLUMBER 2. <input type="checkbox"/> OIL BURNERMAN 3. <input type="checkbox"/> MFG'D. HOUSING DEALER/MECHANIC 4. <input type="checkbox"/> PUBLIC UTILITY EMPLOYEE 5. <input type="checkbox"/> PROPERTY OWNER LICENSE # <u>19511</u>
--	---	--

Number	Hook-Ups And Piping Relocation	Number	Column 2 Type Of Fixture	Number	Column 1 Type Of Fixture
	HOOK-UP: to public sewer in those cases where the connection is not regulated and inspected by the local Sanitary District.		Hosebibb / Sillcock	3	Bathtub (and Shower)
			Floor Drain		Shower (Separate)
			Urinal	1	Sink
	HOOK-UP: to an existing subsurface wastewater disposal system.		Drinking Fountain	3	Wash Basin
			Indirect Waste	4	Water Closet (Toilet)
			Water Treatment Softener, Filter, etc.	2	Clothes Washer
	PIPING RELOCATION: of sanitary lines, drains, and piping without new fixtures.		Grease/Oil Separator	1	Dish Washer
			Dental Cuspidor	1	Garbage Disposal
			Bidet		Laundry Tub
	Hook-Ups (Subtotal)		Other: _____	1	Water Heater
\$	Hook-Up Fee		Fixtures (Subtotal) Column 2		Fixtures (Subtotal) Column 1
			SEE PERMIT FEE SCHEDULE FOR CALCULATING FEE		Fixtures (Subtotal) Column 2
				16	Total Fixtures
				\$ 42.	Fixture Fee
				\$	Hook-Up Fee
				\$ 42.	Permit Fee (Total)

TOWN COPY

437-C-59    Bernard Rd.

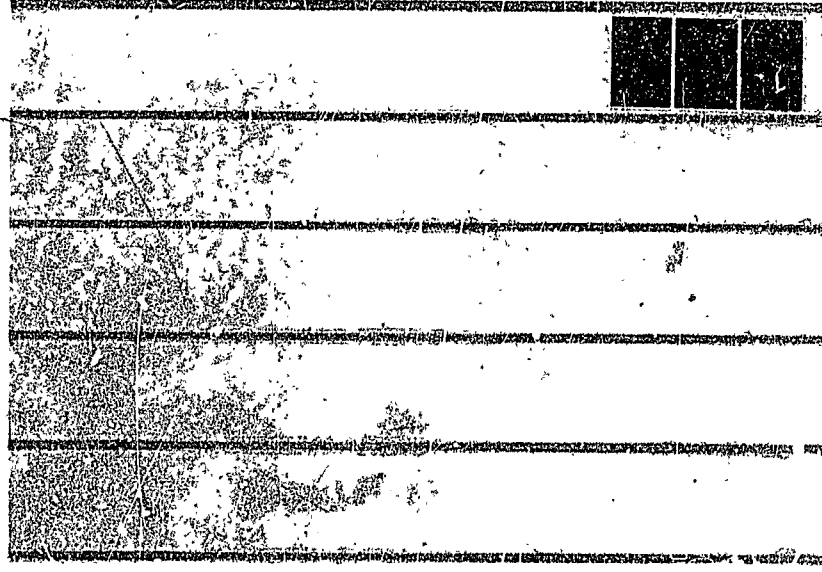

CITY OF PORTLAND, MAINE  
Department of Building Inspection



# Certificate of Occupancy

LOCATION 437-C-59 Bernard Road

Date of Issue May 4, 1984

Issued to Anthony Napolitano

This is to certify that the building, premises, or part thereof, at the above location, built—altered—changed as to use under Building Permit No. 83-769, has had final inspection, has been found to conform substantially to requirements of Zoning Ordinance and Building Code of the City, and is hereby approved for occupancy or use, limited or otherwise, as indicated below.

PORTION OF BUILDING OR PREMISES

APPROVED OCCUPANCY

Single Family Dwelling

Entire

Limiting Conditions:

This certificate supersedes certificate issued

Approved: *[Signature]*  
Inspector

(Date)

*[Signature]*  
Inspector of Buildings

*[Signature]*  
Asst. Chief of Insp. Services

Notice: This certificate identifies lawful use of building or premises, and ought to be transferred from owner to owner when property changes hands. Copy will be furnished to owner or lessee for one dollar.



Applicant: ANTHONY J. NARDITANO Date: 7/27/83  
Address: BERNARD RD.  
Assessors No.: 434-C-55

CHECK LIST AGAINST ZONING ORDINANCE

- Date - NEW
- Zone Location - R-3
- Interior ~~or~~ corner lot -  
40 ft. setback area (Section 21) -
- Use - 26' X 70' DWELLING
- Sewage Disposal PUBLIC
- Rear Yards - 49' - 25' MIN.
- Side Yards - 14' - 14' Z - 14' - 14' MIN.
- Front Yards - 25' - 25' MIN.
- Projections - NONE
- Height - TWO STORY
- Lot Area - 24,900<sup>sq</sup> - 6500<sup>sq</sup> MIN. 50x88  
100x205
- Building Area - 1850<sup>sq</sup> - 6225<sup>sq</sup> MAX. 4410
- Area per Family - 24,900<sup>sq</sup> - 6500<sup>sq</sup> MIN. 30500  
24900
- Width of Lot - 200' Z - 65' MIN. 249
- Lot Frontage 50' - 50' MIN.
- Off-street Parking - YES
- loading Bays -
- Site Plan -
- Shoreland Zoning -
- Flood Plains -

APPLICATION FOR PERMIT

B.O.C.A. USE GROUP .....
B.O.C.A. TYPE OF CONSTRUCTION ..... 00769
ZONING LOCATION ... R-3 ... PORTLAND, MAINE July 25, 1983

PERMIT ISSUED

JUL 27 1983

CITY OF PORTLAND

To the CHIEF OF BUILDING & INSPECTION SERVICES, PORTLAND, MAINE

The undersigned hereby applies for a permit to erect, alter, repair, demolish, move or install the following building, structure, equipment or change use in accordance with the Laws of the State of Maine, the Portland B.O.C.A. Building Code and Zoning Ordinance of the City of Portland with plans and specifications, if any, submitted herewith and the following specifications:

LOCATION 437-C-59 Bernard Road Fire District #1 [ ] #2 [ ]
1. Owner's name and address Anthony J. Napolitano, 6 Samuel Bt., Portland Telephone 797-3623
2. Lessee's name and address Telephone 04103
3. Contractor's name and address owner Telephone

Proposed use of building No. of sheets
Last use No. families
Material No. stories Heat Style of roof Roofing
Other buildings on same lot

Estimated contractual cost \$ 45,000.00 Appeal Fees \$
FIELD INSPECTOR—Mr. 15,000 Base Fee
@ 775-5451 Late Fee

To construct single family home (Colonial), 26' x 70', no garage, as per plans.

TOTAL \$ 235.00
75.00

Stamp of Special Conditions

NOTE TO APPLICANT: Separate permits are required by the installers and subcontractors of heating, plumbing, electrical and mechanicals.

DETAILS OF NEW WORK

Is any plumbing involved in this work? ... YES ... Is any electrical work involved in this work? ... YES ...
Is connection to be made to public sewer? ... YES ... If not, what is proposed for sewage?
Has septic tank notice been sent? ... Form notice sent?
Height average grade to top of plate ... Height average grade to highest point of roof
Size, front ... depth ... No. stories ... solid or filled land? ... earth or rock?
Material of foundation ... Thickness, top ... bottom ... cellar
Kind of roof ... Rise per foot ... Roof covering
No. of chimneys ... Material of chimneys ... of lining ... Kind of heat ... fuel
Framing Lumber- Kind ... Dressed or full size? ... Corner posts ... Sills
Size Girder ... Columns under girders ... Size ... Max. on centers
Studs (outside walls and carrying partitions) 2x4-16" O. C. Bridging in every floor and flat roof span over 8 feet.
Joists and rafters: 1st floor ... 2nd ... 3rd ... roof
On centers: 1st floor ... 2nd ... 3rd ... roof
Maximum span: 1st floor ... 2nd ... 3rd ... roof
If one story building with masonry walls, thickness of walls? ... height?

IF A GARAGE

No. cars now accommodated on same lot ... to be accommodated ... number commercial cars to be accommodated
Will automobile repairing be done other than minor repairs to cars habitually stored in the proposed building?

APPROVALS BY: DATE

BUILDING INSPECTION—PLAN EXAMINER
ZONING: R. L. ... 7/21/83
BUILDING CODE: ... 4/27/84
Fire Dept.:
Health Dept.:
Others:

MISCELLANEOUS

Will work require disturbing of any tree on a public street?
Will there be in charge of the above work a person competent to see that the State and City requirements pertaining thereto are observed?

Signature of Applicant [Signature] Phone # same

Type Name of above ... Anthony J. Napolitano ... 1 [ ] 2 [ ] 3 [ ] 4 [ ]
Other and Address

FIELD INSPECTOR'S COPY APPLICANT'S COPY OFFICE FILE COPY

[Handwritten signature]

REF 1224  
LWAF-HWSD

Permit No. 83/759  
 Location 437 C-59 Demand Board  
 Owner Anthony Napolitano  
 Date of permit 7-25-83  
 Approved 7-27-83  
 Dwelling single family  
 Garage \_\_\_\_\_

Alteration

NOTES

1. 2. Framing Appt. NOT KEPT BY  
 CONTRACTOR. FRAMING ALREADY COMPLETED.  
 10-17 FRAMING INSPECTION DONE.  
 1. DATE CLOSING IN OR PENDING ELEC.  
 2. RUMB INSPECTION DONE.  
 3. NO ONE HERE TO CHECK ON  
 COMPLETED WORK.  
 4-26 FINAL INSPECTION DONE.  
 COL TO BE SENT TO



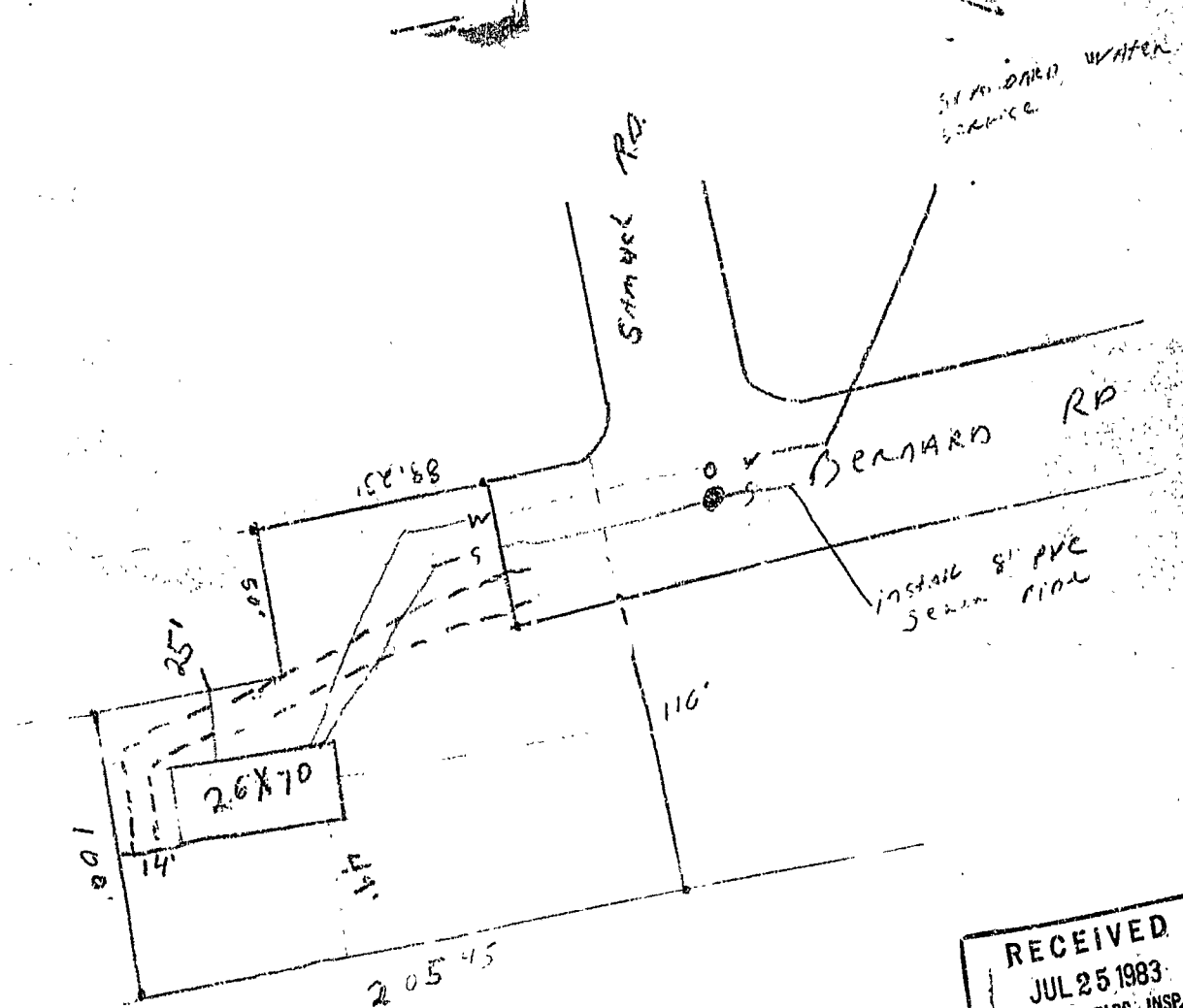

RECEIVED  
 JUL 25 1983  
 DEPT. OF BLDG. INSP.  
 CITY OF PORTLAND