

9-15 KENDALL STREET



APPLICATION FOR PERMIT
DEPARTMENT OF BUILDING INSPECTIONS SERVICES
ELECTRICAL INSTALLATIONS

Date April 8, 1982
 Receipt and Permit number A77601

To the CHIEF ELECTRICAL INSPECTOR, Portland, Maine:

The undersigned hereby applies for a permit to make electrical installations in accordance with the laws of Maine, the Portland Electrical Ordinance, the National Electrical Code and the following specifications:

LOCATION OF WORK: 11 Kendall St.
 OWNER'S NAME: Marlene Small ADDRESS: lives there

	FEES
OUTLETS.	
Receptacles _____ Switches _____ Plugmold _____ ft. TOTAL _____	
FIXTURES (number of)	
Incandescent _____ Fluorescent _____ (not strip) TOTAL _____	
Strip Fluorescent _____ ft. _____	
SERVICES.	
Overhead _____ Underground _____ Temporary _____ TOTAL amperes _____	
METERS (number of) _____	
MOTORS (number of)	
Fractional _____	
1 HP or over _____	
RESIDENTIAL HEATING	
Oil or Gas (number of units) _____	
Electric (number of rooms) _____	
COMMERCIAL OR INDUSTRIAL HEATING:	
Oil or Gas (by a main boiler) _____	
Oil or Gas (by separate units) _____	
Electric Under 20 kws _____ Over 20 kws _____	
APPLIANCES: (number of)	
Ranges _____ Water Heaters _____	
Cook Tops _____ Disposals _____	
Wall Ovens _____ Dishwashers _____	
Dryers _____ Compactors _____	
Fans _____ Others (denote) _____	
TOTAL _____	
MISCELLANEOUS. (number of)	
Branch Panels _____	
Transformers _____	
Air Conditioners Central Unit _____	
Separate Units (windows) _____	
Signs 20 sq ft and under _____	
Over 20 sq ft. _____	
Swimming Pools Above Ground _____	
In Ground _____	
Fire/Burglar Alarms Residential _____	
Commercial _____	
Heavy Duty Outlets, 220 Volt (such as welders) 30 amps and under _____	
over 30 amps _____	
Circus, Fairs, etc. _____	
Alterations to wires <u>xx</u> moving meter _____	2.00
Repairs after fire _____	
Emergency Lights, battery _____	
Emergency Generators _____	
FOR ADDITIONAL WORK NOT ON ORIGINAL PERMIT	INSTALLATION FEE DUE:
FOR REMOVAL OF A "STOP ORDER" (304-16.b)	DOUBLE FEE DUE:
	TOTAL AMOUNT DUE:
	3.00

INSPECTION: Will be ready on _____, 19__; or Will Call _____

CONTRACTOR'S NAME: Hannans Electric

ADDRESS: Hand Hannans Electric 57 Lawn Ave. So. Portland

MASTER LICENSE NO.: 2885 SIGNATURE OF CONTRACTOR: R. Larry Hannans

LIMITED LICENSE NO.: _____

INSPECTOR'S COPY — WHITE
 OFFICE COPY — CANARY
 CONTRACTOR'S COPY — GREEN



FILL IN AND SIGN WITH INK
**APPLICATION FOR PERMIT FOR
 HEATING, COOKING OR POWER EQUIPMENT**

Portland, Maine, February 12, 1947

PERMIT ISSUED
 002335
 FEB 12 1947

To the INSPECTOR OF BUILDINGS, PORTLAND, ME.

The undersigned hereby applies for a permit to install the following heating, cooking or power equipment in accordance with the Laws of Maine, the Building Code of the City of Portland, and the following specifications:

Location . 11 Kendall Street Use of Building . Dwelling No. Stories New Building
 Existing " Existing "
 Name and address of owner of appliance . A. C. Anderson, 11 Kendall Street
 Installer's name and address . A. E. Moody, 179 Auburn St. Telephone 2-772

General Description of Work

To install . oil burning equipment in connection with existing steam heat

IF HEATER, OR POWER BOILER

Location of appliance or source of heat Type of floor beneath appliance
 If wood, how protected? Kind of fuel
 Minimum distance to wood or combustible material, from top of appliance or casing top of furnace
 From top of smoke pipe From front of appliance From sides or back of appliance
 Size of chimney flue Other connections to same flue
 If gas fired, how vented? Rated maximum demand per hour

IF OIL BURNER

Name and type of burner . . . Petro Labelled by underwriters' laboratories? yes . . .
 Will operator be always in attendance? Does oil supply line feed from top or bottom of tank? bottom . . .
 Type of floor beneath burner concrete
 Location of oil storage basement Number and capacity of tanks . . . 1-275 gal.
 If two 275-gallon tanks, will three-way valve be provided?
 Will all tanks be more than five feet from any flame? yes How many tanks fire proofed?
 Total capacity of any existing storage tanks for furnace burners? none

IF COOKING APPLIANCE

Location of appliance Kind of fuel Type of floor beneath appliance
 If wood, how protected?
 Minimum distance to wood or combustible material from top of appliance
 From front of appliance From sides and back From top of smokepipe
 Size of chimney flue Other connections to same flue
 Is hood to be provided? If so, how vented?
 If gas fired, how vented? Rated maximum demand per hour

MISCELLANEOUS EQUIPMENT OR SPECIAL INFORMATION

Amount of fee enclosed? . . 1.00 . . (\$1.00 for one heater, etc., 50 cents additional for each additional heater, etc., in same building at same time.)

APPROVED:

AK 2-12-47 J.F.M.

Will there be in charge of the above work a person competent to see that the State and City requirements pertaining thereto are observed? Yes . . .

Signature of Installer

A.E. Moody

INSPECTION COPY

Permit No. 47/233

Location / Kendallville

Owner A.C. Anderson

Date of permit 2/12/42

Approved B-15-41 (D) 1/16

NOTES

1 Fill Pipe

2 Vent Pipe

3 Kind of Rest

4 Diameter Insulation

5 Name of Label

6 Stock Control

7 High Limit Control

8 Remote Control

9 Piping Support & Protection

10 Valves to Safety Limit

11 Orally Checked

12 Test for Safety

13 Leak Test

14 Oil Gauge

15 Instruction Card

16

Page

INQUIRY BLANK

ZONE RC
FIRE DIST. No

P.H.
ATH
Gut
GWT
RMW
RJS
ES

CITY OF PORTLAND, MAINE
DEPARTMENT OF BUILDING INSPECTION

Verbal
By-Telephone-

DATE 11/22/44

LOCATION 11 Kendall Street OWNER Agge C. Andersen
MADE BY R. M. Thibodeau for Agge Andersen TEL. _____
ADDRESS 11 Kendall Street

PRESENT USE OF BUILDING _____

CLASS OF CONSTRUCTION _____ NO. OF STORIES _____

REMARKS: _____

INQUIRY: Is a permit needed for the erection on the beach near this location of a shed about 16' wide by 40' long to provide a shelter for and space for working on a boat now hauled out on a cradle?

Apparently there is a dwelling ~~with~~ ^{near} the boat + cradle - ~~there~~ ^{or yard}

ANSWER: Yes, a permit is required, and since the location is in an R.C. zone, this is not permissible if it is located on a lot not occupied by a dwelling and since a boat house is not a use customarily incidental to a dwelling house, we could not give a permit for its erection on lot with dwelling-house.

DATE OF REPLY 11/22/44

REPLY BY AGS



FILL IN COMPLETELY AND SIGN WITH INK

PERMIT ISS

APPLICATION FOR PERMIT FOR HEATING, COOKING OR POWER EQUIPMENT.

MAY 22 1939

Portland, Maine, May 22, 1939

To the INSPECTOR OF BUILDINGS, PORTLAND, ME.

The undersigned hereby applies for a permit to install the following heating, cooling or power equipment in accordance with the Laws of Maine, the Building Code of the City of Portland, and the following specifications:

Location 9-15 Kendall Street Use of Building dwelling No. Stories 1 1/2 New Building
Name and address of owner of appliance Aaga E. Anderson 54 Vesuvius Street
Installer's name and address A. E. Moody, 471 Auburn St. Telephone 2-0072

General Description of Work

To install steam heating system

IF HEATER, POWER BOILER OR COOKING DEVICE

Is appliance or source of heat to be in cellar? yes If not, which story Kind of Fuel coal
Material of supports of appliance (concrete floor or what kind) concrete
Minimum distance to wood or combustible material, from top of appliance or casing top of furnace, 15"
from top of smoke pipe 15" from front of appliance over 4" from sides or back of appliance over 4"
Size of chimney flue 8x12 Other connections to same flue stove

IF OIL BURNER

Name and type of burner Labeled and approved by Underwriters' Laboratories?
Will operator be always in attendance? Type of oil feed (gravity or pressure)
Location oil storage No. and capacity of tanks
Will all tanks be more than seven feet from any flame? How many tanks fireproofed?

Amount of fee enclosed? 1.00 (\$1.00 for one heater, etc., 50 cents additional for each additional heater, etc., in same building at same time.)

Signature of Installer

INSPECTION COPY

44032

371454

Permit No. 39/659

Location 9-15 Kendall St.

Owner Page C. Andersen

Date of Permit 5/22/39

Post Card sent

Notif. for inspu.

Approval Tag issued 8/21/39

Oil Burner Check List (date)

1. Kind of heat
2. Label
3. Anti siphon
4. Oil storage
5. Tank distance
6. Vent Pipe
7. Fill Pipe
8. Gauge
9. Rigid
10. Fuel tank
11. Pipe sizes and material
12. Control valve
13. Ash pit vent
14. Temp. or pressure safety
15. Instruction card
- 16.

NOTES

CASCO BAY

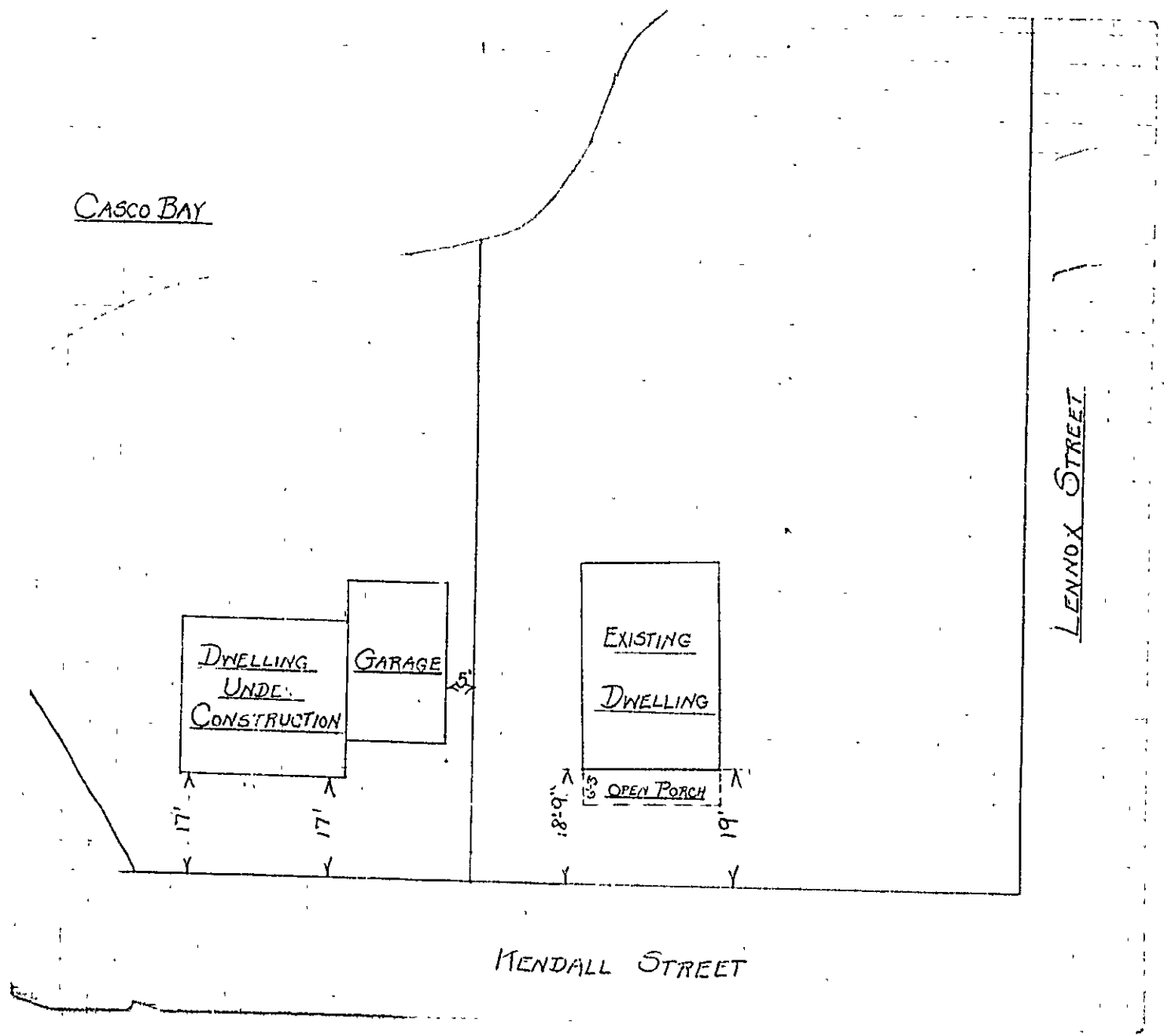

MENDALL STREET

LENNOX STREET

$\frac{1}{6}$ in to Ft.
4 ft to each
sp.
Water

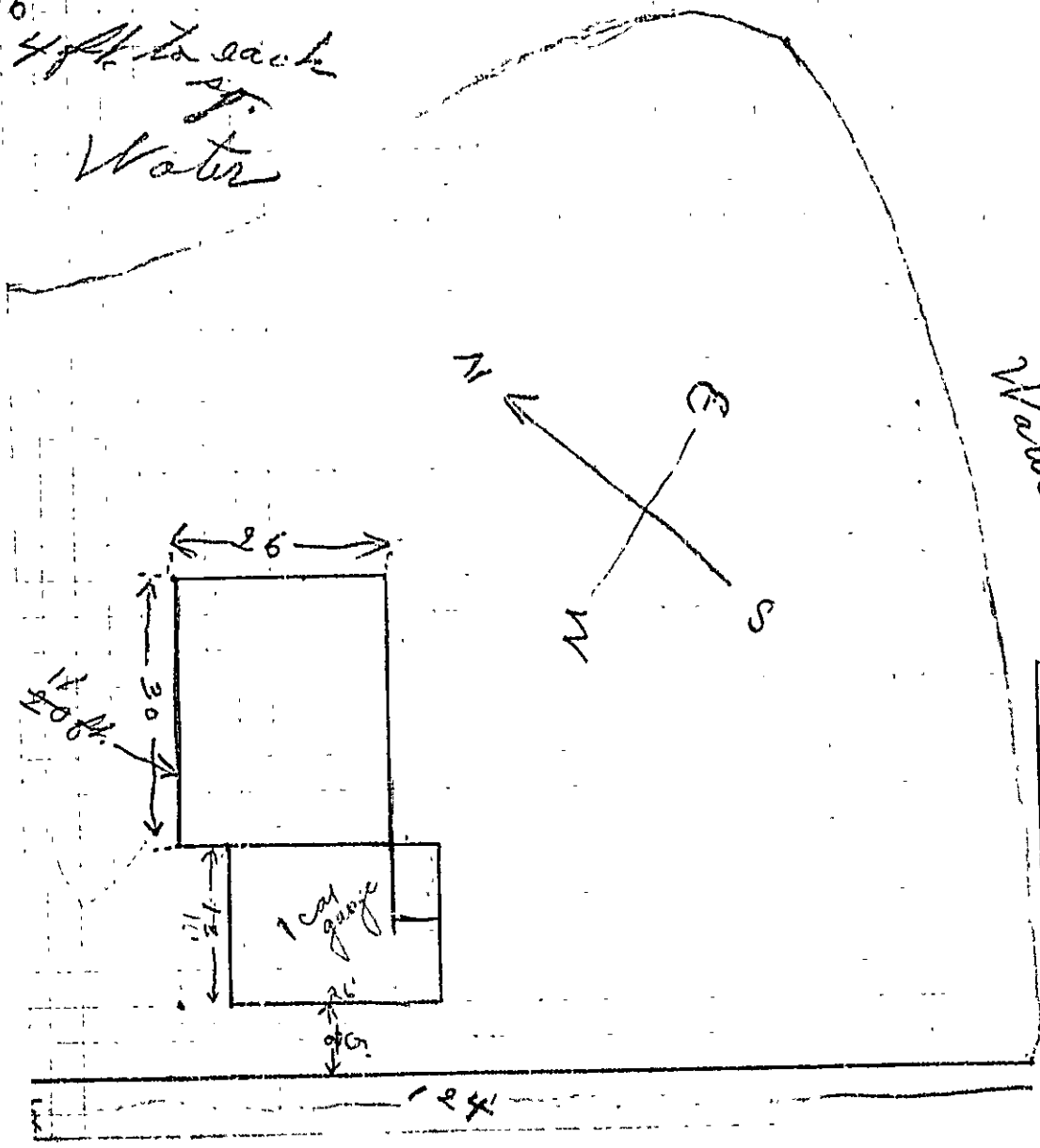

RECEIVED
APR 5 1939
DEPT. OF BLD'G. INSP.
CITY OF PORTLAND

1
2
3
4
5
6
7
8
9
10
11
12
13
14
15
16
17
18
19
20
21
22
23
24
25
26
27
28
29
30
31
32
33
34
35
36
37
38
39
40
41
42
43
44
45
46
47
48
49
50
51
52
53
54
55
56
57
58
59
60
61
62
63
64
65
66
67
68
69
70
71
72
73
74
75
76
77
78
79
80
81
82
83
84
85
86
87
88
89
90
91
92
93
94
95
96
97
98
99
100

STATEMENT ACCOMPANYING APPLICATION FOR BUILDING PERMIT

for one-family dwelling house with garage attached
at 9-15 Kendall Street

Date 4/5/39

1. In whose name is the title of the property now recorded? Page P. Anderson
2. Are the boundaries of the property in the vicinity of the proposed work shown clearly on the ground, and how? _____
3. Is the outline of the proposed work now staked out upon the ground? yes. If not, will you notify the Inspection Office when the work is staked out and before any of the work is commenced? _____
4. What is to be maximum projection or overhang of eaves or drip? dwg. 6"
part. 6"
5. Do you assume full responsibility for the correctness of the location plan or statement of location filed with this application, and does it show the complete outline of the proposed work on the ground, including bay windows, porches, and other projections? yes
6. Do you assume full responsibility for the correctness of all statements in the application concerning the sizes, design and use of the proposed building? yes
7. Do you understand that in case changes are proposed in the location of the work or in any of the details specified in the application that a revised plan and application must be submitted to this office before the changes are made? yes

Page P. Anderson



GENERAL RESIDENCE ZONE
APPLICATION FOR PERMIT

PERMIT ISSUED
9354

Class of Building or Type of Structure Third Class

APR 25 1939

Portland, Maine, April 5, 1939

To the INSPECTOR OF BUILDINGS, PORTLAND, ME.

The undersigned hereby applies for a permit to erect alter install the following building structure equipment in accordance with the Laws of the State of Maine, the Building Code of the City of Portland, plans and specifications, if any, submitted herewith and the following specifications:

Location 15 Kendall Street Within Fire Limits? no Dist. No. _____
 Owner's or Lessee's name and address Raymond C. Anderson, 51 Verona St. Telephone 3-2871
 Contractor's name and address _____ Telephone no
 Architect _____ Plans filed 702 No. of sheets 1
 Proposed use of building dwelling house with 1 car garage attached No. families 1
 Other buildings on same lot _____
 Estimated cost \$ 3300. Ger. Fee \$ 1.25 81.75

Description of Present Building to be Altered

Material _____ No. stories _____ Heat _____ Style of roof _____ Roofing _____
 Last use _____ No. families _____

General Description of New Work

To erect one family dwelling house with 1 car garage attached

The concrete foundation walls will extend at least four feet below the final finished grade of the ground unless ledge is encountered at a less depth in which case the wall will rest on the ledge. Forms will be used on both sides of the wall. The concrete is to be deposited directly upon the original soil or ledge at the bottom of the form without loose stone or anything else being filled in first

4/6/39 PRELIMINARY PERMIT GIVEN TO EXCAVATE ONLY.

The inside of the garage will be covered, where required by law, with metal lath and plaster

Full Don Statement with Permit

It is understood that this permit does not include installation of heating apparatus which is to be taken out separately by and in the name of the heating contractor.

Details of New Work

Size, front 48' depth 26' No. stories 1 1/2 Height average grade to top of plate 8'
 Height average grade to highest point of roof 21'
 To be erected on solid or filled land? earth earth or rock? solid possibly ledge
 Material of foundation concrete concrete trench wall under garage
 Material of underpinning " to fill Height _____ Thickness _____
 Kind of Roof pitch Rise per foot 10" Roof covering arch. lt. shingles on Glass G. Enc. Lab.
 No. of chimneys 1 Material of chimneys brick of hanging tile
 Kind of heat steam Type of fuel coal Is gas fitting involved? no
 Framing Lumber—Kind hexlock Dress'd or Full Size? dressed
 Corner posts 4x6 Sills 4x6 Girt or ledger board? none Size _____
 Material columns under girders iron columns Size 4" Max. on centers 6"
 Studs (outside walls and carrying partitions) 2x16" O. C. Girders 6x8 or larger. Bridging in every floor and flat roof span over 8 feet. Sills and corner posts all one piece in cross section.
 Joists and rafters: 1st floor 2x8, 2nd 2x8, 3rd 2x6 ceiling, roof 2x6
 On centers: 1st floor 16", 2nd 16", 3rd 16", roof 16"
 Maximum sp.: 1st floor 17", 2nd 16", 3rd _____, roof _____
 If one story building with masonry walls, thickness of walls? _____ height? _____

If a Garage

No. cars now accommodated on same lot none to be accommodated 1
 Total number commercial cars to be accommodated none
 Will automobile repairing be done other than minor repairs to cars habitually stored in the proposed building? no

Miscellaneous

Will above work require removal or disturbing of any shade tree on a public street? no
 Will there be in charge of the above work a person competent to see that the State and City requirements pertaining thereto are observed? yes

INSPECTION COPY

Signature of owner Raymond C. Anderson
Frank G. Goble

Permit No. 39/454
 Location 9-15 Kendall St.
 Owner C. C. Andersen
 Date permit 4/25/39
 Notif. R-in 5/20/39
 Inspn. closing-in 5/29/39 - G.I.
 Final 8/19/39
 Final Inspn. 11/15/39 - C.A.
 Cert. of Occupancy issued 11/15/39.

NOTES
 4/6/39 - side line of Pat.
 Drail determined but stables
 on to front porch...
 taken on the...
 4/14/39 - No...
 4/21/39 - No...
 4/30/39 - Form...
 created Front...

- to...
 11/2/39 Mr. ...
 11/15/39 - Matter taken
 care of - C.A.
 5/5/39 - Foundation wall
 5/10/39 - Roof...
 5/20/39 - ...
 5/29/39 - ...
 8/21/39 - ...
 11/15/39 - ...



PERMIT ISSUED
Permit No. 2474

APPLICATION FOR PERMIT

DEC 9 1931

Class of Building or Type of Structure Third Class

Portland, Maine, December 5, 1931

To the INSPECTOR OF BUILDINGS, PORTLAND, ME.

The undersigned hereby applies for a permit to erect alter install the following building structure equipment in accordance with the Laws of the State of Maine, the Building Code of the City of Portland, plans and specifications, if any, submitted herewith and the following specifications:

Location 27 Kendall Street (9-15) Ward 9 Within Fire Limits? no Dist. No. _____
 Owner's or Lessee's name and address Anton C. Andersen, 54 Veranda St. Telephone F 8757
 Contractor's name and address Owner Telephone _____
 Architect's name and address _____
 Proposed use of building _____ No. families _____
 Other buildings on same lot _____
 Plans filed as part of this application? _____ No. of sheets _____
 Estimated cost \$ _____ Fee \$ 50

Description of Present Building to be Altered

Material wood No. stories 1 1/2 Heat _____ Style of roof _____ Roofing _____
 Last use summer camp No. families _____

General Description of New Work

To demolish building 20' x 12'

It is understood that this permit does not include installation of heating apparatus which is to be taken out separately by and in the name of the heating contractor.

Details of New Work

Size, front _____ depth _____ No. stories _____ Height average grade to top of plate _____
 To be erected on solid or filled land? _____ earth or rock? _____
 Material of foundation _____ Thickness, top _____ bottom _____
 Material of underpinning _____ Height _____ Thickness _____
 Kind of Roof _____ Rise per foot _____ Roof covering _____
 No. of chimneys _____ Material of chimneys _____ of lining _____
 Kind of heat _____ Type of fuel _____ Is gas fitting involved? _____
 Corner posts _____ Sills _____ Girt or ledger board? _____ Size _____
 Material columns under girders _____ Size _____ Max. on centers _____
 Studs (outside walls and carrying partitions) 2x1-16" O.C. Girders 6x8 or larger. Bridging in every floor and flat roof span over 8 feet. Sills and corner posts all one piece in cross section.

Joists and rafters: 1st floor _____, 2nd _____, 3rd _____, roof _____
 On centers: 1st floor _____, 2nd _____, 3rd _____, roof _____
 Maximum span: 1st floor _____, 2nd _____, 3rd _____, roof _____

If one story building with masonry walls, thickness of walls? _____ height? _____

If a Garage

No. cars now accommodated on same lot _____, to be accommodated _____
 Total number commercial cars to be accommodated _____
 Will automobile repairing be done other than minor repairs to cars habitually stored in the proposed building? _____

Miscellaneous

Will above work require removal or disturbing of any shade tree on a public street? no
 Will there be in charge of the above work a person competent to see that the State and City requirements pertaining thereto are observed? yes

Signature of owner Anton C Andersen

INSPECTION COPY

6619A

Ward 9 Permit No. 312474

Location 171 Kendall St.

Owner Anton C. Andersen

Date of permit 12/3/31.

Notif. closing-in _____

Inspn. closing-in _____

Final Notif. _____

Final Inspn. _____

Cert. of Occupancy issued None

NOTES

