

395-479 PRESUMPCOT STREET
(Nissen Baking C.)



CITY OF PORTLAND, MAINE
SITE PLAN REVIEW
 Processing Form

394

Applicant _____ Date _____
 Mailing Address _____ Address of Proposed Site _____
 Proposed Use of Site _____ Site Identifier(s) from Assessors Maps _____
 Acreage of Site / Ground Floor Coverage _____ Zoning of Proposed Site _____
 Site Location Review (DEP) Required: () Yes () No Proposed Number of Floors _____
 Board of Appeals Action Required: () Yes () No Total Floor Area _____
 Planning Board Action Required: () Yes () No
 Other Comments: _____
 Date Dept. Review Due: _____

PUBLIC WORKS DEPARTMENT REVIEW

20 October 82
 (Date Received)

	TRAFFIC CIRCULATION	ACCESS	CURB CUTS	ROAD WIDTH	PARKING	SIGNALIZATION	TURNING MOVEMENTS	LIGHTING	CONFLICT WITH CITY CONSTRUCTION PROJECT	DRAINAGE	SOIL TYPES	SEWERS	CURBING	SIDEWALKS	OTHER
APPROVED	X	X	X	X	X			X							
APPROVED CONDITIONALLY										X	X				
DISAPPROVED															

CONDITIONS SPECIFIED BELOW

REASONS SPECIFIED BELOW

REASONS: *Plan should show topography contour lines. Do not fill any more of the wet area. What will be the treatment to prevent erosion of the bank?*

(Attach Separate Sheet If Necessary)

Man A. Summit

SIGNATURE OF REVIEWING STAFF/DATE

PUBLIC WORKS DEPARTMENT COPY

CITY OF PORTLAND, MAINE

SITE PLAN REVIEW

Processing Form

174

Applicant _____
 Mailing Address _____
 Proposed Use of Site _____
 Acreage of Site / Ground Floor Coverage _____
 Site Location Review (DEP) Required: () Yes () No
 Board of Appeals Action Required: () Yes () No
 Planning Board Action Required: () Yes () No
 Other Comments: _____
 Date Dept. Review Due: _____

Date _____
 Address of Proposed Site _____
 Site Identifier(s) from Assessors Maps _____
 Zoning of Proposed Site _____
 Proposed Number of Floors _____
 Total Floor Area _____

PLANNING DEPARTMENT REVIEW

(Date Received) _____

- Major Development — Requires Planning Board Approval: Review Initiated
- Minor Development — Staff Review Below

	LOADING AREA	PARKING	CIRCULATION PATTERN	ACCESS	PEDESTRIAN WALKWAYS	SCREENING	LANDSCAPING	SPACE & BULK OF STRUCTURES	LIGHTING	CONFLICT WITH CITY PROJECTS	FINANCIAL CAPACITY	CHANGE IN SITE PLAN
APPROVED	X	X	X	X	X		X	X	X			
APPROVED CONDITIONALLY						X						
DISAPPROVED												

CONDITIONS SPECIFIED BELOW
 REASONS SPECIFIED BELOW

REASONS: 1 PRESSURE EXISTING VEGETATION NEAR THE LOCATION OF THE PROPOSED FACILITY
2 APPLICANT MUST MEET PUBLIC WORKS REQUIREMENTS FOR NOT FILLING THE WEST ALGA AND TREATMENT OF BANK TO PREVENT EROSION
 (Attach Separate Sheet if Necessary)

Richard Knowlton 11-26-82
 SIGNATURE OF REVIEWING STAFF/DATE

PLANNING DEPARTMENT COPY

CITY OF PORTLAND, MAINE
SITE PLAN REVIEW
Processing Form

294

J. Nissen Baking Company Date October 20, 1982
Washington Avenue, Portland, Maine Address of Proposed Site 305-467 Presumpscot Street
Repair Garage Site Identifier(s) from Assessors Maps 419-A-2
Proposed Use of Site 7.3 / 6120 sq. ft. Zoning of Proposed Site I-2
Acreage of Site / Ground Floor Coverage

Site Location Review (DEP) Required: () Yes () No Proposed Number of Floors _____
Board of Appeals Action Required: () Yes () No Total Floor Area _____
Planning Board Action Required: () Yes () No

Other Comments: _____
Date Dept. Review Due: _____

BUILDING DEPARTMENT SITE PLAN REVIEW
(Does not include review of construction plans)

- Use does NOT comply with Zoning Ordinance
 - Requires Board of Appeals Action
 - Requires Planning Board/City Council Action

Explanation _____

- Use complies with Zoning Ordinance — Staff Review Below

Zoning: SPACE & BULK, as applicable

	DATE	ZONE LOCATION	INTERIOR OR CORNER LOT	40 FT. SETBACK AREA (SEC. 21)	USE	SEWAGE DISPOSAL	REAR YARDS	SIDE YARDS	FRONT YARDS	PROJECTIONS	HEIGHT	LOT AREA	BUILDING AREA	AREA PER FAMILY	WIDTH OF LOT	LOT FRONTAGE	OFF-STREET PARKING	LOADING BAYS	
COMPLIES																			
COMPLIES CONDITIONALLY																			CONDITIONS SPECIFIED BELOW
DOES NOT COMPLY																			REASONS SPECIFIED BELOW

REASONS: _____

Malcolm S. Am...
SIGNATURE OF REVIEWING STAFF/DATE

BUILDING DEPARTMENT -- ORIGINAL

CITY OF PORTLAND, MAINE
SITE PLAN REVIEW
Processing Form

394

October 21, 1982

Date

FIRE DEPARTMENT REVIEW

(Date Received)

	ACCESS TO SITE	ACCESS TO STRUCTURES	SUFFICIENT VEHICLE TURNING ROOM	SAFETY HAZARDS	HYDRANTS	SIAMASE CONNECTIONS	SUFFICIENCY OF WATER SUPPLY	OTHER
APPROVED	✓	✓			✓		✓	
APPROVED CONDITIONALLY								
DISAPPROVED								

CONDITIONS SPECIFIED BELOW

REASONS SPECIFIED BELOW

REASONS: _____

(Attach Separate Sheet if Necessary)

 SIGNATURE OF REVIEWING STAFF / DATE 10-20-82
 FIRE DEPARTMENT COPY



CITY OF PORTLAND, MAINE
Department of Building Inspection

Certificate of Occupancy

LOCATION 413 Presumpscot Street

Issued to JOHN J Nissen Baking Co.

Date of Issue March 17, 1983

This is to certify that the building, premises, or part thereof, at the above location, built—altered—changed as to use under Building Permit No. 82-1001, has had final inspection, has been found to conform substantially to requirements of Zoning Ordinance and Building Code of the City, and is hereby approved for occupancy or use, limited or otherwise, as indicated below.

PORTION OF BUILDING OR PREMISES

APPROVED OCCUPANCY

Entire

Truck Repairs

Limiting Conditions:

This certificate supersedes
certificate issued

Approved:

(Date)

Inspector

Inspector of Buildings

Notice: This certificate identifies lawful use of building or premises, and ought to be transferred from owner to owner when property changes hands. Copy will be furnished to owner or lessee for one dollar.



CITY OF PORTLAND

DEPARTMENT OF URBAN DEVELOPMENT
BUILDING INSPECTION DIVISION

November 5, 1982

F.W. Cunningham & Sons
P.O. Box 1140
Portland, Maine 04104

Dear Sir:

Your application for a building permit to construct a 60' x 100' steel building for John J. Nissen Baking Co. at 413 Presumpscot Street, Portland, Maine is being issued subject to the following requirements.

1. Public Works: Do not fill any more at the wet area.
2. Planning Division: (a) Preserve existing vegetation near the relocation of the propane facility.
(b) Applicant must meet Public Works requirements for not filling the wet area and treatment of bank to prevent erosion.
3. Section 111.7 Engineering Details: If a structure analysis is required, a certificate of design, signed by a licensed structural engineer, shall be filed with the building official. This Division is requesting such a certificate.
4. Mezzanine live load will be designed for a minimum of .125 lbs uniformly distributed.
5. The Heating System will be installed as per Section M-629. of the Boca Basic Mechanical Code/1981. Mechanical ventilating systems for toilet room will be capable of producing a change of air every 12 minutes.

If you have any questions on these requirements, please don't hesitate to call my office.

Sincerely,

P. Samuel Hoffses
Chief of Inspection Services

PSH/ulb

APPLICATION FOR PERMIT

PERMIT ISSUED

B.O.C.A. USE GROUP B

B.O.C.A. TYPE OF CONSTRUCTION 2C 01001

ZONING LOCATION F-2 PORTLAND, MAINE Oct. 18, 1982

NOV 8 1982

CITY OF PORTLAND

To the CHIEF OF BUILDING & INSPECTION SERVICES, PORTLAND, MAINE

The undersigned hereby applies for a permit to erect, alter, repair, demolish, move or install the following building, structure, equipment or change use in accordance with the Laws of the State of Maine, the Portland B.O.C.A. Building Code and Zoning Ordinance of the City of Portland with plans and specifications, if any, submitted herewith and the following specifications:

LOCATION 413 Presumpscot St. Fire District #1 [] #2 []

1. Owner's name and address John J. Nissen Baking Co., 59 Washington Ave., Telephone

2. Lessee's name and address F. W. Cunningham & Sons, P. O. Box 1158, Telephone

3. Contractor's name and address F. W. Cunningham & Sons, P. O. Box 1140 04104, Telephone 773-0246

Proposed use of building No. of sheets

Last use No. families

Material No. stories Heat Style of roof Roofing

Other buildings on same lot

Estimated contractual cost \$ 165,000

FIELD INSPECTOR—Mr. site plan review Appeal Fees \$ 200.00

@ 775-5451

Base Fee 835.00

Late Fee app/site 100.00

TOTAL plans 735.00

Major site plan review To construct 60' x 100' steel building to be used for truck repairs as per plans. 5 sheets of plans.

Stamp of Special Conditions

PERMIT ISSUED WITH LETTER

NOTE TO APPLICANT: Separate permits are required by the installers and subcontractors of heating, plumbing, electrical and mechanicals.

DETAILS OF NEW WORK

Is any plumbing involved in this work? yes Is any electrical work involved in this work? yes
Is connection to be made to public sewer? no If not, what is proposed for sewage? septic system
Has septic tank notice been sent? existing Form notice sent?
Height average grade to top of plate 21' 6" Height average grade to highest point of roof 22' 6"
Size, front 100 depth 60 No. stories 1 solid or filled land? filled earth or rock? earth
Material of foundation concrete Thickness, top 8" bottom 8" cellar
Kind of roof steel Rise per foot 1-24 spread footing steel Roof covering gas propane
No. of chimneys none Material of chimneys of lining Kind of heat fuel
Framing Lumber—Kind Dressed or full size? Corner posts Sills
Size Girder Columns under girders Size Max. on centers
Studs (outside walls and carrying partitions) 2x4-16" O. C. Bridging in every floor and flat roof span over 8 feet.
Joists and rafters: 1st floor 2nd 3rd roof
On centers: 1st floor 2nd 3rd roof
Maximum span: 1st floor 2nd 3rd roof
e story building with masonry walls, thickness of walls? height?

IF A GARAGE

No. cars now accommodated on same lot, to be accommodated, number commercial cars to be accommodated
Will automobile repairing be done other than minor repairs to cars habitually stored in the proposed building?

APPROVALS BY: DATE MISCELLANEOUS
BUILDING INSPECTION—PLAN EXAMINER Will work require disturbing of any tree on a public street?
ZONING: Will there be in charge of the above work a person competent
BUILDING CODE: to see that the State and City requirements pertaining thereto
Fire Dept: are observed?
Health Dept:
Others:

Signature of Applicant Robert A. ... Phone # same

Type Name of above Robert A. ... F. W. Cunningham & Sons

PERMIT ISSUED WITH LETTER

NOTES

12/16/82 Ref checked
 8" foundation wall
 still framing was
 being erected checked
 joists & girders
 checked & added joists
 OK MW

1/3/83 Checked 2x4 studing
 & floor joists &
 rooms for lounge
 toilet area & forms
 under floor in garage
 sheetrocking off going
 up of 2010 floor
 joists 16-00. OK
 showing also. MW

2-18-83 Ref CC. WIP checked int. framing OK

3/4/83 Ref made final
 inspection talked with
 owner checked E.P.'s
 & lighting OK MW

Permit No. 82/1001
 Location 413 Galloway Road
 Owner John M. Moady
 Date of Permit 10-15-82
 Approved 11-8-82
 Dwelling Single Detached
 Garage
 Alteration

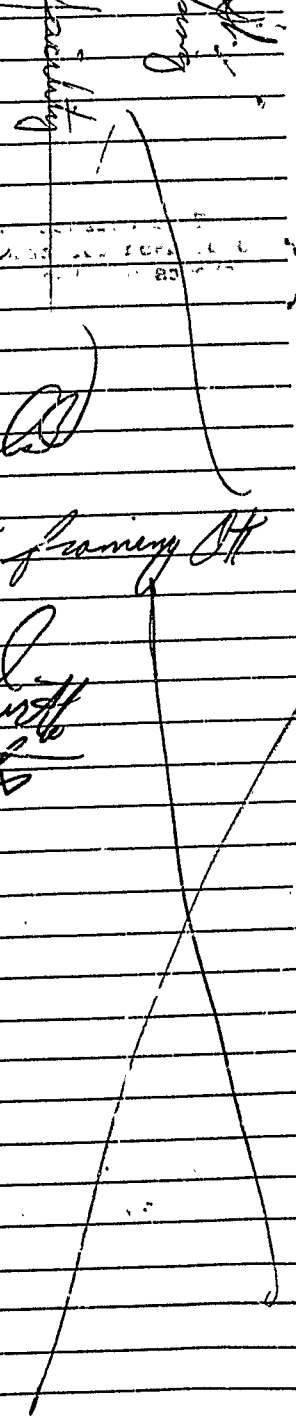

F. W. CUNNINGHAM & SONS
85 West Commercial Street
P. O. Box 1140
Portland, Maine 04104

October 18, 1982

SITE REVIEW FOR PROPOSED TRUCK REPAIR GARAGE

Owned By

John J. Nissen Baking Co.
Box 1158
Portland, Maine 04104

On its land at

395-467 Presumpscot Street
Portland, Maine

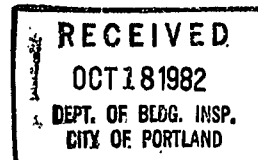

The property is in an I-2 Zone and is shown on City Assessor's Chart #419 A-Z.

The proposed building is to be a repair facility for tractors and small route trucks. The present leased garages on Washington Avenue have become increasingly difficult to operate from because of the heavy traffic on Washington Avenue.

The area under review is a small portion of the land (7.3 acres) owned by the John J. Nissen Baking Co. since about 1974. A building was constructed on this site in 1974. Much of the data required for this site review is contained in the Building Inspector's file. The proposed building is 60' X 102'-8". Siting the building requires partial filling of a gully. The filling operation will stop approximately 50' from the stream bed of the area drainage water course.

No easements are known to exist.

No unusual amount, or type, of solid waste will be generated from the proposed operation. Waste will be disposed of thru commercial disposal companies.

No city sewer exists at the site, and sanitary sewage will be deposited into an existing 1500 gallon septic tank and from there pumped into an existing mounded leaching field. The present system was designed by Thomas A. Griffin Associates Co. in 1974, and details are on file at the Building Inspector's office. It is expected that the new facility will operate on two shifts daily with no more than 10 people per shift. The employees here are being transferred from Nissen's in-town garages so no new jobs are being created. There is a 10" water main in Presumpscot Street between Washington Avenue and Ocean Avenue. Electrical service and telephone service are provided on pole lines installed and maintained by Central Maine Power Co. and New England Telephone and Telegraph Co., respectively. Presumpscot Street is a paved way with a moderate traffic flow.

W. CUNNINGHAM & SONS

SITE REVIEW FOR PROPOSED TRUCK REPAIR GARAGE

Continued

No particular drainage problems are evident. The outfall for the water-courses is a granite box culvert under the Grand Trunk Railroad single track, thence under I-95 to the Presumpscot River tidal estuary.

It is contemplated that the construction of this facility will be completed in four months after permission to start.

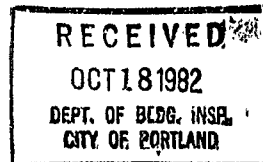

F. W. CUNNINGHAM & SONS
85 West Commercial Street
P. O. Box 1140
Portland, Maine 04104

October 18, 1982

SITE REVIEW FOR PROPOSED TRUCK REPAIR GARAGE

Owned By

John J. Nissen Baking Co.
Box 1158
Portland, Maine 04104

On its land at

395-467 Presumpscot Street
Portland, Maine

The property is in an I-2 Zone and is shown on City Assessor's Chart #419 A-Z.

The proposed building is to be a repair facility for tractors and small route trucks. The present leased garages on Washington Avenue have become increasingly difficult to operate from because of the heavy traffic on Washington Avenue.

The area under review is a small portion of the land (7.3 acres) owned by the John J. Nissen Baking Co. since about 1974. A building was constructed on this site in 1974. Much of the data required for this site review is contained in the Building Inspector's file. The proposed building is 60' X 102'-8". Siting the building requires partial filling of a gully. The filling operation will stop approximately 50' from the stream bed of the area drainage water course.

No easements are known to exist.

No unusual amount, or type, of solid waste will be generated from the proposed operation. Waste will be disposed of thru commercial disposal companies.

No city sewer exists at the site, and sanitary sewage will be deposited into an existing 1500 gallon septic tank and from there pumped into an existing mounded leaching field. The present system was designed by Thomas A. Griffin Associates Co. in 1974, and details are on file at the Building Inspector's office. It is expected that the new facility will operate on two shifts daily with no more than 10 people per shift. The employees here are being transferred from Nissen's in-town garages so no new jobs are being created. There is a 10" water main in Presumpscot Street between Washington Avenue and Ocean Avenue. Electrical service and telephone service are provided on pole lines installed and maintained by Central Maine Power Co. and New England Telephone and Telegraph Co., respectively. Presumpscot Street is a paved way with a moderate traffic flow.

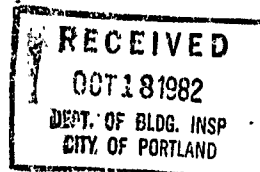

F. W. CUNNINGHAM & SONS

SITE REVIEW FOR PROPOSED TRUCK REPAIR GARAGE

Continued

No particular drainage problems are evident. The outfall for the water-courses is a granite box culvert under the Grand Trunk Railroad single track, thence under I-95 to the Presumpscot River tidal estuary.

It is contemplated that the construction of this facility will be completed in four months after permission to start.

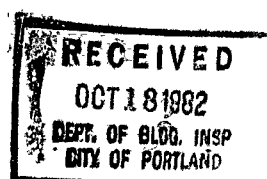

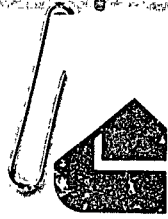

F.W. CUNNINGHAM and SONS

November 12, 1982

City Hall
Department of Urban Development
Building Inspection Division
389 Congress Street
Portland, Maine 04101

RE: Building Permit #01001

ATTENTION: Mr. P. S. Hoffses

Gentlemen:

We are in receipt of the building permit for this project and your attached letter of November 5, 1982 (Copy enclosed). Please review our following comments:

1. We do not plan to alter the natural conditions of the existing stream bed and marsh-type area next to the building site. The construction process may temporarily disturb some perimeter areas, but these will be kept to a minimum and fully re-dressed with the original materials following project completion.
2. The propane facility will be completely on the "up-hill" side of the banking and wet area. Work in this location will tend to improve the bank and lead to better protection of the wet area.
3. The design information will shortly be forwarded to your office.
4. The design will comply with this 125 lb. loading requirement.
5. Our mechanical subcontractors have knowledge of the BOCA code and their work will comply with it.

If you have any questions or comments concerning these items, feel free to call at any time.

Sincerely,

F. W. CUNNINGHAM AND SONS

Bill Nilsen

WN:bmkn

Enclosure



CITY OF PORTLAND

DEPARTMENT OF URBAN DEVELOPMENT
BUILDING INSPECTION DIVISION

November 5, 1982

F.W. Cunningham & Sons
P.O. Box 1140
Portland, Maine 04104

Dear Sir:

Your application for a building permit to construct a 60' x 100' steel building for John J. Nissen Baking Co. at 413 Presumpscot Street, Portland, Maine is being issued subject to the following requirements.

1. Public Works: Do not fill any more at the wet area.
2. Planning Division: (a) Preserve existing vegetation near the relocation of the propane facility.
(b) Applicant must meet Public Works requirements for not filling the wet area and treatment of bank to prevent erosion.
3. Section 111.7 Engineering Details: If a structure analysis is required, a certificate of design, signed by a licensed structural engineer, shall be filed with the building official. This Division is requesting such a certificate. - ART
4. Mezzanine live load will be designed for a minimum of 125 lbs uniformly distributed. - ARB
2x10
16"
5. The Heating System will be installed as per Section M-629. of the Boca Basic Mechanical Code/1981. Mechanical ventilating systems for toilet room will be capable of producing a change of air every 12 minutes.

If you have any questions on these requirements, please don't hesitate to call my office.

Sincerely,

P. Samuel Hoffses
Chief of Inspection Services

PSH/ulb

NISSONS Bakery
Tanks to set on concrete pad
All wiring is explosion proof
Pad fenced in with chainlink.

5-1000
GAL TANKS

TANKS INSTALLED
IN ACCORDANCE WITH
PAMPHLET 58

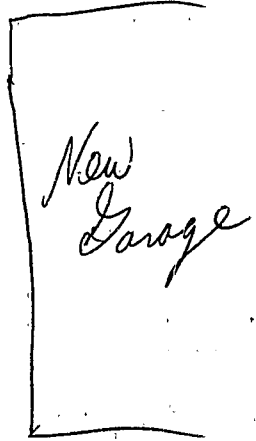
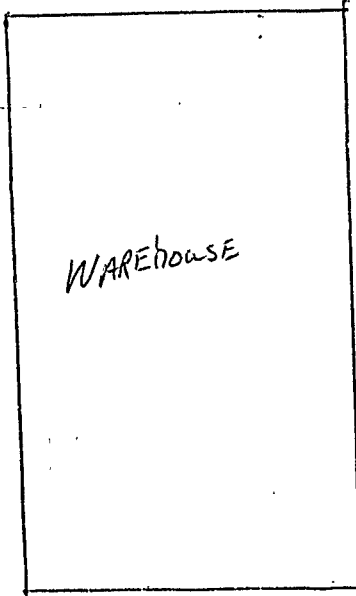

Presumpscot ST

Petrolane Gas Service
95 Main St
Saco, ME 04072

RECEIVED
OCT 25 1982
DEPT. OF BLDG. INSP.
CITY OF PORTLAND

APPLICATION FOR PERMIT

PERMIT ISSUED

B.O.C.A. USE GROUP

B.O.C.A. TYPE OF CONSTRUCTION 00948

ZONING LOCATION PORTLAND, MAINE

OCT 25 1982

CITY OF PORTLAND

To the CHIEF OF BUILDING & INSPECTION SERVICES, PORTLAND, MAINE

The undersigned hereby applies for a permit to erect, alter, repair, demolish, move or install the following building, structure, equipment or change use in accordance with the Laws of the State of Maine, the Portland B.O.C.A. Building Code and Zoning Ordinance of the City of Portland with plans and specifications, if any, submitted herewith and the following specifications:

LOCATION 413 Presumpscot St. Fire District #1 #2

1. Owner's name and address John J Nissen Baking Co. - warehouse Telephone 772-7406

2. Lessee's name and address Petrolane Gas Service - 33 Main St. Telephone 282-0813

3. Contractor's name and address Telephone

Proposed use of building warehouse with tanks for permanent heat No. of sheets

Last use No. families

Material No. stories Heat Style of roof Roofing

Other buildings on same lot

Estimated contractual cost \$.....

FIELD INSPECTOR—Mr. Appeal Fees \$.....

@ 775-5451 Base Fee 35.00

Late Fee

TOTAL \$ 35.00

To install 5-1,000 gal. propane gas tanks to be used for permanent heat as per plans 1 sheet of plans. also for motor fuel

Stamp of Special Conditions

Send permit to # 3 04072

NOTE TO APPLICANT: Separate permits are required by the installers and subcontractors of heating, plumbing, electrical and mechanicals.

DETAILS OF NEW WORK

Is any plumbing involved in this work? Is any electrical work involved in this work?

Is connection to be made to public sewer? If not, what is proposed for sewage?

Has septic tank notice been sent? Form notice sent?

Height average grade to top of plate Height average grade to highest point of roof

Size, front depth No. stories solid or filled land? earth or rock?

Material of foundation Thickness, top bottom cellar

Kind of roof Rise per foot Roof covering

No. of chimneys Material of chimneys of lining Kind of heat fuel

Framing Lumber—Kind Dressed or full size? Corner posts Sills

Size Girder Columns under girders Size Max. on centers

Studs (outside walls and carrying partitions) 2x4-16" O. C. Bridging in every floor and flat roof span over 8 feet.

Joists and rafters: 1st floor 2nd 3rd , roof

On centers: 1st floor 2nd 3rd , roof

Maximum span: 1st floor 2nd 3rd , roof

If one story building with masonry walls, thickness of walls? height?

IF A GARAGE

No. cars now accommodated on same lot , to be accommodated number commercial cars to be accommodated

Will automobile repairing be done other than minor repairs to cars habitually stored in the proposed building?

APPROVALS BY: DATE

MISCELLANEOUS

BUILDING INSPECTION—PLAN EXAMINER Will work require disturbing of any tree on a public street?

ZONING: N/A

BUILDING CODE: Will there be in charge of the above work a person competent

Fire Dept. to see that the State and City requirements pertaining thereto

Health Dept.: are observed?

Others:

Signature of Applicant Thomas Kendall for Phone # same

Type Name of above Petrolane Gas Service 1 2 3 4

Other and Address

Handwritten signature/initials

FIELD INSPECTOR'S COPY

APPLICANT'S COPY

OFFICE FILE COPY

NOTES

Permit No. 82/948

Location 113/2 Western Park St

Owner John J. Alden Consulting

Date of permit 10-25-82

Approved 10-25-82

Dwelling

Garage

Alteration 5,100 gal tanks

11/4/82 Re/ Nothing started yet. MW

23-83 Tanks have been installed in location designated. OK MW

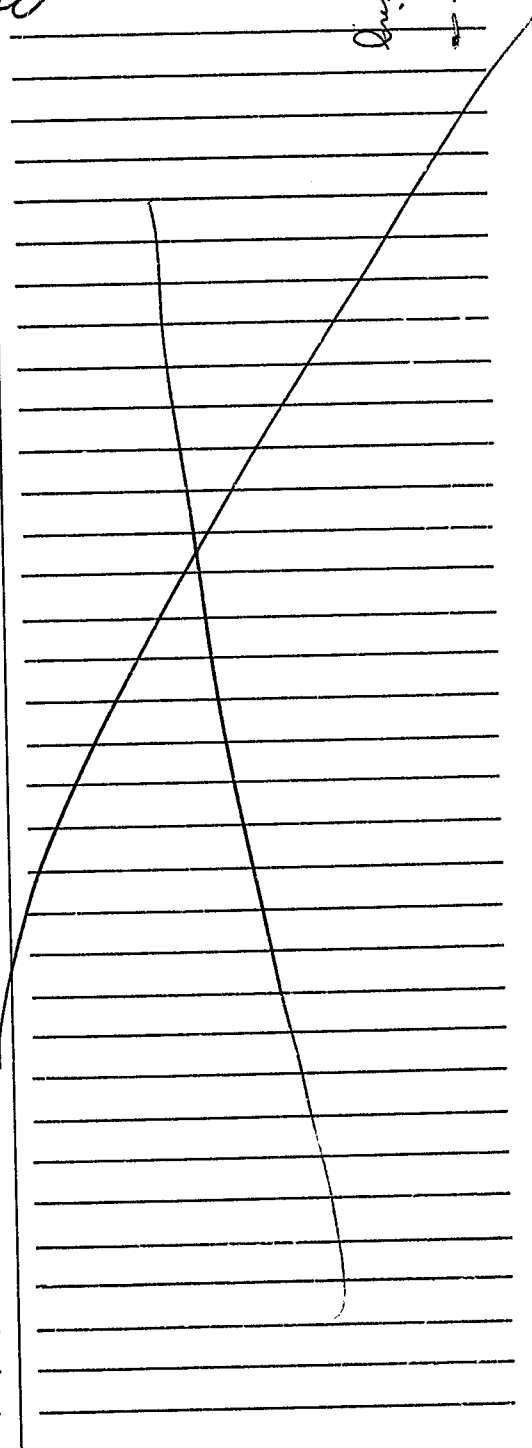



APPLICATION FOR PERMIT

PERMIT ISSUED

B.O.C.A. USE GROUP 881

AUG 27 1981

ZONING LOCATION PORTLAND, MAINE, ... Aug. 24, 1981

CITY OF PORTLAND

To the DIRECTOR OF BUILDING & INSPECTION SERVICES, PORTLAND, MAINE

The undersigned hereby applies for a permit to erect, alter, repair, demolish, move or install the following building, structure, equipment or change use in accordance with the Laws of the State of Maine, the Portland B.O.C.A. Building Code and Zoning Ordinance of the City of Portland with plans and specifications, if any, submitted herewith and the following specifications:

LOCATION ... 413 Presumpscot St. Fire District #1 [] #2 []
1. Owner's name and address John J. Nissen - same Telephone ...
2. Lessee's name and address Telephone ...
3. Contractor's name and address Petrolane Gas Service- 95 Main St. Telephone ... 292-0913
4. Architect Specifications Plans 04072 No. of sheets ...
Proposed use of building bakery warehouse No. families ...
Last use No. families ...
Material No. stories Heat Style of roof Roofing ...
Other buildings on same lot ...
Estimated contractual cost \$ Fee \$ 16.00

FIELD INSPECTOR-Mr. GENERAL DESCRIPTION

This application is for: @ 775-5451
Dwelling Ext. 234 To set 3-1,000 gal. propane gas tanks as per plans 1 sheet of plans, for refueling of trucks
Garage Stamp of Special Conditions
Masonry Bldg.
Metal Bldg.
Alterations
Demolitions
Change of Use
Cover

NOTE TO APPLICANT: Separate permits are required by the installers and subcontractors of heating, plumbing, electrical and mechanicals.

PERMIT IS TO BE ISSUED TO 1 [] 2 [] 3 [x] 4 []
Other:

DETAILS OF NEW WORK

Is any plumbing involved in this work? Is any electrical work involved in this work?
Is connection to be made to public sewer? If not, what is proposed for sewage?
Has septic tank notice been sent? Form notice sent?
Height average grade to top of plate Height average grade to highest point of roof
Size, front depth No. stories solid or filled land? earth or rock?
Material of foundation Thickness, top bottom cellar
Kind of roof Rise per foot Roof covering
No. of chimneys Material of chimneys of lining Kind of heat fuel
Framing Lumber-Kind Dressed or full size? Corner posts Sills
Size Girder Columns under girders Size Max. on centers
Studs (outside walls and carrying partitions) 2x4-16" O. C. Bridging in every floor and flat roof span over 8 feet.
Joists and rafters: 1st floor 2nd 3rd roof
On centers: 1st floor 2nd 3rd roof
Maximum span: 1st floor 2nd 3rd roof
If one story building with masonry walls, thickness of walls? height?

IF A GARAGE

No. cars now accommodated on same lot ... to be accommodated ... number commercial cars to be accommodated ...
Will automobile repairing be done other than minor repairs to cars habitually stored in the proposed building?

APPROVALS BY: DATE MISCELLANEOUS
BUILDING INSPECTION-PLAN EXAMINER Will work require disturbing of any tree on a public street? ..
ZONING:
BUILDING CODE: Will there be in charge of the above work a person competent
Fire Dept.: to see that the State and City requirements pertaining thereto
Health Dept.: are observed? ..
Others:

Signature of Applicant Phone # same
Type Name of above Petrolane Northeast Gas Service [] 2 [] 3 [x] 4 []
Thomas Kendall Other
and Address

OFFICE FILE COPY

1A



APPLICATION FOR PERMIT
DEPARTMENT OF BUILDING INSPECTIONS SERVICES
ELECTRICAL INSTALLATIONS

Date Oct. 7, 19 81
 Receipt and Permit number A 73247

To the CHIEF ELECTRICAL INSPECTOR, Portland, Maine:

The undersigned hereby applies for a permit to make electrical installations in accordance with the laws of Maine, the Portland Electrical Ordinance, the National Electrical Code and the following specifications:

LOCATION OF WORK: 413 Presumpscot St.

OWNER'S NAME: Missen Bakery ADDRESS: same

	FEES
OUTLETS:	
Receptacles _____ Switches _____ Plugmold _____ ft. TOTAL _____	
FIXTURES: (number of)	
Incandescent _____ Flourescent _____ (not strip) TOTAL _____	
Strip Flourescent _____ ft. _____	
SERVICES:	
Overhead _____ Underground _____ Temporary _____ TOTAL amperes _____	
METERS: (number of) _____	
MOTORS: (number of)	
Fractional _____	
1 HP or over <u>x</u> _____	1.00
RESIDENTIAL HEATING:	
Oil or Gas (number of units) _____	
Electric (number of rooms) _____	
COMMERCIAL OR INDUSTRIAL HEATING:	
Oil or Gas (by a main boiler) _____	
Oil or Gas (by separate units) _____	
Electric Under 20 kws _____ Over 20 kws _____	
APPLIANCES: (number of)	
Ranges _____	
Cook Tops _____	
Wall Ovens _____	
Dryers _____	
Fans _____	
Water Heaters _____	
Disposals _____	
Dishwashers _____	
Compactors _____	
Others (denote) _____	
TOTAL _____	
MISCELLANEOUS: (number of)	
Branch Panels <u>1</u> _____	1.00
Transformers _____	
Air Conditioners Central Unit _____	
Separate Units (windows) _____	
Signs 20 sq. ft. and under _____	
Over 20 sq. ft. _____	
Swimming Pools Above Ground _____	
In Ground _____	
Fire/Burglar Alarms Residential _____	
Commercial _____	
Heavy Duty Outlets, 220 Volt (such as welders) 30 amps and under _____	
over 30 amps _____	
Circus, Fairs, etc. _____	
Alterations to wires _____	
Repairs after fire _____	
Emergency Lights, battery _____	
Emergency Generators _____	
INSTALLATION FEE DUE _____	
FOR ADDITIONAL WORK NOT ON ORIGINAL PERMIT DOUBLE FEE DUE: _____	
FOR REMOVAL OF A "STOP ORDER" (304-16.b) _____	
TOTAL AMOUNT DUE _____	2.00
min _____	3.00

INSPECTION:

Will be ready on _____, 19 ____; or Will Call xx

CONTRACTOR'S NAME: milliken Bros.

ADDRESS: Riverside Inds. Parkway

TEL: 797-8375

MASTER LICENSE NO.: on file

LIMITED LICENSE NO.: _____

SIGNATURE OF CONTRACTOR: Carol R. Foster

INSPECTOR'S COPY — WHITE
 OFFICE COPY — CANARY
 CONTRACTOR'S COPY — GREEN

CHECK LIST FOR SIGNS

Date - 3/2/75

Checked By W.G.W.

Location - 395-449 PRESCOTT ST.

- Zone Location - I-2
- Fire Zone - N
- Sign & Review Committee - over 8" in least dimension - NO
- Area of sign - 30'
- Area of existing signs -
- Material -
- Design -
- Facing adjoining Residence Zone - NO
- Flashing or Steady light -
- If on State road - check with State -

Attached Sign -

Height above level of roof -

Detached or pole sign -

- Height - 16'
- Required yards (single pole OK - 2 poles a structure) 40"
- setback 37'
- Corner clearance -
- Footing -
- Certificate of Design -

Projecting Sign -

- Clearance 10' -
- Bonded -
- Height -
- Written Consent -
- Projection over sidewalk (18" from curb) -



APPLICATION FOR PERMIT

PERMIT ISSUED

B.O.C.A. USE GROUP 0185

MAR 26 1975

B.O.C.A. TYPE OF CONSTRUCTION

ZONING LOCATION 2-2 PORTLAND, MAINE, March 21, 1975

CITY OF PORTLAND

To the DIRECTOR OF BUILDING & INSPECTION SERVICES, PORTLAND, MAINE

The undersigned hereby applies for a permit to erect, alter, repair, demolish, move or install the following building, structure, equipment or change use in accordance with the Laws of the State of Maine, the Portland B.O.C.A. Building Code and Zoning Ordinance of the City of Portland with plans and specifications, if any, submitted herewith and the following specifications:

LOCATION 395-479 Presumpscot Street Fire District #1 [], #2 []
1. Owner's name and address Nissens Bakery, same Telephone
2. Lessee's name and address Telephone
3. Contractor's name and address Coyne Sign Co., 66 Cove St. Telephone
4. Architect Specifications Plans YES No. of sheets 1
Planned use of building No. families
Land use No. families
No. stories Heat Style of roof Roofing
Buildings on same lot
Estimated contractual cost \$ Fee \$ 13.00

FIELD INSPECTOR—Mr. Hugh Irving GENERAL DESCRIPTION

This application is for: @ 775-5451 To erect a detached pole sign box as per plans
Dwelling Ext. 234
Garage
Masonry Bldg.
Metal Bldg.
Alterations
Demolitions
Change of Use
Other

NOTE TO APPLICANT: Separate permits are required by the installers and subcontractors of heating, plumbing, electrical and mechanicals.

PERMIT IS TO BE ISSUED TO 1 [] 2 [] 3 [x] 4 []

Other:

DETAILS OF NEW WORK

Is any plumbing involved in this work? Is any electrical work involved in this work?
Is connection to be made to public sewer? If not, what is proposed for sewage?
Has septic tank notice been sent? Form notice sent?
Height average grade to top of plate Height average grade to highest point of roof
Size, front depth No. stories solid or filled land? earth or rock?
Material of foundation Thickness, top bottom cellar
Kind of roof Rise per foot Roof covering
No. of chimneys Material of chimneys of lining Kind of heat fuel
Framing Lumber—Kind Dressed or full size? Corner posts Sills
Size Girder Columns under girders Size Max. on centers
Studs (outside walls and carrying partitions) 2x4-16" O. C. Bridging in every floor and flat roof span over 8 feet.
Joists and rafters: 1st floor, 2nd, 3rd, roof
On centers: 1st floor, 2nd, 3rd, roof
Maximum span: 1st floor, 2nd, 3rd, roof
If one story building with masonry walls, thickness of walls? height?

IF A GARAGE

No. cars now accommodated on same lot, to be accommodated, number commercial cars to be accommodated
Will automobile repairing be done other than minor repairs to cars habitually stored in the proposed building?

APPROVALS BY:

DATE

MISCELLANEOUS

BUILDING INSPECTION—PLAN EXAMINER

Will work require disturbing of any tree on a public street? . .

ZONING: O.K. 3/21/75

BUILDING CODE: O.K. 3/26/75

Will there be in charge of the above work a person competent to see that the State and City requirements pertaining thereto are observed? YES

Fire Dept.:

Health Dept.:

Others:

Signature of Applicant

Phone #

Type Name of above Coyne

1 [] 2 [] 3 [x] 4 []

Other

and Address

FIELD INSPECTOR'S COPY

NOTES

Mar 26/75
 Nothing started yet.
 4-29-75 Nothing yet;
 5/15/75 " "
 6/3/75 " "
 6-11- " "
 6-16- " "
 6-30th - 4
 7-23-75 " "
 28 4
 29 4
 30th " "
 8/3/75 " "
 8-19-75 " "
 9-5-75
 9-9-75
 2-9-76
 2-19-76

Approved _____
 Date of permit 3/26/75

1186
 5-179 Puumua Street
 1186

~~Contractor to be inspected, including:~~
~~Contractor to be inspected, including:~~
~~Contractor to be inspected, including:~~
~~Contractor to be inspected, including:~~
 Sign installed
 Confusion for location - etc.

F-2

Presumpscot St →

RECEIVED
DEC 4 1975
DEPT. OF BLDG. INSP.
CITY OF PORTLAND

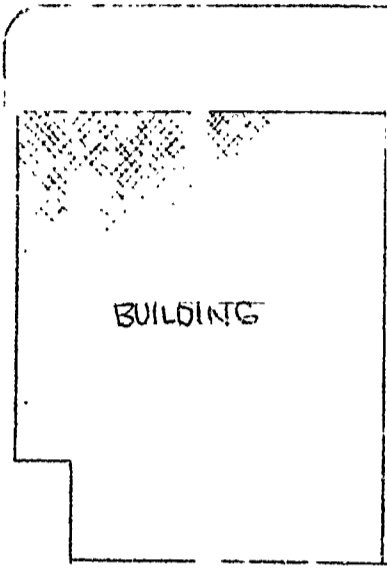

BUILDING

PAYEMENT

7'-10"

31'-6"

Nissen Bakeries

SINGLE FACE METAL PANEL
OVER 3/16" X 1 1/2" X 1 1/2" Z-IRON
FRAME

NISSSEN BAKERIES
415 PRESUMPSCOT ST.
PORTLAND, MAINE

12'-0"

Rear
Yard

RAILROAD

2'-6" X 4" CONCRETE

No flashing lights

Scale 1"=20'-0"

Scale 1/4"=1'-0"

COYNE SIGN Co. Inc
66 COVE STREET
PORTLAND, MAINE 04104

BAKERIES . PORTLAND

SCALE AS NOTED

DATE 12-3-75

*Edwin
Coat*

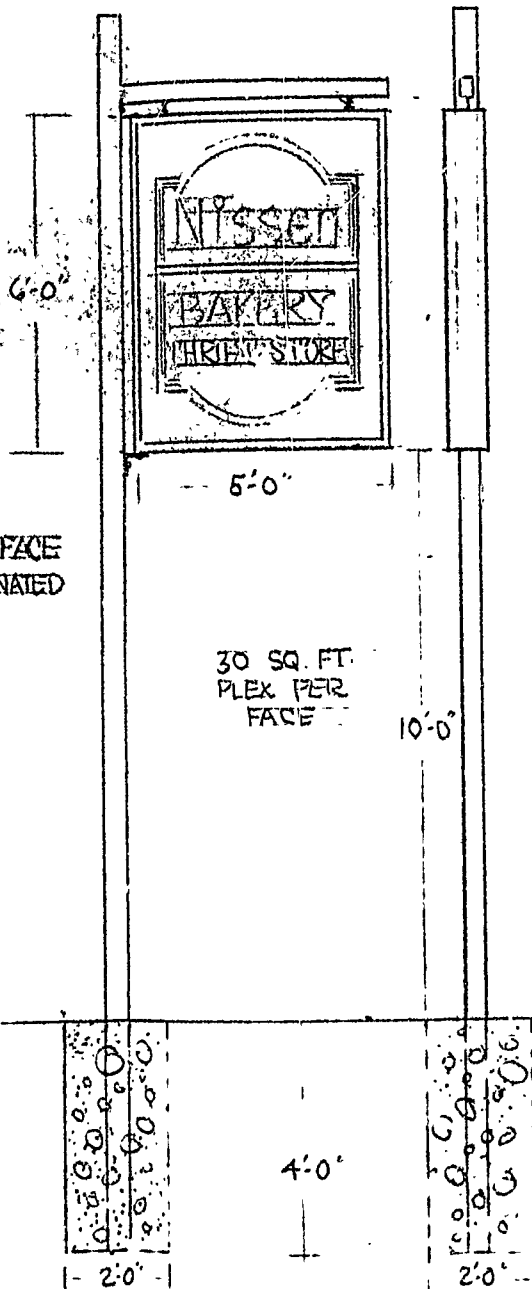

DOUBLE FACE
ILLUMINATED

30 SQ. FT.
PLEX PER
FACE

Scale 3/8" = 1'-0"

RECEIVED
MAR 21 1975
DEPT. OF BLDG. INSP.
CITY OF PORTLAND

COYNE SIGN Co. Inc.
66 COVE STREET
PORTLAND, MAINE 04104

E. AS NOTED

DATE: 3 - 20 - 75

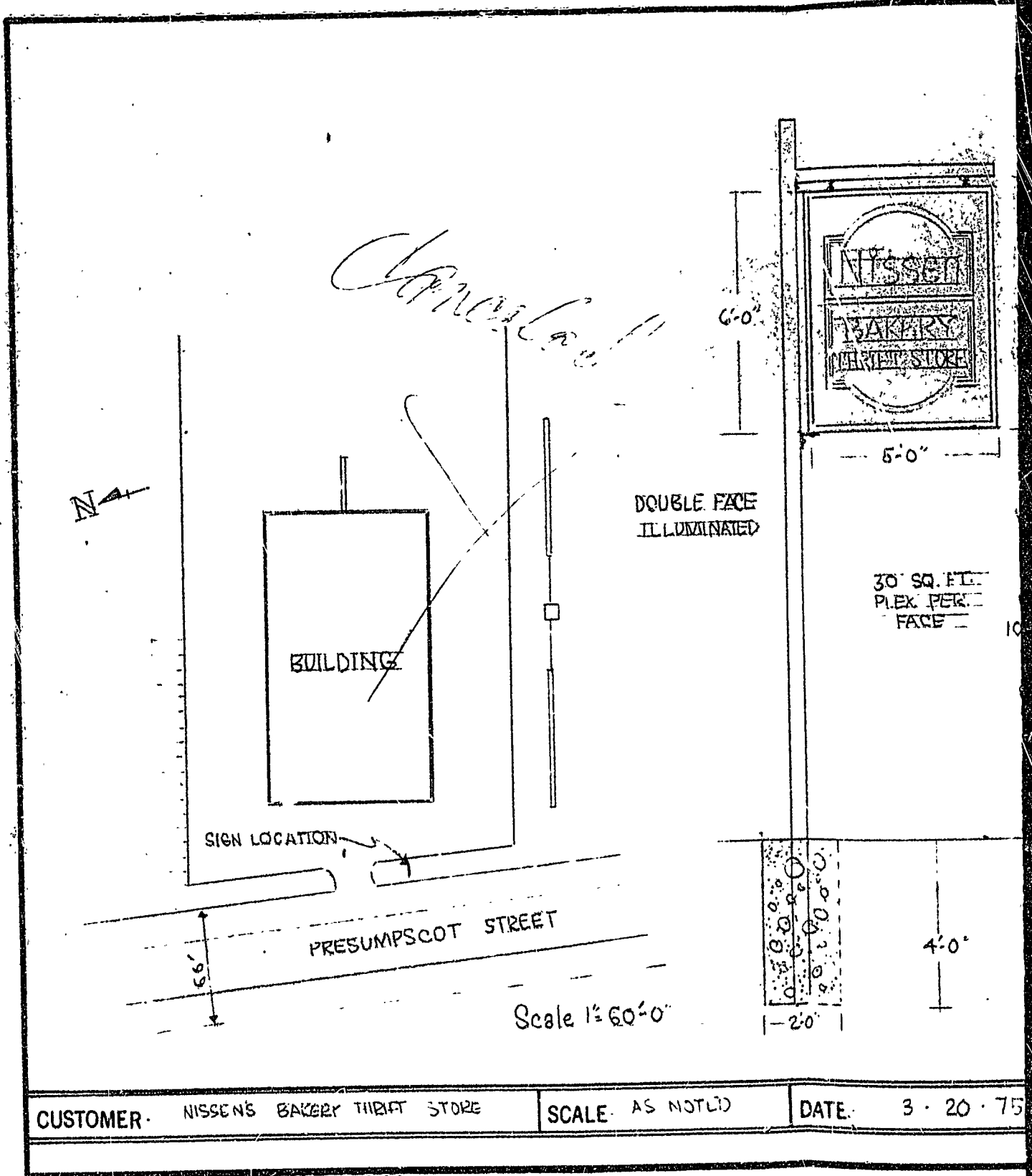

Re: 413 Presumpscot St.

Dec. 8, 1975

Gentlemen:

Although the footings for the sign are shown below frost line, I am not sure they are deep enough to resist wind overturning moments.

A certificate of design is afforded to you to support this information.

Very truly yours,

R. Lovell Brown
Building and Inspection Services Director

RLB:iak

Re: 413 Presumpcot St.

Dec. 8, 1975

Gentlemen:

Although the footings for the sign are shown below frost line, I am not sure they are deep enough to resist wind overturning moments.

A certificate of design is afforded to you to support this information.

Very truly yours,

R. Lovell Brown
Building and Inspection Services Director

RLB:iak



APPLICATION FOR PERMIT TO ERECT
SIGN OVER PUBLIC SIDEWALK OR STREET

Sorry-this is a detached pole sign

Portland, Maine, Dec. 4, 1975 19

PERMIT ISSUED

DEC 8 1975

106

CITY of PORTLAND

To the INSPECTOR OF BUILDINGS, PORTLAND, ME.

The undersigned hereby applies for a permit to erect the following described sign extending over a public sidewalk or street in accordance with the Building Code of the City of Portland, and the following specifications:

Location 413 Presumpscot st. Within Fire Limits? _____ Dist. No. _____

Owner of building to which sign is to be attached John J. Nissen same

Name and address of owner of sign ~~same~~ Coyne Sign Co. 66 Cove St.

Contractor's name and address same as above Telephone 772-4144

When does contractor's bond expire? 12/31/75

Information Concerning Building

No. stories 1 Material of wall to which sign is to be attached _____

Details of Sign and Connections

Building owner's consent and agreement filed with application _____

Electric? no Vertical dimension after erection 7'10" Horizontal 31 1/2'

Weight app. 1000 lbs. Will there be any hollow spaces? no Any rigid frame? yes

Material of frame steel No. advertising faces 1, material Metal 040

No. rigid connections 3 Are they fastened directly to frame of sign? yes

No. through bolts _____, Size _____, Location, top or bottom _____

No. guys _____, material _____, Size _____

Minimum clear height above sidewalk or street _____

Maximum projection into street _____ Fee \$ 34.80

*located in fields
INSPECTION COPY
lak

Signature of contractor

Stuart A. Full

75/1061
413 Pennsylvania
J. De. 8, 1975
Minn

2/25/76 AME - Sign inspection
PM -
2/26/76 Shop inspection
3/11/76 Not on location yet
3/24/76 " " " " "
4/24/76 " " " " "
5/3/76 " " " " "
8/26/76 Sign located on rear
of Bldg facing freeway

PERMIT TO INSTALL PLUMBING

Address **401 Presumcott St** PERMIT NUMBER **4014**

Installation For **Nissens Bakery, same**

Owner of Bldg. **same**

Owner's Address: **same**

Plumber: **D.M. Hardy Inc.**

Date: **2/12/75**

Date Issued **2/12/75**

Portland Plumbing Inspector

By **ERNOLD R. GOODWIN**

App. First Insp.

Date **2-5-75**

By

App. Final Insp.

Date **2-18-75**

By

Type of Bldg.

- Commercial
- Residential
- Single
- Multi Family
- New Construction
- Remodeling

NEW	REPL		NO.	FEE
		SINKS		
		LAVATORIES		
		TOILETS		
		BATH TUBS		
		SHOWERS		
		DRAINS FLOOR SURFACE		
		HOT WATER TANKS		
		TANKLESS WATER HEATERS		
		GARBA'GE DISPOSALS		
	1	SEPTIC TANKS & leaching field		25.00
		HOUSE SEWERS		
		ROOF LEADERS		
		AUTOMATIC WASHERS		
		DISHWASHERS		
		OTHER		
		base fee		3.00
TOTAL				28.00

Building and Inspection Services Dept.; Plumbing Inspection

PERMIT TO INSTALL PLUMBING

Address 395 Presumpscot St.

PERMIT NUMBER **4022**

Installation For Commercial

Owner of Bldg Nissen Baking Co.

Owner's Address same

Plumber Andrew P. Iverson

Date: 2-21-75

Date Issued **Feb. 21, 1975**

Portland Plumbing Inspector

By ERNOLD R GOODWIN

App. First Insp.

Date

By

App. Final Insp.

Date

By

Type of Bldg.

- Commercial
- Residential
- Single
- Multi Family
- New Construction
- Remodeling

NEW	REPL	NO.	FEE
1		PO Box 27	
		SINKS <u>slop</u>	1 2.00
		LAVATORIES	
		TOILETS	
		BATH TUBS	
		SHOWERS	
		DRAINS FLOOR SURFACE	
		HOT WATER TANKS	
		TANKLESS WATER HEATERS	
		GARBAGE DISPOSALS	
		SEPTIC TANKS	
		HOUSE SEWERS	
		ROOF LEADERS	
		AUTOMATIC WASHERS	
		DISHWASHERS	
		OTHER	
		Base Fee	3.00
TOTAL			1 5.00

Building and Inspection Services Dept.: Plumbing Inspection

CITY OF PORTLAND, MAINE
Application for Permit to Install Wires

Permit No. **2471**
 Issued
 Portland, Maine **Jan 2**, 19**75**

To the City Electrician, Portland, Maine:

The undersigned hereby applies for a permit to install wires for the purpose of conducting electric current, in accordance with the laws of Maine, the Electrical Ordinance of the City of Portland, and the following specifications:

(This form must be completely filled out - Minimum Fee, \$1.00)

Owner's Name and Address **Nissen Baking** Tel. **772-2851**

Contractor's Name and Address **Crescent Electric** Tel. **775-0147**

Location **Prospect St.** Use of Building **Commercial**

Number of Families _____ Apartments _____ Stores _____ Number of Stories **1**
 Description of Wiring: New Work Additions _____ Alterations _____

New work metal building

Pipe Cable Metal Molding _____ BX Cable _____ Plug Molding (No. of feet) _____

No. Light Outlets _____ Plugs **14** Light Circuits **7** Plug Circuits _____

FIXTURES: No. **60** Fluor. or Strip Lighting (No. feet) **528**

SERVICE: Pipe _____ Cable _____ Underground _____ No. of Wires _____ Size _____

METERS: Relocated _____ Added _____ Total No. Meters _____

MOTORS: Number _____ Phase _____ H. P. _____ Amps _____ Volts _____ Starter _____

HEATING UNITS: Domestic (Oil) **4** No. Motors _____ Phase _____ H.P. _____
 Commercial (Oil) _____ No. Motors _____ Phase _____ H.P. _____

Electric Heat (No. of Rooms) _____

APPLIANCES: No. Ranges _____ Watts _____ Brand Feeds (Size and No.) _____

Elec. Heaters **3** Watts **13,500**

Miscellaneous _____ Watts _____ Extra Cabinets or Panels _____

Transformers _____ Air Conditioners (No. Units) _____ Signs (No. Units) _____

Will commence **19** Ready to cover in **19** Inspection **19**

Amount of Fee \$ **16.00** Signed **Ray Cloutier #2994**

DO NOT WRITE BELOW THIS LINE

SERVICE _____ METER _____ GROUND _____
 VISITS: **1-28-75** **2-4-75** **2-12-75** **2-26-75** **6**
7 **8** **9** **10** **11** **12**

REMARKS: _____
 INSPECTED BY **Pilby** (OVER)

LOCATION

INSPECTION DATE

WORK COMPLETED

TOTAL NO. INSPECTIONS

REMARKS:

FEES FOR WIRING PERMITS EFFECTIVE JULY 31, 1963

WIRING

1 to 30 Outlets \$ 2.00

31 to 60 Outlets 3.00

Over 60 Outlets, each Outlet05

(Each twelve feet or fraction thereof of fluorescent lighting or any type of plug molding will be classed as one outlet).

SERVICES

Single Phase 2.00

Three Phase 4.00

MOTORS

Not exceeding 50 H.P. 3.00

Over 50 H.P. 4.00

HEATING UNITS

Domestic (Oil) 2.00

Commercial (Oil) 4.00

Electric Heat (Each Room)75

APPLIANCES

Ranges, Cooking Tops, Ovens, Water Heaters, Disposals, Built-in Dishwashers, Dryers, and any permanent built-in appliance — each unit 1.50

MISCELLANEOUS

Temporary Service, Single Phase 1.00

Temporary Service, Three Phase 2.00

Circuses, Carnivals, Fairs, etc. 10.00

Meters, relocate 1.00

Distribution Cabinet or Panel, per unit 1.00

Transformers, per unit 2.00

Air Conditioning

CITY OF PORTLAND, MAINE
Application for Permit to Install Wires

Permit No. 2557
 Issued 2/3/75

Portland, Maine, 1975

To the City Electrician, Portland, Maine:

The undersigned hereby applies for a permit to install wires for the purpose of conducting electric current, in accordance with the laws of Maine, the Electrical Ordinance of the City of Portland, and the following specifications:

(This form must be completely filled out — Minimum Fee, \$1.00)

Owner's Name and Address 395 Nisew's Bldg Co. Tel. 772 2851
 Contractor's Name and Address CRESCENT Elec Tel. 775-6147
 Location 395 Presumpscot St. Use of Building Commercial
 Number of Families _____ Apartments _____ Stores _____ Number of Stories _____
 Description of Wiring: New Work _____ Additions Alterations _____
ADD 100 AMP 3 PHASE METER FOR Elec Heat
 Pipe Cable Metal Molding BX Cable Plug Molding (No. of feet) _____
 No. Light Outlets _____ Plugs _____ Light Circuits _____ Plug Circuits _____
 FIXTURES: No. _____ Fluor. or Strip Lighting (No. feet) _____
 SERVICE: Pipe 1/2" Cable 40 cu Underground _____ No. of Wires 4 Size 100 3 Phase
 METERS: Relocated _____ Added _____ Total No. Meters _____
 MOTORS: Number _____ Phase _____ H. P. _____ Amps _____ Volts _____ Starter _____
 HEATING UNITS: Domestic (Oil) _____ No. Motors _____ Phase _____ H.P. _____
 Commercial (Oil) _____ No. Motors _____ Phase _____ H.P. _____
 Electric Heat (No. of Rooms) _____
 APPLIANCES: No. Ranges _____ Watts _____ Brand Freds (Size and No.) _____
 Elec. Heaters _____ Watts _____
 Miscellaneous _____ Watts _____ Extra Cabinets or Panels _____
 Transformers _____ Air Conditioners (No. Units) _____ Signs (No. Units) cond
 Will commence _____ 19 _____ Ready to cover in _____ 19 _____ Inspection _____ 19 _____
 Amount of Fee \$ 4.00

Signed Roy Carter

DO NOT WRITE BELOW THIS LINE

SERVICE METER _____ GROUND _____
 VISITS: 2-26-75 3 4 5 6
 7 8 9 10 11 12

REMARKS: Service called in

INSPECTED BY Libby (OVER)

PERMIT TO INSTALL PLUMBING

Address **395 Presumpscot St.** PERMIT NUMBER **3911**

Installation For **commercial**

Owner of Bldg **Nissen Baking Co.**

Owner's Address **same**

Plumber **Andrew P. Iverson** Date: **11-12-74**

NEW REPL NO. FEE

NEW	REPL	DESCRIPTION	NO.	FEE
		SINKS		
3		LAVATORIES	3	6.00
3		TOILETS	3	4.60
1		Urinal	1	.60
1		SHOWERS	1	.60
1		DRAINS FLOOR SURFACE	1	.60
1		HOT WATER TANKS	1	2.00
		TANKLESS WATER HEATERS		
		GARBAGE DISPOSALS		
		SEWER TANKS		
		HOUSE SEWERS		
		ROOF LEADERS		
		AUTOMATIC WASHERS		
		DISHWASHERS		
		OTHER		
		Base Fee		3.00
			TOTAL	10 17.40

Date Issued **November 12, 1974**

Portland Plumbing Inspector

By **ERNOLD R GOODWIN**

First Insp. **DEC 9 1974**

Date

By **ERNOLD R GOODWIN**

App. Final Insp.

Date **2-18-75**

By

Type of Bldg

- Commercial
- Residential
- Single
- Multi Family
- New Construction
- Remodeling

Building and Inspection Services Dept.: Plumbing Inspection



APPLICATION FOR PERMIT

PERMIT ISSUED

DEC 11 1974

B.O.C.A. USE GROUP

B.O.C.A. TYPE OF CONSTRUCTION

ZONING LOCATION PORTLAND, MAINE, Dec. 9, 1974

1101 CITY OF PORTLAND

To the DIRECTOR OF BUILDING & INSPECTION SERVICES, PORTLAND, MAINE

The undersigned hereby applies for a permit to erect, alter, repair, demolish, move or install the following building, structure, equipment or change use in accordance with the Laws of the State of Maine, the Portland B.O.C.A. Building Code and Zoning Ordinance of the City of Portland with plans and specifications, if any, submitted herewith and the following specifications:

LOCATION 395-479 Presumpscot St. Fire District #1 [], #2 []
1. Owner's name and address Nissem's Bakery Telephone
2. Lessee's name and address Telephone
3. Contractor's name and address L.A. Profeno Co., 45 Curtis Rd. Telephone 797-3736
4. Architect Specifications Plans Yes No. of sheets 1
Proposed use of building No. families
Last use No. families
Material No. stories 1 story Meat Style of roof Roofing
Other buildings on same lot
Estimated contractual cost \$ Fee \$ 25.00

FIELD INSPECTOR--Mr. Hugh Irving

GENERAL DESCRIPTION

This application is for: @ 775-5451 Air conditioning system - under 10 tons
Dwelling Ext. 234 plus
Garage New Heating System
Masonry Bldg.
Metal Bldg. Stamp of Special Conditions
Alterations
Demolitions
Change of Use
Other

Stamp of Special Conditions (PLAN TYPE IN OTHER IN G.L. ROOM)

NOTE TO APPLICANT: Separate permits are required by the installers and subcontractors of heating, plumbing, electrical and mechanicals.

PERMIT IS TO BE ISSUED TO 1 [] 2 [] 3 [x] 4 []

Other:

DETAILS OF NEW WORK

Is any plumbing involved in this work? Is any electrical work involved in this work?
Is connection to be made to public sewer? If not, what is proposed for sewage?
Has septic tank notice been sent? Form notice sent?
Height average grade to top of plate Height average grade to highest point of roof
Size, front depth No. stories solid or filled land? earth or rock?
Material of foundation Thickness, top bottom cellar
Kind of roof Rise per foot Roof covering
No. of chimneys Material of chimneys of lining Kind of heat fuel
Framing Lumber--Kind Dressed or full size? Corner posts Sills
Size Girder Columns under girders Size Max. on centers
Studs (outside walls and carrying partitions) 2x4-16" O. C. Bridging in every floor and flat roof span over 8 feet.
Joists and rafters: 1st floor, 2nd, 3rd, roof
On centers: 1st floor, 2nd, 3rd, roof
Maximum span: 1st floor, 2nd, 3rd, roof
If one story building with masonry walls, thickness of walls? height?

IF A GARAGE

No. cars now accommodated on same lot, to be accommodated number commercial cars to be accommodated
Will automobile repairing be done other than minor repairs to cars habitually stored in the proposed building?

APPROVALS BY: DATE 12/11/74 MISCELLANEOUS
BUILDING INSPECTION--PLAN EXAMINER Will work require disturbing of any tree on a public street?
ZONING:
BUILDING CODE: O.K. N.E.C. Will there be in charge of the above work a person competent to see that the State and City requirements pertaining thereto are observed? yes
Fire Dept.:
Health Dept.:
Others:

Signature of Applicant Louis Profeno Phone #
Type Name of above 1 [] 2 [] 3 [x] 4 []
Other and Address

FIELD INSPECTOR'S COPY

1581450-NR

NOTES

Feb-19/75

Not started yet

Mar 25 / About half completed

Mar 26 - Progressing

April 3 / 75 About complete

4-4-75 Same

4-29-75 Completed: No

Permit No. 241191
Location 395 Puumass
Owner ARSSEUS BRENH
Date of permit 12/1/74
Approved

57

for

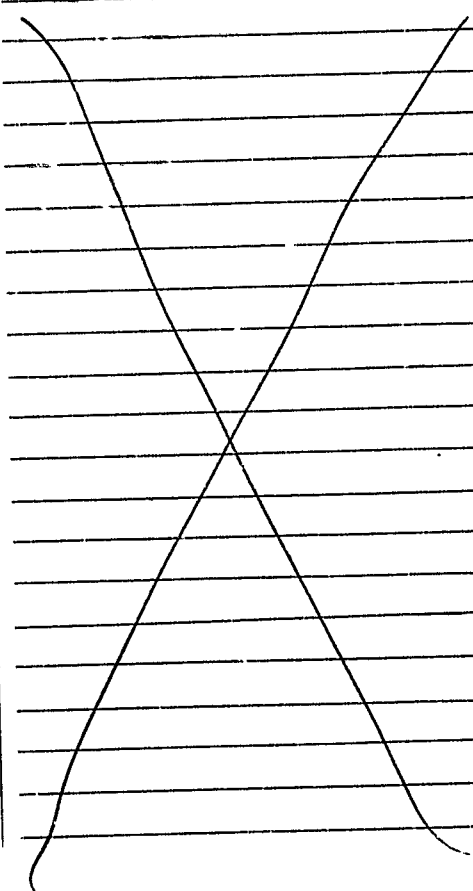

1
A
A

CITY OF PORTLAND, MAINE
FIRE DEPARTMENT



JOSEPH R. CREMO
CHIEF

FIRE PREVENTION BUREAU
380 CONGRESS STREET
PORTLAND, MAINE

11 December 1974

To: Office of Building Inspection

Permit approved provided: If tank is suspect to water problems, pad is to be installed. Fire Department is to be notified when hole is dug for inspection.

Herbert P. Miller
Herbert P. Miller, Captain
Fire Prevention Bureau

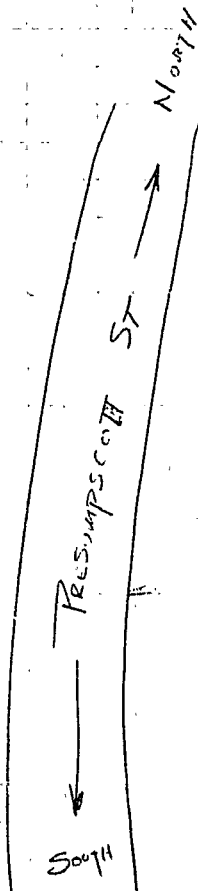

RECEIVED
DEC 9 1974
DEPT. OF BLDG. INSP.
CITY OF PORTLAND

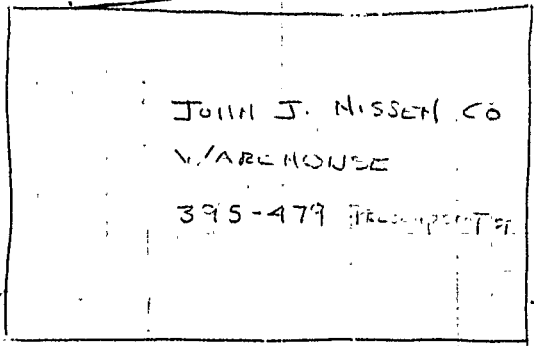

60' ±

12' ±

160' ±

18' ±
12' ±
3' ± Below F. Gino

Utility Line Approx 20' ± TO BLDG.

10' ±



APPLICATION FOR PERMIT

PERMIT ISSUED

DEC 17, 1974
1208

CITY of PORTLAND

B.O.C.A. USE GROUP
B.O.C.A. TYPE OF CONSTRUCTION
ZONING LOCATION _____ PORTLAND, MAINE, Dec. 9, 1974..

To the DIRECTOR OF BUILDING & INSPECTION SERVICES, PORTLAND, MAINE

The undersigned hereby applies for a permit to erect, alter, repair, demolish, move or install the following building, structure, equipment or change use in accordance with the Laws of the State of Maine, the Portland B.O.C.A. Building Code and Zoning Ordinance of the City of Portland with plans and specifications, if any, submitted herewith and the following specifications:

LOCATION 395-479 Presumpscot St. Fire District #1 , #2
1. Owner's name and address Nissen's Bakery Telephone
2. Lessee's name and address Telephone
3. Contractor's name and address L.A. Profeno, Co., 45 Curtis Rd. Telephone 797-3736...
4. Architect Specifications Plans Yes No. of sheets 2
Proposed use of building No. families
Last use No. families
Material No. stories Heat Style of roof Roofing
Other buildings on same lot
Estimated contractual cost \$ Fee \$ 15.00 not

FIELD INSPECTOR—Mr. Hugh Irving GENERAL DESCRIPTION

This application is for: @ 775-5451 To install underground tank - for #2 fuel oil
Dwelling Ext. 234 1000 gal. tank
Garage
Masonry Bldg.
Metal Bldg.
Alterations
Demolitions
Change of Use
Other
Stamp of Special Conditions
Sent to Fire Dept. 12/16/74
12/17/74

NOTE TO APPLICANT: Separate permits are required by the installers and subcontractors of heating, plumbing, electrical and mechanicals.

PERMIT IS TO BE ISSUED TO 1 2 3 4

Other:

DETAILS OF NEW WORK

Is any plumbing involved in this work? Is any electrical work involved in this work?
Is connection to be made to public sewer? If not, what is proposed for sewage?
Has septic tank notice been sent? Form notice sent?
Height average grade to top of plate Height average grade to highest point of roof
Size, front depth No. stories solid or filled land? earth or rock?
Material of foundation Thickness, top bottom cellar
Kind of roof Rise per foot Roof covering
No. of chimneys Material of chimneys of lining Kind of heat fuel
Lumber—Kind Dressed or full size? Corner posts Sills
Girders Columns under girders Size Max. on centers
Joists and rafters: 1st floor 2nd 3rd roof
On centers: 1st floor 2nd 3rd roof
Maximum span: 1st floor 2nd 3rd roof
If one story building with masonry walls, thickness of walls? height?

IF A GARAGE

No. cars now accommodated on same lot , to be accommodated . . . number commercial cars to be accommodated . . .
Will automobile repairing be done other than minor repairs to cars habitually stored in the proposed building?

APPROVALS BY: DATE MISCELLANEOUS
BUILDING INSPECTION—PLAN EXAMINER Will work require disturbing of any tree on a public street? ..
ZONING: ..
BUILDING CODE: Will there be in charge of the above work a person competent
Fire Dept. H. Miller, F.P.B. to see that the State and City requirements pertaining thereto
Health Dept.: are observed? Yes
Others:

Signature of Applicant Louis Profeno Phone # 797-3736
Type Name of above Louis Profeno 1 2 3 4

FIELD INSPECTOR'S COPY

RICHARD PROFENO
O.B. License # 600

Other
and Address

NOTES

12-14-74

Installed of back
Capped =
Carpenter had tied
down with cables

12/18/74

Checked this out
Today & OK if (w) Capt Miller
in the fire Dept

Permit No. 74/1208
Location 395-479 Provingport St
Owner Masonic Bakery
Date of permit 12-17-74
Approved _____
Hughr

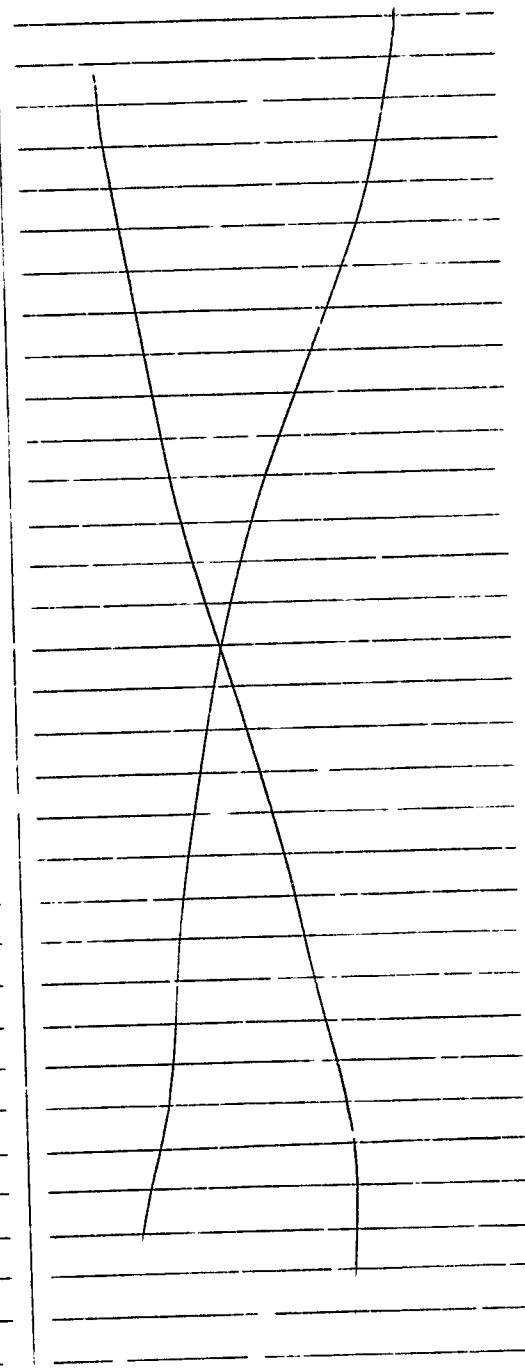

Redi-Letter

TRIP

FROM Portland Building Inspection Dept. City Hall Congress Street Portland, Maine	RETURN TO D.M. HARDY, INC. 46 Gray Road Falmouth, Maine
---	--

SUBJECT NISSEN BAKING COMPANY *395-479 Prescott St* DATE 9 / 20 / 74

MESSAGE

The Armco Metal Building is designed to withstand a live roof load of 40 lbs/SF.

The toilet rooms will be vented by that is not in out contract.

RETURN TO → SIGNED *M. Hardy*

REPLY

SIGNED _____ DATE 1 / 1

Rediform 4S 472 SEND PARTS 1 AND 3 WITH CARBON INTACT - PART 3 WILL BE RETURNED WITH REPLY.

CITY OF PORTLAND, MAINE
Application for Permit to Install Wires

Permit No. **2378**
 Issued **11/25/74**
 , 19

Portland, Maine

To the City Electrician, Portland, Maine:

The undersigned hereby applies for a permit to install wires for the purpose of conducting electric current, in accordance with the laws of Maine, the Electrical Ordinance of the City of Portland, and the following specifications:

(This form must be completely filled out — Minimum Fee, \$1.00)

Owner's Name and Address **Nisser's Bakery** Tel.
 Contractor's Name and Address **Allen Electric Co** Tel. **868-3111**
 Location **400 Presumpscot St** Use of Building **Storage**
 Number of Families **1** Stores **1** Number of Stories **1**
 Description of Wiring: New Work Additions Alterations

Pipe Cable Metal Molding BX Cable Plug Molding (No. of feet) ...
 No. Light Outlets Plugs Light Circuits Plug Circuits ...
 FIXTURES: No. Fluor. or Strip Lighting (No. feet) ...
 SERVICE: Pipe Cable Underground No. of Wires **4** Size **400A 500 mm**
 METERS: Relocated Added Total No. Meters **1**
 MOTORS: Number Phase H. P. Amps Volts Starter ...
 HEATING UNITS: Domestic (Oil) No. Motors Phase H.P. ...
 Commercial (Oil) No. Motors Phase H.P. ...
 Electric Heat (No. of Rooms)

APPLIANCES: No. Ranges Watts Brand Feeds (Size and No.) ...
 Elec. Heaters Watts
 Miscellaneous Watts Extra Cabinets or Panels
 Transformers Air Conditioners (No. Units) Signs (No. Units) **will call**
 Will commence 19 Ready to cover in 19 Inspection 19
 Amount of Fee \$ **4.00** Signed **Carol Allen**

DO NOT WRITE BELOW THIS LINE

SERVICE METER GROUND
 VISITS: **12-31-74** 3 4 5 6
 7 8 9 10 11 12

REMARKS: **Service called in good job** INSPECTED BY **Libby** (OVER)



APPLICATION FOR PERMIT

PERMIT ISSUED

B.O.C.A. USE GROUP
B.O.C.A. TYPE OF CONSTRUCTION

1151 NOV 25 1974

ZONING LOCATION PORTLAND, MAINE, NOV. 20, 1974

CITY OF PORTLAND

To the DIRECTOR OF BUILDING & INSPECTION SERVICES, PORTLAND, MAINE

The undersigned hereby applies for a permit to erect, alter, repair, demolish, move or install the following building, structure, equipment or change use in accordance with the Laws of the State of Maine, the Portland B.O.C.A. Building Code and Zoning Ordinance of the City of Portland with plans and specifications, if any, submitted herewith and the following specifications:

LOCATION: 400 Presumpscot St.

Fire District #1 #2

1. Owner's name and address: Nissen Baking Co

*11/26/74
Melson has been
here + says that
is o.k.
E.S.*

PERMIT ISSUED
NOV 25 1974
CITY OF PORTLAND
1151

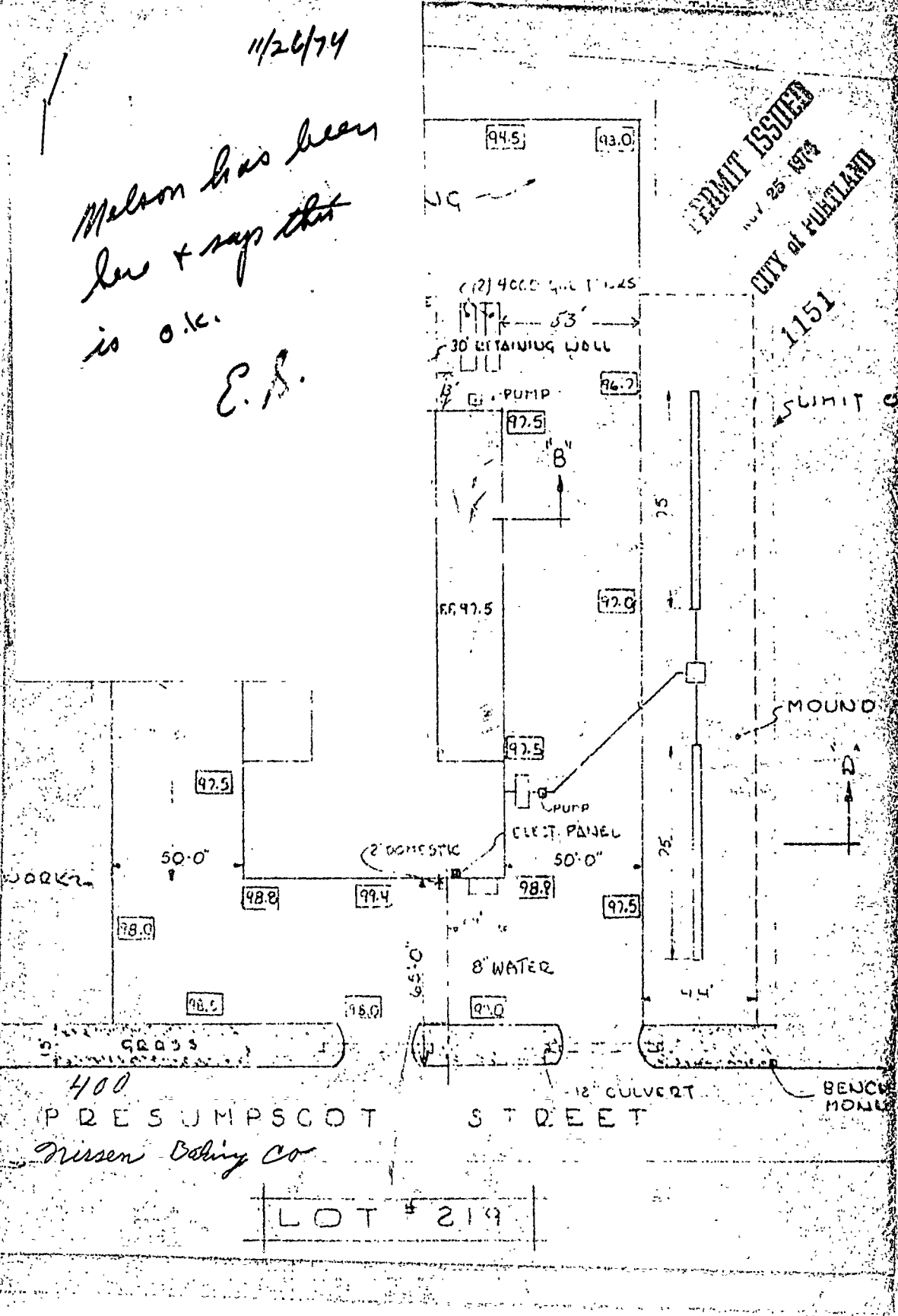

APPLICATION FOR PERMIT

PERMIT ISSUED

B.O.C.A. USE GROUP

B.O.C.A. TYPE OF CONSTRUCTION

1151 NOV 25 1974

ING LOCATION PORTLAND, MAINE, Nov. 20, 1974

CITY OF PORTLAND

RECTOR OF BUILDING & INSPECTION SERVICES, PORTLAND, MAINE

dersigned hereby applies for a permit to erect, alter, repair, demolish, move or install the following building, struc-
ment or change use in accordance with the Laws of the State of Maine, the Portland B.O.C.A. Building Code and
nance of the City of Portland with plans and specifications, if any, submitted herewith and the following specifica-

400 Presumpscot St.

Fire District #1 #2

me and address Nissen Bakery, same

75-9391

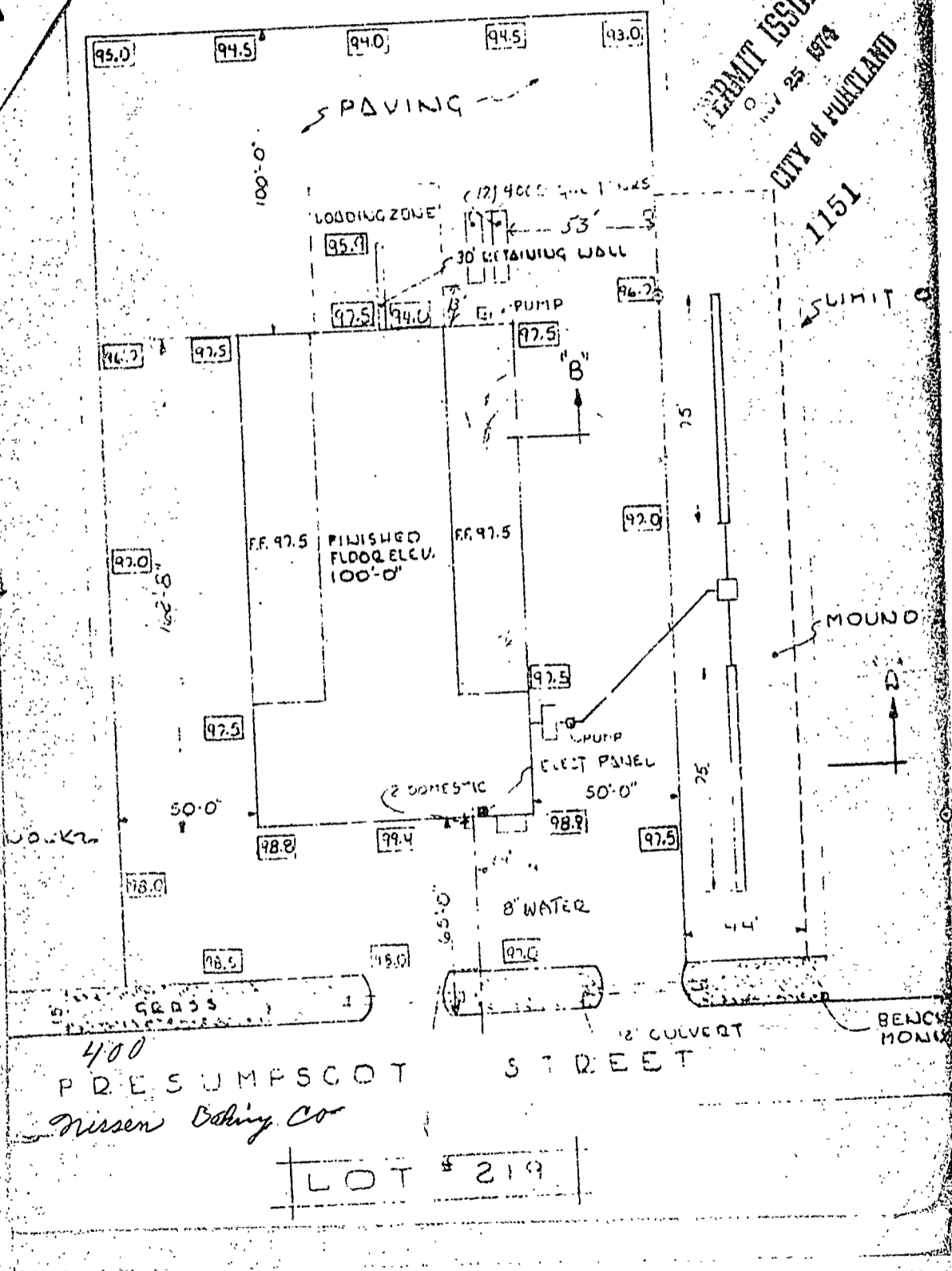



APPLICATION FOR PERMIT

PERMIT ISSUED

B.O.C.A. USE GROUP

B.O.C.A. TYPE OF CONSTRUCTION

1151 NOV 25 1974

BUILDING LOCATION: PORTLAND, MAINE, Nov. 20, 1974

CITY OF PORTLAND

DIRECTOR OF BUILDING & INSPECTION SERVICES, PORTLAND, MAINE

I, undersigned hereby applies for a permit to erect, alter, repair, demolish, move or install the following building, structure, or change use in accordance with the Laws of the State of Maine, the Portland B.O.C.A. Building Code and Ordinance of the City of Portland with plans and specifications, if any, submitted herewith and the following specifications:

400 Presumpscot St., Fire District #1 #2

Name and address Nissen Bakery, same Telephone

Name and address Telephone

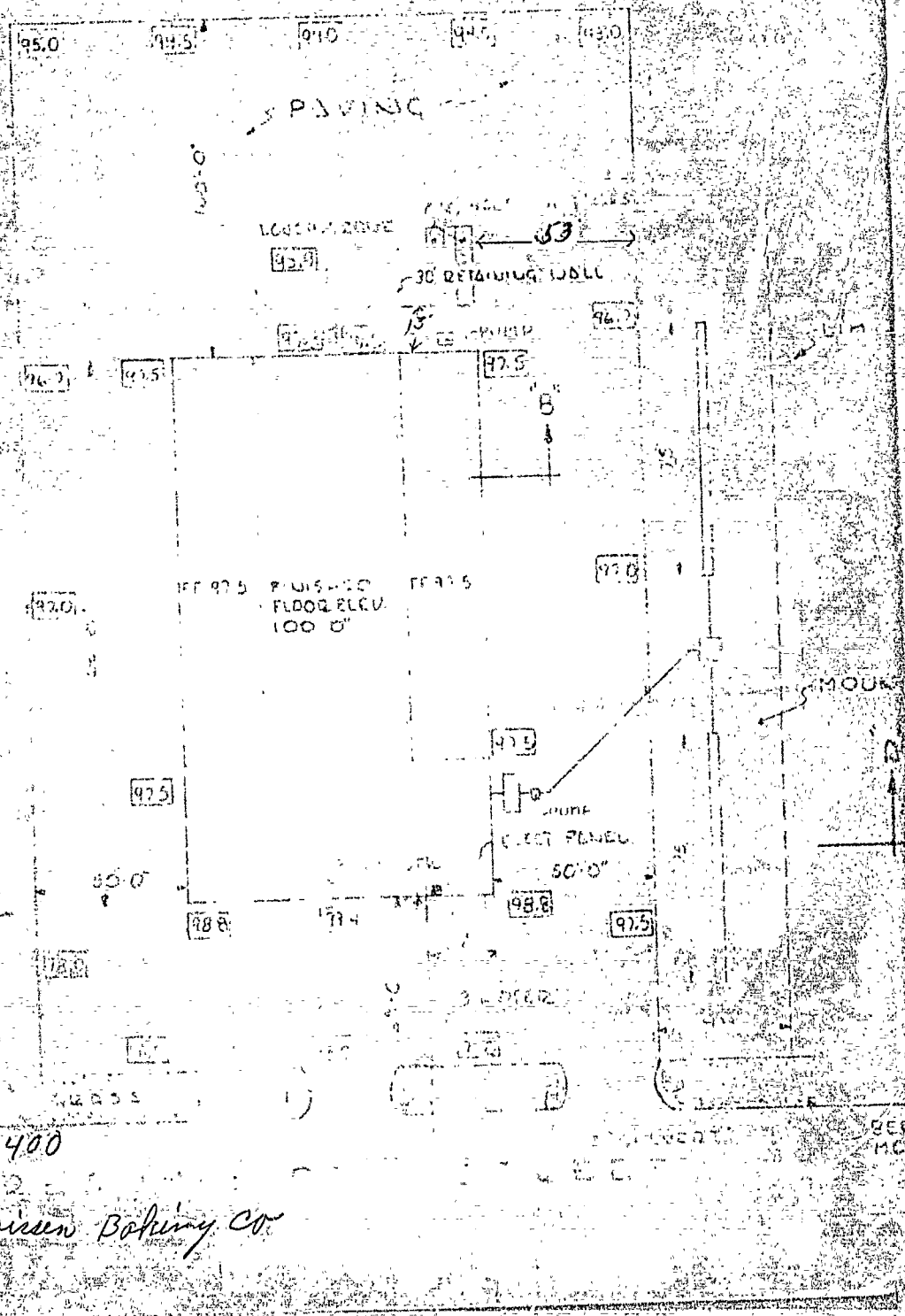



APPLICATION FOR PERMIT

B.O.C.A. USE GROUP

B.O.C.A. TYPE OF CONSTRUCTION

BUILDING LOCATION

PORTLAND, MAINE, Nov. 20, 1974

PERMIT ISSUED

1151 DEC 25 1974

CITY of PORTLAND

DIRECTOR OF BUILDING & INSPECTION SERVICES, PORTLAND, MAINE

I, undersigned hereby apply for a permit to erect, alter, repair, demolish, move or install the following building, structure, equipment or change use in accordance with the Laws of the State of Maine, the Portland B.O.C.A. Building Code and Ordinance of the City of Portland with plans and specifications, if any, submitted herewith and the following specifications:

40 Presumpscot St.
Name and address Nissen Bakery, same
Name and address
Contractor's name and address Portland Pump Co., 521 Lincoln St., So. Portland
Architect
Proposed use of building
Type of use
Material
Other buildings on same lot
Estimated contractual cost \$

Fire District #1 #2
Telephone
Telephone
Telephone 767-2468
Plans No of sheets
No families
No families
Style of roof
Roofing
Fee \$ 30.00

FIELD INSPECTOR—Mr. Hugh I. Rouse
This application is for:
Dwelling @ 775-5451 Ext. 234
Garage
Masonry Bldg.
Metal Bldg.
Alterations
Demolitions
Change of Use
Other

GENERAL DESCRIPTION
to install two 4,000 gal underground tanks both for gasoline.

Sent to Fire Dept 11/21/74
Rec'd from Fire Dept 11/25/74

Stamp of Special Conditions

NOTE TO APPLICANT: Separate permits are required by the installers and subcontractors of heating, plumbing, electrical and mechanicals.

PERMIT IS TO BE ISSUED TO 1 2 3 4
Other:

DETAILS OF NEW WORK

Is any plumbing involved in this work? Is any electrical work involved in this work?
Is connection to be made to public sewer? if not, what is proposed for sewage?
Has septic tank notice been sent? Form notice sent?
Height average grade to top of plate Height average grade to highest point of roof
Size, front depth No. stories solid or filled land? earth or rock?
Material of foundation Thickness, top bottom cellar
Kind of roof Rise per foot Roof covering
No. of chimneys Material of chimneys of lining Kind of heat fuel
Framing Lumber—Kind Dressed or full size? Corner posts Sills
Size Girder Columns under girders Size Max on centers
Studs (outside walls and carrying partitions) 2x4-16" O. C. Bridging in every floor and flat roof span over 8 feet.
Joists and rafters: 1st floor 2nd 3rd roof
On centers: 1st floor 2nd 3rd roof
Maximum span: 1st floor 2nd 3rd roof
If one story building with masonry walls, thickness of walls? height?

IF A GARAGE

No. cars now accommodated on same lot to be accommodated number commercial cars to be accommodated
Will automobile repairing be done other than minor repairs to cars habitually stored in the proposed building?

APPROVALS BY: DATE 11/21/74 MISCELLANEOUS
BUILDING INSPECTION—PLAN EXAMINER Will work require disturbing of any tree on a public street?
ZONING:
BUILDING CODE: O.K. N.F.C. 11/25/74
Fire Dept. H. H. Kelly, Jr. F.P.S. Will there be in charge of the above work a person competent to see that the State and City requirements pertaining thereto are observed? yes
Health Dept.:
Others:

Signature of Applicant Roger Hubert Phone #
Type Name of above Roger HUBERT Hubert 1 2 3 4

FIELD INSPECTOR'S COPY

Character and Address

NOTES

12-13-74

Installed back
filled in 72
Contractor said they were
inspected by fire dept

Permit No. 711151
Location 400 PUESUMSCOTT ST
Owner NISSAN BAKERY
Date of permit 11/26/74
Approved

Handwritten initials

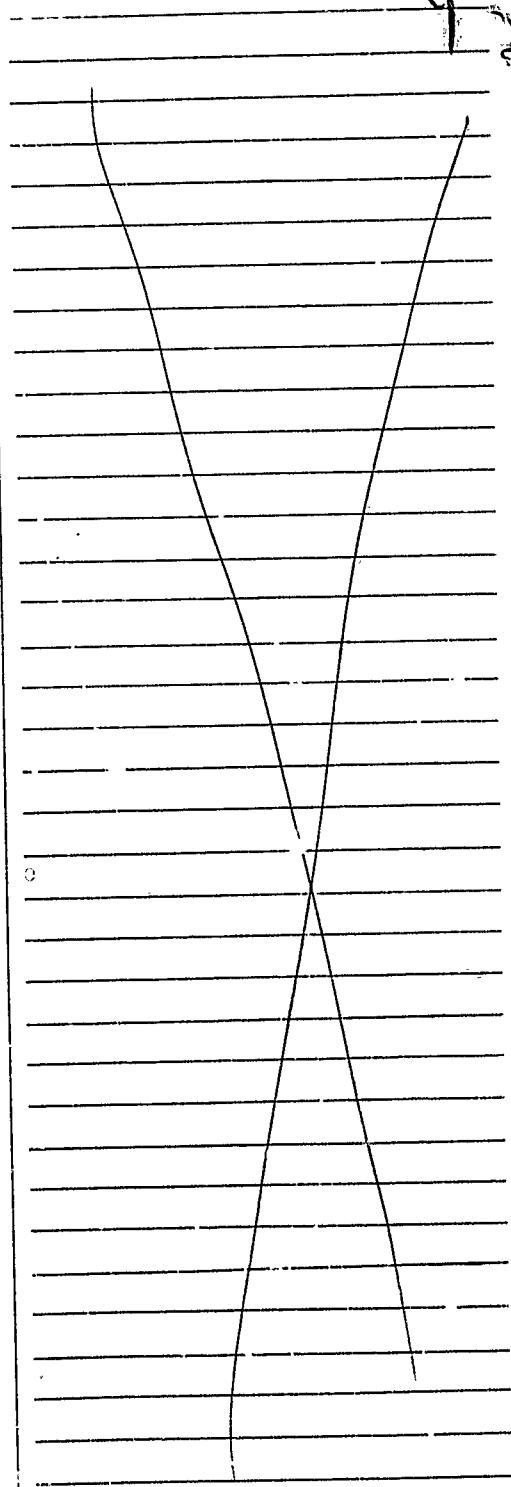

(COPY)



CITY OF PORTLAND, MAINE
Department of Building Inspection

Certificate of Occupancy

LOCATION 395-479 Presumscott St.

Issued to **Nissen Baking Company**

Date of Issue **April 30, 1975**

This is to certify that the building, premises, or part thereof, at the above location, built—altered—changed as to use under Building Permit No. **71/875**, has had final inspection, has been found to conform substantially to requirements of Zoning Ordinance and Building Code of the City, and is hereby approved for occupancy or use, limited or otherwise, as indicated below.

PORTION OF BUILDING OR PREMISES
entire

APPROVED OCCUPANCY
distribution center.

Limiting Conditions:

none

This certificate supersedes
certificate issued

Approved:

4/30/75

(Date)

Inspector

Inspector of Buildings

Notice: This certificate identifies lawful use of building or premises, and ought to be transferred from owner to owner when property changes hands. Copy will be furnished to owner or lessee for one dollar.



APPLICATION FOR PERMIT

B.O.C.A. USE GROUP

B.O.C.A. TYPE OF CONSTRUCTION

ZONING LOCATION PORTLAND, MAINE, August 19, 1974

PERMIT
ST: 17 570
CITY OF PORTLAND

To the DIRECTOR OF BUILDING & INSPECTION SERVICES, PORTLAND, MAINE

The undersigned hereby applies for a permit to erect, alter, repair, demolish, move or install the following building, structure, equipment or change use in accordance with the Laws of the State of Maine, the Portland B.O.C.A. Building Code and Zoning Ordinance of the City of Portland with plans and specifications, if any, submitted herewith and the following specifications:

LOCATION 395-479 249 Presuncott St
1. Owner's name and address Nissen Baking Co, Presuncott St. Fire District #1, #2
2. Lessee's name and address Telephone
3. Contractor's name and address D.M. Hardy Inc., Falmouth, Maine Telephone 797-5630
4. Architect Specifications Plans Yes No. of sheets 8
Proposed use of building distribution center No families
Last use No families
Material metal No. stories 1 Heat Style of roof pitch Roofing
Oth. buildings on same lot none
Estimated contractual cost \$ 152,000.00 Fee \$ 608.00

FIELD INSPECTOR—Mr. Hugh Irving GENERAL DESCRIPTION

This application is for: @ 775-5451
Dwelling Ext. 234 to construct a 100' x 162' metal distribution building per plan.

Garage
Masonry Bldg.
Metal Bldg.
Alterations
Demolitions
Change of Use
Other

PERMIT ISSUED WITH LETTER

Stamp of Special Conditions (PLAN FILED IN OTHER ROOM)

NOTE TO APPLICANT: Separate permits are required by the installers and subcontractors of heating, plumbing, electrical and mechanicals.

PERMIT IS TO BE ISSUED TO 1 2 3 4
Other:

DETAILS OF NEW WORK

Is any plumbing involved in this work? YES Is any electrical work involved in this work? YES
Is connection to be made to public sewer? NO If not, what is proposed for sewage? mound sewerage system
ptic tank notice been sent? YES Form notice sent? YES
Height average grade to top of plate Height average grade to highest point of roof
depth No. stories solid or filled land? earth or rock?
Material of foundation Thickness, top bottom cellar
Kind of roof Rise per foot Roof covering
No. of chimneys Material of chimneys of lining Kind of heat fuel
Framing Lumber—Kind Dressed or full size? Corner posts Sills
Size Girder Columns under girders Size Max. on centers
Studs (outside walls and carrying partitions) 2x4-16" O. C. Bridging in every floor and flat roof span over 8 feet.
Joists and rafters: 1st floor 2nd 3rd roof
On centers: 1st floor 2nd 3rd roof
Maximum span: 1st floor 2nd 3rd roof
If one story building with masonry walls, thickness of walls? height?

IF A GARAGE

No. cars now accommodated on same lot to be accommodated . . . number commercial cars to be accommodated . . .
Will automobile repairing be done other than minor repairs to cars habitually stored in the proposed building?

APPROV. LS BY: DATE
BUILDING INSPECTION—PLAN EXAMINER
ZONING: OK 9/10/74
BUILDING CODE: OK 9/15/74
Fire Dept.:
Health Dept.:
Others:

MISCELLANEOUS

Will work require disturbing of any tree on a public street? NO
Will there be in charge of the above work a person competent to see that the State and City requirements pertaining thereto are observed? YES

Signature of Applicant David M. Hardy Phone # 797-5630
Type Name of above David M. Hardy 1 2

DR'S COPY

Other and Address

NOTES

Permit No. 741575
 Location 395-479 Greenway
 Owner Mason Building Co.
 Date of permit 9/19/74
 Approved

- 9-23-74 Clearing the lot - boring feet going on. Hu
- 9-30-74 About the same location of building yet to be staked out. Hu
- 10-15-74 Started the footing - side lines all staked out - appears to be going according to plan.
- 10-17-74 Progressing according to plan. Hu
- 10-23-74 " " " "
- 10-24-74 + First End of foundation ready for pouring. (OK to proceed)
- 10-28-74 - Footing being poured & formwork going up for foundation.
- 10-29-74 - Footing all poured, foundation forms continuing according to plan.
- 11-5-74 Casting according to plan - ledge approx. 1/3 completed.
- 12-11-74 Gaff according to plan.
- 12-16-74 " " " "
- 12-17-74 " " " "
- 12-18-74 " " " "
- Jan 6/75 " " " "
- Jan 17/75 " " " " , about completed on the inside.
- Feb 19/75 A lot of detail to be completed.
- Mar 3/75 " " " " Same
- Mar 5/75 Slabs - Mar 10 - Same
- Mar 25/75 About completed inside - another 2 to 4 weeks should finish up everything.
- Mar 26/75 stopped by per of OK on the over work.
- Exit signs are not up yet, most everything else is completed. Added some partitions.
- Exit signs installed - Completed according to plan.

Has 3rd Floor St

to record 4/30/75
 Rus

CITY OF PORTLAND, MAINE
MEMORANDUM

TO: Earle Smith, Building Inspection Department
FROM: John R. Kennedy, Department of Public Works
SUBJECT: Site Plan Review
Nissen Baking Company
Lot No. 219 Presumpscot Street

DATE: 9-17-74

This Department gives approval of the above site plan dependent upon the following conditions:

1. That the mound sewerage system be reviewed and approved by the City's plumbing inspector for compliance with the State Plumbing Code, Section 2: Private Sewerage Disposal Code (MRSA Title 22, Section 42(3)).
2. That sidewalks and curbing be provided as set forth in Municipal Code, Chapter 705, Sidewalk Construction and Maintenance, Section 705.1 or that a waiver be obtained as specified in Section 705.4 (copies attached).

JOHN R. KENNEDY
ASSOCIATE ENGINEER II
PUBLIC WORKS DEPARTMENT

JRK/dmd

ATTACHMENTS

**CITY OF PORTLAND, MAINE
SITE PLAN REVIEW**

Processing Form

Applicant D. M. HARDY Date 9/17/74
 Mailing Address 46 GRAY RD Address of Proposed Site 395-479 PRESUMPSCOOT ST.
DIST. CENTER Site Identifier(s) from Assessors Maps 419-4-2 & 420-A-5
 Proposed Use of Site R/G, 200 Zoning of Proposed Site Z-2
 Acreage of Site / Ground Floor Coverage _____

Site Location Review (DEP) Required: () Yes () No
 Board of Appeals Action Required: () Yes () No
 Planning Board Action Required: () Yes () No
 Proposed Number of Floors 1
 Total Floor Area 16000

Other Comments: _____
 Date Dept. Review Due: _____

PLANNING DEPARTMENT REVIEW Sept 16, 1974
 (Date Received)

- Major Development — Requires Planning Board Approval: Review Initiated
- Minor Development — Staff Review Below

	LOADING AREA	PARKING	CIRCULATION PATTERN	ACCESS	PEDESTRIAN WALKWAYS	SCREENING	LANDSCAPING	SPACE & BULK OF STRUCTURES	LIGHTING	CONFLICT WITH CITY PROJECTS	FINANCIAL CAPACITY	CHANGE IN SITE PLAN
APPROVED	X	X	X	X	X	X	X	X	N.R.	X	N.R.	N.R.
APPROVED CONDITIONALLY												
DISAPPROVED												

REASONS: * Not required in minor developments.

(Attach Separate Sheet if Necessary)

Serald A. Koltunoff
 SIGNATURE OF REVIEWING STAFF/DATE

PLANNING DEPARTMENT COPY

CITY OF PORTLAND, MAINE
DEPARTMENT OF BUILDING INSPECTION

NOTICE RELATING TO SEWAGE DISPOSAL

x means copy sent to the parties
Date September 10, 1974
Location 395-479 Presumscot St.
419 A2 & 420 A5 Description _____

Owner and Address Nissens's Bakery

Contractor and Address M.D. Hardy, Falmouth, Maine

Actual Area of Lot _____ Sq. Ft. Zone _____

Area required by Zoning Ord. if sewer were available _____

Where septic tank systems are required for sewage disposal, the Zoning Ordinance provides that the least allowable area of the lot shall be determined by the rate of percolation of the soil, this being the capacity of the soil to allow liquids to pass through as determined by tests. The Building Code directs that, where a septic tank is to be used, a building permit shall not be issued unless the proposed method of sewage disposal has been approved by the Director of Health.

Since application for the above permit indicates that connection to a sewer is not possible, it is necessary for the owner or his agent to file a site plan with the Health Department, to explain the method of sewage disposal proposed, and to make arrangements for a percolation test to be made under supervision of that department.

After the rate of percolation has been determined, the Director of Health will notify this department of the area of lot required on the basis of the results of the test. If the lot area required by the tests is equal to or less than the actual area of the lot and not less than the minimum lot area required in the zone in which the property is located for cases where connection to a sewer is available, the building permit can be issued; otherwise the permit cannot be issued unless authorization is secured from the Board of Appeals.

Director of Building & Inspections

2 copies to Health Director

(This space for Health Department use)

Inspector of Buildings

Rate of Percolation is OVER minutes. On this basis area required by
Zoning Ordinance is _____ sq. feet.

Comments in event zoning appeal is filed: _____

SEP 11 1974

This lot has a
designed private sewerage
disposal system as required
by the new State Plumbing
Code & test was performed by

Soils Engineer so recognized
by the State Dept of H. & M.

Therefore permit to
install may be issued

ERNOLD R. GOODWIN
CHIEF PLUMBING INSPECTOR

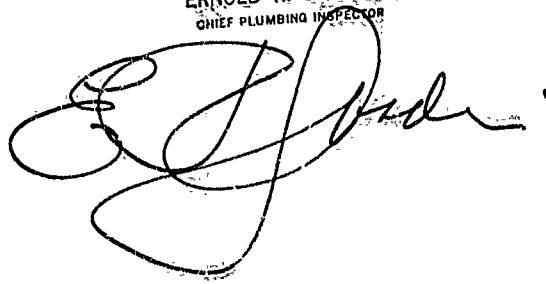

CITY OF PORTLAND, MAINE
SITE PLAN REVIEW
 Processing Form

Applicant: Mr. Hardy Date: 9/10/74
 Mailing Address: 16 Gray Road Address of Proposed Site: 219 Presumscott St.
 Proposed Use of Site: Palmouth Site Identifier(s) from Assessors Maps: _____
 Acreage of Site / Ground Floor Coverage: _____ Zoning of Proposed Site: _____
 Site Location Review (DEP) Required: () Yes () No Proposed Number of Floors: _____
 Board of Appeals Action Required: () Yes () No Total Floor Area: _____
 Planning Board Action Required: () Yes () No
 Other Comments: _____
 Date Dept. Review Due: _____

PUBLIC WORKS DEPARTMENT REVIEW

Sept 16 74
 (Date Received)

	TRAFFIC CIRCULATION	ACCESS	CURB CUTS	ROAD WIDTH	PARKING	SIGNALIZATION	TURNING MOVEMENTS	LIGHTING	CONFLICT WITH CITY CONSTRUCTION PROJECT	DRAINAGE	SOIL TYPES	SEWERS	CURBING	SIDEWALKS	OTHER	
APPROVED	/	/	/	/	/	/	/	/	/	/	/	/	/	/	/	CONDITIONS SPECIFIED BELOW REASONS SPECIFIED BELOW
APPROVED CONDITIONALLY																
DISAPPROVED																

REASONS: SEE MEMO ATTACHED

(Attach Separate Sheet if Necessary)

John R. Kennedy 17 Sept 74
 SIGNATURE OF REVIEWING STAFF/DATE

PUBLIC WORKS DEPARTMENT COPY

CITY OF PORTLAND, MAINE

SITE PLAN REVIEW

Processing Form

7/30/74

_____ Date _____

_____ Address of Proposed Site _____

_____ Mailing Address _____ Site Identifier(s) from Assessors Maps _____

_____ Proposed Use of Site _____ Zoning of Proposed Site _____

_____ Acreage of Site / Ground Floor Coverage _____

Site Location Review (DEP) Required: () Yes () No Proposed Number of Floors _____

Board of Appeals Action Required: () Yes () No Total Floor Area _____

Planning Board Action Required: () Yes () No

Other Comments: _____

Date Dept. Review Due: _____

FIRE DEPARTMENT REVIEW

(Date Received) _____

	ACCESS TO SITE	ACCESS TO STRUCTURES	SUFFICIENT VEHICLE TURNING ROOM	SAFETY HAZARDS	HYDRANTS	SIAMOSE CONNECTIONS	SUFFICIENCY OF WATER SUPPLY	OTHER	
APPROVED									CONDITIONS SPECIFIED BELOW
APPROVED CONDITIONALLY									
DISAPPROVED	X				X		X	X	REASONS SPECIFIED BELOW

REASONS: Insufficient information

9/18/74
 Mancuso says
 O.K.
 E.P.S.

(Attach Separate Sheet if Necessary)

FORWARDED BY

REC'D 9-10-74

RETURNED

BY

Vincent Mancuso
 SIGNATURE OF REVIEWING STAFF/DATE

FIRE DEPARTMENT COPY

ROUTING SLIP FROM:
DEPARTMENT OF BUILDING AND INSPECTION SERVICES

ADDRESS 219 Presumscott

Date 8/19/74

FIRE DEPARTMENT — DIST BLDG

PLANNING BOARD

RENEWAL

MAINE WAY

PUBLIC WORKS

HEALTH

OTHERS

APPROVED

H Miller F.P.B.

DISAPPROVED BY REASON OF:
(quote section of pertinent ordinance or other governing factors)

SPECIAL COMMENTS: 21 August 1974

Site Plan only - approved.

PORTLAND FIRE DEPT.
REC'D. 19 August 74
RETURNED 20 August 74
BY _____

KEEP SECOND COPY AND RETURN ORIGINAL TO BUILDING & INSPECTIONS