

1181-1183 WASHINGTON Ave.

**CITY OF PORTLAND, MAINE**  
**Application for Permit to Install Wires**

Permit No. 53995

Issued  
 Portland, Maine 6/29/15, 19

To the City Electrician, Portland, Maine:

The undersigned hereby applies for a permit to install wires for the purpose of conducting electric current, in accordance with the laws of Maine, the Electrical Ordinance of the City of Portland, and the following specifications:

(This form must be completely filled out — Minimum Fee, \$1.00)

Owner's Name and Address Buttignol Tel. \_\_\_\_\_

Contractor's Name and Address John 249 Tel. \_\_\_\_\_

Location 1183 Washington Use of Building \_\_\_\_\_

Number of Families \_\_\_\_\_ Apartments \_\_\_\_\_ Stores \_\_\_\_\_ Number of Stories \_\_\_\_\_

Description of Wiring: New Work Additions \_\_\_\_\_ Alterations \_\_\_\_\_

Aluminum Steel

Pipe \_\_\_\_\_ Cable \_\_\_\_\_ Metal Molding \_\_\_\_\_ BX Cable \_\_\_\_\_ Plug Molding (No. of feet) \_\_\_\_\_

No. Light Outlets \_\_\_\_\_ Plugs \_\_\_\_\_ Light Circuits \_\_\_\_\_ Plug Circuits \_\_\_\_\_

FIXTURES: No. \_\_\_\_\_ Light Switches \_\_\_\_\_ Fluor. or Strip Lighting (No. feet) \_\_\_\_\_

SERVICE: Pipe \_\_\_\_\_ Cable \_\_\_\_\_ Underground \_\_\_\_\_ No. of Wires \_\_\_\_\_ Size \_\_\_\_\_

METERS: Relocated \_\_\_\_\_ Added \_\_\_\_\_ Total No. Meters \_\_\_\_\_

MOTORS: Number \_\_\_\_\_ Phase \_\_\_\_\_ H. P. \_\_\_\_\_ Amps \_\_\_\_\_ Volts \_\_\_\_\_ Starter \_\_\_\_\_

HEATING UNITS: Domestic (Oil) \_\_\_\_\_ No. Motors \_\_\_\_\_ Phase \_\_\_\_\_ H.P. \_\_\_\_\_

Commercial (Oil) \_\_\_\_\_ No. Motors \_\_\_\_\_ Phase \_\_\_\_\_ H.P. \_\_\_\_\_

Electric Heat (No. of Rooms) \_\_\_\_\_

APPLIANCES: No. Ranges \_\_\_\_\_ Watts \_\_\_\_\_ Brand Feeds (Size and No.) \_\_\_\_\_

Elec. Heaters \_\_\_\_\_ Watts \_\_\_\_\_

Miscellaneous \_\_\_\_\_ Watts \_\_\_\_\_ Extra Cabinets or Panels \_\_\_\_\_

Transformers \_\_\_\_\_ Air Conditioners (No. Units) \_\_\_\_\_ Signs (No. Units) \_\_\_\_\_

Will commence \_\_\_\_\_ 19 \_\_\_\_\_ Ready to cover in \_\_\_\_\_ 19 \_\_\_\_\_ Inspection \_\_\_\_\_ 19 \_\_\_\_\_

Amount of Fee \$ 1.00

Signed A. Kelly

DO NOT WRITE BELOW THIS LINE

SERVICE  METER \_\_\_\_\_ GROUND

VISITS: 1 \_\_\_\_\_ 2 \_\_\_\_\_ 3 \_\_\_\_\_ 4 \_\_\_\_\_ 5 \_\_\_\_\_ 6 \_\_\_\_\_  
 7 \_\_\_\_\_ 8 \_\_\_\_\_ 9 \_\_\_\_\_ 10 \_\_\_\_\_ 11 \_\_\_\_\_ 12 \_\_\_\_\_

REMARKS:

INSPECTED BY J.W. Anderson  
 (OVER)

LOCATION Wash. Av. 1183  
 INSPECTION DATE 6/29/65  
 WORK COMPLETED 6/29/65  
 TOTAL NO. INSPECTIONS 1  
 REMARKS:

FEEES FOR WIRING PERMITS EFFECTIVE JULY 31, 1963

<b>WIRING</b>		
1 to 30 Outlets	(including switches)	\$ 2.00
31 to 60 Outlets	(including switches)	3.00
Over 60 Outlets, each Outlet	(including switches)	.05
(Each twelve feet or fraction thereof of fluorescent lighting or any type of plug molding will be classed as one outlet).		
<b>SERVICES</b>		
Single Phase		2.00
Three Phase		4.00
<b>MOTORS</b>		
Not exceeding 50 H.P.		3.00
Over 50 H.P.		4.00
<b>HEATING UNITS</b>		
Domestic (Oil)		2.00
Commercial (Oil)		4.00
Electric Heat (Each Room)		.75
<b>APPLIANCES</b>		
Ranges, Cooking Tops, Ovens, Water Heaters, Disposals, Dish-washers, etc. — Each Unit		1.50
<b>TEMPORARY WORK (limited to 6 months from date of permit)</b>		
Service, Single Phase		1.00
Service, Three Phase		2.00
Wiring, 1-50 Outlets		1.00
Wiring, each additional outlet over 50		.02
Circuses, Carnivals, Fairs, etc.		10.00
<b>MISCELLANEOUS</b>		
Distribution Cabinet or Panel, per unit		1.00
Transformers, per unit		2.00
Air Conditioners, per unit		2.00
Signs, per unit		2.00
<b>ADDITIONS</b>		
5 Outlets, or less		1.00
Over 5 Outlets, Regular Wiring Rates		

# CITY OF PORTLAND, MAINE

## Application for Permit to Install Wires

Permit No. 53995

Issued 6/29/19  
 Portland, Maine 19

To the City Electrician, Portland, Maine:

The undersigned hereby applies for a permit to install wires for the purpose of conducting electric current, in accordance with the laws of Maine, the Electrical Ordinance of the City of Portland, and the following specifications:

(This form must be completely filled out — Minimum Fee, \$1.00)

Owner's Name and Address Bentley Tel. ....  
 Contractor's Name and Address John S. M. Co. Tel. ....  
 Location 1183 Washington Use of Building .....

Number of Families ..... Apartments ..... Stores ..... Number of Stories .....

Description of Wiring: New Work ..... Additions ..... Alterations .....

Pipe ..... Cable ..... Metal Molding ..... BX Cable ..... Plug Molding (No. of feet) .....

No. Light Outlets ..... Plugs ..... Light Circuits ..... Plug Circuits .....

FIXTURES: No. .... Light Switches ..... Fluor. or Strip Lighting (No. feet) .....

SERVICE: Pipe ..... Cable ..... Underground ..... No. of Wires ..... Size .....

METERS: Relocated ..... Added ..... Total No. Meters .....

MOTORS: Number ..... Phase ..... H. P. .... Amps ..... Volts ..... Starter .....

HEATING UNITS: Domestic (Oil) ..... No. Motors ..... Phase ..... H.P. ....  
 Commercial (Oil) ..... No. Motors ..... Phase ..... H.P. ....  
 Electric Heat (No. of Rooms) .....

APPLIANCES: No. Ranges ..... Watts ..... Brand Feeds (Size and No.) .....

          Elec. Heaters ..... Watts .....

          Miscellaneous ..... Watts ..... Extra Cabinets or Panels .....

Transformers ..... Air Conditioners (No. Units) ..... Signs (No. Units) .....

Will commence ..... 19..... Ready to cover in ..... 19..... Inspection ..... 19.....

Amount of Fee \$ 1.00

Signed A. Wells

DO NOT WRITE BELOW THIS LINE

SERVICE  METER ..... GROUND

VISITS: 1 ..... 2 ..... 3 ..... 4 ..... 5 ..... 6 .....

          7 ..... 8 ..... 9 ..... 10 ..... 11 ..... 12 .....

REMARKS:

INSPECTED BY F. W. Huber  
 (OVER)

PERMIT TO INSTALL PLUMBING

15237

PERMIT NUMBER

Date Issued: 5/26/65  
 PORTLAND PLUMBING INSPECTOR

Address: 1107 Washington Ave.  
 Installation For: Ralph Arnold  
 Owner of Bldg. Same  
 Owner's Address: Same  
 Plumber: Hayden Katz  
 Date: 5/26/65

By: J. J. Walsh  
 APPROVED FIRST INSPECTION

Date: 6/21/65

By: [Signature]  
 APPROVED FINAL INSPECTION

Date: 6/21/65

By: [Signature]  
 TYPE OF BUILDING  
 COMMERCIAL  
 RESIDENTIAL  
 SINGLE  
 MULTI FAMILY  
 NEW CONSTRUCTION  
 REMODELING

NEW	REPL.	PROPOSED INSTALLATIONS	NUMBER	FEES
1	✓	SINKS	1	\$2.00
1	✓	LAVATORIES	1	2.00
1	✓	TOILETS	1	2.00
1	✓	BATH TUBS	1	2.00
		SHOWERS		
		DRAINS		
		HOT WATER TANKS		
		TANKLESS WATER HEATERS		
		GARBAGE GRINDERS - g/w/c		
		SEPTIC TANKS		
		HOUSE SEWERS		
		ROOF LEADERS (Conn. to house drain)		

PORTLAND HEALTH DEPT. PLUMBING INSPECTION TOTAL ▶ \$4.00

# CITY OF PORTLAND, MAINE

## Application for Permit to Install Wires

Permit No. 53908

Issued .....

Portland, Maine .. 5/20/05 .., 19.....

To the City Electrician, Portland, Maine:

The undersigned hereby applies for a permit to install wires for the purpose of conducting electric current, in accordance with the laws of Maine, the Electrical Ordinance of the City of Portland, and the following specifications:

*(This form must be completely filled out — Minimum Fee, \$1.00)*

Owner's Name and Address ..... Tel. ....

Contractor's Name and Address Bellamy & Co ..... Tel. ....

Location 1183 Washington St Use of Building .....

Number of Families ..... Apartments ..... Stores ..... Number of Stories .....

Description of Wiring: New Work ..... Additions ..... Alterations .....

Pipe ..... Cable ..... Metal Molding ..... BX Cable ..... Plug Molding (No. of feet) .....

No. Light Outlets 8 Plugs 21 Light Circuits ..... Plug Circuits .....

FIXTURES: No. .... Light Switches ..... Fluor. or Strip Lighting (No. feet) .....

SERVICE: Pipe ..... Cable ..... Underground ..... No. of Wires ..... Size .....

METERS: Relocated ..... Added ..... Total No. Meters .....

MOTORS: Number ..... Phase ..... H. P. .... Amps ..... Volts ..... Starter .....

HEATING UNITS: Domestic (Oil) ..... No. Motors ..... Phase ..... H.P. ....

Commercial (Oil) ..... No. Motors ..... Phase ..... H.P. ....

Electric Heat (No. of Rooms) .....

APPLIANCES: No. Ranges ..... Watts ..... Brand Feeds (Size and No.) .....

Elec. Heaters ..... Watts .....

Miscellaneous ..... Watts ..... Extra Cabinets or Panels .....

Transformers ..... Air Conditioners (No. Units) ..... Signs (No. Units) .....

Will commence ..... 19..... Ready to cover in ..... 19..... Inspection ..... 19.....

Amount of Fee \$.....

Signed [Signature]

DO NOT WRITE BELOW THIS LINE

SERVICE ..... METER ..... GROUND .....

VISITS: 1 ..... 2 ..... 3 ..... 4 ..... 5 ..... 6 .....

..... 7 ..... 8 ..... 9 ..... 10 ..... 11 ..... 12 .....

REMARKS:

INSPECTED BY [Signature]  
(OVER)

34  
1183

LOCATION Wash. Ave 1183

INSPECTION DATE 5/21/65

WORK COMPLETED 5/21/65

TOTAL NO. INSPECTIONS 2

REMARKS:

FEES FOR WIRING PERMITS EFFECTIVE JULY 31, 1963

WIRING

1 to 30 Outlets	(including switches)	\$ 2.00
31 to 60 Outlets	(including switches)	3.00
Over 60 Outlets, each Outlet	(including switches)	.05

(Each twelve feet or fraction thereof of fluorescent lighting or any type of plug molding will be classed as one outlet).

SERVICES

Single Phase	2.00
Three Phase	4.00

MOTORS

Not exceeding 50 H.P.	3.00
Over 50 H.P.	4.00

HEATING UNITS

Domestic (Oil)	2.00
Commercial (Oil)	4.00
Electric Heat (Each Room)	.75

APPLIANCES

Ranges, Cooking Tops, Ovens, Water Heaters, Disposals, Dishwashers, etc. — Each Unit	1.50
--	------

TEMPORARY WORK (Limited to 6 months from date of permit)

Service, Single Phase	1.00
Service, Three Phase	2.00
Wiring, 150 Outlets	1.00
Wiring, each additional outlet over 50	.02
Circuses, Carnivals, Fairs, etc.	10.00

MISCELLANEOUS

Distribution Cabinet or Panel, per unit	1.00
Transformers, per unit	2.00
Air Conditioners, per unit	2.00
Signs, per unit	2.00

ADDITIONS

5 Outlets, or less	1.00
Over 5 Outlets, Recycle Wiring Rates	1.00

*Ready*

CITY OF PORTLAND, MAINE  
Application for Permit to Install Wires

Permit No. *53860*

Issued *May 9*, 19*55*

Portland, Maine

To the City Electrician, Portland, Maine:

The undersigned hereby applies for a permit to install wires for the purpose of conducting electric current, in accordance with the laws of Maine, the Electrical Ordinance of the City of Portland, and the following specifications:

(This form must be completely filled out — Minimum Fee, \$1.00)

Owner's Name and Address *Bathurst* Tel. ....

Contractor's Name and Address *William E. ...* Tel. ....

Location *118 3/4 Washington Ave* Use of Building .....

Number of Families ..... Apartments ..... Stores ..... Number of Stories .....

Description of Wiring: New Work ..... Additions ..... Alterations .....

*Fluor. Service*

Pipe ..... Cable ..... Metal Molding ..... BX Cable ..... Plug Molding (No. of feet) .....

No. Light Outlets ..... Plugs ..... Light Circuits ..... Plug Circuits .....

FIXTURES: No. .... Light Switches ..... Fluor. or Strip Lighting (No. feet) .....

SERVICE: Pipe ..... Cable ..... Underground ..... No. of Wires ..... Size .....

METERS: Relocated ..... Added ..... Total No. Meters .....

MOTORS: Number ..... Phase ..... H. P. .... Amps ..... Volts ..... Starter .....

HEATING UNITS: Domestic (Oil) ..... No. Motors ..... Phase ..... H.P. ....

Commercial (Oil) ..... No. Motors ..... Phase ..... H.P. ....

Electric Heat (No. of Rooms) .....

APPLIANCES: No. Ranges ..... Watts ..... Brand Feeds (Size and No.) .....

Elec. Heaters ..... Watts .....

Miscellaneous ..... Watts ..... Extra Cabinets or Panels .....

Transformers ..... Air Conditioners (No. Units) ..... Signs (No. Units) .....

Will commence ..... 19..... Ready to cover in ..... 19..... Inspection ..... 19.....

Amount of Fee \$ *1.00* .....

Signed *[Signature]*

DO NOT WRITE BELOW THIS LINE

SERVICE  ..... METER ..... GROUND

VISITS: 1 ..... 2 ..... 3 ..... 4 ..... 5 ..... 6 .....

..... 7 ..... 8 ..... 9 ..... 10 ..... 11 ..... 12 .....

REMARKS:

INSPECTED BY *[Signature]*  
(OVER)



LOCATION Wash. Ave. 1183  
 INSPECTION DATE 5/4/63  
 WORK COMPLETED 5/4/63  
 TOTAL NO. INSPECTIONS 1  
 REMARKS:

**FEES FOR WIRING PERMITS EFFECTIVE JULY 31, 1963**

<b>WIRING</b>	
1 to 30 Outlets	..... (including switches) \$ 2.00
31 to 60 Outlets	..... (including switches) 3.00
Over 60 Outlets, each Outlet	..... (including switches) .05
(Each twelve feet or fraction thereof of fluorescent lighting or any type of plug molding will be classed as one outlet)	
<b>SERVICES</b>	
Single Phase	..... 2.00
Three Phase	..... 4.00
<b>MOTORS</b>	
Not exceeding 50 H.P.	..... 3.00
Over 50 H.P.	..... 4.00
<b>HEATING UNITS</b>	
Domestic (Oil)	..... 2.00
Commercial (Oil)	..... 4.00
Electric Heat (Each Room)	..... .75
<b>APPLIANCES</b>	
Ranges, Cooking Tops, Ovens, Water Heaters, Disposals, Dishwashers, etc. — Each Unit	..... 1.50
<b>TEMPORARY WORK (Limited to 6 months from date of permit)</b>	
Service, Single Phase	..... 1.00
Service, Three Phase	..... 2.00
Wiring, 1-50 Outlets	..... 1.00
Wiring, each additional outlet over 50	..... .02
Circuses, Carnivals, Fairs, etc.	..... 10.00
<b>MISCELLANEOUS</b>	
Distribution Cabinet or Panel, per unit	..... 1.00
Transformers, per unit	..... 2.00
Air Conditioners, per unit	..... 2.00
Signs, per unit	..... 2.00
<b>ADDITIONS</b>	
5 Outlets, or less	..... 1.00
Over 5 Outlets, Regular Wiring Rates	.....



R3 RESIDENCE ZONE

# APPLICATION FOR PERMIT

Class of Building or Type of Structure Third Class

Portland, Maine, April 27, 1965

**PERMIT ISSUED**  
00427  
APR 28 1965  
CITY of PORTLAND

To the INSPECTOR OF BUILDINGS, PORTLAND, MAINE

The undersigned hereby applies for a permit to erect alter repair demolish install the following building structure equipment in accordance with the Laws of the State of Maine, the Building Code and Zoning Ordinance of the City of Portland, plans and specifications, if any, submitted herewith and the following specifications:

Location 1183 Washington Ave. Within Fire Limits?  Dist. No. \_\_\_\_\_

Owner's name and address Ralph Arnold, 1183 Washington Ave. Telephone \_\_\_\_\_

Lessee's name and address \_\_\_\_\_ Telephone \_\_\_\_\_

Contractor's name and address King Butland, 163 Maine Ave. Telephone \_\_\_\_\_

Architect \_\_\_\_\_ Specifications \_\_\_\_\_ Plans no No. of sheets \_\_\_\_\_

Proposed use of building Dwelling No. families 1

Last use \_\_\_\_\_ " \_\_\_\_\_ No. families 1

Material frame No. stories 1 1/2 Heat \_\_\_\_\_ Style of roof \_\_\_\_\_ Roofing \_\_\_\_\_

Other buildings on same lot \_\_\_\_\_

Estimated cost \$ 8000. Fee \$ 16.00

## General Description of New Work

To Repair after Fire without alterations.  
Floors and roof to be framed as existing

It is understood that this permit does not include installation of heating apparatus which is to be taken out separately by and in the name of the heating contractor. **PERMIT TO BE ISSUED TO** King Butland

## Details of New Work

Is any plumbing involved in this work? \_\_\_\_\_ Is any electrical work involved in this work? \_\_\_\_\_

Is connection to be made to public sewer? \_\_\_\_\_ If not, what is proposed for sewage? \_\_\_\_\_

Has septic tank notice been sent? \_\_\_\_\_ Form notice sent? \_\_\_\_\_

Height average grade to top of plate \_\_\_\_\_ Height average grade to highest point of roof \_\_\_\_\_

Size, front \_\_\_\_\_ depth \_\_\_\_\_ No. stories \_\_\_\_\_ solid or filled land? \_\_\_\_\_ earth or rock? \_\_\_\_\_

Material of foundation \_\_\_\_\_ Thickness, top \_\_\_\_\_ bottom \_\_\_\_\_ cellar \_\_\_\_\_

Kind of roof \_\_\_\_\_ Rise per foot \_\_\_\_\_ Roof covering \_\_\_\_\_

No. of chimneys \_\_\_\_\_ Material of chimneys \_\_\_\_\_ of lining \_\_\_\_\_ Kind of heat \_\_\_\_\_ fuel \_\_\_\_\_

Framing Lumber—Kind \_\_\_\_\_ Dressed or full size? \_\_\_\_\_ Corner posts \_\_\_\_\_ Sills \_\_\_\_\_

Size Girder \_\_\_\_\_ Columns under girders \_\_\_\_\_ Size \_\_\_\_\_ Max. on centers \_\_\_\_\_

Studs (outside walls and carrying partitions) 2x4-16" O. C. Bridging in every floor and flat roof span over 8 feet.

Joists and rafters: 1st floor \_\_\_\_\_, 2nd \_\_\_\_\_, 3rd \_\_\_\_\_, roof \_\_\_\_\_

On centers: 1st floor \_\_\_\_\_, 2nd \_\_\_\_\_, 3rd \_\_\_\_\_, roof \_\_\_\_\_

Maximum span: 1st floor \_\_\_\_\_, 2nd \_\_\_\_\_, 3rd \_\_\_\_\_, roof \_\_\_\_\_

If one story building with masonry walls, thickness of walls? \_\_\_\_\_ height? \_\_\_\_\_

## If a Garage

No. cars now accommodated on same lot \_\_\_\_\_, to be accommodated \_\_\_\_\_ number commercial cars to be accommodated \_\_\_\_\_

Will automobile repairing be done other than minor repairs to cars habitually stored in the proposed building? \_\_\_\_\_

## Miscellaneous

Will work require disturbing of any tree on a public street? no

Will there be in-charge of the above work a person competent to see that the State and City requirements pertaining thereto are observed? yes

Ralph Arnold

APPROVED:

*J. E. M.*

Signature of owner By: *King Butland*

P.H.

NOTES

4/29/65 - ~~work~~ <sup>S.H.</sup> was started  
 5/5/65 - work started E.H.  
 5/19/65 - work progressing -  
 softeners off - interior  
 studding (rooms) removed.  
 S.H.  
 5/21/65 - Left C.T. to close  
 in with net - no wiring  
 to be covered until inspector  
 approval. S.H.  
 6/5/65 - work nearly  
 done S.H.

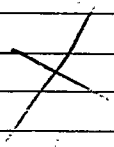

6/3

Permit No. 65-1427

Location 1183 MacLeary Ave

Owner Robert Arnold

Date of permit 4/28/65

Notif. closing-in

Inspn. closing-in

Final Notif.

Final Inspn.

Cert. of Occupancy issued

Staking Out Notice

Form Check Notice

288



FILL IN AND SIGN WITH INK

APPLICATION FOR PERMIT FOR HEATING, COOKING OR POWER EQUIPMENT

Portland, Maine, Nov. 12, 1953

02136

To the INSPECTOR OF BUILDINGS, PORTLAND, MAINE

The undersigned hereby applies for a permit to install the following heating, cooking or power equipment in accordance with the Laws of Maine, the Building Code of the City of Portland, and the following specifications:

Location 1181 Washington Ave. Use of Building dwelling house No. Stories 1 New Building Existing
Name and address of owner of appliance Soule Construction Co., c/o Harold Manchester, R. F. D.
Installer's name and address Portland Sebago Ice Co., 302 Commercial St. Telephone 3-2911

General Description of Work

To install forced warm air heating system and oil burning equipment

IF HEATER, OR POWER BOILER

Location of appliance basement Any burnable material in floor surface or beneath? no
If so, how protected? Kind of fuel? oil plenum chamber with shield
Minimum distance to burnable material, from top of appliance or casing top of furnace 2'
From top of smoke pipe 3 1/2' From front of appliance over 4' From sides or back of appliance over 3'
Size of chimney flue 8x8 Other connections to same flue none
If gas fired, how vented? Rated maximum demand per hour
Will sufficient fresh air be supplied to the appliance to insure proper and safe combustion? yes

IF OIL BURNER

Name and type of burner Delco Labelled by underwriter's laboratories? yes
Will operator be always in attendance? Does oil supply line feed from top or bottom of tank? bottom
Type of floor beneath burner concrete Size of vent pipe 1 1/2
Location of oil storage basement Number and capacity of tanks 1 275 gal.
Low water shut off Make No.
Will all tanks be more than five feet from any flame? yes How many tanks enclosed?
Total capacity of any existing storage tanks for furnace burners none

IF COOKING APPLIANCE

Location of appliance Any burnable material in floor surface or beneath?
If so, how protected? Height of Legs, if any
Skirting at bottom of appliance? Distance to combustible material from top of appliance?
From front of appliance From sides and back From top of smokepipe
Size of chimney flue Other connections to same flue
Is hood to be provided? If so, how vented? Forced or gravity?
If gas fired, how vented? Rated maximum demand per hour

MISCELLANEOUS EQUIPMENT OR SPECIAL INFORMATION

Amount of fee enclosed? 2.00 (\$2.00 for one heater, etc., 50 cents additional for each additional heater, etc., in same building at same time.)

APPROVED:

O. L. E. S. S. 11/12/53

Will there be in charge of the above work a person competent to see that the State and City requirements pertaining thereto are observed? yes

Portland Sebago Ice Co.

Signature of Installer by:

C. J. Smith

INSPECTION COPY





(RC) RESIDENCE ZONE - c

# APPLICATION FOR PERMIT

Class of Building or Type of Structure Third Class  
Portland, Maine, August 14, 1953

PERMIT ISSUED  
01386  
AUG 19 1953  
CITY of PORTLAND

To the INSPECTOR OF BUILDINGS, PORTLAND, MAINE

The undersigned hereby applies for a permit to erect alter repair demolish install the following building structure equipment in accordance with the Laws of the State of Maine, the Building Code and Zoning Ordinance of the City of Portland, plans and specifications, if any, submitted herewith and the following specifications:

Location 1185 Washington Ave. 1181-1183 Within Fire Limits? no Dist. No. \_\_\_\_\_  
Owner's name and address Soule Construction Co., c/o Harold Manchester Telephone \_\_\_\_\_  
Lessee's name and address \_\_\_\_\_ RFD #3 Telephone \_\_\_\_\_  
Contractor's name and address owner Telephone \_\_\_\_\_  
Architect \_\_\_\_\_ Specifications \_\_\_\_\_ Plans yes No. of sheets 1  
Proposed use of building Dwelling No. families 1  
Last use \_\_\_\_\_ No. families \_\_\_\_\_  
Material \_\_\_\_\_ No. stories \_\_\_\_\_ Heat \_\_\_\_\_ Style of roof \_\_\_\_\_ Roofing \_\_\_\_\_  
Other buildings on same lot \_\_\_\_\_  
Estimated cost \$ 7000. Fee \$ 7.00

## General Description of New Work

To construct  $1\frac{1}{2}$  story frame dwelling 29'x26'

*Warning & Important notice sent*

It is understood that this permit does not include installation of heating apparatus which is to be taken out separately by and in the name of the heating contractor. **PERMIT TO BE ISSUED TO Harold Manchester**

## Details of New Work

Is any plumbing involved in this work? yes Is any electrical work involved in this work? yes  
Is connection to be made to public sewer? yes If not, what is proposed for sewage? \_\_\_\_\_  
Height average grade to top of plate 11' Height average grade to highest point of roof 19'  
Size, front \_\_\_\_\_ depth \_\_\_\_\_ No. stories 1 1/2 solid or filled land? solid earth or rock? earth  
Material of foundation concrete at least 4' below grade 10" Thickness, top \_\_\_\_\_ bottom 12" cellar yes  
Material of underpinning \_\_\_\_\_ " to sill \_\_\_\_\_ Height \_\_\_\_\_ Thickness \_\_\_\_\_  
Kind of roof pitch-gable Rise per foot 8" Roof covering asphalt roofing Class C Und. Lab.  
No. of chimneys 1 Material of chimneys brick of lining tile Kind of heat w. air fuel oil  
Framing lumber—Kind hemlock Dressed or full size? dressed  
Corner posts 4x6 Sills 2x8 box \_\_\_\_\_ Girt or ledger board? \_\_\_\_\_ Size \_\_\_\_\_  
Girders yes Size 6x8 full size \_\_\_\_\_ Columns under girders Lally Size 3 1/2" Max. on centers 7'  
Studs (outside walls and carrying partitions) 2x4-16" O. C. Bridging in every floor and flat roof span over 8 feet.  
Joists and rafters: 1st floor 2x8 2nd 2x8 3rd \_\_\_\_\_, roof 2x8  
On centers: 1st floor 12" - 16" 2nd 16" 3rd \_\_\_\_\_, roof 20"  
Maximum span: 1st floor 14' 12' 2nd 12' 3rd \_\_\_\_\_, roof \_\_\_\_\_  
If one story building with masonry walls, thickness of walls? \_\_\_\_\_ height? \_\_\_\_\_

## If a Garage

No. cars now accommodated on same lot \_\_\_\_\_, to be accommodated \_\_\_\_\_ number commercial cars to be accommodated \_\_\_\_\_  
Will automobile repairing be done other than minor repairs to cars habitually stored in the proposed building? \_\_\_\_\_

APPROVED:

OK - 8/19/53 - AJS

## Miscellaneous

Will work require disturbing of any tree on a public street? no  
Will there be in charge of the above work a person competent to see that the State and City requirements pertaining thereto are observed? yes

Soule Construction Co.

INSPECTION COPY

Signature of owner BY:

Arthur O. Soule

PH

8/18/53  
9/16/53  
10/20/53

Permit No. 53/1386

Location: ~~18th St~~ Jackson Ave.

Owner: ~~Paul Construction Co.~~ Paul Construction Co.

Date of permit: 6/19/53

Notif. closing-in: 10/20/53

Inspn. closing-in: 10/20/53

Final Notif.: 11/7/54

Final Inspn.

Cert. of Occupancy issued: 11/8/54

NOTES

8/18/53 ~~Inspection at site~~  
9/16/53 - 7/2 on check mach  
10/20/53 - left S.T. to  
close in

[Empty lined area for notes]

[Empty lined area for notes]

(COPY)



CITY OF PORTLAND, MAINE  
Department of Building Inspection

# Certificate of Occupancy

LOCATION 1181-1183 Washington Ave.

Issued to Soule Construction Co.

Date of Issue Jan. 6, 1954

This is to certify that the building, premises, or part thereof, at the above location, built ~~in 1953~~  
~~changed to use~~ under Building Permit No. 53/1386, has had final inspection, has been found to  
conform substantially to requirements of Zoning Ordinance and Building Code of the City, and is hereby  
approved for occupancy or use, limited or otherwise, as indicated below.

PORTION OF BUILDING OR PREMISES

Entire

APPROVED OCCUPANCY

One-Family Dwelling House

Limiting Conditions:

This certificate supersedes  
certificate issued

Approved:

1/7/54 *Earl Smith*

(Date)

Inspector

*W. M. A. R.*

Inspector of Buildings

Notice: This certificate identifies lawful use of building or premises, and ought to be transferred from  
owner to owner when property changes hands. Copy will be furnished to owner or lessee for one dollar.



STATEMENT ACCOMPANYING APPLICATION FOR BUILDING PERMIT

for Dwelling Date August 14, 1953  
at 1185 Washington Ave. (1181-1183)

Soule Construction

1. In whose name is the title of the property now recorded? \_\_\_\_\_
2. Are the boundaries of the property in the vicinity of the proposed work shown clearly on the ground, and how? stakes
3. Is the outline of the proposed work now staked out upon the ground? yes  
If not, will you notify the Inspection Office when the work is staked out and before any of the work is commenced? \_\_\_\_\_
4. What is to be maximum projection or overhang of eaves or drip? \_\_\_\_\_
5. Do you assume full responsibility for the correctness of the location plan or statement of location filed with this application, and does it show the complete outline of the proposed work on the ground, including bay windows, porches and other projections? yes
6. Do you assume full responsibility for the correctness of all statements in the application concerning the sizes, design and use of the proposed building? yes
7. Do you understand that in case changes are proposed in the location of the work or in any of the details specified in the application that a revised plan and application must be submitted to this office before the changes are made? yes

Arthur O. Soule

AVERAGE - FRONT YARD LOT A =  $\frac{10+22}{2} = 16'$   
 AVERAGE - FRONT YARD LOT B =  $\frac{20+30}{2} = 25'$   
 AVERAGE OF TWO =  $\frac{16+25}{2} = 20.5'$   
 AVERAGE - FRONT YARD LOT C =  $\frac{18.3+26}{2} = 22.25'$

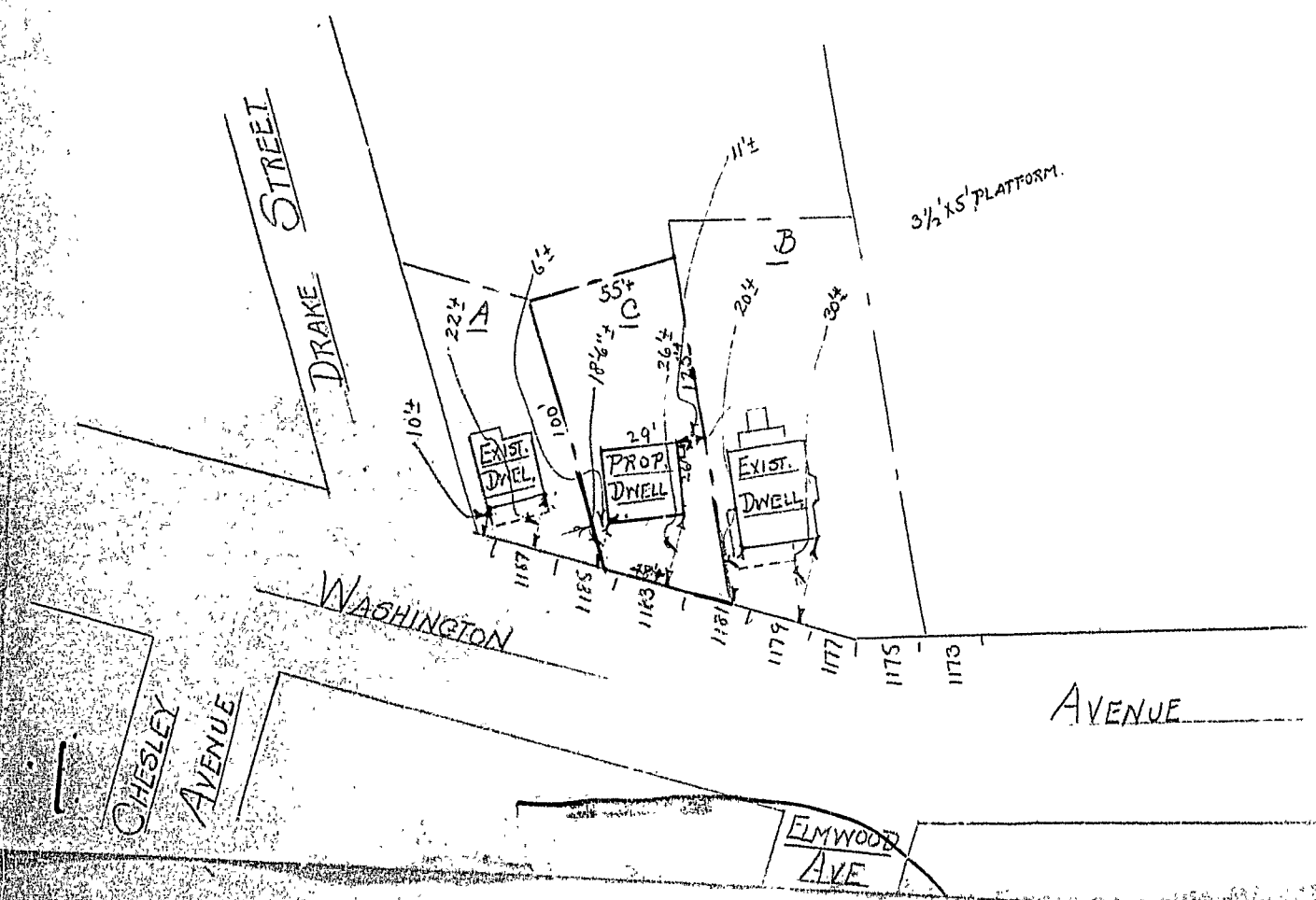

55.44

RECEIVED  
AUG 14 1953  
DEPT. OF BLD'G. INSP.  
CITY OF PORTLAND

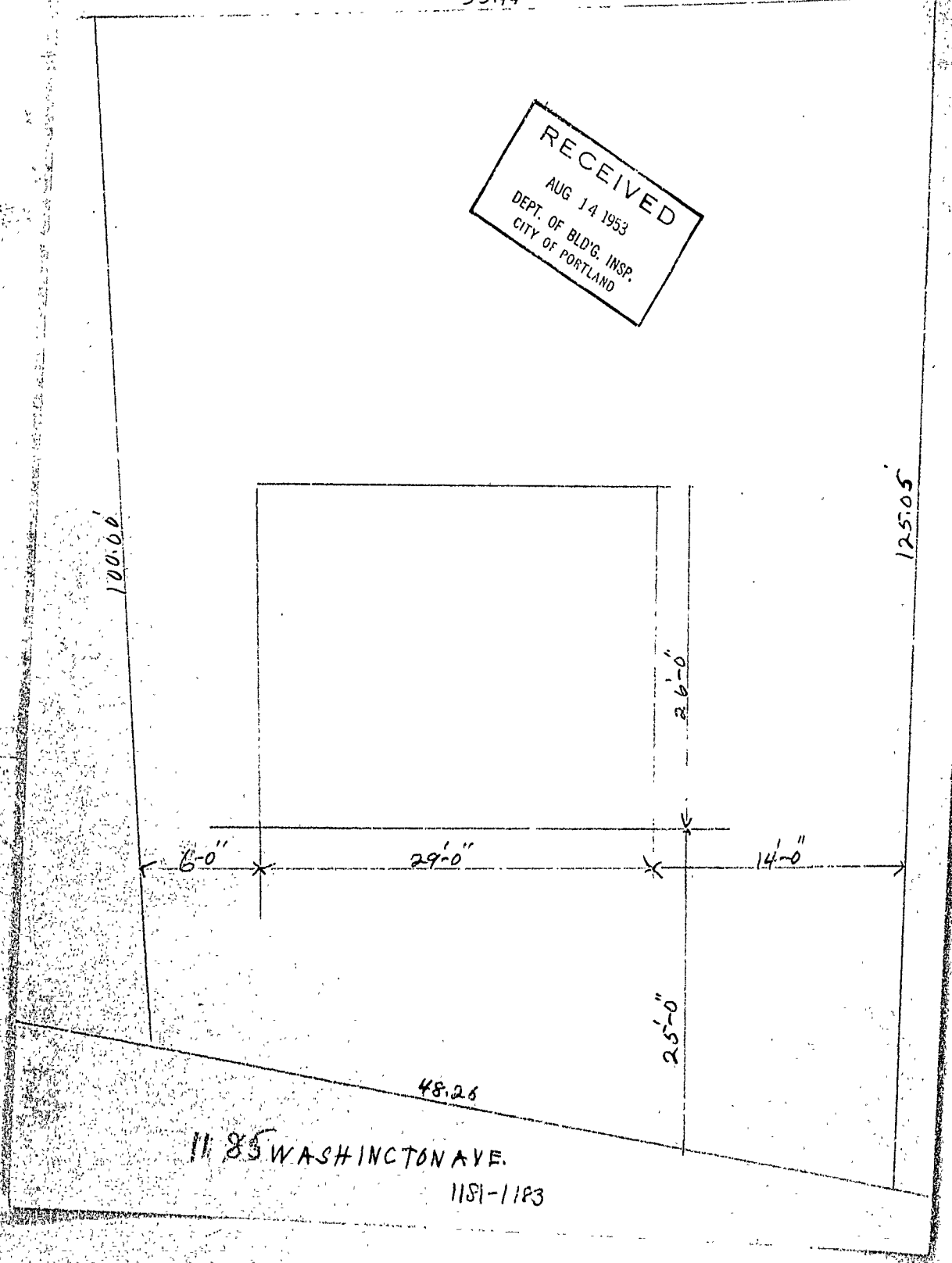

1185 WASHINGTON AVE.  
1181-1183