

R3 RESIDENCE ZONE



APPLICATION FOR PERMIT

Class of Building or Type of Structure

Portland, Maine,

Sept. 27, 1973

PERMIT ISSUED

OCT 1 1973

CITY of PORTLAND

To the INSPECTOR OF BUILDINGS, PORTLAND, MAINE

The undersigned hereby applies for a permit to erect alter repair demolish install the following building structure equipment in accordance with the Laws of the State of Maine, the Building Code and Zoning Ordinance of the City of Portland, plans and specifications, if any, submitted herewith and the following specifications:

Location 47 Maine Ave. Within Fire Limits? Dist. No. Owner's name and address Peter Herrick, same Telephone 797-7231 Lessee's name and address Contractor's name and address owner Telephone Architect Specifications Plans YES No. of sheets Proposed use of building garage No. families Last use No. families Material No. stories Heat Style of roof Roofing Other buildings on same lot Estimated cost \$ 600. Fee \$ 5.

General Description of New Work

To enlarge existing garage to 20' x 22' as per plan. Addition will be about 8'

It is understood that this permit does not include installation of heating apparatus which is to be taken out separately by and in the name of the heating contractor. PERMIT TO BE ISSUED TO owner

Details of New Work

Is any plumbing involved in this work? Is any electrical work involved in this work? Is connection to be made to public sewer? If not, what is proposed for sewage? Has septic tank notice been sent? Form notice sent? Height average grade to top of plate Height average grade to highest point of roof Size, front depth No. stories solid or filled land? earth or rock? Material of foundation Thickness, top bottom cellar Kind of roof Rise per foot Roof covering No. of chimneys Material of chimneys of lining Kind of heat fuel Framing Lumber-Kind Dressed or full size? Corner posts Sills Size Girder Columns under girders Size Max. on centers Studs (outside walls and carrying partitions) 2x4-16" O. C. Bridging in every floor and flat roof span over 8 feet. Joists and rafters: 1st floor, 2nd, 3rd, roof On centers: 1st floor, 2nd, 3rd, roof Maximum span: 1st floor, 2nd, 3rd, roof If one story building with masonry walls, thickness of walls? height?

If a Garage

No. cars now accommodated on same lot, to be accommodated number commercial cars to be accommodated Will automobile repairing be done other than minor repairs to cars habitually stored in the proposed building?

Miscellaneous

Will work require disturbing of any tree on a public street? Will there be in charge of the above work a person competent to see that the State and City requirements pertaining thereto are observed? yes

APPROVED:

9/28/73 ZONING OR M.G.O. O.K. E.S. 10/1/73

Peter Herrick

CS 301

INSPECTION COPY

Signature of owner

by:

Peter Herrick

NOTES

10/17/73
[faded handwritten notes]

10-30-73
[faded handwritten notes]

Jan 23/74

Completed except for out state
[faded handwritten notes]

[Large diagonal scribble across the bottom half of the page]

Permit No. 73/1114
Location 72 MAINE Ave
Owner Peter Kendrick
Date of permit 10/1/73
Notif. closing-in
Inspn. closing-in
Final Notif.
Final Inspn.
Cert. of Occupancy issued
Sinking Out Notice
Form Check Notice

Handwritten initials

Income 1475
Annual 3086

CITY OF PORTLAND, MAINE Application for Permit to Install Wires

Permit No. 58165
Issued 9/22/69
Sept. 22, 1969
Portland, Maine

To the City Electrician, Portland, Maine:

The undersigned hereby applies for a permit to install wires for the purpose of conducting electric current, in accordance with the laws of Maine, the Electrical Ordinance of the City of Portland, and the following specifications:

(This form must be completely filled out - Minimum Fee, \$1.00)

Owner's Name and Address Peter C Herrick 47 MAINE AVE CITY Tel.

Contractor's Name and Address Harry Getchell Tel.

Location 47 MAINE AVE CITY Use of Building Hoose

Number of Families 1 Apartments .. Stores .. Number of Stories 2 stories

Description of Wiring: New Work Additions Alterations

Change of Service To 2-20

Pipe .. Cable Metal Molding BX Cable Plug Molding (No. of feet) ..

No. Light Outlets Plugs .. Light Circuits Plug Circuits ..

FIXTURES: No. Fluor. or Strip Lig. (No. of feet) ..

SERVICE: Pipe Cable Underground No. of W. Size ..

METERS: Relocated Added Total No. Meters ..

MOTORS: Number Phase H. P. Amps .. Volts Starter ..

HEATING UNITS: Domestic (Oil) No. Motors Phase .. H.P.

Commercial (Oil) No. Motors Phase H.P.

Electric Heat (No. of Rooms)

APPLIANCES: No. Ranges Watts Brand Feeds (Size and No.) ..

Elec. Heaters Watts ..

Miscellaneous Watts .. Extra Cabinets or Panels ..

Transformers .. Air Conditioners (No. Units) Signs (No. Units) ..

Will commence .. 19 .. Ready to cover in 19 .. Inspection .. 19 ..

Amount of Fee \$ 2.00

Signed Harry Getchell
Mr. Carl Herrick

DO NOT WRITE BELOW THIS LINE

SERVICE METER .. GROUND

VISITS: 1 .. 2 .. 3 .. 4 .. 5 .. 6 ..

7 .. 8 .. 9 .. 10 .. 11 .. 12 ..

REMARKS:

INSPECTED BY *F. W. [Signature]*
(OVER)

LOCATION *Maine Av. 47*
 INSPECTION DATE *9/30/61*
 WORK COMPLETED *9/30/61*
 TOTAL NO. INSPECTIONS
 REMARKS:

FEEES FOR WIRING PERMITS EFFECTIVE JULY 31, 1963

WIRING

1 to 30 Outlets \$ 2.00
 31 to 60 Outlets 3.00
 Over 60 Outlets, each Outlet05
 (Each twelve feet or fraction thereof of fluorescent lighting or any type of plug molding will be classed as one outlet).

SERVICES

Single Phase 2.00
 Three Phase 4.00

MOTORS

Not exceeding 50 H.P. 3.00
 Over 50 H.P. 4.00

HEATING UNITS

Domestic (Oil) 2.00
 Commercial (Oil) 4.00
 Electric Heat (Each Room)75

APPLIANCES

Ranges, Cooking Tops, Ovens, Water Heaters, Disposals, Built-in Dishwashers, Dryers, and any permanent built-in appliance — each unit 1.50

MISCELLANEOUS

Temporary Service, Single Phase 1.00
 Temporary Service, Three Phase 2.00
 Circuses, Carnivals, Fairs, etc. 10.00
 Meters, relocate 1.00
 Distribution Cabinet or Panel, per unit 1.00

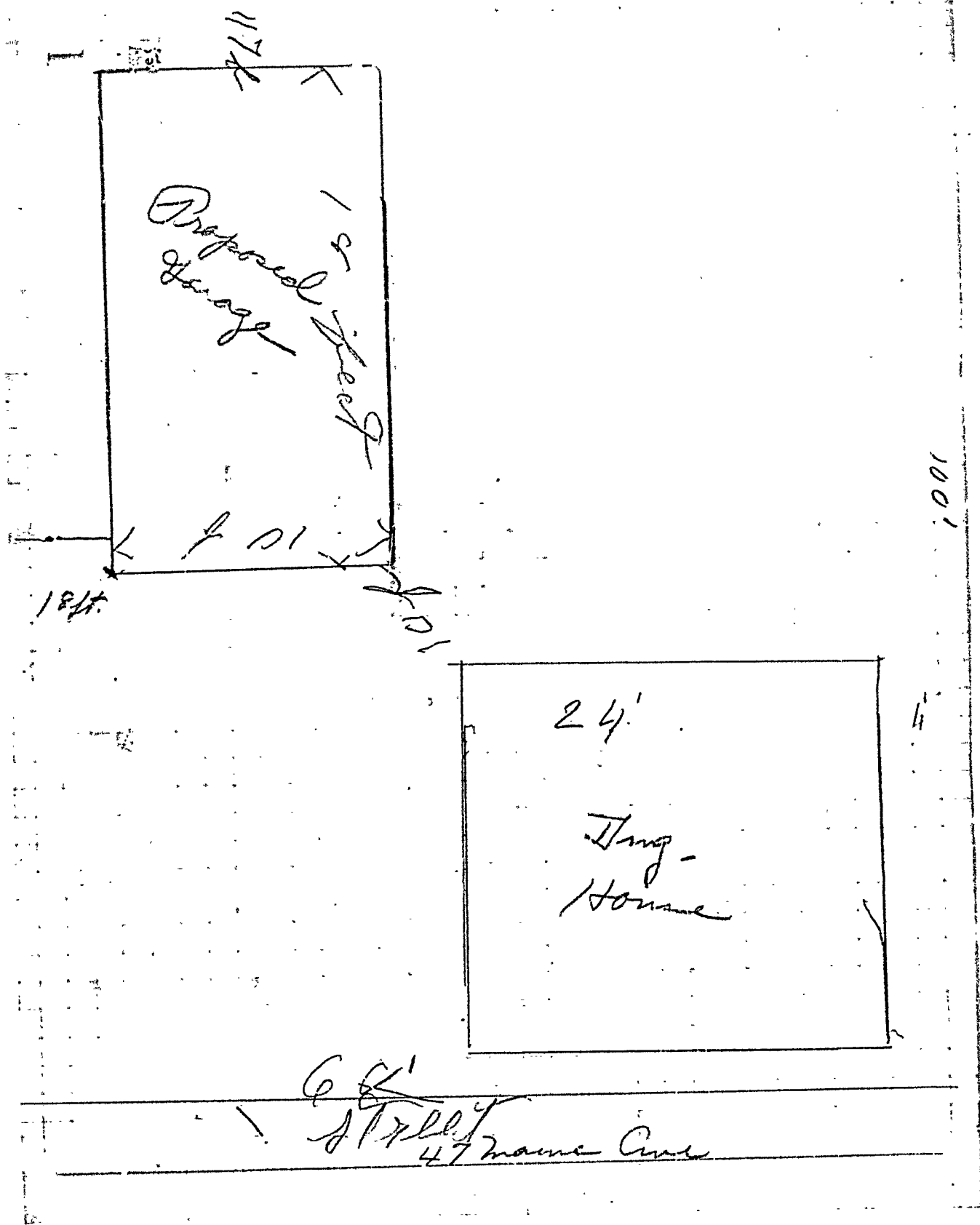

STATEMENT ACCOMPANYING APPLICATION FOR BUILDING PERMIT

for Single Car frame garage
at 47 Maine Ave.

Date 11/5/31

1. In whose name is the title of the property now recorded? *Aurilla Punnella*
2. Are the boundaries of the property in the vicinity of the proposed work shown clearly on the ground, and how? *Wood Stakes*
3. Is the outline of the proposed work now staked out upon the ground? *yes* If not, will you notify the Inspection Office when the work is staked out and before any of the work is commenced? *—*
4. What is to be maximum projection or overhang of eaves or drip? *8"*
5. Do you assume full responsibility for the correctness of the location plan or statement of location filed with this application, and does it show the complete outline of the proposed work on the ground, including bay windows, porches and other projections? *yes*
6. Do you assume full responsibility for the correctness of all statements in the application concerning the sizes, design and use of the proposed building? *yes*
7. Do you understand that in case changes are proposed in the location of the work or in any of the details specified in the application that a revised plan and application must be submitted to this office before the changes are made? *yes*

MF1423

Aurilla Punnella

FILL IN COMPLETELY AND SIGN WITH INK

PERMIT ISSUED
Permit No. 0009



APPLICATION FOR PERMIT FOR HEATING, COOKING OR POWER EQUIPMENT

Portland, Maine, January 5, 1939

To the INSPECTOR OF BUILDINGS, PORTLAND, ME.

The undersigned hereby applies for a permit to install the following heating, cooking or power equipment in accordance with the Laws of Maine, the Building Code of the City of Portland, and the following specifications:

Location 47 Maine Avenue Use of Building Apartment house No. Stories 2

Name and address of owner Fred B. Swales, 47 Maine Avenue Ward 9

Contractor's name and address Portland Sebago Ice Co., 302 Commercial St. Telephone 3-2911

General Description of Work

To install Oil burner in connection with existing steam heat

IF HEATER, POWER BOILER OR COOKING DEVICE

Is heater or source of heat to be in cellar? yes If not, which story _____ Kind of Fuel oil

Material of supports of heater or equipment (concrete floor or what kind) concrete

Minimum distance to wood or combustible material, from top of boiler or casing top of furnace _____

from top of smoke pipe _____, from front of heater _____ from sides or back of heater _____

Size of chimney flue _____ Other connections to same flue _____

IF OIL BURNER

Name and type of burner Master Kraft Labeled and approved by Underwriters' Laboratories? yes

Will operator be always in attendance? _____ Type of oil feed (gravity or pressure) pressure

Location oil storage basement No. and capacity of tanks 1 - 275 gal.

Will all tanks be more than seven feet from any flame? yes How many tanks fireproofed? _____

Amount of fee enclosed? 1.00 (\$1.00 for one heater, etc., 50 cents additional for each additional heater, etc., in same building at same time.)

Signature of contractor By [Signature]

ORIGINAL Copy

36370

Ward 9 Permit No. 3979

Location 47 Maine Ave

Owner Fred B. Eneleth

Date of permit: 1/5/39

Post Card sent

Notif. for insp. None

Approval Tax issued 1/18/39 0.50

Oil Burner Check List (date) 1/18/39

1. Kind of heat Steam

2. Label 120566

3. Anti-siphon

4. Oil storage

5. Tank distance

6. Vert pipe

7. Fill pipe

8. Gauge

9. Rigidity

10. Feed safety

11. Pipe sizes and material

12. Control valve

13. Ash pit vent

14. Temp. or pressure safety

15. Instruction card

16. Insuff. Station on main pipe

NOTES

FILL IN COMPLETELY AND SIGN WITH INK



COMMERCIAL BUSINESS ZONE
APPLICATION FOR PERMIT FOR HEATING, COOKING OR POWER EQ

Permit No.

Portland, Maine, Nov. 24 1936

To the INSPECTOR OF BUILDINGS, PORTLAND, ME.

The undersigned hereby applies for a permit to install the following heating, cooking or power equipment in accordance with the Laws of Maine, the Building Code of the City of Portland, and the following specifications:

Location 47 Maine Ave. Use of Building Dwelling

Name and address of owner Fred E. Eveleth Ward 9

Contractor's name and address J. K. Kieder 55 Maine Ave. Telephone _____

General Description of Work

To install Steam Heating System

IF HEATER, POWER BOILER OR COOKING DEVICE

Is heater or source of heat to be in cellar? yes If not, which story xxx Kind of Fuel Coal

Material of supports of heater or equipment (concrete floor or what kind) Concrete Floor

Minimum distance to wood or combustible material, from top of boiler or casing top of furnace, 18" Except for 6x8 beam
from top of smoke pipe 12" to 24", from front of heater over 4 ft from sides or back of heater over 4 ft

IF OIL BURNER

Name and type of burner _____ Labeled and approved by Underwriter's Laboratories? _____

Will operator be always in attendance? _____ Type of oil feed (gravity or pressure) _____

Location oil storage _____ No. and capacity of tanks _____

Will all tanks be more than seven feet from any flame? _____ How many tanks fireproofed? _____

Amount of fee enclosed? 1- (\$1.00 for one heater, etc., 50 cents additional for each additional heater, etc., in sar building at same time.)

Signature of contractor J. K. Kieder
55 Maine Ave. Portland

INSPECTION COPY

NOTIFICATION BY LOCAL LAWN OR CLEANING IS WANTED
CERTIFICATE OF OCCUPANCY
REQUIREMENT IS WANTED

Ward 9 Permit No. 361
 Location 47 Maine Ct
 Owner Fred B. E. Beth
 Date of permit 12/1/36
 Notif. closing-in _____
 Inspn. closing-in _____
 Final Notif. _____
 Final Inspn. _____
 Cert. of Occupancy _____

NOTES

12/4/36. Work done in kitchen.
 Looks as though the heater is
 metal. OK.
 12/5/36. Heater installed
 and is jacketed type.
 The front of the heater
 is parallel to and on
 line with the window,
 and the top of the
 heater is about 15" below
 it. Other clearances OK
 and chimney has a
 clean out door. OK.

INSPECTION EQUIPMENT

101
 ne
 101



(R) GENERAL RESIDENCE ZONE

PERMIT ISSUED

Permit No. 2302
NOV 7 1931

APPLICATION FOR PERMIT

Class of Building or Type of Structure Third Class

Portland, Maine, November 5, 1931

To the INSPECTOR OF BUILDINGS, PORTLAND, ME.

The undersigned hereby applies for a permit to erect ~~alter~~ install the following building structure equipment in accordance with the Laws of the State of Maine, the Building Code of the City of Portland, plans and specifications, if any, submitted herewith and the following specifications:

Location 74 ~~74~~ Ward 9 Within Fire Limits? NO Dist. No. _____
Owner's or Lessee's name and address Juville Bunnelle 240 Brackett St. Telephone _____
Contractor's name and address Owner Alton Jackson Southport, Me. Telephone _____
Architect's name and address _____
Proposed use of building 1 car garage No. families _____
Other buildings on same lot dwelling house one family
Plans filed as part of this application? yes No. of sheets 1
Estimated cost \$ 150 Fee \$.75

Description of Present Building to be Altered

Material _____ No. stories _____ Heat _____ Style of roof _____ Roofing _____
Last use _____ No. families _____

General Description of New Work

To erect single car frame garage 10' x 18'

NOTIFICATION BEFORE LATHING
OR CLOSING-IN IS WAIVED.

CERTIFICATE OF OCCUPANCY
REQUIRED IS WAIVED.

It is understood that this permit does not include installation of heating apparatus which is to be taken out separately by and in the name of the heating contractor.

Details of New Work

Height average grade to top of plate 8'
Size, front 10' depth 18' No. stories 1 Height average grade to highest point of roof 10'
To be erected on solid or filled land? solid earth or rock? earth
Material of foundation concrete slab Thickness, top _____ bottom _____
Material of underpinning _____ Height _____ Thickness _____
Kind of Roof pitch Rise per foot cu Roof covering asphalt shingles Class C Und Lab
No. of chimneys no Material of chimneys _____ of lining _____
Kind of heat no Type of fuel _____ Is gas fitting involved? _____
Corner posts 4x4 Sills 4x4 Girt or ledger board? _____ Size _____
Material columns under girders _____ Size _____ Max on centers _____
Studs (outside walls and carrying partitions) 2x4-16" O. C. Girders 6x8 or larger. Bridging in every floor and flat roof span over _____ feet. Sills and corner posts all one piece in cross section.
Joists and rafters: 1st floor concrete, 2nd _____, 3rd _____, roof 2x4
On centers: 1st floor _____, 2nd _____, 3rd _____, roof 2'
Maximum span: 1st floor _____, 2nd _____, 3rd _____, roof _____
If one story building with masonry walls, thickness of walls? _____ height? _____

If a Garage

No. cars now accommodated on same lot none, to be accommodated 1
Total number commercial cars to be accommodated none
Will automobile repairing be done other than minor repairs to cars habitually stored in the proposed building? no

Miscellaneous

Will above work require removal or disturbing of any shade tree on a public street? no
Will there be in charge of the above work a person competent to see that the State and City requirements pertaining thereto are observed? yes

INSPECTION COPY

Signature of owner Juville Bunnelle

Oliver J. Bunnelle
CHIEF OF PERMITS DEPT.

6-1-1-A-C

Ward 9 Permit No. 31/2302

LOCATION 47 Maine Ave

Owner Carilla Pennella

permit 11/7/31

if. closing-in

spn. closing-in

inal Notif.

Final Inspn. 11/19/31. ell.

Cert. of Occupancy issued None

²¹⁰11/5/31. NOTES
Location as staked
O.K. ell.

11/19/31.
Roof to be tied
at plate. ell.

31



APPLICATION FOR PERMIT TO BUILD

3rd CLASS BUILDING

Portland, Maine, November 10/26 19

To the INSPECTOR OF BUILDINGS, PORTLAND, ME.

The undersigned hereby applies for a permit to build, according to the following specifications, the Laws of the State of Maine, and the Building Ordinance of the City of Portland:

Location 47 1st 128-136 Maine Avenue Ward 9 Within Fire Limits? no
 Owner's name and address? Carl Jordan, 32 Pownall Street
 Contractor's name and address? Carl Jordan, 32 Pownall Street
 Architect's name and address? _____
 Proposed occupancy of building (purpose)? dwelling
 No. families? 1 apartments? _____ lodgers? _____
 Size, front? 22, depth? 24 No. stories? 1, height, average grade to highest point of roof? 21
 To be erected on solid or filled land? solid earth or rock? _____
 Material of foundation? concrete Thickness, top? 12 bottom? 12
 Material of underpinning? concrete blocks over 4 ft. high? 24in thickness? 8in
 Kind of roof (pitch, hip, etc.)? pitch Kind of roofing? asphalt
 Kind of heat? one pipe Material of chimney? brick, of lining? tile

SIZE OF FRAMING MEMBERS

Corner posts? 4x6 Sills? 4x8 Rafters or roof beams? 2x6 on center? 24
 Material and size of columns under girders? 4in iron pipe on center? 8ft
 Ledger board used? no Size? _____ Studs (outside walls and carrying partitions) 2 x 4 16" O. C.
 Girders 6" x 8" or larger. Bridging in every floor and flat roof span over 8 feet. Sills and corner posts will be all one piece in cross section.

Floor timbers: 1st floor 2x8, 2nd 2x8 finished joists, 4th _____
 On centers: 1st floor 16, 2nd 16, 3rd _____, 4th _____
 Span: 1st floor 11ft, 2nd 11ft, 3rd _____, 4th _____

All non-carrying partitions run parallel to and supported by 2x8 floor joists will have the floor joists doubled under them in the vertical area of the partition is 80sq ft or more and if

External walls } thickness { 1st story _____, 2nd story _____ the span of the joists is 10ft or
 Party walls } thickness { 1st story _____, 2nd story more.

Material of cornice? _____ How fastened? _____

IF APARTMENT, TENEMENT OR LODGING HOUSE

Dimensions of lot? _____
 Descriptions of other buildings on lot? _____
 Clear distance to rear lot line? _____, to one side lot line? _____, to other side lot line? _____

IF A PRIVATE GARAGE

No. cars to be accommodated? _____
 Other buildings on same lot? _____
 Distance from nearest present building to proposed garage? _____
All parts of garage, including eaves, will be at least 2 ft. from all lot lines.
 Garage will be at least _____ feet from nearest windows of adjoining property.
 Will there be a heating plant within building? _____
 If so, how protected? _____

MISCELLANEOUS

Will the above construction require the removal or disturbing of any shade tree on the public street? _____
 Plans filed as part of this application? _____ No. sheets? _____
 Estimated total cost \$ 4,000. Fee? 1.25

Signature of owner or authorized representative? _____

4/20/57

Finished not
right at all
level of chimney
two feet of
around and pipe
has to be called
and placed
rightly.
Trimming at chimney
at end floor level
not satisfactory
Joists in lam 44
cut around
plumbing.

myod
4/20/57.

4/25/57.

Greening

4/17/57

Added frost in
cellar - not
perfectly framed
around chimney
made 2nd floor
one frost of
masonry we
carrying fracture
1st floor - Pinned
frost of
chimney at the
level of
fine of
and pipe
notify again

myod

4/17/57
Greening
Berkshire
36 Calne way
myod

2/11/27

Add post -
cellar - +
In fully framed
around chimney
made 20 ft
one frost of
masonry is
carrying water
1st story - Found
frost of iron
chimney at the
cellar. Found
fine soil and
soil pipe
Notify again

Mrs

AS/27

Presenting
Bridges & Chimney
36 Cal. Street
London

26/1153

H

9
25 3/10/27

Lot 195-196 Mainville

C.S. Jordan

Nov 14/26

2/12/27

Frames mostly
up and no for

Notes 2/23/27 11:30

Chasing
In ready
Six ridge home
Add to wall post
in cellar

3/30/27
3:15

Mr. Jordan
Toll 4/4/27
4/18/27 "30