

LOT 4, JERSEY AVENUE

15-19



#9203-3R



FILL IN AND SIGN WITH INK

APPLICATION FOR PERMIT FOR HEATING, COOKING OR POWER EQUIPMENT

PERMIT ISSUED 192 FEB 27 1970

Portland, Maine, February 26 1970

CITY OF PORTLAND

To the INSPECTOR OF BUILDINGS, PORTLAND, ME.

The undersigned hereby applies for a permit to install the following heating, cooking or power equipment in accordance with the Laws of Maine, the Building Code of the City of Portland, and the following specifications:

Location Lot 4 Jersey Ave. Use of Building Dwelling No Stories 1 1/2 New Building Existing
Name and address of owner of appliance Robert Hayden & Steve Notis, 97 Exchange St.
Installer's name and address Jos. T. Letellier & Sons, 207 Pool St. Biddeford Telephone

General Description of Work

To install Oil-fired forced hot water heating system.

IF HEATER, OR POWER BOILER

Location of appliance Basement Any burnable material in floor surface or beneath? none
If so, how protected? Kind of fuel? oil
Minimum distance to burnable material, from top of appliance or casing top of furnace 3 1/2
From top of smoke pipe 3' From front of appliance 4' From sides or back of appliance over 3'
Size of chimney flue 8x10 Other connections to same flue none
If gas fired, how vented?
Will sufficient fresh air be supplied to the appliance to insure proper and safe combustion? yes

IF OIL BURNER

Name and type of burner Wayne-gun type Labeled by underwriters' laboratories? yes
Will operator be always in attendance? Does oil supply line feed from top or bottom of tank? bottom
Type of floor beneath burner concrete Size of vent pipe 1 1/2
Location of oil storage basement Number and capacity of tanks 275 gals.
Low water shut off tank No.
Will all tanks be more than five feet from any flame? yes How many tanks enclosed?
Total capacity of any existing storage tanks for furnace burners

IF COOKING APPLIANCE

Location of appliance Any burnable material in floor surface or beneath
If so, how protected? Height of Legs, if any
Skirting at bottom of appliance? Distance to combustible material from top of appliance?
From front of appliance From sides and back From top of smokepipe
Size of chimney flue Other connections to same flue
Is hood to be provided? If so, how vented? Forced or gravity?
If gas fired, how vented? Rated maximum demand per hour

MISCELLANEOUS EQUIPMENT OR SPECIAL INFORMATION

[Empty lines for miscellaneous information]

Amount of fee enclosed? \$2.00 (\$2.00 for one heater, etc., \$1.00 additional for each additional heater, etc., in same building at same time.)

APPROVED:

[Handwritten signature]

Will there be in charge of the above work a person competent to see that the State and City requirements pertaining thereto are observed? yes

Jos. T. Letellier & Sons

Signature of Installer by: Royal R. Chretien

1.5 300

INSPECTION COPY

Permit No. 701/192
 Location 155 Lindy Ave.
 Owner Richard H. ...
 Date of permit 2/29/70

Approved _____

NOTES

1	In Pipe	
2	Vent Pipe	
3	Kind of Heat	
4	Burner Quality & Supports	
5	Kind & Label	
6	Steel Conn.	
7	Height to Rod	
8	Rem. Conn.	
9	Pipe Section	
10	Valve	
11	Cap.	
12	Lim. Ry. / Support	
13	Fam. Dist.	
14	Oil Gauge	
15	Insulation Ceil.	
16	Low Water Shut-off	

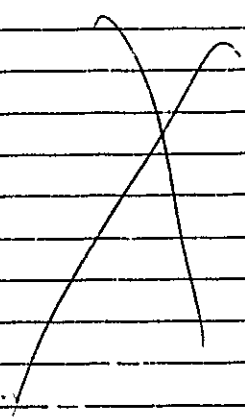
5/15/70 OK M.G.W.

[Empty lined area for notes]

CITY OF PORTLAND, MAINE
Application for Permit to Install Wires

Permit No. **58515**
 Issued **2/18/70**
 Portland, Maine **617**, 19**70**

To the City Electrician, Portland, Maine

The undersigned hereby applies for a permit to install wires for the purpose of conducting electric current, in accordance with the laws of Maine, the Electrical Ordinance of the City of Portland, and the following specifications:

(This form must be completely filled out - Minimum Fee \$1.00)

Owner's Name and Address **Bob Hayden + Steve Nolan** Tel. _____
 Contractor's Name and Address **Charles Annis** Tel. **7735035**

Location **Lot 4 Jersey Ave** Use of Building _____
 Number of Families **1** Apartments _____ Stores _____ Number of Stories _____
 Description of Wiring: New Work Additions _____ Alterations _____

Pipe Cable Metal Molding _____ BX Cable _____ Plug Molding (No. of feet) _____
 No. Light Outlets **10** Plugs **30** Light Circuits **4** Plug Circuits **2**

FIXTURES: No. _____ Fluor. or Strip Lighting (No feet) _____
 SERVICE: Pipe _____ Cable Underground _____ No. of Wires **3** Size **3/2 x 1/4**
 METERS: Relocated _____ Added _____ Total No. Meters _____

MOTORS: Number _____ Phase _____ H. P. _____ Amps _____ Volts _____ starter _____
 HEATING UNITS: Domestic (Oil) _____ No. Motors _____ Phase _____ H.P. _____
 Commercial (Oil) _____ No. Motors _____ Phase _____ H.P. _____
 Electric Heat (No. of Rooms) _____

APPLIANCES: No. Ranges Watts **6 kw** Brand Feeds (Size and No.) **3/6**
 Elec. Heaters _____ Watts _____
 Miscellaneous _____ Watts _____ Extra Cabinets or Panels _____

Transformers _____ Air Conditioners (No Units) _____ Signs (No. Units) _____
 Will commence _____ 19 _____ Ready to cover in _____ 19 _____ Inspection _____ 19 _____
 Amount of Fee \$ **5.50**

Signed **Charles Annis**

DO NOT WRITE BELOW THIS LINE

SERVICE		METER		GROUND	
VISITS: 1	2	3	4	5	6
7	8	9	10	11	12

REMARKS:

PERMIT TO ALL PLUMBING PERMIT NUMBER 1109

Date Issued **2-11-1970**
 Portland Plumbing Inspector
 By **ERNOLD R. GOODWIN**

App. First Insp.
 Date ~~1-16-70~~ **2-11-1970**
 By **ERNOLD R. GOODWIN**

App. Final Insp.
 Date ~~MAY 9 1970~~ **MAY 19 1970**
 By **ERNOLD R. GOODWIN**
 PORTLAND PLUMBING INSPECTOR

- Commercial
- Residential
- Single
- Multi Family
- New Construction
- Remodeling

Address		Lot 4 17		PERMIT NUMBER 1109	
Installation For		Plumbing			
Owner of Bldg		Hector J. Lottis			
Owner's Address		97 Exchange St.		Date 2/11/70	
Plumber		Joe Lottis		NO	FEE
NEW	REPL				
X		SINKS		1	
X		LAVATORIES		2	
X		TOILETS		2	
X		BATH TUBS		1	
		SHOWERS			
		DRAINS FLOOR SURFACE		1	
		HOT WATER TANKS			
X		TANKLESS WATER HEATERS		1	
		G. TRAGE DISPOSALS			
		SEPTIC TANKS			
		HOUSE SEWERS			
		ROOF LEADERS			
X		AUTOMATIC WASHLRS		1	
		DISHWASHERS			
		OTHER			
TOTAL				9	.40

Building and Inspection Services Dept.: Plumbing Inspection

(COPY)

CITY OF PORTLAND, MAINE
Department of Building Inspection



Certificate of Occupancy

LOCATION Lot 4 Jersey Avenue

Issued to Robert Hayton & Steve Notis
97 Exchange St.

Date of Issue May 1, 1951

This is to certify that the building, premises, or part thereof at the above location, as altered or changed use under Building Permit No. 70/42, has had final inspection, has been found to conform substantially to requirements of Zoning Ordinance and Building Code of the City, and is hereby approved for occupancy or use, limited or otherwise, as indicated below.

PORTION OF BUILDING OR PREMISES

APPROVED OCCUPANCY

Entire

One family dwelling house.

Limiting Conditions:

This certificate supersedes
certificate issued

Approved:

E. A. Smith
(Date) Inspector

A. A. Allen
Inspector of Buildings

Notice: This certificate identifies lawful use of building or premises, and ought to be transferred from owner to owner when property changes hands. Copy will be furnished to owner or lessee for one dollar.

H

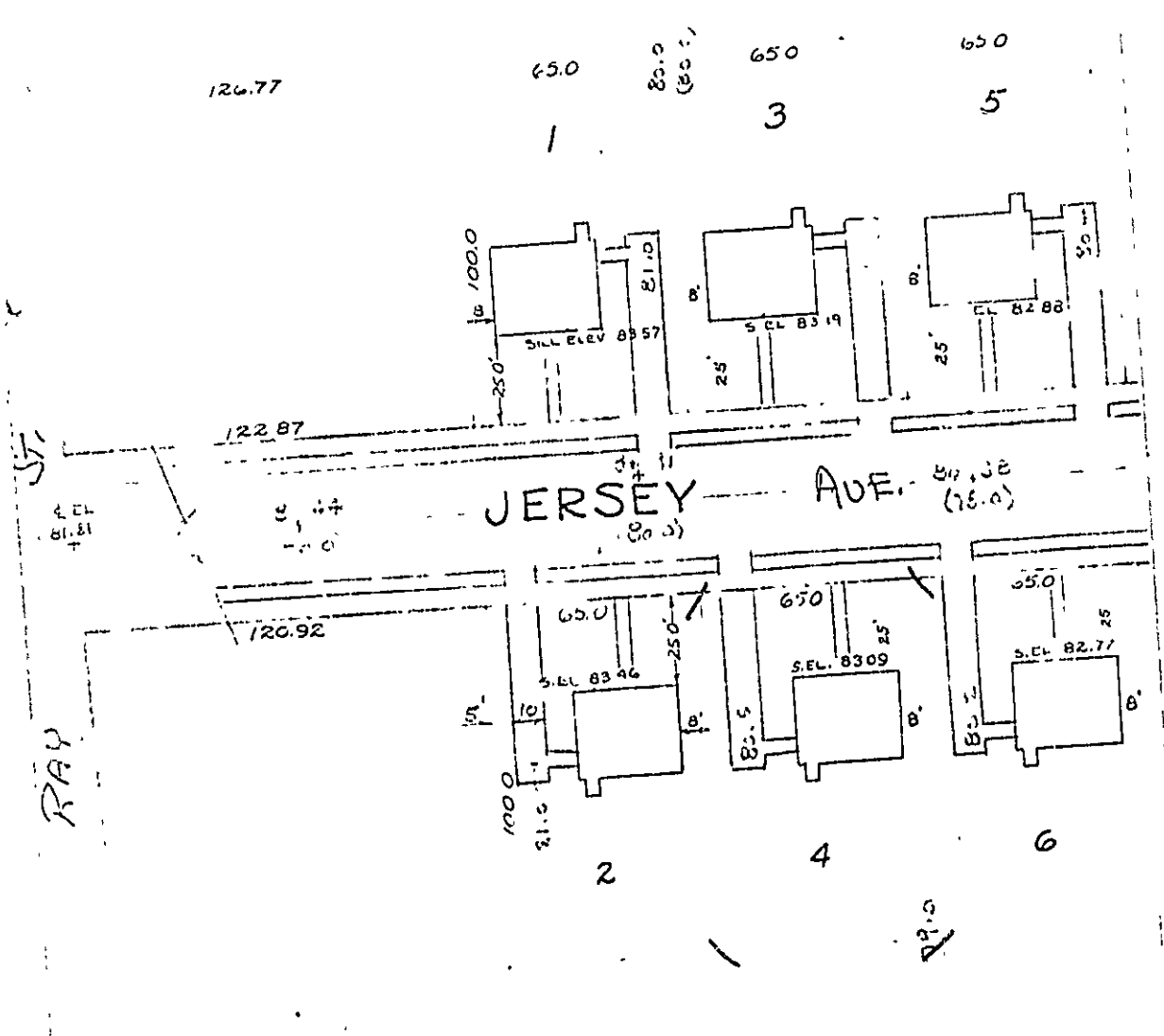
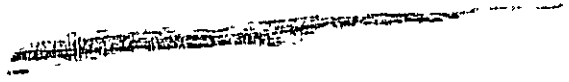

RAY

82.0



R3 RESIDENCE ZONE

APPLICATION FOR PERMIT

PERMIT ISSUED

JAN 13 1970

Class of Building or Type of Structure Third Class
Portland, Maine, December 12, 1969

To the INSPECTOR OF BUILDINGS, PORTLAND, MAINE

The undersigned hereby applies for a permit to erect alter repair demolish install the following building structure equipment in accordance with the Laws of the State of Maine, the Building Code and Zoning Ordinance of the City of Portland, plans and specifications, if any, submitted herewith and the following specifications:

Location Lot 4 Jersey Ave. Within Fire Limits? Dist. No.
Owner's name and address Robert Hayden & Steve Notis, 97 Exchange St. Telephone 774-7888
Lessees name and address Telephone
Contractor's name and address owners Telephone
Architect Specifications Plans yes No. of sheets 7
Proposed use of building Dwelling No. families 1
Last use No. families
Material frame No. stories 1 1/2 Heat Style of roof Roofing
Other buildings on same lot
Estimated cost \$ 12,000 Fee \$ 24.00

General Description of New Work

To construct 1 1/2-story frame dwelling 24' x 32'

It is understood that this permit does not include installation of heating apparatus which is to be taken out separately by and in the name of the heating contractor. PERMIT TO BE ISSUED TO owners

Details of New Work

Is any plumbing involved in this work? yes Is any electrical work involved in this work? yes
Is connection to be made to public sewer? yes If not, what is proposed for sewage?
Has septic tank notice been sent? Form notice sent?
Height average grade to top of plate 5'2" Height average grade to highest point of roof 21'4"
Size, front 32' depth 24' No. stories 1 1/2 solid or filled land? solid earth or rock? earth
Material of foundation concrete at least 7" below grade Thickness, top 10" bottom 10" cellar yes
Kind of roof pitch Rise per foot 3" Roof covering Asphalt Class C Und Label.
No. of chimneys 1 Material of chimneys brick of lining tile Kind of heat f.h. water fuel oil
Framing Lumber-Kind hemlock Dressed or full size? dressed Corner posts 4x6 Sills 2x6 box
Size Girder 6x10 d.f. Columns under girders lally Size 3 1/2" Max. on centers 8'4"
Studs (outside walls and carrying partitions) 2x4-16" O. C. Bridging in every floor and flat roof span over 8 feet.
Joists and rafters: 1st floor 2x10, 2nd 2x8, 3rd, roof 2x8
On centers: 1st floor 16", 2nd 16", 3rd, roof 16"
Maximum span: 1st floor 12', 2nd 13', 3rd, roof 18'
If one story building with masonry walls, thickness of walls? height?

If a Garage

No. cars now accommodated on same lot, to be accommodated, number commercial cars to be accommodated
Will automobile repairing be done other than minor repairs to cars habitually stored in the proposed building?

APPROVED:

B.C. O.K. P.P. 11/2/70
O.K. - 11/13/70 - Zoning - All.

Miscellaneous

Will work require disturbing of any tree on a public street? no
Will there be in charge of the above work a person competent to see that the State and City requirements pertaining thereto are observed? yes

Robert Hayden & Steve Notis

CS 331

INSPECTION COPY

Signature of owner

by:

Steve Notis

Handwritten initials

NOTES

Permit No. 70/47

Location 1st & Vermont Ave.

Owner Alvin H. ...

Date of permit 1/18/70

Notif closing-in

Inspn. closing-in

Final Notif. Notif. Final Insp. requirement 3/18/70

Final Inspn.

Cert. of Occupancy issued 3/5/70 D. ...

Staking Out Notice

Form Check Notice

Sent to Health Dept
Inced from Health Dept 5/18/70

Form imp made

3-7-70 OK to close
in - to fire stop
chimney at 2nd
floor ceiling
5/15/70 - Put to use
usual. HP

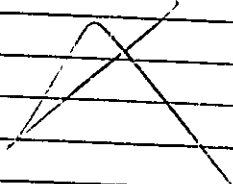



R3 RESIDENTIAL ZONE

APPLICATION FOR PERMIT

Class of Building or Type of Structure Third Class
Portland, Maine, December 12, 1969

PERMIT ISSUED

JAN 13 1970

CITY OF PORTLAND

To the INSPECTOR OF BUILDINGS, PORTLAND, MAINE

The undersigned hereby applies for a permit to erect alter repair demolish install the following building structure equipment in accordance with the Laws of the State of Maine, the Building Code and Zoning Ordinance of the City of Portland, plans and specifications, if any, submitted herewith and the following specifications:

Location Lot 4 Jersey Ave. Within Fire Limits? _____ Dist. No. _____
 Owner's name and address Robert Hayden & Steve Notis, 97 Exchange St. Telephone 774-7888
 Lessee's name and address _____ Telephone _____
 Contractor's name and address owners Telephone _____
 Architect _____ Specifications _____ Plans yes Telephone _____
 Proposed use of building Dwelling No. of sheets 7
 Last use _____ No. families 1
 Material frame No. stories 1 1/2 Heat _____ Style of roof _____
 Other buildings on same lot _____ (roof) _____
 Estimated cost \$ 12,000 Fee \$ 24.00

General Description of New Work

To construct 1 1/2-story frame dwelling 24' x 32'

It is understood that this permit does not include installation of heating apparatus which is to be taken out separately by and in the name of the heating contractor. **PERMIT TO BE ISSUED TO** owners

Details of New Work

Is any plumbing involved in this work? yes Is any electrical work involved in this work? yes
 Is connection to be made to public sewer? yes If not, what is proposed for sewage? _____
 Has septic tank notice been sent? _____ Form notice sent? yes
 Height average grade to top of plate 9'2" Height average grade to highest point of roof 21'4"
 Size, front 32' depth 24' No. stories 1 1/2 solid or filled land? solid earth or rock? earth
 Material of foundation concrete at least 4' below grade _____ Thickness, top 10" bottom 10" earth? yes
 Kind of roof pitch Rise per foot 3" Roof covering Asphalt Clas C Und Label.
 No. of chimneys 1 Material of chimneys brick of lining tile Kind of heat f.h. water fuel oil
 Framing Lumber—Kind hemlock Dressed or full size? dressed Corner posts 4x6 Sills 2x6 box
 Size Girder 6x10 d.f. Columns under girders Lally Size 3 1/2" Max. on centers 8'4"
 Studs (outside walls and carrying partitions) 2x4-16" O. C. Bridging in every floor and flat roof span over 8 feet.
 Joists and rafters: 1st floor 2x10, 2nd 2x8, 3rd _____, roof 2x8
 On centers: 1st floor 16", 2nd 16", 3rd _____, roof 16"
 Maximum span: 1st floor 12', 2nd 13', 3rd _____, roof 18'
 If one story building with masonry walls, thickness of walls? _____ height? _____

If a Garage

No. cars now accommodated on same lot _____, to be accommodated _____ number commercial cars to be accommodated _____
 Will automobile repairing be done other than minor repairs to cars habitually stored in the proposed building? _____

APPROVED:

B.C. O.K. E.P. 11/2/70
O.K. - 11/3/70 - Zoning - All.

Miscellaneous

Will work require disturbing of any tree on a public street? no
 Will there be in charge of the above work a person competent to see that the State and City requirements pertaining thereto are observed? yes

Robert Hayden & Steve Notis

INSPECTION COPY

Signature of owner by: Steve Notis

NOTES

Forming made. E.H.
 3-7-70 OK to close
 in - to fire stop
 chimney at 2nd
 floor ceiling. AD
 5/15/70 - Out to be
 wired. HP

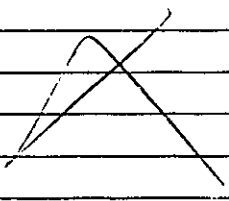

Permit No. 70/43
 Location 1st & Denver Ave.
 Owner Patrick Spangler's Steam Heat
 Date of permit 1/13/70
 Notif. closing-in
 Inspn. closing-in
 Final Notif. 3/18/70
 Final Inspn.
 Cert. of Occupancy Issued 5/15/70 = G. C. Walker
 Sinking Out Notice
 Form Check Notice

Sent to Public Dept.
 Rec'd Insp. 5/18/70