

324-330 CIV. RT.

STANLEY
S 9203-12



APPLICATION FOR PERMIT
DEPARTMENT OF BUILDING INSPECTIONS SERVICES
ELECTRICAL INSTALLATIONS

Date Oct. 22, 19 81
Receipt and Permit number 173294

To the CHIEF ELECTRICAL INSPECTOR, Portland, Maine:

The undersigned hereby applies for a permit to make electrical installations in accordance with the laws of Maine, the Portland Electrical Ordinance, the National Electrical Code and the following specifications:

LOCATION OF WORK: 336 Ray St.

OWNER'S NAME: Anna Aiken ADDRESS: same

	FEES
OUTLETS:	
Receptacles _____ Switches _____ Plugmold _____ ft. TOTAL _____	
FIXTURES: (number of)	
Incandescent _____ Fluorescent _____ (not strip) TOTAL _____	
Strip Fluorescent _____ ft. _____	
SERVICES:	
Overhead _____ Underground _____ Temporary _____ TOTAL amperes _____	
METERS: (number of) _____	
MOTORS: (number of)	
Fractional _____	
1 HP or over _____	
RESIDENTIAL HEATING:	
Oil or Gas (number of units) <u>x</u> _____	3.00
Electric (number of rooms) _____	
COMMERCIAL OR INDUSTRIAL HEATING:	
Oil or Gas (by a main boiler) _____	
Oil or Gas (by separate units) _____	
Electric Under 20 kws _____ Over 20 kws _____	
APPLIANCES: (number of)	
Ranges _____	Water Heaters _____
Cook Tops _____	Disposals _____
Wall Ovens _____	Dishwashers _____
Dryers _____	Compactors _____
Fans _____	Others (denote) _____
TOTAL _____	
MISCELLANEOUS: (number of)	
Branch Panels _____	
Transformers _____	
Air Conditioners Central Unit _____	
Separate Units (windows) _____	
Signs 20 sq. ft. and under _____	
Over 20 sq. ft. _____	
Swimming Pools Above Ground _____	
In Ground _____	
Fire/Burglar Alarms Residential _____	
Commercial _____	
Heavy Duty Outlets, 220 Volt (such as welders) 30 amps and under _____	
over 30 amps _____	
Circus, Fairs, etc. _____	
Alterations to wires _____	
Repairs after fire _____	
Emergency Lights, battery _____	
Emergency Generators _____	
INSTALLATION FEE DUE: _____	
FOR ADDITIONAL WORK NOT ON ORIGINAL PERMIT DOUBLE FEE DUE: _____	
FOR REMOVAL OF A "STOP ORDER" (304-16.b) _____	
TOTAL AMOUNT DUE: _____	3.00

INSPECTION:

Will be ready on ready, 19 81; or Will Call _____

CONTRACTOR'S NAME: Rudi the Plumber

ADDRESS: 1231 Forest Avenue

TEL.: _____

MASTER LICENSE NO.: 1076

SIGNATURE OF CONTRACTOR: _____

LIMITED LICENSE NO.: _____

INSPECTOR'S COPY — WHITE

OFFICE COPY — CANARY

CONTRACTOR'S COPY — GREEN

Permit Number 102517

Permit Number 102517

Location	Address	City	State	Zip	Country

CHANCE: 2000 17 1

104

and Inspector
1766-2-11
8511

by Inspector [redacted] 107

Formulário de Registro - RGE 100. _____

INSPECTIONS: Service _____ by _____

Service called in _____

Closing in _____ by _____

PROGRESS INSPECTIONS: 10-29-81 NOH

10-29-81 NCH
10-30-81 NCH

10-30-81, NCH

11-18-f1 Not1

[illegible]

_____ / _____ / _____

Downloaded from <http://www.jstor.org/> on Tue, 20 Jun 2016 12:00:00 UTC
All use subject to [JSTOR Terms and Conditions](#)

CODE
COMPLIANCE
COMPLETED

DATE 12/22/81

DATE:

REMARKS:

This image shows a single sheet of white paper with horizontal blue or grey ruling lines. A vertical line runs down the left side, creating a margin. The paper appears to be from a notebook or a standard sheet of stationery. There are some faint smudges and marks on the surface, particularly near the top and bottom edges.



FILL IN AND SIGN WITH INK

APPLICATION FOR PERMIT FOR
HEATING, COOKING OR POWER EQUIPMENT

001143

PERMIT ISSUED

OCT 26 1981

Portland, Maine, Oct 22, 1981

CITY OF PORTLAND

To the INSPECTOR OF BUILDINGS, PORTLAND, ME.

The undersigned hereby applies for a permit to install the following heating, cooking or power equipment in accordance with the Laws of Maine, the Building Code of the City of Portland, and the following specifications:

Location 336 Ray St. Use of Building dwelling- single No. Stories New Building
Name and address of owner of appliance Anna Aiken = same Existing "xx"
Installer's name and address Rudi the Plumber-1231 Forest Ave. Telephone

General Description of Work

To install gas boiler - replacing oil gas boiler

IF HEATER, OR POWER BOILER

Location of appliance Any burnable material in floor surface or beneath?
If so, how protected? Kind of fuel? gas
Minimum distance to burnable material, from top of appliance or casing top of furnace
From top of smoke pipe From front of appliance From sides or back of appliance
Size of chimney flue Other connections to same flue
If gas fired, how vented? thru chimney Rated maximum demand per hour 60,000
Will sufficient fresh air be supplied to the appliance to insure proper and safe combustion? yes BTU Per hour

IF OIL BURNER

Name and type of burner Weil- McLain Labeled by underwriters' laboratories? AGA
Will operator be always in attendance? Does oil supply line feed from top or bottom of tank?
Type of floor beneath burner concrete Size of vent pipe
Location of oil storage Number and capacity of tanks
Low water shut off Make No.
Will all tanks be more than five feet from any flame? How many tanks enclosed?
Total capacity of any existing storage tanks for furnace burners

IF COOKING APPLIANCE

Location of appliance Any burnable material in floor surface or beneath?
If so, how protected? Height of Legs, if any
Skirting at bottom of appliance? Distance to combustible material from top of appliance?
From front of appliance From sides and back From top of smokepipe
Size of chimney flue Other connections to same flue
Is hood to be provided? If so, how vented? Forced or gravity?
If gas fired, how vented? Rated maximum demand per hour

MISCELLANEOUS EQUIPMENT OR SPECIAL INFORMATION

Amount of fee enclosed? 15.00

APPROVED:

Will there be in charge of the above work a person competent to see that the State and City requirements pertaining thereto are observed?

CS 300

INSPECTION COPY

Signature of Installer

NOTES

11-91 Have made attempts to
get in contact with Mr. 112
12-3-91 not available
12-10-91 " "

5/10/82 New Gas boiler
replacing existing
gas boiler. New
Low water - cutoff ✓

- 20. Thermal control switch
- 19. Smoke & CO combustible
- 18. Automatic reset button
- 17. On/Off switch
- 16. Instruction Card
- 15. On/Off switch & support
- 14. On/Off switch
- 13. On/Off switch
- 12. On/Off switch
- 11. On/Off switch
- 10. On/Off switch
- 9. On/Off switch
- 8. On/Off switch
- 7. On/Off switch
- 6. On/Off switch
- 5. On/Off switch
- 4. On/Off switch
- 3. On/Off switch
- 2. On/Off switch
- 1. On/Off switch

Permit No. 81/1140
Location 336 Bay St
Owner Anna L. Linn
Date of permit 10-22-81
Approved 10-26-81

Address 336 Ray St. PERMIT NUMBER **2432**
Installation For 2nd floor

10-22-81
Portland Plumbing Inspector

App. First Insp.

By

App. Fincl Insp.

Date _____

By

Type of Bldg.

- ☐ Commercial
☒ Residential
☐ Single
☐ Multi Family
☐ New Construction
☐ Remodeling

Address 335 Ray St.
Installation For

Installation For 336 Ray St.
Owner of Bldg one family

Owner of Bldg.	one family
Owner's Address	Anna Aiken

Owner's Address. Anna - Ai
Plumber: same

Plumber: same
NEW REPL Rudi the Plumber
1231

Date: 10-22-81

NEW	REPL	1331 Forest Ave.	Date
		SINKS	NO. 10-22-61
		LAVATORIES	
		TOILETS	
		BATH TUBS	
		SHOWERS	
		DRAINS FLOOR SURFACE	
*		HOT WATER TANKS	
		TANKLESS WATER HEATERS	1 6.00
		GARBAGE DISPOSALS	
		SEPTIC TANKS	
		HOUSE SEWERS	
		ROOF LEADERS	
		AUTOMATIC WASHERS	
		DISHWASHERS	
		OTHER	
		TOTAL	

Building and Inspection Services Dept.: P1

ing Inspection

~~6.00~~



H106H

APPLICATION FOR PERMIT

Class of Building or Type of Structure _____

Portland, Maine, _____

PERMIT ISSUED

JUN 24 1974

00559

CITY OF PORTLAND

To the INSPECTOR OF BUILDINGS, PORTLAND, MAINE

The undersigned hereby applies for a permit to erect alter repair demolish install the following building structure equipment in accordance with the Laws of the State of Maine, the Building Code and Zoning Ordinance of the City of Portland, plans and specifications, if any, submitted herewith and the following specifications:

Location 336 Ray Street Within Fire Limits? _____ Dist. No. _____
Owner's name and address Mrs. Anna Aiken Telephone 871-2549
Lessee's name and address _____ Telephone _____
Contractor's name and address Maine Shawnee Step Co., Inc. Telephone _____
Architect _____ Specifications _____ Plans _____ No. of sheets _____
Proposed use of building _____ No. families 1
Last use _____ No. families _____
Material _____ No. stories 1 Heat _____ Style of roof _____ Roofing _____
Other buildings on same lot _____
Estimated cost \$ 429.00 Fee \$ 5.00

General Description of New Work

REAR Shawnee Step - 4' wide, 4 riser, 60" platform (sideways step)
Ht=30", Proj=4'

To replace old wood step approximate same size.
Foundation - (2) 8"x8"x4' posts and angle irons.

DISTANCE FROM HOUSE TO REAR LOT LINE = 75 ft.

According to standard Shawnee plan. Approved by R. I. Perry,
Structural Engineer filed in the building department 8/15/57.

It is understood that this permit does not include installation of heating apparatus which is to be taken out separately by and in the name of the heating contractor. PERMIT TO BE ISSUED TO

Details of New Work

Is any plumbing involved in this work? _____ Is any electrical work involved in this work? _____
Is connection to be made to public sewer? _____ If not, what is proposed for sewage? _____
Has septic tank notice been sent? _____ Form notice sent? _____
Height average grade to top of plate _____ Height average grade to highest point of roof _____
Size, front _____ depth _____ No. stories _____ solid or filled land? _____ earth or rock? _____
Material of foundation: _____ Thickness, top _____ bottom _____ cellar _____
Kind of roof _____ Rise per foot _____ Roof covering _____
No. of chimneys _____ Material of chimneys _____ of lining _____ Kind of heat _____ fuel _____
Framing Lumber-Kind _____ Dressed or full size? _____ Corner posts _____ Sills _____
Size Girder _____ Columns under girders _____ Size _____ Max. on centers _____
Studs (outside walls and carrying partitions) 2x4-16" O. C. Bridging in every floor and flat roof span over 8 feet.
Joists and rafters: 1st floor _____, 2nd _____, 3rd _____, roof _____
On center: 1st floor _____, 2nd _____, 3rd _____, roof _____
Maximum span: 1st floor _____, 2nd _____, 3rd _____, roof _____
If one story building with masonry walls, thickness of walls? _____ height? _____

If a Garage

No. cars now accommodated on same lot _____, to be accommodated _____ number commercial cars to be accommodated _____
Will automobile repairing be done other than minor repairs to cars habitually stored in the proposed building? _____

APPROVED:

Miscellaneous

Will work require disturbing of any tree on a public street? _____
Will there be in charge of the above work a person competent to see that the State and City requirements pertaining thereto are observed? _____

CS 301

INSPECTION COPY

Signature of owner

Richard L. Snow

Permit No. 74/554
Location 336 Bay St
Owner Anna Allen
Date of permit 6-24-74
No. closing in
Inspn. closing in
Final Notif
Final Inspn.
Cert. of Occupancy issued
Sinking Out Notice
Form Check Notice

NOTES

July 8 74 -
Installed this
Ann
File

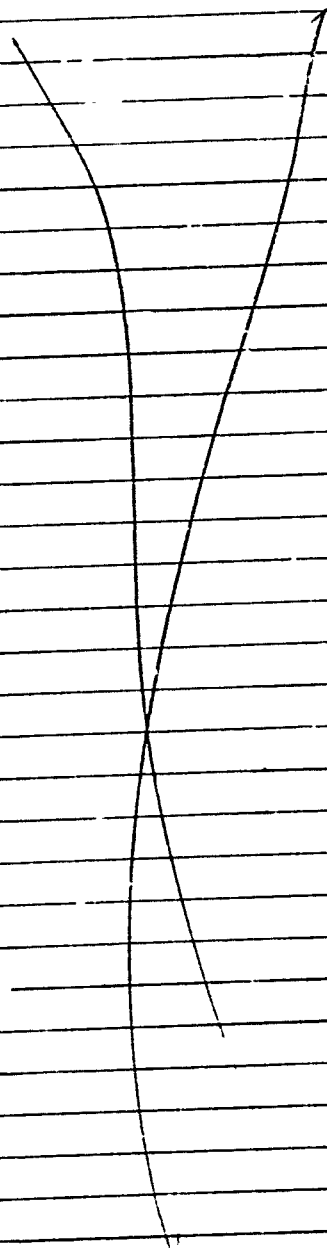



CITY OF PORTLAND
DEPARTMENT OF BUILDING INSPECTION

GAS FITTING CERTIFICATE

The entire system of new gas piping, fittings and equipment in the building
at 336 Ray St.
has been installed in accordance with the Building Code of the City of Portland,
was properly air tested on 10-17-56 and found to satisfy
said test. The service supply pipe from street main is 1 1/2
inches in diameter and all shut-offs required by law have been provided.

Elmer H. Spaulding, Jr.
Signature, in ink, of person in charge of fitting.
Portland Gas Light Co.
Gas Fitting Contractor

After signing, this tag to be attached to "METER FIT" in building and not removed
except by City Inspector.

PAINTING CO., PORTLAND

(COPY)



CITY OF PORTLAND, MAINE
Department of Building Inspection

Certificate of Occupancy

LOCATION 336-338 Ray St.

Issued to Portland Construction Co.

Date of Issue Oct. 31, 1956

This is to certify that the building, premises, or part thereof, at the above location, built—~~under~~
~~under~~ Building Permit No. 56/1070, has had final inspection, has been found to conform
substantially to requirements of Zoning Ordinance and Building Code of the City, and is hereby approved for
occupancy or use, limited or otherwise, as indicated below.

PORTION OF BUILDING OR PREMISES

Entire

APPROVED OCCUPANCY

One-family Dwelling House

Limiting Conditions:

This certificate supersedes
certificate issued

Approved:

10/30/56

(Date)

Inspector

Inspector of Buildings

Notice: This certificate identifies lawful use of building or premises, and ought to be transferred from
owner to owner when property changes hands. Copy will be furnished to owner or lessee for one dollar.

PORTLAND CONSTRUCTION CORP.

PORTLAND, MAINE

PLOT PLAN - HOUSE #6, Ray St., Portland, Me.

Survey being made by Douglas J. Williamson

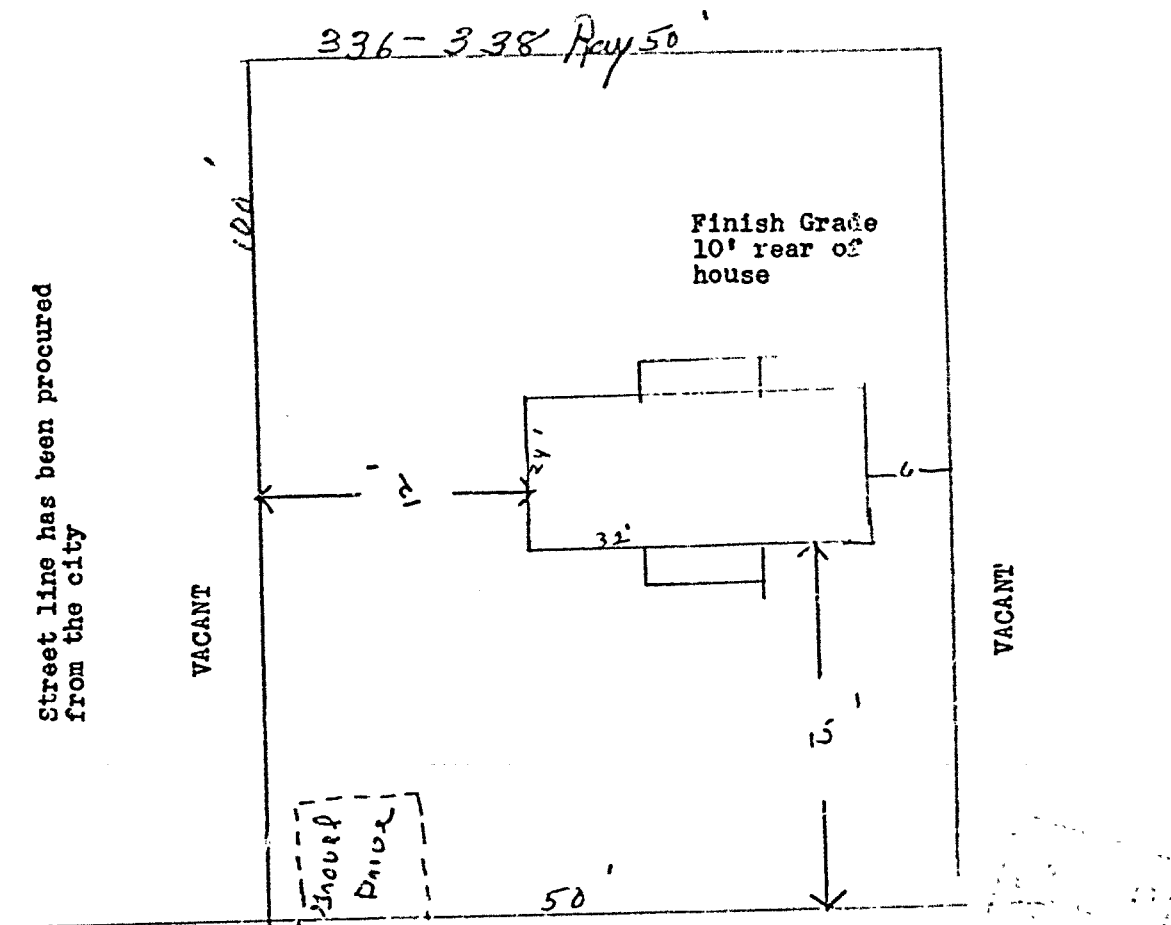

House #6 Ray St., Portland, Maine-Public Works

will give Street number -Sewer, Water, Gas, Elec.



RESIDENCE ZONE - C

APPLICATION FOR PERMIT

Class of Building or Type of Structure Third ClassPortland, Maine, July 20, 1956

CITY OF PORTLAND

RECEIVED

CITY OF PORTLAND

To the INSPECTOR OF BUILDINGS, PORTLAND, MAINE

The undersigned hereby applies for a permit to erect alter, repair, demolish or remove the following building structure or structures in accordance with the Laws of the State of Maine, the Building Code and Zoning Ordinance of the City of Portland, plans and specifications, if any, submitted herewith and the following specifications:

Location 336-338 Bay St. Within Fire Limits? no Dist. No. 1
Owner's name and address Portland Construction Corp., 234 Middle St. Telephone 4-0331
Lessee's name and address _____ Telephone 2-6822
Contractor's name and address owner Telephone _____
Architect _____ Specifications _____ Plans yes No. of sheets 1
Proposed use of building dwelling house No. families 1
Last use _____ No. families _____
Material _____ No. stories _____ Heat _____ Style of roof _____ Roofing _____
Other buildings on same lot _____
Estimated cost \$ 7,000. Fee 7.00

General Description of New Work

To construct 1-story frame dwelling house 32' 8" x 24' 4".

Kind and thickness of outside sheathing of exterior walls? 25/32 Bieldrite Sheathing
It is understood that this permit does not include installation of heating apparatus which is to be taken out separately by and in the name of the heating contractor. PERMIT TO BE ISSUED TO owner

Details of New Work

Is any plumbing involved in this work? yes Is any electrical work involved in this work? yes
Is connection to be made to public sewer? yes If not, what is proposed for sewage? _____
Has septic tank notice been sent? _____ Form notice sent? yes
Height average grade to top of plate 9' Height average grade to highest point of roof 11'
Size, front 32' 8" depth 24' 4" No. stories 1 solid or filled land? solid earth or rock? earth
Material of foundation concrete at least 4' below grade Thickness, top 10" bottom 10" cellar yes
Material of underpinning " to sill Height _____ Thickness _____
Kind of roof pitch-gable Rise per foot 5" Roof covering Asphalt Class C Und Lab
No. of chimneys 1 Material of chimneys brick of lining tile Kind of heat oil waterfuel oil
Framing lumber—Kind herlock Dressed or full size? dressed
Corner posts Lx6 Sills box Girt or ledger board? _____ Size _____
Girders yes Size 6x8 Columns under girders 1x11 Size 2 1/2" Max. on centers 7' 0"
Studs (outside walls and carrying partitions) 2x4-16" O. C. Bridging in every floor and flat roof span over 8 feet.
Joists and rafters: 1st floor 2x8, 2nd _____, 3rd _____, roof 2x8 truss
On centers: 1st floor 16", 2nd _____, 3rd _____, roof _____
Maximum span: 1st floor 12', 2nd _____, 3rd _____, roof _____
If one story building with masonry walls, thickness of walls? _____ height? _____

If a Garage

No. cars now accommodated on same lot _____, to be accommodated _____ number commercial cars to be accommodated _____
Will automobile repairing be done other than minor repairs to cars habitually stored in the proposed building? _____

APPROVED:

O.K. - 7/21/56 - A.J.S.

Miscellaneous

Will work require disturbing of any tree on a public street? no
Will there be in charge of the above work a person competent to see that the State and City requirements pertaining thereto are observed? yes

Portland Construction Corp.

INSPECTION COPY

Signature of owner by: B. Haggan

NOTES

7/27/56 - They would like to have plans sent at 9 A.M. Monday (July 30th). I told Braden what you would be busy Monday morning and I wouldn't tell him when you would be out. I told him he could call between 8 & 9 Monday and you might be able to tell him to tell him when you would be out. — Allen
 8/27/56 - Sept 7th 7, 10 closing P.M.
 9/9/56 - Sept 10th to 11th 8 & 9
 10/30/56 - work done P.M.

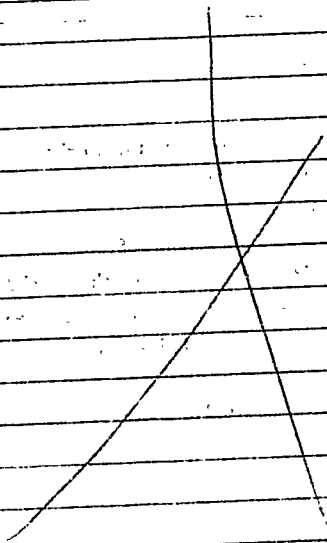

8/4/56 2/25/56
 2/25/56 1/1/56
 Permit No. 56/1070
 Location 336-338 Rice St.
 Owner Portland Cement Co.
 Date of permit 7/23/56
 Notif. closing-in 8/27/56 8:30
 Inspn. closing-in 8/27/56 8:30
 Inspn. closing-in 8/27/56 8:30
 Final Notif. 10/30/56 10:40
 Final Inspn. 10/30/56
 Cert. of Occupancy issued 10/31/56
 Staking Out Notice
 Form Check Notice 7/27/56 - 12 PM



FILL IN AND SIGN WITH INK

APPLICATION FOR PERMIT FOR
HEATING, COOKING OR POWER EQUIPMENT

Portland, Maine, Aug. 13, 1956

PERMIT ISSUED
01277

AUG 13 1956

CITY OF PORTLAND

N-ESS

To the INSPECTOR OF BUILDINGS, PORTLAND, ME.

The undersigned hereby applies for a permit to install the following heating, cooking or power equipment in accordance with the Laws of Maine, the Building Code of the City of Portland, and the following specifications:

Location 336 Ray St. Use of Building 1-family dwelling No. Stories 1 New Building
Name and address of owner of appliance Portland Construction Corp., 234 Middle St. Existing
Installer's name and address Portland Gas Light Co., 5 Temple St. Telephone 2-8321

General Description of Work

To install gas-fired GK-16-N.E. National Hot water heating system

IF HEATER, OR POWER BOILER

Location of appliance basement Any burnable material in floor surface or beneath? no
If so, how protected? Kind of fuel? gas
Minimum distance to burnable material, from top of appliance or casing top of furnace over 2'
From top of smoke pipe over 15' From front of appliance over 4' From sides or back of appliance over 3'
Size of chimney flue 8x12 Other connections to same flue none
If gas fired, how vented? Rated maximum demand per hour
Will sufficient fresh air be supplied to the appliance to insure proper and safe combustion? yes

IF OIL BURNER

Name and type of burner Labelled by underwriters' laboratories?
Will operator be always in attendance? Does oil supply line feed from top or bottom of tank?
Type of floor beneath burner Size of vent pipe
Location of oil storage Number and capacity of tanks
Low water shut off Make No.
Will all tanks be more than five feet from any flame? How many tanks enclosed?
Total capacity of any existing storage tanks for furnace burners

IF COOKING APPLIANCE

Location of appliance Any burnable material in floor surface or beneath?
If so, how protected? Height of Legs, if any
Skirting at bottom of appliance? Distance to combustible material from top of appliance?
From front of appliance From sides and back From top of smoke pipe
Size of chimney flue Other connections to same flue
Is hood to be provided? If so, how vented? Forced or gravity?
If gas fired, how vented? Rated maximum demand per hour

MISCELLANEOUS EQUIPMENT OR SPECIAL INFORMATION

Furnace is equipped with device which will automatically shut off all gas supply in case pilot flame is extinguished.

Amount of fee enclosed? 2.00 (\$2.00 for one heater, etc., 50 cents additional for each additional heater, etc., in same building at same time.)

APPROVED:

OK 288.8/18/56

Will there be in charge of the above work a person competent to see that the State and City requirements pertaining thereto are observed? yes

Portland Gas Light Co.

Signature of Installer by:

Ray H. Gaudin Jr.

INSPECTION COPY

C17 185 IN MAINE PRINTING CO.

NOTES

10/30/56 - *W. L. L. done* *SH*

Permit No. *56/1277*

Location *336 Gray St*

Owner *Crilland Industries*

Date of permit *8/13/56*

Approved *10/30/56*



APPLICATION FOR PERMIT
DEPARTMENT OF BUILDING INSPECTIONS SERVICES
ELECTRICAL INSTALLATIONS

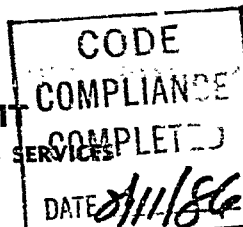

Date August 6, 1986
Receipt and Permit number D-24402

To the CHIEF ELECTRICAL INSPECTOR, Portland, Maine:

The undersigned hereby applies for a permit to make electrical installations in accordance with the laws of Maine, the Portland Electrical Ordinance, the National Electrical Code and the following specifications:

LOCATION OF WORK: 336 Ray Street
OWNER'S NAME: Anna J. Aiken ADDRESS: 336 Ray St. FEES

OUTLETS: Receptacles Switches Plugmold ft. TOTAL

FIXTURES: (number of) Incandescent Fluoresc (not strip) TOTAL
Strip Fluorescent ft.

SERVICES: Overhead x Underground Temporary TOTAL amperes 100 3.00
50

METERS: (number of) 1

MOTORS: (number of) Fractional 1 HP or over

RESIDENTIAL HEATING: Oil or Gas (number of units) Electric (number of rooms)

COMMERCIAL OR INDUSTRIAL HEATING: Oil or Gas (by a main boiler) Oil or Gas (by separate units) Electric Under 20 kws Over 20 kws

APPLIANCES: (number of) Ranges Cook Tops Wall Ovens Dryers Fans Water Heaters Disposals Dishwashers Compactors Others (denote)

TOTAL

MISCELLANEOUS: (number of) Branch Panels Transformers Air Conditioners Central Unit Separate Units (windows) Signs 20 sq. ft. and under Over 20 sq. ft. Swimming Pools Above Ground In Ground Fire/Burglar Alarms Residential Commercial Heavy Duty Outlets, 220 Volt (such as welders) 30 amps and under over 30 amps Circus, Fairs, etc. Alterations to wires Repairs after fire Emergency Lights, battery Emergency Generators

INSTALLATION FEE DUE: DOUBLE FEE DUE:

FOR ADDITIONAL WORK NOT ON ORIGINAL PERMIT

FOR REMOVAL OF A "STOP ORDER" (304-16.b)

TOTAL AMOUNT DUE: Min 5.00

INSPECTION: Will be ready on , 19 ; or Will Call XX

CONTRACTOR'S NAME: Eugene Hamilton

ADDRESS: So. Windham, Maine Park Park Road

TEL: 892-9494

MASTER LICENSE NO.: 2514 SIGNATURE OF CONTRACTOR: Ben Hamilton

LIMITED LICENSE NO.: mD

INSPECTOR'S COPY — WHITE

OFFICE COPY — CANARY

CONTRACTOR'S COPY — GREEN

INSPECTIONS: Service 100 AMP by D. Russo
Service called in to C.M.P. 8/11/86
Closing in _____ by _____

PROGRESS INSPECTIONS: _____ / _____ / _____
_____ / _____ / _____
_____ / _____ / _____
_____ / _____ / _____
_____ / _____ / _____
_____ / _____ / _____

Permit Application Register Page No. 118

By Inspector O. K. Lucas

Final Inspection 8/11/86

Date of Permit 8/6/86

Owner Raymond J. Lucas

Location 336 Ray St

Permit Number 24402

ELECTRICAL INSTALLATIONS

DATE:

REMARKS:

8/11/86 Completed. D.R.R.

Anna Calben

City of Portland, Maine – Building or Use Permit Application 389 Congress Street, 04101, Tel: (207) 874-8703, FAX: 874-8716

Location of Construction: 336 Ray St		Owner: Anna Aiken		Phone: 797-4676		Permit No: 970037
Owner Address: 336 Ray St- Ptld ME 04103		Leasee/Buyer's Name:		Business Name:		
Contractor Name: American Profiles Co., Inc.		Address: 179 Sheridan St- Ptld ME 04101		Phone: 773-6122		<div style="border: 2px solid black; padding: 5px; text-align: center;"> PERMIT ISSUED JAN 16 1997 CITY OF PORTLAND </div>
Past Use: 1-fam dwlg		Proposed Use: 1-fam w deck		COST OF WORK: \$ 12,700 PERMIT FEE: \$ 85 INSPECTION: Use Group R3 Type: 5B Signature: <i>[Signature]</i>		
Proposed Project Description: construct enclosed deck - 10'x12'				PEDESTRIAN ACTIVITIES DISTRICT (P.A.D.) Action: <input type="checkbox"/> Approved <input type="checkbox"/> Approved with Conditions <input type="checkbox"/> Denied Signature: _____ Date: _____		Zones: R-3 CBL: Zoning Approval: <i>[Signature]</i> 1/10/97 Special Zone or Reviews: <input type="checkbox"/> Shoreland <input type="checkbox"/> Wetland <input type="checkbox"/> Flood Zone <input type="checkbox"/> Subdivision <input type="checkbox"/> Site Plan maj <input type="checkbox"/> minor <input type="checkbox"/> mm <input type="checkbox"/>
Permit Taken By: L Chase		Date Applied For: 1/6/97				

1. This permit application doesn't preclude the Applicant(s) from meeting applicable State and Federal rules.
2. Building permits do not include plumbing, septic or electrical work.
3. Building permits are void if work is not started within six (6) months of the date of issuance. False information may invalidate a building permit and stop all work..

**PERMIT ISSUED
WITH REQUIREMENTS**

CERTIFICATION

I hereby certify that I am the owner of record of the named property, or that the proposed work is authorized by the owner of record and that I have been authorized by the owner to make this application as his authorized agent and I agree to conform to all applicable laws of this jurisdiction. In addition, if a permit for work described in the application issued, I certify that the code official's authorized representative shall have the authority to enter all areas covered by such permit at any reasonable hour to enforce the provisions of the code(s) applicable to such permit

SIGNATURE OF APPLICANT: *[Signature]* ADDRESS: **179 Sheridan St** DATE: **1-6-97** PHONE: **207-773-6122**

RESPONSIBLE PERSON IN CHARGE OF WORK. TITLE: _____ PHONE: _____
 White-Permit Desk Green-Assessor's Canary-D.P.W. Pink-Public File Ivory Card-Inspector

Zoning Appeal

☐ Variance
☐ Miscellaneous
☐ Conditional Use
☐ Interpretation
☐ Approved
☐ Denied

Historic Preservation

☒ Not in District or Landmark
☐ Does Not Require Review
☐ Requires Review

Action:

☐ Approved
☐ Approved with Conditions
☐ Denied

Date: **1/8/97**

[Signature]

CEO DISTRICT 7
K. Carroll