

60-66 Caron St. (lot #23)

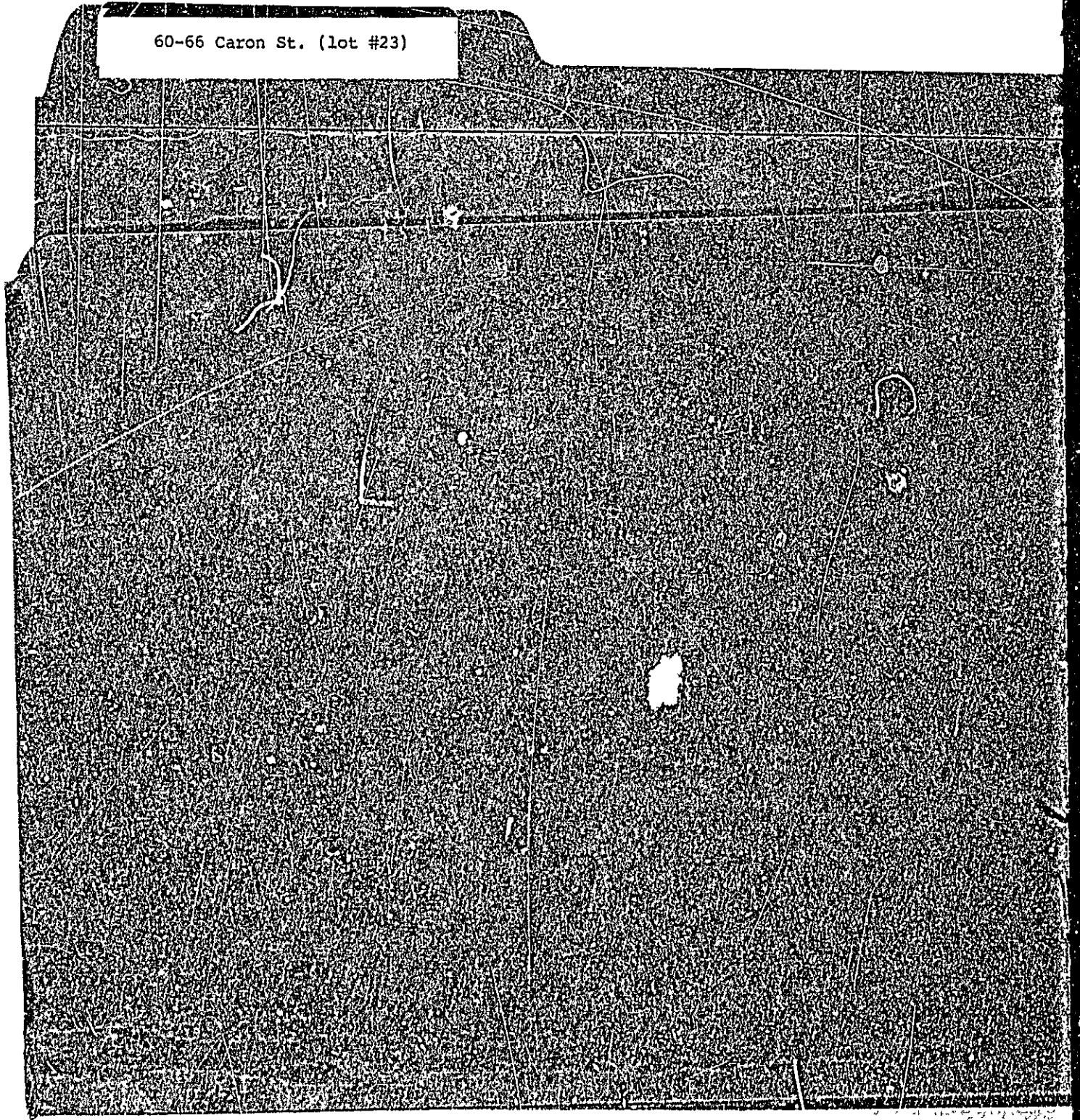



APPLICATION FOR PERMIT
DEPARTMENT OF BUILDING INSPECTIONS SERVICES
ELECTRICAL INSTALLATIONS

Date Jan 25, 19 78
 Receipt and Permit number A 10327

To the CHIEF ELECTRICAL INSPECTOR, Portland, Maine.
 The undersigned hereby applies for a permit to make electrical installations in accordance with the laws of Maine, the Portland Electrical Ordinance, the National Electrical Code and the following specifications

LOCATION OF WORK: Lot 23 to 29 Caron St.

OWNER'S NAME: Christy & Small ADDRESS: _____

OUTLETS: (number of)

Lights	_____	
Receptacles	_____	
Switches	_____	
Plugmold	_____ (number of feet)	
TOTAL	_____	FEES

FIXTURES: (number of)

Incandescent	_____	
Fluorescent	_____ (Do not include strip fluorescent)	
TOTAL	_____	
Strip Fluorescent, in feet	_____	

SERVICES:

Permanent, total amperes	_____	
Temporary	<input checked="" type="checkbox"/> _____	<u>3.00</u>
METERS (number of)	<u>1</u>	<u>.50</u>

MOTORS: (number of)

Fractional	_____	
1 HP or over	_____	

RESIDENTIAL HEATING:

Oil or Gas (number of units)	_____	
Electric (number of rooms)	_____	

COMMERCIAL OR INDUSTRIAL HEATING:

Oil or Gas (by a main boiler)	_____	
Oil or Gas (by separate units)	_____	
Electric (total number of kws)	_____	

APPLIANCES: (number of)

Ranges	_____	Water Heaters	_____
Cook Tops	_____	Disposals	_____
Wall Ovens	_____	Dishwashers	_____
Dryers	_____	Compactors	_____
Fans	_____	Others (denote)	_____
TOTAL	_____		

MISCELLANEOUS: (number of)

Branch Panels	_____	
Transformers	_____	
Air Conditioners	_____	
Signs	_____	
Fire/Burglar Alarms	_____	
Circus, Fairs, etc.	_____	
Alterations to wires	_____	
Repairs after fire	_____	
Heavy Duty, 220v outlets	_____	
Emergency Lights, battery	_____	
Emergency Generators	_____	

FOR ADDITIONAL WORK NOT ON ORIGINAL PERMIT ..	INSTALLATION FEE DUE:	<u>3.50</u>
FOR REMOVAL OF A "STOP ORDER" (304-16.b)	DOUBLE FEE DUE.	_____
FOR PERFORMING WORK WITHOUT A PERMIT (304-9)		_____
	TOTAL AMOUNT DUE:	_____

INSPECTION: Will be ready on now, 19___, or Will Call _____

CONTRACTOR'S NAME: Mancini Elec.
 ADDRESS: 179 Sheridagn St.
 TEL.: 774-5829

MASTER LICENSE NO.: 3436
 LIMITED LICENSE NO.: _____

SIGNATURE OF CONTRACTOR:

INSPECTOR'S COPY



APPLICATION FOR PERMIT

PERMIT ISSUED

B.O.C.A. USE GROUP

APR 20 1977

B.O.C.A. TYPE OF CONSTRUCTION

ZONING LOCATION _____ PORTLAND, MAINE, April 19, 1977

CITY of PORTLAND

To the DIRECTOR OF BUILDING & INSPECTION SERVICES, PORTLAND, MAINE

0222

The undersigned hereby applies for a permit to erect, alter, repair, demolish, move or install the following building, structure, equipment or change use in accordance with the Laws of the State of Maine, the Portland B.O.C.A. Building Code and Zoning Ordinance of the City of Portland with plans and specifications, if any, submitted herewith and the following specifications:

LOCATION 66 Caron St. Fire District #1 [], #2 []
1 Owner's name and address Ben F. Eaton - same Telephone 797-8458
2 Lessee's name and address Telephone
3 Contractor's name and address Swim World - 696 Broadway So Port Telephone 799-3319
4 Architect Specifications Plans No of sheets
Proposed use of building No. families
Last use No. families
Material No. stories Heat Style of roof Roofing
Other buildings on same lot
Estimated contractual cost \$ 37499; 4,600 Fee \$ 3880
FIELD INSPECTOR-Mr. GENERAL DESCRIPTION 20.00

This application is for: @ 775-545!
Dwelling Ext. 234 Permit to install permanent swimming pool
Garage in ground 100 x 120 as per plan . 1 sheet
Masonry Bldg pf plans. 18 x 36
Metal Bldg Stamp of Special Conditions
Alterations
Demolitions
Change of Use
Other swimming pool

NOTE TO APPLICANT: Separate permits are required by the installers and subcontractors of heating, plumbing, electrical and mechanicals.

PERMIT IS TO BE ISSUED TO 1 [x] 2 [] 3 [] 4 []

Other:

DETAILS OF NEW WORK

Is any plumbing involved in this work? Is any electrical work involved in this work?
Is connection to be made to public sewer? If not, what is proposed for sewage?
Has septic tank notice been sent? Form notice sent?
Height average grade to top of plate Height average grade to highest point of roof
Size, front depth No. stories solid or filled land? earth or rock?
Material of foundation Thickness, top bottom cellar
Kind of roof Rise per foot Roof covering
No. of chimneys Material of chimneys of lining Kind of heat fuel
Framing Lumber-Kind Dressed or full size? Corner posts Sills
Size Girder Columns under girders Size Max. on centers
Studs (outside walls and carrying partitions) 2x4-16" O. C. Bridging in every floor and flat roof span over 8 feet.
Joists and rafters 1st floor 2nd 3rd roof
On centers: 1st floor 2nd 3rd roof
Maximum span: 1st floor 2nd 3rd roof
If one story building with masonry walls, thickness of walls? height?

IF A GARAGE

No. cars now accommodated on same lot ..., to be accommodated ... number commercial cars to be accommodated ...
Will automobile repairing be done other than minor repairs to cars habitually stored in the proposed building?

APPROVALS BY: DATE MISCELLANEOUS
BUILDING INSPECTION - PLAN EXAMINER Will work require disturbing of any tree on a public street? ..
ZONING: O.R. 4/19/77 M.G.W.
BUILDING CODE: O.R. E.S. 4/19/77 Will there be in charge of the above work a person competent
Fire Dept.: to see that the State and City requirements pertaining thereto
Health Dept.: are observed?
Others:

Signature of Applicant Ben F. Eaton Phone # same
Type Name of above Ben F. Eaton 1 [x] 2 [] 3 [] 4 []

FIELD INSPECTOR'S COPY and Address

NOTES

6/77 Location OK.
7/77 Completed.

Permit No. 77/0922
Location *St. Joseph*
Owner *St. Joseph*
Date of permit 4-18-77.
Approved 4-21-77

~~[Large section of the page is crossed out with a large X.]~~



APPLICATION FOR PERMIT
 DEPARTMENT OF BUILDING INSPECTIONS SERVICES
 ELECTRICAL INSTALLATIONS

Date May 11, 1977
 Receipt and Permit number A09945

To the CHIEF ELECTRICAL INSPECTOR, Portland, Maine:

The undersigned hereby applies for a permit to make electrical installations in accordance with the laws of Maine, the Portland Electrical Ordinance, the National Electrical Code and the following specifications:

LOCATION OF WORK: 66 Caron St.
 OWNER'S NAME: Stan Eaton ADDRESS: same

OUTLETS: (number of) 1-30
 Lights _____
 Receptacles _____ FEES
 Switches _____
 Plugmold _____ (number of feet)
 TOTAL _____ 3.00

FIXTURES: (number of)
 Incandescent _____
 Fluorescent _____ (Do not include strip fluorescent)
 TOTAL _____
 Strip Fluorescent, in feet _____

SERVICES
 Permanent, total amperes _____
 Temporary _____

METERS: (number of) _____

MOTORS: (number of)
 Fractional _____
 1 HP or over _____

RESIDENTIAL HEATING:
 Oil or Gas (number of units) _____
 Electric (number of rooms) _____

COMMERCIAL OR INDUSTRIAL HEATING:
 Oil or Gas (by a main boiler) _____
 Oil or Gas (by separate units) _____
 Electric (total number of kws) _____

APPLIANCES: (number of)
 Ranges _____ Water Heaters _____
 Cook Tops _____ Disposals _____
 Wall Ovens _____ Dishwashers _____
 Dryers _____ Compactors _____
 Fans _____ Others (denote) _____
 TOTAL _____

MISCELLANEOUS: (number of) Swimming Pool 5.00
 Branch Panels _____
 Transformers _____
 Air Conditioners _____
 Signs _____
 Fire/Burglar Alarms _____
 Circus, Fairs, etc. _____
 Alterations to wires _____
 Repairs after fire _____
 Heavy Duty, 220v outlets _____
 Emergency Lights, battery _____
 Emergency Generators _____

INSTALLATION FEE DUE: _____
 FOR ADDITIONAL WORK NOT ON ORIGINAL PERMIT DOUBLE FEE DUE: _____
 FOR REMOVAL OF A "STOP ORDER" (304-16 b) _____
 FOR PERFORMING WORK WITHOUT A PERMIT (304-9) _____
 TOTAL AMOUNT DUE: 8.00

INSPECTION:
 Will be ready on _____, 19____; or Will Call _____
 CONTRACTOR'S NAME: Thomas Maiorano
 ADDRESS: 89 Murray St.
 TEL.: 774-3572
 MASTER LICENSE NO.: 7232 SIGNATURE OF CONTRACTOR: Thomas Maiorano
 LIMITED LICENSE NO.: 7232

INSPECTOR'S COPY

CITY OF PORTLAND, MAINE
Application for Permit to Install Wires

Permit No. 551.80
 Issued 8-6-71
 Portland, Maine August 6, 1971

To the City Electrician, Portland, Maine:

The undersigned hereby applies for a permit to install wires for the purpose of conducting electric current, in accordance with the laws of Maine, the Electrical Ordinance of the City of Portland, and the following specifications:

(This form must be completely filled out Minimum Fee, \$1.00)

Owner's Name and Address Frank Cavallaro Tel. _____
 Contractor's Name and Address Tom Cavallaro Tel. 7743813
 Location Laron St. Use of Building House
 Number of Families 1 Apartments _____ Stores _____
 Description of Wiring: New Work Additions _____ Alterations _____

Pipe Cable Metal Molding BX Cable Plug Molding (No. of feet)
 No. Light Outlets Plugs Light Circuits Plug Circuits
 FIXTURES: No. Fluor. or Strip Lighting (No. feet)
 SERVICE: Pipe Cable Underground No. of Wires 3 Size 2/2 1/4
 METERS: Relocated Added 1 Total No. Meters _____
 MOTORS: Number Phase H. P. Amps Volts Starter
 HEATING UNITS: Domestic (Oil) No. Motors Phase H.P.
 Commercial (Oil) No. Motors Phase H.P.
 Electric Heat (No. of Rooms) _____
 APPLIANCES: No. Ranges Watts Brand Feeds (Size and No.)
 Elec. Heaters Watts _____
 Miscellaneous Watts _____
 Transformers Air Conditioners (No. Units) Extra Cabinets or Panels
 Will commence 19 Ready to cover in 19 Inspection 19
 Amount of Fee \$ 2.00 Signed Tom Cavallaro

DO NOT WRITE BELOW THIS LINE

SERVICE	METER			GROUND		
VISITS: 1	2	3	4	5	6	
7	8	9	10	11	12	

REMARKS:

INSPECTED BY _____ (OVER)

Frank - this is the first house on the left side going down Caron St where they are building new houses, this is a split farm house

CITY OF PORTLAND, MAINE
Application for Permit to Install Wires

Permit No. 55488
Issued 11/15/71
Portland, Maine 11/8 1971

To the City Electrician, Portland, Maine:

The undersigned hereby applies for a permit to install wires for the purpose of conducting electric current, in accordance with the laws of Maine, the Electrical Ordinance of the City of Portland, and the following specifications:

(This form must be completely filled out - Minimum Fee \$1.00)

Owner's Name and Address Frank Carverllo Tel.
Contractor's Name and Address Paul DeBevoise - Falmouth Tel. 797-5072
Location Caron St 66-68 Use of Building Dwelling
Number of Families 1 Apartments Stores Number of Stories
Description of Wiring: New Work Additions Alterations

Pipe Cable Metal Molding BX Cable Plug Molding (No. of feet)
No. Light Outlets Plugs Light Circuits Plug Circuits
FIXTURES: No. Fluor. or Strip Lighting (No. feet)
SERVICE: Pipe Cable Underground No. of Wires Size
METERS: Relocated Added Total No. Meters
MOTORS: Number Phase H. P. Amps Volts Starter
HEATING UNITS: Domestic (Oil) No. Motors 1 Phase 1 H.P.
Commercial (Oil) No. Motors Phase H.P.
Electric Heat (No. of Rooms)

APPLIANCES: No. Ranges Watts Brand Feeds (Size and No.)
Elec. Heaters Watts
Miscellaneous Watts Extra Cabinets or Panels

Transformers Air Conditioners (No. Units) Signs (No. Units)
Will commence 11/1 1971 Ready to cover in 19 Inspection 11/8 1971
Amount of Fee \$ 2.00

Signed Paul J. DeBevoise #655

DO NOT WRITE BELOW THIS LINE

SERVICE	METER			GROUND		
VISITS: 1	2	3	4	5	6	
	7	8	9	10	11	12

REMARKS:

INSPECTED BY *[Signature]*
(OVER)



FILL IN AND SIGN WITH INK

APPLICATION FOR PERMIT FOR HEATING, COOKING OR POWER EQUIPMENT

Portland, Maine, October 8, 1971

PERMIT ISSUED

1971
265
CITY OF PORTLAND

To the INSPECTOR OF BUILDINGS, PORTLAND, ME.

The undersigned hereby applies for a permit to install the following heating, cooking or power equipment in accordance with the Laws of Maine, the Building Code of the City of Portland, and the following specifications:

Location Lot 23 Pt. 24 Caron St. Use of Building Dwelling No Stories New Building
Name and address of owner of appliance Frank Cavallaro, 15 Berkshire Rd. ~~Existing~~
Installer's name and address William Miles, Box 243, Yarmouth, Maine Telephone

General Description of Work

To install oil-fired forced hot water heating system

IF HEATER, OR POWER BOILER

Location of appliance basement Any burnable material in floor surface or beneath? no
If so, how protected? Kind of fuel? oil
Minimum distance to burnable material, from top of appliance or casing top of furnace 4'
From top of smoke pipe 3' From front of appliance 4' From sides or back of appliance 3'
Size of chimney flue 8x8 Other connections to same flue none
If gas fired, how vented? Rated maximum demand per hour
Will sufficient fresh air be supplied to the appliance to insure proper and safe combustion? yes

IF OIL BURNER

Name and type of burner U.S. National Standard Labelled by underwriters' laboratories? yes
Will operator be always in attendance? Does oil supply line feed from top or bottom of tank? bottom
Type of floor beneath burner concrete Size of vent pipe 1 1/2"
Location of oil storage basement Number and capacity of tanks 1-275 gal.
Low water shut off Make No.
Will all tanks be more than five feet from any flame? yes How many tanks enclosed?
Total capacity of any existing storage tanks for furnace burners none

IF COOKING APPLIANCE

Location of appliance Any burnable material in floor surface or beneath?
If so, how protected? Height of Legs, if any
Skirting at bottom of appliance? Distance to combustible material from top of appliance?
From front of appliance From sides and back From top of smokepipe
Size of chimney flue Other connections to same flue
Is hood to be provided? If so, how vented? Forced or gravity?
If gas fired, how vented? Rated maximum demand per hour

MISCELLANEOUS EQUIPMENT OR SPECIAL INFORMATION

Amount of fee enclosed? 10.00 (~~\$2.00 for one heater, etc., \$1.00 additional for each additional heater, etc., in same building at same time~~)

APPROVED:

OK C.S.L. 10/11/71

Will there be in charge of the above work a person competent to see that the State and City requirements pertaining thereto are observed? yes

Signature of Installer Miller E. Fyfe

4 300

INSPECTION COPY

NOTES

11-18-71 Complete *RD*

8'x8' screen vent
for + gal/hr

JAN

[Large handwritten mark]

Permit No. 71/1965

Location 847 23rd St 24 Curran St

Owner Frank Curran

Date of permit 10/12/71

Notif. closing-in

~~Inspection~~ in WARD

Final Notif.

Final Inspn.

Cert. of Occupancy issued

(COPY)



CITY OF PORTLAND, MAINE
Department of Building Inspection

Certificate of Occupancy

LOCATION Lot 23 & Pt. lot 24 Caron St.

Issued to Frank Cavallaro

Date of Issue Nov. 18, 1971

This is to certify that the building, premises, or part thereof, at the above location, built—altered—changed as to use under Building Permit No. 71/546, has had final inspection, has been found to conform substantially to requirements of Zoning Ordinance and Building Code of the City, and is hereby approved for occupancy or use, limited or otherwise, as indicated below.

PORTION OF BUILDING OR PREMISES

APPROVED OCCUPANCY

Entire

Dwelling & 2-car garage
in basement

Limiting Conditions:

This certificate supersedes
certificate issued

Approved:

Nelson F. Cartwright
(Date) Inspector

[Signature]
Inspector of Buildings

Notice: This certificate identifies lawful use of building or premises, and ought to be transferred from owner to owner when property changes hands. Copy will be furnished to owner or lessee for one dollar.



APPLICATION FOR AMENDMENT TO PERMIT

Amendment No. #1

Portland, Maine, May 25 1971

PERMIT ISSUED

MAY 26 1971

CITY OF PORTLAND

To the INSPECTOR OF BUILDINGS, PORTLAND, MAINE

The undersigned hereby applies for amendment to Permit No. pertaining to the building or structure comprised in the original application in accordance with the Laws of the State of Maine, the Building Code and Zoning Ordinance of the City of Portland, plans and specifications, if any, submitted herewith, and the following specifications:

Location Lot 23 pt. lot 24 Caron St. (60-68) Within Fire Limits? Dist. No.

Owner's name and address Frank Cavallaro, 15 Berkshire Road Telephone

Lessee's name and address Telephone

Contractor's name and address owner Telephone ...772-2947

Architect Plans filed ..yes No. of sheets ...2
filed 5-25-71

Proposed use of building Dwelling & Garage No. families

Last use No. families

Increased cost of work Additional fee 3.00

Description of Proposed Work

To change size of building from 50' x 26' to 52' x 26' as per plans.

Details of New Work permit to owner

Is any plumbing involved in this work? Is any electrical work involved in this work?

Height average grade to top of plate Height average grade to highest point of roof

Size, front depth No. stories solid or filled land? earth or rock?

Material of foundation Thickness, top bottom cellar

Material of underpinning Height Thickness

Kind of roof Rise per foot Roof covering

No. of chimneys Material of chimneys of lining

Framing lumber—Kind Dressed or full size?

Corner posts Sills Girt or ledger board? Size

Girders Size Columns under girders Size Max. on centers

Studs (outside walls and carrying partitions) 8x4-16" O. C. Bridging in every floor and flat roof span over 8 feet.

Joists and rafters: 1st floor....., 2nd....., 3rd....., roof.....

On centers: 1st floor....., 2nd....., 3rd....., roof.....

Maximum span: 1st floor... .., 2nd....., 3rd....., roof.....

Approved:

Frank Cavallaro
Signature of Owner by: *Frank Cavallaro*

Approved: *[Signature]*
Inspector of Buildings

INSPECTION COPY
CS. 103

60-68 Caron Street

May 14, 1971

Frank Cavallaro
15 Berkshire Road

Dear Mr. Cavallaro:

Permit to construct a 1½-story frame dwelling with 2-car garage in the basement is issued herewith subject to the following Building Code requirements:

1. Typical sections show foundation 3' below grade. The Building Code requires that foundations extend at least 4' below grade and 6" above grade.

2. Wooden framed walls veneered with brick; the veneer should be tied to the frame by metal wall ties spaced not more than 16" from center to center of every fifth course of brick, or the equivalent of such spacing in the event that material other than brick shall be used. Ties shall be crimped or corrugated copper no less than 3/4" wide, long enough to allow two nails for fastening to the frame wall, and of such thickness that at a width no greater than 7/8", 1,000 ties will weigh at least 48 lbs., or the same size, shape and weight of sheet metal, galvanized after fabricating, if two ties are nested (one on top of the other) at each point, or any other size, shape, weight and material equivalent in strength and permanency.

Very truly yours,

Earle S. Smith
Plan Examiner

ESS:m

CITY OF PORTLAND, MAINE
DEPARTMENT OF BUILDING INSPECTION

NOTICE RELATING TO SEWAGE DISPOSAL

x means copy sent to the parties
Date May 12, 1971
Location Lot 23 pt. lot 24 Caron St Description Single family dwelling with 2-car garage
Owner and Address Frank Cavallaro, 15 Berkshire Road in basement
Contractor and Address owner
Actual Area of Lot _____ Sq. Ft. Zone R-1 Residence
Area required by Zoning Ord. if sewer were available _____

Where septic tank systems are required for sewage disposal, the Zoning Ordinance provides that the least allowable area of the lot shall be determined by the rate of percolation of the soil, this being the capacity of the soil to allow liquids to pass through as determined by tests. The Building Code directs that, where a septic tank is to be used, a building permit shall not be issued unless the proposed method of sewage disposal has been approved by the Director of Health.

Since application for the above permit indicates that connection to a sewer is not possible, it is necessary for the owner or his agent to file a site plan with the Health Department, to explain the method of sewage disposal proposed, and to make arrangements for a percolation test to be made under supervision of that department.

After the rate of percolation has been determined, the Director of Health will notify this department of the area of lot required on the basis of the results of the test. If the lot area required by the tests is equal to or less than the actual area of the lot and not less than the minimum lot area required in the zone in which the property is located for cases where connection to a sewer is available, the building permit can be issued; otherwise the permit cannot be issued unless authorization is secured from the Board of Appeals.

Director of Building & Inspections

2 copies to Health Director

(This space for Health Department use)

Inspector of Buildings

Rate of Percolation is 16 minutes. On this basis area required by Zoning Ordinance is 12000 sq. feet.

Comments in event zoning appeal is filed: much 196 Lincoln St of
absystem trench Dr

R1 RESIDENCE ZONE



APPLICATION FOR PERMIT

Class of Building or Type of Structure Third Class
Portland, Maine, July 12, 1971

PERMIT 546
1971

CITY OF PORTLAND

To the INSPECTOR OF BUILDINGS, PORTLAND, MAINE

The undersigned hereby applies for a permit to erect alter repair demolish install the following building structure equipment in accordance with the Laws of the State of Maine, the Building Code and Zoning Ordinance of the City of Portland, plans and specifications, if any, submitted herewith and the following specifications:

Location Lot 23 & pt. lot 24 Claron St. Within Fire Limits? _____ Dist. No. _____
 Owner's name and address Frank Cavallaro, 15 Bedshire Road Telephone 772-2947
 Lessee's name and address _____ Telephone _____
 Contractor's name and address owner Telephone 7
 Architect _____ Specifications _____ Plans yes No. of sheets 7
 Proposed use of building Dwelling & 2-car garage No. families 1
 Last use _____ No. families _____
 Material frame No. stories 1 1/2 Heat _____ Style of roof _____ Roofing _____
 Other buildings on same lot _____
 Estimated cost \$ 22,000 Fee \$ 66.00

General Description of New Work

To construct 1 1/2-story frame dwelling (split foyer) with 2-car garage in basement 30'x26'
 The inside of the garage will be covered where required by law with 5/8" sheetrock.
 Solid core door 1 3/4" thickness-self-closing.

It is understood that this permit does not include installation of heating apparatus which is to be taken out separately by and in the name of the heating contractor. **PERMIT TO BE ISSUED TO** owner

Details of New Work

Is any plumbing involved in this work? yes Is any electrical work involved in this work? yes
 Is connection to be made to public sewer? no If not, what is proposed for sewage? septic tank
 Has septic tank notice been sent? yes Form notice sent? yes
 Height average grade to top of plate 15' Height average grade to highest point of roof 20'
 Size, front 50' depth 26' No. stories 1 1/2 solid or filled land? solid earth or rock? earth
 Material of foundation concrete at least 4' below grade Thickness, top 10" bottom 10" cellar yes
 Kind of roof pitch Rise per foot 5" Roof covering Asphalt Class C Und Label
 No. of chimneys 1 Material of chimneys brick of lining tile Kind of heat f.h.water oil
 Framing Lumber-Kind hemlock Dressed or full size? dressed Corner posts 4x6 Sills 4x6
 Size Girder 6x10 Columns under girders Lally Size 3" Max. on centers 6'7"
 Studs (outside walls and carrying partitions) 2x4-16" O. C. Bridging in every floor and flat roof span over 8 feet.
 Joists and rafters: 1st floor 2x10, 2nd 2x6-ceiling, roof 2x6
 On centers: 1st floor 16", 2nd 16", 3rd _____, roof 16"
 Maximum span: 1st floor 12', 2nd _____, 3rd _____, roof 13'
 If one story building with masonry walls, thickness of walls? _____ height? _____

If a Garage

No. cars now accommodated on same lot 0, to be accommodated 2 number commercial cars to be accommodated none
 Will automobile repairing be done other than minor repairs to cars habitually stored in the proposed building? no

APPROVED:
5/13/71 ZONING OK M.A.W.
5/14/71 B.C. G.K. E.R.P.

Miscellaneous

Will work require disturbing of any tree on a public street? no
 Will there be in charge of the above work a person competent that the State and City requirements pertaining thereto be observed? yes

Frank Cavallaro

CS 301

INSPECTION COPY

Signature of owner

by:

Frank Cavallaro

NOTES

6-17-71 Forms OK
as to size & location *AD*

9-20-71 Before closing
Fire stop chimney
" " Vents (2)
hours for boiler room
Fire stop between
strapping garage
wall.
Turn studs ⁽²⁾ side ways
downstairs fireplace

9-22-71 OK to
close in *AD*

11-18-71 Completed *AD*

X

Permit No. 711 544
Location 125 1/2 West Elm St
Owner Frank & Carol Olson
Date of permit 5/17/71
Notif. closing-in
Inspr. closing-in
Final Notif.
Final Inspr.
Cert. of Occupancy issued 11/18/71
Staking Out Notice
Form Check Notice

Brian Pelosi Job
66 Caron St.

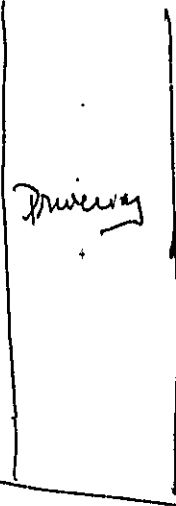
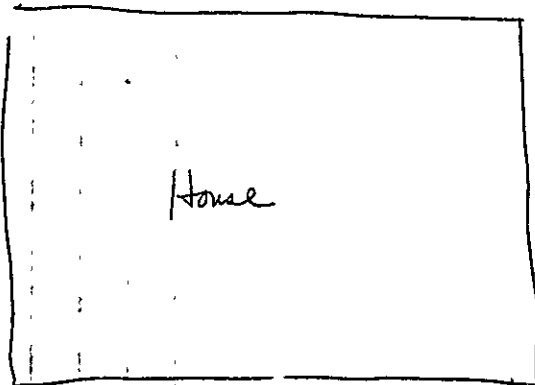
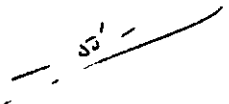
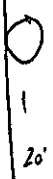
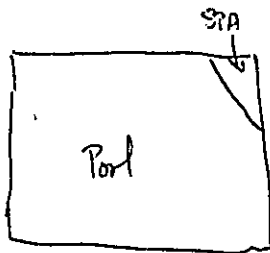

RECEIVED
SEP - 6 1984
DEPT. OF BLDG. INSP.
CITY OF PORTLAND

CARON ST.

APPLICATION FOR PERMIT

PERMIT ISSUED

B.O.C.A. USE GROUP B.O.C.A. TYPE OF CONSTRUCTION 01094

SEP 7 1984

ZONING LOCATION PORTLAND, MAINE Sept. 6, 1984

CITY OF PORTLAND

To the CHIEF OF BUILDING & INSPECTION SERVICES, PORTLAND, MAINE

The undersigned hereby applies for a permit to erect, alter, repair, demolish, move or install the following building, structure, equipment or change use in accordance with the Laws of the State of Maine, the Portland B.O.C.A. Building Code and Zoning Ordinance of the City of Portland with plans and specifications, if any, submitted herewith and the following specifications:

LOCATION 66 Caron Street Fire District #1 , #2
1. Owner's name and address Brian Pelosi, same Telephone 797-4256
2. Lessee's name and address Telephone
3. Contractor's name and address Maine Gas & Appliances, Inc. P.O. Box 1090736 Bridgeton Rd. No. Windham, Maine 04062 Telephone
Proposed use of building No. of sheets
Last use No. families ... 1
Material ... No stories ... Heat ... Style of roof ... Roofing
Other buildings on same lot
Estimated contractual cost \$

FIELD INSPECTOR—Mr. [Signature]

@ 775-5451

Appeal Fees \$
Base Fee
Late Fee
TOTAL \$.15.00

To install 100 gal. propane tank (420 lbs.) in right rear of existing dwelling, as per plan. To set on brick base.

Stamp of Special Conditions

ISSUE PERMIT TO #3

NOTE TO APPLICANT: Separate permits are required by the installers and subcontractors of heating, plumbing, electrical and mechanicals.

DETAILS OF NEW WORK

Is any plumbing involved in this work? Is any electrical work involved in this work?
Is connection to be made to public sewer? If not, what is proposed for sewage?
Has septic tank notice been sent? Form notice sent?
Height average grade to top of plate Height average grade to highest point of roof
Size, front depth No. stories solid or filled land? earth or rock?
Material of foundation Thickness, top bottom cellar
Kind of roof Rise per foot Roof covering
No. of chimneys Material of chimneys of lining Kind of heat fuel
Framing Lumber—Kind Dressed or full size? Corner posts Sills
Size Girder Columns under girders Size Max. on centers
Studs (outside walls and carrying partitions) 2x4-16" O C. Bridging in every floor and flat roof span over 8 feet.
Joists and rafters: 1st floor, 2nd, 3rd, roof
On centers: 1st floor, 2nd, 3rd, roof
Maximum span: 1st floor, 2nd, 3rd, roof
Is one story building with masonry walls, thickness of walls? height?

IF A GARAGE

No. cars now accommodated on same lot, to be accommodated number commercial cars to be accommodated
Will automobile repairing be done other than minor repairs to cars habitually stored in the proposed building?

APPROVALS BY: DATE
BUILDING INSPECTION—PLAN EXAMINER
ZONING:
BUILDING CODE:
Fire Dept.:
Health Dept.:
Others:

MISCELLANEOUS
Will work require disturbing of any tree on a public street?
Will there be in charge of the above work a person competent to see that the State and City requirements pertaining thereto are observed? yes...

Signature of Applicant [Signature] Phone # 892-6746
Type Name of above Joseph A. Johnson, Jr., Sales Rep. 1 2 3 4
Other and Address

Permit No 84/1094

Location 66/ Canyon St.

Owner Diana Pulosi

Date of permit 9-6-84

Approved 9-7-84

Dwelling _____

Garage _____

Alteration 100 gal propane tanks

NOTES

9/20/84 - [Signature]

APPLICATION FOR SUBMETER

City of Portland
Parks/Public Works
55 Portland Street
Portland, ME 04101

Monday 3:00
9-9-85
Monday 3:00
9-9-85

For Sewer User Charge Adjustments

The undersigned hereby requests permission to install additional water meter(s) in accordance with Section 322.6C of the "Municipal Code of the City of Portland, Maine"

It is understood that all expenses related to the purchase, installation and maintenance of the meter(s) is to be borne by the applicant.

To be Completed by Applicant

- X Address where sub-meter is requested 160 Caron St Portland
- X Property owner name Brian + Diana Pelosi
- X Tax Map Reference (on Real Estate Tax Bill) 387-A-24
- X Property owner address 160 Caron St Portland
- X Person to be contacted to schedule inspections Diana Pelosi 797-4256
(Name and Telephone Number)
- X Portland Water District Acct. No. (on bill) D-77-D2989
- X Billing Name & Address (on bill) Brian Pelosi
160 Caron St Portland ME 04103

Location and size existing Portland Water District Service Water _____

Basement 3/4" NO REMOTE READING OUT

Proposed location and size of sub-meter _____

Basement NEXT TO MAIN METER 3/4"

Will a remote reading register be utilized? NO YES (If yes, state location _____)

Description of proposed changes in plumbing required for submetering:

cut in above main meter, run
new supply line to outside sill
cut in plug old supply line

The volume of water to be submetered can be shown not to enter the sewerage system by virtue of its use for:

X _____

Sketch plan showing proposed changes in plumbing and the location of existing and proposed meters. Show water flow through submeter to non-discharge equipment or location (use additional sheet of paper if necessary)

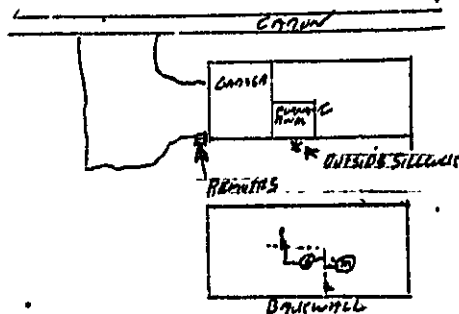

I certify the above information is true and correct:

X Diana Pelosi
Signature

Dec. 17, 1985

X 9-9-85
Date

353

NOTE: The Police Department will not be responsible for the removal of the submetering system if the customer fails to pay the bill for the same. The Police Department will not be responsible for the removal of the submetering system if the customer fails to pay the bill for the same.

NOTE: The Police Department will not be responsible for the removal of the submetering system if the customer fails to pay the bill for the same. The Police Department will not be responsible for the removal of the submetering system if the customer fails to pay the bill for the same.

NOTE: The Police Department will not be responsible for the removal of the submetering system if the customer fails to pay the bill for the same. The Police Department will not be responsible for the removal of the submetering system if the customer fails to pay the bill for the same.

NOTE: The Police Department will not be responsible for the removal of the submetering system if the customer fails to pay the bill for the same. The Police Department will not be responsible for the removal of the submetering system if the customer fails to pay the bill for the same.

NOTE: The Police Department will not be responsible for the removal of the submetering system if the customer fails to pay the bill for the same. The Police Department will not be responsible for the removal of the submetering system if the customer fails to pay the bill for the same.

NOTE: The Police Department will not be responsible for the removal of the submetering system if the customer fails to pay the bill for the same. The Police Department will not be responsible for the removal of the submetering system if the customer fails to pay the bill for the same.

TO BE COMPLETED BY PUBLIC WORKS

Pre-installation inspection by: DAVID E. PETERSON
 on 9-9-85

Automatic reading system requested YES NO

A B/W WATTS Back Flow Preventer or equal shall be installed OUT SIDE SILL CURB

Application Approved Denied

Comments _____

TO BE COMPLETED BY THE PLUMBING INSPECTOR

An inspection of the completed installation of the submetering system approved on this application was conducted on Oct 9, 1985 by Ernold R. Goodwin, Chief Plumbing Inspector of the City of Portland.

The submetering system was installed as approved.

No cross connections were found.

The installation is approved dis-approved

Ernold Goodwin

TO BE COMPLETED BY THE WATER DISTRICT

Date submeter sold 9/16/85

Submeter account number D-27-Dd 949

Submeter make and number SERRA 354 90085

Submeter installation readings 0

Submeter account entered into computer 12-18-85

Submeter account entered into meter book 12-18-85

Special Instructions _____
