

145-151 CHRISTY ROAD

Set 34

STOCKING M.G.S.
1935-1937



APPLICATION FOR PERMIT

PERMIT ISSUED

B.O.C.A. USE GROUP
 B.O.C.A. TYPE OF CONSTRUCTION 0183
 ZONING LOCATION R-2 PORTLAND, MAINE, Mar. 23, 1978

MAR 23 1978
 0183
 CITY OF PORTLAND

To the DIRECTOR OF BUILDING & INSPECTION SERVICES, PORTLAND, MAINE
 The undersigned hereby applies for a permit to alter, repair, demolish, move or install the following building, structure, equipment or change use in accordance with the laws of the State of Maine, the Portland B.O.C.A. Building Code and Zoning Ordinance of the City of Portland with the following specifications, if any, submitted herewith and the following specifications:

LOCATION 147 Christy Road Fire District #1 , #2
 1. Owner's name and address Robert J. Munson-Same Telephone 797-6687
 2. Lessee's name and address Telephone
 3. Contractor's name and address WHG Construction Co., William Small Telephone 829-5887
 47 Hillside Ave., Cumberland, Me.
 4. Architect Specifications Plans No. of sheets
 Proposed use of building garage - single car No. families
 Last use No. families
 Material No. stories Heat Style of roof Roofing
 Other buildings on same lot
 Estimated contractual cost \$ 4,000 Fee \$ 16.00

FIELD INSPECTOR—Mr GENERAL DESCRIPTION
 This application is for: @ 775-5451 To construct single car attached garage
 Dwelling Ext. 234 16 x 22 as per plans.
 Garage
 Masonry Bldg.
 Metal Bldg.
 Alterations
 Demolitions
 Change of Use
 Other

Stamp of Special Conditions

NOTE TO APPLICANT: Separate permits are required by the installers and subcontractors of heating, plumbing, electrical and mechanicals

PERMIT IS TO BE ISSUED TO 1 2 3 4
 Other:

DETAILS OF NEW WORK

Is any plumbing involved in this work? Is any electrical work involved in this work?
 Is connection to be made to public sewer? If not, what is proposed for sewage?
 Has septic tank notice been sent? Form notice sent?
 Height average grade to top of plate Height average grade to highest point of roof
 Size, front depth No. stories solid or filled land? earth or rock?
 Material on foundation Thickness, top bottom cellar
 Kind of roof Rise per foot Roof covering
 No. of chimneys Material of chimneys of lining Kind of heat fuel
 Framing Lumber—Kind Dressed or full size? Corner posts Sills
 Size Girder Columns under girders Size Max. on centers
 Studs (outside walls and carrying partitions) 2x4-16" O. C. Bridging in every floor and flat roof span over 8 feet.
 Joists and rafters: 1st floor 2nd 3rd roof
 On centers: 1st floor 2nd 3rd roof
 Maximum span 1st floor 2nd 3rd roof
 If one story building with masonry walls, thickness of walls? height?

IF A GARAGE

No cars now accommodated on same lot, to be accommodated number commercial cars to be accommodated
 Will automobile repairing be done other than minor repairs to cars habitually stored in the proposed building?

MISCELLANEOUS

APPROVALS BY DATE Will work require disturbing of any tree on a public street?
 BUILDING INSPECTION—PLAN EXAMINER
 ZONING: O.K. M.G.R. 3/23/78
 BUILDING CODE: O.K. 3/23/78
 Fire Dept.:
 Health Dept.:
 Others:

Signature of Applicant Robert J. Munson Phone # 777-6687
 Type Name of above Robert J. Munson 1 2 3 4
 Other and Address

FIELD INSPECTOR'S COPY

CERTIFICATE OF APPROVAL

FOR INTERNAL PLUMBING FOR THE TOWN/CITY OF Portland

OWNER _____

Cert. of App. Number

No 2297 IC

ADDRESS _____, MAINE

Date C.O.A. Issued

DEC 16 1977

DEC 19 1977
Month Day Year

Location where plumbing was done and inspected

Plumbing Installed by _____

Date Inspected

Month Day Year

Date Permit Issued

THE INTERNAL PLUMBING INSTALLED PURSUANT TO THE ABOVE CERTIFICATE OF APPROVAL NUMBER HAS BEEN TESTED IN MY PRESENCE, FOUND TO BE FREE FROM LEAKS, AND WAS INSTALLED IN COMPLIANCE WITH THE MUNICIPAL AND STATE PLUMBING REGULATIONS.

Signature of LPI _____

State Office Use Only
Date Received

ORIGINAL—To be sent to Department of Human Services
Division of Health Engineering 221 State Street Augusta, Maine 04333

INTERNAL PLUMBING PERMIT FOR THE TOWN/CITY OF

Town/City Code

LPI Number

License Number

Date Issued

PERMIT NUMBER

05710

123

976

12/17/77

No 2297 IP

Address of where Plumbing is done

134

CHRISTY RD

City

1 Owner
2 Licensed Master Plumber
3 Licensed Oil Burnerman
4 Employees of Public Utilities

Code

SI/Lot Number

134

Street, Road Name/Subdivision

St Rd

Issued

Name of Owner

CHRISTY H SMALL

Av/Lot

Issued

Type of Construction

- 1 New
- 2 Remodeling
- 3 Addition
- 4 Remodeling & Addition
- 5 Replacement of Hot Water Heater
- 6 Hook-up of Mobile Home
- 7 Minor Change
- 8 Other (Specify)

Plumbing to Serv

- 1 Single (res)
- 2 Multi- (res)
- 3 Mobile Home
- 4 Mobile Home without Coal
- 5 Commercial
- 6 School
- 7 Other (Specify)

SCHEDULE OF FEES
(See Sec. 1.12 of the Part I Code)

1-10 Fixtures \$2.00 each
11-20 Fixtures \$1.00 each
21 Fixtures on up \$.50 each
Hook-ups \$2.00 each
Note: Hot Water Heater (tank or tankless) considered a fixture

Fixture #	Fixture #	Fixture #	Fixture #
Sinks /	Showers /	Hot Water Heaters /	
Toilets /	Urinals /	Floor Drains /	
Bathubs /	Clothes Washers /	Other /	
Lavatories /	Dish Washers /	Hook-ups /	

Quantity	Fee
Fixtures 3	6.00
Hook-ups 1	2.00
Administrative fee	3.00
Total or Double Fee	11.00

Date Received

DEC 16 1977

Receipt Number

Money Received

DEC 16 1977

Administrative fee

3 0 0

Total or Double Fee

11 0 0

Administrative Code

Signature of LPI _____

This "Internal Plumbing Permit" is invalid if work is not commenced within six(6) months from date of issuance. Upon completion of work a "Certificate of Approval" must be obtained.
Original—To be sent to: Department of Human Services, Division of Health Engineering 221 State Street, Augusta, Maine 04333

HHE 211 377

PERMIT TO INSTALL PLUMBING

PERMIT NUMBER **1232**

Date Issued **6-27-77**
 Portland Plumbing Inspector
 By **ERNOLD R GOODWIN**

App. First Insp. **27 1977**
 Date **ERNOLD R. GOODWIN**
 By **CHIEF PLUMBING INSPECTOR**

App. Final Insp.
 Date
 By

Type of Bldg. **1976**
 Commercial
 Residential
 Single R. **GOODWIN**
 Multi-Family **INSPECTOR**
 New Construction
 Remodeling

Address		Lot # 34 Christy Rd		PERMIT NUMBER 1232	
Installation For		one family			
Owner of Bldg		Christy & Scall			
Owner's Address		247 Allen Ave.			
Plumber:		Walter H. Walker		Date	6-27-77
		Waltham		NO	FEE
NEW	REPL				
<input checked="" type="checkbox"/>		SINKS	1		2.00
<input checked="" type="checkbox"/>		LAVATORIES	3		6.00
<input checked="" type="checkbox"/>		TOILETS	3		6.00
<input checked="" type="checkbox"/>		BATH TUBS	1		2.00
<input checked="" type="checkbox"/>		SHOWERS	1		2.00
		DRAINS FLOOR SURFACE			
<input checked="" type="checkbox"/>		HOT WATER TANKS			
<input checked="" type="checkbox"/>		TANKLESS WATER HEATERS	1		2.00
<input checked="" type="checkbox"/>		GARBAGE DISPOSALS	1		2.00
		SEPTIC TANKS			
		HOUSE SEWERS			
		ROOF LEADERS			
<input checked="" type="checkbox"/>		AUTOMATIC WASHERS	1		1.00
<input checked="" type="checkbox"/>		DISHWASHERS	1		1.00
		OTHER			
		base fee			3.00
				TOTAL	24.00 25.00

Building and Inspection Services Dept: Plumbing Inspection

25.00



APPLICATION FOR PERMIT
 DEPARTMENT OF BUILDING INSPECTIONS SERVICES
 ELECTRICAL INSTALLATIONS

Date July 26, 1977
 Receipt and Permit number A10231

To the CHIEF ELECTRICAL INSPECTOR, Portland, Maine.

The undersigned hereby applies for a permit to make electrical installations in accordance with the laws of Maine, the Portland Electrical Ordinance, the National Electrical Code and the following specifications:

LOCATION OF WORK: Lot 2 Christy Road 2nd Floor
 OWNER'S NAME: Robert Munson ADDRESS: _____

OUTLETS: (number of) 1-30

Lights	<u>5</u>	
Receptacles	<u>16</u>	
Switches	<u>5</u>	
Plugmold	_____ (number of feet)	
TOTAL	_____	3.00

FIXTURES: (number of)

Incandescent	_____	
Fluorescent	_____ (Do not include strip fluorescent)	
TOTAL	_____	
Strip Fluorescent, in feet	_____	

SERVICES:

Permanent, total amperes	_____	
Temporary	_____	

METERS: (number of) _____

MOTORS: (number of)

Fractional	_____	
1 HP or over	_____	

RESIDENTIAL HEATING:

Oil or Gas (number of units)	_____	
Electric (number of rooms)	<u>3</u>	3.00

COMMERCIAL OR INDUSTRIAL HEATING:

Oil or Gas (by a main boiler)	_____	
Oil or Gas (by separate units)	_____	
Electric (total number of kws)	_____	

APPLIANCES: (number of)

Ranges	_____	Water Heaters	_____
Cook Tops	_____	Disposals	_____
Wall Ovens	_____	Dishwashers	_____
Dryers	_____	Compactors	_____
Fans	_____	Others (denote)	_____
TOTAL	_____		

MISCELLANEOUS: (number of)

Branch Panels	_____	
Transformers	_____	
Air Conditioners	_____	
Signs	_____	
Fire/Burglar Alarms	_____	
Circus, Fairs, etc.	_____	
Alterations to wires	_____	
Repairs after fire	_____	
Heavy Duty, 220v outlets	_____	
Emergency Lights, battery	_____	
Emergency Generators	_____	

FOR ADDITIONAL WORK NOT ON ORIGINAL PERMIT	_____	DOUBLE FEE DUE:	_____
FOR REMOVAL OF A "STOP ORDER" (304-16.b)	_____		
FOR PERFORMING WORK WITHOUT A PERMIT (304-9)	_____	TOTAL AMOUNT DUE:	6.00

INSPECTION: Will be ready on _____, 19__; or Will Call XX

CONTRACTOR'S NAME: J. T. Manning Co.
 ADDRESS: P. O. Box 516 Canal Plaza
 TEL.: 773-8987

MASTER LICENSE NO.: on file SIGNATURE OF CONTRACTOR: John T. Manning
 LIMITED LICENSE NO.: _____

INSPECTOR'S COPY



APPLICATION FOR PERMIT
DEPARTMENT OF BUILDING INSPECTIONS SERVICES
ELECTRICAL INSTALLATIONS

Date June 23, 1977
 Receipt and Permit number 10096

To the CHIEF ELECTRICAL INSPECTOR, Portland, Maine.
 The undersigned hereby applies for a permit to make electrical installations in accordance with the laws of Maine,
 the Portland Electrical Ordinance, the National Electrical Code and the following specifications:

LOCATION OF WORK: Lot # 34 Christy Road
 OWNER'S NAME: Christy & Small ADDRESS: 247 Allen Ave.

OUTLETS: (number of) 31-60 FEES
 Lights _____
 Receptacles _____
 Switches _____
 Plugmold _____ (number of feet) 5.00
 TOTAL _____

FIXTURES: (number of)
 Incandescent _____
 Fluorescent _____ (Do not include strip fluorescent)
 TOTAL _____
 Strip Fluorescent, in feet _____ 3.00

SERVICES:
 Permanent, total amperes 200 _____
 Temporary _____ .50

METERS: (number of) 1 _____

MOTORS: (number of)
 Fractional _____
 1 HP or over _____ 5.00

RESIDENTIAL HEATING:
 Oil or Gas (number of units) _____
 Electric (number of rooms) 5 _____

COMMERCIAL OR INDUSTRIAL HEATING:
 Oil or Gas (by a main boiler) _____
 Oil or Gas (by separate units) _____
 Electric (total number of kws) _____

APPLIANCES: (number of)
 Ranges 1 _____
 Cook Tops _____
 Wall Ovens 1 _____
 Dryers _____
 Fans _____
 Water Heaters X _____
 Disposals X _____
 Dishwashers X _____
 Compactors _____
 Others (denote) _____ 7.50
 TOTAL _____

MISCELLANEOUS: (number of)
 Branch Panels _____
 Transformers _____
 Air Conditioners _____
 Signs _____
 Fire/Burglar Alarms _____
 Circus, Fairs, etc. _____
 Alterations to wires _____
 Repairs after fire _____
 Heavy Duty, 220v outlets _____
 Emergency Lights, etc. _____
 Emergency Generators _____

FOR ADDITIONAL WORK NOT ON ORIGINAL PERMIT _____
 FOR REMOVAL OF A "STOP ORDER" (304-16 b) _____
 FOR PERFORMING WORK WITHOUT A PERMIT (304-9) _____
 INSTALLATION FEE DUE: _____
 DOUBLE FEE DUE: _____
 TOTAL AMOUNT DUE: 21.00

INSPECTION:
 Will be ready on 6-23-77, 19____, or Will Call _____
 CONTRACTOR'S NAME: Mancini Electric
 ADDRESS: 179 Sheridan St.
 TEL.: 774-5829
 MASTER LICENSE NO.: 2436
 LIMITED LICENSE NO. _____

SIGNATURE OF CONTRACTOR:
[Signature]

INSPECTOR'S COPY



CITY OF PORTLAND, MAINE
Department of Building Inspection

Certificate of Occupancy

LOCATION Lot # 34 Christy Road

Issued to **Christy & Small**

Date of Issue **August 2, 1977**

This is to certify that the building, premises, or part thereof, at the above location, built—altered—changed as to use under Building Permit No. **77/237**, has had final inspection, has been found to conform substantially to requirements of Zoning Ordinance and Building Code of the City, and is hereby approved for occupancy or use, limited or otherwise, as indicated below.

PORTION OF BUILDING OR PREMISES

APPROVED OCCUPANCY

Entire

Single Family Dwelling

Limiting Conditions:

This certificate supersedes
certificate issued

Approved:

[Signature]
(Date) Inspector

[Signature]
Inspector of Buildings

Notice: This certificate identifies lawful use of building or premises, and ought to be transferred from owner to owner when property changes hands. Copy will be furnished to owner or lessee for one dollar.



APPLICATION FOR PERMIT

PERMIT ISSUED

B.O.C.A. USE GROUP
B.O.C.A. TYPE OF CONSTRUCTION

APR 27 1917

ZONING LOCATION A-2 PORTLAND, MAINE, APRIL 20, 1917

CITY of PORTLAND

To the DIRECTOR OF BUILDING & INSPECTION SERVICES, PORTLAND, MAINE

0237

The undersigned hereby applies for a permit to erect, alter, repair, demolish, move or install the following building, structure, equipment or change use in accordance with the Laws of the State of Maine, the Portland B.O.C.A Building Code and Zoning Ordinance of the City of Portland with plans and specifications, if any, submitted herewith and the following specifications:

LOCATION Lot # 34 Gariaty Road Fire District #1 [], #2 []
1. Owner's name and address George Christy-247 Allen Ave. Telephone 191-3441
2. Lessee's name and address
3. Contractor's name and address Owner Telephone
4. Architect Specifications Plans No. of sheets
Proposed use of building dwelling No. families 1
Last use No. families
Material No. stories Heat Style of roof Roofing
Other buildings on same lot
Estimated contractual cost \$ 28,000 Fee \$ 112.00

FIELD INSPECTOR-Mr. Hugh Irving GENERAL DESCRIPTION

This application is for: @ 775-5451
Dwelling Ext. 234 Permit to construct single family dwelling as per plans. 1 sheets of plans. 24 x 36, also 10x12 breezeway Stamp of Special Conditions attached to dwelling
Garage
Masonry Bldg.
Metal Bldg.
Alterations
Demolition
Change of Use
Other

NOTE TO APPLICANT: Separate permits are required by the installers and subcontractors of heating, plumbing, electrical and mechanicals.

PERMIT IS TO BE ISSUED TO 1 [x] 2 [] 3 [] 4 []
Other:

DETAILS OF NEW WORK

Is any plumbing involved in this work? Yes
Is any electrical work involved in this work? Yes
Is connection to be made to public sewer? Yes If not, what is proposed for sewage?
Has septic tank notice been sent? Form notice sent?
Height average grade to top of plate 4.4 ft. Height average grade to highest point of roof 18 ft.
Size, front 36 depth 24 No stones solid or filled land? solid earth or rock? earth
Material of foundation concrete Thickness, top 10 in bottom 10 in cellar yes
Kind of roof gambrel Rise per foot 5 Roof covering asphalt
No. of chimneys Material of chimneys of lining Kind of heat fuel
Framing Lumber-Kin spruce Dressed or full size dressed Corner posts 4 x 6 Sills 2 x 10
Size Girder 6 x 10 Columns under girders 3 x 3 Kellys Size 3 Max. on centers 8 ft.
Studs (outside walls and carrying partitions) 2 x 16 O. C. Bridging in every floor and flat roof span over 8 feet.
Joists and rafters: 1st floor 2 x 16 2nd 3rd roof
On centers: 1st floor 16 2nd 3rd roof
Maximum span: 1st floor 12 ft. 2nd 3rd roof
If one story building with masonry walls, thickness of walls? height?

IF A GARAGE

No. cars now accommodated on same lot to be accommodated number commercial cars to be accommodated
Will automobile repairing be done other than minor repairs to cars habitually stored in the proposed building?

APPROVALS BY: DATE MISCELLANEOUS
BUILDING INSPECTION-PLAN EXAM. Will work require disturbing of any tree on a public street?
ZONING: O.K. M.C.D. 5/12/17
BUILDING CODE: O.K. E.S. 5/12/17 Will there be in charge of the above work a person competent to see that the State and City requirements pertaining hereto are observed? Yes
Fire Dept.:
Health Dept.:
Others:

Signature of Applicant George Christy Phone # same
Type Name of above George Christy 1 [x] 2 [] 3 [] 4 []

FIELD INSPECTOR'S COPY

Other and Address

NOTES Carpet

May 5/77 Off body piece
 gathering of material etc
 Est. etc. approved etc.
 May 12/77 Sub flooring etc.
 May 20/77 Premium paper
 May 31/77 Final etc for closing
 in etc.
 July 22/77 Bldg completed
 Off etc. issue etc of etc - for
 etc. & single family dwelling

Permit No. 77-19237
 Location 1st + 3rd Street
 Owner George Cluney
 Date of permit 4-24-77
 Approved 1-20-77

SPECIAL ALPHABETIC INDEX OF CARDS
 (This section contains a list of card numbers and their corresponding locations, which is mostly illegible due to the quality of the scan.)

(This section contains a large, handwritten 'X' mark that spans across the entire right-hand side of the page, likely indicating that the information in this section is void or unused.)

PERMIT # 002639 TOWN OF _____ BUILDING PERMIT APPLICATION MAP # _____ LOT # 10

Please fill out any part which applies to job. Proper plans must accompany form.

Owner: Robert Dacey
 Address: 147 Christy Road Portland 04103 878-8404

LOCATION OF CONSTRUCTION same
 CONTRACTOR: OWNR SUBCONTRACTORS: _____

ADDRESS: _____
 Est. Construction Cost: 9800 Type of Use: shed
 Past Use: _____
 Building Dimensions: 12W 10 Sq. Ft. Stories: _____ Lot Size: _____
 Is Proposed Use: _____ Seasonal _____ Condominium _____ Apartment _____
 Conversion Explain erect shed 10x12

COMPLETE ONLY IF THE NUMBER OF UNITS WILL CHANGE
 Residential Buildings Only
 # Of Dwelling Units 1 # Of New Dwelling Units _____

Foundations:
 1. Type of Soil: _____
 2. Set Backs - Front _____ Rear _____ Side(s) _____
 3. Footings Size: _____
 4. Foundation Size: _____
 5. Other _____

Floors:
 1. Sills Size: _____ Sills must be anchored.
 2. Girder Size: _____
 3. Lally Column Spacing: _____ Size: _____
 4. Joists Size: _____ Spacing 16" O.C.
 5. Bridging Type: _____ Size: _____
 6. Floor Sheathing Type: _____ Size: _____
 7. Other Material: _____

Exterior Walls:
 1. Studding Size _____ Spacing _____
 2. No. windows _____
 3. No. Doors _____
 4. Header Sizes _____ Span(s) _____
 5. Bracing: Yes _____ No _____
 6. Corner Posts Size _____
 7. Insulation Type _____ Size _____
 8. Sheathing Type _____ Size _____
 9. Siding Type _____ Weather Exposure _____
 10. Masonry Materials _____
 11. Metal Materials _____

Interior Walls:
 1. Studding Size _____ Spacing _____
 2. Header Sizes _____ Span(s) _____
 3. Wall Covering Type _____
 4. Fire Wall if required _____
 5. Other Materials _____

For Official Use Only

Date: 10-3-89 Subdivision: Yes NO
 Name: _____
 Inside Fire Limits: _____
 Bidg Code: _____
 Time Limit: _____
 Estimated Cost: _____
 "Use Structure": 425
 Fee: _____
 City of Portland
 Permit Expiration: _____
 Ownership: _____
 Public: _____

Colling:
 1. Ceiling Joists Size: _____
 2. Ceiling Strapping Size _____ Spacing _____
 3. Type Ceilings: _____
 4. Insulation Type _____
 5. Ceiling Height: _____

Roof:
 1. Truss or Rafter Size _____
 2. Sheathing Type _____
 3. Roof Covering Type _____
 4. Other _____

Chimneys:
 Type: _____ Number of Fire Places _____

Heating:
 Type of Heat: _____

Electrical:
 Service Entrance Size: _____ Smoke Detector Required Yes _____ No _____

Plumbing:
 1. Approval of soil test if required Yes _____ No _____
 2. No. of Tubs or Showers _____
 3. No. of Flushes _____
 4. No. of Lavatories _____
 5. No. of Other Fixtures _____

Swimming Pools:
 1. Type: _____
 2. Pool Size: _____ x _____ Square Footage _____
 3. Must conform to National Electrical Code and State Law.

Zoning:
 District R-2 Street Frontage Req. _____ Provided _____
 Required Setbacks: Front _____ Back _____ Side _____

Review Requirements:
 Zoning Board Approval: Yes _____ No _____ Date: _____
 Planning Board Approval: Yes _____ No _____ Date: _____
 Conditional Use _____ Variance _____ Site Plan _____ Subdivision _____
 Shore and Floodplain Mgmt _____ Special Exception _____
 Other (Explain) _____
 Date Approved: 10-3-89

Permit Received By kat

Signature of Applicant _____ Date _____

Signature of CEO _____ Date _____

Inspection Dates _____

171 Med. Lot

PLOT PLAN

N



FEES (Breakdown From Front)

Base Fee \$ _____
Subdivision Fee \$ _____
Site Plan Review Fee \$ _____
Other Fees \$ _____
(Explain) _____
Late Fee \$ _____

Type

Inspection Record

Date

Type	Inspection Record	Date
_____	_____	____/____/____
_____	_____	____/____/____
_____	_____	____/____/____
_____	_____	____/____/____
_____	_____	____/____/____

COMMENTS

10-17-89 Shes has been put up

Signature of Applicant _____

Date _____

147 CHRISTY RD

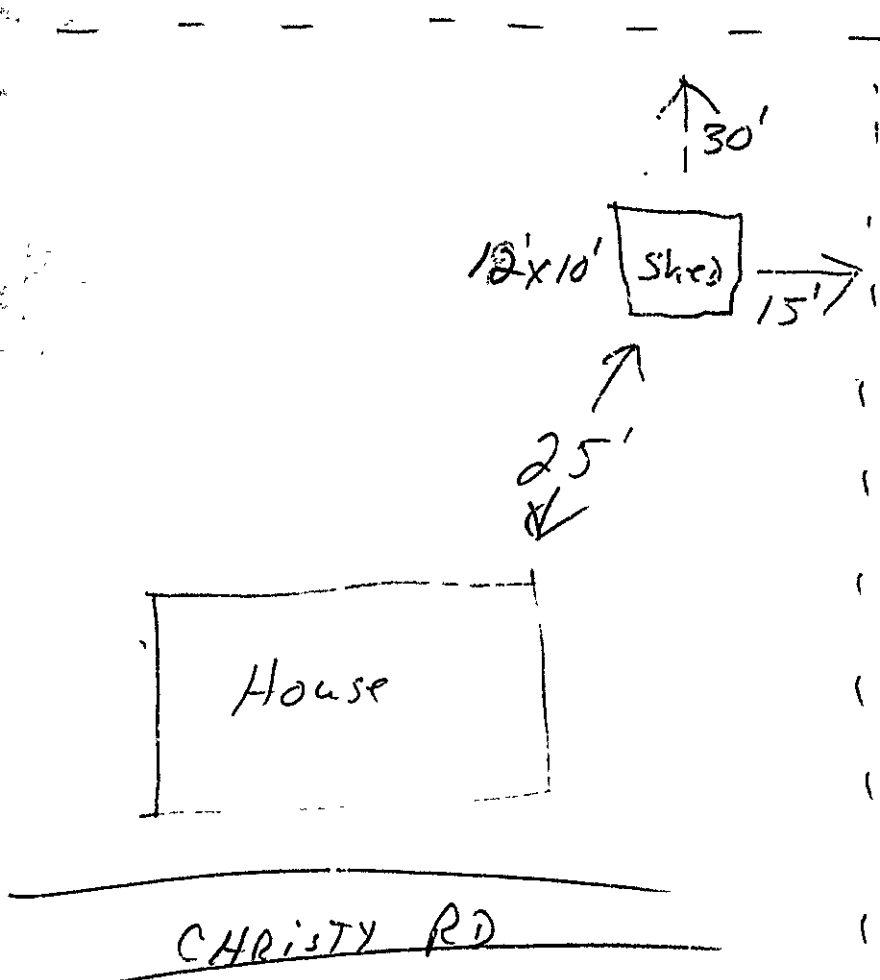

on blocks
10/4/09 - talked to Mr Dacey
is in concrete blocks -
weij 2x4's 2x8's

PERMIT # **02633**

TOWN OF _____ BUILDING PERMIT APPLICATION

MAP # _____

LC# _____

Please fill out any part which applies to job. Proper plans must accompany form.

Owner: **Robert Dacey**
 Address: **147 Christy Road Portland 04103 878-8404**

LOCATION OF CONSTRUCTION same

CONTRACTOR: owner SUBCONTRACTORS: _____

ADDRESS: _____

Est. Construction Cost: **\$800** Type of Use: **shed**

Past Use: _____

Building Dimensions **L-12W-10** Sq. Ft. _____ # Stories _____ Lot Size _____

Is Proposed Use: _____ Seasonal _____ Condominium _____ Apartment _____

Conversion: Explain construct new

COMPLETE ONLY IF THE NUMBER OF UNITS WILL CHANGE

Residential Buildings Only

Of Dwelling Units _____ # Of New Dwelling Units _____

Foundations:

1. Type of Soil: _____
2. Set Backs - Front _____ Rear _____ Side(s) _____
3. Footings Size: _____
4. Foundation Size: _____
5. Other _____

Floors:

1. Sills Size: _____ Sills must be anchored.
2. Girder Size: _____
3. Lally Column Spacing: _____ Size: _____
4. Joists Size: _____ Spacing **16" O.C.**
5. Bridging Type: _____ Size: _____
6. Floor Sheathing Type: _____ Size: _____
7. Other Material: _____

Exterior Walls:

1. Studding Size _____ Spacing _____
2. No. windows _____
3. No. Doors _____
4. Header Size: _____ Span(s) _____
5. Bracing: Yes _____ No _____
6. Corner Posts Size _____
7. Insulation Type _____ Size _____
8. Sheathing Type _____ Size _____
9. Siding Type _____ Weather Exposure _____
10. Masonry Materials _____
11. Metal Materials _____

Interior Walls:

1. Studding Size _____ Spacing _____
2. Header Size _____ Span(s) _____
3. Wall Covering Type _____
4. Fire Wall if required _____
5. Other Materials _____

White-Tax Assesor

Yellow-GPCOG

White Tag -CEO

© Copyright GPCOG 1987

For Official Use Only

Date: 10-3-89	Subdivision: Yes / No _____
Inside Fire Limits: _____	Name: _____
UDG Code: _____	Block: 11111 ISSUED
Time Limit: _____	Permit Expiration: _____
Estimated Cost: _____	Ownable: 001-4-100
Value/Structure: 725	Fee: _____

Ceiling: **City of Portland**

1. Ceiling Joists Size: _____
2. Ceiling Wrapping Size _____ Spacing _____
3. Type Ceiling: _____
4. Insulation Type _____ Size _____
5. Ceiling Height: _____

Roof:

1. Truss or Rafter Size _____ Span _____
2. Sheathing Type _____ Size _____
3. Roof Covering Type _____
4. Other _____

Chimneys:

- Type: _____ Number of Fire Places _____

Heating:

- Type of Heat: _____

Electrical:

- Service Entrance Size: _____ Smoke Detector Required Yes _____ No _____

Plumbing:

1. Approval of soil test if required Yes _____ No _____
2. No. of Tubs or Showers _____
3. No. of Flushes _____
4. No. of Lavatories _____
5. No. of Other Fixtures _____

Swimming Pools:

1. Type: _____
2. Pool Size: _____ x _____ Square Footage _____
3. Must conform to National Electrical Code and State Law.

Zoning:

- District: _____ Street Frontage Req. _____ Provided _____

Review Required:

- Required Setbacks: Front _____ Back _____ Side _____
- Zoning Board Approval: Yes _____ No _____ Date: _____
- Planning Board Approval: Yes _____ No _____ Date: _____
- Conditional Use: _____ Variance _____ Site Plan _____ Subdivision _____
- Shore and Floodplain Mgmt _____ Special Exception _____
- Other (Explain) _____
- Date Approved _____

Permit Received By kat

Signature of Applicant Robert J. Dacey Date _____

Signature of CEO (4) Date _____

Inspection Dates _____