

80-94 CHRISTY ROAD
Lot 17



APPLICATION FOR PERMIT
DEPARTMENT OF BUILDING INSPECTIONS SERVICES
ELECTRICAL INSTALLATIONS

Date Oct. 8, 19 76
 Receipt and Permit number 87973
A 7984

To the CHIEF ELECTRICIAN
 The undersigned here
 the Portland Electrical C-

OR, Portland, Maine:
 a permit to make electrical installation in accordance with the laws of Maine,
 National Electrical Code and the following specifications:

LOCATION OF WORK: Christy Road
 OWNER'S NAME: _____ M. ADDRESS: _____

OUTLETS: (number of) 9.00
 Lights 100
 Receptacles _____
 Switches _____
 Plugmold _____ (number of feet)
 TOTAL _____ FEES

FIXTURES: (number of)
 Incandescent _____
 Fluorescent _____ (Do not include strip fluorescent)
 TOTAL _____
 Strip Fluorescent, in feet _____

SERVICES:
 Permanent, total amperes 200 3.00
 Temporary _____

METERS: (number of) 1 1.50

MOTORS: (number of)
 Fractional 1
 1 HP or over _____

RESIDENTIAL HEATING:
 Oil or Gas (number of units) _____
 Electric (number of rooms) 12 12.00

COMMERCIAL OR INDUSTRIAL HEATING:
 Oil or Gas (by a main boiler) _____
 Oil or Gas (by separate units) _____
 Electric (total number of kws) _____

APPLIANCES: (number of)
 Ranges 2 Water Heaters 1
 Cook Tops _____ Disposals 1
 Wall Ovens _____ Dishwashers _____
 Dryers 1 Compactors _____
 Fans _____ Others (denote) _____
 TOTAL _____ 7.50

MISCELLANEOUS: (number of)
 Branch Panels _____
 Transformers _____
 Air Conditioners _____
 Signs _____
 Fire/Burglar Alarms _____
 Circus, Fairs, etc. _____
 Alterations to wires _____
 Repairs after fire _____
 Heavy Duty, 220v outlets _____
 Emergency Lights, battery _____
 Emergency Generators _____

INSTALLATION FEE DUE: _____
 FOR ADDITIONAL WORK NOT ON ORIGINAL PERMIT ... DOUBLE FEE DUE: _____
 FOR REMOVAL OF A "STOP ORDER" (304-16.b) ... _____
 FOR PERFORMING WORK WITHOUT A PERMIT (304-9) ... _____
 TOTAL AMOUNT DUE: 32.00

INSPECTION: this p. m.
 Will be ready on Ready, 19__; or Will Call _____

CONTRACTOR'S NAME: Percy Electric Co.
 ADDRESS: Box 82 Biddeford, Maine
 TEL.: 282-2342

MASTER LICENSE NO.: 3175 SIGNATURE OF CONTRACTOR: [Signature]
 LIMITED LICENSE NO.: _____

INSPECTOR'S COPY

ELECTRICAL INSTALLATIONS -

Permit Number 7984
Location Lot 17 Clearing Road
Owner Ann Fox
Date of Permit 10-12-76
Final Inspection 11-4-76
By Inspector R. Libby
Permit Application Register Page No. 75

INSPECTIONS: Service ✓ by R. Libby
Service called in 11-4-76
Closing-in 10-12-76 by R. Libby
PROGRESS INSPECTIONS: 10-29-76 |
11-2-76 |

CODE
COMPLIANCE
COMPLETED
DATE 11-4-76

DATE:	REMARKS:
<u>11-2-76</u>	<u>Check service - no bond in cellar</u> <u>no bond on conduit at meter.</u> <u>Not right size bond on bushing.</u>
<u>11-4-76</u>	<u>OK</u>



APPLICATION FOR PERMIT

PERMIT ISSUED

AUG 12 1976

0714

CITY of PORTLAND

B.O.C.A. USE GROUP
B.O.C.A. TYPE OF CONSTRUCTION
ZONING LOCATION R-2 PORTLAND, MAINE, Aug. 6, 1976

To the DIRECTOR OF BUILDING & INSPECTION SERVICES, PORTLAND, MAINE

The undersigned hereby applies for a permit to erect, alter, repair, demolish, move or install the following building, structure, equipment or change use in accordance with the Laws of the State of Maine, the Portland B.O.C.A. Building Code and Zoning Ordinance of the City of Portland with plans and specifications, if any, submitted herewith and the following specifications:

LOCATION Lot 17, Christy Rd. Fire District #1 [] #2 []
1. Owner's name and address John Fox, 10 Sylvia Rd., Portland Telephone
2. Lessee's name and address Telephone
3. Contractor's name and address Robert Bebard & Sons, 5 Pine St., Biddeford Telephone 282-0672
4. Architect Specifications Plans No. of sheets
Proposed use of building dwelling No. families
Last use No. families
Material No. stories Heat Style of roof Roofing
Other buildings on same lot
Estimated contractual cost \$32,000. Fee \$124.00

FIELD INSPECTOR - Mr. Travis Irving GENERAL DESCRIPTION
This application is for: @ 775-5451 To construct dwelling 26' x 48'
Dwelling Ext. 234 No Garage as per plans
Garage
Masonry Bldg
Metal Bldg. Stamp of Special Conditions
Alterations
Demolitions
Change of Use
Other

NOTE TO APPLICANT: Separate permits are required by the installers and subcontractors of heating, plumbing, electrical and mechanicals.

PERMIT IS TO BE ISSUED TO 1 [] 2 [] 3 [] 4 []

Other:

DETAILS OF NEW WORK

Is any plumbing involved in this work? Is any electrical work involved in this work?
Is connection to be made to public sewer? If not, what is proposed for sewage?
Has septic tank notice been sent? Form notice sent?
Height average grade to top of plate 2' Height average grade to highest point of roof 16'
Size, front depth No. stories 2 solid or filled land? earth or rock?
Material of foundation cement 10" Thickness, top bottom cellar
Kind of roof pitch Rise per foot 5/12 Roof covering asphalt shingle
No. of chimneys 1 Material of chimneys of lining Kind of heat elec fuel
Framing Lumber - Kind spruce Dressed or full size? Corner posts 3 1/2 Sills
Size Girder 1 1/2" beam Columns under girders 2 Size Max. centers
Studs (outside walls and carrying partitions) 2x4-16" O. C. Bridging in every floor and flat roof span over P feet.
Joists and rafters: 1st floor 2x10 2nd 3rd roof 2x6
On centers: 1st floor 16 2nd 3rd roof 16
Maximum span: 1st floor 14' 2nd 3rd roof 14'

IF A GARAGE NO GARAGE

No. cars now accommodated on same lot to be accommodated number commercial cars to be accommodated
Will automobile repairing be done other than minor repairs to cars habitually stored in the proposed building?

APPROVALS BY: DATE
BUILDING INSPECTION - PLAN EXAMINER
ZONING: M.G. 8/9/76
BUILDING CODE: 8/10/76
Fire Dept.
Health Dept.
Others:

MISCELLANEOUS
Will work require disturbing of any tree on a public street?
Will there be in charge of the above work a person competent to see that the State and City requirements pertaining thereto are observed? Yes

Signature of Applicant Raymond C. Bebard Phone #
Type Name of above Raymond Bebard 1 [] 2 [] 3 [] 4 []
Other and Address

FIELD INSPECTOR'S COPY

NOTES

9/29/76 ^{Bedont's} Location appears OK.
 No sign of foundation but
 it appears to be well done.
 Boarding up & placing the
 out side finish -
 10/28/76 sheet rocking!
 11/10/76 Plot of interior
 finishing to be completed,
 including the cement basement
 etc. etc. - Electric Heat -
 11/17/76 Progressing
 11/29/76 Final Today; (Completed)
 OK to issue C of O, entire single
 family dwelling.

Bible

Permit No. 76/714
 Location Lot 17 Church Rd
 Owner Parker Fox
 Date of permit 8-11-76
 Approved

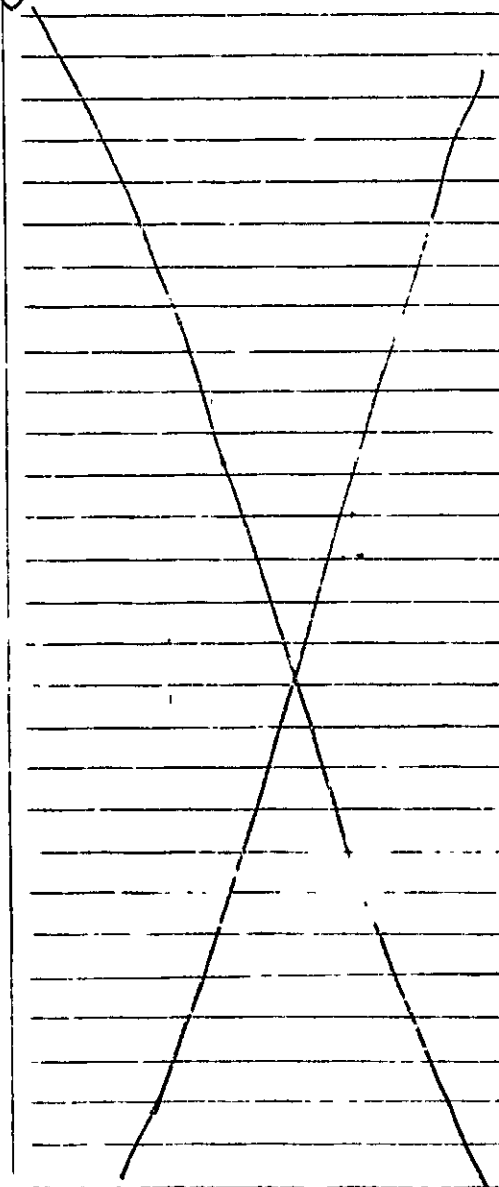

(COPY)

CITY OF PORTLAND, MAINE
Department of Building Inspection



Certificate of Occupancy

LOCATION

Issued to

John Fox

Date of Issue

12-1-75

This is to certify that the building, premises, or part thereof, at the above location, built—altered—changed as to use under Building Permit No. **76/714**, has had final inspection, has been found to conform substantially to requirements of Zoning Ordinance and Building Code of the City, and is hereby approved for occupancy or use, limited or otherwise, as indicated below.

PORTION OF BUILDING OR PREMISES

APPROVED OCCUPANCY

Entire

1 family dwelling

Limiting Conditions:

This certificate supersedes
certificate issued

Approved:

11/31/75
(Date)
F. H. [Signature]
Inspector of Buildings

Notice: This certificate identifies lawful use of building or premises, and ought to be transferred from owner to owner when property changes hands. Copy will be furnished to owner or lessee for one dollar.



APPLICATION FOR PERMIT
DEPARTMENT OF BUILDING INSPECTIONS SERVICES
ELECTRICAL INSTALLATIONS

Date AUG 16, 19 76
 Receipt and Permit number 7756

To the CHIEF ELECTRICAL INSPECTOR, Portland, Maine:
 The undersigned hereby applies for a permit to make electrical installations in accordance with the laws of Maine, the Portland Electrical Ordinance, the National Electrical Code and the following specifications:

LOCATION OF WORK: Lot 17 Christy Road Portland
 OWNER'S NAME: John Fox ADDRESS: _____

OUTLETS: (number of)

Lights	_____	
Receptacles	_____	FEES
Switches	_____	
Plugmold	_____ (number of feet)	
TOTAL	_____	_____

FIXTURES: (number of)

Incandescent	_____	
Fluorescent	_____ (Do not include strip fluorescent)	
TOTAL	_____	_____
Strip Fluorescent, in feet	_____	_____

SERVICES:

Permanent, total amperes	<u>100</u> <i>Frank</i>	<u>3.00</u>
Temporary	_____	_____

METERS: (number of) 15050

MOTORS: (number of)

Fractional	_____	
1 HP or over	_____	

RESIDENTIAL HEATING:

Oil or Gas (number of units)	_____	
Electric (number of rooms)	_____	

COMMERCIAL OR INDUSTRIAL HEATING:

Oil or Gas (by a main boiler)	_____	
Oil or Gas (by separate units)	_____	
Electric (total number of kws)	_____	

APPLIANCES: (number of)

Ranges	_____	Water Heaters	_____
Cook Tops	_____	Disposals	_____
Wall Ovens	_____	Dishwashers	_____
Dryers	_____	Compactors	_____
Fans	_____	Others (denote)	_____
TOTAL	_____		_____

MISCELLANEOUS: (number of)

Branch Panels	_____	
Transformers	_____	
Air Conditioners	_____	
Signs	_____	
Fire/Burglar Alarms	_____	
Circus, Fairs, etc.	_____	
Alterations to wires	_____	
Repairs after fire	_____	
Heavy Duty, 220v outlets	_____	
Emergency Lights, battery	_____	
Emergency Generators	_____	

INSTALLATION FEE DUE:	_____
FOR ADDITIONAL WORK NOT ON ORIGINAL PERMIT DOUBLE FEE DUE: _____
FOR REMOVAL OF A "STOP ORDER" (304-16.b) _____
FOR PERFORMING WORK WITHOUT A PERMIT (304-9) _____
TOTAL AMOUNT DUE:	<u>3.50</u>

INSPECTION:
 Will be ready on _____, 19____; or Will Call _____

CONTRACTOR'S NAME: Leo Berube
 ADDRESS: Boon Rd, Saco, Me.
 TEL.: _____

MASTER LICENSE NO.: _____
 LIMITED LICENSE NO.: 3097

SIGNATURE OF CONTRACTOR:
Paul Berube

INSPECTOR'S COPY

ELECTRICAL INSTALLATIONS—

Permit Number 7756
 Location Lot 17 Pleasant Road
 Owner John Cox
 Date of Permit 8-16-76
 Final Inspection P-11-76
 By Inspector Palby
 Permit Application Register Page No. 68

INSPECTIONS: Service T. Cox by Palby
 Service called in 8-16-76
 Closing-in by

PROGRESS INSPECTIONS:

**CODE
 COMPLIANCE
 COMPLETED**
 DATE 8-16-76

DATE:	REMARKS:

Palby

APPLICATION FOR PERMIT

PERMIT ISSUED

B.O.C.A. USE GROUP

B.O.C.A. TYPE OF CONSTRUCTION

573

MAY 25 1984

ZONING LOCATION PORTLAND, MAINE

MAY 17, 1984

CITY OF PORTLAND

To the CHIEF OF BUILDING & INSPECTION SERVICES, PORTLAND, MAINE

The undersigned hereby applies for a permit to erect, alter, repair, demolish, move or install the following building, structure, equipment or change use in accordance with the Laws of the State of Maine, the Portland B.O.C.A. Building Code and Zoning Ordinance of the City of Portland with plans and specifications, if any, submitted herewith and the following specifications:

LOCATION 82 Christy Road

1. Owner's name and address John Fox - 3333

Fire District #1 #2

Telephone W 797-5551

2. Lessee's name and address

Telephone W 780-3330

3. Contractor's name and address Bob Bliver Pools - Rta # 4 Longfellow Dr.

Telephone B39-3418

Gorham

Proposed use of building above ground pool

No. of sheets

Last use

No. families

Material No. stories Heat Style of roof

Roofing

Other buildings on same lot

Estimated contractual cost \$ 2,000

Appeal Fees \$

FIELD INSPECTOR—Mr.

@ 775-5451

Base Fee

20.00

Late Fee

To install above ground pool, 24" diameter as per plans. 1 sheet of plans.

TOTAL

\$ 20.00

send permit to # 21 04103

Stamp of Special Conditions

NOTE TO APPLICANT: Separate permits are required by the installers and subcontractors of heating, plumbing, electrical and mechanicals.

DETAILS OF NEW WORK

Is any plumbing involved in this work? no Is any electrical work involved in this work? yes
Is connection to be made to public sewer? If not, what is proposed for sewage?
Has septic tank notice been sent? Form notice sent?
Height average grade to top of plate Height average grade to highest point of roof
Size, front depth No. stories solid or filled land? car, h or rock?
Material of foundation Thickness, top bottom cellar
Kind of roof Rise per foot Roof covering
No. of chimneys Material of chimneys of lining Kind of heat fuel
Framing Lumber—Kind Dressed or full size? Corner posts Sills
Size Girder Columns under girders Size Max. on centers
Studs (outside walls and carrying partitions) 2x4-16" O. C. Bridging in every floor and flat roof span over 8 feet.
Joists and rafters, 1st floor 2nd 3rd roof
On centers: 1st floor 2nd 3rd roof
Maximum span: 1st floor 2nd 3rd roof
If one story building with masonry walls, thickness of walls? height?

IF A GARAGE

No. cars now accommodated on same lot to be accommodated number commercial cars to be accommodated
Will automobile repairing be done other than minor repairs to cars habitually stored in the proposed building?

APPROVALS BY: DATE

MISCELLANEOUS

BUILDING INSPECTION—PLAN EXAMINER

Will work require disturbing of any tree in public street?

ZONING:

BUILDING CODE:

Will there be in charge of the above work a person competent to see that the State and City requirements pertaining thereto are observed?

Fire Dept.:

Health Dept.:

Others:

Signature of Applicant

John Fox

Phone # 21123

Type Name of above

1 2 3 4

Other and Address

FIELD INSPECTOR'S COPY

APPLICANT'S COPY

OFFICE FILE COPY

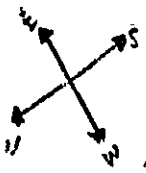

Christy Road

John C Fox
82 Christy RD
Portland ME
Site plan of
24' Diameter Above
Ground Swimming Pool.

Driveway

House

Metal
Sheet

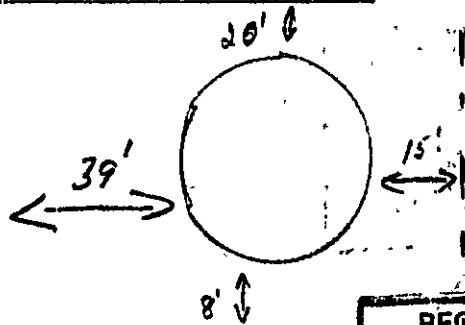

RECEIVED
MAY 17 1984
DEPT. OF BLDG. INSP.
CITY OF PORTLAND



Sharkline

SEASPRAY-SHARKLINE, INC.
431 BAYVIEW AVENUE • AMITYVILLE, L.I. NEW YORK 11701

ARISTOCRAT ROUND

24' inch. \$ 1406.00

Skimmer 40.00
\$ 1446.00

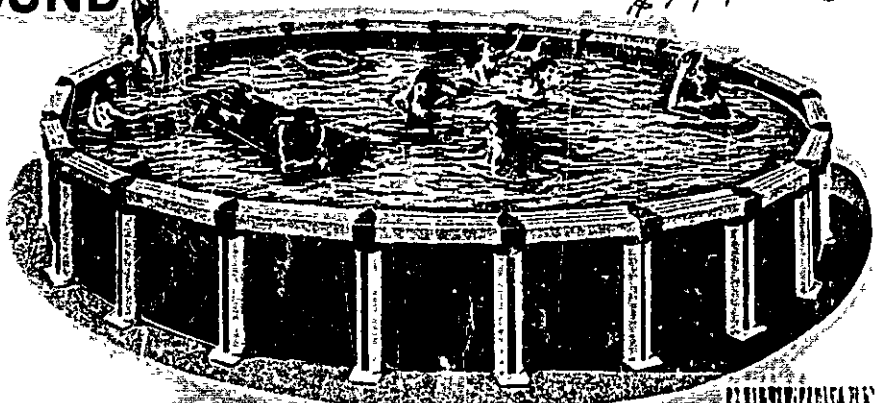

OPTIONAL WOOD-GRAIN
ALUMINUM WALL AVAILABLE
!!! BLUE OR GREEN



RECEIVED
MAY 17 1984
DEPT. OF BLDG. INSP.
CITY OF PORTLAND

ROXBURY

15 Year
Limited Warranty
and Service Policy



CITY OF PORTLAND

JOSEPH E. GRAY, JR.
DIRECTOR OF PLANNING
AND URBAN DEVELOPMENT

May 25, 1984

John Fox
82 Christy Road
Portland, Maine 04103

Re: 82 Christy Road

Dear Mr. Fox:

Your permit to install a 24' ^{above ground} ~~swimming~~ pool at 82 Christy Road, as per plans on file in this office, is being issued with the following requirements:

- (1) Section 627.9 Swimming pool safety devices: Every person owning land on which there is situated a swimming pool, which contains 24 inches or more of water depth at any point shall erect and maintain thereon an adequate enclosure either surrounding the property or pool area, sufficient to make such body of water inaccessible to small children. Such enclosure, including gates therein, must be not less than 4 feet above underlying ground. All gates must be self latching with latches placed 4 feet above underlying ground. All gates must be self latching with latches placed 4 feet above the underlying ground and otherwise made inaccessible from the outside to small children.

A natural barrier, hedge, pool cover or other protective device approved by the governing body may be used so long as the degree of protection afforded by the substituted devices or structures is not less than the protection afforded by the enclosure, gate and latch described herein.

- (2) Electrical and plumbing permits must be obtained.

If you have any questions on these requirements, please call this office.

Sincerely,

P. S. Hoffes
Chief of Inspection Services

KWC
CEO
A.P.E.

F3H/jmr



CITY OF PORTLAND

JOSEPH E. GRAY, JR.
DIRECTOR OF PLANNING
AND URBAN DEVELOPMENT

May 25, 1984

John Fox
82 Christy Road
Portland, Maine 04103

Re: 82 Christy Road

Dear Mr. Fox:

Your permit to install a 24' ~~above ground~~ pool at 82 Christy Road,
as per plans on file in this office, is being issued with the following
requirement:

- (1) Section 627.9 Swimming pool safety devices: Every person owning land on which there is situated a swimming pool, which contains 24 inches or more of water depth at any point shall erect and maintain thereon an adequate enclosure either surrounding the property or pool area, sufficient to make such body of water inaccessible to small children. Such enclosure, including gates therein, must be not less than 4 feet above underlying ground. All gates must be self latching with latches placed 4 feet above underlying ground. All gates must be self latching with latches placed 4 feet above the underlying ground and otherwise made inaccessible from the outside to small children.

A natural barrier, hedge, pool cover or other protective device approved by the governing body may be used so long as the degree of protection afforded by the substituted devices or structures is not less than the protection afforded by the enclosure, gate and latch described herein.

- (2) Electrical and plumbing permits must be obtained.

If you have any questions on these requirements, please call this office.

Sincerely,

P. S. Hoffes
Chief of Inspection Services

PSH/jmr

KWC
CEO
A.P.E.

APPLICATION FOR PERMIT

PERMIT ISSUED

B.O.C.A. USE GROUP 573

B.O.C.A. TYPE OF CONSTRUCTION

ZONING LOCATION .. R-3 ... PORTLAND, MAINE .. May 17, 1984

MAY 25 1984

CITY of PORTLAND

To the CHIEF OF BUILDING & INSPECTION SERVICES, PORTLAND, MAINE

The undersigned hereby applies for a permit to erect, alter, repair, demolish, move or install the following building, structure, equipment or change use in accordance with the Laws of the State of Maine, the Portland B.O.C.A. Building Code and Zoning Ordinance of the City of Portland with plans and specifications, if any, submitted herewith and the following specifications:

LOCATION 82 Christy Road Fire District #1 [] #2 []

1. Owner's name and address John Fox - same Telephone H797-8561

2. Lessee's name and address Telephone W 780-3330

3. Contractor's name and address Bob Oliver Pools - Rte # 4 Longfellow Dr. Telephone 839-6418

Proposed use of building above ground pool No. of sheets

Last use No. families

Material No. stories Heat Style of roof Roofing

Other buildings on same lot

Estimated contractual cost \$ 2,000 Appeal Fees \$

FIELD INSPECTOR—Mr. Base Fee 20.00

@ 775-5451 Late Fee

To install above ground pool, 24' diameter as per plans. 1 sheet of plans.

TOTAL \$ 20.00

send permit to # 31 04103

Stamp of Special Conditions

PERMIT ISSUED WITH LETTER

NOTE TO APPLICANT: Separate permits are required by the installers and subcontractors of heating, plumbing, electrical and mechanicals.

DETAILS OF NEW WORK

Is any plumbing involved in this work? no Is any electrical work involved in this work? yes

Is connection to be made to public sewer? If not, what is proposed for sewage?

Has septic tank notice been sent? Form notice sent?

Height average grade to top of plate Height average grade to highest point of roof

Size, front depth No. stories solid or filled land? earth or rock?

Material of foundation Thickness, top bottom cellar

Kind of roof Rise per foot Roof covering

No. of chimneys Material of chimneys of lining Kind of heat fuel

Framing Lumber—Kind Dressed or full size? Corner posts Sills

Size Girder Columns under girders Size Max. on centers

Studs (outside walls and carrying partitions) 2x4-16" O. C. Bridging in every floor and flat roof span over 8 feet.

Joists and rafters: 1st floor, 2nd, 3rd, roof

On centers: 1st floor, 2nd, 3rd, roof

Maximum span: 1st floor, 2nd, 3rd, roof

If one story building with masonry walls, thickness of walls? height?

IF A GARAGE

No. cars now accommodated on same lot to be accommodated number commercial cars to be accommodated

Will automobiles repairing be done other than minor repairs to cars habitually stored in the proposed building?

APPROVALS BY: DATE MISCELLANEOUS

BUILDING INSPECTION—PLAN EXAMINER Will work require disturbing of any tree on a public street? no

ZONING: OK Made 5/17/84

BUILDING CODE: J.W. 5/18/84 Will there be in charge of the above work a person competent

Fire Dept.: to see that the State and City requirements pertaining thereto

Health Dept.: are observed?

Others: Kevin W. Carroll, A.P.E.

Signature of Applicant John Fox Phone # same

Type Name of above John Fox 1 [] 2 [] 3 [] 4 []

Other and Address

FIELD INSPECTOR'S COPY APPLICANT'S COPY OFFICE FILE COPY

Handwritten signature: Hill

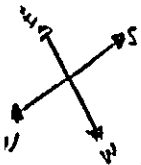

Christy Road

John C Fox
82 Christy Rd
Portland ME
Site plan of
24' Diameter Above
Ground Swimming Pool.

Driveway

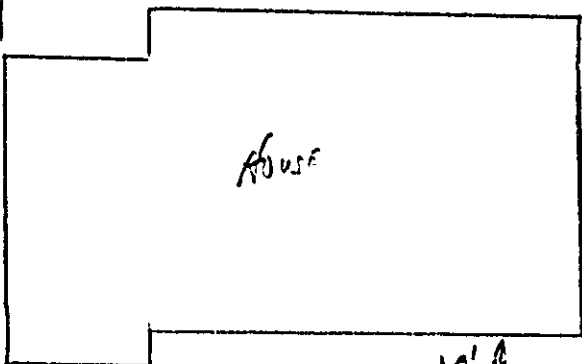

Metal
Shed

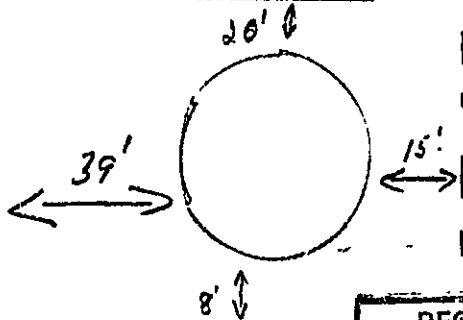

RECEIVED
MAY 17 1984
DEPT. OF BLDG. INSP
CITY OF PORTLAND



Sharkline

SEASPRAY-SHARKLINE, INC.
431 BAYVIEW AVENUE • AMITYVILLE, LI, NEW YORK 11701

ARISTOCRAT ROUND

24' dia. \$ 1406.00
Skummy 40.00

\$ 1446.00

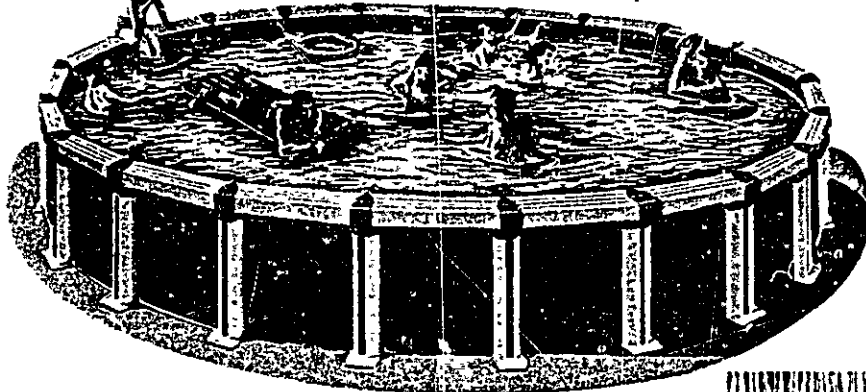

OPTIONAL WOOD-GRAIN
ALUMINUM WALL AVAILABLE
IN BLUE OR GREEN



RECEIVED
MAY 17 1984
DEPT. OF BLDG INSP
CITY OF PORTLAND

ROXBURY

15 Year
Limited Warranty
and Service Policy



CITY OF PORTLAND

JOSEPH E. GRAY, JR.
DIRECTOR OF PLANNING
AND URBAN DEVELOPMENT

May 25, 1984

John Fox
82 Christy Road
Portland, Maine 04103

Re: 82 Christy Road

Dear Mr. Fox:

Your permit to install a 24' ~~swimming~~ ^{above ground} pool at 82 Christy Road as per plans on file in this office, is being issued with the following requirement:

- (1) Section 627.9 Swimming pool safety devices: Every person owning land on which there is situated a swimming pool, which contains 24 inches or more of water depth at any point shall erect and maintain thereon an adequate enclosure either surrounding the property or pool area, sufficient to make such body of water inaccessible to small children. Such enclosure, including gates therein, must be not less than 4 feet above underlying ground. All gates must be self latching with latches placed 4 feet above underlying ground. All gates must be self latching with latches placed 4 feet above the underlying ground and otherwise made inaccessible from the outside to small children.

A natural barrier, hedge, pool cover or other protective device approved by the governing body may be used so long as the degree of protection afforded by the substituted devices or structures is not less than the protection afforded by the enclosure, gate and latch described herein.

- (2) Electrical and plumbing permits must be obtained.

If you have any questions on these requirements, please call this office.

Sincerely,

P. S. Hoffes
Chief of Inspection Services

KWC
CEO
A.P.E.

FSH/jmr



CITY OF PORTLAND

JOSEPH E. GRAY, JR.
DIRECTOR OF PLANNING
AND URBAN DEVELOPMENT

May 25, 1984

John Fox
82 Christy Road
Portland, Maine 04103

Re: 82 Christy Road

Dear Mr. Fox:

Your permit to install a 24' ^{above ground} ~~in-ground~~ pool at 82 Christy Road, as per plans on file in this office, is being issued with the following requirement:

- (1) Section 627.9 Swimming pool safety devices: Every person owning land on which there is situated a swimming pool, which contains 24 inches or more of water depth at any point shall erect and maintain thereon an adequate enclosure either surrounding the property or pool area, sufficient to make such body of water inaccessible to small children. Such enclosure, including gates therein, must be not less than 4 feet above underlying ground. All gates must be self latching with latches placed 4 feet above underlying ground. All gates must be self latching with latches placed 4 feet above the underlying ground and otherwise made inaccessible from the outside to small children.

A natural barrier, hedge, pool cover or other protective device approved by the governing body may be used so long as the degree of protection afforded by the substituted devices or structures is not less than the protection afforded by the enclosure, gate and latch described herein.

- (2) Electrical and plumbing permits must be obtained.

If you have any questions on these requirements, please call this office.

Sincerely,

P. S. Hoffnes
Chief of Inspection Services

PSH/jmr

KWC
CEO
A.P.E.

APPLICATION FOR PERMIT

PERMIT ISSUED

B.O.C.A. USE GROUP 573

MAY 25 1984

B.O.C.A. TYPE OF CONSTRUCTION

ZONING LOCATION R-7 PORTLAND, MAINE .. May 17, 1984.

CITY of PORTLAND

To the CHIEF OF BUILDING & INSPECTION SERVICES, PORTLAND, MAINE

The undersigned hereby applies for a permit to erect, alter, repair, demolish, move or install the following building, structure, equipment or change use in accordance with the Laws of the State of Maine, the Portland B.O.C.A. Building Code and Zoning Ordinance of the City of Portland with plans and specifications, if any, submitted herewith and the following specifications:

LOCATION 82 Christy Road Fire District #1 #2
 1. Owner's name and address John Fox - same Telephone #797-8561
 2. Lessee's name and address Telephone #780-3330
 3. Contractor's name and address Bob Oliver Pools - Rte. # 4 Longfellow Dr, Telephone .. 839-6418 ..
 Gorham No. of sheets
 Proposed use of building above ground pool No. families
 Last use No. families
 Material No. stories Heat Style of roof Roofing
 Other Buildings on same lot
 Estimated contractual cost \$.. 2,000 ..

FIELD INSPECTOR—Mr.
 @ 775-5451

Appeal Fees \$
 Base Fee 20.00
 Late Fee
 TOTAL \$ 20.00

To install above ground pool, 24' diameter as per plans. 1 sheet of plans.

send permit to # 71 04103

Stamp of Special Conditions
PERMIT ISSUED WITH LETTER

NOTE TO APPLICANT: Separate permits are required by the installers and subcontractors of heating, plumbing, electrical and mechanicals.

DETAILS OF NEW WORK

Is any plumbing involved in this work? no Is any electrical work involved in this work? no
 Is connection to be made to public sewer? If not, what is proposed for sewage?
 Has septic tank notice been sent? Form notice sent?
 Height average grade to top of plate Height average grade to highest point of roof
 Size, front depth No. stories solid or filled land? earth or rock?
 Material of foundation Thickness, top bottom cellar
 Kind of roof Rise per foot Roof covering
 No. of chimneys Material of chimneys of lining Kind of heat fuel
 Framing Lumber—Kind Dressed or full size? Corner posts Sills
 Size Girder Columns under girders Size Max. on centers
 Studs (outside walls and carrying partitions) 2x4-16" O. C. Bridging in every floor and flat roof span over 8 feet.
 Joists and rafters: 1st floor 2nd 3rd roof
 On centers: 1st floor 2nd 3rd roof
 Maximum span: 1st floor 2nd 3rd roof
 If one story building with masonry walls, thickness of walls? height?

IF A GARAGE

No. cars now accommodated on same lot to be accommodated number commercial cars to be accommodated
 Will automobile repairing be done other than minor repairs to cars habitually stored in the proposed building?

APPROVALS BY: DATE

MISCELLANEOUS

BUILDING INSPECTION—PLAN EXAMINER Will work require disturbing of any tree on a public street? no
 ZONING: John Fox
 BUILDING CODE: John Fox Will there be in charge of the above work a person competent to see that the State and City requirements pertaining thereto
 Fire Dept.: observed?
 Health Dept.:
 Others: John Fox
 Signature of Applicant John Fox Phone # same
 Type Name of above John Fox 1 2 3 4

Other
 and Address

FIELD INSPECTOR'S COPY APPLICANT'S COPY OFFICE FILE COPY

Handwritten signature

NOTES

8/24/84
Completed, ^{entire} finished
in as per code. J.H.

Permit No. 84/573
Location 82 Knight Road
Owner J.H.
Date of permit 5-17-84
Approved J-25-84
Dwelling
Garage
Alteration
Change ground post

Empty lined area for additional notes or drawings, with a large 'X' drawn across the right side.

NOTES

3/86 - Completed as per
plan. No insps called for
by owner

Permit No 86/186

Location 820 Canyon RD

Owner J. J. Gray

Date of Permit 2-20-86

Approved 2-25-86

Dwelling

Garage 1 Car attached

Alteration

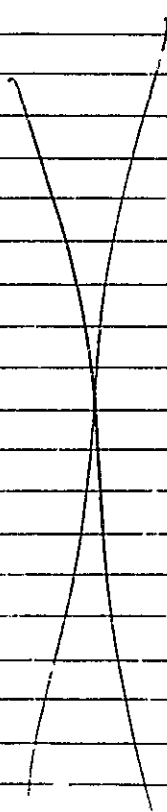

APPLICATION FOR PERMIT

PERMIT ISSUED

B.O.C.A. USE GROUP

B.O.C.A. TYPE OF CONSTRUCTION 00186

FEB 25 1986

ZONING LOCATION ... P-2 ... PORTLAND, MAINE ... Feb. 20, 1986

City Of Portland

To the CHIEF OF BUILDING & INSPECTION SERVICES, PORTLAND MAINE

The undersigned hereby applies for a permit to erect, alter, repair, demolish, move or install the following building, structure, equipment or change use in accordance with the Laws of the State of Maine, the Portland B.O.C.A. Building Code and Zoning Ordinance of the City of Portland with plans and specifications as submitted herewith and the following specifications.

LOCATION ... 82 Christy Road ... Fire District #1 , #2

1. Owner's name and address ... John Fox - same ... Telephone ... 797-8561

2. Lessee's name and address ... Telephone ...

3. Contractor's name and address ... Owner ... Telephone ...

Proposed use of building ... 1 car attached garage ... No. of sheets ...

Last use ... No families ...

Material ... No. stories ... Heat ... Style of roof ... Roofing ...

Other buildings on same lot ...

Estimated contractual cost \$... 6,000... Appeal Fees \$...

FIELD INSPECTOR—Mr. ... Base Fee ... 50.00 ...

@ 775-5451

Late Fee ...

TOTAL \$...

To construct 1 car attached garage, 14' x 24' approximate size as per plans. 3 sheets of plans.

04103

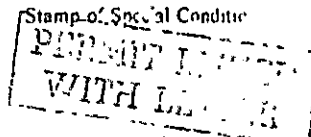

NOTE TO APPLICANT: Separate permits are required by the installers and subcontractors of heating, plumbing, electrical and mechanicals.

DETAILS OF NEW WORK

Is any plumbing involved in this work? ... no ... Is any electrical work involved in this work? ... yes ...

Is connection to be made to public sewer? ... If not, what is proposed for disposal? ...

Has septic tank notice been sent? ... Form notice sent? ...

Height average grade to top of plate ... Height average grade to highest point of roof ...

Size, front ... depth ... No. stories ... solid or filled land? ... earth or rock? ...

Material of foundation ... Thickness, top ... bottom ... cellar ...

Kind of roof ... Rise per foot ... Roof covering ...

No. of chimneys ... Material of chimneys ... of lining ... Kind of heat ... fuel ...

Framing Lumber—Kind ... Dressed or full size? ... Corner posts ... Sills ...

Size Girder ... Columns under girders ... Size ... Max. on centers ...

Studs (outside walls and carrying partitions) 2x4 16" O.C. Bridging in every floor and flat roof span over 8 feet.

Joists and rafters 1st floor ... 2nd ... 3rd ... roof ...

On centers 1st floor ... 2nd ... 3rd ... roof ...

Maximum span 1st floor ... 2nd ... 3rd ... roof ...

If one story building with masonry walls thickness of walls? ... height? ...

IF A GARAGE

No. cars now accommodated on same lot ... to be accommodated ... number commercial cars to be accommodated ...

Will automobile repairing be done other than minor repairs to cars habitually stored in the proposed building? ...

APPROVALS BY: DATE

MISCELLANEOUS

BUILDING INSPECTION—PLAN EXAMINER ... Will work require disturbing of any tree on a public street? ... no

ZONING, D.K. 2/9/86 ... 2/24/86 ...

BUILDING CODE? ... Will there be in charge of the above work a person competent

Fire Dept. ... to see that the State and City requirements pertaining thereto

Health Dept. ... are observed? ... yes ...

Others ...

Signature of Applicant

[Handwritten signature]

office 780-3330

Phone # same

Type Name of above

John Fox

1 2 3 4

Other ... and Address ...



FIELD INSPECTOR'S COPY

APPLICANT'S COPY

OFFICE FILE COPY

4 MAR. 1986



CITY OF PORTLAND

DEPARTMENT OF PLANNING & URBAN DEVELOPMENT
INSPECTION SERVICES DIVISION

February 25, 1986

RE: 82 Christy Road

Mr. John Fox
82 Christy Road
Portland, Maine 04103

Dear Sir:

Your application to construct a 1 car attached garage 14' X 24' has been reviewed and a building permit is herewith issued subject to the following requirements:

Building Code Requirements

1. All lot lines shall be clearly marked before calling for a foundation inspection;
2. All concrete and the earth below the foundation and slab shall be protected from freezing;
3. The 2" X 6" rafters must be changed to a 2" X 8" because of such a large span; and,
4. Attached private garages shall be completely separated from the adjacent interior spaces and the attic area by means of 1/2 inch gypsum board or equivalent applied to the garage side. The sills of all door openings between the garage and adjacent interior spaces shall be raised not less than 4 inches above the garage floor. The door opening protectives shall be 1-3/4 inch solid core wood door or approved equivalent.

Sincerely,

P. Samuel Hoffses
Chief of Inspection Services

PSH/el

Applicant: *John C. Fox* Date: *Feb. 20, 1985*
Address: *52 Christy Road* 777-8561
Assessors No.: *381-A-9*

CHECK LIST AGAINST ZONING ORDINANCE

- Date -
- Zone Location - *R-2*
- Interior or corner lot -
- Use -
- Sewage Disposal -
- Rear Yards -
- Side Yards -
- Front Yards -
- Projections -
- Height -
- Lot Area - *9,809 sq ft.*
- Building Area -
- Area per Family -
- Width of Lot -
- Lot Frontage -
- Off-street Parking -
- Loading Ways -

- Site Plan -
- Shoreland Zoning -
- Flood Plains -

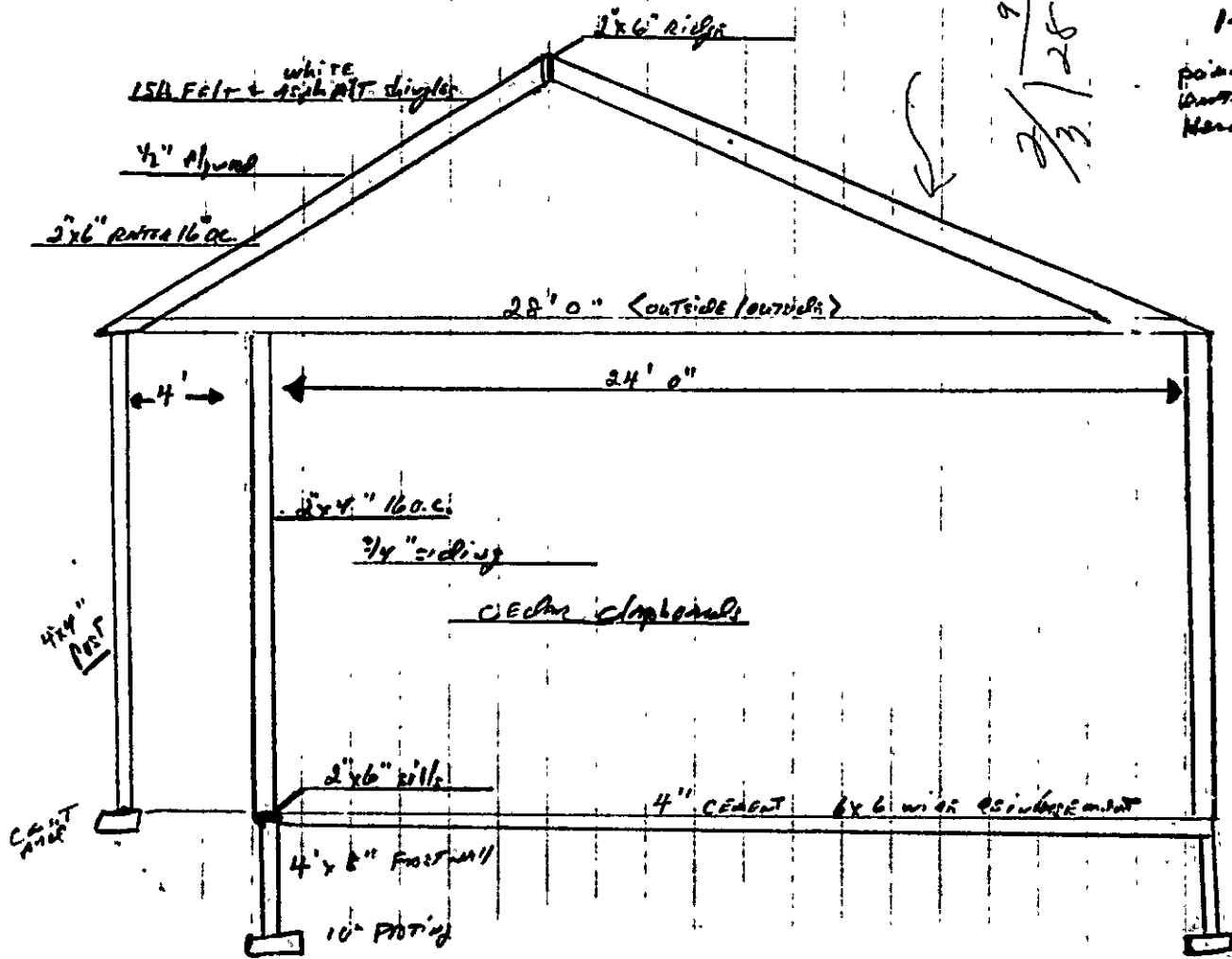

1- 9' wide garage door
 2- 22" windows side
 1- 30' door REAR L.S.
 pointing construction 2x4"
 windows & doors 2x6"
 handrail 2x8" double

2/3/86

RECEIVED

FEB 20 1986
 DEPT OF BUILDING INSPECTIONS
 CITY OF PORTLAND

FEB-20, 1986

City of Portland
Office of Building Permits
Portland, Maine

RECEIVED

FEB 20 1986

GENTLEMEN:

DEPT OF BUILDING INSPECTIONS
CITY OF PORTLAND

Attached is my site plan and construction plan for a 1 car garage that I would like to build attached to my residence at 82 Christy Road.

In accordance with the city's building permit procedure and as provided for in SECTION 14-432(2) please issue a building permit and a side lot variance of 6' feet. This side lot variance would allow me to construct so that I would be 8' from the property line.

I will be doing this construction and the total cost including foundation etc should be approximately \$6,000.00.

Thank you for your consideration

Sincerely
John C. ...
82 Christy Road
797-8561

APPLICATION FOR PERMIT

PERMIT ISSUED

B.O.C.A. USE GROUP

FEB 25 1986

B.O.C.A. TYPE OF CONSTRUCTION 00186

ZONING LOCATION ... P-2 ... PORTLAND, MAINE .. Feb. 20, 1986

City Of Portland

To the CHIEF OF BUILDING & INSPECTION SERVICES, PORTLAND, MAINE

The undersigned hereby applies for a permit to erect, alter, repair, demolish, move or install the following building, structure, equipment or change use in accordance with the Laws of the State of Maine, the Portland B.O.C.A. Building Code and Zoning Ordinance of the City of Portland with plans and specifications, if any, submitted herewith and the following specifications:

LOCATION 82 Christy Road Fire District #1 , #2

1. Owner's name and address ... John Fox - same Telephone 797-8561

2. Lessee's name and address Telephone

3. Contractor's name and address .. Owner Telephone

..... No. of sheets

Proposed use of building ... 1 car attached garage No. families

Last use No. families

Material No. stories Heat Style of roof Roofing

Other buildings on same lot

Estimated contractual cost \$... 6,000....

FIELD INSPECTOR—Mr. Appeal Fees \$

@ 775-5451

Base Fee .. 50.00

Late Fee

TOTAL \$

To construct 1 car attached garage, 14' x 24' approximate size as per plans. 3 sheets of plans.

04103

Stamp of Special Conditions PERMIT ISSUED WITH LETTER

NOTE TO APPLICANT: Separate permits are required by the installers and subcontractors of heating, plumbing, electrical and mechanicals.

DETAILS OF NEW WORK

Is any plumbing involved in this work? ... no Is any electrical work involved in this work? yes...

Is connection to be made to public sewer? If not, what is proposed for sewage?

Has septic tank notice been sent? Form notice sent?

Height average grade to top of plate Height average grade to highest point of roof

Size, front depth No. stories solid or filled land? earth or rock?

Material of foundation Thickness, top bottom cellar

Kind of roof Rise per foot Roof covering

No. of chimneys Material of chimneys of lining Kind of heat fuel

Framing Lumber—Kind Dressed or full size? Corner posts Sills

Size Girder Columns under girders Size Max. of centers

Studs (outside walls and carrying partitions) 2x4-16" O. C. Bridging in every floor and flat roof span over 8 feet.

Joists and rafters: 1st floor 2nd 3rd roof

On centers: 1st floor 2nd 3rd roof

Maximum span: 1st floor 2nd 3rd roof

If one story building with masonry walls, thickness of walls? height?

IF A GARAGE

No. cars now accommodated on same lot to be accommodated number commercial cars to be accommodated

Will automobile repairing be done other than minor repairs to cars habitually stored in the proposed building?

APPROVALS BY: DATE

MISCELLANEOUS

BUILDING INSPECTION—PLAN EXAMINER

Will work require disturbing of any tree on a public street? ... no

ZONING: O.K. No. 2/24/86

Will there be in charge of the above work a person competent to see that the State and City requirements pertaining thereto are observed? ... yes...

BUILDING CODE:

Fire Dept.:

Health Dept.:

Others:

Signature of Applicant

office 780-3330

Phone # same

Type Name of above

John Fox

1 2 3 4

Other

and Address

PERMIT ISSUED WITH LETTER

FIELD INSPECTOR'S COPY

OFFICE FILE COPY

4 MA, IAWING

NOTES

3/86 - Completed as per
plan No maps called for
by owner

Permit No. 861116

Location

Owner

Date of Permit

Approved

Dwelling

Garage

Alteration

1 car attached

2-25-86

2-20-86

John J. [unclear]

[unclear]



APPLICATION FOR PERMIT
DEPARTMENT OF BUILDING INSPECTIONS SERVICES
ELECTRICAL INSTALLATIONS

Date June 13 86
 Receipt and Permit number 9-28993

To the CHIEF ELECTRICAL INSPECTOR, Portland, Maine

The undersigned hereby applies for a permit to make electrical installations in accordance with the laws of Maine, the Portland Electrical Ordinance, the National Electrical Code and the following specifications:

LOCATION OF WORK: 82 Christy Road
 OWNER'S NAME: John Fox ADDRESS: lives there

	FEE\$
OUTLETS:	
Receptacles _____ Switches _____ Plugmold _____ ft. TOTAL <u>1-30</u>	<u>3.00</u>
FIXTURES: (number of)	
Incan/lescent _____ Flourescent _____ (not strip) TOTAL	
Strip Flourescent _____ ft.	
SERVICES:	
Overhead _____ Underground _____ Temporary _____ TOTAL amperes ..	
METERS: (number of)	
MOTORS: (number of)	
Fractional	
1 HP or over	
RESIDENTIAL HEATING:	
Oil or Gas (number of units)	
Electric (number of rooms)	
COMMERCIAL OR INDUSTRIAL HEATING:	
Oil or Gas (by a main boiler)	
Oil or Gas (by separate units)	
Electric Under 20 kvs _____ Over 20 kws	
APPLIANCES: (number of)	
Ranges _____ Water Heaters _____	
Cook Tops _____ Disposals _____	
Wall Ovens _____ Dishwashers _____	
Dryers _____ Compactors _____	
Fans _____ Others (denote) _____	
TOTAL	
MISCELLANEOUS: (number of)	
Branch Panels	
Transformers	
Air Conditioners Central Unit	
Separate Units (windows)	
Signs 20 sq. ft. and under	
Over 20 sq. ft.	
Swimming Pools Above Ground	
In Ground	
Fire/Burglar Alarms Residential	
Commercial	
Heavy Duty Outlets, 220 Volt (such as welders) 30 amps and under	
over 30 amps	
Circus, Fairs, etc.	
Alterations to wires	
Repairs after fire	
Emergency Lights, battery	
Emergency Generators	
FOR ADDITIONAL WORK NOT ON ORIGINAL F	INSTALLATION FEE DUE:
FOR REMOVAL OF A "STOP ORDER" (304-16.b)	DOUBLE FEE DUE:
	<u>3.00</u>
	TOTAL AMOUNT DUE:
	<u>5.00</u>

INSPECTION:
 Will be ready on John Fox, 1986; or Will Call XX
CONTRACTOR'S NAME: same
ADDRESS: 797-8561
TEL.: Home owner **SIGNATURE OF CONTRACTOR:** [Signature]
MASTER LICENSE NO.: _____
LIMITED LICENSE NO.: _____

INSPECTOR'S COPY — WHITE

