

49 AUTUMN LANE

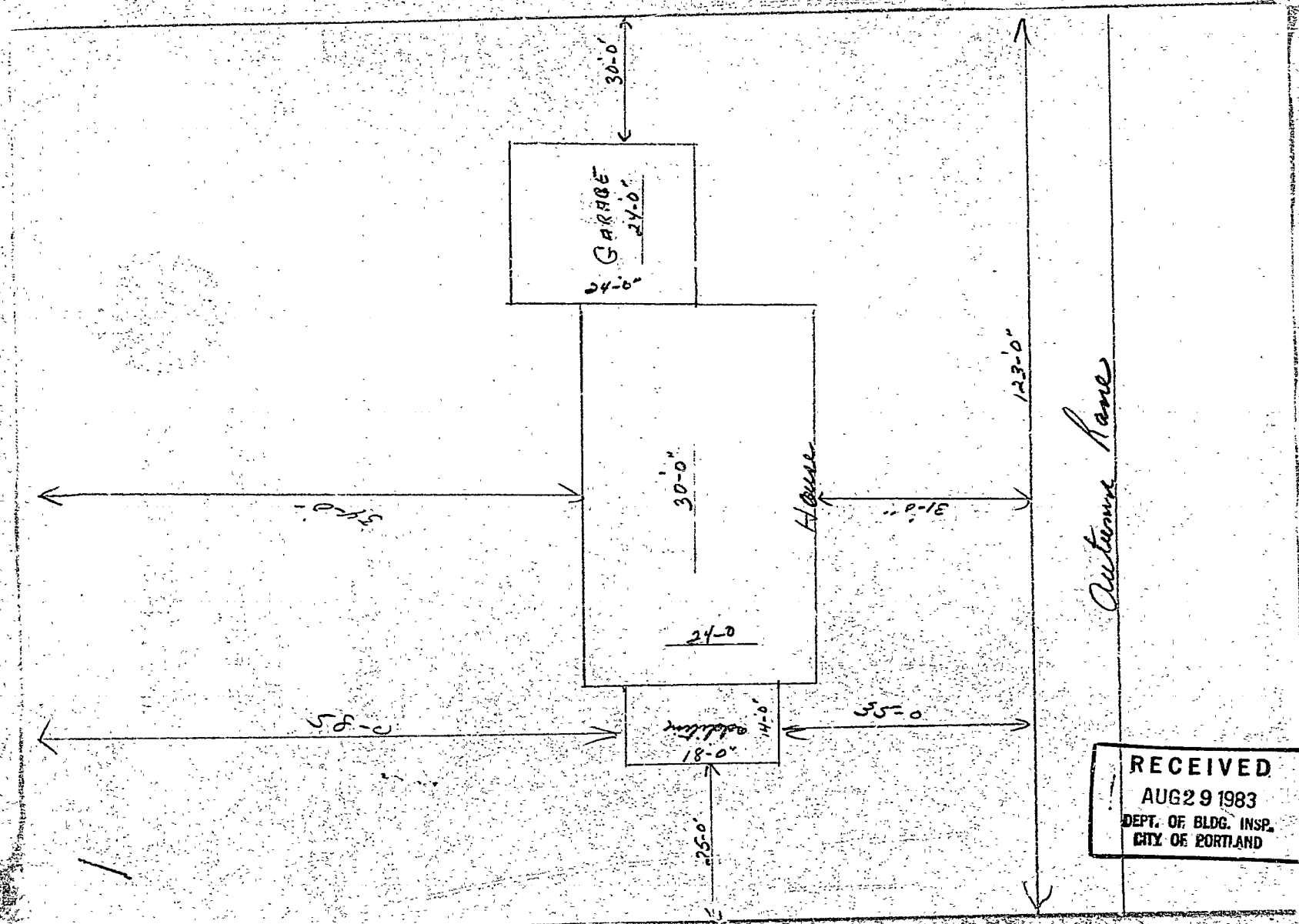

Customs Lane

RECEIVED
 AUG 29 1983
 DEPT. OF BLDG. INSP.
 CITY OF PORTLAND



CITY OF PORTLAND

JOSEPH E. GRAY, JR.
DIRECTOR OF PLANNING & URBAN DEVELOPMENT

August 18, 1983

With reference to the rehabilitation work which is to be done on the property of which you are a resident, will you kindly complete the enclosed Tenant Information Form and return it to us in the enclosed self-addressed stamped envelope as soon as possible.

Thank you.

Very truly yours,

Russell O. Pearce
RUSSELL O. PEARCE,
REHABILITATION ADMINISTRATOR

ROP/mlb

ENC.

off. -
Printed
Route 3

APPLICATION FOR PERMIT

B.O.C.A. USE GROUP
B.O.C.A. TYPE OF CONSTRUCTION 00890
ZONING LOCATION .. R-3 PORTLAND, MAINE August 29, 1983

PERMIT ISSUED

AUG 30 1983

To the CHIEF OF BUILDING & INSPECTION SERVICES, PORTLAND, MAINE

CITY of PORTLAND

The undersigned hereby applies for a permit to erect, alter, repair, demolish, move or install the following building, structure, equipment or change use in accordance with the Laws of the State of Maine, the Portland B.O.C.A. Building Code and Zoning Ordinance of the City of Portland with plans and specifications, if any, submitted herewith and the following specifications:

LOCATION 49 Autumn Lane
1. Owner's name and address Philip Dawson - same Fire District #1 #2
Telephone 797-4741
2. Lessee's name and address Telephone
3. Contractor's name and address Roger Vaillancourt - 385 Methodist St. Rd. Telephone 854-8870
Westbrook
Proposed use of building dwelling with addition No. of sheets
Last use No. families 1
Material No. stories Heat Style of roof Roofing
Other buildings on same lot
Estimated contractual cost \$ 6,800

FIELD INSPECTOR—Mr. @ 775-5451

Appeal Fees \$
Base Fee 45.00
Late Fee
TOTAL \$ 45.00

To construct 14' x 18' 1 story addition to already existing dwelling, family room, as per plans. 1 sheet of plans.

Stamp of Special Conditions

send permit to # 1 04103

NOTE TO APPLICANT: Separate permits are required by the installers and subcontractors of heating, plumbing, electrical and mechanicals.

DETAILS OF NEW WORK

Is any plumbing involved in this work? NO Is any electrical work involved in this work? YES
Is connection to be made to public sewer? If not, what is proposed for sewage?
Has septic tank notice been sent? Form notice sent?
Height average grade to top of plate Height average grade to highest point of roof
Size, front depth No. stories solid or filled land? earth or rock?
Material of foundation Thickness, top bottom cellar
Kind of roof Rise per foot Roof covering
No. of chimneys Material of chimneys of lining Kind of heat fuel
Framing Lumber—Kind Dressed or full size? Corner posts Sills
Size Girder Columns under girders Size Max. on centers
Studs (outside walls and carrying partitions) 2x4-16" O. C. Bridging in every floor and flat roof span over 8 feet.
Joists and rafters: 1st floor , 2nd , 3rd , roof
On centers: 1st floor , 2nd , 3rd , roof
Maximum span: 1st floor , 2nd , 3rd , roof
If one story building with masonry walls, thickness of walls? height?

IF A GARAGE

No. cars now accommodated on same lot , to be accommodated number commercial cars to be accommodated
Will automobile repairing be done other than minor repairs to cars habitually stored in the proposed building?

APPROVALS BY: DATE MISCELLANEOUS
BUILDING INSPECTION—PLAN EXAMINER Will work require disturbing of any tree on a public street? NO
ZONING: *OK M.A.W. 8/29/83*
BUILDING CODE: Will there be in charge of the above work a person competent
Fire Dept.: to see that the State and City requirements pertaining thereto
Health Dept.: are observed? yes.....
Others:

Signature of Applicant *Roger Vaillancourt* Phone # *same*
Type Name of above Roger Vaillancourt for 1 2 3 4
Philip Dawson Other
and Address

FIELD INSPECTOR'S COPY APPLICANT'S COPY OFFICE FILE COPY

[4] MR. IRVING

Oct
10/31/82

NOTES

All work on the addition completed - walls & siding with out a plumbing approval or electrical approval. No foundation inspections called for etc.

Due to excessive work load of general jobs combined into one I have been unable to keep up with the year building permits. No finish or paint on the dry wall - to be completed in the year future.

Permit no. 89/899

Location 19 [unclear] Street

Owner G. [unclear] [unclear]

Date of permit 8-12-83

Approved 8-30-83

Dwelling - [unclear]

Garage - [unclear]

Alteration [unclear]

3949 AUTUMN LANE

ELECTRICAL INSTALLATIONS —

Permit Number 79785

Location 39 AUTUMN LAKE

Owner DONALD SLIPP

Date of Permit OCTOBER 5, '82

Final Inspection NO ACCES

By Inspector Tully

Permit Application Register Page No. 129

INSPECTIONS:	Service	by
	Service called in	by
	Closing-in	by

PROGRESS INSPECTIONS:	DATE	BY
	<u>10-20-82</u>	<u>NOTH</u>
	<u>11-19-82</u>	<u>NOTH</u>
	<u>12-21-82</u>	<u>NOTH</u>

CODE COMPLIANCE COMPLETED
DATE 10/20/82
BY SL

REMARKS:

Vertical lines for remarks.

3949 AUTUMN LANE



APPLICATION FOR PERMIT

PERMIT ISSUED

B.O.C.A. USE GROUP 0234
B.O.C.A. TYPE OF CONSTRUCTION

MAR 26 1984

ZONING LOCATION PORTLAND, MAINE March 21, 1984

CITY of PORTLAND

To the CHIEF OF BUILDING & INSPECTION SERVICES, PORTLAND, MAINE

The undersigned hereby applies for a permit to erect, alter, repair, demolish, move or install the following building, structure, equipment or change use in accordance with the Laws of the State of Maine, the Portland B.O.C.A. Building Code and Zoning Ordinance of the City of Portland with plans and specifications, if any, submitted herewith and the following specifications:

LOCATION 39 Autumn Lane Fire District #1 [] #2 []
1. Owner's name and address Donald R. Slipp Telephone 797-2048
2. Lessee's name and address Telephone
3. Contractor's name and address Portland Vocational Tech. 196 Allen Ave. Telephone 797-8440
Proposed use of building No. of sheets
Last use No. families
Material No. stories Heat Style of roof Roofing
Other buildings on same lot
Estimated structural cost: \$500.00
FIELD INSPECTOR—Mr. @ 775-5451
Appeal Fees \$
Base Fee
Late Fee
To erect storage shed, 6' x 8', rear of lot, as per plan. TOTAL \$ 15.00

ISSUE PERMIT TO #1

Stamp of Special Conditions

NOTE TO APPLICANT: Separate permits are required by the installers and subcontractors of heating, plumbing, electrical and mechanicals.

DETAILS OF NEW WORK

Is any plumbing involved in this work? Is any electrical work involved in this work?
Is connection to be made to public sewer? If not, what is proposed for sewage?
Has septic tank notice been sent? Form notice sent?
Height average grade to top of plate Height average grade to highest point of roof
Size, front depth No. stories solid or filled land? earth or rock?
Material of foundation Thickness top bottom cellar
Kind of roof Rise per foot Roof covering
No. of chimneys Material of chimneys of lining Kind of heat fuel
Framing Lumber—Kind Dressed or size? Corner posts Sills
Size Girder Columns under girders Size Max. on centers
Studs (outside walls and carrying partitions) 2x4-16" O. C. Bridging in every floor and flat roof span over 8 feet.
Joists and rafters: 1st floor 2nd 3rd roof
On centers: 1st floor 2nd 3rd roof
Maximum span: 1st floor 2nd 3rd roof
If one story building with masonry walls, thickness of walls? height?

IF A GARAGE

No. cars now accommodated on same lot to be accommodated number commercial cars to be accommodated
Will automobile repairing be done other than minor repairs to cars habitually stored in the proposed building?

APPROVALS BY: DATE MISCELLANEOUS
BUILDING INSPECTION—PLAN EXAMINER Will work require felling of any tree on a public street?
ZONING:
BUILDING CODE: Will there be in charge of the above work a person competent
Fire Dept. to see that the State and City requirements pertaining thereto
Health Dept. are observed? YES
Others:

Signature of Applicant Donald R. Slipp Phone #
Type Name of above Donald R. Slipp [] 2 [] 3 [] 4 []
Other
and Address

FIELD INSPECTOR'S COPY APPLICANT'S COPY OFFICE FILE COPY

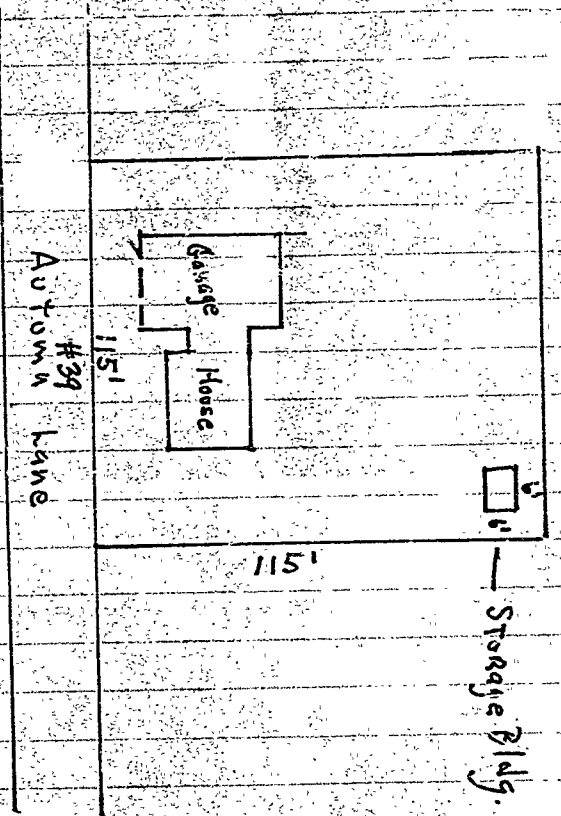

RECEIVED
MAR 2 1 1984
DEPT. OF BLDG. INSP.
CITY OF PORTLAND

Donald B. Slipp

APPLICATION FOR PERMIT

PERMIT ISSUED

B.O.C.A. USE GROUP 7

B.O.C.A. TYPE OF CONSTRUCTION 0234

ZONING LOCATION R-2 PORTLAND, MAINE March 21, 1984

MAR 25 1984

CITY OF PORTLAND

To the CHIEF OF BUILDING & INSPECTION SERVICES, PORTLAND, MAINE

The undersigned hereby applies for a permit to erect, alter, repair, demolish, move or install the following building, structure, equipment or change use in accordance with the Laws of the State of Maine, the Portland B.O.C.A. Building Code and Zoning Ordinance of the City of Portland with plans and specifications, if any, submitted herewith and the following specifications:

1. LOCATION 39 Autumn Lane Fire District #1 [] #2 []

1. Owner's name and address Donald R. Slipp - same Telephone 797-2048

2. Lessee's name and address Telephone 04103

3. Contractor's name and address Portland Vocational Tech. 196 Alien Ave Telephone 797-8440

No. of sheets

Proposed use of building No. families

Last use No. families

Material No. stories Heat Style of roof Roofing

Other buildings on same lot

Estimated contractual cost \$600.00 Appeal Fees \$

FIELD INSPECTOR - Mr. Davin @ 775-5451 Base Fee

Late Fee

To erect storage shed, 8' x 8', rear of lot, as per plan. TOTAL \$ 15.00

ISSUE PERMIT TO #1

Stamp of Special Conditions

NOTE TO APPLICANT: Separate permits are required by the installers and subcontractors of heating, plumbing, electrical and mechanicals.

DETAILS OF NEW WORK

Is any plumbing involved in this work? Is any electrical work involved in this work?
No connection to be made to public sewer? If not, what is proposed for sewage?
Has septic tank notice been sent? Form notice sent?
Height average grade to top of plate Height average grade to highest point of roof
Size, front depth No. stories solid or filled land? earth or rock?
Material of foundation Thickness, top bottom cellar
Kind of roof Rise per foot Roof covering
No. of chimneys Material of chimneys of lining Kind of heat fuel
Framing Lumber - kind Dressed or full size? Corner posts Sills
Size Girder Columns under girders Size Max. on centers
Studs (outside walls and carrying partitions) 2x4-16" O. C. Bridging in every floor and flat roof span over 8 feet.
Joists and rafters: 1st floor 2nd 3rd roof
On centers: 1st floor 2nd 3rd roof
Maximum span: 1st floor 2nd 3rd roof
If one story building with masonry walls, thickness of walls? height?

IF A GARAGE

No. cars now accommodated on same lot, to be accommodated number commercial cars to be accommodated
Will automobile repairing be done other than minor repairs to cars habitually stored in the proposed building?

APPROVALS BY: DATE MISCELLANEOUS
BUILDING INSPECTION - PLANNING EXAMINER Will work require disturbing of any tree on a public street?
ZONING: O.N. Slipp
BUILDING CODE: Will there be in charge of the above work a person competent
Fire Dept. to see that the State and City requirements pertaining thereto
Health Dept. are observed? yes
Others:

Signature of Applicant Donald R. Slipp Phone #

Type Name of above Donald R. Slipp 1 [x] 2 [] 3 [] 4 []
Other and Address

FIELD INSPECTOR'S COPY APPLICANT'S COPY OFFICE FILE COPY
Dav 11/11/84

Permit No. 02334

Location 39 Williams Ln

Owner Donald R. Slipp

Date of permit March 1/84

Approved WHP 3/6/84

Dwelling

Garage

Alteration

NOTES.

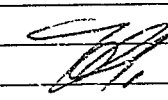
4/20/84
Shed in place
operation ok

<p>Blank lined area for notes.</p>	<p>Blank lined area for notes, crossed out with a large X.</p>
------------------------------------	--