

166-170 CHRISTY ROAD July 41

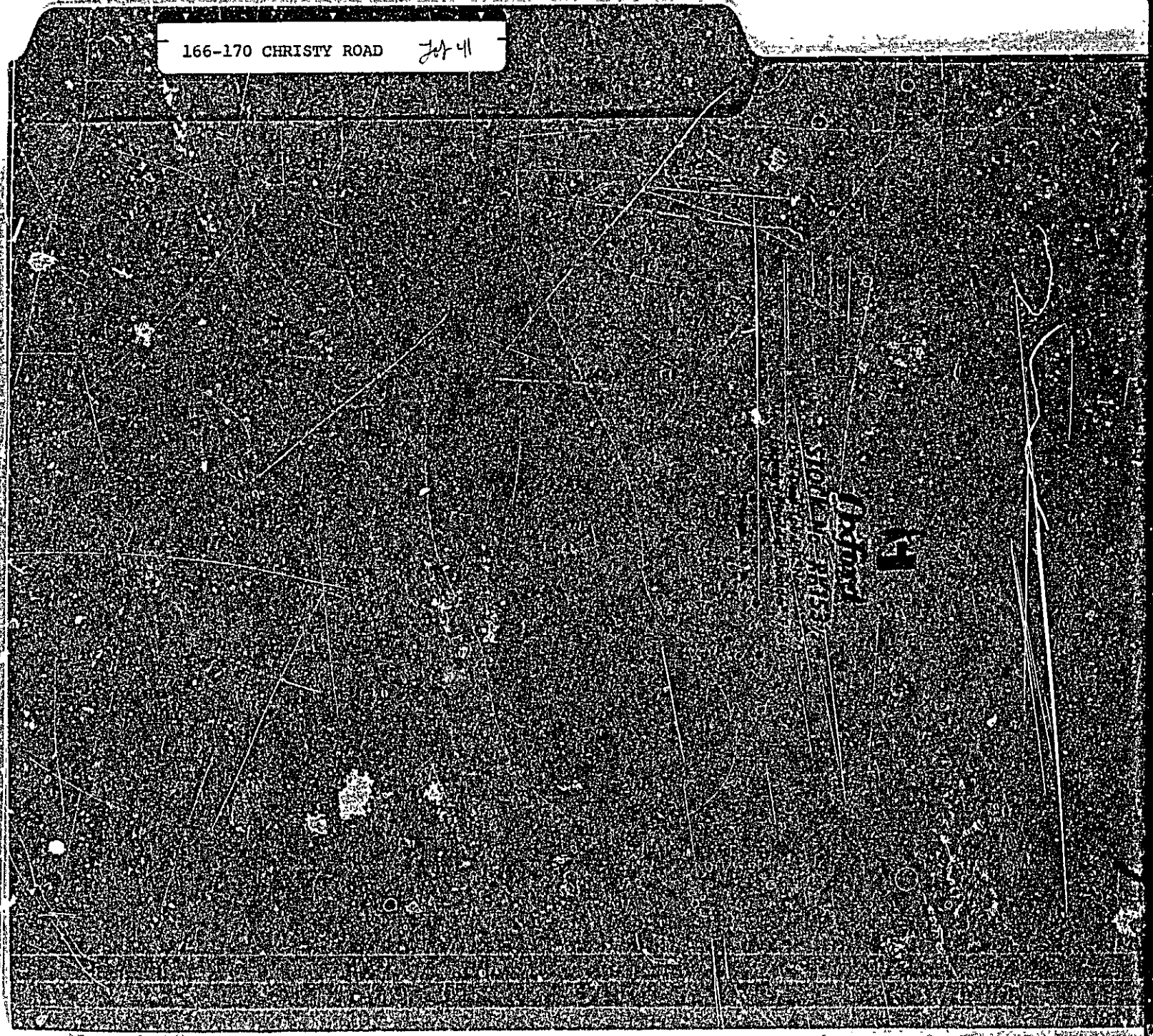

Optima
1000
10000



APPLICATION FOR PERMIT

DEPARTMENT OF BUILDING INSPECTIONS SERVICES

ELECTRICAL INSTALLATIONS

Date May 18, 19 77
 Receipt and Permit number A09972

To the CHIEF ELECTRICAL INSPECTOR, Portland, Maine:
 The undersigned hereby applies for a permit to make electrical installations in accordance with the laws of Maine, the Portland Electrical Ordinance, the National Electrical Code and the following specifications:
 LOCATION OF WORK: Lot # 41 Christy Rd.
 OWNER'S NAME: Christy & Small ADDRESS: 247 Allen Ave.

OUTLETS: (number of) 80 FEES

Light	_____	
Receptacles	_____	
Switches	_____	
Plugmold	_____ (number of feet)	<u>7.00</u>
TOTAL	_____	

FIXTURES: (number of)

Incandescent	_____	
Fluorescent	_____ (Do not include strip fluorescent)	
TOTAL	_____	
Strip Fluorescent, in feet	_____	<u>3.00</u>

SERVICES:

Permanent, total amperes	<u>200</u>	
Temporary	_____	<u>.50</u>

METERS: (number of) 1

MOTORS: (number of)

Fractional	_____	
1 HP or over	_____	

RESIDENTIAL HEATING:

Oil or Gas (number of units)	_____	
Electric (number of rooms)	<u>11</u>	<u>11.00</u>

COMMERCIAL OR INDUSTRIAL HEATING:

Oil or Gas (by a main boiler)	_____	
Oil or Gas (by separate units)	_____	
Electric (total number of kws)	_____	

APPLIANCES: (number of)

Ranges	_____ <u>x</u>	Water Heaters	_____ <u>x</u>
Cook Tops	_____ <u>x</u>	Disposals	_____ <u>x</u>
Wall Ovens	_____ <u>x</u>	Dishwashers	_____
Dryers	_____	Compactors	_____
Fans	_____	Others (denote)	_____
TOTAL	_____		<u>9.00</u>

MISCELLANEOUS: (number of)

Branch Panels	_____	
Transformers	_____	
Air Conditioners	_____	
Signs	_____	
Fire/Burglar Alarms	_____	
Circus, Fairs, etc.	_____	
Alterations to wires	_____	
Repairs after fire	_____	
Heavy Duty, 220v outlets	_____	
Emergency Lights, battery	_____	
Emergency Generators	_____	

FOR ADDITIONAL WORK NOT ON ORIGINAL PERMIT
 FOR REMOVAL OF A "STOP ORDER" (304-16.b)
 FOR PERFORMING WORK WITHOUT A PERMIT (304-9)
 INSTALLATION FEE DUE: _____
 DOUBLE FEE DUE: _____
 TOTAL AMOUNT DUE: 30.50

INSPECTION: Will be ready on 5-18, 1977, or Will Call _____
 CONTRACTOR'S NAME: Mancini Electric
 ADDRESS: 179 Sheridan St.
 TEL.: 774-5879
 MASTER LICENSE NO.: 2436
 LIMITED LICENSE NO.: _____

SIGNATURE OF CONTRACTOR: [Signature]

INSPECTOR'S COPY

ELECTRICAL INSTALLATIONS -

Permit Number 0972
Location Lot 41 Christy Road
Owner Christy
Date of Permit 5-18-77
Final Inspection
By Inspector
Permit Application Register Page No. 98

INSPECTIONS: Service V by HERBERT
Service called in 6-17-77
Closing-in 5-18-77 by Herbert

PROGRESS INSPECTIONS: 5-23-77 / 5-26-77 /

CODE
COMPLIANCE
COMPLETED
DATE 7-25-77

DATE:	REMARKS:

Handwritten notes at bottom center, including a signature and some illegible text.



CITY OF PORTLAND, MAINE
Department of Building Inspection

Certificate of Occupancy

LOCATION ¹⁶⁶⁻¹⁷⁰
~~Lot #41~~ Christy Road

Issued to Christy & Small

Date of Issue August 5, 1977

This is to certify that the building, premises, or part thereof, at the above location, built—altered—changed as to use under Building Permit No. 77/173, has had final inspection, has been found to conform substantially to requirements of Zoning Ordinance and Building Code of the City, and is hereby approved for occupancy or use, limited or otherwise, as indicated below.

PORTION OF BUILDING OR PREMISES

APPROVED OCCUPANCY

Entire

Single Family Dwelling

Limiting Conditions

This certificate supersedes
certificate issued

Approved:

8/6/77

(Date)

Inspector

Inspector of Building

Notice: This certifi- identifies lawful use of building or premises, and ought to be transferred from owner to owner when property changes hands. Copy will be furnished to owner or lessee for one dollar.

166-170
EST. 421, Christy POBA

March 11, 1977

~~CONFIDENTIAL~~
~~ALL INFORMATION CONTAINED~~
~~HEREIN IS UNCLASSIFIED~~

~~DATE 01/01/81 BY 60322~~

~~EXCEPT WHERE SHOWN OTHERWISE, ALL INFORMATION CONTAINED~~
~~HEREIN IS UNCLASSIFIED DATE 01/01/81 BY 60322~~

~~EXCEPT WHERE SHOWN OTHERWISE, ALL INFORMATION CONTAINED~~
~~HEREIN IS UNCLASSIFIED DATE 01/01/81 BY 60322~~

~~EXCEPT WHERE SHOWN OTHERWISE, ALL INFORMATION CONTAINED~~
~~HEREIN IS UNCLASSIFIED DATE 01/01/81 BY 60322~~

~~CONFIDENTIAL~~

~~CONFIDENTIAL~~

~~CONFIDENTIAL~~



APPLICATION FOR PERMIT

PERMIT ISSUED

APR 5 1977

B.O.C.A. USF GROUP
B.O.C.A. TYPE OF CONSTRUCTION
ZONING LOCATION R-2 PORTLAND, MAINE, Mar..21,..1977

CITY of PORTLAND

To the DIRECTOR OF BUILDING & INSPECTION SERVICES, PORTLAND, MAINE

The undersigned hereby applies for a permit to erect, alter, repair, demolish, move or install the following building, structure, equipment or change use in accordance with the Laws of the State of Maine, the Portland B.O.C.A. Building Code and Zoning Ordinance of the City of Portland with plans and specifications, if any, submitted herewith and the following specifications:

LOCATION 166-170 Christy Rd. Fire District #1 #2

1. Owner's name and address Christy & Small 24 Allen Ave. Telephone 797-3444

2. Lessee's name and address

3. Contractor's name and address same Telephone

4. Architect

Proposed use of building dwelling Specifications Plans No. of sheets X 4

Last use

Material No. stories Heat Style of roof Roofing

Other buildings on same lot 30,000 Fee \$ 120.

Estimated contractual cost \$

GENERAL DESCRIPTION

FIELD INSPECTOR—Mr. @ 775-5451 Ext. 234 To erect 25'x36' dwelling with attached 2 car garage as per plans

- Dwelling
- Garage
- Masonry Bldg.
- Metal Bldg.
- Alterations
- Demolitions
- Change of Use
- Other

Stamp of Special Conditions

NOTE TO APPLICANT: Separate permits are required by the installers and subcontractors of heating, plumbing, electrical and mechanicals.

PERMIT IS TO BE ISSUED TO 1 2 3 4

PERMIT ISSUED WITH LETTER

DETAILS OF NEW WORK

Is any plumbing involved in this work? yes Is any electrical work involved in this work? yes

Is connection to be made to public sewer? yes If not, what is proposed for sewage?

Has septic tank notice been sent?

Form notice sent?

Height average grade to top of plate 16' Height average grade to highest point of roof 20'

Size, front 36' depth 25' No. stories 2 solid or filled land? earth

Material of foundation concrete-4' below grade Thickness, top 10" bottom yes

Kind of roof pitch Rise per foot 6 Roof covering asphalt shingles

No. of chimneys 1 Material of chimneys br. of lining clay tile Kind of heat elec.

Framing Lumber—Kind SP. Dressed or full size?

Size Girder 6x10 Columns under girders lally Size 3x2 Max. on centers

Studs (outside walls and carrying partitions) 2x4-16" O. C. Bridging in every floor and flat roof span over 8 feet.

Joists and rafters: 1st floor 2x10, 2nd 2x10, 3rd

On centers: 1st floor 16", 2nd

Maximum span: 1st floor

If one story building with masonry walls, thickness of walls?

IF A GARAGE

No. cars now accommodated on same lot, to be accommodated ... number commercial cars to be accommodated ... Will automobile repairing be done other than minor repairs to cars habitually stored in the proposed building?

APPROVALS BY:

BUILDING INSPECTION—PLAN EXAMINER

ZONING: R.R. 3/28/77 M.C.O.

BUILDING CODE: O.K.C.B. 3/29/77

Fire Dept.:

Health Dept.:

Others:

MISCELLANEOUS

Will work require disturbing of any tree on a public street?

Will there be in charge of the above work a person competent to see that the State and City requirements pertaining thereto are observed? yes

Signature of Applicant George Christy Phone # 797-3444

Type Name of above George Christy 1 2 3 4

Other

and Address

INSPECTOR'S COPY

Garrison

NOTES

4/14/77 No plot plan attached to this work sheet

Line measured from the front of

line of 40' & 41' set back -

talked with Mr Brown regard the set back of 50' -

Mr Christy to call Bob Brown regarding the 50' set back

at the what of to position the building 35' back - Mr Brown

agreed to 40' in side yard were 45'

May 5/77 Ground work completed

May 12/77 Same

May 26/77 Exterior about complete, interior started

May 17/77 Window completed

Aug 4/77 Final map, OK to issue

Permit No. 97/1173
 Location 111 # 41 Christy Rd
 Owner Christy & Small
 Date of permit: 8/21-77
 Approved 1-5-77

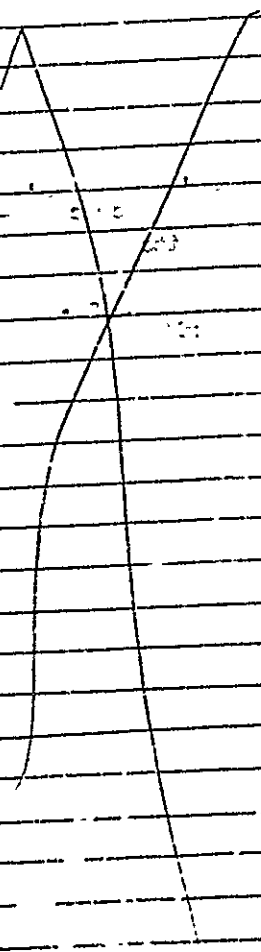

NOTES

5/5/86 Sent copy of swimming pool requirements with Permit # 1

5/12/86

Permit No. 86/541

Location 166 Chaska Rd

Owner Sharon Gehman

Date of permit 4/28/86

Approved 5/8/86

Use: Inground Pool

Garage

Alteration

Two large sections of horizontal lines for notes, with a large 'X' drawn across the right section.

DEPT OF BUILDING INSPECTIONS
CITY OF PORTLAND

APR 28 1988

RECEIVED

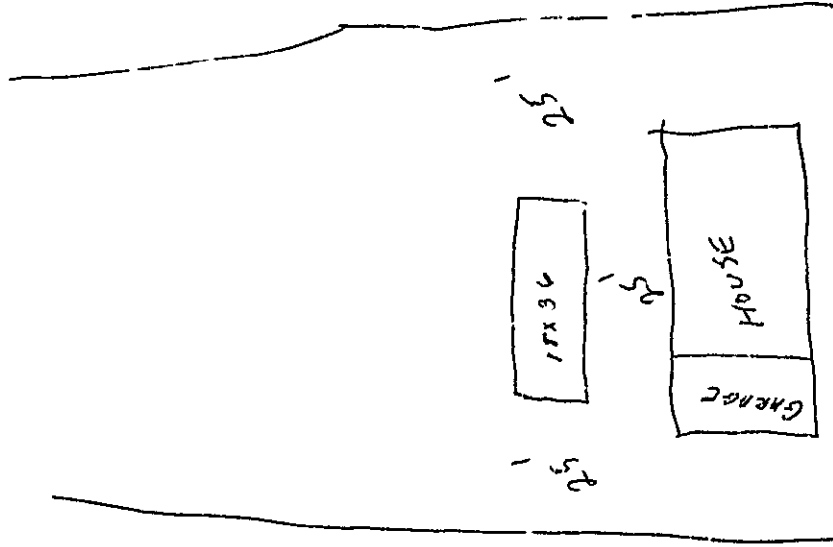

APPLICATION FOR PERMIT

PERMIT ISSUE

MAY 8 1986

City Of Portland

B.O.C.A. USE GROUP
B.O.C.A. TYPE OF CONSTRUCTION 00541
ZONING LOCATION ... R-2 PORTLAND, MAINE April 28, 1986

To the CHIEF OF BUILDING & INSPECTION SERVICES, PORTLAND, MAINE
The undersigned hereby applies for a permit to erect, alter, repair, demolish, move or install the following building, structure, equipment or change use in accordance with the Laws of the State of Maine, the Portland B.O.C.A. Building Code and Zoning Ordinance of the City of Portland with plans and specifications, if any, submitted herewith and the following specifications:
LOCATION 166 Christy Road

1. Owner's name and address Sharon Cochran - same Fire District #1 #2
2. Lessee's name and address Telephone ... 797-4146
3. Contractor's name and address Poolside Shop - Rte. #1 Falmouth Telephone 781-2323
Proposed use of building inground pool No. of sheets
Last use No. families
Material No. stories Heat Style of roof Roofing
Other buildings on same lot
Estimated contractual cost \$ 9,500

FIELD INSPECTOR—Mr. @ 775-5451
Appeal Fees \$
Base Fee \$ 70.00
Late Fee \$
TOTAL \$

To install inground swimming pool, 18' x 36'
plans on file in office

Stamp of Special Conditions

NOTE TO APPLICANT: Separate permits are required by the installers and subcontractors of heating, plumbing, electrical and mechanicals.

DETAILS OF NEW WORK

Is any plumbing involved in this work? no
Is any electrical work involved in this work? yes
Is connection to be made to public sewer? If not, what is proposed for sewage?
Has septic tank notice been sent? Form notice sent?
Height average grade to top of plate Height average grade to highest point of roof
Size, front depth No. stories solid or filled land? curb or rock?
Material of foundation Thickness, top bottom cellar
Kind of roof Rise per foot Roof covering
No. of chimneys Material of chimneys of lining Kind of heat fuel
Framing Lumber—Kind Dressed or full size? Corner posts Sills
Size Girder Columns under girders Size Max. on centers
Studs (outside walls and carrying partitions) 2x4 O. C. Bridging in every floor and flat roof span over 8 feet
Joists and rafters: 1st floor 2nd 3rd roof
On centers: 1st floor 2nd 3rd roof
Maximum span: 1st floor 2nd 3rd roof
If one story building with masonry walls, thickness of walls? height?

IF A GARAGE

No. cars now accommodated on same lot, to be accommodated number commercial cars to be accommodated
Will automobile repairing be done other than minor repairs to cars habitually stored in the proposed building?

APPROVALS BY: DATE
BUILDING INSPECTION—PLAN EXAMINER
ZONING: D.K. W.J.T. #128/86
BUILDING CODE:
Fire Dept.
Health Dept.
Others:

MISCELLANEOUS

Will work require disturbing of any tree on a public street? no
Will there be in charge of the above work a person competent to see that the State and City requirements pertaining thereto are observed? yes

Signature of Applicant Bruce Cochran Phone # same
Type Name of above and Address
Other 1 2 3 4

FIELD INSPECTOR'S COPY MR. JAVIER
APPLICANT'S COPY
OFFICE FILE COPY

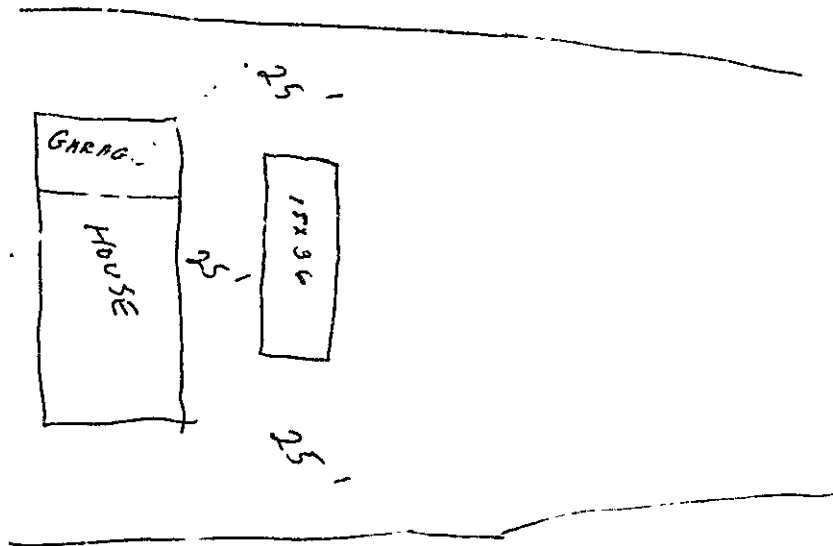

RECEIVED

APR 28 1986

DEPT OF BUILDING INSPECTIONS
CITY OF PORTLAND



APPLICATION FOR PERMIT
DEPARTMENT OF BUILDING INSPECTIONS SERVICES
ELECTRICAL INSTALLATIONS

Date April 28, 19 86
 Receipt and Permit number D-2703

To the CHIEF ELECTRICAL INSPECTOR, Portland, Maine:
 The undersigned hereby applies for a permit to make electrical installations in accordance with the laws of
 Maine, the Portland Electrical Ordinance, the National Electrical Code and the following specifications:

LOCATION OF WORK: 166 Christy Road
 OWNER'S NAME: Sharon Cochran ADDRESS: lives there

OUTLETS:	Receptacles _____	Switches _____	Plugmold _____	1: TOTAL _____	FEES _____
FIXTURES: (number of)	Incan. escent _____	Flourescent _____	(not strip) TOTAL _____		
	Strip Flourescent _____ ft.				
SERVICES:	Overhead _____	Underground _____	Temporary _____	TOTAL amperes _____	
METERS: (number of)					
MOTORS: (number of)	Fractional _____				
	1 HP or over _____				
RESIDENTIAL HEATING:	Oil or Gas (number of units) _____				
	Electric (number of rooms) _____				
COMMERCIAL OR INDUSTRIAL HEATING:	Oil or Gas (by a main boiler) _____				
	Oil or Gas (by separate units) _____				
	Electric Under 20 kws _____	Over 20 kws _____			
APPLIANCES: (number of)	Ranges _____	Water Heaters _____			
	Cook Tops _____	Disposals _____			
	Wall Ovens _____	Dishwashers _____			
	Dryers _____	Ccmpactors _____			
	Fans _____	Others (denote) _____			
	TOTAL _____				
MISCELLANEOUS: (number of)	Branch Panels _____				
	Transformers _____				
	Air Conditioners Central Unit _____	Separate Units (windows) _____			
	Signs 20 sq. ft. and under _____	Over 20 sq. ft. _____			
	Swimming Pools Above Ground _____	In Ground _____			
	Fire/Burglar Alarms Residential _____	Commercial _____			10.00
	Heavy Duty Outlets, 220 Volt (such as welders) 30 amps and under _____	over 30 amps _____			
	Circus, Fairs, etc. _____				
	Alterations to wires _____				
	Repairs after fire _____				
	Emergency Lights, battery _____				
	Emergency Generators _____				

FOR ADDITIONAL WORK NOT ON ORIGINAL PERMIT INSTALLATION FEE DUE:
 FOR REMOVAL OF A "STOP ORDER" (304-16.b) DOUBLE FEE DUE:
 TOTAL AMOUNT DUE: 10-00

INSPECTION: Will be ready on _____, 19__; or Will Call xx
 CONTRACTOR'S NAME: Chris DeSimone
 ADDRESS: 116 Orchard Rd. Cumb
 TEL.: 829-3433
 MASTER LICENSE NO.: 2999 SIGNATURE OF CONTRACTOR: Bruce Cochran
 LIMITED LICENSE NO.: _____

ELECTRICAL INSTALLATIONS

Permit Number 25708

Location 166 Liberty Rd

Owner S. Cookson

Date of Permit 4-28-86

Final Inspection _____

By Inspector _____

Permit Application Register Page No. 111

INSPECTIONS: Service _____ by _____
Service call in _____
Closing-in _____ by _____

PROGRESS INSPECTIONS: _____ / _____ / _____
_____ / _____ / _____
_____ / _____ / _____

CODE
COMPLIANCE
COMPLETED
DATE _____

DATE:	REMARKS:

NOTES

5/5/86 Sent copy of swimming pool requirements with permit #1

5/12/86

Permit No. 86/541

Location 1166 Chishy Rd

Owner Sharon Cochran

Date of permit 4/28/86

Approved 5/8/86

Dwelling Inground Pool

Garage

Alteration

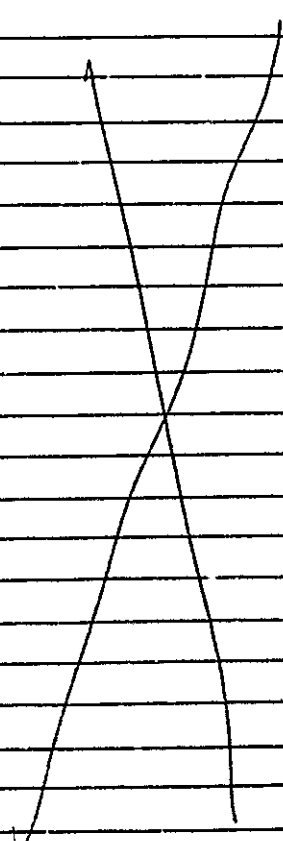

APPLICATION FOR PERMIT

PERMIT ISSUE

B.O.C.A. USE GROUP

B.O.C.A. TYPE OF CONSTRUCTION 00541

MAY 8 1986

ZONING LOCATION R-2 PORTLAND, MAINE April 28, 1986

City Of Portland

to the CHIEF OF BUILDING & INSPECTION SERVICES, PORTLAND, MAINE

The undersigned hereby applies for a permit to erect, alter, repair, demolish, move or install the following building, structure, equipment or change use in accordance with the Laws of the State of Maine, the Portland B.O.C.A. Building Code and Zoning Ordinance of the City of Portland with plans and specifications, if any, submitted herewith and the following specifications:

LOCATION 166 Christy Road Fire District #1 , #2

1. Owner's name and address Sharon Cochran - same Telephone ... 797-9146.

2. Lessee's name and address Telephone

3. Contractor's name and address Poolside Shop - Rte. # 1 Fairbush Telephone . 781-2323

..... No. of sheets

Proposed use of building inground pool No. families

Last use No. families

Material ... No. stories ... Heat Style of roof Roofing

Other buildings on same lot

Estimated contractual cost \$ 9,500

Appeal Fees \$

FIELD INSPECTOR—Mr.

Base Fee \$ 70.00

@ 775-5451

Late Fee

TOTAL \$

To install inground swimming pool, 18' x 36' plans on file in office

Stamp of Special Conditions

NOTE TO APPLICANT: Separate permits are required by the installers and subcontractors of heating, plumbing, electrical and mechanicals.

DETAILS OF NEW WORK

Is any plumbing involved in this work? ... no ... Is any electrical work involved in this work? ... yes

Is connection to be made to public sewer? If not, what is proposed for sewage?

Has septic tank notice been sent? Form notice sent?

Height average grade to top of plate Height average grade to highest point of roof

Size, front depth No. stories solid or filled land? earth or rock?

Material of foundation Thickness, top bottom cellar

Kind of roof Rise per foot Roof covering

No. of chimneys Material of chimneys of lining Kind of heat fuel

Framing Lumber—Kind Dressed or full size? Corner posts Sills

Size Girder Columns under girders Size Max. on centers

Studs (outside walls and carrying partitions) 2x4-16" O. C. Bridging in every floor and flat roof span over 8 feet.

Joists and rafters: 1st floor 2nd 3rd roof

On centers: 1st floor 2nd 3rd roof

Maximum span: 1st floor 2nd 3rd roof

If one story building with masonry walls, thickness of walls? height?

IF A GARAGE

No. cars now accommodated on same lot, to be accommodated . . . number commercial cars to be accommodated

Will automobile repairing be done other than minor repairs to cars habitually stored in the proposed building?

APPROVALS BY: DATE

MISCELLANEOUS

BUILDING INSPECTION—PLAN EXAMINER

Will work require disturbing of any tree on a public street? no

ZONING: A.K.A. M.P.T. 4/28/86

BUILDING CODE:

Will there be in charge of the above work a person competent to see that the State and City requirements pertaining thereto are observed? yes

Fire Dept.:

Health Dept.:

Others:

Signature of Applicant Phone # same

Type Name of ab Bruce Cochran 1 2 3 4

Other and Address

FIELD INSPECTOR'S COPY

APPLICANT'S COPY

OFFICE FILE COPY

MA JAVIN

Mail To: City of Portland
Parks/Public Works
55 Portland Street
Portland, Maine 04101

Dave Peterson
775-5451 #452

FOR SUBMETER

FOR SEWER USER CHARGE ADJUSTMENTS

The undersigned hereby requests permission to install additional water meter(s) in accordance with Section 322.60 of the "Municipal Code of the City of Portland, Maine"

It is understood that all expenses related to the purchase, installation and maintenance of the meter(s) is to be borne by the applicant.

TO BE COMPLETED BY APPLICANTS

Address where sub-meter is requested 166 Christy Rd

Property owner's name Sharon Cochran

Tax Map Reference (On Real Estate Tax Bill) 378 A Lot 55

Property owner's address 166 Christy

Person to be contacted to schedule inspections Above 775-0727
(Name and Telephone Number)

Portland Water District Account No. (On bill) D-78-03454

Billing Name & Address (On bill) Sharon Stewart
166 Christy Rd Port

Location and size existing Portland Water District Service Meter Rockwell 5/8 SR

Proposed location and size of sub-meter same location as main meter
Down stream of main meter

Will a remote reading register be utilized? (If yes, state location NEXT TO EXISTING METER BY DRIVEWAY)

Description of proposed changes in plumbing required for sub-metering: Put the
meter in line for two outside faucets

The volume of water to be submetered can be shown not to enter the sewerage system by virtue of its use for: Swimming Pool - 1/2 wash etc.

I certify the above information is true and correct:
Sharon Stewart Cochran
Signature

7-27-86
Date

May 7, 1987

Sketch plan showing proposed changes in plumbing and the location of existing and proposed meters. Show water flow through submeter to non-discharge equipment or location (use additional sheet of paper if necessary)

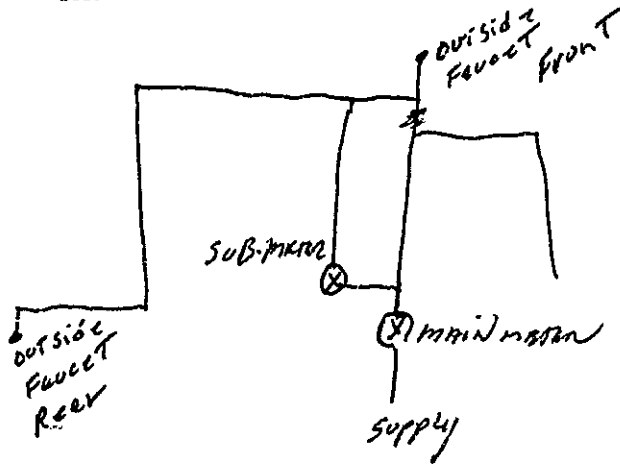

TO BE COMPLETED BY PUBLIC WORKS

Pre-installation inspection by DAVID E. PETERSON
on 3/23/87

Automatic reading system requested YES NO

A WATS Back Flow Preventer or equal shall be installed ON OUTSIDE SILLOCK'S:

Application Approved Denied

Comments _____

TO BE COMPLETED BY THE PLUMBING INSPECTOR

An inspection of the completed installation of the sub-metering system approved on this application was conducted on 5-6-87 by Ernie R. Goodwin, Chief Plumbing Inspector of the City of Portland.

The sub-metering system was installed as approved

No cross connections were found

Ernie R. Goodwin

The installation is approved dis-approved

TO BE COMPLETED BY THE WATER DISTRICT

Date submeter sold 5/1/87
Submeter account number D-28-13459
Submeter make and number FOR # 354 B 1417
Submeter installation readings 93705
Submeter account entered into computer 5/2/87
Submeter account entered into meter book 5/7/87
Special instructions _____

