

PLUMBING APPLICATION

Department of Human Services
Division of Health Engineering
(207) 299-3826

PROPERTY ADDRESS

Town Or Plantation: Portland

Street Subdivision Lot #: Bramblewood Lot #4

PROPERTY OWNERS NAME

Last: Kasprzak, Inc. First:

Applicant Name: EASTERN MECHANICAL, INC.

Mailing Address of Owner/Applicant (If Different): PO Box 518 Biddeford ME 04005

PORTLAND 3894 TOWN COPY

Date Permitted: 06.26.90 \$ 3.00 FEE Charged Double Fee

[Signature] L.P.I. # 0123

Owner/Applicant Statement

I certify that the information submitted is correct to the best of my knowledge and understand that any falsification is reason for the Local Plumbing Inspector to deny a Permit.

[Signature] Date: 6/26/90

Caution: Inspection Required

I have inspected the installation authorized above and found it to be in compliance with the Maine Plumbing Rules.

[Signature] Date Approved: 06.18.1990

PERMIT INFORMATION

This Application is for:

1. NEW PLUMBING

2. RELOCATED PLUMBING

LOW VOLUME
JUN 23 1990

Type Of Structure To Be Served:

1. SINGLE FAMILY DWELLING

2. MODULAR OR MOBILE HOME

3. MULTIPLE FAMILY DWELLING

4. OTHER - SPECIFY _____

Plumbing To Be Installed By:

1. MASTER PLUMBER

2. OIL BURNERMAN

3. MFG'D. HOUSING DEALER/MECHANIC

4. PUBLIC UTILITY EMPLOYEE

5. PROPERTY OWNER

LICENSE # 02271

Hook-Up & Piping Relocation Maximum of 7 Hook-Up	Number	Column 2 Type of Fixture	Number	Column 1 Type of Fixture
<u>AUG 24 1990</u> HOOK-UP to public sewer in those cases where the connection is not regulated and inspected by the local Sanitary District.	2	Hosebibb / Sillcock	1	Bathtub (and Shower)
		Floor Drain	1	Shower (Separate)
		Urinal	1	Sink
<u>SEP 7 1990</u> HOOK-UP to an existing subsurface wastewater disposal system.		Drinking Fountain	3	Wash Basin
		Infect Waste	3	Water Closet (Toilet)
		Water Treatment Softener, Filter, etc.	1	Clothes Washer
		Grease/Oil Separator	1	Dish Washer
		Dental Cuspidor	1	Garbage Disposal
		Bidet		Laundry Tub
Number of Hook-Ups & Relocations	1	Other: <u>TANKLESS</u>		Water Heater
Hook-Up & Relocation Fee	3	Fixtures (Subtotal) Column 2	11	Fixtures (Subtotal) Column 1
			3	Fixtures (Subtotal) Column 2
			14	Total Fixtures
			\$ 25.	Fixture Fee
			\$	Hook-Up & Relocation Fee
			\$ 38.	Permit Fee (Total)

SEE PERMIT FEE SCHEDULE FOR CALCULATING FEE

TOWN COPY



APPLICATION FOR PERMIT
DEPARTMENT OF BUILDING INSPECTIONS SERVICES
ELECTRICAL INSTALLATIONS

Date June 8, 1990
 Receipt and Permi' numb: 01349

To the CHIEF ELECTRICAL INSPECTOR, Portland, Maine:

The undersigned hereby applies for a permit to make electrical installations in accordance with the laws of Maine, the Portland Electrical Ordinance, the National Electrical Code and the following specifications:

LOCATION OF WORK: Lot #4 Bramblewood Drive
 OWNER'S NAME: Kasprzak, Inc. ADDRESS: Rte. #5, No. Waterboro, ME

	FEES
OUTLETS:	
Receptacles <u>X</u> Switches <u>X</u> Plugmold _____ ft. TOTAL <u>31-60</u>	<u>5.00</u>
FIXTURES: (number of)	
Incandescent <u>X</u> Fluorescent _____ (not strip) TOTAL <u>1-10</u>	<u>3.00</u>
Strip Fluorescent _____ ft.	
SERVICES:	
Overhead _____ Underground <u>X</u> Temporary _____ TOTAL amperes <u>200</u> ..	<u>3.00</u>
METERS: (number of) <u>1</u>	<u>.50</u>
MOTORS: (number of)	
Fractional	
1 HP or over	
RESIDENTIAL HEATING:	
Oil or Gas (number of units) <u>oil</u>	<u>3.00</u>
Electric (number of rooms)	
COMMERCIAL OR INDUSTRIAL HEATING:	
Oil or Gas (by a main boiler)	
Oil or Gas (by separate units)	
Electric Under 20 kws _____ Over 20 kws	
APPLIANCES: (number of)	
Ranges <u>1</u> Water Heaters _____	
Cook Tops _____ Disposals _____	
Wall Ovens _____ Dishwashers <u>1</u>	
Dryers <u>1</u> Compactors _____	
Fans <u>2</u> Others (denote) _____	
TOTAL <u>5</u>	<u>7.50</u>
MISCELLANEOUS: (number of)	
Branch Panels	
Transformers	
Air Conditioners Central Unit	
Separate Units (windows)	
Signs 20 sq. ft. and under	
Over 20 sq. ft.	
Swimming Pools Above Ground	
In Ground	
Fire/Burglar Alarms Residential	
Commercial	
Heavy Duty Outlets, 220 Volt (such as welders) 30 amps and under	
over 30 amps	
Circus, Fairs, etc.	
Alterations to wires	
Repairs after fire	
Emergency Lights, battery	
Emergency Generators	
INSTALLATION FEE DUE:	
FOR ADDITIONAL WORK NOT ON ORIGINAL PERMIT DOUBLE FEE DUE:	
FOR REMOVAL OF A "STOP ORDER" (304-16.b)	
TOTAL AMOUNT DUE:	<u>22.00</u>

INSPECTION: SERVICE READY
 Will be ready on 6/8, 1990, or Will Call _____
 CONTRACTOR'S NAME: John Cudworth
 ADDRESS: P.O. Box 40, Springvale, ME 04083
 TEL.: 490-1604
 MASTER LICENSE NO.: 03685 SIGNATURE OF CONTRACTOR: John Cudworth
 LIMITED LICENSE NO.: _____

INSPECTOR'S COPY — WHITE
 OFFICE COPY — CANARY
 CONTRACTOR'S COPY — GREEN

CITY OF PORTLAND, MAINE
Department of Building Inspection



Certificate of Occupancy

LOCATION Lot #4, Bramblewood

Date of Issue 8/13/90

Issued to: Kasprzak, Inc.

This is to certify that the building, premises, or part thereof, at the above location, built -- altered -- changed as to use under Building Permit No. 90/0397, has had final inspection, has been found to conform substantially to requirements of Zoning Ordinance and Building Code of the City, and is hereby approved for occupancy or use, limited or otherwise, as indicated below.

PORTION OF BUILDING OR PREMISES

APPROVED OCCUPANCY

Entire

Single-family

Limiting Conditions:

This certificate supersedes
certificate issued

Approved by:

Mark Seary
(Date) 8/13/90 Inspector

Inspector of Buildings

Notice: This certificate identifies lawful use of building or premises, and ought to be transferred from owner to owner when property changes hands. Copy will be furnished to owner or lessee for one dollar.

Permit # 0397 City of Portland BUILDING PERMIT APPLICATION Fee \$520.00 Zone _____ Map # _____ Lot# _____
 Please fill out any part which applies to job. Proper plans must accompany form.

Owner: Karpazak, Inc. Phone # 247-5482530
 Address: Rt. 5 No. Waterboro, Maine 04069 (Mail Permit)
 LOCATION OF CONSTRUCTION Lot 4 Bramblewood
 Contractor: Self Sub: _____
 Address: _____ Phone # _____
 Est. Construction Cost: 100,000 Proposed Use: single family vacant lot
 Past Use: _____
 # of Existing Res. Units _____ # of New Res. Units _____
 Building Dimensions L 56 W 27 Total Sq. Ft. 2500
 # Stories: 2 # Bedrooms 3 Lot Size: 11,461
 Is Proposed Use: Seasonal _____ Condominium _____ Conversion _____
 Explain Conversion: To construct single family residence with attached 2 car garage

For Official Use Only
 Date May 4, 1990 Subdivision: **PERMIT ISSUED**
 Inside Fire Limits _____ Name _____
 Bldg Code _____ Date: MAY 18 1990
 Time Limit _____ Ownership: _____
 Estimated Cost: \$100,000 City of Portland
 Zoning: Street Frontage Provided: _____
 Provided Setbacks: Front _____ Back _____ Side _____
 Review Required:
 Zoning Board Approval: Yes _____ No _____ Date: _____
 Planning Board Approval: Yes _____ No _____ Date: _____
 Conditional Use: _____ Variance _____ Site Plan _____ Subdivision _____
 Shoreland Zoning Yes _____ No _____ Floodplain Yes _____ No _____
 Special Exception _____
 Other (Explain) OK WNA 5-17-90

Foundation:
 1. Type of Soil: _____
 2. Setbacks - Front _____ Rear _____ Side(s) _____
 3. Footings Size: _____
 4. Foundation Size: _____
 5. Other _____

Floor:
 1. Sills Size: _____ Sills must be anchored.
 2. Girder Size: _____
 3. Lally Column Spacing: _____ Size: _____
 4. Joist Size: _____ Spacing 16" O.C.
 5. Bridging Type: _____ Size: _____
 6. Floor Sheathing Type: _____ Size: _____
 7. Other Material: _____

Exterior Walls:
 1. Studding Size _____ Spacing _____
 2. No. windows _____
 3. No. Doors _____
 4. Header Sizes _____ Span(s) _____
 5. Bracing: Yes _____ No _____
 6. Corner Posts Size _____
 7. Insulation Type _____ Size _____
 8. Sheathing Type _____ Size _____
 9. Siding Type _____ Weather Exposure _____
 10. Masonry Materials _____
 11. Metal Materials _____

Interior Walls:
 1. Studding Size _____ Spacing _____
 2. Header Sizes _____ Span(s) _____
 3. Wall Covering Type _____
 4. Fire Wall if required _____
 5. Other Materials _____

Ceiling:
 1. Ceiling Joists Size: _____
 2. Ceiling Strapping Size _____ Spacing _____
 3. Type Ceilings: _____ Size _____
 4. Insulation Type _____
 5. Ceiling Height: _____

Roof:
 1. Truss or Rafter Size _____ Span _____
 2. Sheathing Type _____ Size _____
 3. Roof Covering Type _____

Chimneys:
 Type: _____ Number of Fire Places _____

Heating:
 Type of Heat: _____
 Electrical: Service Entrance Size: _____ Smoke Detector Required Yes _____ No _____

Plumbing:
 1. No. of Sinks _____
 2. No. of Tubs or Showers _____
 3. No. of Flushes _____
 4. No. of Lavatories _____
 5. No. of Other Fixtures _____

Swimming Pools:
 1. Type: _____ Square Footage _____
 2. Pool Size: _____ x _____
 3. Must conform to National Electrical Code and State Law.

Permit Received By _____
 Signature of Applicant: _____ Date: 5/4/90
 Signature of CEO: _____
 Inspection Dates: _____

PERMIT ISSUED WITH LETTER

PLOT PLAN

N



FEES (Breakdown From Front)
Base Fee \$ 520.00
Subdivision Fee \$ _____
Site Plan Review Fee \$ 50.00 Minor Minor
Other Fees \$ _____
(Explain) _____
Late Fee \$ _____

Type	Inspection Record	Date
_____	_____	____/____/____
_____	_____	____/____/____
_____	_____	____/____/____
_____	_____	____/____/____
_____	_____	____/____/____

COMMENTS 2 plot plans 1 construction plan submitted
5-24 90 Set lines check out OK on foundation OK.
Plow called for framing inspection.
5-10. This will be completed for C of D

Signature of Applicant John M. Rbb as agent for Koszerek Trac. Date 5-4-90

5' AGGREGATE SUBBASE COURSE - GRAVEL

ON

RECEIVED

MAY 0 4 1990

DEPT. OF BUILDING INSPECTIONS
CITY OF PORTLAND

4 BEAMBLEWOOD

PHAIR ACRES SUBDIVISION

PLAN BOOK 113, PAGE 36 C.C.R.D.
749.90' 1" EVERY

STOCKADE FENCE

N 70°-24'-31" E

90.08'

60.85'

S 77°

N 17°-14'-48" W
143.21'

13,054 SF.

1,481 SF.

12,199 SF.

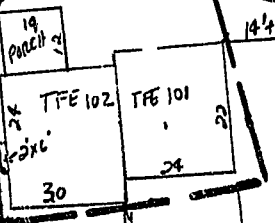

25.14'

74.15'

S 72°-45'-12" W 100.00'

100

378-A-65



N 72°-45'-12" E 100.00'

21.45'

78.57'

Area 45'

Area 103-07

Area 7C



CITY OF PORTLAND, MAINE

389 CONGRESS STREET
PORTLAND, MAINE 04101
(207)874-8300

DEPARTMENT OF PLANNING & URBAN DEVELOPMENT

P. SAMUEL HOFFSES, CHIEF
INSPECTION SERVICES DIVISION

May 17, 1990

RE: Lot #4 Bramblewood

Kasprzak, Inc.
RT. #5
North Waterboro, Maine 04061

Dear Sir:

Your application to construct a single family dwelling has been reviewed and a permit is herewith issued subject to the following requirements:

No certificate of occupancy can be issued until all requirements of this letter are met.

Site Plan Review Requirements

Inspection Services-Approved-William Giroux
Public Works-All damage to curb and sidewalk must be repaired prior to issuance of a Certificate of Occupancy. Two City approved trees must be planted on lot on street frontage.

Building Code Requirements

Please read and implement items 1, 6, 7, 8, and 9 of the attached building permit report.

If you have any questions regarding these requirements, please do not hesitate to contact this office.

Sincerely,

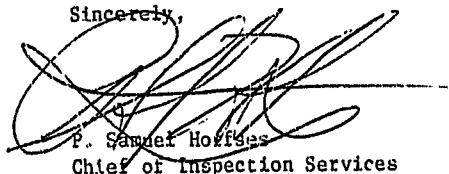

P. Samuel Hoffses
Chief of Inspection Services

.el

cc: Paul Niehoff, Public Works Department
Steve Harris, Public Works Department

Applicant: Ka Sprzak Inc
Address: Lot #4 Bramblewood
Assessors No.:

Date: 5-17-90

CHECK LIST AGAINST ZONING ORDINANCE

Date -

Zone Location - R-2

Interior or corner lot -

Use - single

Sewage Disposal - city

Rear Yards - 25'+

Side Yards - 14'

Front Yards - 25'+

Projections - none

Height - 2 story

Lot Area - 11,461 sq ft

Building Area - OK

Area per Family - entire

Width of Lot - 82' where structure is 80' minimal

Lot Frontage - 96' +-

Off-street Parking - 2 cars

Loading Bays - N/A

Site Plan -

Shoreland Zoning -

Flood Plains -

MINOR MINOR SITE PLAN
CITY OF PORTLAND, MAINE
 SITE PLAN REVIEW
 Processing Form

Applicant Kasprzak, Inc. Date May 4, 1990
 Mailing Address Rt. 5 No. Waterboro, Maine 04061 Address of Proposed Site Lot 4 Bramblewood
single family with attached garage Site Identifier(s) from Assessors Maps 378-A-65
 Proposed Use of Site _____ Zoning of Proposed Site R-2
 Acreage of Site 11.461 / Ground Floor Coverage 1248 sq. ft. Proposed Number of Floors 2
 Site Location Review (DEP) Required: () Yes () No Total Floor Area 2500 sq. ft.
 Board of Appeals Action Required: () Yes (X) No
 Planning Board Action Required: () Yes (X) No

Other Comments: _____
 Date Dept. Review Due: _____

BUILDING DEPARTMENT SITE PLAN REVIEW
 (Does not include review of construction plans)

- Use does NOT comply with Zoning Ordinance
 - Requires Board of Appeals Action
 - Requires Planning Board/City Council Action

Explanation _____
 Use complies with Zoning Ordinance — Staff Review Below

Zoning: SPACE & BULK, as applicable

	DATE	ZONE LOCATION	INTERIOR OR CORNER LOT	40 FT. SETBACK AREA (SEC 21)	USE	SEWAGE DISPOSAL	REAR YARDS	SIDE YARDS	FRONT YARD	PROJECTIONS	HEIGHT	LOT AREA	BUILDING AREA	AREA PER FAMILY	WIDTH OF LOT	LOT FRONTAGE	OFF-STREET PARKING	LOADING BAYS	
COMPLIES																			
COMPLIES CONDITIONALLY																			
DOES NOT COMPLY																			

REASONS: OK W.D.A. 5-17-90

SIGNATURE OF REVIEWING STAFF/DATE
 BUILDING DEPARTMENT—ORIGINAL

MINOR MINOR SITE PLAN
CITY OF PORTLAND, MAINE
SITE PLAN REVIEW
 Processing Form

Steve Harris

Applicant Kasprzak, Inc. Date May 4, 1990

Mailing Address Rt. 5 W. Waterboro, Maine 04668 Address of Proposed Site Lot 4 Bramblewood

Proposed Use of Site single family with attached garage Site Identifier(s), from Assessors Maps 378-A-65

Acreage of Site 11.461 / Ground Floor Coverage 1248 sq. ft. Zoning of Proposed Site R-2

Site Location Review (DEP) Required: () Yes () No Proposed Number of Floors 2

Board of Appeals Action Required: () Yes () No Total Floor Area 2500 sq. ft.

Planning Board Action Required: () Yes () No

Other Comments: _____

Date Dept. Review Due: _____

PUBLIC WORKS DEPARTMENT REVIEW

(Date Received) _____

	TRAFFIC CIRCULATION	ACCESS	CURB CUTS	ROAD WIDTH	PARKING	SIGNALIZATION	TURNING MOVEMENTS	LIGHTING	CONFLICT WITH CITY CONSTRUCTION PROJECT	DRAINAGE	SOIL TYPES	SEWERS	CURING	SIDEWALKS	OTHER	
APPROVED																CONDITIONS SPECIFIED BELOW
APPROVED CONDITIONALLY																
DISAPPROVED																REASONS SPECIFIED BELOW

REASONS: All damage to curb and sidewalk must be repaired prior to issuance of a CoFO. Two City approved trees must be planted on lot on street frontage.

(Attach Separate Sheet if Necessary)

Stephen K. Harris 5/10/90
 SIGNATURE OF REVIEWING STAFF/DATE

PUBLIC WORKS DEPARTMENT COPY

0397
 Permit # _____ City of Portland BUILDING PERMIT APPLICATION Fee \$520.00 Zone _____ Map # _____ Lot# _____
 Please fill out as far as which applies to job. Proper plans must accompany form.

Owner: Kaplan, Inc. Phone # 247-5482
 Address: Rt. 5 No. Waterboro, Maine 04068 (Mail Permit)
 LOCATION OF CONSTRUCTION Lot 4 Bramblewood
 Contractor: S&C Sub: _____ Phone # _____
 Address: _____
 Est. Construction Cost: 100,000 Proposed Use: Single family vacant lot
 Past Use: _____
 # of Existing Res. Units _____ # of New Res. Units _____
 Building Dimensions L 56 W 27 Total Sq. Ft. 2500
 # Stories: 2 # Bedrooms 3 Lot Size: 11,461
 Is Proposed Use: Seasonal _____ Condominium _____ Conversion _____
 Explain Conversion To construct single family residence with attached 2 car garage

For Official Use Only PERMIT ISSUED
 Date May 4, 1990 Subdivision: _____
 Inside Fire Limits: _____ Name: _____
 Bldg Code: _____ Lot: MAY 18 1990
 Time Limit: _____ Ownership: City of Portland
 Estimated Cost: \$100,000
 Zoning: R-2 Residence
 Street Frontage Provided: _____ Side _____ Side _____
 Provided Setback: Front _____ Back _____ Side _____ Side _____
 Review Required:
 Zoning Board Approval: Yes _____ No _____ Date: _____
 Planning Board Approval: Yes _____ No _____ Date: _____
 Conditions Use: _____ Variance _____ Site Plan _____ Subdivision _____
 Shoreland Zoning Yes _____ No _____ Floodplain Yes _____ No _____
 Special Exception _____
 Other (Explain): OK UNL 5-17-90

Foundation:

1. Type of Soil: _____
 2. Set Backs - Front _____ Rear _____ Side(s) _____
 3. Footings Size: _____
 4. Foundation Size: _____
 5. Other _____

Floor:

1. Sills Size: _____ Sills must be anchored.
 2. Girder Size: _____
 3. Lally Column Spacing: _____ Size: _____ Spacing 16" O.C.
 4. Joists Size: _____
 5. Bridging Type: _____ Size: _____
 6. Floor Sheathing Type: _____ Size: _____
 7. Other Material: _____

Exterior Walls:

1. Studding Size _____ Spacing _____
 2. No. windows _____
 3. No. Doors _____
 4. Header Sizes _____ Spant(s) _____
 5. Bracing: Yes _____ No _____
 6. Corner Posts Size _____
 7. Insulation Type _____ Size _____
 8. Sheathing Type _____ Size _____ Weather Exposure _____
 9. Siding Type _____
 10. Masonry Materials _____
 11. Meta Materials _____

Interior Walls:

1. Studding Size _____ Spacing _____
 2. Header Sizes _____ Spant(s) _____
 3. Wall Covering Type _____
 4. Fire Wall if required _____
 5. Other Materials _____

Ceiling:

1. Ceiling Joists Size: _____ Spacing _____
 2. Ceiling Strapping Size _____
 3. Type Ceilings: _____ Size _____
 4. Insulation Type _____
 5. Ceiling Height: _____

Roof:

Truss or Rafter Size _____ Span _____
 Sheathing Type _____ Size _____
 Covering Type _____

Chimney:

Type _____ Number of Fire Places _____

Heating:

Type of Heat: _____

Electrical:

Service Entrance Size: _____ Smoke Detector Required Yes _____ No _____

Plumbing:

1. Approval of soil test if required Yes _____ No _____
 2. No. of Tubs or Showers _____
 3. No. of Flushes _____
 4. No. of Lavatories _____
 5. No. of Other Fixtures _____

Swimming Pools:

1. Type: _____ Square Footage _____
 2. Pool Size: _____
 3. Must conform to National Electrical Code and State Law.

Permit Received By:

Signature of Applicant: John Kaplan Date: 5/4/90
 Signature of CEO: _____
 Inspection Date: _____

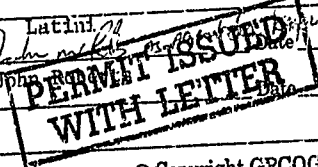

900665

PERMIT ISSUED

JUN 29 1990

City Of Portland

FILL IN AND SIGN WITH INK



APPLICATION FOR PERMIT FOR HEATING, COOKING OR POWER EQUIPMENT

Portland, Maine, 6/28/90

To the INSPECTOR OF BUILDINGS, PORTLAND, ME.

The undersigned hereby applies for a permit to install the following heating, cooking or power equipment in accordance with the Laws of Maine, the Building Code of the City of Portland, and the following specifications:

Location 4 Bramblewood Dr. Use of Building 1-family No. Stories New Building Existing "
Name and address of owner of appliance STEVE KASPAR 71 Waterboro, ME
Installer's name and address Eastern Mechanical, Inc. P O Box 513, Alfred Road Industrial Park Biddeford, ME 04115 Telephone
To install a new hot water heating system

IF HEATER, OR POWER BOILER

Location of appliance Any burnable material in floor surface or beneath?
If so, how protected? Kind of fuel?
Minimum distance to burnable material, from top of appliance or casing top of furnace
From top of smoke pipe From front of appliance From sides or back of appliance
Size of chimney flue Other connections to same flue
If gas fired, how vented? Rated maximum demand per hour
Will sufficient fresh air be supplied to the appliance to insure proper and safe combustion?

IF OIL BURNER

Name and type of burner Beckett 3450 Labeled by underwriters' laboratories? yes
Will operator be always in attendance? Does oil supply line feed from top or bottom of tank? bottom
Type of floor beneath burner concrete Size of vent pipe 1-1/4 inches
Location of oil storage basement Number and capacity of tanks one 275-gallon
Low water shut off yes Make Safeguard No. AEG
Will all tanks be more than five feet from any flame? yes How many tanks enclosed? 0
Total capacity of any existing storage tanks for furnace burners 0

IF COOKING APPLIANCE

Location of appliance Any burnable material in floor surface or beneath?
If so, how protected? Height of Legs, if any
Skirting at bottom of appliance? Distance to combustible material from top of appliance?
From front of appliance From sides and back From top of smokepipe
Size of chimney flue Other connections to same flue
Is hood to be provided? If so, how vented? Forced or gravity?
If gas fired, how vented? Rated maximum demand per hour

MISCELLANEOUS EQUIPMENT OR SPECIAL INFORMATION

Estimated construction cost - \$4500.

William C. Dineen Master #02786

Amount of fee enclosed? 45.

APPROVED:

Will there be in charge of the above work a person competent to see that the State and City requirements pertaining thereto are observed? yes.

Signature of Installer William C Dineen

INSPECTION FILE APPLICANT'S ASSESSOR'S COPY

4 Made Leary



APPLICATION FOR PERMIT FOR HEATING, COOKING OR POWER EQUIPMENT

Portland, Maine, 6/28/90

900665

PERMIT ISSUED

JUN 29 1990

City Of Portland

To the INSPECTOR OF BUILDINGS, PORTLAND, ME.

The undersigned hereby applies for a permit to install the following heating, cooking or power equipment in accordance with the Laws of Maine, the Building Code of the City of Portland, and the following specifications:

Location 4 Bramblewood Dr. Use of Building 1-family No. Stories New Building Existing " Name and address of owner of appliance Steve Kaspazak, Waterboro, ME Installer's name and address Eastern Mechanical, Inc. P O Box 518, Alfred Road Industrial Park Biddeford, ME General Description of Work To install a new hot water heating system

IF HEATER, OR POWER BOILER

Location of appliance Any burnable material in floor surface or beneath? If so, how protected? Kind of fuel? Minimum distance to burnable material, from top of appliance or casing top of furnace From top of smoke pipe From front of appliance From sides or back of appliance Size of chimney flue Other connections to same flue If gas fired, how vented? Rated maximum demand per hour Will sufficient fresh air be supplied to the appliance to insure proper and safe combustion?

IF OIL BURNER

Name and type of burner Beckett 3450 Labelled by underwriters' laboratories? YES Will operator be always in attendance? NO Does oil supply line feed from top or bottom of tank? bottom Type of floor beneath burner concrete Size of vent pipe 1-1/4 inches Location of oil storage basement Number and capacity of tanks one 275-gallon Low water shut off yes Make Safeguard No. AEG Will all tanks be more than five feet from any flame? YES How many tanks enclosed? 0 Total capacity of any existing storage tanks for furnace burners 0

IF COOKING APPLIANCE

Location of appliance Any burnable material in floor surface or beneath? If so, how protected? Height of Legs, if any Skirting at bottom of appliance? Distance to combustible material from top of appliance? From front of appliance From sides and back From top of smokepipe Size of chimney flue Other connections to same flue Is hood to be provided? If so, how vented? Forced or gravity? If gas fired, how vented? Rated maximum demand per hour

MISCELLANEOUS EQUIPMENT OR SPECIAL INFORMATION

Estimated construction cost - \$4500. William C. Dineen Master #02786

Amount of fee enclosed? 45.

APPROVED:

Will there be in charge of the above work a person competent to see that the State and City requirements pertaining thereto are observed? YES.

INSPECTION FILE APPLICANT'S ASSESSOR'S COPY Signature of Installer William C. Dineen 4 Mark Lehey