

Town Or Jurisdiction: Poplarville  
 Lot # 13 # 3  
 Last: Reed First: Arthur  
 Applicant Name: Stephen Reed, Jr.  
 Mailing Address of Owner/Applicant (if different): 1-F-111, Poplarville  
 I certify that the knowledge and information furnished herein is correct to the best of my knowledge and belief, and I am not aware of any false or misleading information being furnished.  
 Signature of Owner/Applicant: Stephen Reed, Jr. Date: 1/10/88

Permit No. 1988-016  
 Date Issued: 1/19/88  
 License # 12151  
 Caution Inspection Required  
 I have inspected the installation as noted above and found it to be in compliance with the Health Plumbing Rules.  
 Local Plumbing Inspector Signature: George J. Anderson Date Approved: APR 2 1988

This Application is for:  
 1.  NEW PLUMBING  
 2.  RELOCATED PLUMBING

Type Of Structure To Be Served:  
 1.  SINGLE FAMILY DWELLING  
 2.  MODULAR OR MOBILE HOME  
 3.  MULTIPLE FAMILY DWELLING  
 4.  OTHER - SPECIFY \_\_\_\_\_

Plumbing To Be Installed By:  
 1.  MASTER PLUMBER  
 2.  JOURNED MAN  
 3.  APPOINTED HOUSEHOLD DEALER/MECHANIC  
 4.  PUBLIC UTILITY EMPLOYEE  
 5.  PROPERTY OWNER  
 LICENSE # 12151

Hook-Up & Piping Relocation Maximum of 1 Hook-Up	Number	Column 2 Type of Fixture	Column 1 Type of Fixture
HOOK-UP: to public sewer in those cases where the connection is not regulated and inspected by the local Sanitary District.		Household Sillcock	Bath Tub (and Shower)
		Floor Drain	Shower (Separate)
OR HOOK-UP: to an existing subsurface wastewater disposal system		Urinal	Sink
		Drinking Fountain	Wash Basin
		Indirect Waste	Water Closet (Toilet)
		Water Treatment Softener, Filter, etc.	Clothes Washer
		Grease/Oil Separator	Dish Washer
PIPING RELOCATION: of sanitary lines, drains, and piping without new fixtures.		Dental Cuspidor	Garbage Disposal
		Bidet	Laundry Tub
Number of Hook-Ups & Relocations		Other: _____	Water Heater
Hook Up & Relocation Fee		Fixture (Subtotal) Column 2	Fixture (Subtotal) Column 1

SEE PERMIT FEE SCHEDULE FOR CALCULATING FEE

Page 1 of 1  
 Rev. 9/86  
 TOWN COPY



**APPLICATION FOR PERMIT**  
**DEPARTMENT OF BUILDING INSPECTIONS SERVICES**  
**ELECTRICAL INSTALLATIONS**

Date February 21, 1961  
 Receipt and Permit number 22-21

To the CHIEF ELECTRICAL INSPECTOR, Portland, Maine.

The undersigned hereby applies for a permit to make electrical installations in accordance with the laws of Maine, the Portland Electrical Ordinance, the National Electrical Code and the following specifications:

LOCATION OF WORK: Lot 115 Bramblewood  
 OWNER'S NAME: Tony P. P. P. ADDRESS: 127 Lester Drive

OUTLETS:								
Receptacles	Switches	Plugmold	ft. TOTAL	100				9.00
FIXTURES: (number of)								
Incandescent	144	Flourescent	9	(not strip)	TOTAL	2.22		4.10
Strip Flourescent		ft.						
SERVICES:								
Overhead	Unde. ground	Temporary	TOTAL amperes					
METERS: (number of)								
MOTORS: (number of)								
Fractional								
1 HP or over								
RESIDENTIAL HEATING:								
Oil or Gas (number of units)	1							3.00
Electric (number of rooms)								
COMMERCIAL OR INDUSTRIAL HEATING:								
Oil or Gas (by a main boiler)								
Oil or Gas (by separate units)								
Electric Under 20 kws		Over 20 kws						
APPLIANCES (number of)								
Ranges	1	Water Heaters						
Cook Tops		Dishwash	1					
Wall Ovens		Washing M.	1					
Dryer	1	Compressor						
Fans	3	Others (denote)						
TOTAL	7							10.50
MISCELLANEOUS (number of)								
Branch Panels								
Transformers								
Air Conditioners Central Unit								
Separate Unit (windows)								
Signs 20 sq. ft. and under								
Over 20 sq. ft.								
Swimming Pools Above Ground								
In Ground								
Fire/Burglar Alarms Residential								
Commercial								
Heavy Duty Outlets 220 Volt (such as welders) 30 amps and under								
over 30 amps								
Circus, Fairs, etc.								
Alterations to wires								
Repairs after fire								
Emergency Light's, battery								
Emergency Generators								
FOR ADDITIONAL WORK NOT ON ORIGINAL PERMIT								INSTALLATION FEE DUE
FOR REMOVAL OF A "STOP ORDER" (3/1/61)								DOUBLE FEE DUE
								TOTAL AMOUNT DUE:
								26.80

INSPECTION  
 Will be ready on 02/01, 1961; or Will Call \_\_\_\_\_  
 CONTRACTOR'S NAME Plaza Electric  
 ADDRESS: 166 Summit Street  
 TEL.: 797-9954  
 MASTER LICENSE NO. 10626 SIGNATURE OF CONTRACTOR  
 LIMITED LICENSE NO. \_\_\_\_\_ *Charles E. Williams*

INSPECTOR'S COPY — WHITE  
 OFFICE COPY — CANARY  
 CONTRACTOR'S COPY — GREEN



**APPLICATION FOR PERMIT**  
**DEPARTMENT OF BUILDING INSPECTIONS SERVICES**  
**ELECTRICAL INSTALLATIONS**

Date December 7, 1987  
 Red ipt and Permit number 22207

To the CHIEF ELECTRICAL INSPECTOR, Portland, Maine:

The undersigned hereby applies for a permit to make electrical installations in accordance with the laws of Maine, the Portland Electrical Ordinance, the National Electrical Code and the following specifications:

LOCATION OF WORK: Lot 15 Bramblewood  
 OWNER'S NAME: Tony Proccedia ADDRESS: 125 Lester Drive

OUTLETS:	Receptacles	Switches	Plugmold	ft. TOTAL	100	9.00
FIXTURES: (number of)						
	Incandescent	Flourescent	(not strip)	TOTAL	20	4.00
	Strip Flourescent	ft.				
SERVICES:	Overhead	Underground	Temporary	TOTAL amperes	200	3.00
METERS: (number of)	1					1.50
MOTORS: (number of)						
	Fractional					
	1 HP or over					
RESIDENTIAL HEATING:	Oil or Gas (number of units)	1				3.00
	Electric (number of rooms)					
COMMERCIAL OR INDUSTRIAL HEATING:	Oil or Gas (by a main boiler)					
	Oil or Gas (by separate units)					
	Electric Unde 20 kws	Over 20 kws				
APPLIANCES: (number of)						
	Ranges	1	Water Heaters			
	Cook Tops		Disposals	1		
	Wall Ovens		Dishwashers	1		
	Dryers	1	Comfactors			
	Fans	2	Others (denote)			
	TOTAL	6				9.00
MISCELLANEOUS: (number of)						
	Branch Panels					
	Transformers					
	Air Conditioners Central Unit					
	Separate Units (windows)					
	Signs 20 sq. ft. and under					
	Over 20 sq. ft.					
	Swimming Pools Above Ground					
	In Ground					
	Fire/Burglar Alarms Residential	3				2.00
	Commercial					
	Heavy Duty Outlets, 220 Volt (such as welders) 30 amps and under					
	over 30 amps					
	Circus, Fairs, etc.					
	Alterations to wires					
	Repairs after fire					
	Emergency Lights, battery					
	Emergency Generators					
FOR ADDITIONAL WORK NOT ON ORIGINAL PERMIT	INSTALLATION FEE DUE					
FOR REMOVAL OF A "STOP ORDER" (304-16.b)	DOUBLE FEE DUE					
	TOTAL AMOUNT DUE					20.50

INSPECTION: Will be ready on \_\_\_\_\_, 19\_\_\_\_; or Will Call \_\_\_\_\_  
 CONTRACTOR'S NAME: Place Electric  
 ADDRESS: 166 Summit Street  
 TEL.: 797-9954  
 MASTER LICENSE NO. 1066 SIGNATURE OF CONTRACTOR: Charles S. Place  
 LIMITED LICENSE NO. \_\_\_\_\_

INSPECTOR'S COPY -- WHITE  
 OFFICE COPY -- ORANGE  
 CONTRACTOR'S COPY -- GREEN

PERMIT # 1923 CITY OF Portland BUILDING PERMIT APPLICATION MAP # \_\_\_\_\_ LOT# \_\_\_\_\_

Please fill out any part which applies to job. Proper plans must accompany form.

Owner: Anthony J. Procidia

Address: 119 Lester Drive, 04103

LOCATION OF CONSTRUCTION Lot #15 Applebee Circle

CONTRACTOR: Steve Kasprazack SUBCONTRACTORS: \_\_\_\_\_

ADDRESS: Waterville, ME

Est. Construction Cost: 75,000 Type of Use: single family

Past Use: vacant

Building Dimensions L 36 W 24 Sq. Ft. 1908 Stories: 2 Lot Size: \_\_\_\_\_

Is Proposed Use: \_\_\_\_\_ Seasonal \_\_\_\_\_ Condominium \_\_\_\_\_ Apartment \_\_\_\_\_

Conversion - Explain to construct w/attached garage as per plans

COMPLETE ONLY IF THE NUMBER OF UNITS WILL CHANGE

Residential Buildings Only:

# Of Dwelling Units \_\_\_\_\_ # Of New Dwelling Units \_\_\_\_\_

Foundation:

1. Type of Soil: \_\_\_\_\_
2. Set Backs - Front \_\_\_\_\_ Rear \_\_\_\_\_ Side(s) \_\_\_\_\_
3. Footings Size: \_\_\_\_\_
4. Foundation Size: \_\_\_\_\_
5. Other: \_\_\_\_\_

Floor:

1. Sills Size: 2x6 Sills must be anchored.
2. Girder Size: 2x10
3. Lally Column Spacing: where applicable Size: 4 1/2
4. Joists Size: 2x10 Spacing 16" O.C.
5. Bridging Type: CROSS Size: \_\_\_\_\_
6. Floor Sheathing Type: 2x2 CDX 46 1/2 Size: \_\_\_\_\_
7. Other Material: \_\_\_\_\_

Exterior Walls:

1. Studding Size: 2x4 Spacing \_\_\_\_\_
2. No. windows: 25
3. No. Doors: \_\_\_\_\_
4. Header Sizes: 2x10 + 2x12 Span(s) where applicable
5. Bracing: Yes  No \_\_\_\_\_
6. Corner Posts Size: where applicable
7. Insulation Type: 3 1/2 fiber Size: 3/4 foam
8. Sheathing Type: water ext Size: \_\_\_\_\_
9. Siding Type: CLAPBOARD Weather Exposure: 4 1/2 - 5"
10. Masonry Materials: BLACK BRICK
11. Metal Materials: 2x4 BRAMS where applicable

Interior Walls:

1. Studding Size: 2x4 Spacing \_\_\_\_\_
2. Header Size: 2x10 Span(s) \_\_\_\_\_
3. Wall Covering Type: sheet rock
4. Fire Wall if required: yes
5. Other Materials: \_\_\_\_\_

For Official Use Only	
Date: <u>October 9, 1987</u>	Subdivision: Yes / No _____
Inside Fire Limits: _____	Name: _____
Bldg Code: _____	Lot: _____
Time Limit: _____	Block: _____
Estimated Cost: <u>75,000</u>	Permit Expiration: _____
Value/Structure: _____	Ownership: _____ Public _____ Private _____
Fee: <u>\$395.00</u>	

Ceiling:

1. Ceiling Joists Size: 2x6 2nd floor
2. Ceiling Strapping Size: 1x3 Spacing: 16" O.C.
3. Type Ceilings: Sheet Rock
4. Insulation Type: FIBER GLASS Size: \_\_\_\_\_
5. Ceiling Height: 7'6" to same cathedral

Roof:

1. Truss or Rafter Size: 2x6 Span: 16" O.C.
2. Sheathing Type: 1/2 CDX Size: \_\_\_\_\_
3. Roof Covering Type: ASPHALT
4. Other: \_\_\_\_\_

Chimneys:

Type: 2 flues Number of Fire Places: 1

Heating:

Type of Heat: OIL

Electrical:

Service Entrance Size: 200 AMP Smoke Detector Required: Yes  No \_\_\_\_\_

Plumbing:

1. Approval of soil test if required: Yes \_\_\_\_\_ No
2. No. of Tubs or Showers: 2 oversize
3. No. of Flushes: 3
4. No. of Lavatories: 1
5. No. of Other Fixtures: 1 SINK

Swimming Pools:

1. Type: \_\_\_\_\_
2. Pool Size: \_\_\_\_\_
3. Must conform to National Electrical Code and State Law.

Zoning:

District: \_\_\_\_\_ Street Frontage Req.: OCT 11 1987

Required Setbacks: Front \_\_\_\_\_ Back \_\_\_\_\_ Side \_\_\_\_\_ Side \_\_\_\_\_

Review Required:

Zoning Board Approval: Yes \_\_\_\_\_ No CITY Date: Portland

Planning Board Approval: Yes \_\_\_\_\_ No \_\_\_\_\_ Date: \_\_\_\_\_

Conditional Use: \_\_\_\_\_ Variance \_\_\_\_\_ Site Plan \_\_\_\_\_ Subdivision \_\_\_\_\_

Shore and Floodplain Mgmt \_\_\_\_\_ Special Exception \_\_\_\_\_

Other: (Explain) \_\_\_\_\_

Date Approved: \_\_\_\_\_

Permit Received By: Kandi Cote

Signature of Applicant: Anthony J. Procidia Date: 10-9-87

Signature of CEO: \_\_\_\_\_ Date: \_\_\_\_\_

Inspection Dates: \_\_\_\_\_

K. Taylor

PERMIT TO INSTALL PLUMBING

Address: APPLE LEDGE CONDO, 5 BUILDING NUMBER 2628

Installation For:

Owner of Bldg.:

Owner's Address:

Plumber: S. S. PLUMBING & HEATING Date: 1, Oct 1987

Date Issued  
Portland Plumbing Inspector  
By ERNOLD R. GOODWIN

App. First Insp.  
Date  
By

App. Final Insp.  
Date  
By

- Type of Bldg.
- Commercial
  - Residential
  - Single
  - Multi Family
  - New Construction
  - Remodeling

NEW	REPL	DESCRIPTION	NO.	FEES
		SINKS		
		LAVATORIES		
		TOILETS		
		BATH TUBS		
		SHOWERS	supplement to cover	
		DRAINS	FLOOR SURFACE	
		HOT WATER TANKS	Building fee	\$18.00
		TANKLESS WATER HEATERS		
		GARBAGE DISPOSALS		
		SEPTIC TANKS		
		HOUSE SEWERS	am	
		ROOF LEADERS		
		AUTOMATIC WASHERS	2519	
		DISHWASHERS		
		OTHER		
		TOTAL		\$18.00

Building and Inspection Services Dept. Plumbing Inspection



CITY OF PORTLAND, MAINE  
Department of Building Inspection

# Certificate of Occupancy

LOCATION **Loc 15 Applebae Circle**

Issued to **Anthony J. Procida**

Date of Issue **April 26, 1988**

This is to certify that the building, premises, or part thereof, at the above location, built—altered—changed as to use under Building Permit No. **87-1323**, has had final inspection, has been found to conform substantially to requirements of Zoning Ordinance and Building Code of the City, and is hereby approved for occupancy or use, limited or otherwise, as indicated below.

PORTION OF BUILDING OR PREMISES

APPROVED OCCUPANCY

**entire**

**single family dwelling with  
attached gar**

Limiting Conditions:

This certificate supersedes  
certificate issued

Approved:

Date: **4/26/88**

Inspector

*[Signature]*  
Inspector of Buildings

Notice: This certificate is for official use of building or premises, and ought to be transferred from owner to owner when property changes hands. Copy will be furnished to owner or lessee for one dollar.

PERMIT # 0013 CITY OF Portland BUILDING PERMIT APPLICATION MAP # \_\_\_\_\_ LOT# \_\_\_\_\_

Please fill out any part which applies to job. Proper plans must accompany form.

Owner: Anthony J. Frasca

Address: 119 Leister Drive, 04103

LOCATION OF CONSTRUCTION Lot #15 Ag. Acres Circle

CONTRACTOR: Steve Waspyzack SUBCONTRACTORS:

ADDRESS: Wasserville, ME

Est. Construction Cost: 95,000 Type of Use: single a

Post Use: residential

Building Dimensions: 12x36 Sq. Ft. 432 Stories: 2 Lot Size:

Is Proposed Use: Single-Family Condominium Apartment

Construction: Complete w/attached garage as per plans

COMPLETE ONLY IF THE NUMBER OF UNITS WILL CHANGE

Residential Building Only

# of Dwelling Units: \_\_\_\_\_ # of New Dwelling Units: \_\_\_\_\_

Foundation:

Type of Soil: \_\_\_\_\_

Set Backs: Front \_\_\_\_\_ Rear \_\_\_\_\_ Side(s) \_\_\_\_\_

Footings: Size \_\_\_\_\_

Foundation Size: \_\_\_\_\_

Other: \_\_\_\_\_

Floor:

1. Floor Size: \_\_\_\_\_ Sills must be anchor

2. Ceiling Size: \_\_\_\_\_

3. Column Spacing: 12' x 12' Spacing 16" O.C.

4. Joist Size: \_\_\_\_\_

5. Joist Type: \_\_\_\_\_ Size: \_\_\_\_\_

6. Floor Finishing Type: \_\_\_\_\_ Size: \_\_\_\_\_

7. Other Material: \_\_\_\_\_

Exterior Wall:

1. Siding Size: \_\_\_\_\_ Spacing \_\_\_\_\_

2. No. Windows: \_\_\_\_\_

3. No. Doors: \_\_\_\_\_

4. Header Size: \_\_\_\_\_ Spacing \_\_\_\_\_

5. Bracing: Yes  No

6. Corner Posts Size: \_\_\_\_\_

7. Insulation Type: \_\_\_\_\_ Size: \_\_\_\_\_

8. Sheathing Type: \_\_\_\_\_ Size: \_\_\_\_\_

9. Slab Type: \_\_\_\_\_ Weather Exposure: \_\_\_\_\_

10. Other Materials: \_\_\_\_\_

11. Metal Material: \_\_\_\_\_

12. Wall: \_\_\_\_\_

13. Siding: \_\_\_\_\_ Spacing \_\_\_\_\_

14. Header Size: \_\_\_\_\_ Spacing \_\_\_\_\_

15. Wall: \_\_\_\_\_

16. Other Material: \_\_\_\_\_

17. Other Material: \_\_\_\_\_

18. Other Material: \_\_\_\_\_

19. Other Material: \_\_\_\_\_

20. Other Material: \_\_\_\_\_

21. Other Material: \_\_\_\_\_

22. Other Material: \_\_\_\_\_

23. Other Material: \_\_\_\_\_

24. Other Material: \_\_\_\_\_

25. Other Material: \_\_\_\_\_

26. Other Material: \_\_\_\_\_

27. Other Material: \_\_\_\_\_

28. Other Material: \_\_\_\_\_

29. Other Material: \_\_\_\_\_

30. Other Material: \_\_\_\_\_

31. Other Material: \_\_\_\_\_

32. Other Material: \_\_\_\_\_

33. Other Material: \_\_\_\_\_

34. Other Material: \_\_\_\_\_

35. Other Material: \_\_\_\_\_

36. Other Material: \_\_\_\_\_

37. Other Material: \_\_\_\_\_

For Official Use Only	
Date: <u>October 9, 1987</u>	Subdivision: Yes <input type="checkbox"/> No <input type="checkbox"/>
Inside Fire Limits	Name: <u>FRANK LEONCO</u>
Blby Code	Lot
Time Limit	Block
Estimated Cost: <u>95,000</u>	Point Estimated
Value/Structure	Ownership
	Public
	Private

Ceiling:

- Ceiling Joists Size: \_\_\_\_\_ Spacing \_\_\_\_\_
- Ceiling Strapping Size: \_\_\_\_\_ Spacing \_\_\_\_\_
- Type Ceiling: \_\_\_\_\_
- Insulation Type: \_\_\_\_\_ Size \_\_\_\_\_
- Ceiling Height: \_\_\_\_\_

Roof:

- Truss or Rafter Size: \_\_\_\_\_ Span \_\_\_\_\_
- Sheathing Type: \_\_\_\_\_ Size \_\_\_\_\_
- Roof Covering Type: \_\_\_\_\_
- Other: \_\_\_\_\_

Chimneys:

Type: \_\_\_\_\_ Number of Fire Pl. con: \_\_\_\_\_

Heating:

Type of Heat: \_\_\_\_\_

Electrical:

Service Entrance Size: 100 Smoke Detector Required: Yes  No

Plumbing:

- Approval of soil test if required: Yes  No
- No. of Tubs or Showers: 1
- No. of Flushes: \_\_\_\_\_
- No. of Lavators: \_\_\_\_\_
- No. of Other Fixtures: \_\_\_\_\_

Swimming Pools:

- Type: \_\_\_\_\_
- Pool Size: \_\_\_\_\_ Square Feet: 15
- Must conform to National Electrical Code and State Law.

Zoning:

District: R-2 Street Frontage Req: \_\_\_\_\_

Required Setbacks: Front \_\_\_\_\_ Back \_\_\_\_\_ Side \_\_\_\_\_

Review Required:

Zoning Board Approval: Yes  No  Date: \_\_\_\_\_

Planning Board Approval: Yes  No  Date: \_\_\_\_\_

Conditional Use: \_\_\_\_\_ Variance: \_\_\_\_\_ Site Plan: \_\_\_\_\_ Subdivision: \_\_\_\_\_

Shore and Floodplain Mgmt: \_\_\_\_\_ Special Exception: \_\_\_\_\_

Other: \_\_\_\_\_ (Explain) \_\_\_\_\_

Date Approved: 10/15/87

Permit Received By: Kandi Cote

Signature of Applicant: Anthony Frasca Date: 10/9/87

Signature of CEO: \_\_\_\_\_ Date: \_\_\_\_\_

Inspection Dates: \_\_\_\_\_

PERMIT ISSUED WITH LETTER

PERMIT ISSUED

Lot 15 Applebee Circle (Bramblewood)

**PHOTOPLAN**

1980 Nothing yet.  
 11/13 - Formulation in without calling for maps. Sitbacks ok  
 12/21 - Estimating framed days ok  
 1/18/85 - Framing OK  
 4/05 - No access.  
 4/12 - "  
 4/14 - "  
 4/15 - "  
 4/19 - "  
 11/21/85 - for 4/2



**FEES (Breakdown From Front)**

Base Fee \$ 295.00  
 Subdivision Fee \$ \_\_\_\_\_  
 Site Plan Review Fee \$ \_\_\_\_\_  
 Other Fees \$ \_\_\_\_\_  
 (Explain) \_\_\_\_\_  
 Late Fee \$ \_\_\_\_\_

Type	Inspection Record	Date
_____	_____	_____
_____	_____	_____
_____	_____	_____
_____	_____	_____

**COMMENT**

\_\_\_\_\_  
 \_\_\_\_\_  
 \_\_\_\_\_  
 \_\_\_\_\_  
 \_\_\_\_\_  
 \_\_\_\_\_  
 \_\_\_\_\_  
 \_\_\_\_\_  
 \_\_\_\_\_  
 \_\_\_\_\_  
 \_\_\_\_\_

Signature of Applicant: *Anthony J. ...*

Date: \_\_\_\_\_

9



Applicant: *Anthony J. Procida 119 Kester Drive*  
Date: *Oct 7, 1987*

Address: *Lot #15 Bramblewood Drive*

Assessors No.: *Not assigned*

Contractor: *Steve Kasprzak*

CHECK LIST AGAINST ZONING ORDINANCE

Date -

Zone Location - *R-2 Residence*

Interior or corner lot - *Interior*

Use - *Single family w/ attached garage*

Sewage Disposal - *City*

Rear Yards - *30' 25' required*

Side Yards - *20' and 100' 14' required*

Front Yards - *45' 25' required*

Projections -

Height - *1 story*

Area - *159 sq ft.*

Building - *34' x 36' = 516' This breezeway = 120' w/ garage*

Area per family - *10,000 sq ft.*

Width of lot - *200'*

Lot Frontage - *72'*

Off-street Parking - *C.N.*

Loading Bays -

Site Plan -

Shoreland Zoning -

Flood Plains -

*Recent New  
subdivision*

NOT TO SCALE

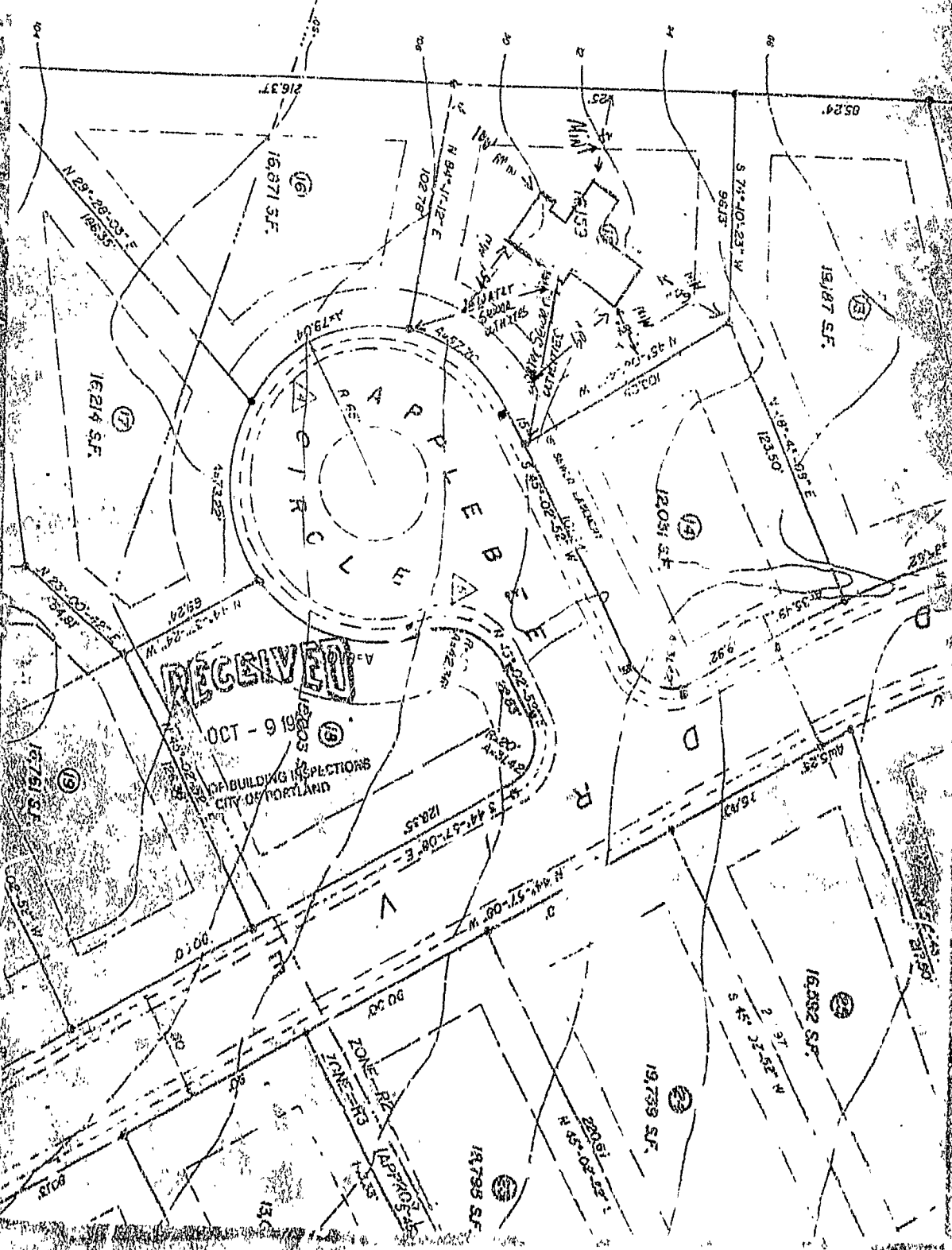



CITY OF PORTLAND, MAINE  
Department of Building Inspection

# Certificate of Occupancy

Issued to **Anthony J. Proutis**

LOCATION **Lot 15 Apples Circle**

Date of Issue **April 28, 1988**

This is to certify that the building, premises, or part thereof, at the above location, built, altered, changed as to use under Building Permit No. **87-1329**, has had final inspection, has been found to conform substantially to requirements of Zoning Ordinance and Building Code of the City, and is hereby approved for occupancy or use, limited or otherwise, as indicated below.

PORTION OF BUILDING OR PREMISES

PROVED OCCUPANCY

Limiting Conditions: **as is**

**single family dwelling with attached garage**

This certificate supersedes certificate issued

Approved:

*4/28/88 Ken Taylor*  
(Date) *Inspector*

*[Signature]*  
Inspector

Notice: This certificate identifies lawful use of building or premises, and ought to be transferred from owner to owner when property changes hands. Copy will be furnished to owner or trustee for due date.

*OP*  
*EAC*

City of Portland  
Parks/Public Works  
55 Portland Street  
Portland, Maine 04101

# FOR SUBMETER

FOR SEWER USEP CHARGE ADJUSTMENTS

The undersigned hereby requests permission to install additional water meter(s) in accordance with Section 322.60 of the "Municipal Code of the City of Portland, Maine".

It is understood that all expenses related to the purchase, installation and maintenance of the meter(s) is to be borne by the applicant.

## TO BE COMPLETED BY APPLICANTS

Address where sub-meter is requested Lot #15 Apple Bee Cir  
 Property owner's name ANTHONY J PROCIDA  
 Tax Map Reference (On Real Estate Tax Bill) (Extension 160)  
 Property owner's address 119 Lester Dr  
 Person to be contacted to schedule inspections: Same 797-9434  
(Name and Telephone Number)  
 Portland Water District Account No. (On bill) (PUSD 774-5961)  
 Billing Name & Address (On bill) ANTHONY J PROCIDA  
119 Lester Dr Portland Me  
(Not yet plumbed in as of 2/25/88)  
Location and size existing Portland Water District Service Meter \_\_\_\_\_

Proposed location and size of sub-meter 5/8" Sub-meter to be plumbed above main meter at feed line in basement floor at foot of basement stairs.  
Will a remote reading register be utilized? NO  YES (If yes, state location See sketch opposite side, top left.)

Description of proposed changes in plumbing required for sub-metering: Main meter, & sub-meter, to be plumbed as shown on back side, upper right hand corner (or equivalent).

The volume of water to be submetered can be shown not to enter the sewerage system by virtue of its use for: WATERING LAWN WASHING CAR EXTERIOR USE ONLY

I certify the above information is true and correct:

Anthony J Procida  
Signature

2-25-88  
Date

Revised 12-30-85

Sep. 19, 1989

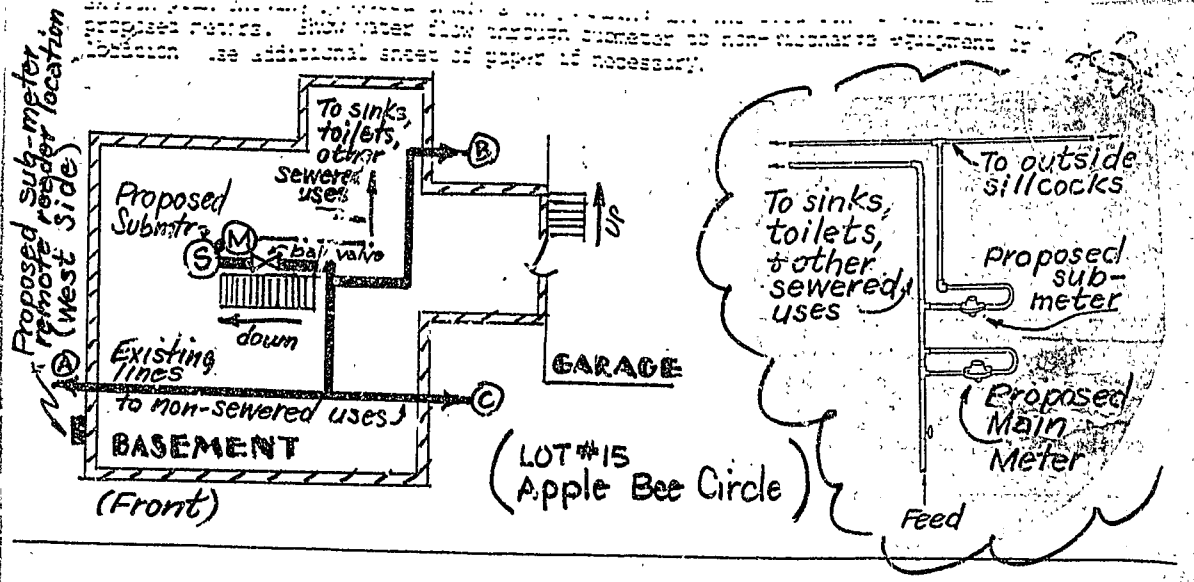

TO BE COMPLETED BY PUBLIC WORKS

Pre-installation inspection by Frank Brancely  
on February 25, 1988

Automatic reading system requested  YES  NO  
 Back Flow Preventers or equal shall have been installed on all three sillcocks (see below):

Application  Approved  Denied  
Comments All three sillcocks (A), (B), & (C) are Duraflo #58-10 in. anti-siphon / frost-proof sillcocks.

TO BE COMPLETED BY THE PLUMBING INSPECTOR

An inspection of the completed installation of the sub-metering system approved on this application was conducted on 9/18/89 by Ernold R. Goodwin, Chief Plumbing Inspector of the City of Portland.

- The sub-metering system was installed as approved
- No cross connections were found

The installation is  approved  dis-approved  
Ernold Goodwin  
098400

TO BE COMPLETED BY THE WATER DISTRICT

Date submeter sold 3/7/88  
Submeter account number 0-75-04844  
Submeter make and number 5/8 R #25410976  
Submeter installation readings 0931.00  
Submeter account entered into computer 9/19/89  
Submeter account entered into meter lock 9/19/89  
Special instructions \_\_\_\_\_