

to 315
Believe
in same
drive way

10 Mainway Rd
FANNIE MASCHINO
D. B. A.
MASCHINO & SONS LUMBER CO.
RFD #1 - BOX 519-C
NEW GLOUCESTER, MAINE 04260
Tel. 926-4288

781-3458
#03325
pd.

Customer's Order No. David Payne Date 6/30 19 86
Name Bud Newcomb
Address 436 Allen Ave.
City _____ State ME - 1986 ZIP _____

RECEIVED

SOLD BY CASH C.O.D. CHARGE ON ACCT DEPT. MOSE IN PAIR DEPT. CITY OF PORTLAND

QUAN.	DESCRIPTION	PRICE	AMOUNT
2x6	1/20 R	@.51	10.00
2x6	3/16 18/8 3/10 D45	@.25	55.50
2x4	4/10 7/8 D45	@.25	12.00
2x12	4/8 D45	@.35	22.40
2x10	7/8 D45	@.32	29.76
5x6	400 1/20 20/16 8/10	@.32	80.00
			209.66
		TAX	10.49

THANK YOU Please keep this copy for reference TOTAL 220.15

ALL CLAIMS AND RETURNED GOODS MUST BE ACCOMPANIED BY 10.50
+ 10.50 for Niles 230.65

Received By _____

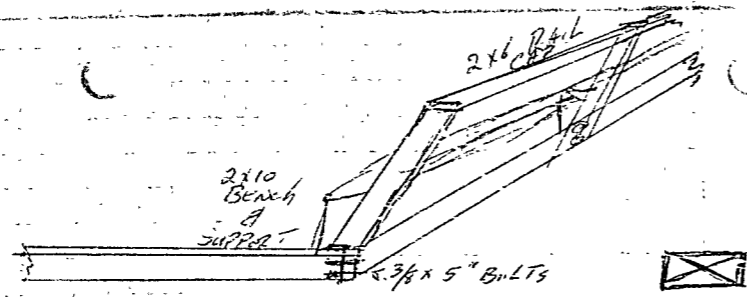

- MATERIAL LIST:**
- | | |
|----------------------------|-----------------------------------|
| FRAMING & RAFTS | RAILS - STAIRS & RAFTS |
| 1 - 2x6 x 20' | 4 - 2x4 x 10' |
| 3 - 2x6 x 16' | 4 - 2x4 x 8' |
| 18 - 2x6 x 8' | 4 - 2x12 x 8' |
| 3 - 2x6 x 10' | 7 - 2x10 x 8' |
| 10 - 3x8 x 36' | (Decking of 5/4 Spruce) |
| | (APPROX 380 LIN. FT.) |

House

RECEIVED
JUL 1 1986

DEPT OF BUILDING INSPECTIONS
CITY OF PORTLAND

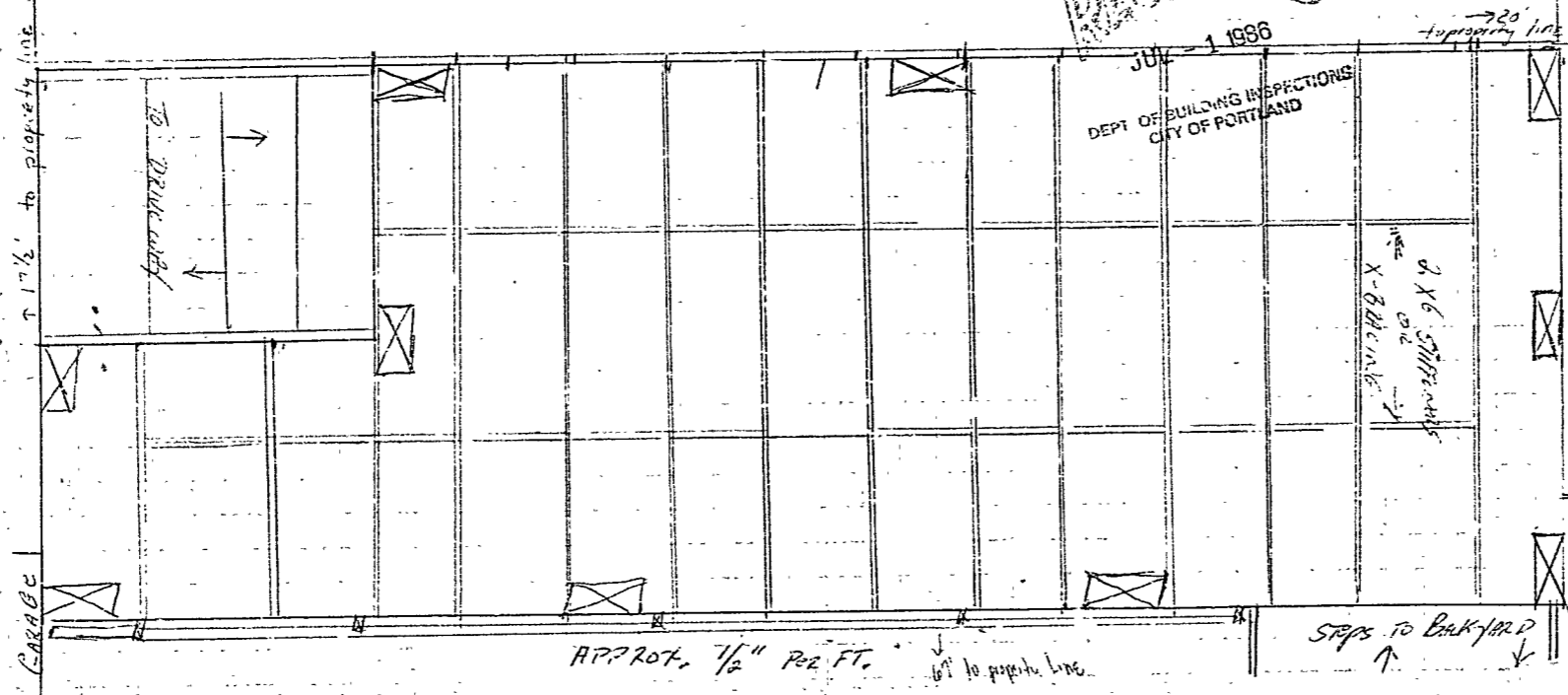

STEPS TO BACKYARD



CITY OF PORTLAND

DEPARTMENT OF PLANNING & URBAN DEVELOPMENT
INSPECTION SERVICES DIVISION

July 1, 1986

Mrs. Karen E. Payne
436 Allen Avenue
Portland, ME 04103

Re: 436 Allen Avenue

Dear Mrs. Payne:

deck A building permit for the garage which you propose to have built at 436 Allen Avenue by Lowell Newcomb of Falmouth, as contractor, can not be issued as you have not provided an adequate plot plan showing the location of the ~~garage~~ on the lot and its setbacks from the lot lines and the existing residence.

Please furnish a plot plan to aid us in reviewing this application for a building permit.

Sincerely,

Warren J. Turner

Warren J. Turner
Zoning Enforcement Inspector

WJT/jmr

cc: P. Samuel Hoffses, Chief of Inspection Services
Hugh Irving, Code Enforcement Officer

Pencil figures on attached sketch show setbacks in feet to property lines O.K. to issue 7/1/86

APPLICATION FOR PERMIT

PERMIT ISSUED

JUL 8 1986

B.O.C.A. USE GROUP

B.O.C.A. TYPE OF CONSTRUCTION 00848

ZONING LOCATION R-3 PORTLAND, MAINE ... July 1, 1986

City Of Portland

To the CHIEF OF BUILDING & INSPECTION SERVICES, PORTLAND, MAINE

The undersigned hereby applies for a permit to erect, alter, repair, demolish, move or install the following building, structure, equipment or change use in accordance with the Laws of the State of Maine, the Portland B.O.C.A. Building Code and Zoning Ordinance of the City of Portland with plans and specifications, if any, submitted herewith and the following specifications:

LOCATION 436 Allen Avenue Fire District #1 , #2

1. Owner's name and address David A. & Karen E. Payne - same Telephone 797-4731

2. Lessee's name and address

3. Contractor's name and address Lowell Newcomb - 10 Machigonne Rd. Telephone 781-3458

Proposed use of building dwelling No. of sheets No. families 1

Last use same No. families

Material No. stories Heat Style of roof Roofing

Other buildings on same lot

Estimated contractual cost \$ 350.00

FIELD INSPECTOR—Mr. Appeal Fees \$

@ 775-5451

Base Fee ... 25.00

Late Fee

TOTAL \$

To construct 8' x 19' open sun deck on rear of dwelling as per plans. 1 sheet of plans.

Stamp of Special Conditions

send permit to # 1 04103

NOTE TO APPLICANT. Separate permits are required by the installers and subcontractors of heating, plumbing, electrical and mechanicals.

DETAILS OF NEW WORK

Is any plumbing involved in this work? ... no Is any electrical work involved in this work? ... no
Is connection to be made to public sewer? If not, what is proposed for sewage?
Has septic tank notice been sent? Form notice sent?
Height average grade to top of plate Height average grade to highest point of roof
Material of foundation Thickness, top bottom cellar
Kind of roof Rise per foot Roof covering
No. of chimneys Material of chimneys of lining Kind of heat fuel
Framing Lumber--Kind Dressed or full size? Corner posts Sills
Size Girder Columns under girders Size Max. on centers
Studs (outside walls and carrying partitions) 2x4-16" O. C. Bridging in every floor and flat roof span over 8 feet.
Joists and rafters: 1st floor 2nd 3rd roof
On centers: 1st floor 2nd 3rd roof
* Maximum span: 1st floor 2nd 3rd roof
If one story building with masonry walls, thickness of walls? height?

IF A GARAGE

No. cars now accommodated on same lot to be accommodated number commercial cars to be accommodated
Will automobile repairing be done other than minor repairs to cars habitually stored in the proposed building?

APPROVALS BY: DATE
BUILDING INSPECTION--PLAN EXAMINER
ZONING: O.K. 9/10/86 July 2, 1986
BUILDING CODE:
Fire Dept.:
Health Dept.:
Others:

MISCELLANEOUS

Will work require disturbing of any tree on a public street?
Will there be in charge of the above work a person competent to see that the State and City requirements pertaining thereto are observed? YES

Signature of Applicant Karen E. Payne Phone # ... same

Type Name of above Karen E. Payne EX 2 3 4

Other and Address

FIELD INSPECTOR'S COPY

APPLICANT'S COPY

OFFICE FILE COPY

Handwritten initials and signature: (4) M.A. Irvine

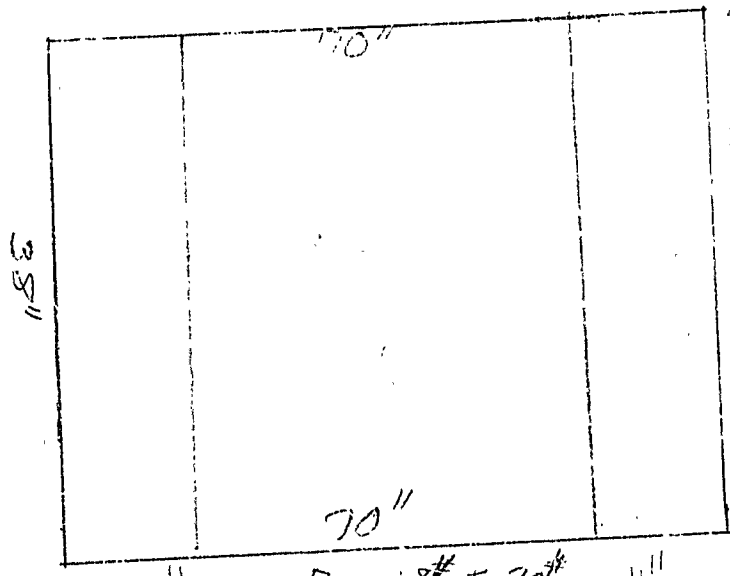

RECEIVED

SEP - 4 1985

DEPT. OF BUILDING INSPECTION'S
CITY OF PORTLAND