

103-109 Primrose Lane

PERMIT TO INSTALL PLUMBING

Address Lot #65 Primrose Lane PERMIT NUMBER 4070

Installation For 1 fam.

Owner of Bldg Pine Construction Co.

Owner's Address 25 Mechanic St., Gorham, Me.

Plumber William H. Willard Date 4-16-75

Box 100, Gorham, Me. P/O

Date Issued April 16, 1975

Portland Plumbing Inspector

By ARNOLD R. GOODWIN

Date APR 25 1975
ERNOLD R. GOODWIN

By CHIEF PLUMBING INSPECTOR

App. Final Insp.

Date AUG 21 1975
ERNOLD R. GOODWIN

By CHIEF PLUMBING INSPECTOR

Type of Bldg.

- Commercial
 Residential
 Single
 Multi Family
 New Construction
 Remodeling

NEW	REPL		P/O	FEE
1		SINKS	1	2.00
1		LAVATORIES	1	2.00
1		TOILETS	1	2.00
1		BATH TUBS	1	2.00
		SHOWERS		
		PAINS FLOOR SURFACE		
1		HOT WATER TANKS	1	2.00
		TAN/LESS WATER HEATERS		
1		GARAGE DISPOSALS	1	.60
		SEPTIC TANKS		
		HOUSE SEWERS		
		ROOF LEADERS		
1		AUTOMATIC WASHERS	1	.60
1		DISHWASHERS	1	.60
		O.H.R.		
		<u>Bills Fee</u>		<u>3.00</u>

TOTAL 8 14.80

Building and Inspection Services Dept.: Plumbing Inspection

(COPY)

CITY OF PORTLAND, MAINE
Department of Building Inspection



Certificate of Occupancy

LOCATION

Lot 65, Primrose Lane

Issued to Pine Construction Company

Date of Issue June 9, 1975

This is to certify that the building, premises, or part thereof, at the above location, built—altered—changed as to use under Building Permit No. 75/170, has had final inspection, has been found to conform substantially to requirements of Zoning Ordinance and Building Code of the City, and is hereby approved for occupancy or use, limited or otherwise, as indicated below.

PORTION OF BUILDING OR PREMISES

APPROVED OCCUPAN

entire

Limiting Conditions:

single family dwelling with attached garage.

none

This certificate supersedes certificate issued

Approved:

6/9/75

(Date)

Inspector

[Signature]
Inspector of Buildings

Notice: This certificate identifies lawful use of building or premises, and ought to be transferred from owner to owner when property changes hands. Copy will be furnished to owner or lessee for one dollar.



APPLICATION FOR PERMIT

PERMIT ISSUED

B.O.C.A. USE GROUP 0170

MAR 19 1975

B.O.C.A. TYPE OF CONSTRUCTION

ZONING LOCATION A-3 PORTLAND, MAINE, Mar. 17, 1975

CITY of PORTLAND

To the DIRECTOR OF BUILDING & INSPECTION SERVICES, PORTLAND, MAINE

The undersigned hereby applies for a permit to erect, alter, repair, demolish, move or install the following building, structure, equipment or change use in accordance with the Law of the State of Maine, the Portland B.O.C.A. Building Code and Zoning Ordinance of the City of Portland with plans and specifications, if any, submitted herewith and the following specifications:

LOCATION Lot 65, Primrose Lane Fire District #1, #2
1. Owner's name and address Pine Construction Co., 25 Mechanic St, Gorham Telephone 339-6711
2. Lessee's name and address
3. Contractor's name and address same Telephone
4. Architect Specifications Plans YES No. of sheets 7
Proposed use of building single family dwelling w/ rear attached garage No. families 1
Last use No. families
Material frame No. stories 1 Heat Style of roof Roofing
Other buildings on same lot
Estimated contractual cost \$23,000.00 Fee \$ 92.00

FIELD INSPECTOR—Mr Ray Reitze GENERAL DESCRIPTION
This application is for @ 773-5451 to construct a dwelling per plan, two 9' openings
Dwelling Ext. 234 with 4x10 headers over garage openings.
Garage
Masonry Bldg. Stamp of Special Conditions
Metal Bldg.
Alterations
Demolitions
Change of Use
Other

NOTE TO APPLICANT: Separate permits are required by the installers and subcontractors of heating, plumbing, electrical and mechanicals.

PERMIT IS TO BE ISSUED TO 1x 2 3 4

Other:

DETAILS OF NEW WORK

Is any plumbing involved in this work? yes Is any electrical work involved in this work? yes
Is connection to be made to public sewer? If not, what is proposed for sewage?
Has septic tank notice been sent? Form notice sent?
Height average grade to top of plate 9' Height average grade to highest point of roof 14'
Size, front 44'8" depth 25'8" No. stories 1 solid or filled land? solid earth or rock? earth
Material of foundation conc Thickness, top 10 bottom 10 cellar yes
Kind of roof pitch Rise per foot 4/12 Roof covering asphalt shingles
No. of chimney 1 Material of chimneys bf of lining tile Kind of heat electric fuel
Framing Lumber—Kind spruce Dressed or full size? yes Corner posts 4x6 Sills 2x6 box
Size Girder 6x10 Columns under girders lally Size 3 1/2 Max. on centers 8'
Studs (outside walls and carrying partitions) 2x4-16" O. C. Bridging in every floor and flat roof span over 8 feet.
Joists and rafters: 1st floor 2x10 2nd 3rd roof truss
On centers. 1st floor 16" 2nd 3rd roof FS Plumber 24"
Maximum span: 1st floor 3 3/4 2nd 3rd roof

IF A GARAGE
No. cars to be accommodated on same lot to be accommodated number commercial cars to be accommodated
Will automobile repairing be done other than minor repairs to cars habitually stored in the proposed building?

APPROVALS BY: DATE MISCELLANEOUS
BUILDING INSPECTION—PLAN EXAMINER Will work require disturbing of any tree on a public street?
ZONING: O.K. M.E.W. 3/18/75
BUILDING CODE: O.K. E.R. 3/11/75 Will there be in charge of the above work a person competent to see that the State and City requirements pertaining hereto are observed? yes
Fire Dept.:
Health Dept.:
Others:

Signature of Applicant Robert M. Chene Phone # 839-6711

Type Name of above 1x 2 3 4

Other and Address

FIELD INSPECTOR'S COPY

DATE: 3-27-75

NOTES

FORM INSPECTION

3-27-75 FORM INSPECTION GAVE OK
TO THE FOSTER R. BEITZ

April 15 - 1975 work on
road to bridge

May 1 - 1975 " " R. Beitz

May 22 - 1975
work nearly finished

June 3 - 1975 " " R. Beitz

June 7 - 1975 work finished all work
of the area C of D
R. Beitz

c/o mailed 6/9/75
Russ

Approved

Date of permit

Owner

Location

Permit No.

75/1170
1265 Lawrence Ave
R. Beitz
3/19/75

Handwritten signature/initials

PERMIT ISSUED

MAR 19 1975

CITY of PORTLAND

Lot 65
Primrose Lane

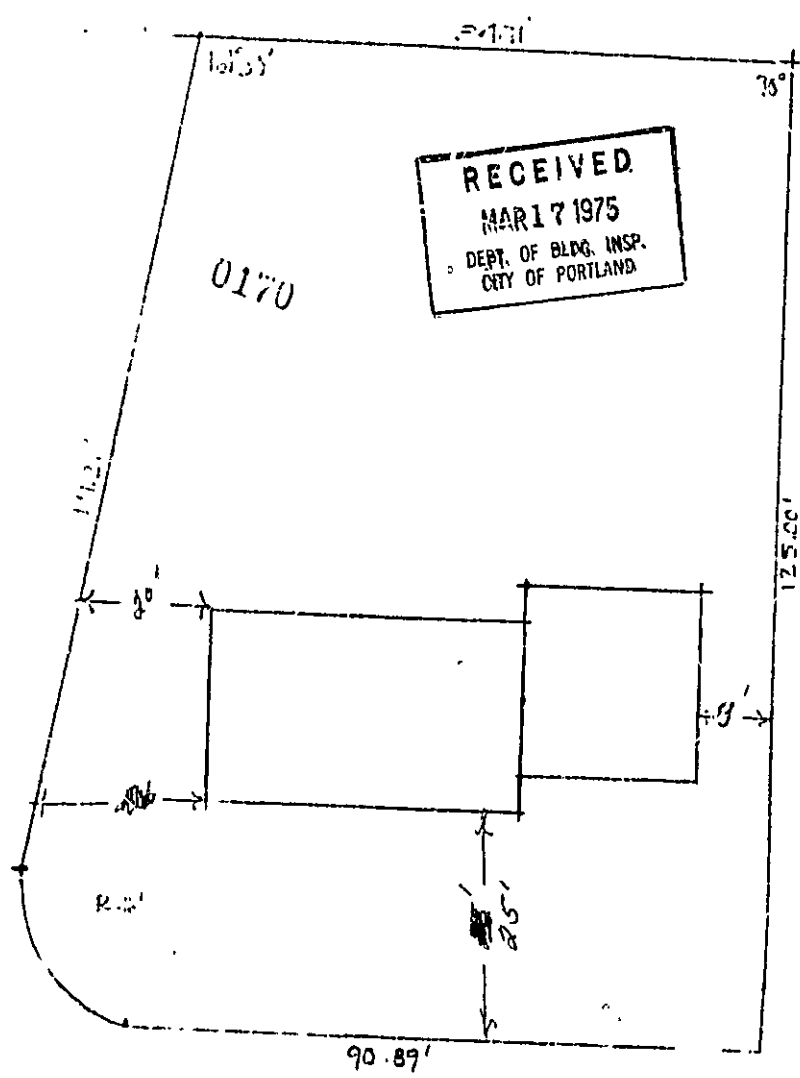

RECEIVED
MAR 17 1975
DEPT. OF BLDG. INSP.
CITY OF PORTLAND

0170

PRIMROSE LA.

1"=20'

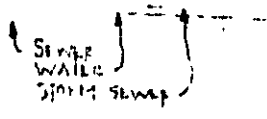

CITY OF PORTLAND, MAINE

Application for Permit to Install Wires

Permit No. **2751**
 Issued **4/25**, 19**25**
 Portland, Maine

To the City Electrician, Portland, Maine:

The undersigned hereby applies for a permit to install wires for the purpose of conducting electric current, in accordance with the laws of Maine, the Electrical Ordinance of the City of Portland, and the following specifications:

(This form must be completely filled out: - Minimum Fee, \$1.00)

Owner's Name and Address *Hamm* Tel.
 Contractor's Name and Address *Al. Ames* Tel. *774-0604*
 Location *705 Business La.* Use of Building *Res.*
 Number of Families *1* Apartments Stores Number of Stories
 Description of Wiring: New Work Additions Alterations

Pipe ... Cable Metal Molding BX Cable Plug Molding (No. of feet)
 No. Light Outlets *16* Plugs *20* Light Circuits *3* Plug Circuits *4*
 FIXTURES: No. *16* Fluor. or Strip Lighting (No. feet)
 SERVICE: Pipe Cable Underground No. of Wires *3* Size *4/4*
 METERS: Relocated Added Total No. Meters
 MOTORS: Number Phase H. P. Amps Volts Starter
 HEATING UNITS: Domestic (Oil) No. Motors Phase H. P.
 Commercial (Oil) No. Motors Phase H. P.
 Electric Heat (No. of Rooms) *5*
 APPLIANCES: No. Ranges *1* Watts *2500* Brand Feeds (Size and No.) *6/3*
 Elec. Heaters *1* Watts *4500*
 Miscellaneous Watts Extra Cabinets or Panels
 Transformers Air Conditioners (No. Units) Signs (No. Units)
 Will commence *19* Ready to cover in *4/28* 19**25** Location *19*
 Amount of Fee \$ *11.75* Signed *Al. Ames*

DO NOT WRITE BELOW THIS LINE

SERVICE	METER	GROUND
VISITS: 1 <i>4-28-25</i>	2 <i>4-29-25</i>	3
4	5	6
7	8	9
10	11	12

REMARKS:

CLOSE IN
CRACKED IN

INSPECTED BY *[Signature]*

(OVER)