



Location, ownership and detail must be correct, complete and legible. Separate application required for every building. Plans must be filed with this application.

## APPLICATION FOR PERMIT TO BUILD

(3D CLASS BUILDING)

Portland Me., August 28, 1918 19

To THE INSPECTOR OF BUILDINGS:

The undersigned hereby applies for a permit to build, according to the following Specifications:—

Location Lots 37 - 41 Deering Terrace (Off Forest Ave.) Wd. 3

Name of owner is? W. P. Durrell Address 57 Allen Ave.

Name of mechanic is? Omer " " " "

Name of architect is? " " " "

Proposed occupancy of building (purpose)? dwelling

If a dwelling or tenement house, for how many families? 270

Are there to be stores in lower story? No.

Size of lot, No. of feet front? 30; No. of feet rear? " " " " ; No. of feet deep? 90

Size of building, No. of feet front? 20; No. of feet rear? " " " " ; No. of feet deep? 24

No. of stories, front? 1 1/2; rear? " " " "

No. of feet in height from the mean grade of street to the highest part of the roof? 15 ft.

Distance from lot lines, front? " " " " feet; side? " " " " feet; rear? " " " " feet

Firestop to be used? Yes (wood)

Will the building be erected on solid or filled land? solid

Will the foundation be laid on earth, rock, or piles? " " " "

If on piles, No. of rows? " " " " distance on centres? " " " " length of? " " " "

Diameter, top of? " " " " diameter, bottom of? " " " "

Size of posts? 4 x 6 Bills 4 x 8 Studding 2 x 4 16" O.C. Roof rafters 2 x 6 24" O.C.

" girts? two 2 x 4 Girder 6 x 8

" floor timbers? 1st floor 2 x 8 2d " " " " 3d " " " " 4th " " " "

O. C. " " " " 16" " " " " " " " "

Span " " " " " " " " " " " " " "

Braces, how put in? " " " " " " " "

Building, how framed? " " " " " " " "

Material of foundation? posts thickness of? " " " " laid with mortar? " " " "

Underpinning, material of? " " " " height of? " " " " thickness of? " " " "

Will the roof be flat, pitch, mansard, or hip? pitch Material of roofing? Asphalt

Will the building be heated by steam, furnaces, stoves or grates? no yes Will the flues be lined? Yes

Will the building conform to the requirements of the law? Yes

No. of brick walls? " " " " and where placed? " " " "

Means of egress? " " " " " " " "

PERMIT MUST BE RECEIVED BEFORE BEGINNING WORK.

Plans must be submitted in duplicate, one set to be filed with the Department and the duplicate set thereof (bearing the approval of the Inspector of Buildings) shall be kept on the work and exhibited on demand.

If the building is to be occupied as a Tenement House, give the following particulars:

What is the height of cellar or basement? " " " "

What will be the clear height of first story? " " " " second? " " " " third? " " " "

State what means of egress is to be provided? " " " " " " " "

Scuttle and step ladder to roof? " " " "

Estimated Cost, \$ 700.00 Signature of owner or authorized representative, W. P. Durrell

Address, " " " "

Plans submitted? " " " " Received by? " " " "



Location, Ownership and detail must be correct, complete and legible.  
 Separate application required for every building.  
 Plans must be filed with this application.

## Application for Permit for Alterations, etc.

Portland, Me. May 24, 1924 19

To the

INSPECTOR OF BUILDINGS:

The undersigned applies for a permit to alter the following described building:—

Description of Present Bldg.

Location lot 37 Aldworth Street Ward 9 in fire-limits? no  
 Name of Owner or Lessee, A T Vanstrom Address Aldworth Street  
 " " Contractor, owner " "  
 " " Architect, " "  
 Material of Building is wood Style of Roof, pitch Material of Roofing, shingle  
 Size of Building is 24ft feet long; 20ft feet wide. No. of Stories, 1 1/2  
 Cellar Wall is constructed of posts is \_\_\_\_\_ inches wide on bottom and batters to \_\_\_\_\_ inches on top.  
 Underpinning is \_\_\_\_\_ is \_\_\_\_\_ inches thick; is \_\_\_\_\_ feet in height.  
 Height of Building 15ft Wall, if Brick; 1st, \_\_\_\_\_ 2d, \_\_\_\_\_ 3d, \_\_\_\_\_ 4th, \_\_\_\_\_ 5th, \_\_\_\_\_  
 What was Building last used for? dwelling No. of Families? 1  
 What will Building now be used for? dwelling & family

PERMIT MUST BE OBTAINED BEFORE BEGINNING WORK

### Detail of Proposed Work

Put in concrete foundation all to comply with the building ordinance.

Estimated Cost \$ 150.

### If Extended On Any Side

Size of Extension, No. of feet long? \_\_\_\_\_; No. of feet wide? \_\_\_\_\_; No. of feet high above sidewalk? \_\_\_\_\_  
 No. of Stories high? \_\_\_\_\_; Style of Roof? \_\_\_\_\_; Material of Roofing? \_\_\_\_\_  
 Of what material will the Extension be built? \_\_\_\_\_ Foundation? \_\_\_\_\_  
 If of Brick, what will be the thickness of External Walls? \_\_\_\_\_ inches; and Party Walls \_\_\_\_\_ inches.  
 How will the extension be occupied? \_\_\_\_\_ How connected with Main Building? \_\_\_\_\_

### When Moved, Raised or Built Upon

No. of Stories in height when Moved, Raised, or Built upon? \_\_\_\_\_ Proposed Foundations \_\_\_\_\_  
 No. of feet high from level of ground to highest part of Roof to be? \_\_\_\_\_  
 How many feet will the External Walls be increased in height? \_\_\_\_\_ Party Walls \_\_\_\_\_

### If Any Portion of the External or Party Walls Are Removed

Will an opening be made in the Party or External Walls? \_\_\_\_\_ in \_\_\_\_\_ Story.  
 Size of the opening? \_\_\_\_\_ How protected? \_\_\_\_\_  
 How will the remaining portion of the wall be supported? \_\_\_\_\_

Signature of Owner or  
 Authorized Representative

Address

A. T. Vanstrom  
Aldworth St.

1622

10  
X



**YOU!**  
Responsible for complying  
with the law, whether you  
know the requirements or not  
**READ!**

Location, Ownership and detail must be correct, complete and legible.  
Separate application required for every building.  
Plans must be filed with this application.

### Application for Permit for Alterations, etc.

Portland, Me., Sept. 9, 1926

This Application and  
Get All Questions Settled  
To the Commanding Work  
INSPECTOR OF BUILDINGS:

The undersigned applies for a permit to alter the following described building:—  
Location Aldworth St. Ward 9 in fire-limits? No.

Description of Present Bldg.

Name of Owner ##### A. T. Vanstrom Address Aldworth St.  
" " Contractor, OWNER " "  
" " Architect, " "  
Material of Building is Wood Style of Roof, " Material of Roofing, "  
Size of Building is " feet long; " feet wide. No. of Stories, "  
Cellar Wall is constructed of " is " inches wide on bottom and batters to " inches on top.  
Underpinning is " is " inches thick; is " feet in height.  
Height of Building " Wall, if Brick; 1st, " 2d, " 3d, " 4th, " 5th, "  
What was Building last used for? Dwelling No. of Families? One  
What will Building now be used for? One Family Dwelling.

#### Detail of Proposed Work

Build one story piazza 7ft. x 24 ft. with roof over end  
front steps, all to complt. with the building ordinance.

Estimated Cost \$ 125.00

#### If Extended On Any Side

Size of Extension, No. of feet long? " ; No. of feet wide? " ; No. of feet high above sidewalk? "  
No. of Stories high? " ; Style of Roof? " ; Material of Roofing? "  
Of what material will the Extension be built? " Foundation? "  
If of Brick, what will be the thickness of External Walls? " inches; and Party Walls " inches.  
How will the extension be occupied? " How connected with Main Building? "

#### When Moved, Raised or Built Upon

No. of Stories in height when Moved, Raised, or Built upon? " Proposed Foundations? "  
No. of feet high from level of ground to highest part of Roof to be? " Party Walls "  
How many feet will the External Walls be increased in height? "

#### If Any Portion of the External or Party Walls Are Removed

Will an opening be made in the Party or External Walls? " in " Story.  
Size of the opening? " How protected? "  
How will the remaining portion of the wall be supported? "

Signature of Owner or  
Authorized Representative

A. T. Vanstrom

Address

PERMIT MUST BE OBTAINED BEFORE BEGINNING WORK

32d  
1



# APPLICATION FOR PERMIT

Class of Building or Type of Structure Third Class

Portland, Maine, October 24, 1929

Permit No. 2258  
PERMIT ISSUED

To the INSPECTOR OF BUILDINGS, PORTLAND, ME.

The undersigned hereby applies for a permit to ~~erect~~ alter ~~in accordance with the Laws of the State of Maine, the Building Code of the City of Portland, plans and specifications, if any, submitted herewith and the following specifications:~~ the following building ~~structure~~ ~~equipment~~ in accordance with the Laws of the State of Maine, the Building Code of the City of Portland, plans and specifications, if any, submitted herewith and the following specifications:

Location Lot #38 Aldworth Street Ward 9 Within Fire Limits? no Dist. No. \_\_\_\_\_

Owner's or Lessee's name and address A. T. Vanstrom Lot #38 Aldworth Street Telephone \_\_\_\_\_

Contractor's name and address \_\_\_\_\_ Telephone \_\_\_\_\_

Architect's name and address \_\_\_\_\_

Proposed use of building dwelling No. families 1

Other building: on same lot \_\_\_\_\_

### Description of Present Building to be Altered

Material wood No. stories 1 1/2 Heat \_\_\_\_\_ Style of roof pitch Roofing \_\_\_\_\_

Last use dwelling No. families 1

### General Description of New Work

To enclose existing rear porch, the major portion of the enclosure to be of glass. This porch is at least 10' from the side property line, and at least 20' from the rear property line. The porch with the roof over it was existing December 26th, 1926.

APPLICATION BEFORE LATHING OR CLOSING IS WAIVED  
CERTIFICATE OF REQUIREMENTS

### Details of New Work

Size, front \_\_\_\_\_ depth \_\_\_\_\_ No. stories \_\_\_\_\_ Height average grade to highest point of roof \_\_\_\_\_

To be erected on solid or filled land? solid earth or rock? earth

Material of foundation \_\_\_\_\_ Thickness, top \_\_\_\_\_ bottom \_\_\_\_\_

Material of underpinning \_\_\_\_\_ Height \_\_\_\_\_ Thickness \_\_\_\_\_

Kind of roof \_\_\_\_\_ Roof covering \_\_\_\_\_

No. of chimneys \_\_\_\_\_ Material of chimneys \_\_\_\_\_ of lining \_\_\_\_\_

Kind of heat \_\_\_\_\_ Type of fuel \_\_\_\_\_ Distance, heater to chimney \_\_\_\_\_

If oil burner, name and model \_\_\_\_\_

Capacity and location of oil tanks \_\_\_\_\_

Is gas fitting involved? \_\_\_\_\_ Size of service \_\_\_\_\_

Corner posts \_\_\_\_\_ Sills \_\_\_\_\_ Girt or ledger board? \_\_\_\_\_ Size \_\_\_\_\_

Material columns under girders \_\_\_\_\_ Size \_\_\_\_\_ Max. on centers \_\_\_\_\_

Studs (outside walls and carrying partitions) 2x4-16" O. C. Girders 6x8 or larger. Bridging in every floor and flat roof span over 8 feet. Sills and corner posts all one piece in cross section.

Joists and rafters: 1st floor \_\_\_\_\_, 2nd \_\_\_\_\_, 3rd \_\_\_\_\_, roof \_\_\_\_\_

On centers: 1st floor \_\_\_\_\_, 2nd \_\_\_\_\_, 3rd \_\_\_\_\_, roof \_\_\_\_\_

Maximum span: 1st floor \_\_\_\_\_, 2nd \_\_\_\_\_, 3rd \_\_\_\_\_, roof \_\_\_\_\_

If one story building with masonry walls, thickness of walls? \_\_\_\_\_ height? \_\_\_\_\_

### If a Garage

No. cars now accommodated on same lot \_\_\_\_\_, to be accommodated \_\_\_\_\_

Total number commercial cars to be accommodated \_\_\_\_\_

Will automobile repairing be done other than minor repairs to cars habitually stored in the proposed building? \_\_\_\_\_

### Miscellaneous

Will above work require removal or disturbing of any shade tree on a public street? no

Plans filed as part of this application? no No. sheets \_\_\_\_\_

Estimated cost \$ 20 Fee \$ .25

Will there be in charge of the above work a person competent to see that the State and City requirements pertaining thereto are observed? yes

Signature of owner A. T. Vanstrom

INSPECTION COPY

517 AC



(R) GENERAL RESIDENCE ZONE  
APPLICATION FOR PERMIT

Permit No.

1530

Class of Building or Type of Structure Third

Portland, Maine, Sept. 18, 1975

To the INSPECTOR OF BUILDINGS, PORTLAND, ME.

The undersigned hereby applies for a permit to erect alter install the following building structure equipment in accordance with the Laws of the State of Maine, the Building Code of the City of Portland, plans and specifications, if any, submitted herewith and the following specifications:

Location 60 Aldworth St. Ward 9 Within Fire Limits? no Dist. No. \_\_\_\_\_  
Owner's or Lessee's name and address Samuel McKenzie 60 Aldworth St. Telephone \_\_\_\_\_  
Contractor's name and address Arthur Emery 48 Aldworth St. Telephone no  
Architect's name and address \_\_\_\_\_  
Proposed use of building 1 car garage No. families \_\_\_\_\_  
Other buildings on same lot dwelling house  
Plans filed as part of this application? yes No. of sheets 1  
Estimated cost \$ 75. Fee \$ .50

Description of Present Building to be Altered

Material \_\_\_\_\_ No. stories \_\_\_\_\_ Heat \_\_\_\_\_ Style of roof \_\_\_\_\_ Roofing \_\_\_\_\_  
Last use \_\_\_\_\_ No. families \_\_\_\_\_

General Description of New Work

To erect 1 car frame garage 12'-0" x 18'-0"  
4"x10" H.P. on edge 18'-0" through center to carry roof.

CERTIFICATE OF OCCUPANCY  
REQUIREMENT IS WAIVED

It is understood that this permit does not include installation of heating apparatus which is to be taken out separately by and in the name of the heating contractor.

Details of New Work

Size, front 12'-0" depth 18'-0" No. stories 1 Height average grade to top of plate 8'-0"  
Height average grade to highest point of roof 9'-3"  
To be erected on solid or filled land? solid earth or rock? earth  
Material of foundation below frost 3x3 hard pine posts Thickness, top \_\_\_\_\_ bottom \_\_\_\_\_  
Material of underpinning \_\_\_\_\_ Height \_\_\_\_\_ Thickness \_\_\_\_\_  
Kind of Roof Flat (shed) Rise per foot 1 1/2" Roof covering alt roll class C under. 1st.  
No. of chimneys none Material of chimneys \_\_\_\_\_ of lining \_\_\_\_\_  
Kind of heat none Type of fuel \_\_\_\_\_ Is gas fitting involved? \_\_\_\_\_  
Corner posts 4x6 Sills 3x6 Girt or ledger board? \_\_\_\_\_ Size \_\_\_\_\_  
Material columns under girders \_\_\_\_\_ Size \_\_\_\_\_ Max. on centers \_\_\_\_\_  
Studs (outside walls and carrying partitions) 2x4-16" O. C. Girders 6x8 or larger. Bridging in every floor and flat roof  
span over 8 feet. Sills and corner posts all one piece in cross section.  
Joists and rafters: 1st floor girt, 2nd \_\_\_\_\_, 3rd \_\_\_\_\_, roof 2x4  
On centers: 1st floor \_\_\_\_\_, 2nd \_\_\_\_\_, 3rd \_\_\_\_\_, roof \_\_\_\_\_  
Maximum span: 1st floor \_\_\_\_\_, 2nd \_\_\_\_\_, 3rd \_\_\_\_\_, roof 14'  
If one story building with masonry walls, thickness of walls? \_\_\_\_\_ height? \_\_\_\_\_

If a Garage

No. cars now accommodated on same lot none, to be accommodated 1  
Total number commercial cars to be accommodated none  
Will automobile repairing be done other than minor repairs to cars habitually stored in the proposed building? none

Miscellaneous

Will above work require removal or disturbing of any shade tree on a public street? \_\_\_\_\_  
Will there be in charge of the above work a person competent to see that the State and City requirements pertaining thereto are observed? \_\_\_\_\_

INSPECTION COPY

Signature of owner

Samuel McKenzie

CHIEF OF FIRE DEPT.

Arthur Emery

5315274



Original Permit No. 85/1880

Amendment No. PERMIT ISSUED

### AMENDMENT TO APPLICATION FOR PERMIT

To the INSPECTOR OF BUILDINGS, PORTLAND, ME.

Portland, Maine, Sept. 25, 1916

The undersigned hereby applies for an amendment to Permit No. 85/1880 pertaining to the building or structure comprised in the original application in accordance with the Laws of the State of Maine, the Building Code of the City of Portland, plans and specifications if any, submitted herewith, and the following specifications:

Location 80 Aldworth Street Ward 9 With the Fire Limits? YES No. Dist. No.

Owner's or Lessee's name and address Samuel McKenzie, 80 Aldworth Street

Contractor's name and address Arthur Emery, 45 Aldworth Street

Plans filed as part of this Amendment No No. of Sheets         

Increased cost of work          Additional fee .25

#### Description of Proposed Work

To change floor from dirt to wood with 6 x 8 girder on 8' span and 4 x 6 floor timbers 16" on centers on 9' spca.

Approved:

Signature of Owner Samuel McKenzie

Arthur Emery



# APPLICATION FOR PERMIT

Class of Building or Type of Structure Third Class

Portland, Maine, August 27, 1969

PERMIT ISSUED  
838

SEP 2 1969

CITY of PORTLAND

To the INSPECTOR OF BUILDINGS, PORTLAND, MAINE

The undersigned hereby applies for a permit to erect alter repair demolish install the following building structure equipment in accordance with the Laws of the State of Maine, the Building Code and Zoning Ordinance of the City of Portland, plans and specifications, if any, submitted herewith and the following specifications:

Location 60 Aldworth Street Within Fire Limits? \_\_\_\_\_ Dist. No. \_\_\_\_\_  
 Owner's name and address Barry E. Curtis, 60 Aldworth Street Telephone \_\_\_\_\_  
 Lessee's name and address \_\_\_\_\_ Telephone \_\_\_\_\_  
 Contractor's name and address owner Telephone \_\_\_\_\_  
 Architect \_\_\_\_\_ Specifications \_\_\_\_\_ Plans yes No. of sheets 2  
 Proposed use of building 2 car garage No. families \_\_\_\_\_  
 Last use \_\_\_\_\_ No. families \_\_\_\_\_  
 Material \_\_\_\_\_ No. stories \_\_\_\_\_ Heat \_\_\_\_\_ Style of roof \_\_\_\_\_ Roofing \_\_\_\_\_  
 Other buildings on same lot dwelling  
 Estimated cost \$ 2000. Fee \$ 6.00

### General Description of New Work

To construct 2-car frame garage 24'x24'

To demolish existing 1-car frame garage

10' opening -  
Lx8 header - gable end

It is understood that this permit does not include installation of heating apparatus which is to be taken out separately by and in the name of the heating contractor. **PERMIT TO BE ISSUED TO** owner

### Details of New Work

Is any plumbing involved in this work? \_\_\_\_\_ Is any electrical work involved in this work? \_\_\_\_\_  
 Height average grade to top of plate 10'6" Height average grade to highest point of roof 14'  
 Size, front 24' depth 24' No. stories 1 solid or filled land? solid earth or rock? earth  
 Material of foundation concrete slab Thickness, top \_\_\_\_\_ bottom \_\_\_\_\_ cellar \_\_\_\_\_  
 Material of underpinning \_\_\_\_\_ Height \_\_\_\_\_ Thickness \_\_\_\_\_  
 Kind of roof pitch Rise per foot \_\_\_\_\_ Roof covering asphalt roofing Class C Und. Lab.  
 No. of chimneys \_\_\_\_\_ Material of chimneys \_\_\_\_\_ of lining \_\_\_\_\_ Kind of heat \_\_\_\_\_ fuel \_\_\_\_\_  
 Framing lumber—Kind hemlock Dressed or full size? dressed  
 Corner posts 4x6 Sills 4x4 6 Girt or ledger board? \_\_\_\_\_ Size \_\_\_\_\_  
 Girders \_\_\_\_\_ Size \_\_\_\_\_ Columns under girders \_\_\_\_\_ Size \_\_\_\_\_ Max. on centers \_\_\_\_\_  
 Studs (outside walls and carrying partitions) 2x4-24" O. C. Bridging in every floor and flat roof span over 8 feet.  
 Joists and rafters: 1st floor concrete, 2nd \_\_\_\_\_, 3rd \_\_\_\_\_, roof truss  
 On centers: 1st floor \_\_\_\_\_, 2nd \_\_\_\_\_, 3rd \_\_\_\_\_, roof \_\_\_\_\_  
 Maximum span: 1st floor \_\_\_\_\_, 2nd \_\_\_\_\_, 3rd \_\_\_\_\_, roof \_\_\_\_\_  
 If one story building with masonry walls, thickness of walls? \_\_\_\_\_ height? \_\_\_\_\_

### If a Garage

No. cars now accommodated on same lot 1, to be accommodated 2 number commercial cars to be accommodated 0  
Will automobile repairing be done other than minor repairs to cars habitually stored in the proposed building? no

APPROVED:

O.K. E.S.S. 8/28/69

### Miscellaneous

Will work require disturbing of any tree on a public street? no  
Will there be in charge of the above work a person competent to see that the State and City requirements pertaining thereto are observed? yes

INSPECTION COPY

Signature of owner

Barry E Curtis

PH

PERMIT TO INSTALL PLUMBING

1722 Foster  
PERMIT NUMBER 720

Date Issued **September 16, 1969**

Portland Plumbing Inspector  
By **ERNOLD R. GOODWIN**

App. First Insp.  
Date **9/17/69**  
By **WALTER H. WALLACE**  
DEPUTY PLUMBING INSPECTOR

App. Final Insp.  
Date **9/16/69**  
By **WALTER H. WALLACE**  
DEPUTY PLUMBING INSPECTOR

- Type of Bldg.
- Commercial
  - Residential
  - Single
  - Multi Family
  - New Construction
  - Remodeling

Address **60 Aldworth St.**  
 Installation For: **dwelling**  
 Owner of Bldg.: **Katherine Curtis**  
 Owner's Address: **same** Date: **9/16/69**  
 Plumber: **Jose L. Luby 8 Merrill Rd. Palm Beach, Fla.** NO. **9/16/69**

NEW	REPL			
			SINKS	
			LAVATORIES	
			TOILETS	
			BATH TUBS	
			SHOWERS	
			DRAINS FLOOR SURFACE	
			HOT WATER TANKS	
			TANKLESS WATER HEATERS	
			GARBAGE DISPOSALS	
		<b>1</b>	SEPTIC TANKS	<b>2.00</b>
			HOUSE SEWERS	
			ROOF LEADERS	
			AUTOMATIC WASHERS	
			DISHWASHERS	
			OTHER	
				<b>TOTAL 1 2.00</b>

Building and Inspection Services Dept.: Plumbing Inspection



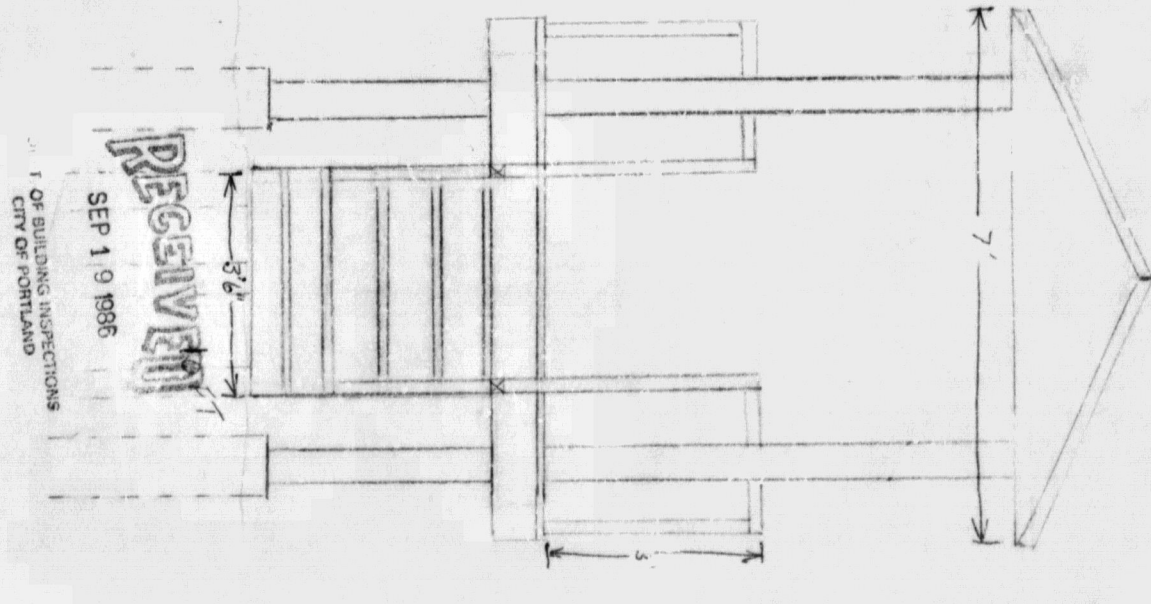
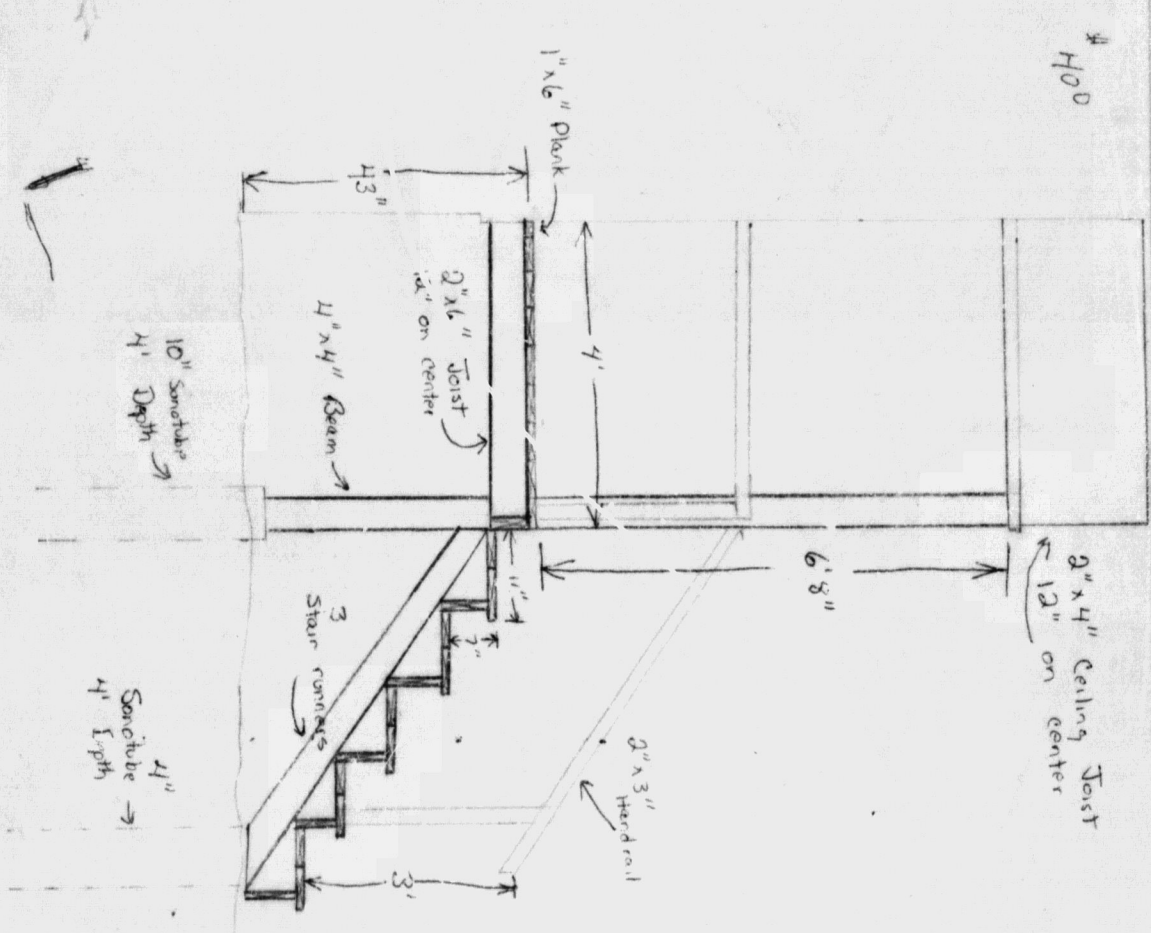

RECEIVED  
 SEP 19 1986  
 CITY OF BUILDING INSPECTIONS  
 CITY OF PORTLAND

APPLICATION FOR PERMIT

PERMIT ISSUED

B.O.C.A. USE GROUP .....

SEP 22 1986

B.O.C.A. TYPE OF CONSTRUCTION 01259

ZONING LOCATION R-3 PORTLAND, MAINE Sept. 19, 1986

City Of Portland

To the CHIEF OF BUILDING & INSPECTION SERVICES, PORTLAND, MAINE

The undersigned hereby applies for a permit to erect, alter, repair, demolish, move or install the following building, structure, equipment or change use in accordance with the Laws of the State of Maine, the Portland B.O.C.A. Building Code and Zoning Ordinance of the City of Portland with plans and specifications, if any, submitted herewith and the following specifications:

LOCATION 60 Aldworth Street -04103 Fire District #1  #2

1. Owner's name and address Katharine Curtis - same Telephone 797-3501

2. Lessee's name and address Telephone

3. Contractor's name and address Owner Telephone

Proposed use of building dwelling No. of sheets

Las use same No. families 1

Material No. stories Heat Style of roof Roofing

Other buildings on same lot

Estimated contractual cost \$ 400 Appeal Fees \$

FIELD INSPECTOR - Mr. @ 775-5451 Base Fee 25.00

Late Fee

TOTAL \$

To construct 4 x 7 porch on front of dwelling as per plans. 1 sheet of plans.

(Replacing a larger porch removed)

Stamp of Special Conditions

NOTE TO APPLICANT: Separate permits are required by the installers and subcontractors of heating, plumbing, electrical and mechanicals.

DETAILS OF NEW WORK

Is any plumbing involved in this work? Is any electrical work involved in this work?

Is connection to be made to public sewer? If not, what is proposed for sewage?

Has septic tank notice been sent? Form notice sent?

Height average grade to top of plate Height average grade to highest point of roof

Size, front depth No. stories solid or filled land? earth or rock?

Material of foundation Thickness, top bottom cellar

Kind of roof Rise per foot Roof covering

No. of chimneys Material of chimneys of lining Kind of heat fuel

Framing Lumber - Kind Dressed or full size? Corner posts Sills

Size Girder Columns under girders Size Max. on centers

Studs (outside walls and carrying partitions) 2x4-16" O. C. Bridging in every floor and flat roof span over 8 feet.

Joists and rafters: 1st floor 2nd 3rd roof

On centers: 1st floor 2nd 3rd roof

Maximum spar: 1st floor 2nd 3rd roof

If one story building with masonry walls, thickness of walls? height?

IF A GARAGE

No. cars now accommodated on same lot to be accommodated number commercial cars to be accommodated

Will automobile repairing be done other than minor repairs to cars habitually stored in the proposed building?

APPROVALS BY: DATE

MISCELLANEOUS

BUILDING INSPECTION - PLAN EXAMINER

Will work require disturbing of any tree on a public street?

ZONING: A.K. N. J. T. Sept. 19, 1986

Will there be in charge of the above work a person competent

BUILDING CODE:

to see that the State and City requirements pertaining thereto

Fire Dept.:

are observed?

Health Dept.:

Others:

Signature of Applicant Katharine Curtis Phone # same

Type Name of above Katharine Curtis 2 3 4

Other

and Address

FIELD INSPECTOR'S COPY

APPLICANT'S COPY

OFFICE FILE COPY

MA. I 04179

NOTES

9/21/86 Attached copy of Bldg  
Code 827-0 Guards.

9/24/86  
Completed

Permit No 86/1259  
Location 69 yr Laingville Rd  
Owner R. Johnson  
Date of Permit 9-19-86  
Approved 9-22-86  
Inspector [Signature]  
Municipality [Signature]

