

75-81 BELFORT STREET

STEAMER
1000-3R

CITY OF PORTLAND, MAINE
Application for Permit to Install Wires

Permit No. 53772
 Issued _____
 Portland, Maine Mar. 31, 1965

To the City Electrician, Portland, Maine:

The undersigned hereby applies for a permit to install wires for the purpose of conducting electric current, in accordance with the laws of Maine, the Electrical Ordinance of the City of Portland, and the following specifications:

(This form must be completely filled out - Minimum Fee, \$1.00)

Owner's Name and Address ... Kerry M. Shaw ... Tel.
 Contractor's Name and Address ... J. W. Cassidy ... Tel.
 Location ... 77 Belfort St ... Use of Building

Number of Families ... Apartments ... Stores ... Number of Stories ...
 Description of Wiring: New Work Additions Alterations
 Pipe ... Cable ... Metal Molding ... BX Cable ... Plug Molding (No. of feet) ...
 No. Light Outlets 2 Plugs 6 Light Circuits 1 Plug Circuits ...
 FIXTURES: No. ... Light Switches 3 Fluor. or Strip Lighting (No. feet) ...
 SERVICE: Pipe ... Cable ... Underground ... No. of Wires ... Size ...
 METERS: Relocated ... Added ... Total No. Meters ...
 MOTORS: Number ... Phase ... H. P. ... Amps ... Volts ... Starter ...
 HEATING UNITS: Domestic (Oil) ... No. Motors ... Phase ... H.P. ...
 Commercial (Oil) ... No. Motors ... Phase ... H.P. ...
 Electric Heat (No. of Rooms) ...
 APPLIANCES: No. Ranges ... Watts ... Brand Feeds (Size and No.) ...
 Elec. Heaters ... Watts ...
 Miscellaneous ... Watts ... Extra Cabinets or Panels ...
 Transformers ... Air Conditioners (No. Units) ... Signs (No. Units) ...
 Will commence Mar 31 1965 Ready to cover in Mar 31 1965 Inspection Mar 31 1965
 Amount of Fee \$..... Signed James W. Cassidy

DO NOT WRITE BELOW THIS LINE

SERVICE METER GROUND
 VISITS: 1 2 3 4 5 6
 7 8 9 10 11 12

REMARKS:

INSPECTED BY J. W. Cassidy
 (OVER)



R3 RESIDENCE ZONE

APPLICATION FOR PERMIT

Third Class

Class of Building or Type of Structure 77 Belfort St.
Portland, Maine,

PERMIT ISSUED
00301
MAY 20 1965

To the INSPECTOR OF BUILDINGS, PORTLAND, MAINE
The undersigned hereby applies for a permit to erect alter repair demolish install the following building structure equipment in accordance with the Laws of the State of Maine, the Building Code and Zoning Ordinance of the City of Portland, plans and specifications, if any, submitted herewith and the following specifications:

Location 77 Belfort St. Within Fire Limits? Dist. No. _____
 Owner's name and address Kerry Shaw, 77 Belfort St. Telephone _____
 Lessee's name and address _____ Telephone _____
 Contractor's name and address Charles H Hanson, 193 Allen Ave. Telephone 797-3395
 Architect _____ Specifications _____ Plans yes No. of sheets 1
 Proposed use of building _____ Dwelling _____ No. families 1
 Last use _____ " _____ Roofing _____
 Material frame No. stories 1 1/2 Heat _____ Style of roof _____
 Other buildings on same lot _____ Fee \$ 5.00
 Estimated cost \$ 1000.00

General Description of New Work

To finish off (2) rooms on second floor for bedrooms.
2x4 studs 16" o.c. covered with sheetrock. (as per plan)

It is understood that this permit does not include installation of heating apparatus which is to be taken out separately by and in the name of the heating contractor. **PERMIT TO BE ISSUED TO** _____ contractor

Details of New Work

Is any plumbing involved in this work? _____ Is any electrical work involved in this work? _____
 Is connection to be made to public sewer? _____ If not, what is proposed for sewage? _____
 Has septic tank notice been sent? _____ Form notice sent? _____
 Height average grade to top of plate _____ Height average grade to highest point of roof _____
 Size, front _____ depth _____ No. stories _____ solid or filled land? _____ earth or rock? _____
 Material of foundation _____ Thickness, top _____ bottom _____ cellar _____
 Kind of roof _____ Rise per foot _____ Roof covering _____ Kind of heat _____ fuel _____
 No. of chimneys _____ Material of chimneys _____ of lining _____ Sills _____
 Framing Lumber—Kind _____ Dressed or full size? _____ Corner posts _____
 Size Girder _____ Columns under girders _____ Size _____ Max. on centers _____
 Studs (outside walls and carrying partitions) 2x4-16" O. C. Bridging in every floor and flat roof span over 8 feet.
 Joists and rafters: 1st floor _____, 2nd _____, 3rd _____, roof _____
 On centers: 1st floor _____, 2nd _____, 3rd _____, roof _____
 Maximum span: 1st floor _____, 2nd _____, 3rd _____, roof _____
 If one story building with masonry walls, thickness of walls? _____ height? _____

If a Garage

No. cars now accommodated on same lot _____, to be accommodated _____ number commercial cars to be accommodated _____
 Will automobile repairing be done other than minor repairs to cars habitually stored in the proposed building? _____

Miscellaneous

Will work require disturbing of any tree on a public street? _____ no
 Will there be in charge of the above work a person competent to see that the State and City requirements pertaining thereto are observed? Yes

APPROVED:

M. E. [Signature]

Kerry Shaw
Charles H Hanson

Charles H Hanson

CS 301

INSPECTION COPY

Signature of owner by:

FM

RS RESIDENCE ZONE

PERMIT ISSUED

OCT 27 1960

CITY of PORTLAND



APPLICATION FOR PERMIT

Class of Building or Type of Structure Third Class
Portland, Maine, October 26, 1960

To the INSPECTOR OF BUILDINGS, PORTLAND, MAINE

The undersigned hereby applies for a permit to erect alter repair demolish install the following building structure equipment in accordance with the Laws of the State of Maine, the Building Code and Zoning Ordinance of the City of Portland, plans and specifications, if any, submitted herewith and the following specifications:

Location 77 Belfort Street Within Fire Limits? _____ Dist. No. _____
 Owner's name and address Kerry Shaw, 77 Belfort St. Telephone 4-268 7467
 Lessee's name and address _____ Telephone _____
 Contractor's name and address owner Telephone _____
 Architect _____ Specifications _____ Plans yes No. of sheets _____
 Proposed use of building Dwelling No. families 1
 Last use _____ " _____ No. families 1
 Material frame _____ No. stories _____ Heat _____ Style of roof _____ Roofing _____
 Other buildings on same lot _____ Fee \$ 2.00
 Estimated cost \$ 150.

General Description of New Work

To construct roof-over-existing 5'x5' side platform and to enclose piazza.

It is understood that this permit does not include installation of heating apparatus which is to be taken out separately by and in the name of the heating contractor. **PERMIT TO BE ISSUED TO** owner

Details of New Work

Is any plumbing involved in this work? _____ Is any electrical work involved in this work? _____
 Is connection to be made to public sewer? _____ If not, what is proposed for sewer? _____
 Has septic tank notice been sent? _____ Form notice sent? _____
 Height average grade to top of plate 8' Height average grade to highest point of roof 11'
 Size, front _____ depth _____ No. stories 1 solid or filled land? solid earth or rock? earth
 Material of foundation _____ Thickness, top _____ bottom _____ cellar _____
 Kind of roof pitch Rise per foot _____ Roof covering asphalt roofing Class C Und. L
 No. of chimneys _____ Material of chimneys _____ of lining _____ Kind of heat _____ fuel _____
 Framing Lumber—Kind hemlock Dressed or full size? dressed Corner posts 4x4 Sills _____
 Size Girder _____ Columns under girders _____ Size _____ Max. on centers _____
 Studs (outside walls and carrying partitions) 2x4-16" O. C. Bridging in every floor and flat roof span over 8 feet.
 Joists and rafters: 1st floor _____, 2nd _____, 3rd _____, roof 2x4
 On centers: 1st floor _____, 2nd _____, 3rd _____, roof 24"
 Maximum span: 1st floor _____, 2nd _____, 3rd _____, roof 21'6"
 If one story building with masonry walls, thickness of walls? _____ height? _____

If a Garage

No. cars now accommodated on same lot _____ to be accommodated _____ number commercial cars to be accommodated _____
Will automobile repairing be done other than minor repairs to cars habitually stored in the proposed building? _____

Miscellaneous

Will work require disturbing of any tree on a public street? _____
Will there be in charge of the above work a person who has been trained and observed that the State and City requirements pertain? yes

APPROVED:

O.R. - 10/27/60 - agf

CS 301

INSPECTION COPY

Signature of owner

Kerry M. Shaw



FILL IN AND SIGN WITH INK

APPLICATION FOR PERMIT FOR HEATING, COOKING OR POWER EQUIPMENT

PERMIT NUMBER
01216

SEP 14 1959

Portland, Maine, Sept. 13, 1959

CITY OF PORTLAND

To the INSPECTOR OF BUILDINGS, PORTLAND, ME.

The undersigned hereby applies for a permit to install the following heating, cooking or power equipment in accordance with the Laws of Maine, the Building Code of the City of Portland, and the following specifications:

Location 75-81 Belfort St. Use of Building Dwelling No. Stories 1 1/2 New Building
Name and address of owner of appliance Charles H. Hanson Co., Inc., 193 Allen Ave. Existing
Installer's name and address M. William Cohen, 67 Codman St. Telephone 3-0817

General Description of Work

To install Forced hot water heating system and oil burning equipment.

IF HEATER, OR POWER BOILER

Location of appliance Basement Any burnable material in floor surface or beneath? none
If so, how protected? Kind of fuel? oil
Minimum distance to burnable material, from top of appliance or casing top of furnace 4'
From top of smoke pipe over 3' From front of appliance over 4' From sides or back of appliance over 3'
Size of chimney flue 6" Other connections to same flue none
If gas fired, how vented? Rated maximum demand per hour
Will sufficient fresh air be supplied to the appliance to insure proper and safe combustion? yes

IF OIL BURNER

Name and type of burner Crane-gun type Labelled by underwriters' laboratories yes
Will operator be always in attendance? Does oil supply line feed from top or bottom of tank? bottom
Type of floor beneath burner concrete Size of vent pipe 1 1/2"
Location of oil storage basement Number and capacity of tanks 1-275 gal.
Low water shut off Make No.
Will all tanks be more than five feet from any flame? yes How many tanks enclosed?
Total capacity of any existing storage tanks for furnace burners

IF COOKING APPLIANCE

Location of appliance Any burnable material in floor surface or beneath?
If so, how protected? Height of Legs, if any
Skirting at bottom of appliance? Distance to combustible material from top of appliance?
From front of appliance From sides and back From top of smoke pipe
Size of chimney flue Other connections to same flue
Is hood to be provided? If so, how vented? Forced or gravity?
If gas fired, how vented? Rated maximum demand per hour

MISCELLANEOUS EQUIPMENT OR SPECIAL INFORMATION

Amount of fee enclosed? \$2.00 (\$2.00 for one heater, etc., 50 cents additional for each additional heater, etc., in same building at same time.)

APPROVED:

D.K.S. 9/14/59

Will there be in charge of the above work a person competent to see that the State and City requirements pertaining thereto are observed? yes
M. William Cohen

INSPECTION COPY

Signature of Installer

by M. William Cohen



RS RESIDENCE ZONE
APPLICATION FOR PERMIT

Class of Building or Type of Structure.....Third-Class.....
Portland, Maine,.....June 1, 1959

PERMIT ISSUED
NO 682
JUN 5 1959
CITY OF PORTLAND

To the INSPECTOR OF BUILDINGS, PORTLAND, MAINE

The undersigned hereby applies for a permit to erect ~~alter-repair-demolish~~ install the following building structure equipment in accordance with the Laws of the State of Maine, the Building Code and Zoning Ordinance of the City of Portland, plans and specifications, if any, submitted herewith and the following specifications:

Location Lots 169-170-179-180 Balfort St. (75-81) Within Fire Limits? no Dist. No.
Owner's name and address Charles H Hanson, 193 Allen Ave. Telephone 2-7848
Lessee's name and address Telephone
Contractor's name and address owner Telephone
Architect Specifications Plans yes No. of sheets 4
Proposed use of building Dwelling No. families 1
Last use No. families
Material frame No. stories 1 Heat Style of roof Roofing
Other building on same lot
Estimated cost \$ 9,000.00 Fee \$ 9.00

General Description of New Work

To construct 1 1/2-story frame dwelling house 26' x 32'

It is understood that this permit does not include installation of heating apparatus which is to be taken out separately by and in the name of the heating contractor. PERMIT TO BE ISSUED TO owner

Details of New Work

Is any plumbing involved in this work? yes Is any electrical work involved in this work? yes
Is connection to be made to public sewer? yes If not, what is proposed for sewage?
Has septic tank notice been sent? Form notice sent? yes
Height average grade to top of plate 10' Height average grade to highest point of roof 20'
Size, front 32' depth 26' No. stories 1 1/2 solid or filled land? solid earth or rock? earth
Material of foundation concrete at least 4' below grade Thickness, top 11" bottom 11" cellar yes
Material of underpinning " to sill Height Thickness
Kind of roof pitch-gable Rise per foot 10" Roof covering Asphalt Class C Und. Lab.
No. of chimneys 1 Material of chimneys brick of lining tile Kind of heat h, water oil
Framing Lumber—Kind hemlock Dressed or full size? dressed Corner posts 4x4 Sills box
Size Girder 6x10 Columns under girders lally Size 3 1/2" Max. on centers 7'6"
Kind and thickness of outside sheathing of exterior walls?
Studs (outside walls and carrying partitions) 2x4-16" O. C. Bridging in every floor and flat roof span over 8 feet.
Joists and rafters: 1st floor 2x8, 2nd, 3rd, roof 2x8
On centers: 1st floor 16", 2nd, 3rd, roof 16"
Maximum span: 1st floor 14', 2nd, 3rd, roof 12'
If one story building with masonry walls, thickness of walls? height?

If a Garage

No. cars now accommodated on same lot, to be accommodated, number commercial cars to be accommodated.
Will automobile repairing be done other than minor repairs to cars habitually stored in the proposed building?

APPROVED: 6/5/59
[Signature]

Miscellaneous

Will work require disturbing of any tree on a public street? no
Will there be in charge of the above work a person competent to see that the State and City requirements pertaining thereto observed? yes

Charles H Hanson

[Signature] F.M.

Signature of owner by:

INSPECTION COPY

City of Portland, Maine -- Building or Use Permit Application 389 Congress Street, 04101, Tel: (207) 874-8703, FAX: 874-8716

Location of Construction: 77 Salford St.		Owner: Marr, Steve	Phone:	Permit No: 950490
Owner Address: 77 Salford St - Portland, ME		Leasee/Buyer's Name:	Phone:	Business Name:
Contractor Name: Harry Grant Carpentry		Address: 451 Grand St - Portland, ME		Phone:
Past Use: 1-100	Proposed Use: 1-100 addition	COST OF WORK: \$ 3,000	PERMIT FEE: \$ 45	PERMIT ISSUED MAY 22 1995 CITY OF PORTLAND Permit No. 950490 Zoning Approval: 511-E-10
Proposed Project Description: CONSTRUCT ADDITION		FIRE DEPT. <input type="checkbox"/> Approved <input type="checkbox"/> Denied	INSPECTION: Use Group 93 Type 5.2 1200-93 Signature: <i>[Signature]</i>	
PEDESTRIAN ACTIVITIES DISTRICT (P.A.D.)		Action: <input type="checkbox"/> Approved <input type="checkbox"/> Approved with Cond <input type="checkbox"/> Denied		Special Zon. or Reviews: <input type="checkbox"/> Shoreland <input type="checkbox"/> Wetland <input type="checkbox"/> Flood Zone <input type="checkbox"/> Subdivision <input type="checkbox"/> Site Plan maj <input type="checkbox"/> minor <input type="checkbox"/> mm <input type="checkbox"/>
Permit Taken By: L. GRASS		Date Applied For: 5/21/95		Zoning Appeal: <input type="checkbox"/> Variance <input type="checkbox"/> Miscellaneous <input type="checkbox"/> Conditional Use <input type="checkbox"/> Interpretation <input type="checkbox"/> Approved <input type="checkbox"/> Denied

- This permit application doesn't preclude the Applicant(s) from meeting applicable State and Federal rules.
- Building permits do not include plumbing, septic or electrical work.
- Building permits are void if work is not started within six (6) months of the date of issuance. False information may invalidate a building permit and stop all work.

CERTIFICATION

I hereby certify that I am the owner of record of the named property, or that the proposed work is authorized by the owner of record and that I have been authorized by the owner to make this application as his authorized agent and I agree to conform to all applicable laws of this jurisdiction. In addition, if a permit for work described in the application issued, I certify that the code official's authorized representative shall have the authority to enter all areas covered by such permit at any reasonable hour to enforce the provisions of the code(s) applicable to such permit

SIGNATURE OF APPLICANT	ADDRESS:	DATE:	PHONE:
<i>[Signature]</i>		5/21/95	
RESPONSIBLE PERSON IN CHARGE OF WORK, TITLE	PHONE:		

White-Permit Desk Green-Assessor's Canary-D.P.W. Pink-Public File Ivory Card-Inspector

Historic Preservation
 Not in District or Landmark
 Does Not Require Review
 Requires Review

Action:
 Approved
 Approved with Conditions
 Denied

Date: **5/22/95**

[Signature]

CEO DISTRICT **[Signature]**

Mr. Jordan

COMMENTS

5-24-95 - 3 (10" Sono Tubes OK per plans)

6-14-95 - 1st. Joist, 2x10 16'OC, walls 2x4 16'OC, Rattens 2x8 (16'OC) 6" Fiberglass (Facing)
2x6 Headers, stairs called to add entrance 41" wide not on plan, 4x4 support posts on?
(Rattens not on plans) (no call for Insp. on stair supports)

6-26-95 - not finished

7-13-95 - int. not yet finished

8-7-95 Completed class

Type	Inspection Record	Date
Foundation:	_____	_____
Framing:	_____	_____
Plumbing:	_____	_____
Final: <u>OK</u>	_____	<u>8-2-95</u>
Other:	_____	_____

City of Portland, Maine -- Building Use Permit Application 389 Congress Street, 04101. Tel: (207) 874-8703, FAX: 874-8716

Location of Construction: 77 Belfort St.	Owner: Kerry Shaw	Phone:
Water Address: * 77 Belfort St- Ptd, ME 04103	Leasee/Buyer's Name:	Business Name:
Contractor Name: Larry Grant Carpentry	Address: 463 Brook St- Westbrook, ME 04092	Phone: 797-4079
Past Use: 1-fam	Proposed Use: 1-fam addition	COST OF WORK: \$5000
		PERMIT FEE: \$ 45
		FIRE DEPT. <input type="checkbox"/> Approved <input type="checkbox"/> Denied
		INSPECTION: Use Group: 73 Type: 5A Signature: [Signature] Date: 5/22/95

Permit No: **950490**

PERMIT ISSUED

22685

CITY OF PORTLAND

797-499-E-10

Zoning Approval: [Signature]

Proposed Project Description:
construct addition Existing House

Permit Taken By: L Chase Date Applied For: 5/22/95

PEDESTRIAN ACTIVITIES DISTRICT (P.A.D.)

Action: Approved
 Approved with Conditions
 Denied

Special Zoning or Reviews:

Shoreland
 Wetland
 Flood Zone
 Subdivision
 Site Plan major minor mm

Zoning: [Signature]

Variance
 Miscellaneous
 Conditional Use
 Interpretation
 Approved
 Denied

1. This permit application doesn't preclude the Applicant(s) from meeting applicable State and Federal rules.
2. Building permits do not include plumbing, septic or electrical work.
3. Building permits are void if work is not started within six (6) months of the date of issuance. False information may invalidate a building permit and stop all work.

Attached to house
Floor to be level with kitchen floor

Historic Preservation

Not in District or Landmark
 Does Not Require Review
 Requires Review

Action:

Approved
 Approved with Conditions
 Denied

Date: 5/22/95

CERTIFICATION

I hereby certify that I am the owner of record of the named property, or that the proposed work is authorized by the owner of record and that I have been authorized by the owner to make this application as his authorized agent and I agree to conform to all applicable laws of this jurisdiction. In addition, if a permit for work described in the application issued, I certify that the code official's authorized representative shall have the authority to enter all areas covered by such permit at any reasonable hour to enforce the provisions of the code(s) applicable to such permit.

SIGNATURE OF APPLICANT: [Signature] ADDRESS: [Address] DATE: 5/22/95 PHONE: 797-4079

RESPONSIBLE PERSON IN CHARGE OF WORK, TITLE: [Signature] White-Permit Desk Green-Assessor's Office Pink-Public File Ivory Card-Inspector

CEO DISTRICT: 7

MR. Jordan

Sending To: [Signature]

Estimate

Contract

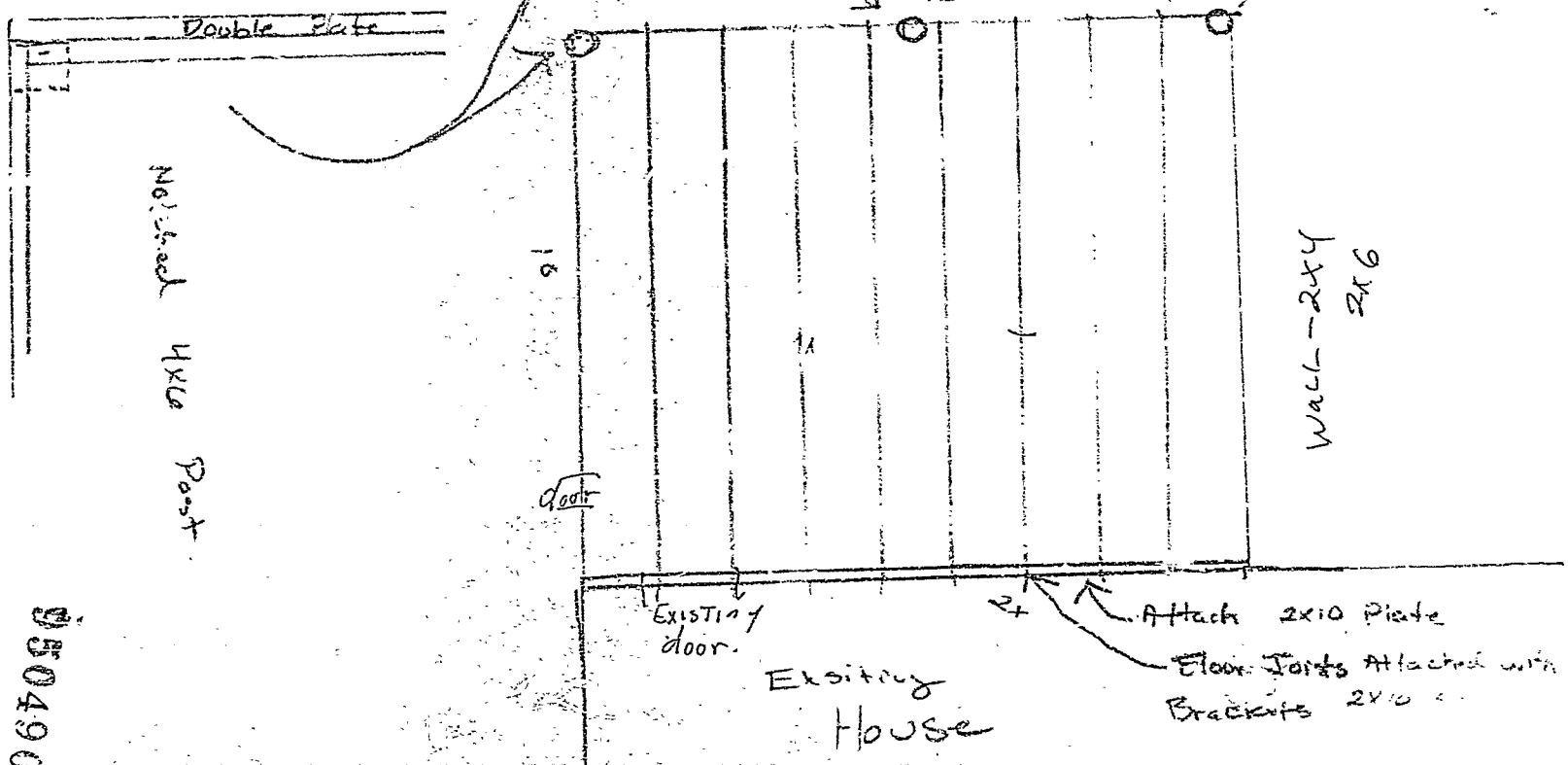

550490

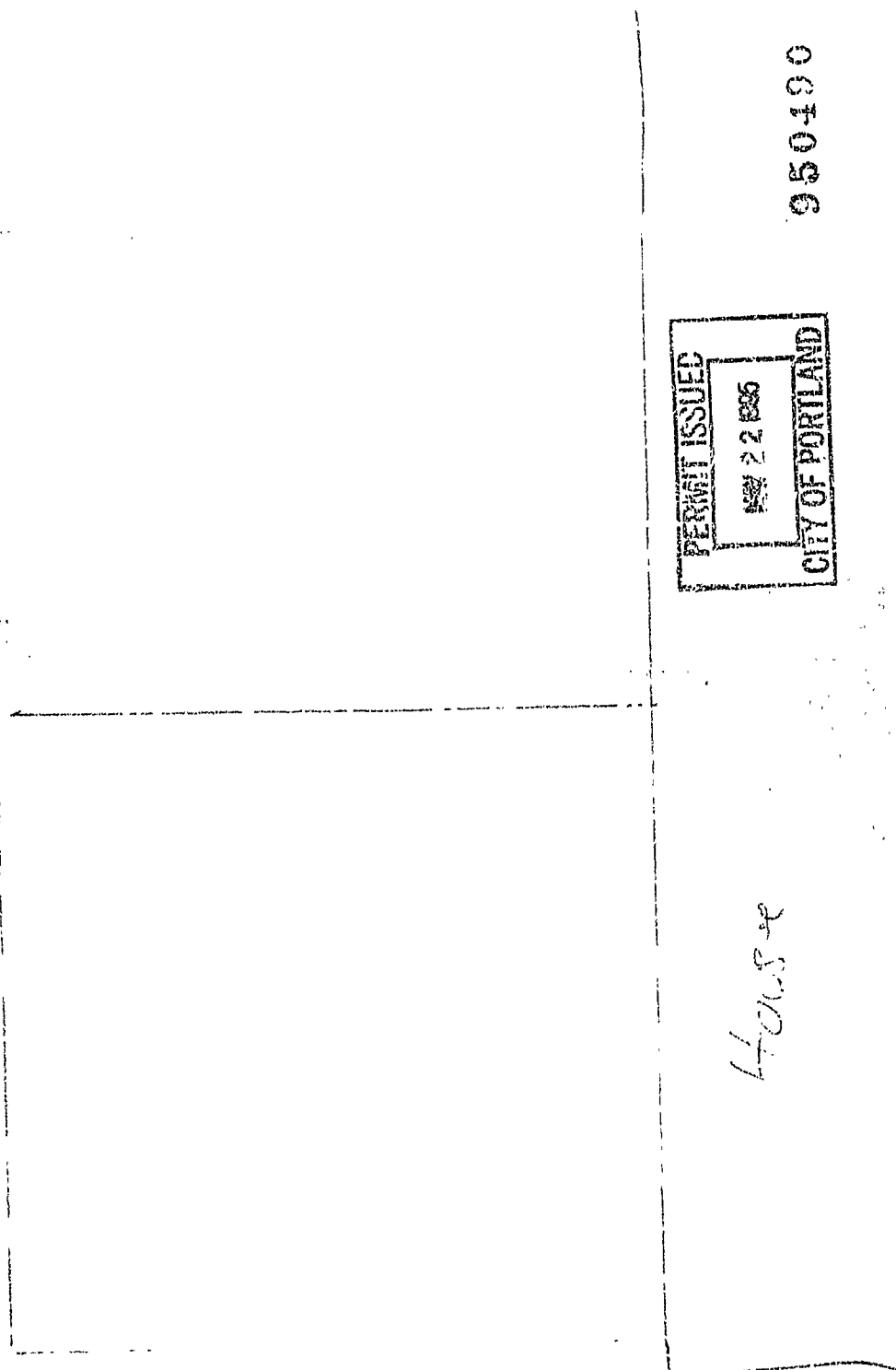
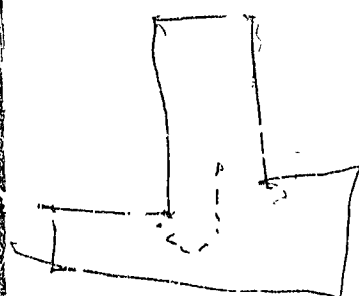

PERMIT ISSUED
MAY 2 1936
CITY OF PORTLAND

House

950490

ELECTRICAL PERMIT City of Portland, Me.



To the Chief Electrical Inspector, Portland Maine:
The undersigned hereby applies for a permit to make electrical installations
in accordance with the laws of Maine, the City of Portland Electrical Ordinance,
National Electrical Code and the following specification:

Date 15 June 1995

Permit # 3989

LOCATION: 77 Belfort St

OWNER Shaw, Kerry ADDRESS _____

						TOTAL EACH FEE	
OUTLETS	Receptacles	Switches			8	.20	1.60
	(number of)						
FIXTURES	Incandescent	fluorescent			1	.20	.20
	fluorescent strip					.20	
SERVICES	Overhead		TTL AMPS TO	800		15.00	
	Underground			800		15.00	
TEMPORARY SERV.	Overhead		AMPS CVTR	800		25.00	
	Underground			800		25.00	
METERS	(number of)					1.00	
MOTORS	(number of)					2.00	
RESID/COM	Electric units					1.00	
HEATING	oil/gas units					5.00	
APPLIANCES	Ranges	Cook Tops	Wall Ovens			2.00	
	Water heaters	Fans	Dryers	1	1	2.00	4.00
Disposals	Dishwasher	Compactors	Others (denote)			2.00	
MISC. (number of)	Air Cond/win					3.00	
	Air Cond/cent					10.00	
	Signs					5.00	
	Pools					10.00	
	Alarms/res					5.00	
	Alarms/com					15.00	
	Heavy Duty					2.00	
	Outlets						
	Circus/Carnv						25.00
	Alterations						5.00
	Fire Repairs						15.00
	E Lights						1.00
E Generators						20.00	
Panels						4.00	
TRANSFER	0-25 Kva					5.00	
	25-200 Kva					8.00	
	Over 200 Kva					10.00	
TOTAL AMOUNT DUE							
MINIMUM FEE						25.00	XX 25.00

INSPECTION: Will be ready 6/16 AM or will call _____

CONTRACTORS NAME Dennis Smith

ADDRESS 9 Sullivan Dr Gorham 04038

TELEPHONE 839-4026

MASTER LICENSE No. 3989

LIMITED LICENSE No. _____

SIGNATURE OF CONTRACTOR
Dennis Smith

