

13-15 WEST COMMONWEALTH DRIVE LOT 86

16





R3 RESIDENCE ZONE

APPLICATION FOR PERMIT

PERMIT ISSUED

JUN 23 1958

CITY of PORTLAND

Class of Building or Type of Structure Third Class
Portland, Maine, June 20, 1958

To the INSPECTOR OF BUILDINGS, PORTLAND, MAINE

The undersigned hereby applies for a permit to ~~erect~~ ~~repair~~ ~~demolish~~ install the following building structure equipment in accordance with the laws of the State of Maine, the Building Code and Zoning Ordinance of the City of Portland, plans and specifications, if any, submitted herewith and the following specifications:

Location 13 West Commonwealth Drive Within Fire Limits? no Dist. No. _____
 Owner's name and address Lewis Kenney, 50 Emerson St. Telephone _____
 Lessee's name and address _____ Telephone _____
 Contractor's name and address Hasco Mfg. Company, Pride's Corner Westbrook Me Telephone _____
 Architect _____ Specifications _____ Plans _____ No. of sheets _____
 Proposed use of building 2-car garage No. families _____
 Last use _____ No. families _____
 Material _____ No. stories _____ Heat _____ Style of roof _____ Roofing _____
 Other buildings on same lot dwelling
 Estimated cost \$ 1800.00 Fee \$ 5.00

General Description of New Work

To construct 2-car frame garage 20' x 22'

It is understood that this permit does not include installation of heating apparatus which is to be taken out separately by and in the name of the heating contractor. **PERMIT TO BE ISSUED TO** Hasco Mfg. Company

Details of New Work

Is any plumbing involved in this work? _____ Is any electrical work involved in this work? _____
 Height average grade to top of plate 8' Height average grade to highest point of roof 11'
 Size, front 20' depth 22' No. stories 1 solid or filled land? solid earth or rock? earth
 Material of foundation Concrete slab Thickness, top _____ bottom _____ cellar _____
 Material of underpinning _____ Height _____ Thickness _____
 Kind of roof pitch Rise per foot 5" Roof covering Asphalt Class C Und. Lab.
 No. of chimneys _____ Material of chimneys _____ of lining _____ Kind of heat _____ fuel _____
 Framing lumber—Kind hemlock Dressed or full size? dressed
 Corner posts 4x4 Sills 2x6 Girt or ledger board? _____ Size _____
 Girders _____ Size _____ Columns under girders _____ Size _____ Max. on centers _____
 Studs (outside walls and carrying partitions) 2x4-24" O. C. Bridging in every floor and flat roof span over 8 feet.
 Joists and rafters: 1st floor concrete, 2nd _____, 3rd _____, roof 2x6
 On centers: 1st floor _____, 2nd _____, 3rd _____, roof 2 1/2"
 Maximum span: 1st floor _____, 2nd _____, 3rd _____, roof 10'
 If one story building with masonry walls, thickness of walls? _____ height? _____

If a Garage

No. cars now accommodated on same lot 0, to be accommodated 2 number commercial cars to be accommodated no
 Will automobile repairing be done other than minor repairs to cars habitually stored in the proposed building? no

APPROVED:
O.W. 6/23/58 agj

Miscellaneous

Will work require disturbing of any tree on a public street? no
 Will there be in charge of the above work a person competent to see that the State and City requirements pertaining thereto are observed? yes

Lewis Kenney
Hasco Mfg. Company

Signature of owner by: Hasco Mfg. Company

NOTES

6/23/58 - Location O.S.
 7/16/58 - Slab poured
 10/21/58 - work done
 E.A.R.

475-81-9
 Permit No. 58/766
 Location 137 Peach (Linn County) Rd. Knoxville
 Owner (Linn County Linn County)
 Date of permit 6/23/58
 Notif. closing-in
 Inspn. closing-in
 Final Notif.
 Final Inspn. 10/21/58
 Cert. of Occupancy issued

(This section contains a large handwritten 'X' mark across the lined area.)



FILL IN AND SIGN WITH INK

APPLICATION FOR PERMIT FOR HEATING, COOKING OR POWER EQUIPMENT

Portland, Maine, Jan. 28, 1957

PERMIT ISSUED 00114 JAN 29 1957 CITY of PORTLAND

N-ESS

To the INSPECTOR OF BUILDINGS, PORTLAND, ME.

The undersigned hereby applies for a permit to install the following heating, cooking or power equipment in accordance with the Laws of Maine, the Building Code of the City of Portland, and the following specifications:

Location 13-15 W. Commonwealth Dr. Use of Building dwelling house No. Stories 1 1/2 New Building Existing
Name and address of owner of appliance Charles H. Hanson, 193 Allen Ave.
Installer's name and address M. William Cohen, 21 Codman St. Telephone 3-0817

General Description of Work

To install forced hot water heating system and oil burning equipment

IF HEATER, OR POWER BOILER

Location of appliance basement Any burnable material in floor surface or beneath? no
If so, how protected? Kind of fuel? oil
Minimum distance to burnable material, from top of appliance or casing top of furnace over 15"
From top of smoke pipe over 15" From front of appliance over 4" From sides or back of appliance over 3"
Size of chimney flue 8x8 Other connections to same flue none
If gas fired, how vented? Rated maximum demand per hour
Will sufficient fresh air be supplied to the appliance to insure proper and safe combustion? yes

IF OIL BURNER

Name and type of burner American Labeled by underwriters' laboratories? yes
Will operator be always in attendance? Does oil supply line feed from top or bottom of tank? bottom
Type of floor beneath burner concrete Size of vent pipe 1 1/2"
Location of oil storage basement Number and capacity of tanks 1-275 gal.
Low water shut off Make No.
Will all tanks be more than five feet from any flame? yes How many tanks enclosed?
Total capacity of any existing storage tanks for furnace burners

IF COOKING APPLIANCE

Location of appliance Any burnable material in floor surface or beneath?
If so, how protected? Height of Legs, if any
Skirting at bottom of appliance? Distance to combustible material from top of appliance?
From front of appliance From sides and back From top of smokepipe
Size of chimney flue Other connections to same flue
Is hood to be provided? If so, how vented? Forced or gravity?
If gas fired, how vented? Rated maximum demand per hour

MISCELLANEOUS EQUIPMENT OR SPECIAL INFORMATION

[Empty lines for miscellaneous information]

Amount of fee enclosed? 2.00 (\$2.00 for one heater, etc., 50 cents additional for each additional heater, etc., in same building at same time.)

APPROVED: [Signature] 1/28/57

Will there be in charge of the above work a person competent to see that the State and City requirements pertaining thereto are observed? yes

C17 MAINE PRINTING CO.

Signature of Installer

[Signature]

INSPECTION COPY

- 1 Mill Pipe
 2 Vent Pipe
 3 Kind of Rest
 4 Burner Reg. & Supports
 5 Name of Installer
 6 Stack Control
 7 High Limits Control
 8 Burner Control
 9
 10
 11
 12
 13
 14
 15
 16
 17
 18
 19
 20
 21
 22
 23
 24
 25
 26
 27
 28
 29
 30
 31
 32
 33
 34
 35
 36
 37
 38
 39
 40
 41
 42
 43
 44
 45
 46
 47
 48
 49
 50
 51
 52
 53
 54
 55
 56
 57
 58
 59
 60
 61
 62
 63
 64
 65
 66
 67
 68
 69
 70
 71
 72
 73
 74
 75
 76
 77
 78
 79
 80
 81
 82
 83
 84
 85
 86
 87
 88
 89
 90
 91
 92
 93
 94
 95
 96
 97
 98
 99
 100

NOTES

Permit No. 571/114
 Location 13-15
 Owner Charles J. Stinson
 Date of permit 1/29/57
 Approved 5/6/57

Blank lined area for notes and details, including a large diagonal scribble.

INVESTIGATION COPY

CS MAINE PRINTING CO., PORTLAND

(COPY)



CITY OF PORTLAND, MAINE
Department of Building Inspection

Certificate of Occupancy

LOCATION 13-15 W. Commonwealth Drive

Issued to Charles H. Hanson

Date of Issue May 7, 1957

This is to certify that the building, premises, or part thereof, at the above location, built—altered—changed as to use under Building Permit No. 56/2057 has had final inspection, has been found to conform substantially to requirements of Zoning Ordinance and Building Code of the City, and is hereby approved for occupancy or use, limited or otherwise, as indicated below.

PORTION OF BUILDING OR PREMISES

APPROVED OCCUPANCY

Entire

1-family dwelling

Limiting Conditions:

This certificate supersedes
certificate issued

Approved:

(Date)

Inspector

Inspector of Buildings

Notice: This certificate certifies lawful use of building or premises, and ought to be transferred from owner to owner when property changes hands. Copy will be furnished to owner or lessee for one dollar.



APPLICATION FOR PERMIT

Class of Building or Type of Structure Third Class

Portland, Maine, Nov. 19, 1956

020.37
NOV 20 1956

To the INSPECTOR OF BUILDINGS, PORTLAND, MAINE

The undersigned hereby applies for a permit to erect ~~alter, repair, demolish or install~~ the following building ~~structure or equipment~~ in accordance with the Laws of the State of Maine, the Building Code and Zoning Ordinance of the City of Portland, plans and specifications, if any, submitted herewith and the following specifications:

Location 13-15 West Commonwealth Drive Lot 86 Within Fire Limits? no Dist. No. _____
 Owner's name and address Charles H. Hanson, 193 Allen Ave. Telephone 2-7848
 Lessee's name and address _____ Telephone _____
 Contractor's name and address owner Telephone _____
 Architect _____ Specifications _____ Plans yes No. of sheets 4
 Proposed use of building dwelling house No. families 1
 Last use _____ No. families _____
 Material _____ No. stories _____ Heat _____ Style of roof _____ Roofing _____
 Other buildings on same lot _____
 Estimated cost \$ 9,000 Fee \$ 9.00

General Description of New Work

To construct 1 1/2-story frame dwelling house 26' x 32'.

Kind and thickness of outside sheathing of exterior walls? 1" boards
 It is understood that this permit does not include installation of heating apparatus which is to be taken out separately by and in the name of the heating contractor. **PERMIT TO BE ISSUED TO** owner

Details of New Work

Is any plumbing involved in this work? yes Is any electrical work involved in this work? yes
 Is connection to be made to public sewer? yes If not, what is proposed for sewage? _____
 Has septic tank notice been sent? _____ Form notice sent? yes
 Height average grade to top of plate 10' Height average grade to highest point of roof 20'
 Size, front 32' depth 26' No. stories 1 1/2 solid or filled land? solid earth or rock? earth
 Material of foundation concrete at least 4' below grade Thickness, top 11" bottom 11" cellar yes
 Material of underpinning " to sill _____ Height _____ Thickness _____
 Kind of roof pitch-gable Rise per foot 10" Roof covering Asphalt Class C Und Lab
 No. of chimneys 1 Material of chimneys brick tile _____ Kind of heat steam fuel oil
 Framing lumber--Kind hemlock (full size? dressed)
 Corner posts 4x4 Sills box Girt or led. _____ Size _____
 Girders yes Size 6x10 Column under girders ally Size 3 1/2" Max. on centers 7'6"
 Studs (outside walls and carrying partitions) 2x4-16" O. C. Bridging in every floor and flat roof span over 3 feet.
 Joists and rafters: 1st floor 2x8, 2nd 2x8, 3rd _____, roof 2x8
 On centers: 1st floor 16", 2nd 16", 3rd _____, roof 16"
 Maximum span: 1st floor 14', 2nd 14', 3rd _____, roof _____
 If one story building with masonry walls, thickness of walls? _____ height? _____

If a Garage

No. cars now accommodated on same lot _____, to be accommodated _____ number commercial cars to be accommodated _____
 Will automobile repairing be done other than minor repairs to cars habitually stored in the proposed building? _____

APPROVED:

O.N. - 11/20/56 - ags

Miscellaneous

Will work require disturbing of any tree on a public street? no
 Will there be in charge of the above work a person competent to see that the State and City requirements pertaining thereto are observed? yes

Signature of owner

Charles H. Hanson

NOTES

11/29/56 Form imp made

P. 88

2/11/57 - Left G.I.

to close in P.S. 8.

7/6/57 - Work done

Cert. sent to Bureau

P. 2.8

[Faint, illegible text]

[Faint, illegible text]

[Faint, illegible text]

[Faint, illegible text]

[Faint, illegible text]

[Faint, illegible text]

[Faint, illegible text]

[Faint, illegible text]

[Faint, illegible text]

[Faint, illegible text]

[Faint, illegible text]

[Faint, illegible text]

[Faint, illegible text]

[Faint, illegible text]

[Faint, illegible text]

[Faint, illegible text]

[Faint, illegible text]

[Faint, illegible text]

Permit No. 5613957
 Location 3755 N. Central Expressway
 Owner Chas. Lee & Co. Houston
 Date of Permit 11/20/56
 Notif. closing-in 11/15/57
 Inspn. closing-in 11/15/57
 Final Inspn. 5/6/59
 Cert. of Occupancy issued 5/6/59
 Staking Out Notice 11/29/56
 Form Check Notice 5-15-57

11/29/56

AMMCMCM

13-15 COMMONWEALTH DRIVE WEST LOT 86

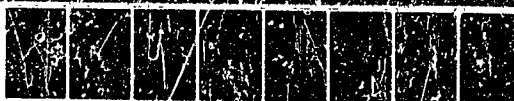



CITY OF PORTLAND

JOSEPH E. GRAY, JR.
DIRECTOR OF PLANNING
AND URBAN DEVELOPMENT

June 24, 1983

Mr. & Mrs. Virginia & Wayne Athearn
13 West Commonwealth Drive
Portland, Maine 04103

Re: 13 West Commonwealth Drive

Dear Mr. & Mrs. Athearn:

Your permit to install a 12' x 18' inground pool at 13 West Commonwealth Drive as per plans on file in this office, is being issued with the following requirement:

- (1) Section 627.9 Swimming pool safety devices: Every person owning land on which there is situated a swimming pool, which contains 24 inches or more of water depth at any point shall erect and maintain thereon an adequate enclosure either surrounding the property or pool area, sufficient to make such body of water inaccessible to small children. Such enclosure, including gates therein, must be not less than 4 feet above underlying ground. All gates must be self latching with latches placed 4 feet above underlying ground. All gates must be self latching with latches placed 4 feet above the underlying ground and otherwise made inaccessible from the outside to small children.

A natural barrier, hedge, pool cover or other protective device approved by the governing body may be used so long as the degree of protection afforded by the substituted devices or structures is not less than the protection afforded by the enclosure, gate and latch described herein.

- (2) Electrical and plumbing permits must be obtained.

If you have any questions on these requirements, please call this office.

Sincerely,

P. S. Hoffner
Chief of Inspection Services

PSH/jmr

The Pool is
a cotelco
Cost of Pool
\$350

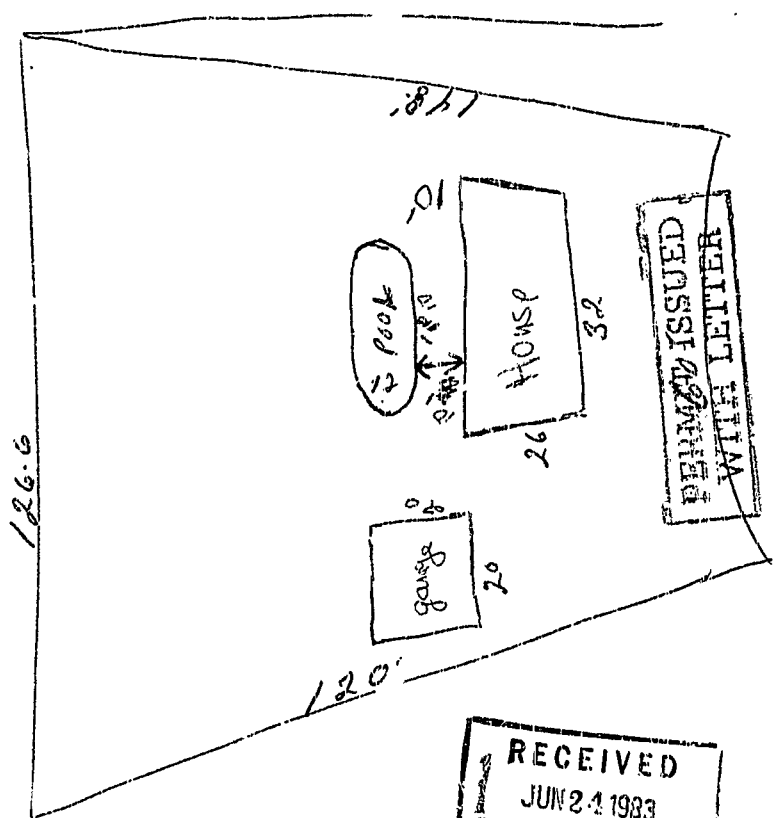

RECEIVED
JUN 24 1983
DEPT. OF BLDG. INSP.
CITY OF PORTLAND

APPLICATION FOR PERMIT

PERMIT ISSUED

B.O.C.A. USE GROUP 00624

JUN 27 1983

B.O.C.A. TYPE OF CONSTRUCTION

ZONING LOCATION PORTLAND, MAINE ... June 24, 1983

CITY of PORTLAND

To the CHIEF OF BUILDING & INSPECTION SERVICES, PORTLAND, MAINE

The undersigned hereby applies for a permit to erect, alter, repair, demolish, move or install the following building, structure, equipment or change use in accordance with the Laws of the State of Maine, the Portland B.O.C.A. Building Code and Zoning Ordinance of the City of Portland with plans and specifications, if any, submitted herewith and the following specifications:

LOCATION 13 West Commonwealth Drive
1. Owner's name and address Virginia & Wayne Athearn - same Telephone 797-6433
2. Contractor's name and address Owner Telephone
Proposed use of building above ground pool No. of sheets
Last use No. families
Material No. stories Heat Style of roof Roofing
Other buildings on same lot
Estimated contractual cost \$ 350.00 Appeal Fees \$ 15.00
FIELD INSPECTOR-Mr. @ 775-5451 Base Fee 15.00
Late Fee
TOTAL \$ 15.00

Top set 12' x 18' above ground swimming pool

Stamp of Specia. Conditions

PERMIT ISSUED WITH LETTER

NOTE TO APPLICANT: Separate permits are required by the installers and subcontractors of heating, plumbing, electrical and mechanicals.

DETAILS OF NEW WORK

Is any plumbing involved in this work? Is any electrical work involved in this work?
Is connection to be made to public sewer? If not, what is proposed for rewage?
Has septic tank notice been sent? Form notice sent?
Height average grade to top of plate Height average grade to highest point of roof
Size, front depth No. stories solid or filled land? earth or rock?
Material of foundation Thickness, top bottom cellar
Kind of roof Rise per foot Roof covering
No. of chimneys Material of chimneys of lining Kind of heat fuel
Framing Lumber--Kind Dressed or full size? Corner posts Sills
Size Girder Columns under girders Size Max. on centers
Sunds (outside walls and carrying partitions) 2x4 10" O. C. Bridging in every floor and flat roof span over 8 feet.
Joists and rafters: 1st floor 2nd 3rd roof
On centers: 1st floor 2nd 3rd roof
Maximum span 1st floor 2nd 3rd roof
If one story building with masonry walls, thickness of walls? height?

IF A GARAGE

No. cars now accommodated on same lot to be accommodated number commercial cars to be accommodated
Will automobile repairing be done other than minor repairs to cars habitually stored in the proposed building?

APPROVALS BY: DATE MISCELLANEOUS
BUILDING INSPECTION-PLAN EXAMINER Will work require disturbing of any tree on a public street?
ZONING: O.K. R.S. Zone, etc. Will there be in charge of the above work a person competent to see that the State and City requirements pertaining thereto are observed?
BUILDING CODE:
Fire Dept:
Health Dept:
Others:
Signature of Applicant Denise Limer Phone # 552
Type Name of above Denise Limer for 1 2 3 4
Virginia & Wayne Athearn Other and Address

PERMIT ISSUED WITH LETTER

FIELD INSPECTOR'S COPY APPLICANT'S COPY OFFICE FILE COPY

[Handwritten signature]

Permit no. 83/624

Location 13 West Commonwealth Drive

Owner Virginia Graham

Date of permit 6-27-83

Approved 6-27-83

Dwelling Above ground pool

Garage

Alteration

NOTES

7/6/83 -

Pool installed & all
permitted in.

VA

13-15 COMMONWEALTH DRIVE WEST LOT 86



4

APPLICATION FOR PERMIT

PERMIT ISSUED

B.O.C.A. USE GROUP
 B.O.C.A. TYPE OF CONSTRUCTION 00.224
 ZONING LOCATION PORTLAND, MAINE
 June 24, 1983

JUN 27 1983

CITY of PORTLAND

To the CHIEF OF BUILDING & INSPECTION SERVICES, PORTLAND, MAINE

The undersigned hereby applies for a permit to erect, alter, repair, demolish, move or install the following building, structure, equipment or change use in accordance with the Laws of the State of Maine, the Portland B.O.C.A. Building Code and Zoning Ordinance of the City of Portland, Maine, and the specifications, if any, submitted herewith and the following specifications:

LOCATION: Virginia & Wayne Atheam - same Fire District 75-6433

1. Owner's name and address Telephone

2. Lessee's name and address Telephone

3. Contractor's name and address Telephone

Proposed use of building above ground pool No. of sheets

Last use No. families

Material No. stories Heat Style of roof Roofing

Other buildings on same lot 350.00

Estimated contractual cost \$ Appeal Fees \$ 15.00

FIELD INSPECTOR—Mr. @ 775-5451 Base Fee Late Fee 15.00

To set 12' x 18' above ground swimming pool TOTAL \$

Stamp of Special Condition.

NOTE TO APPLICANT: Separate permits are required by the installers and subcontractors of heating, plumbing, electrical and mechanicals.

DETAILS OF NEW WORK

Is any plumbing involved in this work? Is any electrical work involved in this work?

Is connection to be made to public sewer? If not, what is proposed for sewage?

Has septic tank notice been sent? Form notice sent?

Height average grade to top of plate Height average grade to highest point of roof

Size, front depth No. stories solid or filled land? earth or rock?

Material of foundation Thickness, top bottom cellar

Kind of roof Rise per foot Roof covering

No. of chimneys Material of chimneys of lining Kind of heat fuel

Framing Lumber—Kind Dressed or full size? Corner posts Sills

Size Girder Columns under girders Size Max. on centers

Studs (outside walls and carrying partitions) 2x4-16" O. C. Bridging in every floor and flat roof span over 8 feet.

Joists and rafters: 1st floor 2nd 3rd roof

On centers: 1st floor 2nd 3rd roof

Maximum span: 1st floor 2nd 3rd of

If one story building with masonry walls, thickness of walls?

IF A GARAGE

No. cars now accommodated on same lot to be accommodated numh accommodated?

Will automobile repairing be done other than minor repairs to cars habitually stored on the project building?

APPROVALS BY: DATE

BUILDING INSPECTION—PLAN EXAMINER Will work require on public street?

ZONING Will there be competent

BUILDING CODE: see that the Sta ne ing thereto

Fire Dept.: are observed?

Health Dept.:

Others:

Signature of Applicant Denise Turner for Virginia & Wayne Atheam 4

Type Name of above

4

FIELD INSPECTOR'S COPY APPLICANT'S COPY OFFICE FILE COPY