

32-36 BELFORT STREET

SHAW-WALKER

Full size 2920R with 60/182000 1000 0015 0200 0000 0000 0000

PERMIT TO INSTALL PLUMBING

(Date Issued) 2/27/61
PORTLAND PLUMBING INSPECTOR

Address: 34 Belfort Street
 Installation For: Mr. Fred Cross
 Owner of Bldg.: Mr. Fred Cross
 Owner's Address: 34 Belfort Street
 Plumber: Richard P. Holtz

10465
 PERMIT NUMBER

By J. P. Welch

APPROVED FIRST INSPECTION

Date 8-4-61

By J. P. Welch

APPROVED FINAL INSPECTION

Date 8-2-61

By JOSEPH P. WELCH

- TYPE OF BUILDING
- COMMERCIAL
 - RESIDENTIAL
 - SINGLE
 - MULTI FAMILY
 - NEW CONSTRUCTION
 - REMODELING

NEW	REPL.	PROPOSED INSTALLATIONS	NUMB.	FILE
		SINKS		
		LAVATORIES		
		TOILETS		
		BATH TUBS		
		SHOWERS		
		DRAINS		
		HOT WATER TANKS		
		TANKLESS WATER HEATERS		
		GARBAGE GRINDERS		
		SEPTIC TANKS	1	\$ 2.00
		HOUSE SEWERS		
		ROOF LEADERS (Conn. to house drain)		

PORTLAND HEALTH DEPT. PLUMBING INSPECTION

TOTAL \$ 2.00

Date Issued **8-5-71**

By **ERNOLD R. GOODWIN**
Portland Plumbing Inspector

Date **AUG 5 - 1971**
App. First Insp.

By **ERNOLD R. GOODWIN**
App. Final Insp.

Date **AUG 13 1971**

- ERNOLD R. GOODWIN**
CHIEF PLUMBING INSPECTOR
- Commercial
 - Residential
 - Single
 - Multi Family
 - New Construction
 - Remodeling

PERMIT TO INSTALL PLUMBING

Address **34 Dalsfort St.**
 Installation For: **Single**
 Owner of Bldg.: **Allen Ramsdell**
 Owner's Address: **10 Road St. Scarborough**
 Plumber: **Philip Lauria**

PERMIT NUMBER **700**
 Date: **8-5-71**
 NO.

NEW	REPL		FEE
		SINKS	2.00
		LAVATORIES	2.00
		TOILETS	2.00
		BATH TUBS	2.00
		SHOWERS	
		DRAINS	
		HOT WATER FLOOR SURFACE	
		TANKLESS WATER HEATERS	
		GARBAGE DISPOSALS	
		SEPTIC TANKS	
		HOUSE SEWER	
		ROOF LEADERS	
		AUTOMATIC WASHERS	
		DISHWASHERS	
		OTHER	

TOTAL **8**
8.00

Building and Inspection Services Dept.: Plumbing Inspection

PERMIT TO INSTALL PLUMBING
 PERMIT NUMBER: 5906
 Date Issued: 11/27/57
 Address: 941 Belmont St
 Installation For: [Blank]
 Owner of Bldg.: Friedrich X. Gross
 Owner's Address: Friedrich X. Gross
 Plumber: Fred J. [Blank]
 Date: 11/27/57

APPROVED FIRST INSPECTION
 By: J.P. Welch
 Date: Nov 25-57

APPROVED FINAL INSPECTION
 By: J.P. Welch
 Date: Nov 25-57

TYPE OF BUILDING
 COMMERCIAL
 RESIDENTIAL
 SINGLE
 MULTI FAMILY
 NEW CONSTRUCTION
 REMODELING

PROPOSED INSTALLATIONS	NEW	REPL	NUMBER	FEE
SINKS				
LAVATORIES				
TOILETS				
BATH TUBS				
SHOWERS				
DRAINS				
HOT WATER TANKS				
TANKLESS WATER HEATERS				
GARBAGE GRINDERS				
SEPTIC TANKS				
HOUSE SEWERS				
ROOF LEADERS (conn. to house drain)				
PLUMBING INSPECTION				1 .75
Total				1 .75

54 12-53 □ PORTLAND HEALTH DEPT.



FILL IN AND SIGN WITH INK

APPLICATION FOR PERMIT FOR HEATING, COOKING OR POWER EQUIPMENT

Portland, Maine, AUG. 3, 1961

PERMIT ISSUED AUG. 4 1961 CITY OF PORTLAND

To the INSPECTOR OF BUILDINGS, PORTLAND, ME.

The undersigned hereby applies for a permit to install the following heating, cooking or power equipment in accordance with the Laws of Maine, the Building Code of the City of Portland, and the following specifications:

Location 34 Balford St. Use of Building dwelling No. Stories 1 1/2 New-Building Existing "
Name and address of owner of appliance Frederick Cross, 34 Balford St.
Installer's name and address Richard P. Waltz, 536 Washington Ave. Telephone

General Description of Work

To install forced hot water heating system and oil burning equipment in place of coal burning forced hot air heat.

IF HEATER, OR POWER BOILER

Location of appliance basement Any burnable material in floor surface or beneath? no
If so, how protected? Kind of fuel? oil
Minimum distance to burnable material, from top of appliance or casing top of furnace 3'
From top of smoke pipe 3' From front of appliance over 4' From sides or back of appliance over 4'
Size of chimney flue 8x8 Other connections to same flue no
If gas fired, how vented? Rated maximum demand per hour
Will sufficient fresh air be supplied to the appliance to insure proper and safe combustion?

IF OIL BURNER

Name and type of burner Weil-McLean gun type Labelled by underwriters' laboratories? yes
Will operator be always in attendance? Does oil supply line feed from top or bottom of tank? bottom
Type of floor beneath burner cement Size of vent pipe 1 1/2
Location of oil storage basement Number and capacity of tanks 1- 275 gal.
Low water shut off Make How many tanks enclosed? No.
Will all tanks be more than five feet from any flame? yes
Total capacity of any existing storage tanks for furnace burners

IF COOKING APPLIANCE

Location of appliance Any burnable material in floor surface or beneath?
If so, how protected? Height of Le, if any
Skirting at bottom of appliance? Distance to combustible material from top of appliance?
From front of appliance From sides and back From top of smoke pipe
Size of chimney flue Other connections to same flue
Is hood to be provided? If so, how vented?
If gas fired, how vented? Forced or gravity?
Rated maximum demand per hour

MISCELLANEOUS EQUIPMENT OR SPECIAL INFORMATION

Amount of fee enclosed? 2.00 (\$2.00 for one heater, etc. 50 cents additional for each additional heater, etc., in same building at same time.)

APPROVED [Signature]

Will there be in charge of the above work a person competent to see that the State and City requirements pertaining thereto are observed? yes
Richard P. Waltz

INSPECTION COPY Signature of Installer By: [Signature]

F. Mac



APPLICATION FOR PERMIT

PERMIT ISSUED
01643

OCT 27 1960

CITY OF PORTLAND

Class of Building or Type of Structure Third Class

PORTLAND, MAINE, October 27 1960

To the INSPECTOR OF BUILDINGS, Portland, Me.

The undersigned hereby applies for a permit to repair or renew roof covering of the following described building in accordance with the laws of Maine, the Building Code of the City of Portland, and the following specifications :

Location 34 Belfort St.

Owner's name and address Frederick K Gross, 34 Belfort St. Telephone _____

Contractor's name and address Arthur O Soule, 15 Dudley St. Telephone _____

Use of building—Present Dwelling Proposed Dwelling

No. of Stories 1 Style of roof pitch Type of present roof covering Asphalt

Type and Grade of roofing to be used Asphalt Class C Und.Lab. No. plies _____

GENERAL DESCRIPTION OF NEW WORK

To cover garage roof.

Fred K Gross

by: *Arthur O Soule*

Fee \$.50

Signature of Owner

INSPECTION COPY

January 21, 1927.

Mr. H. S. Robinson
Belfort Street
Portland, Maine.

Dear Sir:-

Referring to your application for a building permit to build a car private garage on lot 12-13 Belfort Street, the upper story to be used for the storage of carpenters and contractors equipment.

Your property is located in a general resident zone and the use which you give for the second story of this building is a non-conforming one under the Zoning Ordinance of the City.

It is therefore necessary for this department to withhold the permit. If you intend to go ahead with merely the garage part of the building, you should come to this office and alter your application to this effect. On the other hand if you decide that you will not build at all, the fee which you have paid for the permit will be refunded if you will return the receipt for the same to this office on or before January 23.

Sincerely,

Inspector of Buildings.

(R) GENERAL RESIDENCE ZONE

27/27



APPLICATION FOR PERMIT TO BUILD

1st CLASS BUILDING

Portland, Maine, January 11/27 1927

To the INSPECTOR OF BUILDINGS, PORTLAND, ME.

The undersigned hereby applies for a permit to build, according to the following specifications, the Laws of the State of Maine, and the Building Ordinance of the City of Portland:

PERMIT ISSUED

JAN 25 1927

Location 32-36 Lot 12-13 Belfort Street Ward 9 Within Fire Limits? no

Owner's name and address? H B Robinson, Belfort Street

Contractor's name and address? none

Architect's name and address? none

Proposed occupancy of building (purpose)? priv. to garage 2 cars (not more than one commercial truck)

No. families? - apartments? - lodgers? -

Size, front? 18, depth? 80, No. stories? 1, height, average grade to highest point of roof? -

To be erected on solid or filled land? solid earth or rock? earth

Material of foundation? concrete posts Thickness, top? - bottom? -

Material of underpinning? - over 4 ft. high? - thickness? -

Kind of roof (pitch, hip, etc.)? pitch Kind of roofing? asphalt

Kind of heat? no Material of chimney? -, of lining? -

Size of Framing Members

Corner posts? 4x4 Sills? 6x2 Rafters or roof beams? 2x5 on center? 24in

Material and size of columns under girders? - on center? -

Ledger board used? - Size? - Studs (outside walls and carrying partitions) 2 x 4 16" O. C.

Girders 6" x 8" or larger. Bridging in every floor and flat roof span over 8 feet. Sills and corner posts will be all one piece in cross section.

Floor timbers: 1st floor wood, 2nd -, 3rd -, 4th -

On centers: 1st floor -, 2nd -, 3rd -, 4th -

Span: 1st floor -, 2nd -, 3rd -, 4th -

If 1st or 2nd Class Building

External walls } thickness { 1st story -, 2nd story -

Party walls } thickness { 1st story -, 2nd story -

Material of cornice? - How fastened? -

If Apartment, Tenement or Lodging House

Dimensions of lot? -

Descriptions of other buildings on lot? -

Clear distance to rear lot line? -, to one side lot line? -, to other side lot line? -

If a Private Garage

No. cars now accommodated on lot? none Total number to be accommodated? 2

Other buildings on same lot? dwelling on fully

Distance from nearest present building to proposed garage? 20

All parts of garage, including eaves, will be at least 2 ft. from all lot lines.

Garage will be at least 100 feet from nearest windows of adjoining property.

Will there be a heating plant within building? no

If so, how protected? -

Miscellaneous

Will the above construction require the removal or disturbing of any shade tree on the public street? no

Plans filed as part of this application? sketch No. sheets? 2

Estimated total cost \$ 250.00 Fee? .75

Signature of owner or authorized representative? -



Location, ownership and detail must be correct, complete and legible. Separate application required for every building. Plans must be filed with this application. Know the requirements or not.

APPLICATION FOR PERMIT TO BUILD

(3d CLASS BUILDING)

Portland, Me., October 29, 1925

Moved to
425
26/513

Plans must be submitted in duplicate, one set to be filed with the Department and the duplicate set thereof (bearing the approval of the Inspector of Buildings) to be placed on the work and retained until the work is completed.

To THE INSPECTOR OF BUILDINGS

The undersigned hereby applies for a permit to build, according to the following Specifications:

Location Portland, Me. Ward 9 Fire Limits Belfort Street

Name of owner is? H S Robinson Address Belfort Street

Name of mechanic is? owner Address

Name of architect is? Address

Proposed occupancy of building (purpose)? dwelling

If a dwelling or tenement house, for how many families? 1

Are there to be stores in the lower story? no

Size of lot, No. of feet front? 16ft; No. of feet rear? 16ft; No. of feet deep? 20ft

Size of building, front? 1 1/2; No. of feet rear? ; No. of feet deep? 20ft

No. of stories, front? 1 1/2; rear? ; No. of feet deep? 20ft

No. of feet in height from the mean grade of street to the highest part of the roof? feet; rear? feet

Distance from lot lines, front? yes feet; side?

Firestop to be used? yes length of?

Will the building be erected on solid or filled land? yes

Will the foundation be laid on earth, rock or piles?

If on piles, No. of rows? 6 Sills 4x8 Roof Rafters 2x6 Girders 6x8

Diameter, top of? 16 diameter, bottom of? 16

Size of posts, 4x4 1st floor: 2x8, 2d 16, 3d 16, 4th 16

Size of girts 4x4, 2d not over 16, 3d not over 16, 4th not over 8ft

Size of floor timbers? O.C. " " " not over 16, 2d not over 16, 3d not over 16, 4th not over 8ft

Span O.C. Will the building be properly braced? yes Bridging in every floor span over 8ft

Material of foundation? posts thickness of? laid with mortar? yes

Underpinning, material of? posts height of? thickness of?

Will the roof be flat, pitch, mansard or hip? pitch Material of roofing? asphalt

Will the building be heated by steam, furnaces, stoves or grates? stove Will the flues be lined? yes

Will the building conform to the requirements of the law? yes

Means of egress? yes

The above construction will not require the removal of or disturbing of any shade tree on the public street.

If the building is to be occupied as a Tenement House, give the following particulars

What is the height of cellar or basement? second? third?

What will be the clear height of first story?

State what means of egress is to be provided Scuttle and stepladder to roof?

PERMIT MUST BE RECEIVED BEFORE BEGINNING WORK

Estimated Cost, \$ 900. Signature of owner or authorized representative, H S Robinson Address, Belfort Street Received by?

Plans submitted?



Location, ownership and detail must be correct, complete, and legible. Separate application required for every building. Plans must be filed with this application.

APPLICATION FOR PERMIT TO BUILD
(3D CLASS BUILDING)

Portland, Me., November 1, 1923 19

To THE
INSPECTOR OF BUILDINGS

The undersigned hereby applies for a permit to build, according to the following

32-36

Specifications:—

Location lot 12 Belfort Street Ward 9 Fire Limits? no
 Name of owner is? H S Robinson Address lot 13 Belfort Street
 Name of mechanic is? OWNER Address _____
 Name of architect is? _____ Address _____
 Proposed occupancy of building (purpose)? dwelling
 If a dwelling or tenement house, for how many families? 1
 Are there to be stores in lower story? _____
 Size of lot, No. of feet front? _____; No. of feet rear? _____; No. of feet deep? _____
 Size of building, No. of feet front? 24ft No. of feet rear? 24ft; No. of feet deep? 26ft
 No. of stories, front? 1 1/2; rear? _____
 No. of feet in height from the mean grade of street to the highest part of the roof? 20ft
 Distance from lot lines, front? _____ feet; side? _____ feet; side? _____ feet; rear? _____
 Firestop to be used? yes
 Will the building be erected on solid or filled land? yes
 Will the foundation be laid on earth, rock or piles?
 If on piles, No. of rows? _____ distance on centres? _____ length of? _____
 Diameter, top of? _____ diameter, bottom of? _____
 Size of posts, 4 x 6 Studding? 2 x 4 16 O. C. Sills 4 x 8 Roof Rafters 2 x 6 24 O. C. Girders 6 x 8
 Size of girts 4 x 4
 Size of floor timbers? 1st floor 2x8, 2d _____, 3d _____, 4th _____
 O. C. " " " " 16, 2d _____, 3d _____, 4th _____
 Span " " " " not over 16ft, 3d _____, 4th _____
 Will the building be properly braced?
 Building, how framed?
 Material of foundation? concrete thickness of? 12in laid with mortar?
 Underpinnings, material of? brick height of? 3ft thickness of? 8in
 Will the roof be flat, pitch, mansard or hip? pitch Material of roofing? asphalt
 Will the building be heated by stoves, furnaces, stoves or grates? furnace Will the flues be lined? yes
 Will the building conform to the requirements of the law? yes
 Means of egress? _____

PERMIT MUST BE RECEIVED BEFORE BEGINNING WORK

Plans must be submitted in duplicate, one set to be filed with the Department and the duplicate set thereof (bearing the approval of the Inspector of Buildings) shall be kept on the work and exhibited on demand.

If the building is to be occupied as a Tenement House, give the following particulars

What is the height of cellar or basement? _____
 What will be the clear height of first story? _____ second? _____ third? _____
 State what means of egress is to be provided _____
 Scuttle and stepladder to roof? _____

Estimated Cost,

\$ 5,000.

Signature of owner or authorized representative,

Address,

Plans submitted?

Received by?

1.25



APPLICATION FOR PERMIT
 DEPARTMENT OF BUILDING INSPECTIONS SERVICES
 ELECTRICAL INSTALLATIONS

Date Feb. 11 2/11/87 19 87
 Receipt and Permit number D 09061

To the CHIEF ELECTRICAL INSPECTOR, Portland, Maine:
 The undersigned hereby applies for a permit to make electrical installations in accordance with the laws of
 Maine, the Portland Electrical Ordinance, the National Electrical Code and the following specifications:

LOCATION OF WORK: 34 Belfort St.
 OWNER'S NAME: James Spizoco ADDRESS: lives there

OUTLETS:		FEES
Receptacles	Switches	Plugmold
_____ ft. TOTAL		_____
FIXTURES: (number of)		
Incandescent	Flourescent	(not strip) TOTAL
_____	_____	_____
Strip Flourescent	_____ ft.	_____
SERVICES:		
Overhead <input checked="" type="checkbox"/>	Underground	Temporary
_____ TOTAL amperes		<u>200</u> ..
MFTERS: (number of)	<u>1</u>	<u>3.00</u>
MOTORS: (number of)	_____	<u>.50</u>
Fractional	_____	_____
1 HP or over	_____	_____
RESIDENTIAL HEATING:		
Oil or Gas (number of units)	_____	_____
Electric (number of rooms)	_____	_____
COMMERCIAL OR INDUSTRIAL HEATING:		
Oil or Gas (by a main boiler)	_____	_____
Oil or Gas (by separate units)	_____	_____
Electric Under 20 kws	_____	Over 20 kws _____
APPLIANCES: (number of)		
Ranges	_____	Water Heaters _____
Cook Tops	_____	Disposals _____
Wall Ovens	_____	Dishwashers _____
Dryers	_____	Compactors _____
Fans	_____	Others (denote) _____
TOTAL	_____	_____
MISCELLANEOUS: (number of)		
Branch Panels	_____	_____
Transformers	_____	_____
Air Conditioners Central Unit	_____	_____
Separate Units (windows)	_____	_____
Signs 20 sq. ft. and under	_____	_____
Over 20 sq. ft.	_____	_____
Swimming Pools Above Ground	_____	_____
In Ground	_____	_____
Fire/Burglar Alarms Residential	_____	_____
Commercial	_____	_____
Heavy Duty Outlets, 220 Volt (such as welders) 30 amps and under	_____	_____
over 30 amps	_____	_____
Circus, Fairs, etc.	_____	_____
Alterations to wires	_____	_____
Repairs after fire	_____	_____
Emergency Lights, battery	_____	_____
Emergency Generators	_____	_____

INSTALLATION FEE DUE: _____
 FOR ADDITIONAL WORK NOT ON ORIGINAL PERMIT DOUBLE FEE DUE: _____
 FOR REMOVAL OF A "STOP ORDER" (304-11.0)
 TOTAL AMOUNT DUE: 3.50
 min 5.00

INSPECTION:
 Will be ready on _____ 19__ ; or Will Call
 CONTRACTOR'S NAME: Mitchell M Rossignol
 ADDRESS: 101 Danforth St. Apt 7
 TEL.: 775-3106
 MASTER LICENSE NO.: 10627 SIGNATURE OF CONTRACTOR: Mitchell Rossignol
 LIMITED LICENSE NO.: _____

INSPECTOR'S COPY — WHITE
 OFFICE COPY — CANARY
 CONTRACTOR'S COPY — GREEN

PLUMBING APPLICATION

Department of Human Services
Division of Health Engineering
(207) 289-3826

PROPERTY ADDRESS:
Town Or Plantation: Portland
Street Subdivision Lot #: 34 Belmont
PROPERTY OWNERS NAME:
Last: Horsmole, K.W.
Applicant Name: SEARS ROEBUCK & CO.
Mailing Address of Owner/Applicant (If Different): SEARS SERVICE CENTER
147 PLEASANT HILL RD.
SCARBOROUGH, MAINE 04074-9990

PORTLAND PERMIT # 3,201 TOWN COPY
Date Permit Issued: 11/21/88 \$ 1,161.00 Double Fee Charged
Local Plumbing Inspector Signature: _____ L.P.I. # 11213

Owner/Applicant Statement
I certify that the information submitted is correct to the best of my knowledge and understand that any falsification is reason for the Local Plumbing Inspector to deny a Permit.
Signature of Owner/Applicant: [Signature] Date: 11/21/88

Caution: Inspection Required
I have inspected the installation authorized above and found it to be in compliance with the Maine Plumbing Rules.
Local Plumbing Inspector Signature: _____ Date Approved: _____

PERMIT INFORMATION

This Application is for	Type Of Structure To Be Served:	Plumbing To Be Installed By:
1. <input checked="" type="checkbox"/> NEW PLUMBING 2. <input type="checkbox"/> RELOCATED PLUMBING	1. <input checked="" type="checkbox"/> SINGLE FAMILY DWELLING 2. <input type="checkbox"/> MODULAR OR MOBILE HOME 3. <input type="checkbox"/> MULTIPLE FAMILY DWELLING 4. <input type="checkbox"/> OTHER - SPECIFY _____	1. <input checked="" type="checkbox"/> MASTER PLUMBER 2. <input type="checkbox"/> OIL BURNERMAN 3. <input type="checkbox"/> MFG'D. HOUSING DEALER/MECHANIC 4. <input type="checkbox"/> PUBLIC UTILITY EMPLOYEE 5. <input type="checkbox"/> PROPERTY OWNER LICENSE # <u>105,693</u>

Hook-Up & Piping Relocation Maximum of 1 Hook-Up	Number	Column 2 Type of Fixture	Number	Column 1 Type of Fixture
HOOK-UP: to public sewer in those cases where the connection is not regulated and inspected by the local Sanitary District.		Hosebibb / Sillcock		Bathtub (and Shower)
		Floor Drain		Shower (Separate)
OR		Urinal		Sink
		Drinking Fountain		Wash Basin
HOOK-UP: to an existing subsurface wastewater disposal system.		Indirect Waste		Water Closet (Toilet)
		Water Treatment Softener, Filter, etc.		Clothes Washer
PIPING RELOCATION: of sanitary lines, drains, and piping without new fixtures.		Grease/Oil Separator		Dish Washer
		Dental Cuspidor		Garbage Disposal
Number of Hook-Ups & Relocations		Bidet		Laundry Tub
		Other: _____		Water Heater
Hook-Up & Relocation Fee		Fixtures (Subtotal) Column 2		Fixtures (Subtotal) Column 1
				Fixtures (Subtotal) Column 2
SEE PERMIT FEE SCHEDULE FOR CALCULATING FEE				Total Fixtures
				Fixture Fee
Hook-Up & Relocation Fee				Permit Fee (Total)
				\$ <u>6.00</u>

TOWN COPY

900233

Permit # _____ City of Portland BUILDING PERMIT APPLICATION Fee \$35. Zone _____ Map # _____ Lot# _____
Please fill out any part which applies to job. Proper plans must accompany form.

Owner: Ken Hovermale Phone # 797-6878
 Address: 34 Belfort St; Portland, ME 04101
 LOCATION OF CONSTRUCTION 34 Belfort St.
 Contractor: Equinox Builders Sub: _____
 Address: 6 Hawthorne Rd; No, Yarmouth, ME 04096
 Est. Construction Cost: \$3000. Proposed Use: 1-family
 Past Use: 1-family
 # of Existing Res. Units _____ # of New Res. Units _____
 Building Dimensions L _____ W _____ Total Sq. Ft. _____
 # Stories: _____ # Bedrooms _____ Lot Size: _____
 Is Proposed Use: Seasonal _____ Condominium _____ Conversion _____
 Explain Conversion ALTERATION - add a 12'x18' deck

For Official Use Only PERMIT ISSUANCE
 Date 4/2/90 Subdivision Name _____
 Inside Fire Limits _____ Name _____
 Bldg Code _____ Lot APP 9 1990
 Time Limit _____ Ownership: Public _____
 Estimated Cost: \$3000. City Of Portland
 Zoning: R-3
 Street Frontage Provided: _____
 Provided Setbacks: Front _____ Back _____ Side _____ Side _____
 Review Required:
 Zoning Board Approval: Yes _____ No _____ Date: _____
 Planning Board Approval: Yes _____ No _____ Date: _____
 Conditional Use: _____ Variance _____ Site Plan _____ Subdivision _____
 Shoreland Zoning Yes _____ No _____ Floodplain Yes _____ No _____
 Special Exception _____
 Other (Explain) OK WDH - P 7-3-90

Foundations:

1. Type of Soil: _____
2. Set Backs - Front _____ Rear _____ Side(s) _____
3. Footings Size: _____
4. Foundation Size: _____
5. Other _____

Floor:

1. Sills Size: _____ Sills must be anchored.
2. Girder Size: _____
3. Lally Column Spacing: _____ Size: _____
4. Joists Size: _____ Spacing 16" O.C.
5. Bridging Type: _____ Size: _____
6. Floor Sheathing Type: _____ Size: _____
7. Other Material: _____

Exterior Walls:

1. Studding Size _____ Spacing _____
2. No. windows _____
3. No. Doors _____
4. Header Sizes _____ Span(s) _____
5. Bracing: Yes _____ No _____
6. Corner Posts Size _____
7. Insulation Type _____ Size _____
8. Sheathing Type _____ Size _____
9. Siding Type _____ Weather Exposure _____
10. Masonry Materials _____
11. Metal Materials _____

Interior Walls:

1. Studding Size _____ Spacing _____
2. Header Sizes _____ Span(s) _____
3. Wall Covering Type _____
4. Fire Wall if required _____
5. Other Materials _____

Ceiling:

1. Ceiling Joists Size: _____
2. Ceiling Strapping Size _____ Spacing _____
3. Type Ceilings: _____
4. Insulation Type _____ Size _____
5. Ceiling Height: _____

Roof:

1. Truss or Rafter Size _____ Span _____
2. Sheathing Type _____ Size _____
3. Roof Covering Type _____

Chimneys:

Type: _____ Number of Fire Places _____

Heating:

Type of Heat: _____

Electrical:

Service Entrance Size: _____ Smoke Detector Required Yes _____ No _____

Plumbing:

1. Approval of soil test if required Yes _____ No _____
2. No. of Tubs or Showers _____
3. No. of Flushes _____
4. No. of Lavatories _____
5. No. of Other Fixtures _____

Swimming Pools:

1. Type: _____
2. Pool Size: _____ x _____ Square Footage _____
3. Must conform to National Electrical Code and State Law.

Permit Received By Louise E. Chase

Signature of Applicant: Dick Baker Date 2 APRIL 90

Signature of CEO Dick Baker Date _____

Inspection Dates _____

900233

Permit # 900233 City of Portland BUILDING PERMIT APPLICATION Fee \$35. Zone _____ Map # _____ Lot# _____

Please fill out any part which applies to job. Proper plans must accompany form.

Owner: Ken Hovez male Phone # 797-6878
 Address: 34 Belfort St; Portland, ME 04101
 LOCATION OF CONSTRUCTION 34 Belfort St.
 Contractor: Equinox Builders Sub.
 Address: 6 Hawthorne Rd; Yarmouth, ME 04096
 Est. Construction Cost: \$3000. Proposed Use: 1-family
 Past Use: 1-family
 # of Existing Res. Units _____ # of New Res Units _____
 Building Dimensions L _____ W _____ Total Sq. Ft. _____
 # Stories: 3 # Bedrooms _____ Lot Size: _____
 Is Proposed Use: Seasonal _____ Condominium _____ Conversion _____
 Explain Conversion: ALTERATION - add a 12'x18' deck

For Official Use Only PERMIT ISSUED
 Date: 4/2/90 Subdivision: _____ Name: APR 3 1990
 Inside Fire Limits _____ Lot: _____
 Bldg Code _____ Ownership: City of Portland Public
 Time Limit _____
 Estimated Cost: \$3000.
 Zoning: R-3
 Street Frontage Provided: _____
 Provided Setbacks: Front _____ Back _____ Side _____
 Review Required:
 Zoning Board Approval: Yes _____ No _____ Date: _____
 Planning Board Approval: Yes _____ No _____ Date: _____
 Conditional Use: _____ Variance _____ Site Plan _____ Subdivision _____
 Shoreland Zoning Yes _____ No _____ Floodplain Yes _____ No _____
 Special Exception _____
 Other (Explain) CK 12x18 deck 4-3-90

Foundation:
 1. Type of Soil: _____
 2. Set Backs Front _____ Rear _____ Side(s) _____
 3. Footings Size: _____
 4. Foundation Size: _____
 5. Other _____

Floor:
 1. Sills Size: _____ Sills must be anchored.
 2. Girder Size: _____
 3. Lally Column Spacing: _____ Size: _____
 4. Joists Size: _____ Spacing 16" O.C.
 5. Bridging Type: _____ Size: _____
 6. Floor Sheathing Type: _____ Size: _____
 7. Other Material: _____

Exterior Walls:
 1. Studding Size _____ Spacing _____
 2. No. windows _____
 3. No. Doors _____
 4. Header Sizes _____ Span(s) _____
 5. Bracing: Yes _____ No _____
 6. Corner Posts Size _____
 7. Insulation Type _____ Size _____
 8. Sheathing Type _____ Size _____
 9. Siding Type _____ Weather Exposure _____
 10. Masonry Materials _____
 11. Metal Materials _____

Interior Walls:
 1. Studding Size _____ Spacing _____
 2. Header Sizes _____ Span(s) _____
 3. Wall Covering Type _____
 4. Fire Wall if required _____
 5. Other Materials _____

Ceiling:
 1. Ceiling Joists Size: _____
 2. Ceiling Strapping Size _____ Spacing _____
 3. Type Ceilings: _____
 4. Insulation Type _____ Size _____
 5. Ceiling Height: _____

Roof:
 1. Truss or Rafter Size _____ Spacing _____
 2. Sheathing Type _____ Size _____
 3. Roof Covering Type _____

Chimneys:
 Type: _____ Number of Fire Places _____

Heating:
 Type of Heat: _____

Electrical:
 Service Entrance Size: _____ Smoke Detector Required Yes _____ No _____

Plumbing:
 1. Approval of soil test if required Yes _____ No _____
 2. No. of Tubs or Showers _____
 3. No. of Flushes _____
 4. No. of Lavatories _____
 No. of Other Fixtures _____

Swimming Pools:
 1. Type: _____
 2. Pool Size: _____ x _____ Square Footage _____
 3. Must conform to National Electrical Code and State Law.

Permit Received By Louise F. Chase

Signature of Applicant Dick Baker Date 2 APR 10

Signature of CEO _____ Date _____

Inspection Dates _____

PLOT PLAN

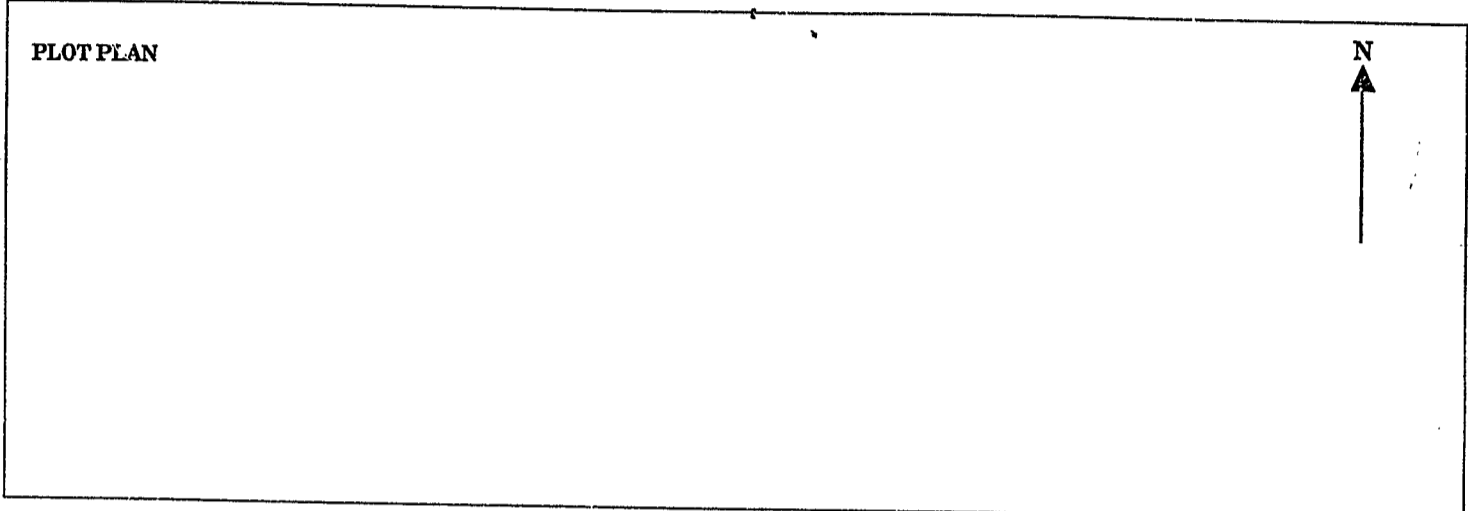

FEES (Breakdown From Front)

Base Fee \$ 35.
 Subdivision Fee \$ _____
 Site Plan Review Fee \$ _____
 Other Fees \$ _____
 (Explain) _____
 Late Fee \$ _____

Inspection Record

Type	Date
_____	____/____/____
_____	____/____/____
_____	____/____/____
_____	____/____/____

COMMENTS *4-6-90 Posts have been set. The framing will be completed within 1 week. 4-26-90 All work complete.*

Signature of Applicant *Dave Baker*

Date *2 APRIL 90*

Hovershale Property
 Zone R-3
 Lot 12113
 34 BELFORD ST.
 PORTLAND.

RECEIVED

APR 02 1990

DEPT. OF BUILDING INSPECTIONS
 CITY OF PORTLAND

34 Belford 1 APR 11 1990
 #NO SCALE

DICK BAKER
 EQUIPOX BUILDERS
 E.L.C. 8463744

*NOTE
 12x18 DECK
 IS PROPOSED ADDITION.
 HOUSE IS 6' OFF
 RIGHT SIDELINE AS SHOWN.
 DECK IS 12' FROM MIDLINE
 OF SEVERAL BENT METAL
 STRAKES.

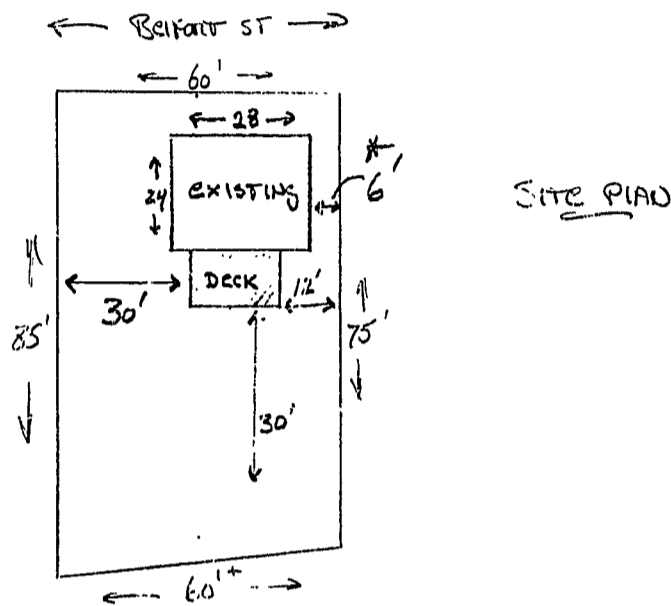

DECK
STRUCTURAL

*NOTE: 33" TAILING
 WITH PSALUSTRELS
 6" O.C. KIT
 (HOW)

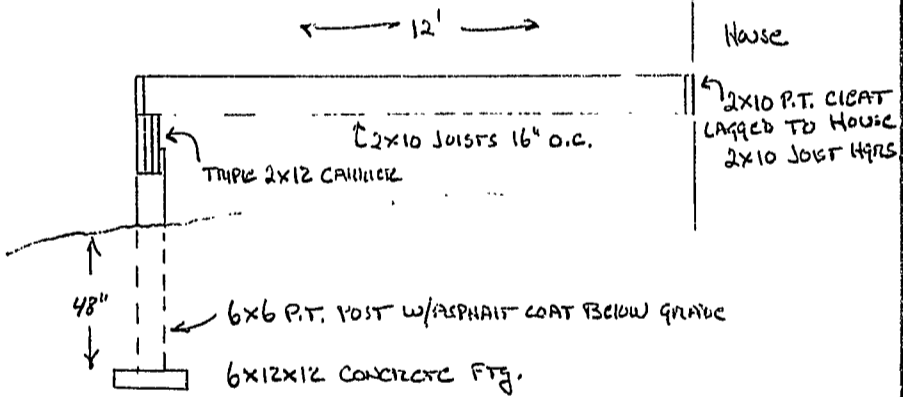

960974

FILL IN AND SIGN WITH INK



APPLICATION FOR PERMIT FOR HEATING, COOKING OR POWER EQUIPMENT

Portland, Maine, 10/1/96

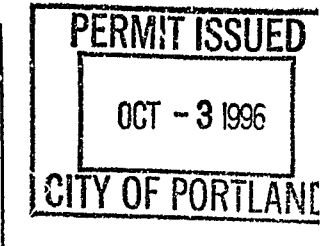

To the INSPECTOR OF BUILDINGS, PORTLAND, ME.

The undersigned hereby applies for a permit to install the following heating, cooking or power equipment in accordance with the Laws of Maine, the Building Code of the City of Portland, and the following specifications:

Location 34 Belfort St Use of Building 1-family No. Stories New Building Existing Name and address of owner of appliance Barbara Bradbury 34 Belfort St Ptld ME 04103 Installer's name and address 130 Burner Service 113 MacArthur Circle - So Ptld ME 04106 Telephone General Description of Work

To install replacement boiler

IF HEATER, OR POWER BOILER

Location of appliance basement Any burnable material in floor surface or beneath? no If so, how protected? Kind of fuel? oil Minimum distance to burnable material, from top of appliance or casing top of furnace 5 ft From top of smoke pipe 4 ft From front of appliance 3 ft From sides or back of appliance 18 inch Size of chimney flue 3 inch Other connections to same flue no If gas fired, how vented? Rated maximum demand per hour 1 gph Will sufficient fresh air be supplied to the appliance to insure proper and safe combustion? yes

IF OIL BURNER

Name and type of burner Beckett Labeled by underwriters' laboratories? yes Will operator be always in attendance? no Does oil supply line feed from top or bottom of tank? bottom Type of floor beneath burner cement Size of vent pipe 6 inch Location of oil storage basement Number and capacity of tanks one 275 gal Low water shut off yes Make OEM No Will all tanks be more than five feet from any flame? yes How many tanks enclosed? none Total capacity of any existing storage tanks for furnace burners 275

IF COOKING APPLIANCE

Location of appliance Any burnable material in floor surface or beneath? If so, how protected? Height of Legs, if any Skirting at bottom of appliance? Distance to combustible material from top of appliance? From front of appliance From sides and back From top of smokepipe Size of chimney flue Other connections to same flue Is hood to be provided? If so, how vented? Forced or gravity? If gas fired, how vented? Rated maximum demand per hour

MISCELLANEOUS EQUIPMENT OR SPECIAL INFORMATION

master oil burner license: MS20005912

Claudia M Bernheisel

Amount of fee enclosed? \$15

APPROVED:

Will there be in charge of the above work a person competent to see that the State and City requirements pertaining thereto are observed? yes

CS 300

INSPECTION FILE APPLICANT'S ASSESSOR'S COPY

Signature of Installer Claudia Bernheisel 10/1/96

7 MA. CARROLL