



APPLICATION FOR PERMIT

PERMIT ISSUED

MAR 13 1985

CITY of PORTLAND

B.O.C.A. USE GROUP
B.O.C.A. TYPE OF CONSTRUCTION 0201
ZONING LOCATION PORTLAND, MAINE 3/13/85

To the CHIEF OF BUILDING & INSPECTION SERVICES, PORTLAND, MAINE

The undersigned hereby applies for a permit to erect, alter, repair, demolish, move or install the following building, structure, equipment or change use in accordance with the Laws of the State of Maine, the Portland B.O.C.A. Building Code and Zoning Ordinance of the City of Portland with plans and specifications, if any, submitted herewith and the following specifications:

LOCATION 25 Ardmore Street Fire District #1 [] #2 []
1. Owner's name and address Woodrow Simons, same Telephone 797-9271
2. Lessee's name and address Telephone
3. Contractor's name and address Ken Ouellette, 16 Pitt Street, Portland Telephone
Proposed use of building 1 car garage (detached) No. of sheets
Last use No. families
Material No. stories Heat Style of roof Roofing
Other buildings on same lot
Estimated contractual cost \$ 4,400 Appeal Fees \$
FIELD INSPECTOR—Mr. @ 775-5451 Base Fee
Late Fee
TOTAL \$ 30.00

to construct a 16x22 1-car garage (detached) as shown on plan

Stamp of Special Conditions

send to #1

NOTE TO APPLICANT: Separate permits are required by the installers and subcontractors of heating, plumbing, electrical and mechanicals.

DETAILS OF NEW WORK

Is any plumbing involved in this work? Is any electrical work involved in this work?
Is connection to be made to public sewer? If not, what is proposed for sewage?
Has septic tank notice been sent? Form notice sent?
Height average grade to top of plate Height average grade to highest point of roof
Size, front depth No. stories solid or filled land? earth or rock?
Material of foundation Thickness, top bottom cellar
Kind of roof Rise per foot Roof covering
No. of chimneys Material of chimneys of lining Kind of heat fuel
Framing Lumber--Kind Dressed or full size? Corner posts Sills
Size Girder Columns under girders Size Max. on centers
Studs (outside walls and carrying partitions) 2x4-16" O. C. Bridging in every floor and flat roof span over 8 feet.
Joists and rafters: 1st floor, 2nd, 3rd, roof
On centers: 1st floor, 2nd, 3rd, roof
Maximum span: 1st floor, 2nd, 3rd, roof
If one story building with masonry walls, thickness of walls? height?

IF A GARAGE

No. cars now accommodated on same lot, to be accommodated, number commercial cars to be accommodated
Will automobile repairing be done other than minor repairs to cars habitually stored in the proposed building?

APPROVALS BY: DATE MISCELLANEOUS
BUILDING INSPECTION—PLAN EXAMINER Will work require disturbing of any tree or public street?
ZONING:
BUILDING CODE: Will there be in charge of the above work a person competent
Fire Dept.: to see that the State and City requirements pertaining thereto
Health Dept.: are observed?
Others:

Signature of Applicant Woodrow Simons Phone #
Type Name of above 1 [] 2 [] 3 [] 4 []
Other and Address

FIELD INSPECTOR'S COPY APPLICANT'S COPY OFFICE FILE COPY

Mr. Simmons
25 Ardmore ST.

1 car garage

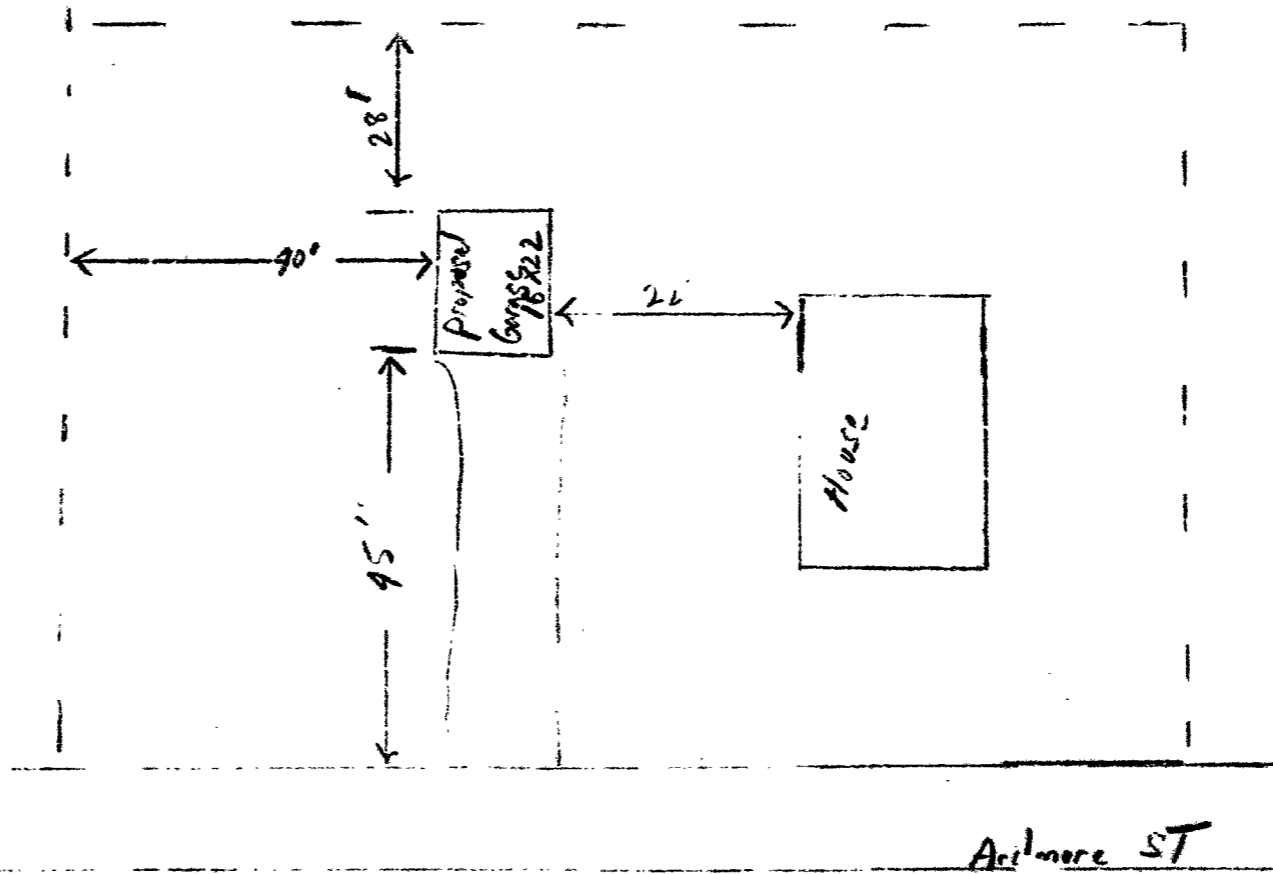

Ardmore ST

Mr. Simms Framing Detail
One Cor garage 16x22'

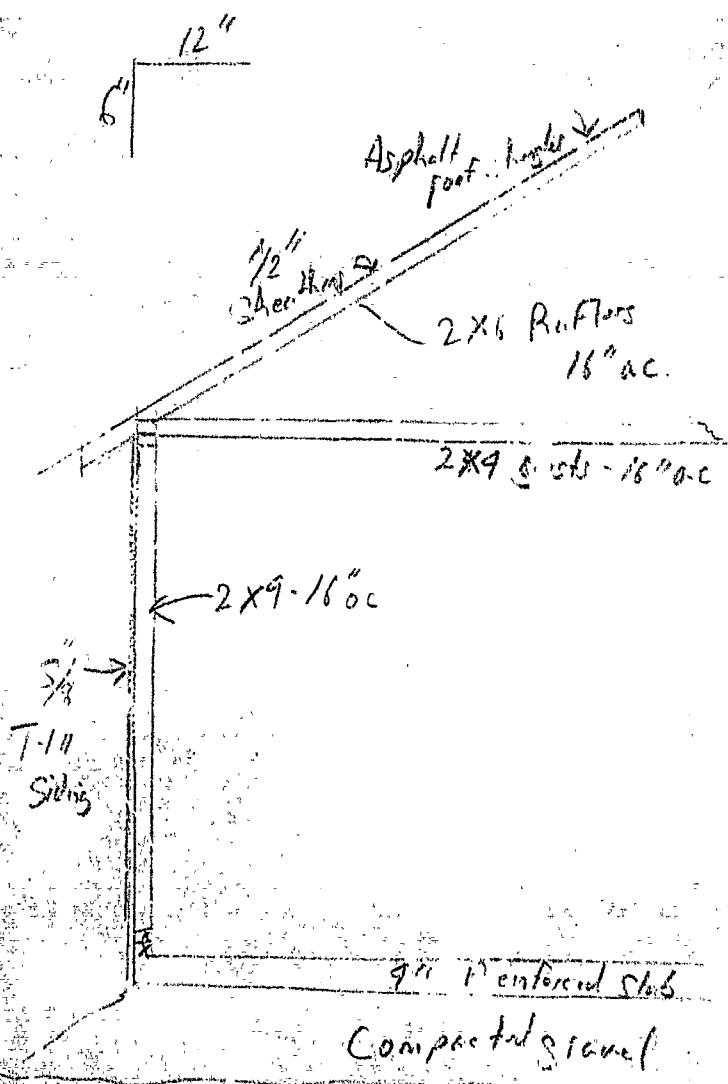

Garage door - 9x7 - 2x8 headers
One window - 2x8 header

APPLICATION FOR PERMIT

B.O.C.A. USE GROUP
B.O.C.A. TYPE OF CONSTRUCTION 0 201
ZONING LOCATION R-5 PORTLAND, MAINE 3/13/85

PERMIT ISSUED
MAR 18 1985
CITY of PORTLAND

To the CHIEF OF BUILDING & INSPECTION SERVICES, PORTLAND MAINE

The undersigned hereby applies for a permit to erect, alter, repair, demolish, move or install the following building, structure, equipment or change use in accordance with the Laws of the State of Maine, the Portland B.O.C.A. Building Code and Zoning Ordinance of the City of Portland with plans and specifications, if any, submitted herewith and the following specifications:

LOCATION 25 Ardmore Street Fire District #1 [] #2 []
1. Owner's name and address Woodrow Simmins, same Telephone 797-9271
2. Lessee's name and address Telephone
3. Contractor's name and address Ken Quellette, 16 Pitt Street, Portland Telephone
Proposed use of building 1 car garage (detached) No. of sheets
Last use No. families
Material No. stories Heat Style of roof Roofing
Other buildings on same lot
Estimated contractual cost \$4,400

FIELD INSPECTOR—Mr @ 775-5451
Appeal Fees \$
Base Fee
Late Fee
TOTAL \$ 30.00

to construct a 16x22 1-car garage (detached) as shown on plan

Stamp of Special Conditions

send to #1

NOTE TO APPLICANT: Separate permits are required by the installers and subcontractors of heating, plumbing, electrical and mechanicals.

DETAILS OF NEW WORK

Is any plumbing involved in this work? Is any electrical work involved in this work?
Is connection to be made to public sewer? If not, what is proposed for sewage?
Has septic tank notice been sent? Form notice sent?
Height average grade to top of plate Height average grade to highest point of roof
Side front depth No. stories solid or filled land? earth or rock?
Material of foundation Thickness, top bottom cellar
Kind of roof Rise per foot Roof covering
No. of chimneys Material of chimneys of lining Kind of heat fuel
Framing Lumber—Kind Dressed or full size? Corner posts Sills
Size Girder Columns under girders Size Max. on centers
Studs (outside walls and carrying partitions) 2x4-16" O. C. Bridging in every floor and flat roof span over 8 feet.
Joists and rafters: 1st floor 2nd 3rd roof
On centers: 1st floor 2nd 3rd roof
Maximum span: 1st floor 2nd 3rd roof
If one story building with masonry walls, thickness of walls? height?

IF A GARAGE

No. cars now accommodated on same lot to be accommodated number commercial cars to be accommodated
Will automobile repairing be done other than minor repairs to cars habitually stored in the proposed building?

APPROVALS BY: DATE MISCELLANEOUS
BUILDING INSPECTION—PLAN EXAMINER Will work require disturbing of any tree on a public street?
ZONING C.K. M.A.C. 3/13/85
BUILDING CODE: Will there be in charge of the above work a person competent
Fire Dept.: to see that the State and City requirements pertaining thereto
Health Dept.: are observed?
Others:

Signature of Applicant W. Woodrow Simmins Phone #
Type Name of above Woodrow Simmins 1 [] 2 [] 3 [] 4 []
Other
and Address

FIELD INSPECTOR'S COPY APPLICANT'S COPY OFFICE FILE COPY

[Handwritten signature and initials]

NOTES

3/10/85
 Nothing started
 3/29/85 - Same
 4/2/85 - Same
 8/86, Completed

Permit No. 85/241
 Location 85/241
 Owner P. ...
 Date of permit 3-13-85
 Approved 3-13-85
 Dwelling
 Garage 1 car attached
 Alteration

85/241
 8/86

