

17 BISHOP STREET

STOKER
STOKER No. 415534
Dated 20th Dec 1952
Printed & Published by
The Commercial Press Ltd.
20, Victoria Street,
HONG KONG



APPLICATION FOR PERMIT

PERMIT ISSUED

B.O.C.A. USE GROUP 000640

AUG 3 1979

B.O.C.A. TYPE OF CONSTRUCTION

July 31, 1979

ZONING LOCATION _____ PORTLAND, MAINE

CITY of PORTLAND

To the DIRECTOR OF BUILDING & INSPECTION SERVICES, PORTLAND, MAINE

The undersigned hereby applies for a permit to erect, alter, repair, demolish, move or install the following building, structure, equipment or change use in accordance with the Laws of the State of Maine, the Portland B.O.C.A. Building Code and Zoning Ordinance of the City of Portland with plans and specifications, if any, submitted herewith and the following specifications:

LOCATION 17 Bishop Street Fire District #1 #2

1. Owner's name and address Maine Turnpike Auth - same Telephone 797-7771

2. Lessee's name and address Telephone

3. Contractor's name and address Owner Telephone

4. Architect Specifications Plans No. of sheets

Proposed use of building No. families

Last use No. families

Material No. stories Heat Style of roof Roofing

Other buildings on same lot

Estimated contractual cost \$ Fee \$ 15.00

FIELD INSPECTOR—Mr. GENERAL DESCRIPTION

This application is for: @ 775-5451 To install underground fuel oil tank,
 Dwelling Ext. 234 as per plans. 1 sheet of plans.

Garage

Masonry Bldg.

Metal Bldg.

Alterations

Demolitions

Change of Use

Other

Stamp of Special Conditions

Sent to Fire Dept. 7-31-79
Rec'd Mean Elm 8-2-79

NOTE TO APPLICANT: Separate permits are required by the installers and subcontractors of heating, plumbing, electrical and mechanicals.

PERMIT IS TO BE ISSUED TO 1 2 3 4
Other:

DETAILS OF NEW WORK

Is any plumbing involved in this work? Is any electrical work involved in this work?

Is connection to be made to public sewer? If not, what is proposed for sewage?

Has septic tank notice been sent? Form notice sent?

Height average grade to top of plate Height average grade to highest point of roof

Size, front depth No. stories solid or filled land? earth or rock?

Material of foundation Thickness, top bottom cellar

Kind of roof Rise per foot Roof covering

No. of chimneys Material of chimneys of lining Kind of heat fuel

Framing Lumber—Kind Dressed or full size? Corner posts Sills

Size Girder Columns under girders Size Max. on centers

Studs (outside walls and carrying partitions) 2x4-16" O. C. Bridging in every floor and flat roof span over 8 feet.

Joists and rafters: 1st floor 2nd 3rd roof

On centers: 1st floor 2nd 3rd roof

Maximum span: 1st floor 2nd 3rd roof

If one story building with masonry walls, thickness of walls? height?

IF A GARAGE

No. cars now accommodated on same lot . . . , to be accommodated . . . number commercial cars to be accommodated . . .
 Will automobile repairing be done other than minor repairs to cars habitually stored in the proposed building?

APPROVALS BY: DATE

BUILDING INSPECTION—PLAN EXAMINER

ZONING: *J. James*

BUILDING CODE: *J. James*

Fire Dept.: *J. James*

Health Dept.:

Others:

MISCELLANEOUS

Will work require disturbing of any tree on a public street? . . .

Will there be in charge of the above work a person competent to see that the State and City requirements pertaining thereto are observed? . . .

Signature of Applicant *David S. Jewell* Phone # same

Type Name of above Maine Turnpike Authority 1 2 3 4

Other and Address

FIELD INSPECTOR'S COPY

NOTES

8-6-79 installed & already covered
area -> F.D. WAS NOTIFIED of permit

Permit No. 99/640
Location 17 Signal Hill (Wentworth)
Owner Mr. Simpson
Date of permit 9-31-79
Approved 8-3-79 [Signature]

[Blank lined area]

[Large handwritten 'X' mark over lined area]

[Blank lined area]



APPLICATION FOR PERMIT
DEPARTMENT OF BUILDING INSPECTIONS SERVICES
ELECTRICAL INSTALLATIONS

Date June 19, 19 78
 Receipt and Permit number A 12128

To the CHIEF ELECTRICAL INSPECTOR, Portland, Maine:
 The undersigned hereby applies for a permit to make electrical installations in accordance with the laws of Maine, the Portland Electrical Ordinance, the National Electrical Code and the following specifications:

LOCATION OF WORK: 17 Bishop Street
 OWNER'S NAME: Me. Turnpike Auth ADDRESS: same

OUTLETS: (number of)
 Lights _____
 Receptacles _____ FEES
 Switches _____
 Plugmold _____ (number of feet)
 TOTAL _____

FIXTURES: (number of)
 Incandescent _____
 Fluorescent _____ (Do not include strip fluorescent)
 TOTAL _____
 Strip Fluorescent, in feet _____

SERVICES:
 Permanent, total amperes _____
 Temporary _____

METERS: (number of) _____

MOTORS: (number of)
 Fractional _____
 1/2 HP or over _____

RESIDENTIAL HEATING:
 Oil or Gas (number of units) _____
 Electric (number of rooms) _____

COMMERCIAL OR INDUSTRIAL HEATING:
 Oil or Gas (by a main boiler) ~~xxx~~ _____ **5.00**
 Oil or Gas (by separate units) _____
 Electric (total number of kws) _____

APPLIANCES: (number of)
 Ranges _____ Water Heaters _____
 Cook Tops _____ Disposals _____
 Wall Ovens _____ Dishwashers _____
 Dryers _____ Compactors _____
 Fans _____ Others (denote) _____
 TOTAL _____

MISCELLANEOUS: (number of)
 Branch Panels _____
 Transformers _____
 Air Conditioners _____
 Signs _____
 Fire/Burglar Alarms _____
 Circus, Fairs, etc. _____
 Alterations to wires _____
 Repairs after fire _____
 Heavy Duty, 220v outlets _____
 Emergency Lights, battery _____
 Emergency Generators _____

INSTALLATION FEE DUE: _____
 FOR ADDITIONAL WORK NOT ON ORIGINAL PERMIT DOUBLE FEE DUE: _____
 FOR REMOVAL OF A "STOP ORDER" (304-16.b) _____
 FOR PERFORMING WORK WITHOUT A PERMIT (304-9) _____
 TOTAL AMOUNT DUE: **5.00**

INSPECTION:
 Will be ready on _____, 19____; or Will Call ~~at~~ **xxx** _____

CONTRACTOR'S NAME: Dixon Bros.
 ADDRESS: 230 Maine St. Gorham
 TEL.: 839-3311

MASTER LICENSE NO.: 1267 SIGNATURE OF CONTRACTOR: Dixon Bros. / Dave Dixon
 LIMITED LICENSE NO.: _____

INSPECTOR'S COPY



FILL IN AND SIGN WITH INK 0 0517

APPLICATION FOR PERMIT FOR HEATING, COOKING OR POWER EQUIPMENT

Portland, Maine, June 19, 1978

PERMIT ISSUED

JUN 20 1978

CITY of PORTLAND

To the INSPECTOR OF BUILDINGS, PORTLAND, ME.

The undersigned hereby applies for a permit to install the following heating, cooking or power equipment in accordance with the Laws of Maine, the Building Code of the City of Portland, and the following specifications:

Location 17 Bishop St. Use of Building office bldg. No. Stories 2 New Building Existing " Name and address of owner of appliance Maine Turnpike Authority - same Installer's name and address Dixon Bros. - 230 Main St. Gorham Telephone 839-3311

General Description of Work

To install boiler & burner - replacement

IF HEATER, OR POWER BOILER

Location of appliance basement Any burnable material in floor surface or beneath? no If so, how protected? Kind of fuel? # 2 fuel oil Minimum distance to burnable material, from top of appliance or casing top of furnace 3 ft. all around From top of smoke pipe From front of appliance From sides or back of appliance Size of chimney flue 12 x 12 Other connections to same flue none If gas fired, how vented? Rated maximum demand per hour Will sufficient fresh air be supplied to the appliance to insure proper and safe combustion? yes

IF OIL BURNER

Name and type of burner Fearless - gun Labelled by underwriters' laboratories? yes Will operator be always in attendance? no Does oil supply line feed from top or bottom of tank? bottom Type of floor beneath burner cement Size of vent pipe 1 1/2 Location of oil storage basement Number and capacity of tanks 2-275 gal. Low water shut off yes Make McDonald Miller No Will all tanks be more than five feet from any flame? yes How many tanks enclosed? none Total capacity of any existing storage tanks for furnace burners 550 gal.

IF COOKING APPLIANCE

Location of appliance Any burnable material in floor surface or beneath? If so, how protected? Height of Legs, if any Skirting at bottom of appliance? Distance to combustible material from top of appliance? From front of appliance From sides and back From top of smokepipe Size of chimney flue Other connections to same flue Is hood to be provided? If so, how vented? Forced or gravity? If gas fired, how vented? Rated maximum demand per hour

MISCELLANEOUS EQUIPMENT OR SPECIAL INFORMATION

Amount of fee enclosed? 5.00

APPROVED:

Signature and date: O.K. P.A. 6/20/78

Will there be in charge of the above work a person competent to see that the State and City requirements pertaining thereto are observed?

CS 300

Signature of Installer

Signature of Installer: Renee Dejon

INSPECTION COPY



APPLICATION FOR PERMIT
DEPARTMENT OF BUILDING INSPECTIONS SERVICES
ELECTRICAL INSTALLATIONS

Date April 12, 19 77
 Receipt and Permit number A09865

To the CHIEF ELECTRICAL INSPECTOR, Portland, Maine:
 The undersigned hereby applies for a permit to make electrical installations in accordance with the laws of Maine, the Portland Electrical Ordinance, the National Electrical Code and the following specifications:

LOCATION OF WORK: 17 Bishop St.
 OWNER'S NAME: Me. Turnpike Authority ADDRESS: same

OUTLETS: (number of)
 Lights 30x 1-30
 Receptacles _____ FEES _____
 Switches _____
 Plugmold _____ (number of feet)
 TOTAL 3.00

FIXTURES: (number of)
 Incandescent _____
 Fluorescent _____ (Do not include strip fluorescent)
 TOTAL _____
 Strip Fluorescent, in feet _____

SERVICES:
 Permanent, total amperes _____
 Temporary _____

METERS: (number of) _____

MOTORS: (number of)
 Fractional _____
 1 HP or over _____

RESIDENTIAL HEATING:
 Oil or Gas (number of units) _____
 Electric (number of rooms) _____

COMMERCIAL OR INDUSTRIAL HEATING:
 Oil or Gas (by a main boiler) _____
 Oil or Gas (by separate units) _____
 Electric (total number of kws) _____

APPLIANCES: (number of)
 Ranges _____ Water Heaters _____
 Cook Tops _____ Disposals _____
 Wall Ovens _____ Dishwashers _____
 Dryers _____ Compactors _____
 Fans _____ Others (denote) _____
 TOTAL, _____

MISCELLANEOUS: (number of)
 Branch Panels _____
 Transformers _____
 Air Conditioners _____
 Signs _____
 Fire/Burglar Alarms _____
 Circus, Fairs, etc. _____
 Alterations to wires _____
 Repairs after fire _____
 Heavy Duty, 220v outlets _____
 Emergency Lights, battery _____
 Emergency Generators _____

INSTALLATION FEE DUE: _____
 FOR ADDITIONAL WORK NOT ON ORIGINAL PERMIT DOUBLE FEE DUE: _____
 FOR REMOVAL OF A "STOP ORDER" (304-16.b) _____
 FOR PERFORMING WORK WITHOUT A PERMIT (304-9) _____
 TOTAL AMOUNT DUE: 3.00

INSPECTION:
 Will be ready on _____, 19____; or Will Call X

CONTRACTOR'S NAME: Eastern Electric
 ADDRESS: P. O. Box 346
 TEL.: 772-6762

MASTER LICENSE NO.: 3279 SIGNATURE OF CONTRACTOR: _____
 LIMITED LICENSE NO.: _____

INSPECTOR'S COPY



1-2 INDUSTRIAL ZONE
APPLICATION FOR PERMIT

Class of Building or Type of Structure office building

Portland, Maine, July 26, 1973

PERMIT ISSUED

00812 JUL 30 1973

CITY of PORTLAND

To the INSPECTOR OF BUILDINGS, PORTLAND, MAINE

The undersigned hereby applies for a permit to erect alter repair demolish install the following building structure equipment in accordance with the Laws of the State of Maine, the Building Code and Zoning Ordinance of the City of Portland, plans and specifications, if any, submitted herewith and the following specifications:

Location Bishop St. Within Fire Limits? _____ Dist. No. _____
 Owner's name and address Maine Turnpike Authority Telephone _____
 Lessee's name and address _____ Telephone _____
 Contractor's name and address Richard L. Hamilton, same Telephone _____
 Architect _____ Specifications _____ Plans _____ No. of sheets _____
 Proposed use of building _____ No. families _____
 Last use _____ No. families _____
 Material _____ No. stories _____ Heat _____ Style of roof _____ Roofing _____
 Other buildings on same lot _____
 Estimated cost \$ 500.00 Fee \$ 3.00

General Description of New Work

Construct a wooden canopy over existing platform (stairs) at westerly end of the building as per plan.

It is understood that this permit does not include installation of heating apparatus which is to be taken out separately by and in the name of the heating contractor. PERMIT TO BE ISSUED TO

Details of New Work

Is any plumbing involved in this work? _____ Is any electrical work involved in this work? _____
 Is connection to be made to public sewer? _____ If not, what is proposed for sewage? _____
 Has septic tank notice been sent? _____ Form notice sent? _____
 Height average grade to top of plate _____ Height average grade to highest point of roof _____
 Size, front _____ depth _____ No. stories _____ solid or filled land? _____ earth or rock? _____
 Material of foundation _____ Thickness, top _____ bottom _____ cellar _____
 Kind of roof _____ Rise per foot _____ Roof covering _____
 No. of chimneys _____ Material of chimneys _____ of lining _____ Kind of heat _____ fuel _____
 Framing Lumber-Kind spruce Dressed or full size? or Corner posts _____ Sills _____
 Size Girder _____ Column under girders _____ Size _____ Max on centers _____
 Studs (outside walls and carrying partitions) 2x4-16" O. C. Bridging in every floor and flat roof span over 8 feet.
 Joists and rafters: 1st floor _____, 2nd _____, 3rd _____, roof _____
 On centers: 1st floor _____, 2nd _____, 3rd _____, roof _____
 Maximum span: 1st floor _____, 2nd _____, 3rd _____, roof _____
 If one story building with masonry walls, thickness of walls? _____ height? _____

If a Garage

No. cars now accommodated on same lot _____, to be accommodated _____ number commercial cars to be accommodated _____
 Will automobile repairing be done other than minor repairs to cars habitually stored in the proposed building? _____

Miscellaneous

Will work require disturbing of any tree on a public street? _____
 Will there be in charge of the above work a person competent to see that the State and City requirements pertaining thereto are observed? YES

Maine Turnpike Authority

APPROVED:
0.4-7/27/73- Allen

INSPECTION COPY

Signature of owner by: Richard L. Hamilton

17 BISHOP STREET

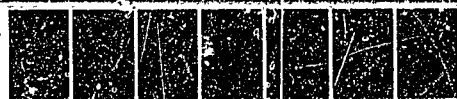

A series of horizontal lines, likely representing a form or a list of items, located below the graphic element. The lines are evenly spaced and extend across the width of the page.

CITY OF PORTLAND, MAINE
SITE PLAN REVIEW
 Processing Form

338

Applicant Maine Turnpike Authority Date Oct. 18, 1983
 Mailing Address 17 Bishop Street
 Address of Proposed Site 414-440 Riverside Street
 Proposed Use of Site office building
 Site Identifier(s) from Assessors Maps _____
 Acreage of Site 2.6 acres / Ground Floor Coverage 9,800 sq. ft.
 Zoning of Proposed Site J-1
 Site Location Review (DEP) Required: () Yes () No
 Board of Appeals Action Required: () Yes () No
 Planning Board Action Required: () Yes () No
 Proposed Number of Floors _____
 Total Floor Area 9,800 sq. ft.
 Other Comments: Major Site Plan Review
 Date Dept. Review Due: _____

BUILDING DEPARTMENT SITE PLAN REVIEW
 (Does not include review of construction plans)

- Use does NOT comply with Zoning Ordinance
 - Requires Board of Appeals Action
 - Requires Planning Board/City Council Action

Explanation: _____

- Use complies with Zoning Ordinance — Staff Review Below

Zoning: SPACE & BULK,
 as applicable

COMPLIES
 COMPLIES
 CONDITIONALLY
 DOES NOT
 COMPLY

DATE	ZONE LOCATION	INTERIOR OR CORNER LOT	40 FT. SETBACK AREA (SEC. 21)	USE	SEWAGE DISPOSAL	REAR YARDS	SIDE YARDS	FRONT YARDS	PROJECTIONS	HEIGHT	LOT AREA	BUILDING AREA	AREA PER FAMILY	WIDTH OF LOT	LOT FRONTAGE	OFF-STREET PARKING	LOADING BAYS

CONDITIONS SPECIFIED BELOW
 REASONS SPECIFIED BELOW

REASONS: _____

[Signature]
 SIGNATURE OF REVIEWING STAFF/DATE

BUILDING DEPARTMENT - ORIGINAL

**CITY OF PORTLAND, MAINE
SITE PLAN REVIEW
Processing Form**

Oct. 18, 1983

Applicant <u>17 Siskoo Street</u>		Date <u> </u>
Mailing Address <u> </u>		Address of Proposed Site <u>414-440 Riverside Street</u>
Proposed Use of Site <u> </u>		Site Identifier(s) from Assessors Maps <u> </u>
Acreage of Site / Ground Floor Coverage <u> </u>		Zoning of Proposed Site <u> </u>
Site Location Review (DEP) Required: () Yes () No	Board of Appeals Action Required: () Yes () No	Proposed Number of Floors <u> </u>
Planning Board Action Required: () Yes () No	Other Comments: <u>Major Site Plan Review</u>	Total Floor Area <u>9,800 sq. ft.</u>
Date Dept. Review Due: <u> </u>		

PLANNING DEPARTMENT REVIEW 10/18/83
(Date Received)

Major Development — Requires Planning Board Approval: Review Initiated

Minor Development — Staff Review Below

	LOADING AREA	PARKING	REGULATION PATTERN	ACCESS	PEDESTRIAN WALKWAYS	SCREENING	LANDSCAPING	SPACE & BULK OF STRUCTURES	LIGHTING	CONFLICT WITH CITY PROJECTS	FINANCIAL CAPACITY	CHANGE IN SITE PLAN
APPROVED	X	X	X	X	X	X		X	X	X	X	
APPROVED CONDITIONALLY							X					
DISAPPROVED												

REASONS:

- In addition to the plant material shown on the plan, the developer must include 20 junipers (Junipers 'Sea Green' or 'Pfitzeriana 18-24") along the front of the building. Refer to attached memo and plan.
- The size of the shade trees are to be increased from the proposed ten feet (1 3/4" caliper) to twelve to fourteen feet (2-2 1/2" caliper).
- The chambers in the disposal area, ^{of the wastewater system} are to be vented as per the

Note: (Attach Separate Sheet if Necessary)
Maine State Plumbing Code, Part 2.
Anne Grimes, City Arborist is available for consultation so that plant materials may be inspected prior to their planting.
Barbara Barkhoff 10/27/83

SIGNATURE OF REVIEWING STAFF/DATE

PLANNING DEPARTMENT COPY

CITY OF PORTLAND, MAINE
SITE PLAN REVIEW
 Processing Form

Maine Turnpike Authority: _____ Date: Oct. 18, 1983

Applicant: 17 High Street _____ Date: _____

Mailing Address: _____ Address of Proposed Site: 414-440 Riverside Street

Proposed Use of Site: _____ Site Identifier(s) from Assessors Maps: _____

Acreage of Site: _____ / Ground Floor Coverage: _____ Zoning of Proposed Site: _____

Site Location Review (DEP) Required: () Yes () No Proposed Number of Floors: _____

Board of Appeals Action Required: () Yes () No Total Floor Area: 9,800 sq. ft.

Planning Board Action Required: () Yes () No

Other Comments: Major Site Plan Review

Date Dept. Review Due: _____

PUBLIC WORKS DEPARTMENT REVIEW

(Date Received) _____

	TRAFFIC CIRCULATION	ACCESS	CURB CUTS	ROAD WIDTH	PARKING	SIGNALIZATION	TURNING MOVEMENTS	LIGHTING	CONFLICT WITH CITY CONSTRUCTION PROJECT	DRAINAGE	SOIL TYPES	SEWERS	CURBING	SIDEWALKS	OTHER	
APPROVED													*	*		CONDITIONS SPECIFIED BELOW
APPROVED CONDITIONALLY																
DISAPPROVED																

REASONS: ** Since Public Works Department approval is given for this site plan even though curb and sidewalk are not shown thereon. Given the nature of the area and the lack of pedestrian traffic we hold this requirement as unnecessary.*

W. A. Southley Oct. 21, 1983

SIGNATURE OF REVIEWING STAFF/DATE

PUBLIC WORKS DEPARTMENT COPY

**CITY OF PORTLAND, MAINE
SITE PLAN REVIEW
Processing Form**

Applicant: 17 Main Street Date: Oct. 18, 1983

Mailing Address: 17 Main Street Address of Proposed Site: 17 Main Street

Proposed Use of Site: Office Site Identifier(s) from Assessors Maps: _____

Acreage of Site: 0.1 Ground Floor Coverage: _____ Zoning of Proposed Site: _____

Site Location Review (DEP) Required: () Yes () No Proposed Number of Floors: _____

Board of Appeals Action Required: () Yes () No Total Floor Area: 3,500 sq. ft.

Planning Board Action Required: () Yes () No

Other Comments: Major Site Also Under Review

Date Dept. Review Due: _____

FIRE DEPARTMENT REVIEW

(Date Received) _____

	ACCESS TO SITE	ACCESS TO STRUCTURES	SUFFICIENT VEHICLE TURNING ROOM	SAFETY HAZARDS	HYDRANTS	SIAMASE CONNECTIONS	SUFFICIENCY OF WATER SUPPLY	OTHER	
APPROVED	<input checked="" type="checkbox"/>	<input checked="" type="checkbox"/>	<input checked="" type="checkbox"/>	<input checked="" type="checkbox"/>	<input checked="" type="checkbox"/>	<input checked="" type="checkbox"/>	<input checked="" type="checkbox"/>	<input checked="" type="checkbox"/>	
APPROVED CONDITIONALLY	<input type="checkbox"/>	<input type="checkbox"/>	<input type="checkbox"/>	<input type="checkbox"/>	<input type="checkbox"/>	<input type="checkbox"/>	<input type="checkbox"/>	<input type="checkbox"/>	CONDITIONS SPECIFIED BELOW
DISAPPROVED	<input type="checkbox"/>	<input type="checkbox"/>	<input type="checkbox"/>	<input type="checkbox"/>	<input type="checkbox"/>	<input type="checkbox"/>	<input type="checkbox"/>	<input type="checkbox"/>	REASONS SPECIFIED BELOW

REASONS: _____

(Attach Separate Sheet if Necessary)

James P. Collins
SIGNATURE OF REVIEWING STAFF/DATE

FIRE DEPARTMENT COPY

0-24-83

CITY OF PORTLAND, MAINE
SITE PLAN REVIEW
Processing Form

287

Applicant Disamine Corporation
 Mailing Address 61 Bishop Street
 Proposed Use of Site Warehouse
 Acreage of Site 54,200 sq ft / 8,703 sq ft. Ground Floor Coverage
 Date August 23, 1982
 Address of Proposed Site 49-71 Bishop Street
 Site Identifier(s) from Assessors Maps 293-A-9
 Zoning of Proposed Site I-2
 Proposed Number of Floors 1
 Total Floor Area _____
 Site Location Review (DEP) Required: () Yes () No
 Board of Appeals Action Required: () Yes () No
 Planning Board Action Required: () Yes () No
 Other Comments: _____
 Date Dept. Review Due: _____

BUILDING DEPARTMENT SITE PLAN REVIEW
 (Does not include review of construction plans)

- Use does NOT comply with Zoning Ordinance
 - Requires Board of Appeals Action
 - Requires Planning Board/City Council Action

Explanation _____

- Use complies with Zoning Ordinance --- Staff Review Below

Zoning:
 SPACE & BULK,
 as applicable

COMPLIES
 COMPLIES
 CONDITIONALLY
 DOES NOT
 COMPLY

DATE	ZONE LOCATION	INTERIOR OR CORNER LOT	40 FT. SETBACK AREA (SEC. 21)	USE	SEWAGE DISPOSAL	REAR YARDS	SIDE YARDS	FRONT YARDS	PROJECTIONS	HEIGHT	LOT AREA	BUILDING AREA	AREA PER FAMILY	WIDTH OF LOT	LOT FRONTAGE	OFF-STREET PARKING	LOADING BAYS

CONDITIONS SPECIFIED BELOW
 REASONS SPECIFIED BELOW

REASONS: _____

[Signature]
 SIGNATURE OF REVIEWING STAFF/DATE 10/13/82
 BUILDING DEPARTMENT - ORIGINAL

~~Hold For
P.W.D. APPROVAL
10/13/82
\$~~

Sam
O.K. to issue
Permit -
Bill Southley

CITY OF PORTLAND, MAINE
SITE PLAN REVIEW
Processing Form

287

Applicant: Edison Electric Date: August 23, 1982

Mailing Address: 40-71 Edison Address of Proposed Site: _____

Proposed Use of Site: _____ Site Identifier(s) from Assessors Maps: _____

Acreage of Site: 1.702 ac. ± Ground Floor Coverage: _____ Zoning of Proposed Site: _____

Site Location Review (DEP) Required: () Yes () No Proposed Number of Floors: _____

Board of Appeals Action Required: () Yes () No Total Floor Area: _____

Planning Board Action Required: () Yes () No

Other Comments: _____

Date Dept. Review Due: _____

PUBLIC WORKS DEPARTMENT REVIEW

(Date Received) _____

	TRAFFIC CIRCULATION	ACCESS	CURB CUTS	ROAD WIDTH	PARKING	SIGNALIZATION	TURNING MOVEMENTS	LIGHTING	CONFLICT WITH CITY CONSTRUCTION PROJECT	DRAINAGE	SOIL TYPES	SEWERS	CURBING	SIDEWALKS	OTHER
APPROVED	✓	✓	✓	✓	✓	✓	✓	✓	✓	✓	✓	✓	✓	✓	✓
APPROVED CONDITIONALLY															
DISAPPROVED															

CONDITIONS SPECIFIED BELOW
 REASONS SPECIFIED BELOW

REASONS: Drainage approved on condition that this department gets and approves a detailed plan of a system to handle possible chemical spills before a permit is given.

(Attach Separate Sheet if Necessary)

W. S. Swalley 8/24/82
 SIGNATURE OF REVIEWING STAFF / DATE

PUBLIC WORKS DEPARTMENT COPY

CITY OF PORTLAND, MAINE
SITE PLAN REVIEW
Processing Form

287

Applicant Massive Corporation Date August 24, 1982
 Mailing Address 61 Bishop Street Address of Proposed Site 67-71 Bishop Street
 Proposed Use of Site Warehouse Site Identifier(s) from Assessors Maps 221-7-03
 Acreage of Site 0.701 sq. ft. Zoning of Proposed Site 1-2
 Site Location Review (DEP) Required: Yes No Proposed Number of Floors _____
 Board of Appeals Action Required: Yes No Total Floor Area _____
 Planning Board Action Required: Yes No
 Other Comments: _____
 Date Dept. Review Due: _____

FIRE DEPARTMENT REVIEW

(Date Received)

	ACCESS TO SITE	ACCESS TO STRUCTURES	SUFFICIENT VEHICLE TURNING ROOM	SAFETY HAZARDS	HYDRANTS	SIAMESE CONNECTIONS	SUFFICIENCY OF WATER SUPPLY	OTHER
APPROVED	<input checked="" type="checkbox"/>	<input checked="" type="checkbox"/>	<input checked="" type="checkbox"/>	<input checked="" type="checkbox"/>	<input checked="" type="checkbox"/>	<input checked="" type="checkbox"/>	<input checked="" type="checkbox"/>	<input checked="" type="checkbox"/>
APPROVED CONDITIONALLY	<input type="checkbox"/>	<input type="checkbox"/>	<input type="checkbox"/>	<input type="checkbox"/>	<input type="checkbox"/>	<input type="checkbox"/>	<input type="checkbox"/>	<input type="checkbox"/>
DISAPPROVED	<input type="checkbox"/>	<input type="checkbox"/>	<input type="checkbox"/>	<input type="checkbox"/>	<input type="checkbox"/>	<input type="checkbox"/>	<input type="checkbox"/>	<input type="checkbox"/>

CONDITIONS SPECIFIED BELOW _____
 REASONS SPECIFIED BELOW _____

REASONS: _____

(Attach Separate Sheet if Necessary)

[Signature]
 SIGNATURE OF REVIEWING STAFF/DATE 8-23-82

FIRE DEPARTMENT COPY

CITY OF PORTLAND, MAINE
SITE PLAN REVIEW
 Processing Form

Applicant _____ Date _____
 Mailing Address _____ Address of Proposed Site _____
 Proposed Use of Site _____ Site Identifier(s) from Assessors Maps _____
 Acreage of Site / Ground Floor Coverage _____ Zoning of Proposed Site _____
 Site Location Review (DEP) Required: () Yes () No Proposed Number of Floors _____
 Board of Appeals Action Required: () Yes () No Total Floor Area _____
 Planning Board Action Required: () Yes () No
 Other Comments: _____
 Date Dept. Review Due: _____

PLANNING DEPARTMENT REVIEW

(Date Received)

- Major Development — Requires Planning Board Approval: Review initiated
 Minor Development — Staff Review Below

	LOADING AREA	PARKING	CIRCULATION PATTERN	ACCESS	PEDESTRIAN WALKWAYS	SCREENING	LANDSCAPING	SPACE & BULK OF STRUCTURES	LIGHTING	CONFLICT WITH CITY PROJECTS	FINANCIAL CAPACITY	CHANGE IN SITE PLAN
APPROVED												
APPROVED CONDITIONALLY												CONDITIONS SPECIFIED BELOW
DISAPPROVED												REASONS SPECIFIED BELOW

REASONS:

(Attach Separate Sheet if Necessary)

Richard K... AUG 20 1982
 SIGNATURE OF REVIEWING STAFF/DATE
 PLANNING DEPARTMENT COPY



APPLICATION FOR PERMIT
DEPARTMENT OF BUILDING INSPECTIONS SERVICES
ELECTRICAL INSTALLATIONS

Date March 1, 1983
 Receipt and Permit number A96642

To the CHIEF ELECTRICAL INSPECTOR, Portland, Maine:

The undersigned hereby applies for a permit to make electrical installations in accordance with the laws of Maine, the Portland Electrical Ordinance, the National Electrical Code and the following specifications:

LOCATION OF WORK: 61 Bishop Street
 OWNER'S NAME: Plasmine Corp. ADDRESS: same

	FEES	
OUTLETS:	Receptacles _____ Switches _____ Plugmold _____ ft. TOTAL _____	✓
FIXTURES: (number of)	Incandescent <u>X</u> Fluorescent _____ (not strip) TOTAL <u>1-10</u>	3.00
	Strip Fluorescent _____ ft.	
SERVICES:	Overhead _____ Underground _____ Temporary _____ TOTAL amperes _____	
METERS: (number of) _____		
MOTORS: (number of)	Fractional _____	
	1 HP or over <u>2</u>	✓ 2.00
RESIDENTIAL HEATING:	Oil or Gas (number of units) _____	
	Electric (number of rooms) _____	
COMMERCIAL OR INDUSTRIAL HEATING:	Oil or Gas (by a main boiler) _____	
	Oil or Gas (by separate units) _____	
	Electric Under 20 kws _____ Over 20 kws _____	
APPLIANCES: (number of)	Ranges _____ Water Heaters _____	
	Cook Tops _____ Disposals _____	
	Wall Ovens _____ Dishwashers _____	
	Dryers _____ Compactors _____	
	Fans _____ Others (denote) _____	
	TOTAL _____	✓
MISCELLANEOUS: (number of)	Branch Panels <u>1</u>	1.00
	Transformers <u>1</u>	2.00
	Air Conditioners Central Unit _____	
	Separate Units (windows) _____	
	Signs 20 sq. ft. and under _____	
	Over 20 sq. ft. _____	
	Swimming Pools Above Ground _____	
	In Ground _____	
	Fire/Burglar Alarms Residential _____	
	Commercial _____	
	Heavy Duty Outlets, 220 Volt (such as welders) 30 amps and under _____	
	over 30 amps _____	
	Circus, Fairs, etc. _____	
	Alterations to wires _____	
	Repairs after fire _____	
	Emergency Lights, battery _____	
	Emergency Generators _____	
	INSTALLATION FEE DUE: _____	
	FOR ADDITIONAL WORK NOT ON ORIGINAL PERMIT DOUBLE FEE DUE: _____	
	FOR REMOVAL OF A "STOP ORDER" (304-16.b)	
	TOTAL AMOUNT DUE: <u>8.00</u>	

INSPECTION:
 Will be ready on _____, 19__ ; or Will Call X
 CONTRACTOR'S NAME: Bailey & Pickrell
 ADDRESS: 11 Allen Ave. Ext.
 TEL.: 797-8633
 MASTER LICENSE NO.: 03105 SIGNATURE OF CONTRACTOR:
 LIMITED LICENSE NO.: _____ Ralph E. Bentley Jr.

INSPECTOR'S COPY — WHITE
 OFFICE COPY — CANARY
 CONTRACTOR'S COPY — GREEN

**CERTIFICATE OF APPROVAL
FOR INTERNAL PLUMBING**

TOWN/CITY CODE: 05170 LPI NUMBER: 00123 DATE PERMIT ISSUED: 3/18/83
 THE TOWN/CITY OF: Portland No: 71004 IC
 Installer's Name: GERBER COMPANY F.I. M.I. []
 Owner: Blasquez []
 Address: 61 Washington Street Subdivision: []
 (Location where plumbing was done and inspected)

- Certificate of App. Number
1. Owner
 2. Licensed Master Plumber
 3. Licensed Oil Burnerman
 4. Employee of Public Utility
 5. Manufactured Housing Dealer
 6. Manufactured Housing Mechanic
 7. Limited License

THE INTERNAL PLUMBING INSTALLED PURSUANT TO THE ABOVE CERTIFICATE OF APPROVAL NUMBER HAS BEEN TESTED IN MY PRESENCE, FOUND TO BE FREE FROM LEAKS, AND WAS INSTALLED IN COMPLIANCE WITH THE MUNICIPAL AND STATE PLUMBING RULES.

Ernest J. Goodwin
 Signature of LPI

Date Inspected: MAR 18 1983

ORIGINAL - To be sent to: Department of Human Services
 Division of Health Engineering

OWNER'S COPY

INTERNAL PLUMBING PERMIT FOR THE TOWN/CITY OF

Town/City Code: 05170 LPI Number: 00123 Date Issued: 3/18/83
 FOR THE TOWN/CITY OF: Portland INSTALLER'S License No.: 71983 No: 71004 IP
 Address of Where Plumbing is Done: 61 Washington Street Subdivision: []
 Name of Owner: PLASANCE CORP F.I. M.I. []
 Last Name: [] F.I. M.I. [] Mailing Address: [] Zip Code: []

Type of Construction	1 New	2 Remodeling	3 Addition	4 Remodeling & Addition	5 Replacement of Hot Water Heater	6 Hook-up of Mobile Home	7 Hook-up of Modular Home	8 Other (Specify)
Plumbing To Serve	1 Single (Res)	2 Multi-Fam(Res)	3 Mobile Home	4 Modular Home	5 Commercial	6 School	7 Other (Specify)	[]
Number of Fixtures or Hook-Ups	Sink(s) []	Toilet(s) []	Bathtub(s) []	Lavatorie(s) []	Shower(s) []	Urinal(s) []	Hook-Up(s) []	[]
	Clothes Washer(s) []	Dish-Washer(s) []	Hot Water Heater(s) []	Floor Drain(s) []	[]	[]	[]	[]

- PERMIT NUMBER
1. Owner
 2. Licensed Master Plumber
 3. Licensed Oil Burnerman
 4. Employee of Public Utility
 5. Manufactured Housing Dealer
 6. Manufactured Housing Mech
 7. Limited License

TOWN'S COPY

IMPORTANT: Note the following conditions:
 1. This Permit is non-transferable to another person or party.
 2. If construction has not started within 6 months from the Date of Issue, this Permit becomes invalid.

Fixture Fee: [] [] [] [] [] [] [] [] [] []
 Hook-Up Fee: [] [] [] [] [] [] [] [] [] []
 Total Fee: [] [] [] [] [] [] [] [] [] []
 If Double Fee Check Box:

Dept. of Human Services
 Div. of Health Engineering

Signature of LPI: _____

APPLICATION FOR PERMIT

PERMIT ISSUED

B.O.C.A. USE GROUP

B.O.C.A. TYPE OF CONSTRUCTION 00707

JUL 14 1983

ZONING LOCATION PORTLAND, MAINE July 12, 1983

CITY OF PORTLAND

To the CHIEF OF BUILDING & INSPECTION SERVICES, PORTLAND, MAINE

The undersigned hereby applies for a permit to erect, alter, repair, demolish, move or install the following building, structure, equipment or change use in accordance with the Laws of the State of Maine, the Portland B.O.C.A. Building Code and Zoning Ordinance of the City of Portland with plans and specifications, if any, submitted herewith and the following specifications:

LOCATION .. 61 Bishop Street .. Fire District #1 , #2

1. Owner's name and address .. Plasme Corporation - same .. Telephone 797-5009

2. Lessee's name and address Telephone ..

3. Contractor's name and address .. Thomas E. Burns - 5 Woodward Lane, Falmouth .. Telephone 781-4411

Proposed use of building .. offices with remodeling .. No. of sheets ..

Last use .. same .. No. families ..

Material .. No. stories .. Heat .. Style of roof .. Roofing ..

Other buildings on same lot ..

Estimated contractual cost \$.. 6,500 .. Appeal Fees \$..

FIELD INSPECTOR—Mr. .. Base Fee .. 45.00

@ 775-5451 .. Late Fee ..

TOTAL \$.. 45.00

To erect partitions to divide existing office space and to install 2 windows, as per plans, 1 sheet of plans.

send permit to # 1 04

Stamp of Special Conditions

NOTE TO APPLICANT: Separate permits are required by the installers and subcontractors of heating, plumbing, electrical and mechanicals.

DETAILS OF NEW WORK

Is any plumbing involved in this work? .. no .. Is any electrical work involved in this work? .. no

Is connection to be made to public sewer? .. If not, what is proposed for sewage? ..

Has septic tank notice been sent? .. Form notice sent? ..

Height average grade to top of plate .. Height average grade to highest point of roof ..

Size, front .. depth .. No. stories .. solid or filled land? .. earth or rock? ..

Material of foundation .. Thickness, top .. bottom .. cellar ..

Kind of roof .. Rise per foot .. Roof covering ..

No. of chimneys .. Material of chimneys .. of lining .. Kind of heat .. fuel ..

Framing Lumber—Kind .. Dressed or full size? .. Corner posts .. Sills ..

Size Girder .. Columns under girders .. Size .. Max. on centers ..

Studs (outside walls and carrying partitions) 2x4-16" O. C. Bridging in every floor and flat roof span over 8 feet.

Joists and rafters: 1st floor .. 2nd .. 3rd .. roof ..

On centers: 1st floor .. 2nd .. 3rd .. roof ..

Maximum span: 1st floor .. 2nd .. 3rd .. roof ..

If one story building with masonry walls, thickness of walls? .. height? ..

IF A GARAGE

No. cars now accommodated on same lot .. to be accommodated .. number commercial cars to be accommodated ..

Will automobile repairing be done other than minor repairs to cars habitually stored in the proposed building? ..

APPROVALS BY: DATE MISCELLANEOUS .. no

BUILDING INSPECTION—PLAN EXAMINER .. Will work require disturbing of any tree on a public street? ..

ZONING: ..

BUILDING CODE: .. Will there be in charge of the above work a person competent

Fire Dept.: .. to see that the State and City requirements pertaining thereto

Health Dept.: .. are observed? yes

Others: ..

Signature of Applicant .. Eugene J. Rogers .. Phone # .. same

Type Name of above .. Eugene/Rogers for Thomas Burns .. 1 2 3 4

/Plasme Corporation .. Other ..

and Address ..

FIELD INSPECTOR'S COPY

APPLICANT'S COPY

OF FILE COPY



APPLICATION FOR PERMIT
DEPARTMENT OF BUILDING INSPECTIONS SERVICES
ELECTRICAL INSTALLATIONS

Date July 1 1968
 Receipt and Permit number 22307

To the **CHIEF ELECTRICAL INSPECTOR, Portland, Maine.**
 The undersigned hereby applies for a permit to make electrical installations in accordance with the laws of
 Maine, the Portland Electrical Ordinance, the National Electrical Code and the following specifications:

LOCATION OF WORK: 17 Bishop St.
 OWNER'S NAME: James Sargis ADDRESS: 119 Forest Ave., Portland

OUTLETS:	Receptacles _____	Switches _____	Plugmold _____	R. TOTAL _____	FEES
FIXTURES: (number of)	Incandescent _____	Flourescent _____	(not str) _____	TOTAL _____	
	Strip Flourescent _____ ft.				
SERVICES:	Overhead _____	Underground _____	Temporary _____	TOTAL amperes _____	
METERS: (number of)					
MOTORS: (number of)	Fractional _____				
	1 HP or over _____				
RESIDENTIAL HEATING:	Oil or Gas (number of unit) _____				
	Electric (number of rooms) _____				
COMMERCIAL OR INDUSTRIAL HEATING:	Oil or Gas (by a main boiler) _____				
	Oil or Gas (by separate units) _____				
	Electric Under 20 kws _____	Over 20 kws _____			
APPLIANCES (number of)	Ranges _____	Water Heaters _____			
	Cook Tops _____	Disposals _____			
	Wall Ovens _____	Dishwashers _____			
	Dryers _____	Compactors _____			
	Fans _____	Others (denote) _____			
	TOTAL _____				
MISCELLANEOUS (number of)	Branch Panels _____				
	Transformers _____				
	Air Conditioners Central Unit _____				
	Separate Units (windows) _____				
	Signs 20 sq ft and under _____				
	Over 20 sq. ft _____				
	Swimming Pools Above Ground _____				
	In Ground _____				
	Fire/Burglar Alarms Residential _____				
	Commercial _____				
	Heavy Duty Outlets 220 Volt (such as welders) 30 amps and under _____				
	over 30 amps _____				
	Circus, Fairs, etc. _____				
	Alteration to wires _____				
	Repairs after fire _____				5.00 Min.
	Emergency Lights, battery _____				
	Emergency Generators _____				

FOR ADDITIONAL WORK NOT ON ORIGINAL PERMIT INSTALLATION FEE DUE _____
 FOR REMOVAL OF A "STOP ORDER" (304-16.b) DOUBLE FEE DUE _____
TOTAL AMOUNT DUE: 5.00

INSPECTION:
 Will be ready on 7-1, 1968; or Will Call _____
CONTRACTOR'S NAME: Edwin Leland Lowell, Jr. (Marlio's Elec.)
ADDRESS: 337 Deering Ave., Portland, ME 04101
TEL: 774-3129
MASTER LICENSE NO: 12584 **SIGNATURE OF CONTRACTOR:** Edwin L. Lowell, Jr.
LIMITED LICENSE NO: _____

INSPECTOR'S COPY — WHITE
 OFFICE COPY — CANARY
 CONTRACTOR'S COPY — GREEN

CITY OF Portland BUILDING PERMIT APPLICATION

MAP # _____ LOT# _____

Please fill in any part which applies to job. Proper plans must accompany form.
 Owner: John P. Pease
 Address: River Road Windham
 LOCATION OF CONSTRUCTION: 1/2 Bishop Street
 CONTRACTOR: TPC Associates SUBCONTRACTORS: Call to pick up
 ADDRESS: PO Box 2704 So. Portland 04106 767-5191
 Est. Construction Cost: \$13,500 Type of Use: Dance School

For Official Use Only	
Date: <u>APR 19 1988</u>	Subdivision: Yes / No _____
Inside Fire Limits _____	Name _____
Blind Code _____	Lot _____
_____	Block _____
Estimate Cost: <u>\$13,500</u>	Permit Expiration _____
Value Structure _____	Ownership: _____
Fee: <u>00</u>	Public/Private _____

Building Dimensions: L _____ W _____ S _____ Stories _____ Lot Size _____
 Is Proposed Use: _____ Condominium _____ Apartment _____
 Construction: Explain Add no. loadbearing walls to existing space

COMPLETE ONLY IF THE NUMBER OF UNITS WILL CHANGE
 Residential Buildings Only:
 # of Dwelling Units _____ # of New Dwelling Units _____

Foundation:
 1. Type of Soil: _____
 2. Set Backs - Front _____ Rear _____ Side(s) _____
 3. Footings Size: _____
 4. Foundation Size: _____
 5. Other _____

Floor:
 1. Sills Size: _____ Sills must be anchored.
 2. Girder Size: _____
 3. Lally Column Spacing: _____ Size: _____
 4. Joists Size: _____ Spacing 16 C.
 5. Bridging Type: _____ Size: _____
 6. Floor Sheathing Type: _____ Size: _____
 7. Other Material: _____

Exterior Walls:
 1. Studding Size _____ Spacing _____
 2. No. windows _____
 3. No. Doors _____
 4. Header Sizes _____ Span(s) _____
 5. Bracing: Yes _____ No _____
 6. Corner Posts Size _____
 7. Insulation Type _____ Size _____
 8. Sheathing Type _____ Size _____
 9. Siding Type _____ Weather Exposure _____
 10. Masonry Materials _____
 11. Metal Materials _____

Exterior Walls:
 1. Studding Size _____ Spacing _____
 2. Header Sizes _____ Span(s) _____
 3. Wall Covering Type _____
 4. Fire Wall if required _____
 5. Other Materials _____

Ceiling:
 1. Ceiling Joists Size: _____
 2. Ceiling Strapping Size _____ Spacing _____
 3. Type Ceilings: _____
 4. Insulation Type _____ Size _____
 5. Ceiling Height: _____

Roof:
 1. Truss or Rafter Size _____ Span _____
 2. Sheathing Type _____ Size _____
 3. Roof Covering Type _____
 4. Other _____

Chimneys:
 Type: _____ Number of Fire Places _____

Heating:
 Type of Heat: _____

Electrical:
 Service Entrance Size: _____ Smoke Detector Required Yes _____ No _____

Plumbing:
 1. Approval of soil test if required Yes _____ No _____
 2. No. of Tubs or Showers _____
 3. No. of Finishes _____
 4. No. of Lavatories _____
 5. No. of Other Fixtures _____

Swimming Pools:
 1. Type: _____
 2. Pool Size: _____ Square Footage _____
 3. Must conform to National Electrical Code and State Law.

Zoning:
 District _____ Street Fronting _____ Provided _____
 Required Setbacks: Front _____ Back _____ Side _____

Review Required:
 Zoning Board Approval: Yes _____ No _____ Date _____
 Planning Board Approval: Yes _____ No _____ Date _____
 Conditional Use: _____ Variance: _____ Site Plan _____ Subdivisor _____
 Short and Precise Main Mgmt _____ Special Exception _____
 Other: _____ (Explain) _____
 Date Approved _____

Permit Received By: Lynne Benoit
 Signature of Applicant: [Signature] Date: 4/19/88
 Signature of CEO: David Pease Date: _____
 Inspection Dates: _____



APPLICATION FOR PERMIT
DEPARTMENT OF BUILDING INSPECTION SERVICES
ELECTRICAL INSTALLATIONS

Date June 16 1988
 Receipt and Permit number 2972

To the CHIEF ELECTRICAL INSPECTOR, Portland, Maine:
 The undersigned hereby applies for a permit to make electrical installations in accordance with the laws of Maine, the Portland Electrical Ordinance, the National Electrical Code and the following specifications:
 LOCATION OF WORK: 27 Bishop St., Portland, Me 04102
 OWNER'S NAME: American School of Dance ADDRESS: same

OUTLETS:		FEES
Receptacles <u>26</u>	Switches _____ Plugmold _____ ft. TOTAL <u>26</u>	_____
FIXTURES: (number)		_____
Incandescent _____	Fluorescent _____ (not strip) TOTAL <u>2</u>	_____
Strip fluorescent _____		_____
SERVICES:		
Overhead _____	Underground _____	Temporary _____ TOTAL amperes _____
METERS: (number of) _____		
MOTORS: (number of)		
Fraction _____		
1 HP. or over _____		
RESIDENTIAL HEATING:		
Oil or Gas (number of units) _____		_____
Electric (number of rooms) _____		_____
COMMERCIAL OR INDUSTRIAL HEATING:		
Oil or Gas (by a main boiler) _____		_____
Oil or Gas (by separate units) _____		_____
Electric Under 20 kws _____		Over 20 kws _____
APPLIANCES: (number of)		
Ranges _____	Water Heaters _____	_____
Cook Tops _____	Disposals _____	_____
Wall Ovens _____	Dishwashers _____	_____
Dryers _____	Compactors _____	_____
Fans _____	Others (detail) _____	_____
TOTAL _____		
MISCELLANEOUS: (number of)		
Branch Panels _____		
Transformers _____		
Air Conditioners Central Unit _____		
Separate Units (windows) _____		
Signs 20 sq. ft. and under _____		
Over 20 sq. ft. _____		
Swimming Pools Above Ground _____		
In Ground _____		
Fire/Burglar Alarms Residential _____		
Commercial _____		
Heavy Duty Outlets, 220 Volt (such as welders) 30 amps and under _____		
over 30 amps _____		
Circus, Fairs, etc. _____		
Alterations to wires _____		
Repairs after fire _____		
Emergency Lights or other _____		
Emergency Generators _____		
FOR ADDITIONAL WORK NOT ON ORIGINAL PERMIT		INSTALLATION FEE DUE: _____
FOR REMOVAL OF A "STOP ORDER" (304-16.b)		DOUBLE FEE DUE: _____
		TOTAL AMOUNT DUE: <u>6.00</u>

INSPECTION:
 Will be ready on June 16, 1988, or Will Call _____
 CONTRACTOR'S NAME: Rudy A. Clark
 ADDRESS: 22 South Street, Portland, Me 04101
 TEL: 774-8970
 MASTER LICENSE NO.: 10745
 LIMITED LICENSE NO.: _____

SIGNATURE OF CONTRACTOR:
Rudy A. Clark

INSPECTOR'S COPY — WHITE
 OFFICE COPY — CANARY
 CONTRACTOR'S COPY — GREEN

INSPECT NS. Service _____ by _____
Service installation _____
Change-in _____ by _____

PROGRESS INSPECTIONS:

DATE:	REMARKS:

ELECTRICAL INSTALLATION
DATE: 3/2/59
Inspector: [Signature]
F-2 (Inst. Cl.) [Signature]
Inspector: [Signature]
Public Application Register Page No. 25

74
75

ELECTRICAL INSTALLATIONS

Permit Number 29514
Location 1700 Rockledge Dr
Owner George M. ...
Date of Permit 8/31/88
Final Inspection 9/23/88
By Inspector [Signature]
Permit Application Register Page No. 12

INSPECTIONS: Service 350 amp by [Signature]
Service called in 10/11/88
Closing-in 9/6/88 by [Signature]

PROGRESS INSPECTIONS:

DATE:	REMARKS:
9/23/88	Recess Section additional walls may be closed in
10/27/88	Final for Cozo completed

COZO COMPLIANCE COMPLETED DATE 10/27/88



APPLICATION FOR PERMIT
DEPARTMENT OF BUILDING INSPECTIONS SERVICES
ELECTRICAL INSTALLATIONS

Date August 31, 1988, 19
 Receipt and Permit number 29514

To the CHIEF ELECTRICAL INSPECTOR, Portland, Maine:
 The undersigned hereby applies for a permit to make electrical installations in accordance with the laws of
 Maine, the Portland Electrical Ordinance, the National Electrical Code and the following specifications:

LOCATION OF WORK: 17 Bishop Street
 OWNER'S NAME: Dirigo Management ADDRESS: 178 Middle Street

OUTLETS:	FEES
Receptacles <u>83</u> Switches <u>24</u> Plugmold _____ ft. TOTAL 107x	10.00
FIXTURES: (number of)	
Incandescent _____ Fluorescent <u>x</u> (not strip) TOTAL <u>75</u>	21.50
Strip Fluorescent _____ ft.	
SERVICES:	
Overhead <u>x</u> Underground _____ Temporary _____ TOTAL amperes <u>400</u> ..	3.00
METERS: (number of) <u>4</u>	2.00
MOTORS: (number of)	
Fractional _____	
1 HP or over _____	
RESIDENTIAL HEATING:	
Oil or Gas (number of units) _____	
Electric (number of rooms) _____	
COMMERCIAL OR INDUSTRIAL HEATING:	
Oil or Gas (by a main boiler) <u>X</u>	5.00
Oil or Gas (by separate units) _____	
Electric Under 20 kws _____ Over 20 kws _____	
APPLIANCES: (number of)	
Ranges _____	Water Heaters <u>1</u>
Cook Tops _____	Disposals _____
Wall Ovens _____	Dishwashers _____
Dryers _____	Compactors _____
Fans <u>3</u>	Others (denote) _____
TOTAL	6.00
MISCELLANEOUS: (number of)	
Branch Panels _____	
Transformers _____	
Air Conditioners Central Unit _____	
Separate Units (windows) _____	
Signs 20 sq. ft. and under _____	
Over 20 sq. ft. _____	
Swimming Pools Above Ground _____	
In Ground _____	
Fire/Burglar Alarms Residential _____	
Commercial <u>1</u>	5.00
Heavy Duty Outlets, 220 Volt (such as welders) 30 amps and under _____	
over 30 amps _____	
Circus, Fairs, etc. _____	
Alterations to wires _____	
Repairs after fire _____	
Emergency Lights, battery _____	
Emergency Generators _____	
FOR ADDITIONAL WORK NOT ON ORIGINAL PERMIT	INSTALLATION FEE DUE:
FOR REMOVAL OF A "STOP ORDER" (304-16.b)	DOUBLE FEE DUE:
	TOTAL AMOUNT DUE: <u>52.50</u>

INSPECTION:
 Will be ready on _____, 19__; or Will Call _____ X
 CONTRACTOR'S NAME: Michael LaPlante
 ADDRESS: 2 Evergreen Drive
 TEL.: 878-2868
 MASTER LICENSE NO.: 03714 SIGNATURE OF CONTRACTOR: Michael LaPlante
 LIMITED LICENSE NO.: _____

INSPECTOR'S COPY — WHITE
 OFFICE COPY — CANARY
 CONTRACTOR'S COPY — GREEN

PERMIT # 000411 CITY OF Portland BUILDING PERMIT APPLICATION MAP # _____ LOT# _____

Please fill out any part which applies to job. Proper plans must accompany form.

Owner: John Miele
 Address: River Road Windham

LOCATION OF CONSTRUCTION 17 Bishop Street

CONTRACTOR: TPC Associates SUBCONTRACTORS: Call to pick up
 ADDRESS: PO Box 2704 So. Portland 04106 767-5191

Est. Construction Cost: \$13,500 Type of Use: Dance School

Past Use: _____

Building Dimensions: L _____ W _____ Sq. Ft. _____ # Stories _____ Lot Size _____

Is Proposed Use: _____ Seasonal _____ Condo./inlum _____ Apartment _____
 Conversion - Explain Add non-loadbearing walls to existing space

COMPLETE ONLY IF THE NUMBER OF UNITS WILL CHANGE
 Residential Buildings Only
 # Of Dwelling Units _____ # Of New Dwelling Units _____

Foundation:
 1. Type of Soil: _____
 2. Set Backs - Front _____ Rear _____ Side(s) _____
 3. Footings Size: _____
 4. Foundation Size: _____
 5. Other _____

Floor:
 1. Sills Size: _____ Sills must be anchored.
 2. Girder Size: _____
 3. Lally Column Spacing: _____ Size: _____
 4. Joists Size: _____ Spacing 16" O.C.
 5. Bridging Type: _____ Size: _____
 6. Floor Sheathing Type: _____ Size: _____
 7. Other Material: _____

Exterior Walls:
 1. Studding Size _____ Spacing _____
 2. No. windows _____
 3. No. Doors _____
 4. Header Sizes _____ Span(s) _____
 5. Bracing: Yes _____ No _____
 6. Corner Posts Size _____
 7. Insulation Type _____ Size _____
 8. Sheathing Type _____ Size _____
 9. Siding Type _____ Weather Exposure _____
 10. Masonry Materials _____
 11. Metal Materials _____

Interior Walls:
 1. Studding Size _____ Spacing _____
 2. Header Sizes _____ Span(s) _____
 3. Wall Covering Type _____
 4. Fire Wall if required _____
 5. Other Materials _____

For Official Use Only

Date: April 19, 1988 Subdivision: Yes / No _____
 Inside Fire Limits: _____ Name: _____
 Blg Code: _____ Lot: _____
 Time Limit: _____ Block: _____
 Estimated Cost: \$13,500 Permit Expiration: _____
 Value/Structure: _____ Owner: _____ Public _____
 Fee: 90 Private _____

Ceiling:
 1. Ceiling Joists Size: _____
 2. Ceiling Strapping Size _____ Spacing _____
 3. Type Ceilings: _____
 4. Insulation Type _____ Size _____
 5. Ceiling Height: _____

Roof:
 1. Truss or Rafter Size _____ Span _____
 2. Sheathing Type _____ Size _____
 3. Roof Covering Type _____
 4. Other _____

Chimneys:
 Type: _____ Number of Fire Places _____

Heating:
 Type of Heat: _____

Electrical:
 Service Entrance Size: _____ Smoke Detector Required Yes _____ No _____

Plumbing:
 1. Approval of soil test if required Yes _____ No _____
 2. No. of Tubs or Showers _____
 3. No. of Flushes _____
 4. No. of Lavatories _____
 5. No. of Other Fixtures _____

Swimming Pools:
 1. Type: _____
 2. Pool Size: _____ x _____ Square Footage _____
 3. Must conform to National Electrical Code and State Law.

Zoning:
 District: _____ Street Frontage Req. _____ Provided _____
 Required Setbacks: Front _____ Back _____ Side _____ Side _____

Review Required:
 Zoning Board Approval: Yes _____ No _____ Date: _____
 Planning Board Approval: Yes _____ No _____ Date: _____
 Conditional Use: _____ Variance _____ Site Plan _____ Subdivision _____
 Shore and Floodplain Mgmt. _____ Special Exception _____
 Other: _____ (Explain) _____
 Date Approved: _____

Permit Received By Lynne Benoit

Signature of Applicant [Signature] Date 4/19/88

Signature of CEO [Signature] Date 4/20/88

Inspection Dates _____

PLOT PLAN

N



FEES (Breakdown From Front)		Type	Inspection Record	Date
Base Fee \$	90 - pd 4/19/88			/ /
Subdivision Fee \$				/ /
Site Plan Review Fee \$				/ /
Other Fees \$				/ /
(Explain)				/ /
Late Fee \$				/ /

COMMENTS

Signature of Applicant *M. Case*

Date *19 APR 1988*

PERMIT # 000939 CITY OF Portland BUILDING PERMIT APPLICATION MAP # _____ LOT# _____

Please fill out any part which applies to job. Proper plans must accompany form.

Owner: Dirigo Management Co.
 Address: 178 Middle Street
 LOCATION OF CONSTRUCTION 17 Bishop Street
 CONTRACTOR: owner SUBCONTRACTORS: 871-1080
 ADDRESS: _____

For Official Use Only	
Date: <u>July 25, 1988</u>	Subdivision: Yes / No _____
Inside Fire Limits _____	Name _____
Blkg Code _____	Lot _____
Time Limit _____	Block _____
Estimated Cost _____	Permit Expiration: _____
Value/Structure _____	Ownership: _____ Public _____ Private _____
Fee: <u>10.00</u>	

Est. Construction Cost: _____ Type of Use: commercial
 Past Use: _____
 Building Dimensions L _____ W _____ Sq. Ft. _____ # Stories _____ Lot Size _____
 Is Proposed Use: _____ Seasonal _____ Condominium _____ Apartment _____
 Conversion - Explain remove 1 3,000 gallon tank

COMPLETE ONLY IF THE NUMBER OF UNITS WILL CHANGE
 Residential Buildings Only:
 # Of Dwelling Units _____ # Of New Dwelling Units _____

Foundation:
 1. Type of Soil: _____
 2. Set Backs - Front _____ Rear _____ Side(s) _____
 3. Footings Size: _____
 4. Foundation Size: _____
 5. Other _____

Floor:
 1. Sills Size: _____ Sills must be anchored.
 2. Girder Size: _____
 3. Lally Column Spacing: _____ Size: _____
 4. Joists Size: _____ Spacing 16" O.C.
 5. Bridging Type: _____ Size: _____
 6. Floor Sheathing Type: _____ Size: _____
 7. Other Material: _____

Exterior Walls:
 1. Studding Size _____ Spacing _____
 2. No. windows _____
 3. No. Doors _____
 4. Header Sizes _____ Span(s) _____
 5. Bracing: Yes _____ No _____
 6. Corner Posts Size _____
 7. Insulation Type _____ Size _____
 8. Sheathing Type _____ Size _____
 9. Siding Type _____ Weather Exposure _____
 10. Masonry Materials _____
 11. Metal Materials _____

Interior Walls:
 1. Studding Size _____ Spacing _____
 2. Header Sizes _____ Span(s) _____
 3. Wall Covering Type _____
 4. Fire Wall if required _____
 5. Other Materials _____

Ceiling:
 1. Ceiling Joists Size: _____
 2. Ceiling Strapping Size _____ Spacing _____
 3. Type Ceilings: _____
 4. Insulation Type _____
 5. Ceiling Height: _____

Roof:
 1. Truss or Rafter Size AUG 4" x 12" Span
 2. Sheathing Type City of Portland
 3. Roof Covering Type _____
 4. Other _____

Chimneys:
 Type: _____ Number of Fire Places _____

Heating:
 Type of Heat: _____

Electrical:
 Service Entrance Size: _____ Smoke Detector Required Yes _____ No _____

Plumbing:
 1. Approval of soil test if required Yes _____ No _____
 2. No. of Tubs or Showers _____
 3. No. of Flushes _____
 4. No. of Lavatories _____
 5. No. of Other Fixtures _____

Swimming Pools:
 1. Type: _____
 2. Pool Size: _____ x _____ Square Footage _____
 3. Mtc it conform to National Electrical Code and State Law.

Zoning:
 District R2 Street Frontage Req. _____ Provided _____
 Required Setbacks: Front _____ Back _____ Side _____ Side _____

Review Required:
 Zoning Board Approval: Yes _____ No _____ Date: _____
 Planning Board Approval: Yes _____ No _____ Date: _____
 Conditional Use: _____ Variance _____ Site Plan _____ Subdivision _____
 Shore and Floodplain Mgmt _____ Special Exception _____
 Other: (Explain) _____
 Date Approved: July 25, 1988

Permit Received By Joanna Quint

Signature of Applicant [Signature] Date July 28, 1988

Signature of CEO [Signature] Date 8-3-88

Inspection Dates _____

<<<< T.S.M. LIVE DEVELOPMENT SYSTEM (TSMSYS) >>>> UNOTANKU
EIU022 : *** Make desired changes and TRANSMIT (F6 FOR NEXT PAGE) ***
Facility Name: REICHHOLD CHEMICALS, INC. Registration Number: 1685
Location: PORTLAND
Owner: REICHHOLD CHEMICALS, INC.

Installer ID: NOTE - All dates are entered MM/YY

Tank Number	Tank Type	Pipe Type	Tank Size	Added Prot.	Product Stored	Date Installed	Inact. Stat	Product Left	Fee App
1	large asphalt steel	galvanized M steel	3000		02 oil	01/80	Active B /		N

Is This Tank Manifolder? If Yes, Tank Number

	Date	Tester	Results	Replication
Last Tank Test:	/			
Last Piping Test:	/			
Visual Inspection:				
Statistical Analysis:	/			
Permit Variance:				

Comment: /
<<<< T.S.M. LIVE DEVELOPMENT SYSTEM (TSMSYS) >>>> UNOPG2U
EIU004 : *** Please VERIFY and RE-TRANSMIT. (F12 to EXIT) ***
Facility Name: REICHHOLD CHEMICALS, INC. Registration Number: 1683 X
Location: PORTLAND
Owner: REICHHOLD CHEMICALS, INC.

Operator Name: REICHHOLD CHEMICALS, INC.
Mail:
Street: 61 BISHOP STREET
City: PORTLAND
Zip: 04103
State: ME
Telephone: (207)797-5009

Tanks 6,000 Gal. or Under @ \$25/Tank
Tanks over 6,000 @ \$50/tank
1 Tanks Not Requiring Fees

1 Total number of tanks

Fee Due: \$ Paid? (Y/N)

RECEIVED

MAY 06 1988

Management Company

<<<< T.S.M. LIVE DEVELOPMENT SYSTEM (TSMSYS) >>>> UNOPG1U
EI/004 : *** Please VERIFY and RE-TRANSMIT. (F12 to EXIT) ***
Date of Registration: 6/26/1986 (MM/DD/YYYY) Registration Number: 1683 X
Date of Last Update: 12/23/1986
Facility Name: REICHHOLD CHEMICALS, INC.
Mail:
Street: 61 BISHOP STREET
City: PORTLAND State: ME Geocode: 5170
Zip: 04103 Telephone: (207)797-5009
Direct: TANK LOCATED AT REAR EAST END OF FORMER ME. TPKE. BUILDING.

Within 1000 ft of Public Water Supply: N (Y/N)
Within 300 ft of Private Water Supply: N (Y/N)
Within 300 ft of Well Owned by Others: N (Y/N)
Facility on Sand or Gravel Aquifer: N (Y/N)

Facility Use: C (See Table #004)

Owner Name: REICHHOLD CHEMICALS, INC.
Mail: 61 BISHOP STREET
City: PORTLAND
State: ME Zip: 04103 Telephone: (207)797-5009

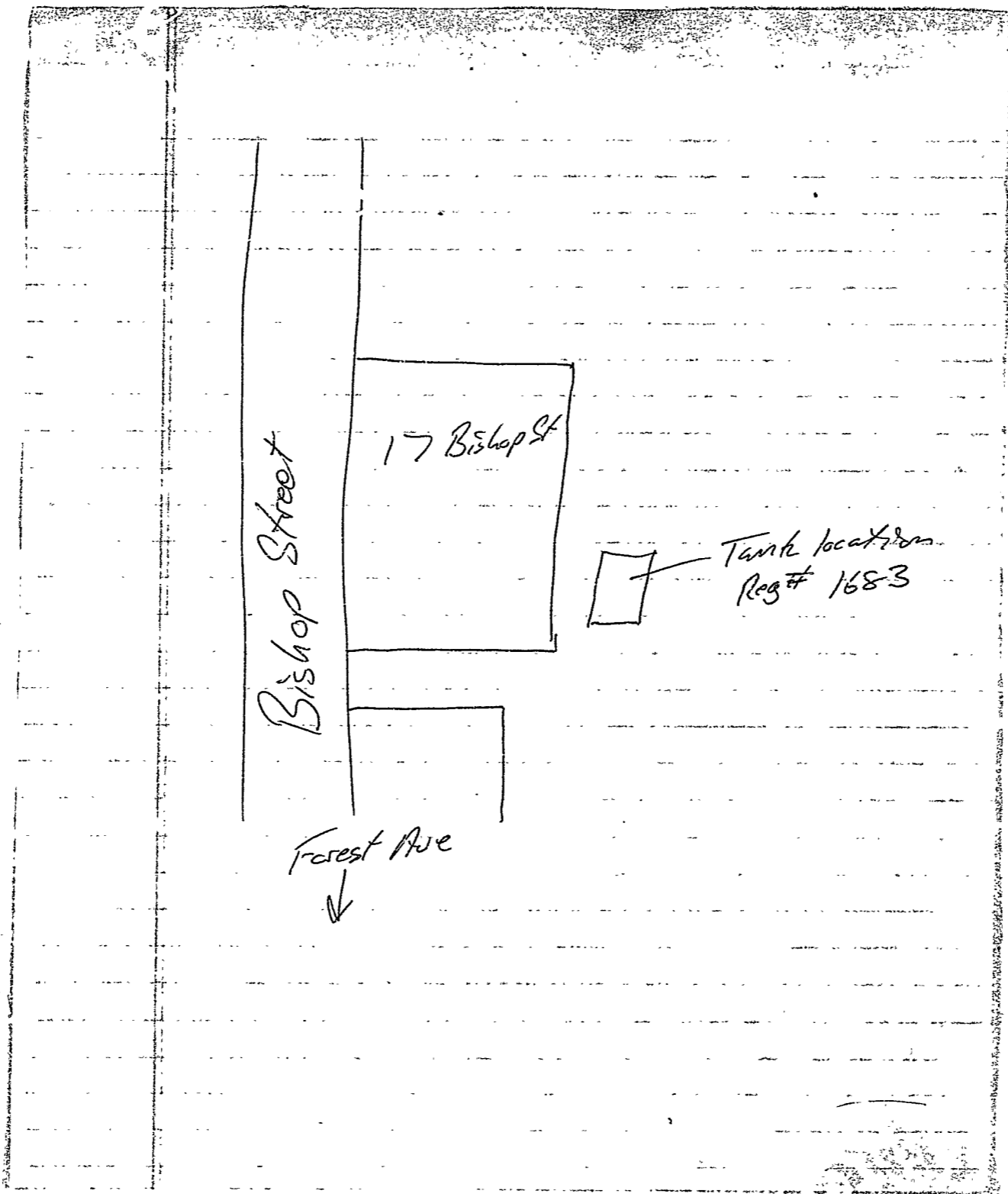

Bishop Street

17 Bishop St

Tank location
Reg # 1683

Forest Ave
↓

PERMIT # 000813 CITY OF Portland BUILDING PERMIT APPLICATION

MAP # _____ LOT# _____

Please fill out any part which applies to job. Proper plans must accompany form.

Owner: Dirigo Management Company
Address: 178 Middle Street

LOCATION OF CONSTRUCTION 17 Bishop Street

CONTRACTOR: Dirigo Management SUBCONTRACTORS: 871-1080
ADDRESS: 178 Middle Street 04101

Est. Construction Cost: 180,000 Type of Use: Commercial

Past Use: _____

Building Dimensions: L _____ W _____ Sq. Ft. _____ # Stories _____ Lot Size _____

Is Proposed Use: _____ Seasonal _____ Condominium _____ Apartment _____

Conversion - Explain: To make interior renovations and 1st floor addition

COMPLETE ONLY IF THE NUMBER OF UNITS WILL CHANGE as per plans

Residential Buildings Only: _____

Of Dwelling Units _____ # Of New Dwelling Units _____

- Foundation:**
1. Type of Soil: _____
 2. Set Backs - Front _____ Rear _____ Side(s) _____
 3. Footings Size: _____
 4. Foundation Size: _____
 5. Other _____

- Floor:**
1. Sills Size: _____ Sills must be anchored.
 2. Girder Size: _____
 3. Lally Column Spacing: _____ Size: _____
 4. Joists Size: _____ Spacing 16" O.C.
 5. Bridging Type: _____ Size: _____
 6. Floor Sheathing Type: _____ Size: _____
 7. Other Material: _____

- Exterior Walls:**
1. Studding Size _____ Spacing _____
 2. No. windows _____
 3. No. Doors _____
 4. Header Sizes _____ Span(s) _____
 5. Bracing: Yes _____ No _____
 6. Corner Posts Size _____
 7. Insulation Type _____ Size _____
 8. Sheathing Type _____ Size _____
 9. Siding Type _____ Weather Exposure _____
 10. Masonry Materials _____
 11. Metal Materials _____

- Interior Walls:**
1. Studding Size _____ Spacing _____
 2. Header Sizes _____ Span(s) _____
 3. Wall Covering Type _____
 4. Fire Wall if required _____
 5. Other Materials _____

For Official Use Only	
Date: <u>July 25, 1988</u>	Subdivision: Yes / No _____
Inside Fire Limits: _____	Name: _____
Bldg Code: _____	Lot: _____
Time Limit: _____	Block: _____
Estimated Cost: <u>180,000</u>	Permit Expiration: _____
Value/Structure: _____	Ownership: _____ Public _____ Private _____
Fee: <u>920.00</u>	

- Ceiling:**
1. Ceiling Joists Size: _____
 2. Ceiling Strapping Size _____ Spacing _____
 3. Type Ceilings: _____
 4. Insulation Type _____
 5. Ceiling Height: _____

- Roof:**
1. Truss or Rafter Size _____ Span _____
 2. Sheathing Type _____ Size _____
 3. Roof Covering Type _____
 4. Other _____

Chimneys: Type: _____ Number of Fire Places _____

Heating: Type of Heat: _____

Electric: Service Entrance Size: _____ Smoke Detector Required Yes _____ No _____

- Plumbing:**
1. Approval of soil test if required 00.25 Yes _____ No _____
 2. No. of Tubs or Showers _____
 3. No. of Flushes _____
 4. No. of Lavatories _____
 5. No. of Other Fixtures 00.208

- Swimming Pools:**
1. Type: _____
 2. Pool Size: _____ x _____ Square Footage _____
 3. Must conform to National Electrical Code and State Law.

Zoning: District R2 Street Frontage Req. _____ Provided _____

Required Setbacks: Front _____ Back _____ Side _____

Review Required:
Zoning Board Approval: Yes _____ No _____ Date: _____
Planning Board Approval: Yes _____ No _____ Date: _____
Conditional Use: _____
Shore and Floodplain Mgr: _____
Other (Explain): _____
Date Approved: OK **PERMIT ISSUED WITH LETTER** 1988

Permit Received By: Lisa Cushman

Signature of Applicant: _____ Date: July 26, 1988

Signature of CEO: J. V. G. Clark Date: 8-3-88

Inspection Dates: _____

PLOT PLAN



FEES (Breakdown From Front)
Base Fee \$ 25.00
Subdivision Fee \$ _____
Site Plan Review Fee \$ _____
Other Fees \$ 895.00
(Explain) _____
Late Fee \$ _____

Type	Inspection Record	Date
_____	_____	____/____/____
_____	_____	____/____/____
_____	_____	____/____/____
_____	_____	____/____/____
_____	_____	____/____/____

COMMENTS

Signature of Applicant *Ray B Moore* *Agent of Owner* Date July 25, 1988



CITY OF PORTLAND, MAINE

389 CONGRESS STREET
PORTLAND, MAINE 04101
(207) 775-5451

DEPARTMENT OF PLANNING & URBAN DEVELOPMENT

P. SAMUEL HOFFSES, CHIEF
INSPECTION SERVICES DIVISION

August 4, 1988

RE: 17 Bishop Street

Dirigo Management Company
178 Middle Street
Portland, Maine 04101

Dear Sir:

Your application to make interior renovations at 17 Bishop Street has been reviewed and a permit is herewith issued subject to the following requirement:

All vertical openings shall be enclosed with construction having a fire rating of at least one (1) hour including fire doors with self-closers.

If you have any questions regarding this requirement, please do not hesitate to contact this office.

Sincerely,

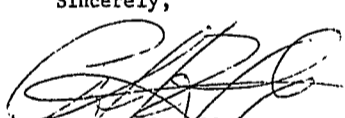
P. Samuel Hoffses
Chief of Inspection Services

/el

cc: LT. James P. Collins, Fire Prevention

PERMIT # 949 CITY OF Oakland BUILDING PERMIT APPLICATION

MAP # _____ LOT# _____

Please fill out any part which applies to job. Proper plans must accompany form.

Owner: Dirigo Management Company
Address: 178 Middle Street

LOCATION OF CONSTRUCTION 17 Bishop Street

CONTRACTOR: Dirigo Management SUBCONTRACTORS: 871-1680
ADDRESS: 17 Middle Street 04101

Est. Construction Cost: 120,000 Type of Use: Commercial

Past Use: _____

Building Dimensions: L _____ W _____ Sq. Ft. _____ # Stories _____ Lot Size _____

Is Proposed Use: _____ Seasonal _____ Condominium _____ Apartment _____

Conversion - Explain to make interior renovations and 1st floor

COMPLETE ONLY IF THE NUMBER OF UNITS WILL CHANGE as per plans

Residential Buildings Only

Of Dwelling Units _____ # Of New Dwelling Units _____

Foundation:
1. Type of Soil: _____
2. Set Backs - Front _____ Rear _____ Side(s) _____
3. Footings Size: _____
4. Foundation Size: _____
5. Other: _____

Floor:
1. Sills Size: _____ Sills must be anchored.
2. Girder Size: _____
3. Lally Column Spacing: _____ Size: _____
4. Joists Size: _____ Spacing 16" O.C.
5. Bridging Type: _____ Size: _____
6. Floor Sheathing Type: _____ Size: _____
7. Other Material: _____

Exterior Walls:
1. Studding Size _____ Spacing _____
2. No. windows _____
3. No. Doors _____
4. Header Sizes _____ Span(s) _____
5. Bracing: Yes _____ No _____
6. Corner Posts Size _____
7. Insulation Type _____ Size _____
8. Sheathing Type _____ Size _____
9. Siding Type _____ Weather Exposure _____
10. Masonry Materials _____
11. Metal Materials _____

Interior Walls:
1. Studding Size _____ Spacing _____
2. Header Sizes _____ Span(s) _____
3. Wall Covering Type _____
4. Fire Wall if required _____
5. Other Materials _____

For Official Use Only	
Date: <u>July 26, 1988</u>	Subdivision: Yes / No _____
Inside Fire Limits: _____	Name: _____
Bldg Code: _____	Loc: _____
Time Limit: _____	Block: _____
Estimated Cost: <u>120,000</u>	Permit Expiration: _____
Value Structure: _____	Ownership: _____
Fee: <u>220.00</u>	Public / Private _____

Ceiling:
1. Ceiling Joists Size: _____
2. Ceiling Strapping Size: _____
3. Type Ceilings: _____
4. Insulation Type: _____
5. Ceiling Height: _____

Roof:
1. Truss or Rafter Size: _____ Span _____
2. Sheathing Type: _____ Size _____
3. Roof Covering Type: _____
4. Other: _____

Chimneys: _____
Type: _____ Number of Fire Places _____

Heating: _____
Type of Heat: _____

Electrical: _____
Service Entrance Size: _____ Smoke Detector Required: Yes _____ No _____

Plumbing:
1. Approval of soil test if required: _____ Yes _____ No _____
2. No. of Tubs or Showers: _____
3. No. of Flushes: _____
4. No. of Lavatories: _____
5. No. of Other Fixtures: _____

Swimming Pools:
1. Type: _____
2. Pool Size: _____ Square Footage _____
3. Must conform to National Electrical Code and State Law.

Zoning: District R2 Street Frontage Req. _____ Provided _____
Required Setbacks: Front _____ Back _____ Side _____ Side _____

Review Required:
Zoning Board Approval: Yes _____ No _____ Date: _____
Planning Board Approval: Yes _____ No _____ Date: _____
Conditional Use: _____ Variance: _____ One-Plan _____
Shore and Floodplain Mgmt. _____
Other: (Explain) _____
Date Approved: 8-3-88

PERMIT ISSUED
WITH LETTER

Permit Received By: Lisa Curdson

Signature of Applicant: _____ Date: _____

Signature of CEO: [Signature] Date: 8-3-88

Inspector's Date: _____

PERMIT # 939 CITY OF Portland BUILDING PERMIT APPLICATION MAP # _____ LOT# _____

Please fill out any part which applies to job. Proper plans must accompany form.

Owner: Dirigo Management Co.

Address: 178 Middle Street

LOCATION OF CONSTRUCTION 17 Bishop Street

CONTRACTOR: owner SUBCONTRACTORS: 071-1080

ADDRESS: _____

Est. Construction Cost: _____ Type of Use: commercial

Past Use: _____

Building Dimensions L _____ W _____ Sq. Ft. _____ # Stories _____ Lot Size: _____

Is Proposed Use: _____ Seasonal _____ Condominium _____ Apartment _____

Conversion Explain remove 1 3,000 gallon tank

COMPLETE ONLY IF THE NUMBER OF UNITS WILL CHANGE

Residential Buildings Only:

Of Dwelling Units _____ # Of New Dwelling Units _____

Foundation:

1. Type of Soil: _____
2. Set Backs - Front _____ Rear _____ Side(s) _____
3. Footings Size: _____
4. Foundation Size: _____
5. Other _____

Floor:

1. Sills Size: _____ Sills must be anchored.
2. Girder Size: _____
3. Lally Column Spacing: _____ Size: _____
4. Joists Size: _____ Spacing 16" O.C.
5. Bridging Type: _____ Size: _____
6. Floor Sheathing Type: _____ Size: _____
7. Other Material: _____

Exterior Walls:

1. Studding Size _____ Spacing _____
2. No. windows _____
3. No. Doors _____
4. Header Sizes _____ Span(s) _____
5. Bracing: Yes _____ No _____
6. Corner Posts Size _____
7. Insulation Type _____ Size _____
8. Sheathing Type _____ Size _____
9. Siding Type _____ Weather Exposure _____
10. Masonry Materials _____
11. Metal Materials _____

Interior Walls:

1. Studding Size _____ Spacing _____
2. Header Sizes _____ Span(s) _____
3. Wall Covering Type _____
4. Fire Wall If required _____
5. Other Materials _____

For Official Use Only	
Date: <u>July 29, 1988</u>	Subdivision: Yes / No _____
Inside Fire Limits: _____	Name: _____
Blk. Code: _____	Lot: _____
Time Limit: _____	Block: _____
Estimated Cost: _____	Permit Expiration: _____
Val. Structure: _____	Ownership: _____ Public _____ Private _____
Fee: <u>100.00</u>	

Ceiling:

1. Ceiling Joists Size: _____
2. Ceiling Strapping Size _____ Spacing _____
3. Type Ceiling: _____
4. Insulation Type _____
5. Ceiling Height: _____

Roof:

1. Truss or Rafter Size _____ Span _____
2. Sheathing Type _____ Size _____
3. Roof Covering Type _____
4. Other _____

Chimneys:

Type: _____ Number of Fire Places _____

Heating: Type of Heat: _____

Electrical: Service Entrance Size: _____ Smoke Detector Required Yes _____ No _____

Plumbing:

1. Approval of soil test if required Yes _____ No _____
2. No. of Tubs or Showers _____
3. No. of Flushes _____
4. No. of Lavatories _____
5. No. of Other Fixtures _____

Swimming Pools:

1. Type: _____
2. Pool Size: _____ x _____ Square Footage _____
3. Must conform to National Electrical Code and State Law.

Zoning: District ED Street Frontage Req. _____ Provided _____

Required Setbacks: Front _____ Back _____ Side _____

Review Required: Zoning Board Approval: Yes _____ No _____ Date: _____

Planning Board Approval: Yes _____ No _____ Date: _____

Conditional Use: _____ Variance _____ Site Plan _____ Subdivision _____

Shore and Floodplain Mgmt. _____ Special Exception _____

Other: (Explain) _____

Date Approved: July 28, 1988

Permit Received By Joanne Quint

Signature of Applicant: _____ Date: July 28, 1988

Signature of CEO: J.P. Collins, Sr. Date: 8-3-88

Inspection Dates: _____

121 MA CONNELL

Permit # **940536** City of **Portland** **BUILDING PERMIT APPLICATION** Fee **2,515.00** Zone **\$300 - minor site plan** Map # **_____** Lot# **_____**
 Please fill out any part which applies to job. Proper plans must accompany form.

Owner: **Spurwink School** Phone # **_____**
 Address: **899 Riverside St- Ptd, ME 04103**
 LOCATION OF CONSTRUCTION **17 Bishop St.**
 Contractor: **C.M. Cimino, Inc.** Sub: **_____** Phone # **854-8876 - Mike C.**
 Address: **Westbrook, ME**
 Est. Construction Cost: **499,000.** Proposed Use: **evaluation clinic**
 Past Use: **dance studio**
 # of Existing Res. Units **_____** # of New Res. Units **_____**
 Building Dimensions L **_____** W **_____** Total Sq. Ft. **_____**
 # Stories: **_____** # Bedrooms **_____** Lot Size: **_____**
 Is Proposed Use: Seasonal **_____** Condominium **_____** Conversion **_____**
 Explain Conversion **construc. addition - appx 334 sq ft**

6 Jun '94 **For Official Use Only**
 Date **3/23/94** Subdivision: **_____**
 Inside Fire Limits **_____** Name **_____**
 Bldg Code **_____** Lot **JUN - 9 1994**
 Time Limit **_____** Ownership: **Public**
 Estimated Cos. **_____** **Private**
CITY OF PORTLAND

Zoning: **E-2**
 Street Frontage Provided: **_____**
 Provided Setbacks: Front **_____** Back **_____** Side **_____**
 Review Required: **_____**
 Zoning Board Approval: Yes **_____** No **_____** Date: **_____**
 Planning Board Approval: Yes **_____** No **_____** Date: **_____**
 Conditional Use: **_____** Variance **_____** Site Plan **_____** Subdivision **_____**
 Shoreland Zoning Yes **_____** No **_____** Floodplain Yes **_____** No **_____**
 Special Exception **_____**
 Other (Explain) **_____**

XXXXXXXX 293-D-015/016
 Foundation: **minor site plan** 8-Singe Axle Dump Ceiling: **0747C - 0748B**

1. Type of Soil: **_____**
 2. Set Back - Front **_____** Rear **_____** Side(s) **_____**
 3. Footings Size: **_____**
 4. Foundation Size: **_____**
 5. Other **_____**
- Floor:
 1. Sills Size: **_____** Sills must be anchored.
 2. Girder Size: **_____**
 3. Lally Column Spacing: **_____** Size: **_____**
 4. Joists Size: **_____** Spacing **16" O.C.**
 5. Bridging Type: **_____** Size: **_____**
 6. Floor Sheathing Type: **_____** Size: **_____**
 7. Other Material: **_____**

- HISTORIC PRESERVATION**
 1. Ceiling Joists Size: **_____** Action: **Approved**
 2. Ceiling Strapping Size **_____** Spacing **_____** Not in District nor Landmark
 3. Type Ceilings: **_____** Does not require review.
 4. Insulation Type **_____** Size: **_____** Requires Review.
 5. Ceiling Height: **_____** *****
 Roof:
 1. Truss or Rafter Size **_____** Span: **_____** Action: **Approved**
 2. Sheathing Type **_____** Size: **_____** Approved with conditions.
 3. Roof Covering Type **_____** Size: **_____**
 Chimneys:
 Type: **_____** Number of Fire Places **_____** Size: **_____**
 Heating:
 Type of Heat: **_____**
 Electrical:
 Service Entrance Size: **_____** Smoke Detector Required Yes **_____** No **_____**
 Plumbing:
 1. Approval of soil test if required Yes **_____** No **_____**
 2. No. of Tubs or Showers **_____**
 3. No. of Flushes **_____**
 4. No. of Lavatories **USE Group B Type S**
 5. No. of Other Fixtures **_____**
 Swimming Pools:
 1. Type: **_____**
 2. Pool Size: **_____**
 3. Must conform to National Electrical Code and State Law. **_____** Square Footage **_____**

- Exterior Walls:
 1. Studding Size **_____** Spacing **_____**
 2. No. windows **_____**
 3. No. Doors **_____**
 4. Header Sizes **_____**
 5. Bracing: Yes **_____** No **_____** Span(s) **_____**
 6. Corner Posts Size **_____**
 7. Insulation Type **_____** Size **_____**
 8. Sheathing Type **_____** Size **_____**
 9. Siding Type **_____**
 10. Masonry Materials **_____** Weather Exposure **_____**
 11. Metal Materials **_____**
- Interior Walls:
 1. Studding Size **_____** Spacing **_____**
 2. Header Sizes **_____** Span(s) **_____**
 3. Wall Covering Type **_____**
 4. Fire Wall if required **_____**
 5. Other Materials **_____**

PERMIT ISSUED WITH LETTER

Permit Received By **Michael B. Frion**
 Signature of Applicant **Michael B. Frion**
 Date **3/23/94**
 CEO's District **_____**
 Michael Cimino
 CONTINUED TO REVERSE SIDE
 Ivory Tag - CEO

White - Tax Assessor

6 June 1994



APPLICATION FOR PERMIT
DEPARTMENT OF BUILDING INSPECTIONS SERVICES
ELECTRICAL INSTALLATIONS

Date 29 July 1994, 19
 Receipt and Permit number 4821

To the CHIEF ELECTRICAL INSPECTOR, Portland, Maine:

The undersigned hereby applies for a permit to make electrical installations in accordance with the laws of Maine, the Portland Electrical Ordinance, the National Electrical Code and the following specifications:

LOCATION OF WORK: 17 Bishop St
 OWNER'S NAME: Spurwink School ADDRESS: _____

	FEES
OUTLETS:	
Receptacles _____ Switches _____ Plugmold _____ ft. TOTAL <u>75</u>	15.00
FIXTURES: (number of)	
Incandescent _____ Fluorescent _____ (not strip) TOTAL <u>45</u>	9.00
Strip Fluorescent _____ ft.	
SERVICES:	
Overhead _____ Underground <u>x</u> Temporary _____ TOTAL amperes <u>600</u> ..	15.00
METERS: (number of) <u>1</u>	1.00
MOTORS: (number of)	
Fractional _____	
1 HP or over _____	
RESIDENTIAL HEATING:	
Oil or Gas (number of units) _____	
Electric (number of rooms) _____	
COMMERCIAL OR INDUSTRIAL HEATING:	
Oil or Gas (by a main boiler) _____	
Oil or Gas (by separate units) _____	
Electric Under 20 kws _____ Over 20 kws _____	
APPLIANCES: (number of)	
Ranges _____ <u>x</u> Water Heaters _____ <u>x</u>	
Cook Tops _____ Disposals _____	
Wall Ovens _____ Dishwashers _____	
Dryers _____ Compactors _____	
Fans _____ Others (denote) _____	
TOTAL	4.00
MISCELLANEOUS: (number of)	
Branch Panels _____	
Transformers _____	
Air Conditioners Central Unit _____	
Separate Units (windows) _____	
Signs 20 sq. ft. and under _____	
Over 20 sq. ft. _____	
Swimming Pools Above Ground _____	
In Ground _____	
Fire/Burglar Alarms Residential _____	
Commercial <u>15.00</u>	15.00
Heavy Duty Outlets, 220 Volt (such as welders) 30 amps and under _____	
over 30 amps _____	
Circus, Fairs, etc. _____	
Alterations to wires _____	
Repairs after fire _____	
Emergency Lights, battery _____	
Emergency Generators _____	
INSTALLATION FEE DUE: _____	
FOR ADDITIONAL WORK NOT ON ORIGINAL PERMIT DOUBLE FEE DUE: _____	
FOR REMOVAL OF A "STOP ORDER" (304-16.b)	
TOTAL AMOUNT DUE: _____	59.00

INSPECTION:

Will be ready on 7/29, 1994; or Will Call _____

CONTRACTOR'S NAME: Peter Doria
 ADDRESS: 135 Bolton St 04102
 TEL: 775-0888
 MASTER LICENSE NO.: 4821 SIGNATURE OF CONTRACTOR: _____
 LIMITED LICENSE NO.: _____

INSPECTOR'S COPY — WHITE
 OFFICE COPY — CANARY
 CONTRACTOR'S COPY — GREEN

