

50-60 HUNT STREET

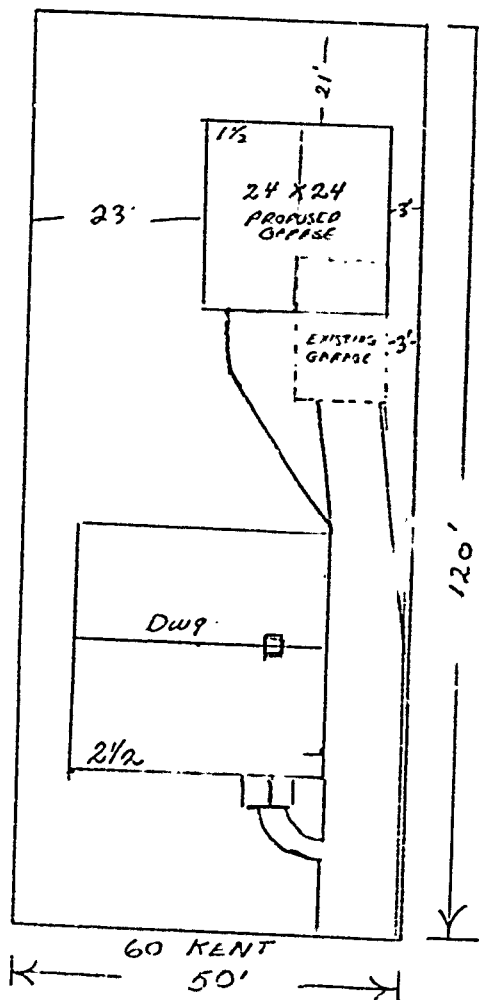

Full cut #920R - Half cut #9202R - Third cut #9203R - Fifth cut #9205R

4602 MATERIALS
1250 LABOR
250 DEMOLITION
\$6100.



JOHN MARINO
60 KENT ST
PORTLAND, ME.
04102

773-0677

CONTRACTOR
RICHARD C.
RAUTENBERG
33 SCOTT DYER RD.
CAPE ELIZABETH,
ME.
04107

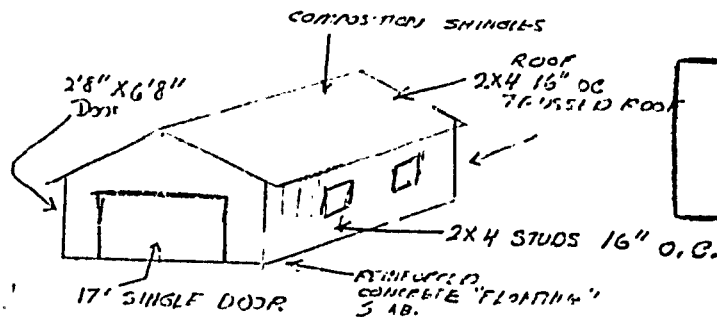

RECEIVED

APR 27 1981

DEPT. OF BLDG. INSP.
CITY OF PORTLAND

CITY OF PORTLAND, MAINE
BUILDING & INSPECTION SERVICES

Date April 27, 1981

To: ~~Richard C Rautenberg~~ Richard C Rautenberg
(contractor)

38 Scott Dyer Rd. Cape Elizabeth

With relation to permit applied for to demolish a 1 car garage, 13 x 19'

at (address) 60 Kent Street belonging to

(owner) John Marino. It is unlawful to
commence demolition work until a permit has been issued from this
department.

Section of the Ordinance for rodent and vermin control provides,
"It shall be unlawful to demolish a building or structure unless
provision is made for rodent and vermin eradication. No permit
for the demolition of a building or structure shall be issued by
the Building and Inspection Services Department until and unless
provisions for rodent and vermin eradication have been carried out
under supervision of a pest control operator registered with the
Health Department."

The building permit for demolition cannot be issued until the
provisions of this section have been satisfied. It is the obli-
gation of owner or demolition contractor or both to take up with
the Health Department the matter of complying with this section,
being prepared to inform that department what registered pest
control operator is to be employed.

NOTICE - PER MUNICIPAL CODE
A PERMIT TO DEMOLISH OR REMOVE A
STRUCTURE SHALL EXPIRE THIRTY
(30) DAYS AFTER THE DATE OF
ISSUANCE.

Very truly yours,

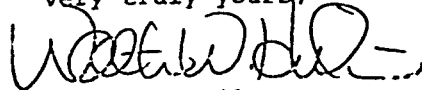
Walter W. Hilton
chief Building Inspector

Health Department comments: No vermin noted.

Copies to:

- 2 - Health - Environ. (Mr. Vandoloski)
- 1 - Health - (Mr. Noyes)
- 1 - Public Works (Phil Mullin)
- 1 - Fire Dept.



APPLICATION FOR PERMIT

PERMIT ISSUED

B.O.C.A. USE GROUP

B.O.C.A. TYPE OF CONSTRUCTION

361

MAY 4 1981

ZONING LOCATION

PORTLAND, MAINE, April 27, 1981

CITY OF PORTLAND

To the DIRECTOR OF BUILDING & INSPECTION SERVICES, PORTLAND, MAINE

The undersigned hereby applies for a permit to erect, alter, repair, demolish, move or install the following building, structure, equipment or change use in accordance with the Laws of the State of Maine, the Portland B.O.C.A. Building Code and Zoning Ordinance of the City of Portland with plans and specifications, if any, submitted herewith and the following specification:

LOCATION 60 Kent Street 041022 Fire District #1 ☐ #2 ☐
1. Owner's name and address John Marino - same Telephone 773-0677
2. Lessee's name and address Telephone
3. Contractor's name and address Richard C. Rautenberg - 38 Scott Dyer Telephone
4. Architect Specifications Plans No. of sheets
Proposed use of building garage - 2 car No. families
L. No. families
No. stories Heat Style of roof Roofing
Other buildings on same lot
Estimated contractual cost \$ 6,000 Fee \$ 28.50

FIELD INSPECTOR—Mr.

GENERAL DESCRIPTION demo

5.00

33.50

This application is for:

@ 775-21

Dwelling

Ext. 23

Garage

To demolish 1 car garage 13' x 19'
and construct 24' x 24' 2 car garage
as per plans. 1 sheet of plans.

Stamp of Special Conditions

Masonry Bldg.

Metal Bldg.

Additions

Demolitions

Change of Use

Other

Sent to Health Dept. 4-27-81

Rec'd from Health Dept. 5-4-81

NOTE TO APPLICANT: Separate permits are required by the installers and subcontractors of heating, plumbing, electrical and mechanicals.

PERMIT IS TO BE ISSUED TO 1 ☒ 2 ☐ 3 ☐ 4 ☐

Other:

DETAILS OF NEW WORK

Is any plumbing involved in this work? Is any electrical work involved in this work?
Is connection to be made to public sewer? If not, what is proposed for sewage?
Has septic tank notice been sent? Form notice sent?
Height average grade to top of plate Height average grade to highest point of roof
Size, front depth No. stories solid or filled land? earth or rock?
Material of foundation Thickness, top bottom cellar
Kind of roof Rise per foot Roof covering
No. of chimneys Material of chimneys of lining Kind of heat fuel
Framing Lumber—Kind Dressed or full size? Corner posts Sills
Size Girder Columns under girders Size Max. on centers
Studs (outside walls and carrying partitions) 2x4-16" O. C. Bridging in every floor and flat roof span over 8 feet.
Joists and rafters: 1st floor 2nd 3rd roof
On centers: 1st floor 2nd 3rd roof
Maximum span: 1st floor 2nd 3rd roof
If one story building with masonry walls, thickness of walls? height?

IF A GARAGE

No. cars now accommodated on same lot to be accommodated ... number commercial cars to be accommodated ...
Will automobile repairing be done other than minor repairs to cars habitually stored in the proposed building?

APPROVALS BY:

DATE

MISCELLANEOUS

BUILDING INSPECTION—PLAN EXAMINER

Will work require disturbing of any tree on a public street? ..

ZONING:

BUILDING CODE:

Fire Dept.:

Health Dept.:

Others:

Signature of Applicant

John Marino

Phone # same

Type Name of above

John Marino

1 ☒ 2 ☐ 3 ☐ 4 ☐

Other

and Address

FIELD INSPECTOR'S COPY

3A

NOTES

5-4-81 - removed old driveway - rubble
all from north - now flat & clear
garage - picture, not in hole, but

5/11/81 - concrete pad poured - GB

6/25/81 - garage up - OK GB

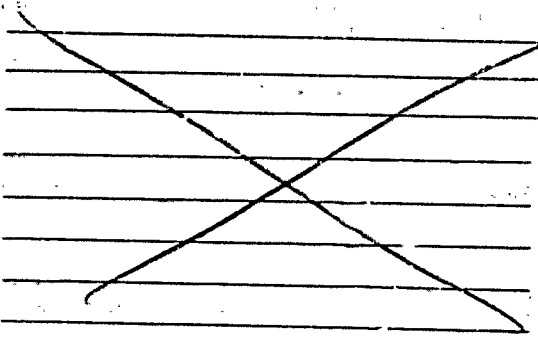

Permit No. 81/361 AB 881 E. 11th
Location 600 2nd Street
Owner Joe M. M. M.
Date of permit 1-27-81
Approved 5-4-81 / 1st/2nd/3rd/4th/5th/6th/7th/8th/9th/10th/11th/12th



(RC) GENERAL RESIDENCE ZONE - C
APPLICATION FOR PERMIT

Class of Building or Type of Structure Third Class

Permit No. 548

Portland, Maine, June 5, 1945 JUN 5 1945

To the INSPECTOR OF BUILDINGS, PORTLAND, ME.

The undersigned hereby applies for a permit to alter install the following building structure equipment in accordance with the laws of the State of Maine, the Building Code of the City of Portland, M.E., and specifications, if any, submitted herewith and the following specifications:

Location 60 Kent Street Within Fire Limits? no Dist. No. _____
Owner's or Lessee's name and address Ralph C. Lombard, 60 Kent Street Telephone 3-6952
Contractor's name and address W. J. Carpenter, Allen Avenue Telephone _____
Architect _____ Plans filed no No. of sheets _____
Proposed use of building Dwelling No. families 1
Other buildings on same lot garage
Estimated cost \$ 20. Fee \$.25

Description of Present Building to be Altered

Material frame No. stories 1 1/2 Heat _____ Style of roof _____ Roofing _____
Last use Dwelling No. families 1

General Description of New Work

To cut in two small openings (louvres) one at each end of gable roof.

NOTIFICATION BE RELATING
OR CLOSING-IN IS WAIVED
CERTIFICATE OF OCCUPANCY
REQUIREMENT IS WAIVED

It is understood that this permit does not include installation of heating apparatus which is to be taken out separately by and in the name of the heating contractor.

Details of New Work

Is any plumbing work involved in this work? _____
Is any electrical work involved in this work? _____ Height average grade to top of plate _____
Size, front _____ depth _____ No. stories _____ Height average grade to highest point of roof _____
To be erected on solid or filled land? _____ earth or rock? _____
Material of foundation _____ Thickness, top _____ bottom _____ cellar _____
Material of underpinning _____ Height _____ Thickness _____
Kind of roof _____ Rise per foot _____ Roof covering _____
No. of chimneys _____ Material of chimneys _____ of lining _____
Kind of heat _____ Type of fuel _____ Is gas fitting involved? _____
Framing lumber—Kind _____ Dressed or full size? _____
Corner posts _____ Sills _____ Girt or ledger board? _____ Size _____
Material columns under girders _____ Size _____ Max. on centers _____
Studs (outside walls and carrying partitions) 2x4-16" O. C. Girders 6x8 or larger. Bridging in every floor and flat roof span over 8 feet. Sills and corner posts all one piece in cross section.
Joists and rafters: 1st floor _____, 2nd _____, 3rd _____, roof _____
On centers: 1st floor _____, 2nd _____, 3rd _____, roof _____
Maximum span: 1st floor _____, 2nd _____, 3rd _____, roof _____

If one story building with masonry walls, thickness of walls? _____ height? _____

If a Garage

No. cars now accommodated on same lot _____, to be accommodated _____
Total number commercial cars to be accommodated _____
Will automobile repairing be done other than minor repairs to cars habitually stored in the proposed building? _____

Miscellaneous

Will above work require removal or disturbing of any shade tree on a public street? no
Will there be in charge of the above work a person competent to see that the State and City requirements pertaining thereto are observed? yes
Inspector _____

Original

Signature of owner

By

Mrs. Ralph Lombard

Ralph Lombard

Permit No. 45/548 ^{NA-45-2} _(S. 11.1.1.1)

Location 60 Kent Street

Owner Ralph C. Lombard

Date of permit 6/6/45

Notif. closing-in

Inspn. closing-in

Final Notif.

Final Inspn. 7/13/46

Cert. of Occupancy issued NONE

NOTES

6/9/45 Howdork test
7/3/45 711 Change
7/15/46 WORKING
FINISHED Ed

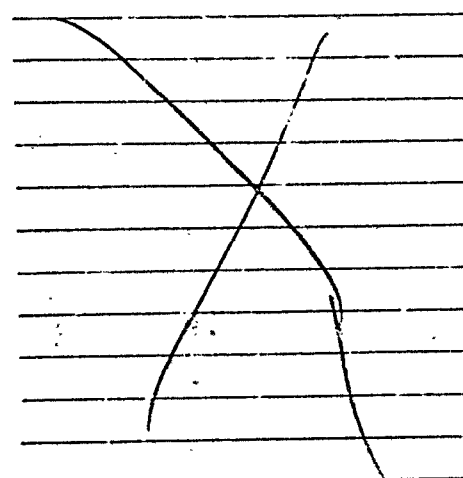



FILL IN COMPLETELY AND SIGN WITH INK

APPLICATION FOR PERMIT FOR HEATING, COOKING OR POWER EQUIPMENT

PERMIT ISSUED
6718

MAY 28 1936

Portland, Maine, May 27, 1936

To the INSPECTOR OF BUILDINGS, PORTLAND, ME.

The undersigned hereby applies for a permit to install the following heating, cooking or power equipment in accordance with the Laws of Maine, the Building Code of the City of Portland, and the following specifications:

Location 60 Kent St Use of Building Washing
Name and address of owner Robert C. Lombard 60 Kent St Ward 9
Contractor's name and address Paul Farmer 70 Free St Telephone 38187

General Description of Work

To install Oil Burner - Steam Heat

IF HEATER, POWER BOILER OR COOKING DEVICE

Is heater or source of heat to be in cellar? Yes If not, which story _____ Kind of Fuel oil
Material of supports of heater or equipment (concrete floor or what kind) Concrete
Minimum distance to wood or combustible material, from top of boiler or casing top of furnace, _____
from top of smoke pipe _____, from front of heater _____ from sides or back of heater _____
Size of chimney, flue _____ Other connections to same flue _____

IF OIL BURNER

Name and type of burner Petro 8-20 Labeled and approved by Underwriters' Laboratories? Yes
Will operator be always in attendance? No Type of oil feed (gravity or pressure) Gravity
Location oil storage Basement No. and capacity of tanks 1-225 gal
Will all tanks be more than seven feet from any flame? Yes How many tanks fireproofed? 4 blue

Amount of fee enclosed? _____ (\$1.00 for one heater, etc., 50 cents additional for each additional heater, etc., in same building at same time.)

INSPECTION COPY

Signature of contractor Paul Farmer

E. T. Allen

60356

Ward 9 Per. No. 36718
Location 60 Kent St.
Owner Ralph C. Lombard
Date of permit 5/28/36.
Post Card sent 5/28/36.

Notif. for insp. 6/4/36
Approval Tag issued 6/4/36
Oil Burner Check List (date) 6/4/36

1. Kind of heat oil
2. Label ✓
3. Anti-siphon ✓
4. Oil storage ✓
5. Tank distance ✓
6. Vent pipe ✓
7. Fill pipe ✓
8. Gauge ✓
9. Rigidity ✓
10. Feed safety ✓
11. Pipe sizes and material ✓
12. Control valve ✓
13. Ash pit vent ✓
14. Temp. or pressure safety ✓
15. Instruction card ✓
16. Dr. Draft O-Stat

NOTES

Chimney has
clean but doors

STATEMENT ACCOMPANYING APPLICATION FOR BUILDING PERMIT

for 1 car frame garage
at 60 Kent Street

Date Oct. 2, 1934

Ralph C. & Bertha M Lombard

1. In whose name is the title of the property now recorded? Ralph C. & Bertha M Lombard
2. Are the boundaries of the property in the vicinity of the proposed work shown clearly on the ground, and how? Stakes in corner s of lot
3. Is the outline of the proposed work now staked out upon the ground? If not, will you notify the Inspection Office when the work is staked out and before any of the work is commenced? Will be ready A. M. of 10/3/34
4. What is to be maximum projection or overhang of eaves or drip? 12" 6"
5. Do you assume full responsibility for the correctness of the location plan or statement of location filed with this application, and does it show the complete outline of the proposed work on the ground, including bay windows, porches and other projections? Yes
6. Do you assume full responsibility for the correctness of all statements in the application concerning the sizes, design and use of the proposed building? Yes
7. Do you understand that in case changes are proposed in the location of the work or in any of the details specified in the application that a revised plan and application must be submitted to this office before the changes are made? Yes

Bertha M. Lombard.

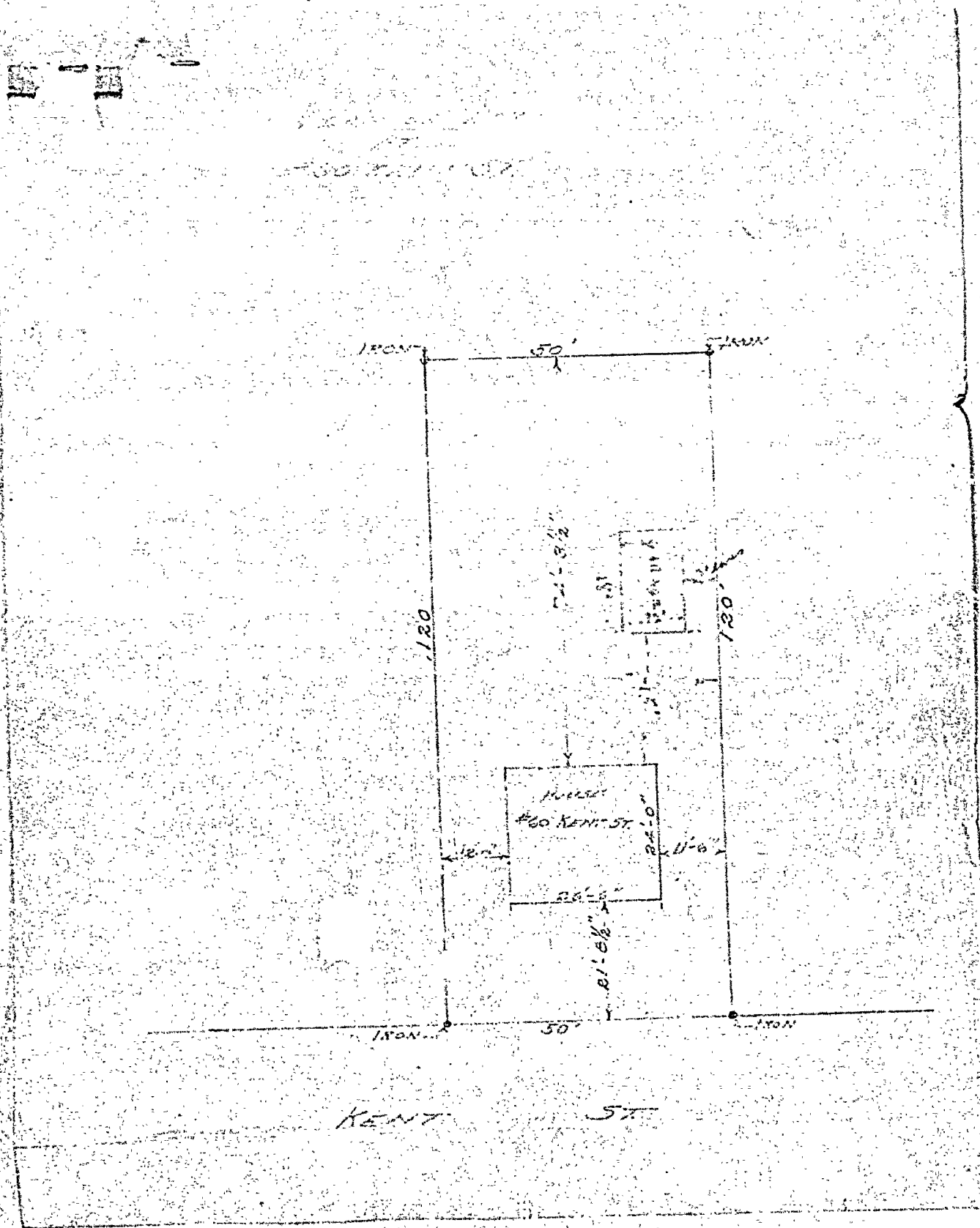



R) GENERAL RESIDENCE ZONE
APPLICATION FOR PERMIT

PERMIT ISSUED

OCT 9 1934

Class of Building or Type of Structure Third Class

Portland, Maine, Sept. 28 1934

To the INSPECTOR OF BUILDINGS, PORTLAND, ME.

Application Completed October 2, 1934.

The undersigned hereby applies for a permit to erect ~~alter~~ install the following building ~~structure~~ equipment in accordance with the Laws of the State of Maine, the Building Code of the City of Portland, plans and specifications, if any, submitted herewith and the following specifications:

Location 60 Kent St. Ward 9 Within Fire Limits? Yes Dist. No. _____
Owner's or ~~Plat~~'s name and address Ralph & Bertha Lombard, 60 Kent Street Telephone _____
Contractor's name and address Owner Telephone _____
Architect's name and address _____
Proposed use of building 1 Car Garage No. families _____
Other buildings on same lot Dwelling House
Plans filed as part of this application? Yes No. of sheets 1
Estimated cost \$ 175 Fee \$.75

Description of Present Building to be Altered

Material _____ No. stories _____ Heat _____ Style of roof _____ Roofing _____
Last use _____ No. families _____

General Description of New Work

To build 1 car ~~store~~ garage 12' x 16'

NOTIFICATION BEFORE LATHEW
OR CLOSING-IN IS WAIVED

CERTIFICATE OF OCCUPANCY
IS WAIVED

It is understood that this permit does not include installation of heating apparatus which is to be taken out separately by and in the name of the heating contractor.

Details of New Work

Height average grade to top of plate 7 1/2'
Size, front 12' depth 16' No. stories 1 Height average grade to highest point of roof 11'
To be erected on solid or filled land? Earth Solid earth or rock? Earth
Material of foundation Concr Posts Thickness, top _____ bottom _____
Material of underpinning _____ Height _____ Thickness _____
Kind of Roof Pitch Rise per foot 4" Roof covering Asphalt Roofing Glass "C"
No. of chimneys None Material of chimneys _____ of lining _____
Kind of heat None Type of fuel _____ Is gas fitting involved? _____
Corner posts 4 x 4 Sills 4 x 6 Girt or ledger board? _____ Size _____
Material columns under girders _____ Size _____ Max. on centers _____
Studs (outside walls and carrying partitions) 2x4-16" O. C. Girders 6x8 or larger. Bridging in every floor and flat roof span over 8 feet. Sills and corner posts all one piece in cross section.
Joists and rafters: 1st floor 2 x 6, 2nd _____, 3rd _____, roof 2 x 4
On centers: 1st floor 16", 2nd _____, 3rd _____, roof 24"
Maximum span: 1st floor 12', 2nd _____, 3rd _____, roof _____
If one story building with masonry walls, thickness of walls? _____ height? _____

If a Garage

No. cars now accommodated on same lot None, to be accommodated One
Total number commercial cars to be accommodated None
Will automobile repairing be done other than minor repairs to cars habitually stored in the proposed building? No

Miscellaneous

Will above work require removal or disturbing of any shade tree on a public street? No
Will there be in charge of the above work a person competent to see that the State and City requirements pertaining thereto are observed? Yes

Signature of owner Ralph & Bertha Lombard

INSPECTION COPY

Oliver T. Sanborn
CHIEF OF FIRE DEPT.

By Mr. Bertha M. Lombard

1470B

Ward 9 Permit No. 34/1504

Location 60 Kent St

Own Ralph L. L. L.

Date of permit 10/3/34

Notif. closing-in

Inspn. closing-in

Final Notif.

Final Inspn. 10/22/34

Cert. of Occupancy issued None

NOTES

10/3/34 - Striking
out O.K. (11.4)
10/9/34 Walls framed.
A.C.
10/22/34 - Work com-
pleted A.C.

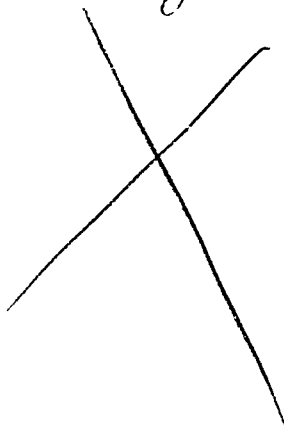



FILL IN COMPLETELY AND SIGN WITH INK

Permit No. 2580

APPLICATION FOR PERMIT FOR HEATING, COOKING OR POWER EQUIPMENT

To the INSPECTOR OF BUILDINGS, PORTLAND, ME.

Portland, Maine, December 30, 1931

The undersigned hereby applies for a permit to install the following heating, cooking or power equipment in accordance with the Laws of Maine, the Building Code of the City of Portland, and the following specifications:

Location 58-60 Kent Street

Use of Building Dwelling House

Name and address of owner Fossett & Bertelsen, 26 Kent St.

Ward 9

Contractor's name and address A. E. Moody, 471 Auburn St.

Telephone P 1156

General Description of Work

To install steam heating system

IF HEATER, POWER BOILER OR COOKING DEVICE

Is heater or source of heat to be in cellar? yes If not, which story _____ Kind of Fuel _____

Material of supports of heater or equipment (concrete floor or what kind) concrete

Minimum distance to wood or combustible material, from top of boiler or casing top of furnace, 2 1/2'

from top of smoke pipe 20" from front of heater 5' from sides or back of heater 3'

IF OIL BURNER

Name and type of burner _____ Labeled and approved by Underwriters' Laboratories? _____

Will operator be always in attendance? _____ Type of oil feed (gravity or pressure) _____

Location oil storage _____ No. and capacity of tanks _____

Will all tanks be more than seven feet from any flame? _____ How many tanks fireproofed? _____

Amount of fee enclosed? 1.00 (\$1.00 for one heater, etc., 50 cents additional for each additional heater, etc., in same building at same time.)

INSPECTION COPY

Signature of contractor _____

NOTIFICATION BEFORE
CLOSING IS WAIVED
CERTIFICATE OF OCCUPANCY
P. C. 12/31/31

Ward 9 Permit No. 31/2580

Location 58-60 Kent St.

Owner Forsell + Berlebaen

Date of permit 12/30/31

Notif. closing-in _____

Inspn. closing-in _____

Final Notif. Not Req.

Final Inspn. 3/24/32 - OK

Owell 3/1/2002
Cert. of Occupancy issued File

1/5/32. NOTES
Heater set up but
not covered or connected.
Smokepipe opening
not cut. C.O.B.

PHONE-FOREST 3473-J

(R) GENERAL RESIDENCE ZONE

PHONE-FOREST 6324-J

FOSSETT & BERTELSEN
CARPENTERS AND BUILDERS

33 GRAFTON STREET - 102 OXFORD STREET

PORTLAND, MAINE,192.....

ONE STORY
WOOD BLDG.

RIGGS ST

VACANT LOT

VACANT LOT

26'-6"
PROPOSED ONE
FAMIL' WOODEN
DWELLING

12'-0"
12'-0"
12'-0"
12'-0"
12'-0"

58-60 KENT ST

TO BRIGHTON AVE.

STATE _____ T ACCOMPANYING APPLICATION FOR BUILDING PERMIT

for one family frame dwelling house
at 58-60 Kent St.

Date 10/16/31

1. In whose name is the title of the property now recorded? *Forrest & Bertelsen*
2. Are the boundaries of the property in the vicinity of the proposed work shown clearly on the ground, and how? *Stakes*
3. Is the outline of the proposed work now staked out upon the ground? *yes* If not, will you notify the Inspection Office when the work is staked out and before any of the work is commenced? *yes*
4. What is to be maximum projection or overhang of eaves or drip? *14 inches*
5. Do you assume full responsibility for the correctness of the location plan or statement of location filed with this application, and does it show the complete outline of the proposed work on the ground, including bay windows, porches and other projections? *yes*
6. Do you assume full responsibility for the correctness of all statements in the application concerning the sizes, design and use of the proposed building? *yes*
7. Do you understand that in case changes are proposed in the location of the work or in any of the details specified in the application that a revised plan and application must be submitted to this office before the changes are made? *yes*

Paul H. Bertelsen



GENERAL RESIDENCE ZONE

PERMIT ISSUED

APPLICATION FOR PERMIT

Class of Building or Type of Structure Third Class

2082
OCT 16 1931

Portland, Maine, October 16, 1931

To the INSPECTOR OF BUILDINGS, PORTLAND, ME.

The undersigned hereby applies for a permit to erect ~~alter~~ install the following building structure equipment in accordance with the Laws of the State of Maine, the Building Code of the City of Portland, plans and specifications, if any, submitted herewith and the following specifications:

Location 58-60 Kent Street Ward 9 Within Fire Limits? no Dist. No. _____

Owner's or Lessee's name and address Fossett & Bertelsen, 26 Kent St. Telephone F 8831 J

Contractor's name and address Owner Telephone _____

Architect's name and address _____

Proposed use of building dwelling house No. families 1

Other buildings on same lot none

Plans filed as part of this application? yes No. of sheets 1

Estimated cost \$ 3500. Gas Fee \$ 1.25 ²⁵
\$1.50

Description of Present Building to be Altered

Material _____ No. stories _____ Heat _____ Style of roof _____ Roofing _____

Last use _____ No. families _____

General Description of New Work

To erect one family frame dwelling house

It is understood that this permit does not include installation of heating apparatus which is to be taken out separately by and in the name of the heating contractor.

Details of New Work

Height average grade to top of plate _____

Size, front 26' depth 28' No. stories 2 Height average grade to highest point of roof 35'

To be erected on solid or filled land? solid earth or rock? earth

Material of foundation concrete Thickness, top 10" bottom 14"

Material of underpinning brick Height 18" Thickness 8"

Kind of Roof pitch Rise per foot 8" Roof covering Asphalt shingles Class C Und. Lab.

No. of chimneys 1 Material of chimneys brick of lining tile

Kind of heat steam Type of fuel coal Is gas fitting involved? yes

Corner posts 4x6 Sills 4x6 Girt or ledger board? girt Size 2-2x4

Material columns under girders iron pipe Size 4" Max. on centers 8'

Studs (outside walls and carrying partitions) 2x4-16" O. C. Girders 6x8 or larger. Bridging in every floor and flat roof span over 8 feet. Sills and corner posts all one piece in cross section.

Joists and rafters: 1st floor 2x8, 2nd 2x8, 3rd 2x6 unf, roof 2x6

On centers: 1st floor 16", 2nd 16", 3rd 24", roof 24"

Maximum span: 1st floor 13', 2nd 13', 3rd 13', roof _____

If one story building with masonry walls, thickness of walls? _____ height? _____

If a Garage

No. cars now accommodated on same lot _____, to be accommodated _____

Total number commercial cars to be accommodated _____

Will automobile repairing be done other than minor repairs to cars habitually stored in the proposed building? _____

Miscellaneous

Will above work require removal or disturbing of any shade tree on a public street? no

Will there be in charge of the above work a person competent to see that the State and City requirements pertaining thereto are observed? yes

Fossett & Bertelsen

Signature of owner

By Carl E. Bertelsen

INSPECTION COPY

62134

Ward 9 Permit No. 31/2082
 Location 58-60 Kent St.
 Owner Fussell & Berolase
 Date of permit 10/16/31.
 Notif. closing-in 1/5/32 - 1230 P.M.
 Inspn. closing-in 1/2/32 G.T. etc.
 Final Inspect. 1/5/32
 Final Notif. 3/24/32
 Final Inspn. 3/24/32, C.R.
 Cert. of Occupancy issued 3/24/32.

NOTES
 10/16/31. Location as shown on plan. C.R.
 10/21/31. Excavating. C.R.
 10/28/31. Concrete poured, forms not down. This is about 10" at top. C.R.
 11/23/31. Frame well along, roof of chimney between 1st & 2nd floor. C.R.
 12/4/31. Outside frame appears complete, some sections to be put in place at this time. C.R.
 same. C.R. over

12/21/31. Same, no work being done. C.R.



APPLICATION FOR PERMIT
DEPARTMENT OF BUILDING INSPECTIONS SERVICES
ELECTRICAL INSTALLATIONS

Date June 5, 19 84
Receipt and Permit number B 22517

To the CHIEF ELECTRICAL INSPECTOR, Portland, Maine:

The undersigned hereby applies for a permit to make electrical installations in accordance with the laws of Maine, the Portland Electrical Ordinance, the National Electrical Code and the following specifications:

LOCATION OF WORK: 60 Kent St.

OWNER'S NAME: John Marino ADDRESS: lives there

OUTLETS:

Receptacles _____ Switches _____ Plugmold _____ ft. TOTAL _____

FIXTURES: (number of)

Incandescent _____ Fluorescent _____ (not strip) TOTAL _____

Strip Fluorescent _____ ft. _____

SERVICES:

Overhead ☒ Underground _____ Temporary _____ TOTAL amperes 100 3.00

METERS: (number of) 1 .50

MOTORS: (number of)

Fractional _____

1 HP or over _____

RESIDENTIAL HEATING:

Oil or Gas (number of units) _____

Electric (number of rooms) _____

COMMERCIAL OR INDUSTRIAL HEATING:

Oil or Gas (by a main boiler) _____

Oil or Gas (by separate units) _____

Electric Under 20 kws _____ Over 20 kws _____

APPLIANCES: (number of)

Ranges _____ Water Heaters _____

Cook Tops _____ Disposals _____

Wall Ovens _____ Dishwashers _____

Dryers _____ Compactors _____

Fans _____ Others (denote) _____

TOTAL _____

MISCELLANEOUS: (number of)

Branch Panels _____

Transformers _____

Air Conditioners Central Unit _____

Separate Units (windows) _____

Signs 20 sq. ft. and under _____

Over 20 sq. ft. _____

Swimming Pools Above Ground _____

In Ground _____

Fire/Burglar Alarms Residential _____

Commercial _____

Heavy Duty Outlets, 220 Volt (such as welders) 30 amps and under _____

over 30 amps _____

Circus, Fairs, etc. _____

Alterations to wires _____

Repairs after fire _____

Emergency Lights, battery _____

Emergency Generators _____

INSTALLATION FEE DUE:

FOR ADDITIONAL WORK NOT ON ORIGINAL PERMIT DOUBLE FEE DUE:

FOR REMOVAL OF A "STOP ORDER" (304-16.b) TOTAL AMOUNT DUE:

min 3.50

5.00

INSPECTION:

Will be ready on _____, 19 ____; or Will Call _____

CONTRACTOR'S NAME: Mancini Elec

ADDRESS: 179 Sheridan St.

TEL: _____

MASTER LICENSE NO.: 2436 SIGNATURE OF CONTRACTOR:

LIMITED LICENSE NO.: _____

INSPECTOR'S COPY — WHITE

OFFICE COPY — CANARY

CONTRACTOR'S COPY — GREEN

Permit Number

Permit Number

Location 60 Kent St.

Owner — J. Thorne

Date of Permit: 6-5-89

Final Inspection _____

By Inspector _____

Permit Application Register Page No. 1

INSPECTIONS: Service _____ by _____

Service called in _____

Closing-in _____ by _____

PROGRESS INSPECTIONS: _____ / _____ / _____

CODE
COMPLIANCE
COMPLETED
DATE 11-9-84

DATE:

REMARKS:



APPLICATION FOR PERMIT
DEPARTMENT OF BUILDING INSPECTIONS SERVICES
ELECTRICAL INSTALLATIONS

Date September 18, 1986
Receipt and Permit number D 25124

To the CHIEF ELECTRICAL INSPECTOR, Portland, Maine:
The undersigned hereby applies for a permit to make electrical installations in accordance with the laws of
Maine, the Portland Electrical Ordinance, the National Electrical Code and the following specifications:
LOCATION OF WORK: 60 Kent St.
OWNER'S NAME: John J. Marino ADDRESS: 60 Kent St.

	FEES
OUTLETS: Receptacles _____ Switches _____ Plugmold _____ ft. TOTAL _____	
FIXTURES: (number of) Incandescent _____ Fluorescent _____ (not strip) TOTAL _____ Strip Fluorescent _____ ft. _____	
SERVICES: Overhead <input checked="" type="checkbox"/> Underground _____ Temporary _____ TOTAL amperes <u>100</u>	3.00
METERS: (number of) <u>1</u>	.50
MOTORS: (number of) Fractional _____ 1 HP or over _____	
RESIDENTIAL HEATING: Oil or Gas (number of units) _____ Electric (number of rooms) _____	
COMMERCIAL OR INDUSTRIAL HEATING: Oil or Gas (by a main boiler) _____ Oil or Gas (by separate units) _____ Electric Under 20 kws _____ Over 20 kws _____	
APPLIANCES: (number of) Ranges _____ Cook Tops _____ Wall Ovens _____ Dryers _____ Fens _____ TOTAL _____	
MISCELLANEOUS: (number of) Branch Panels _____ Transformers _____ Air Conditioners Central Unit _____ Separate Units (windows) _____ Signs 20 sq. ft. and under _____ Over 20 sq. ft. _____ Swimming Pools Above Ground _____ In Ground _____ Fire/Burglar Alarms Residential _____ Commercial _____ Heavy Duty Outlets, 220 Volt (such as welders) 30 amps and under _____ over 30 amps _____ Circus, Fairs, etc. _____ Alterations to wires _____ Repairs after fire _____ Emergency Lights, battery _____ Emergency Generators _____	2.00
FOR ADDITIONAL WORK NOT ON ORIGINAL PERMIT	INSTALLATION FEE DUE:
FOR REMOVAL OF A "STOP ORDER" (304-16.b)	DOUBLE FEE DUE:
	TOTAL AMOUNT DUE: <u>5.50</u>

INSPECTION: Will be ready on Sept 22 3:45 - 4:00
CONTRACTOR'S NAME: Milton Emerson, 1986 or Will Call
ADDRESS: 60 Kent St.
TEL.: 892-3165 So. Windham, Maine 04082
MASTER LICENSE NO.: 04591
LIMITED LICENSE NO.: _____ SIGNATURE OF CONTRACTOR: _____

INSPECTOR'S COPY — WHITE
OFFICE COPY — CANARY
CONTRACTOR'S COPY — GREEN

ELECTRICAL INSTALLATIONS—

Permit Number 201-57

Location Local Authority

Owner John G. Williams

Date of Permit 7/19/86

Final Inspection 9/22/85

By Inspector W. J. G. 225

Permit Application Register Page No. 143

INSPECTIONS: Service 100 AMP by Russo
Service called in 9/22
Closing in _____ by _____

Service called in 9/22

Closing-in _____ by _____

PROGRESS INSPECTIONS: 9/22 / /

DATE:

REMARKS:

9/22/86	Service Completed
---------	-------------------

CODE
COMPLIANCE
COMPLET

DATE: 9/2/86 DR