

PERMIT # **000439**

CITY OF Portland BUILDING PERMIT APPLICATION

MAP # \_\_\_\_\_ LOT# \_\_\_\_\_

Please fill out any part which applies to job. Proper plans must accompany form.

Owner: William Mekoney

Address: 587 Brighton Avenue

LOCATION OF CONSTRUCTION same

CONTRACTOR: Peter Wentworth SUBCONTRACTORS: 839-3569

ADDRESS: 17 Elm Street, Gorham

Est. Construction Cost: \_\_\_\_\_ Type of Use: retail

Past Use: \_\_\_\_\_

Building Dimensions L \_\_\_\_\_ W \_\_\_\_\_ Sq. Ft. \_\_\_\_\_ # Stories: \_\_\_\_\_ Lot Size: \_\_\_\_\_

Is Proposed Use: \_\_\_\_\_ Seasonal \_\_\_\_\_ Condominium \_\_\_\_\_ Apartment \_\_\_\_\_

Conversion - Explain temporary sign May 2 - June 2

COMPLETE ONLY IF THE NUMBER OF UNITS WILL CHANGE

Residential Buildings Only:

# Of Dwelling Units \_\_\_\_\_ # Of New Dwelling Units \_\_\_\_\_

Foundation:

1. Type of Soil: \_\_\_\_\_
2. Set Backs - Front \_\_\_\_\_ Rear \_\_\_\_\_ Side(s) \_\_\_\_\_
3. Footings Size: \_\_\_\_\_
4. Foundation Size: \_\_\_\_\_
5. Other \_\_\_\_\_

Floor:

1. Sills Size: \_\_\_\_\_ Sills must be anchored.
2. Girder Size: \_\_\_\_\_
3. Lally Column Spacing: \_\_\_\_\_ Size: \_\_\_\_\_
4. Joists Size: \_\_\_\_\_ Spacing 16" O.C.
5. Bridging Type: \_\_\_\_\_ Size: \_\_\_\_\_
6. Floor Sheathing Type: \_\_\_\_\_ Size: \_\_\_\_\_
7. Other Material: \_\_\_\_\_

Exterior Walls:

1. Studding Size \_\_\_\_\_ Spacing \_\_\_\_\_
2. No. windows \_\_\_\_\_
3. No. Doors \_\_\_\_\_
4. Header Sizes \_\_\_\_\_ Span(s) \_\_\_\_\_
5. Bracing: Yes \_\_\_\_\_ No \_\_\_\_\_
6. Corner Posts Size \_\_\_\_\_
7. Insulation Type \_\_\_\_\_ Size \_\_\_\_\_
8. Sheathing Type \_\_\_\_\_ Size \_\_\_\_\_
9. Siding Type \_\_\_\_\_ Weather Exposure \_\_\_\_\_
10. Masonry Materials \_\_\_\_\_
11. Metal Materials \_\_\_\_\_

Interior Walls:

1. Studding Size \_\_\_\_\_ Spacing \_\_\_\_\_
2. Header Sizes \_\_\_\_\_ Span(s) \_\_\_\_\_
3. Wall Covering Type \_\_\_\_\_
4. Fire Wall if required \_\_\_\_\_
5. Other Materials \_\_\_\_\_

For Official Use Only	
Date: <u>May 2, 1988</u>	Subdivision: Yes / No _____
Inside Fire Limits _____	Name _____
Blgd Code _____	Lot _____
Time Limit _____	Block _____
Estimated Cost _____	Permit Expiration: _____
Value/Structure _____	Ownership: _____ Public _____ Private _____
Fee: <u>20.00</u>	

PERMIT ISSUED

Celling:

1. Ceiling Joists Size: \_\_\_\_\_
2. Ceiling Strapping Size \_\_\_\_\_ Spacing MAY 3 1988
3. Type Ceilings: \_\_\_\_\_
4. Insulation Type \_\_\_\_\_ Size \_\_\_\_\_
5. Ceiling Height: \_\_\_\_\_ City Of Portland

Roof:

1. Truss or Raft Size \_\_\_\_\_ Span \_\_\_\_\_
2. Sheathing Type \_\_\_\_\_ Size \_\_\_\_\_
3. Roof Covering Type \_\_\_\_\_
4. Other \_\_\_\_\_

Chimneys:

Type: \_\_\_\_\_ Number of Fire Places \_\_\_\_\_

Heating:

Type of Heat: \_\_\_\_\_

Electrical:

Service Entrance Size: \_\_\_\_\_ Smoke Detector Required Yes \_\_\_\_\_ No \_\_\_\_\_

Plumbing:

1. Approval of soil test if required Yes \_\_\_\_\_ No \_\_\_\_\_
2. No. of Tubs or Showers \_\_\_\_\_
3. No. of Flushes \_\_\_\_\_
4. No. of Lavatories \_\_\_\_\_
5. No. of Other Fixtures \_\_\_\_\_

Swimming Pools:

1. Type: \_\_\_\_\_
2. Pool Size: \_\_\_\_\_ x \_\_\_\_\_ Square Footage \_\_\_\_\_
3. Must conform to National Electrical Code and State Law.

Zoning:

District: B-1 Street Frontage Req: \_\_\_\_\_ Provided \_\_\_\_\_

Required Setbacks: Front \_\_\_\_\_ Back \_\_\_\_\_ Side \_\_\_\_\_

Review Required:

Zoning Board Approval: Yes \_\_\_\_\_ No \_\_\_\_\_ Date: \_\_\_\_\_  
 Planning Board Approval: Yes \_\_\_\_\_ No \_\_\_\_\_ Date: \_\_\_\_\_  
 Conditional Use: \_\_\_\_\_ Variance \_\_\_\_\_ Site Plan \_\_\_\_\_ Subdivision \_\_\_\_\_  
 Shore and Floodplain Mgmt: \_\_\_\_\_ Special Exception \_\_\_\_\_  
 Other (Explain) O.K. P.H. Turner May 3, 1988  
 Date Approved \_\_\_\_\_

Permit Received By Jeanne Quint

Signature of Applicant William Mekoney Date 5-2-88

Signature of CEO \_\_\_\_\_ Date \_\_\_\_\_

Inspection Dates \_\_\_\_\_

White-Tax Assessor

Yellow-GPCOG

White Tag-GEO

© Copyright GPCOG 1987

[2] MA. CARROLL

PLOT PLAN

N



**FEES (Breakdown From Front)**  
Base Fee \$ 13 00  
Subdivision Fee \$ \_\_\_\_\_  
Site Plan Review Fee \$ \_\_\_\_\_  
Other Fees \$ \_\_\_\_\_  
(Explain) \_\_\_\_\_  
Late Fee \$ \_\_\_\_\_

Type	Inspection Record	Date
_____	_____	/ /
_____	_____	/ /
_____	_____	/ /
_____	_____	/ /
_____	_____	/ /

**COMMENTS**

Signature of Applicant

Date

5-2-88

MODERN PRINT  
887 BRIGHTON AVE.  
PORTLAND, ME.

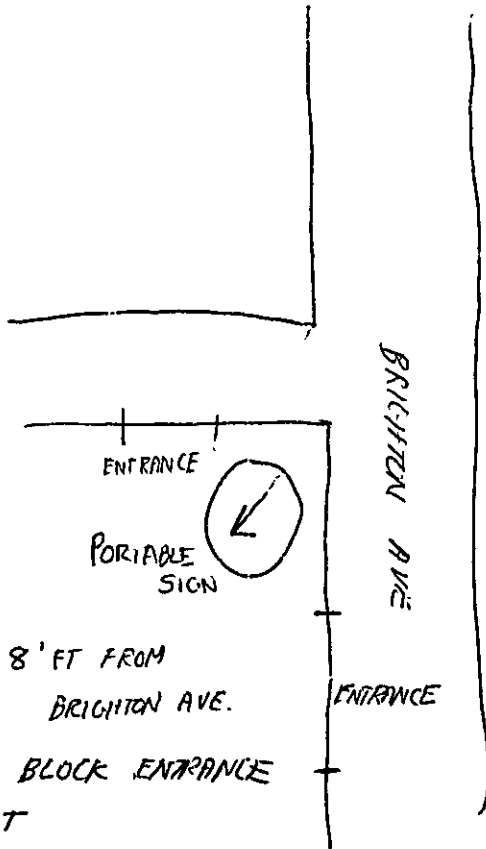



CITY OF PORTLAND, MAINE  
Department of Building Inspection

# Certificate of Occupancy

Returned to J. Gannon-885 Brighton Ave.  
LOCATION 885-889 Brighton Ave.

Date of Issue Dec. 11, 1986

This is to certify that the building, premises, or part thereof, at the above location, built—altered—changed as to use under Building Permit No. 5388, has had final inspection, has been found to conform substantially to requirements of Zoning Ordinance and Building Code of the City, and is hereby approved for occupancy or use, limited or otherwise, as indicated below.

PORTION OF BUILDING OR PREMISES

101' x 35' Second Story Addition

APPROVED OCCUPANCY

Six office units and two  
bathrooms

Limiting Conditions:

As amended  
additional 40' extension at west end (Kent St. side) of bldg is roof covering only. This space shall remain vacant and be separated from this certificate superseded certificate issued occupiable space by a one hour's rated fire wall with vertical openings.

Approved:  
12/11/86  
(Date)

Inspector

Inspector of Buildings

Notice: This certificate certifies lawful use of building or premises, and ought to be transferred from owner to owner or when property changes hands. Copy will be furnished to owner or lessee for one dollar.

PERMIT # 002021 CITY OF Portland BUILDING PERMIT APPLICATION

MAP # \_\_\_\_\_ LOT# \_\_\_\_\_

Please fill out any part which applies to job. Proper plans must accompany form.

Owner: Rudy Gagnon  
 Address: 885 Brighton Ave. Portland, Maine  
 LOCATION OF CONSTRUCTION: 887 Brighton Avenue  
 CONTRACTOR: Coubr SUBCONTRACTORS: \_\_\_\_\_  
 ADDRESS: \_\_\_\_\_

Est. Construction Cost: \_\_\_\_\_ Type of Use: Paint Store

Building Dimensions: L \_\_\_\_\_ W \_\_\_\_\_ Sq. Ft. \_\_\_\_\_ # Stories \_\_\_\_\_ Lot Size: \_\_\_\_\_  
 Is Proposed Use: \_\_\_\_\_ Seasonal \_\_\_\_\_ Condominium \_\_\_\_\_ Apartment \_\_\_\_\_

Conversion - Explain: to erect temporary sign for 90 days, (4'x8')  
 from 4/27/89 to 7/27/89.

COMPLETE ONLY IF THE NUMBER OF UNITS WILL CHANGE  
 Residential Buildings Only: \_\_\_\_\_  
 # Of Dwelling Units: \_\_\_\_\_ # Of New Dwelling Units: \_\_\_\_\_

Foundation:  
 1. Type of Soil: \_\_\_\_\_  
 2. Set Backs - Front \_\_\_\_\_ Rear \_\_\_\_\_ Side(s) \_\_\_\_\_  
 3. Footings Size: \_\_\_\_\_  
 4. Foundation Size: \_\_\_\_\_  
 5. Other: \_\_\_\_\_

Floors:  
 1. Sills Size: \_\_\_\_\_ Sills must be anchored.  
 2. Girder Size: \_\_\_\_\_  
 3. Lally Column Spacing: \_\_\_\_\_ Size: \_\_\_\_\_  
 4. Joists Size: \_\_\_\_\_ Spacing 16" O.C.  
 5. Bridging Type: \_\_\_\_\_ Size: \_\_\_\_\_  
 6. Floor Sheathing Type: \_\_\_\_\_ Size: \_\_\_\_\_  
 7. Other Material: \_\_\_\_\_

Exterior Walls:  
 1. Studding Size \_\_\_\_\_ Spacing \_\_\_\_\_  
 2. No. windows \_\_\_\_\_  
 3. No. Doors \_\_\_\_\_  
 4. Header Sizes \_\_\_\_\_ Span(s) \_\_\_\_\_  
 5. Bracing: Yes \_\_\_\_\_ No \_\_\_\_\_  
 6. Corner Posts Size \_\_\_\_\_  
 7. Insulation Type \_\_\_\_\_ Size \_\_\_\_\_  
 8. Sheathing Type \_\_\_\_\_ Size \_\_\_\_\_  
 9. Siding Type \_\_\_\_\_ Weather Exposure \_\_\_\_\_  
 10. Masonry Materials \_\_\_\_\_  
 11. Metal Materials \_\_\_\_\_

Interior Walls:  
 1. Studding Size \_\_\_\_\_ Spacing \_\_\_\_\_  
 2. Header Sizes \_\_\_\_\_ Span(s) \_\_\_\_\_  
 3. Wall Covering Type \_\_\_\_\_  
 4. Fire Wall If Required \_\_\_\_\_  
 5. Other Materials \_\_\_\_\_

**For Official Use Only**

Date: April 27, 1989 Subdivision: Yes \_\_\_\_\_ No \_\_\_\_\_  
 Inside Fire Limits \_\_\_\_\_ Name: \_\_\_\_\_  
 Bldg Code \_\_\_\_\_ Lot \_\_\_\_\_  
 Time Limit \_\_\_\_\_ Block \_\_\_\_\_  
 Estimated Cost \_\_\_\_\_ Permit Expiration: \_\_\_\_\_  
 Value/Structure \_\_\_\_\_ Ownership: \_\_\_\_\_ Public \_\_\_\_\_ Private \_\_\_\_\_  
 Fee \$30.00

Ceiling:  
 1. Ceiling Joists Size: \_\_\_\_\_  
 2. Ceiling Strapping Size \_\_\_\_\_ Spacing \_\_\_\_\_  
 3. Type Ceiling: \_\_\_\_\_  
 4. Insulation Type: \_\_\_\_\_ Size \_\_\_\_\_  
 5. Ceiling Height: \_\_\_\_\_

Roof:  
 1. Truss or Rafter Size \_\_\_\_\_ Span \_\_\_\_\_  
 2. Sheathing Type \_\_\_\_\_  
 3. Roof Covering Type \_\_\_\_\_  
 4. Other: \_\_\_\_\_  
 Type: \_\_\_\_\_ Number of Fire Places \_\_\_\_\_

Heating:  
 Type of Heat: \_\_\_\_\_  
 Electrical:  
 Service Entrance Size: \_\_\_\_\_ Smoke Detector Required: Yes \_\_\_\_\_ No \_\_\_\_\_

Plumbing:  
 1. Approval of coil test if required: NO Yes \_\_\_\_\_ No \_\_\_\_\_  
 2. No. of Tubs or Showers \_\_\_\_\_  
 3. No. of Flushes \_\_\_\_\_  
 4. No. of Lavatories \_\_\_\_\_  
 5. No. of Other Fixtures \_\_\_\_\_

Swimming Pool:  
 1. Pool Size: \_\_\_\_\_ Square Footage \_\_\_\_\_  
 2. Must conform to National Electrical Code and State Law.

Zoning:  
 District: R-1 Street Frontage Req. \_\_\_\_\_ Provided \_\_\_\_\_  
 Required Setbacks: Front \_\_\_\_\_ Back \_\_\_\_\_ Side \_\_\_\_\_

Review Required:  
 Zoning Board Approval: Yes \_\_\_\_\_ No \_\_\_\_\_ Date: \_\_\_\_\_  
 Planning Board Approval: Yes \_\_\_\_\_ No \_\_\_\_\_ Date: \_\_\_\_\_  
 Conditional Use: \_\_\_\_\_ Variance \_\_\_\_\_ Site Plan \_\_\_\_\_ Subdivision \_\_\_\_\_  
 Shore and Floodplain Mgmt. \_\_\_\_\_ Special Exception \_\_\_\_\_  
 Other (Explain): \_\_\_\_\_  
 Date Approved: 4/27/89

Permit Received By: Nancy Grosman  
 Signature of Applicant: W. P. ... Date: 4-27-89  
 Signature of CEO: \_\_\_\_\_ Date: \_\_\_\_\_  
 Inspection Dates: \_\_\_\_\_

White-Tax Assessor: \_\_\_\_\_ Yellow-GPCOG: \_\_\_\_\_ White Tag-CEO: \_\_\_\_\_  
 Copyright GPCOG 1987  
 TAYLOR

**PERMIT ISSUED**  
MAY 4 1989  
**City Of Portland**

**PLOT PLAN**

N

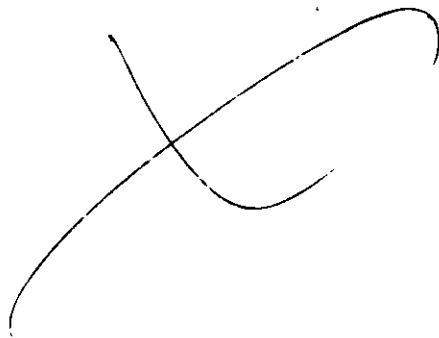

**FEES (Breakdown From Front)**  
Base Fee \$ 30.00  
Subdivision Fee \$ \_\_\_\_\_  
Site Plan Review Fee \$ \_\_\_\_\_  
Other Fees \$ \_\_\_\_\_  
(Explain) \_\_\_\_\_  
Late Fee \$ \_\_\_\_\_

Type	Inspection Record	Date
_____	_____	____/____/____
_____	_____	____/____/____
_____	_____	____/____/____
_____	_____	____/____/____
_____	_____	____/____/____

**COMMENTS**

\_\_\_\_\_  
\_\_\_\_\_  
\_\_\_\_\_  
\_\_\_\_\_  
\_\_\_\_\_  
\_\_\_\_\_  
\_\_\_\_\_  
\_\_\_\_\_  
\_\_\_\_\_

Signature of Applicant William E. McKone Jr. Date 11-27-89

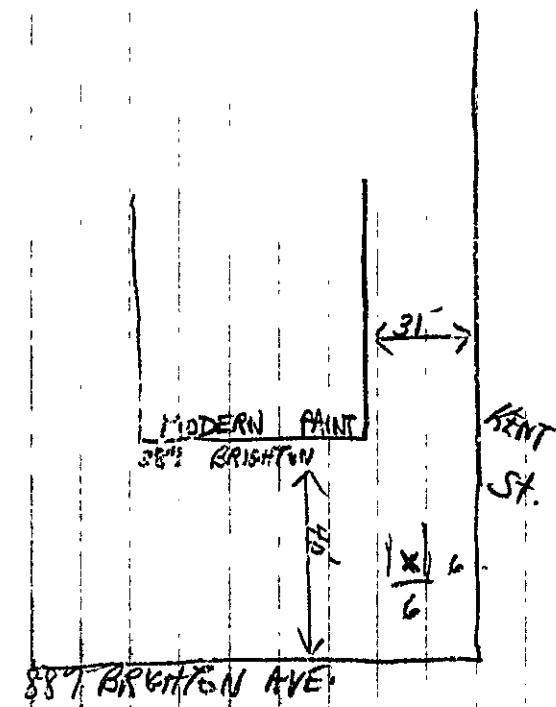

**RECEIVED**

APR 27 1989

DEPT OF BUILDING INSPECT  
CITY OF PORTLAND

WRITTEN CONSENT AND AGREEMENT RELATING TO A CERTAIN SIGN OR AWNING PROPOSED TO BE ERECTED ON A BUILDING AT 887 Brighton Ave. IN PORTLAND, MAINE Rudy Gagnon being the owner of the premises at 887 Brighton in Portland, Maine hereby gives consent to the erection of a certain sign owned by Modern Paint over the sidewalk or on the building from said premises as described in application to the Division of Inspection Services of Portland, Maine for a permit to cover the erection of said sign:

And in consideration of the issuance of said permit Rudy Gagnon owner of said premises, in event said sign shall cease to serve the purpose for which it was erected or shall become dangerous and in event the owner of said sign shall fail to remove said sign or make it permanently safe in case the sign still serves the purpose for which it was erected, hereby agrees for himself or herself, for his heirs, its successors, and his or its assigns, to completely remove said sign in such condition and of order from him to remove it.

In Witness whereof, the owner of said premises has signed this consent and agreement this 27<sup>th</sup> day of April 19 87

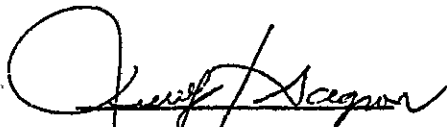
  
Owner's signature

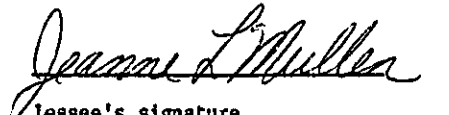
  
Lessee's signature  
Modern Paint



MODERN PAINT

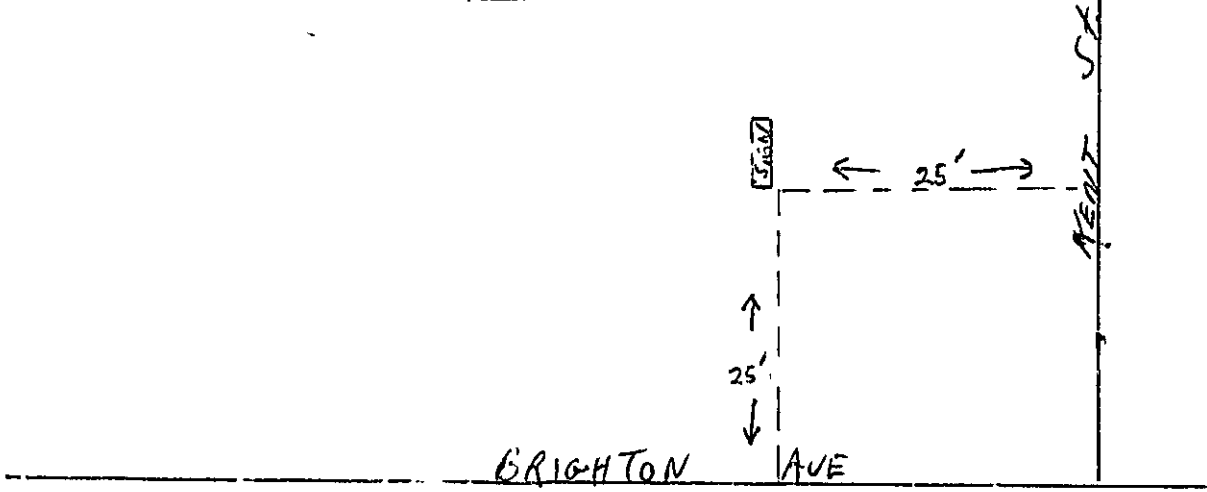

PORTABLE SIGN  
TEMPORARY PERMIT  
3 MOS.