

46-50 CANDLEWYCK ROAD (Lot #280)
called 46 not 48

STANDARD
#9203-12

46 Candlewyck Road

May 22, 1973

Arthur Shields
46 Candlewyck Road

Dear Mr. Shields:

This office is unable to issue a permit to construct a breezeway and attached garage 24' x 24' because the estimated cost is too low. Before we will be in a position to further process your permit it will be necessary to come to this office and revise the cost to a more realistic figure.

Very truly yours,

Barle S. Smith
Plan Examiner

ESS:m



R3 RESIDENCE ZONE

APPLICATION FOR PERMIT

Class of Building or Type of Structure _____

Portland, Maine, May 21, 1973

PERMIT ISSUED

MAY 30 1973 00587

CITY of PORTLAND

To the INSPECTOR OF BUILDINGS, PORTLAND, MAINE

The undersigned hereby applies for a permit to erect alter repair demolish install the following building structure equipment in accordance with the Laws of the State of Maine, the Building Code and Zoning Ordinance of the City of Portland, plans and specifications, if any, submitted herewith and the following specifications:

Location 46 Candlewyck Rd. Within Fire Limits? _____ Dist. No. _____
Owner's name and address Arthur Shields, same Telephone 772-6825
Lessee's name and address _____ Telephone _____
Contractor's name and address owner Telephone _____
Architect _____ Specifications _____ Plans _____ No. of sheets _____
Proposed use of building attached garage No families _____
Last use _____ No. families _____
Material _____ No. stories _____ Heat _____ Style of roof _____ Roofing _____
Other buildings on same lot dwelling
Estimated cost \$ 1700 fee \$ 6.

General Description of New Work

To construct breezeway and attached garage 24' x 24' as per plan

Pl 6-5-30-73
12 Total

It is understood that this permit does not include installation of heating apparatus which is to be taken out separately by and in the name of the heating contractor. PERMIT TO BE ISSUED TO owner

Details of New Work

Is any plumbing involved in this work? no Is any electrical work involved in this work? YES
Is connection to be made to public sewer? _____ If not, what is proposed for sewage? _____
Has septic tank notice been sent? _____ Form notice sent? _____
Height average grade to top of plate 8' Height average grade to highest point of roof 13'
Size, front 24' depth 24' No. stories 1 below grade? solid or filled land? solid earth or rock?
Material of foundation 8" concrete blocks Thickness, top _____ bottom _____ cellar _____
Kind of roof pitch Rise per foot 5" Roof covering asphalt shingles
No. of chimneys _____ Material of chimneys _____ of lining _____ Kind of heat fuel
Laming Lumber-Kind spruce Dressed or full size? dr. Corner posts 4x4 Sills 4x6
Size Girder _____ Columns under girders _____ Size _____ Max. on centers _____
Studs (outside walls and carrying partitions) 2x4-10" O. C Bridging in every floor and flat roof span over 8 feet.
Joists and rafters: 1st floor _____, 2nd _____, 3rd _____, roof 2x6
On centers: 1st floor _____, 2nd _____, 3rd _____, roof 2'
Maximum span: 1st floor _____, 2nd _____, 3rd _____, roof _____
If one story building with masonry walls, thickness of walls? _____ height? _____

If a Garage

No. cars now accommodated on same lot _____, to be accommodated _____ number commercial cars to be accommodated _____
Will automobile repairing be done other than minor repairs to cars habitually stored in the proposed building? _____

APPROVED:
5/22/73 ZONING O.H. M.B.
5/22/73

Miscellaneous

Will work require disturbing of any tree on a public street? _____
Will there be in charge of the above work a person competent to see that the State and City requirements pertaining thereto are observed? YES

Signature of owner Arthur Shields

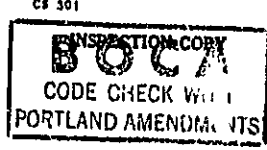

NOTES

5-31-73 GAVE PERMITS
 * NU TO PLACE FOUNDA
 TION - *[Signature]*
 6-18-73 SLAB *[Signature]*
 7-11-73 FRAMING COM
 PLETED *[Signature]*
 7-31-73 COMPLETELY *[Signature]*

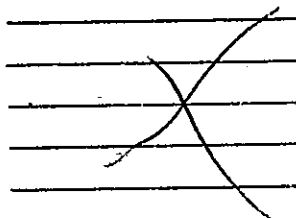

SAM

Permit No. 73/587
 Location 46 Cambridge Rd
 Owner Arthur Apple
 Date of permit 5/30/73
 Notif. closing-in _____
 Inspn. closing-in _____
 Final Notif. _____
 Final Inspn. _____
 Cert. of Occupancy issued _____
 Staking Out Notice _____
 Form Check Notice _____

PERMIT TO INSTALL PLUMBING

1512

PERMIT NUMBER

Date Issued **June 24, 1970**
 Portland Plumbing Inspector
 By **ERNOLD R GOODWIN**

App. First Insp.
 Date **6/25/70**
 By **WALTER H WALLACE**
 DEPUTY PLUMBING INSPECTOR

* App. Final Insp.
 Date **7/6/71**
 By **WALTER H WALLACE**
 DEPUTY PLUMBING INSPECTOR

- Type of Bldg.
- Commercial
 - Residential
 - Single
 - Multi Family
 - New Construction
 - Remodeling

Address		Lot 200 Chandler Rd.		PERMIT NUMBER	1512
Installation For		Plumbing			
Owner of Bldg		Winat Corp.			
Owner's Address		37 Franklin St.		Date	June 24, 1970
Plumber		William Miles, Jr.		NO.	FEE
NEW	REPL				
		SINKS		1	
X		LAVATORIES		2	
X		TOILETS		2	
X		BATH TUBS		1	
X		SHOWERS			
X		DRAINS FLOOR SURFACE			
X		HOT WATER TANKS			
X		TANKLESS WATER HEATERS		1	
X		GARBAGE DISPOSALS		1	
X		SEPTIC TANKS			
		HOUSE SEWERS			
		ROOF LEADERS			
X		AUTOMATIC WASHERS		1	
X		DISHWASHERS		1	
		OTHER			
				TOTAL	11
					13.60

Building and Inspection Services Dept.: Plumbing Inspection

CITY OF PORTLAND, MAINE
Application for Permit to Install Wires

Permit No. 56104
 Issued 7-6-70
 7-6-1970

Portland, Maine

To the City Electrician, Portland, Maine:

The undersigned hereby applies for a permit to install wires for the purpose of conducting electric current, in accordance with the laws of Maine, the Electrical Ordinance of the City of Portland, and the following specifications:

(This form must be completely filled out — Minimum Fee \$100.00)

Owner's Name and Address MINAT Corp. Tel.
 Contractor's Name and Address Palotta Oil Co. Tel.
 Location lot 280 Candivyck Use of Building Dwelling Number of Stories I
 Number of Families I Apartments Stores
 Description of Wiring: New Work X Additions Alterations

Pipe . . . Cable . . . Metal Molding . . . BX Cable . . . Plug Molding (No. of feet) . . .
 No. Light Outlets . . . Plugs . . . Light Circuits . . . Plug Circuits . . .
 FIXTURES: No. Floor. or Strip Lighting (No feet)
 SERVICE: Pipe Cable Underground No. of Wires Size
 METERS: Relocated Added Total No. Meters
 MOTORS: Number Phase S H. P. 8 Amps Volts 110 Starter
 HEATING UNITS: Domestic (Oil) ✓ No. Motors 1 Phase S H.P. 110
 Commercial (Oil) No. Motors Phase H.P.
 Electric Heat (No. of Rooms)

APPLIANCES: No. Ranges Watts Brand Feeds (Size and No.)
 Elec. Heaters Watts
 Miscellaneous Watts Extra Cabinets or Panels

Transformers Air Conditioners (No. Units) Signs (No. Units)
 Will commence 19 Ready to cover in 19 Inspection 19
 Amount of Fee \$

Signed S. J. Palotta

DO NOT WRITE BELOW THIS LINE

SERVICE METER GROUND
 VISITS: 1 2 3 4 5 6
 7 8 9 10 11 12
 REMARKS:

INSPECTED BY [Signature]
 (OVER)

CITY OF PORTLAND, MAINE
Application for Permit to Install Wires

Permit No. 56088
 Issued 7/2/70
July 2, 1970

Portland, Maine

To the City Electrician, Portland, Maine:

The undersigned hereby applies for a permit to install wires for the purpose of conducting electric current, in accordance with the laws of Maine, the Electrical Ordinance of the City of Portland, and the following specifications:

(This form must be completely filled out — Minimum Fee, \$1.00)

Owner's Name and Address Minat Corp. Tel.
 Contractor's Name and Address C.O. O'Brien Tel.
 Location Lot 250 Chandler St Use of Building ..
 Number of Families / Apartments Stores Number of Stories ...
 Description of Wiring: New Work Additions Alterations

Pipe ... Cable ... Metal Molding BX Cable Plug Molding (No. of feet)
 No. Light Outlets 27 Plugs 29 Light Circuits 4 Plug Circuits 2
 FIXTURES: No. Fluor. or Strip Lighting (No feet)
 SERVICE: Pipe ... Cable ... Underground No. of Wires 3 Size 2 #3 @ #4
 METERS: Relocated Added Total No. Meters
 MOTORS: Number ... Phase H. P. Amps Volts Starter
 HEATING UNITS: Domestic (Oil) No. Motors Phase H.P.
 Commercial (Oil) No. Motors Phase H.P.
 Electric Heat (No. of Rooms)
 APPLIANCES: No. Ranges / Watts Brand Feeds (Size and No.)
 Elec. Heaters ... Watts
 Miscellaneous Refr Watts ... Extra Cabinets or Panels
 Transformers Air Conditioners (No. Units) Signs (No. Units)
 Will commence 19 Ready to cover in 19 Inspection 7/2 19 70
 Amount of Fee \$..
 Signed C.O. O'Brien

DO NOT WRITE BELOW THIS LINE

SERVICE	<input checked="" type="checkbox"/>	METER	<input type="checkbox"/>	GROUND	<input checked="" type="checkbox"/>
VISITS:	1	2	3	4	5
	6	7	8	9	10
	11	12			

REMARKS:
Service not ready

INSPECTED BY F.W. Hart
 (OVER)

PERMIT TO INSTALI PLUMBING.

PERMIT NUMBER 1317

Date Issued 4/23/70
 Portland Plumbing Inspector
 By ERNOLD R GOODWIN

App. First Insp.
 Date 4/23/70
 By WALTER H. WALLACE
 DEPUTY PLUMBING INSPECTOR

App. Final Insp.
 Date 4/24/70
 By WALTER H. WALLACE
 DEPUTY PLUMBING INSPECTOR

- Type of Bldg.
- Commercial
 - Residential
 - Single
 - Multi Family
 - New Construction
 - Remodeling

Address		Lot 230 Sandberg & Rd.		PERMIT NUMBER 1317	
Installation For		Owner of Bldg: Hiral Corp.		Date: 4/23/70	
Owner's Address: 34 Prairie St.		Plumber: Walter Klins, Jr.		NO. / FEE	
Plumber: 243, Yarmouth					
NEW	REPL.				
		SINKS			
		LAVATORIES			
		TOILETS			
		BATH TUBS			
		SHOWERS			
		DRAINS	FLOOR	SURFACE	
		HOT WATER TANKS			
		TANKLESS WATER HEATERS			
		GARBAGE DISPOSALS			
		SEPTIC TANKS			
		HOUSE SEWERS		1	2.00
		ROOF LEADERS			
		AUTOMATIC WASHERS			
		DISHWASHERS			
		OTHER			
TOTAL				1	2.00

Building and Inspection Services Dept.: Plumbing Inspection

PERMIT TO INSTALL PLUMBING.

PERMIT NUMBER **1317**

Date Issued **4/23/70**
 Portland Plumbing Inspector
 By **ERNOLD R GOODWIN**

Address **Lot 290 Gardlonyck Rd.**

Installation For: _____

Owner of Bldg: **Minot Corp.**

Owner's Address: **34 Preble St.**

Plumber: **Walter Miles, Jr.** Date: **4/23/70**

243, Yarmouth NO _____ FEE _____

NEW	REPL	DESCRIPTION	NO	FEE
		SINKS		
		LAVATORIES		
		TOILETS		
		BATH TUBS		
		SHOWERS		
		DRAINS FLOOR SURFACE		
		HOT WATER TANKS		
		TANKLESS WATER HEATERS		
		GARBAGE DISPOSALS		
		SEPTIC TANKS		
1		HOUSE SEWERS	1	2.00
		ROOF LEADERS		
		AUTOMATIC WASHERS		
		DISHWASHERS		
		OTHER		
			TOTAL 1	2.00

App. First Insr.
 Date **4/24/70**
 By **WALTER H. WALLACE**
 DEPUTY PLUMBING INSPECTOR

App. Final Insr.
 Date **4/24/70**
 By **WALTER H. WALLACE**
 DEPUTY PLUMBING INSPECTOR

- Type of Bldg.
- Commercial
 - Residential
 - Single
 - Multi Family
 - New Construction
 - Remodeling

Building and Inspection Services Dept.; Plumbing Inspection



FILL IN AND SIGN WITH INK

APPLICATION FOR PERMIT FOR HEATING, COOKING OR POWER EQUIPMENT

Portland, Maine, July 7, 1970

PERMIT ISSUE
JUL 8 1970
761
CITY of PORTLAND

To the INSPECTOR OF BUILDINGS, PORTLAND, ME.

The undersigned hereby applies for a permit to install the following heating, cooking or power equipment in accordance with the Laws of Maine, the Building Code of the City of Portland, and the following specifications:

Location Lot 280 Candlewyck Rd. Use of Building. 2 fam. dwelling No. Stories 1 New Building Existing
Name and address of owner of appliance Minat Corp., 34 Freble St.
Installer's name and address Pallotta Oil Co., 142 Presumpscot St. Telephone

General Description of Work

To install forced hot water heating system and oil burning equipment

IF HEATER, OR POWER BOILER

Location of appliance basement Any burnable material in floor surface or beneath? no
If so, how protected? Kind of fuel? oil
Minimum distance to burnable material, from top of appliance or casing top of furnace 4"
From top of smoke pipe 2' From front of appliance over 4" From sides or back of appliance over 4"
Size of chimney flue 8x8 Other connections to same flue no
If gas fired, how vented? Rated maximum demand per hour
Will sufficient fresh air be supplied to the appliance to insure proper and safe combustion?

IF OIL BURNER

Name and type of burner Del. Ray DB800 WP Labeled by underwriters' laboratories? yes
Will operator be always in attendance? Does oil supply line feed from top or bottom of tank? bottom
Type of floor beneath burner concrete Size of vent pipe 14"
Location of oil storage basement Number and capacity of tanks 275 gal.
Low water shut off Make No.
Will all tanks be more than five feet from any flame? yes How many tanks enclosed?
Total capacity of any existing storage tanks for furnace burners

IF COOKING APPLIANCE

Location of appliance Any burnable material in floor surface or beneath?
If so, how protected? Height of Legs, if any
Skirting at bottom of appliance? Distance to combustible material from top of appliance?
From front of appliance From sides and back From top of smokepipe
Size of chimney flue Other connections to same flue
Is hood to be provided? If so, how vented? Forced or gravity?
If gas fired, how vented? Rated maximum demand per hour

MISCELLANEOUS EQUIPMENT OR SPECIAL INFORMATION

Amount of fee enclosed: 10.00 (~~\$200~~ for one heater, etc., \$1.00 additional for each additional heater, etc., in one building at same time.)

APPROVED: JUL 7 1970
R. C. D.

Will there be in charge of the above work a person competent to see that the State and City requirements pertaining thereto are observed? yes
pallotta Oil Co.

By: J. Pallotta Jr.
Signature of Installer

NOTES

Permit No. 701 761

Location 2500 South Weymouth Rd

Owner Merrill Corp

Date of permit 7/8/71

Approved

3-1-71 Completed
PR

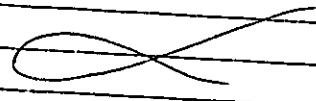

Main body of the document consisting of multiple columns of horizontal lines for notes or data entry.

(COPY)



CITY OF PORTLAND, MAINE
Department of Building Inspection

Certificate of Occupancy

LOCATION **Lot 280 Caradonock Road**

Issued to **The Minat Corporation**

Date of Issue **March 1, 1971**

3/4 Froble St.
This is to certify that the building, premises, or part thereof, at the above location, built—altered—changed as to use under Building Permit No. **70/393**, has had final inspection, has been found to conform substantially to requirements of Zoning Ordinance and Building Code of the City, and is hereby approved for occupancy or use, limited or otherwise, as indicated below.

PORTION OF BUILDING OR PREMISES

APPROVED OCCUPANCY

Entire

Limiting Conditions:

One family dwelling house.

This certificate supersedes
certificate issued

Approved:

(Date)

Inspector

Inspector of Buildings

Notice: This certificate identifies lawful use of building or premises, and ought to be transferred from owner to owner when property changes hands. Copy will be furnished to owner or lessee for one dollar.



R3 RESIDENCE ZONING
APPLICATION FOR PERMIT

Class of Building or Type of Structure
Portland, Maine

March 31-68
April 22 1970

CITY OF PORTLAND

To the INSPECTOR OF BUILDINGS, PORTLAND, MAINE

The undersigned hereby applies for a permit to erect alter repair demolish install the following building structure equipment in accordance with the Laws of the State of Maine, the Building Code and Zoning Ordinance of the City of Portland, plans and specifications, if any, submitted herewith and the following specifications:

Location Lot 280 Candlewick Road Within Fire Limits? _____ Dist. No. _____
 Owner's name and address The Minat Corp. 34 Preble St. Telephone 774-8013
 Lessee's name and address _____ Telephone _____
 Contractor's name and address owners Telephone _____
 Architect _____ Specifications _____ Plans: yes No. of sheets 3
 Proposed use of building Dwelling No. families: 1
 Last use _____ No. families: _____
 Material frame No. stories 2 Heat _____ Style of roof _____ Roofing _____
 Other buildings on same lot _____
 Estimated cost \$ 16,000 Fee \$ 32.00

General Description of New Work

To construct 2-story frame dwelling 34' x 24'

It is understood that this permit does not include installation of heating apparatus which is to be taken out separately by and in name of the heating contractor. PERMIT TO BE ISSUED TO owners

Details of New Work

Any plumbing involved in this work? yes Is any electrical work involved in this work? yes
 Connection to be made to public sewer? yes If not, what is proposed for sewage? _____
 Septic tank notice been sent? _____ Form notice sent? yes
 Front average grade to top of plate 16' Height average grade to highest point of roof 26'
 Front 34' depth 24' No. stories 2 solid or filled land? solid earth or rock? earth
 Material of foundation concrete at least 4' below grade Thickness, top 9" bottom 12" cellar yes
 Material of underpinning _____ Height _____ Thickness _____
 Roof pitch _____ Rise per foot 4" Roof covering Asphalt Class C Und Latel.
 Chimneys 1 Material of chimneys brick of lining tile Kind of heat f.h. w/ fuel oil
 Lumber - Kind hemlock Dressed or full size? dressed
 Posts 4x6 Sills box Girt or ledger board? _____ Size _____
 Joists 8x8 f.s. Size box Columns under girders lally Size 3 1/2" Max. on centers 6'6"
 Outside walls and carrying partitions) 2x4-16" O. C. Bridging in every floor and flat roof span over 8 feet.
 Joists and rafters: 1st floor 2x8, 2nd 2x8, 3rd 2x6-ceiling, timb. roof 2x8
 Spacing: 1st floor 16", 2nd 16", 3rd 24", roof 20"
 Maximum span: 1st floor 12', 2nd 12', 3rd _____, roof 12'
 Building with masonry walls, thickness of walls? _____ height? _____

If a Garage

to be accommodated on same lot _____, to be accommodated _____ number commercial cars to be accommodated _____
 Mobile repairing be done other than minor repairs to cars habitually stored in the proposed building? _____

Miscellaneous

Will work require disturbing of any tree on a public street? no
 Will there be in charge of the above work a person competent to see that the State and City requirements pertaining thereto are observed? yes
 The Minat Corp.

E. B. 4/23/70
4/24/70 E. B.

NOTES

To pour - drop wall
in rear. *RD*

7-1-70 OK to close in
hangers needed on header
rear wall basement *He*

3-15-71 Final all OK
to issue C.O. *RD*

RD

Unit No. 3-20
Location 150
Owner
Date of permit 4/27/70
North Closing-in 1/1/70
East Closing-in
Local Notif. 4/1/71
Local Inspr
Certificate of Occupancy issued 3/1/71
Sliding Out Notice
Form Check Notice 4/27/70

Hangers needed rear
basement sliding doors *RD*

RD

It is noted that all work is complete and ready for final inspection. The contractor has provided all necessary permits and approvals. The work was completed in accordance with the approved plans and specifications. The contractor has provided all necessary documentation for the final inspection. The work was completed in accordance with the approved plans and specifications. The contractor has provided all necessary documentation for the final inspection.

APPLICATION FOR PERMIT

B.O.C.A. USE GROUP
 B.O.C.A. TYPE OF CONSTRUCTION 6.14
 ZONING LOCATION PORTLAND, MAINE

PERMIT ISSUED

JUN 4 1984

To the CHIEF OF BUILDING & INSPECTION SERVICES, PORTLAND, MAINE

The undersigned hereby applies for a permit to erect, alter, repair, demolish, move or install the following building, structure, equipment or change use in accordance with the Laws of the State of Maine, the Portland B.O.C.A. Building Code and Zoning Ordinance of the City of Portland with plans and specifications, if any, submitted herewith and the following specifications:

CITY of PORTLAND

LOCATION 48 Candie way, Portland
 1. Owner's name and address Edward H. Smith Fire District #1 #2
 2. Lessee's name and address Telephone 775 1370
 3. Contractor's name and address owner Telephone
 Proposed use of building Single Family No. of sheets
 Last use No. families
 Material No. stories Heat Style of roof Roofing
 Other buildings on same lot no
 Estimated contractual cost \$ 1500.00
 FIELD INSPECTOR--Mr. CARROLL Appeal Fees \$
 @ 775-5451 Base Fee
 Late Fee
 TOTAL \$ 20.00

To CONSTRUCT A 10x22' CARPORT

Stamp of Special Conditions

NOTE TO APPLICANT: Separate permits are required by the installers and subcontractors of heating, plumbing, electrical and mechanical.

DETAILS OF NEW WORK

Is any plumbing involved in this work? NO Is any electrical work involved in this work? NO
 Is connection to be made to public sewer? NO If not, what is proposed for sewage? NO
 Has septic tank notice been sent? NO Form notice sent? NO
 Height average grade to top of plate 10' Height average grade to highest point of roof 14'
 Size, front 10' depth 22' No. stories 1 solid or filled land? YES earth or rock?
 Material of foundation 10" SOND WITH FOOTING Thickness, top bottom cellar
 Kind of roof Rise per foot Roof covering
 No. of chimneys Material of chimneys of lining Kind of heat fuel
 Framing Lumber—Kind Dressed or full size? Corner posts 1x4 Sills
 Size Girder Columns under girders Size Max. on centers
 Studs (outside walls and carrying partitions) 2x4-16" O. C. Bridging in every floor and flat roof span over 8 feet.
 Joists and rafters: 1st floor 2x8 2nd 3rd roof Plywood 7/8"
 On centers 1st floor 2nd 3rd roof ASJ. batt
 Maximum span. 1st floor 2nd 3rd roof

IF A GARAGE

No. cars now accommodated on same lot, to be accommodated number commercial cars to be accommodated
 Will automobile repairing be done other than minor repairs to cars habitually stored in the proposed building?

APPROVALS BY: DATE
 BUILDING INSPECTION—PLAN EXAMINER
 ZONING:
 BUILDING CODE:
 Fire Dept.:
 Health Dept.:
 Others:

MISCELLANEOUS
 Will work require disturbing of any tree on a public street?
 Will there be in charge of the above work a person competent to see that the State and City requirements pertaining thereto are observed?

Signature of Applicant [Signature] Phone #

Type Name of above
 Other
 and Address

FIELD INSPECTOR'S COPY

APPLICANT'S COPY

OFFICE FILE COPY



APPLICATION FOR PERMIT

PERMIT ISSUED

B.O.C.A. USE GROUP 001234

B.O.C.A. TYPE OF CONSTRUCTION

OCT 25 1985

ZONING LOCATION PORTLAND, MAINE

City Of Portland

To the CHIEF OF BUILDING & INSPECTION SERVICES, PORTLAND, MAINE

The undersigned hereby applies for a permit to erect, alter, repair, demolish, move or use all the following building, structure, equipment or change use in accordance with the Laws of the State of Maine, the Portland B.O.C.A. Building Code and Zoning Ordinance of the City of Portland with plans and specifications, if any, submitted herewith and the following specifications:

LOCATION 46 Candlewick Rd. Portland, Me. Fire District #1 , #2

1. Owner's name and address Phil Rotolo Telephone 7724862..

2. Lessee's name and address Telephone 7841388..

3. Contractor's name and address American Concrete Ind. Telephone 7841388..
1022 Minot Ave. Auburn, Maine 04210

Proposed use of building dwelling No. of sheets
Last use No. families

Material No. stories Heat Style of roof Roofing

Other buildings on same lot

Estimated contractual cost \$ 59.00 Appeal Fees \$ 25.00

FIELD INSPECTOR—Mr. @ 775-5451 Base Fee
Late Fee

Shawnee Step Front Breezeway XX 3 Riser TOTAL \$

Stamp of Special Conditions

NOTE TO APPLICANT: Separate permits are required by the installers and subcontractors of heating, plumbing, electrical and mechanicals.

DETAILS OF NEW WORK

Is any plumbing involved in this work? Is any electrical work involved in this work?

Is connection to be made to public sewer? If not, what is proposed for sewage?

Has septic tank notice been sent? Form notice sent?

Height average grade to top of plate Height average grade to highest point of roof

Size, front depth No. stories solid or filled land? earth or rock?

Material of foundation Thickness, top bottom cellar

Kind of roof Rise per foot Roof covering

No. of chimneys Material of chimneys of lining Kind of heat fuel

Framing Lumber—Kind Dressed or full size? Corner posts Sills

Size Girder Columns under girders Size Max. on centers

Studs (outside walls and carrying partitions) 2x4-16" O. C. Bridging in every floor and flat roof span over 8 feet.

Joists and rafters: 1st floor 2nd 3rd roof

On centers: 1st floor 2nd 3rd roof

Maximum span: 1st floor 2nd 3rd roof

If one story building with masonry walls, thickness of walls? height?

IF A GARAGE

No. cars now accommodated on same lot, to be accommodated number commercial cars to be accommodated

Will automobile repairing be done other than minor repairs to cars habitually stored in the proposed building?

APPROVALS BY: DATE

BUILDING INSPECTION—PLAN EXAMINER

ZONING:

BUILDING CODE:

Fire Dept.:

Health Dept.:

Others:

MISCELLANEOUS

Will work require disturbing of any tree on a public street?

Will there be in charge of the above work a person competent to see that the State and City requirements pertaining thereto are observed?

Signature of Applicant Lucille E. Hawley Phone # 7841388

Type Name of above Lucille E. Hawley 1 2 3 4

Other
and Address

FIELD INSPECTOR'S COPY

APPLICANT'S COPY

OFFICE FILE COPY

APPLICATION FOR PERMIT

B.O.C.A. USE GROUP 001234
B.O.C.A. TYPE OF CONSTRUCTION
ZONING LOCATION PORTLAND, MAINE

PERMIT ISSUED
OCT 25 1985
City of Portland

To the CHIEF OF BUILDING & INSPECTION SERVICES, PORTLAND, MAINE

The undersigned hereby applies for a permit to erect, alter, repair, demolish, move or install the following building, structure, equipment or change use in accordance with the Laws of the State of Maine, the Portland B.O.C.A. Building Code and Zoning Ordinance of the City of Portland with plans and specifications, if any, submitted herewith and the following specifications:

LOCATION 46 Candlewyck Rd. Portland, Me. Fire District #1 [], #2 []
1. Owner's name and address Phil. Rotolo Telephone 7724862
2. Lessee's name and address Telephone
3. Contractor's name and address American Concrete Ind. Telephone 7841388
1022 Minot Ave. Auburn, Maine 04210
Proposed use of building dwelling No. of sheets
Last use No. families
Material No. stories Heat Style of roof Roofing
Other buildings on same lot
Estimated contractual cost \$ 459.00 Appeal Fees \$ 25.00
FIELD INSPECTOR-Mr. @ 775-5451 Base Fee
Late Fee
TOTAL \$
Shawnee Step, Front Breezeway XX 3 Riser

Stamp of Special Conditions

NOTE TO APPLICANT: Separate permits are required by the installers and subcontractors of heating, plumbing, electrical and mechanicals.

DETAILS OF NEW WORK

Is any plumbing involved in this work? Is any electrical work involved in this work?
Is connection to be made to public sewer? If not, what is proposed for sewage?
Has septic tank notice been sent? Form notice sent?
Height average grade to top of plate Height average grade to highest point of roof
Size, front depth No. stories solid or filled land? earth or rock?
Material of foundation Thickness, top bottom cellar
Kind of roof Rise per foot Roof covering
No. of chimneys Material of chim of lining Kind of heat fuel
Framing Lumber-Kind Dressed or finished? Corner posts Sills
Size Girder Columns under girders Size Max. on centers
Studs (outside walls and carrying partitions) 2x4-16" O. C. Bridging in every floor and flat roof span over 8 feet.
Joists and rafters: 1st floor 2nd 3rd roof
On centers: 1st floor 2nd 3rd roof
Maximum span: 1st floor 2nd 3rd roof
If one story building with masonry walls, thickness of walls? height?

IF A GARAGE

No. cars now accommodated on same lot to be accommodated number commercial cars to be accommodated
Will automobile repairing be done other than minor repairs to cars habitually stored in the proposed building?

APPROVALS BY: DATE
BUILDING INSPECTION-PLAN EXAMINER
ZONING:
BUILDING CODE:
Fire Dept.:
Health Dept.:
Others:

MISCELLANEOUS

Will work require disturbing of any tree on a public street?
Will there be in charge of the above work a person competent to see that the State and City requirements pertaining thereto are observed?

Signature of Applicant Lucille E. Hawley Phone # 7841388
Type Name of above Lucille E. Hawley 1 [] 2 [] 3 [] 4 []
Other and Address

FIELD INSPECTOR'S COPY APPLICANT'S COPY OFFICE FILE COPY

[Signature] M. Carroll

Permit No. 8574237

Location 1234 Main St. City

Owner John Doe

Date of permit 10-25-85

Approved [Signature]

Dwelling [Signature]

Garage [Signature]

Alteration [Signature]

NOTES

Large ruled area for notes, divided into two columns by a vertical line.

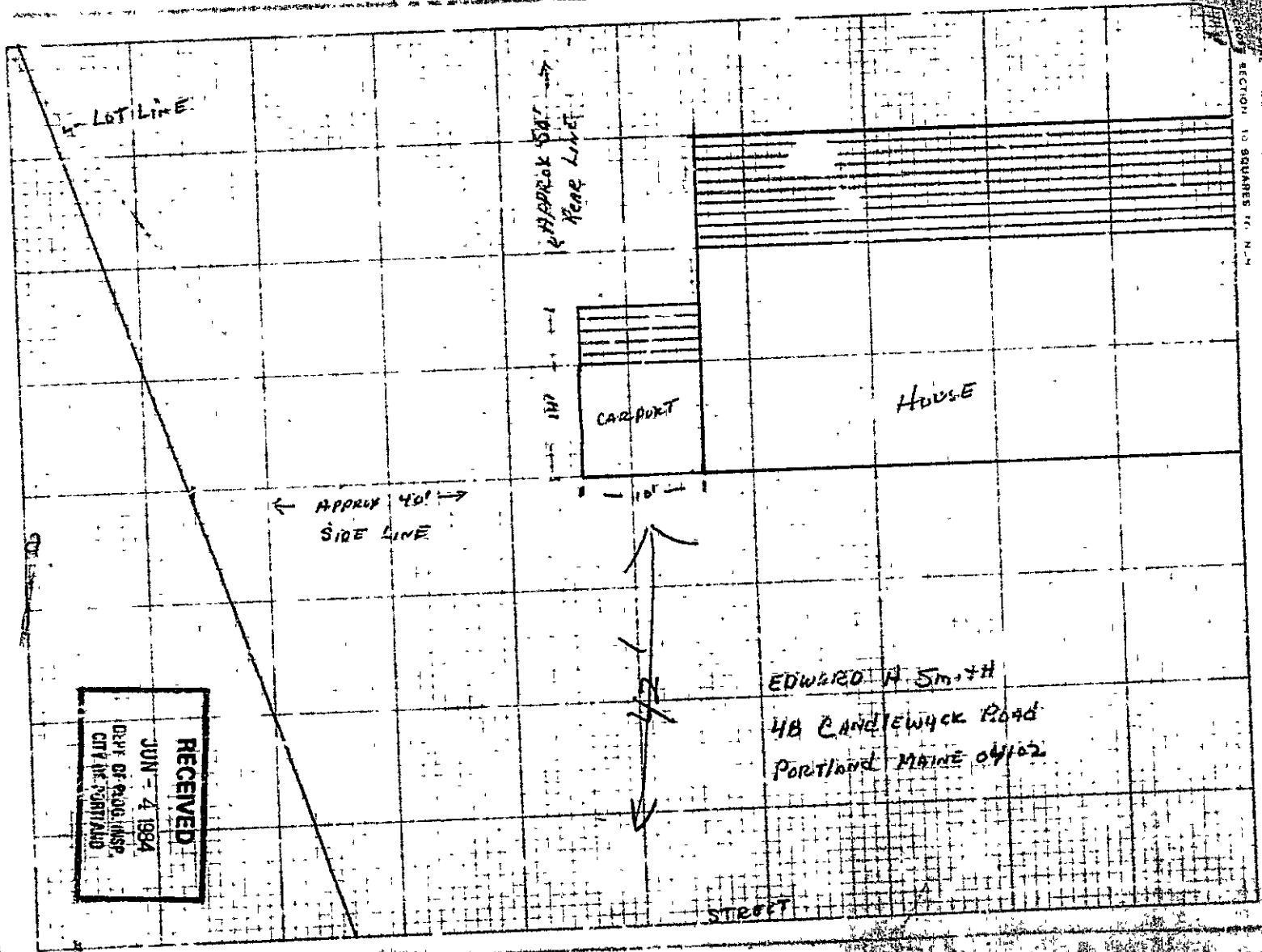

SECTION 13 SQUARES 11, N. 11

RECEIVED
 JUN - 7 1994
 DEPT. OF REG. & DISP.
 CITY OF PORTLAND

EDWARD A. SMITH
 48 CANDLEWICK ROAD
 PORTLAND MAINE 04102

STREET

THE SHEET LINE IS 810
THIS SECTION IS SQUARES TO INCH

EDWARD H. STATH
46 Grandway St. Road
Portland Maine 04102

FRONT

10' 0" 10' 0"

END

RECEIVED
JUN - 4 1984
DEPT. OF BLDG. INSP.
CITY OF PORTLAND

APPLICATION FOR PERMIT

PERMIT ISSUED

B.O.C.A. USE GROUP 614

B.O.C.A. TYPE OF CONSTRUCTION 614

JUN 4 1984

ZONING LOCATION R-3 PORTLAND, MAINE

CITY OF PORTLAND

To the CHIEF OF BUILDING & INSPECTION SERVICES, PORTLAND, MAINE

The undersigned hereby applies for a permit to erect, alter, repair, demolish, move or install the following building, structure, equipment or change use in accordance with the Laws of the State of Maine, the Portland B.O.C.A. Building Code and Zoning Ordinance of the City of Portland with plans and specifications, if any, submitted herewith and the following specifications:

LOCATION 48 Candlewick Rd Fire District #1 #2

1. Owner's name and address Edward H. Smith Telephone 775-1370

2. Lessee's name and address

3. Contractor's name and address OWNER Telephone

..... No. of sheets

Proposed use of building Single Family No. families

..... No families

Material No. stories Heat Style of roof Roofing

Other buildings on same lot NO

Estimated contractual cost \$1,500.00

FIELD INSPECTOR—Mr. CARROLL

@ 775-5451

To CONSTRUCT A 10'x22' CARPORT

TOTAL \$ 20.00

Stamp of Special Conditions

NOTE TO APPLICANT: Separate permits are required by the installers and subcontractors of heating, plumbing, electrical and mechanicals.

DETAILS OF NEW WORK

Is any plumbing involved in this work? NO Is any electrical work involved in this work? NO

Is connection to be made to public sewer? NO If not, what is proposed for sewage? NO

Has septic tank notice been sent? NO Form notice sent? NO

Height average grade to top of plate 10' Height average grade to highest point of roof 14'

Size, front 10' depth 22' No. stories 1 solid or filled land? YES earth or rock?

Material of foundation 10" SAND Thickness, top FOOTING bottom

Kind of roof Rise per foot Roof covering

No. of chimneys Material of chimneys of lining Kind of heat fuel

Framing Lumber—Kind Dressed or full size? Corner posts 4x4 Sills

Size Girder Columns under girders Size Max. on centers

Studs (outside walls and carrying partitions) 2x4-15" O. C. Bridging in every floor and flat roof span over 8 feet.

Joists and rafters. 1st floor 2x8 2nd 3rd roof plywood 5/8"

On center. 1st floor 2nd 3rd roof 175j. mlt

Maximum span: 1st floor 2nd 3rd roof

If one story building with masonry walls, thickness of walls? height?

IF A GARAGE

No. cars now accommodated on same lot to be accommodated number commercial cars to be accommodated

Will automobile repairing be done other than minor repairs to cars habitually stored in the proposed building?

APPROVALS BY: DATE MISCELLANEOUS

BUILDING INSPECTION—PLAN EXAMINER Will work require disturbing of any tree on a public street?

ZONING: W.H. Madala 6/1/84 Will there be in charge of the above work a person competent to see that the State and City requirements pertaining thereto are observed?

BUILDING CODE:

Fire Dept:

Health Dept:

Others:

Signature of Applicant Edward H. Smith Phone #

Type Name of above 1 2 3 4

Other and Address

FIELD INSPECTOR'S COPY APPLICANT'S COPY OFFICE FILE COPY

MR. CARROLL

Permit No. 84/614

060024

Owner

W. Campbell & Co. Ltd.
Edinburgh

Site of permit

Approved

6-11-64

Dwelling

Garage

Alteration

Garage

NOTES

~~Notes section with horizontal lines and a large handwritten X.~~