

002165

Permit # _____ City of Portland BUILDING PERMIT APPLICATION Fee 25. Zone _____ Map # _____ Lot# _____
Please fill out any part which applies to job. Proper plans must accompany form.

Owner Richard Stilphen Phone # _____
Address: 16 Aspen Dr; Ptld, ME 04102

LOCATION OF CONSTRUCTION: 16 Aspen Dr;
City: Northern Propane Sub: NR 603 325-2052

Address: 425 West Rd; Portsmouth NH
Est. Construction Cost: _____ Proposed Use: 1-fam w tank

Past Use: 1-fam
of Existing Res. Units _____ # of New Res. Units _____
Building Dimensions L _____ W _____ Total Sq. Ft. _____

Stories: _____ # Bedrooms _____ Lot Size: _____
Is Proposed Use: Seasonal _____ Condominium _____ Conversion _____

Explain Conversion Install propane tank - 100 gallons

MAIL PERMIT John L. Dorsch
Foundation: _____

- 1. Type of Soil: RFD 8, Box 174 G
- 2. Set Backs - Front _____ Rear _____ Side(s) _____
- 3. Footings Size: Concord, NH 03301
- 4. Foundation Size: _____
- 5. Other _____

- Floor:
- 1. Sills Size: _____ Sills must be anchored.
 - 2. Girder Size: _____
 - 3. Lelly Column Spacing: _____ Size: _____
 - 4. Joists Size: _____ Spacing 16" O.C.
 - 5. Bridging Type: _____ Size: _____
 - 6. Floor Sheathing Type: _____ Size: _____
 - 7. Other Material: _____

- Exterior Walls:
- 1. Studding Size _____ Spacing _____
 - 2. No. windows _____
 - 3. No. Doors _____
 - 4. Header Sizes _____ Spnn(s) _____
 - 5. Bracing: Yes _____ No _____
 - 6. Corner Posts Size _____
 - 7. Insulation Type _____
 - 8. Sheathing Type _____ Size _____
 - 9. Siding Type _____
 - 10. Masonry Materials _____ Weather Exposure _____
 - 11. Metal Materials _____

- Interior Walls:
- 1. Studding Size _____ Spacing _____
 - 2. Header Sizes _____ Spnn(s) _____
 - 3. Wall Covering Type _____
 - 4. Fire Wall if required _____
 - 5. Other Materials _____

For Official Use Only PERMIT ISSUED

Date 11/20/90 Subdivision: _____
 Inside Fire Limits _____ Name _____
 Bldg Code _____ Lot NOV 20 1990
 Time Limit _____ Ownership: _____
 Estimated Cost _____ City of Portland

Zoning: R-3
 Street Frontage Provided: _____
 Provided Setbacks: Front _____ Back _____ Side _____
 Review Required: _____
 Zoning Board Approval: Yes _____ No _____ Date: _____
 Planning Board Approval: Yes _____ No _____ Date: _____
 Conditional Use: _____ Variance _____ Site Plan _____ Subdivision _____
 Shoreland Zoning Yes _____ No _____ Floodplain Yes _____ No _____
 Special Exception _____
 Other (Explain) OR W/D 11-26-90

- Ceiling:
- 1. Ceiling Joists Size: _____
 - 2. Ceiling Strapping Size _____ Spacing _____
 - 3. Type Ceilings: _____
 - 4. Insulation Type _____ Size _____
 - 5. Ceiling Height: _____

- Roof:
- 1. Truss or Rafter Size _____ Span _____ Action: _____
 - 2. Sheathing Type _____ Size _____
 - 3. Roof Covering Type _____

- Chimneys:
- Type: _____ Number of Fire Places _____

- Heating:
- Type of Heat: _____

- Electrical:
- Service Entrance Size: _____ Smoke Detector Required Yes _____ No _____

- Plumbing:
- 1. Approval of soil test if required Yes _____ No _____
 - 2. No. of Tubs or Showers _____
 - 3. No. of Flushes _____
 - 4. No. of Lavatories _____
 - 5. No. of Other Fixtures _____

- Swimming Pools:
- 1. Type: _____
 - 2. Pool Size: _____ x _____ Square Footage _____
 - 3. Must conform to National Electrical Code and State Law.

Permit Received By Louise E. Chase
 Signature of Applicant _____ Date 11-20-90
 Signature of CEO _____
 Inspection Dates _____

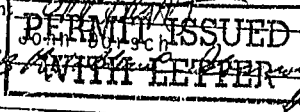

CITY OF PORTLAND, MAINE
ZONING BOARD OF APPEALS



THOMAS F. JEWELL
Chairman

September 4, 1991

RE: 16 Aspen Drive

Mr. Richard Stilphen
16 Aspen Drive
Portland, Maine 04102

Dear Mr. Stilphen:

Receipt of your application for a variance appeal regarding the side setback of your property, is acknowledged.

This appeal will be scheduled for review before the Board of Appeals on Thursday evening, September 26, 1991, at 7 P.M. in Room 209, City Hall, Portland, Maine. We hope that you will plan to attend to answer any questions which the Board members may have concerning this appeal.

We will send you a copy of the September 26th agenda as soon as copies become available for distribution.

Sincerely,

William D. Giroux
Zoning Administrator

/el

cc: Thomas F. Jewell, Chairman, Board of Appeals
Joseph E. Gray, Jr., Director of Planning and Urban Development
P. Samuel Hoffses, Chief of Inspection Services
Charles A. Lane, Associate Corporation Counsel
Kevin Carroll, Code Enforcement Officer

902165

Permit # _____ City of Portland BUILDING PERMIT APPLICATION Fee 25 Zone _____ Map # _____ Lot# _____

Please fill out any part which applies to job. Proper plans must accompany form.

Owner: Richard Stilphen Phone # _____
 Address: 16 Aspen Dr; Ptd, ME 04102
 LOCATION OF CONSTRUCTION: 16 Aspen Dr.
 Contractor: Northern Propane Sub: 88 603 325-2052
 Address: 425 West 2nd; Portsmouth NH
 Est. Construction Cost: _____ Proposed Use: 1 gas tank
 Past Use: 1 gas
 # of Existing Res. Units: _____ # of New Res. Units: _____
 Building Dimensions L _____ W _____ Total Sq. Ft. _____
 # Stories: _____ # Bedrooms: _____ Lot Size: _____
 Is Proposed Use: Seasonal _____ Condominium _____ Conversion _____
 Explain Conversion: Install propane tank - 110 gallons

For Official Use Only

Date: 11/29/80 Subdivision: _____
 Inside Fire Limits: _____
 Bldg Code: _____
 Time Limit: _____
 Estimated Cost: _____
 Ownership: _____
PERMIT ISSUED
 NOV 28 1980

City of Portland

Zoning: R-3
 Street Frontage Provided: _____
 Provided Setbacks: Front _____ Back _____ Side _____
 Review Required:
 Zoning Board Approval: Yes _____ No _____ Date: _____
 Planning Board Approval: Yes _____ No _____ Date: _____
 Conditional Use: _____ Variance _____ Site Plan _____ Subdivision _____
 Shoreland Zoning: Yes _____ No _____ Floodplain: Yes _____ No _____
 Special Exception _____
 Other (Explain): on WPAH - 11-26-80

MAIL PERMIT: John L. Dorsch
 Foundation:
 1. Type of Soil: RFD 3, Box 174 G
 2. Set Backs - Front _____ Rear _____ Side(s) _____
 3. Footings Size: Concord, NH 03301
 4. Foundation Size: _____
 5. Other: _____

Coiling:
 1. Ceiling Joists Size: _____
 2. Ceiling Strapping Size _____ Spacing _____
 3. Type Ceilings: _____
 4. Insulation Type _____ Size _____
 5. Ceiling Height: _____

Floor:
 1. Sills Size: _____ Sills must be anchored.
 2. Girder Size: _____
 3. Lally Column Spacing: _____ Size: _____
 4. Joists Size: _____ Spacing 16" O.C.
 5. Bridging Type: _____ Size: _____
 6. Floor Sheathing Type: _____ Size: _____
 7. Other Material: _____

Roof:
 1. Truss or Rafter Size _____ Span _____
 2. Sheathing Type _____ Size _____
 3. Roof Covering Type _____
 Action: _____ Approved _____
 Approved with Condition _____
 Denied _____

Exterior Walls:
 1. Studding Size _____ Spacing _____
 2. No. windows _____
 3. No. Doors _____
 4. Header Sizes _____ Span(s) _____
 5. Bracing: Yes _____ No _____
 6. Corner Posts Size _____
 7. Insulation Type _____ Size _____
 8. Sheathing Type _____ Size _____
 9. Siding Type _____ Weather Exposure _____
 10. Masonry Materials _____
 11. Metal Materials _____

Chimneys:
 Type: _____ Number of Fire Places _____ Date: _____
 Heating:
 Type of Heat: _____
 Electrical:
 Service Entrance Size: _____ Smoke Detector Required Yes _____ No _____

Interior Walls:
 1. Studding Size _____ Spacing _____
 2. Header Sizes _____ Span(s) _____
 3. Wall Covering Type _____
 4. Fire Wall if required _____
 5. Other Materials _____

Plumbing:
 1. Approval of soil test if required: Yes _____ No _____
 2. No. of Tubs or Showers _____
 3. No. of Flushes _____
 4. No. of Lavatories _____
 5. No. of Other Fixtures _____
 Swimming Pools:
 1. Type: _____
 2. Pool Size: _____ x _____ Square Footage _____
 3. Must conform to National Electrical Code and State Law

Permit Received By: Louise E. Chase
 Signature of Applicant: [Signature] Date: 11/29/80
 Signature of CEO: [Signature] Date: 11-26-80
 Inspection Dates: _____

PLOT PLAN

11/91 - Installed at driveway. Needs barricades. Fella out



FEES (Breakdown From Front)

Base Fee \$ 25
Subdivision Fee \$ _____
Site Plan Review Fee \$ _____
Other Fees \$ _____
(Explain) _____
Late Fee \$ _____

Type	Inspection Record	Date
_____	_____	____/____/____
_____	_____	____/____/____
_____	_____	____/____/____
_____	_____	____/____/____
_____	_____	____/____/____

COMMENTS

Signature of Applicant

[Handwritten Signature]

Date

11-20-90

BUILDING PERMIT REPORT

DATE: 11-26-90

ADDRESS: 16 Aspen Drive

REASON FOR PERMIT: 1-125 gal? 700 gal? ABOVE GROUND L/P TANKS

BUILDING OWNER: Richard St. John

CONTRACTOR: Northern Pipe & Fittings Co. Portland, ME

PERMIT APPLICANT: John Dersch

APPROVED: XDC ~~-DENIED-~~

CONDITION OF APPROVAL OR DENIAL:

- 1.) All above ground L/P storage tanks shall be located in accordance with NFPA #58 standards.
- 2.) Any tank located near the path of vehicle movement shall be protected with appropriate permanent barricades.
- 3.) All piping shall be protected from possible mechanical damage and vandalism.

Bay State / Northern Propane

ACCOUNT # 10-3190 REPRESENTATIVE [Signature] DATE PROMISE _____
 NAME RICHARD STEPHEN TELEPHONE _____
 DELIVERY ADDRESS 16 ASPEN DR
 TOWN POITZMAN STATE MAINE POLE # _____

EQUIPMENT	CONVERSION YES OR NO	BTU's	NUMBER OF TANKS:	POLE #
<u>1225</u>	<u>—</u>	<u>35000</u>	<u>1</u>	SIZE: <u>125 @ 1/2"</u>
			NUMBER OF REGULATORS: <u>1</u>	TYPE: <u>R-922-21</u>
			NUMBER OF MEN: <u>2</u>	EST. HOURS: <u>2</u>
			NUMBER OF METERS: <u>—</u>	SIZE: <u>—</u>
SQUARE FOOT. OF BUILDING:	TOTAL:	LENGTH OF PIPING: <u>15'</u>	TRAILER ACCESSIBLE: YES/NO	SIZE: <u>1/2" COPPER</u>
<u>1400</u>	<u>35000</u>	EST. INST. COST \$ <u>744.7</u>	PERMIT FEE \$	GAS RATE: \$
		MATERIALS		

INSTRUCTIONS SET 125 IN SIDE NEXT TO DRIVEWAY BETWEEN WINDOWS - MAINTAIN 3' E
WAY - RUN TRAILING ACROSS UP TO INT (ALSO INSTALL HTR) CO. SALE & OPERATION

IDENTIFY IN DETAIL, DIRECTIONS TO LOCATION WITH A MAP

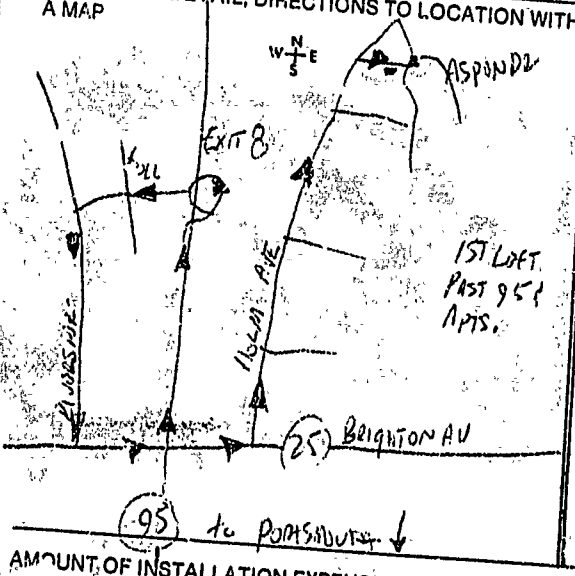
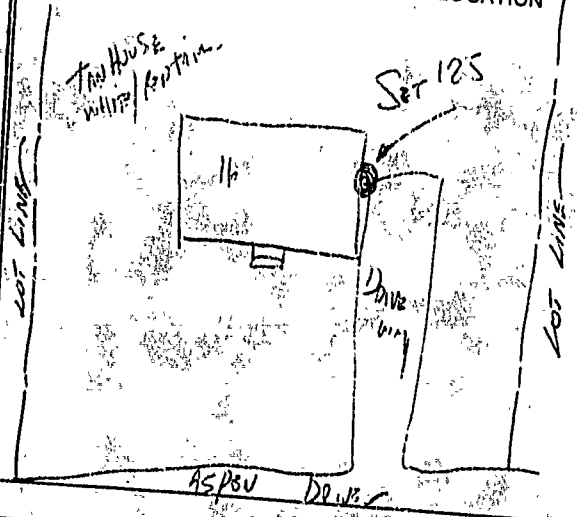

DIAGRAM OF HOUSE OR BUILDING AND DRIVEWAY, FROM STREET - BE SURE TO SHOW TANK LOCATION



AMOUNT OF INSTALLATION EXPENSE RECOUPED: \$ _____
 VIA: GALLONS/MINIMUM/RENTAL OR OTHER _____

LENGTH OF AGREEMENT 3 months/years

MANAGER'S APPROVAL _____ DATE _____

* SUBMIT WITH SELECTIVE PRICING SHEET

WHITE - SERVICE MAN'S COPY YELLOW - OFFICE COPY PINK - SALESMAN'S COPY



CITY OF PORTLAND, MAINE

389 CONGRESS STREET
PORTLAND, MAINE 04101
(207) 874-8300

DEPARTMENT OF PLANNING & URBAN DEVELOPMENT

P. SAMUEL HOFFSES, CHIEF
INSPECTION SERVICES DIVISION

February 12, 1991.

Mr. Richard Stilphen
16 Aspen Drive
Portland, ME 04102

RE: Propane tank installation - Permit No. 90-2165

Dear Mr. Stilphen:

Inspection was made recently of the propane tank installed at
16 Aspen Drive.

One of the requirements concerning installation of such a tank
near a driveway is that it be barricaded for your safety.

Please provide some sort of permanent barricade to protect
against possible damage.

Sincerely,

Kathleen A. Lowe
Code Enforcement Officer

Enclosure

cc: P. Samuel Hoffses, Chief of Inspection Services