

10

### APPLICATION FOR PERMIT

B.O.C.A. USE GROUP .....  
B.O.C.A. TYPE OF CONSTRUCTION ..... 6.6.7 .....  
ZONING LOCATION ..... PORTLAND, MAINE June 12, 1984 .....

**PERMIT ISSUED**  
JUN 14 1984  
CITY OF PORTLAND

To the CHIEF OF BUILDING & INSPECTION SERVICES, PORTLAND, MAINE

The undersigned hereby applies for a permit to erect, alter, repair, demolish, move or install the following building, structure, equipment or change use in accordance with the Laws of the State of Maine, the Portland B.O.C.A. Building Code and Zoning Ordinance of the City of Portland with plans and specifications, if any, submitted herewith and the following specifications:

LOCATION .... 103 Birney Drive  
1. Owner's name and address ... Paul Vinay - same ..... Fire District #1 , #2  Telephone 772-7107  
2. Lessee's name and address ..... Telephone .....  
3. Contractor's name and address ... Falmouth Foundation - (foundation) ..... Telephone 727-2852  
John Sterling  
Proposed use of building ..... No. of sheets .....  
Last use ..... No. families .....  
Material ..... No. stories ..... Heat ..... Style of roof ..... Roofing .....  
Other buildings on same lot .....  
Estimated contractual cost \$ 3,499.00

FIELD INSPECTOR—Mr. .... Appeal Fees \$ .....  
@ 77-5451 ..... Base Fee .....  
Late Fee .....  
TOTAL \$ 25.00

To construct attached 1-CAR GARAGE, 25' x 16', in rear of existing dwelling, as per plan. Existing deck taken down so foundation could be poured. Will be put back to exact specifications.

Stamp of Special Conditions

ISSUE PERMIT TO #1

**NOTE TO APPLICANT:** Separate permits are required by the installers and subcontractors of heating, plumbing, electrical and mechanicals.

#### DETAILS OF NEW WORK

Is any plumbing involved in this work? ..... Is any electrical work involved in this work? .....  
Is connection to be made to public sewer? ..... If not, what is proposed for sewage? .....  
Has septic tank notice been sent? ..... Form notice sent? .....  
Height average grade to top of plate ..... Height average grade to highest point of roof .....  
Size, front ..... depth ..... No. stories ..... solid or filled land? ..... earth or rock? .....  
Material of foundation ..... Thickness, top ..... bottom ..... cellar .....  
Kind of roof ..... Rise per foot ..... Roof covering .....  
No. of chimneys ..... Material of chimneys ..... of lining ..... Kind of heat ..... fuel .....  
Framing Lumber—Kind ..... Dressed or full size? ..... Corner posts ..... Sills .....  
Size Girder ..... Columns under girders ..... Size ..... Max. on centers .....  
Studs (outside walls and carrying partitions) 2x4-16" O. C. Bridging in every floor and flat roof span over 8 feet.  
Joists and rafters: 1st floor ..... 2nd ..... 3rd ..... roof .....  
On centers: 1st floor ..... 2nd ..... 3rd ..... roof .....  
Maximum span: 1st floor ..... 2nd ..... 3rd ..... roof .....  
If one story building with masonry walls, thickness of walls? ..... height? .....

#### IF A GARAGE

No. cars now accommodated on same lot ..... to be accommodated ..... number commercial cars to be accommodated .....  
Will automobile repairing be done other than minor repairs to cars habitually stored in the proposed building? .....

**APPROVALS BY:** DATE MISCELLANEOUS  
BUILDING INSPECTION—PLAN EXAMINER ..... Will work require disturbing of any tree on a public street? <sup>no</sup> .....  
ZONING: .....  
BUILDING CODE: ..... Will there be in charge of the above work a person competent to see that the State and City requirements pertaining thereto are observed? <sup>yes</sup> .....  
Fire Dept.: .....  
Health Dept.: .....  
Others: .....

Signature of Applicant ..... Phone # .....  
Type Name of above Paul Vinay .....  
2 ..... Other .....  
and Address .....

FIELD INSPECTOR'S COPY

APPLICANT'S COPY

OFFICE FILE COPY

APPLICATION FOR PERMIT

PERMIT ISSUED

B.O.C.A. USE GROUP .....

B.O.C.A. TYPE OF CONSTRUCTION ..... 667

ZONING LOCATION ... R-3 ... PORTLAND, MAINE June 12, 1984.

JUN 14 1984

CITY of PORTLAND

To the CHIEF OF BUILDING & INSPECTION SERVICES, PORTLAND, MAINE

The undersigned hereby applies for a permit to erect, alter, repair, demolish, move or install the following building, structure, equipment or change use in accordance with the Laws of the State of Maine, the Portland B.O.C.A. Building Code and Zoning Ordinance of the City of Portland with plans and specifications, if any, submitted herewith and the following specifications:

LOCATION ... 103 Birchvale Drive ... 61107

1. Owner's name and address ... Paul Viney - same ... Fire District #1 , #2

2. Lessee's name and address ... Telephone 772-7107 - Home

3. Contractor's name and address ... Falmouth Foundation - (foundation) ... Telephone 774-4561 - Bus

John Sterling ... Telephone 797-2852

Proposed use of building ... No. of sheets ...

Last use ... No. families ...

Material ... No. stories ... Heat ... Style of roof ... Roofing ...

Other buildings on same lot ...

Estimated contractual cost \$ ~~XXXXXX~~ 3,499.00

FIELD INSPECTOR - Mr. Carroll ... Appeal Fees \$ ...

@ 775-5451 ... Base Fee ...

To construct attached 1-CAR GARAGE, 25' x 16', in rear ... Late Fee ...

of existing dwelling, as per plan. Existing deck taken ... TOTAL \$ 25.00

down so foundation could be poured. Will be put back ... Stamp of Special Conditions

to exact specifications.

ISSUE PERMIT TO #1

NOTE TO APPLICANT: Separate permits are required by the installers and subcontractors of heating, plumbing, electrical and mechanicals.

DETAILS OF NEW WORK

Is any plumbing involved in this work? ... Is any electrical work involved in this work? ...

Is connection to be made to public sewer? ... If not, what is proposed for sewage? ...

Has septic tank notice been sent? ... Form notice sent? ...

Height average grade to top of plate ... Height average grade to highest point of roof ...

Size, front ... depth ... No. stories ... solid or filled land? ... earth or rock? ...

Material of foundation ... Thickness, top ... bottom ... cellar ...

Kind of roof ... Rise per foot ... Roof covering ...

No. of chimneys ... Material of chimneys ... of lining ... Kind of heat ... fuel ...

Framing Lumber—Kind ... Dressed or full size? ... Corner posts ...

Size Girder ... Columns under girders ... Size ... Max. on centers ...

Studs (outside walls and carrying partitions) 2x4-16" O. C. Bridging in every floor and flat roof span over 8 feet.

Joists and rafters: 1st floor ... 2nd ... 3rd ... roof ...

On centers: 1st floor ... 2nd ... 3rd ... roof ...

Maximum span: 1st floor ... 2nd ... 3rd ... roof ...

If one story building with masonry walls, thickness of walls? ... height? ...

IF A GARAGE

No. cars now accommodated on same lot ... to be accommodated ... number commercial cars to be accommodated ...

Will auto mobile repairing be done other than minor repairs to cars habitually stored in the proposed building? ...

APPROVALS BY: BUILDING INSPECTION - PLAN EXAMINER DATE

ZONING: R-3 ... 6/13/84

BUILDING CODE: ...

Fire Dept.: ...

Health Dept.: ...

Others: ...

MISCELLANEOUS

Will work require disturbing of any tree on a public street? NO

Will there be in charge of the above work a person competent to see that the State and City requirements pertaining thereto are observed? yes

Signature of Applicant Paul Viney Phone #

Type Name of above Paul Viney

Other and Address

FIELD INSPECTOR'S COPY APPLICANT'S COPY OFFICE FILE COPY

Mr. Carroll

Permit No. 841667

Location 103 Byngham Drive

Owner [Signature]

Date of permit 6-12-89

Approved 6-14-89

Dwelling

Garage 1 car attached

Alteration

NOTES

Large ruled area for notes, divided into two columns by a vertical line. A large 'X' is drawn across the top portion of the left column.

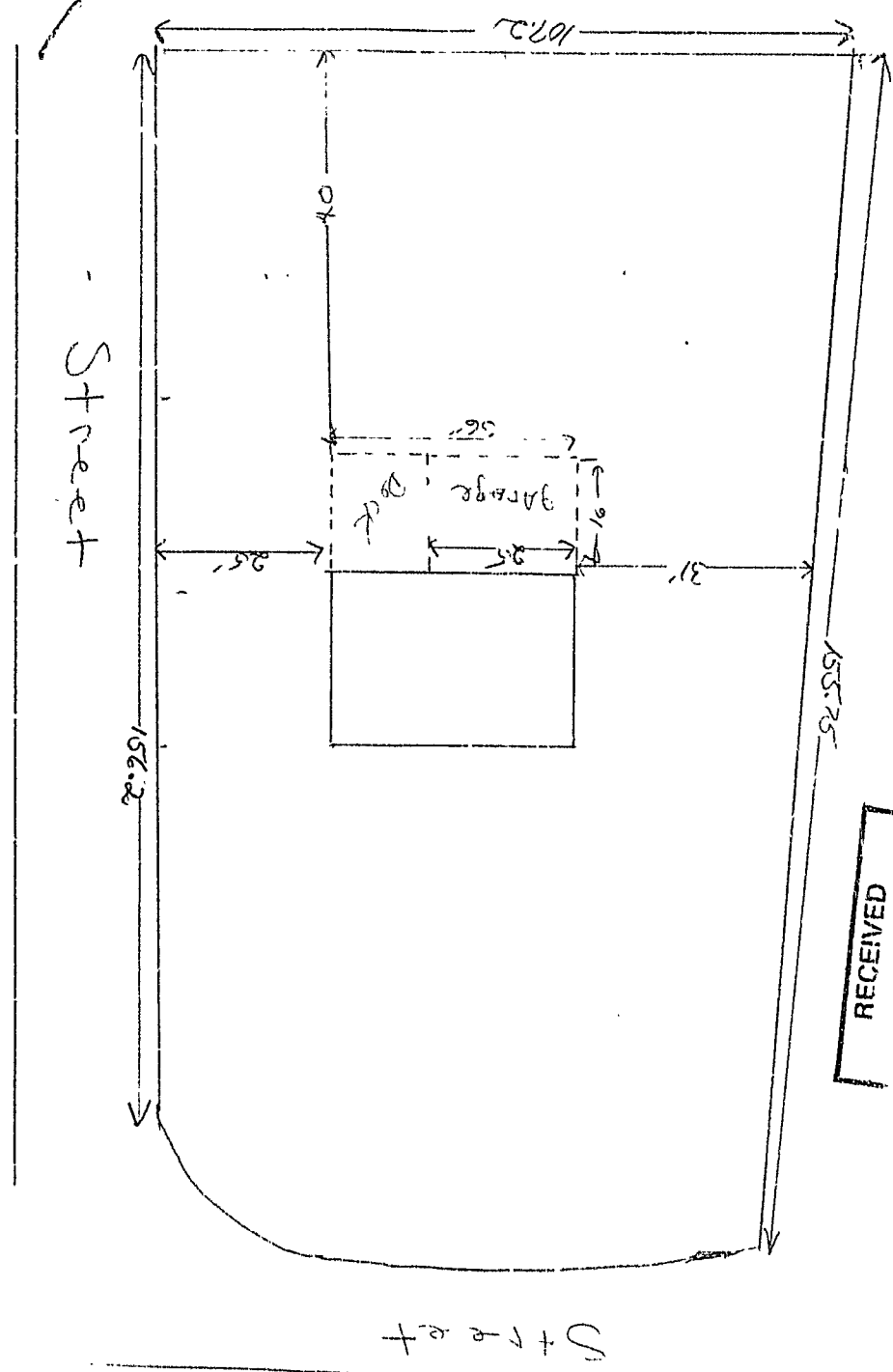

RECEIVED  
 JUN 12 1984  
 as per



**APPLICATION FOR PERMIT**  
**DEPARTMENT OF BUILDING INSPECTIONS SERVICES**  
**ELECTRICAL INSTALLATIONS**

Date June 29, 19 87  
 Receipt and Permit number D 10836

To the CHIEF ELECTRICAL INSPECTOR, Portland, Maine:  
 The undersigned hereby applies for a permit to make electrical installations in accordance with the laws of  
 Maine, the Portland Electrical Ordinance, the National Electrical Code and the following specifications:

LOCATION OF WORK: 103 Birchvale Drive  
 OWNER'S NAME: Paul Viney ADDRESS: same

OUTLETS:	FEES
Receptacles _____ Switches _____ Plugmold _____ ft. TOTAL <u>1</u> .....	3.00
FIXTURES: (number of)	
Incandescent _____ Fluorescent _____ (not strip) TOTAL _____	
Strip Fluorescent _____ ft. ....	
SERVICES:	
Overhead _____ Underground _____ Temporary _____ TOTAL amperes _____	
METERS: (number of) _____	
MOTORS: (number of)	
Fractional _____	
1 HP or over _____	
RESIDENTIAL HEATING:	
Oil or Gas (number of units) _____	
Electric (number of rooms) _____	
COMMERCIAL OR INDUSTRIAL HEATING:	
Oil or Gas (by a main boiler) _____	
Oil or Gas (by separate units) _____	
Electric Under 20 kws _____ Over 20 kws _____	
APPLIANCES: (number of)	
Ranges _____	Water Heaters _____
Cook Tops _____	Disposals _____
Wall Ovens _____	Dishwashers _____
Dryers _____	Compactors _____
Fans _____	Others (denote) _____
TOTAL _____	
MISCELLANEOUS: (number of)	
Branch Panels _____	
Transformers _____	
Air Conditioners Central Unit _____	
Separate Units (windows) _____	
Signs 20 sq. ft. and under _____	
Over 20 sq. ft. _____	
Swimming Pools Above Ground _____	
In Ground _____	
Fire/Burglar Alarms Residential _____	
Commercial _____	
Heavy Duty Outlets, 220 Volt (such as welders) 30 amps and under _____	
over 30 amps _____	
Circus Fairs, etc. _____	
Alterations to wires _____	
Repairs after fire _____	
Emergency Lights, battery _____	
Emergency Generators _____	

INSTALLATION FEE DUE: \_\_\_\_\_  
 FOR ADDITIONAL WORK NOT ON ORIGINAL PERMIT ..... DOUBLE FEE DUE: \_\_\_\_\_  
 FOR REMOVAL OF A "STOP ORDER" (304-16.b) .....  
 TOTAL AMOUNT DUE: 5.00 min

INSPECTION:  
 Will be ready on now, 1987; or Will Call \_\_\_\_\_  
 CONTRACTOR'S NAME: Paul Viney  
 ADDRESS: 103 Birchvale Drive  
 TEL.: 772-7107  
 MASTER LICENSE NO.: \_\_\_\_\_  
 LIMITED LICENSE NO.: \_\_\_\_\_

SIGNATURE OF CONTRACTOR:

INSPECTOR'S COPY — WHITE  
 OFFICE COPY — CANARY  
 CONTRACTOR'S COPY — GREEN



