

APPLICATION FOR PERMIT

PERMIT

B.O.C.A. USE GROUP

B.O.C.A. TYPE OF CONSTRUCTION

MAY 18 1986

ZONING LOCATION PORTLAND, MAINE May 12, 1986

City Of Portland

To the CHIEF OF BUILDING & INSPECTION SERVICES, PORTLAND MAINE

The undersigned hereby applies for a permit to erect, alter, repair, demolish, move or install the following building, structure, equipment or change use in accordance with the Laws of the State of Maine, the Portland B.O.C.A. Building Code and Zoning Ordinance of the City of Portland with plans and specifications, if any, submitted herewith and the following specifications:

LOCATION 13 Campbell Road, Portland, Maine Fire District #1 #2
1. Owner's name and address Francis X Downey, Carroll St. Falmouth, Me Telephone 781-6332
2. Lessee's name and address
3. Contractor's name and address C. Paul LaBrecque Telephone 797-6305
Proposed use of building Office building No. of sheets
Last use Same No. families
Material No. stories Heat Style of roof Roofing
Other buildings on same lot
Estimated contractual cost \$ 16,000

FIELD INSPECTOR—Mr. @ 775-5451
Appeal Fees \$
Base Fee
Late Fee
TOTAL \$ 100.00

To construct an attached 26' X 30' garage on slab w/footing to store car wash equipment, packaged motor oil, misc. items. As per plan. for car wash.

Stamp of Special Conditions

NOTE TO APPLICANT: Separate permits are required by the installers and subcontractors of heating, plumbing, electrical and mechanicals.

DETAILS OF NEW WORK

Is any plumbing involved in this work? Is any electrical work involved in this work?
Is connection to be made to public sewer? If not, what is proposed for sewage?
Has septic tank notice been sent? Form notice sent?
Height average grade to top of plate Approx 8ft Height average grade to highest point of roof 15 ft
Size, front depth No. stories solid or filled land? solid earth or rock
Material of foundation concrete Thickness, top bottom cellar
Kind of roof Truss Rise per foot Roof covering asphalt
No. of chimneys Material of chimneys of lining Kind of heat fuel
Framing Lumber—Kind Dressed or full size? Corner posts Sills
Size Girder Columns under girders Size Max. on centers
Studs (outside walls and carrying partitions) 2x4-16" O. C. Bridging in every floor and flat roof span over 8 feet.
Joists and rafters: 1st floor, 2nd, 3rd, roof
On centers 1st floor, 2nd, 3rd, roof
Maximum span: 1st floor, 2nd, 3rd, roof
If one story building with masonry walls, thickness of walls? height?

IF A GARAGE

How many cars now accommodated on same lot? to be accommodated? number commercial cars to be accommodated?
Will automobile repairing be done other than minor repairs to cars habitually stored in the proposed building?

APPROVALS BY DATE MISCELLANEOUS
BUILDING INSPECTION—PLAN EXAMINER Will work require disturbing of any tree on a public street?
ZONING Will there be in charge of the above work a person competent to see that the State and City requirements pertaining thereto are observed?
Fire Dept.
Health Dept.
Others

Signature of Applicant Francis Downey (J. Pevarada) Phone #
Type Name of above 1 2 3 4

Other and Address

FIELD INSPECTOR'S COPY APPLICANT'S COPY OFFICE FILE COPY



APPLICATION FOR PERMIT

PERMIT ISSUED
NOV 7 1986
City Of Portland

B.O.C.A. USE GROUP
B.O.C.A. TYPE OF CONSTRUCTION 001622
ZONING LOCATION PORTLAND, MAINE .. Nov. 5, 1986

To the CHIEF OF BUILDING & INSPECTION SERVICES, PORTLAND, MAINE

The undersigned hereby applies for a permit to erect, alter, repair, demolish, move or install the following building, structure, equipment or change use in accordance with the Laws of the State of Maine, the Portland B.O.C.A. Building Code and Zoning Ordinance of the City of Portland with plans and specifications, if any, submitted herewith and the following specifications:

LOCATION ... 13 Campbell St Fire District #1 #2
1. Owner's name and address .. Fill It Up Please .. name Telephone
2. Lessee's name and address Telephone
3. Contractor's name and address .. Suburban Propane Gas .. Thompson .. Pt .. Telephone .. 774-0387 ..
..... Portland No. of sheets
Proposed use of building .. warehouse & office No. families
Last use No. families
Material No. stories Heat Style of roof Roofing
Other buildings on same lot
Estimated contractual cost \$.....

FIELD INSPECTOR—Mr.
@ 775-5451
Appeal Fees \$
Base Fee ... 25.00...
Late Fee
TOTAL \$

To set 2 100 gal propane gas tanks to be used for heat as per plans. 1 sheet of plans.

Stamp of Special Conditions

send permit to # 3 04102

NOTE TO APPLICANT: Separate permits are required by the installers and subcontractors of heating, plumbing, electrical and mechanicals

DETAILS OF NEW WORK

Is any plumbing involved in this work? Is any electrical work involved in this work?
Is connection to be made to public sewer? If not, what is proposed for sewage?
Has septic tank notice been sent? Form notice sent?
Height average grade to top of plate Height average grade to highest point of roof
Size, front depth No. stories solid or filled land? earth or rock?
Material of foundation Thickness, top bottom cellar
Kind of roof Rise per foot Roof covering
No. of chimneys Material of chimneys of lining Kind of heat fuel
Framing Lumber—Kind Dressed or full size? Corner posts Sills
Size Girder Columns under girders Size Max. on centers
Studs (outside walls and carrying partitions) 2x4-16" O. C. Bridging in every floor and flat roof span over 8 feet.
Joists and rafters: 1st floor 2nd 3rd roof
On centers: 1st floor 2nd 3rd roof
Maximum span: 1st floor 2nd 3rd roof
If one story building with masonry walls, thickness of walls? height?

IF A GARAGE

No. cars now accommodated on same lot to be accommodated number commercial cars to be accommodated
Will automobile repairing be done other than minor repairs to cars habitually stored in the proposed building?

APPROVALS BY: DATE MISCELLANEOUS
BUILDING INSPECTION—PLAN EXAMINER Will work require disturbing of any tree on a public street?
ZONING:
BUILDING CODE: Will there be in charge of the above work a person competent to see that the State and City requirements pertaining thereto are observed?
Fire Dept.:
Health Dept.:
Others:

Signature of Applicant Phone # .. same
Type Name of above Dwight Smith for 1 2 3 4
Suburban Propane Gas Co
Other
and Address

FIELD INSPECTOR'S COPY APPLICANT'S COPY OFFICE FILE COPY

SUBSURFACE WASTEWATER DISPOSAL SYSTEM APPLICATION

Department of Human Services
Division of Health Engineering
(207) 289-3328

PROPERTY ADDRESS:
Town Or Plantation: Portland
Street Subdivision Lot #: 13 Campbell St
PROPERTY OWNERS NAME:
Last: F. Elshup Please
Applicant Name: Lee Nelson & Sons
Mailing Address of Owner/Applicant (if Different): P.O. Box 1028 Westbrook

PORTLAND PERMIT # 2,584 TOWN COPY
Date Issued: 10/27/87 \$ 20 Fee Charged
Lee Nelson Local Plumbing Inspector Signature
L.P.I. # _____

Owner/Applicant Statement
I certify that the information submitted is correct to the best of my knowledge and understand that any falsification is reason for the Local Plumbing Inspector to deny a Permit.

Caution: Inspection Required
I have inspected the installation authorized above and found it to be in compliance with the Subsurface Wastewater Disposal Rules.
OCT 27 1987
Local Plumbing Inspector Signature _____ Date Approved _____

PERMIT INFORMATION

<p>THIS APPLICATION IS FOR:</p> <p><input type="checkbox"/> NEW SYSTEM OCT 27 1987</p> <p><input type="checkbox"/> REPLACEMENT SYSTEM</p> <p><input type="checkbox"/> EXPANDED SYSTEM</p> <p><input type="checkbox"/> SEASONAL CONVERSION</p> <p><input type="checkbox"/> EXPERIMENTAL SYSTEM</p>	<p>THIS APPLICATION REQUIRES:</p> <p><input type="checkbox"/> NO RULE VARIANCE REQUIRED</p> <p><input type="checkbox"/> NEW SYSTEM VARIANCE Attach New System Variance Form</p> <p><input type="checkbox"/> REPLACEMENT SYSTEM VARIANCE Attach Replacement System Variance Form</p> <p><input type="checkbox"/> Requires by Local Plumbing Inspector Approval</p> <p><input type="checkbox"/> Requires both State and Local Plumbing Inspector Approval</p>	<p>INSTALLATION IS COMPLETE SYSTEM:</p> <p><input type="checkbox"/> NON-ENGINEERED SYSTEM</p> <p><input type="checkbox"/> PRIMITIVE SYSTEM (Includes Alternative Toilet)</p> <p><input type="checkbox"/> ENGINEERED (+2000 gpd)</p> <p>INDIVIDUALLY INSTALLED COMPONENTS:</p> <p><input type="checkbox"/> TREATMENT TANK (ONLY)</p> <p><input type="checkbox"/> HOLDING TANK</p> <p><input type="checkbox"/> ALTERNATIVE TOILET (ONLY)</p> <p><input type="checkbox"/> NON-ENGINEERED DISPOSAL AREA (ONLY)</p> <p><input type="checkbox"/> ENGINEERED DISPOSAL AREA (ONLY)</p> <p><input type="checkbox"/> SEPARATED LAUNDRY SYSTEM</p>
<p>IF REPLACEMENT SYSTEM: YEAR FAILING SYSTEM INSTALLED _____</p> <p>THE FAILING SYSTEM IS:</p> <p><input type="checkbox"/> BED <input type="checkbox"/> TRENCH</p> <p><input type="checkbox"/> CHAMBER <input type="checkbox"/> OTHER _____</p>	<p>DISPOSAL SYSTEM TO SERVE:</p> <p><input type="checkbox"/> SINGLE FAMILY DWELLING</p> <p><input type="checkbox"/> MODULAR OR MOBILE HOME</p> <p><input type="checkbox"/> MULTIPLE FAMILY DWELLING</p> <p><input type="checkbox"/> OTHER _____ SPECIFY _____</p>	<p>TYPE OF WATER SUPPLY</p>
<p>SIZE OF PROPERTY _____ ZONING _____</p>	<p>DESIGN DETAILS (SYSTEM LAYOUT SHOWN ON PAGE 3)</p>	

<p>TREATMENT TANK</p> <p><input type="checkbox"/> SEPTIC: <input type="checkbox"/> Regular <input type="checkbox"/> Low Profile</p> <p><input type="checkbox"/> AEROBIC</p> <p>SIZE: _____ GALS.</p>	<p>WATER CONSERVATION</p> <p><input type="checkbox"/> NONE</p> <p><input type="checkbox"/> LOW VOLUME TOILET</p> <p><input type="checkbox"/> SEPARATED LAUNDRY SYSTEM</p> <p><input type="checkbox"/> ALTERNATIVE TOILET</p> <p>SPECIFY: _____</p>	<p>PUMPING</p> <p><input type="checkbox"/> NOT REQUIRED</p> <p><input type="checkbox"/> MAY BE REQUIRED (DEPENDENT ON TREATMENT TANK, LOCATION AND ELEVATION)</p> <p><input type="checkbox"/> REQUIRED</p> <p>DOSE: _____ GALS</p>	<p>CRITERIA USED FOR DESIGN FLOW (BEDROOMS, SEATING, EMPLOYEES, WATER RECORDS, ETC.)</p>
<p>SOIL CONDITIONS USED FOR DESIGN PURPOSES</p> <p>PROFILE _____ CONDITION _____</p> <p>DEPTH TO LIMITING FACTOR _____</p>	<p>SIZE RATINGS USED FOR DESIGN PURPOSES</p> <p><input type="checkbox"/> SMALL</p> <p><input type="checkbox"/> MEDIUM</p> <p><input type="checkbox"/> MEDIUM-LARGE</p> <p><input type="checkbox"/> LARGE</p> <p><input type="checkbox"/> EXTRA LARGE</p>	<p>DISPOSAL AREA TYPE/SIZE</p> <p><input type="checkbox"/> BED _____ Sq. Ft.</p> <p><input type="checkbox"/> CHAMBER _____ Sq. Ft.</p> <p><input type="checkbox"/> REGULAR <input type="checkbox"/> H-TO</p> <p><input type="checkbox"/> TRENCH _____ Linear Ft.</p> <p><input type="checkbox"/> OTHER: _____</p>	<p>DESIGN FLOW: _____ (GALLONS/DAY)</p>

SITE EVALUATOR STATEMENT (SITE EVALUATION WAIVED BY LOCAL OPTION)

On _____ (date) I conducted a site evaluation for this project and certify that the data reported is accurate. The system I propose is in accordance with the Subsurface Wastewater Disposal Rules.

Site Evaluator or Professional Engineer's Signature _____ SE# / PE# _____ Date _____

Local Plumbing Inspector's Signature if a Local Site Evaluation Waiver under a Local Option _____

Page 1 of 3
HHE-200 Rev 4/83

TOWN COPY

SUBURBAN PROPANE
THOMPSONS POINT
PORTLAND, MAINE 04102
TEL. 774-0387

Application to INSTALL
2 100 gal propane
STORAGE TANKS

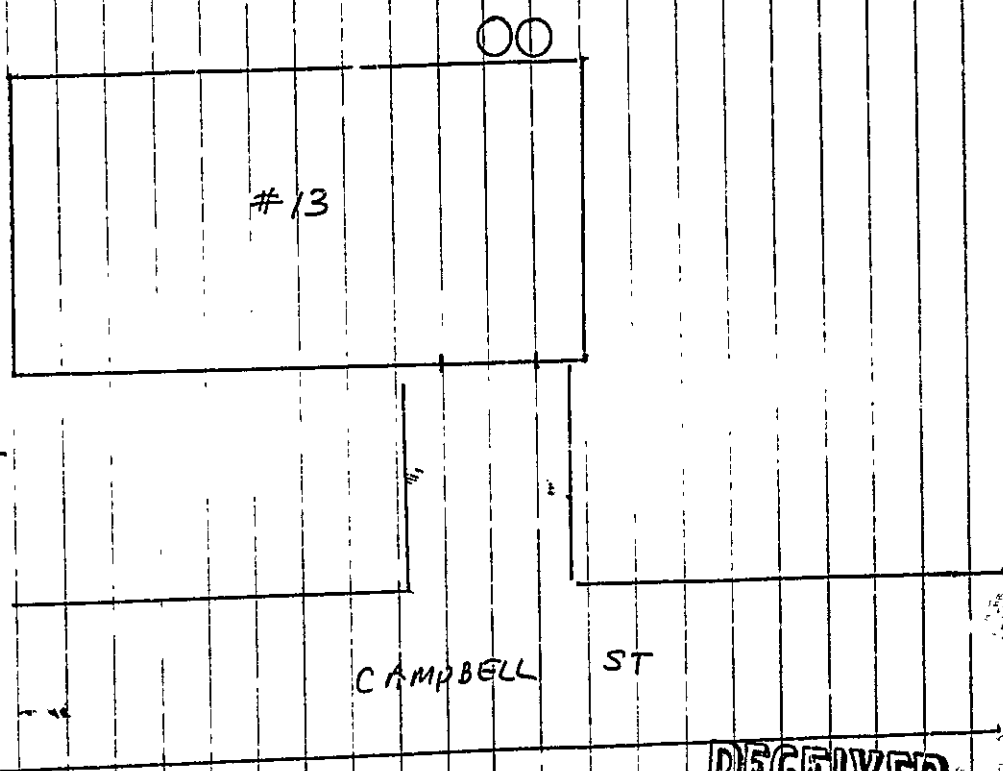

FILL IT UP PLEASE
13 CAMPBELL ST
PORTLAND ME

FRANK DOWNEY
781-4439

RECEIVED
NOV - 5 1986
DEPT OF BUILDING INSPECTIONS
CITY OF PORTLAND

APPLICATION FOR PERMIT

PERMIT ISSUED

B.O.C.A. USE GROUP

B.O.C.A. TYPE OF CONSTRUCTION

001622

NOV 7 1986

ZONING LOCATION

PORTLAND, MAINE

Nov 5, 1986

City of Portland

To the CHIEF OF BUILDING & INSPECTION SERVICES, PORTLAND, MAINE

The undersigned hereby applies for a permit to erect, alter, repair, demolish, move or install the following building, structure, equipment or change use in accordance with the laws of the State of Maine, the Portland B.O.C.A. Building Code and Zoning Ordinance of the City of Portland with plans and Specifications, if any, submitted herewith and the following specifications.

LOCATION 13 Campbell St.

1. Owner's name and address Fill It Up Please - same

Fire District #1 #2

2. Lessee's name and address

Telephone ..

3. Contractor's name and address Suburban Propane Gas - Thompson Pt Portland

Telephone .. 774-0387

Proposed use of building warehouse & office

No. of sheets

Tag use

No. families ..

Material No. stories Heat State of roof

No. families ..

Other buildings on same lot

Roofing ..

Estimated contractual cost \$

Appeal Fees \$

FIELD INSPECTOR Mr

Base Fee 25.00

Late Fee

To set 2 100 gal propane gas tanks to be used for heat as per plans. 1 sheet of plans.

TOTAL \$

Stamp of Special Conditions

send permit to # 3 04102

NOTE TO APPLICANT Separate permits are required for the installers and subcontractors of heating, plumbing and mechanical.

DETAILS OF NEW WORK

Is any plumbing involved in this work?

Is any electrical work involved in this work?

Is connection to be made to public sewer?

If so, what is proposed for sewage?

Has septic tank notice been sent?

Form notice sent?

Height average grade to top of plate

Height average grade to highest point of roof

Size front depth

solid or filled land? earth or rock?

Material of foundation

No. stories

Thickness top bottom .. cellar

Kind of roof

Rise per foot

Roof covering ..

No. of chimneys

Material of chimneys

of lining

Kind of heat

Framing Lumber Kind

Dressed or full size?

Corner posts

Sills ..

Size Girder

Columns under girders

Size

Max. on centers ..

Studs (outside walls and carrying partitions) 2x4 16' O.C. Bridge

in every floor and flat roof spar over 8 feet

Joists and rafters

1st floor

2nd

3rd

roof

On centers

1st floor

2nd

3rd

roof

Maximum span

1st floor

2nd

3rd

roof

One story building with masonry walls, thickness of walls?

height?

IF A GARAGE

No. cars now accommodated on same lot .. to be accommodated .. number commercial cars to be accommodated

Will automobile repairing be done other than minor repairs to cars habitually stored in the proposed building?

APPROVALS BY

DATE

MISCELLANEOUS

BUILDING INSPECTION - PLAN EXAMINER

Will work require disturbing of any tree on a public street?

ZONING

BUILDING CODE

Will there be in charge of the above work a person competent to see that the State and City requirements pertaining thereto are observed?

Fire Dept.

Health Dept.

Others

Signature of Applicant

Dwight Smith

Phone # .. same ..

Type Name of above

Dwight Smith for

Suburban Propane Gas Co.

Other

and Address

MR. CARROLL FIELD INSPECTOR'S COPY

APPLICANT'S COPY

OFFICE FILE COPY

43 Carroll St.
Falmouth, ME 04105
May 20, 1986

Office of the Building Inspector
City Hall
389 Congress St.
Portland, ME 04101

Gentlemen:

The following is the additional information that you requested in connection with my application to construct a garage addition to the existing office building at 13 Campbell Rd.

1) The framing will be of two by fours, 16" on center. The framing around the overhead door will be two by twelve with a 5/8" plywood core. The framing for the side door will be two by six with a 5/8" plywood core.

2) The roof trusses will be a pre-manufactured type by Wood Products of Biddeford and will be located 2' on center. The roof pitch will be 5/12" and the live load rating according to the manufacturer will be 50 lbs. per square foot.

3) The fire wall against the present building, in accordance with Lt. Collins instructions, will be framed with two by fours, again 16" on center with both sides of the wall sided with 5/8" fire-rated sheet rock which will afford a one hour rating. The door and the door frame that will be part of this wall, will also have a one hour fire rating and will be so stamped.

Should you require any additional information, I can be reached at 781-4439. My mailing address is 43 Carroll St., Falmouth, Maine 04105.

Very truly yours,

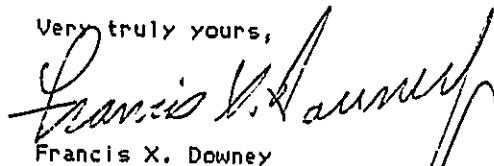

Francis X. Downey

FXD/1ej

APPLICATION FOR PERMIT

B.O.C.A. USE GROUP
 B.O.C.A. TYPE OF CONSTRUCTION 610
 ZONING LOCATION B-2 PORTLAND, MAINE May 13, 1986..

MAY 13 1986
 City of Portland

To the CHIEF OF BUILDING & INSPECTION SERVICES, PORTLAND MAINE

The undersigned hereby applies for a permit to repair, demolish, move or install the following building, structure, equipment or change use in accordance with the laws of the State of Maine, the Portland B.O.C.A Building Code and Zoning Ordinance of the City of Portland with plans and specifications, if any, submitted herewith and the following specifications:

LOCATION . . . 13 Campbell Road, Portland, Maine Fire District #1 , #2
 1. Owner's name and address Francis X. Downey, Carroll St., Falmouth, Me Telephone . 781-4332 . . .
 2. Lessee's name and address Telephone
 3. Contractor's name and address C. Paul LaBrecque Telephone . 797-6305 . . .
 . . . Brook Rd. West Falmouth, Maine No. of sheets
 Proposed use of building . . . Office building No. families
 Last use . . . Same No. families
 Material No. stories Heat Style of roof Roofing
 Other buildings on same lot
 Estimated contractual cost \$. 16,000

FIELD INSPECTOR—Mr. Appeal Fees \$
 @ 775-5451 Base Fee
 Lat. Fee
 TOTAL \$. 100.00

To construct an attached 26' X 30' garage w/ slab w/footing to store car wash equipment, packaged motor oil, misc. items. As per plan. for car wash.

Send Plan #1

Stamp of Special Conditions

NOTE TO APPLICANT: Separate permits are required by the installers and subcontractors of heating, plumbing, electrical and mechanicals.

DETAILS OF NEW WORK

Is any plumbing involved in this work? . . . No Is any electrical work involved in this work? . . . Yes
 Is connection to be made to public sewer? If not, what is proposed for sewage?
 Has septic tank notice been sent? Form notice sent?
 Height average grade to top of plate . . . Approx. 8ft. . . . Height average grade to highest point of roof 15 Ft.
 Size, front depth No. stories solid or filled land? . . solid . . . earth or rock earth
 Material of foundation . . . concrete Thickness, top 8" . . . bottom pillar
 Kind of roof . . . Truss Rise per foot Roof covering . . . asphalt
 No. of chimneys Material of chimneys of lining Kind of heat fuel
 Framing Lumber—Kind Dressed or full size? dressed Corner posts 4X6 Sills 2X6
 Size Girder Columns under girders Size Max on centers
 Studs (outside walls and carrying partitions) 2x4-16" O. C. Bridging in every floor and flat roof span over 8 feet.
 Joists and rafters: 1st floor 2nd 3rd roof
 On centers: 1st floor 2nd 3rd roof
 Maximum span. 1st floor 2nd 3rd roof
 If one story building with masonry walls, thickness of walls? height?

IF A GARAGE

No. cars now accommodated on same lot n/a to be accommodated n/a number commercial cars to be accommodated n/a.
 Will automobile repairing be done other than minor repairs to cars habitually stored in the proposed building?

APPROVALS BY: DATE
 BUILDING INSPECTION—PLAN EXAMINER
 ZONING D. K.
 BUILDING CODE:
 Fire Dept. James
 Health Dept. John
 Others:

MISCELLANEOUS
 Will work require disturbing of any tree on a public street? . . . No
 Will there be in charge of the above work a person competent to see that the State and City requirements pertaining thereto are observed? . . . Yes

Signature of Applicant Francis X. Downey by J. Peverada Phone
 Type Name of above . . . Francis Downey . . . (J. Peverada) . . . 1 2 3 4
 Other
 and Address

FIELD INSPECTOR'S COPY
 APPLICANT'S COPY
 OFFICE FILE COPY
2 John Connell

NOTES

Permit No.

86/577

Location

13 Campbell Rd

Owner

Francis Deung

Date of permit

5/13/86

Approved

5/1

Dwelling

on site attached

Garage

26' x 50' garage on

Alteration

specifications for

garage

Large blank lined area for notes, divided into two columns.



APPLICATION FOR PERMIT
DEPARTMENT OF BUILDING INSPECTIONS SERVICES
ELECTRICAL INSTALLATIONS

Date November 18, 1986
 Receipt and Permit number D 09705

To the CHIEF ELECTRICAL INSPECTOR, Portland, Maine:

The undersigned hereby applies for a permit to make electrical installations in accordance with the laws of Maine, the Portland Electrical Ordinance, the National Electrical Code and the following specifications.

LOCATION OF WORK: 13 Campbell Rd.
 OWNER'S NAME Fili-It-Up Please ADDRESS Same

	FEES
OUTLETS	
Receptacles _____ Switches _____ Plugmold _____ ft. TOTAL <u>30</u>	3.00
FIXTURES (number of)	
Incandescent _____ Fluorescent _____ (not strip) TOTAL _____	
Strip Fluorescent <u>32</u> ft _____	3.00
SERVICES	
Overhead _____ Underground _____ Temporary _____ TOTAL amperes _____	
METERS : (number of) _____	
MOTORS (number of)	
Fractional _____	
1 HP or over _____	
RESIDENTIAL HEATING	
Oil or Gas (number of units) _____	
Electric (number of rooms) _____	
COMMERCIAL OR INDUSTRIAL HEATING	
Oil or Gas (by a main boiler) _____	
Oil or Gas (by separate units) _____	
Electric Under 20 kws _____ Over 20 kws _____	
APPLIANCES (number of)	
Ranges _____	Water Heaters _____
Cook Tops _____	Disposals _____
Wall Ovens _____	Dishwashers _____
Dryers _____	Compactors _____
Fans _____	Others (denote) _____
TOTAL	
MISCELLANEOUS (number of)	
Branch Panels _____	
Transformers _____	
Air Conditioners Central Unit _____	
Separate Units (windows) _____	
Sq. ft. 20 sq ft and under _____	
Over 20 sq ft _____	
Swimming Pools Above Ground _____	
In. Gr. and _____	
Fire/Burglar Alarm Residential _____	
Commercial _____	
Heavy Duty Outlets, 220 Volt (such as _____)	
30 amps and under _____	
over 30 amps _____	
Circus, Fairs, etc _____	
Alterations to wires _____	
Repairs after fire _____	
Emergency Lights, battery _____	
Emergency Generators _____	
	INSTALLATION FEE DUE _____
	DOUBLE FEE DUE _____
FOR ADDITIONAL WORK NOT ON ORIGINAL PERMIT	
FOR REMOVAL OF A "STOP ORDER" (304-16 b)	
	TOTAL AMOUNT DUE <u>6 00</u>

INSPECTION

Will be ready on _____, 1986; or Will Call 11/19/86
 CONTRACTOR'S NAME Wilson Elec.
 ADDRESS 66 Alba St. Portland
 TEL 773-1981
 MASTER LICENSE NO 03413 SIGNATURE OF CONTRACTOR Jean M. Wilson
 LIMITED LICENSE NO _____

INSPECTOR'S COPY — WHITE
 OFFICE COPY — CANARY
 CONTRACTOR'S COPY — GREEN

ELECTRICAL INSTALLATIONS -

Permit Number 09509

Location 13 Alvinfield St

Owner Willie Lee Brown

Date of Permit 10/15/88

Final Inspection See Perm # 24412

By Inspector D. D. [Signature]

Permit Application Register Page No 126

INSPECTIONS: Service _____ by _____

Service called in _____

Closing-in _____ by _____

PROGRESS INSPECTIONS. _____ / _____ / _____

_____ / _____ / _____

_____ / _____ / _____

_____ / _____ / _____

_____ / _____ / _____

DATE

REMARKS

8/8/88

See Perm # 24412 for inspection
no call for final inspection



APPLICATION FOR PERMIT
DEPARTMENT OF BUILDING INSPECTIONS SERVICES
ELECTRICAL INSTALLATIONS

Date Oct. 15, 19 86
 Receipt and Permit number D09509

To the CHIEF ELECTRICAL INSPECTOR, Portland, Maine:

The undersigned hereby applies for a permit to make electrical installations in accordance with the laws of Maine, the Portland Electrical Ordinance, the National Electrical Code and the following specifications:

LOCATION OF WORK: 13 Campbell St.
 OWNER'S NAME: "Fill It Up Please" ADDRESS: Box 703, Portland

OUTLETS: _____ FEES _____

Receptacles _____ Switches _____ Plugmold _____ ft. TOTAL _____

Permit D24412 Paid for 16 incandescent, should be _____

Incandescent _____ Fluorescent 8 (not strip) TOTAL 8 3.40 fluorescent

Strip fluorescent _____ ft. _____

SERVICES: - Permit D24412 Paid for 100 Amp. service, should be 200 amp.

Overhead _____ Underground _____ Temporary _____ TOTAL amperes _____

METERS: (number of) _____

MOTORS: (number of) _____

Fractional _____

1 HP or over _____

RESIDENTIAL HEATING: _____

Oil or Gas (number of units) _____

Electric (number of rooms) _____

COMMERCIAL OR INDUSTRIAL HEATING: _____

Oil or Gas (by a main boiler) _____

Oil or Gas (by separate units) _____

Electric Under 20 kws _____ Over 20 kws _____

APPLIANCES: (number of) _____

Ranges _____ Water Heaters _____

Cook Tops _____ Disposals _____

Wall Ovens _____ Dishwashers _____

Dryers _____ Compactors _____

Fans _____ Others (denote) _____

TOTAL _____

MISCELLANEOUS: (number of) _____

Branch Panels 1 1.00

Transformers _____

Air Conditioners Central Unit _____

Separate Units (windows) _____

Signs 20 sq. ft. and under _____

Over 20 sq. ft. _____

Swimming Pools Above Ground _____

In Ground _____

Fire/Burglar Alarms Residential _____

Commercial _____

Heavy Duty Outlets, 220 Volt (such as welders) 30 amps and under _____

over 30 amps _____

Circuits, Fairs, etc. _____

Alterations to wires _____

Repairs after fire _____

Emergency Lights, battery _____

Emergency Generators _____

FOR ADDITIONAL WORK NOT ON ORIGINAL PERMIT _____ INSTALLATION FEE DUE: _____
 FOR REMOVAL OF A "STOP ORDER" (304-16 b) _____ DOUBLE FEE DUE: _____

TOTAL AMOUNT DUE: \$ 5.00

INSPECTION. _____ M.W.

Will be ready on _____, 19__; or Will Call x

CONTRACTOR'S NAME: Wilson Electric

ADDRESS: 66 Alba St.

TEL.: 773-1981

MASTER LICENSE NO.: 03413

LIMITED LICENSE NO.: _____

SIGNATURE OF CONTRACTOR
Jean M. Wilson

INSPECTOR'S COPY — WHITE
 OFFICE COPY — CANARY
 CONTRACTOR'S COPY — GREEN

ELECTRICAL INSTALLATIONS -

Permit Number 24412

Location 13 Campbell St

Owner Fill It up Please

Date of Permit 8/15/86

Final Inspection Jim P. Puccio

By Inspector Jim P. Puccio

Permit Application Register Page No 119

INSPECTIONS. Service 200 amp by P. Puccio
Service called in Delayed - 8/11/86
Closing-in _____ by _____

PROGRESS INSPECTIONS 8/11/86 _____
10/21/86 _____

DATE	REMARKS
<u>8/11/86</u> <u>10/21/86</u>	Temporary service o.k. called in to C.M.P. needs S.S.P. call tied in before inspection completion
<u>8/8/88</u>	no call for final inspection

PERMIT # 54728 CITY OF Portland BUILDING PERMIT APPLICATION

MAP # _____ LOT# _____

Owner: Fill-It-Up Please - 775-4700
 Address: 13 Campbell Rd., Portland, Maine
 OCCASION OF CONSTRUCTION: 1185 Forest Avenue
 CONTRACTOR: Portland Plum Co. 1000 Commercial St. 282-4317
 Address: P.O. Box 1189, Scar, Maine 04074

For Official Use Only

Date: June 23, 1988 Jurisdiction: You / Me
 Inside Fire Limits: _____ Name: _____
 City Code: _____ Lot: _____
 Time Limits: _____ Block: _____
 Estimated Cost: _____ Permit Expiration: _____
 Value/Type: \$10,000 Ownership: _____
 Public _____
 Private _____

Est. Construction Cost: _____ Type of Use: Full-time Station
 Bulkhead: _____ # Stories: _____ Lot Size: _____
 Foundation: _____
 Roof: _____
 Heating: _____
 Electrical: _____
 Plumbing: _____
 Swimming Pools: _____
 Zoning: _____
 Review: _____
 Permit received by: _____
 Signature of Applicant: _____ Date: 12/2/85
 Signature of CEO: _____ Date: _____
 Inspection Dates: _____

Foundation:
 1. Type of Soil: _____
 2. Spacing - Front _____ Rear _____ Sides _____
 3. Footing Size: _____
 4. Foundation Size: _____
 5. Other: _____

Floors:
 1. Sills: _____ Sills must be anchored
 2. Joints: _____
 3. Lally Column Spacing: _____
 4. Joist Size: _____
 5. Beam Type: _____
 6. Floor Joist Type: _____
 7. Other Materials: _____

Exterior Walls:
 1. Stud Spacing: _____
 2. No. windows: _____
 3. 16a. Code: _____
 4. Insulation: _____
 5. Framing: Yes _____ No _____
 6. Other Materials: _____
 7. Sheathing Type: _____
 8. Sheathing Size: _____
 9. Siding Type: _____
 10. Siding Material: _____
 11. Final Exterior: _____

Interior Walls:
 1. Studding Size: _____ Spacing: _____
 2. Siding Size: _____ Spacing: _____
 3. Wall Covering Type: _____
 4. Fire Wall if required: _____
 5. Other Materials: _____

Roofing:
 1. Ceiling Joist Size: _____
 2. Ceiling Strapping Size: _____ Spacing: _____
 3. Type Ceiling: _____
 4. Insulation Type: _____
 5. Ceiling Height: _____

Roof Plan:
 1. Truss or Rafters Size: _____
 2. Ceiling Type: _____
 3. Rafter Spacing Type: _____
 4. Other: _____

Chimneys:
 Type: _____ Number of Fire Places: _____

Electrical:
 Entrance: _____ Smoke Detector Req: _____ Yes _____ No _____

Plumbing:
 1. Approval of soil test if required: Yes _____ No _____
 2. No. of Toilets: _____
 3. No. of Sinks: _____
 4. No. of Lavatories: _____
 5. No. of Other Fixtures: _____

Swimming Pools:
 1. Type: _____
 2. Perimeter: _____ Square Footage: _____
 3. Must conform to Maine Electrical Code and State Law

Zoning:
 District: _____ Front Yard Req: _____
 Review Required: _____
 Planning Board Approval: Yes _____ No _____
 Conditional Use: _____ Variance: _____
 Other (explain): _____
 Date Approved: _____

Permit received by: _____
 Signature of Applicant: _____ Date: 12/2/85
 Signature of CEO: _____ Date: _____
 Inspection Dates: _____