

T PLAN

8 - OK to close
5 of

N

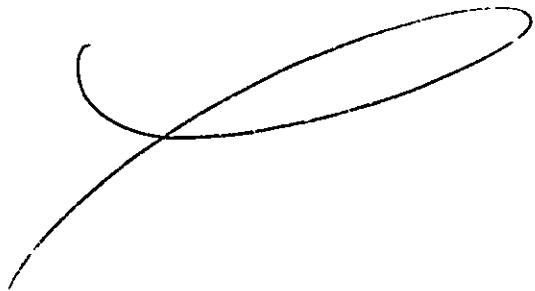

Inspection Record

FEES (Breakdown From Front)

Base Fee \$ 25.00
Subdivision Fee \$ _____
Site Plan Review Fee \$ _____
Other Fee \$ ~~25.00~~ 50.00
(Explain) _____
Late Fee \$ _____

	T	Date
_____	_____	/ /
_____	_____	/ /
_____	_____	/ /
_____	_____	/ /
_____	_____	/ /

COMMENTS

Signature of Applicant Timo J. d. Murray As Agent for Owner Date 1/17/89



CITY OF PORTLAND, MAINE
Department of Building Inspection

Certificate of Occupancy

LOCATION 1000 Brighton Avenue

Issued to LedgeWood, Inc.

Date of Issue February 16, 1989

This is to certify that the building, premises, or part thereof, at the above location, built—altered—changed as to use under Building Permit No. 88/1051, has had final inspection, has been found to conform substantially to requirements of Zoning Ordinance and Building Code of the City, and is hereby approved for occupancy or use, limited or otherwise, as indicated below.

PORTION OF BUILDING OR PREMISES

2nd Floor Center Mezzanine

APPROVED OCCUPANCY

Dead Storage Only

Limiting Conditions:

No human occupancy permitted in this space.

This certificate supersedes
certificate issued

Approved:

2/21/89

(Date)

Inspector

Inspector of Building

Michael C. Conway
Sent F.B.B. 2-17-89

Notice: This certificate identifies lawful use of building or premises, and ought to be transferred from owner to owner when property changes hands. Copy will be furnished to owner or lessee for one dollar.

PERMIT # 1051 CITY OF Portland BUILDING PERMIT APPLICATION

MAP # _____ LOT# _____

Please fill out any part which applies to job. Proper plans must accompany form.

Owner: Forest City Chevrolet

Address: 1000 Brighton Ave., Portland, Maine

LOCATION OF CONSTRUCTION 1000 Brighton Avenue

CONTRACTOR: Ledgewood, Inc. 908095200008 775-0741-David

ADDRESS: P.O. Box 8107, Portland, Maine 04104 Leach

Est. Construction Cost: \$110,000.00 Type of Use: Car dealer

Past Use: same

Building Dimensions L. _____ W. _____ Sq. Ft. _____ # Stories: _____ Lot Size: _____

Is Proposed Use: _____ Seasonal _____ Condominium _____ Apartment _____

Conversion - Explain Interior renovations, as per plans. New mezzanine

COMPLETE ONLY IF THE NUMBER OF UNITS WILL CHANGE over auto reception.

Residential Buildings Only: _____ area.

Of Dwelling Units _____ # Of New Dwelling Units _____

Foundation:

1. Type of Soil: _____

2. Foot Backs - Front _____ Rear _____ Side(s) _____

3. Footings Size: _____

4. Foundation Size: _____

5. Other _____

Floor:

1. Sills Size: _____ Sills must be anchored.

2. Girder Size: _____

3. Lally Column Spacing: _____ Size: _____

4. Joists Size: _____ Spacing 16" O.C.

5. Bridging Type: _____ Size: _____

6. Floor Sheathing Type: _____ Size: _____

7. Other Material: _____

Exterior Walls:

1. Studding Size _____ Spacing _____

2. No. windows _____

3. No. Doors _____

4. Header Sizes _____ Span(s) _____

5. Bracing: Yes _____ No _____

6. Corner Posts Size _____

7. Insulation Type _____ Size _____

8. Sheathing Type _____ Size _____

9. Siding Type _____ Weather Exposure _____

10. Masonry Materials _____

11. Metal Materials _____

Interior Walls:

1. Studding Size _____ Spacing _____

2. Header Sizes _____ Span(s) _____

3. Wall Covering Type _____

4. Fire Wall if required _____

5. Other Materials _____

For Official Use Only

Date <u>August 19, 1988</u>	Subdivision: Yes / No _____
Inside Fire Limits _____	Name _____
Bldg Code _____	Lot _____
Time Limit _____	Block _____
Estimated Cost <u>\$110,000.00</u>	Permit Expiration: _____
Value/Structure _____	Ownership: _____ Public _____ Private _____
Fee <u>\$570.00</u>	

PERMIT ISSUED

Ceiling:

1 Ceiling Joists Size: _____

2 Ceiling Strapping Size _____ Spacing AUG 29 1988

3 Type Ceiling: _____

4 Insulation Type _____ Size: City of Portland

5 Ceiling Height: _____

Roof:

1 Truss or Rafter Size _____ Span _____

2 Sheathing Type _____ Size _____

3 Roof Covering Type _____

4 Other _____

Chimneys:

Type: _____ Number of Fire Places _____

Heating:

Type of Heat: _____

Electrical:

Service Entrance Size: _____ Smoke Detector Required Yes _____ No _____

Plumbing:

1 Approval of soil test if required Yes _____ No _____

2 No. of Tubs or Showers _____

3 No. of Flushes _____

4 No. of Lavatories _____

5 No. of Other Fixtures _____

Swimming Pools:

1 Type: _____

2 Pool Size _____ x _____ Square Footage _____

3 Must conform to National Electrical Code and State Law.

Zoning:

District _____ Street Frontage Req. _____ Provided _____

Required Setbacks: Front _____ Back _____ Side _____

Review Required:

Zoning Board Approval: Yes _____ No _____ Date _____

Planning Board Approval: Yes _____ No _____ Date _____

Conditional Use: _____ Variance _____ Site Plan _____ Subdivision _____

Shore and Floodplain Mgmt _____ Special Exception _____

Other (Explain) _____

Date Approved _____

Permit Received By Joyce M. Rinaldi

Signature of Applicant [Signature] Date 8/19/88

Signature of CEO [Signature] Date _____

Inspection Dates 2 KC

930938

Permit # _____ City of Portland BUILDING PERMIT APPLICATION Fee \$10.00 Zone _____ Map # _____ Lot# _____
 Please fill out any part which applies to job. Proper plans must accompany form.

Owner: Chevrolet (Forest City) Phone # 774-5971
 Address: 1000 Brighton Ave. 04102
 LOCATION OF CONSTRUCTION 1000 Brighton Ave.
 Contractor: Les Wilson & Sons Sub: _____
 Address: P. O. Box 1028 Westbrook 04098 Phone # 854-4583
 Est. Construction Cost: _____ Proposed Use: _____
 Past Use: _____
 # of Existing Res. Units _____ # of New Res. Units _____
 Building Dimensions L _____ W _____ Total _____
 # Stories: _____ # Bedrooms _____
 Is Proposed Use: Seasonal _____ Condor _____
 Explain Conversion to remove one unground tank _____

For Official Use Only
 Sub-division _____
 Date Oct. 5, 1993 No. OCT -- 8 1000
 Inside Fire Limits _____ Lot _____
 Blg. Code _____
 Time Limit _____
 Estimated Cost _____
 City of PORTLAND
 Zoning: _____
 Street Frontage Provided _____
 Provided Setbacks: Front _____ Back _____ Side _____ Side _____
 Review Required:
 Zoning Board Approval: Yes _____ No _____ Date: _____
 Planning Board Approval: Yes _____ No _____ Date: _____
 Conditional Use: _____ Variance _____ Site Plan _____ Subdivision _____
 Shoreland Zoning: Yes _____ No _____ Floodplain: Yes _____ No _____
 Special Exception _____
 Other: (Explain) _____
WILSON - 10-6-93

Foundations:
 1. Type of Soil: _____
 2. Set Backs - Front _____ Rear _____ Side(s) _____
 3. Footings Size: _____
 4. Foundation Size: _____
 5. Other: _____

Ceiling:
 1. Ceiling Joists Size: _____
 2. Ceiling Strapping Size _____ Spacing _____
 3. Type Ceilings: _____
 4. Insulation Type _____ Size _____
 5. Ceiling Height _____
 HISTORIC PRESERVATION
 Not in District or Landmark
 Does not require review
 Requires Review

Floor:
 1. Sills Size: _____ Sills must be anchored.
 2. Girder Size: _____
 3. Lally Column Spacing _____ Size: _____
 4. Joists Size: _____ Spacing 16" O.C.
 5. Bridging Type: _____ Size: _____
 6. Floor Sheathing Type: _____ Size: _____
 7. Other Material: _____

Roof:
 1. Truss or Rafter Size _____ Span _____
 2. Sheathing Type _____ Size _____
 3. Roof Covering Type _____

 action Approved
 Approved with conditions

Exterior Walls:
 1. Studding Size _____ Spacing _____
 2. No. windows _____
 3. No. Doors _____
 4. Header Sizes _____ Span(s) _____
 5. Bracing: Yes _____ No _____
 6. Corner Posts Size _____
 7. Insulation Type _____ Size _____
 8. Sheathing Type: _____ Size _____
 9. Siding Type _____ Weather Exposure _____
 10. Masonry Materials _____
 11. Metal Materials _____

Chimneys:
 Type _____ Number of Fire Places _____ Date _____
 Signature _____

Interior Walls:
 1. Studding Size _____ Spacing _____
 2. Header Sizes _____ Span(s) _____
 3. Wall Covering Type _____
 4. Fire Wall if required _____
 5. Other Materials _____

Heating:
 Type of Heat _____
Electrical:
 Service Entrance Size _____ Smoke Detector Required Yes _____ No _____
Plumbing:
 1. Approval of soil test if required Yes _____ No _____
 2. No. of Toilets or Showers _____
 3. No. of Fixtures _____
 4. No. of Lavatories _____
 5. No. of Other Fixtures _____

Swimming Pools:
 1. Type: _____
 2. Pool Size _____ x _____ Square Footage _____
 3. Must conform to National Electrical Code and State Law.

Permit Received By _____
 Signature of Applicant Ron Wilson Date 10/5/93
 Signature of CEO _____
 Inspection Dates _____

PERMIT ISSUED
 REQUIREMENTS

930415

Permit # _____ City of Portland BUILDING PERMIT APPLICATION Fee \$62.00 Zone _____ Map # _____ Lot# _____
 Please fill out any part which applies to job. Proper plans must accompany form

PERMIT ISSUED

Owner Forest City Chevrolet Phone # 774-5971
 Address: 1000 Brighton Ave.
 LOCATION OF CONSTRUCTION 1000 Brighton Ave.
 Contractor Self Sub _____
 Address: _____ Phone # _____
 Est Construction Cost _____ Proposed Use _____
 Past Use _____
 # of Existing Res. Units _____ # of New Res. Units _____
 Building Dimensions L _____ W _____ Total Sq Ft _____
 # Stories _____ # Bedrooms _____ Lot Size _____
 Is Proposed Use: Seasonal _____ Condominium _____ Conversion _____
 Explain Conversion To move shed and erect tent May 14 to Aug 1, 1993

For Official Use Only
 Date May 18, 1993 Subdivision _____
 Inside Fire Limits _____ Name MAY 24 1993
 Bldg Code _____ Lot _____
 Time Limit _____ Owner _____
 Estimated Cost _____

CITY OF PORTLAND

Zoning: Street Frontage Provided _____
 Provided Setbacks Front _____ Back _____ Side _____

Review Required:
 Zoning Board Approval Yes _____ No _____ Date _____
 Planning Board Approval Yes _____ No _____ Date _____
 Conditional Use _____ Variance _____ Site Plan _____ Subdivision _____
 Shoreland Zoning Yes _____ No _____ Floodplain Yes _____ No _____
 Special Exception _____
 Other (Explain) 5-20-93

HISTORIC PRESERVATION

Foundation
 1. Type of Soil: _____
 2. Set Backs - Front _____ Rear _____ Side(s) _____
 3. Footings Size: _____
 4. Foundation Size: _____
 5. Other _____

Ceiling:
 1. Ceiling Joists Size: _____
 2. Ceiling Strapping Size: _____ Spacing _____
 3. Ceiling Type: _____
 4. Insulation Type: _____ Size _____
 5. Ceiling Height: _____

Floor:
 1. Sill's Size: _____ Sills must be anchored.
 2. Girder Size: _____
 3. Lally Column Spacing: _____ Size _____
 4. Joists Size: _____ Spacing 16" O C
 5. Bridging Type: _____ Size _____
 6. Floor Sheathing Type: _____ Size _____
 7. Other Material: _____

Roof:
 1. Truss or Rafter Size: 2x6 Span/Action 0D.2E Approved _____
 2. Sheathing Type: _____ Size _____
 3. Roof Covering Type: _____

Exterior Walls:
 1. Studding Size: _____ Spacing _____
 2. No. windows _____
 3. No. Doors _____
 4. Header Sizes: _____ Span(s) _____
 5. Bracing: Yes _____ No _____
 6. Corner Posts Size: _____
 7. Insulation Type: _____ Size _____
 8. Sheathing Type: _____ Size _____
 9. Siding _____ Weather Exposure _____
 10. Masonry Materials _____
 11. Metal Materials _____

Chimneys:
 Type _____ Number of Fire Places _____

Heating:
 Type of Heat _____

Electrical:
 Service Entrance Size _____ Smoke Detector Required Yes _____ No _____

Plumbing:
 1. No. of Tubs or Showers _____
 2. No. of Flushes _____
 3. No. of Lavatories _____
 4. No. of Other Fixtures _____

Swimming Pools:
 1. Type: _____
 2. Pool Size: _____ x _____ Square Footage _____
 Must conform to National Electrical Code and State Law.

Interior Walls:
 1. Studding Size: _____ Spacing _____
 2. Header Sizes: _____ Span(s) _____
 3. Wall Covering Type _____
 4. Fire Wall if required _____
 Other Materials _____

Permit Received By Latini

Signature of Applicant Kenneth Clark Date 5/18/93

Signature of CEO _____ Date _____

Inspection Date: _____

PLOT PLAN



FEE'S (Breakdown From Front)
Base Fee \$ 35.00 and \$25.00
Subdivision Fee \$ _____
Site Plan Review Fee \$ _____
Other Fees \$ _____
(Explain) _____
Late Fee \$ _____

Type	Inspection Record	Date
_____	_____	____/____/____
_____	_____	____/____/____
_____	_____	____/____/____
_____	_____	____/____/____
_____	_____	____/____/____

COMMENTS submitted plot plan and certificate of flameproof ok per Bill Giroux

Date _____

Signature of Applicant _____

FOREST CITY ROLETSAAB

1000 Brighton Ave., P.O. Box 3564
Portland, Maine 04104
(207) 774-5971



May 17, 1993

City Hall
Portland, ME

LOCATION OF
60' x 40' TENT
NOW THAN AUG. 1ST.
FLAMABILITY CERT.
ATTACHED.

To whom it may concern:

I would like to request a building permit to move a 10' by 20' steel frame, glass side building, presently located in the middle of our lot, approximately 20 feet directly back deeper into our lot. The building will be founded with cement filled tubes as is presently the case. In its new location the building will be 10 plus feet from lot lines on each side. This letter and information is presented as requested by Mr. Bill Giroux on 5/14/93 as the result of our discussing the project.

Thank you.

John P. McLeod
John P. McLeod
VP/General Manager

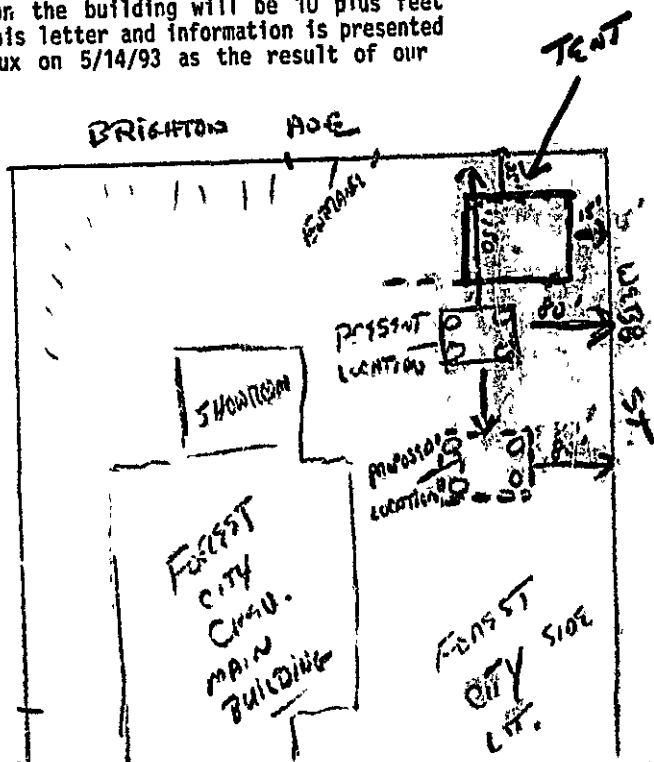

Certificate of Flame Resistance



REGISTERED
APPLICATION
CONCERN No.

A-217

ISSUED BY

JOHN BOYLE & COMPANY, INC.
SALISBURY ROAD
STATESVILLE, NC 28677

Date treated or
manufactured

6/87

704 B72-8151

This is to certify that the materials described on the reverse side hereof have been flame-retardant treated (or are inherently nonflammable).

FOR MAINE HAY CANVAS ADDRESS _____
CITY 977 BRIGHTON AVE. STATE _____
PORTLAND, MAINE 04102

CEAC (207) 273-2251 made that: (Check "a" or "b")

- (a) The articles described on the reverse side of this Certificate have been treated with a flame retardant chemical approved and registered by the State Fire Marshal and that the application of said chemical was done in conformance with the laws of the State of California and the Rules and Regulations of the State Fire Marshal.

Name of chemical used _____ Chem. Reg. No. _____

Method of application _____

- (b) The articles described on the reverse side hereof are made from a flame-resistant fabric or material registered and approved by the State Fire Marshal for such use.

Trade name of flame-resistant fabric or material used _____ Reg. No. _____

The Flame Retardant Process Used WILL NOT Be Removed By Washing

JOHN BOYLE & COMPANY, INC.

Name of Applicator or Production Superintendent

JOHN BOYLE & COMPANY, INC.

By

Nick Albujo
File

COVERS - 30' WIDE + 40' WIDE + 50' WIDE + 60' WIDE

SOLE SOURCE	
MAINE BAY CANVAS	CONTROL#--> 01355
977 BRIGHTON AVE	ORDER#--> 13871
	INVOICE#--> 663469
PORTLAND	MFG DATE--> 06-12-88
ME 04102	QUANTITY--> 95.00

STYLE-----> 42355FR
 DESCRIPTION----> 42355 BLUE/WHT ULTRAFAB FR
 REGISTER NO.----> F-121.08
 CALIFORNIA ID.---->

Sell The Certified *Flame Retardant "Big Top" By BOYLE

YOUR PRODUCT WILL MEET THE RIGID SPECIFICATIONS OF THE
 CALIFORNIA FIRE MARSHALL AND HELP TO INSURE CUSTOMER SATISFACTION
 RIGHT DOWN THE LINE.

*Copies of your own certificate with all purchases of

BIG TOP

JOHN BOYLE & COMPANY AND DISTRIBUTORS

City of Portland, Maine - Building or Use Permit Application 389 Congress Street, 04101, Tel: (207) 874-8703, FAX: 874-8716

Location of Construction: 1000 Brighton Av		Owner Forest City Chevrolet		Phone		Permit No: 940718
Owner Address:		Leasee/Buyer's Name		Business Name		
Contractor Name: Keeley Construction Co.,		Address P.O. Box 1074 Portland, ME 04101		Phone 773-8499		Permit Issued: JUL 18
Past Use: Retail Sales		Proposed Use: Retail Sales		COST OF WORK: \$ 1,700.00		PERMIT FEE: \$ 25.00
				FIRE DEPT. <input type="checkbox"/> Approved <input type="checkbox"/> Denied		INSPECTION: Use Group 4 Type 5B
Proposed Project Description: Move Building				Signature		Signature
				PEDESTRIAN ACTIVITIES DISTRICT (P.A.D.)		Zone: CSL:
				Action		Zoning Approval
				Approved		Special Zone or Reviews: <input type="checkbox"/> Shoreland <input type="checkbox"/> Wetland <input type="checkbox"/> Flood Zone <input type="checkbox"/> Subdivision <input type="checkbox"/> Site Plan map <input type="checkbox"/> minor <input type="checkbox"/> mm <input type="checkbox"/>
				Approved with Conditions		
				Denied		
				Signature		Date

1. This permit application doesn't preclude the Applicant(s) from meeting applicable State and Federal rules
2. Building permits do not include plumbing, septic or electrical work
3. Building permits are void if work is not started within six (6) months of the date of issuance. False information may invalidate a building permit and stop all work

Zoning Appeal

Variance
 Miscellaneous
 Conditional Use
 Interpretation
 Approved
 Denied

Historic Preservation

Not In District or Landmark
 Does Not Require Review
 Requires Review

Action:

Approved
 Approved with Conditions
 Denied

CERTIFICATION

I hereby certify that I am the owner of record of the named property, or that the proposed work is authorized by the owner of record and that I have been authorized by the owner to make this application as his authorized agent and I agree to conform to all applicable laws of this jurisdiction. In addition, if a permit for work described in the application issued, I certify that the code official's authorized representative shall have the authority to enter all areas covered by such permit at any reasonable hour to enforce the provisions of the code(s) applicable to such permit

SIGNATURE OF APPLICANT *Susan Stackpole* ADDRESS DATE 13 July 1994 PHONE

Date: *7/14/94*
[Signature]

RESPONSIBLE PERSON IN CHARGE OF WORK, TITLE PHONE

CEO DISTRICT *4*
MR. CARROLL

White-Permit Desk Green-Assessor's Canary-D.P.W. Pink-Public File Ivory Card-Inspector

040214

Permit City of Portland BUILDING PERMIT APPLICATION Fee 43.00 Zone Map # Lot #

Owner Forest City Chevrolet Phone #

Address 1000 Brighton Ave

LOCATION OF CONSTRUCTION 1000 Brighton Ave

Contractor Signature Signs Sub: P.O. Box 1023 Portland, ME 04104

Address: Phone # 775-6312

Est. Construction Unit: Proposed Use Car Sales w/Signs UL# AW92945

Past Use Car Sales

of Existing Res. Units # of New Res. Units

Building Dimensions L W Total Sq Ft.

Stories # Bedrooms Lot Size

Is Proposed Use Seasonal Condominium Conversion

Explain Conversion Erect Signs as per plans

263-B-043 Foundations

- 1. Type of Soil
2. Set Backs Front Rear Side(s)
3. Footings Size
4. Foundation Size
5. Other

- Floor:
1. Sills Size Sills must be anchored.
2. Girder Size
3. Lally Column Spacing Size.
4. Joist Size Spacing 16" O C
5. Bridging Type Size
6. Floor Sheathing Type Size.
7. Other Material

- Exterior Walls:
1. Studding Size Spacing
2. No windows
3. No Doors
4. Header Sizes Span(s)
5. Bracing Yes No
6. Corner Posts Size
7. Insulation Type Size
8. Sheathing Type Size
9. Siding Type Weather Exposure
10. Masonry Materials
11. Meta Materials

- Interior Walls:
1. Studding Size Spacing
2. Header Sizes Span(s)
3. Wall Covering Type
4. Fire Wall if required
5. Other Materials

For Official Use Only
Date 29 March '94
Inside Fire Layouts
Bldg Code
Time Limit
Estimated Cost
CITY OF PORTLAND

Zoning: Street Frontage Provided.
Review Required: Zoning Board Approval Yes No Date
Planning Board Approval Yes No
Condition Use: Variance
Shoreland Zoning Yes No Floor
Special Execution
Other (explain)

Ceiling:
1. Ceiling Joists Size
2. Ceiling Strapping Size Spacing
3. Type Ceiling
4. Insulation Type
5. Ceiling Height

Roof:
1. Truss or Rafter Size Spar Size Approved
2. Sheathing Type Size Approves with conditions
3. Roof Covering Type

Chimneys:
Type Number of Fire Places

Heating:
Type of Heat

Electrical:
Service Entrance Size. Smoke Detector Required Yes No

Plumbing:
1. Approval of soil test if required Yes No
2. No of Tubs or Showers
3. No of Flushes
4. No of Lavatories
5. No of Other Fixtures

Swimming Pools:
1. Type
2. Pool Size Square Footage
3. Must conform to National Electrical Code and State Law.

Permit Received By Mary Gresik

Signature of Applicant Nasser Chanani Date 29 March 94

CEO's Distric. 4 Assmt For the owner

CONTINUED TO REVERSE SIDE
Ivory Tag - CEO [4] M.A. Carroll

White - Tax Assessor

APPLICATION FOR PERMIT

PERMIT ISSUED

B.O.C.A. USE GROUP B.O.C.A. TYPE OF CONSTRUCTION 000090

JAN 31 1986

ZONING LOCATION B-2 PORTLAND, MAINE Jan. 9, 1986

City Of Portland

To the CHIEF OF BUILDING & INSPECTION SERVICES, PORTLAND, MAINE

The undersigned hereby applies for a permit to erect, alter, repair, demolish, move or install the following building, structure, equipment or change use in accordance with the Laws of the State of Maine, the Portland B.O.C.A. Building Code and Zoning Ordinance of the City of Portland with plans and specifications, if any, submitted herewith and the following specifications:

- LOCATION 1000 Brighton Avenue Forest City Chevrolet, Inc. P.O. Box 3564, Portland, ME 04101
1. Owner's name and address Phillip Gervais, P.O. Box 3564, Portland, ME 04101 Telephone 774-5971
2. Lessee's name and address Attn: Bill Howe P.O. Box 1396, Portland, ME 04104 Telephone
3. Contractor's name and address Allied Construction, Portland, Maine Telephone 772-2888

Proposed use of building Paint Spray Booth No. families
Last use scene No. families
Material No. stories Heat Style of roof Roofing
Other buildings on same lot
Estimated contractual cost \$ 35,000.00

FIELD INSPECTOR - Mr. @ 775-5451
Appeal Fees \$
Base Fee
Late Fee
TOTAL \$ 195.00

To construct paint spray booth within existing building, as per plan.

Stamp of Special Conditions

ISSUE PERMIT TO - ATTN: BILL HOWE

NOTE TO APPLICANT Separate permits are required by the installers and subcontractors of heating, plumbing, electrical and mechanical.

DETAILS OF NEW WORK

Is any plumbing involved in this work? NO Is any electrical work involved in this work? YES
Is connection to be made to public sewer? If not, what is proposed for sewage?
Has septic tank notice been sent? Form notice sent?
Height average grade to top of plate Height average grade to highest point of roof
Size, front depth No. stories sand or filled land? earth or rock?
Material of foundation Thickness, top bottom cellar
Kind of roof Rise per foot Roof covering
No. of chimneys Material of chimneys of lining Kind of heat fuel
Framing Lumber - Kind Dressed or full size? Corner posts Sills
Size Girder Columns under girders Size Max. on centers
Studs (outside walls and carrying partitions) 2x4-16" O.C. Bridging in every floor and flat roof span over 8 feet
Joists and rafters 1st floor 2nd 3rd roof
On centers 1st floor 2nd 3rd roof
Maximum span 1st floor 2nd 3rd roof
If one story building with masonry walls thickness of walls? height?

IF A GARAGE

Now or now accommodated on same lot to be accommodated number commercial cars to be accommodated
Will automobile repairing be done other than minor repairs to cars habitually stored in the proposed building?

APPROVALS BY DATE MISCELLANEOUS
BUILDING INSPECTION - PLAN EXAMINER Will work require disturbing of any tree on a public street? NO
ZONING G.R. 2/25/86
BUILDING CODE: Will there be in charge of the above work a person competent
Fire Dept. James V. Collins, Chief to see that the State and City requirements pertaining thereto
Health Dept. are observed? YES
Others

Signature of Applicant William Howe
Type Name of above William Howe for Forest City Chevrolet, 1000 Brighton Avenue, Portland, ME 04101
and Address

FIELD INSPECTOR'S COPY APPLICANT'S COPY OFFICE FILE COPY

Handwritten signature and initials at the bottom of the page.

830415

Permit # 830415 City of Portland BUILDING PERMIT APPLICATION Fee \$60.00 Zone _____ Map # _____ Lot # _____ PERMIT ISSUED

Please fill out an, part which applies to job. Proper plans must accompany form.

Owner Forest City Chevrolet Phone # 774-5971
 Address 1000 Brighton Ave.
 LOCATION OF CONSTRUCTION 1000 Brighton Ave.
 Contractor Self Sub. _____
 Address: _____ Phone # _____
 Est. Construction Cost _____ Proposed Use _____
 Past Use _____
 # of Existing Res. Units _____ # of New Res. Units _____
 Building Dimensions L _____ W _____ Total Sq Ft _____
 # Stories _____ # Bedrooms _____ Lot Size _____
 Is Proposed Use Seasonal _____ Condominium _____ Conversion _____
 Explain Conversion To move shed and erect tent May 14 to Aug 1, 1993

For Official Use Only
 Date May 18, 1993 Subdivision Name MAY 24 1993
 Inside Fire Limits _____ Lt. _____
 Bldg Code _____ Owner **CITY OF PORTLAND**
 Time Limit _____
 Estimated Cost _____

Zoning: Street Frontage Provided _____ Back _____ Side _____ Side _____
 Provided Setbacks: Front _____ Back _____ Side _____ Side _____
 Review Required:
 Zoning Board Approval: Yes _____ No _____ Date: _____
 Planning Board Approval: Yes _____ No _____ Date: _____
 Conditional Use: _____ Variance _____ Site Plan _____ S-division _____
 Shoreland Zoning Yes _____ No _____ Floodplain Yes _____ No _____
 Special Exception _____
 Other (explain) WOT - 25 - 93

Foundations
 1. Type of Soil: _____
 2. Set Backs - Front _____ Rear _____ Side(s) _____
 3. Footings Size _____
 4. Foundation Size _____
 5. Other _____

Floors
 1. Sill Size: _____ Sills must be anchored.
 2. Girder Size: _____
 3. Lally Column Spacing: _____ Size: _____
 4. Joists Size: _____ Spacing 16" O C
 5. Bridging Type: _____ Size: _____
 6. Floor Sheathing Type: _____ Size: _____
 7. Other Material: _____

Exterior Walls
 1. Studding Size _____ Spacing _____
 2. No. windows _____
 3. No. Doors _____
 4. Header Sizes _____ Span(s) _____
 5. Bracing: Yes _____ No _____
 6. Corner Posts Size _____
 7. Insulation Type _____ Size _____
 8. Sheathing Type _____
 9. Siding Type _____ Weather Exposure _____
 10. Masonry Materials _____
 11. Metal Materials _____

Interior Walls
 1. Studding _____ Spacing _____
 2. Header _____ Span(s) _____
 3. Ceiling Type _____
 4. Fire Wall if required _____
 5. Other Materials _____

Ceiling
 1. Ceiling Joists Size _____ Spacing _____
 2. Ceiling Strapping Size _____ Spacing _____
 3. Type Ceilings: _____
 4. Insulation Type _____ Size _____
 5. Ceiling Height: _____

Roof
 1. Truss or Rafter Size _____ Span/Action _____ Approved _____
 2. Sheathing Type _____ Size _____ Approved with Conditions _____
 3. Roof Covering Type _____

Chimneys
 Type: _____ Number of Fire Places _____ Date: _____

Heating
 Type of Heat _____

Electricals
 Service Entrance Size _____ Smoke Detector Required Yes _____ No _____

Plumbing
 1. Approval of soil test if required Yes _____ No _____
 2. No. of Tubs or Showers _____
 3. No. of Flushes _____
 4. No. of Lavatories _____
 5. No. of other Fixtures _____

Swimming Pool
 1. Type: _____ Square Footage _____
 2. Pool Size: _____
 3. Must conform to National Electrical Code and State Law.

Permit Received By Latini

Signature of Applicant [Signature] Date 5/18/93

Signature of CEO [Signature] Date _____

Inspection Dates _____

White-Tax Assessor Yellow-GPCOG White Tag -CEO [4] Copyright GPCOG 1988



CITY OF PORTLAND

DEPARTMENT OF PLANNING & URBAN DEVELOPMENT
INSPECTION SERVICES DIVISION

July 1, 1986

Forest City Motors
1000 Brighton Avenue
Portland, ME 04102

Dear Sir:

Your application to construct an extension of the existing parking lot has been reviewed and a permit is herewith issued subject to the following requirements:

SITE PLAN REVIEW

Inspection Services - Approved, Mr. Warren J. Turner, 6/27/86.

Public Works - Approved with conditions:

1. Plan is approved for extension of parking lot only. No building will take place over City sewer.
2. Plan does not meet requirements of ordinance for submittal. Mr. William Boothby, 5/29/86.

Fire Department - Approved, Lt. James P. Collins, 6/2, 86.

Planning Division - Approved, Mr. David I. Klenk, 6/23/86.

If this office can be of any further help, please call.

Sincerely,

A handwritten signature in dark ink, appearing to read "P. Samuel Hoffses".

P. Samuel Hoffses
Chief of Inspection Services

cc: Lt. James P. Collins, Fire Prevention Bureau
William Boothby, Public Works Department
David Klenk, Planning Department

PSH/jmr

PERM.

JUL 8 1986

APPLICATION FOR CERTIFICATE OF OCCUPANCY FOR USE OF PREMISES IN City of Portland

Portland, Maine May 27, 1986

Location Rano Road Zone B-2

To the INSPECTOR OF BUILDINGS, Portland, Maine

**PERMIT ISSUED
WITH LETTER**

The undersigned hereby applies for a certificate of occupancy to allow the use of the above named premises for Extension of Existing Parking Lot

as set forth on the attached site plan (made by Blue Rock Industries whose address is 58 Main St. West, Me.) to show compliance with the Zoning Ordinance according to the intended use and the zone in which the property is located; and in accordance with the following pertinent information:-

Chev/Saab

Owner (name, address and phone number) Forest City Motors, 1000 Brighton Ave., Portland 774-5971

Lessee (name, address and phone number) _____

Is proposed use to be accessory to a building or other use on this lot? yes
If so, what is use of building or other use Car dealers

If off-street parking is sought, what is proposed maximum number of vehicles to be parked—passenger cars? _____, commercial vehicles? _____.

Have you secured on the site plan the written approval of existing and proposed entrances to and exits from the premises for vehicles over public sidewalks by the Traffic Engineer (Dept. of Public Works)? N/A
And, if access to the premises is available from more than one street, have you secured similar approval by the Planning Board? N/A

Have you shown on the site plan the true location of all trees on the public street along the frontage of the premises (both streets if a corner lot)? N/A

Do you propose to remove or disturb any tree on a public street? no
If so, have you secured on the site plan the written approval of the Director of Parks and Recreation? N/A

Signature of Owner FOREST CITY CHEVROLET - SAAB
Phillip GORNER
By Robert A. Beady BRT
(duly authorized thereto)

THIS IS NOT A CERTIFICATE OF OCCUPANCY

To:

COMMENCING the above proposed use of the premises would be IN VIOLATION of the Zoning Ordinance unless a Certificate of Occupancy is first procured from the Department of Building Inspection.

However, improvement of the premises according to the site plan and the above application may now proceed without further authorization, but subject to the conditions indicated below—notice of readiness for final inspection to be given to this department when the premises have been placed in compliance with the requirements:-

(Date)

**PERMIT ISSUED
WITH LETTER**

[Signature]
Inspector of Buildings

O.K. B-2 Business Zone
3/27 Turner June 27 1986

6/29/86

City of Portland, Maine - Building or Use Permit Application 389 Congress Street, 04101. Tel: (207) 874-8703, FAX: 874-8716

Location of Construction 1000 Brighton Ave Owner Address	Owner Forest City Chevrolet	Phone	Permit No: 941182
Contractor Name Allied Construction	Address P.O. Box 13 6 Portland, ME 04104	Phone 772-2888	Permit Issued OCT 27 1994
Past Use Retail	Proposed Use Retail w/addition	COST OF WORK: \$ 150,000.	PERMIT FEE: \$770.
Proposed Project Description Showroom Addition Approx 2,000 sq ft	Signature: <i>[Signature]</i>	FIRE DEPT. <input checked="" type="checkbox"/> Approved <input type="checkbox"/> Denied	INSPECTION: Use Group <i>B</i> Type <i>3B</i>
Foundation permit on prior submittal	Signature: <i>[Signature]</i>	PEDESTRIAN ACTIVITIES DISTRICT (P.A.D.) Action <input type="checkbox"/> Approved <input type="checkbox"/> Approved with Conditions <input type="checkbox"/> Denied	CITY OF PORTLAND 663-B-045
Permit Taken By Mary Gresik	Date Applied For 26 Oct 94	Signature: _____	Date _____

- This permit application doesn't preclude the Applicant(s) from meeting applicable State and Federal rules
- Building permits do not include plumbing, septic or electrical work
- Building permits are void if work is not started within six (6) months of the date of issuance. False information may invalidate a building permit and stop all work.

PERMIT ISSUED WITH LETTER

CERTIFICATION
I hereby certify that I am the owner of record of the named property, or that the proposed work is authorized by the owner or record and that I have been authorized by the owner to make this application as his authorized agent and I agree to conform to all applicable laws of this jurisdiction. In addition, if a permit for work described in the application issued, I certify that the code official's authorized representative shall have the authority to enter all areas covered by such permit at any reasonable hour to enforce the provisions of the code(s) applicable to such permit

Signature of Applicant: *David H. Cook*
David H. Cook
ADDRESS _____

26 Oct 94
DATE: _____ PHONE: _____

RESPONSIBLE PERSON IN CHARGE OF WORK, IT'S _____

White-Permit Desk Green-Assessor's Canary-D.P.W. Pink-Public File Ivory Card-Inspector

- Zoning Approval: *[Signature]*
- Special Zoning or Reviews:
- Shoreland
 - Wetland
 - Flood Zone
 - Subdivision
 - Site Plan Major Minor Other
- Zoning Appeal:
- Variance
 - Miscellaneous
 - Conditional Use
 - Interpretation
 - Approved
 - Denied
- Historic Preservation:
- Not in District or Landmark
 - Does Not Require Review
 - Requires Review
- Action:
- Approved
 - Approved with Conditions
 - Denied
- Date: *27 Oct 94*

CEO DISTRICT **4**
M. Cook

I. GENERAL INFORMATION

Location/address of construction 1000 Brighton Avenue
 1. Owner's name Forest City Chevrolet Tel 774-5971
 Address _____
 2. Lessee's name _____ Tel _____
 Address _____ # 645
 3. Contractor's name Les Wilson & Sons Tel. 854-4583
 Address: 161 Warren Avenue, Westbrook, 04092
 4. Is this a legally recorded lot? yes X no _____

JUN 16 1987
 City Of Portland

II. DESCRIPTION OF WORK:

changing 300 gal. above ground gasoline tank to 1,000 gal. above ground tank

permit sent to P.O. Box 3564 Portland 04104
 Forest City Chevrolet ATTN: Bill Howe

III. BUILDING DIMENSIONS: length _____ width _____ square footage _____ height _____ #stories _____

IV. ZONE _____ Street frontage _____ Zoning board approval no yes date _____
 Setbacks: front _____ back _____ side _____ side _____ Planning board approval no yes date _____

V. REVIEW REQUIRED: variance _____ other _____ Number of off-street parking spaces:
 site plan _____ subdivision _____ shore _____ floodplain mgmt _____ enclosed _____ outdoors _____

VI. FEES:
 Base fee _____ other fees _____
 subdivision fee _____ late fee _____
 site plan review fee _____ TOTAL 835.00

VII. DETAILS OF WORK

1. WATER SUPPLY: <input type="checkbox"/> public <input type="checkbox"/> private	7. ELECTRICAL: service entrance size _____ # smoke detectors _____	8. CHIMNEY: # flues _____ material _____ # fireplaces _____
2. SEWER: <input type="checkbox"/> public <input type="checkbox"/> private; type _____	9. FRAMING: floor joists _____ size _____ max on center _____ ceiling joists _____ rafters _____ studs _____ wall studs _____	
3. HEAT: type _____ fuel _____	10. If 1-story building w/masonry walls: - wall thickness _____ height _____	11. BEDROOM WINDOWS height _____ width _____ all height egress window? yes <input type="checkbox"/> no <input type="checkbox"/>
4. FOUNDATION: type _____ thickness _____ footing _____		
5. ROOF: type _____ pitch _____ cover _____ load _____		
6. PLUMBING: - SPRINKLER SYSTEM? yes <input type="checkbox"/> no <input type="checkbox"/>		

VIII. OFFICE USE: TAX MAP # _____ LOT # _____ VALUE/STRUCTURE _____ PERMIT EXPIRATION _____	IX. NEW OR PHASED SUBDIVISION REFERENCE: Name _____ Block _____
---	---

X. CODES: <input checked="" type="checkbox"/> Residential <input type="checkbox"/> Commercial <input type="checkbox"/> Seasonal <input type="checkbox"/> Condominium <input type="checkbox"/> Apartment
XI. PROPOSED USE _____
XII. PAST USE _____
XIII. OWNERSHIP: PUBLIC _____ PRIVATE _____
XIV. EST. CONSTRUCTION COST: <u>1,000</u>
XV. GR. SQ. FT. OF LOT: _____ BUILDING _____

COMPLETE XV AND XVI ONLY IF THE NUMBER OF UNITS WILL CHANGE

XV. RESIDENTIAL BUILDINGS ONLY: # NEW DWELLING UNITS WITH: _____ # EXISTING DWELLING UNITS WITH: _____	# BEDROOMS: 1: BDRM _____ 2: BDRMS _____ 3: BDRMS _____	XVI. # RESIDENTIAL UNITS: # NEW DWELLINGS _____ # EXISTING DWELLINGS _____ TOTAL RESIDENTIAL UNITS _____
--	--	---

APPROVALS BY: _____ DATE _____ BUILDING INSPECTION - PLAN EXAMINER _____ ZONING: _____ C.E.O. _____ FIRE DEPT _____	MISCELLANEOUS: Will work require disturbing of any tree on a public street? _____ Will there be in charge of the above work a person competent to see that the State and City requirements pertaining thereto are observed? _____
---	---

NOTE TO APPLICANT: Separate permits are required by the installers and subcontractors of heating, plumbing, electrical and mechanicals.

District No. _____	XVII. SIGNATURE OF APPLICANT: <u>Bill Howe</u> PHONE # <u>774-5971</u>
	TYPE NAME OF ABOVE: <u>Bill Howe, Forest City Chevrolet</u>

White - GPCOG Green - Applicant Yellow - Assessor Pink - Office File Gold - Field Inspector

City of Portland, Maine - Building or Use Permit Application 389 Congress Street, 04101, Tel: (207) 874-8703 FAX: 874-8716

Location of Construction 1000 Brighton Ave.		Owner Forest City Chev.		Phone: 774-5971	
Owner Address same		Leasee/Buyer's Name		Business Name	
Contractor Name Allied Const.		Address P.O. Box 1396 Portland 04104		Phone: 772-2888	
Past Use retail sales		Proposed Use Service Bay retail sales with two additions		COST OF WORK: \$ 100,000	
Proposed Project Description To construct service bay addition as per two sets of plans		FIRE DEPT. <input checked="" type="checkbox"/> Approved <input type="checkbox"/> Denied		PERMIT FEE: \$ 520.00	
		Signature: <i>[Signature]</i>		INSPECTION: Use Group <i>SI</i> Type <i>FD</i>	
		Signature: <i>[Signature]</i>		Signature: <i>[Signature]</i>	

Permit No. **41177**

Permit Issued:
PERMIT ISSUED
OCT 27 1994

Zoning Approval
CITY OF PORTLAND

Special Use or Reviews:
 Shoreland
 Wetland
 Flood Zone
 Subdivisor
 Site Plan major minor mm

Permit Taken By **LATINI** Date Applied For **10/24/94**

- This permit application doesn't preclude the Applicant(s) from meeting applicable State and Federal rules
- Building permits do not include plumbing, septic or electrical work
- Building permits are void if work is not started within six (6) months of the date of issuance. False information may invalidate a building permit and stop all work

Zoning Appeal

Variance
 Miscellaneous
 Conditional Use
 Interpretation
 Approved
 Denied

Dump permits purchased at time of foundation permits applied for.

Permits go to Allied construction--address above

PERMIT ISSUED WITH LETTER

CERTIFICATION

I hereby certify that I am the owner of record of the named property, or that the proposed work is authorized by the owner of record and that I have been authorized by the owner to make this application as his authorized agent and I agree to conform to all applicable laws of this jurisdiction. In addition, if a permit for work described in the application issued, I certify that the code official's authorized representative shall have the authority to enter all areas covered by such permit at any reasonable hour to enforce the provisions of the code(s) applicable to such permit

SIGNATURE OF APPLICANT: *[Signature]* ADDRESS: DATE: 10/24/94 PHONE: 772-2888

RESPONSIBLE PERSON IN CHARGE OF WORK, TITLE: PHONE: **CEO DISTRICT 4**
M.A. Carroll

White-Permit Desk Green-Assessor's Canary-D.P.W. Pink-Public File Ivory Card-Inspector

City of Portland, Maine - Building or Use Permit Application 389 Congress Street, 04101, Tel: (207) 874-8705, FAX: 874-8716

Location of Construction 1000 Brighton Ave		Owner Forest City Chevrolet	Phone	Permit No: 941115
Owner Address		Leasee/Buyer's Name	Phone	Business Name
Contractor Name		Address		Phone
Past Use Retail Sales	Proposed Use Retail Sales w/2 Additions	COST OF WORK: \$ 25,000 - \$145	PERMIT FEE: \$ 500.	Permit Issued: PERMIT ISSUED SEP 17 1994 CITY OF PORTLAND
Proposed Project Description: Construct 2 additions totalling XXXXXXX 7,755 sq ft construct foundation 9/21/94		FIRE DEPT. <input type="checkbox"/> Approved <input type="checkbox"/> Denied	INSPECTION: Use Group: Type	
		Signature: <i>[Signature]</i>	Signature: <i>[Signature]</i>	Zoning Approval <i>[Signature]</i>
		PEDESTRIAN ACTIVITIES DISTRICT (P.U.D.)		Special Zone or Reviews: <input type="checkbox"/> Shoreland <input type="checkbox"/> Wetland <input type="checkbox"/> Flood Zone <input type="checkbox"/> Subdivision <input type="checkbox"/> Site Plan <input type="checkbox"/> major <input type="checkbox"/> minor <input type="checkbox"/> mm <input type="checkbox"/>
		Action: Approved <input type="checkbox"/> Approved with Conditions <input type="checkbox"/> Denied <input type="checkbox"/>	Date	Zoning Appeal <input type="checkbox"/> Variance <input type="checkbox"/> Miscellaneous <input type="checkbox"/> Conditional Use <input type="checkbox"/> Interpretation <input type="checkbox"/> Approved <input type="checkbox"/> Denied

- 1 This permit application doesn't preclude the Applicant(s) from meeting applicable State and Federal rules
- 2 Building permits do not include plumbing, septic or electrical work.
- 3 Building permits are void if work is not started within six (6) months of the date of issuance. False information may invalidate a building permit and stop all work. *****CONSTRUCT FOUNDATION ONLY*****

Mail fndn prmt; Allied Construction Co.
P O Box 1396
Portland, ME 04104

L Chase
9/21/94

CERTIFICATION

I hereby certify that I am the owner of record of the named property, or that the proposed work is authorized by the owner of record and that I have been authorized by the owner to make this application as his authorized agent and I agree to conform to all applicable laws of this jurisdiction. In addition, if a permit for work described in the application issued, I certify that the code official's authorized representative shall have the authority to enter all areas covered by such permit at any reasonable hour to enforce the provisions of the code(s) applicable to such permit

SIGNATURE OF APPLICANT <i>[Signature]</i>	Shawn Frank	ADDRESS:	13 Sept '94	DATE:	PHONE:
RESPONSIBLE PERSON IN CHARGE OF WORK, TITLE <i>[Signature]</i>	David Cook, Allied		13 Oct 94		PHONE:

Action:
 Approved
 Approved with Conditions
 Denied

Date: *10/13/94*

CEO DISTRICT **4**
M.A. Carroll

White-Permit Desk Green-Assessor's Canary-D.P.W. Pink-Public File Ivory Card-Inspector

Permit No. 86190

Location: 1008 Budget Lane

Owner: Billings - Sanders

Date of permit: 1-1-86

Approved: H 30-86

Dwelling: 2 in 1 spray booth

Garage: _____

Alteration: _____

NOTES

Large ruled area for notes, divided into two columns by a vertical line.

FOREST CITY CHEVROLET, INC.

PASSENGER CAR SHOP

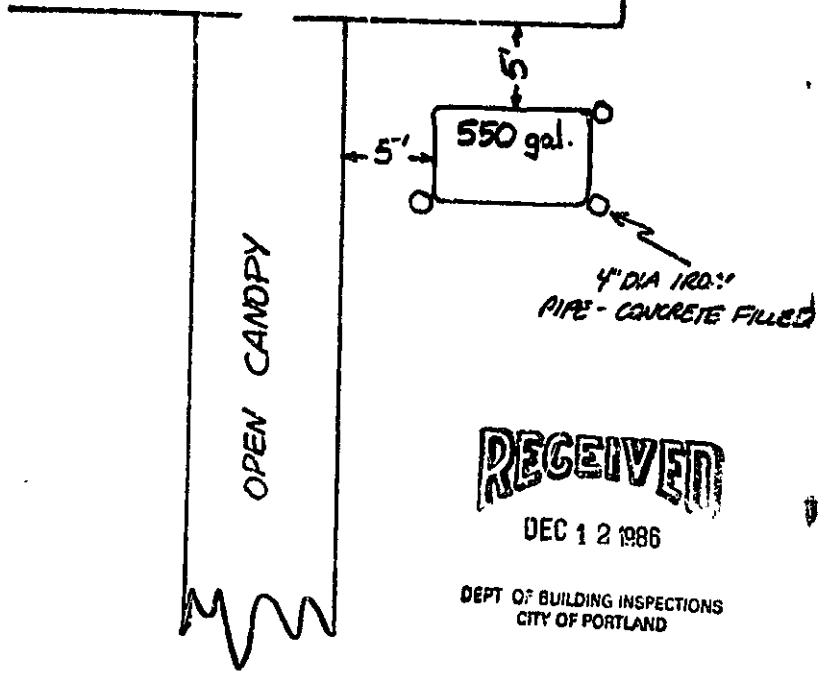

RECEIVED

DEC 12 1986

DEPT OF BUILDING INSPECTIONS
CITY OF PORTLAND

APPLICATION FOR PERMIT

PERMIT ISSUED

B.O.C.A. USE GROUP

B.O.C.A. TYPE OF CONSTRUCTION

001779

DEC 18 1986

ZONING LOCATION

PORTLAND, MAINE December, 12, 1986

City Of Portland

To the CHIEF OF BUILDING & INSPECTION SERVICES, PORTLAND, MAINE

The undersigned hereby applies for a permit to erect, alter, repair, demolish, move or install the following building, structure, equipment or change use in accordance with the Laws of the State of Maine, the Portland B.O.C.A. Building Code and Zoning Ordinance of the City of Portland with plans and specifications, if any, submitted herewith and the following specifications:

LOCATION 1000 Brighton Avenue Fire District #1 #2

1 Owner's name and address Forest City Chev, Inc., 1000 Brighton Ave. Telephone 774-5971

2 Lessee's name and address Telephone

3 Contractor's name and address Les A Wilson and Sons Telephone 854-4583
Warren Avenue Westbrook, Maine

Proposed use of building No. of sheets

Last use No. families

Material No. stories Heat Structure Roof Roofing

Other buildings on same lot

Estimated contractual cost \$ Appeal Fees \$

FIELD INSPECTOR--Mr @ 775-5451 Base Fee

Late Fee

Install 1-550 gallon above ground gasoline storage tank. TOTAL \$ 35.00

To be used in vehicles

As per plan

Permit #1 Stamp of Special Conditions

NOTE TO APPLICANT: Separate permits are required by the installers and subcontractors of heating, plumbing, electrical and mechanicals

DETAILS OF NEW WORK

Is any plumbing involved in this work? Is any electrical work involved in this work?

Is correction to be made to public sewer? If not, what is proposed for sewage?

Has septic tank notice been sent? Form notice sent?

Height average grade to top of plate Height average grade to highest point of roof

Size, front depth No. stories solid or filled land? earth or rock?

Material of foundation Thickness, top bottom cellar

Kind of roof Rise per foot Roof covering

No. of chimneys Material of chimneys of lining Kind of heat fuel

Framing Lumber--Kind Dressed or full size? Corner posts Sills

Size of order Columns under girders Size Max. on centers

Studs (outside walls and carrying partitions) 2x4-16" O. C Bridging in every floor and flat roof span over 8 feet

Joists and rafters 1st floor 2nd 3rd roof

On centers 1st floor 2nd 3rd roof

Maximum span 1st floor 2nd 3rd roof

If on story building with masonry walls, thickness of walls? height?

IF A GARAGE

Number cars to be accommodated on same lot to be accommodated Number commercial cars to be accommodated

Will automobile repairing be done other than minor repairs to cars habitually stored in the proposed garage?

APPROVALS BY DATE MISCELLANEOUS

BUILDING INSPECTION--PLAN EXAMINER Will work require disturbing of any tree on a public street? No

ZONING

BUILDING CODE Will there be in charge of the above work a person competent to see that the State and City requirements pertaining thereto are observed? Yes

Health Dept

City

Signature of Applicant William Hows for Forest City Chev Phone # 774-5971

Type Name of above William Hows for Forest City Chev 10 20 30 10

Other and Address

FIELD INSPECTOR'S COPY [Signature]

APPLICANT'S COPY

OFFICE FILE COPY

NOTES

Handwritten notes area with horizontal lines.

Large handwritten notes area on the left side of the page with horizontal lines.

Large handwritten notes area on the right side of the page with horizontal lines.

Permit No. 861-1279
Location 1920 25th St NW
Owner 1st City Chevrolet
Date of permit 12-12-86
Approved 12-18-86
Inspected positive tanks
Garage _____
Alteration _____

APPLICATION FOR PERMIT 001708 PERMIT ISSUED

B.O.C.A. USE GROUP
 B.O.C.A. TYPE OF CONSTRUCTION

DEC 2 1988
 City Of Portland

ZONING LOCATION PORTLAND, MAINE November 25, 1988

To the CHIEF OF BUILDING & INSPECTION SERVICES, PORTLAND, MAINE

The undersigned hereby applies for a permit to erect, alter, repair, demolish, move or install the following building, structure, equipment or change use in accordance with the Laws of the State of Maine, the Portland B.O.C.A. Building Code and Zoning Ordinance of the City of Portland with plans and specifications, if any, submitted herewith and the following specifications:

LOCATION ... 1000 Brighton Avenue, Portland, Maine Fire District #1 , #2

1. Owner's name and address Philip Gemner, Rt. 88 Cumberland Foreside Telephone 781-5176

2. Lessee's name and address Telephone 854-4581

3. Contractor's name and address Les Wilson and Sons, Warren Ave., Westbrook, Maine 04092 Telephone

Proposed use of building No. of sheets

Last use No. families

Material No. stories Heat Style of roof Roofing

Other buildings on same lot

Estimated contractor's cost \$ Appeal Fees \$

FIELD INSPECTOR—Mr @ 775 5451 Base Fee

To remove 2-4000 gal. Gasoline Storage Tanks (Underground) Late Fee

TOTAL \$.. 20.00

Stamp of Special Conditions

NOTE TO APPLICANT: Separate permits are required by the installers and subcontractors of heating, plumbing, electrical and mechanicals

DETAILS OF NEW WORK

Is any plumbing involved in this work? Is any electrical work involved in this work?

If connection to be made to public sewer? If not, what is proposed for sewage?

Has septic tank notice been sent? Form notice sent?

Height average grade to top of plate Height average grade to highest point of roof

Size, front depth No. stories solid or filled (sand)? earth or rock?

Material of foundation Thickness, top bottom cellar

Kind of roof Rise per foot Roof covering

No. of chimneys Material of chimneys of lining Kind of heat fuel

Framing Lumber— Kind Dressed or full size? Corner posts Sills

Size Girder Columns under girders Size Max on centers

Studs (outside walls and carrying partitions) 2x4-16" O.C. Blocking in every floor and flat roof span over 8 feet

Joists and rafters 1st floor 2nd 3rd roof

On centers 1st floor 2nd 3rd roof

Maximum span 1st floor 2nd 3rd roof

If one story building with masonry walls thickness of walls? height?

IF A GARAGE

No. cars now accommodated on same lot to be accommodated number commercial cars to be accommodated

Will automobile repairing be done other than minor repairs to cars habitually stored in the proposed building?

APPROVALS BY **DATE**

BUILDING INSPECTION—PLAN EXAMINER
 ZONING
 BUILDING CODE
 Fire Dept. *James P. Collins, Chief*
 Health Dept.
 Other

MISCELLANEOUS

Will work require disturbing of any tree on a public street?

Will there be a charge of the above work a person competent to see that the State and City requirements pertaining thereto are observed? \$25

Signature of Applicant *William Howe* Phone # 774-5971

Type Name of above William Howe

Other and Address

Permit No

8611708

Location

1000 Brighton ave.

Owner

Philip Brennan

Date of permit

12-2-86

App. used

Facilities

Controls

Allegation

NOTES

Notes section with horizontal lines.

Main notes section with horizontal lines, divided into two columns by a vertical line.

May 28, 1987

PERMIT BUILDING PERMIT APPLICATION **Portland** Previous permit: #

APPLICANT FILL OUT I - VIII AND DETAILS OF WORK ON REVERSE
0 647 Please Insert N/A (not applicable) for any item not pertaining to your request

I. GENERAL INFORMATION

Location/address of construction 1000 Brighton Ave.
Owner or lessee's name Philip Gemmer / Forest City Chevrolet Tel. 774-5971
Address Same

Contractor's name Les Wilson and Sons Tel. 854-4583
Address 161 Warren Avenue

Subcontractors:

PERMIT ISSUED

JUN 8 1987

City Of Portland

II. NEW SUBDIVISION OR EXISTING LOT REFERENCE	
Name	
Lot	
Block	
Bk & pg	Rec'd
Deeds	
Data recorded	

III. PROPOSED USE	CODE: If other, explain	Seasonal	Condominium	Apartment
IV. PAST USE				
V. OWNERSHIP	PUBLIC (Federal, State, local government)	PRIVATE (Individual/corp/nonprofit)		

VI. DESCRIPTION OF WORK:

to remove 2 4000 gallon oil storage tanks and replacing / (underground)
installing 2 1900 gallon above ground oil storage tanks

VII. BUILDING DIMENSIONS: length _____ width _____ square footage _____ height _____ #stories _____

VIII. EST. CONSTRUCTION COST: \$ _____ IX. GR. SQ. FT. OF LAND: _____ BUILDING _____

X. RESIDENTIAL BUILDINGS ONLY	BEDROOMS	XI. RESIDENTIAL UNITS
NEW DWELLING UNITS WITH	2 BDRMS 3 BDRMS	NEW DWELLING
EXISTING DWELLING UNITS WITH		EXISTING DWELLINGS
		NET RESIDENTIAL UNITS

XII. SIGNATURE OF APPLICANT: William G. ... DATE: 5/28/87

DO NOT WRITE BELOW THIS LINE

XIII. ZONING:

DISTRICT _____ STREET FRONTAGE _____
SETBACKS: front _____ back _____ side _____ side _____
ZONING BOARD APPROVAL: no yes (date) _____
PLANNING BOARD APPROVAL: no yes (date) _____

XIV. OFFICE USE
TAX MAP
LOT
VALUE/STRUCTURE
PERMIT EXPIRATION

XV. CONDITIONAL USE: variance _____ site plan _____ subdivision _____ shore and floodplain mgmt _____
special exception _____ other _____ (explain) _____

XVI. SIGNATURE OF FIELD INSPECTOR (CEO) _____ DATE _____

XVII. FEES:

base fee...
subdivision fee...
site plan review fee...
other fees...
late fee...
TOTAL... 70.00

XVIII. SPACE FOR FIGURES / ADDITIONAL COMMENTS:

James V. Callins, Chief

1. WATER SUPPLY <input type="checkbox"/> public <input type="checkbox"/> private	8. CHIMNEY * flues * fireplaces material
2. SEWER <input type="checkbox"/> public <input type="checkbox"/> private, type	9. FRAMING: floor joists
3. HEAT type _____ fuel _____	size _____ max on centers _____
4. FOUNDATION type _____ thickness _____ footing _____	ceiling joists _____
5. DRAIN type _____ coating _____	rafters _____
6. PLUMBING * tubs * showers * lavatories * laundry tubs * flushes * other	clads _____
SPLITTER SYSTEM? <input type="checkbox"/> yes <input type="checkbox"/> no	wall studs _____
7. ELECTRICAL service entrance size _____ * smoke detectors _____	10. If 1-story building w/ masonry walls wall thickness _____ height _____
NUMBER OF OFF-STREET PARKING SPACES: enclosed _____ outdoors _____	11. BEDROOM WINDOWS height _____ width _____ sill height _____ egress window? <input type="checkbox"/> yes <input type="checkbox"/> no

PLOT PLAN/DETAILS OF WORK ON REVERSE

Pink - Tax Assessor
Gold - GPCUG

2 MB CAIROL

City of Portland, Maine - Building or Use Permit Application 389 Congress Street, 04101, Tel: (207) 874-8703, FAX: 874-8716

Location of Construction 1000 Brighton Ave.		Owner Forest City Chevrolet Inc	Phone 04243	Permit No: 941272
Owner Address 1000 Brighton Ave- Ptd, ME		Leasee/Buyer's Name 04102	Business Name	
Contractor Name: sprinkler Systems, Inc		Address P O Box 1285 - Lewiston ME	Phone 04243 782-0104	Permit Issued: PERMIT ISSUED DEC - 7 1994
Past Use: retail car sales	Proposed Use: retail car sales sprinkler system	COST OF WORK: \$ 5,000	PERMIT FEE: \$ 45	CITY OF PORTLAND Zoning Approval: <i>[Signature]</i> Special Zone or Reviews: <input type="checkbox"/> Shoreland <input type="checkbox"/> Wetland <input type="checkbox"/> Flood Zone <input type="checkbox"/> Subdivision <input type="checkbox"/> Site Plan major <input type="checkbox"/> minor <input type="checkbox"/> mm <input type="checkbox"/>
		FIRE DEPT <input checked="" type="checkbox"/> Approved <input type="checkbox"/> Denied	INSPECTION: Use Group <i>U</i> Type <i>000493</i>	
Proposed Project Description: install sprinkler system		Signature <i>[Signature]</i>	Signature <i>[Signature]</i>	
Permit Taken By L Chase	Date Applied For 12/1/94	PEDESTRIAN ACTIVITIES DISTRICT (P.A.D.) Action Approved <input type="checkbox"/> Approved with Conditions <input type="checkbox"/> Denied <input type="checkbox"/>	Signature	Date

1. This permit application doesn't preclude the Applicant(s) from meeting applicable State and Federal rules.
2. Building permits do not include plumbing, septic or electrical work.
3. Building permits are void if work is not started within six (6) months of the date of issuance. False information may invalidate a building permit and stop all work.

Zoning Appeal

Variance
 Miscellaneous
 Conditional Use
 Interpretation
 Approved
 Denied

Historic Preservation

Not in District or Landmark
 Does Not Require Review
 Requires Review

Action:

Approved
 Approved with Conditions
 Denied

Date: *12/2/94*

[Signature]

CERTIFICATION

I hereby certify that I am the owner of record of the named property, or that the proposed work is authorized by the owner of record and that I have been authorized by the owner to make this application as his authorized agent and I agree to conform to all applicable laws of this jurisdiction. In addition, if a permit for work described in the application issued, I certify that the code official's authorized representative shall have the authority to enter all areas covered by such permit at any reasonable hour to enforce the provisions of the code(s) applicable to such permit.

SIGNATURE OF APPLICANT: *[Signature]* ADDRESS: _____ DATE: *12/1/94* PHONE: _____

RESPONSIBLE PERSON IN CHARGE OF WORK, TITLE: _____ PHONE: _____

White-Permit Desk Green-Assessor's Canary-D.P.W Pink-Public File Ivory Card-Inspector

CEO DISTRICT **4**
[Signature]



APPLICATION FOR PERMIT
DEPARTMENT OF BUILDING INSPECTIONS SERVICES
ELECTRICAL INSTALLATIONS

Date 8 Nov 94, 19____
 Receipt and Permit number 3604

To the CHIEF ELECTRICAL INSPECTOR, Portland, Maine:

The undersigned hereby applies for a permit to make electrical installations in accordance with the laws of Maine, the Portland Electrical Ordinance, the National Electrical Code and the following specifications:

LOCATION OF WORK: 1000 Brighton Ave
 OWNER'S NAME: Forest City Chevy ADDRESS: _____

	FEES
OUTLETS:	
Receptacles <u>15</u> Switches <u>4</u> Plugmold _____ ft. TOTAL _____	1.80
FIXTURES: (number of)	
Incandescent _____ Flourescent _____ (not strip) TOTAL <u>30</u>	6.00
Strip Flourescent _____ ft. _____	
SERVICES:	
Overhead _____ Underground _____ Temporary _____ TOTAL amperes _____	
METERS: (number of) _____	
MOTORS: (number of)	
Fractional <u>4</u> _____	8.00
1 HP or over _____	
RESIDENTIAL HEATING:	
Oil or Gas (number of units) _____	
Electric (number of rooms) _____	
COMMERCIAL OR INDUSTRIAL HEATING:	
Oil or Gas (by a main boiler) _____	
Oil or Gas (by separate units) _____	
Electric Under 20 kws _____ Over 20 kws _____	
APPLIANCES: (number of)	
Ranges _____	Water Heaters _____
Cook Tops _____	Disposals _____
Wall Ovens _____	Dishwashers _____
Dryers _____	Compactors _____
Fans _____	Others (denote) _____
TOTAL _____	
MISCELLANEOUS: (number of)	
Branch Panels _____	
Transformers _____	
Air Conditioners Central Unit _____	
Separate Units (windows) _____	
Signs 20 sq. ft. and under _____	
Over 20 sq. ft. _____	
Swimming Pools Above Ground _____	
In Ground _____	
Fire/Burglar Alarms Residential _____	
Commercial _____	
Heavy Duty Outlets, 220 Volt (such as welders) 30 amps and under _____	
over 30 amps _____	
Circus, Fairs, etc. _____	
Alterations to wires _____	
Repairs after fire _____	
Emergency Lights, battery <u>4</u> _____	4.00
Emergency Generators _____	
	INSTALLATION FEE DUE: _____
	DOUBLE FEE DUE: _____
	TOTAL AMOUNT DUE: 19.80

INSPECTION:

Will be ready on _____, 19____; or Will Call _____

CONTRACTOR'S NAME: Brian Milliken
 ADDRESS: 203 Anderson Ptld
 TEL: 879-1877
 MASTER LICENSE NO.: 3604 SIGNATURE OF CONTRACTOR: Brian H. Milliken
 LIMITED LICENSE NO.: _____

INSPECTOR'S COPY -- WHITE
 OFFICE COPY -- CANARY
 CONTRACTOR'S COPY -- GREEN



APPLICATION FOR PERMIT
DEPARTMENT OF BUILDING INSPECTIONS SERVICES
ELECTRICAL INSTALLATIONS

Date 1/26/95, 1995
 Receipt and Permit number 3604

To the CHIEF ELECTRICAL INSPECTOR, Portland, Maine:

The undersigned hereby applies for a permit to make electrical installations in accordance with the laws of Maine, the Portland Electrical Ordinance, the National Electrical Code and the following specifications:

LOCATION OF WORK: XXXX 1000 Brighton Ave
 OWNER'S NAME: Forest City Chevrolet ADDRESS: _____

	FEES
OUTLETS:	
Receptacles <u>48</u> Switches <u>30</u> Plugmold _____ ft. TOTAL <u>78</u>	15.60
FIXTURES: (number of)	
Incandescent _____ Fluorescent <u>88</u> (not strip) TOTAL <u>88</u>	17.60
Strip Fluorescent _____ ft.	
SERVICES:	
Overhead _____ Underground _____ Temporary _____ TOTAL amperes _____ ..	
METERS: (number of)	
MOTORS: (number of)	
Fractional _____	
1 HP or over <u>2</u>	4.00
RESIDENTIAL HEATING:	
Oil or Gas (number of units) _____	
Electric (number of rooms) _____	
COMMERCIAL OR INDUSTRIAL HEATING:	
Oil or Gas (by a main boiler) _____	
Oil or Gas (by separate units) _____	
Electric Under 20 kws _____ Over 20 kws _____	
APPLIANCES: (number of)	
Ranges _____ Water Heaters _____	
Cook Tops _____ Disposals _____	
Wall Ovens _____ Dishwashers _____	
Dryers _____ Compactors _____	
Fans _____ Others (denote) _____	
TOTAL	
MISCELLANEOUS: (number of)	
Branch Panels <u>1</u>	4.00
Transformers _____	
Air Conditioners Central Unit _____	
Separate Units (windows) _____	
Signs 20 sq. ft. and under _____	
Over 20 sq. ft. _____	
Swimming Pools Above Ground _____	
In Ground _____	
Fire/Burglar Alarms Residential _____	
Commercial _____	
Heavy Duty Outlets, 220 Volt (such as welders) 30 amps and under _____	
over 30 amps _____	
Circus, Fairs, etc. _____	
Alterations to wires _____	
Repairs after fire _____	
Emergency Lights, battery _____	
Emergency Generators _____	
INSTALLATION FEE DUE:	
FOR ADDITIONAL WORK NOT ON ORIGINAL PERMIT DOUBLE FEE DUE:	
FOR REMOVAL OF A "STOP ORDER" (304-16.b)	
TOTAL AMOUNT DUE:	<u>41.20</u>

INSPECTION:

Will be ready on _____, 1995; or Will Call x

CONTRACTOR'S NAME: H B Milliken Co

ADDRESS: Ptld, ME

TEL: 879-1877

MASTER LICENSE NO.: Brian Milliken SIGNATURE OF CONTRACTOR:

EXPIRED LICENSE NO.: _____ #3604 Brian Milliken

INSPECTOR'S COPY — WHITE
 OFFICE COPY — CANARY
 CONTRACTOR'S COPY — GREEN

City of Portland, Maine – Building or Use Permit Application 389 Congress Street, 04101, Tel: (207) 874-8703, FAX: 874-8716

Location of Construction 1000 Brighton Ave		Owner Forest City Chevrolet	Phone 774-5971	Permit No. 950390
Owner Address P.O. Box 3564 Portland, ME 04104		Leasee/Buyer's Name	Phone	Business Name
Contractor Name		Address		Phone
Past Use: Auto Sales	Proposed Use Same	COST OF WORK: \$	PERMIT FEE: \$ 35.00	<div style="border: 2px solid black; padding: 5px; text-align: center;"> PERMIT ISSUED Permit Issued: APR 27 1995 CITY OF PORTLAND </div>
Proposed Project Description Erect Tent till 29 Apr 95		FIRE DEPT. <input checked="" type="checkbox"/> Approved <input type="checkbox"/> Denied Signature: <i>[Signature]</i>	INSPECTION: <i>4</i> Use Group Type MOCA 93 Signature: <i>[Signature]</i>	
		PEDESTRIAN ACTIVITIES DISTRICT (off. d.) Action: <input type="checkbox"/> Approved <input type="checkbox"/> Approved with Conditions <input type="checkbox"/> Denied Signature: _____ Date: _____	Zoning: CBL: 263-B-043 Zoning Approval: <i>OK us 4/25/95</i> Special Zone or Reviews: <input type="checkbox"/> Shoreland <input type="checkbox"/> Wetland <input type="checkbox"/> Flood Zone <input type="checkbox"/> Subdivision <input type="checkbox"/> Site Plan major <input type="checkbox"/> minor <input type="checkbox"/> mm <input type="checkbox"/>	
Permit Taken By: Mary Gresik	Date Applied For: 24 April 1995			

- This permit application doesn't preclude the Applicant(s) from meeting applicable State and Federal rules
- Building permits do not include plumbing, septic or electrical work
- Building permits are void if work is not started within six (6) months of the date of issuance. False information may invalidate a building permit and stop all work

Zoning Appeal

Variance
 Miscellaneous
 Conditional Use
 Interpretation
 Approved
 Denied

Historic Preservation

Not in District or Landmark
 Does Not Require Review
 Requires Review

CERTIFICATION

I hereby certify that I am the owner of record of the named property, or that the proposed work is authorized by the owner of record and that I have been authorized by the owner to make this application as his authorized agent and I agree to conform to all applicable laws of this jurisdiction. In addition, if a permit for work described in the application issued, I certify that the code official's authorized representative shall have the authority to enter all areas covered by such permit at any reasonable hour to enforce the provisions of the code(s) applicable to such permit

[Signature]
 SIGNATURE OF APPLICANT: Ken Clark ADDRESS: _____ DATE: 24 April 1995 PHONE: _____

RESPONSIBLE PERSON IN CHARGE OF WORK, TITLE: _____ PHONE: _____

Action:

Approved
 Approved with Conditions
 Denied

Date: *[Signature]*

CEO DISTRICT **4**
[Signature]
 K. Carroll

City of Portland, Maine - Building or Use Permit Application 389 Congress Street, 04101, Tel: (207) 874-8703, FAX: 874-8716

Location of Construction: 1000 Brighton Ave.		Owner Forest City Chev.		Phone 774-5971		Permit No. 950614
Owner Address: P.O. Box 3564 Portland 04104		Leasee/Buyer's Name		Phone		
Contractor Name: Signature Sign		Address P. O. Box 1023 Portland 04104		Phone 883-2500		Permit Issued: ZONE: B-2 CBL: 263-B-043 Zoning Approval <i>ok us</i> ACT. <i>22-23 6/14/95</i> Special Zone or Reviews: <input type="checkbox"/> Shoreland <input type="checkbox"/> Wetland <input type="checkbox"/> Flood Zone <input type="checkbox"/> Subdivision <input type="checkbox"/> Site Plan <input type="checkbox"/> major <input type="checkbox"/> minor <input type="checkbox"/> mm <input type="checkbox"/>
Past Use: Car sales		Proposed Use: same with sign		COST OF WORK: \$ FIRE DEPT. <input type="checkbox"/> Approved <input type="checkbox"/> Denied INSPECTION: <i>598</i> Use Group Type Signature: <i>BOCAPP Afflu</i>		
Proposed Project Description: to erect 34' X 33" sign as per plan		PEDESTRIAN ACTIVITIES DISTRICT (P.A.D.) Action: <input type="checkbox"/> Approved <input type="checkbox"/> Approved with Conditions <input type="checkbox"/> Denied Signature: _____ Date: _____				
Permit Taken By: LATINI		Date Applied For: 6/9/95				

- This permit application does not preclude the Applicant(s) from meeting applicable State and Federal rules
- Building permits do not include plumbing, septic or electrical work
- Building permits are void if work is not started within six (6) months of the date of issuance. False information may invalidate a building permit and stop all work

UL # E157042M
Submitted insurance-drawing-

CERTIFICATION

I hereby certify that I am the owner of record of the named property, or that the proposed work is authorized by the owner of record and that I have been authorized by the owner to make this application as his authorized agent and I agree to conform to all applicable laws of this jurisdiction. In addition, if a permit for work described in the application issued, I certify that the code officials authorized representative shall have the authority to enter all areas covered by such permit at any reasonable hour to enforce the provisions of the code(s) applicable to such permit.

SIGNATURE OF APPLICANT: *[Signature]* ADDRESS: *12 Franklin Rd. Scarborough* DATE: *6/9/95* PHONE: *883-2500*

RESPONSIBLE PERSON IN CHARGE OF WORK, TITLE: _____ PHONE: _____

White-Permit Desk Green-Assessor's Canary-D.P.W. Pink-Public File Ivory Card-Inspector

Action:
 Approved
 Approved with Conditions
 Denied
 Date: *6/15/95*
[Signature]
 CEO DISTRICT **4**
K. Carroll

City of Portland, Maine - Building or Use Permit Application 389 Congress Street, 04101, Tel: (207) 874-8703, FAX: 874-8716

950529

Location of Construction 1000 Brighton Ave		Owner Forest City Chevrolet		Phone		Permit No.	
Owner Address		Lessee/Buyer's Name		Phone		Business Name	
Contractor Name Allied Construction		Address 208 Fore St Portland, ME 04101		Phone 772-2888		PERMIT ISSUED MAY 25 1995	
Proposed Use Retail Sales		Proposed Use Same w/ int Reno		COST OF WORK: \$ 31,000.		PERMIT FEE: \$ 175.00	
Proposed Project Description Make Interior Renovations as per plans		FIRE DEPT. <input checked="" type="checkbox"/> Approved <input type="checkbox"/> Denied		INSPECTION: Use Group 3 Type 3B BOCA 93 Signature: [Signature]		Zone: CBL Zoning Approval	
		PEDESTRIAN ACTIVITIES DISTRICT (P.A.D.)		Action		Special Zone or Reviews:	
				Approved <input type="checkbox"/>		<input type="checkbox"/> Shoreland	
				Approved with Conditions <input type="checkbox"/>		<input type="checkbox"/> Wetland	
				Denied <input type="checkbox"/>		<input type="checkbox"/> Flood Zone	
		Signature		Date		<input type="checkbox"/> Subdivision	
Permit Taken By: Mary Gresik		Date Applied For: 23 May 1995				<input type="checkbox"/> Site Plan <input type="checkbox"/> minor <input type="checkbox"/> mm <input type="checkbox"/>	

1. This permit application doesn't preclude the Applicant(s) from meeting applicable State and Federal rules
2. Building permits do not include plumbing, septic or electrical work
3. Building permits are void if work is not started within six (6) months of the date of issuance. False information may invalidate a building permit and stop all work

PERMIT ISSUED WITH LETTER

Zoning Appeal

Variance
 Miscellaneous
 Conditional Use
 Interpretation
 Approved
 Denied

Historic Preservation

Not in District or Landmark
 Does Not Require Review
 Requires Review

Action:

Approved
 Approved with Conditions
 Denied

Date: 5/23/95

[Signature]

CEO DISTRICT 4

[Signature]

CERTIFICATION

I hereby certify that I am the owner of record of the named property, or that the proposed work is authorized by the owner of record and that I have been authorized by the owner to make this application as his authorized agent and I agree to conform to all applicable laws of this jurisdiction. In addition, if a permit for work described in the application issued, I certify that the code official's authorized representative shall have the authority to enter all areas covered by such permit at any reasonable hour to enforce the provisions of the code(s) applicable to such permit

[Signature] 23 May 1995

SIGNATURE OF APPLICANT Paul LaLiberty ADDRESS DATE PHONE

[Signature] RESPONSIBLE PERSON IN CHARGE OF WORK TITLE PHONE

White-Permit Desk Green-Assessor's Canary-D.P.W Pink-Public File Ivory Card-Inspector

City of Portland, Maine - Building or Use Permit Application 389 Congress Street, 04101 Telephone: 877-8703, FAX: 874-8716

Location of Construction: 1000 Brighton Ave		Owner Forest City Chevrolet	Phone 774-5971
Owner Address: SAA Ptld, ME 04102		Leasee/Buyer's Name	Business Name
Contractor Name:		Address	Phone
Past Use: Retail Sales (Vehicles)	Proposed Use: Same w/o Structure	COST OF WORK: \$ 1,000.00	PERMIT FEE: \$ 25.00
Proposed Project Description: Structure to be removed		FIRE DEPT. <input checked="" type="checkbox"/> Approved <input type="checkbox"/> Denied	INSPECTION: Use Group Type
		Signature: <i>[Signature]</i>	Signature:
		PEDESTRIAN ACTIVITIES DISTRICT (P.U.D.)	
		Action	Approved <input type="checkbox"/> Approved with Conditions <input type="checkbox"/> Denied <input type="checkbox"/>
		Signature	Date
Permit Taken By: Mary Gresik	Date Applied For 09 May 1995		

Permit No:
950427

PERMIT ISSUED

MAY 10 1995

CITY OF PORTLAND
263-B-043

Zoning Approval:
[Signature] 5/10/95

Special Zone or Reviews:

- Shoreland
- Wetland
- Flood Zone
- Subdivision
- Site Plan major minor mm

- This permit application doesn't preclude the Applicant(s) from meeting applicable State and Federal rules
- Building permits do not include plumbing, septic or electrical work
- Building permits are void if work is not started within six (6) months of the date of issuance. False information may invalidate a building permit and stop all work

No debris removal necessary - structure to be relocated

Zoning Appeal

- Variance
- Miscellaneous
- Conditional Use
- Interpretation
- Approved
- Denied

Historic Preservation

- Not in District or Landmark
- Does Not Require Review
- Requires Review

Action:

- Approved
- Approved with Conditions
- Denied

Date: *8/10/95*

[Signature]

CEO DISTRICT **4**

K. Carroll

CERTIFICATION

I hereby certify that I am the owner of record of the named property, or that the proposed work is authorized by the owner of record and that I have been authorized by the owner to make this application as his authorized agent and I agree to conform to all applicable laws of this jurisdiction. In addition, if a permit for work described in the application issued, I certify that the code official's authorized representative shall have the authority to enter all areas covered by such permit at any reasonable hour to enforce the provisions of the code(s) applicable to such permit

[Signature] 09 May 1995
SIGNATURE OF APPLICANT Ken Clark ADDRESS DATE PHONE

RESPONSIBLE PERSON IN CHARGE OF WORK, TITLE PHONE

City of Portland, Maine - Building or Use Permit Application 3rd Congress Street, 04101, Tel: (207) 874-8703, FAX: 874-8716

Location of Construction: 1000 Brighton Ave		Owner Forest City Chevrolet	Phone	Permit # 50833
Owner Address: P.O. Box 3564 Ptld, ME XXXXXXXXXXXXXXXXXXXX		Phone/Buyer's Name 04104 774-5971	Phone	Business Name
Contractor Name:		Address		Phone
Past Use: Parking Lot	Proposed Use Same	COST OF WORK: \$	PERMIT FEE: \$ 35.00	<div style="border: 2px solid black; padding: 5px; text-align: center;"> PERMIT ISSUED AUG 10 1995 CITY OF PORTLAND </div>
Proposed Project Description Erect tent from 11 Aug thru 19 Aug 1995		FIRE DEPT. <input checked="" type="checkbox"/> Approved <input type="checkbox"/> Denied	INSPECTION: <i>41</i> Use Group: Type: Signature: <i>M.M.</i> Date: <i>DOCA 93</i>	
		PEDESTRIAN ACTIVITIES DISTRICT (P.A.D.) Action: <input type="checkbox"/> Approved <input type="checkbox"/> Approved with Conditions <input type="checkbox"/> Denied		Zoning: <i>B-2</i> CBL: 26A-B-043 Zoning Approval: <i>Must be 10' from front & side</i> <input type="checkbox"/> Wetland <i>us el/10'</i> <input type="checkbox"/> Flood Zone <input type="checkbox"/> Subdivision <input type="checkbox"/> Site Plan, minor <input type="checkbox"/> minor <input type="checkbox"/> mm <input type="checkbox"/>
Permit Taken By: Mary Gresik	Date Applied For 08 August 1995			

- This permit application doesn't preclude the Applicant(s) from meeting applicable State and Federal rules
- Building permits do not include plumbing, septic or electrical work
- Building permits are void if work is not started within six (6) months of the date of issuance. False information may invalidate a building permit and stop all work

PERMIT ISSUED WITH REQUIREMENTS

Zoning Appeal

Variance
 Miscellaneous
 Conditional Use
 Interpretation
 Approved
 Denied

Historic Preservation

Not in District or Landmark
 Does Not Require Review
 Requires Review

Action:

Approved
 Approved with Conditions
 Denied

Date: *8/9/95*

CERTIFICATION

I hereby certify that I am the owner of record of the named property, or that the proposed work is authorized by the owner of record and that I have been authorized by the owner to make this application as his authorized agent and I agree to conform to all applicable laws of this jurisdiction. In addition, if a permit for work described in the application issued, I certify that the code official's authorized representative shall have the authority to enter all areas covered by such permit at any reasonable hour to enforce the provisions of the code(s) applicable to such permit.

SIGNATURE OF APPLICANT: *Ken Clark* ADDRESS: _____ DATE: 08 August 1995 PHONE: _____

RESPONSIBLE PERSON IN CHARGE OF WORK, TITLE: _____ PHONE: _____

White-Permit Desk Green-Assessor's Canary-D.P.W. Pink-Public File Ivory Card-Inspector

CEO DISTRICT **4**
K. Carroll