

82-90 Howe Ave.

SHAW-WALKER
© 1970-19

48.00
Fee

CITY OF PORTLAND, MAINE

Application for Permit to Install Wires

Permit No. 58753
Issued 6/7/72
Portland, Maine 6/6, 1972

To the City Electrician, Portland, Maine:

The undersigned hereby applies for a permit to install wires for the purpose of conducting electric current, in accordance with the laws of Maine, the Electrical Ordinance of the City of Portland, and the following specifications:

(This form must be completely filled out - Minimum Fee, \$1.00)

Owner's Name and Address FLOYD YORK 82 ROWE ST Tel. _____

Contractor's Name and Address DAYS ELECTRICAL DECEPOT Tel. 865-3818

Location Rowe St Arc Use of Building RESIDENCE

Number of Families 1 Apartments _____ Stores _____ Number of Stories _____

Description of Wiring: New Work Additions _____ Alterations _____

Pipe _____ Cable Metal Molding _____ BX Cable _____ Plug Molding (No. of feet) _____

No. Light Outlets 13 Plugs 32 Light Circuits 1 Plug Circuits _____

FIXTURES: No. 13 Fluor. or Strip Lighting (No. feet) _____

SERVICE: Pipe _____ Cable Underground _____ No. of Wires _____ Size _____

METERS: Relocated _____ Added _____ Total No. Meters 1

MOTORS: Number _____ Phase _____ H. P. _____ Amps _____ Volts _____ Starter _____

HEATING UNITS: Domestic (Oil) _____ No. Motors _____ Phase _____ H.P. _____

Commercial (Oil) _____ No. Motors _____ Phase _____ H.P. _____

Electric Heat (No. of Rooms) _____

APPLIANCES: No. Ranges 1 Watts 600 Brand Feeds (Size and No.) 4 ALUM

Elec. Heaters _____ Watts _____

Miscellaneous Outlet Watts 450 Extra Cabinets or Panels _____

Transformers _____ Air Conditioners (No. Units) _____ Signs (No. Units) _____

Will commence _____ 19 _____ Ready to cover in _____ 19 _____ Inspection _____ 19 _____

Amount of Fee \$ 8.00

signed _____

DO NOT WRITE BELOW THIS LINE

SERVICE	METER	GROUND
VISITS: 1	2	3
4	5	6
7	8	9
10	11	12

REMARKS:

INSPECTED BY [Signature]
(OVER)

LOCATION *Rowe Av 82*
INSPECTION DATE *6/13/72*
WORK COMPLETED *6/13/72*
TOTAL NO. INSPECTIONS *1*
REMARKS.

FEES FOR WIRING PERMITS EFFECTIVE JULY 31, 1963

WIRING	
1 to 30 Outlets	\$ 2.00
31 to 60 Outlets	3.00
Over 60 Outlets each Outlet	.05
(Each twelve feet or fraction thereof of line count lighting or any type of plug molding will be classed as one outlet)	
SERVICES	
Single Phase	2.00
Three Phase	4.00
MOTORS	
Not exceeding 50 H.P.	3.00
Over 50 H.P.	1.00
HEATING UNITS	
Domestic (Oil)	2.00
Commercial (Oil)	4.00
Electric Heat (Each Room)	.75
APPLIANCES	
Ranges, Cooking Tops, Ovens, Water Heaters, Disposals, Built-in Dishwashers, Dryers, and any permanent built-in appliance — each unit	1.50
MISCELLANEOUS	
Temporary Service, Single Phase	1.00
Temporary Service, Three Phase	2.00

INSTALL. PLUMBING

PERMIT NUMBER **460**

PERMIT TO INSTALL PLUMBING

Address **82-84 Rowe Ave.** PERMIT NUMBER **459**

Installation For **Single**

Owner of Bldg. **FLORENCE YOUNG**

Owner's Address: **YERBOUTH, Maine**

Plumber: **William R. Miles Sr.** Date **6-5-72**

Box 243, Yermouth

NEW	REPL	NO	FEE
1		SINKS	2.00
1		LAVATORIES	2.00
1		TOILETS	2.00
1		BATH TUBS	2.00
		SHOWERS	
1		DRAINS FLOOR SURFACE	2.00
		HOT WATER TANKS	
1		TANKLESS WATER HEATERS	.00
1		GARBAGE DISPOSALS	.60
		SEPTIC TANKS	
		HOUSE SEWERS	
		ROOF LEADERS	
1		AUTOMATIC WASHERS	.60
		DISHWASHERS	
		OTHER	
TOTAL			11.00

Date Issued **6-5-72**
 Portland Plumbing Inspector
 By **ERNOULD R GOODWIN**

App. Final **6/7/72**
 Date **6/7/72**
 By **ERNOULD R GOODWIN**

App. Final **6/7/72**
 Date
 By **ERNOULD R. GOODWIN**
 Type of Bldg:

- Commercial
- Residential
- Single
- Multi Family
- New Construction
- Remodeling

Building and Inspection Services Dept. Plumbing Inspection

PERMIT TO INSTALL PLUMBING

Date Issued **6-5-72**

Portland Plumbing Inspector

By **ERNOLD R GOODWIN**

App. First Insp.

Date

By

App. Final Insp.

Date

By

Type of Bldg.

- Commercial
- Residential
- Single
- Multi Family
- New Construction
- Remodeling

ERNOLD R GOODWIN, R.
 Chief, Plumbing Inspector
 NO. 113, CITY IS BLDG.
 PORTLAND, MAINE 04102

Address 82-84 Santa Ave.		PERMIT NUMBER 460	
Installation For Single			
Owner of Bldg Floyd York			
Owner's Address Warren			
Plumber William B. Miles, Sr.		Date: 6-5-72	
NEW	REPL	NO	FEE
	Appt 243 Warren		
	SINKS		
	LAVATORIES		
	TOILETS		
	BATH TUBS		
	SHOWERS		
	DRAINS FLOOR SURFACE		
	HOT WATER TANKS		
	TANKLESS WATER HEATERS		
	GARBAGE DISPOSALS		
	SEPTIC TANKS		
1	HOUSE SEWERS		2.00
	ROOF LEADERS		
	AUTOMATIC WASHERS		
	DISHWASHERS		
	OTHER		
TOTAL		1	2.00

Building and Inspection Services Dept.; Plumbing Inspection

1" = 40'

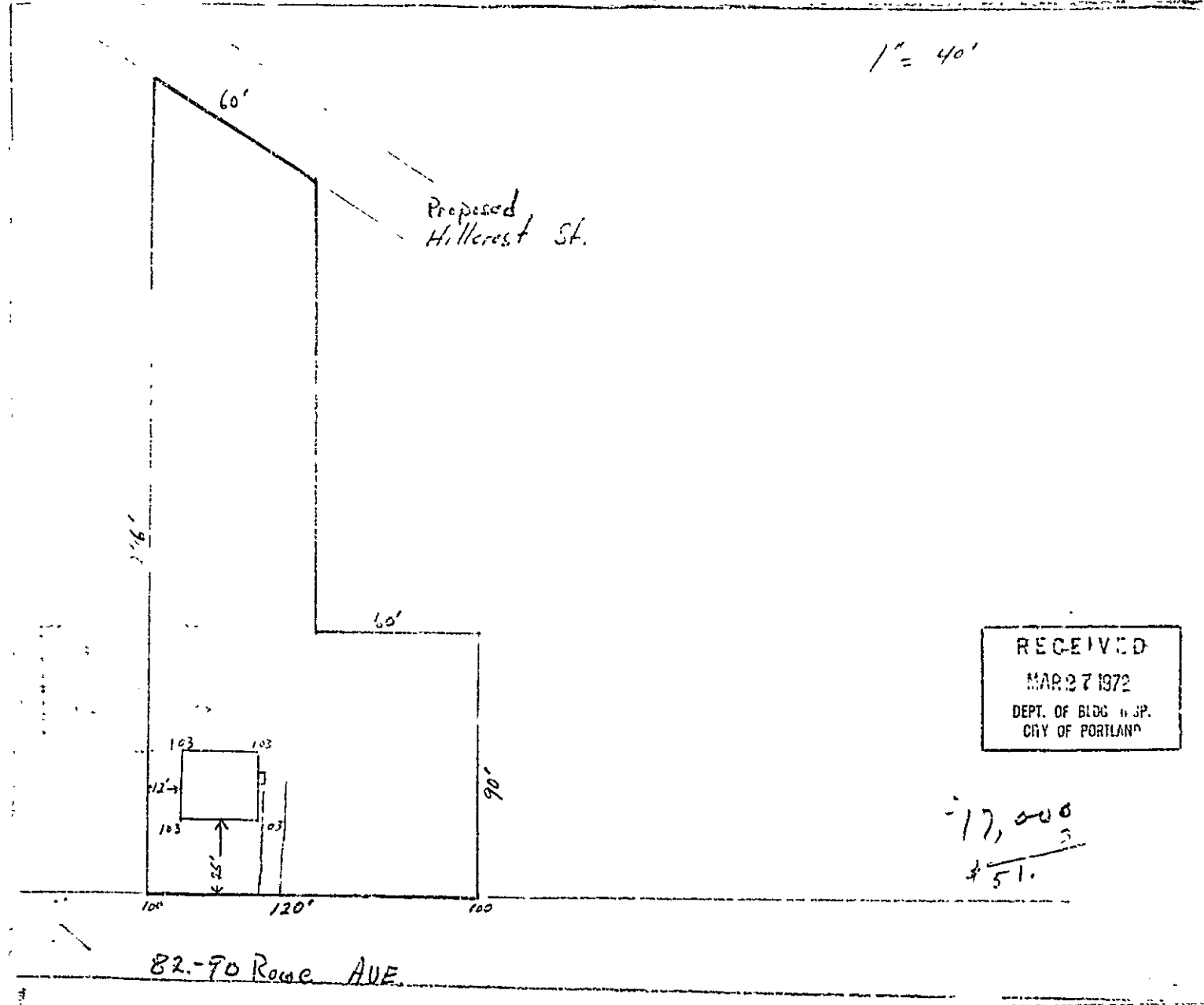

Proposed Hillcrest St.

RECEIVED
MAR 27 1972
DEPT. OF BLDG. INSP.
CITY OF PORTLAND

17,000
\$ 51.

82-70 Rome AVE.

RESIDENCE ZONE



APPLICATION FOR PERMIT

Class of Building or Type of Structure

Portland, Maine, March 27, 1972

PERMIT ISSUED

MAR 27 1972

0314 CITY OF PORTLAND

To the INSPECTOR OF BUILDINGS, PORTLAND, MAINE

The undersigned hereby applies for a permit to erect alter repair demolish install the following building structure equipment in accordance with the Laws of the State of Maine, the Building Code and Zoning Ordinance of the City of Portland, plans and specifications, if any, submitted herewith and the following specifications:

Location 82-90 Rowe Ave. Within Fire Limits? Dist. No. Owner's name and address Floyd I. York, North Rd., Yarmouth Telephone Lessee's name and address Contractor's name and address Floyd York, North Road, Yarmouth Telephone Architect Specification Plans yes No. of sheets 5 Proposed use of building Dwelling No. families 1 Last use Material wood No. stories 1 1/2 Heat Style of roof Roofing Other buildings on same lot Estimated cost \$ 17,000. Fee \$ 51.

General Description of New Work

To construct 25 x 32' dwelling as per plan

It is understood that this permit does not include installation of heating apparatus which is to be taken out separately by and in the name of the heating contractor. PERMIT TO BE ISSUED TO Contractor

Details of New Work

Is any plumbing involved in this work? yes Is any electrical work involved in this work? yes Is connection to be made to public sewer? yes If not, what is proposed for sewage? Has septic tank notice been sent? Form notice sent? Height average grade to top of plate Height average grade to highest point of roof Size, front depth No. stories solid or filled land? earth or rock? Material of foundation Thickness, top bottom cellar Kind of roof Rise per foot Roof covering No. of chimneys Material of chimneys of lining Kind of heat fuel Framing Lumber-Kind Dressed or full size? Corner posts Sills Size Girder Columns under girders Size Max. on centers Studs (outside walls and carrying partitions) 2x4-16" O. C. Bridging in every floor and flat roof span over 8 feet Joists and rafters: 1st floor, 2nd, 3rd, roof On centers: 1st floor, 2nd, 3rd, roof Maximum span: 1st floor, 2nd, 3rd, roof If one story building with masonry walls, thickness of walls? height?

If a Garage

No. cars now accommodated on same lot, to be accommodated number commercial cars to be accommodated Will automobile repairing be done other than minor repairs to cars habitually stored in the proposed building?

APPROVED:

O.K. E.S. 3/27/72

Miscellaneous

Will work require disturbing of any tree on a public street? Will there be in charge of the above work a person competent to see that the State and City requirements pertaining thereto are observed? yes

Floyd I York

INSPECTION COPY

Signature of owner

By:

[Signature]

NOTES

4-7-72 work out started

5-23-72 plumbing work
completed without permit

6-7-72 fire alarm
work completed

6-30-72 work done

8-28-72 completed
without inspection

[Signature]

~~X~~

~~X~~

Permit No. 721/314

Location 82-90 Avenue C

Owner F. B. ...

Date of permit 3/27/72

Notif. closing-in

Inspn. closing-in

Final Notif.

Final Inspn.

Cert. of Occupancy Issued

Scaling Out Notice 5 x 11

Form Check Notice