

94-98 CRAIGIE ST. ~~EDMONTON~~

SHAW-WALKER
9203-15



R3 RESIDENCE ZONE

APPLICATION FOR PERMIT

Class of Building or Type of Structure

Portland, Maine, August 20, 1957

To the INSPECTOR OF BUILDINGS, PORTLAND, MAINE

The undersigned hereby applies for a permit to erect alter repair demolish install the following building structure equipment in accordance with the Laws of the State of Maine, the Building Code and Zoning Ordinance of the City of Portland, plans and specifications, if any, submitted herewith and the following specifications:

Location 98 Craigie St. Within Fire Limits? Dist. No.
Owner's name and address Glen Hansen, 98 Craigie St. Telephone
Lessee's name and address Telephone
Contractor's name and address Granite Restoration Co. Inc. 595 Broadway Belden Telephone
Architect Specifications yes Plans yes No. of sheets 1
Proposed use of building Swimming Pool No. families
Last use No. families
Material No. stories Heat Style of roof Roofing
Other building on same lot
Estimated cost \$4,975.00 Fee \$5.00

General Description of New Work

To construct "Swimming Pool" in rear of dwelling 20' x 40' as per plan and specifications.
6" concrete floor with 10" vertical walls.
Pool will be 3'6" depth and 3'6" at deep end.

Refused. 2/25/58 - Rec. # 9374.
It is understood that this permit does not include installation of heating apparatus which is to be taken out separately by and in the name of the heating contractor. PERMIT TO BE ISSUED TO owner

Details of New Work

Is any plumbing involved in this work? Is any electrical work involved in this work?
Is connection to be made to public sewer? If not, what is proposed for sewage?
Has septic tank notice been sent? Form notice sent?
Height average grade to top of plate Height average grade to highest point of roof
Size, front depth No. stories solid or filled land? earth or rock?
Material of foundation Thickness, top bottom cellar
Material of underpinning Height Thickness
Kind of roof Rise per foot Roof covering
No. of chimneys Material of chimneys of lining Kind of heat fuel
Framing Lumber—Kind Dressed or full size? Corner posts Sills
Size Girder Columns under girders Size Max. on centers
Kind and thickness of outside sheathing of exterior walls?
Studs (outside walls and carrying partitions) 2x4-16" O. C. Bridging in every floor and flat roof span over 8 feet.
Joists and rafters: 1st floor 2nd 3rd roof
On centers: 1st floor 2nd 3rd roof
Maximum span: 1st floor 2nd 3rd roof
If one story building with masonry walls, thickness of walls? height?

If a Garage

No. cars now accommodated on same lot, to be accommodated number commercial cars to be accommodated
Will automobile repairing be done other than minor repairs to cars habitually stored in the proposed building?

APPROVED:

Miscellaneous

Will work require disturbing of any tree on a public street? no
Will there be in charge of the above work a person competent to see that the State and City requirements pertaining thereto are observed? yes
Glen Hansen
Granite Restoration Co. Inc.

SECTION COPY

Signature of owner by:

Eliza L. A. Hansen and Glen R. Hansen
F.M.

Permit No. 171
Location 98 Craigie St
Owner Glen Hanson
Date of permit _____
Notif. closing-in _____
Inspn. closing-in _____
Final Notif. _____
Final Inspn. _____
Cert. of Occupancy issued _____
Staking Out Notice _____
Form Check Notice _____

NOTES

CS MAINE PRINTING CO., PORTLAND

(COPY)



CITY OF PORTLAND, MAINE
Department of Building Inspection

Certificate of Occupancy

LOCATION 94-98 Craigs St.

Issued to Dr. Wm. A. Hansen

Date of Issue Sept. 14, 1966

This is to certify that the building, premises, or part thereof, at the above location, built—~~altered~~
—~~changed as to use~~ under Building Permit No. 54/1629, has had final inspection, has been found to conform
essentially to requirements of Zoning Ordinance and Building Code of the City, and is hereby approved for
occupancy or use, limited or otherwise, as indicated below.

PORTION OF BUILDING OR PREMISES

APPROVED OCCUPANCY

Office

Office Building

Limiting Conditions:

This certificate supersedes
certificate issued

Approved:

9/17/66 Nelson F. Cartwright
(Date) Inspector

Inspector of Buildings

Notice: This certificate identifies lawful use of building or premises, and ought to be transferred from
owner to owner when property changes hands. Copy will be furnished to owner or lessee for one dollar.

(NOT REISSUED) ZONE - C



APPLICATION FOR PERMIT

Class of Building or Type of Structure Third Class

Portland, Maine, Sept. 22, 1955

PERMIT TO CONSTRUCT
61680

SEP 27 1955

To the INSPECTOR OF BUILDINGS, PORTLAND, MAINE

The undersigned hereby applies for a permit to erect ~~the following building structure~~ in accordance with the Laws of the State of Maine, the Building Code and Zoning Ordinance of the City of Portland, plans and specifications, if any, submitted herewith and the following specifications:

Location 94-98 Craigie St. Extension Within Fire Limits? no Dist. No. 34
Owner's name and address The Minat Corp., 220 Preble St. Telephone 4-8013
Lessee's name and address _____ Telephone _____
Contractor's name and address owner Telephone _____
Architect _____ Specifications _____ Plans yes No. of sheets 3
Proposed use of building dwelling house No. families 1
Last use _____ No. families _____
Material _____ No. stories _____ Heat _____ Style of roof _____ Roofing _____
Other buildings on same lot _____
Estimated cost \$ 10,000. Fee \$ 10.00

General Description of New Work

To construct 2-story frame dwelling house 24' x 32'
16" overhang and bay window

Approved with Leave

It is understood that this permit does not include installation of heating apparatus which is to be taken out separately by and in the name of the heating contractor. PERMIT TO BE ISSUED TO owner

Details of New Work

Is any plumbing involved in this work? yes Is any electrical work involved in this work? yes
Is connection to be made to public sewer? yes If not, what is proposed for sewage? _____
Has septic tank notice been sent? _____ Form notice sent? _____
Height average grade to top of plate 16' Height average grade to highest point of roof 26'
Size, front 32' depth 24' No. stories 2 solid or filled land? solid earth or rock? earth
Material of foundation concrete at least 4' below grade Thickness, top 10" bottom 12" cellar yes
Material of underpinning _____ to sill Height _____ Thickness _____
Kind of roof pitch-gable Rise per foot 6" Roof covering Asphalt Class C Und Lab
No. of chimneys 1 Material of chimneys brick of lining tile Kind of heat hot water fuel oil
Framing lumber—Kind hemlock Dressed or full size? dressed
Corner posts 4x6 Sills box Girt or ledger board? _____ Size _____
Girders yes one piece Size 8x8 Hemlock under girders lally Size 3 1/2" Max. on centers 7'7"
Studs (outside walls and carrying partitions) 2x4-16" O. C. Bridging in every floor and flat roof span over 8 feet.
Joists and rafters: 1st floor 2x8 2nd 2x8 3rd 2x6 roof 2x8
On centers: 1st floor 16" 2nd 16" 3rd 24" roof 24"
Maximum span: 1st floor 12' 2nd 12' 3rd _____ roof _____
If one story building with masonry walls, thickness of walls? _____ height? _____

If a Garage

No. cars now accommodated on same lot _____, to be accommodated _____ number commercial cars to be accommodated _____
Will automobile repairing be done other than minor repairs to cars habitually stored in the proposed building? _____

APPROVED:

with leave by AGJ

Miscellaneous

Will work require disturbing of any tree on a public street? no
Will there be in charge of the above work a person competent to see that the State and City requirements pertaining thereto are observed? yes

The Minat Corp.

Signature of owner by: Chapman

INSPECTION COPY

NOTES

10-12-55 Fort - OK OK
 4-23-56 (no work)
 missing - 10/1/56
 6-1-56 - 1st of 1st
 11-1-56 - heater work
 1-1-56 - void space
 4-25-56 OK to close OK
 9-14-56 Final OK OK
 1175

New owner
 Dr. George Hansen

Permit No. 55/1689
 Location 9408 Carnegie St. E.
 Owner The Alquist Corp.
 Date of permit 9/27/55
 Notif. closing-in 1-2-56
 Inspn. closing-in 4-25-56
 Final Notif. 11-1-56
 Final Inspn. 9-14-56
 Cert. of Occupancy issued 9-14-56
 Staking Out Notice
 Form, check Notice 10/1/56



(20) RESIDENCE ZONE - C

APPLICATION FOR PERMIT

01448

Class of Building or Type of Structure Third Class
Portland, Maine, Sept. 6, 1956

To the INSPECTOR OF BUILDINGS, PORTLAND, MAINE

The undersigned hereby applies for a permit to ~~alter~~ construct the following building ~~and~~ in accordance with the Laws of the State of Maine, the Building Code and Zoning Ordinance of the City of Portland, plans and specifications, if any, submitted herewith and the following specifications:

Location 96 Craigie St. Within Fire Limits? no Dist. No. _____
Owner's name and address Dr. Glen Hanson, 43 Berry Ave. Telephone _____
Lessee's name and address _____ Telephone 2215
Contractor's name and address Placid Violette, 11 Violette Ave. Telephone _____
Architect _____ Specifications _____ Plans yes No. of sheets 1
Proposed use of building dwelling and garage No. families 1
Last use _____ No. families _____
Material wood No. stories 1 1/2 Heat _____ Style of roof _____ Roofing _____
Other buildings on same lot _____
Estimated cost \$2,000. Fee \$ 5.00

General Description of New Work

(glassed-in)

To construct 2-car frame garage 21' x 26' with enclosed breezeway 10' x 14'.

The inside of the garage will be covered ~~by~~ where required by law, with perforated gypsum lath covered with plaster.

It is understood that this permit does not include installation of heating apparatus which is to be taken out separately by and in the name of the heating contractor. **PERMIT TO BE ISSUED TO Placid Violette**

Details of New Work

Is any plumbing involved in this work? _____ Is any electrical work involved in this work? _____
Is connection to be made to public sewer? _____ If not, what is proposed for sewage? _____
Has septic tank notice been sent? _____ Form notice sent? _____
Height average grade to top of plate _____ Height average grade to highest point of roof _____
Size, front _____ depth _____ No. stories _____ solid or filled land? _____ earth or rock? _____
Material of foundation concrete blocks Thickness, top 8" bottom 8" cellar no
Material of underpinning _____ Height _____ Thickness _____
Kind of roof pitch-gable Rise per foot _____ Roof covering Asphalt Glass C Und Lab
No. of chimneys _____ Material of chimneys _____ of lining _____ Kind of heat _____ fuel _____
Framing lumber—Kind hemlock Dressed or full size? dressed
Corner posts 4x6 Sills 4x6 Girt or ledger board? _____ Size _____
Girders _____ Size _____ Columns under girders _____ Size _____ Max. on centers _____
Studs (outside walls and carrying partitions) 2x4-16" O. C. Bridging in every floor and flat roof span over 8 feet.
Joists and rafters: 1st floor _____, 2nd _____, 3rd _____, roof _____
On centers: 1st floor _____, 2nd _____, 3rd _____, roof _____
Maximum span: 1st floor _____, 2nd _____, 3rd _____, roof _____
If one story building with masonry walls, thickness of walls? _____ height? _____

If a Garage

No. cars now accommodated on same lot _____, to be accommodated _____ number commercial cars to be accommodated _____
Will automobile repairing be done other than minor repairs to cars habitually stored in the proposed building? _____

Miscellaneous

Will work require disturbing of any tree on a public street? no
Will there be in charge of the above work a person competent to see that the State and City requirements pertaining thereto are observed? yes

Dr. Glen Hanson

APPROVED:

OK-9/7/56-OK

Signature of owner by: Placid Violette

INSPECTION COPY

NOTES

10-11-56 Fire protection
not done on garage
wall.
Hollow 1 1/2" door on
porch to garage.
No door glass.
Hole to be filled
again with glass.

10-23-56 Not plastered
11-1-56 Plastered in
No door glass
11-5-56 Not done
11-16-56 Completion

Permit No. 56/1448
Location 96 Craigie St
Owner Rm. H. H. H. H. H.
Date of permit 9/7/56
Notif. closing-in
Inspn. closing-in
Final Notif.
Final Insp.
Cert. of Occupancy issued
Selling Out Notice
Form Check Notice

10-18
11-21
11-23



FILL IN AND SIGN WITH INK

APPLICATION FOR PERMIT FOR
HEATING, COOKING OR POWER EQUIPMENT

Portland, Maine, June 14, 1955

PERMIT ISSUED

JUN 15 1955

CITY OF PORTLAND

AL REC

To the INSPECTOR OF BUILDINGS, PORTLAND, ME.

The undersigned hereby applies for a permit to install the following heating, cooking or power equipment in accordance with the Laws of Maine, the Building Code of the City of Portland, and the following specifications:

Location 94-98 Craigie St. Use of Building dwelling No. Stories New Building
Name and address of owner of appliance The Hinet Corp., 31 Krehle St. Existing
Installer's name and address Fallotta Oil Co., 112 Exchange St. Telephone 4-2671

General Description of Work

To install forced hot water heating system and oil burning equipment

IF HEATER, OR POWER BOILER

Location of appliance basement Any burnable material in floor surface or beneath? no
If so, how protected? Kind of fuel? oil
Minimum distance to burnable material, from top of appliance or casing top of furnace over 15"
From top of smoke pipe over 15" From front of appliance over 4' From sides or back of appliance over 3'
Size of chimney flue 2x8 Other connections to same flue none
If gas fired, how vented? Rated maximum demand per hour
Will sufficient fresh air be supplied to the appliance to insure proper and safe combustion? yes

IF OIL BURNER

Name and type of burner Fluid Heat Labelled by underwriters' laboratories? yes
Will operator be always in attendance? Does oil supply line feed from top or bottom of tank? bottom
Type of floor beneath burner concrete Size of vent pipe 1 1/2"
Location of oil storage basement Number and capacity of tanks 1-275 gal.
Low water shut off Make No.
Will all tanks be more than five feet from any flame? yes How many tanks enclosed?
Total capacity of any existing storage tanks for furnace burners none

IF COOKING APPLIANCE

Location of appliance Any burnable material in floor surface or beneath?
If so, how protected? Height of Legs, if any
Skirting at bottom of appliance? Distance to combustible material from top of appliance?
From front of appliance From sides and back From top of smokepipe
Size of chimney flue Other connections to same flue
If wood to be provided? If so, how vented? Forced or gravity?
If gas fired, how vented? Rated maximum demand per hour

MISCELLANEOUS EQUIPMENT OR SPECIAL INFORMATION

Amount of fee enclosed? 2.00 (\$2.00 for one heater, etc., 50 cents additional for each additional heater, etc., in same building at same time.)

APPROVED:

J. H. 6-15-55 JHC

Will there be in charge of the above work a person competent to see that the State and City requirements pertaining thereto are observed? yes

Fallotta Oil Co.

Signature of Installer by: J. Fallotta

CITY OF PORTLAND PRINTING CO.

INSPECTION COPY

NOTES	
1	Test pressure
2	Test pressure
3	Test pressure
4	Test pressure
5	Test pressure
6	Test pressure
7	Test pressure
8	Test pressure
9	Test pressure
10	Test pressure
11	Test pressure
12	Test pressure
13	Test pressure
14	Test pressure
15	Test pressure
16	Test pressure

Permit No.	51833
Location	94-98 Craigie St
Owner	Joe Smith Corp
Date of permit	8/15/56
Approved	

94-98 CRAIGLE STREET



PERMIT ISSUED

JUL 27 1923

Appeal Fees	\$
Base Fee 2-	\$20.00.....
Late Fee	\$25.00.....
TOTAL	\$25.00.....

Stamp of Special Conditions

NOTE TO APPLICANT: Separate permits are required by the installers and subcontractors of heating, plumbing, electrical and mechanical.

Is any plumbing involved in this work? **NO.** Is any electrical work involved in this work? **NO.**

Is connection to be made to public sewer? If not, what is proposed for sewage?

Has septic tank notice been sent? Form notice sent?

Height average grade to top of plate Height average grade to highest point of roof

Size, front depth, solid or filled land?

Material of foundation No. stories Thickness, top bottom cellar

Kind of roof Rise per foot Roof covering Kind of heat fuel

No. of chimneys Material of chimneys of lining Corner posts Size Max. on centers

Framing Lumber--Kind Dressed or full size? Bridging in every floor and flat roof span over 8 feet.

Size Girder Columns under girders 1st floor 2nd 3rd roof

Studs (outside walls and carrying partitions) 2x4-16" O. C. 1st floor 2nd 3rd roof

Joists and rafters: 1st floor 2nd 3rd roof

On centers: 1st floor 2nd 3rd roof

Maximum spar: 1st floor 2nd 3rd roof

If one story building with masonry walls, thickness of walls? height?

No. cars now accommodated on same lot to be accommodated number comments

Will automobile repairing be done other than minor repairs to cars here?

IF A GARAGE

APPROVALS BY: _____

BUILDING INSPECTION _____

PLUMBING _____

ELECTRIC _____

.....
IF A GARAGE
COST

IF A GARAGE , roof
 to be accommodated height?
 number commercial cars to be accommodated
 Will work require district
 MISCELLANEOUS
 APPROVALS BY:
 BUILDING INSPECTION - PLAN EXAMINER
 ZONING:
 BUILDING CODE:
 Fire Dept.:
 Health Dept.:

MISCELLANEOUS

Will there be in charge of the above work a person competent to see that the State and City requirements pertaining thereto are observed? Yes

Signature of Applicant

The Name of above

Phone # same

Other 2 ☐ 3 ☒ 4 ☐
and Address

FIELD INSPECTOR'S COPY

APPLICANT'S COPY

OFFICIAL COPY

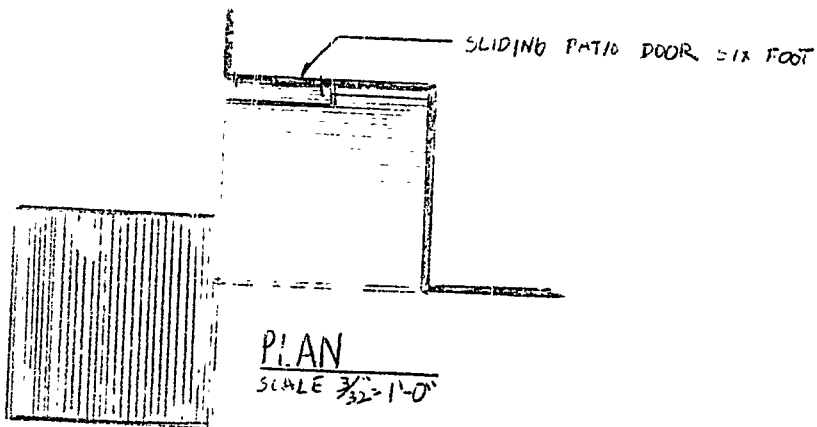

G. J. Cuffey, Inc.
5 LEWIS STREET
WESTBROOK, MAINE 04092
TEL: 854-5423

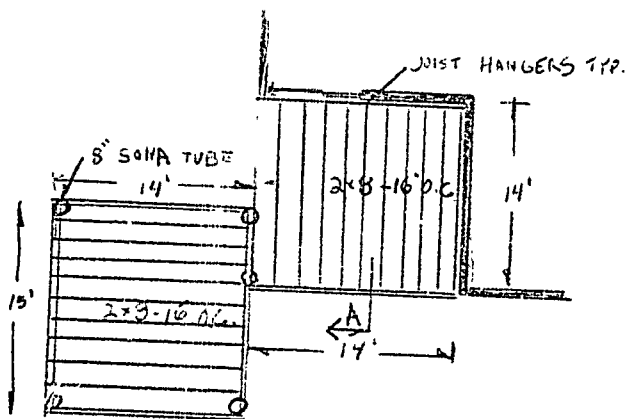

FRAMING PLAN
SCALE $\frac{3}{32}'' = 1'-0''$

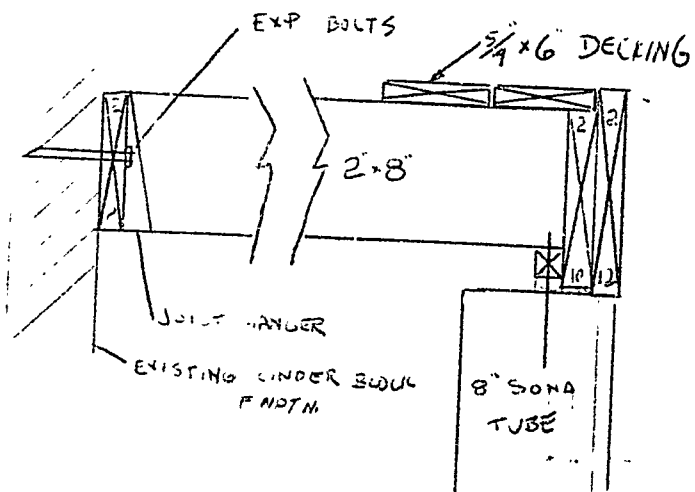

SECTION A
SCALE $1\frac{1}{2}'' = 1'-0''$

RECEIVED
JUL 27 1983
DEPT. OF BLDG. INSP.
CITY OF PORTLAND

DIBIASE DECK
18 CRAIGIE STR.

G. J. Cuffey, Inc.
5 LEWIS STREET
WESTBROOK, MAINE 04092
TEL: 854-5423

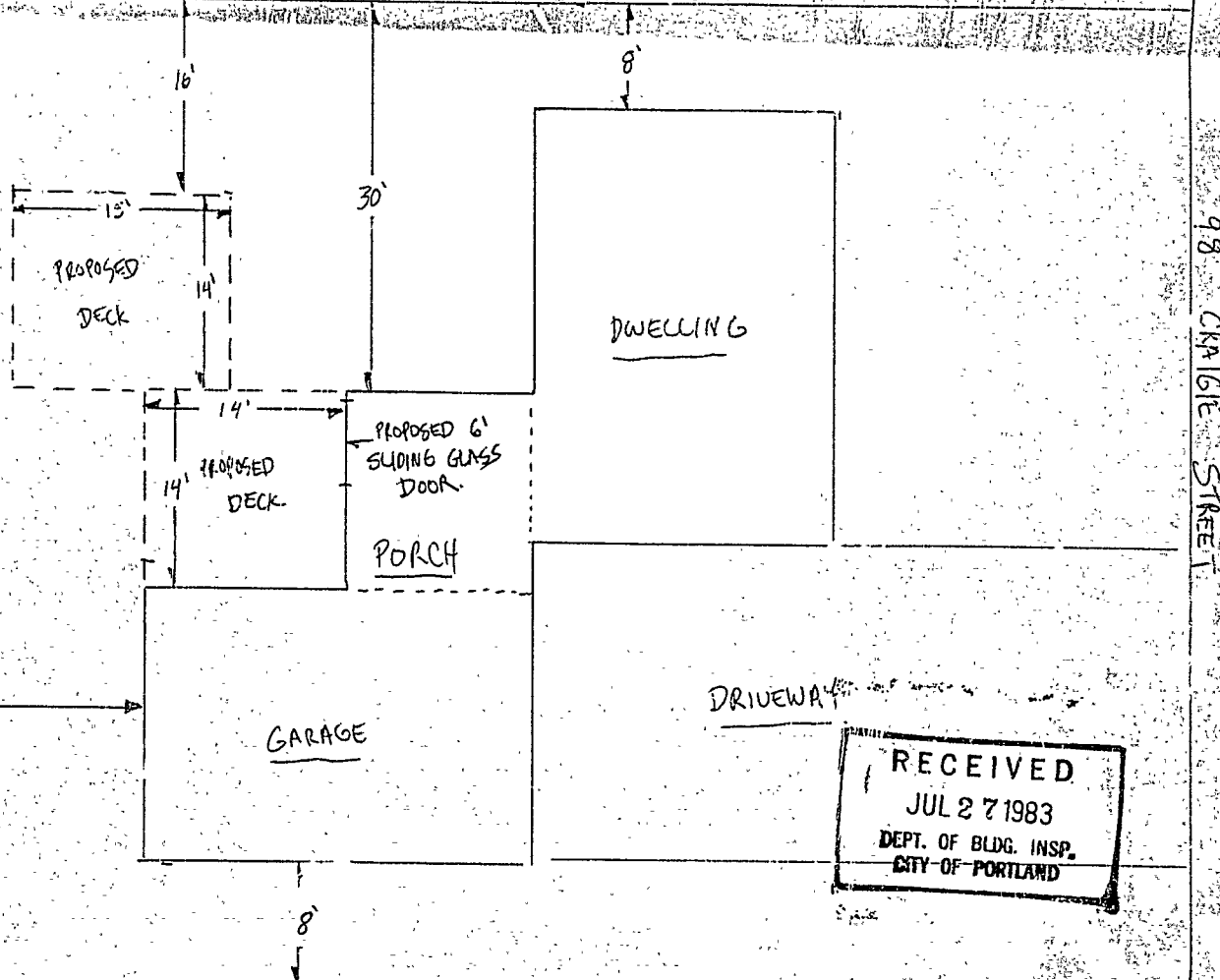

RECEIVED
JUL 27 1983
DEPT. OF BLDG. INSP.
CITY OF PORTLAND

APPLICATION FOR PERMIT

PERMIT ISSUED

B.O.C.A. USE GROUP
 B.O.C.A. TYPE OF CONSTRUCTION 00771
 ZONING LOCATION ... R-3 ... PORTLAND, MAINE ... July 27, 1983

JUL 27 1983

CITY of PORTLAND

To the CHIEF OF BUILDING & INSPECTION SERVICES, PORTLAND, MAINE

The undersigned hereby applies for a permit to erect, alter, repair, demolish, move or install the following building, structure, equipment or change use in accordance with the Laws of the State of Maine, the Portland B.O.C.A. Building Code and Zoning Ordinance of the City of Portland with plans and specifications, if any, submitted here with and the following specifications:

LOCATION ... 98 Craigie Street ... Fire District #1 ☐ #2 ☐
 1. Owner's name and address ... Frank DiBiase - same ... Telephone ... 772-5564
 2. Lessee's name and address ... Telephone ...
 3. Contractor's name and address ... G. J. Cuffey, Inc. - 5 Lewis St. West Telephone ... 854-5423

Proposed use of building ... dwelling with 2 level sun deck ... No. of sheets ...
 Last use ... No families ...
 Material ... No. stories ... Heat ... Style of roof ... Roofing ...
 Other buildings on same lot ...

Estimated contractual cost \$... 2,000...

Appeal Fees \$
 Base Fee 2- 20.00...
 Late Fee
 TOTAL \$ 20.00...

FIELD INSPECTOR - Mr. @ 775-5451

To construct 2 level open sun deck on rear of dwelling, also to install sliding glass door as per plans. 1 sheet of plans.

Stamp of Special Conditions

4 x 6 header on door
 send permit to # 304092

NOTE TO APPLICANT: Separate permits are required for the installers and subcontractors of heating, plumbing, electrical and mechanicals.

DETAILS OF NEW WORK

Is any plumbing involved in this work? ... no ... Is any electrical work involved in this work? ... no ...
 Is connection to be made to public sewer? ... If not, what is proposed for sewage? ...
 Has septic tank notice been sent? ... Form notice sent? ...
 Height average grade to top of plate ... Height average grade to highest point of roof ...
 Size, front ... depth ... No. stories ... solid or filled land? ... earth or rock? ...
 Material of foundation ... Thickness, top ... bottom ... cellar ...
 Kind of roof ... Rise per foot ... Roof covering ...
 No. of chimneys ... Material of chimneys ... of lining ... Kind of heat ... fuel ...
 Framing Lumber—Kind ... Dressed or full size? ... Corner posts ... Sills ...
 Size Girder ... Columns under girders ... Size ... Max. on centers ...
 Studs (outside walls and carrying partitions) 2x4-16" O. C. Bridging in every floor and flat roof span over 8 feet.
 Joists and rafters: 1st floor ... 2nd ... 3rd ... roof ...
 On centers: 1st floor ... 2nd ... 3rd ... roof ...
 Maximum span: 1st floor ... 2nd ... 3rd ... roof ...
 If one story building with masonry walls, thickness of walls? ... height? ...

IF A GARAGE

No. cars now accommodated on same lot ... to be accommodated ... number commercial cars to be accommodated ...
 Will automobile repairing be done other than minor repairs to cars habitually stored in the proposed building? ...

APPROVALS BY:

DATE

MISCELLANEOUS

BUILDING INSPECTION—PLAN EXAMINER

ZONING: ... 9/12/83

BUILDING CODE:

Fire Dept.:

Health Dept.:

Other:

Will work require disturbing of any tree on a public street? ... no

Will there be in charge of the above work a person competent to see that the State and City requirements pertaining thereto are observed? ... yes

Signature of Applicant

Phone # ... same

Type Name of above

Greg Cuffey for G. J. Cuffey, Inc. 2 ☐ 3 ☒ 4 ☐

Other ... and Address ...

INSPECTOR'S COPY

APPLICANT'S COPY

OFFICE FILE COPY

2011

Permit No. 83/271
Location 98/Cigga
Owner Heand Vi Briel
Date of permit 7-27-83
Approved 7-27-83
Dwelling
Garage
Alteration

NOTES

8/1/83 - Work Completed
Permit for 1st Inspection - Not
Went to Check for Permit
Appears ok (P)

