

18-20 COLONIAL ROAD

SHAW-WALKER

Full cut # 927R - Half cut # 9202R - Third cut # 9233R - Fifth cut # 9208R

City of Portland, Maine
Fire Department

Agnes Racine

Pettingill Pond

N. Windham, ME

Re: Fire at 20 Colonial Rd.

Dear Mrs. Racine

On March 19, 1931 a fire occurred in the building listed above of which you are reported to be the owner ().

If permanent repair work is required for this building, you must obtain a permit from the Building & Inspection Department in City Hall before starting such work.

Very Truly Yours,

Chief
Portland Fire Department

cc: Building & Inspection Department
Corporation Counsel
Health Department (Housing Div)
City Assessor's (Mr. Lucci)

2½ story, wood frame. Fire confined to an oil spill on the basement floor.



FILL IN AND SIGN WITH INK

385

APPLICATION FOR PERMIT FOR HEATING, COOKING OR POWER EQUIPMENT

Portland, Maine, May 11, 1981

PERMIT ISSUED

MAY 12 1981

CITY of PORTLAND

To the INSPECTOR OF BUILDINGS, PORTLAND, ME.

The undersigned hereby applies for a permit to install the following heating, cooking or power equipment in accordance with the Laws of Maine, the Building Code of the City of Portland, and the following specifications:

Location 18 Colonial Rd Use of Building multi - 2 dwelling - No. Stories 2 New Building Existing 892-4666
Name and address of owner of appliance Agnes Racine - 2888X W ndham, Me.
Installer's name and address Ballard Oil & Equip -135 Marginal Way telephone 772-1991

General Description of Work

To install burner - replacement.

IF HEATER, OR POWER BOILER

Location of appliance Any burnable material in floor surface or beneath?
If so, how protected? Kind of fuel?
Minimum distance to burnable material, from top of appliance or casing top of furnace
From top of smoke pipe From front of appliance From sides or back of appliance
Size of chimney flue Other connections to same flue
If gas fired, how vented? Rated maximum demand per hour
Will sufficient fresh air be supplied to the appliance to insure proper and safe combustion?

IF OIL BURNER

Name and type of burner Baskett - gun Labelled by underwriters' laboratories? Yes
Will operator be always in attendance? no Does oil supply line feed from top or bottom of tank? bottom
Type of floor beneath burner concrete Size of vent pipe 1 1/2
Location of oil storage basement Number and capacity of tanks 1-275 gal.
Low water shut off none Make No.
Will all tanks be more than five feet from any flame? yes How many tanks enclosed? none
Total capacity of any existing storage tanks for furnace burners 275 gal.

IF COOKING APPLIANCE

Location of appliance Any burnable material in floor surface or beneath?
If so, how protected? Height of Legs, if any
Skirting at bottom of appliance? Distance to combustible material from top of appliance?
From front of appliance From sides and back From top of smokepipe
Size of chimney flue Other connections to same flue
Is hood to be provided? If so, how vented? Forced or gravity?
If gas fired, how vented? Rated maximum demand per hour

MISCELLANEOUS EQUIPMENT OR SPECIAL INFORMATION

Amount of fee enclosed? 5.00
cost of work 372. 5.50

APPROVED: 10.50

Will there be in charge of the above work a person competent to see that the State and City requirements pertaining thereto are observed?

Signature of Installer Ralph Nabil # 1850 Jack Boyer

CI 300

INSPECTION COPY

3A

NOTES

5-14-81 Couldn't get in
 5-18-81 Same - will try to get
 hold of owner to set up - couldn't
 get hold of owner by phone to make
 Appt - will try once more later
 5-26-81 Same - will cross off
 all owner or someone CALLS to
 let me in

Permit No. 81-1385
 Location 1515 1/2 Street
 Owner Legate District
 Date of permit 5-11-81
 Approved 5-13-81 [Signature] Building Department

- 1 Ins. pipe
- 2 Ins. pipe
- 3 Ins. pipe & support
- 4 Ins. pipe
- 5 Ins. pipe
- 6 Ins. pipe
- 7 Ins. pipe
- 8 Ins. pipe
- 8 Ins. pipe
- 10 Ins. pipe & reflection
- 11 Ins. pipe
- 12 Ins. pipe
- 13 Ins. pipe & support
- 14 Ins. pipe & support
- 15 Oil pipe
- 16 Ins. pipe
- 17 Oil pipe
- 18 Adequate ventilation
- 19 Smoke pipe & bushing
- 20 Thermal Control switch

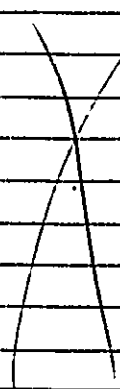



APPLICATION FOR PERMIT
DEPARTMENT OF BUILDING INSPECTIONS SERVICES
ELECTRICAL INSTALLATIONS

Date Dec. 1, 1980
 Receipt and Permit number A 59644

To the CHIEF ELECTRICAL INSPECTOR, Portland, Maine:
 The undersigned hereby applies for a permit to make electrical installations in accordance with the laws of
 Maine, the Portland Electrical Ordinance, the National Electrical Code and the following specifications:
 LOCATION OF WORK: 16 Colonial Rd.

OWNER'S NAME: Philip Whitlock ADDRESS: lives there FEES

OUTLETS: Receptacles _____ Switches _____ Plugmold _____ ft. TOTAL _____

FIXTURES: (number of) Incandescent _____ Fluorescent _____ (not strip) TOTAL _____
 Strip Fluorescent _____ ft. _____

SERVICES: Overhead Underground _____ Temporary _____ TOTAL amperes 200 3.00
.50

METERS: (number of) 1

MOTORS: (number of) Fractional _____
 1 HP or over _____

RESIDENTIAL HEATING: Oil or Gas (number of units) _____
 Electric (number of rooms) _____

COMMERCIAL OR INDUSTRIAL HEATING: Oil or Gas (by a main boiler) _____
 Oil or Gas (by separate units) _____
 Electric Under 20 kws _____ Over 20 kws _____

APPLIANCES: (number of) Ranges _____ Water Heaters _____
 Cook Tops _____ Disposals _____
 Wall Ovens _____ Dishwashers _____
 Dryers _____ Compactors _____
 Fans _____ Others (denote) _____

TOTAL _____

MISCELLANEOUS: (number of) Branch Panels _____
 Transformers _____
 Air Conditioners Central Unit _____
 Separate Units (windows) _____
 Signs 20 sq. ft. and under _____
 Over 20 sq. ft. _____
 Swimming Pools Above Ground _____
 In Ground _____
 Fire, Burglar Alarms Residential _____
 Commercial _____
 Heavy Duty Outlets, 220 Volt (such as welders) 30 amps and under _____
 over 30 amps _____
 Circus, Fairs, etc. _____
 Alterations to wires _____
 Repairs after fire _____
 Emergency Lights, battery _____
 Emergency Generators _____

FOR ADDITIONAL WORK NOT ON ORIGINAL PERMIT INSTALLATION FEE DUE:
 FOR REMOVAL OF A "STOP ORDER" (304-16.b) DOUBLE FEE DUE:
 TOTAL AMOUNT DUE: 3.50

INSPECTION: Will be ready on _____; or Will Call
 CONTRACTOR'S NAME: Dennis Electric
 ADDRESS: 5 Longfellow Drive, Cape Elizabeth
 TEL.: 799-5218
 MASTER LICENSE NO.: 3910 SIGNATURE OF CONTRACTOR:
 LIMITED LICENSE NO.: _____ *[Signature]*

INSPECTOR'S COPY — WHITE
 OFFICE COPY — CANARY
 CONTRACTOR'S COPY — GREEN

CITY OF PORTLAND, MAINE

Application for Permit to Install Wires

Permit No. 5551
 Issued 1/31/67
 Portland, Maine 1967

To the City Electrician, Portland, Maine:

The undersigned hereby applies for a permit to install wires for the purpose of conducting electric current, in accordance with the laws of Maine, the Electrical Ordinance of the City of Portland, and the following specifications:

(This form must be completely filled out — Minimum Fee, \$1.00)

Owner's Name and Address Arthur Stevens Tel. 773-2790
 Contractor's Name and Address Lowell W. Weeks Tel. 781-3595
 Location 18 Colonial Rd Use of Building dwelling
 Number of Families 2 Apartments 1 Stores 0 Number of Stories 2
 Description of Wiring: New Work Additions 0 Alterations 0
 Pipe Cable 0 Metal Molding 0 BX Cable 0 Plug Molding (No. of feet) 0
 No. Light Outlets 0 Fuses 0 Light Circuits 0 Plug Circuits 0
 FIXTURES: No. 0 Light Switches 0 Fluor. or Strip Lighting (No. feet) 0
 SERVICE: Pipe Cable 0 Underground 0 N of Wires 3 Size #16
 METERS: Relocated 0 Added 0 Total No. Meters 0
 MOTORS: Number 0 Phase 0 H. P. 0 Amps 0 Volts 0 Starter 0
 HEATING UNITS: Domestic (Oil) 0 No. Motors 0 Phase 0 H.P. 0
 Commercial (Oil) 0 No. Motors 0 Phase 0 H.P. 0
 Electric Heat (No. of Rooms) 0
 APPLIANCES: No. Ranges 0 Watts 0 Brand Feeds (Size and No.) 0
 Elec. Heaters 0 Watts 0
 Miscellaneous 0 Watts 0 Extra Cabinets or Panels 0
 Transformers 0 Air Conditioners (No. Units) 0 Signs (No. Units) 0
 Will commence 4/7/67 1967 Ready to cover in 19 Inspection Feb 6 19 67
 Amount of Fee \$ 2.00
 Signed Lowell W. Weeks

DO NOT WRITE BELOW THIS LINE

SERVICE METER 0 GROUND
 VISITS: 1 0 2 0 3 0 4 0 5 0 6 0
 7 0 8 0 9 0 10 0 11 0 12 0
 REMARKS:

INSPECTED BY F.W. Hennessey
 (OVER)

LOCATION *California Rd 18*
 INSPECTION DATE *2/13/47*
 WORK COMPLETED *2/13/47*
 TOTAL NO. INSPECTIONS *1*
 REMARKS:

FEE S FOR WIRING PERMITS EFFECTIVE JULY 31, 1963

WIRING	
1 to 30 Outlets (including switches)	\$ 2.00
31 to 60 Outlets (including switches)	3.00
Over 60 Outlets, each Outlet (including switches)	.05
(Each twelve feet or fraction thereof of fluorescent lighting or any type of plug molding will be classed as one outlet).	
SERVICES	
Single Phase	2.00
Three Phase	4.00
MOTORS	
Not exceeding 50 H.P.	3.00
Over 50 H.P.	4.00
HEATING UNITS	
Domestic (Oil)	2.00
Commercial (Oil)	4.00
Electric Heat (Each Room)	.75
APPLIANCES	
Ranges, Cooking Tops, Ovens, Water Heaters, Disposals, Dishwashers, etc. — Each Unit	1.50
TEMPORARY WORK (Limited to 6 months from date of permit)	
Service, Single Phase	1.00
Service, Three Phase	2.00
Wiring, 1-50 Outlets	1.00
Wiring, each additional outlet over 50	.02
Circuses, Carnivals, Fairs, etc.	10.00
MISCELLANEOUS	
Distribution Cabinet or Panel, per unit	1.00
Transformers, per unit	2.00
Air Conditioners, per unit	2.00
Signs, per unit	2.00
ADDITIONS	
5 Outlets, or less	1.00
Over 5 Outlets, Regular Wiring Rates	

CITY OF PORTLAND, MAINE
Application for Permit to Install Wires

Permit No. 55063

Issued

Portland, Maine July 28, 1966

To the City Electrician, Portland, Maine:

The undersigned hereby applies for a permit to install wires for the purpose of conducting electric current, in accordance with the laws of Maine, the Electrical Ordinance of the City of Portland, and the following specifications:

(This form must be completely filled out - Minimum Fee, \$1.00)

Owner's Name and Address Arthur H. Stevens, 18 Colonial Road, Portland
 Contractor's Name and Address Ballard Oil & Equipment Co. Tel. 135 Marginal Way
 Location 18 Colonial Rd., Port. Use of Building Residence

Number of Families Apartments Stores Number of Stories
 Description of Wiring: New Work Additions Alterations
 Wiring of high pressure gun type burner and controls
 Pipe .. Cable .. Metal Molding .. BX Cable Plug Molding (No. of feet) ..
 No. Light Outlets Plugs Light Circuits Plug Circuits

FIXTURES: No. Light Switches Fluor. or Strip Lighting (No. feet)

SERVICE: Pipe Cable Underground No. of Wires Size

METERS: Relocated Added Total No. Meters

MOTORS: Number 1 Phase 1 H. P. 1/8 Amps 30 Volts 115 Starter

HEATING UNITS: Domestic (Oil) No. Motors Phase H.P.

Commercial (Oil) No. Motors Phase H.P.

Electric Heat (No. of Rooms)

APPLIANCES: No. Ranges Watts Brand Feeds (Size and No.)

Elec. Heaters Watts

Miscellaneous Watts Extra Cabinets or Panels

Transformers Air Conditioners (No. Units) Signs (No. Units)

Will commence 7-29-66 / Ready to cover in 19 Inspection 3-6-1966

Amount of Fee \$ 27.00 Ballard Oil & Equipment Co.

Signed L. W. Jordan

DO NOT WRITE BELOW THIS LINE

SERVICE METER GROUND

VISITS: 1 2 3 4 5 6

7 8 9 10 11 12

REMARKS:

INSPECTED BY [Signature]
 (OVER)

CS 203

LOCATION *Colonial Bldg.*
 INSPECTION DATE *8/6/66*
 WORK COMPLETED *8/6/66*
 TOTAL NO. INSPECTIONS
 REMARKS:

FEE S FOR WIRING PERMITS EFFECTIVE JULY 31, 1963

WIRING		
1 to 30 Outlets	(including switches)	\$ 2.00
31 to 60 Outlets	(including switches)	3.00
Over 60 Outlets, each Outlet	(including switches)	.05
(Each twelve feet or fraction thereof of fluorescent lighting or any type of plug molding will be classed as one outlet).		
SERVICES		
Single Phase		2.00
Three Phase		4.00
MOTORS		
Not exceeding 50 H.P.		3.00
Over 50 H.P.		4.00
HEATING UNITS		
Domestic (Oil)		2.00
Commercial (Oil)		4.00
Electric Heat (Each Room)		.75
APPLIANCES		
Ranges, Cooking Tops, Ovens, Water Heaters, Disposals, Dish washers, etc. — Each Unit		1.50
TEMPORARY WORK (Limited to 6 months on date of permit)		
Service, Single Phase		1.00
Service, Three Phase		2.00
Wiring, 1-50 Outlets		1.00
Wiring, each additional outlet over 10		.02
Circuits, Circuits, etc.		10.00
MISCELLANEOUS		
Distribut. Cabinet or Panel, per unit		1.00
Transformers, per unit		2.00
Air Conditioning, per unit		2.00
Signs, per unit		2.00
ADDITIONS		
5 Outlets, or less		1.00
Over 5 Outlets, Regular Wiring Rates		



FILL IN ANY BLANK WITH INK

APPLICATION FOR PERMIT FOR HEATING, COOKING OR POWER EQUIPMENT

Portland, Maine, August 3 1966

PERMIT ISSUED

(10710) AUG 4 1966

CITY OF PORTLAND

To the INSPECTOR OF BUILDINGS, PORTLAND, ME.

The undersigned hereby applies for a permit to install the following heating, cooking or power equipment in accordance with the Laws of Maine, the Building Code of the City of Portland, and the following specifications:

Location 18 Colonial Road Use of Building Dwelling No. Stories 2 Max Building Existing "
Name and address of owner of appliance Arthur H Stevens, 18 Colonial Road
Installer's name and address Ballard Oil & Equipment Co. 135 Marginalway Telephone

General Description of Work

To install Oil-fired domestic hot water heater, replacing electric tank.

IF HEATER, OR POWER BOILER

Location of appliance Basement Any burnable material in floor surface or beneath? none
If so, how protected? Kind of fuel? oil
Minimum distance to burnable material, from top of appliance or casing top of furnace 3'
From top of smoke pipe 2' From front of appliance 6' From sides or back of appliance 6'
Size of chimney flue 8x12 Other connections to same flue furnace
If gas fired, how vented? Rated maximum demand per hour
Will sufficient fresh air be supplied to the appliance to insure proper and safe combustion? yes

IF OIL BURNER

Name and type of burner Aldrich-guntyps Labeled by underwriters' laboratories? yes
Will operator be always in attendance? Does oil supply line feed from top or bottom of tank? bottom
Type of floor beneath burner concrete Size of vent pipe 4"
Location of oil storage basement Number and capacity of tanks 275 existing
Low water shut off Make No
Will all tanks be more than five feet from any flame? yes How many tanks enclosed
Total capacity of any existing storage tanks for furnace burners

IF COOKING APPLIANCE

Location of appliance Any burnable material in floor surface or beneath
If so, how protected? Height of Legs, if any
Skirting at bottom of appliance? Distance to combustible material from top of appliance?
From front of appliance From sides and back From top of smokepipe
Size of chimney flue Other connections to same flue
Is hood to be provided? If so, how vented? Forced or gravity?
If gas fired, how vented? Rated maximum demand per hour

MISCELLANEOUS EQUIPMENT OR SPECIAL INFORMATION

Amount of fee enclosed 2.00 (\$2.00 for one heater, etc., \$1.00 additional for each additional heater, etc., in same building at same time.)

APPROVED:

0.5 8-3-66 [Signature]

Will there be in charge of the above work a person competent to see that the State and City requirements pertaining thereto are observed? yes

Ballard Oil & Equipment Co.

Signature of Installer Ballard Oil & Equipment Co. [Signature]

CS 320

INSPECTION COPY

Jm.

NOTES

Permit No.

66/709

Location

18 Colonial Road

Owner

Arthur H. Stearns

Date of permit

8/4/66

Approved *[Signature]*

[Faint, illegible handwritten notes]

8-22-66 Not home for
3/4" Beacon Pressure Relief Valve

[Large handwritten 'X' mark across the remaining lined area]

PERMIT TO INSTALL PLUMBING

Date Issued **8/3/66**
 Portland Plumbing Inspector
 By **ERNOLD R. GOODWIN**

App. First Insp.
 Date **8/4/66**
 By **H. Montgomery**
 App. Final Insp.
 Date **AUG 5 - 1966**
 By **ERNOLD R. GOODWIN**
 Chief Plumbing Inspector

- Type of Bldg.
- Commercial
 - Residential
 - Single
 - Multi Family
 - New Construction
 - Remodeling

Address **18 Colonial Road** PERMIT NUMBER **16460**
 Installation For: **Dwelling**
 Owner of Bldg.: **Arthur H. Stevens**
 Owner's Address: **18 Colonial Road, Portland, Maine**
 Plumber: **V. F. Cunningham** Date: **8/3/66**

NEW	REFL.		NO.	FEE
		SINKS		
		LAVATORIES		
		TOILETS		
		BATH TUBS		
		SHOWERS		
		DRAINS FLOOR SURFACE		
		HOT WATER TANKS		
		TANKLESS WATER HEATERS		
		GARBAGE DISPOSALS		
		SEPTIC TANKS		
		HOUSE SEWERS		
		ROOF LEADERS		
		AUTOMATIC WASHERS		
		DISHWASHERS		
		OTHER		
1		OIL FIRED 30 gal. water heater	1	2.00
		TOTAL	1	2.00

Building and Inspection Services Dept: Plumbing Inspection



FILL IN AND SIGN WITH INK

APPLICATION FOR PERMIT FOR HEATING, COOKING OR POWER EQUIPMENT

PERMIT ISSUED
11721
NOV 17 1959

To the INSPECTOR OF BUILDINGS, PORTLAND, ME.
The undersigned hereby applies for a permit to install the following heating, cooking or power equipment in accordance with the Laws of Maine, the Building Code of the City of Portland, and the following specifications:

Location 20 Colonial Road. Use of Building residence. No. Stories 2
Name and address of owner of appliance Mr. Arthur H. Stevens, 18 Colonial Rd.
Installer's name and address Ballard Oil & Equip. Co., 135 Marginal Way Telephone

To install oil-fired steam heating system and oil burning equipment (replacement)
General Description of Work

IF HEATER, OR POWER BOILER
Location of appliance basement. Any burnable material in floor surface or beneath? no
If so, how protected? Kind of fuel? oil
Minimum distance to burnable material, from top of appliance or casing top of furnace
From top of smoke pipe 3' From front of appliance 6'
Size of chimney flue 12x12 Other connections to same flue stove
If gas fired, how vented? Rated maximum demand per hour
Will sufficient fresh air be supplied to the appliance to insure proper and safe combustion?

IF OIL BURNER
Name and type of burner L-ED. Esso. high pressure gun type Labeled by underwriters' laboratories? yes
Will operator be always in attendance? Does oil supply line feed from top or bottom of tank? bottom
Type of floor beneath burner xxxxxxxx Size of vent pipe 1 1/2"
Location of oil storage basement Number and capacity of tanks 275-existing
Low water shut off Make McDonnell Miller No. 469
Will all tanks be more than five feet from any flame? yes How many tanks enclosed? 1- Miller
Total capacity of any existing storage tanks for furnace burners

IF COOKING APPLIANCE
Location of appliance Any burnable material in floor surface or beneath?
If so, how protected? Height of Legs, if any
Skirting at bottom of appliance? Distance to combustible material from top of appliance?
From front of appliance From sides and back From top of smokepipe
Size of chimney flue Other connections to same flue
Is hood to be provided? If so, how vented? Forced or gravity?
If gas fired, how vented? Rated maximum demand per hour

MISCELLANEOUS EQUIPMENT OR SPECIAL INFORMATION

Amount of fee enclosed? 2.00 (\$2.00 for one heater, etc., 50 cents additional for each additional heater, etc., in same building at same time.)

APPROVED
11-17-59
[Signature]

Will there be in charge of the above work a person competent to see that the State and City requirements pertaining thereto are observed? yes

INSPECTION COPY

Signature of Installer

[Signature]
Ballard Oil & Equip. Co.

F M + Mac M



FILL IN AND SIGN WITH INK

APPLICATION FOR PERMIT FOR HEATING, COOKING OR POWER EQUIPMENT

PERMIT ISSUED

APR 1 1958

CITY OF PORTLAND

Portland, Maine, . . . Marsh 31, 1958

To the INSPECTOR OF BUILDINGS, PORTLAND, ME.

The undersigned hereby applies for a permit to install the following heating, cooking or power equipment in accordance with the Laws of Maine, the Building Code of the City of Portland, and the following specifications:

Location 18 Colonial Rd. Use of Building Residence No. Stories 2 New Building
 Name and address of owner of appliance Arthur H. Stevens 18 Colonial Road X Existing "
 Installer's name and address Ballard Oil & Equipment Co. Telephone

General Description of Work

To install conversion oil burner in existing steam boiler

IF HEATER, OR POWER BOILER

Location of appliance Any burnable material in floor surface or beneath?
 If so, how protected? Kind of fuel?
 Minimum distance to burnable material, from top of appliance or casing top of furnace
 From top of smoke pipe From front of appliance From sides or back of appliance
 Size of chimney flue Other connections to same flue
 If gas fired, how vented? Rated maximum demand per hour
 Will sufficient fresh air be supplied to the appliance to insure proper and safe combustion?

IF OIL BURNER

Name and type of burner Ballard GunType Model SC Labeled by underwriters' laboratories? Yes
 Will operator be always in attendance? No Does oil supply line feed from top or bottom of tank? Bottom
 Type of floor beneath burner Concrete Size of vent pipe 1 1/4"
 Location of oil storage Basement Number and capacity of tanks 1-275 existing
 Low water shut off Make McDonnell & Miller No. #169
 Will all tanks be more than five feet from any flame? Yes How many tanks enclosed? None
 Total capacity of any existing storage tanks for furnace burners 1 275 existing

IF COOKING APPLIANCE

Location of appliance Any burnable material in floor surface or beneath?
 If so, how protected? Height of Legs, if any
 Skirting at bottom of appliance? Distance to combustible material from top of appliance?
 From front of appliance From sides and back From top of smokepipe
 Size of chimney flue Other connections to same flue
 Is hood to be provided? If so, how vented? Forced or gravity?
 If gas fired, how vented? Rated maximum demand per hour

MISCELLANEOUS EQUIPMENT OR SPECIAL INFORMATION

Replacing old oil burner

Amount of fee enclosed? \$2.00 (\$3.00 for one heater, etc., 50 cents additional for each additional heater, etc., in same building at same time.)

APPROVED
 3-31-58
 [Signature]

Will there be in charge of the above work a person competent to see that the State and City requirements pertaining thereto are observed?

BALLARD OIL & EQUIPMENT CO.

INSPECTION COPY

Signature of Installer

Richard J. Cole, Manager
Oil Heating Department

fm

4-7

A-3

Permit No. 58/246
 Location 17th Street, N.W.
 Owner W. H. Brown, Jr.
 Date of permit 7/1/55
 Approved [Signature]

NOTES

1	Full	
2	Part	
3	Excavation	
4	Demolition	
5	Foundation	
6	Other	
7	Other	
8	Other	
9	Other	
10	Other	
11	Other	
12	Other	
13	Other	
14	Other	
15	Other	
16	Other	
17	Other	
18	Other	
19	Other	
20	Other	
21	Other	
22	Other	
23	Other	
24	Other	
25	Other	
26	Other	
27	Other	
28	Other	
29	Other	
30	Other	
31	Other	
32	Other	
33	Other	
34	Other	
35	Other	
36	Other	
37	Other	
38	Other	
39	Other	
40	Other	
41	Other	
42	Other	
43	Other	
44	Other	
45	Other	
46	Other	
47	Other	
48	Other	
49	Other	
50	Other	

Two large rectangular areas with horizontal lines, intended for handwritten notes or descriptions. The left area is approximately 250x550 units, and the right area is approximately 250x550 units.

Inquiry 118 Colonia Rd.

September 30, 1952

Mr. Charles C. Nicely,
1041 Brighton Avenue,
Portland, Maine

Dear Mr. Nicely:

In regard to your inquiry concerning the question of constructing an outside fireplace chimney on the side towards Capisic Street of the dwelling at 118 Colonial Road, we find that, according to the location plan filed with the application for permit for construction of the building, the minimum allowable side yard clearance of five feet from the lot line was provided on this side of the building. This being the case, we would not be able to issue a permit for the projection of an outside chimney any distance whatsoever into this existing side yard.

As is the case with other requirements of the Zoning Ordinance, this question is subject to appeal. Although we cannot tell in advance what action the Board of Appeals might take on a request from you that relief be granted from compliance with the precise terms of the Ordinance in this particular case, you have the right to exercise your appeal rights if you desire to do so. In such a case the procedure to follow is to file an application for a building permit to erect the chimney, issuance of which we shall have to deny because of the reason stated above. Knowing that you wish to appeal, we will then send you a letter denying issuance of the permit, enclosing an outline of the appeal procedure, and authorizing action by the Corporation Counsel in assisting you to file the appeal.

Very truly yours,

Inspector of Buildings

AJS/R

INQUIRY BLANK

ZONE _____

CITY OF PORTLAND, MAINE
DEPARTMENT OF BUILDING INSPECTION

FIRE DIST. _____

Verbal
By Telephone

Date 9/29/52

LOCATION 118 Colonial Rd. OWNER Charles C. Nichols

MADE BY Same TEL. _____

ADDRESS _____

PRESENT USE OF BUILDING Dwellings

CLASS OF CONSTRUCTION 2d NO. OF STORIES _____

REMARKS: _____

INQUIRY: Can an outside fireplace chimney be constructed on the side of the house toward Capric St?

ANSWER: See letter attached.

DATE OF REPLY 9/29/52 REPLY BY ajs

Receipt—Applicant's Copy

CITY OF PORTLAND, MAINE

Department of Building Inspection

not paid

94 F

Received from Samuel Allen, Jr. Jan. 18 1950

of Town a fee of 00 /100 Dollars \$ 2.00

for permit to install erect alter move demolish dwellings

at 18 Colonel Road Est. Cost \$ 150

Harrold McDonald
Inspector of Buildings

Per RB

THIS IS NOT A PERMIT

No work is to be started until PERMIT CARD is actually posted upon the premises. Acceptance of fee is no guarantee that permit will be granted. PRE-SERVE THIS RECEIPT. In case permit cannot be granted, the amount of the fee will be refunded upon return of the receipt.



APPLICATION FOR PERMIT

Class of Building or Type of Structure Third Class

Portland, Maine, January 18, 1950

To the INSPECTOR OF BUILDINGS, PORTLAND, MAINE

The undersigned hereby applies for a permit to ~~construct~~ alter ~~reconstruct~~ the following building ~~structure~~ in accordance with the Laws of the State of Maine, the Building Code and Zoning Ordinance of the City of Portland, plans and specifications, if any, submitted herewith and the following specifications:

Location 18 Colonial Road Within Fire Limits? no Dist. No. _____
 Owner's name and address Samuel Allen, Jr., 18 Colonial Road Telephone 4-0175
 Lessee's name and address _____ Telephone _____
 Contractor's name and address Owner Telephone _____
 Architect _____ Specifications _____ Plans no No. of sheets _____
 Proposed use of building Duplex dwelling house No. families 2
 Past use _____ " " " " No. families 2
 Material wood No. stories 2 1/2 Heat _____ Style of roof _____ Roofing _____
 Other buildings on same lot _____
 Estimated cost \$ 150. Fee \$ 2.00

General Description of New Work

To finish off room on third floor approximately 15' x 18' for recreational room.
 Walls will be covered with celotex and provide celotex ceiling.
 One stairway existing to third floor on this side of building.

It is understood that this permit does not include installation of heating system which is to be taken out separately by and in the name of the heating contractor. **PERMIT TO BE ISSUED TO owner**

Details of New Work

Is any plumbing involved in this work? _____ Is any electrical work involved in this work? _____
 Height average grade to top of plate _____ Height average grade to highest point of roof _____
 Size, front _____ depth _____ No. stories _____ solid or filled land? _____ earth or rock? _____
 Material of foundation _____ Thickness, top _____ bottom _____ cellar _____
 Material of underpinning _____ Height _____ Thickness _____
 Kind of roof _____ Rise per foot _____ Roof covering _____
 No. of chimneys _____ Material of chimney _____ of lining _____ Kind of heat _____ fuel _____
 Framing lumber—Kind _____ Dressed or full size? _____
 Corners—posts _____ Sills _____ Girt or ledger board? _____ Size _____
 Girders _____ Size _____ Columns under girders _____ Size _____ Max. on centers _____
 Studs (outside walls and carrying partitions) 2x4-16" O. C. Bridging in every floor and flat roof span over 8 feet
 Joists and rafters: 1st floor _____, 2nd _____, 3rd _____, roof _____
 On centers: 1st floor _____, 2nd _____, 3rd _____, roof _____
 Maximum span: 1st floor _____, 2nd _____, 3rd _____, roof _____
 If one story building with masonry walls, thickness of walls? _____ height? _____

If a Garage

No. cars now accommodated on same lot _____, to be accommodated _____ number commercial cars to be accommodated _____
 Will automobile repairing be done other than minor repairs to cars habitually stored in the proposed building? _____

APPROVED:

Miscellaneous

Will work require disturbing of any tree on a public street? no
 Will there be in charge of the above work a person competent to see that the State and City requirements pertaining thereto are observed? yes

INSPECTION COPY

Signature of owner



FILL IN AND SIGN WITH INK

APPLICATION FOR PERMIT FOR HEATING, COOKING OR POWER EQUIPMENT

Portland, Maine, April 20, 1948

PERMIT ISSUED
00536
APR 20 1948
CITY of PORTLAND

To the INSPECTOR OF BUILDINGS, PORTLAND, MAINE

The undersigned hereby applies for a permit to install the following heating, cooking or power equipment in accordance with the Laws of Maine, the Building Code of the City of Portland, and the following specifications:

Location 18 Colonial Road Use of Building Dwelling No. Stories 2 New Building
Existing "
Name and address of owner of appliance Sam Allen, Jr., 18 Colonial Road
Installer's name and address Arthur Moulton, 21 Roberts Street Telephone 4-2711

General Description of Work

To ~~install~~ To Replace steam boiler

IF HEATER, OR POWER BOILER

Location of appliance or source of heat Cellar Type of floor beneath appliance Concrete
If wood, how protected? _____ Kind of fuel Oil
Minimum distance to wood or combustible material, from top of appliance or casing top of furnace 4'
From top of smoke pipe 4' From front of appliance over 4' From sides or back of appliance over 4' on one side
Size of chimney flue 8x8 Other connections to same flue Another boiler over 4' on other side
If gas fired, how vented? _____ Rated maximum demand per hour _____

IF OIL BURNER

Name and type of burner _____ Labeled by underwriter's laboratories? _____
Will operator be always in attendance? _____ Does oil supply line feed from top or bottom of tank? _____
Type of floor beneath burner _____
Location of oil storage _____ Number and capacity of tanks _____
If two 275-gallon tanks, will three-way valve be provided? _____
Will all tanks be more than five feet from any flame? _____ How many tanks fire proofed? _____
Total capacity of any existing storage tanks for furnace burners _____

IF COOKING APPLIANCE

Location of appliance _____ Kind of fuel _____ Type of floor beneath appliance _____
If wood, how protected? _____
Minimum distance to wood or combustible material from top of appliance _____
From front of appliance _____ From sides and back _____ From top of smokepipe _____
Size of chimney flue _____ Other connections to same flue _____
Is hood to be provided? _____ If so, how vented? _____
If gas fired, how vented? _____ Rated maximum demand per hour _____

MISCELLANEOUS EQUIPMENT OR SPECIAL INFORMATION

Amount of fee enclosed? 1.00 (\$1.00 for one heater, etc., 50 cents additional for each additional heater, etc., in same building at same time.)

APPROVED:

OK 4-20-48 [Signature]

Will there be in charge of the above work a person competent to see that the State and City requirements pertaining thereto are observed? Yes

INSPECTION COPY

Signature of Installer

Arthur Moulton



FILL IN COMPLETELY AND SIGN WITH INK

APPLICATION FOR PERMIT FOR HEATING, COOKING OR POWER EQUIPMENT

PERMIT 0117
ISSUED

FEB 9 1940

To the INSPECTOR OF BUILDINGS, PORTLAND, ME.

Portland, Maine, February 3, 1940

The undersigned hereby applies for a permit to install the following heating, cooking or power equipment in accordance with the Laws of Maine, the Building Code of the City of Portland, and the following specifications:

Location 18 Colonial Road Use of Building dwelling house No. Stories 2 NEW Existing "EXISTING"
Name and address of owner of appliance S. N. Allen, 95 Hastings Street
Installer's name and address Owner Telephone 2-3797

General Description of Work

To install steam heating system

IF HEATER, POWER BOILER OR COOKING DEVICE

Is appliance or source of heat to be in cellar? yes If not, which story _____ Kind of Fuel oil
Material of supports of appliance (concrete floor or what kind) concrete
Minimum distance to wood or combustible material, from top of appliance or casing top of furnace, 4"
from top of smoke pipe 5" from front of appliance 4" from sides or back of appliance 4"
Size of chimney flue 8x12 Other connections to same flue at same place

IF OIL BURNER

Name and type of burner _____ Labeled and approved by Underwriters' Laboratories? _____
Will operator be always in attendance? _____ Type of oil feed (gravity, pressure) _____
Location oil storage _____ No. and capacity of tanks _____
Will all tanks be more than seven feet from any flame? _____ How many tanks fire proofed? _____
Amount of fee enclosed? 1.00 (\$1.00 for one heater, etc., 50 cents additional for each additional heater, etc., in same building at same time.)

INSPECTION COPY

Signature of Installer S. N. Allen

P. 33/2051-I
P. 40/48-I

January 20, 1940

Mr. Samuel N. Allen,
94 Hastings Street,
Portland, Maine

Dear Sir:

With relation to your building at 18 Colonial Road, Halverson Bros. have secured a permit to cover the installation of two oil burners, one in connection with an existing steam heating plant and the other to be a part of a new steam heating system.

No permit has been applied for as required for the installation of the steam system, though we find that the boiler has been set in the cellar and the steam pipes at least are being connected.

In case of more than one party working on a job, we consider that a permit is to be taken out by the person, firm or corporation which connects the boiler to the chimney.

Will you be kind enough to see that this additional permit is applied for and secured without delay, before the job is carried any farther?

Very truly yours,

EMcD/H

CC: Halverson Bros.
15 Union Street

Inspector of Buildings



FILL IN COMPLETELY AND SIGN WITH INK

PERMIT ISSUED
Permit No. 0018

APPLICATION FOR PERMIT FOR HEATING, COOKING OR POWER EQUIPMENT

Portland, Maine, January 15, 1940

To the INSPECTOR OF BUILDINGS, PORTLAND, ME.

The undersigned hereby applies for a permit to install the following heating, cooking or power equipment in accordance with the Laws of Maine, the Building Code of the City of Portland, and the following specifications:

Location 18-20 Colonial Road Use of Building Dwelling House No. Stories 2 Non-Existing
Existing "Existing"
Name and address of owner of appliance St. K. Allen, 94 Hastings St.
Installer's name and address Halverson Bros. 9-15 Union St. Telephone 3-3732

General Description of Work

To install (2) Oil Burning Equipment in connection with existing steam heat and with new steam system to be installed

IF HEATER, POWER BOILER OR COOKING DEVICE

Is appliance or source of heat to be in cellar? yes If not, which story _____ Kind of Fuel Oil

Material of supports of appliance (concrete floor or what kind) concrete

Minimum distance to wood or combustible material, from top of appliance or casing top of furnace, _____
from top of smoke pipe _____ from front of appliance _____ from sides or back of appliance _____

Size of chimney flue _____ Other connections to same flue _____

IF OIL BURNER

Name and type of burner Torrington Model G Labeled and approved by Underwriters' Laboratories? yes

Will operator be always in attendance? _____ Type of oil feed (gravity or pressure) pressure

Location oil storage basement No. and capacity of tanks 1- 275 gal. for each

Will all tanks be more than seven feet from any flame? yes How many tanks fireproofed? _____

Amount of fee enclosed? 1.00 (\$1.00 for one heater, etc., 50 cents additional for each additional heater, etc., in same building at same time.)
Signature of Installer Halverson Bros.

INSPECTION COPY

Permit No. 40/48
 Location 18-20 Colonial Road
 Owner S. N. Allen
 Date of Permit 1/16/40

Post Card sent
 Notif. for insp.
 Approval Tag issued 2/12/40
 Oil Burner Check List (date) 2/12/40

1. Kind of heat Steam
2. Label ✓
3. Anti-siphon ✓
4. Oil storage ✓
5. Tank distance ✓
6. Vent Pipe ✓
7. Fill Pipe ✓
8. Gauge ✓
9. Rigidity ✓
10. Feed safety ✓
11. Pipe sizes and material ✓
12. Control valve ✓
13. Ath pit vent ✓
14. Temp. or pressure safety ✓
15. Instruction card ✓
- 16.

NOTES

1/15/40. No work started
1/20/40 - Better and not
checked without permit issued.

P.53/2081-I
C. 43/48-I

January 30, 1940

Mr. Samuel N. Allen,
94 Hastings Street,
Portland, Maine

Dear Sir:

With relation to your building at 18 Colonial Road, Halverson Bros. have secured a permit to cover the installation of two oil burners, one in connection with an existing steam heating plant and the other to be a part of a new steam heating system.

No permit has been applied for as required for the installation of the steam system, though we find that the boiler has been set in the cellar and the steam pipes at least are being connected.

In case of more than one party working on a job, we consider that a permit is to be taken out by the person, firm or corporation which connects the boiler to the chimney.

Will you be kind enough to see that this additional permit is applied for and secured without delay, before the job is carried any farther?

Very truly yours,

EMcD/H

CC: Halverson Bros.
15 Union Street

Inspector of Buildings



APPLICATION FOR PERMIT

Class of Building or Type of Structure _____

NOV 10 1939

Portland, Maine, November 7, 1939

To the INSPECTOR OF BUILDINGS, PORTLAND, ME.

The undersigned hereby applies for a permit to erect alter install the following building structure-equipment in accordance with the Laws of the State of Maine, the Building Code of the City of Portland, plans and specifications, if any, submitted herewith and the following specifications:

Location 18 Colonial Road Within Fire Limits? NO Dist. No. _____
 Owner's or Lessee's name and address Samuel Allen, 94 Hastings St. Telephone _____
 Contractor's name and address Karl Furst, 19 Inverness St. Telephone 3-3391
 Architect _____ Plans filed yes No. of sheets 2
 Proposed use of building dwelling house No. families 2
 Other buildings on same lot _____
 Estimated cost \$ 1,000. Fee \$ 1.00

Description of Present Building to be Altered

Material wood No. stories 2 Heat steam Style of roof pitch Roofing asphalt
 Last use dwelling house No. families 1

General Description of New Work

18 Colonial Road-11/10/39-To Karl Furst and Samuel N. Allen
94 Hastings St.

Dear Mr. Furst:

I understand that you are to introduce whatever supporting girders, posts, etc. that are necessary to comply with Building Code requirements as to strength including a 6x8 through the center of the building supported by posts and additional posts under a built up 6x8 in the cellar which you say is on a 12-foot span.

Details of New Work

Is any plumbing work involved in this work? yes
 Is any electrical work involved in this work? yes Height average grade to top of plate _____
 Size, front _____ depth _____ No. stories _____ Height average grade to highest point of roof _____
 To be erected on solid or filled land? _____ earth or rock? _____
 Material of foundation _____ Thickness, top _____ bottom _____ ce'lar _____
 Material of underpinning _____ Height _____ thickness _____
 Kind of Roof _____ Rise per foot _____ Roof covering _____
 No. of chimneys _____ Material of chimneys _____ of lining _____
 Kind of heat _____ Type of fuel _____ Is gas fitting involved? _____
 Framing Lumber-Kind _____ Dressed or Full Size? _____
 Corner posts _____ Sills _____ Girt or ledger board? _____ Size _____
 Material columns under girders _____ Size _____ Max. on centers _____
 Studs (outside walls and carrying partition) 2x4-16" O. C. Girders 6x8 or larger. Bridging in every floor and flat roof span over 8 feet. Sills and corner posts all one piece in cross section.
 Joists and rafters: 1st floor _____, 2nd _____, 3rd _____, roof _____
 On centers: 1st floor _____, 2nd _____, 3rd _____, roof _____
 Maximum span: 1st floor _____, 2nd _____, 3rd _____, roof _____
 If one story building with masonry walls, thickness of walls? _____ height? _____

If a Garage

No. cars now accommodated on same lot _____, to be accommodated _____
 Total number commercial cars to be accommodated _____
 Will automobile repairing be done other than minor repairs to cars habitually stored in the proposed building? _____

Miscellaneous

Will above work require removal or disturbing of any shade tree on a public street? no
 Will there be in charge of the above work a person competent to see that the State and City requirements pertaining thereto are observed? yes

Signature of owner

Samuel Allen

INSTRUCTION COPY

By Karl Furst

3-435

912751

Permit # 912751 City of Portland BUILDING PERMIT APPLICATION Fee \$25. Zone _____ Map # _____ Lot# _____
Please fill out any part which applies to job. Proper plans must accompany form.

Owner: Agnes S. Racine Phone # 892-4656
Address: P O Box 743, No Windham, ME 04062
LOCATION OF CONSTRUCTION 18-20 Colonial Rd.
Contractor: Owen P. Maescher Sub: 772-7404
Address: 20 Colonial Rd; Ptd. ME Phone # 04102
Est. Construction Cost: \$950 Proposed Use: 2-fam w shed
Past Use: _____
of Existing Res. Units _____ # of New Res. Units _____
Building Dimensions L _____ W _____ Total Sq. Ft. _____
Stories: _____ # Bedrooms _____ Lot Size: _____
Is Proposed Use: Seasonal _____ Condominium _____ Conversion _____
Explain Conversion Demolish garage & Construct shed - 6'x4'

For Official Use Only
Date: 6/19/91 Subdivision _____
Inside Fire Limits _____
Bldg Code _____ Ownership _____
Time Limit _____
Estimated Cost: \$950
Zoning: R-5 Residence
Street Frontage Provided: _____
Provided Setbacks: Front _____ Back _____ Side _____ Side _____
Review Required:
Zoning Board Approval: Yes _____ No _____ Date: _____
Planning Board Approval: Yes _____ No _____ Date: _____
Conditional Use: _____ Variance _____ Site Plan _____ Subdivision _____
Shoreland Zoning Yes _____ No _____ Floodplain Yes _____ No _____
Special Exception _____
Other (Explain) W.D. 6-24-91

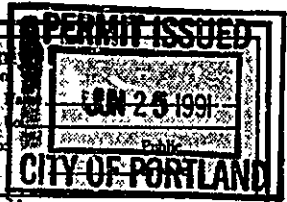

Foundations:
1. Type of Soil: _____
2. Set Backs - Front _____ Rear _____ Side(s) _____
3. Footings Size: _____
4. Foundation Size: _____
5. Other _____

Floor:
1. Sills Size: _____ Sills must be anchored.
2. Girder Size: _____
3. Lally Column Spacing: _____ Size: _____
4. Joists Size: _____ Spacing 16" O.C.
5. Bridging Type: _____ Size: _____
6. Floor Sheathing Type: _____ Size: _____
7. Other Material: _____

Exterior Walls:
1. Studding Size _____ Spacing _____
2. No. windows _____
3. No. Doors _____
4. Header Sizes _____ Span(s) _____
5. Bracing: Yes _____ No _____
6. Corner Posts Size _____
7. Insulation Type _____ Size _____
8. Sheathing Type _____ Size _____
9. Siding Type _____ Weather Exposure _____
10. Masonry Materials _____
11. Metal Materials _____

Interior Walls:
1. Studding Size _____ Spacing _____
2. Header Sizes _____ Span(s) _____
3. Wall Covering Type _____
4. Fire Wall if required _____
5. Other Materials _____

Ceiling:
1. Ceiling Joists Size: _____
2. Ceiling Strapping Size _____ Spacing _____
3. Type Ceiling: _____
4. Insulation Type _____ Size _____
5. Ceiling Height: _____
HISTORIC PRESERVATION
*Not in District nor Landmark.
*Does not require review.
*Requires Review.

Roof:
1. Truss or Rafter Size _____ Span _____ Action _____
2. Sheathing Type _____ Size _____
3. Roof Covering Type _____

Chimneys:
Type: _____ Number of Fire Places _____ Date: _____

Heating:
Type of Heat: _____
Electrical:
Service Entrance Size: _____ Smoke Detector Required Yes _____ No _____

Plumbing:
1. Approval of soil test if required Yes _____ No _____
2. No. of Tubs or Showers _____
3. No. of Flushes _____
4. No. of Lavatories _____
5. No. of Other Fixtures _____

Swimming Pools:
1. Type: _____
2. Pool Size: _____ x _____ Square Footage _____
3. Must conform to National Electrical Code and State Law.

Permit Issued By: Louise F. Chase
Signature of Applicant: Owen P. Maescher Date: 6-19-91
Signature of CEO: _____ Date: _____
Inspection Dates: _____

PERMIT ISSUED WITH REQUIREMENTS

White-Tax Assessor Yellow-GPCOG White Tag-CEO
[H] M.A. Carroll © Copyright GPCOG 1988



APPLICATION FOR PERMIT
DEPARTMENT OF BUILDING INSPECTIONS SERVICES
ELECTRICAL INSTALLATIONS

212VI

Date November 30, 1992, 19
 Receipt and Permit number 6207

To the **CHIEF ELECTRICAL INSPECTOR, Portland, Maine:**
 The undersigned hereby applies for a permit to make electrical installations in accordance with the laws of
 Maine, the Portland Electrical Ordinance, the National Electrical Code and the following specifications:

LOCATION OF WORK: 20 Colonial Rd
OWNER'S NAME: Agnes Racine **ADDRESS:** _____

OUTLETS:		FEES
Receptacles <u>7</u>	Switches _____ Plugmold _____ ft. TOTAL _____	<u>1.40</u>
FIXTURES: (number of)		FEES
Incandescent _____	Flourescent _____ (not strip) TOTAL _____	<u>2.00</u>
Strip Flourescent _____ ft.		
SERVICES:		
Overhead <input checked="" type="checkbox"/> Underground _____ Temporary _____	TOTAL amperes <u>100</u> each	<u>30.00</u>
METERS: (number of) <u>2</u>		<u>2.00</u>
MOTORS: (number of)		
Fractional _____		
1 HP or over _____		
RESIDENTIAL HEATING:		
Oil or Gas (number of units) _____		
Electric (number of rooms) _____		
COMMERCIAL OR INDUSTRIAL HEATING:		
Oil or Gas (by a main boiler) _____		
Oil or Gas (by separate units) _____		
Electric Under 20 kws _____ Over 20 kws _____		
APPLIANCES: (number of)		
Ranges _____	Water Heaters _____	
Cook Tops _____	Disposals _____	
Wall Ovens _____	Dishwashers _____	
Dryers _____	Compactors _____	
Fans _____	Others (denote) _____	
TOTAL: _____		
MISCELLANEOUS: (number of)		
Branch Panels _____		
Transformers _____		
Air Conditioners Central Unit _____		
Separate Units (windows) _____		
Signs 20 sq. ft. and under _____		
Over 20 sq. ft. _____		
Swimming Pools Above Ground _____		
In Ground _____		
Fire/Burglar Alarms Residential _____		
Commercial _____		
Heavy Duty Outlets, 220 Volt (such as welders) 30 amps and under _____		
over 30 amps _____		
Circus, Fairs, etc. _____		
Alterations to wires _____		
Repairs after fire _____		
Emergency Lights, battery _____		
Emergency Generators _____		

FOR ADDITIONAL WORK NOT ON ORIGINAL PERMIT **INSTALLATION FEE DUE:**
 FOR REMOVAL OF A "STOP ORDER" (304-16.b) **DOUBLE FEE DUE:**
TOTAL AMOUNT DUE: 33.40

INSPECTION:
 Will be ready on _____, 19____; or Will Call XXX 874-8300 X8700
CONTRACTOR'S NAME: Marc's Electrical Service
ADDRESS: 527 Blackstrap Rd Falmouth 04105
TEL.: 797-7722
MASTER LICENSE NO.: 6207 **SIGNATURE OF CONTRACTOR:** Marc Gagne
LIMITED LICENSE NO.: _____

ORB-12-5-90

INSPECTOR'S COPY — WHITE
 OFFICE COPY — CANARY
 CONTRACTOR'S COPY — GREEN

912751

Permit # _____ City of Portland BUILDING PERMIT APPLICATION Fee \$25 Zone _____ Map # _____ Lot# _____

Please fill out any part which applies to job. Proper plans must accompany form.

Owner: Alan S. Macpherson Phone # 842-4565
 Address: 18-70 Colonial Rd. #1062
 LOCATION OF CONSTRUCTION: 18-70 Colonial Rd.
 Contractor: Harvey Haeschler Sub: 772-7194
 Address: 18-70 Colonial Rd. #1062 Phone # 04102
 Est. Construction Cost: 3250 Proposed Use: 2-Fam 4 shdw
 Past Use: _____
 # of Existing Res. Units _____ # of New Res. Units _____
 Building Dimensions: L _____ W _____ Total Sq. Ft. _____
 # Stories: _____ # Bedrooms _____ Lot Size: _____
 Proposed Use: Seasonal _____ Condominium _____ Conversion _____
 Explain Conversion: Demolish garage & Construct shed - 6'x1'

PERMIT ISSUED
FOR OFFICIAL USE ONLY
 Date: 5/20/91
 Inside Fire Limits: _____
 Bldg Code: _____
 Time Limit: _____
 Estimated Cost: _____
CITY OF PORTLAND
 JUN 25 1991

Zoning: _____
 Street Frontage Provided: _____
 Provided Setbacks: Front _____ Back _____ Side _____
 Review Required:
 Zoning Board Approval: Yes _____ No _____ Date: _____
 Planning Board Approval: Yes _____ No _____ Date: _____
 Conditional Use: _____ Variance _____ Site Plan _____ Subdivision _____
 Sherland Zoning Yes _____ No _____ Floodplain Yes _____ No _____
 Special Exception _____
 Other: W.D. 18-24-91

Foundations:
 1. Type of Soil: _____
 2. Set Backs: Front _____ Rear _____ Side(s) _____
 3. Footings Size: _____
 4. Foundation Size: _____
 5. Other: _____

Floor:
 1. Sills Size: _____ Sills must be anchored.
 2. Girder Size: _____
 3. Lally Column Spacing: _____ Size: _____
 4. Joists Size: _____ Spacing 16" O.C
 5. Bridging Type: _____ Size: _____
 6. Floor Sheathing Type: _____ Size: _____
 7. Other Material: _____

Exterior Walls:
 1. Studding Size _____ Spacing _____
 2. No. windows _____
 3. No. Doors _____
 4. Header Sizes _____ Span(s) _____
 5. Bracing: Yes _____ No _____
 6. Corner Posts Size _____
 7. Insulation Type _____ Size _____
 8. Sheathing Type _____ Size _____
 9. Siding Type _____ Weather Exposure _____
 10. Masonry Materials _____
 11. Metal Materials _____

Interior Walls:
 1. Studding Size _____ Spacing _____
 2. Header Sizes _____ Span(s) _____
 3. Wall Covering Type _____
 4. Fire Wall if required _____
 5. Other Materials _____

HISTORIC PRESERVATION
 1. Ceiling Joists Size _____
 2. Ceiling Strapping Size _____ Spacing _____
 3. Type Ceilings: _____
 4. Insulation Type _____ Size _____
 5. Ceiling Height: _____

Roof:
 1. Truss or Rafter Size _____ Spacing _____
 2. Sheathing Type _____ Size _____
 3. Roof Covering Type _____

Chimneys:
 Type: _____ Number of Fire Places _____

Heating:
 Type of Heat: _____

Electrical:
 Service Entrance Size: _____ Smoke Detector Required Yes _____ No _____

Plumbing:
 1. Approval of soil test if required Yes _____ No _____
 2. No. of Tubs or Showers _____
 3. No. of Flushes _____
 4. No. of Lavatories _____
 5. No. of Other Fixtures _____

Swimming Pools:
 1. Type _____
 2. Pool Size _____ Square Footage _____
 3. Must conform to National Electrical Code and State Law.

Permit Received By _____

Signature of Applicant: Harvey Haeschler Date: 6-19-91

Signature of Inspector: _____

Inspection Dates: _____

White-Tax Assessor Yellow-GPCOG White Tag-CEO © Copyright GPCOG 1985
 M.A. Carroll

PLOT PLAN



Done w/out Insp.

FEES (Breakdown From Front)

Base Fee \$ 25-

Subdivision Fee \$ _____

Site Plan Review Fee \$ _____

Other Fees \$ _____

(Explain) _____

Late Fee \$ _____

Type	Inspection Record	Date
_____	_____	____/____/____
_____	_____	____/____/____
_____	_____	____/____/____
_____	_____	____/____/____

COMMENTS

Signature of Applicant Mary L. Maescher Date _____

Demolition of Buildings Permit

**PERMIT ISSUED
WITH REQUIREMENTS**

(a) No building served by a building drainage system, sanitary or storm sewer, or both, which is connected to the public sewers or to a private sewer system connected to the public sewers, may be demolished prior to the termination of the building and/or facility sewer or drain at the city sewer under the inspection of the public works authority. The building sewer shall be terminated at the main, at the point designated by the public works authority.

(b) Notice of intent to demolish a building shall be given to the public works authority, by means of a copy of the application for a demolition permit from the building authority or by direct notice to the public works authority, in advance of the time when the building drain is to be terminated. No such demolition permit shall be issued until a drain termination permit has been issued by the public works authority and a copy thereof has been given to the building authority.

(c) The fee to terminate the building and/or facility sewer and/or drain system will be paid to the city in advance of the termination. The fee of two hundred fifty dollars (\$250.00) per termination represents inspection fees and materials to terminate sewer service. Upon payment of this fee and approval by the public works authority, the applicant shall be issued a sewer termination permit.

(d) Failure to give notice of intent to demolish a building to the public works authority, or to terminate the building drain prior to demolition thereof, or to obtain a permit therefor, shall be deemed a violation of this section, with each day in which the violation continues deemed to be a separate violation.

(e) All excavation for sewer service termination shall be made and maintained in compliance with all provisions of the construction safety rules and regulations of chapter 25, article VII of this Code.

Removal and disposal of demolition debris: Before a permit either to demolish or remove a structure or a part thereof or to remove or dispose of existing demolition debris, as defined herein, is issued, the applicant will satisfy the building official that:

1. All such debris will be removed from the island and transported to the mainland for disposal prior to the expiration of the permit;
2. The debris will be removed to a duly licensed disposal facility; and
3. The disposal of the debris at such facility will be in accordance with all applicable federal and state rules, statutes and regulations relating to the transportation and disposition of such material.

Demolition debris: Demolition debris includes, but is not limited to, materials which are created by site preparation, clearing land or erection of a structure. It also includes, but is not limited to, brush, tree limbs, stumps; and building materials and the waste products of building activity, such as: clay, brick, masonry, concrete, plaster, glass, wood and wood products, asphalt, rubber, metal; and plumbing, electrical and heating fixtures, appurtenances thereto and parts thereof.

No demolition debris shall either be disposed of or stored on any of the islands.

18-20 Colonial Road
Portland, Maine 04102
Agnes S. Racine, Owner

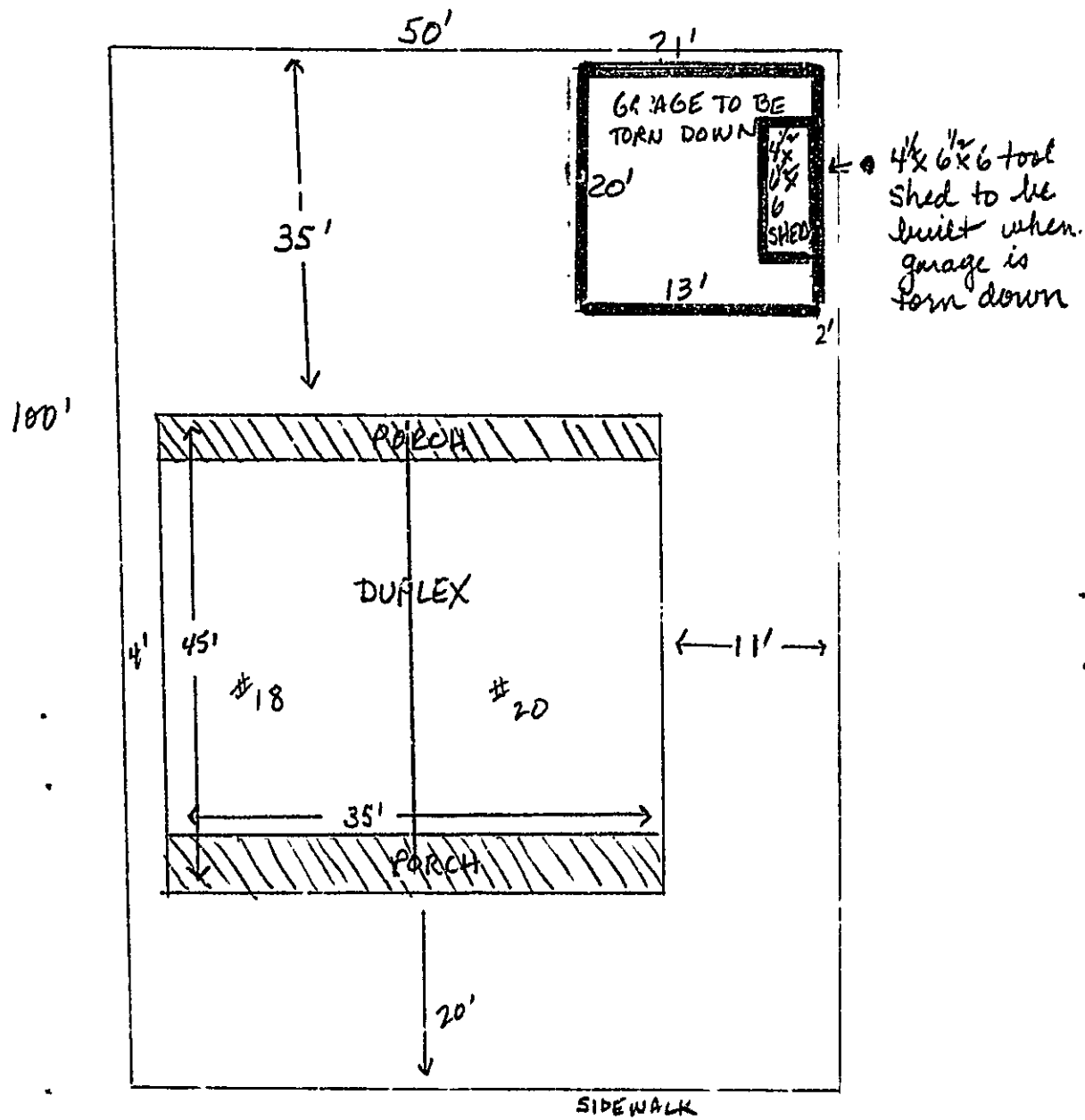

Tool Shed to be built
18-20 Colonial Road
Portland, ME 04102

Agnes S. Racine, Owner

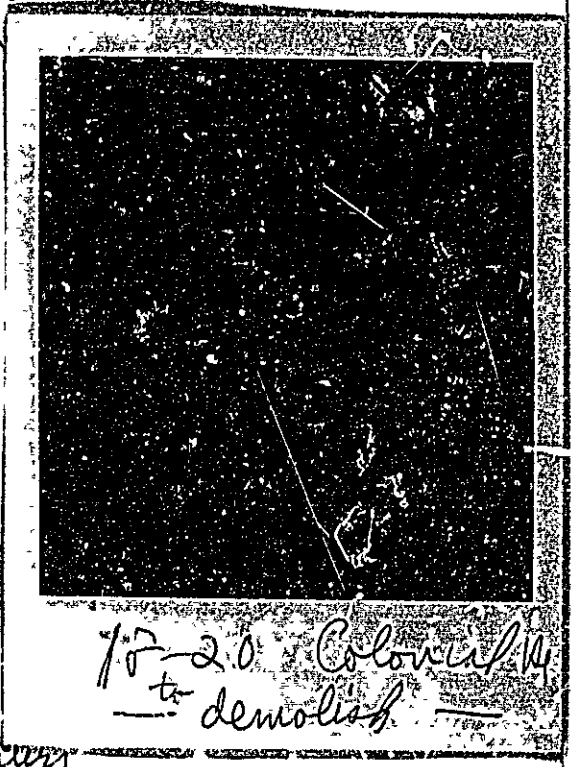
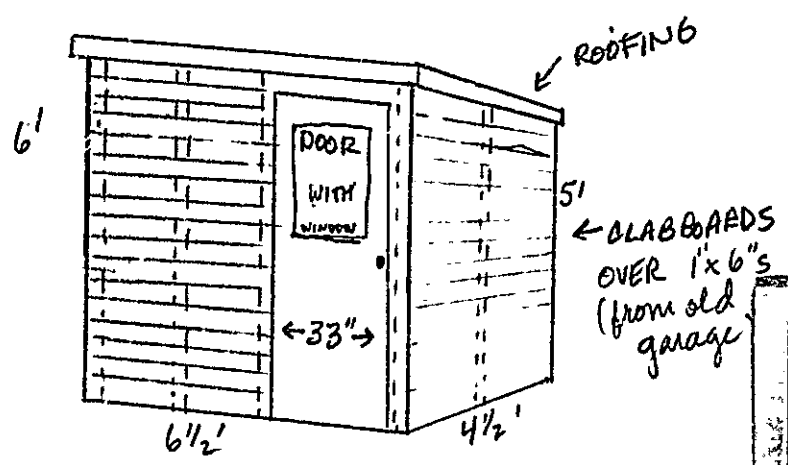

18-20 Colonial Rd
to demolish

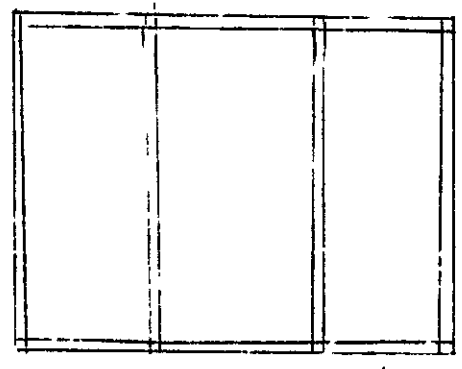

Frame out with 2x4"s on 24" centers

Floor of 3/4" pressed board over cinder block foundation

Materials recycled from torn down garage.