

(COPY)

CITY OF PORTLAND, MAINE
Department of Building Inspection



Certificate of Occupancy

LOCATION Lot 17 Alden Circle

Issued to The Hinat Corp.

Date of Issue July 21, 1959

This is to certify that the building, premises, or part thereof, at the above location, built ~~1958~~
~~1958~~ changed as to use under Building Permit No. 59/850, has had final inspection, has been found to conform
substantially to requirements of Zoning Ordinance and Building Code of the City, and is hereby approved for
occupancy or use, limited or otherwise, as indicated below.

PORTIONS OF BUILDING OR PREMISES

APPROVED OCCUPANCY

Entire

1-family dwelling

Limiting Conditions:

This certificate supersedes
certificate issued

Approved:

Nelson F. Cartwright
Inspector

(Date)

Albert J. Sears
Inspector of Buildings

Notice: This certificate identifies lawful use of building or premises, and ought to be transferred from
owner to owner when property changes hands. Copy will be furnished to owner or lessee for one dollar.



R3 RESIDENCE ZONE
APPLICATION FOR PERMIT

Class of Building or Type of Structure Third Class
Portland, Maine, July 3, 1958

PERMIT ISSUED

JUL 8 1958

CITY OF PORTLAND

To the INSPECTOR OF BUILDINGS, PORTLAND, MAINE

The undersigned hereby applies for a permit to erect ~~alter repair demolish~~ install the following building structure equipment in accordance with the Laws of the State of Maine, the Building Code and Zoning Ordinance of the City of Portland, plans and specifications, if any, submitted herewith and the following specifications:

Location Lot 17 Alden Circle Within Fire Limits? no Dist. No.
Owner's name and address The Minat Corp. 34 Freble St. Telephone
Lessee's name and address Telephone
Contractor's name and address OWNERS Telephone 4-8013
Architect Specifications Plans yes No. of sheets 3
Proposed use of building Dwelling No. families 1
Last use No. families
Material frame No. stories 2 Heat Style of roof Roofing
Other building on same lot
Estimated cost \$ 13,000 Fee \$ 13.00

General Description of New Work

To construct 2-story frame dwelling house 24' x 32'

It is understood that this permit does not include installation of heating apparatus which is to be taken out separately by and in the name of the heating contractor. PERMIT TO BE ISSUED TO owners

Details of New Work

Is any plumbing involved in this work? yes Is any electrical work involved in this work? yes
Is connection to be made to public sewer? yes If not, what is proposed for sewage?
Has septic tank notice been sent? Form notice sent? YES
Height average grade to top of plate 16' Height average grade to highest point of roof 26'
Size, front 32' depth 24' No. stories 2 solid or filled land? solid earth or rock? earth
Material of foundation Concrete at least 4' below grade Thickness, top 10" bottom 12" cellar yes
Material of underpinning " to sill Height Thickness
Kind of roof pitch-gable Rise per foot 10" Roof covering Asphalt Class C Und. Lab.
No. of chimneys 1 Material of chimneys brick of lining tile Kind of heat water fuel oil
Framing Lumber—Kind hemlock Dressed or full size? dressed Corner posts 4x6 Sills box
Size Girder 8x8 f.s. Columns under girders lally Size 3 1/2" Max. on centers 7'7"
Kind and thickness of outside sheathing of exterior walls?
Studs (outside walls and carrying partitions) 2x4-16" O. C. Bridging in every floor and flat roof over 8 feet
Joists and rafters: 1st floor 2x8, 2nd 2x8, 3rd 2x6 ceiling 2x8
On centers: 1st floor 16", 2nd 16", 3rd 20", roof 20"
Maximum span: 1st floor 12', 2nd 12', 3rd , roof
If one story building with masonry walls, thickness of walls? height?

If a Garage

No. cars now accommodated on same lot, to be accommodated number commercial cars to be accommodated
Will automobile repairing be done other than minor repairs to cars habitually stored in the proposed building?

APPROVED:

[Signature]
.....
.....

Miscellaneous

Will work require disturbing of any tree on a public street? no
Will there be in charge of the above work a person competent to see that the State and City requirements pertaining thereto are observed? yes
The Minat Corp.

Signature of owner By: [Signature]

INSPECTION COPY

F 11



FILL IN AND SIGN WITH INK

APPLICATION FOR PERMIT FOR HEATING, COOKING OR POWER EQUIPMENT

Portland, Maine, June 22, 1959

PERMIT ISSUED

JUN 22 1959

CITY OF PORTLAND

To the INSPECTOR OF BUILDINGS, PORTLAND, ME.

The undersigned hereby applies for a permit to install the following heating, cooking or power equipment in accordance with the Laws of Maine, the Building Code of the City of Portland, and the following specifications:

Location Lot 17 Alden Circle Use of Building Dwelling No. Stories 1 1/2 New Building Existing " Name and address of owner of appliance The Minat. Corp. 34 Preble St. Installer's name and address Pallotta Oil Co. 112 Exchange St. Telephone

General Description of Work

To install Forced hot water heating system and oil burning equipment.

IF HEATER, OR POWER BOILER

Location of appliance Basement Any burnable material in floor surface or beneath? none If so, how protected? Kind of fuel? oil Minimum distance to burnable material, from top of appliance or casing top of furnace 31 From top of smoke pipe 20!! From front of appliance over 4' From sides or back of appliance over 3' Size of chimney flue 8x8 Other connections to same flue none If gas fired, how vented? Rated maximum demand per hour Will sufficient fresh air be supplied to the appliance to insure proper and safe combustion? yes

IF OIL BURNER

Name and type of burner Delco-gumtype Labeled by underwriters' laboratories? yes Will operator be always in attendance? Does oil supply line feed from top or bottom of tank? bottom Type of floor beneath burner concrete Size of vent pipe 1 1/4" Location of oil storage basement Number and capacity of tanks 1-275 gal. Low water shut off Make No. Will all tanks be more than five feet from any flame? yes How many tanks enclosed? Total capacity of any existing storage tanks for furnace burners

IF COOKING APPLIANCE

Location of appliance Any burnable material in floor surface or beneath? If so, how protected? Height of Legs, if any Skirting at bottom of appliance? Distance to combustible material from top of appliance? From front of appliance From sides and back From top of smokepipe Size of chimney flue Other connections to same flue Is hood to be provided? If so, how vented? Forced or gravity? If gas fired, how vented? Rated maximum demand per hour

MISCELLANEOUS EQUIPMENT OR SPECIAL INFORMATION

Amount of fee enclosed? 2.00 (\$2.00 for one heater, etc., 50 cents additional for each additional heater, etc., in same building at same time.)

APPROVED:

6-18-59 6-22-59 1170

Will there be in charge of the above work a person competent to see that the State and City requirements pertaining thereto are observed? yes

Pallotta Oil Company

INSPECTION COPY

Signature of Installer

by: [Signature]

Fm



APPLICATION FOR PERMIT

PERMIT ISSUED

B.O.C.A. USE GROUP
B.O.C.A. TYPE OF CONSTRUCTION 000343

MAY 11 1979

ZONING LOCATION PORTLAND, MAINE, ... May 11, 1979

CITY of PORTLAND

To the DIRECTOR OF BUILDING & INSPECTION SERVICES, PORTLAND, MAINE

The undersigned hereby applies for a permit to erect, alter, repair, demolish, move or install the following building, structure, equipment or change use in accordance with the Laws of the State of Maine, the Portland B.O.C.A. Building Code and Zoning Ordinance of the City of Portland with plans and specifications, if any, submitted herewith and the following specifications:

LOCATION 3 Alden Circle from 36 Wagon Side Fire District #1 [], #2 []
1. Owner's name and address Richard Ross - same Telephone 773-2486
2. Lessee's name and address Telephone
3. Contractor's name and address W. Allen Adams - 42 Savoy St. 04103 Telephone 774-5326
4. Architect Specifications Plans No. of sheets
Proposed use of building dwelling with sun deck No. families 1
Last use dwelling No. families 1
Material No. stories Heat Style of roof Roofing
Other buildings on same lot
Estimated contractual cost \$ 1,500. Fee \$ 10.00

FIELD INSPECTOR—Mr. GENERAL DESCRIPTION

This application is for: @ 775-5431
Dwelling Ext. 234 To construct open sun deck 14 x 16 as per plans. 2 sheets of plans.
Garage Stamp of Special Conditions
Masonry Bldg.
Metal Bldg.
Alterations
Demolitions
Change of Use
Other

NOTE TO APPLICANT: Separate permits are required by the installers and subcontractors of heating, plumbing, electrical and mechanicals.

PERMIT IS TO BE ISSUED TO 1 [] 2 [] 3 [x] 4 []

Other:

DETAILS OF NEW WORK

Is any plumbing involved in this work? Is any electrical work involved in this work?
Is connection to be made to public sewer? If not, what is proposed for sewage?
Has septic tank notice been sent? Form notice sent?
Height average grade to top of plate Height average grade to highest point of roof
Size, front depth No. stories solid or filled land? earth or rock?
Material of foundation Thickness, top bottom cellar
Kind of roof Rise per foot Roof covering
No. of chimneys Material of chimneys of lining Kind of heat fuel
Framing Lumber—Kind Dressed or full size? Corner posts Sills
Size Girder Columns under girders Size Max. on centers
Studs (outside walls and carrying partitions) 2x4-16" O. C. Bridging in every floor and flat roof span over 8 feet.
Joists and rafters: 1st floor, 2nd, 3rd, roof
On centers: 1st floor, 2nd, 3rd, roof
Maximum span: 1st floor, 2nd, 3rd, roof
If one story building with masonry walls, thickness of walls? Weight?

IF A GARAGE

No. cars now accommodated on same lot, to be accommodated number commercial cars to be accommodated
Will automobile repairing be done other than minor repairs to cars habitually stored in the proposed building?

APPROVALS BY: DATE MISCELLANEOUS
BUILDING INSPECTION—PLAN EXAMINER Will work require disturbing of any tree on a public street?
ZONING:
BUILDING CODE: Will there be in charge of the above work a person competent
Fire Dept.: to see that the State and City requirements pertaining thereto
Health Dept.: are observed?
Others:

Signature of Applicant W. Allen Adams Phone # same
Type Name of above W. Allen Adams 1 [] 2 [] 3 [x] 4 []

Other and Address

FIELD INSPECTOR'S COPY

3 ALDEN CIRCLE (Lot 17)



Full cut # 9201 - Half cut # 9202 - Third cut # 9203R - Fifth cut # 9205 R

ALDEN CIRCLE

PERMIT # **PORTLAND BUILDING PERMIT APPLICATION** **DATE** 6/16/87 **PERMIT ISSUED**

I. GENERAL INFORMATION
 Location/address of construction 3 Alden Circle
 1. Owner's name Richard A. Rose Tel. 773-2466
 Address
 2. Lessee's name Tel.
 Address
 3. Contractor's name Anes Properties & Builders Tel. 772-3131 # 713
 Address P.O. Box 760A, NYS 04112
 4. Is this a legally recorded lot? yes no

PERMIT ISSUED
JUN 17 1987
City Of Portland

II. DESCRIPTION OF WORK:
to construct 2 car garage not attached as per plans
send to #1 04102

III. BUILDING DIMENSIONS: length 24 width 24 square footage 576 height 21 #stories 2
IV. ZONING: Street frontage Zoning board approval: no yes date
 Setbacks: front back side side Planning board approval: no yes date
V. REVIEW REQUIRED: variance other Number of off-street parking spaces:
 site plan subdivision shore floodplain mgmt enclosed outdoors
VI. FEES:
 base fee other fees
 subdivision fee late fee
 site plan review fee TOTAL 520.00

VII. DETAILS OF WORK

1. WATER SUPPLY: <input type="checkbox"/> public <input type="checkbox"/> private	7. ELECTRICAL: service entrance size <u> </u> # smoke detectors <u> </u>	8. CHIMNEY: # flues <u> </u> material <u> </u> # fireplaces <u> </u>
2. SEWER: <input type="checkbox"/> public <input type="checkbox"/> private, type <u> </u>	9. FRAMING: floor joists <u> </u> size <u> </u> max. on cen <u> </u> ceiling joists <u> </u> rafters <u> </u> studs <u> </u> wall studs <u> </u>	
3. HEAT: type <u> </u> fuel <u> </u>	10. If 1-story building w/masonry walls: wall thickness <u> </u> height <u> </u>	11. BEDROOM WINDOWS height width <u> </u> sill height <u> </u> egress window? yes <input type="checkbox"/> no <input type="checkbox"/>
4. FOUNDATION: type <u> </u> thickness footing <u> </u>		
5. ROOF: type <u> </u> pitch <u> </u> covering <u> </u> load <u> </u>		
6. PLUMBING: SPRINKLER SYSTEM? yes <input type="checkbox"/> no <input type="checkbox"/>		

VIII. OFFICE USE: TAX MAP # LOT # VALUE/STRUCTURE PERMIT EXPIRATION
IX. NEW OR PHASED SUBDIVISION REFERENCE: Name Lot Block
CODE: If other, explain Seasonal Condominium Apartment
X. PROPOSED USE:
XI. PAST USE:
XII. OWNERSHIP: PUBLIC PRIVATE
XIII. EST. CONSTRUCTION COST: \$1,000.00 **XIV. GR. SQ. FT. OF LOT BUILDING:**

COMPLETE XV AND XVI ONLY IF THE NUMBER OF UNITS WILL CHANGE

XV. RESIDENTIAL BUILDINGS ONLY: # BEDROOMS: <u> </u> # NEW DWELLING UNITS WITH: 1: BDRM <u> </u> 2: BDRMS <u> </u> 3: BDRMS <u> </u> # EXISTING DWELLING UNITS WITH: <u> </u>	XVI. # RESIDENTIAL UNITS: # NEW DWELLINGS <u> </u> # EXISTING DWELLINGS <u> </u> TOTAL RESIDENTIAL UNITS <u> </u>
--	--

APPROVALS BY: <u> </u> DATE: <u> </u> BUILDING INSPECTION - PLAN EXAMINER: <u> </u> ZONING: <u> </u> C.E.O.: <u> </u> FIRE DEPT.: <u> </u>	MISCELLANEOUS Will work require disturbing of any tree on a public street? <u> </u> Will there be in charge of the above work a person competent to see that the State and City requirements pertaining thereto are observed? <u> </u>
--	---

NOTE TO APPLICANT: Separate permits are required by the installors and subcontractors of heating, plumbing, electrical, and mechanicals.

District No. <u>2</u>	XVII. SIGNATURE OF APPLICANT: <u>Richard A. Rose</u> PHONE #: <u>773-2466</u> TYPE NAME OF ABOVE: <u>Richard A. Rose</u>
-----------------------	--



APPLICATION FOR PERMIT
 DEPARTMENT OF BUILDING INSPECTIONS SERVICES
 ELECTRICAL INSTALLATIONS

Date September 11, 19 87
 Receipt and Permit number 22,323

To the CHIEF ELECTRICAL INSPECTOR, Portland, Maine:
 The undersigned hereby applies for a permit to make electrical installations in accordance with the laws of
 Maine, the Portland Electrical Ordinance, the National Electrical Code and the following specifications:

LOCATION OF WORK: 3 Alden Circle
 OWNER'S NAME: Richard Ross ADDRESS: same

	FEES
OUTLETS: Receptacles <u>1-30</u> Switches _____ Plugmold _____ ft. TOTAL _____	3.00
FIXTURES: (number of) Incandescent _____ Fluorescent _____ (not strip) TOTAL <u>1-10</u> Strip Fluorescent _____ ft. _____	3.00
SERVICES: Overhead <u>X</u> Underground _____ Temporary _____ TOTAL amperes <u>200</u>	3.00
METERS: (number of) <u>1</u>	.50
MOTORS: (number of) Fractional _____ 1 HP or over _____	
RESIDENTIAL HEATING: Oil or Gas (number of units) _____ Electric (number of rooms) _____	
COMMERCIAL OR INDUSTRIAL HEATING: Oil or Gas (by a main boiler) _____ Oil or Gas (by separate units) _____ Electric Under 20 kws _____ Over 20 kws _____	
APPLIANCES: (number of) Ranges _____ Water Heaters _____ Cook Tops _____ Disposals _____ Wall Ovens _____ Dishwashers _____ Dryers _____ Compactors _____ Fans _____ Others (denote) _____ TOTAL _____	
MISCELLANEOUS: (number of) Branch Panels <u>1</u>	1.00
Transformers _____ Air Conditioners Central Unit _____ Separate Units (windows) _____ Signs 20 sq. ft. and under _____ Over 20 sq. ft. _____ Swimming Pools Above Ground _____ In Ground _____ Fire/Burglar Alarms Residential _____ Commercial _____ Heavy Duty Outlets, 220 Volt (such as welders) 30 amps and under _____ over 30 amps _____ Circus, Fairs, etc. _____ Alterations to wires _____ Repairs after fire _____ Emergency Lights, battery _____ Emergency Generators _____	

INSTALLATION FEE DUE: _____
 FOR ADDITIONAL WORK NOT ON ORIGINAL PERMIT DOUBLE FEE DUE: _____
 FOR REMOVAL OF A "STOP ORDER" (304-16.b)
 TOTAL AMOUNT DUE: 10.50

INSPECTION:
 Will be ready on service 9/14, 19 87; or Will Call X
 CONTRACTOR'S NAME: Seacoast Elec Co.
 ADDRESS: 450 Commercial Street
 TEL: 774-6171
 MASTER LICENSE NO.: X 03088 SIGNATURE OF CONTRACTOR: [Signature]
 LIMITED LICENSE NO.: _____

INSPECTOR'S COPY — WHITE
 OFFICE COPY — CANARY
 CONTRACTOR'S COPY — GREEN

ELECTRICAL INSTALLATIONS -

INSPECTIONS: Service 200 amp by Revan
 Service called in 9/14/87
 Closing-in _____ by _____

PROGRESS INSPECTIONS: _____ / _____ / _____
 _____ / _____ / _____
 _____ / _____ / _____
 _____ / _____ / _____
 _____ / _____ / _____

Permit Number 22323
 Location 3 Olden Circle
 Owner Richard Jones
 Date of Permit 9/14/87
 Final Inspection 9/14/87
 By Inspector Revan
 Permit Application Register Page No. 1d

DATE:	REMARKS:

COPIES
 COMPLETED
 DATE 9/14/87

PERMIT # _____	PORTLAND BUILDING PERMIT APPLICATION	DATE <u>6/16/87</u>	PERMIT ISSUED
I. GENERAL INFORMATION			JUN 17 1987 City Of Portland
Location/address of construction <u>3 Alden Circle</u>			
1. Owner's name <u>Richard A. Ross</u>	Tel. <u>773-2486</u>		
Address <u>_____</u>			
2. Lessee's name _____			
Address _____			
3. Contractor's name <u>Ross Properties & Builders</u>			
Address <u>P.O. Box 7604, NW 94112</u>			
4. Is this a legally recorded lot? yes _____ no _____			

713

II. DESCRIPTION OF WORK:
 to construct 2 car garage not attached as per plans
 send to #1 04102

III. BUILDING DIMENSIONS: length 24 width 24 square footage 576 height 21 #stories 2

IV. ZONE _____ Street frontage _____ Zoning board approval: no yes date _____
 Setbacks: front _____ back _____ side _____ side _____ Planning board approval: no yes date _____

V. REVIEW REQUIRED: variance _____ other _____
 site plan _____ subdivision _____ shore _____ floodplain mgmt _____
 Number of off-street parking spaces: enclosed _____ outdoors _____

VI. FEES:
 base fee _____ other fees _____
 subdivision fee _____ late fee _____
 site plan review fee _____
 TOTAL \$80.00

VII. DETAILS OF WORK

1. WATER SUPPLY: <input checked="" type="checkbox"/> public <input type="checkbox"/> private	7. ELECTRICAL: service, entrance size # smoke detectors	8. CHIMNEY: # flues material # fireplaces
2. SEWER: <input checked="" type="checkbox"/> public <input type="checkbox"/> private, type _____	9. FRAMING: floor joists _____ size _____ max. on center _____ ceiling joists _____ rafters _____ studs _____ wall studs _____	
3. HEAT: type _____ fuel _____	10. If 1-story building w/masonry walls: wall thickness _____ height _____	11. BEDROOM WINDOWS: height _____ width _____ sill height _____ egress window? yes <input type="checkbox"/> no <input type="checkbox"/>
4. FOUNDATION: type _____ thickness _____ footing _____		
5. ROOF: type _____ pitch _____ covering _____ load _____		
6. PLUMBING: SPRINKLER SYSTEM? yes <input type="checkbox"/> no <input checked="" type="checkbox"/>		

VIII. OFFICE USE:
 TAX MAP # _____
 LOT # _____
 VALUE/STRUCTURE _____
 PERMIT EXPIRATION _____

IX. NEW OR PHASED SUBDIVISION REFERENCE:
 Name _____
 Lot _____
 Block _____

X. PROPOSED USE: Residential Seasonal Condominium Apartment

XI. PAST USE: _____

XII. OWNERSHIP: PUBLIC PRIVATE

XIII. EST. CONSTRUCTION COST: \$1,200.00 XIV. GR. SQ. FT. OF LOT BUILDING _____

COMPLETE XV AND XVI ONLY IF THE NUMBER OF UNITS WILL CHANGE

XV. RESIDENTIAL BUILDINGS ONLY: # NEW DWELLING UNITS WITH 1 BDRM _____ 2 BDRMS _____ 3 BDRMS _____ # EXISTING DWELLING UNITS WITH _____	XVI. RESIDENTIAL UNITS: # NEW DWELLINGS _____ # EXISTING DWELLINGS _____ TOTAL RESIDENTIAL UNITS _____
---	---

APPROVALS BY: _____ DATE _____

BUILDING INSPECTION PLAN EXAMINER _____

ZONING _____

FIRE DEPT _____

MISCELLANEOUS:
 Will work require disturbing of any tree on a public street? _____
 Will there be in charge of the above work a person competent to see that the State and City requirements pertaining thereto are observed? _____

NOTE TO APPLICANT: Separate permits are required by the installers and subcontractors of heating, plumbing, electrical, and mechanicals.

District No. _____

XVII. SIGNATURE OF APPLICANT _____ PHONE # _____

TYPE NAME OF ABOVE Richard A. Ross 1 2 3 4

White - GPCOG Green - Applicant Yellow - Assessor Pink - Office File Gold - Field Inspector

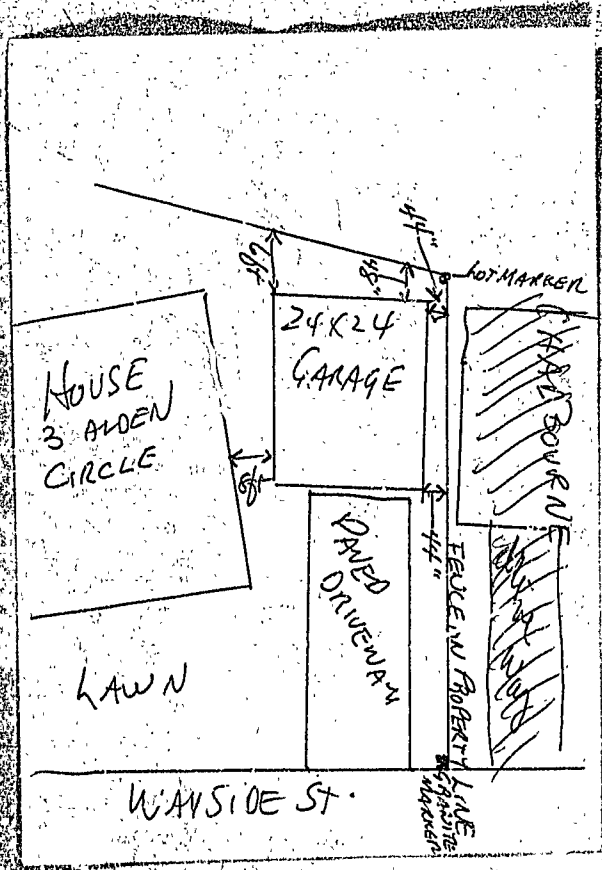

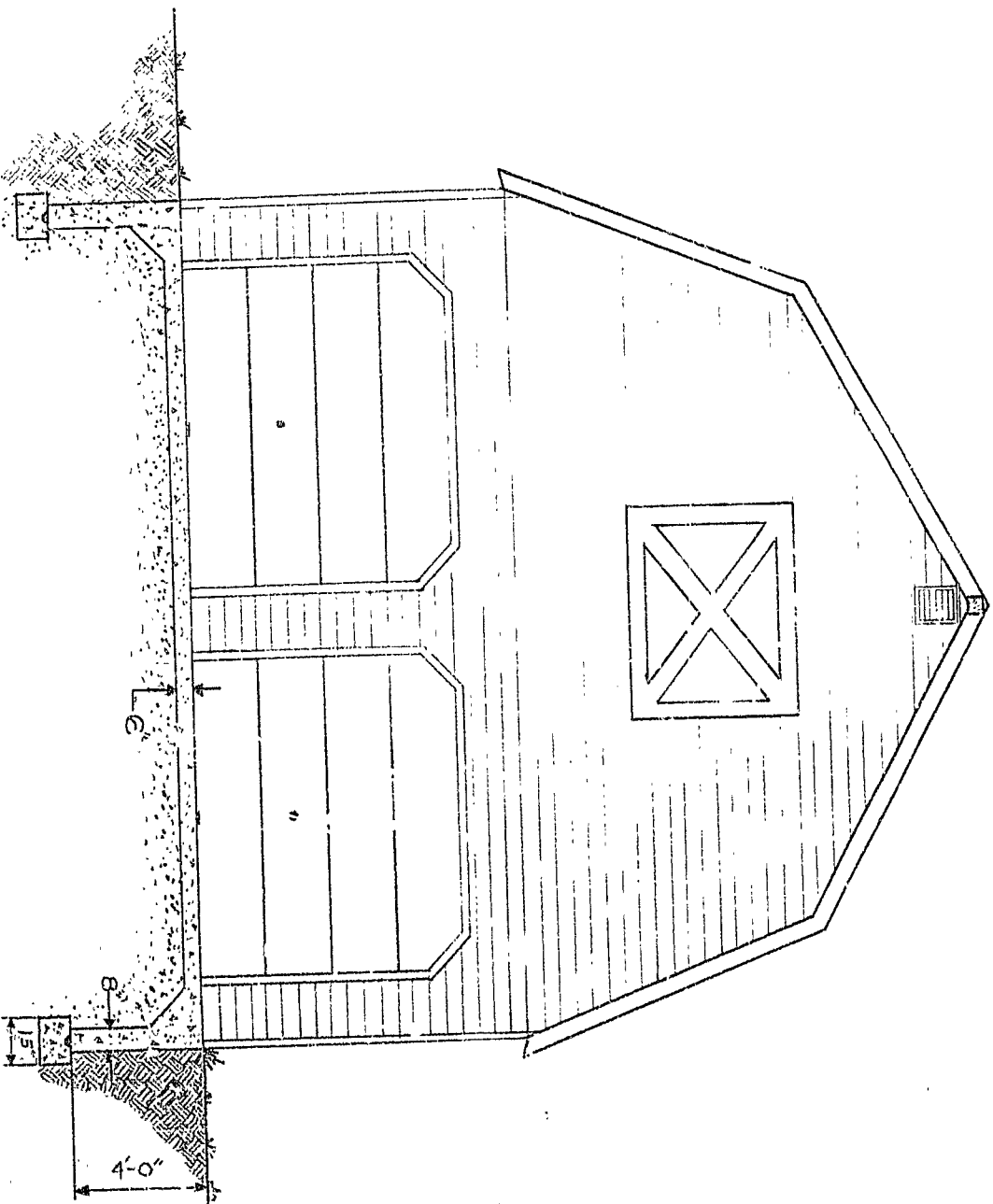

CONCRETE
 SAND

EARTH & COMPACTED FILL

NOTES:

1. 24' x 24' GARAGE W/ GAMBREL ROOF.
2. WALLS... 2" x 4" CONSTRUCTION, 16" O.C.
3. RAFTERS... 2' x 6" CONSTRUCTION, 16" O.C.
4. FIRST FLOOR... 6" CONCRETE SLAB, W/ 4" FROST WALL ON 12" x 15" KEYED FOOTING.
5. SECOND FLOOR JOICES... 2' x 10" CONSTRUCTION, 16" O.C.
6. 10" x 16" BEAM ON ϕ .

RECEIVED

JUN 16 1957

JAMES H. BROWN
 CIVIL ENGINEER
 1001 1/2 ST. J. ST.
 PORTLAND, ORE.

BY	DATE	REVISION	NO.
Richard Ross			
8/12/57			
8/12/57			

BY	DATE	BY	DATE

24' x 24' GARAGE WITH GAMBREL ROOF.	AMES PROPERTIES
SCALE 1/4" = 1'-0"	DATE 6/12/57
BY J. H. BROWN	BY J. H. BROWN