

95 91-95 EDGEWORTH AVENUE

CHAMBERLAIN  
WALKER

First cut # 620R - Half cut # 9202R - Third cut # 9203R - Fifth cut # 9205R

**CITY OF PORTLAND, MAINE**  
**Application for Permit to Install Wires**

Permit No. 108  
 Issued 12/13/72...

Portland, Maine . . . , 19

To the City Electrician, Portland, Maine:

The undersigned hereby applies for a permit to install wires for the purpose of conducting electric current, in accordance with the laws of Maine, the Electrical Ordinance of the City of Portland, and the following specifications:

*(This form must be completely filled out — Minimum Fee, \$1.00)*

Owner's Name and Address Mrs Marilyn Smith 95 Edgeworth Ave Tel. 7741948  
 Contractor's Name and Address Cyrran Electric Tel. 7725424  
 Location 95 Edgeworth Ave Use of Building home  
 Number of Families 1 Apartments Stores Number of Stories  
 Description of Wiring: New Work Additions Alterations

Pipe Cable  Metal Molding BX Cable Plug Molding (No. of feet)  
 No. Light Outlets Plugs Light Circuits Plug Circuits  
 FIXTURES: No. Fluor. or Strip Lighting (No. feet)  
 SERVICE: Pipe Cable  Underground No. of Wires 3 Size 2  
 METERS: Relocated Added Total No. Meters  
 MOTORS: Number Phase H. P. Amps Volts Starter  
 HEATING UNITS: Domestic (Oil) No. Motors Phase H.P.  
 Commercial (Oil) No. Motors Phase H.P.  
 Electric Heat (No. of Rooms)  
 APPLIANCES: No. Ranges Watts Brand Feeds (Size and No.)  
 Elec. Heaters Watts  
 Miscellaneous Watts Extra Cabinets or Panels  
 Transformers Air Conditioners (No. Units) Signs (No. Units) . . .  
 Will commence 19 Ready to cover in 19 Inspection 19  
 Amount of Fee \$ 2.00

Signed [Signature]

DO NOT WRITE BELOW THIS LINE

SERVICE  METER GROUND   
 VISITS: 1 2 3 4 5 6  
 . . . 7 8 9 10 11 12  
 REMARKS:

INSPECTED BY [Signature]  
 (OVER)

LOCATION *Edgeworth Av. 95*

INSPECTION DATE *1/11/73*

WORK COMPLETED *2/11/73*

TOTAL NO. INSPECTIONS

REMARKS:

**FEEES FOR WIRING PERMITS EFFECTIVE JULY 31, 1963**

**WIRING**

1 to 30 Outlets ..... \$ 2.00  
31 to 60 Outlets ..... 3.00  
Over 60 Outlets, each Outlet ..... .05  
(Each twelve feet or fraction thereof of fluorescent lighting or any type of plug molding will be classed as one outlet).

**SERVICES**

Single Phase ..... 2.00  
Three Phase ..... 4.00

**MOTORS**

Not exceeding 50 H.P. .... 3.00  
Over 50 H.P. .... 4.00

**HEATING UNITS**

Domestic (Oil) ..... 2.00  
Commercial (Oil) ..... 4.00  
Electric Heat (Each Room) ..... 75

**APPLIANCES**

Ranges, Cooking Tops, Ovens, Water Heaters, Disposals, Built-in Dishwashers, Dryers, and any permanent built-in appliance — each unit ..... 1.50

**MISCELLANEOUS**

1.50

R3 RESIDENCE ZONE

TYPICAL PLOT PLAN

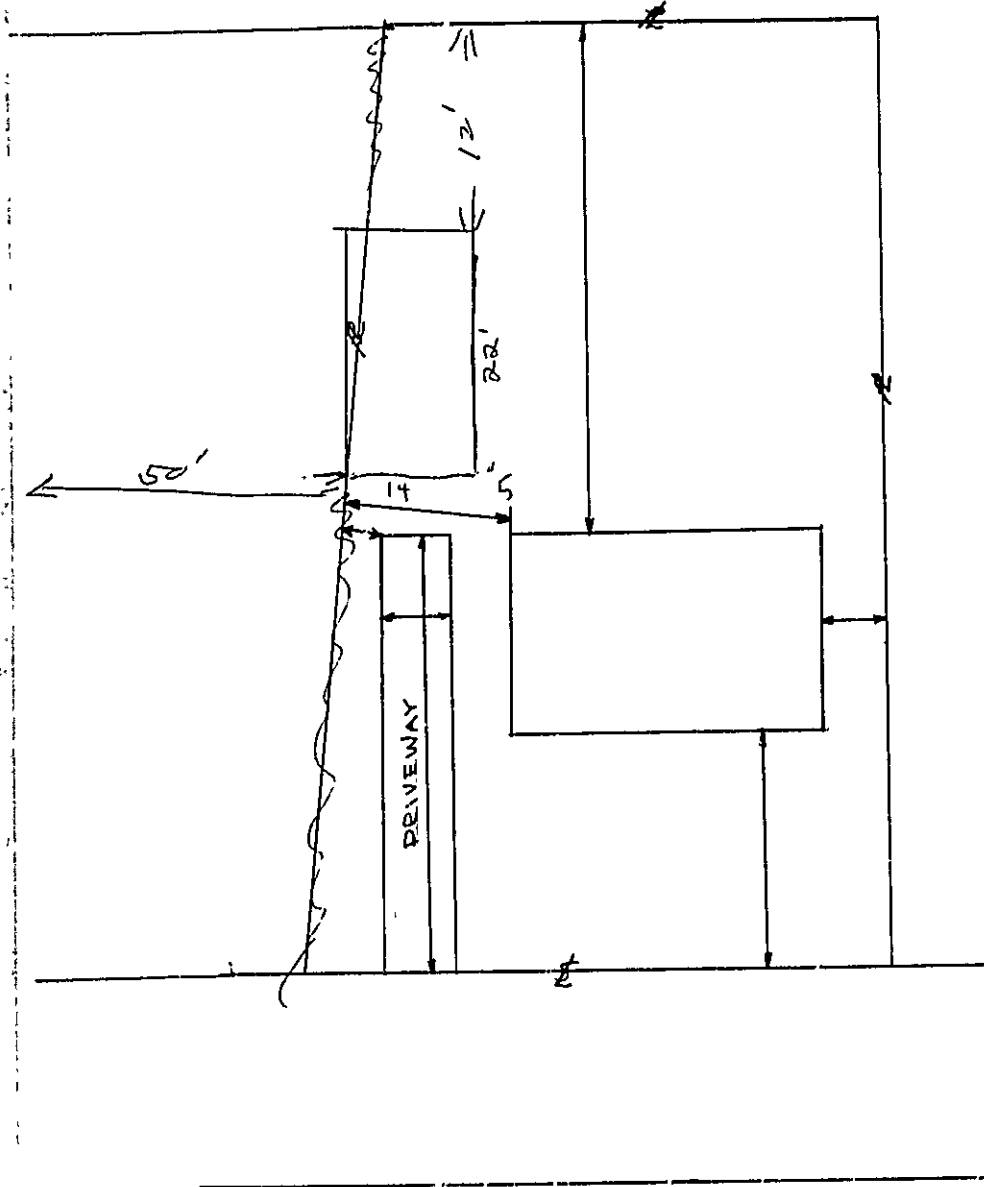

NOTE :

STREET NAME . . . . .

SIZE OF BLDG . . . . .

OWNER . . . . .

CONTRACTOR . . . . .

INDICATE PROJECTIONS (E.L.L.S)



R3 RESIDENCE ZONE

### APPLICATION FOR PERMIT

PERMIT ISSUED

Class of Building or Type of Structure \_\_\_\_\_  
Portland, Maine, April 24, 1972

APR 25 1972

0441

To the INSPECTOR OF BUILDINGS, PORTLAND, MAINE

The undersigned hereby applies for a permit to erect alter repair demolish install the following building structure equipment in accordance with the Laws of the State of Maine, the Building Code and Zoning Ordinance of the City of Portland, plans and specifications, if any, submitted herewith and the following specifications:

Location 95 Edgeworth Ave. Within Fire Limits? \_\_\_\_\_ Dist. No. \_\_\_\_\_  
 Owner's name and address Marilyn Smith, same Telephone \_\_\_\_\_  
 Lessee's name and address \_\_\_\_\_ Telephone \_\_\_\_\_  
 Contractor's name and address Richard Doten, 20 Tucker Ave, Portland Telephone 797-4  
 Architect \_\_\_\_\_ Specifications \_\_\_\_\_ Plans \_\_\_\_\_ No. of sheets \_\_\_\_\_  
 Proposed use of building garage No. families \_\_\_\_\_  
 Last use \_\_\_\_\_ No. families \_\_\_\_\_  
 Material frame No. stories 1 Heat \_\_\_\_\_ Style of roof \_\_\_\_\_ Roofing \_\_\_\_\_  
 Other buildings on same lot house  
 Estimated cost \$ 1800. Fee \$ 6.00

#### General Description of New Work

To construct 14' x 22' garage

Header will be 4 x 12 . 9' door opening - under eaves

It is understood that this permit does not include installation of heating apparatus which is to be taken out separately by and in the name of the heating contractor. PERMIT TO BE ISSUED TO

Contractor

#### Details of New Work

Is any plumbing involved in this work? no Is any electrical work involved in this work? no  
 Height average grade to top of plate 8' Height average grade to highest point of roof 13'  
 Size, front 14' depth 22' No. stories 1 solid or filled land? solid earth or rock? earth  
 Material of foundation concrete slab Thickness, top 4" bottom \_\_\_\_\_ cellar \_\_\_\_\_  
 Material of underpinning \_\_\_\_\_ Height \_\_\_\_\_ Thickness \_\_\_\_\_  
 Kind of roof pitch Rise per foot 5/12 Roof covering asphalt shingles  
 No. of chimneys no Material of chimneys \_\_\_\_\_ of lining \_\_\_\_\_ Kind of heat \_\_\_\_\_ fuel \_\_\_\_\_  
 Framing lumber—Kind hemlock Dressed or full size? dressed  
 Corner post 4 x 4 Sills 4 x 4 Girt or ledger board? \_\_\_\_\_ Size \_\_\_\_\_  
 Girders \_\_\_\_\_ Size \_\_\_\_\_ Columns under girders \_\_\_\_\_ Size \_\_\_\_\_ Max. on centers \_\_\_\_\_  
 Studs (outside walls and carrying partitions) 2x4-24" O. C. Bridging in every floor and flat roof span over 8 feet.  
 Joists and rafters: 1st floor concrete 2nd \_\_\_\_\_, 3rd \_\_\_\_\_, roof 2 x 6  
 On centers: 1st floor \_\_\_\_\_, 2nd \_\_\_\_\_, 3rd \_\_\_\_\_, roof 24"  
 Maximum span: 1st floor \_\_\_\_\_, 2nd \_\_\_\_\_, 3rd \_\_\_\_\_, roof 12'  
 If one story building with masonry walls, thickness of walls? \_\_\_\_\_ height? \_\_\_\_\_

#### If a Garage

No. cars now accommodated on same lot 1, to be accommodated 1 number commercial cars to be accommodated \_\_\_\_\_  
 Will automobile repairing be done other than minor repairs to cars habitually stored in the proposed building? no

APPROVED:

O.K. E.B. 4/25/72

#### Miscellaneous

Will work require disturbing of any tree on a public street? \_\_\_\_\_  
 Will there be in charge of the above work a person competent to see that the State and City requirements pertaining thereto are observed? yes

Richard Doten

*Richard Doten*

INSPECTION COPY

Signature of owner By:

NOTES

4/24/72 - Location O.K.  
HUGH.

5-19-72 Slab placed  
and framing of walls completed  
[Signature]

6-3-72 Work completed  
[Signature]

Permit No. 73/0441

Location 95 Edgewater Ave

Owner Marilyn Smith

Date of permit 4/25/72

Notif. closing-in

Inspn. closing-in

Final Notif.

Inspector [Signature]

Cert. of Occupancy issued [Signature] SAM

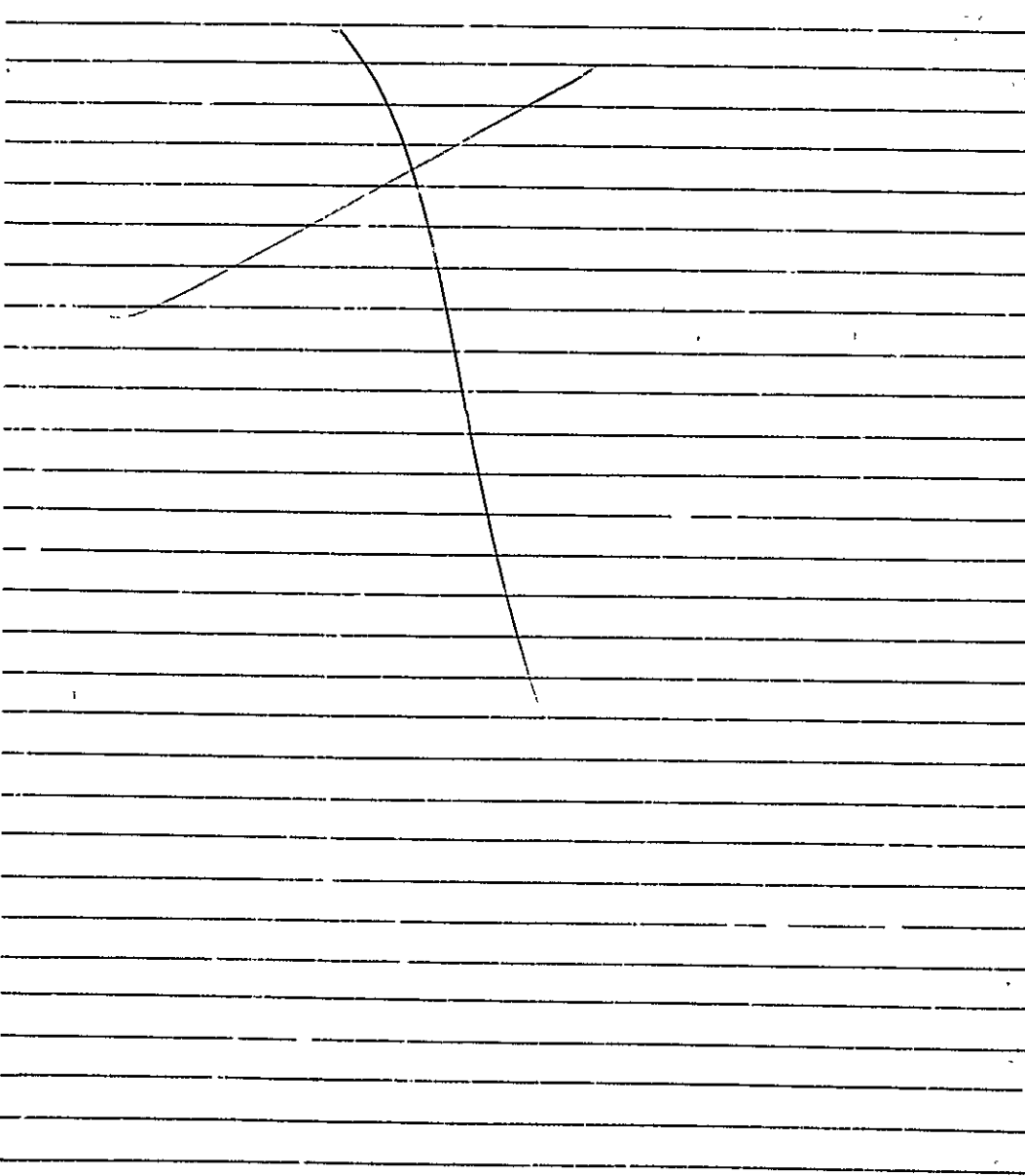

PERMIT TO INSTALL PLUMLING

Date Issued **August 18, 1969**  
 Portland Plumbing Inspector  
 By ERNOLD R GOODWIN

App. First Insp.  
 Date **8/3/69**  
 By

App. Final Insp.  
 Date **8/3/69**  
 By **WILLIAM H. WALL**  
 Type of Bldg.

- Commercial
- Residential
- Single
- Multi Family
- New Construction
- Remodeling

Address		<b>95 Edgeworth Avenue</b>		PERMIT NUMBER	<b>653</b>
Installation For		<b>Dwelling</b>			
Owner of Bldg		<b>Harilyn Smith</b>			
Owner's Address		<b>95 Edgeworth Avenue</b>			
Plumber		<b>W. Franklin Sisko</b>		Date	<b>August 18, 1969</b>
NEW	REP.			NO	
		SINKS			
		LAVATORIES			
		TOILETS			
		BATH TUBS			
		SHOWERS			
		DRAINS FLOOR SURFACE			
		HOT WATER TANKS			
		TANKLESS WATER HEATERS			
		GARBAGE DISPOSALS			
		SEPTIC TANKS			
	<b>1</b>	HOUSE SEWERS		<b>1</b>	<b>2.00</b>
		ROOF LEADERS			
		AUTOMATIC WASHERS			
		DISHWASHERS			
		OTHER			
				TOTAL	<b>2.00</b>

Building and Inspection Services Dept. Plumbing Inspection



FILL IN AND SIGN WITH INK

APPLICATION FOR PERMIT FOR HEATING, COOKING OR POWER EQUIPMENT

Portland, Maine, Jan. 22, 1954

To the INSPECTOR OF BUILDINGS, PORTLAND, MAINE

The undersigned hereby applies for a permit to install the following heating, cooking or power equipment in accordance with the Laws of Maine, the Building Code of the City of Portland, and the following specifications:

Location 95 Edgeworth Ave. Use of Building dwelling house No Stories Existing Building Name and address of owner of appliance John E. McEnney, 95 Edgeworth Ave. Installer's name and address Holland Furnace Co., 8 Longfellow Square Telephone 3-3285

General Description of Work

To install gravity warm air heater (replacement)

IF HEATER, OR POWER BOILER

Location of appliance basement Any burnable material in floor surface or beneath? no If so, how protected? Kind of fuel? coal Minimum distance to burnable material, from top of appliance or casing top of furnace 2' From top of smoke pipe 1' From front of appliance over 4' From sides or back of appliance over 3' Size of chimney flue 8x8 Other connections to same flue none If gas fired, how vented? Rated maximum demand per hour Will sufficient fresh air be supplied to the appliance to insure proper and safe combustion? yes

IF OIL BURNER

Name and type of burner Labelled by underwriter's laboratories? Will operator be always in attendance? Does oil supply line feed from top or bottom of tank? Type of floor beneath burner Size of vent pipe Location of oil storage Number and capacity of tanks Low water shut off Make No Will all tanks be more than five feet from any flame? How many tanks enclosed? Total capacity of any existing storage tanks for furnace burners

IF COOKING APPLIANCE

Location of appliance Any burnable material in floor surface or beneath? If so, how protected? Height of Legs, if any Starting at bottom of appliance? Distance to combustible material from top of appliance? From front of appliance From sides and back From top of smokepipe Size of chimney flue Other connections to same flue Is hood to be provided? If so, how vented? Forced or gravity? If gas fired, how vented? Rated maximum demand per hour

MISCELLANEOUS EQUIPMENT OR SPECIAL INFORMATION

Amount of fee enclosed? 2.00 (\$2.00 for one heater, etc., 50 cents additional for each additional heater, etc., in same building at same time)

APPROVED: [Signature] 1-22-54

Will there be in charge of the above work a person competent to see that the State and City requirements pertaining thereto are observed? yes

Holland Furnace Co.

Signature of Installer: [Signature]





91-93

LOVE BE  
1801 0 1031

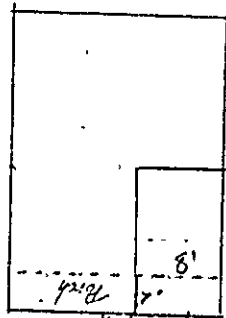

13'-2"

95  
Stewart Ave.



GENERAL RESIDENCE ZONE  
 APPLICATION FOR PERMIT **PERMIT ISSUED**  
**1301**

Class of Building or Type of Structure 3rd Class **SEP 10 1934**

Portland, Maine, September 8, 1934

To the INSPECTOR OF BUILDINGS, PORTLAND, ME.

The undersigned hereby applies for a permit to erect alter install the following building structure equipment in accordance with the Laws of the State of Maine, the Building Code of the City of Portland, plans and specifications, if any, submitted herewith and the following specifications:

Location 95 Higworth Avenue Ward 9 Within Fire Limits? no Dist. No. \_\_\_\_\_  
 Owner's or Lessee's name and address Ernest Barbour, 95 Higworth Ave. Telephone no  
 Contractor's name and address Owner Telephone \_\_\_\_\_  
 Architect's name and address \_\_\_\_\_  
 Proposed use of building dwelling house No. families 1  
 Other buildings on same lot \_\_\_\_\_  
 Plans filed as part of this application? yes No. of sheets 1  
 Estimated cost \$ 25. Fee \$ .25

Description of Present Building to be Altered

Material wood No. stories 1 1/2 Heat \_\_\_\_\_ Style of roof \_\_\_\_\_ Roofing \_\_\_\_\_  
 Last use dwelling house No. families 1

General Description of New Work

To enlarge portion 8 1/2 x 7 of existing one story front piazza  
 To remove 8' per section of front wall to include this space in living room

Support is to be provided in place where wall is removed to adequately support building according to Building Code standards.

CERTIFICATE OF OCCUPANCY  
 REQUIREMENT IS FULFILLED

It is understood that this permit does not include installation of heating apparatus which is to be taken out separately by and in the name of the heating contractor.

Details of New Work

Height average grade to top of plate \_\_\_\_\_  
 Size, front \_\_\_\_\_ depth \_\_\_\_\_ No. stories \_\_\_\_\_ Height average grade to highest point of roof \_\_\_\_\_  
 To be erected on solid or filled land? \_\_\_\_\_ earth or rock? \_\_\_\_\_  
 Material of foundation \_\_\_\_\_ Thickness, top \_\_\_\_\_ bottom \_\_\_\_\_  
 Material of underpinning \_\_\_\_\_ Height \_\_\_\_\_ Thickness \_\_\_\_\_  
 Kind of Roof \_\_\_\_\_ Rise per foot \_\_\_\_\_ Roof covering \_\_\_\_\_  
 No. of chimneys \_\_\_\_\_ Material of chimneys \_\_\_\_\_ of lining \_\_\_\_\_  
 Kind of heat \_\_\_\_\_ Type of fuel \_\_\_\_\_ Is gas fitting involved? \_\_\_\_\_  
 Corner posts \_\_\_\_\_ Sills \_\_\_\_\_ Girt or ledger board? \_\_\_\_\_ Size \_\_\_\_\_  
 Material columns under girders \_\_\_\_\_ Size \_\_\_\_\_ Max. on centers \_\_\_\_\_  
 Studs (outside walls and carrying partitions) 2x4-16" O. C. Girders 6x8 or larger. Bridging in every floor and flat roof span over 8 feet. Sills and corner posts all one piece in cross section.  
 Joists and rafters: 1st floor \_\_\_\_\_, 2nd \_\_\_\_\_, 3rd \_\_\_\_\_, roof \_\_\_\_\_  
 On centers: 1st floor \_\_\_\_\_, 2nd \_\_\_\_\_, 3rd \_\_\_\_\_, roof \_\_\_\_\_  
 Maximum span: 1st floor \_\_\_\_\_, 2nd \_\_\_\_\_, 3rd \_\_\_\_\_, roof \_\_\_\_\_  
 If one story building with masonry walls, thickness of walls? \_\_\_\_\_ height? \_\_\_\_\_

If a Garage

No. cars now accommodated on same lot \_\_\_\_\_, to be accommodated \_\_\_\_\_  
 Total number commercial cars to be accommodated \_\_\_\_\_  
 Will automobile repairing be done other than minor repairs to cars habitually stored in the proposed building? \_\_\_\_\_

Miscellaneous

Will above work require removal or disturbing of any shade tree on a public street? no  
 Will there be in charge of the above work a person competent to see that the State and City requirements pertaining thereto are observed? yes  
Ernest Barbour

Signature of owner \_\_\_\_\_

INSPECTION COPY

2664B

Ward 9 Permit No 34/1301  
Location 95 Edgeworth Ave  
Owner Ernest Barberis  
Date of perm: 9/10/34  
Notif. closing-in \_\_\_\_\_  
Inspn. closing-in \_\_\_\_\_  
Final Notif. \_\_\_\_\_  
Final Inspn 10/22/34  
Cert. of Occupancy issued None

NOTES

~~7/15/34 - No work  
started. AJS  
9/21/34 - Work of figuring  
out started. AJS  
9/27/34 - No change.  
AJS  
10/2/34 - Work pro-  
gressing slowly.  
AJS  
10/8/34 - same. AJS  
10/22/34 - No change  
and call with-  
out inspection.  
AJS~~

(C) GENERAL RESIDENCE ZONE

1011  
1012  
1013  
1014  
1015  
1016  
1017  
1018  
1019  
1020  
1021  
1022  
1023  
1024  
1025  
1026  
1027  
1028  
1029  
1030  
1031  
1032  
1033  
1034  
1035  
1036  
1037  
1038  
1039  
1040  
1041  
1042  
1043  
1044  
1045  
1046  
1047  
1048  
1049  
1050  
1051  
1052  
1053  
1054  
1055  
1056  
1057  
1058  
1059  
1060  
1061  
1062  
1063  
1064  
1065  
1066  
1067  
1068  
1069  
1070  
1071  
1072  
1073  
1074  
1075  
1076  
1077  
1078  
1079  
1080  
1081  
1082  
1083  
1084  
1085  
1086  
1087  
1088  
1089  
1090  
1091  
1092  
1093  
1094  
1095  
1096  
1097  
1098  
1099  
1100

1011  
1012  
1013  
1014  
1015  
1016  
1017  
1018  
1019  
1020  
1021  
1022  
1023  
1024  
1025  
1026  
1027  
1028  
1029  
1030  
1031  
1032  
1033  
1034  
1035  
1036  
1037  
1038  
1039  
1040  
1041  
1042  
1043  
1044  
1045  
1046  
1047  
1048  
1049  
1050  
1051  
1052  
1053  
1054  
1055  
1056  
1057  
1058  
1059  
1060  
1061  
1062  
1063  
1064  
1065  
1066  
1067  
1068  
1069  
1070  
1071  
1072  
1073  
1074  
1075  
1076  
1077  
1078  
1079  
1080  
1081  
1082  
1083  
1084  
1085  
1086  
1087  
1088  
1089  
1090  
1091  
1092  
1093  
1094  
1095  
1096  
1097  
1098  
1099  
1100

28th E. Drive

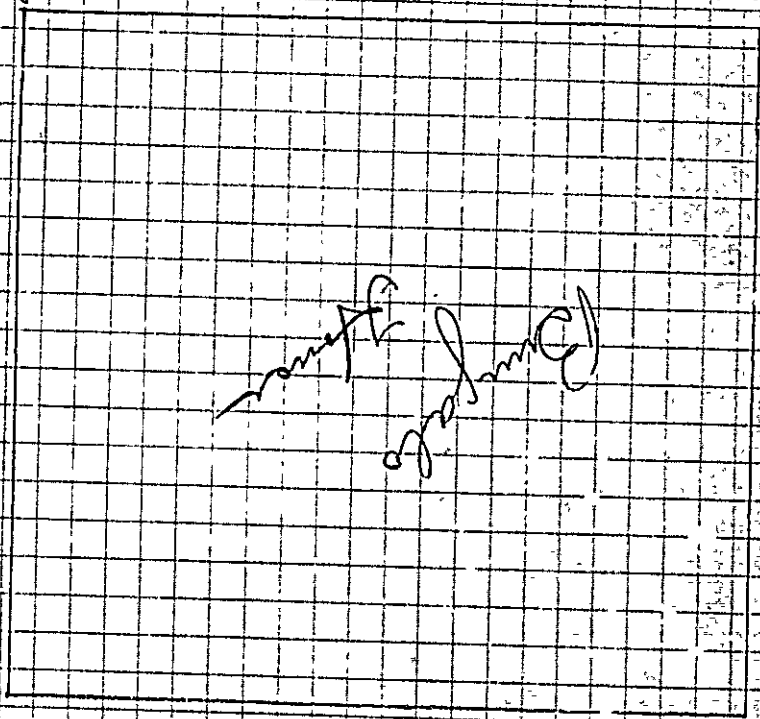

001

Bungalow  
4th Avenue

111  
112  
113  
114  
115  
116  
117  
118  
119  
120  
121  
122  
123  
124  
125  
126  
127  
128  
129  
130  
131  
132  
133  
134  
135  
136  
137  
138  
139  
140  
141  
142  
143  
144  
145  
146  
147  
148  
149  
150  
151  
152  
153  
154  
155  
156  
157  
158  
159  
160  
161  
162  
163  
164  
165  
166  
167  
168  
169  
170  
171  
172  
173  
174  
175  
176  
177  
178  
179  
180  
181  
182  
183  
184  
185  
186  
187  
188  
189  
190  
191  
192  
193  
194  
195  
196  
197  
198  
199  
200



# APPLICATION FOR PERMIT

Permit No. PERMIT ISSUED  
6330  
MAY 17 1928

Class of Building or Type of Structure Third Class

Portland, Maine, May 16, 1928

To the INSPECTOR OF BUILDINGS, PORTLAND, ME.

The undersigned hereby applies for a permit to erect ~~alter~~ install the following building structure equipment in accordance with the Laws of the State of Maine, the Building Code of the City of Portland, plans and specifications, if any, submitted herewith and the following specifications:

Location 95 Edgeworth Avenue Ward 9 Within Fire Limits? No Dist. No. \_\_\_\_\_  
Owner's or Lessee's name and address Ernest Barbour, 95 Edgeworth Ave. Telephone \_\_\_\_\_  
Contractor's name and address Owner Telephone \_\_\_\_\_  
Architect's name and address \_\_\_\_\_  
Proposed use of building 1 car garage No. families \_\_\_\_\_  
Other buildings on same lot Swelling house 1 family

### Description of Present Building to be Altered

Material \_\_\_\_\_ No. stories \_\_\_\_\_ Heat \_\_\_\_\_ Style of roof \_\_\_\_\_ Roofing \_\_\_\_\_  
Last use \_\_\_\_\_ No. families \_\_\_\_\_

### General Description of New Work

To erect frame 1 car garage

NOTE: NO WORK ON FOUNDATION IS ALLOWED.

### Details of New Work

Size, front 10' depth 15 1/2' No. stories 1 Height average grade to highest point of roof 10'  
To be erected on solid or filled land? solid earth or rock? earth  
Material of foundation Concrete slab Thickness, top \_\_\_\_\_ bottom \_\_\_\_\_  
Material of underpinning \_\_\_\_\_ Height \_\_\_\_\_ Thickness \_\_\_\_\_  
Kind of roof pitch Roof covering Asphalt shingles Class C Und. Lab.  
No. of chimneys no Material of chimneys \_\_\_\_\_ of lining \_\_\_\_\_  
Kind of heat no Type of fuel \_\_\_\_\_ Distance, heater to chimney \_\_\_\_\_  
If oil burner, name and model \_\_\_\_\_  
Capacity and location of oil tanks \_\_\_\_\_  
Is gas fitting involved? no Size of service \_\_\_\_\_  
Corner posts 4x4 Sills 2x4 Girt or ledger board? \_\_\_\_\_ Size \_\_\_\_\_  
Material columns under girders \_\_\_\_\_ Size \_\_\_\_\_ Max. on centers \_\_\_\_\_  
Studs (outside walls and carrying partitions) 2x4-13" O.C. Girders 6x8 or larger. Bridging in every floor and flat roof span over 8 feet. Sills and corner posts all one piece in cross section.  
Joists and rafters: 1st floor Concrete, 2nd \_\_\_\_\_, 3rd \_\_\_\_\_, roof 2x4  
On centers: 1st floor \_\_\_\_\_, 2nd \_\_\_\_\_, 3rd \_\_\_\_\_, roof 1.8"  
Maximum span: 1st floor \_\_\_\_\_, 2nd \_\_\_\_\_, 3rd \_\_\_\_\_, roof \_\_\_\_\_  
If one story building with masonry walls, thickness of walls? \_\_\_\_\_ height? \_\_\_\_\_

### If a Garage

No. cars now accommodated on same lot no, to be accommodated 1  
Total number commercial cars to be accommodated none  
Will automobile repairing be done other than minor repairs to cars habitually stored in the proposed building? no

### Miscellaneous

Will above work require removal or disturbing of any shade tree on a public street? no  
Plans filed as part of this application? yes No. sheets 1  
Estimated cost \$ 150. Fee \$ .75

Will there be in charge of the above work a person competent to see that the State and City requirements pertaining thereto are observed? yes

Signature of owner

Ernest Barbour

INSPECTION COPY

Walter P. Barbour

CHIEF OF PLAN DEPT.

6491

62-15-  
Ward 9 Permit No 28/896  
Location 95 Edgeworth Ave.  
Owner Ernest Barbour  
Date of permit 5/17/28  
Notif. closing-in \_\_\_\_\_  
If sing-in \_\_\_\_\_  
Final Notif. \_\_\_\_\_  
Final Insp. 6/21/28 MB  
Cert. of Occupancy issued \_\_\_\_\_

NOTES





Location, ownership, and detail must be correct, complete and legible. Separate application required for every building.

### APPLICATION FOR PERMIT TO BUILD A PRIVATE GARAGE

Portland, Me., January 24, 1924 19

To THE  
INSPECTOR OF BUILDINGS

The undersigned hereby applies for a permit to build, according to the following Specifications:-

Location 25 - lot 85 Edgewort Ave Fire Districts no Ward 8  
 Name of owner is? Ernest Barbour Address 32 Leeman Street  
 Name of mechanic is? owner Address \_\_\_\_\_  
 Proposes occupancy of building (purpose)? Private garage for one  
 cars only, and no space to be let.  
 Not nearer than two feet from any lot line, will not obstruct windows of adjoining property.  
 A Pyrene fire extinguisher to be kept in garage.  
 Size of building, No. of feet front? 8ft; No. of feet rear? 8ft; No. of feet deep? 14ft  
 No. of stories? 1  
 No. of feet in height from the mean grade of street to the highest part of the roof? 12ft  
 Floor to be? \_\_\_\_\_  
 Will the roof be flat, pitch, mansard, or hip? pitch Material of roofing? asphalt  
 Will there be a chimney? no Will the flues be lined? \_\_\_\_\_ No stoves to be used  
 Will the building conform to the requirements of the law? yes  
 Will the building be as good in appearance as other surrounding buildings? yes  
 Have you or any person acting for you previously applied for a permit to build a private garage? no  
 If so, state the particulars \_\_\_\_\_  
 \_\_\_\_\_  
 \_\_\_\_\_  
 \_\_\_\_\_

Estimated Cost,  
\$ 100.

Signature of owner or authorized representative,

Ernest Barbour

Address, # 32 Leeman St



lot 83 Edgeworth Ave.

No. 5655

APPLICATION FOR  
PRIVATE GARAGE

LOCATION

No. lot 6. Edgeworth Ave

91-5

WARD 8

PERMIT GRANTED

Jan 24, 1924

102



Location, ownership and detail must be correct, complete and legible. Separate application required for every building. Plans must be filed with this application.

APPLICATION FOR PERMIT TO BUILD  
(3rd CLASS BUILDING)

Portland, Me., January 24, 1924 19

TO THE  
INSPECTOR OF BUILDINGS

The undersigned hereby applies for a permit to build, according to the following Specifications:-

Location 98 - lot 83 Edgeworth Avenue Ward 8 Fire Limits? no  
 Name of owner is? Ernest Barbour Address 32 Lee-man Street  
 Name of mechanic is? owner Address \_\_\_\_\_  
 Name of architect is? \_\_\_\_\_ Address \_\_\_\_\_  
 Proposed occupancy of building (purpose)? dwelling  
 If a dwelling or tenement house, for how many families? 1  
 Are there to be stores in lower story? \_\_\_\_\_  
 Size of lot, No. of feet front? \_\_\_\_\_; No. of feet rear? \_\_\_\_\_; No. of feet deep? \_\_\_\_\_  
 Size of building, No. of feet front? 25ft; No. of feet rear? 25ft; No. of feet deep? 26ft  
 No. of stories, front? 1 1/2; rear? \_\_\_\_\_  
 No. of feet in height from the mean grade of street to the highest part of the roof? 25ft  
 Distance from lot lines, front? \_\_\_\_\_ feet; side? \_\_\_\_\_ feet; side? \_\_\_\_\_ feet; rear? \_\_\_\_\_  
 Firestop to be used? yes  
 Will the building be erected on solid or filled land? solid  
 Will the foundation be laid on earth, rock or piles? \_\_\_\_\_  
 If on piles, No. of rows? \_\_\_\_\_ distance on centres? \_\_\_\_\_ length of? \_\_\_\_\_  
 Diameter, top of? \_\_\_\_\_ diameter, bottom of? \_\_\_\_\_  
 Size of posts, 4 x 6 Studding 2 x 4 16 O. C. Sills 4 x 8 Roof Rafters 2 x 6 24 O. C Girders 6 x 8  
 Size of girts 4 x 4  
 Size of floor timbers: 1st floor 2x8, 2d \_\_\_\_\_, 3d \_\_\_\_\_, 4th \_\_\_\_\_  
 O. C. " " " " 16, 2d \_\_\_\_\_, 3d \_\_\_\_\_, 4th \_\_\_\_\_  
 Span " " " " not over 16ft, 3d \_\_\_\_\_, 4th \_\_\_\_\_  
 Will the building be properly braced? \_\_\_\_\_  
 Building, how framed? \_\_\_\_\_  
 Material of foundation? concrete thickness of? 12in laid with mortar? \_\_\_\_\_  
 Underpinning, material of? concrete height of? 3ft thickness of? 8in  
 Will the roof be flat, pitch, mansard or hip? pitch Material of roofing? asphalt  
 Will the building be heated by steam, furnaces, stoves or grates? hot air Will the flues be lined? yes  
 Will the building conform to the requirements of the law? yes  
 Means of egress? \_\_\_\_\_

Plans must be submitted in duplicate, one set to be filed with the Department and the duplicate set thereof (bearing the approval of the Inspector of Buildings) shall be kept on the work and exhibited on demand.

PERMIT MUST BE RECEIVED BEFORE BEGINNING WORK

If the building is to be occupied as a Tenement House, give the following particulars

What is the height of cellar or basement? \_\_\_\_\_  
 What will be the clear height of first story? \_\_\_\_\_ second? \_\_\_\_\_ third? \_\_\_\_\_  
 State what means of egress is to be provided \_\_\_\_\_  
 Scuttle and stepladder to roof? \_\_\_\_\_

Estimated Cost,

\$ 3,000.

Signature of owner or authorized representative,

Ernest Barbour

Address, # 32 Lee-man St.

Plans submitted? \_\_\_\_\_ Received by? \_\_\_\_\_

