

Yard 9 Permit No. 36/300
 Loc. 89 011a St.
 Owner: C. O. R. R. R.
 Date of permit 3/30/36
 No. ...
 Inspn. closing-in
 Final Notif.
 Final Inspn: 11/24/36
 Cert. of Occupancy issued

5/27/36 - Same - O.C.C.
 6/5/36 - Same - O.C.C.
 6/13/36 - Same - O.C.C.
 6/23/36 - Same - O.C.C.
 7/15/36 - Same - O.C.C.
 8/1/36 - Same - O.C.C.
 8/13/36 - Same - O.C.C.
 8/24/36 - Same - O.C.C.
 9/12/36 - Same - O.C.C.
 10/9/36 - Same - O.C.C.
 10/23/36 - Same - O.C.C.
 11/20/36 - Same - O.C.C.
 11/20/36 - Same - O.C.C.

NOTES:
 3/30/36 - Started work
 3/25/36 - Building out OK
 4/15/36 - No work started
 4/19/36 - Building frame
 4/24/36 - Building frame
 4/28/36 - Building frame
 5/1/36 - Building frame
 5/7/36 - Building frame
 5/15/36 - Same - O.C.C.



(R) GENERAL RESIDENCE ZONE Permit No. 0300
PERMIT

APPLICATION FOR PERMIT

Class of Building or Type of Structure Third Class MAR 20 1936

Portland, Maine, March 28, 1936

To the INSPECTOR OF BUILDINGS, PORTLAND, ME.

The undersigned hereby applies for a permit to erect/alter/install the following building structure/equipment in accordance with the Laws of the State of Maine, the Building Code of the City of Portland, plans and specifications, if any, submitted herewith and the following specifications:

Location 89 Alba Street Ward 9 Within Fire Limits? no Dist. No. _____
Owner's or Lessee's name and address Clara H. Folwertschny, 89 Alba St. Telephone _____
Contractor's name and address Ernest E. Gould, 61 Montreal St. Telephone 2-8241
Architect's name and address _____
Proposed use of building 1 car garage No. families _____
Other buildings on same lot 1 family dwelling
Plans filed as part of this application? yes No. of sheets 1
Estimated cost \$ 20. Fee \$.50

Description of Present Building to be Altered

Material wood No. stories 1 Heat _____ Style of roof _____ Roofing _____
Last use 1 car garage & poultry house No. families _____

General Description of New Work

To demolish ~~existing~~ building 14x14 and
To rebuild as one car garage 18x20 on same property
Side walls of building to be clapboarded

NOTIFICATION BEFORE
OR CLOSING-IN IS REQUIRED.
CERTIFICATE OF OCCUPANCY
REQUIREMENT BY SECTION 111

It is understood that this permit does not include installation of heating apparatus which is to be taken out separately by the name of the heating contractor.

Details of New Work

Size, front 22' depth 20' No. stories 1 Height average grade to top of plate. 8 1/2'
Height average grade to highest point of roof 11 1/2'
To be erected on solid or filled land? solid earth or rock? earth
Material of foundation concrete piers Thickness, top _____ bottom _____
Material of underpinning _____ Height _____ Thickness _____
Kind of Roof pitch Rise per foot 5" Roof covering Asphalt roofing Class C Und. Loh.
No. of chimneys no Material of chimneys _____ of lining _____
Kind of heat no Type of fuel _____ Is gas fitting involved? _____
Corner posts 4x4 Sills 6x8 Girt or ledger board? _____ Size _____
Material columns under girders _____ Size _____ Max. on centers _____
Studs (outside walls and carrying partitions) 2x4-16" O. C. Girders 6x8 or larger Bridging in every floor and flat roof span over 8 feet. Sills and corner posts all one piece in cross section.
Joists and rafters: 1st floor 2x8 6x8 girder over center, 2nd _____, 3rd _____, roof 2x8
On centers: 1st floor 2', 2nd _____, 3rd _____, roof 2'
Maximum span: 1st floor 8', 2nd _____, 3rd _____, roof _____

If one story building with masonry walls, thickness of walls? 18" m. height? _____

If a Garage

No. cars now accommodated on same lot 1, to be accommodated 1
Total number commercial cars to be accommodated none
Will automobile repairing be done other than minor repairs to cars habitually stored in the proposed building? no

Miscellaneous

Will above work require removal or disturbing of any shade tree on a public street? no
Will there be in charge of the above work a person competent to see that the State and City requirements pertaining thereto are observed? _____

INSPECTION COPY Clara H. Folwertschny Signature of Owner By Ernest E. Gould

CHIEF OF FIRE DEPT.

37523



APPLICATION FOR PERMIT

PERMIT ISSUED

Class of Building or Type of Structure Third Class

Permit No. APR 1 1911

Portland, Maine, April 1, 1911

To the INSPECTOR OF BUILDINGS, PORTLAND, ME.

The undersigned hereby applies for a permit to erect alter install the following building structure equipment in accordance with the Laws of the State of Maine, the Building Code of the City of Portland, plans and specifications, if any, submitted herewith and the following specifications:

Location 89 Albe Street Within Fire Limits? no Dist. No.
Owner's name and address Ernest Gould, 89 Albe Street Telephone
Contractor's name and address Ivan S. Bryan, 9 Bedell St. Telephone 3-5966
Architect Plans filed no No. of sheets
Proposed use of building dwelling house No. families 1
Other buildings on same lot garage
Estimated cost \$15. Fee \$.25

Description of Present Building to be Altered

Material wood No. stories 1 1/2 Heat Style of roof Roofing
Last use dwelling house No. families 1

General Description of New Work

To cut in one new window in first floor hall, side of building.

It is understood that this permit does not include installation of heating apparatus which is to be taken out separately by and in the name of the heating contractor.

Details of New Work

Is any plumbing work involved in this work?
Is any electrical work involved in this work? Height average grade to top of plate
Size, front depth No. stories Height average grade to highest point of roof
To be erected on soil or filled land? earth or rock?
Material of foundation Thickness, top bottom cellar
Material of underpinning Height Thickness
Kind of roof Rise per foot Roof covering
No. of chimneys Material of chimneys of lining
Kind of heat Type of fuel Is gas fitting involved?
Framing lumber--Kind Dressed or full size?
Corner posts Sills Girt or ledger board? Size
Material columns under girders Size M.x. on centers
Studs (outside walls and carrying partitions) 2x4-16" O. C. Girders 6x8 or larger. Bridging in every floor and flat roof span over 8 feet. Sills and corner posts all one piece in cross section.
Joists and rafters 1st floor 2nd 3rd roof
On centers: 1st floor 2nd 3rd roof
Maximum span: 1st floor 2nd 3rd roof
If one story building with masonry walls, thickness of walls? height?

If a Garage

No. cars now accommodated on same lot to be accommodated
Total number commercial cars to be accommodated
Will automobile repairing be done other than minor repairs to cars habitually stored in the proposed building?

Miscellaneous

Will above work require removal or disturbing of any shade tree on a public street? no
Will there be in charge of the above work a person competent to see that the State and City requirements pertaining thereto are observed? yes

Signature of owner Ernest Gould

Ivan S. Bryan

INSPECTION COPY

91050



APPLICATION FOR PERMIT

PERMIT ISSUED

Class of Building or Type of Structure Third Class

Portland, Maine, August 14, 1937 **AUG 14 1937**

To the INSPECTOR OF BUILDINGS, PORTLAND, ME.

The undersigned hereby applies for a permit to erect alter install the following building-structure-equipment in accordance with the Laws of the State of Maine, the Building Code of the City of Portland, plans and specifications, if any, submitted herewith and the following specifications:

Location 89 Alba Street Ward 8 Within Fire Limits? no Dist. No. _____
Owner's or Lessee's name and address Estate of Clara Folwarthohny Telephone 3-5717
Contractor's name and address Ernest E. Gould, Exec. Telephone _____
Architect _____ Plans filed yes No. of sheets 1
Proposed use of building dwelling house No. families 1
Other buildings on same lot garage on adj. lot
Estimated cost \$ 45. Fee \$.50

Description of Present Building to be Altered

Material wood No. stories 1 1/2 Heat _____ Style of roof _____ Roofing _____
Last use dwelling house No. families 1

General Description of New Work

To rebuild one story frame shed 7' x 14', making it 10' x 14' (sun parlor)

It is understood that this permit does not include installation of heating apparatus which is to be taken out separately by and in the name of the heating contractor.

Details of New Work

CERTIFICATE OF OCCUPANCY REQUIREMENT IS WAIVED.

Size, front 14' depth 10' No. stories 1 Height average grade to top of plate _____
To be erected on solid or filled land? solid earth or rock? earth
Material of foundation concrete Thickness, top 10" bottom 12"
Material of underpinning concrete blocks Height 2' Thickness 8"
Kind of Roof flat Rise per foot 5/8" Roof covering Asphalt roofing Class 0 Und. Lab.
No. of chimneys no Material of chimneys _____ of lining _____
Kind of heat _____ Type of fuel _____ Is gas fitting involved? _____
Corner posts 4x4 Sills 4x6 Girt or ledger board? _____ Size _____
Material columns under girders _____ Size _____ Max. on centers _____
Studs (outside walls and carrying partitions) 2x4-16" O. C. Girders 6x8 or larger. Bridging in every floor and 1st roof span over 8 feet. Sills and corner posts all one piece in cross section.
Joists and rafters: 1st floor 2x7, 2nd _____, 3rd _____, roof 2x7
On centers: 1st floor 16", 2nd _____, 3rd _____, roof 16"
Maximum span: 1st floor 10', 2nd _____, 3rd _____, roof 10'
If one story building with masonry walls, thickness of walls? _____ height? _____

If a Garage

No. cars now accommodated on same lot _____, to be accommodated _____
Total number commercial cars to be accommodated _____
Will automobile repairing be done other than minor repairs to cars habitually stored in the proposed building? _____

Miscellaneous

Will above work require removal or disturbing of any shade tree on a public street? no
Will there be in charge of the above work a person competent to see that the State and City requirements pertaining thereto are observed? yes
Estate of Clara Folwarthohny

Signature of owner Ernest E. Gould

INSPECTION COPY

Ernest E. Gould ext.

49413

STATEMENT ACCOMPANYING APPLICATION FOR BUILDING PERMIT

for rebuild shed

at 89-Alba Street

Date 8/14/37

1. In whose name is the title of the property now recorded? Clara Falwarchny
2. Are the boundaries of the property in the vicinity of the proposed work shown clearly on the ground, and how? Fenced in stak
3. Is the outline of the proposed work now staked out upon the ground? yes If not, will you notify the Inspection Office when the work is staked out and before any of the work is commenced?
4. What is to be maximum projection or overhang of eaves or drip? 6"
5. Do you assume full responsibility for the correctness of the location plan or statement of location filed with this application, and does it show the complete outline of the proposed work on the ground, including bay windows, porches and other projections? yes
6. Do you assume full responsibility for the correctness of all statements in the application concerning the sizes, design and use of the proposed building? yes
7. Do you understand that in case changes are proposed in the location of the work or in any of the details specified in the application that a revised plan and application must be submitted to this office before the changes are made? yes

Ernest E. Gould



GENERAL RESIDENCE ZONE
APPLICATION FOR PERMIT

PERMIT ISSUED
Permit No. 1241

Class of Building or Type of Structure Third Class AUG 12 1939

To the INSPECTOR OF BUILDINGS, PORTLAND, ME. Portland, Maine, August 11, 1939

The undersigned hereby applies for a permit to erect, alter, install, the following building structure, equipment in accordance with the Laws of the State of Maine, the Building Code of the City of Portland, plans and specifications, if any, submitted herewith and the following specifications:

Location 89 Alba Street Within Fire Limits? no Dist. No. _____
Owner's or Lessee's name and address Ernest E. Gould, 89 Alba Street Telephone 3-5717
Contractor's name and address William F. Frey, 111 Breatwood Street Telephone _____
Architect _____ Plans filed no No. of sheets _____
Proposed use of building dwelling house No. families 1
Other buildings on same lot _____
Estimated cost \$ 35. Fee \$.50

Description of Present Building to be Altered

Material wood No. stories 1 1/2 Heat _____ Style of roof _____ Roofing _____
Last use dwelling house No. families 1

General Description of New Work

To cut off one end of existing one story front piazza portion 9' x 7'
To cover roof of remaining portion of piazza

NOTIFICATION DEPT. OF HEALTH
OR CLOSING-IN
CERTIFICATION AND IN THE NAME OF
CITY OF PORTLAND
REQUIREMENT IS WAIVED

It is understood that this permit does not include installation of heating apparatus which is to be taken out separately by the heating contractor.

Details of New Work

Is any plumbing work involved in this work? _____
Is any electrical work involved in this work? _____ Height average grade to top of plate _____
Size, front _____ depth _____ No. stories _____ Height average grade to highest point of roof _____
To be erected on solid or filled land? _____ earth or rock? _____
Material of foundation _____ Thickness, top _____ bottom _____ cellar _____
Material of underpinning _____ Height _____ Thickness _____
Kind of Roof _____ Rise per foot _____ Roof covering Asphalt roofing Class C Und. Lab.
No. of chimneys _____ Material of chimneys _____ of lining _____
Kind of heat _____ Type of fuel _____ Is gas fitting involved? _____
Framing Lumber—Kind _____ Dressed or Full Size? _____
Corner posts _____ Sills _____ Girt or ledger board? _____ Size _____
Material columns under girders _____ Size _____ Max. on centers _____
Studs (outside walls and carrying partitions) 2x4-16" O. C. Girders 6x8 or larger. Bridging in every floor and flat roof span over 8 feet. Sills and corner posts all one piece in cross section.
Joists and rafters: 1st floor _____, 2nd _____, 3rd _____, roof _____
On centers: " 1st floor _____, 2nd _____, 3rd _____, roof _____
Maximum span: 1st floor _____, 2nd _____, 3rd _____, roof _____
If one story building with masonry walls, thickness of walls? _____ height? _____

If a Garage

No. cars now accommodated on same lot _____, to be accommodated _____
Total number commercial cars to be accommodated _____
Will automobile repairing be done other than minor repairs to cars habitually stored in the proposed building? _____

Miscellaneous

Will above work require removal or disturbing of any shade tree on a public street? no
Will there be in charge of the above work a person competent to see that the State and City requirements pertaining thereto are observed? yes
Signature of owner Ernest E. Gould

INSTRUCTION COPY



FILL IN COMPLETELY AND SIGN WITH INK

APPLICATION FOR PERMIT FOR HEATING, COOKING OR POWER EQUIPMENT

PERMIT ISSUED
11/3/39

To the INSPECTOR OF BUILDINGS, PORTLAND, ME.

Portland, Maine, 11/3/39 1939

The undersigned hereby applies for a permit to install the following heating, cooking or power equipment in accordance with the Laws of Maine, the Building Code of the City of Portland, and the following specifications:

Location 89 Alba St Use of Building Dwelling No. Stories 1 New Building Existing "Existing"
Name and address of owner of appliance C. C. Gauld 89 Alba St
Installer's name and address Gauld Farm Co Telephone 38187

General Description of Work

To install oil burner in warm air furnace

IF HEATER, POWER BOILER OR COOKING DEVICE

Is appliance or source of heat to be in cellar? yes If not, which story 1st Kind of Fuel oil
Material of supports of appliance (concrete floor or what kind) concrete
Minimum distance to wood or combustible material, from top of appliance or casing top of furnace, _____
from top of smoke pipe _____ from front of appliance _____ from sides or back of appliance _____
Size of chimney flue _____ Other connections to same flue _____

IF OIL BURNER

Name and type of burner Petro P9X Labeled and approved by Underwriters' Laboratories? yes
Will operator be always in attendance? No Type of oil feed (gravity or pressure) gravity
Location oil storage Basement No. and capacity of tanks 1 - 75 gal
Will all tanks be more than seven feet from any flammable? yes How many tanks fireproofed? 1
Amount of fee enclosed 1.00 (\$1.00 for one heater, etc., 60 cents additional for each additional heater, etc., in same building at same time.)

INSPECTION COPY

Signature of Installer Gauld Farm Co
E. T. Allen 59060

37-93 ALBA STREET

SHAMWALKER

920R • Half cut # 9202R • Third cut # 9203R • Fifth cut # 9205R

APPLICATION FOR PERMIT
DEPARTMENT OF BUILDING INSPECTIONS SERVICES
ELECTRICAL INSTALLATIONS

Date July 28, 1992, 19
 Receipt and Permit number 4234

Electrical installations in accordance with the laws of
 Electrical Code and the following specifications:

Electrical Inspector, Portland, Maine
 I hereby apply for a permit to make electrical installations in accordance with the laws of
 and Electrical Ord. nce, the National Electrical Code and the following specifications:
 WORK: 89 Alba St.
Pat Cushman ADDRESS: 89 Alba
 30 Switches 12 Plug mold
 2 Fluorescent (hot strip)
 2 Fluorescent ft.
 Underground Temporary TOTAL amperes
 HEATING:
 (number of units)
 (number of rooms)
 FOR INDUSTRIAL HEATING:
 (by main boiler)
 (by separate units)
 Under 20 kw Over 20 kw
 (number of)
 Water Heaters
 Disposal
 Dishwashers
 Contractors
 Others (denote)

FEES	
ft. TOTAL	8.40
TOTAL	2.40
TOTAL amperes	
Water Heaters	
Disposal	
Dishwashers	
Contractors	
Others (denote)	



CEILING: 20' 00"
 FOUNDATION: 1-1/2" W. CON/LA/4" ft
 INTERIOR RENOVATIONS & CONST ADDITION
 FOUNDATION: 1-1/2" W. CON/LA/4" ft
 CEILING: 20' 00"
 FOUNDATION: 1-1/2" W. CON/LA/4" ft

DATE: 7/23/92
 TIME: 2:00 PM
 REVIEW REQUIRED: NO
 ZONING: R-3
 SUBDIVISION: 4-27-92
 MASS. PERMIT NO.: 4234

FOUNDATION:
 1. Type of Soil:
 2. Depth:
 3. Foundation Size:
 4. Other:
 Sills must be anchored.

CEILING:
 1. Ceiling Joist Size:
 2. Ceiling Strapping Size:
 3. Insulation Type:
 4. Ceiling Height:
 Roof:
 1. Truss or Rafter Size:
 2. Sheathing Type:
 3. Roof Covering Type:
 Chimneys:
 1. Type:
 2. Size:
 3. Must conform to National Electrical Code and State Law.

EXTERIOR WALLS:
 1. Studding Size:
 2. No. Windows:
 3. No. Doors:
 4. Header Size:
 5. Bracing:
 6. Corner Posts Size:
 7. Insulation Type:
 8. Sheathing Type:
 9. Siding Type:
 10. Masonry Materials:
 11. Metal Materials:

ELECTRICAL:
 Service Entrance Size:
 Smoke Detector Required:
 Plumbing:
 1. Approval of soil test, if required:
 2. No. of Tubs or Showers:
 3. No. of Lavatories:
 4. No. of Other Fixtures:
 Swimming Pools:
 1. Type:
 2. Pool Size:
 3. Must conform to National Electrical Code and State Law.

INTERIOR WALLS:
 1. Studding Size:
 2. Header Size:
 3. Wall Covering Type:
 4. Fire Wall if required:
 5. Other Materials:

PERMIT RECEIVED BY: LOUISE E. CHASE
 SIGNATURE OF APPLICANT: Pat Cushman DATE: 7-23-92
 CEO'S DISTRICT: Pat Cushman
 CONTINUED TO REVERSE SIDE
 IVORY TAG - CEO
Mr. Carroll

INSPECTOR'S COPY — WHITE
 OWNER'S COPY — CANARY
 CONTRACTOR'S COPY — GREEN

923600

Permit # 923600 City of Portland BUILDING PERMIT APPLICATION Fee 3 Zone Map # Lot #
Please fill out any part which applies to job. Proper plans must accompany form.

Owner: Patrick Cushman Phone # 751-0291 *

Address: 99 Alba St; Pld, NE 04103

LOCATION OF CONSTRUCTION 99 Alba St.

Contractor: Pld Bldrs Sub.:

Address: Phone #

Est. Construction Cost: 20,000. Proposed Use: 1-fam w ren/addtn
Past Use: 1-fam

of Existing Res. Units # of New Res. Units

Building Dimensions L W Total Sq. Ft.

Stories: # Bedrooms Lot Size:

Is Proposed Use: Seasonal Condominium Conversion

Explain Conversion Interior renovations & const addition

For Official Use Only

Date: 4/23/92 Subdivision: Name: Lot:

Inside Fire Lim: Ownership:

Bldg Code: Estimated Cost: 000

Time Limit:

Zoning: R

Street Frontage Provided:

Provided Setbacks: Front Back Side Side

Review Required:

Zoning Board Approval: Yes No Date:

Planning Board Approval: Yes No Date:

Conditional Use: Variance Site Plan Subdivision

Shoreland Zoning Yes No Floodplain Yes No

Special Exception

Other (Explain)

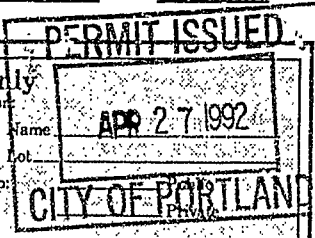

Foundation:

1. Type of Soil:

2. Set Backs - Front Rear Side(s)

3. Footings Size:

4. Foundation Size:

5. Other

Floor:

1. Sills Size: Sills must be anchored.

2. Girder Size:

3. Lally Column Spacing: Size:

4. Joists Size: Spacing 16" O.C.

5. Bridging Type: Size:

6. Floor Sheathing Type: Size:

7. Other Material:

Exterior Walls:

1. Studding Size Spacing

2. No. windows

3. No. Doors

4. Header Sizes Span(s)

5. Bracing: Yes No

6. Corner Posts Size

7. Insulation Type Size

8. Sheathing Type Size

9. Siding Type Weather Exposure

10. Masonry Materials

11. Metal Materials

Interior Walls:

1. Studding Size: Spacing

2. Header Sizes Span(s)

3. Wall Covering Type

4. Fire Wall if required

5. Other Materials

Ceiling:

1. Ceiling Joists Size:

2. Ceiling Strapping Size Spacing Not in District nor Landmark

3. Type Ceilings: Does not require review

4. Insulation Type Size Requires Review

5. Ceiling Height:

Roof:

1. Truss or Rafter Size Span Action: Approved

2. Sheathing Type Size Approved with Condition

3. Roof Covering Type

Chimneys:

Type: Number of Fire Places

Heating:

Type of Heat:

Electrical:

Service Entrance Size: Smoke Detector Required Yes No

Plumbing:

1. Approval of soil test if required Yes No

2. No. of Tubs or Showers

3. No. of Flushes

4. No. of Lavatories

5. No. of Other Fixtures

Swimming Pools:

1. Type:

2. Pool Size: x Square Footage

3. Must conform to National Electrical Code and State Law.

Permit Received By Louise R Chase

Signature of Applicant Patrick Cushman Date

CEO's District

White - Tax Assessor

CONTINUED TO REVERSE SIDE
Ivory Tag - CEO

PLOT PLAN

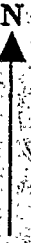

FEES (Breakdown From Front)

Base Fee \$ 120-
 Subdivision Fee \$ _____
 Site Plan Review Fee \$ _____
 Other Fees \$ _____
 (Explain) _____
 Late Fee \$ _____

Inspection Record

Type	Date
_____	____/____/____
_____	____/____/____
_____	____/____/____
_____	____/____/____

COMMENTS

5/20/92 Foundation / setbacks OK
4/7/92 work completed - never called after 5/20/92

CERTIFICATION

I hereby certify that I am the owner of record of the named property, or that the proposed work is authorized by the owner of record and that I have been authorized by the owner to make this application as has authorized agent and I agree to conform to all applicable laws of this jurisdiction. In addition, if a permit for work described in this application is issued, I certify that the code official or the code official's authorized representative shall have the authority to enter areas covered by such permit at any reasonable hour to enforce the provisions of the code(s) applicable to such permit.

Robert B. Cochran
 SIGNATURE OF APPLICANT

89 Alba ST. Portland
 ADDRESS

761-0298
 PHONE NO.

RESPONSIBLE PERSON IN CHARGE OF WORK, TITLE

PHONE NO.

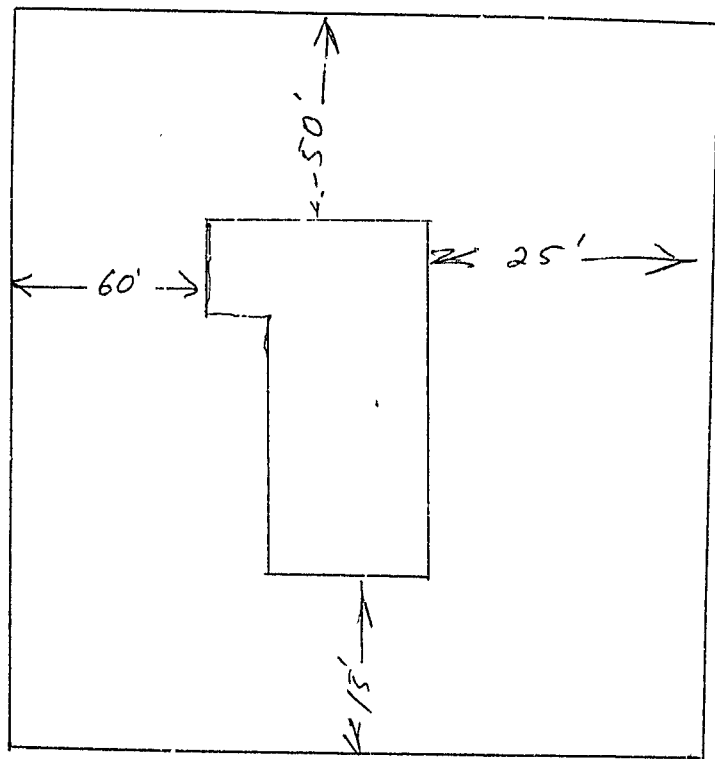

100'
89 A13A

DECEMBER
APR 2 5 1992
FEDERAL BUREAU OF INVESTIGATION
U.S. DEPARTMENT OF JUSTICE